

NSL

Initial

Application

RECEIVED: 03/03/21	REVIEWER: LRL	TYPE: NSL	APP NO: pLEL2106431906
---------------------------	----------------------	------------------	-------------------------------

ABOVE THIS TABLE FOR OCD DIVISION USE ONLY

NEW MEXICO OIL CONSERVATION DIVISION
 - Geological & Engineering Bureau -
 1220 South St. Francis Drive, Santa Fe, NM 87505

**ADMINISTRATIVE APPLICATION CHECKLIST**

THIS CHECKLIST IS MANDATORY FOR ALL ADMINISTRATIVE APPLICATIONS FOR EXCEPTIONS TO DIVISION RULES AND
 REGULATIONS WHICH REQUIRE PROCESSING AT THE DIVISION LEVEL IN SANTA FE

Applicant: SPUR ENERGY PARTNERS LLC **OGRID Number:** 328947
Well Name: ROSE SOUTH 50H **API:** 30-015-PENDNG
Pool: PENASCO DRAW; SA-YESO (ASSOC) **Pool Code:** 50270

**SUBMIT ACCURATE AND COMPLETE INFORMATION REQUIRED TO PROCESS THE TYPE OF APPLICATION
 INDICATED BELOW**

- 1) **TYPE OF APPLICATION:** Check those which apply for [A]
 A. Location – Spacing Unit – Simultaneous Dedication
☒ NSL ☐ NSP (PROJECT AREA) ☐ NSP (PRORATION UNIT) ☐ SD
- B. Check one only for [I] or [II]
 [I] Commingling – Storage – Measurement
☐ DHC ☐ CTB ☐ PLC ☐ PC ☐ OLS ☐ OLM
 [II] Injection – Disposal – Pressure Increase – Enhanced Oil Recovery
☐ WFX ☐ PMX ☐ SWD ☐ IPI ☐ EOR ☐ PPR
- 2) **NOTIFICATION REQUIRED TO:** Check those which apply.
 A. ☒ Offset operators or lease holders
 B. ☐ Royalty, overriding royalty owners, revenue owners
 C. ☐ Application requires published notice
 D. ☒ Notification and/or concurrent approval by SLO
 E. ☐ Notification and/or concurrent approval by BLM
 F. ☐ Surface owner
 G. ☐ For all of the above, proof of notification or publication is attached, and/or,
 H. ☐ No notice required

FOR OCD ONLY

- ☐ Notice Complete
☐ Application
 Content
 Complete

- 3) **CERTIFICATION:** I hereby certify that the information submitted with this application for administrative approval is **accurate** and **complete** to the best of my knowledge. I also understand that **no action** will be taken on this application until the required information and notifications are submitted to the Division.

Note: Statement must be completed by an individual with managerial and/or supervisory capacity.

MARCH 3, 2021

Date

SARAH CHAPMAN

Print or Type Name

832-930-8613

Phone Number

Sarah Chapman

Signature

SCHAPMAN@SPUREPLLC.COM

e-mail Address



March 3, 2021

New Mexico Oil Conservation Division
1220 South St. Francis Dr.
Santa Fe, NM 87505

Attention: Leonard Lowe

RE: ***Application for Administrative Approval of Non- Standard Location
Rose South 50H – Penasco Draw; SA-Yeso (Assoc) (50270)
Surface Hole – 2280’ FSL 700’ FWL Lot 3 Sec 7 T19S R26E
First Take Point – 2580’ FSL 100’ FEL Unit I Sec 12 T19S R25E
Last Take Point – 2580’ FSL 100’ FWL Unit L Sec 12 T19S R25E
Bottom Hole – 2580’ FSL 50’ FWL Unit L Sec 12 T19S R25E
Eddy County, New Mexico***

Dear Mr. Lowe:

Spur Energy Partners LLC respectfully requests administrative approval of a non-standard location on the Rose South 10H, API Number 30-015-Pending, Property Code Pending. The 10H well is proposed to be completed in the Penasco Draw; SA-Yeso (Assoc) pool, Pool Code 50270. The proposed wellbore is to be completed within 330’ feet of the S/2 of the N/2 of Section 12. The proposed interval is projected as follows:

Surface Hole – 2280’ FSL 700’ FWL Lot 3 Sec 7 T19S R26E
First Take Point – 2580’ FSL 100’ FEL Unit I Sec 12 T19S R25E
Last Take Point – 2580’ FSL 100’ FWL Unit L Sec 12 T19S R25E
Bottom Hole – 2580’ FSL 50’ FWL Unit L Sec 12 T19S R25E

The adjoining units which the unorthodox location encroaches are located in T19S R25E, Section 12, Units E, F, G and H.

Approval of the unorthodox completed interval will allow for efficient spacing of horizontal wells and thereby prevent waste.

To support this request, the following information has been submitted for your review:

1. Application Checklist
2. C-102 Plat for proposed well and an additional plat with offsetting affected units
3. List of affected parties in each of the units in the same pool located closer to the unorthodox well location that the minimum distance prescribed by rule or order, copies of the sign certified return copies will be furnished upon request
4. Service List

If you need any additional information, please call me at 832-930-8613.

Sincerely,

Sarah Chapman

Regulatory Director

Attachments
CC: Service List

District I
1625 N. French Dr., Hobbs, NM 88240
Phone: (575) 393-6161 Fax: (575) 393-0720
District II
811 S. First St., Artesia, NM 88210
Phone: (575) 748-1283 Fax: (575) 748-9720
District III
1000 Rio Brazos Road, Aztec, NM 87410
Phone: (505) 334-6178 Fax: (505) 334-6170
District IV
1220 S. St. Francis Dr., Santa Fe, NM 87505
Phone: (505) 476-3460 Fax: (505) 476-3462

State of New Mexico
Energy, Minerals & Natural Resources Department
OIL CONSERVATION DIVISION
1220 South St. Francis Dr.
Santa Fe, NM 87505

Form C-102
Revised August 1, 2011
Submit one copy to appropriate
District Office

☐ AMENDED REPORT

WELL LOCATION AND ACREAGE DEDICATION PLAT

¹ API Number 30-015-		² Pool Code 50270		³ Pool Name PENASCO DRAW; SA-YESO (ASSOC)	
⁴ Property Code		⁵ Property Name ROSE SOUTH			⁶ Well Number 50H
⁷ OGRID NO. 328947		⁸ Operator Name SPUR ENERGY PARTNERS LLC.			⁹ Elevation 3384'

¹⁰ Surface Location

UL or lot no.	Section	Township	Range	Lot Idn	Feet from the	North/South line	Feet From the	East/West line	County
3	7	19S	26E		2280	SOUTH	700	WEST	EDDY

¹¹ Bottom Hole Location If Different From Surface

UL or lot no.	Section	Township	Range	Lot Idn	Feet from the	North/South line	Feet from the	East/West line	County
L	12	19S	25E		2580	SOUTH	50	WEST	EDDY
¹² Dedicated Acres 320	¹³ Joint or Infill	¹⁴ Consolidation Code	¹⁵ Order No.						

No allowable will be assigned to this completion until all interest have been consolidated or a non-standard unit has been approved by the division.

<p>¹⁶ <u>GEODETIC DATA</u> NAD 83 GRID - NM EAST</p> <p><u>SURFACE LOCATION (SL)</u> N: 608976.2 - E: 512400.9 LAT: 32.6740854° N LONG: 104.4273753° W</p> <p><u>FIRST TAKE POINT (FTP)</u> 2580' FSL & 100' FEL - SEC 12 N: 609284.2 - E: 511600.4 LAT: 32.6749302° N LONG: 104.4299769° W</p> <p><u>LAST TAKE POINT (LTP)</u> 2580' FSL & 100' FWL - SEC 12 N: 609270.8 - E: 506446.4 LAT: 32.6748792° N LONG: 104.4467281° W</p> <p><u>BOTTOM HOLE (BH)</u> N: 609270.7 - E: 506396.4 LAT: 32.6748787° N LONG: 104.4468906° W</p> <p><u>CORNER DATA</u> NAD 83 GRID - NM EAST</p> <p>A: FOUND BOLT N: 606691.2 - E: 506353.0</p> <p>B: FOUND 1/2" REBAR N: 612008.3 - E: 506339.4</p> <p>C: FOUND 5/8" REBAR N: 611978.8 - E: 511694.1</p> <p>D: FOUND ALUM CAP "ILLEGIBLE" N: 612006.0 - E: 514294.2</p> <p>E: FOUND 3" PIPE N: 612034.2 - E: 516918.2</p> <p>F: FOUND SPIKE NAIL N: 609327.0 - E: 516948.7</p> <p>G: FOUND SPIKE NAIL N: 606619.9 - E: 516980.1</p> <p>H: FOUND 1" PIPE N: 606673.4 - E: 514339.7</p> <p>I: FOUND 1/2" REBAR N: 606705.1 - E: 511706.5</p>	<p>¹⁷ OPERATOR CERTIFICATION <i>I hereby certify that the information contained herein is true and complete to the best of my knowledge and belief, and that this organization either owns a working interest or unleased mineral interest in the land including the proposed bottom hole location or has a right to drill this well at this location pursuant to a contract with an owner of such a mineral or working interest, or to a voluntary pooling agreement or a compulsory pooling order heretofore entered by the division.</i></p> <p><i>Sarah Chapman</i> 03/03/2021 Signature Date</p> <p>SARAH CHAPMAN Printed Name</p> <p>SCHAPMAN@SPUREPLLC.COM E-mail Address</p> <p>¹⁸ SURVEYOR CERTIFICATION <i>I hereby certify that the well location shown on this plat was plotted from field notes of actual surveys made by me or under my supervision, and that the same is true and correct to the best of my belief.</i></p> <p>12-10-2020 Date of Survey</p> <p>Signature and Seal of Professional Surveyor 19680 Certificate Number</p>
--	---

LS20120748

Intent ☒ As Drilled ☐

API # 30-015-			
Operator Name: SPUR ENERGY PARTNERS LLC		Property Name: ROSE SOUTH	Well Number 50H

Kick Off Point (KOP)

UL	Section	Township	Range	Lot	Feet	From N/S	Feet	From E/W	County
Latitude					Longitude				NAD

First Take Point (FTP)

UL	Section	Township	Range	Lot	Feet	From N/S	Feet	From E/W	County
I	12	19S	25E		2580	SOUTH	100	EAST	EDDY
Latitude					Longitude				NAD
32.6749302					-104.4299769				NAD83

Last Take Point (LTP)

UL	Section	Township	Range	Lot	Feet	From N/S	Feet	From E/W	County
L	12	19S	25E		2580	SOUTH	100	WEST	EDDY
Latitude					Longitude				NAD
32.6748792					-104.4467281				NAD83

Is this well the defining well for the Horizontal Spacing Unit? ☐

Is this well an infill well? ☒

If infill is yes please provide API if available, Operator Name and well number for Defining well for Horizontal Spacing Unit.

API # 30-015-Pending			
Operator Name: SPUR ENERGY PARTNERS LLC		Property Name: ROSE SOUTH	Well Number 20H

KZ 06/29/2018

Spur Energy Partners LLC
Rose South 50H
Section 7 Township 19 South, Range 26 East
Eddy County, New Mexico

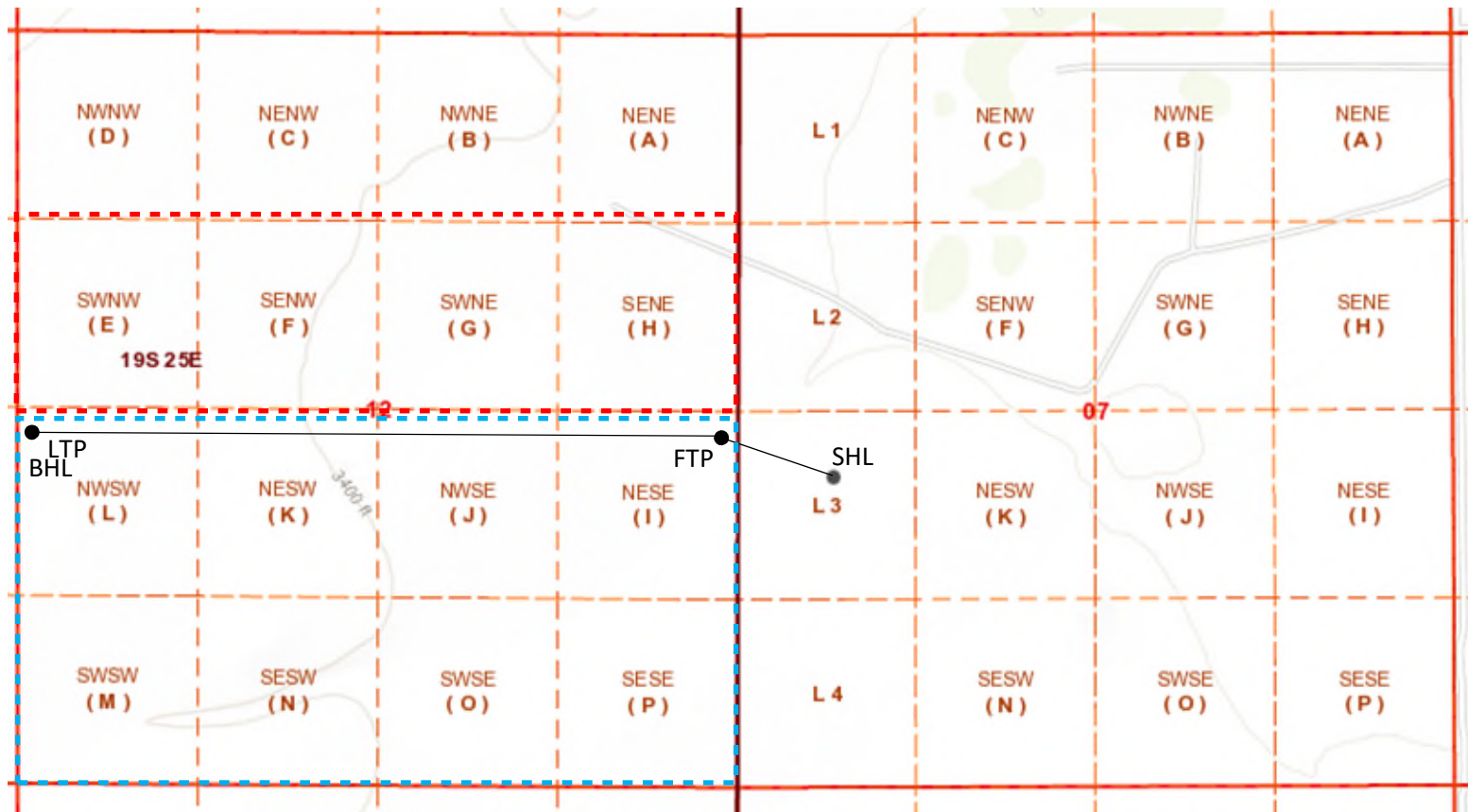

Red Outline – Affected Tracts

Blue Outline – Horizontal Spacing Unit

Application of Non-Standard Location - Service List
Spur Energy Partners LLC
Rose South 50H

New Mexico Oil Conservation Division
811 S. First St.
Artesia, NM 88210
9414 8118 9876 5897 3625 32

New Mexico Oil Conservation Division
1220 South St. Francis Dr.
Santa Fe, NM 87505
Uploaded online

New Mexico State Land Office
310 Old Santa Fe Trail
Santa Fe. NM 87501
9414 8118 9876 5897 3602 86

T19S R25E
Operator: Section 12 - Units E, F, G and H

SEP Permian LLC
9655 Katy Freeway, Suite 500
Houston, TX 77024

T19S R25E
Working Interest Ownership: Section 12 - Units E, F, G and H

SEP Permian LLC
9655 Katy Freeway, Ste 500
Houston, TX 77024

Fred Bohannon Royalty Company
P.O. Box 780573
Wichita, KS 67278
9414 8118 9876 5897 3607 36

Marianne B. Jost
3101 Castlerock Road #34
Oklahoma City, OK 73120
9414 8118 9876 5897 3606 51

Sally Ellis
771 Crescent Drive
Boulder, CO 80303
9414 8118 9876 5897 3608 42

EOG Resources, Inc.
104 South 4th Street
Artesia, NM 88210
9414 8118 9876 5897 3609 96

Hubbart Family Trust DTD 3/3/97
206 Davis Road
Hiram, GA 30141
9414 8118 9876 5897 36003 54

Copies of the application were mailed to the above individuals, companies and organizations
on March 3, 2021

Sarah Chapman

Spur Energy Partners LLC