

# Additional Information

Extension Request 3/29/21



March 29, 2021

New Mexico Oil Conservation Division  
Attn: Mr. Phillip Goetze  
1220 South St. Francis Drive  
Santa Fe, New Mexico 87505

SUBJECT: Request for Permit Extension (SWD -1987)  
Silver Bullet 16 SWD #1  
1980' FSL, 275' FEL  
Sec 16, Twp 26S, Rge 29E  
Eddy County, NM

Dear Mr. Goetze:

The purpose of this letter is to request a one-year permit extension for SWD -1987, that is scheduled to expire on 6/17/2021. My company has secured new leases that are scheduled to be developed late in 2021. Company water predictions suggest that these new wells may necessitate the drilling of this operated saltwater disposal well if additional commercial disposal capacity is not developed in the area.

Per your guidance, we have re-reviewed wells, surface owners, unleased lands, lessees, and operators, within the one (1) mile Area of Review (AOR).

**Wells within 1 Mile AOR**

Attached is an updated spreadsheet of wells located within the 1-mile AOR. There has been new horizontal oil and gas well drilling activity, but no new wells have been drilled that penetrate the Devonian-Silurian formations. The closest active Devonian SWD well is approximately 1.6 miles to the east and there is a pending Devonian SWD permit approximately 1.7 miles to the south. A Devonian SWD map has been attached for your review.

**Operators / Lessees within 1 Mile AOR**

A current offset operator / lessee / unleased owner review has been conducted and four new notifications were required. Copies of our original C-108 were mailed to the XTO Holdings, WPX and EOG Resources. A C-108 was also sent to the BLM as they own surface / minerals within the AOR. Return receipts will be emailed to you later this week.

P.O. Box 7698 • Tyler, Texas 75711  
3620 Old Bullard Road • Tyler, Texas 75701

**Seismicity Review**

Attached is a map that highlights earthquakes documented in the USGS Earthquake Catalog. The closest earthquake (1970-current) is approximately 12 miles east of the proposed Silver Bullet 16 SWD.

Please contact me if you have any questions regarding our request.

Very truly yours,



Tim Harrington  
Reservoir Engineer  
[tharrington@mewbourne.com](mailto:tharrington@mewbourne.com)

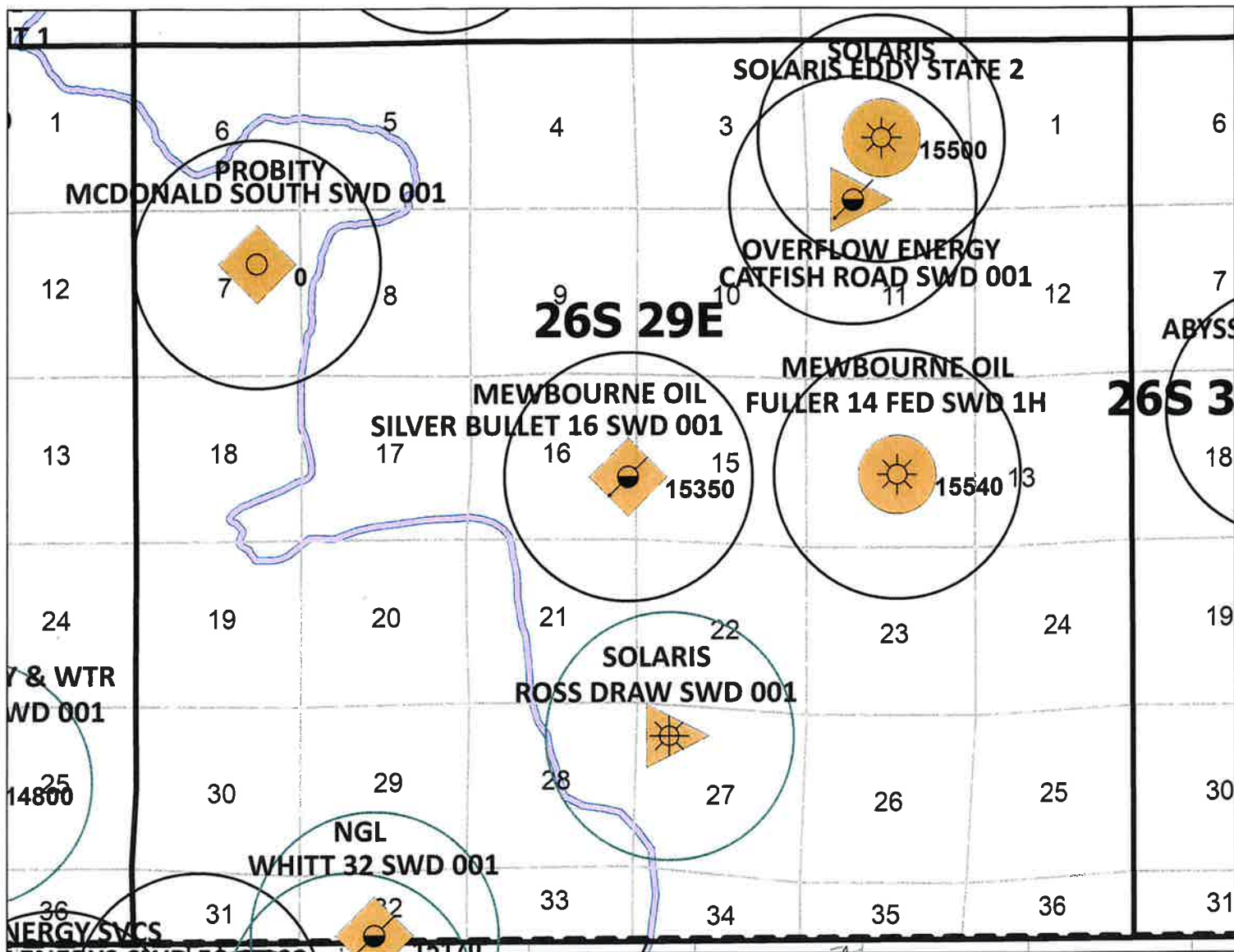

#### ACTIVE DEVONIAN SWD WELLS



TOP INTERVAL



THREE QUARTER MILE RADIUS



PERMITTED DISPOSAL WELL



ACTIVE DISPOSAL WELL



PLUGGED DISPOSAL WELLS



TEMPORARILY ABANDON



SHUT - IN REASON UNKNOWN





SWD APPLICATION

NOTE: SOURCE OF DISPOSAL DATA NMOC

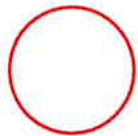
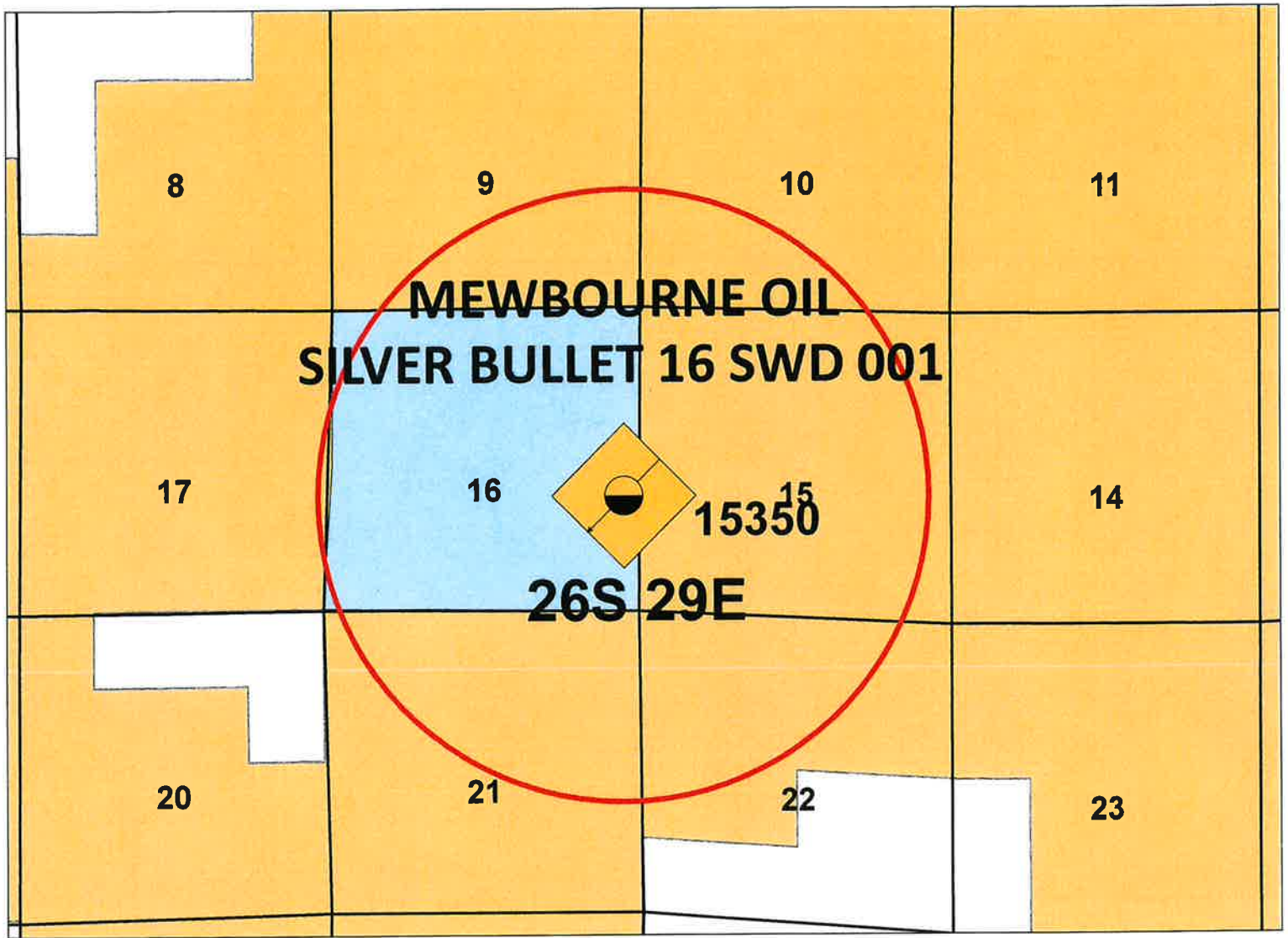
SILVER BULLET 16 SWD #1 EDDY COUNTY NEW MEXICO		
Author: Tim Harrington		Date: 12 March, 2021
Tech: sd	Scale: 1" = 11250'	



**AREA OF REVIEW**

<b>BLM LEGEND</b>	
	FEDERAL LANDS
	PRIVATE LANDS
	STATE LANDS

 <b>Mewbourne Oil Company</b>		
MEWBOURNE OIL COMPANY SILVER BULLET SWD #1		
		Date: 12 March, 2021
Technician: ad	Scale: 1" = 10000'	

**Updated Listing of Notified Persons**

Silver Bullet 16 State #1 Permit Extension Application  
SWD-1987  
1980' FSL & 275' FEL  
Section 16, T26S, R29E, Eddy County, NM  
Revisions or additions are shown in blue

**Surface Owner**

New Mexico State Land Office  
310 Old Santa Fe Trail  
Santa Fe, NM 87504  
P.O. Box 7698  
Tyler, TX 75711

**Additional State or Federal Surface Owners Within 1 Mile**

Bureau of Land Management  
620 E. Greene St  
Carlsbad, NM 88220

**Offsetting Operators Or Leasehold Owners Within 1 Mile**

**Section 9, 26S, 29E**

EOG Y Resources, Inc.  
104 S. 4<sup>th</sup> Street  
Artesia, NM 88201

EOG Resources Inc.  
5509 Champions Drive  
Midland, TX 79706

COG Operating LLC  
600 W. Illinois Ave  
Midland, TX 79710

OXY USA Inc.  
5 Greenway Plaza  
Houston, TX 77046

**Section 10, 26S, 29E**

COG Operating LLC  
600 W. Illinois Ave  
Midland, TX 79710

OXY USA Inc.  
5 Greenway Plaza  
Houston, TX 77046

XTO Energy, Inc.  
6401 Holiday Hill Road  
Building 5  
Midland, TX 79707

XTO Holdings, LLC  
6401 Holiday Hill Road  
Building 5  
Midland, TX 79707

Section 15, 26S, 29E

EOG Y Resources, Inc.  
104 S. 4<sup>th</sup> Street  
Artesia, NM 88201

EOG Resources Inc.  
5509 Champions Drive  
Midland, TX 79706

Stephens & Johnson Operating Company  
811 Sixth Street  
Suite 300  
Wichita Falls, TX 76301

Section 16, 26S, 29E

OXY USA Inc.  
5 Greenway Plaza  
Houston, TX 77046

Mewbourne Oil Company  
P.O. Box 5270  
Hobbs, NM 88241

Section 17, 26S, 29E

COG Production, LLC  
600 W. Illinois Ave  
Midland, TX 79701

Section 21, 26S, 29E

Marathon Oil Permian, LLC.  
5555 San Felipe St.  
Houston, TX 77056

COG Production, LLC  
600 W. Illinois Ave  
Midland, TX 79701

Prior Notification

OXY USA Inc.  
5 Greenway Plaza  
Houston, TX 77046

Prior Notification

Mewbourne Oil Company  
P.O. Box 5270  
Hobbs, NM 88241

Section 22, 26S, 29E

RKI Exploration & Production, LLC  
3500 One Williams Center  
Tulsa, OK 74172

WPX Energy Permian, LLC  
3500 One Williams Center  
Tulsa, OK 74172

Stephens & Johnson Operating Company  
811 Sixth Street  
Suite 300  
Wichita Falls, TX 76301

XTO Energy, Inc.  
6401 Holiday Hill Road  
Building 5  
Midland, TX 79707

XTO Holdings LLC  
6401 Holiday Hill Road  
Building 5  
Midland, TX 79707



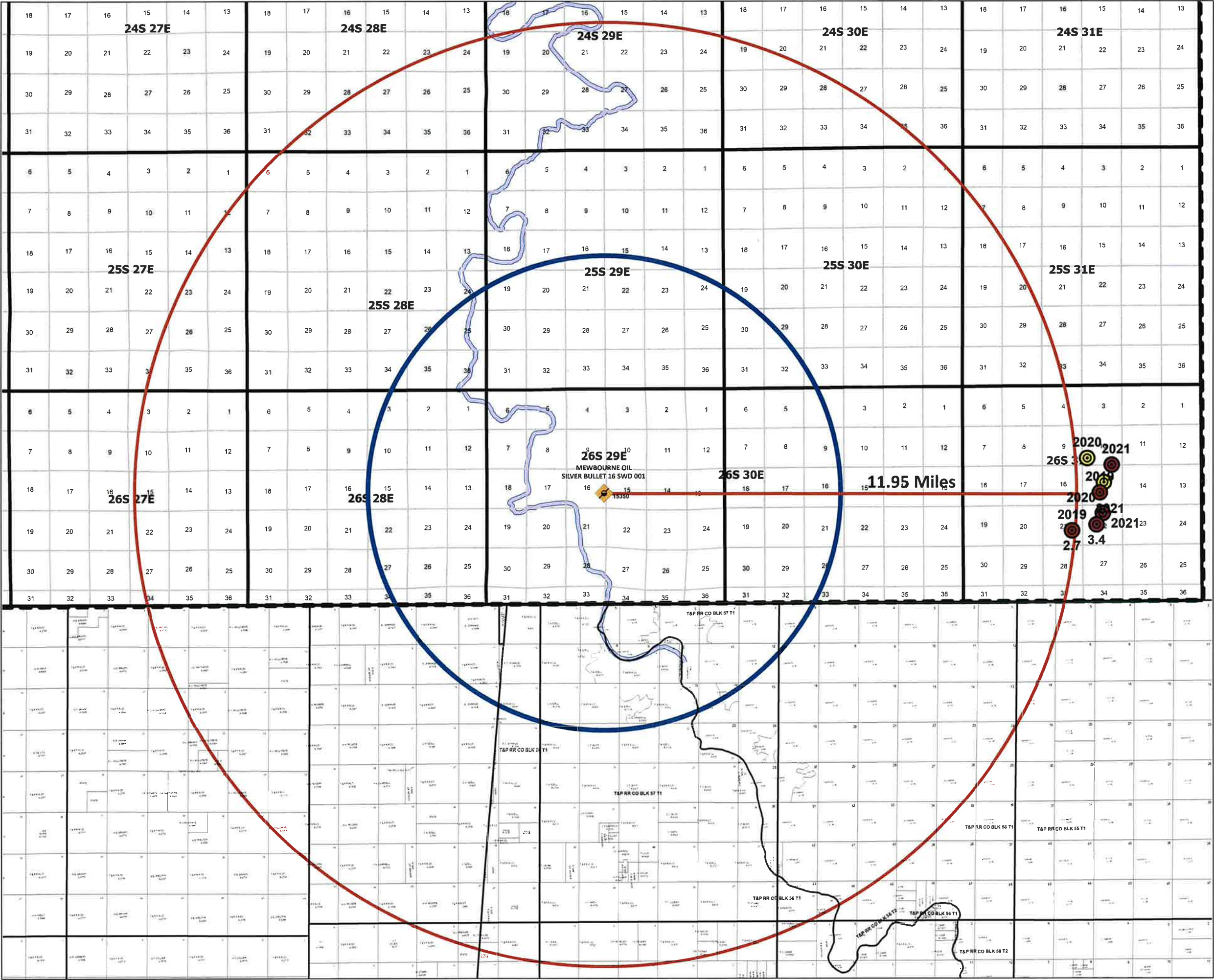

DEVONIAN SWD WELLS



2018 AVG RATE  
TOP INTERVAL

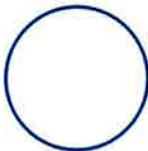

SIX MILE CIRCLE

<b>MOC Mewbourne Oil Company</b>		
<b>SILVER BULLET 16 SWD #001</b> EDDY CO NEW MEXICO		
Author: Dan Harrington	Date: 26 March, 2021	
Tech: nd	Scale: 1" = 12563'	map Exhibit 2 gmp

MEWBOURNE OIL COMPANY  
SILVER BULLET 16 SWD #1 APPLICATION  
TABULATION OF WELLS WITHIN 1 MILE AREA OF REVIEW

Updated 3/26/31

ESTIMATED TOP OF DEVONIAN = 15350'

Dir	API	Lease Name	Well #	Operator Name	Current Operator				Footage	Final Status	Current		Driller TD	TVD/Proposed	Form at TD Name	Prod Formation	Proj Depth	Proj Form	Permit Date	Spud Date	Comp Date	Final Drill Date
						S	T	R			Status	IP Formation										
H	30015475790000	ROCK JELLY FEDERAL COM	705H	COG OPERATING LLC	COG OPERATING LLC	3	26S	29E	350 FNL 1470 FWL	PERMIT	LOCATION	WOLFCAMP		10,074			25,458	WOLFCAMP	2020-10-08			
H	30015475800000	ROCK JELLY FEDERAL COM	704H	COG OPERATING LLC	COG OPERATING LLC	3	26S	29E	350 FNL 1500 FWL	PERMIT	LOCATION	WOLFCAMP		10,074			25,650	WOLFCAMP	2020-10-08			
H	30015475810000	ROCK JELLY FEDERAL COM	703H	COG OPERATING LLC	COG OPERATING LLC	3	26S	29E	350 FNL 1530 FWL	PERMIT	LOCATION	WOLFCAMP		10,115			20,436	WOLFCAMP	2020-10-08			
H	30015475820000	ROCK JELLY FEDERAL COM	702H	COG OPERATING LLC	COG OPERATING LLC	3	26S	29E	210 FNL 1085 FEL	PERMIT	LOCATION	WOLFCAMP		10,133			25,713	WOLFCAMP	2020-10-08			
H	30015475830000	ROCK JELLY FEDERAL COM	701H	COG OPERATING LLC	COG OPERATING LLC	3	26S	29E	210 FNL 1055 FEL	PERMIT	LOCATION	WOLFCAMP		10,143			25,809	WOLFCAMP	2020-10-08			
H	30015437790000	BIG PAPI FEDERAL COM	012H	COG OPERATING LIMITED LIABILITY CORP	COG OPERATING LLC	4	26S	29E	200 FNL 2060 FEL	OIL	PRODUCING	BONE SPRING	18,529	8,678	BONE SPRING	BONE SPRING	18,592	BONE SPRING	2016-05-12	2018-08-31	2018-12-06	2018-09-29
V	30015269950000	GEHRIG FEDERAL	2	HANAGAN PETROLEUM CORPORATION	COG OPERATING LLC	9	26S	29E	330 FSL 330 FEL	OIL	PRODUCING	BRUSHY CANYON	5,425	5,425	BRUSHY CANYON	BRUSHY CANYON	5,500	DELAWARE	1992-12-21	1992-12-31	1993-02-07	
H	30015336000000	GEHRIG FEDERAL	1	MARBOB ENERGY CORPORATION	COG OPERATING LLC	9	26S	29E	1980 FSL 10 FEL	OIL	PRODUCING	CHERRY CANYON	7,155	5,500	CHERRY CANYON	CHERRY CANYON	7,500	DELAWARE	2004-08-08	2004-12-13	2005-01-25	2005-01-08
V	30015376780000	GEHRIG FEDERAL COM	5H	COG OPERATING LIMITED LIABILITY CORP	COG OPERATING LLC	9	26S	29E	430 FSL 330 FEL	PILOT		BONE SPRING	6,828		BONE SPRING		10,100	BONE SPRING	2010-03-03	2010-10-30	2010-11-13	2010-11-13
H	30015376780100	GEHRIG FEDERAL COM	5H	COG OPERATING LIMITED LIABILITY CORP	COG OPERATING LLC	9	26S	29E	430 FSL 330 FEL	OIL	PRODUCING	BONE SPRING	11,774	7,445	BONE SPRING	BONE SPRING	11,800	BONE SPRING	2010-03-03	2010-11-15	2011-09-10	2010-11-23
V	30015281920000	FEDERAL 'AFC'	1	POGO PRODUCING COMPANY	OXY USA INC	10	26S	29E	330 FSL 1650 FWL	OIL	PRODUCING	L. CHERRY CANYON	5,500	5,500	BRUSHY CANYON	L. CHERRY CANYON	5,500	DELAWARE	1994-11-16	1994-11-26	1994-12-27	
H	30015378420000	JRS HORZ FEDERAL COM	3H	COG OPERATING LIMITED LIABILITY CORP	COG OPERATING LLC	10	26S	29E	480 FNL 1980 FEL	OIL	PRODUCING	BONE SPRING	13,003	8,766	BONE SPRING	BONE SPRING	13,111	BONE SPRING	2010-05-13	2014-04-25	2014-06-18	2014-05-10
V	30015379040000	JRS HORZ FEDERAL COM	6H	COG OPERATING LIMITED LIABILITY CORP	COG OPERATING LLC	10	26S	29E	330 FNL 1980 FWL	PILOT			10,254		BONE SPRING			BONE SPRING	2011-07-13	2010-07-15	2010-07-26	2010-07-24
H	30015379040100	JRS HORZ FEDERAL COM	6H	COG OPERATING LIMITED LIABILITY CORP	COG OPERATING LLC	10	26S	29E	330 FNL 1980 FWL	OIL-WO	PRODUCING	BONE SPRING	11,912	7,459	BONE SPRING	BONE SPRING	11,912	BONE SPRING	2010-05-20	2010-07-28	2011-07-22	2010-08-03
V	30015252050000	EXXON FED	2	WORTH PETROLEUM COMPANY	STEPHENS & JOHNSON OPERATING CO	15	26S	29E	330 FSL 2310 FWL	OIL	PRODUCING	DELAWARE	5,180	5,180	DELAWARE	DELAWARE	5,200	DELAWARE	1985-02-19	1985-03-01	1985-04-27	
V	30015260870000	SOSA FEDERAL	1	EXXON CORPORATION	EOG RESOURCES INCORPORATED	15	26S	29E	330 FSL 1700 FEL	OIL	PRODUCING	CHERRY CANYON	5,200	5,200	CHERRY CANYON	CHERRY CANYON	5,250	DELAWARE	1989-04-28	1989-05-08	1989-06-17	1989-05-19
V	30015262470000	SOSA FEDERAL	2	EXXON CORPORATION	EOG RESOURCES INCORPORATED	15	26S	29E	480 FSL 600 FEL	OIL	PRODUCING	CHERRY CANYON	5,210	5,210	CHERRY CANYON	CHERRY CANYON	5,250	DELAWARE	1989-12-10	1989-12-20	1990-01-27	1990-01-03
V	30015269300000	DIMAGGIO	001	POGO PRODUCING COMPANY	OXY USA INC	16	26S	29E	1650 FSL 1693 FEL	OIL	P&A	DELAWARE	7,000	7,000	BONE SPRING	DELAWARE	7,000	DELAWARE	1992-01-29	1992-02-05	1992-03-09	1992-02-20
V	30015269300001	DIMAGGIO	001	POGO PRODUCING COMPANY	OXY USA INC	16	26S	29E	1650 FSL 1693 FEL	SWD-WO	INJECTING	DELAWARE	7,000	7,000	BONE SPRING	DELAWARE	7,000	DELAWARE	1994-06-19	1994-06-29	1994-07-12	
V	30015278920000	DIMAGGIO	2	POGO PRODUCING COMPANY	OXY USA INC	16	26S	29E	660 FNL 660 FEL	OIL	PRODUCING	CHERRY CANYON	5,425	5,425	BRUSHY CANYON	CHERRY CANYON	5,500	DELAWARE	1994-03-23	1994-04-02	1994-05-02	
V	30015282660000	DIMAGGIO	3	POGO PRODUCING COMPANY	OXY USA INC	16	26S	29E	660 FNL 1980 FEL	OIL	PRODUCING	CHERRY CANYON	5,170	5,170	BRUSHY CANYON	CHERRY CANYON	5,500	DELAWARE	1995-01-18	1995-01-28	1995-02-06	
V	30015281740000	DIMAGGIO	8	POGO PRODUCING COMPANY	OXY USA INC	16	26S	29E	1980 FNL 660 FEL	OIL	TA	BRUSHY CANYON	5,700	5,700	BRUSHY CANYON	BRUSHY CANYON	5,500	DELAWARE	1994-11-28	1994-12-08	1994-12-31	
V	30015281750000	DIMAGGIO	9	POGO PRODUCING COMPANY	OXY USA INC	16	26S	29E	1980 FSL 660 FEL	OIL	PRODUCING	CHERRY CANYON	5,210	5,210	BRUSHY CANYON	CHERRY CANYON	5,500	DELAWARE	1995-04-24	1995-05-04	1995-06-02	
V	30015284500000	DIMAGGIO	10	POGO PRODUCING COMPANY	OXY USA INC	16	26S	29E	660 FSL 660 FEL	OIL	SHUT IN	DELAWARE	5,230	5,230	BRUSHY CANYON	DELAWARE	5,500	DELAWARE	1995-05-03	1995-05-13	1995-06-14	1995-05-19
H	30015335570000	DIMAGGIO	11	POGO PRODUCING COMPANY	OXY USA INC	16	26S	29E	1980 FNL 760 FEL	OIL	PRODUCING	L. CHERRY CANYON	6,405	4,998	L. CHERRY CANYON	L. CHERRY CANYON	6,370	DELAWARE	2004-08-17	2004-08-27	2004-11-24	2004-09-24
H	30015452110000	SILVER BULLET 16 W1DM STATE	001H	MEWBOURNE OIL COMPANY	MEWBOURNE OIL COMPANY	16	26S	29E	225 FNL 330 FWL	WAIT ON COMPLETION	AT TD	WOLFCAMP	14,464	9,968	WOLFCAMP	WOLFCAMP	14,310	WOLFCAMP	2018-08-28	2020-11-23		2020-12-07
H	30015452120000	SILVER BULLET 16 W1DM STATE	002H	MEWBOURNE OIL COMPANY	MEWBOURNE OIL COMPANY	16	26S	29E	225 FNL 360 FWL	WAIT ON COMPLETION	AT TD	WOLFCAMP	14,810	10,184	WOLFCAMP	WOLFCAMP	14,579	WOLFCAMP	2018-08-28	2020-12-10		2020-12-26
H	30015463580000	SILVER BULLET 16 W1AP STATE	001H	MEWBOURNE OIL COMPANY	MEWBOURNE OIL COMPANY	16	26S	29E	450 FNL 1400 FEL	WELL PERMIT	LOCATION	WOLFCAMP		10,285	WOLFCAMP	WOLFCAMP	14,990	WOLFCAMP	2019-10-08			
H	30015463590000	SILVER BULLET 16 W1AP STATE	002H	MEWBOURNE OIL COMPANY	MEWBOURNE OIL COMPANY	16	26S	29E	450 FNL 1430 FEL	WELL PERMIT	LOCATION	WOLFCAMP		10,040	WOLFCAMP	WOLFCAMP	14,689	WOLFCAMP	2019-10-08			
H	30015463600000	SILVER BULLET 16 W1BO STATE	003H	MEWBOURNE OIL COMPANY	MEWBOURNE OIL COMPANY	16	26S	29E	450 FNL 1460 FEL	WELL PERMIT	LOCATION	WOLFCAMP		10,265	WOLFCAMP	WOLFCAMP	14,893	WOLFCAMP	2019-10-08			
H	30015463610000	SILVER BULLET 16 W1BO STATE	004H	MEWBOURNE OIL COMPANY	MEWBOURNE OIL COMPANY	16	26S	29E	450 FNL 1490 FEL	WELL PERMIT	LOCATION	WOLFCAMP		10,017	WOLFCAMP	WOLFCAMP	14,672	WOLFCAMP	2019-10-08			
H	30015476930000	SILVER BULLET 16 W1CN STATE	003H	MEWBOURNE OIL COMPANY	MEWBOURNE OIL COMPANY	16	26S	29E	205 FNL 2100 FWL	WAIT ON COMPLETION	AT TD	WOLFCAMP	14,545	9,971	WOLFCAMP	WOLFCAMP	14,583	WOLFCAMP	2020-11-20	2021-01-01		2021-01-14
H	30015476940000	SILVER BULLET 16 W1CN STATE	004H	MEWBOURNE OIL COMPANY	MEWBOURNE OIL COMPANY	16	26S	29E	205 FNL 2130 FWL	WAIT ON COMPLETION	AT TD	WOLFCAMP	14,765	10,183	WOLFCAMP	WOLFCAMP	14,804	WOLFCAMP	2020-11-20	2021-01-16		2021-01-29
V	30015256870000	MOBIL '22' FEDERAL	7	SUN EXPLORATION & PRODUCTION CO	STEPHENS & JOHNSON OPERATING CO	22	26S	29E	1905 FNL 1780 FWL	OIL	SHUT IN	CHERRY CANYON	5,505	5,505	CHERRY CANYON	CHERRY CANYON	5,505		1987-10-15	1987-10-25	1988-02-26	1987-11-02
V	30015257010000	MOBIL '22' FEDERAL	8	CHALLENGER ENERGY CORPORATION	STEPHENS & JOHNSON OPERATING CO	22	26S	29E	890 FNL 2160 FWL	OIL	PRODUCING	CHERRY CANYON	5,241	5,241	CHERRY CANYON	CHERRY CANYON	6,250	CHERRY CANYON	1987-02-26	1987-03-08	1987-07-03	1987-06-05
V	30015251040000	WORTH FEDERAL	2	WORTH PETROLEUM COMPANY	STEPHENS & JOHNSON OPERATING CO	22	26S	29E	990 FNL 2280 FEL	OIL	PRODUCING	DELAWARE	5,140	5,140	DELAWARE	DELAWARE	5,200	DELAWARE	1984-12-03	1984-12-13	1985-02-19	
H	30015405680000	PECOS EAST FEDERAL COM 22	1H	RKI EXPLORATION & PRODUCTION LLC	WPX ENERGY PERMIAN, LLC	22	26S	29E	250 FSL 1690 FWL	OIL	PRODUCING	BONE SPRING	11,543	7,016	BONE SPRING	BONE SPRING	11,527	BONE SPRING	2012-08-01	2012-08-13	2013-02-13	2012-09-11
H	30015405820000	PECOS EAST FEDERAL COM 22	2H	RKI EXPLORATION & PRODUCTION LLC	WPX ENERGY PERMIAN, LLC	22	26S	29E	250 FSL 1690 FEL	OIL	PRODUCING	BONE SPRING	12,109	7,375	BONE SPRING	BONE SPRING	11,583	BONE SPRING	2012-08-01	2013-06-23	2013-10-13	2013-07-18
H	30015422850000	PECOS EAST FEDERAL 22	3H	RKI EXPLORATION & PRODUCTION LLC	WPX ENERGY PERMIAN, LLC	22	26S	29E	50 FSL 530 FWL	OIL	PRODUCING	BONE SPRING	13,125	8,574	BONE SPRING	BONE SPRING	11,792	BONE SPRING	2014-04-02	2014-11-10	2015-01-29	2014-12-07
H	30015422700000	PECOS EAST FEDERAL 22	5H	RKI EXPLORATION & PRODUCTION LLC	WPX ENERGY PERMIAN, LLC	22	26S	29E	250 FSL 2185 FWL	OIL	PRODUCING	BONE SPRING	13,031	8,621	BONE SPRING	BONE SPRING	11,913	BONE SPRING	2014-03-28	2015-06-23	2015-08-16	2015-07-14
H	30015422810000	PECOS EAST FEDERAL COM 22	6H	RKI EXPLORATION & PRODUCTION LLC	WPX ENERGY PERMIAN, LLC	22	26S	29E	250 FSL 1840 FEL	OIL	PRODUCING	BONE SPRING	13,305	8,676	BONE SPRING	BONE SPRING	13,371	BONE SPRING	2014-03-28	2015-12-16	2016-03-14	2016-01-12
H	30015433490000	PECOS EAST FEDERAL 22	9H	RKI EXPLORATION & PRODUCTION LLC	WPX ENERGY PERMIAN, LLC	22	26S	29E	250 FSL 1355 FWL	GAS	PRODUCING	WOLFCAMP	15,590	10,940	WOLFCAMP	WOLFCAMP	15,723	WOLFCAMP	2015-08-31	2017-01-21	2017-05-14	2017-02-13

Status changes or added since first application

NOTE: NO WELLS WITHIN THE 1 MILE AREA OF REVIEW (AOR) PENETRATE THE PROPOSED DISPOSAL FORMATION