

# Additional Information

Extension Request 4/6/21



April 6, 2021

New Mexico Oil Conservation Division  
1220 S. St. Francis  
Santa Fe, New Mexico 87504

Attn: Ms. Adrienne Sandoval, Director

Re: Request for Extension of Solaris Water Midstream, LLC Injection Permit-Clara Allen SWD #1  
Administrative Order SWD-2309  
Located: Unit A, Sec 07, T20S, R29E, NMPM, Eddy County, New Mexico  
Order Date: May 11, 2020  
Injection Formations: Devonian formation; 12,510 feet to 14,310 feet

Dear Ms. Sandoval:

Solaris Water Midstream, LLC ("Solaris") hereby requests approval from the Division for a one (1) year extension from the deadline stipulated in Order SWD-2309 to commence injection on the Clara Allen SWD #1 well.

The well has not yet been drilled for various reasons, including the ongoing Covid-19 situation.

According to the GIS on the NMOCD website the AOR for the above referenced well has not changed.

I have enclosed a copy of the approved permit for your convenience. If you or your staff have any questions or require additional information, please do not hesitate to contact me at [whitney.mckee@solariswater.com](mailto:whitney.mckee@solariswater.com) or 432-203-9020.

Best regards,

A handwritten signature in blue ink, appearing to read "Whitney McKee", is written over a horizontal line.

Whitney McKee  
Solaris Water Midstream, LLC  
Regulatory Specialist

State of New Mexico  
Energy, Minerals and Natural Resources Department

---

**Michelle Lujan Grisham**  
Governor

**Sarah Cottrell Propst**  
Cabinet Secretary

**Todd E. Leahy, JD, PhD**  
Deputy Secretary

**Adrienne Sandoval**, Director  
Oil Conservation Division



Administrative Order SWD-2309  
May 11, 2020

**ADMINISTRATIVE ORDER  
OF THE OIL CONSERVATION DIVISION**

Pursuant to the provisions of Division Rule 19.15.26.8(B) NMAC, Solaris Water Midstream, LLC (“the Operator”) seeks an administrative order for its Clara Allen SWD No. 1 (“the Proposed Well”) with a location of 275 feet from the North line and 1,000 feet from the East line, Unit Letter A of Section 07, Township 20 South, Range 29 East, NMPM, Eddy County, New Mexico, for the purpose of commercial disposal of produced water.

**THE DIVISION DIRECTOR FINDS THAT:**

The application has been duly filed under the provisions of Division Rule 19.15.26.8(B) NMAC and satisfactory information has been provided that affected parties have been notified and no objections have been received within the prescribed waiting period. The applicant has presented satisfactory evidence that all requirements prescribed in Division Rule 19.15.26.8 NMAC have been met and the operator is in compliance with Division Rule 19.15.5.9 NMAC.

**Application for Disposal in Devonian and Silurian Formations:** Due to the potential for the projected injection volume of the proposed well to impact an area greater than the one-half mile radius applied in Division Form C-108 and Division rule, the applicant has provided the following supplementary information:

1. Notification following Division Rule 19.15.26.8(B) NMAC for a radius of one mile from the surface location of the proposed well;
2. An expanded Area of Review for wells penetrating the disposal interval for a radius of one mile from the surface location of the proposed well; and
3. A statement by a qualified person assessing the potential of induced-seismic events associated with the disposal activities for the predicted service life of the proposed well.

**IT IS THEREFORE ORDERED THAT:**

The applicant, Solaris Water Midstream, LLC (OGRID 371643), is hereby authorized to utilize its Clara Allen SWD No. 1 (API 30-015-Pending) with a location of 275 feet from the North line and 1,000 feet from the East line, Unit Letter A of Section 07, Township 20 South, Range 29 East, NMPM, Eddy County, for disposal of oil field produced water (UIC Class II only) through open-hole completion into an interval consisting of the Devonian and Silurian formations from

approximately 12,510 feet to approximately 14,310 feet. Injection will occur through internally-coated, 5.5-inch or smaller tubing within the 9 $\frac{5}{8}$ -inch production casing and 5 inch or smaller tubing within the 7 $\frac{5}{8}$ -inch liner with a packer set within 100 feet of the top of the disposal interval. This permit does not allow disposal into:

1. The Woodford Shale and formations above the lower contact of the Woodford Shale;
2. Formations below the Silurian formations including the Montoya formation and the Ellenburger formation (lower Ordovician); and
3. Any lost circulation intervals directly on top and obviously connected to these formations.

*The Operator shall complete the disposal well as proposed in the C-108 application which ensures the isolation and protection of the Capitan Reef aquifer. Any modification of this well construction (excluding adjustments in depths as a result of drilling and logging information) shall require the submission of a Form C-103 Sundry notice of intent and the approval of both the District and the Engineering Bureau Santa Fe prior to initiating the modification. Failure of the operator to provide notice and obtain approval shall result in the loss of authority to inject*

*Prior to commencing disposal, the operator shall submit mudlog and geophysical logs information, to the Division's District geologist and Santa Fe Engineering Bureau, showing evidence agreeable that only the permitted formation is open for disposal including a summary of depths (picks) for contacts of the formations which the Division shall use to amend this order for a final description of the depth for the injection interval. If significant hydrocarbon shows occur while drilling, the operator shall notify the Division's District office and the operator shall be required to receive written permission prior to commencing disposal.*

*The operator shall circulate to surface the cement for the 9 $\frac{5}{8}$ -inch production casing.*

*If cement does not circulate on any casing string, the operator shall run a cement bond log ("CBL") or other log to determine top of cement and shall notify the Artesia District with the top of cement on the emergency phone number prior to continuing with any further cement activity with the proposed well. If cement did not tie back into the next higher casing shoe, the operator shall perform remedial cement job to bring cement, at a minimum, 200 feet above the next higher casing shoe.*

*The operator shall run a CBL (or equivalent) for the 7 $\frac{5}{8}$ -inch liner to demonstrate the placement of cement and the cement bond with the tie-in with 9 $\frac{5}{8}$ -inch production casing string. The operator shall provide a copy of the CBL to the Division's District office prior to commencing disposal.*

*Prior to commencing disposal, the operator shall obtain a bottom-hole pressure measurement representative of the open-hole completion. This information shall be provided with the written notice of the date of commencement of disposal.*

IT IS FURTHER ORDERED THAT:

The operator shall take all steps necessary to ensure that the disposed water enters only the approved disposal interval and is not permitted to escape to other formations or onto the surface. This includes the completion and construction of the well as described in the application and, if necessary, as modified by the District Supervisor or the Bureau of Land Management.

After installing tubing, the casing-tubing annulus shall be loaded with an inert fluid and equipped with a pressure gauge or an approved leak detection device in order to determine leakage in the casing, tubing, or packer. The casing shall be pressure tested from the surface to the packer setting depth to assure casing integrity.

The well shall pass an initial mechanical integrity test ("MIT") prior to initially commencing disposal and prior to resuming disposal each time the disposal packer is unseated. All MIT procedures and schedules shall follow the requirements in Division Rule 19.15.26.11(A) NMAC. The Division Director retains the right to require at any time wireline verification of completion and packer setting depths in this well.

Without limitation on the duties of the operator as provided in Division Rules 19.15.29 and 19.15.30 NMAC, or otherwise, the operator shall immediately notify the Division's District II office of any failure of the tubing, casing or packer in the well, or of any leakage or release of water, oil or gas from around any produced or plugged and abandoned well in the area, and shall take such measures as may be timely and necessary to correct such failure or leakage.

If the disposal well fails a MIT or if there is evidence that the mechanical integrity of said well is impacting correlative rights, the public health, any underground sources of fresh water, or the environment, the Division Director shall require the well to be shut-in within 24 hours of discovery and the operator shall redirect all disposal waters to another facility. The operator shall take the necessary actions to address the impacts resulting from the mechanical integrity issues in accordance with Division Rule 19.15.26.10 NMAC, and the well shall be tested pursuant to Rule 19.15.26.11 NMAC prior to returning to injection.

The wellhead injection pressure on the well shall be limited to **no more than 2502 psi**. In addition, the disposal well or system shall be equipped with a pressure limiting device in workable condition which shall, at all times, limit surface tubing pressure to the maximum allowable pressure for this well.

The Director of the Division may authorize an increase in tubing pressure upon a proper showing by the operator of said well that such higher pressure will not result in migration of the disposed fluid from the target formations. Such proper showing shall be demonstrated by sufficient evidence including but not limited to an acceptable step-rate test.

The operator shall notify the supervisor of the Division's District II office of the date and time of the installation of disposal equipment and of any MIT so that the same may be inspected and witnessed. The operator shall provide written notice of the date of commencement of disposal to the Division's District II office. The operator shall submit monthly reports of the disposal

operations that includes number of days of operation, injection volume, and injection pressure on Division Form C-115, in accordance with Division Rules 19.15.26.13 and 19.15.7.24 NMAC.

The injection authority granted under this order is not transferable except upon Division approval. The Division may require the operator to demonstrate mechanical integrity of any injection well that will be transferred prior to approving transfer of authority to inject.

The Division may revoke this injection order after notice and hearing if the operator is in violation of Rule 19.15.5.9 NMAC.

The disposal authority granted herein shall terminate one (1) year after the effective date of this Order if the operator has not commenced injection operations into the subject well. One year after the last date of reported disposal into this well, the Division shall consider the well abandoned, and the authority to dispose will terminate *ipso facto*. The Division, upon written request mailed by the operator prior to the termination date, may grant an extension thereof for good cause.

Compliance with this Order does not relieve the operator of the obligation to comply with other applicable federal, state or local laws or rules, or to exercise due care for the protection of fresh water, public health and safety and the environment.

Jurisdiction is retained by the Division for the entry of such further orders as may be necessary for the prevention of waste and/or protection of correlative rights or upon failure of the operator to conduct operations (1) to protect fresh or protectable waters or (2) consistent with the requirements in this order, whereupon the Division may, after notice and hearing, terminate the disposal authority granted herein.

---

ADRIENNE SANDOVAL  
Director

AS/dhr

cc: Oil Conservation Division – Artesia District Office  
Admin. Appl. No. pDHR1930260838  
Bureau of Land Management – Carlsbad Field Office

Attachment: C-108 well completion diagram

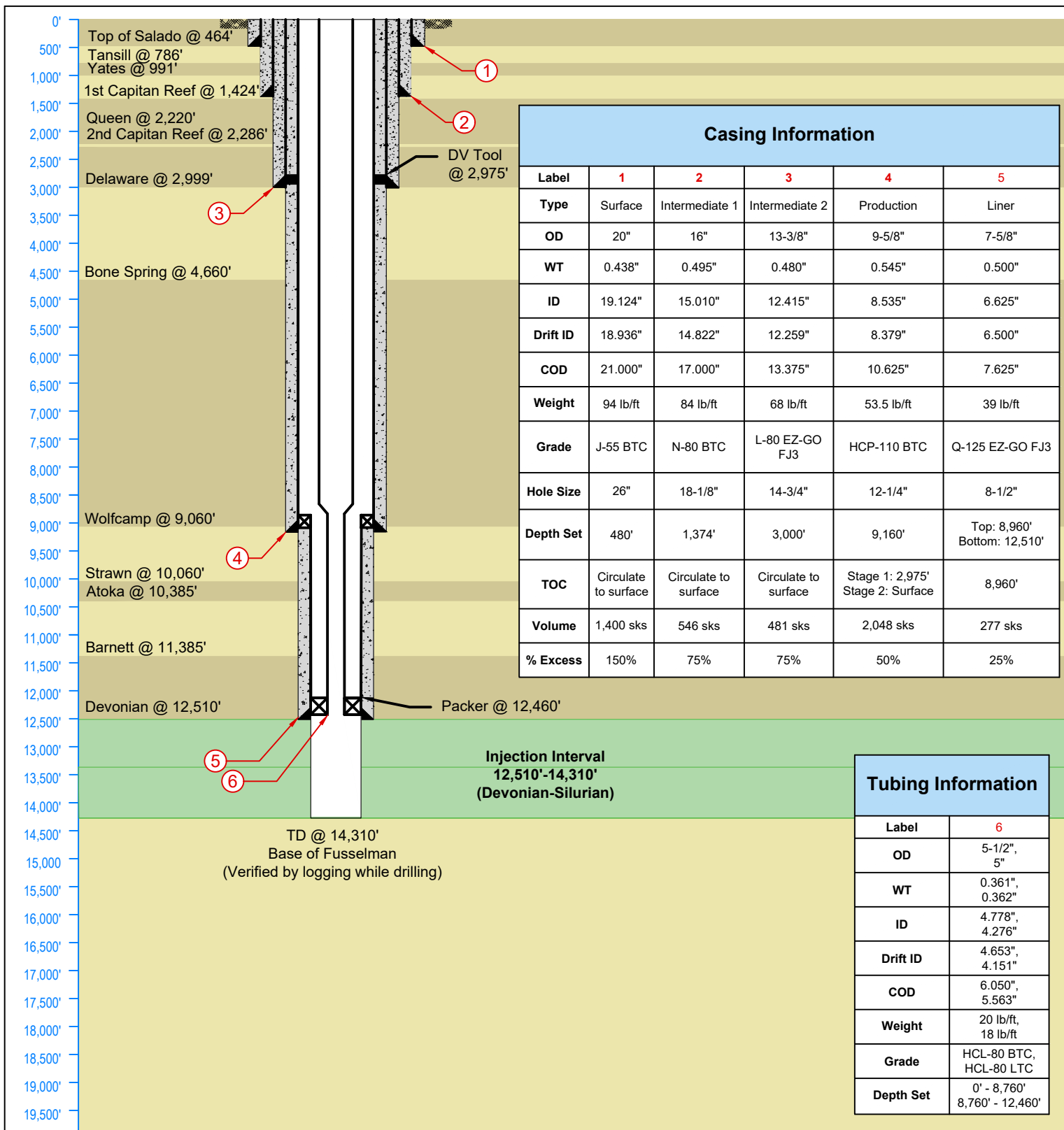

<b>LONQUIST &amp; CO. LLC</b> PETROLEUM ENGINEERS ENERGY ADVISORS HOUSTON   CALGARY AUSTIN   WICHITA   DENVER Texas License F-9147 12912 Hill Country Blvd. Ste F-200 Austin, Texas 78738 Tel: 512.732.9812 Fax: 512.732.9816	Solaris Water Midstream, LLC		Clara Allen SWD No. 1	
	Country: USA		State/Province: New Mexico	County/Parish: Eddy
	Location:		Site: 275' FNL, 1,000' FEL	Survey: S7-T20S-R29E
	API No: NA		Field: Devonian-Silurian (Code: 97869)	Well Type/Status: SWD
	NMOCD District No: 2		Project No: 1916	Date: 9/27/2019
	Drawn: TFM		Reviewed: RKH	Approved:
	Rev No: 1		Notes: Additional casing string to protect Capitan Reef	





Date: 3/3/2021

Table 1  
Wells Within 1.0 Miles

id	name	type_	status_cod	status	ogrid_name	county	ulstr	latitude	longitude	projection	directiona	status2	symbology	year_spudd	spud_date	measured_v	true_verti	pool_id_li	effective_	plug_date
30-015-41029	WILLIAMSON BC FEDERAL #006H	Oil	C	Cancelled	EOG Y RESOURCES, INC.	Eddy	L-07-20S-29E	32.58620830000	-104.12141420000	NAD 83	H	C	OC	9999	12/31/99	0	0	[65010] WINCHESTER, BONE SPRING	1/31/13	12/31/99
30-015-02349	PRE-ONGARD WELL #001	Oil	P	Plugged (site released)	PRE-ONGARD WELL OPERATOR	Eddy	H-12-20S-28E	32.58914180000	-104.12299350000	NAD 83		P	OP	1900	1/1/00	0	0		1/1/00	1/1/01
30-015-22908	SUPERIOR KJ FEDERAL COM #001	Gas	A	Active	EOG RESOURCES INC	Eddy	D-07-20S-29E	32.59255980000	-104.11875150000	NAD 83	V	A	GA	1994	11/2/94	11536	11536	[73200] BURTON FLAT, ATOKA, EAST (GAS); [73400] BURTON FLAT, STRAWN, EAST (GAS)	1/16/19	12/31/99
30-015-25400	PRE-ONGARD WELL #007	Oil	C	Cancelled	PRE-ONGARD WELL OPERATOR	Eddy	O-06-20S-29E	32.59736686000	-104.11263160000	NAD 83		C	OC	9999	12/31/99	0	0		1/1/00	12/31/99
30-015-22049	WILLIAMSON BC #004	Gas	P	Plugged (site released)	EOG Y RESOURCES, INC.	Eddy	K-07-20S-29E	32.58620450000	-104.11563110000	NAD 83	V	P	GP	9999	12/31/99	99999	99999	[87680] WINCHESTER, UPPER PENN (GAS)	8/1/87	1/31/07
30-015-23979	SUPERIOR FEDERAL #006	Gas	P	Plugged (site released)	CIMAREX ENERGY CO. OF COLORADO	Eddy	N-06-20S-29E	32.59709170000	-104.11549380000	NAD 83	V	P	GP	9999	12/31/99	99999	99999	[73200] BURTON FLAT, ATOKA, EAST (GAS); [73320] BURTON FLAT, MORROW, EAST (GAS); [73400] BURTON FLAT, STRAWN, EAST (GAS)	8/1/04	8/23/13
30-015-03630	PRE-ONGARD WELL #001	Oil	P	Plugged (site released)	PRE-ONGARD WELL OPERATOR	Eddy	O-07-20S-29E	32.58257290000	-104.11228180000	NAD 83		P	OP	1900	1/1/00	0	0		1/1/00	1/1/00
30-015-20374	PRE-ONGARD WELL #001	Oil	P	Plugged (site released)	PRE-ONGARD WELL OPERATOR	Eddy	J-06-20S-29E	32.60071950000	-104.11227420000	NAD 83		P	OP	1900	1/1/00	0	0		1/1/00	1/1/00
30-015-10875	PRE-ONGARD WELL #002	Oil	P	Plugged (site released)	PRE-ONGARD WELL OPERATOR	Eddy	P-07-20S-29E	32.58166120000	-104.10692600000	NAD 83		P	OP	1900	1/1/00	0	0		1/1/00	1/1/00
30-015-10829	PRE-ONGARD WELL #001	Oil	P	Plugged (site released)	PRE-ONGARD WELL OPERATOR	Eddy	P-07-20S-29E	32.58256910000	-104.10799410000	NAD 83		P	OP	1900	1/1/00	0	0		1/1/00	1/1/00
30-015-03633	PRE-ONGARD WELL #002	Oil	P	Plugged (site released)	PRE-ONGARD WELL OPERATOR	Eddy	A-07-20S-29E	32.59254840000	-104.10691830000	NAD 83		P	OP	1900	1/1/00	0	0		1/1/00	1/1/01
30-015-03632	PRE-ONGARD WELL #001	Oil	P	Plugged (site released)	PRE-ONGARD WELL OPERATOR	Eddy	H-07-20S-29E	32.59073260000	-104.10691830000	NAD 83		P	OP	1900	1/1/00	0	0		1/1/00	1/1/00
30-015-03634	PRE-ONGARD WELL #002	Oil	P	Plugged (site released)	PRE-ONGARD WELL OPERATOR	Eddy	E-08-20S-29E	32.58982090000	-104.10370640000	NAD 83		P	OP	1900	1/1/00	0	0		1/1/00	1/1/00
30-015-03637	PRE-ONGARD WELL #003	Oil	P	Plugged (site released)	PRE-ONGARD WELL OPERATOR	Eddy	E-08-20S-29E	32.58891680000	-104.10477450000	NAD 83		P	OP	1900	1/1/00	0	0		1/1/00	1/1/00
30-015-03635	PRE-ONGARD WELL #001	Oil	P	Plugged (site released)	PRE-ONGARD WELL OPERATOR	Eddy	M-08-20S-29E	32.58256150000	-104.10370640000	NAD 83		P	OP	1900	1/1/00	0	0		1/1/00	1/1/00
30-015-31392	RUSSELL 8 FEDERAL #001	Gas	P	Plugged (site released)	DEVON ENERGY PRODUCTION COMPANY, LP	Eddy	D-08-20S-29E	32.59317400000	-104.10370640000	NAD 83	V	P	GP	2000	12/27/00	11730	11730	[65010] WINCHESTER, BONE SPRING; [73200] BURTON FLAT, ATOKA, EAST (GAS); [73320] BURTON FLAT, MORROW, EAST (GAS)	10/1/14	8/3/16
30-015-10246	PRE-ONGARD WELL #001	Oil	P	Plugged (site released)	PRE-ONGARD WELL OPERATOR	Eddy	D-08-20S-29E	32.59435270000	-104.10263060000	NAD 83		P	OP	1900	1/1/00	0	0		1/1/00	1/1/00
30-015-20825	SUPERIOR FEDERAL COM #001	Gas	P	Plugged (site released)	MARATHON OIL CO	Eddy	G-08-20S-29E	32.59071350000	-104.09941860000	NAD 83	V	P	GP	9999	12/31/99	99999	99999	[73200] BURTON FLAT, ATOKA, EAST (GAS)	2/1/81	1/14/94
30-015-03636	PRE-ONGARD WELL #001	Oil	P	Plugged (site released)	PRE-ONGARD WELL OPERATOR	Eddy	F-08-20S-29E	32.58890530000	-104.10048680000	NAD 83		P	OP	1900	1/1/00	0	0		1/1/00	1/1/01
30-015-26301	PRE-ONGARD WELL #007	Oil	P	Plugged (site released)	PRE-ONGARD WELL OPERATOR	Eddy	K-05-20S-29E	32.60039140000	-104.09974670000	NAD 83		P	OP	1900	1/1/00	0	0		1/1/00	1/1/00
30-015-21359	PRE-ONGARD WELL #004	Oil	C	Cancelled	PRE-ONGARD WELL OPERATOR	Eddy	O-05-20S-29E	32.59705606000	-104.09511577000	NAD 83		C	OC	9999	12/31/99	0	0		1/1/00	12/31/99
30-015-33041	COLT 6 FEDERAL #001	Gas	A	Active	MEWBOURNE OIL CO	Eddy	J-06-20S-29E	32.60071950000	-104.11120610000	NAD 83	V	A	GA	2003	12/13/03	11670	11670	[73200] BURTON FLAT, ATOKA, EAST (GAS); [73320] BURTON FLAT, MORROW, EAST (GAS)	10/8/03	12/31/99
30-015-20926	YATES FEDERAL COM #001	Gas	A	Active	OXY USA WTP LIMITED PARTNERSHIP	Eddy	N-08-20S-29E	32.58309940000	-104.09941860000	NAD 83	V	A	GA	1973	8/10/73	11712	11712	[73320] BURTON FLAT, MORROW, EAST (GAS); [73400] BURTON FLAT, STRAWN, EAST (GAS)	6/2/09	12/31/99
30-015-34208	RUGER 6 FEDERAL #002	Gas	A	Active	MEWBOURNE OIL CO	Eddy	F-06-20S-29E	32.60557560000	-104.11623380000	NAD 83	V	A	GA	2005	9/27/05	11500	11500	[73320] BURTON FLAT, MORROW, EAST (GAS)	7/8/05	12/31/99
30-015-34968	RUGER 6 FEDERAL #003	Oil	N	New	MEWBOURNE OIL CO	Eddy	A-06-20S-29E	32.60736470000	-104.10906220000	NAD 83	V	N	ON	9999	12/31/99	0	0	[65010] WINCHESTER, BONE SPRING	6/13/06	12/31/99
30-015-41897	SAVAGE 5 EH FEDERAL #001H	Oil	A	Active	MEWBOURNE OIL CO	Eddy	H-06-20S-29E	32.60388950000	-104.10649110000	NAD 83	H	A	OA	2014	2/8/14	11750	6922	[65010] WINCHESTER, BONE SPRING	12/19/13	12/31/99
30-015-33905	RUGER 6 FEDERAL #001	Gas	A	Active	MEWBOURNE OIL CO	Eddy	H-06-20S-29E	32.60554500000	-104.10863490000	NAD 83	V	A	GA	2005	2/23/05	11570	11570	[73200] BURTON FLAT, ATOKA, EAST (GAS); [73320] BURTON FLAT, MORROW, EAST (GAS)	1/14/05	12/31/99
30-015-32652	GATUNA CANYON 5 FEDERAL COM #002	Gas	A	Active	MEWBOURNE OIL CO	Eddy	F-05-20S-29E	32.60461040000	-104.10048680000	NAD 83		A	GA	2003	3/6/03	11650	11650	[73320] BURTON FLAT, MORROW, EAST (GAS)	2/20/03	12/31/99
30-015-37183	GATUNA CANYON 5 FEDERAL #004E	Oil	C	Cancelled	MEWBOURNE OIL CO	Eddy	N-05-20S-29E	32.59566313000	-104.09830822000	NAD 83		C	OC	9999	12/31/99	99999	99999	[65010] WINCHESTER, BONE SPRING	7/22/13	12/31/99
30-015-42805	SAVAGE 5 B1 DA FEDERAL #001H	Oil	C	Cancelled	MEWBOURNE OIL CO	Eddy	D-05-20S-29E	32.60795330000	-104.10502810000	NAD 83	H	C	OC	9999	12/31/99	0	0	[65010] WINCHESTER, BONE SPRING	11/19/14	12/31/99
30-015-23975	SUPERIOR FEDERAL #005	Gas	P	Plugged (site released)	TOM BROWN INC	Eddy	K-05-20S-29E	32.60069660000	-104.09941100000	NAD 83	V	P	GP	9999	12/31/99	99999	99999	[73400] BURTON FLAT, STRAWN, EAST (GAS); [84352] RUSSELL, WOLFCAMP (GAS)	1/1/97	12/27/01
30-015-44126	SIG 5 6 B2FE FEDERAL COM #001H	Oil	N	New	MEWBOURNE OIL CO	Eddy	G-05-20S-29E	32.60390106000	-104.09618783000	NAD 27	H	N	ON	9999	12/31/99	0	0	[65010] WINCHESTER, BONE SPRING	4/6/17	12/31/99
30-015-32521	GATUNA CANYON 5 FEDERAL COM #001	Gas	A	Active	MEWBOURNE OIL CO	Eddy	M-05-20S-29E	32.59798430000	-104.10369870000	NAD 83	V	A	GA	2002	11/18/02	11630	11630	[73200] BURTON FLAT, ATOKA, EAST (GAS); [73320] BURTON FLAT, MORROW, EAST (GAS)	11/5/02	12/31/99
30-015-42804	SIG 5 6 B2KL FEDERAL #001H	Oil	C	Cancelled	MEWBOURNE OIL CO	Eddy	J-05-20S-29E	32.60079782000	-104.09638188000	NAD 83	H	C	OC	9999	12/31/99	0	0	[65010] WINCHESTER, BONE SPRING	11/19/14	12/31/99
30-015-44125	SIG 5 6 B2NM FEDERAL #001H	Oil	N	New	MEWBOURNE OIL CO	Eddy	O-05-20S-29E	32.59651953000	-104.09618294000	NAD 27	H	N	ON	9999	12/31/99	0	0	[65010] WINCHESTER, BONE SPRING	4/6/17	12/31/99



**Legend**

-  CLARA ALLEN SWD 1
-  1.0 Mile Radius
-  BLM Lease
-  SLO Lease

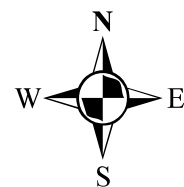

0 0.25 0.5  
Miles

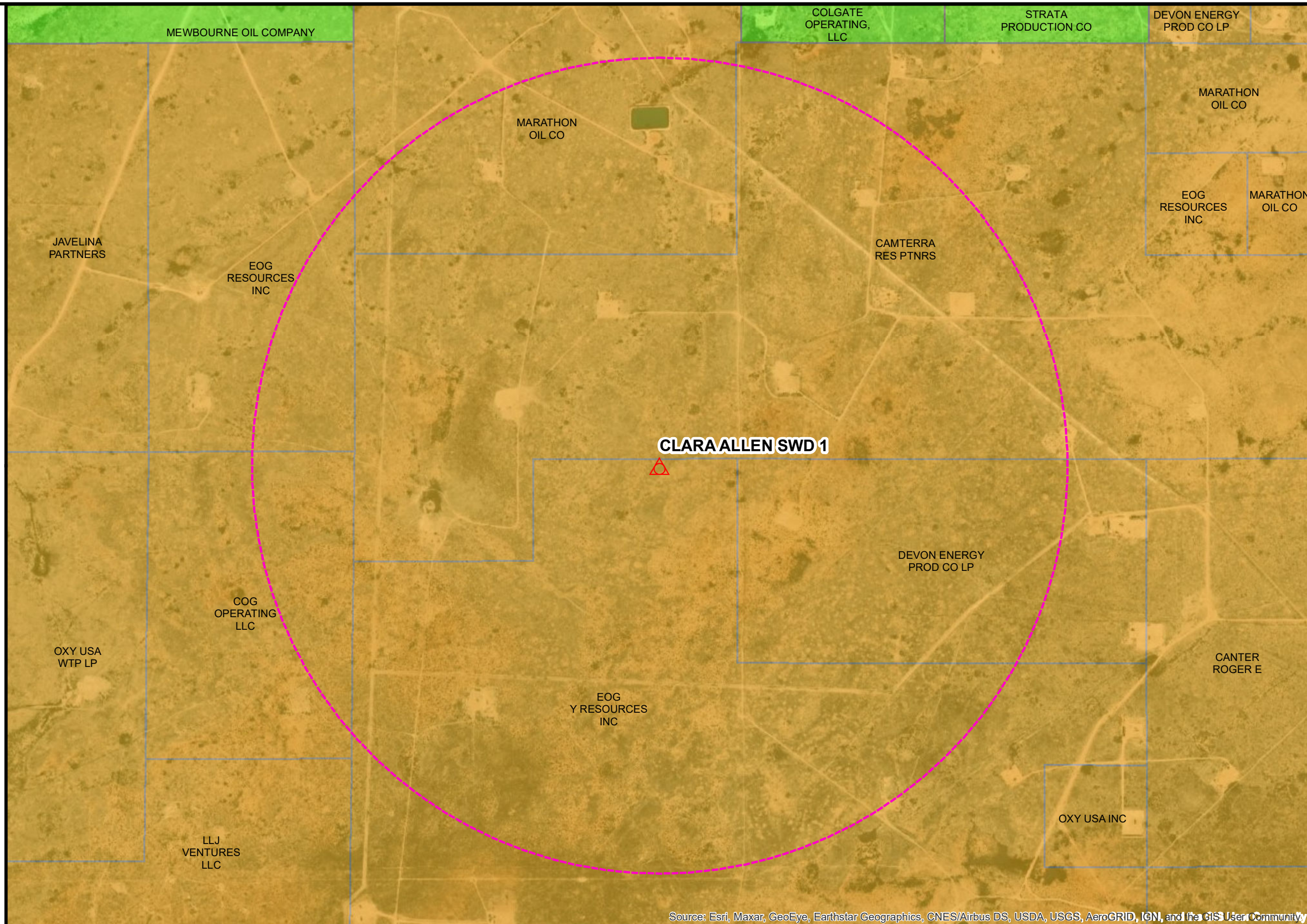

Source: Esri, Maxar, GeoEye, Earthstar Geographics, CNES/Airbus DS, USDA, USGS, AeroGRID, IGN, and the GIS User Community

**State and Federal Leases**  
**Solaris Water Midstream - Clara Allen SWD #1 - Eddy County NM**

Date: 3/3/2021

Table 2  
BLM Leases Within 1.0 Miles

SerialNumb	AdminAgenc	Price	Acres	Dispositio	CaseType Co	CaseType	Commodity	EffectDate	RoyaltyRt	HBP	OR_	Name1	PerInt1	Name2	PerInt2	Name3	PerInt3	Name4	PerInt4	UpdateDate	Shape__Are	Shape__Len
NMNM 013237	BUREAU OF LAND MGMT	0	919.88	Authorized	311211	O&g lse simo public land	Oil & gas	3/1/1971	Rlty rate - 12 1/2%	HBP	OR	MARATHON OIL CO	100		0		0		0	12/1/2017	5262594.0625	9458.9068
NMNM 005489	BUREAU OF LAND MGMT	0	240.00	Authorized	311211	O&g lse simo public land	Oil & gas	5/1/1968	Rlty rate - 12 1/2%	HBP	OR	COG OPERATING LLC	100		0		0		0	12/1/2017	1391988.1016	4816.7956
NMNM 0144698	BUREAU OF LAND MGMT	0	1743.54	Authorized	311111	O&g lse noncomp pub land	Oil & gas	2/1/1961	Rlty rate - 12 1/2%	HBP	OR	CAMTERRA RES PTNRS	100		0		0		0	12/1/2017	9993060.6719	21861.8383
NMNM 026683	BUREAU OF LAND MGMT	0	439.65	Authorized	311211	O&g lse simo public land	Oil & gas	11/1/1975	Rlty rate - 12 1/2%	HBP	OR	EOG RESOURCES INC	100		0		0		0	12/1/2017	2543859.9648	10572.8961
NMNM 0001165	BUREAU OF LAND MGMT	0	2494.41	Authorized	311111	O&g lse noncomp pub land	Oil & gas	7/1/1950	Rlty rate - 12 1/2%	HBP	OR	EOG Y RESOURCES INC	100		0		0		0	12/1/2017	14276020.500	18013.8707
NMNM 103878	BUREAU OF LAND MGMT	610	320.00	Authorized	312021	O&g lse comp pd -1987	Oil & gas	3/1/2000	Rlty rate - 12 1/2%	HBP		DEVON ENERGY PROD CO LP	100		0		0		0	12/1/2017	1834536.9844	5743.5065



**Legend**

 CLARA ALLEN SWD 1

 1.0 Mile Radius

 PLSS Township

 PLSS First Division

**NM Surface Ownership**

 BLM

 State

 Private

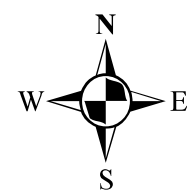

0 0.25 0.5  
Miles

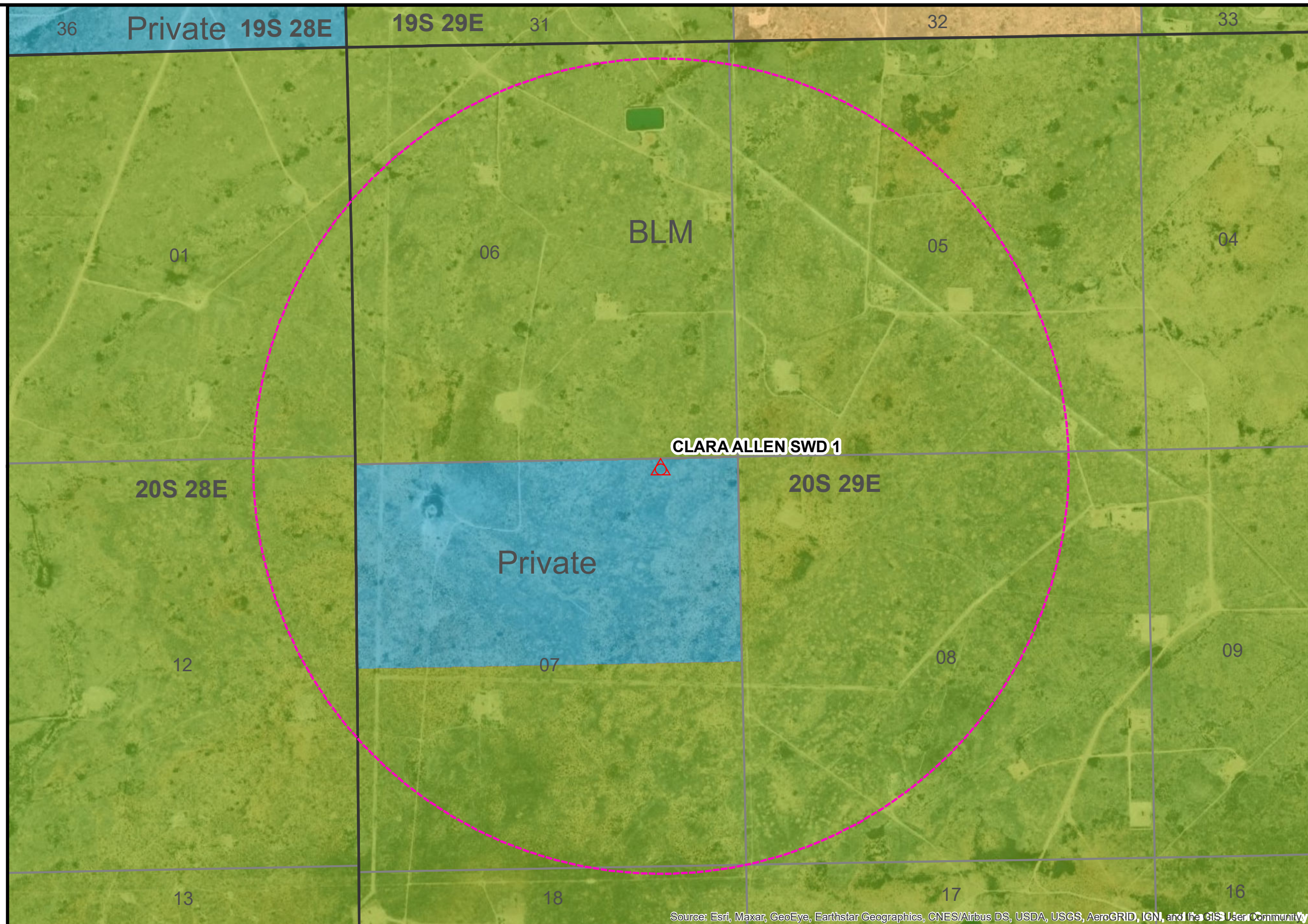

Source: Esri, Maxar, GeoEye, Earthstar Geographics, CNES/Airbus DS, USDA, USGS, AeroGRID, IGN, and the GIS User Community

**Surface Ownership**  
**Solaris Water Midstream - Clara Allen SWD #1 - Eddy County NM**

Date: 3/3/2021

	OWNER NAME
	BUREAU OF LAND MANAGEMENT
	HARLEY W. & CAROL J. BALLARD