

Initial Application Part I

Received 8/5/21

This application is placed in file for record. It MAY or MAY NOT have been reviewed to be determined Administratively Complete

RECEIVED: 8/5/21	REVIEWER:	TYPE: SWD	APP NO: pBL2121757164
-------------------------	-----------	------------------	------------------------------

ABOVE THIS TABLE FOR OCD DIVISION USE ONLY

NEW MEXICO OIL CONSERVATION DIVISION
 - Geological & Engineering Bureau -
 1220 South St. Francis Drive, Santa Fe, NM 87505

**ADMINISTRATIVE APPLICATION CHECKLIST**

THIS CHECKLIST IS MANDATORY FOR ALL ADMINISTRATIVE APPLICATIONS FOR EXCEPTIONS TO DIVISION RULES AND REGULATIONS WHICH REQUIRE PROCESSING AT THE DIVISION LEVEL IN SANTA FE

Applicant: Anthem Water Solutions, LLC **OGRID Number:** 330069
Well Name: Whitetail Federal SWD 1 **API:** 30-015-20609
Pool: SWD; Devonian-Silurian **Pool Code:** 97869

SUBMIT ACCURATE AND COMPLETE INFORMATION REQUIRED TO PROCESS THE TYPE OF APPLICATION INDICATED BELOW

1) TYPE OF APPLICATION: Check those which apply for [A]

A. Location – Spacing Unit – Simultaneous Dedication

☐ NSL☐ NSP (PROJECT AREA)☐ NSP (PRORATION UNIT)☐ SD**SWD-2449**

B. Check one only for [I] or [II]

[I] Commingling – Storage – Measurement

☐ DHC☐ CTB☐ PLC☐ PC☐ OLS☐ OLM

[II] Injection – Disposal – Pressure Increase – Enhanced Oil Recovery

☐ WFX☐ PMX☒ SWD☐ IPI☐ EOR☐ PPR**2) NOTIFICATION REQUIRED TO:** Check those which apply.A. ☒ Offset operators or lease holdersB. ☐ Royalty, overriding royalty owners, revenue ownersC. ☒ Application requires published noticeD. ☒ Notification and/or concurrent approval by SLOE. ☒ Notification and/or concurrent approval by BLMF. ☒ Surface ownerG. ☒ For all of the above, proof of notification or publication is attached, and/or,H. ☐ No notice required**FOR OCD ONLY**☐

Notice Complete

☐Application
Content
Complete

- 3) CERTIFICATION:** I hereby certify that the information submitted with this application for administrative approval is **accurate** and **complete** to the best of my knowledge. I also understand that **no action** will be taken on this application until the required information and notifications are submitted to the Division.

Note: Statement must be completed by an individual with managerial and/or supervisory capacity.

Marshall Tippen

Print or Type Name

Signature

8/4/2021

Date

(972) 795-4201

Phone Number

mtippen@anthemwsllc.com

e-mail Address



8/4/2021

New Mexico Oil Conservation Division
1220 South St. Francis Drive
Santa Fe, New Mexico, 87505

Re: Application of Anthem Water Solutions, LLC to drill and permit the saltwater disposal well Whitetail Federal SWD 1 located in Unit K, Section 3, Township 19 South, Range 27 East, NMPM, Eddy County, New Mexico.

To Whom it May Concern:

Please find the enclosed C-108 Application for Authority to Inject, supporting the above-referenced request for saltwater disposal. The well will be operated as a commercial endeavor offering operations in the area additional options for produced water disposal. Please find the enclosed C-108 Application for Authority to Inject along with supporting documents.

I would like to point out that this application is to re-open and re-complete an existing plugged and abandoned well 30-015-20609, which was drilled by Hanagan Petroleum Corporation in April of 1972 to a total depth of 10262 feet. The surface and intermediate casing were cemented to the surface, and this well was properly plugged and abandoned by Hanagan Petroleum Corporation in June of 1972. In addition to all information required for a completed Form C-108 a copy of the Sundry Notice plugging report C-103 is included with this application package. This well is located on federal land and federal minerals; a copy of the application has been sent to the appropriate regulatory bodies.

I respectfully request that the approval of this saltwater disposal well proceed swiftly and if your staff requires additional information or has any questions, please do not hesitate to call or email me.

Sincerely,

A handwritten signature in black ink, appearing to read "Marshall Tippen".

Marshall Tippen
Anthem Water Solutions
mtippen@anthemwsllc.com | (972) 795-4201

APPLICATION FOR AUTHORIZATION TO INJECT

- I. PURPOSE: _____ Secondary Recovery _____ Pressure Maintenance X Disposal _____ Storage
Application qualifies for administrative approval? X Yes _____ No
- II. OPERATOR: Anthem Water Solutions, LLC
ADDRESS: 5914 W. Courtyard Drive, Suite 320, Austin TX 78730
CONTACT PARTY: Marshall Tippen PHONE: (979) 795-4201
- III. WELL DATA: Complete the data required on the reverse side of this form for each well proposed for injection.
Additional sheets may be attached if necessary.
- IV. Is this an expansion of an existing project? _____ Yes X No
If yes, give the Division order number authorizing the project: _____
- V. Attach a map that identifies all wells and leases within two miles of any proposed injection well with a one-half mile radius circle drawn around each proposed injection well. This circle identifies the well's area of review.
- VI. Attach a tabulation of data on all wells of public record within the area of review which penetrate the proposed injection zone. Such data shall include a description of each well's type, construction, date drilled, location, depth, record of completion, and a schematic of any plugged well illustrating all plugging detail.
- VII. Attach data on the proposed operation, including:
1. Proposed average and maximum daily rate and volume of fluids to be injected;
 2. Whether the system is open or closed;
 3. Proposed average and maximum injection pressure;
 4. Sources and an appropriate analysis of injection fluid and compatibility with the receiving formation if other than reinjected produced water; and,
 5. If injection is for disposal purposes into a zone not productive of oil or gas at or within one mile of the proposed well, attach a chemical analysis of the disposal zone formation water (may be measured or inferred from existing literature, studies, nearby wells, etc.).
- *VIII. Attach appropriate geologic data on the injection zone including appropriate lithologic detail, geologic name, thickness, and depth. Give the geologic name, and depth to bottom of all underground sources of drinking water (aquifers containing waters with total dissolved solids concentrations of 10,000 mg/l or less) overlying the proposed injection zone as well as any such sources known to be immediately underlying the injection interval.
- IX. Describe the proposed stimulation program, if any.
- *X. Attach appropriate logging and test data on the well. (If well logs have been filed with the Division, they need not be resubmitted).
- *XI. Attach a chemical analysis of fresh water from two or more fresh water wells (if available and producing) within one mile of any injection or disposal well showing location of wells and dates samples were taken.
- XII. Applicants for disposal wells must make an affirmative statement that they have examined available geologic and engineering data and find no evidence of open faults or any other hydrologic connection between the disposal zone and any underground sources of drinking water.
- XIII. Applicants must complete the "Proof of Notice" section on the reverse side of this form.
- XIV. Certification: I hereby certify that the information submitted with this application is true and correct to the best of my knowledge and belief.
- NAME: Marshall Tippen TITLE: Director of Engineering
SIGNATURE:  DATE: 8/4/2021
E-MAIL ADDRESS: mtippen@anthemwsllc.com
- * If the information required under Sections VI, VIII, X, and XI above has been previously submitted, it need not be resubmitted. Please show the date and circumstances of the earlier submittal: _____

III. WELL DATA

A. The following well data must be submitted for each injection well covered by this application. The data must be both in tabular and schematic form and shall include:

- (1) Lease name; Well No.; Location by Section, Township and Range; and footage location within the section.
- (2) Each casing string used with its size, setting depth, sacks of cement used, hole size, top of cement, and how such top was determined.
- (3) A description of the tubing to be used including its size, lining material, and setting depth.
- (4) The name, model, and setting depth of the packer used or a description of any other seal system or assembly used.

Division District Offices have supplies of Well Data Sheets which may be used or which may be used as models for this purpose. Applicants for several identical wells may submit a "typical data sheet" rather than submitting the data for each well.

B. The following must be submitted for each injection well covered by this application. All items must be addressed for the initial well. Responses for additional wells need be shown only when different. Information shown on schematics need not be repeated.

- (1) The name of the injection formation and, if applicable, the field or pool name.
- (2) The injection interval and whether it is perforated or open-hole.
- (3) State if the well was drilled for injection or, if not, the original purpose of the well.
- (4) Give the depths of any other perforated intervals and detail on the sacks of cement or bridge plugs used to seal off such perforations.
- (5) Give the depth to and the name of the next higher and next lower oil or gas zone in the area of the well, if any.

XIV. PROOF OF NOTICE

All applicants must furnish proof that a copy of the application has been furnished, by certified or registered mail, to the owner of the surface of the land on which the well is to be located and to each leasehold operator within one-half mile of the well location.

Where an application is subject to administrative approval, a proof of publication must be submitted. Such proof shall consist of a copy of the legal advertisement which was published in the county in which the well is located. The contents of such advertisement must include:

- (1) The name, address, phone number, and contact party for the applicant;
- (2) The intended purpose of the injection well; with the exact location of single wells or the Section, Township, and Range location of multiple wells;
- (3) The formation name and depth with expected maximum injection rates and pressures; and,
- (4) A notation that interested parties must file objections or requests for hearing with the Oil Conservation Division, 1220 South St. Francis Dr., Santa Fe, New Mexico 87505, within 15 days.

NO ACTION WILL BE TAKEN ON THE APPLICATION UNTIL PROPER PROOF OF NOTICE HAS BEEN SUBMITTED.

NOTICE: Surface owners or offset operators must file any objections or requests for hearing of administrative applications within 15 days from the date this application was mailed to them.

Item III – Subject Well Data (Attachment 1)

A. Well Data

1) General Well Data

Operator: Anthem Water Solutions, LLC

Lease Name and Well Number: Whitetail Federal SWD 1

Location Footage Calls: 1980' from FSL, 1980' from FWL

Legal Location: Unit K, Section 3, Township 19 South, Range 27 East, NMPPM

Ground Elevation: 3423 feet

Proposed Injection Interval: 10550 - 11063 (open hole)

County: Eddy

2) - 3) Casing , Tubing & Cement Information

Casing / Tubing / Cement					
Label	1	2	3	4	5
Type	Surface	Intermediate	Intermediate	Open Hole	Tubing
OD	12 3/4"	8 5/8"	7"	5 1/2"	4 1/2"
Weight	35 lb / ft	23 / 24 lb / ft	26 lb / ft	N/A	11.6 lb / ft
Grade	Unknown	Unknown	P-110	N/A	N-80 IPC
Hole Size	17"	11"	7 7/8"	5 1/2"	N/A
Depth Set	295'	1,884'	10,550'	10,550' - 11,063'	0' - 10,500'
TOC	Surface	Unknown	Surface*	N/A	N/A
Volume	350 sks	250 sks	1,800 sks	N/A	N/A
DV Tool 1	N/A	N/A	5,000'	N/A	N/A

**Wellbore Diagram Attached*

4) Packer Information:

Arrowset AS1-X or equivalent packer set at approximately 10500 feet

**Packer Schematic Attached*

B. Completion Information

1) **Injection Formation Name:** Devonian-Silurian

Pool Name: SWD; Devonian-Silurian

Pool Code: 97869

2) **Injection Interval:** 10550 - 11063 (open hole)

3) **Drilling Purpose:** Drilled for injection

4) **Overlying Oil and Gas Zones:** Below are approximate tops for known oil and gas producing zones in the area.

- Bone Spring: 3831'
- Wolfcamp: 7600'
- Strawn: 9228'
- Atoka: 9450'
- Morrow: 9855'

5) **Underlying Oil and Gas Zones:** No underlying oil and gas zones exist.

Item V – Well and Lease Maps (Attachment 2)

- 1) **2-mile oil & Gas Well Map**
- 2) **1-mile Well Detail List**
- 3) **2-Mile Lease Map**
- 4) **2-Mile Mineral Ownership Map**
- 5) **2-Mile Surface Ownership map**
- 6) **1.5-Mile Deep SWD Map (Devonian-Silurian)**
- 7) **Potash Lease Map**

Item VI – AOR Well List (Attachment 2)

There have been 14 wells drilled within the 1-mile AOR. None of these wells nor any new or permitted wells penetrate the injection zone.

Item VII – Proposed Operation (Attachment 3)

- 1) **Proposed Maximum Injection Rate:** 30,000 bwpd
Proposed Average Injection Rate: 15,000 bwpd
- 2) A **closed system** will be used.
- 3) **Proposed Maximum Injection Pressure:** 2110 psi (surface)
- 4) **Proposed Average Injection Pressure:** 1266 psi (surface)
- 5) **Source Water Analysis:** It is expected that the injected fluid will consist of water produced from the Wolfcamp and Bone Springs formations. Water samples from these formations are included in Attachment 3.
- 6) **Injection Formation Water Analysis:** The proposed SWD will be injecting water into the Devonian-Silurian formation which is a non-productive zone known to be compatible with formation water from the Wolfcamp and Bone Springs formations. Water analyses from the Devonian-Silurian formation in the area are included in attachment 3.

Item VIII – Geologic Description

The proposed injection interval includes the Devonian–Silurian formation from 10550 feet to 11063 feet. This formation consists of interbedded carbonate rocks consisting of dolomites and limestones with some interbedded siltstones and shales. Several thick sections of porous and permeable intervals capable of taking water are present within the subject formations in the area.

The base of the lowermost Underground Source of Drinking Water (USDW) is at a depth of approximately 1,182 feet. The USDW is covered by 8 5/8" casing set at 1,884 feet and cemented to surface as well as 7" casing to be set at 10,550'.

Item IX – Proposed Stimulation

A small cleanup acid job may be used to remove mud and drill cutting from the formation. However, no other formation stimulation is currently planned.

Item X – Logging and Test Data

Log data will be submitted to the OCD upon completion of this well.

Item XI – Fresh Groundwater Samples (Attachment 4)

Based on a review of the data from the New Mexico Office of State Engineer there are no fresh water wells within a 1-mile radius of the proposed location. As a result, no groundwater samples were obtained.

XII – No Hydrologic Connection Statement (Attachment 5)

Anthem has examined available geologic and engineering data, and has found no evidence of faulting present in the area that would provide a hydrologic connection between the injection interval and overlying USDWs. Additionally, the casing and cementing program has been designed to further insure there will be no hydrologic connection between the injection interval and overlying USDWs. A letter from a knowledgeable and qualified expert stating that there is a low risk of seismic activity from the proposed injection activities is included in Attachment 5.

XIII – Proof of Notice (Attachment 6)

A Public Notice was filed with Carlsbad Current-Argus and an affidavit is included in Attachment 6.

A copy of the application was mailed to the OCD District Office, landowners, appropriate regulatory bodies, and leasehold operators within a 1-mile radius of the proposed SWD location. A list of recipients, as well as delivery confirmations, is included in Attachment 6.

Attachments Table of Content:

Attachment 1:

C-102

Existing Wellbore Diagram

Proposed Wellbore Diagram

Packer Schematic

C-103

Attachment 2:

2-mile Oil & Gas Well Map

1-mile Well Detail List

2-Mile Lease Map

2-Mile Mineral Ownership Map

2-Mile Surface Ownership map

1.5-Mile Deep SWD Map (Devonian-Silurian)

Potash Lease Map

Attachment 3:

Source Water Analysis

Formation Water Analysis

Attachment 4:

1-Mile Fresh Ground Water Map

Fresh Ground Water Samples

Attachment 5:

Letter of Seismic Activity

Attachment 6:

Public Notice Affidavit

List of Notification Applicants & Delivery Confirmations

NEW MEXICO OIL CONSERVATION COMMISSION
WELL LOCATION AND ACREAGE DEDICATION PLAT

Form C-102
Supersedes C-12B
Effective 1-1-65

All distances must be from the outer boundaries of the Section.

Owner Hanagan Petroleum Corporation				Well No. 1	
Tract Letter K	Section 3	Township 19 South	Range 27 East	County Eddy	
Actual Footage Location of Well					
1980	feet from the	South	line and	1980	feet from the
Ground Level Elev. 3423	Producing Formation Morrow		Well Wilcoat	Dedicated Acreage 320 Acres	

1. Outline the acreage dedicated to the subject well by colored pencil or hatchure marks on the plat below.
2. If more than one lease is dedicated to the well, outline each and identify the ownership thereof (both as to working interest and royalty).
3. If more than one lease of different ownership is dedicated to the well, have the interests of all owners been consolidated by communitization, unitization, force-pooling, etc?

☐ Yes ☒ No If answer is "yes," type of consolidation _____

If answer is "no," list the owners and tract descriptions which have actually been consolidated. (Use reverse side of this form if necessary.) Will be communitized if productive.

No allowable will be assigned to the well until all interests have been consolidated (by communitization, unitization, forced-pooling, or otherwise) or until a non-standard unit, eliminating such interests, has been approved by the Commission.

CERTIFICATION

I hereby certify that the information contained herein is true and complete to the best of my knowledge and belief.

Hugh E. Hanagan
Name

Hugh E. Hanagan

Position

Vice President

Company

Hanagan Petroleum Corp.

Date

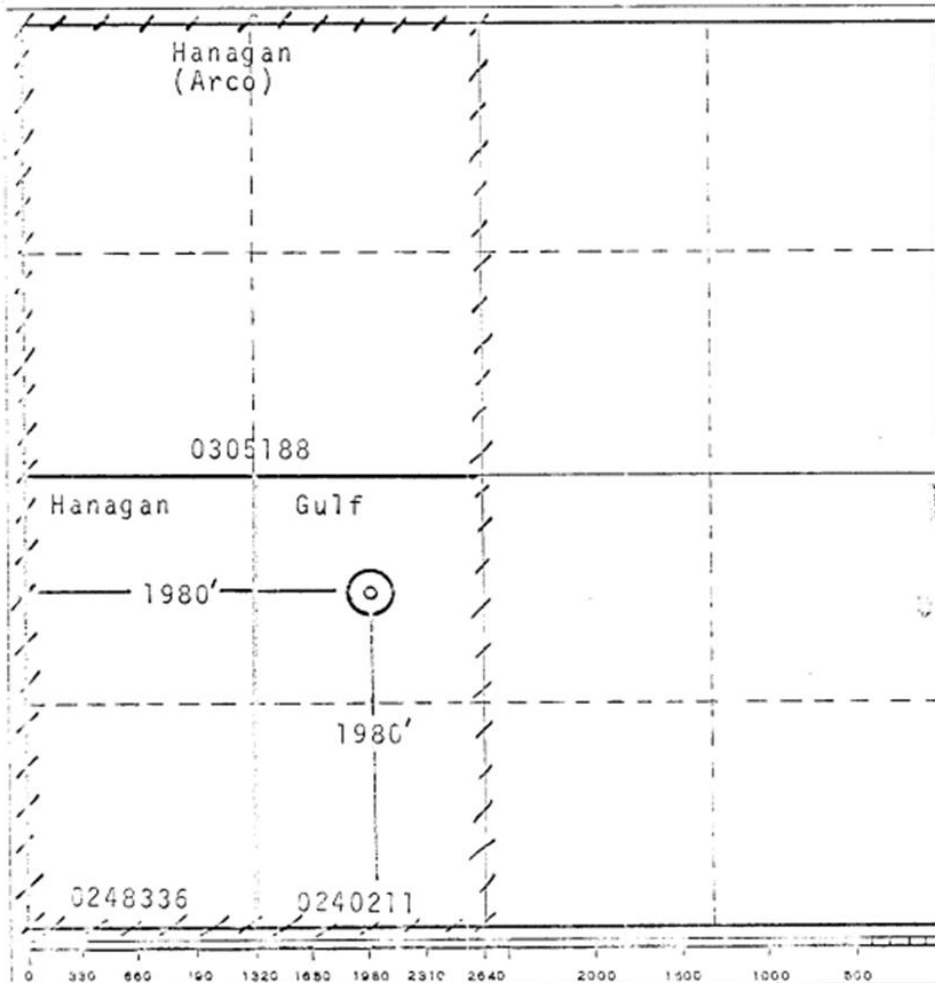

RECEIVED LAND SURVEYOR
I hereby certify that the well location shown on this plat was plotted from field notes of actual survey made by me or under my supervision, and that the same are true and correct to the best of my knowledge and belief.

JAMES H. BROWN

Date Surveyed

March 16th 1972

Registered Professional Engineer
and/or Land Surveyor

James H. Brown
Certificate No. 542

Attachment 1: Existing Wellbore Diagram

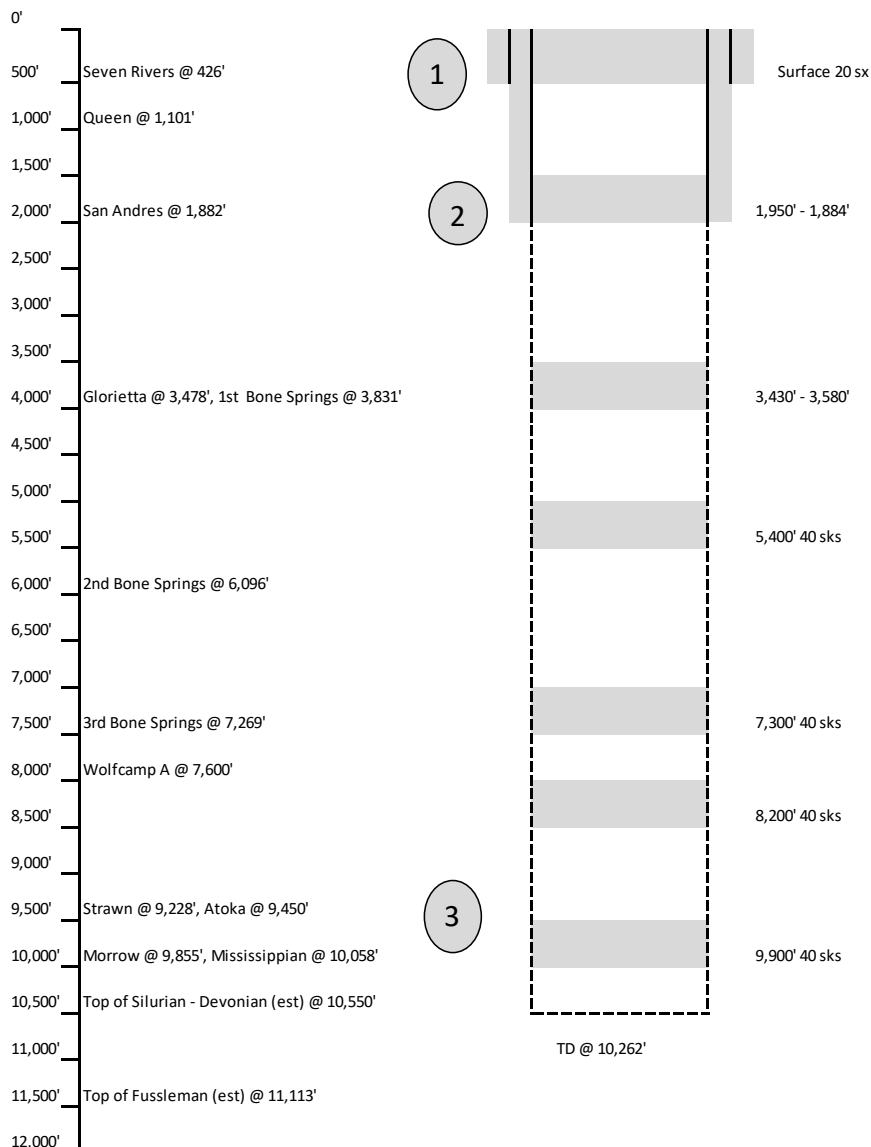

Casing / Tubing / Cement			
Label	1	2	3
Type	Surface	Intermediate	Open Hole
OD	12 3/4"	8 5/8"	N/A
Weight	35 lb / ft	23 / 24 lb / ft	N/A
Grade	Unknown	Unknown	N/A
Hole Size	17"	11"	7 7/8"
Depth Set	295'	1,884'	1,884' - 10,262'
TOC	Surface	Unknown	N/A
Volume	350 sks	250 sks	N/A

 5914 W. Courtyard Dr. Suite 320, Austin, Texas, 78730	Anthem Water Solutions, LLC	East McMillian #1: 30-015-20609
	Location: 1,980' FSL, 1,980' FWL	Date Spud: 4/20/1972
	API: 30-015-20609	Date Plugged: 6/6/1972
	NMOCD District: 2	Legal: Section 3, Township 19 South, Range 27 East, Eddy County, NM
	Drawn: PMT	Date Prepared: 6/14/2021
Notes: Wellbore diagram depicts the current wellbore condition, Image not drawn to scale		

Attachment 1: Proposed Wellbore Diagram

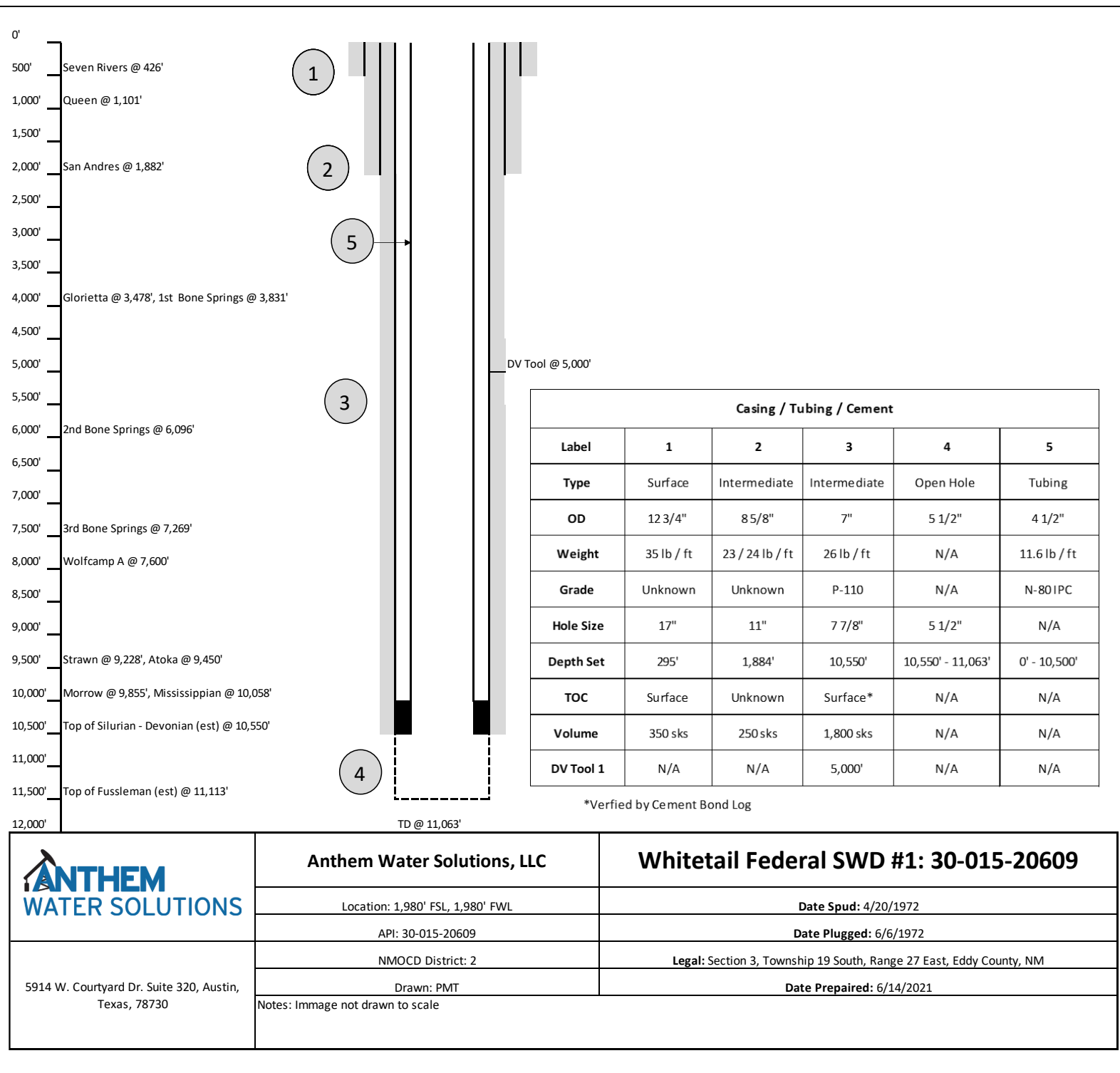

Attachment 1: Packer Schematic

AS1-X MECHANICAL PACKER



The ACT AS1-X Packer is the most versatile of the mechanically set retrievable packers and may be used in any production application. Treating, testing, injecting, pumping wells, flowing wells, deep or shallow, the AS1-X is suited for all. The packer can be left in tension or compression, depending on well conditions and the required application. A large internal by-pass reduces swabbing when running and retrieving. The by-pass closes when the packer is set and opens prior to releasing the upper slips when retrieving to allow pressure equalization.

The J-slot design allows easy setting and releasing: 1/4 turn right-hand set, right-hand release. A patented upper-slip releasing system reduces the force required to release the packer. A non directional slip is released first, making it easier to release the other slips. The AS1-X packer can withstand 7,000 psi (48 MPa) of differential pressure above or below.

FEATURES, ADVANTAGES AND BENEFITS:

- The design holds high differential pressure from above or below, enabling the packer to meet most production, stimulation, and injection needs
 - The packer can be set with compression, tension, or wire line, enabling deployment in shallow and deep applications
 - The packer can be set and released with only a one-quarter turn of the tubing
 - The bypass valve is below the upper slips so that debris are washed from the slips when the valve is opened, reducing the times for circulation and total retrieval
-
- The full opening enables unrestricted flow and the passage of wire line tools and other packer systems
 - The packer can be run with the T-2 on-off tool, which enables the tubing to be disconnected and retrieved without retrieving the packer

OPTIONS:

- Elastomer options are available for hostile environments
- Optional safety releases are available

Form 9-331
(May 1963)UNITED STATES
DEPARTMENT OF THE INTERIOR
GEOLOGICAL SURVEYSUBMIT IN 1. LOCATE*
(Other instructions on reverse side)Form approved.
Budget Bureau No. 42-R1424.

SUNDRY NOTICES AND REPORTS ON WELLS

(Do not use this form for proposals to drill or to deepen or plug back to a different reservoir.
Use "APPLICATION FOR PERMIT—" for such proposals.)

1. OIL WELL <input type="checkbox"/> GAS WELL <input type="checkbox"/> OTHER <input checked="" type="checkbox"/> Dry Hole		5. LEASE DESIGNATION AND SERIAL NO. NM 0240211	
2. NAME OF OPERATOR Hanagan Petroleum Corporation		6. IF INDIAN, ALLOTTEE OR TRIBE NAME ---	
3. ADDRESS OF OPERATOR P. O. Box 1737, Roswell, New Mexico 88201		7. UNIT AGREEMENT NAME ---	
4. LOCATION OF WELL (Report location clearly and in accordance with any State requirements.* See also space 17 below.) At surface 1980' FSL & 1980' FWL		8. FARM OR LEASE NAME East McMillan	
14. PERMIT NO.		9. WELL NO. 1	
15. ELEVATIONS (Show whether DF, RT, GR, etc.) 3434' KB		10. FIELD AND POOL, OR WILDCAT Wildcat	
		11. SEC., T., R., M., OR BLK. AND SURVEY OR AREA 3-19S-27E	
		12. COUNTY OR PARISH Eddy	
		13. STATE N. Mex.	

16. Check Appropriate Box To Indicate Nature of Notice, Report, or Other Data

NOTICE OF INTENTION TO:		SUBSEQUENT REPORT OF:	
TEST WATER SHUT-OFF <input type="checkbox"/>	FULL OR ALTER CASING <input type="checkbox"/>	WATER SHUT-OFF <input type="checkbox"/>	REPAIRING WELL <input type="checkbox"/>
FRACTURE TREAT <input type="checkbox"/>	MULTIPLE COMPLETE <input type="checkbox"/>	FRACTURE TREATMENT <input type="checkbox"/>	ALTERING CASING <input type="checkbox"/>
SHOOT OR ACIDIZE <input type="checkbox"/>	ABANDON* <input checked="" type="checkbox"/>	SHOOTING OR ACIDIZING <input type="checkbox"/>	ABANDONMENT* <input type="checkbox"/>
REPAIR WELL <input type="checkbox"/>	CHANGE PLANS <input type="checkbox"/>	(Other) <input type="checkbox"/>	

(NOTE: Report results of multiple completion on Well Completion or Recompletion Report and Log form.)

17. DESCRIBE PROPOSED OR COMPLETED OPERATIONS (Clearly state all pertinent details, and give pertinent dates, including estimated date of starting any proposed work. If well is directionally drilled, give subsurface locations and measured and true vertical depths for all markers and zones pertinent to this work.)*

6/5/72: Subject well to be plugged and abandoned as approved by Mr. Knauf by telephone this date as follows:

40 sx plug 9900-9800'
40 sx plug 8200-8100'
40 sx plug 7300-7200'
40 sx plug 5400-5300'
50 sx plug 3580-3430'
50 sx plug 8-5/8" csg. @ 1884' (1850-1950')
20 sx plug @ surface with appropriate dry hole marker.
No surface or intermediate csg. pulled. Work to be performed immediately.

RECEIVED

JUN 5 1972

JUN - 7 1972

U. S. GEOLOGICAL SURVEY
ARTS & MINES

18. I hereby certify that the foregoing is true and correct

SIGNED Hugh C. Hanagan TITLE Vice President DATE 6/5/72

(This space for Federal or State office use)



TITLE _____ DATE _____

*See Instructions on Reverse Side

Attachment 2: 2-Mile Oil & Gas Map

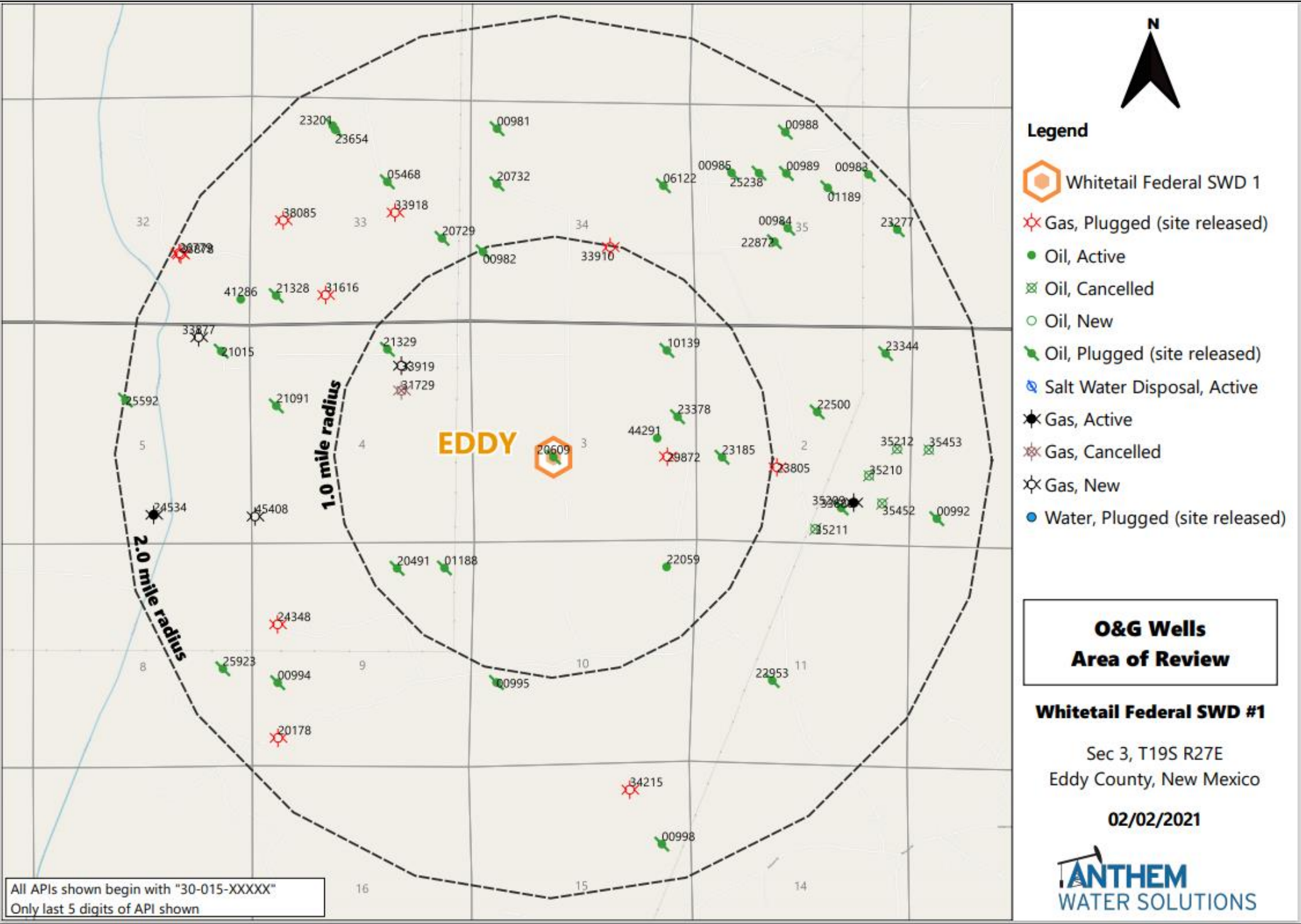

Attachment 2: 1-mile Well Detail List

AOR Tabulation for Whitetail Federal SWD #1 (Top of Injection Interval: 10,550')								
Well Name	API #	Well Type	Well Status	Operator	Spud Date	Location (Sec, Tn, Rg)	Total Vertical Depth	Penetrate Inj Zone
CIELO 4 FEDERAL COM #001	30-015-33919	Gas	New	EOG RESOURCES INC	12/31/9999	B-04-19S-27E	Never Drilled Pmt	No
PRE-ONGARD WELL #002	30-015-21329	Oil	Plugged (site released)	PRE-ONGARD WELL OPERATOR (Hanagan Petroleum Corp)	8/28/1974	B-04-19S-27E	668	No
PRE-ONGARD WELL #001	30-015-20491	Oil	Plugged (site released)	PRE-ONGARD WELL OPERATOR (Hanagan Petroleum Corp)	8/27/1971	B-09-19S-27E	1,072	No
PRE-ONGARD WELL #001	30-015-01188	Oil	Plugged (site released)	PRE-ONGARD WELL OPERATOR	1/1/1900	A-09-19S-27E	-	No
PRE-ONGARD WELL #001	30-015-00982	Oil	Plugged (site released)	PRE-ONGARD WELL OPERATOR	1/1/1900	L-34-18S-27E	-	No
KAISER LAKE 4 FEDERAL COM #001	30-015-31729	Gas	Cancelled	NEARBURG PRODUCING CO	12/31/9999	G-04-19S-27E	-	No
PRE-ONGARD WELL #001	30-015-20609	Oil	Plugged (site released)	PRE-ONGARD WELL OPERATOR	1/1/1900	K-03-19S-27E	-	No
SECRETARIAT 3 FEDERAL COM #501H	30-015-44291	Oil	Active	EOG RESOURCES INC	8/16/2017	I-03-19S-27E	6,534	No
SAGEBRUSH FEDERAL COM #001	30-015-33910	Gas	Plugged (site released)	COG OPERATING LLC	5/15/2005	J-34-18S-27E	10,340	No
FEDERAL HF #001	30-015-22059	Oil	Active	EOG RESOURCES INC	2/24/1977	A-10-19S-27E	3,038	No
PRE-ONGARD WELL #001	30-015-10139	Oil	Plugged (site released)	PRE-ONGARD WELL OPERATOR	1/1/1900	A-03-19S-27E	-	No
PRE-ONGARD WELL #001	30-015-23378	Oil	Plugged (site released)	PRE-ONGARD WELL OPERATOR	1/1/1900	H-03-19S-27E	-	No
PRE-ONGARD WELL #001	30-015-23185	Oil	Plugged (site released)	PRE-ONGARD WELL OPERATOR	1/1/1900	L-02-19S-27E	-	No
ANGELL FEDERAL COM #001	30-015-29872	Gas	Plugged (site released)	CHI OPERATING INC	11/12/1997	I-03-19S-27E	8,894	No
Notes: No Wells within a 1-mile radius penetrated the injection interval.								

Attachment 2: 2-Mile Oil & Gas Lease Map

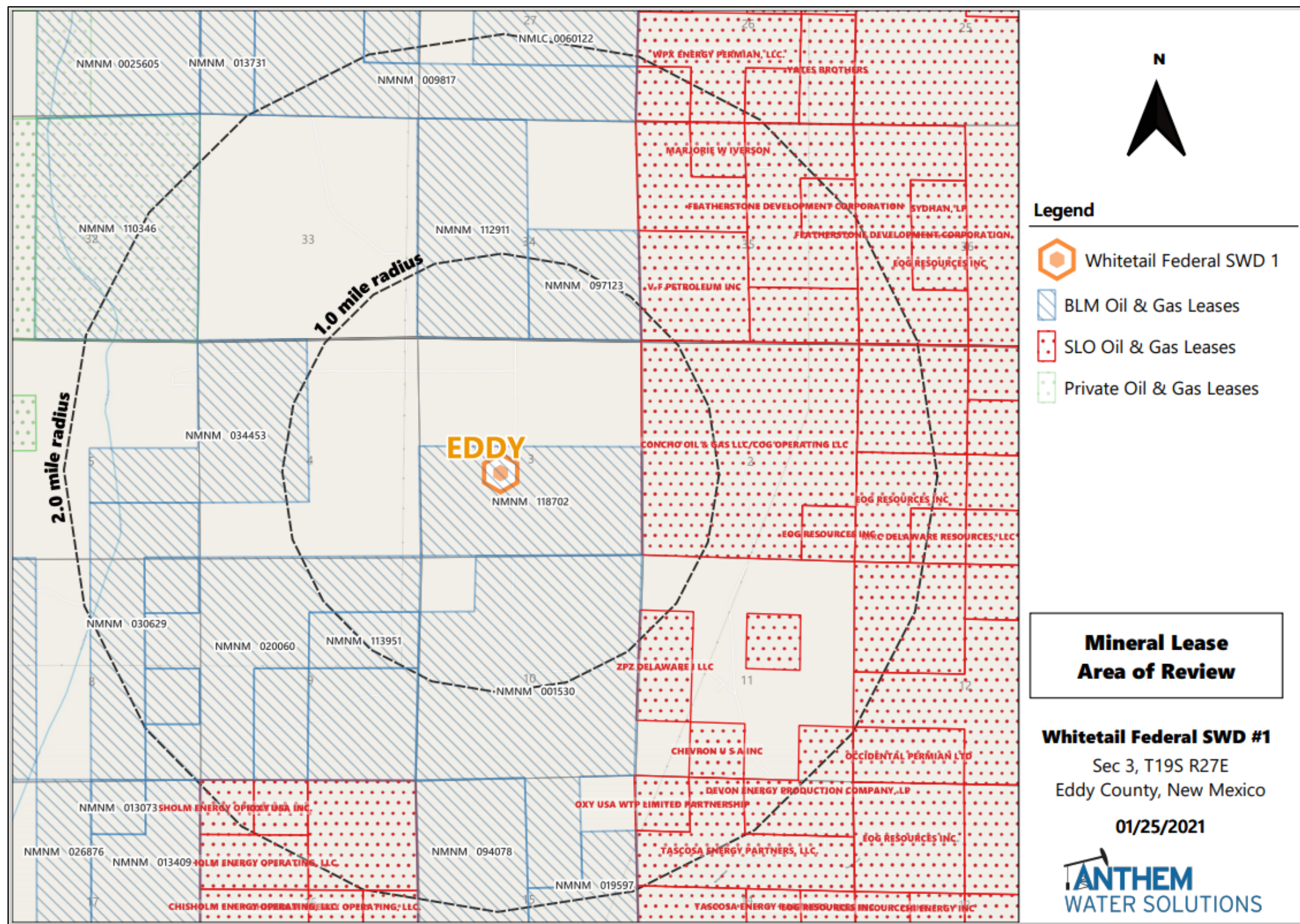

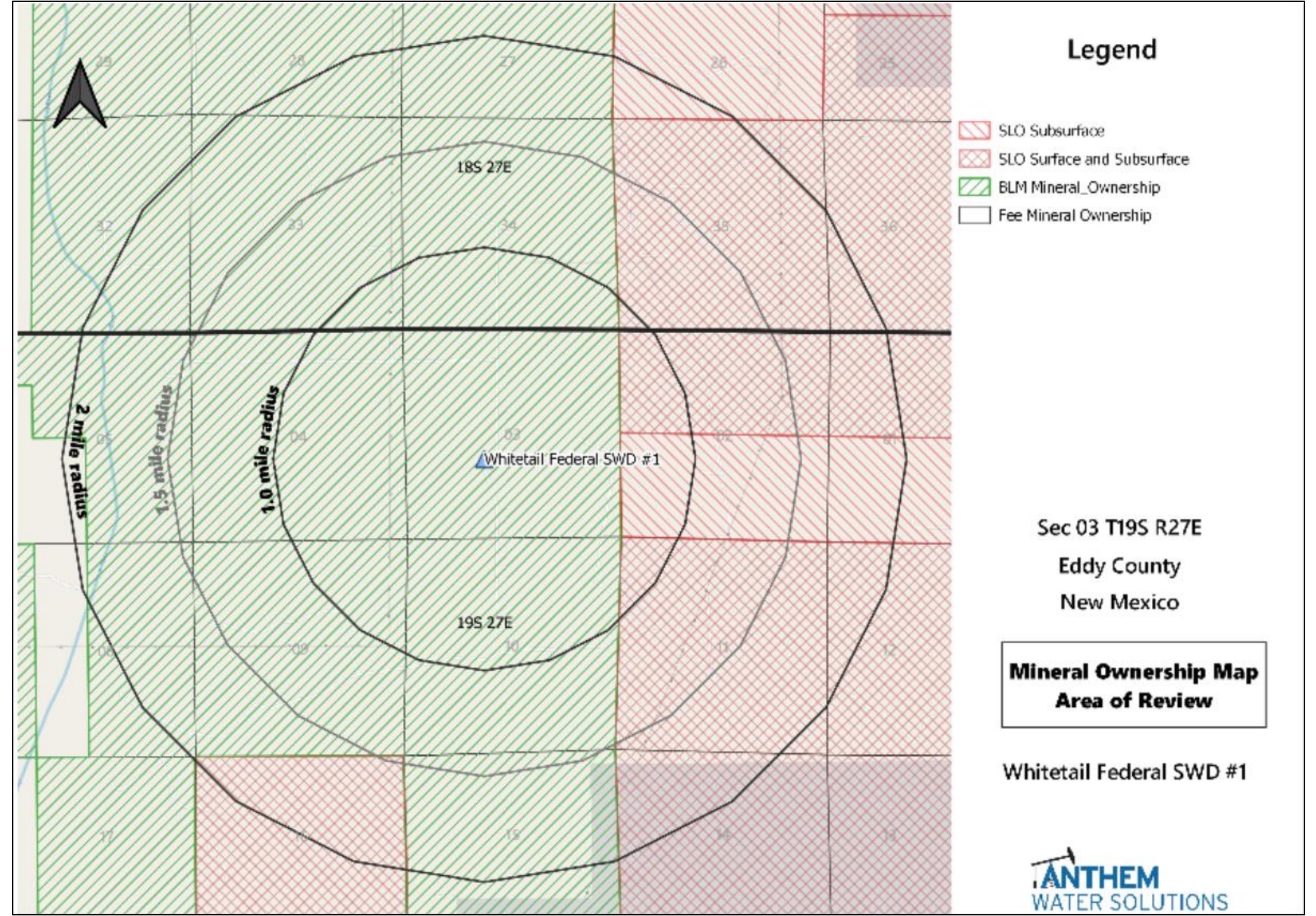

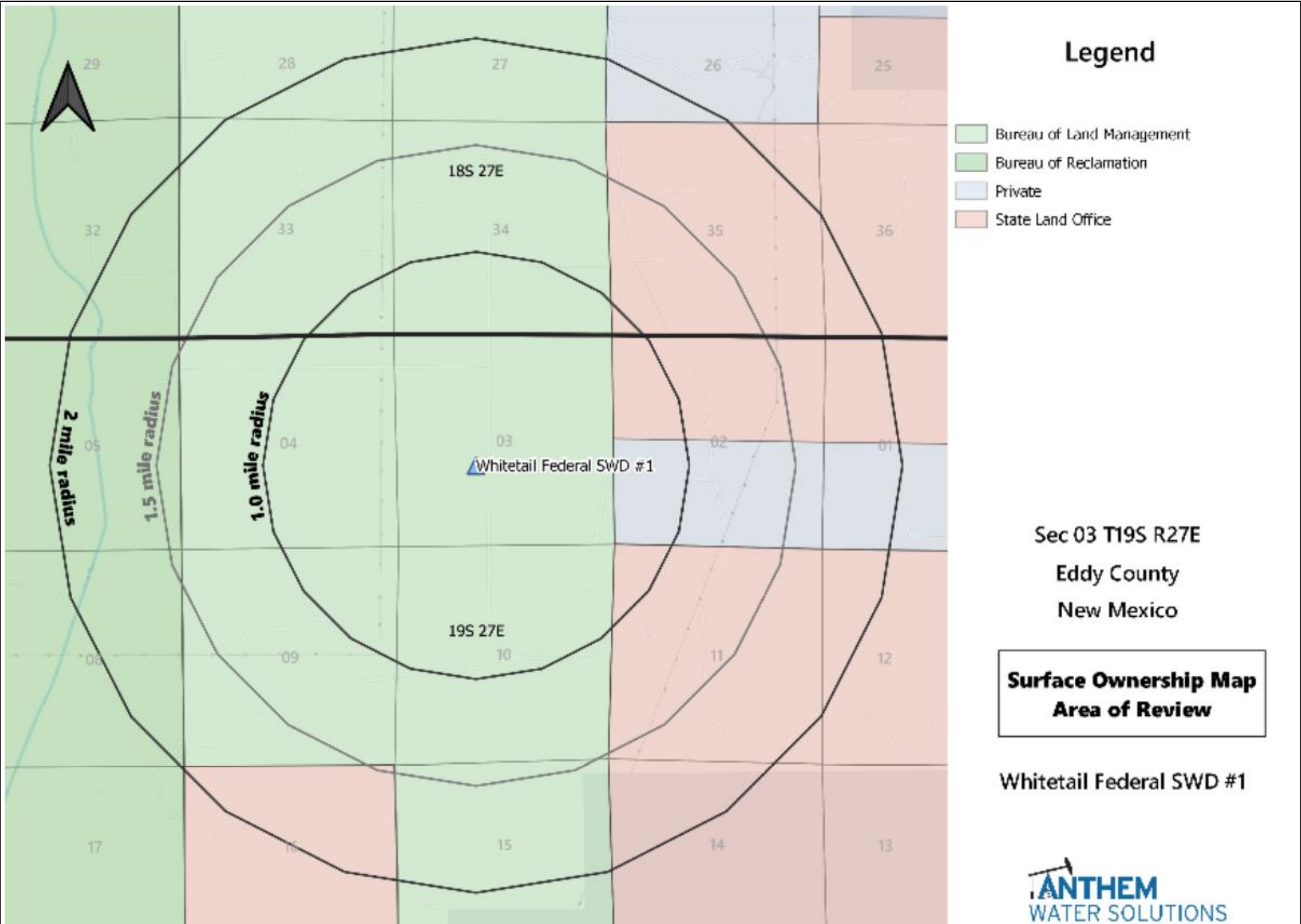

Attachment 2: 1.5 Mile Deep SWD Map

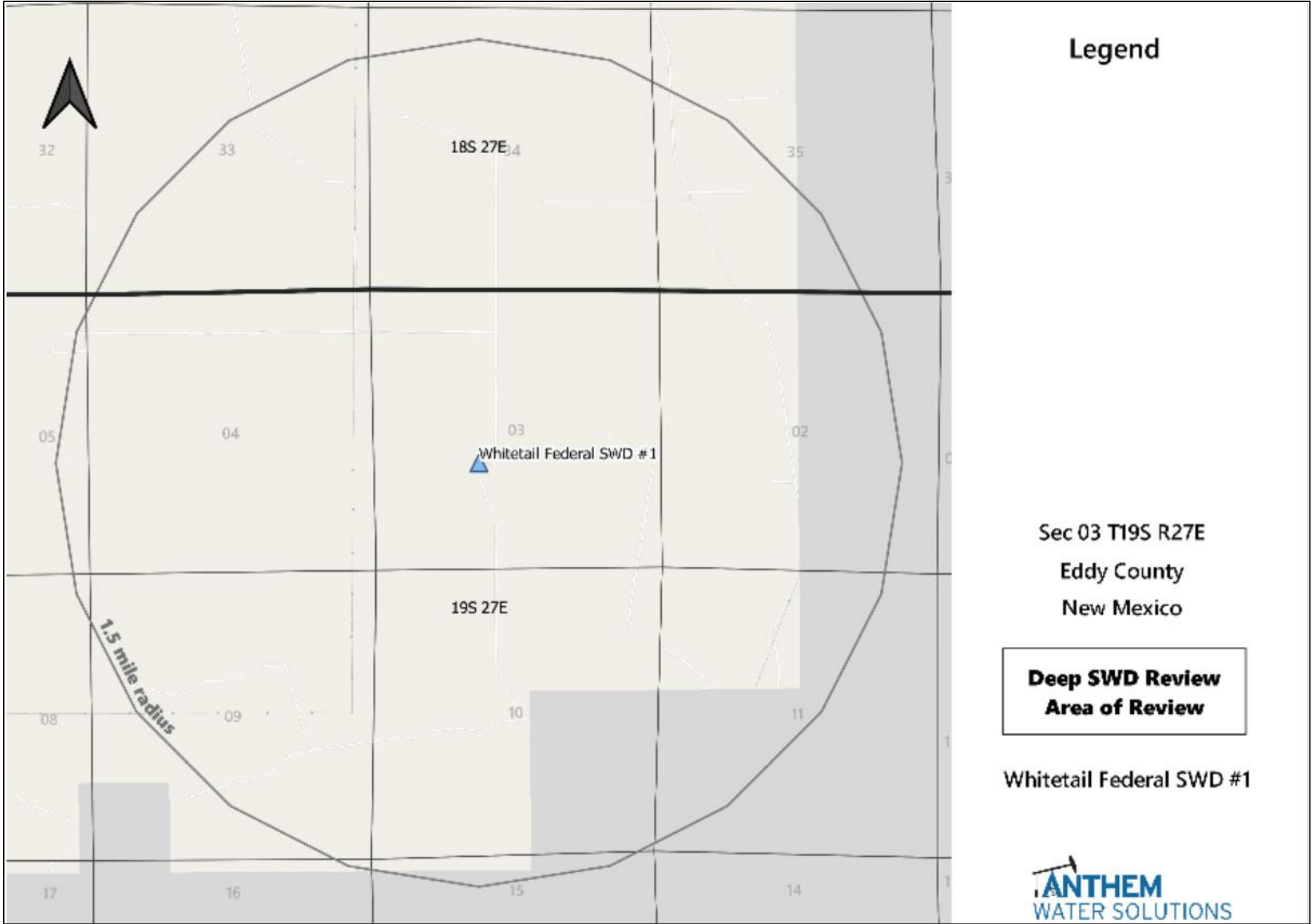

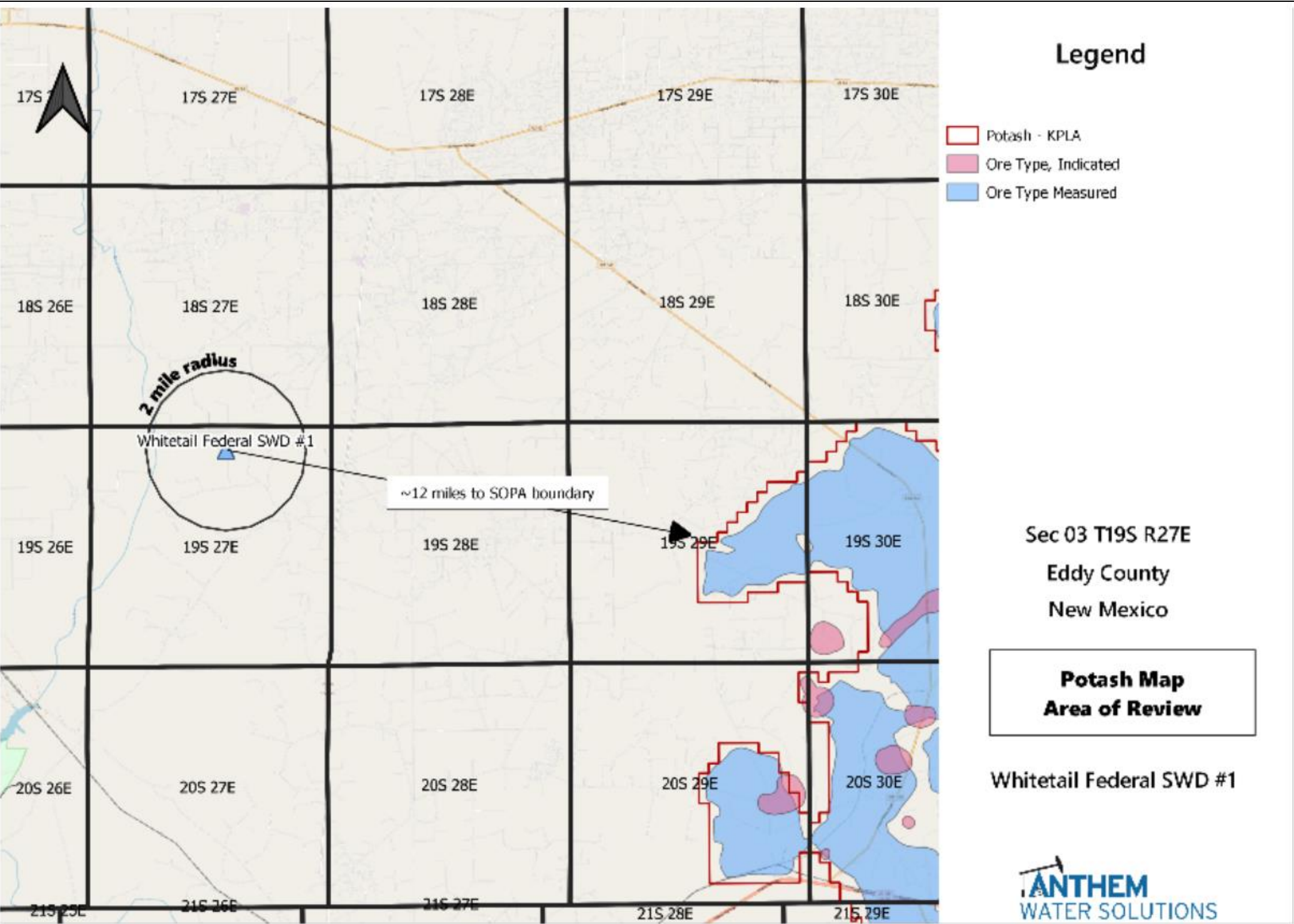

Attachment 3: Formation & Source Water Analysis

Injection Formation Water Analysis													
Anthem Water Solutions, LLC													
Well Name	API	Latitude	Longitude	Section	Township	Range	County	State	Field	Formation	TDS (Mg/L)	Bicarbonate (MG/L)	Sulfate (Mg/L)
PRE-ONGARD WELL #001	30-015-02416	32.5527229	-104.1623917	22	20S	28E	Eddy	NM		DEVONIAN	39,605	810	1,618
PRE-ONGARD WELL #001	30-015-02475	32.4421539	-104.042305	36	21S	28E	Eddy	NM		DEVONIAN	50,026	762	1,150
PRE-ONGARD WELL #001	30-015-03537	32.6839676	-104.0347595	1	19S	29E	Eddy	NM		DEVONIAN	29,011	520	1,500
WHITE CITY PENN GAS COM UNIT 1 #001	30-015-00408	32.1937523	-104.3088455	29	24S	26E	Eddy	NM	WHITE CITY	DEVONIAN	#N/A	653	1,336
REMUDA BASIN UNIT #001	30-015-03691	32.2886238	-103.9360428	24	23S	29E	Eddy	NM	REMUDA	DEVONIAN	271,010	130	100
BIG EDDY SWD #001	30-015-05819	32.5968154	-103.8504983	3	20S	31E	Eddy	NM	SWD	DEVONIAN	137,989	1,420	1,751
COTTON DRAW UNIT #084	30-015-29728	32.1592751	-103.7438736	2	25S	31E	Eddy	NM	PADUCA	DEVONIAN	85,799	59	389
COTTON DRAW UNIT #076	30-015-29252	32.1565857	-103.737999	1	25S	31E	Eddy	NM	PADUCA	DEVONIAN	128,947	317	481
COTTON DRAW UNIT #086	30-015-29850	32.1446877	-103.7278824	12	25S	31E	Eddy	NM	PADUCA	DEVONIAN	131,450	353	542
Source Water Analysis													
Anthem Water Solutions, LLC													
Well Name	API	Latitude	Longitude	Section	Township	Range	County	State	Field	Formation	TDS (Mg/L)	Bicarbonate (MG/L)	Sulfate (Mg/L)
PRE-ONGARD WELL #001	30-015-02416	32.5527229	-104.1623917	22	20S	28E	Eddy	NM		WOLFCAMP	55,965	252	2,260
PRE-ONGARD WELL #004	30-015-02280	32.6479454	-104.1791229	21	19S	28E	Eddy	NM	MILLMAN EAST	WOLFCAMP	118,720	2,700	1,080
SERRANO 29 FEDERAL #001H	30-015-37763	32.1901523	-104.2192003	29	24S	27E	Eddy	NM	SULPHATE DRAW	WOLFCAMP	102,136	183	#N/A
HABANERO 17 FEDERAL COM #001H	30-015-36108	32.2218759	-104.2189611	17	24S	27E	Eddy	NM	BLACK RIVER	WOLFCAMP	108,205	146	#N/A
WHITE CITY PENN GAS COM UNIT 1 #001	30-015-00408	32.1937523	-104.3088455	29	24S	26E	Eddy	NM	WHITE CITY	WOLFCAMP	#N/A	653	1,336
STATE AC COM #001	30-015-22299	32.5572166	-104.1806107	21	20S	28E	Eddy	NM	BURTON FLAT	WOLFCAMP	144,926	37	1,350
PURE GOLD C-17 FEDERAL #002	30-015-26021	32.3057258	-103.7987356	17	23S	31E	Eddy	NM	SAND DUNES WEST	WOLFCAMP	11,361	1,708	#N/A
PARKWAY WEST UNIT #015	30-015-32363	32.6353531	-104.0734329	28	19S	29E	Eddy	NM	PARKWAY WEST UNIT #015	BONE SPRING	215,934	98	702
APACHE 25 FEDERAL #009	30-015-32797	32.361248	-103.8309479	25	22S	30E	Eddy	NM	APACHE 25 FEDERAL #009	BONE SPRING	160,590	146	856
TODD 22 G FEDERAL #007	30-015-32881	32.2917137	-103.7635422	22	23S	31E	Eddy	NM	TODD 22 G FEDERAL #007	BONE SPRING	269,658	37	10
PARKWAY #021	30-015-32686	32.6253433	-104.0725937	28	19S	29E	Eddy	NM	PARKWAY #021	BONE SPRING	214,972	85	715
TODD 15 M FEDERAL #013	30-015-33118	32.2989769	-103.7720947	15	23S	31E	Eddy	NM	TODD 15 M FEDERAL #013	BONE SPRING	292,473	85	490
APACHE 25 FEDERAL #005	30-015-32720	32.3612404	-103.8266678	25	22S	30E	Eddy	NM	APACHE 25 FEDERAL #005	BONE SPRING	300,667	61	17
STRAWBERRY 7 FEDERAL #003	30-015-37171	32.6812553	-103.9148483	7	19S	31E	Eddy	NM	STRAWBERRY 7 FEDERAL #003	BONE SPRING	185,540	183	600
STRAWBERRY 7 FEDERAL #007	30-015-38485	32.6812526	-103.9012376	7	19S	31E	Eddy	NM	STRAWBERRY 7 FEDERAL #007	BONE SPRING	187,930	98	940
REMUDA BASIN UNIT #001	30-015-03691	32.2886238	-103.9360428	24	23S	29E	Eddy	NM	REMUDA BASIN UNIT #001	BONE SPRING	271,010	130	100
JONES FEDERAL B #003	30-015-10394	32.6405487	-103.8334885	23	19S	31E	Eddy	NM	JONES FEDERAL B #003	BONE SPRING	178,015	305	721
LONETREE STATE #001	30-015-21920	32.478508	-104.1454086	13	21S	27E	Eddy	NM	LONETREE STATE #001	BONE SPRING	244,966	122	1,013
FEDERAL HJ-27 #001	30-015-25780	32.6335258	-103.863533	27	19S	31E	Eddy	NM	FEDERAL HJ-27 #001	BONE SPRING	176,639	305	530
HANLEY FEDERAL #001	30-015-26068	32.7674713	-103.9105911	7	18S	31E	Eddy	NM	HANLEY FEDERAL #001	BONE SPRING	204,076	293	1,515
ALLIED 7 FEDERAL #001	30-015-25900	32.7638435	-103.9067764	7	18S	31E	Eddy	NM	ALLIED 7 FEDERAL #001	BONE SPRING	225,562	122	740
APACHE 25 FEDERAL #002	30-015-27478	32.3576164	-103.8298492	25	22S	30E	Eddy	NM	APACHE 25 FEDERAL #002	BONE SPRING	9,546	183	51
ORE IDA 14 FEDERAL #009	30-015-29278	32.2118607	-103.9491348	14	24S	29E	Eddy	NM	ORE IDA 14 FEDERAL #009	BONE SPRING	190,367	244	539
H B 11 FEDERAL #003	30-015-29249	32.2272186	-103.9569855	11	24S	29E	Eddy	NM	H B 11 FEDERAL #003	BONE SPRING	195,306	256	650
HACKBERRY 18 FEDERAL #001	30-015-29780	32.654953	-103.9065323	18	19S	31E	Eddy	NM	HACKBERRY 18 FEDERAL #001	BONE SPRING	180,325	85	850
WEST SHUGART 19 FEDERAL #002	30-015-30780	32.7271385	-103.9094238	19	18S	31E	Eddy	NM	WEST SHUGART 19 FEDERAL #002	BONE SPRING	144,906	390	850
WEST SHUGART 30 FEDERAL #003	30-015-30776	32.7247467	-103.9067154	30	18S	31E	Eddy	NM	WEST SHUGART 30 FEDERAL #003	BONE SPRING	136,715	244	675
ROOKIE STATE #001	30-015-10060	32.4134165	-104.3325848	7	22S	26E	Eddy	NM	ROOKIE STATE #001	BONE SPRING	67,985	61	1,148

Attachment 4: 1-mile Fresh Water Map and Tabular List

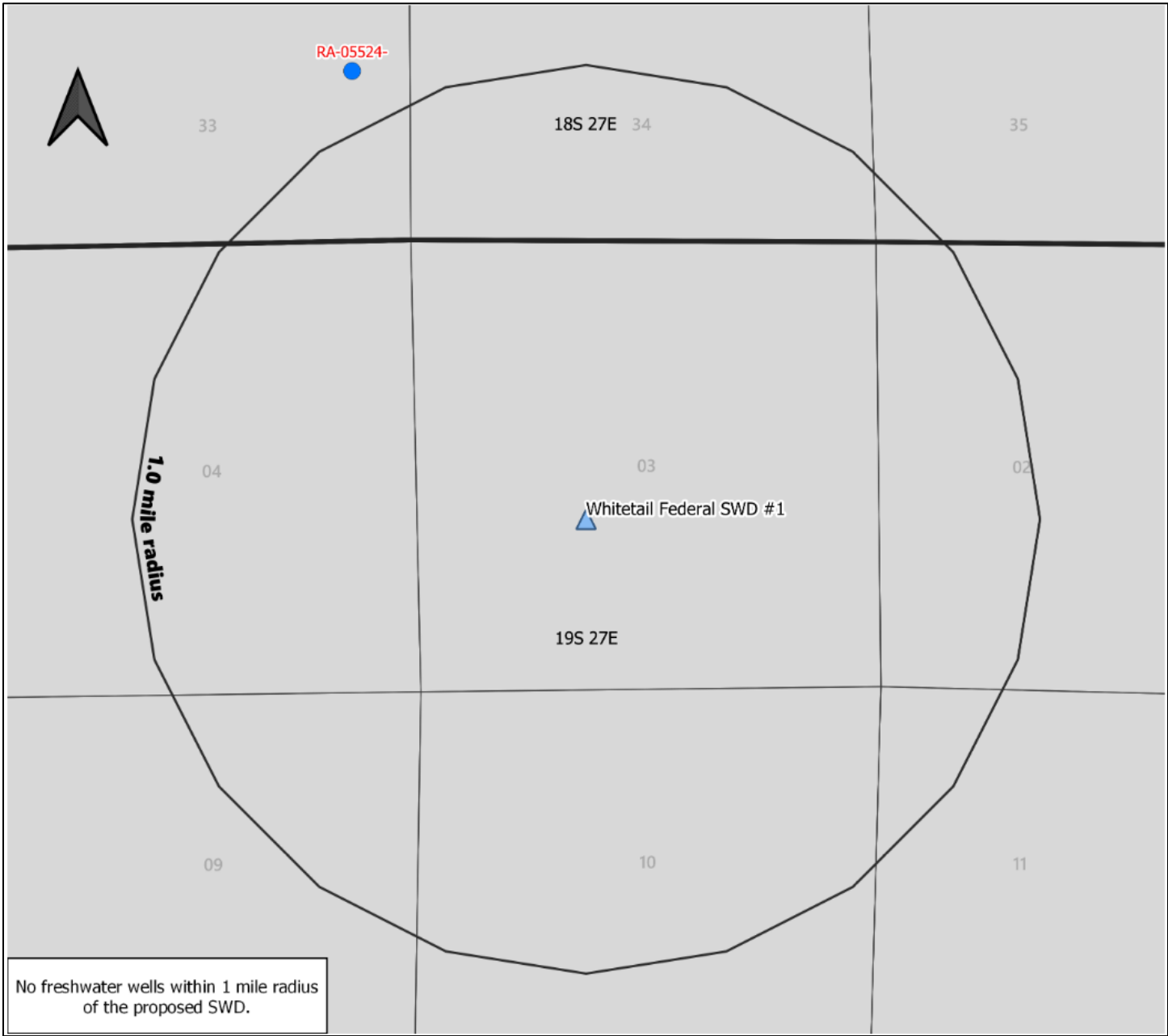

Water Well Sampling Rational					
Whitetail Federal SWD #1					
Water Wells	Owner	Available Contact Information	Use	Sampling Required	Notes
There are no water wells within a 1-mile radius					



NM Oil Conservation Division
1220 S. St. Francis Dr.
Santa Fe, NM 87505

Re: Geology Statement
Anthem Water Solutions, LLC
Whitetail Federal SWD No. 1
Section 3, T. 19S, R. 27E
Eddy County, New Mexico

To whom it may concern:

Publicly available geologic and engineering data related to the proposed well have been thoroughly reviewed, and no evidence for open faults or any other hydrologic connection between the proposed Devonian-Silurian injection zone and any underground sources of drinking water has been found. Please see the attached seismic risk assessment for additional information.

Sincerely,

A handwritten signature in dark ink that reads "Cory Walk". The signature is written in a cursive, flowing style.

Cory Walk
Geologist

Seismic Risk Assessment
Anthem Water Solutions, LLC
Whitetail Federal SWD No. 1
Section 3, Township 19 South, Range 27 East
Eddy County, New Mexico

Cory Walk, M.S.

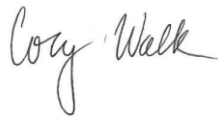
A handwritten signature in cursive script that reads "Cory Walk".

Geologist
Permits West Inc.

July 20, 2021

GENERAL INFORMATION

Whitetail Federal SWD No. 1 is located in the SW 1/4, section 3, T19S, R27E, about 17 miles north of Carlsbad, NM in the Permian Basin. Anthem Water Solutions proposes the injection zone to be within the Devonian-Silurian formation through an open hole from 10,550'-11,063' below ground surface. This report assesses concerns relating to induced seismicity along deep penetrating Precambrian faults or the connection between the injection zone and known underground potable water sources.

SEISMIC RISK ASSESSMENT

Historical Seismicity

Searching the USGS earthquake catalog resulted in no (0) earthquakes above a magnitude 2.5 within 6 miles (9.7 km) of the proposed deep disposal site since 1970 (Fig. 1). The nearest earthquake occurred on June 21, 2003 about 13.9 miles (~22.3 km) west of the proposed SWD site and had a magnitude of 3.6.

Basement Faults and Subsurface Conditions

A structure contour map (Fig. 1) of the Precambrian basement shows the Whitetail Federal SWD #1 is approximately 20.1 miles from the nearest basement-penetrating fault inferred by Ewing et al (1990). **Information about nearby faults is listed in Table 1.**

Snee and Zoback (2018) state, "In the western part of Eddy County, New Mexico, S_{Hmax} is ~north-south (consistent with the state of stress in the Rio Grande Rift; Zoback and Zoback, 1980) but rotates to ~east-northeast-west-southwest in southern Lea County, New Mexico and the northernmost parts of Culberson and Reeves counties, Texas." **Around the Whitetail Federal SWD site, Snee and Zoback indicate a S_{Hmax} direction of N010°E and an A_ϕ of 0.57, indicating an extensional (normal) stress regime.**

Induced seismicity is a growing concern of deep SWD wells. Software developed by the Stanford Center for Induced and Triggered Seismicity allows for the probabilistic screening of deeply penetrating faults near the proposed injection zone (Walsh et al., 2016; Walsh et al., 2017). This software uses parameters such as stress orientations, fault strike/dip, injection rates, fault friction coefficients, etc. to estimate the potential for fault slip. Using this software, Snee and Zoback (2018) indicate that the nearest fault (20 miles to the southeast) has a 20-30% probability of fault slip (Fig. 2). But, due to a distance of over 20 miles, the proposed SWD is unlikely to have any major effect on this fault.

GROUNDWATER SOURCES

The Capitan Aquifer (Grayburg, Queen, Seven Rivers, Yates, and Tansill Formations) acts as the principal aquifer used for potable ground water near the Whitetail Federal SWD #1 location (Richey et al., 1985). Around the Whitetail Federal SWD #1, the base of the Capitan Aquifer (San Andres Formation top) lies at a depth of approximately 1,182' bgs.

VERTICAL MIGRATION OF FLUIDS

Permeability barriers exist above (Woodford shale; 35 ft thick) and below (Simpson Group; 55 ft thick) the targeted Devonian-Silurian injection zone (Plate 2, Comer et al., 1991; Fig. 8, Frenzel et al., 1988). Precambrian structure contours (Ruppel, 2009) show the basement to be at a depth of approximately 12,610' in this area. Therefore, the injection zone lies approximately 1,550' above the Precambrian basement and approximately 9,370' below the previously stated lower limit of potable water at the base of the Capitan Aquifer (San Andres Formation top). The stratigraphy suggests that the Woodford Shale and Simpson Group are adequate confining barriers that would prevent the vertical migration of injected fluids.

CONCLUSION

After examination of publicly available geologic and engineering data, there is no evidence of open faults or any other hydrologic connection between the disposal zone and any underground sources of drinking water.

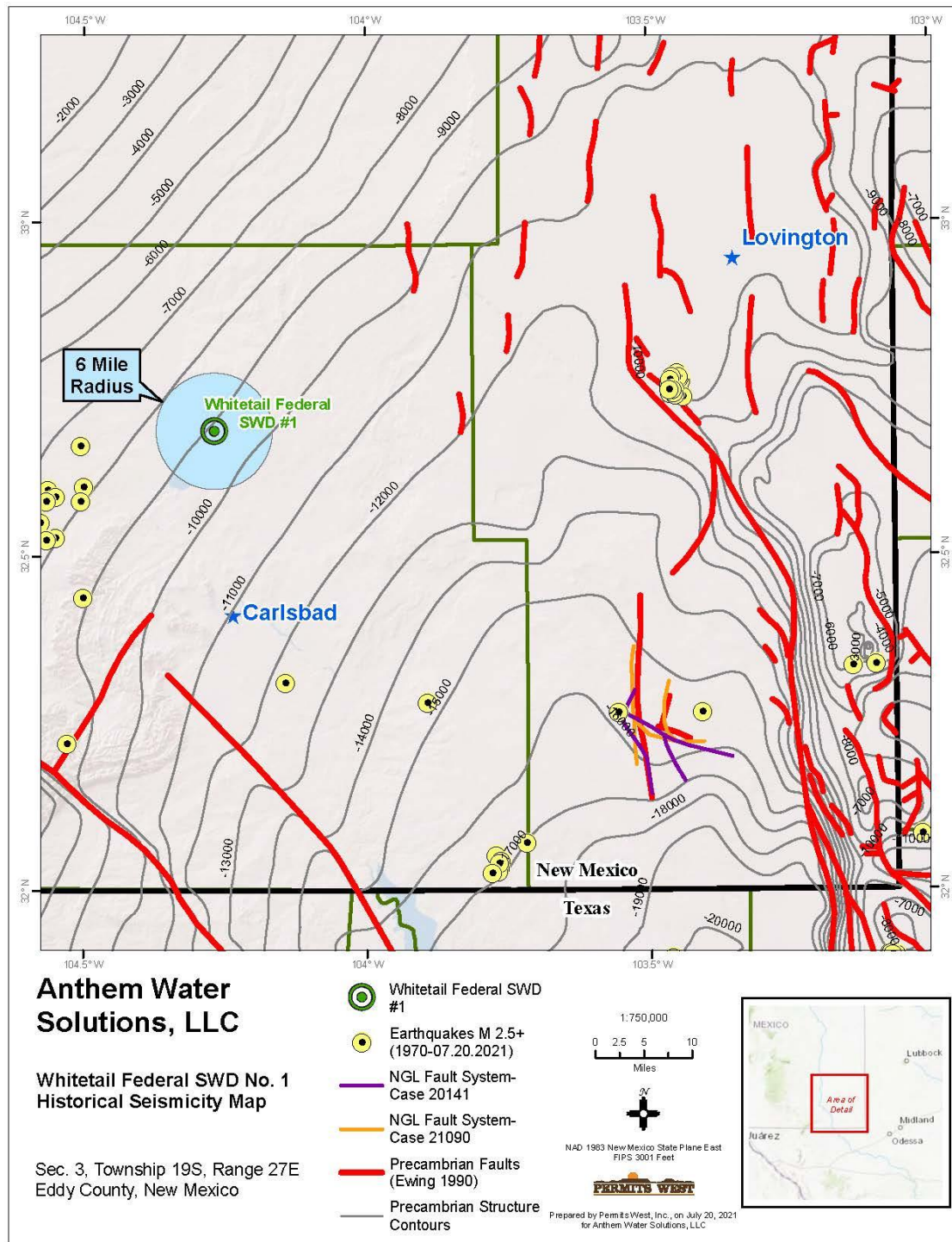

Figure 1. Structural contour map of the Precambrian basement in feet below sea level. Red lines represent the locations of Precambrian basement-penetrating faults (Ewing et al., 1990). Purple and orange lines represent the locations of basement-penetrating faults inferred by Todd Reynolds representing NGL in NMOCD Case Nos. 20141 and 21090. The Whitetail Federal SWD #1 well lies ~20.1 miles northwest of the closest deeply penetrating fault and ~13.9 miles east of the closest historic earthquake.

Table 1: Nearby Fault Information

Fault Number (Fig. 2)	Distance to proposed SWD (mi)	Strike (°)	Dip (°)	FSP (%)
1	20.1	220	50-90	20-30
2	25.2	168	50-90	0-20
3	25.6	320	50-90	0

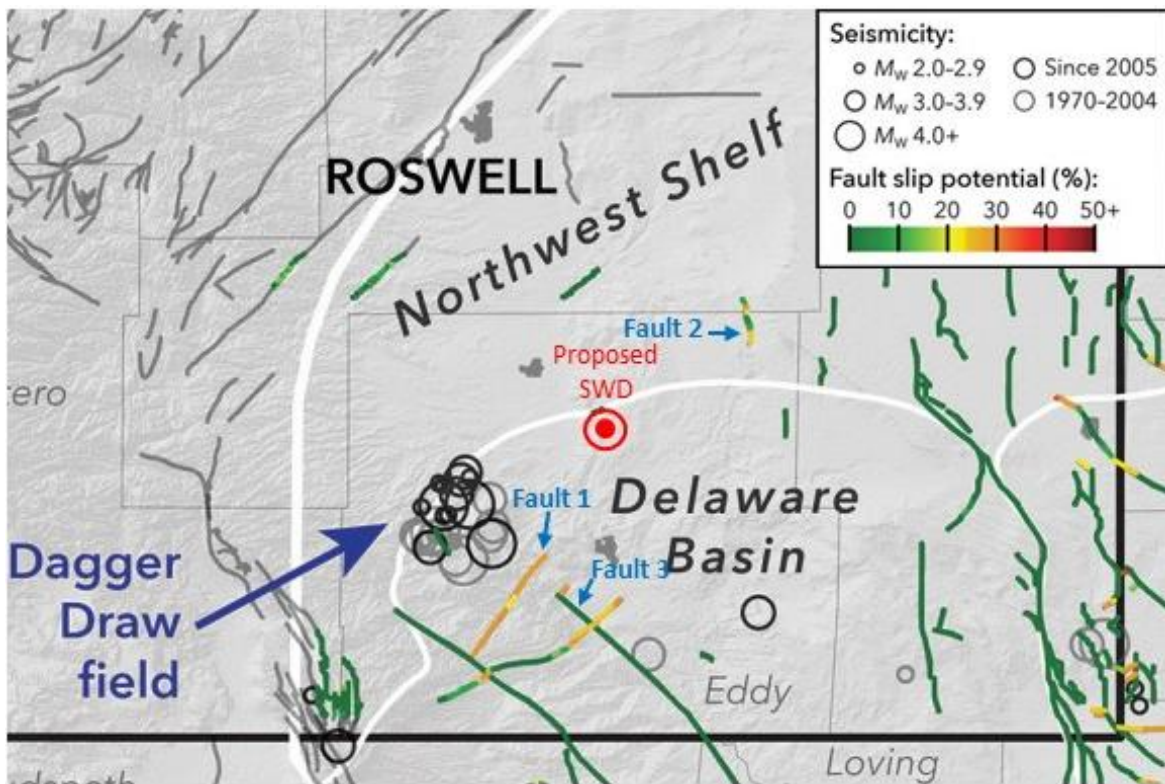

Figure 2. Modified Figure 3 from Snee and Zoback (2018). Map showing proposed location of Whitetail Federal SWD #1 in relation to Snee and Zoback's results of their FSP analysis.

References Cited

- Comer, J. B., 1991, Stratigraphic Analysis of the Upper Devonian Woodford Formation, Permian Basin, West Texas and Southeastern New Mexico: The University of Texas at Austin, Bureau of Economic Geology, Report of Investigations No. 201, 63 p.
- Ewing, T. E., 1990, The tectonic map of Texas: Austin, Bureau of Economic Geology, The University of Texas at Austin.
- Frenzel, H. N., Bloomer, R. R., Cline, R. B., Cys, J. M., Galley, J. E., Gibson, W. R., Hills, J. M., King, W. E., Seager, W. R., Kottowski, F. E., Thompson, S., III, Luff, G. C., Pearson, B. T., and Van Siclen, D. C., 1988, The Permian Basin region, in Sloss, L. L., ed., Sedimentary cover—North American Craton, U.S.: Boulder, Colorado, Geological Society of America, The Geology of North America, v. D-2, p. 261–306.
- Hurd, O; Zoback, MD, 2012, Intraplate earthquakes, regional stress and fault mechanics in the Central and Eastern U.S. and Southeastern Canada. *Tectonophysics*, 581:182-92.
- Richey, S., Wells, J., and Stephens, K., 1985, Geohydrology of the Delaware Basin and Vicinity, Texas and New Mexico: United States Geological Survey, Water-Resources Investigations Report 84-4077, 101 pp.
- Ruppel, S.C., 2009, Integrated synthesis of the Permian basin: data and models for recovering existing and undiscovered oil resources from the largest oil-bearing basin: U.S. Oil & Natural Gas Technology, Bureau Economic Geology, The University of Texas at Austin, p. 1-959.
- Snee, J.-E.L., Zoback, M.D., 2018, State of stress in the Permian Basin, Texas and New Mexico: Implications for induced seismicity: *Leading Edge*, v. 37, p. 127–134.
- Walsh, F. R., and Zoback, M. D., (2016) Probabilistic assessment of potential fault slip related to injection induced earthquakes: Application to north central Oklahoma, USA, *Geology*, Data Repository item 2016334, doi:10.1130/G38275.1
- Walsh, F. R., Zoback, M. D., Pais, D., Weingarten, M., and Tyrrell, T. (2017) FSP 1.0: A Program for Probabilistic Estimation of Fault Slip Potential Resulting From Fluid Injection, User Guide from the Stanford Center for Induced and Triggered Seismicity, available at [SCITS.Stanford.edu/software](https://scits.stanford.edu/software)
- Zoback, M. L., and M. D. Zoback, 1980, State of stress in the conterminous United States: *Journal of Geophysical Research*, 85, no. B11, 6113–6156, <https://doi.org/10.1029/JB085iB11p06113>.

Attachment 6: Public Notice Affidavit

Carlsbad Current Argus.
READ BY SUBSCRIBER OR RETAILER

Affidavit of Publication

Ad # 0004833536

This is not an invoice

ANTHEM WATER SOLUTIONS, LLC
5914 W. COURTYARD DR, STE 320

AUSTIN, TX 78730

I, a legal clerk of the **Carlsbad Current Argus**, a newspaper published daily at the City of Carlsbad, in said county of Eddy, state of New Mexico and of general paid circulation in said county; that the same is a duly qualified newspaper under the laws of the State wherein legal notices and advertisements may be published; that the printed notice attached hereto was published in the regular and entire edition of said newspaper and not in supplement thereof on the date as follows, to wit:

07/22/2021

Legal Clerk

Subscribed and sworn before me this July 22, 2021:

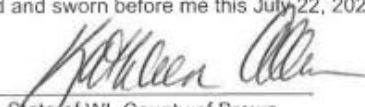
State of WI, County of Brown
NOTARY PUBLIC

1-7-25
My commission expires

**APPLICATION FOR
AUTHORITY TO INJECT**

NOTICE IS HEREBY GIVEN:
That Anthem Water Solutions, LLC, 5914 W. Courtyard Dr., Suite 320, Austin Texas, 78730, is requesting that the New Mexico Oil Conservation Division administratively approve the APPLICATION FOR AUTHORITY TO INJECT as follow:

PURPOSE: The intended purpose of the injection well is to dispose of salt water produced from permitted oil and gas wells.

WELL NAME AND LOCATION: Whitetail Federal SWD 1 Located 13 miles southeast of Artesia. NE1/4 of the SW1/4 Section 3, Township 19S, Range 27E, 1980' from South Line & 1980' from West Line, Eddy County, New Mexico.

NAME AND DEPTH OF DISPOSAL ZONE: Devonian-Silurian (10550' - 11063')

EXPECTED MAXIMUM INJECTION RATE: 30,000 barrels/day

EXPECTED MAXIMUM INJECTION PRESSURE: 2110 psi (surface)

Objections or requests for hearing must be filed with the New Mexico Oil Conservation Division within fifteen (15) days. Any objections or requests for hearing should be mailed to the Oil Conservation Division, 1220 South St. Francis Dr., Santa Fe, New Mexico 87505.

Additional information may be obtained by contacting Marshall Tippen (972) 795-4201.

#4833536, Current Argus,
July 22, 2021

Ad # 0004833536

PO #:

of Affidavits 1

This is not an invoice

Attachment 6: List of Notification Applicants & Delivery Confirmations

Whitetail Federal SWD #1 - Notice of Application Receipts				
Entity	Address	City	State	Zip Code
Landowner and Mineral Owner				
New Mexico BLM	620 E Greene St.	Carlsbad	NM	88220
New Mexico State Land Office	310 Old Santa Fe Trail	Santa Fe	NM	87501
OCD District				
NM OCD District 2	811 S. First St.	Artesia	NM	88210
Leasehold Operators (1-mile)				
EOG Resources	5509 Champions Dr	Midland	TX	79706
Notes: The table above shows the Entities who were identified as parties of interest requiring notification on either the 1-mile well detail list (Attachment 2) or on the 2-mile Mineral Lease Map (Attachment 2).				



Marshall Tippen
Anthem Water Solutions, LLC
3300 North A Street, Building 2, Suite 222
Midland, Texas 79705

New Mexico BLM
620 E Greene St.
Carlsbad, NM 88220

APPLICATION FOR AUTHORITY TO INJECT

To Whom it May Concern,

NOTICE IS HEREBY GIVEN; That Anthem Water Solutions, LLC, 5914 W. Courtyard Dr., Suite 320, Austin Texas, 78730, is requesting that the New Mexico Oil Conservation Division administratively approve the APPLICATION FOR AUTHORITY TO INJECT as follow:

PURPOSE: The intended purpose of the injection well is to dispose of salt water produced from permitted oil and gas wells.

WELL NAME AND LOCATION: Whitetail Federal SWD 1 Located 13 miles southeast of Artesia. NE1/4 of the SW1/4 Section 3, Township 19S, Range 27E, 1980' from South Line & 1980' from West Line, Eddy County, New Mexico.

NAME AND DEPTH OF DISPOSAL ZONE: Devonian-Silurian (10550' – 11063')

EXPECTED MAXIMUM INJECTION RATE: 30,000 barrels/day

EXPECTED MAXIMUM INJECTION PRESSURE: 2110 psi (surface)

Objections or requests for hearing must be filed with the New Mexico Oil Conservation Division within fifteen (15) days. Any objections or requests for hearing should be mailed to the Oil Conservation Division, 1220 South St. Francis Dr., Santa Fe, New Mexico 87505.

Additional information may be obtained by contacting Marshall Tippen (972) 795-4201.

Regards,

A handwritten signature in black ink, appearing to read 'Marshall Tippen', written in a cursive style.

Marshall Tippen



Marshall Tippen
Anthem Water Solutions, LLC
3300 North A Street, Building 2, Suite 222
Midland, Texas 79705

New Mexico State Land Office
310 Old Santa Fe Trail
Santa Fe, NM 87501

APPLICATION FOR AUTHORITY TO INJECT

To Whom it May Concern,

NOTICE IS HEREBY GIVEN; That Anthem Water Solutions, LLC, 5914 W. Courtyard Dr., Suite 320, Austin Texas, 78730, is requesting that the New Mexico Oil Conservation Division administratively approve the APPLICATION FOR AUTHORITY TO INJECT as follow:

PURPOSE: The intended purpose of the injection well is to dispose of salt water produced from permitted oil and gas wells.

WELL NAME AND LOCATION: Whitetail Federal SWD 1 Located 13 miles southeast of Artesia. NE1/4 of the SW1/4 Section 3, Township 19S, Range 27E, 1980' from South Line & 1980' from West Line, Eddy County, New Mexico.

NAME AND DEPTH OF DISPOSAL ZONE: Devonian-Silurian (10550' – 11063')

EXPECTED MAXIMUM INJECTION RATE: 30,000 barrels/day

EXPECTED MAXIMUM INJECTION PRESSURE: 2110 psi (surface)

Objections or requests for hearing must be filed with the New Mexico Oil Conservation Division within fifteen (15) days. Any objections or requests for hearing should be mailed to the Oil Conservation Division, 1220 South St. Francis Dr., Santa Fe, New Mexico 87505.

Additional information may be obtained by contacting Marshall Tippen (972) 795-4201.

Regards,

A handwritten signature in black ink, appearing to read 'Marshall Tippen', written in a cursive style.

Marshall Tippen



Marshall Tippen
Anthem Water Solutions, LLC
3300 North A Street, Building 2, Suite 222
Midland, Texas 79705

NM OCD District 2
811 S. First St.
Artesia, NM 88210

APPLICATION FOR AUTHORITY TO INJECT

To Whom it May Concern,

NOTICE IS HEREBY GIVEN; That Anthem Water Solutions, LLC, 5914 W. Courtyard Dr., Suite 320, Austin Texas, 78730, is requesting that the New Mexico Oil Conservation Division administratively approve the APPLICATION FOR AUTHORITY TO INJECT as follow:

PURPOSE: The intended purpose of the injection well is to dispose of salt water produced from permitted oil and gas wells.

WELL NAME AND LOCATION: Whitetail Federal SWD 1 Located 13 miles southeast of Artesia. NE1/4 of the SW1/4 Section 3, Township 19S, Range 27E, 1980' from South Line & 1980' from West Line, Eddy County, New Mexico.

NAME AND DEPTH OF DISPOSAL ZONE: Devonian-Silurian (10550' – 11063')

EXPECTED MAXIMUM INJECTION RATE: 30,000 barrels/day

EXPECTED MAXIMUM INJECTION PRESSURE: 2110 psi (surface)

Objections or requests for hearing must be filed with the New Mexico Oil Conservation Division within fifteen (15) days. Any objections or requests for hearing should be mailed to the Oil Conservation Division, 1220 South St. Francis Dr., Santa Fe, New Mexico 87505.

Additional information may be obtained by contacting Marshall Tippen (972) 795-4201.

Regards,

A handwritten signature in black ink, appearing to read 'Marshall Tippen', is written over a light blue horizontal line.

Marshall Tippen



Marshall Tippen
Anthem Water Solutions, LLC
3300 North A Street, Building 2, Suite 222
Midland, Texas 79705

EOG Resources
5509 Champions Dr
Midland, TX 79706

APPLICATION FOR AUTHORITY TO INJECT

To Whom it May Concern,

NOTICE IS HEREBY GIVEN; That Anthem Water Solutions, LLC, 5914 W. Courtyard Dr., Suite 320, Austin Texas, 78730, is requesting that the New Mexico Oil Conservation Division administratively approve the APPLICATION FOR AUTHORITY TO INJECT as follow:

PURPOSE: The intended purpose of the injection well is to dispose of salt water produced from permitted oil and gas wells.

WELL NAME AND LOCATION: Whitetail Federal SWD 1 Located 13 miles southeast of Artesia. NE1/4 of the SW1/4 Section 3, Township 19S, Range 27E, 1980' from South Line & 1980' from West Line, Eddy County, New Mexico.

NAME AND DEPTH OF DISPOSAL ZONE: Devonian-Silurian (10550' – 11063')

EXPECTED MAXIMUM INJECTION RATE: 30,000 barrels/day

EXPECTED MAXIMUM INJECTION PRESSURE: 2110 psi (surface)

Objections or requests for hearing must be filed with the New Mexico Oil Conservation Division within fifteen (15) days. Any objections or requests for hearing should be mailed to the Oil Conservation Division, 1220 South St. Francis Dr., Santa Fe, New Mexico 87505.

Additional information may be obtained by contacting Marshall Tippen (972) 795-4201.

Regards,

A handwritten signature in black ink, appearing to read 'Marshall Tippen', written in a cursive style.

Marshall Tippen

Place label at top of the center of the envelope and fold at dotted line.

Place label at top of the center of the envelope and fold at dotted line.

Jack Ball
Anthem Water Solutions
5914 W. Courtyard Dr., Ste 320
Austin TX 78730-4924

\$4.11⁰
US POSTAGE
FIRST-CLASS
FROM 78730
08/04/2021
stamps
endicia



Place label at top of the center of the envelope and fold at dotted line.

CERTIFIED MAIL®

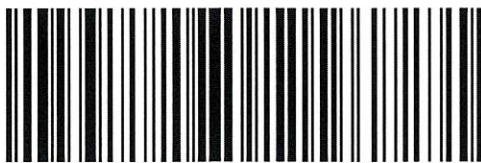

9407 1118 9956 1428 5764 05

EOG Resources Inc
5509 Champions Dr
Midland TX 79706-2843

Jack Ball
Anthem Water Solutions
5914 W. Courtyard Dr., Ste 320
Austin TX 78730-4924

\$4.11⁰
US POSTAGE
FIRST-CLASS
FROM 78730
08/04/2021
stamps
endicia



Place label at top of the center of the envelope and fold at dotted line.

CERTIFIED MAIL®

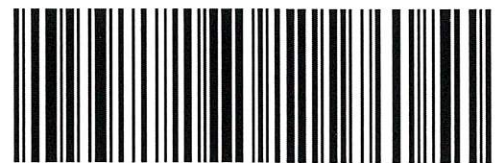

9407 1118 9956 1428 5765 59

New Mexico BLM
620 E Greene St.
Carlsbad NM 88220

Certified Mail® Labels

Jack Ball
Anthem Water Solutions
5914 W. Courtyard Dr., Ste 320
Austin TX 78730-4924

\$4.110
US POSTAGE
FIRST-CLASS
FROM 78730
08/04/2021
stamps
endicia



Top of the page

Print postage using Stamps.com Template SDC-3610

Jack Ball
Anthem Water Solutions
5914 W. Courtyard Dr., Ste 320
Austin TX 78730-4924

\$4.110
US POSTAGE
FIRST-CLASS
FROM 78730
08/04/2021
stamps
endicia



Place label at top of the center of the envelope and fold at dotted line.

CERTIFIED MAIL®

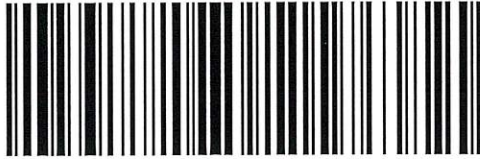

9407 1118 9956 1428 5765 73

New Mexico State Land Office
310 Old Santa Fe Trail
Santa Fe NM 87501-2708

Place label at top of the center of the envelope and fold at dotted line.

CERTIFIED MAIL®

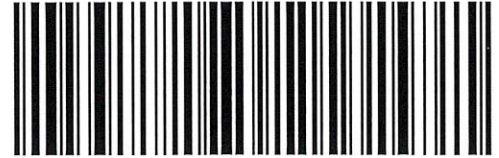

9407 1118 9956 1428 5712 95

NMOCD District 2
811 S. First St
Artesia NM 88210

Place label at top of the center of the envelope and fold at dotted line.

CERTIFIED MAIL®

Place label at top of the center of the envelope and fold at dotted line.

CERTIFIED MAIL®