

# Initial Application Part I

Received 8/6/21

*This application is placed in file for record. It MAY or MAY NOT have been reviewed to be determined Administratively Complete*

RECEIVED: <b>8/6/21</b>	REVIEWER:	TYPE: <b>SWD</b>	APP NO: <b>pBL2121848212</b>
-------------------------	-----------	------------------	------------------------------

ABOVE THIS TABLE FOR OCD DIVISION USE ONLY

**NEW MEXICO OIL CONSERVATION DIVISION**  
 - Geological & Engineering Bureau -  
 1220 South St. Francis Drive, Santa Fe, NM 87505

**ADMINISTRATIVE APPLICATION CHECKLIST**

THIS CHECKLIST IS MANDATORY FOR ALL ADMINISTRATIVE APPLICATIONS FOR EXCEPTIONS TO DIVISION RULES AND  
 REGULATIONS WHICH REQUIRE PROCESSING AT THE DIVISION LEVEL IN SANTA FE

**Applicant:** Anthem Water Solutions, LLC **OGRID Number:** 330069  
**Well Name:** Dall Sheep 262025 Federal SWD 1 **API:** 30-015-27997  
**Pool:** SWD; Devonian-Silurian **Pool Code:** 97869

**SUBMIT ACCURATE AND COMPLETE INFORMATION REQUIRED TO PROCESS THE TYPE OF APPLICATION  
 INDICATED BELOW**

**1) TYPE OF APPLICATION:** Check those which apply for [A]

A. Location – Spacing Unit – Simultaneous Dedication

☐ NSL☐ NSP (PROJECT AREA)☐ NSP (PRORATION UNIT)☐ SD**SWD-2451**

B. Check one only for [ I ] or [ II ]

[ I ] Commingling – Storage – Measurement

☐ DHC☐ CTB☐ PLC☐ PC☐ OLS☐ OLM

[ II ] Injection – Disposal – Pressure Increase – Enhanced Oil Recovery

☐ WFX☐ PMX☒ SWD☐ IPI☐ EOR☐ PPR**2) NOTIFICATION REQUIRED TO:** Check those which apply.A. ☒ Offset operators or lease holdersB. ☐ Royalty, overriding royalty owners, revenue ownersC. ☒ Application requires published noticeD. ☒ Notification and/or concurrent approval by SLOE. ☒ Notification and/or concurrent approval by BLMF. ☒ Surface ownerG. ☒ For all of the above, proof of notification or publication is attached, and/or,H. ☐ No notice required**FOR OCD ONLY**☐

Notice Complete

☐Application  
Content  
Complete

- 3) CERTIFICATION:** I hereby certify that the information submitted with this application for administrative approval is **accurate** and **complete** to the best of my knowledge. I also understand that **no action** will be taken on this application until the required information and notifications are submitted to the Division.

**Note: Statement must be completed by an individual with managerial and/or supervisory capacity.**

**Marshall Tippen**

Print or Type Name

Signature

8/4/2021

Date

(972) 795-4201

Phone Number

mtippen@anthemwsllc.com

e-mail Address



8/4/2021

New Mexico Oil Conservation Division  
1220 South St. Francis Drive  
Santa Fe, New Mexico, 87505

Re: Application of Anthem Water Solutions, LLC to drill and permit the saltwater disposal well Dall Sheep 262025 Federal SWD 1 located in Unit F, Section 26, Township 20 South, Range 25 East, NMPM, Eddy County, New Mexico.

To Whom it May Concern:

Please find the enclosed C-108 Application for Authority to Inject, supporting the above-referenced request for saltwater disposal. The well will be operated as a commercial endeavor offering operations in the area additional options for produced water disposal. Please find the enclosed C-108 Application for Authority to Inject along with supporting documents.

I would like to point out that this application is to re-open and re-complete an existing plugged and abandoned well 30-015-27997, which was drilled by Mewbourne Oil Company in July of 1994 to a total depth of 10,031 feet. The surface and intermediate casing were cemented to the surface, and this well was properly plugged and abandoned by Mewbourne Oil Company in August of 1994. In addition to all information required for a completed Form C-108 a copy of the Sundry Notice plugging report C-103 is included with this application package. This well is located on Federal land and Federal minerals; a copy of the application has been sent to the appropriate regulatory bodies.

I respectfully request that the approval of this saltwater disposal well proceed swiftly and if your staff requires additional information or has any questions, please do not hesitate to call or email me.

Sincerely,

A handwritten signature in black ink, appearing to read "Marshall Tippen".

Marshall Tippen

Anthem Water Solutions

[mtippen@anthemwsllc.com](mailto:mtippen@anthemwsllc.com) | (972) 795-4201

**APPLICATION FOR AUTHORIZATION TO INJECT**

- I. PURPOSE: \_\_\_\_\_ Secondary Recovery \_\_\_\_\_ Pressure Maintenance   X   Disposal \_\_\_\_\_ Storage  
Application qualifies for administrative approval?   X   Yes \_\_\_\_\_ No
- II. OPERATOR:   Anthem Water Solutions, LLC    
ADDRESS:   5914 W. Courtyard Drive, Suite 320, Austin TX 78730    
CONTACT PARTY:   Marshall Tippen   PHONE:   (979) 795-4201
- III. WELL DATA: Complete the data required on the reverse side of this form for each well proposed for injection.  
Additional sheets may be attached if necessary.
- IV. Is this an expansion of an existing project? \_\_\_\_\_ Yes   X   No  
If yes, give the Division order number authorizing the project: \_\_\_\_\_
- V. Attach a map that identifies all wells and leases within two miles of any proposed injection well with a one-half mile radius circle drawn around each proposed injection well. This circle identifies the well's area of review.
- VI. Attach a tabulation of data on all wells of public record within the area of review which penetrate the proposed injection zone. Such data shall include a description of each well's type, construction, date drilled, location, depth, record of completion, and a schematic of any plugged well illustrating all plugging detail.
- VII. Attach data on the proposed operation, including:
1. Proposed average and maximum daily rate and volume of fluids to be injected;
  2. Whether the system is open or closed;
  3. Proposed average and maximum injection pressure;
  4. Sources and an appropriate analysis of injection fluid and compatibility with the receiving formation if other than reinjected produced water; and,
  5. If injection is for disposal purposes into a zone not productive of oil or gas at or within one mile of the proposed well, attach a chemical analysis of the disposal zone formation water (may be measured or inferred from existing literature, studies, nearby wells, etc.).
- \*VIII. Attach appropriate geologic data on the injection zone including appropriate lithologic detail, geologic name, thickness, and depth. Give the geologic name, and depth to bottom of all underground sources of drinking water (aquifers containing waters with total dissolved solids concentrations of 10,000 mg/l or less) overlying the proposed injection zone as well as any such sources known to be immediately underlying the injection interval.
- IX. Describe the proposed stimulation program, if any.
- \*X. Attach appropriate logging and test data on the well. (If well logs have been filed with the Division, they need not be resubmitted).
- \*XI. Attach a chemical analysis of fresh water from two or more fresh water wells (if available and producing) within one mile of any injection or disposal well showing location of wells and dates samples were taken.
- XII. Applicants for disposal wells must make an affirmative statement that they have examined available geologic and engineering data and find no evidence of open faults or any other hydrologic connection between the disposal zone and any underground sources of drinking water.
- XIII. Applicants must complete the "Proof of Notice" section on the reverse side of this form.
- XIV. Certification: I hereby certify that the information submitted with this application is true and correct to the best of my knowledge and belief.
- NAME:   Marshall Tippen   TITLE:   Director of Engineering    
SIGNATURE:      DATE:   8/4/2021    
E-MAIL ADDRESS:   mtippen@anthemwsllc.com
- \* If the information required under Sections VI, VIII, X, and XI above has been previously submitted, it need not be resubmitted. Please show the date and circumstances of the earlier submittal: \_\_\_\_\_



### III. WELL DATA

A. The following well data must be submitted for each injection well covered by this application. The data must be both in tabular and schematic form and shall include:

- (1) Lease name; Well No.; Location by Section, Township and Range; and footage location within the section.
- (2) Each casing string used with its size, setting depth, sacks of cement used, hole size, top of cement, and how such top was determined.
- (3) A description of the tubing to be used including its size, lining material, and setting depth.
- (4) The name, model, and setting depth of the packer used or a description of any other seal system or assembly used.

Division District Offices have supplies of Well Data Sheets which may be used or which may be used as models for this purpose. Applicants for several identical wells may submit a "typical data sheet" rather than submitting the data for each well.

B. The following must be submitted for each injection well covered by this application. All items must be addressed for the initial well. Responses for additional wells need be shown only when different. Information shown on schematics need not be repeated.

- (1) The name of the injection formation and, if applicable, the field or pool name.
- (2) The injection interval and whether it is perforated or open-hole.
- (3) State if the well was drilled for injection or, if not, the original purpose of the well.
- (4) Give the depths of any other perforated intervals and detail on the sacks of cement or bridge plugs used to seal off such perforations.
- (5) Give the depth to and the name of the next higher and next lower oil or gas zone in the area of the well, if any.

### XIV. PROOF OF NOTICE

All applicants must furnish proof that a copy of the application has been furnished, by certified or registered mail, to the owner of the surface of the land on which the well is to be located and to each leasehold operator within one-half mile of the well location.

Where an application is subject to administrative approval, a proof of publication must be submitted. Such proof shall consist of a copy of the legal advertisement which was published in the county in which the well is located. The contents of such advertisement must include:

- (1) The name, address, phone number, and contact party for the applicant;
- (2) The intended purpose of the injection well; with the exact location of single wells or the Section, Township, and Range location of multiple wells;
- (3) The formation name and depth with expected maximum injection rates and pressures; and,
- (4) A notation that interested parties must file objections or requests for hearing with the Oil Conservation Division, 1220 South St. Francis Dr., Santa Fe, New Mexico 87505, within 15 days.

NO ACTION WILL BE TAKEN ON THE APPLICATION UNTIL PROPER PROOF OF NOTICE HAS BEEN SUBMITTED.

---

NOTICE: Surface owners or offset operators must file any objections or requests for hearing of administrative applications within 15 days from the date this application was mailed to them.

## Item III – Subject Well Data (Attachment 1)

### A. Well Data

#### 1) General Well Data

Operator: Anthem Water Solutions, LLC

Lease Name and Well Number: Dall Sheep 262025 Federal SWD 1

Location Footage Calls: 1650' from FNL, 1650' from FWL

Legal Location: Unit F, Section 26, Township 20 South, Range 25 East, NMPM

Ground Elevation: 3591 feet

Proposed Injection Interval: 10762 - 11122 (open hole)

County: Eddy

#### 2) - 3) Casing , Tubing & Cement Information

Casing / Tubing / Cement					
Type	Surface (1)	Intermediate (2)	Intermediate (3)	Open Hole (4)	Tubing (5)
OD	13 3/8"	9 5/8"	7"	5 1/2"	4 1/2"
Weight	#48	#40 & #36	26 lb / ft	N/A	11.6 lb / ft
Grade	Unknown	Unknown	P-110	N/A	N-80 IPC
Hole Size	17 1/2"	12 1/4"	8 3/4"	6 1/8"	N/A
Depth Set	340'	2,496'	10,762'	10,762' - 11,122'	10,712'
TOC	Surface	Surface	Surface*	N/A	N/A
Volume	500 sks	700 sks	1,700 sks	N/A	N/A
DV Tool 1	N/A	N/A	2,836'	N/A	N/A
DV Tool 2	N/A	N/A	5,403'	N/A	N/A
*Verified by Cement Bond Log					

*\*Current and Proposed Wellbore Diagrams Attached*

#### 4) Packer Information:

Arrowset AS1-X or equivalent packer set at approximately 10712 feet

*\*Packer Schematic Attached*

## **B. Completion Information**

- 1) **Injection Formation Name:** Devonian-Silurian  
**Pool Name:** SWD; Devonian-Silurian  
**Pool Code:** 97869
- 2) **Injection Interval:** 10762 - 11122 (open hole)
- 3) **Drilling Purpose:** Drilled for injection
- 4) **Overlying Oil and Gas Zones:** Below are approximate tops for known oil and gas producing zones in the area.
  - Bone Spring: 2937'
  - Strawn: 8756'
  - Atoka: 9275'
  - Morrow: 9647'
- 5) **Underlying Oil and Gas Zones:** No underlying oil and gas zones exist.

## **Item V – Well and Lease Maps (Attachment 2)**

- 1) 2-mile oil & Gas Well Map
- 2) 1-mile Well Detail List
- 3) 2-Mile Lease Map
- 4) 2-Mile Mineral Ownership Map
- 5) 2-Mile Surface Ownership map
- 6) 1.5-Mile Deep SWD Map (Devonian-Silurian)
- 7) Potash Lease Map

## **Item VI – AOR Well List (Attachment 2)**

There have been 7 wells drilled within the 1-mile AOR including the subject well. None of these wells nor any new or permitted wells penetrate the injection zone.

## **Item VII – Proposed Operation (Attachment 3)**

- 1) **Proposed Maximum Injection Rate:** 30,000 bwpd  
**Proposed Average Injection Rate:** 15,000 bwpd
- 2) A closed system will be used.
- 3) **Proposed Maximum Injection Pressure:** 2152 psi (surface)
- 4) **Proposed Average Injection Pressure:** 1291 psi (surface)

- 5) **Source Water Analysis:** It is expected that the injected fluid will consist of water produced from the Wolfcamp and Bone Springs formations. Water samples from these formations are included in Attachment 3.
- 6) **Injection Formation Water Analysis:** The proposed SWD will be injecting water into the Devonian-Silurian formation which is a non-productive zone known to be compatible with formation water from the Wolfcamp and Bone Springs formations. Water analyses from the Devonian-Silurian formation in the area are included in attachment 3.

## **Item VIII – Geologic Description**

The proposed injection interval includes the Devonian–Silurian formation from 10762 feet to 11122 feet. This formation consists of interbedded carbonate rocks consisting of dolomites and limestones with some interbedded siltstones and shales. Several thick sections of porous and permeable intervals capable of taking water are present within the subject formations in the area.

The base of the lowermost Underground Source of Drinking Water (USDW) is at a depth of approximately 1,026 feet. The USDW is covered by 9 5/8 inch casing set at 2,496 feet and cemented to surface and proposed 7" casing set to 10,762 feet and cemented to surface.

## **Item IX – Proposed Stimulation**

A small cleanup acid job may be used to remove mud and drill cutting from the formation. However, no other formation stimulation is currently planned.

## **Item X – Logging and Test Data**

Log data will be submitted to the OCD upon completion of this well.

## **Item XI – Fresh Groundwater Samples (Attachment 4)**

Based on a review of the data from the New Mexico Office of State Engineer there are no fresh water wells within a 1-mile radius of the proposed location. As a result, no groundwater samples were obtained.

## **XII – No Hydrologic Connection Statement (Attachment 5)**

Anthem has examined available geologic and engineering data, and has found no evidence of faulting present in the area that would provide a hydrologic connection between the injection interval and overlying USDWs. Additionally, the casing and cementing program has been designed to further insure there will be no hydrologic connection between the injection interval and overlying USDWs. A letter from a knowledgeable and qualified expert stating that there is a low risk of seismic activity from the proposed injection activities is included in Attachment 5.

## **XIII – Proof of Notice (Attachment 6)**

A Public Notice was filed with Carlsbad Current-Argus and an affidavit is included in Attachment 6.

A copy of the application was mailed to the OCD District Office, landowners, appropriate regulatory bodies, and leasehold operators within a 1-mile radius of the proposed SWD location. A list of recipients, as well as delivery confirmations, is included in Attachment 6.

## **Attachments Table of Content:**

### **Attachment 1:**

C-102

Existing Wellbore Diagram

Proposed Wellbore Diagram

Packer Schematic

C-103

### **Attachment 2:**

2-mile Oil & Gas Well Map

1-mile Well Detail List

2-Mile Lease Map

2-Mile Mineral Ownership Map

2-Mile Surface Ownership map

1.5-Mile Deep SWD Map (Devonian-Silurian)

Potash Lease Map

### **Attachment 3:**

Source Water Analysis

Formation Water Analysis

### **Attachment 4:**

1-Mile Fresh Ground Water Map

Fresh Ground Water Samples

### **Attachment 5:**

Letter of Seismic Activity

### **Attachment 6:**

Public Notice Affidavit

List of Notification Applicants & Delivery Confirmations

Submit to Appropriate  
District Office  
State Lease - 4 copies  
Fee Lease - 3 copies

State of New Mexico  
Energy, Minerals and Natural Resources Department

Form C-102  
Revised 1-1-89

**OIL CONSERVATION DIVISION**

P.O. Box 2088  
Santa Fe, New Mexico 87504-2088

**DISTRICT I**  
P.O. Box 1980, Hobbs, NM 88240

**DISTRICT II**  
P.O. Drawer DD, Artesia, NM 88210

**DISTRICT III**  
1000 Rio Brazos Rd., Aztec, NM 87410

**WELL LOCATION AND ACREAGE DEDICATION PLAT**

All Distances must be from the outer boundaries of the section

Operator <b>MEWBOURNE OIL COMPANY</b>			Lease <b>BUBBLING SPRINGS 26 FEDERAL</b>		com. <b>1</b>	Well No. <b>1</b>
Unit Letter <b>F</b>	Section <b>26</b>	Township <b>20 SOUTH</b>	Range <b>25 EAST</b>	County <b>NMPM</b>		<b>EDDY</b>
Actual Footage Location of Well: <b>1650</b> feet from the <b>NORTH</b> line and <b>1650</b> feet from the <b>WEST</b> line						
Ground level Elev. <b>3591</b>	Producing Formation <b>Morrow</b>		Pool <b>West Bubbling Springs Morrow</b>		Dedicated Acreage: <b>320</b> Acres	

- Outline the acreage dedicated to the subject well by colored pencil or hatchure marks on the plat below.
- If more than one lease is dedicated to the well, outline each and identify the ownership thereof (both as to working interest and royalty).
- If more than one lease of different ownership is dedicated to the well, have the interest of all owners been consolidated by communitization, unitization, force-pooling, etc.?
 

☒ Yes ☐ No If answer is "yes" type of consolidation **communitization**

If answer is "no" list the owners and tract descriptions which have actually been consolidated. (Use reverse side of this form if necessary.)

No allowable will be assigned to the well until all interests have been consolidated (by communitization, unitization, forced-pooling, or otherwise) or until a non-standard unit, eliminating such interest, has been approved by the Division.

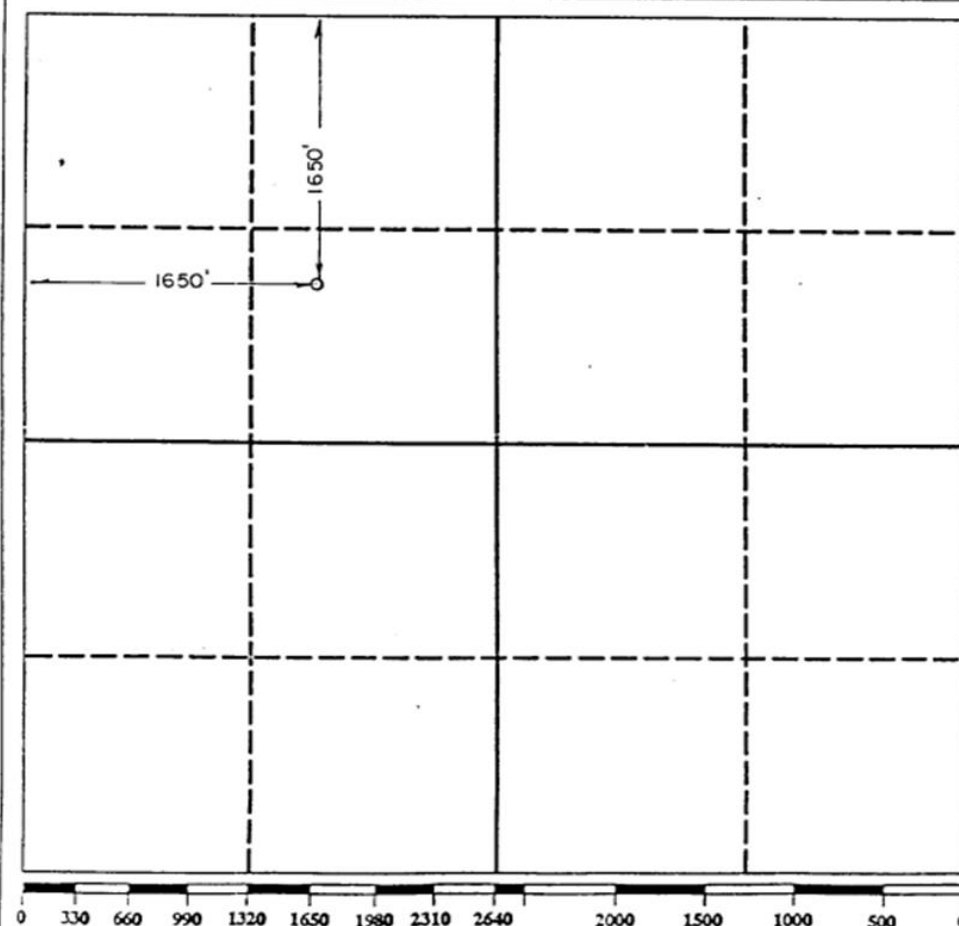

**OPERATOR CERTIFICATION**

I hereby certify that the information contained herein is true and complete to the best of my knowledge and belief.

Signature *Bill Pierce*  
Printed Name **Bill Pierce**  
Position **Drilling Superintendent**  
Company **Mewbourne Oil Company**  
Date **March 16, 1994**

**SURVEYOR CERTIFICATION**

I hereby certify that the well location shown on this plat was plotted from field notes of actual surveys made by me or under my supervision, and that the same is true and correct to the best of my knowledge and belief.

Date Surveyed **7/20/93**  
Signature & Seal of Professional Surveyor

Certification No. **3640**  
Professional Surveyor

Attachment 1: Existing Wellbore Diagram

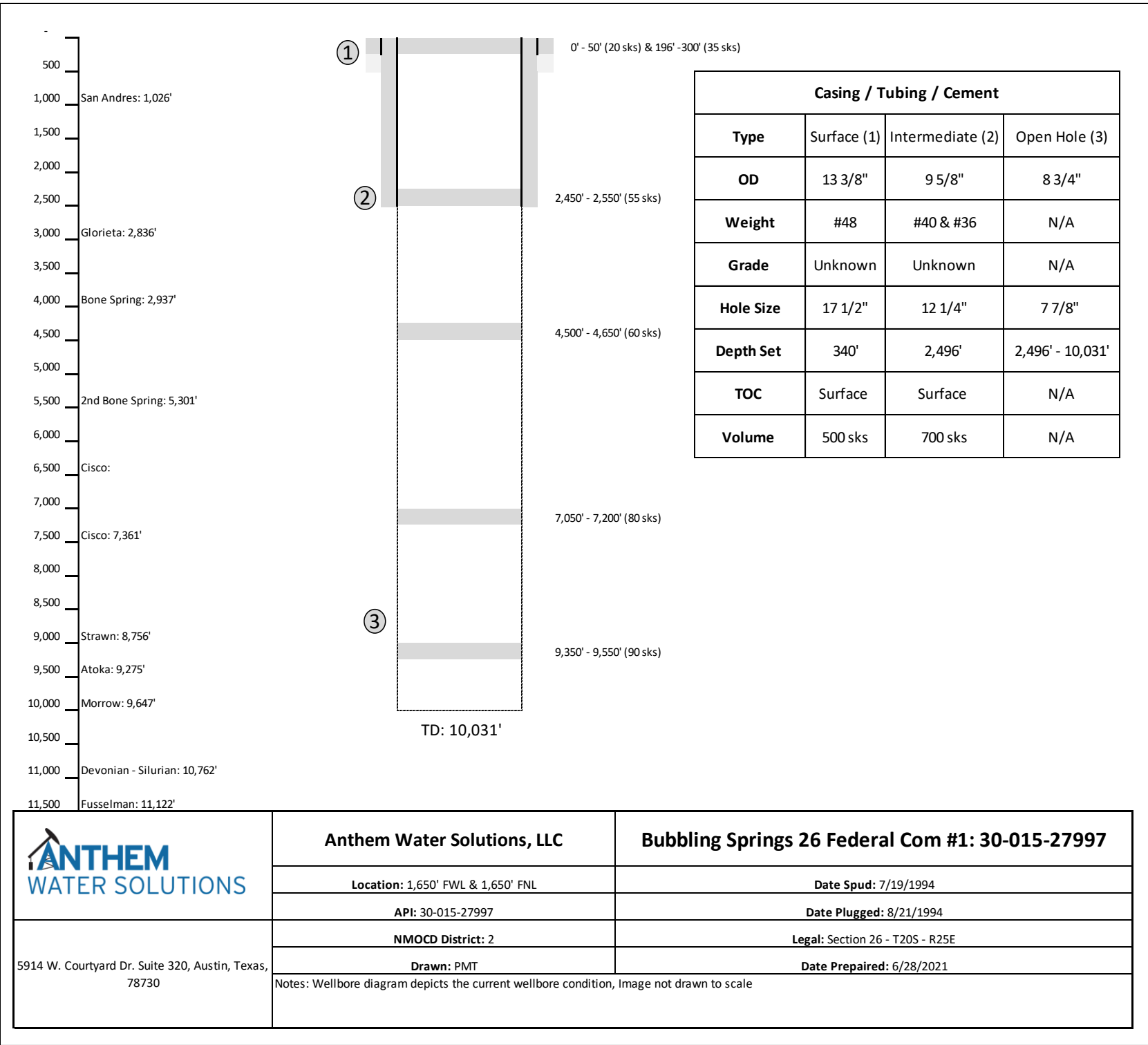



# Attachment 1: Proposed Wellbore Diagram

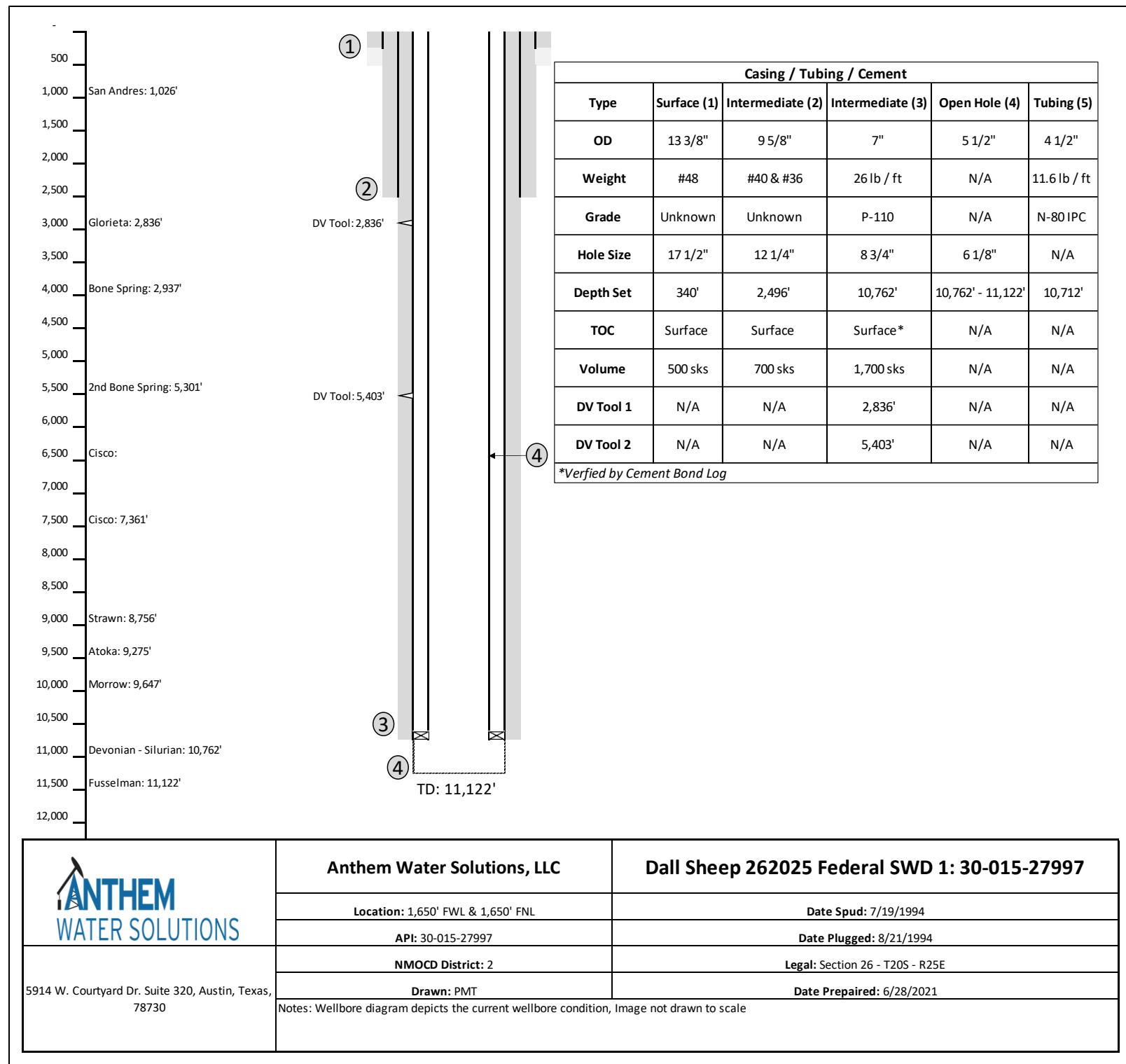

## Attachment 1: Packer Schematic

# AS1-X MECHANICAL PACKER



The ACT AS1-X Packer is the most versatile of the mechanically set retrievable packers and may be used in any production application. Treating, testing, injecting, pumping wells, flowing wells, deep or shallow, the AS1-X is suited for all. The packer can be left in tension or compression, depending on well conditions and the required application. A large internal by-pass reduces swabbing when running and retrieving. The by-pass closes when the packer is set and opens prior to releasing the upper slips when retrieving to allow pressure equalization.

The J-slot design allows easy setting and releasing: 1/4 turn right-hand set, right-hand release. A patented upper-slip releasing system reduces the force required to release the packer. A non directional slip is released first, making it easier to release the other slips. The AS1-X packer can withstand 7,000 psi (48 MPa) of differential pressure above or below.

### FEATURES, ADVANTAGES AND BENEFITS:

- The design holds high differential pressure from above or below, enabling the packer to meet most production, stimulation, and injection needs
  - The packer can be set with compression, tension, or wire line, enabling deployment in shallow and deep applications
  - The packer can be set and released with only a one-quarter turn of the tubing
  - The bypass valve is below the upper slips so that debris are washed from the slips when the valve is opened, reducing the times for circulation and total retrieval
- 
- The full opening enables unrestricted flow and the passage of wire line tools and other packer systems
  - The packer can be run with the T-2 on-off tool, which enables the tubing to be disconnected and retrieved without retrieving the packer
- OPTIONS:**
- Elastomer options are available for hostile environments
  - Optional safety releases are available

Form 3160-5  
(June 1990)RECEIVED  
AUG 20 11 11 AMUNITED STATES  
DEPARTMENT OF THE INTERIOR  
BUREAU OF LAND MANAGEMENTNM OIL COMMISSION  
Drawer DD  
Artesia, NM 88210FORM APPROVED  
Budget Bureau No. 1004-0135  
Expires: March 31, 19935. Lease Designation and Serial No.  
NM-88098

6. If Indian, Allottee or Tribe Name

7. If Unit or CA, Agreement Designation

8. Well Name and No.  
Bubbling Springs "26"  
Federal #19. API Well No.  
30-015-2799710. Field and Pool, or Exploratory Area  
West Bubbling Springs  
Morrow

11. County or Parish, State

Eddy County, N.M.

SUNDRY NOTICES AND REPORTS ON WELLS  
Do not use this form for proposals to drill or to deepen or reentry to a different reservoir.  
Use "APPLICATION FOR PERMIT—" for such proposals

SUBMIT IN TRIPLICATE

RECEIVED

1. Type of Well

☐ Oil Well ☒ Gas Well ☐ Other

2. Name of Operator

Mewbourne Oil Company

3. Address and Telephone No.

P.O. Box 5270 Hobbs, New Mexico 88241 (505) 393-5900

4. Location of Well (Footage, Sec., T., R., M., or Survey Description)

1650' FWL & 1650' FNL  
Sec. 26-T20S-R25E

OCT 05 '94

O. C. D.

ARTESIA, OFFICE

12. CHECK APPROPRIATE BOX(S) TO INDICATE NATURE OF NOTICE, REPORT, OR OTHER DATA

## TYPE OF SUBMISSION

☐ Notice of Intent☒ Subsequent Report☐ Final Abandonment Notice

## TYPE OF ACTION

☒ Abandonment☐ Recompletion☐ Plugging Back☐ Casing Repair☐ Altering Casing☐ Other☐ Change of Plans☐ New Construction☐ Non-Routine Fracturing☐ Water Shut-Off☐ Conversion to Injection☐ Dispose Water

(Note: Report results of multiple completion on Well Completion or Recompletion Report and Log form.)

13. Describe Proposed or Completed Operations (Clearly state all pertinent details, and give pertinent dates, including estimated date of starting any proposed work. If well is directionally drilled, give subsurface locations and measured and true vertical depths for all markers and zones pertinent to this work.)\*

08/20/94 Drilled 8-3/4" production hole to 10,031' KB. Ran E-logs &amp; evaluated same.

Decided to plug well. Received verbal plugging orders from Adam Salameh with Carlsbad BLM office. Plugged well in following manner:

Spotted Class "H" plug from 9,550'-9,350' (90 sacks)  
Spotted Class "H" plug from 7,200'-7,050' (80 sacks)  
Spotted Class "H" plug from 4,650'-4,500' (60 sacks)  
Spotted Class "H" plug from 2,550'-2,450' (55 sacks)  
Spotted Class "H" plug from 300'-200' (35 sacks)Part FD-2  
11-11-94  
PVA

Waited on plug to set up and tagged @ 196'. Spotted Class "H" plug @ 50'-0' (20 sacks). Cut off wellhead, welded on plate and installed dry hole marker w/proper inscription. Released rig @ 5:00 P.M. 08/21/94.

Approved as to plugging of the well bore.  
Liability under bond is retained until  
surface restoration is completed.

14. I hereby certify that the foregoing is true and correct

Signed Bill PrinceTitle Drilling SuperintendentDate August 25, 1994

(This space for Federal or State office use)

Approved by Orig. Signed by Shannon J. ShawTitle Petroleum EngineerDate 9/30/94

Conditions of approval, if any:

Title 18 U.S.C. Section 1001, makes it a crime for any person knowingly and willfully to make to any department or agency of the United States any false, fictitious or fraudulent statements or representations as to any matter within its jurisdiction.

\*See Instruction on Reverse Side

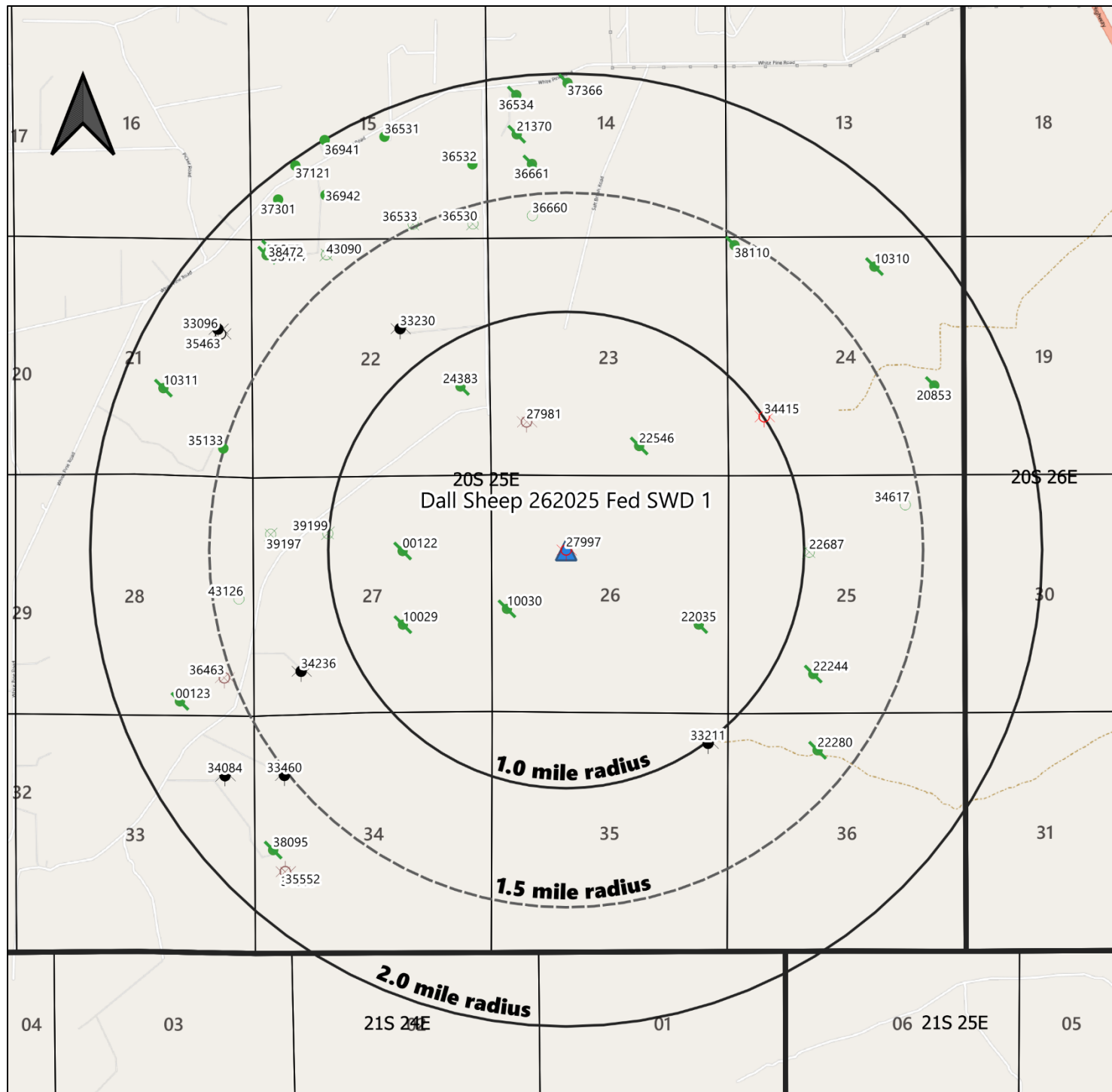

## Legend

- Gas, Active
- ⊗ Gas, Cancelled
- ⊙ Gas, New
- ⊗ Gas, Plugged (site released)
- Oil, Active
- ⊗ Oil, Cancelled
- Oil, New
- Oil, Plugged (not released)
- Oil, Plugged (site released)

Sec 26 T20S R25E  
Eddy County  
New Mexico

**Offset Well Review  
Area of Review**

Dall Sheep 262025 Fed  
SWD 1

## Attachment 2: 1-mile Well Detail List

AOR Tabulation for Dall Sheep 262025 Federal SWD 1 (Top of Injection Interval: 10,762')								
Well Name	API #	Well Type	Well Status	Operator	Spud Date	Location (Sec, Tn, Rg)	TVD	Penetrate Inj Zone
PRE-ONGARD WELL #001	30-015-10029	Oil	Plugged (site released)	PRE-ONGARD WELL OPERATOR	3/29/1963	J-27-20S-25E	10,225	No
PRE-ONGARD WELL #001	30-015-00122	Oil	Plugged (site released)	PRE-ONGARD WELL OPERATOR	12/27/1962	G-27-20S-25E	1,481	No
PRE-ONGARD WELL #001	30-015-24383	Oil	Plugged (site released)	PRE-ONGARD WELL OPERATOR	1/17/1983	I-22-20S-25E	852	No
PRE-ONGARD WELL #001	30-015-10030	Oil	Plugged (site released)	PRE-ONGARD WELL OPERATOR	6/30/1963	L-26-20S-25E	1,715	No
PRE-ONGARD WELL #002	30-015-22546	Oil	Plugged (site released)	PRE-ONGARD WELL OPERATOR	6/3/1978	O-23-20S-25E	10,200	No
PRE-ONGARD WELL #001	30-015-22035	Oil	Plugged (site released)	PRE-ONGARD WELL OPERATOR	3/30/1977	I-26-20S-25E	10,450	No
BUBBLING SPRING 23 FEDERAL #001	30-015-27981	Gas	Cancelled	MEWBORNE OIL CO	N/A	M-23-20S-25E	N/A	No
BUBBLING SPRINGS 26 FEDERAL COM #001	30-015-27997	Gas	Plugged (site released)	MEWBORNE OIL CO	7/19/1994	F-26-20S-25E	10,031	

**Notes:**  
No Wells within a 1-mile radius penetrated the injection interval. Subject well highlighted in green.



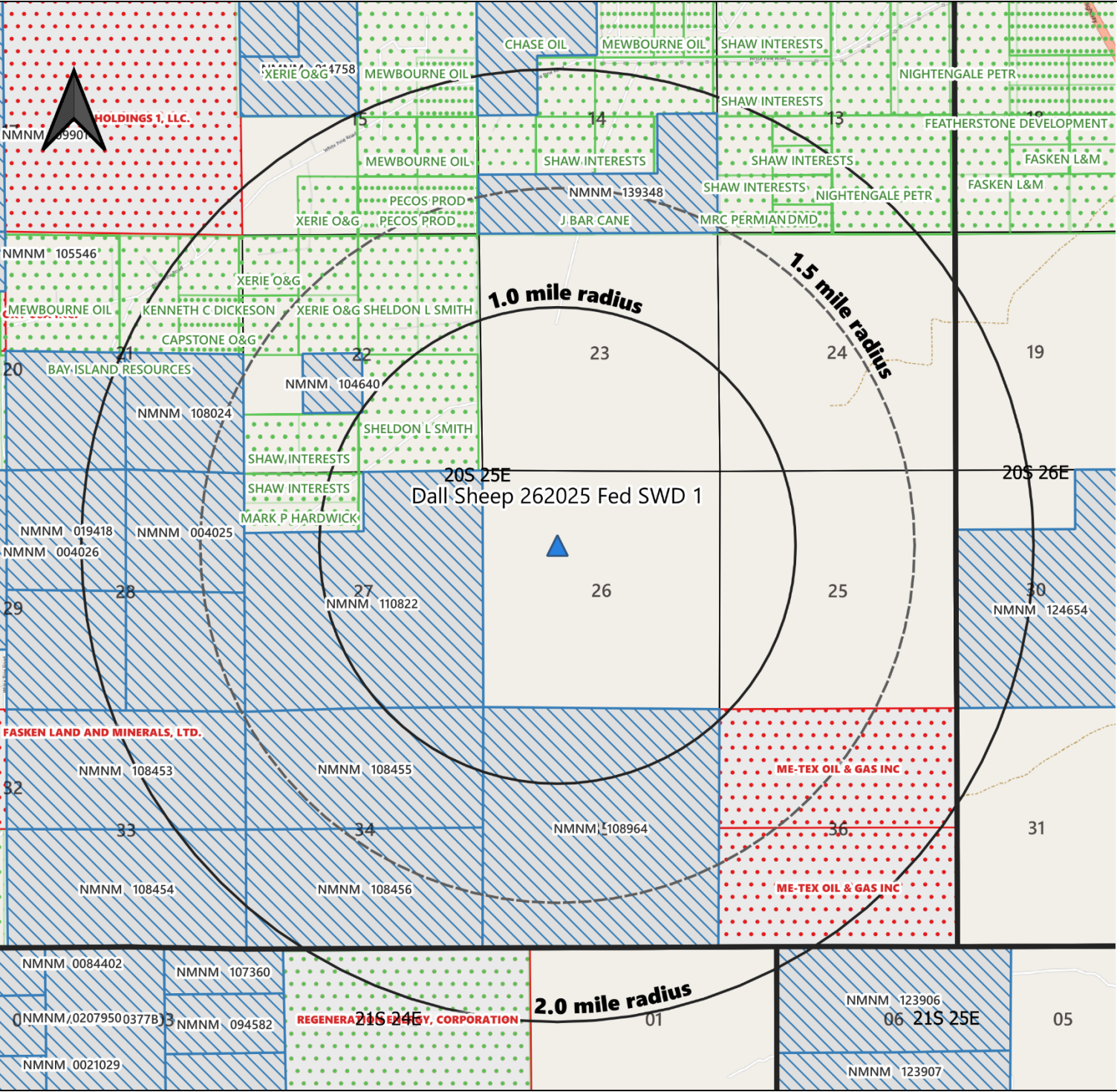

Legend

- State
- Federal
- Fee

Sec 26 T20S R25E  
Eddy County  
New Mexico

**Mineral Lease Map  
Area of Review**

Dall Sheep 262025 Fed  
SWD 1





Attachment 2: Mineral Ownership Map

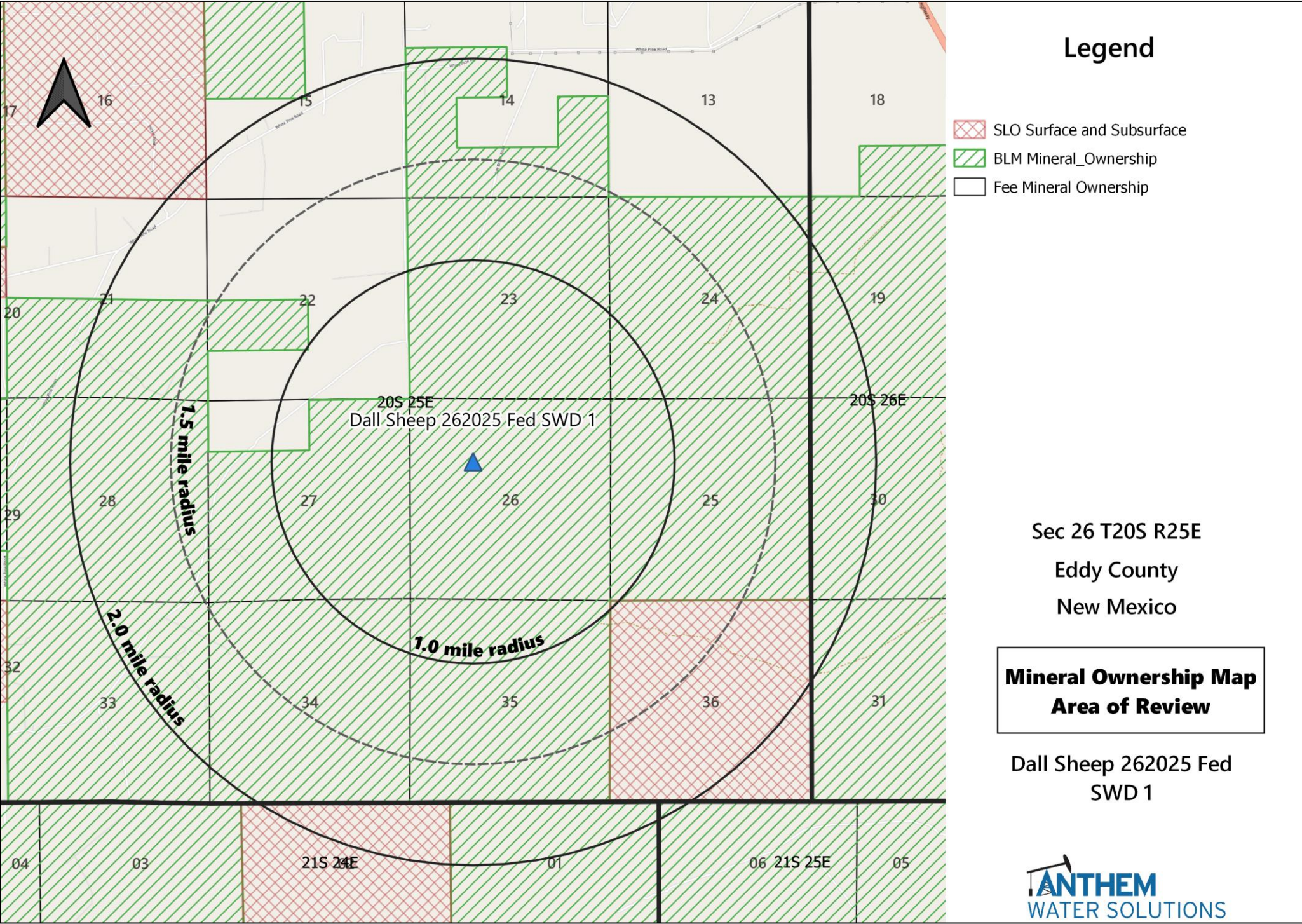

Legend

- SLO Surface and Subsurface
- BLM Mineral\_Ownership
- Fee Mineral Ownership

Sec 26 T20S R25E  
Eddy County  
New Mexico

Mineral Ownership Map  
Area of Review

Dall Sheep 262025 Fed  
SWD 1





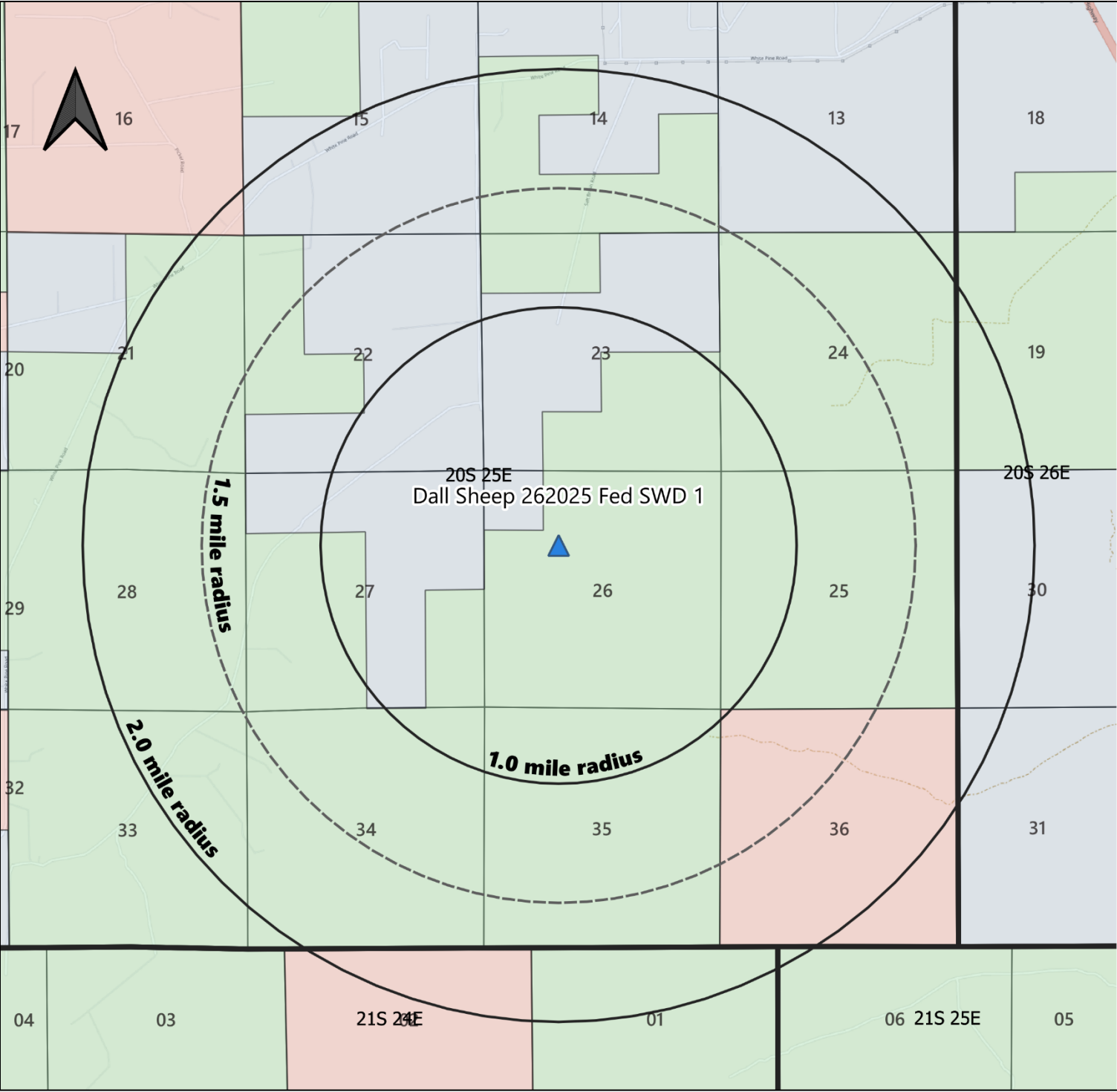

Legend

- Bureau of Land Management
- Private
- State Land Office

Sec 26 T20S R25E  
Eddy County  
New Mexico

**Surface Ownership Map  
Area of Review**

Dall Sheep 262025 Fed  
SWD 1





Attachment 2: 1.5 Mile Deep SWD Map

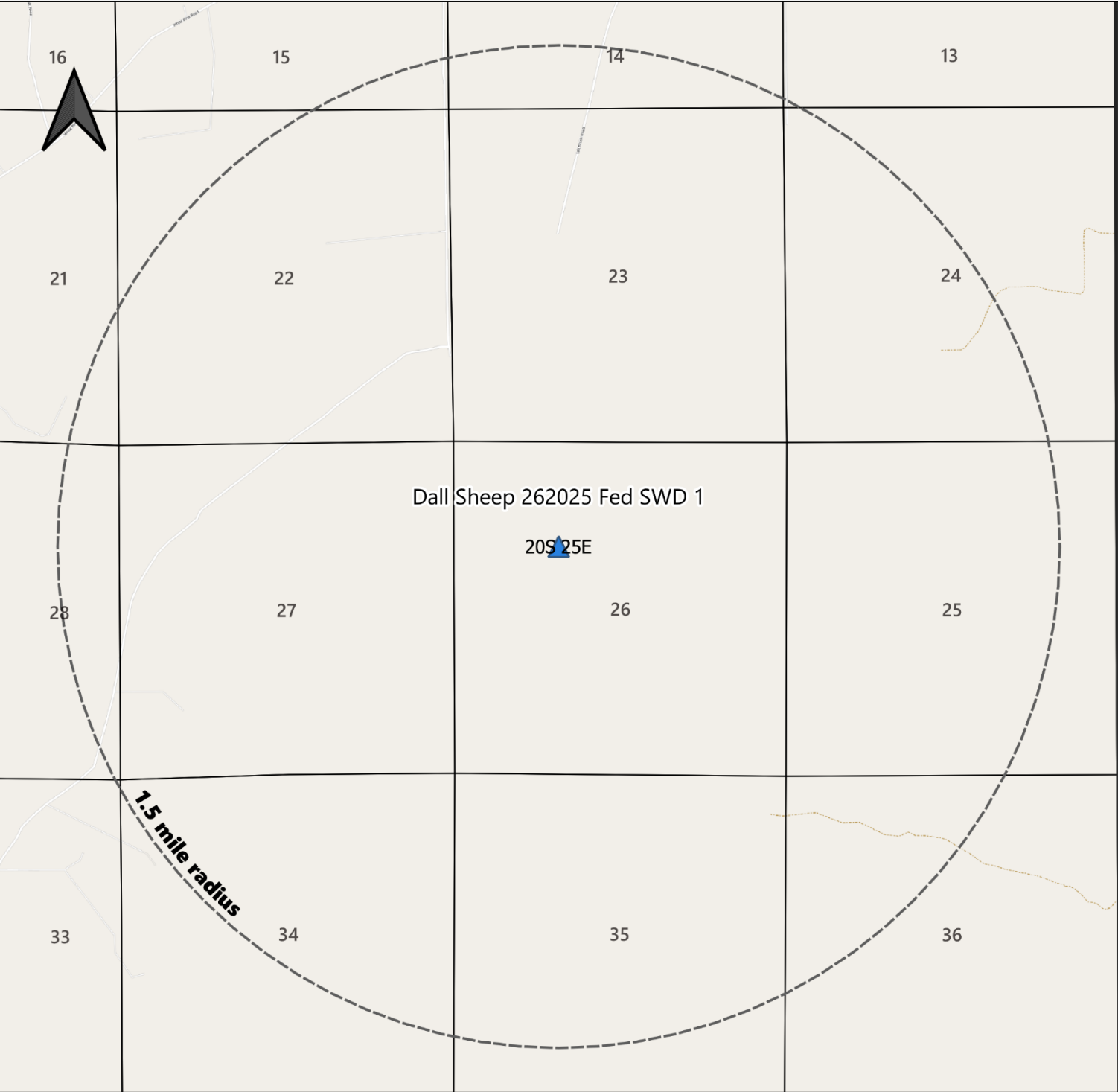

*No active deep injection wells within a 1.5 mile radius of the proposed SWD.*

Sec 26 T20S R25E  
Eddy County  
New Mexico

**Deep SWD Review  
Area of Review**

Dall Sheep 262025 Fed  
SWD 1



Attachment 2: Potash Lease Map

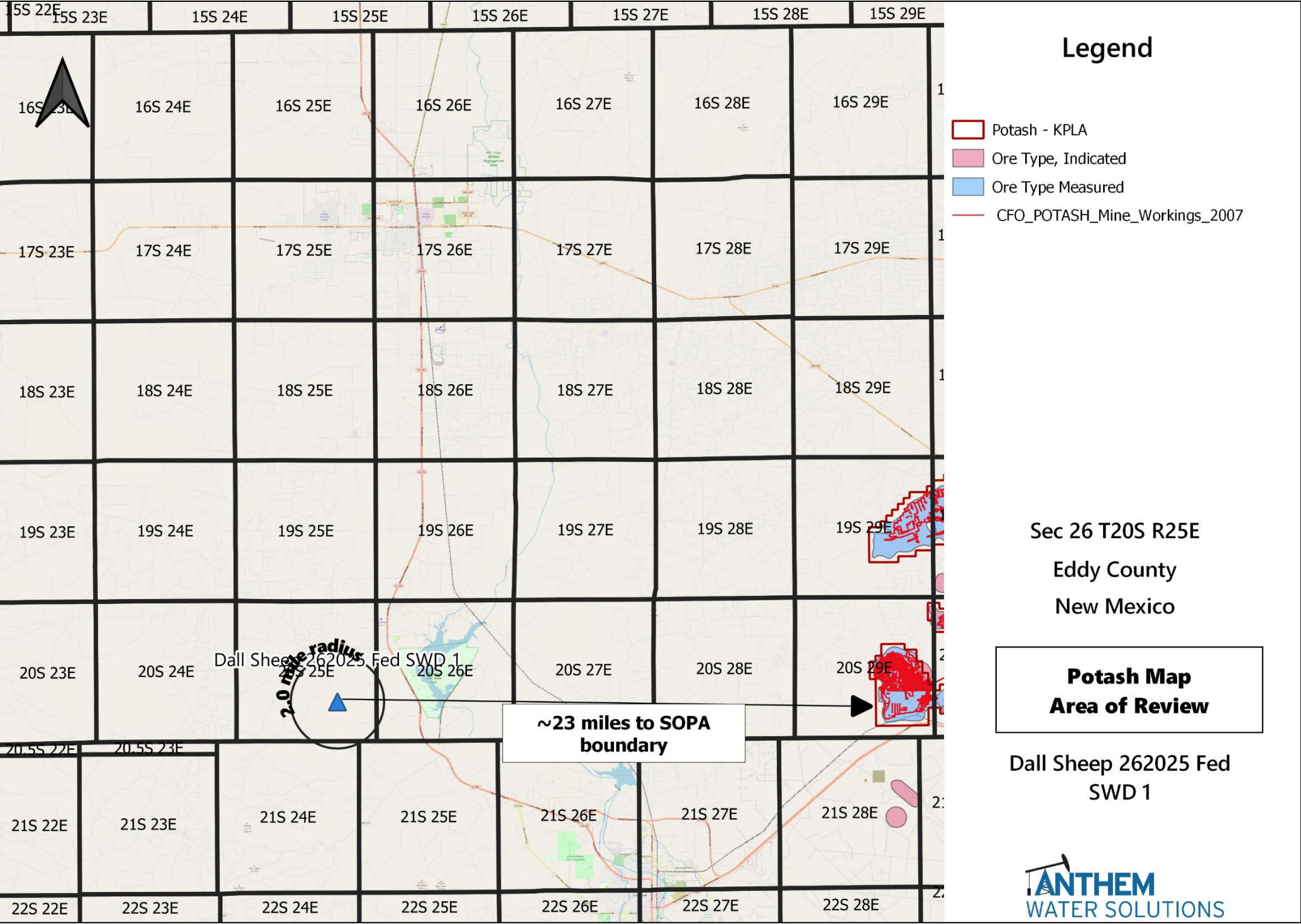

### Attachment 3: Formation & Source Water Analysis

Injection Formation Water Analysis													
Anthem Water Solutions, LLC													
Well Name	API	Latitude	Longitude	Section	Township	Range	County	State	Field	Formation	TDS (Mg/L)	Bicarbonate (MG/L)	Sulfate (Mg/L)
PRE-ONGARD WELL #001	30-015-02416	32.5527229	-104.1623917	22	20S	28E	Eddy	NM		DEVONIAN	39,605	810	1,618
PRE-ONGARD WELL #001	30-015-02475	32.4421539	-104.042305	36	21S	28E	Eddy	NM		DEVONIAN	50,026	762	1,150
PRE-ONGARD WELL #001	30-015-03537	32.6839676	-104.0347595	1	19S	29E	Eddy	NM		DEVONIAN	29,011	520	1,500
WHITE CITY PENN GAS COM UNIT 1 #001	30-015-00408	32.1937523	-104.3088455	29	24S	26E	Eddy	NM	WHITE CITY	DEVONIAN	#N/A	653	1,336
REMUDA BASIN UNIT #001	30-015-03691	32.2886238	-103.9360428	24	23S	29E	Eddy	NM	REMUDA	DEVONIAN	271,010	130	100
BIG EDDY SWD #001	30-015-05819	32.5968154	-103.8504983	3	20S	31E	Eddy	NM	SWD	DEVONIAN	137,989	1,420	1,751
COTTON DRAW UNIT #084	30-015-29728	32.1592751	-103.7438736	2	25S	31E	Eddy	NM	PADUCA	DEVONIAN	85,799	59	389
COTTON DRAW UNIT #076	30-015-29252	32.1565857	-103.737999	1	25S	31E	Eddy	NM	PADUCA	DEVONIAN	128,947	317	481
COTTON DRAW UNIT #086	30-015-29850	32.1446877	-103.7278824	12	25S	31E	Eddy	NM	PADUCA	DEVONIAN	131,450	353	542
Source Water Analysis													
Anthem Water Solutions, LLC													
Well Name	API	Latitude	Longitude	Section	Township	Range	County	State	Field	Formation	TDS (Mg/L)	Bicarbonate (MG/L)	Sulfate (Mg/L)
PRE-ONGARD WELL #001	30-015-02416	32.5527229	-104.1623917	22	20S	28E	Eddy	NM		WOLFCAMP	55,965	252	2,260
PRE-ONGARD WELL #004	30-015-02280	32.6479454	-104.1791229	21	19S	28E	Eddy	NM	MILLMAN EAST	WOLFCAMP	118,720	2,700	1,080
SERRANO 29 FEDERAL #001H	30-015-37763	32.1901523	-104.2192003	29	24S	27E	Eddy	NM	SULPHATE DRAW	WOLFCAMP	102,136	183	#N/A
HABANERO 17 FEDERAL COM #001H	30-015-36108	32.2218759	-104.2189611	17	24S	27E	Eddy	NM	BLACK RIVER	WOLFCAMP	108,205	146	#N/A
WHITE CITY PENN GAS COM UNIT 1 #001	30-015-00408	32.1937523	-104.3088455	29	24S	26E	Eddy	NM	WHITE CITY	WOLFCAMP	#N/A	653	1,336
STATE AC COM #001	30-015-22299	32.5572166	-104.1806107	21	20S	28E	Eddy	NM	BURTON FLAT	WOLFCAMP	144,926	37	1,350
PURE GOLD C-17 FEDERAL #002	30-015-26021	32.3057258	-103.7987356	17	23S	31E	Eddy	NM	SAND DUNES WEST	WOLFCAMP	11,361	1,708	#N/A
PARKWAY WEST UNIT #015	30-015-32363	32.6353531	-104.0734329	28	19S	29E	Eddy	NM	PARKWAY WEST UNIT #015	BONE SPRING	215,934	98	702
APACHE 25 FEDERAL #009	30-015-32797	32.361248	-103.8309479	25	22S	30E	Eddy	NM	APACHE 25 FEDERAL #009	BONE SPRING	160,590	146	856
TODD 22 G FEDERAL #007	30-015-32881	32.2917137	-103.7635422	22	23S	31E	Eddy	NM	TODD 22 G FEDERAL #007	BONE SPRING	269,658	37	10
PARKWAY #021	30-015-32686	32.6253433	-104.0725937	28	19S	29E	Eddy	NM	PARKWAY #021	BONE SPRING	214,972	85	715
TODD 15 M FEDERAL #013	30-015-33118	32.2989769	-103.7720947	15	23S	31E	Eddy	NM	TODD 15 M FEDERAL #013	BONE SPRING	292,473	85	490
APACHE 25 FEDERAL #005	30-015-32720	32.3612404	-103.8266678	25	22S	30E	Eddy	NM	APACHE 25 FEDERAL #005	BONE SPRING	300,667	61	17
STRAWBERRY 7 FEDERAL #003	30-015-37171	32.6812553	-103.9148483	7	19S	31E	Eddy	NM	STRAWBERRY 7 FEDERAL #003	BONE SPRING	185,540	183	600
STRAWBERRY 7 FEDERAL #007	30-015-38485	32.6812526	-103.9012376	7	19S	31E	Eddy	NM	STRAWBERRY 7 FEDERAL #007	BONE SPRING	187,930	98	940
REMUDA BASIN UNIT #001	30-015-03691	32.2886238	-103.9360428	24	23S	29E	Eddy	NM	REMUDA BASIN UNIT #001	BONE SPRING	271,010	130	100
JONES FEDERAL B #003	30-015-10394	32.6405487	-103.8334885	23	19S	31E	Eddy	NM	JONES FEDERAL B #003	BONE SPRING	178,015	305	721
LONETREE STATE #001	30-015-21920	32.478508	-104.1454086	13	21S	27E	Eddy	NM	LONETREE STATE #001	BONE SPRING	244,966	122	1,013
FEDERAL HJ-27 #001	30-015-25780	32.6335258	-103.863533	27	19S	31E	Eddy	NM	FEDERAL HJ-27 #001	BONE SPRING	176,639	305	530
HANLEY FEDERAL #001	30-015-26068	32.7674713	-103.9105911	7	18S	31E	Eddy	NM	HANLEY FEDERAL #001	BONE SPRING	204,076	293	1,515
ALLIED 7 FEDERAL #001	30-015-25900	32.7638435	-103.9067764	7	18S	31E	Eddy	NM	ALLIED 7 FEDERAL #001	BONE SPRING	225,562	122	740
APACHE 25 FEDERAL #002	30-015-27478	32.3576164	-103.8298492	25	22S	30E	Eddy	NM	APACHE 25 FEDERAL #002	BONE SPRING	9,546	183	51
ORE IDA 14 FEDERAL #009	30-015-29278	32.2118607	-103.9491348	14	24S	29E	Eddy	NM	ORE IDA 14 FEDERAL #009	BONE SPRING	190,367	244	539
H B 11 FEDERAL #003	30-015-29249	32.2272186	-103.9569855	11	24S	29E	Eddy	NM	H B 11 FEDERAL #003	BONE SPRING	195,306	256	650
HACKBERRY 18 FEDERAL #001	30-015-29780	32.654953	-103.9065323	18	19S	31E	Eddy	NM	HACKBERRY 18 FEDERAL #001	BONE SPRING	180,325	85	850
WEST SHUGART 19 FEDERAL #002	30-015-30780	32.7271385	-103.9094238	19	18S	31E	Eddy	NM	WEST SHUGART 19 FEDERAL #002	BONE SPRING	144,906	390	850
WEST SHUGART 30 FEDERAL #003	30-015-30776	32.7247467	-103.9067154	30	18S	31E	Eddy	NM	WEST SHUGART 30 FEDERAL #003	BONE SPRING	136,715	244	675
ROOKIE STATE #001	30-015-10060	32.4134165	-104.3325848	7	22S	26E	Eddy	NM	ROOKIE STATE #001	BONE SPRING	67,985	61	1,148



## Attachment 4: 1-mile Fresh Water Map and Tabular List

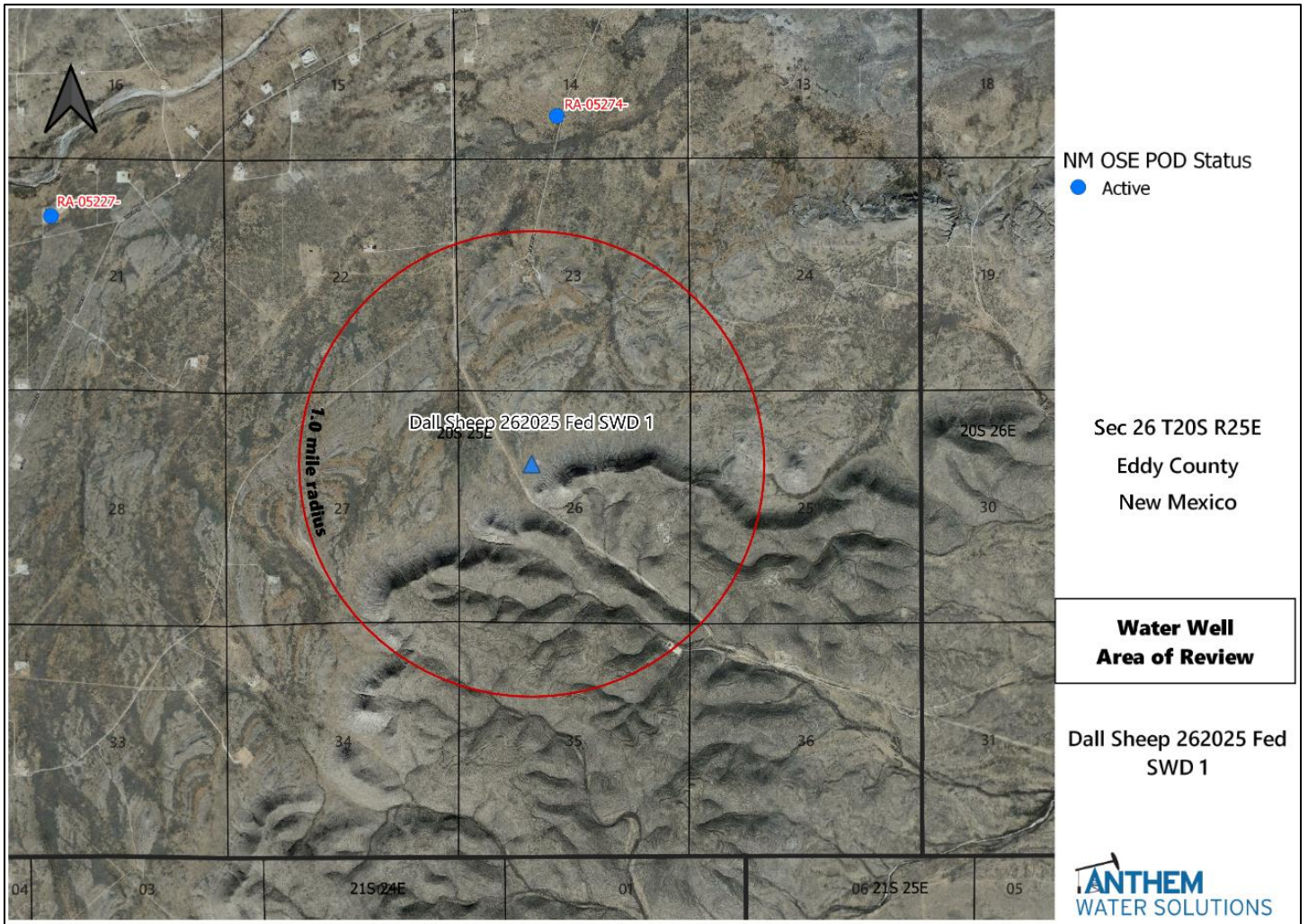

Water Well Sampling Rational					
Dall Sheep 262025 Federal SWD 1					
Water Wells	Owner	Available Contact Information	Use	Sampling Required	Notes
There are no water wells within a 1-mile radius					



NM Oil Conservation Division  
1220 S. St. Francis Dr.  
Santa Fe, NM 87505

**Re: Geology Statement**  
**Anthem Water Solutions, LLC**  
**Dall Sheep 262025 Federal SWD No. 1**  
**Section 26, T. 20S, R. 25E**  
**Eddy County, New Mexico**

To whom it may concern:

Publicly available geologic and engineering data related to the proposed well have been thoroughly reviewed, and no evidence for open faults or any other hydrologic connection between the proposed Devonian-Silurian injection zone and any underground sources of drinking water has been found. Please see the attached seismic risk assessment for additional information.

Sincerely,

A handwritten signature in dark ink that reads "Cory Walk". The signature is written in a cursive, flowing style.

Cory Walk  
Geologist

**Seismic Risk Assessment**  
**Anthem Water Solutions, LLC**  
**Dall Sheep 262025 Federal SWD No. 1**  
**Section 26, Township 20 South, Range 25 East**  
**Eddy County, New Mexico**

**Cory Walk, M.S.**

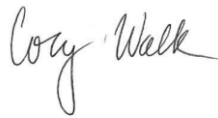
A handwritten signature in cursive script that reads "Cory Walk".

**Geologist**  
**Permits West Inc.**

**July 20, 2021**

## GENERAL INFORMATION

Dall Sheep 262025 Federal SWD No. 1 is located in the NW 1/4, section 26, T20S, R25E, about 14 miles northwest of Carlsbad, NM in the Permian Basin. Anthem Water Solutions proposes the injection zone to be within the Devonian-Silurian formation through an open hole from 10,762'-11,122' below ground surface. This report assesses concerns relating to induced seismicity along deep penetrating Precambrian faults or the connection between the injection zone and known underground potable water sources.

## SEISMIC RISK ASSESSMENT

### *Historical Seismicity*

**Searching the USGS earthquake catalog resulted in three (3) earthquakes above a magnitude 2.5 within 6 miles (9.7 km) of the proposed deep disposal site since 1970 (Fig. 1).** The nearest earthquake occurred on August 26, 2004 about 3.6 miles (~5.8 km) northwest of the proposed SWD site and had a magnitude of 3.4.

### *Basement Faults and Subsurface Conditions*

A structure contour map (Fig. 1) of the Precambrian basement shows the Dall Sheep 262025 Federal SWD #1 is approximately 10.4 miles from the nearest basement-penetrating fault inferred by Ewing et al (1990). **Information about nearby faults is listed in Table 1.**

Snee and Zoback (2018) state, "In the western part of Eddy County, New Mexico,  $S_{Hmax}$  is ~north-south (consistent with the state of stress in the Rio Grande Rift; Zoback and Zoback, 1980) but rotates to ~east-northeast-west-southwest in southern Lea County, New Mexico and the northernmost parts of Culberson and Reeves counties, Texas." **Around the Dall Sheep 262025 Federal SWD site, Snee and Zoback indicate a  $S_{Hmax}$  direction of N010°E and an  $A_\phi$  of 0.57, indicating an extensional (normal) stress regime.**

Induced seismicity is a growing concern of deep SWD wells. Software developed by the Stanford Center for Induced and Triggered Seismicity allows for the probabilistic screening of deeply penetrating faults near the proposed injection zone (Walsh et al., 2016; Walsh et al., 2017). This software uses parameters such as stress orientations, fault strike/dip, injection rates, fault friction coefficients, etc. to estimate the potential for fault slip. Using this software, Snee and Zoback (2018) indicate that the nearest fault (10 miles to the southeast) has a 20-30% probability of fault slip (Fig. 2). But, due to a distance of over 10 miles, the proposed SWD is unlikely to have any major effect on this fault.

## GROUNDWATER SOURCES

The Capitan Aquifer (Grayburg, Queen, Seven Rivers, Yates, and Tansill Formations) acts as the principal aquifer used for potable ground water near the Dall Sheep 262025 Federal SWD #1 location (Richey et al., 1985). Around the Dall Sheep 262025 Federal SWD #1, the base of the Capitan Aquifer (San Andres Formation top) lies at a depth of approximately 1,026' bgs.

## **VERTICAL MIGRATION OF FLUIDS**

Permeability barriers exist above (Woodford shale; 40 ft thick) and below (Simpson Group; 20 ft thick) the targeted Devonian-Silurian injection zone (Plate 2, Comer et al., 1991; Fig. 8, Frenzel et al., 1988). Precambrian structure contours (Ruppel, 2009) show the basement to be at a depth of approximately 12,390' in this area. Therefore, the injection zone lies approximately 1,270' above the Precambrian basement and approximately 9,736' below the previously stated lower limit of potable water at the base of the Capitan Aquifer (San Andres Formation top).

## **CONCLUSION**

After examination of publicly available geologic and engineering data, there is no evidence of open faults or any other hydrologic connection between the disposal zone and any underground sources of drinking water.



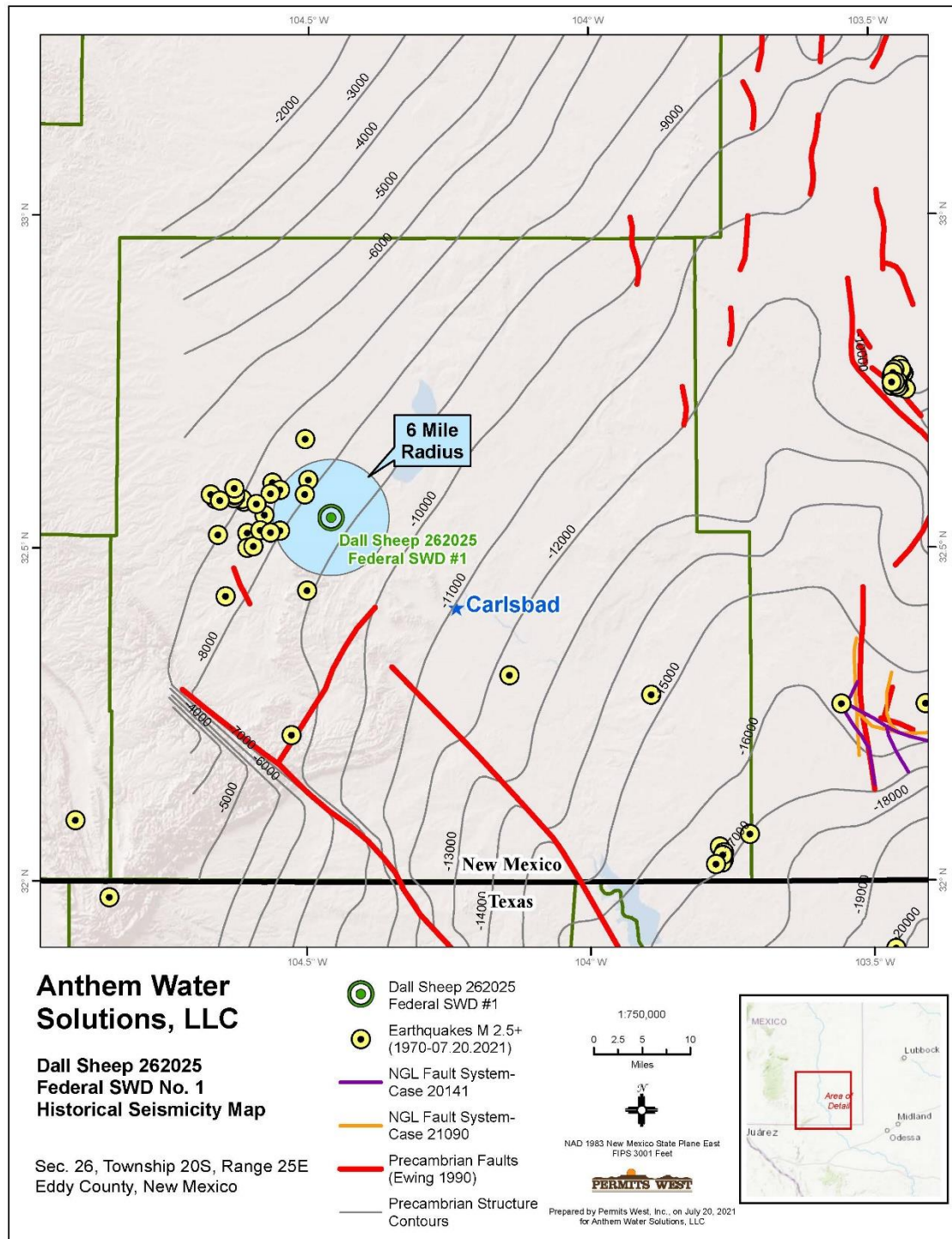

Figure 1. Structural contour map of the Precambrian basement in feet below sea level. Red lines represent the locations of Precambrian basement-penetrating faults (Ewing et al., 1990). Purple and orange lines represent the locations of basement-penetrating faults inferred by Todd Reynolds representing NGL in NMOCD Case Nos. 20141 and 21090. The Dall Sheep 262025 Federal SWD #1 well lies ~10.4 miles northwest of the closest deeply penetrating fault and ~3.6 miles southeast of the closest historic earthquake.

**Table 1: Nearby Fault Information**

Fault Number (Fig. 2)	Distance to proposed SWD (mi)	Strike (°)	Dip (°)	FSP (%)
1	10.4	220	50-90	20-30
2	11.3	148	50-90	0
3	16.7	320	50-90	0

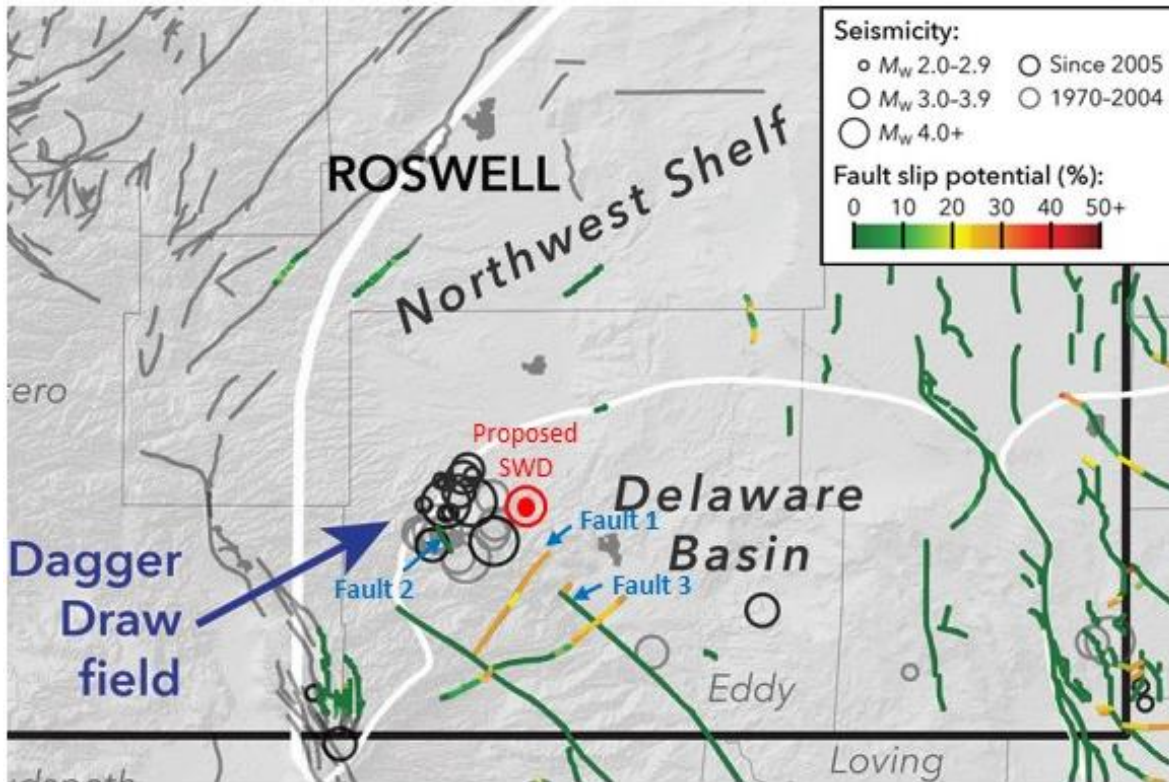

Figure 2. Modified Figure 3 from Snee and Zoback (2018). Map showing proposed location of Dall Sheep 262025 Federal SWD #1 in relation to Snee and Zoback's results of their FSP analysis.

## References Cited

- Comer, J. B., 1991, Stratigraphic Analysis of the Upper Devonian Woodford Formation, Permian Basin, West Texas and Southeastern New Mexico: The University of Texas at Austin, Bureau of Economic Geology, Report of Investigations No. 201, 63 p.
- Ewing, T. E., 1990, The tectonic map of Texas: Austin, Bureau of Economic Geology, The University of Texas at Austin.
- Frenzel, H. N., Bloomer, R. R., Cline, R. B., Cys, J. M., Galley, J. E., Gibson, W. R., Hills, J. M., King, W. E., Seager, W. R., Kottowski, F. E., Thompson, S., III, Luff, G. C., Pearson, B. T., and Van Siclen, D. C., 1988, The Permian Basin region, in Sloss, L. L., ed., Sedimentary cover—North American Craton, U.S.: Boulder, Colorado, Geological Society of America, The Geology of North America, v. D-2, p. 261–306.
- Hurd, O; Zoback, MD, 2012, Intraplate earthquakes, regional stress and fault mechanics in the Central and Eastern U.S. and Southeastern Canada. *Tectonophysics*, 581:182-92.
- Richey, S., Wells, J., and Stephens, K., 1985, Geohydrology of the Delaware Basin and Vicinity, Texas and New Mexico: United States Geological Survey, Water-Resources Investigations Report 84-4077, 101 pp.
- Ruppel, S.C., 2009, Integrated synthesis of the Permian basin: data and models for recovering existing and undiscovered oil resources from the largest oil-bearing basin: U.S. Oil & Natural Gas Technology, Bureau Economic Geology, The University of Texas at Austin, p. 1-959.
- Snee, J.-E.L., Zoback, M.D., 2018, State of stress in the Permian Basin, Texas and New Mexico: Implications for induced seismicity: *Leading Edge*, v. 37, p. 127–134.
- Walsh, F. R., and Zoback, M. D., (2016) Probabilistic assessment of potential fault slip related to injection induced earthquakes: Application to north central Oklahoma, USA, *Geology*, Data Repository item 2016334, doi:10.1130/G38275.1
- Walsh, F. R., Zoback, M. D., Pais, D., Weingarten, M., and Tyrrell, T. (2017) FSP 1.0: A Program for Probabilistic Estimation of Fault Slip Potential Resulting From Fluid Injection, User Guide from the Stanford Center for Induced and Triggered Seismicity, available at [SCITS.Stanford.edu/software](https://SCITS.Stanford.edu/software)
- Zoback, M. L., and M. D. Zoback, 1980, State of stress in the conterminous United States: *Journal of Geophysical Research*, 85, no. B11, 6113–6156, <https://doi.org/10.1029/JB085iB11p06113>.

Attachment 6: Public Notice Affidavit

## Carlsbad Current Argus.

PART OF THE USA TODAY NETWORK

### Affidavit of Publication

Ad # 0004833670

This is not an invoice

**ANTHEM WATER SOLUTIONS, LLC**  
5914 W. COURTYARD DR, STE 320

**AUSTIN, TX 78730**

I, a legal clerk of the **Carlsbad Current Argus**, a newspaper published daily at the City of Carlsbad, in said county of Eddy, state of New Mexico and of general paid circulation in said county; that the same is a duly qualified newspaper under the laws of the State wherein legal notices and advertisements may be published; that the printed notice attached hereto was published in the regular and entire edition of said newspaper and not in supplement thereof on the date as follows, to wit:

07/22/2021

  
Legal Clerk

Subscribed and sworn before me this July 22, 2021:

  
State of WI, County of Brown  
NOTARY PUBLIC

1-7-25

My commission expires

#### APPLICATION FOR AUTHORITY TO INJECT

#### NOTICE IS HEREBY GIVEN;

That Anthem Water Solutions, LLC, 5914 W. Courtyard Dr., Suite 320, Austin Texas, 78730, is requesting that the New Mexico Oil Conservation Division administratively approve the APPLICATION FOR AUTHORITY TO INJECT as follow:

**PURPOSE:** The intended purpose of the injection well is to dispose of salt water produced from permitted oil and gas wells.

**WELL NAME AND LOCATION:** Dall Sheep 262025 Federal SWD 1 Located 16 miles northwest of Carlsbad. SE1/4 of the NW1/4 Section 26, Township 20S, Range 25E, 1650' from North Line & 1650' from West Line, Eddy County, New Mexico.

**NAME AND DEPTH OF DISPOSAL ZONE:** Devonian-Silurian (10762' - 11122')

**EXPECTED MAXIMUM INJECTION RATE:** 30,000 barrels/day

**EXPECTED MAXIMUM INJECTION PRESSURE:** 2152 psi (surface)

Objections or requests for hearing must be filed with the New Mexico Oil Conservation Division within fifteen (15) days. Any objections or requests for hearing should be mailed to the Oil Conservation Division, 1220 South St. Francis Dr., Santa Fe, New Mexico 87505.

Additional information may be obtained by contacting Marshall Tippen (972) 795-4201.

#4833670, Current Argus, July 22, 2021

Ad # 0004833670

PO #: Dall Sheep 262025 Federal SWD  
# of Affidavits 1

This is not an invoice

## Attachment 6: List of Notification Applicants & Delivery Confirmations

Dall Sheep 262025 Federal SWD 1 - Notice of Application Receipts				
Entity	Address	City	State	Zip Code
<b>Landowner and Mineral Owner</b>				
New Mexico BLM	620 E Greene St.	Carlsbad	NM	88220
New Mexico State Land Office	310 Old Santa Fe Trail	Santa Fe	NM	87501
<b>OCD District</b>				
NMOCD District 2	811 S. First St	Artesia	NM	88210
<b>Leasehold Operators (1-mile)</b>				
SHELDON L SMITH	PO BOX 3544	MIDLAND	TX	79701
PECOS PROD	400 W ILLINOIS STE 1070	MIDLAND	TX	79701
MYCO INDUSTRIES	105 South Fourth St	Artesia	NM	88210
SHAW INTERESTS	PO BOX 9612	MIDLAND	TX	79708
MARK P HARDWICK	PO BOX 213	MIDLAND	TX	79702
TRINITY RESOURCES	200 W. 1ST STREET, SUITE #859	ROSWELL	NM	88203
CAPSTONE O&G	P.O. BOX 10187	MIDLAND	TX	79705
FASKEN L&M	303 W. WALL AVENUE SUITE 1800	MIDLAND	TX	79701
Mewbourne	P.O Box 7698	Tyler	TX	75711
ROSS DUNCAN PROPERTIES	PO BOX 647	Artesia	NM	88211
CGS OPERATING	1650 SOUTH HIGHWAY 287	DECATUR	TX	76234
<b>Notes: The table above shows the Entities who were identified as parties of interest requiring notification on either the 1-mile well detail list (Attachment 2) or on the 2-mile Mineral Lease Map (Attachment 2).</b>				



Marshall Tippen  
Anthem Water Solutions, LLC  
3300 North A Street, Building 2, Suite 222  
Midland, Texas 79705

New Mexico BLM  
620 E Greene St.  
Carlsbad, NM 88220

**APPLICATION FOR AUTHORITY TO INJECT**

To Whom it May Concern,

**NOTICE IS HEREBY GIVEN;** That Anthem Water Solutions, LLC, 5914 W. Courtyard Dr., Suite 320, Austin Texas, 78730, is requesting that the New Mexico Oil Conservation Division administratively approve the APPLICATION FOR AUTHORITY TO INJECT as follow:

**PURPOSE:** The intended purpose of the injection well is to dispose of salt water produced from permitted oil and gas wells.

**WELL NAME AND LOCATION:** Dall Sheep 262025 Federal SWD 1 Located 16 miles northeast of Carlsbad. SE1/4 of the NW1/4 Section 26, Township 20S, Range 25E, 1650' from North Line & 1650' from West Line, Eddy County, New Mexico.

**NAME AND DEPTH OF DISPOSAL ZONE:** Devonian-Silurian (10762' – 11122')

**EXPECTED MAXIMUM INJECTION RATE:** 30,000 barrels/day

**EXPECTED MAXIMUM INJECTION PRESSURE:** 2152 psi (surface)

Objections or requests for hearing must be filed with the New Mexico Oil Conservation Division within fifteen (15) days. Any objections or requests for hearing should be mailed to the Oil Conservation Division, 1220 South St. Francis Dr., Santa Fe, New Mexico 87505.

Additional information may be obtained by contacting Marshall Tippen (972) 795-4201.

Regards,

A handwritten signature in black ink, appearing to read 'Marshall Tippen', written in a cursive style.

Marshall Tippen



Marshall Tippen  
Anthem Water Solutions, LLC  
3300 North A Street, Building 2, Suite 222  
Midland, Texas 79705

New Mexico State Land Office  
310 Old Santa Fe Trail  
Santa Fe, NM 87501

**APPLICATION FOR AUTHORITY TO INJECT**

To Whom it May Concern,

**NOTICE IS HEREBY GIVEN;** That Anthem Water Solutions, LLC, 5914 W. Courtyard Dr., Suite 320, Austin Texas, 78730, is requesting that the New Mexico Oil Conservation Division administratively approve the APPLICATION FOR AUTHORITY TO INJECT as follow:

**PURPOSE:** The intended purpose of the injection well is to dispose of salt water produced from permitted oil and gas wells.

**WELL NAME AND LOCATION:** Dall Sheep 262025 Federal SWD 1 Located 16 miles northeast of Carlsbad. SE1/4 of the NW1/4 Section 26, Township 20S, Range 25E, 1650' from North Line & 1650' from West Line, Eddy County, New Mexico.

**NAME AND DEPTH OF DISPOSAL ZONE:** Devonian-Silurian (10762' – 11122')

**EXPECTED MAXIMUM INJECTION RATE:** 30,000 barrels/day

**EXPECTED MAXIMUM INJECTION PRESSURE:** 2152 psi (surface)

Objections or requests for hearing must be filed with the New Mexico Oil Conservation Division within fifteen (15) days. Any objections or requests for hearing should be mailed to the Oil Conservation Division, 1220 South St. Francis Dr., Santa Fe, New Mexico 87505.

Additional information may be obtained by contacting Marshall Tippen (972) 795-4201.

Regards,

A handwritten signature in black ink, appearing to read 'Marshall Tippen', is written over a horizontal line.

Marshall Tippen





Marshall Tippen  
Anthem Water Solutions, LLC  
3300 North A Street, Building 2, Suite 222  
Midland, Texas 79705

NMOCD District 2  
811 S. First St  
Artesia, NM 88210

**APPLICATION FOR AUTHORITY TO INJECT**

To Whom it May Concern,

**NOTICE IS HEREBY GIVEN;** That Anthem Water Solutions, LLC, 5914 W. Courtyard Dr., Suite 320, Austin Texas, 78730, is requesting that the New Mexico Oil Conservation Division administratively approve the APPLICATION FOR AUTHORITY TO INJECT as follow:

**PURPOSE:** The intended purpose of the injection well is to dispose of salt water produced from permitted oil and gas wells.

**WELL NAME AND LOCATION:** Dall Sheep 262025 Federal SWD 1 Located 16 miles northeast of Carlsbad. SE1/4 of the NW1/4 Section 26, Township 20S, Range 25E, 1650' from North Line & 1650' from West Line, Eddy County, New Mexico.

**NAME AND DEPTH OF DISPOSAL ZONE:** Devonian-Silurian (10762' – 11122')

**EXPECTED MAXIMUM INJECTION RATE:** 30,000 barrels/day

**EXPECTED MAXIMUM INJECTION PRESSURE:** 2152 psi (surface)

Objections or requests for hearing must be filed with the New Mexico Oil Conservation Division within fifteen (15) days. Any objections or requests for hearing should be mailed to the Oil Conservation Division, 1220 South St. Francis Dr., Santa Fe, New Mexico 87505.

Additional information may be obtained by contacting Marshall Tippen (972) 795-4201.

Regards,

A handwritten signature in black ink, appearing to read 'Marshall Tippen', is written over a horizontal line.

Marshall Tippen





Marshall Tippen  
Anthem Water Solutions, LLC  
3300 North A Street, Building 2, Suite 222  
Midland, Texas 79705

SHELDON L SMITH  
PO BOX 3544  
MIDLAND, TX 79701

**APPLICATION FOR AUTHORITY TO INJECT**

To Whom it May Concern,

**NOTICE IS HEREBY GIVEN;** That Anthem Water Solutions, LLC, 5914 W. Courtyard Dr., Suite 320, Austin Texas, 78730, is requesting that the New Mexico Oil Conservation Division administratively approve the APPLICATION FOR AUTHORITY TO INJECT as follow:

**PURPOSE:** The intended purpose of the injection well is to dispose of salt water produced from permitted oil and gas wells.

**WELL NAME AND LOCATION:** Dall Sheep 262025 Federal SWD 1 Located 16 miles northeast of Carlsbad. SE1/4 of the NW1/4 Section 26, Township 20S, Range 25E, 1650' from North Line & 1650' from West Line, Eddy County, New Mexico.

**NAME AND DEPTH OF DISPOSAL ZONE:** Devonian-Silurian (10762' – 11122')

**EXPECTED MAXIMUM INJECTION RATE:** 30,000 barrels/day

**EXPECTED MAXIMUM INJECTION PRESSURE:** 2152 psi (surface)

Objections or requests for hearing must be filed with the New Mexico Oil Conservation Division within fifteen (15) days. Any objections or requests for hearing should be mailed to the Oil Conservation Division, 1220 South St. Francis Dr., Santa Fe, New Mexico 87505.

Additional information may be obtained by contacting Marshall Tippen (972) 795-4201.

Regards,

A handwritten signature in black ink, appearing to read 'Marshall Tippen', written in a cursive style.

Marshall Tippen



Marshall Tippen  
Anthem Water Solutions, LLC  
3300 North A Street, Building 2, Suite 222  
Midland, Texas 79705

PECOS PROD  
400 W ILLINOIS STE 1070  
MIDLAND, TX 79701

**APPLICATION FOR AUTHORITY TO INJECT**

To Whom it May Concern,

**NOTICE IS HEREBY GIVEN;** That Anthem Water Solutions, LLC, 5914 W. Courtyard Dr., Suite 320, Austin Texas, 78730, is requesting that the New Mexico Oil Conservation Division administratively approve the APPLICATION FOR AUTHORITY TO INJECT as follow:

**PURPOSE:** The intended purpose of the injection well is to dispose of salt water produced from permitted oil and gas wells.

**WELL NAME AND LOCATION:** Dall Sheep 262025 Federal SWD 1 Located 16 miles northeast of Carlsbad. SE1/4 of the NW1/4 Section 26, Township 20S, Range 25E, 1650' from North Line & 1650' from West Line, Eddy County, New Mexico.

**NAME AND DEPTH OF DISPOSAL ZONE:** Devonian-Silurian (10762' – 11122')

**EXPECTED MAXIMUM INJECTION RATE:** 30,000 barrels/day

**EXPECTED MAXIMUM INJECTION PRESSURE:** 2152 psi (surface)

Objections or requests for hearing must be filed with the New Mexico Oil Conservation Division within fifteen (15) days. Any objections or requests for hearing should be mailed to the Oil Conservation Division, 1220 South St. Francis Dr., Santa Fe, New Mexico 87505.

Additional information may be obtained by contacting Marshall Tippen (972) 795-4201.

Regards,

A handwritten signature in black ink, appearing to read 'Marshall Tippen', written in a cursive style.

Marshall Tippen



Marshall Tippen  
Anthem Water Solutions, LLC  
3300 North A Street, Building 2, Suite 222  
Midland, Texas 79705

MYCO INDUSTRIES  
105 South Fourth St  
Artesia, NM 88210

**APPLICATION FOR AUTHORITY TO INJECT**

To Whom it May Concern,

**NOTICE IS HEREBY GIVEN;** That Anthem Water Solutions, LLC, 5914 W. Courtyard Dr., Suite 320, Austin Texas, 78730, is requesting that the New Mexico Oil Conservation Division administratively approve the APPLICATION FOR AUTHORITY TO INJECT as follow:

**PURPOSE:** The intended purpose of the injection well is to dispose of salt water produced from permitted oil and gas wells.

**WELL NAME AND LOCATION:** Dall Sheep 262025 Federal SWD 1 Located 16 miles northeast of Carlsbad. SE1/4 of the NW1/4 Section 26, Township 20S, Range 25E, 1650' from North Line & 1650' from West Line, Eddy County, New Mexico.

**NAME AND DEPTH OF DISPOSAL ZONE:** Devonian-Silurian (10762' – 11122')

**EXPECTED MAXIMUM INJECTION RATE:** 30,000 barrels/day

**EXPECTED MAXIMUM INJECTION PRESSURE:** 2152 psi (surface)

Objections or requests for hearing must be filed with the New Mexico Oil Conservation Division within fifteen (15) days. Any objections or requests for hearing should be mailed to the Oil Conservation Division, 1220 South St. Francis Dr., Santa Fe, New Mexico 87505.

Additional information may be obtained by contacting Marshall Tippen (972) 795-4201.

Regards,

A handwritten signature in black ink, appearing to read 'Marshall Tippen', is written over a horizontal line.

Marshall Tippen



Marshall Tippen  
Anthem Water Solutions, LLC  
3300 North A Street, Building 2, Suite 222  
Midland, Texas 79705

SHAW INTERESTS  
PO BOX 9612  
MIDLAND, TX 79708

**APPLICATION FOR AUTHORITY TO INJECT**

To Whom it May Concern,

**NOTICE IS HEREBY GIVEN;** That Anthem Water Solutions, LLC, 5914 W. Courtyard Dr., Suite 320, Austin Texas, 78730, is requesting that the New Mexico Oil Conservation Division administratively approve the APPLICATION FOR AUTHORITY TO INJECT as follow:

**PURPOSE:** The intended purpose of the injection well is to dispose of salt water produced from permitted oil and gas wells.

**WELL NAME AND LOCATION:** Dall Sheep 262025 Federal SWD 1 Located 16 miles northeast of Carlsbad. SE1/4 of the NW1/4 Section 26, Township 20S, Range 25E, 1650' from North Line & 1650' from West Line, Eddy County, New Mexico.

**NAME AND DEPTH OF DISPOSAL ZONE:** Devonian-Silurian (10762' – 11122')

**EXPECTED MAXIMUM INJECTION RATE:** 30,000 barrels/day

**EXPECTED MAXIMUM INJECTION PRESSURE:** 2152 psi (surface)

Objections or requests for hearing must be filed with the New Mexico Oil Conservation Division within fifteen (15) days. Any objections or requests for hearing should be mailed to the Oil Conservation Division, 1220 South St. Francis Dr., Santa Fe, New Mexico 87505.

Additional information may be obtained by contacting Marshall Tippen (972) 795-4201.

Regards,

A handwritten signature in black ink, appearing to read 'Marshall Tippen', written in a cursive style.

Marshall Tippen



Marshall Tippen  
Anthem Water Solutions, LLC  
3300 North A Street, Building 2, Suite 222  
Midland, Texas 79705

MARK P HARDWICK  
PO BOX 213  
MIDLAND, TX 79702

**APPLICATION FOR AUTHORITY TO INJECT**

To Whom it May Concern,

**NOTICE IS HEREBY GIVEN;** That Anthem Water Solutions, LLC, 5914 W. Courtyard Dr., Suite 320, Austin Texas, 78730, is requesting that the New Mexico Oil Conservation Division administratively approve the APPLICATION FOR AUTHORITY TO INJECT as follow:

**PURPOSE:** The intended purpose of the injection well is to dispose of salt water produced from permitted oil and gas wells.

**WELL NAME AND LOCATION:** Dall Sheep 262025 Federal SWD 1 Located 16 miles northeast of Carlsbad. SE1/4 of the NW1/4 Section 26, Township 20S, Range 25E, 1650' from North Line & 1650' from West Line, Eddy County, New Mexico.

**NAME AND DEPTH OF DISPOSAL ZONE:** Devonian-Silurian (10762' – 11122')

**EXPECTED MAXIMUM INJECTION RATE:** 30,000 barrels/day

**EXPECTED MAXIMUM INJECTION PRESSURE:** 2152 psi (surface)

Objections or requests for hearing must be filed with the New Mexico Oil Conservation Division within fifteen (15) days. Any objections or requests for hearing should be mailed to the Oil Conservation Division, 1220 South St. Francis Dr., Santa Fe, New Mexico 87505.

Additional information may be obtained by contacting Marshall Tippen (972) 795-4201.

Regards,

A handwritten signature in black ink, appearing to read 'Marshall Tippen', written in a cursive style.

Marshall Tippen



Marshall Tippen  
Anthem Water Solutions, LLC  
3300 North A Street, Building 2, Suite 222  
Midland, Texas 79705

TRINITY RESOURCES  
200 W. 1ST STREET, SUITE #859  
ROSWELL, NM 88203

**APPLICATION FOR AUTHORITY TO INJECT**

To Whom it May Concern,

**NOTICE IS HEREBY GIVEN;** That Anthem Water Solutions, LLC, 5914 W. Courtyard Dr., Suite 320, Austin Texas, 78730, is requesting that the New Mexico Oil Conservation Division administratively approve the APPLICATION FOR AUTHORITY TO INJECT as follow:

**PURPOSE:** The intended purpose of the injection well is to dispose of salt water produced from permitted oil and gas wells.

**WELL NAME AND LOCATION:** Dall Sheep 262025 Federal SWD 1 Located 16 miles northeast of Carlsbad. SE1/4 of the NW1/4 Section 26, Township 20S, Range 25E, 1650' from North Line & 1650' from West Line, Eddy County, New Mexico.

**NAME AND DEPTH OF DISPOSAL ZONE:** Devonian-Silurian (10762' – 11122')

**EXPECTED MAXIMUM INJECTION RATE:** 30,000 barrels/day

**EXPECTED MAXIMUM INJECTION PRESSURE:** 2152 psi (surface)

Objections or requests for hearing must be filed with the New Mexico Oil Conservation Division within fifteen (15) days. Any objections or requests for hearing should be mailed to the Oil Conservation Division, 1220 South St. Francis Dr., Santa Fe, New Mexico 87505.

Additional information may be obtained by contacting Marshall Tippen (972) 795-4201.

Regards,

A handwritten signature in black ink, appearing to read 'Marshall Tippen', written in a cursive style.

Marshall Tippen



Marshall Tippen  
Anthem Water Solutions, LLC  
3300 North A Street, Building 2, Suite 222  
Midland, Texas 79705

CAPSTONE O&G  
P.O. BOX 10187  
MIDLAND, TX 79705

**APPLICATION FOR AUTHORITY TO INJECT**

To Whom it May Concern,

**NOTICE IS HEREBY GIVEN;** That Anthem Water Solutions, LLC, 5914 W. Courtyard Dr., Suite 320, Austin Texas, 78730, is requesting that the New Mexico Oil Conservation Division administratively approve the APPLICATION FOR AUTHORITY TO INJECT as follow:

**PURPOSE:** The intended purpose of the injection well is to dispose of salt water produced from permitted oil and gas wells.

**WELL NAME AND LOCATION:** Dall Sheep 262025 Federal SWD 1 Located 16 miles northeast of Carlsbad. SE1/4 of the NW1/4 Section 26, Township 20S, Range 25E, 1650' from North Line & 1650' from West Line, Eddy County, New Mexico.

**NAME AND DEPTH OF DISPOSAL ZONE:** Devonian-Silurian (10762' – 11122')

**EXPECTED MAXIMUM INJECTION RATE:** 30,000 barrels/day

**EXPECTED MAXIMUM INJECTION PRESSURE:** 2152 psi (surface)

Objections or requests for hearing must be filed with the New Mexico Oil Conservation Division within fifteen (15) days. Any objections or requests for hearing should be mailed to the Oil Conservation Division, 1220 South St. Francis Dr., Santa Fe, New Mexico 87505.

Additional information may be obtained by contacting Marshall Tippen (972) 795-4201.

Regards,

A handwritten signature in black ink, appearing to read 'Marshall Tippen', is written over a horizontal line.

Marshall Tippen



Marshall Tippen  
Anthem Water Solutions, LLC  
3300 North A Street, Building 2, Suite 222  
Midland, Texas 79705

FASKEN L&M  
303 W. WALL AVENUE SUITE 1800  
MIDLAND, TX 79701

**APPLICATION FOR AUTHORITY TO INJECT**

To Whom it May Concern,

**NOTICE IS HEREBY GIVEN;** That Anthem Water Solutions, LLC, 5914 W. Courtyard Dr., Suite 320, Austin Texas, 78730, is requesting that the New Mexico Oil Conservation Division administratively approve the APPLICATION FOR AUTHORITY TO INJECT as follow:

**PURPOSE:** The intended purpose of the injection well is to dispose of salt water produced from permitted oil and gas wells.

**WELL NAME AND LOCATION:** Dall Sheep 262025 Federal SWD 1 Located 16 miles northeast of Carlsbad. SE1/4 of the NW1/4 Section 26, Township 20S, Range 25E, 1650' from North Line & 1650' from West Line, Eddy County, New Mexico.

**NAME AND DEPTH OF DISPOSAL ZONE:** Devonian-Silurian (10762' – 11122')

**EXPECTED MAXIMUM INJECTION RATE:** 30,000 barrels/day

**EXPECTED MAXIMUM INJECTION PRESSURE:** 2152 psi (surface)

Objections or requests for hearing must be filed with the New Mexico Oil Conservation Division within fifteen (15) days. Any objections or requests for hearing should be mailed to the Oil Conservation Division, 1220 South St. Francis Dr., Santa Fe, New Mexico 87505.

Additional information may be obtained by contacting Marshall Tippen (972) 795-4201.

Regards,

A handwritten signature in black ink, appearing to read 'Marshall Tippen', is written over a horizontal line.

Marshall Tippen





Marshall Tippen  
Anthem Water Solutions, LLC  
3300 North A Street, Building 2, Suite 222  
Midland, Texas 79705

Mewbourne  
P.O Box 7698  
Tyler, TX 75711

**APPLICATION FOR AUTHORITY TO INJECT**

To Whom it May Concern,

**NOTICE IS HEREBY GIVEN;** That Anthem Water Solutions, LLC, 5914 W. Courtyard Dr., Suite 320, Austin Texas, 78730, is requesting that the New Mexico Oil Conservation Division administratively approve the APPLICATION FOR AUTHORITY TO INJECT as follow:

**PURPOSE:** The intended purpose of the injection well is to dispose of salt water produced from permitted oil and gas wells.

**WELL NAME AND LOCATION:** Dall Sheep 262025 Federal SWD 1 Located 16 miles northeast of Carlsbad. SE1/4 of the NW1/4 Section 26, Township 20S, Range 25E, 1650' from North Line & 1650' from West Line, Eddy County, New Mexico.

**NAME AND DEPTH OF DISPOSAL ZONE:** Devonian-Silurian (10762' – 11122')

**EXPECTED MAXIMUM INJECTION RATE:** 30,000 barrels/day

**EXPECTED MAXIMUM INJECTION PRESSURE:** 2152 psi (surface)

Objections or requests for hearing must be filed with the New Mexico Oil Conservation Division within fifteen (15) days. Any objections or requests for hearing should be mailed to the Oil Conservation Division, 1220 South St. Francis Dr., Santa Fe, New Mexico 87505.

Additional information may be obtained by contacting Marshall Tippen (972) 795-4201.

Regards,

A handwritten signature in black ink, appearing to read 'Marshall Tippen', is written over a light blue horizontal line.

Marshall Tippen



Marshall Tippen  
Anthem Water Solutions, LLC  
3300 North A Street, Building 2, Suite 222  
Midland, Texas 79705

ROSS DUNCAN PROPERTIES  
PO BOX 647  
Artesia, NM 88211

**APPLICATION FOR AUTHORITY TO INJECT**

To Whom it May Concern,

**NOTICE IS HEREBY GIVEN;** That Anthem Water Solutions, LLC, 5914 W. Courtyard Dr., Suite 320, Austin Texas, 78730, is requesting that the New Mexico Oil Conservation Division administratively approve the APPLICATION FOR AUTHORITY TO INJECT as follow:

**PURPOSE:** The intended purpose of the injection well is to dispose of salt water produced from permitted oil and gas wells.

**WELL NAME AND LOCATION:** Dall Sheep 262025 Federal SWD 1 Located 16 miles northeast of Carlsbad. SE1/4 of the NW1/4 Section 26, Township 20S, Range 25E, 1650' from North Line & 1650' from West Line, Eddy County, New Mexico.

**NAME AND DEPTH OF DISPOSAL ZONE:** Devonian-Silurian (10762' – 11122')

**EXPECTED MAXIMUM INJECTION RATE:** 30,000 barrels/day

**EXPECTED MAXIMUM INJECTION PRESSURE:** 2152 psi (surface)

Objections or requests for hearing must be filed with the New Mexico Oil Conservation Division within fifteen (15) days. Any objections or requests for hearing should be mailed to the Oil Conservation Division, 1220 South St. Francis Dr., Santa Fe, New Mexico 87505.

Additional information may be obtained by contacting Marshall Tippen (972) 795-4201.

Regards,

A handwritten signature in black ink, appearing to read 'Marshall Tippen', is written over a horizontal line.

Marshall Tippen



Marshall Tippen  
Anthem Water Solutions, LLC  
3300 North A Street, Building 2, Suite 222  
Midland, Texas 79705

CGS OPERATING  
1650 SOUTH HIGHWAY 287  
DECATUR, TX 76234

**APPLICATION FOR AUTHORITY TO INJECT**

To Whom it May Concern,

**NOTICE IS HEREBY GIVEN;** That Anthem Water Solutions, LLC, 5914 W. Courtyard Dr., Suite 320, Austin Texas, 78730, is requesting that the New Mexico Oil Conservation Division administratively approve the APPLICATION FOR AUTHORITY TO INJECT as follow:

**PURPOSE:** The intended purpose of the injection well is to dispose of salt water produced from permitted oil and gas wells.

**WELL NAME AND LOCATION:** Dall Sheep 262025 Federal SWD 1 Located 16 miles northeast of Carlsbad. SE1/4 of the NW1/4 Section 26, Township 20S, Range 25E, 1650' from North Line & 1650' from West Line, Eddy County, New Mexico.

**NAME AND DEPTH OF DISPOSAL ZONE:** Devonian-Silurian (10762' – 11122')

**EXPECTED MAXIMUM INJECTION RATE:** 30,000 barrels/day

**EXPECTED MAXIMUM INJECTION PRESSURE:** 2152 psi (surface)

Objections or requests for hearing must be filed with the New Mexico Oil Conservation Division within fifteen (15) days. Any objections or requests for hearing should be mailed to the Oil Conservation Division, 1220 South St. Francis Dr., Santa Fe, New Mexico 87505.

Additional information may be obtained by contacting Marshall Tippen (972) 795-4201.

Regards,

A handwritten signature in black ink, appearing to read 'Marshall Tippen', written in a cursive style.

Marshall Tippen

Place label at top of the center of the envelope and fold at dotted line.

Place label at top of the center of the envelope and fold at dotted line.

Jack Ball  
Anthem Water Solutions  
5914 W. Courtyard Dr., Ste 320  
Austin TX 78730-4924

**\$4.11<sup>0</sup>**  
US POSTAGE  
FIRST-CLASS  
FROM 78730  
08/04/2021  
stamps  
endicia



Place label at top of the center of the envelope and fold at dotted line.

Jack Ball  
Anthem Water Solutions  
5914 W. Courtyard Dr., Ste 320  
Austin TX 78730-4924

**\$4.11<sup>0</sup>**  
US POSTAGE  
FIRST-CLASS  
FROM 78730  
08/04/2021  
stamps  
endicia



Place label at top of the center of the envelope and fold at dotted line.

**CERTIFIED MAIL®**



9407 1118 9956 1428 4800 09

CAPSTONE O&G  
P.O. BOX 10187  
MIDLAND TX 79702-7187

**CERTIFIED MAIL®**

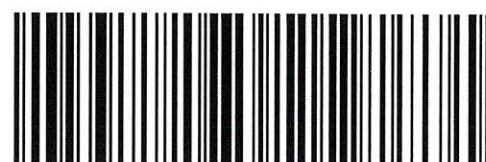

9407 1118 9956 1428 4804 36

CGS OPERATING  
1650 SOUTH HIGHWAY 287  
DECATUR TX 76234-2437



**Certified Mail® Labels**↑ **Top of the page**Print postage using Stamps.com Template **SDC-3610**

Jack Ball  
Anthem Water Solutions  
5914 W. Courtyard Dr., Ste 320  
Austin TX 78730-4924

**\$4.110**  
US POSTAGE  
FIRST-CLASS  
FROM 78730  
08/04/2021  
stamps  
endicia



062S0014203870

Place label at top of the center of the  
envelope and fold at dotted line.

**CERTIFIED MAIL®**  
**CERTIFIED MAIL®**

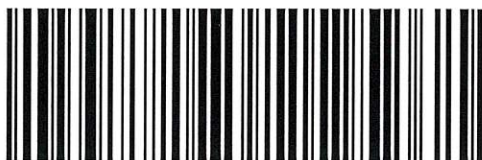

9407 1118 9956 1428 4882 58

FASKEN L&M  
303 W. WALL St SUITE 1800  
MIDLAND TX 79701-5106

Jack Ball  
Anthem Water Solutions  
5914 W. Courtyard Dr., Ste 320  
Austin TX 78730-4924

**\$4.110**  
US POSTAGE  
FIRST-CLASS  
FROM 78730  
08/04/2021  
stamps  
endicia



062S0014203870

Place label at top of the center of the  
envelope and fold at dotted line.

**CERTIFIED MAIL®**  
**CERTIFIED MAIL®**

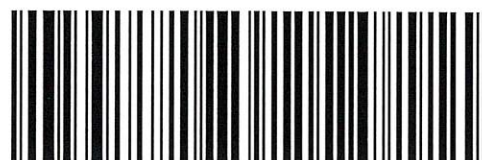

9407 1118 9956 1428 4888 14

MARK P HARDWICK  
PO BOX 213  
MIDLAND TX 79702-0213

Jack Ball  
Anthem Water Solutions  
5914 W. Courtyard Dr., Ste 320  
Austin TX 78730-4924

**\$4.110**  
US POSTAGE  
FIRST-CLASS  
FROM 78730  
08/04/2021  
stamps  
endicia



062S0014203870

Place label at top of the center of the  
envelope and fold at dotted line.

**CERTIFIED MAIL®**  
**CERTIFIED MAIL®**



9407 1118 9956 1428 4888 45

Mewbourne  
P.O Box 7698  
Tyler TX 75711-7698

Jack Ball  
Anthem Water Solutions  
5914 W. Courtyard Dr., Ste 320  
Austin TX 78730-4924

**\$4.110**  
US POSTAGE  
FIRST-CLASS  
FROM 78730  
08/04/2021  
stamps  
endicia



062S0014203870

Place label at top of the center of the  
envelope and fold at dotted line.

**CERTIFIED MAIL®**  
**CERTIFIED MAIL®**

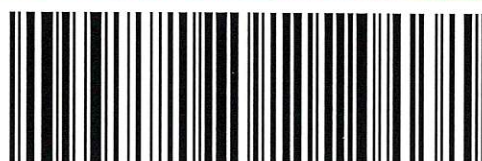

9407 1118 9956 1428 4887 46

MYCO INDUSTRIES  
105 South Fourth St  
Artesia NM 88210-2177



**Certified Mail® Labels**↑ **Top of the page**Print postage using Stamps.com Template **SDC-3610**

Jack Ball  
Anthem Water Solutions  
5914 W. Courtyard Dr., Ste 320  
Austin TX 78730-4924

**\$4.110**  
US POSTAGE  
FIRST-CLASS  
FROM 78730  
08/04/2021  
stamps  
endicia



062S0014203870

Place label at top of the center of the  
envelope and fold at dotted line.

**CERTIFIED MAIL®**  
**CERTIFIED MAIL®**



9407 1118 9956 1428 4889 06

New Mexico BLM  
620 E Greene St.  
Carlsbad NM 88220

Jack Ball  
Anthem Water Solutions  
5914 W. Courtyard Dr., Ste 320  
Austin TX 78730-4924

**\$4.110**  
US POSTAGE  
FIRST-CLASS  
FROM 78730  
08/04/2021  
stamps  
endicia



062S0014203870

Place label at top of the center of the  
envelope and fold at dotted line.

**CERTIFIED MAIL®**  
**CERTIFIED MAIL®**



9407 1118 9956 1428 4889 75

New Mexico State Land Office  
310 Old Santa Fe Trail  
Santa Fe NM 87501-2708

Jack Ball  
Anthem Water Solutions  
5914 W. Courtyard Dr., Ste 320  
Austin TX 78730-4924

**\$4.110**  
US POSTAGE  
FIRST-CLASS  
FROM 78730  
08/04/2021  
stamps  
endicia



062S0014203870

Place label at top of the center of the  
envelope and fold at dotted line.

**CERTIFIED MAIL®**  
**CERTIFIED MAIL®**



9407 1118 9956 1428 4886 23

NMOCD District 2  
811 S. First St  
Artesia NM 88210

Jack Ball  
Anthem Water Solutions  
5914 W. Courtyard Dr., Ste 320  
Austin TX 78730-4924

**\$4.110**  
US POSTAGE  
FIRST-CLASS  
FROM 78730  
08/04/2021  
stamps  
endicia



062S0014203870

Place label at top of the center of the  
envelope and fold at dotted line.

**CERTIFIED MAIL®**  
**CERTIFIED MAIL®**

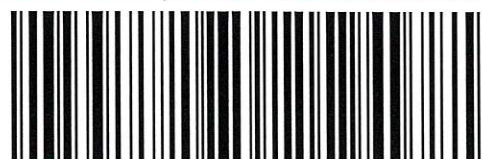

9407 1118 9956 1428 4881 97

PECOS PROD  
400 W ILLINOIS Ave STE 1070  
MIDLAND TX 79701-4639



**Certified Mail® Labels**

Jack Ball  
Anthem Water Solutions  
5914 W. Courtyard Dr., Ste 320  
Austin TX 78730-4924

**\$4.110**  
US POSTAGE  
FIRST-CLASS  
FROM 78730  
08/04/2021  
stamps  
endicia



Place label at top of the center of the envelope and fold at dotted line.

**CERTIFIED MAIL®**  
**CERTIFIED MAIL®**

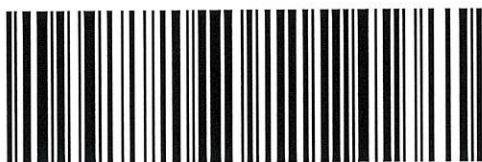

9407 1118 9956 1428 4883 57

ROSS DUNCAN PROPERTIES  
PO BOX 647  
Artesia NM 88211-0647

**Top of the page**

Print postage using Stamps.com Template SDC-3610

Jack Ball  
Anthem Water Solutions  
5914 W. Courtyard Dr., Ste 320  
Austin TX 78730-4924

**\$4.110**  
US POSTAGE  
FIRST-CLASS  
FROM 78730  
08/04/2021  
stamps  
endicia



Place label at top of the center of the envelope and fold at dotted line.

**CERTIFIED MAIL®**  
**CERTIFIED MAIL®**

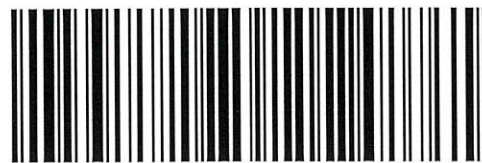

9407 1118 9956 1428 4883 40

SHAW INTERESTS  
PO BOX 9612  
MIDLAND TX 79708-9612

Jack Ball  
Anthem Water Solutions  
5914 W. Courtyard Dr., Ste 320  
Austin TX 78730-4924

**\$4.110**  
US POSTAGE  
FIRST-CLASS  
FROM 78730  
08/04/2021  
stamps  
endicia



Place label at top of the center of the envelope and fold at dotted line.

**CERTIFIED MAIL®**  
**CERTIFIED MAIL®**

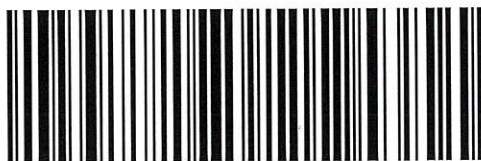

9407 1118 9956 1428 4880 67

SHELDON L SMITH  
PO BOX 3544  
MIDLAND TX 79702-3544

Jack Ball  
Anthem Water Solutions  
5914 W. Courtyard Dr., Ste 320  
Austin TX 78730-4924

**\$4.110**  
US POSTAGE  
FIRST-CLASS  
FROM 78730  
08/04/2021  
stamps  
endicia



Place label at top of the center of the envelope and fold at dotted line.

**CERTIFIED MAIL®**  
**CERTIFIED MAIL®**

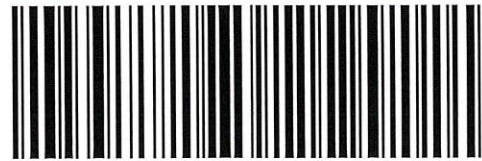

9407 1118 9956 1428 4884 18

TRINITY RESOURCES  
200 W. 1ST STREET, SUITE #859  
ROSWELL NM 88203-4697