

AP - 58

ANNUAL MONITORING REPORT

YEAR(S):
2010

CERTIFIED MAIL RECEIPT NO. 7010 2250 0001 4928 0117



March 11, 2011

Mr. Edward Hansen
New Mexico Energy, Minerals, & Natural Resources
Oil Conservation Division, Environmental Bureau
1220 S. St. Francis Drive
Santa Fe, New Mexico 87504

RECEIVED

MAR 14 2011

Oil Conservation Division
1220 S. St. Francis Drive
Santa Fe, NM 87505

RE: **2010 ANNUAL GROUNDWATER MONITORING REPORT**
BD SANTA RITA EOL RELEASE SITE (AP-58)
T22S, R37E, SECTION 27, UNIT LETTER A
LEA COUNTY, NEW MEXICO

Mr. Hansen:

As agent for Rice Operating Company (ROC), Trident Environmental submits this 2010 Annual Groundwater Monitoring Report for the BD Santa Rita EOL Release site (AP-58) located in the Blinebry-Drinkard (BD) Salt Water Disposal (SWD) System.

Groundwater recovery activities were initiated at recovery well RW-1 on June 22, 2010. As of November 26, 2010, approximately 6,847 bbls of groundwater has been removed when the system was shut down for the winter season to avoid any breakdowns from freezing conditions. On August 3, 2010, ROC submitted a *Stage 2 Progress Report* to the OCD which documented the excavation, backfilling, lining, re-seeding of the vadose zone, and re-establishment of native vegetation.

ROC is the service provider (agent) for the BD SWD System and has no ownership of any portion of pipeline, well, or facility. The BD SWD System is owned by a consortium of oil producers, System Parties, who provide all operating capital on a percentage ownership/usage basis.

Thank you for your consideration concerning this annual summary of groundwater monitoring information. If you have any questions, please contact Hack Conder at (575) 393-9174.

Sincerely,

Gilbert J. Van Deventer, REM, PG

cc: Hack Conder (Rice Operating Co., Hobbs, NM)

RECEIVED

MAR 14 2011

Oil Conservation Division
1220 S. St. Francis Drive
Santa Fe, NM 87505

enclosures: map, table, graphs, laboratory analytical report, and chain of custody documentation

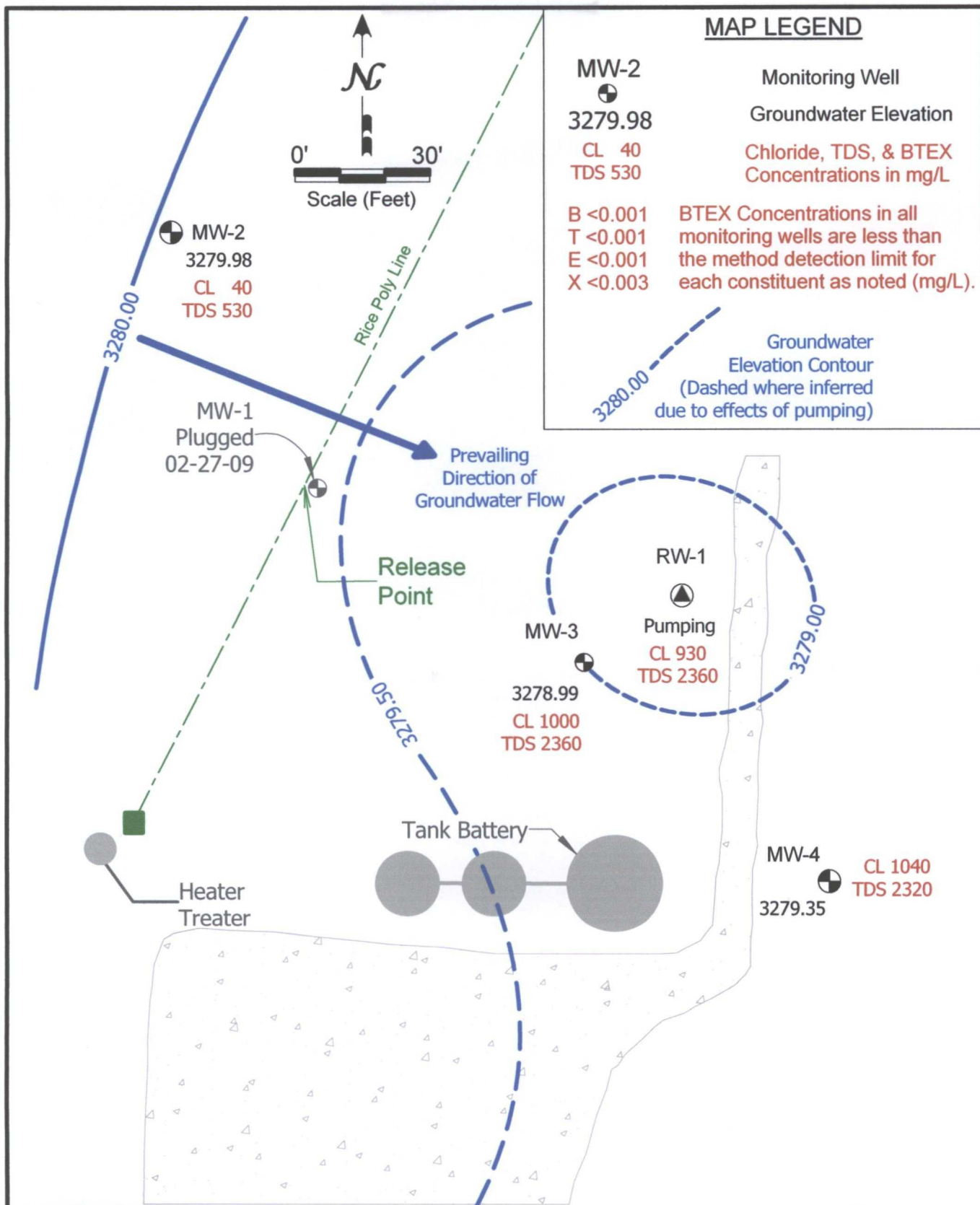

BD Santa Rita EOL Release Site
 T22S - R37E - Section 27, Unit A
RICE Operating Company

Water Table Elevation and
 Chloride, TDS, & BTEX
 Concentration Map
 October 6, 2010

2010 Annual Groundwater Monitoring Report
BD Santa Rita EOL Release Site (AP-58)
T22S - R37E - Section 27 - Unit A

Table 1

Summary of Groundwater Monitoring Results

Monitoring Well	Sample Date	Depth to Groundwater (feet BTOC)	Groundwater Elevation (feet AMSL)	Chloride (mg/L)	TDS (mg/L)	Benzene (mg/L)	Toluene (mg/L)	Ethylbenzene (mg/L)	Xylene (mg/L)
MW-1	09/02/05	54.04	3280.28	4,480	7,600	<0.001	<0.001	<0.001	<0.001
	10/24/05	53.85	3280.47	7,170	16,400	<0.001	<0.001	<0.001	<0.001
	01/23/06	53.98	3280.34	7,450	14,300	<0.001	<0.001	<0.001	<0.001
	04/24/06	54.07	3280.25	7,100	14,300	<0.001	<0.001	<0.001	<0.001
	07/19/06	54.08	3280.24	6,180	14,000	<0.001	<0.001	<0.001	<0.001
	10/11/06	53.99	3280.33	2,100	4,560	<0.001	<0.001	<0.001	<0.001
	01/25/07	54.10	3280.22	2,740	4,560	<0.001	<0.001	<0.001	<0.001
	04/04/07	54.11	3280.21	2,610	5,720	<0.001	<0.001	<0.001	<0.001
	07/09/07	53.80	3280.52	363	1,470	<0.001	<0.001	<0.001	<0.003
	11/12/07	53.87	3280.45	356	1,398	<0.001	<0.001	<0.001	<0.003
	01/15/08	53.88	3280.44	408	1,499	<0.001	<0.001	<0.001	<0.003
	04/07/08	53.98	3280.34	420	1,460	<0.001	<0.001	<0.001	<0.003
	07/22/08	54.06	3280.26	440	1,460	<0.002	<0.002	<0.002	<0.006
	10/02/08	54.11	3280.21	392	1,390	<0.001	<0.001	<0.001	<0.003
	01/14/09	54.08	3280.24	352	1,250	<0.001	<0.001	<0.001	<0.003
	02/27/09	This source area well was plugged on this date prior to excavation.							
MW-2	11/12/07	54.55	3280.48	160	930	<0.001	<0.001	<0.001	<0.003
	01/15/08	54.57	3280.46	128	1,001	<0.001	<0.001	<0.001	<0.003
	04/07/08	54.65	3280.38	100	982	<0.001	<0.001	<0.001	<0.003
	07/22/08	54.74	3280.29	92	931	<0.002	<0.002	<0.002	<0.006
	10/02/08	54.81	3280.22	88	902	<0.001	<0.001	<0.001	<0.003
	01/14/09	54.78	3280.25	84	850	<0.001	<0.001	<0.001	<0.003
	04/14/09	54.82	3280.21	80	858	<0.001	<0.001	<0.001	<0.003
	07/13/09	54.79	3280.24	76	802	<0.001	<0.001	<0.001	<0.003
	10/08/09	54.79	3280.24	64	776	<0.001	<0.001	<0.001	<0.003
	01/06/10	54.83	3280.20	60	726	<0.001	<0.001	<0.001	<0.003
	04/09/10	54.85	3280.18	52	710	<0.001	<0.001	<0.001	<0.003
	07/09/10	55.10	3279.93	52	644	<0.001	<0.001	<0.001	<0.003
	10/06/10	55.05	3279.98	40	530	<0.001	<0.001	<0.001	<0.003

Continued on next page

2010 Annual Groundwater Monitoring Report
BD Santa Rita EOL Release Site (AP-58)
T22S - R37E - Section 27 - Unit A

Table 1
Summary of Groundwater Monitoring Results

Monitoring Well	Sample Date	Depth to Groundwater (feet BTOC)	Groundwater Elevation (feet AMSL)	Chloride (mg/L)	TDS (mg/L)	Benzene (mg/L)	Toluene (mg/L)	Ethylbenzene (mg/L)	Xylene (mg/L)
MW-3	11/12/07	53.70	3280.27	1,210	2,596	<0.001	<0.001	<0.001	<0.003
	01/15/08	53.69	3280.28	1,010	2,398	<0.001	<0.001	<0.001	<0.003
	04/07/08	53.73	3280.24	1,080	2,620	<0.001	<0.001	<0.001	<0.003
	07/22/08	53.82	3280.15	1,030	2,890	<0.002	<0.002	<0.002	<0.006
	10/02/08	53.86	3280.11	1,020	2,830	<0.001	<0.001	<0.001	<0.003
	01/14/09	53.83	3280.14	1,050	2,670	<0.001	<0.001	<0.001	<0.003
	04/14/09	53.90	3280.07	960	2,200	<0.001	<0.001	<0.001	<0.003
	07/13/09	53.88	3280.09	900	2,080	<0.001	<0.001	<0.001	<0.003
	10/08/09	53.85	3280.12	900	2,340	<0.001	<0.001	<0.001	<0.003
	01/06/10	54.04	3279.93	910	2,170	<0.001	<0.001	<0.001	<0.003
	04/09/10	53.94	3280.03	1,110	2,150	<0.001	<0.001	<0.001	<0.003
	07/09/10	54.94	3279.03	780	1,840	<0.001	<0.001	<0.001	<0.003
	10/06/10	54.98	3278.99	1,000	2,360	<0.001	<0.001	<0.001	<0.003
MW-4	07/13/09	52.28	3279.90	1,040	2,260	<0.001	<0.001	<0.001	<0.003
	10/08/09	52.23	3279.95	1,240	3,320	<0.001	<0.001	<0.001	<0.003
	01/06/10	52.23	3279.95	1,200	2,750	<0.001	<0.001	<0.001	<0.003
	04/09/10	52.24	3279.94	900	2,100	<0.001	<0.001	<0.001	<0.003
	07/09/10	52.76	3279.42	1,450	2,810	<0.001	<0.001	<0.001	<0.003
	10/06/10	52.83	3279.35	1,040	2,320	<0.001	<0.001	<0.001	<0.003
RW-1	07/13/09	53.02	3280.05	1,340	2,750	<0.001	<0.001	<0.001	<0.003
	10/08/09	53.01	3280.06	1,520	2,970	<0.001	<0.001	<0.001	<0.003
	01/06/10	53.04	3280.03	1,480	2,880	<0.001	<0.001	<0.001	<0.003
	04/09/10	53.06	3280.01	1,300	2,620	<0.001	<0.001	<0.001	<0.003
	07/09/10	---	---	1,260	2,750	<0.001	<0.001	<0.001	<0.003
	10/06/10	---	---	930	2,360	<0.001	<0.001	<0.001	<0.003

Chloride Concentrations Versus Time Graph

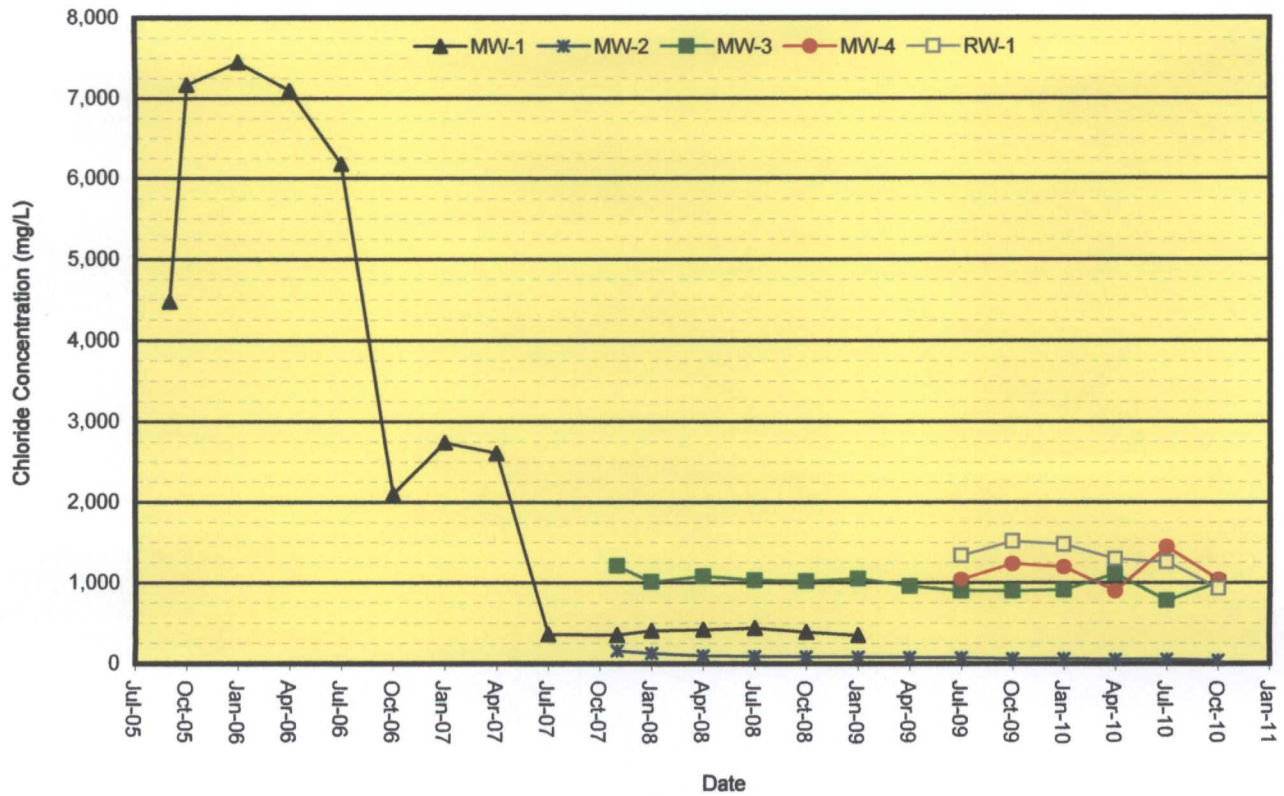

Total Dissolved Solids Concentrations Versus Time Graph

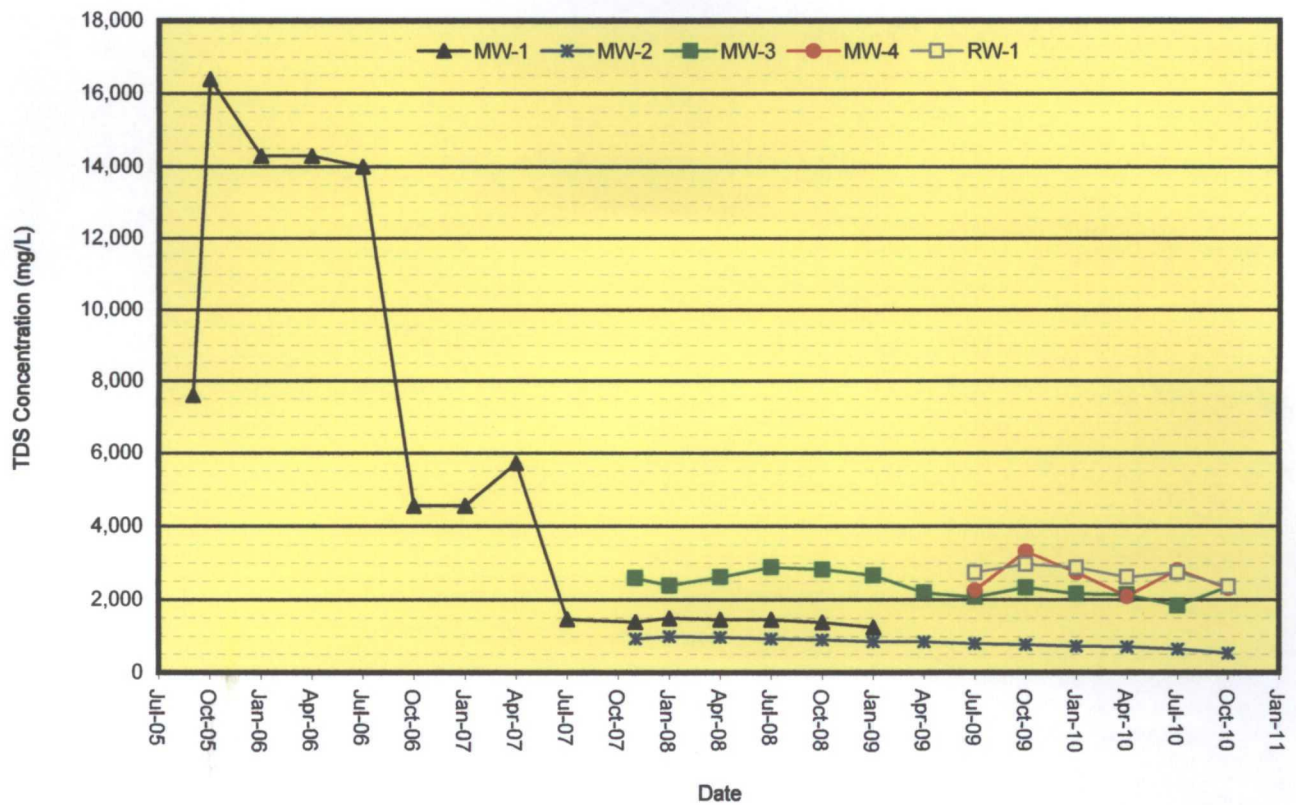



PHONE (575) 393-2326 • 101 E. MARLAND • HOBBS, NM 88240

October 14, 2010

Hack Conder
Rice Operating Company
112 W. Taylor
Hobbs, NM 88240

RE: BD SANTA RITA LEAK

Enclosed are the results of analyses for samples received by the laboratory on 10/08/10 11:10.

Cardinal Laboratories is accredited through Texas NELAP for:

Method SW-846 8021	Benzene, Toluene, Ethyl Benzene, and Total Xylenes
Method SW-846 8260	Benzene, Toluene, Ethyl Benzene, and Total Xylenes
Method TX 1005	Total Petroleum Hydrocarbons

Certificate number T104704398-08-TX. Accreditation applies to solid and chemical materials and non-potable water matrices.

Cardinal Laboratories is accredited through the State of Colorado Department of Public Health and Environment for:

Method EPA 552.2	Haloacetic Acids (HAA-5)
Method EPA 524.2	Total Trihalomethanes (TTHM)
Method EPA 524.4	Regulated VOCs (V2, V3)

Accreditation applies to public drinking water matrices.

This report meets NELAP requirements and is made up of a cover page, analytical results, and a copy of the original chain-of-custody. If you have any questions concerning this report, please feel free to contact me.

Sincerely,

Celey D. Keene
Lab Director/Quality Manager



PHONE (575) 393-2326 • 101 E. MARLAND • HOBBS, NM 88240

Analytical Results For:

Rice Operating Company
Hack Conder
112 W. Taylor
Hobbs NM, 88240
Fax To: (575) 397-1471

Received: 10/08/2010
Reported: 10/14/2010
Project Name: BD SANTA RITA LEAK
Project Number: NOT GIVEN
Project Location: T22S R37E SEC27 A-LEA CTY., NM

Sampling Date: 10/06/2010
Sampling Type: Water
Sampling Condition: Cool & Intact
Sample Received By: Jodi Henson

Sample ID: MONITOR WELL #2 (H021015-01)

BTX 8021B		mg/L		Analyzed By: cms					
Analyte	Result	Reporting Limit	Analyzed	Method Blank	BS	% Recovery	True Value QC	RPD	Qualifier
Benzene*	<0.001	0.001	10/12/2010	ND	0.018	88.5	0.0200		
Toluene*	<0.001	0.001	10/12/2010	ND	0.017	87.4	0.0200		
Ethylbenzene*	<0.001	0.001	10/12/2010	ND	0.018	89.2	0.0200		
Total Xylenes*	<0.003	0.003	10/12/2010	ND	0.052	86.1	0.0600		

Surrogate: 4-Bromofluorobenzene (PIL) 101 % 80-120

Chloride, SM4500Cl-B		mg/L		Analyzed By: HM					
Analyte	Result	Reporting Limit	Analyzed	Method Blank	BS	% Recovery	True Value QC	RPD	Qualifier
Chloride	40.0	4.00	10/13/2010	ND	100	100	100	0.00	

Sulfate 375.4		mg/L		Analyzed By: HM					
Analyte	Result	Reporting Limit	Analyzed	Method Blank	BS	% Recovery	True Value QC	RPD	Qualifier
Sulfate	115	10.0	10/13/2010	ND	38.9	97.2	40.0	5.36	

TDS 160.1		mg/L		Analyzed By: HM					
Analyte	Result	Reporting Limit	Analyzed	Method Blank	BS	% Recovery	True Value QC	RPD	Qualifier
TDS	530	5.00	10/13/2010	ND				10.8	

Cardinal Laboratories

*=Accredited Analyte

PLEASE NOTE: Liability and Damages. Cardinal's liability and client's exclusive remedy for any claim arising, whether based in contract or tort, shall be limited to the amount paid by client for analyses. All claims, including those for negligence and any other cause whatsoever shall be deemed waived unless made in writing and received by Cardinal within thirty (30) days after completion of the applicable service. In no event shall Cardinal be liable for incidental or consequential damages, including, without limitation, business interruptions, loss of use, or loss of profits incurred by client, its subsidiaries, affiliates or successors arising out of or related to the performance of the services hereunder by Cardinal, regardless of whether such claim is based upon any of the above stated reasons or otherwise. Results relate only to the samples identified above. This report shall not be reproduced except in full with written approval of Cardinal Laboratories.

Celey D. Keene, Lab Director/Quality Manager



PHONE (575) 393-2326 • 101 E. MARLAND • HOBBS, NM 88240

Analytical Results For:

Rice Operating Company
Hack Conder
112 W. Taylor
Hobbs NM, 88240
Fax To: (575) 397-1471

Received: 10/08/2010
Reported: 10/14/2010
Project Name: BD SANTA RITA LEAK
Project Number: NOT GIVEN
Project Location: T22S R37E SEC27 A-LEA CTY., NM

Sampling Date: 10/06/2010
Sampling Type: Water
Sampling Condition: Cool & Intact
Sample Received By: Jodi Henson

Sample ID: MONITOR WELL #3 (H021015-02)

BTX 8021B		mg/L		Analyzed By: cms					
Analyte	Result	Reporting Limit	Analyzed	Method Blank	BS	% Recovery	True Value QC	RPD	Qualifier
Benzene*	<0.001	0.001	10/12/2010	ND	0.018	88.5	0.0200		
Toluene*	<0.001	0.001	10/12/2010	ND	0.017	87.4	0.0200		
Ethylbenzene*	<0.001	0.001	10/12/2010	ND	0.018	89.2	0.0200		
Total Xylenes*	<0.003	0.003	10/12/2010	ND	0.052	86.1	0.0600		

Surrogate: 4-Bromofluorobenzene (PIL) 102 % 80-120

Chloride, SM4500Cl-B		mg/L		Analyzed By: HM					
Analyte	Result	Reporting Limit	Analyzed	Method Blank	BS	% Recovery	True Value QC	RPD	Qualifier
Chloride	1000	4.00	10/13/2010	ND	100	100	100	0.00	

Sulfate 375.4		mg/L		Analyzed By: HM					
Analyte	Result	Reporting Limit	Analyzed	Method Blank	BS	% Recovery	True Value QC	RPD	Qualifier
Sulfate	266	10.0	10/13/2010	ND	38.9	97.2	40.0	5.36	

TDS 160.1		mg/L		Analyzed By: HM					
Analyte	Result	Reporting Limit	Analyzed	Method Blank	BS	% Recovery	True Value QC	RPD	Qualifier
TDS	2360	5.00	10/13/2010	ND				10.8	

Cardinal Laboratories

*=Accredited Analyte

PLEASE NOTE: Liability and Damages. Cardinal's liability and client's exclusive remedy for any claim arising, whether based in contract or tort, shall be limited to the amount paid by client for analyses. All claims, including those for negligence and any other cause whatsoever shall be deemed waived unless made in writing and received by Cardinal within thirty (30) days after completion of the applicable service. In no event shall Cardinal be liable for incidental or consequential damages, including, without limitation, business interruptions, loss of use, or loss of profits incurred by client, its subsidiaries, affiliates or successors arising out of or related to the performance of the services hereunder by Cardinal, regardless of whether such claim is based upon any of the above stated reasons or otherwise. Results relate only to the samples identified above. This report shall not be reproduced except in full with written approval of Cardinal Laboratories.

Celey D. Keene, Lab Director/Quality Manager



PHONE (575) 393-2326 • 101 E. MARLAND • HOBBS, NM 88240

Analytical Results For:

Rice Operating Company
Hack Conder
112 W. Taylor
Hobbs NM, 88240
Fax To: (575) 397-1471

Received: 10/08/2010
Reported: 10/14/2010
Project Name: BD SANTA RITA LEAK
Project Number: NOT GIVEN
Project Location: T22S R37E SEC27 A-LEA CTY., NM

Sampling Date: 10/06/2010
Sampling Type: Water
Sampling Condition: Cool & Intact
Sample Received By: Jodi Henson

Sample ID: MONITOR WELL #4 (H021015-03)

BTX 8021B		mg/L		Analyzed By: cms						
Analyte	Result	Reporting Limit	Analyzed	Method Blank	BS	% Recovery	True Value QC	RPD	Qualifier	
Benzene*	<0.001	0.001	10/12/2010	ND	0.018	88.5	0.0200			
Toluene*	<0.001	0.001	10/12/2010	ND	0.017	87.4	0.0200			
Ethylbenzene*	<0.001	0.001	10/12/2010	ND	0.018	89.2	0.0200			
Total Xylenes*	<0.003	0.003	10/12/2010	ND	0.052	86.1	0.0600			

Surrogate: 4-Bromofluorobenzene (PIL) 102 % 80-120

Chloride, SM4500Cl-B		mg/L		Analyzed By: HM						
Analyte	Result	Reporting Limit	Analyzed	Method Blank	BS	% Recovery	True Value QC	RPD	Qualifier	
Chloride	1040	4.00	10/13/2010	ND	100	100	100	0.00		

Sulfate 375.4		mg/L		Analyzed By: HM						
Analyte	Result	Reporting Limit	Analyzed	Method Blank	BS	% Recovery	True Value QC	RPD	Qualifier	
Sulfate	251	10.0	10/13/2010	ND	38.9	97.2	40.0	5.36		

TDS 160.1		mg/L		Analyzed By: HM						
Analyte	Result	Reporting Limit	Analyzed	Method Blank	BS	% Recovery	True Value QC	RPD	Qualifier	
TDS	2320	5.00	10/13/2010	ND				10.8		

Cardinal Laboratories

*=Accredited Analyte

PLEASE NOTE: Liability and Damages. Cardinal's liability and client's exclusive remedy for any claim arising, whether based in contract or tort, shall be limited to the amount paid by client for analyses. All claims, including those for negligence and any other cause whatsoever shall be deemed waived unless made in writing and received by Cardinal within thirty (30) days after completion of the applicable service. In no event shall Cardinal be liable for incidental or consequential damages, including, without limitation, business interruptions, loss of use, or loss of profits incurred by client, its subsidiaries, affiliates or successors arising out of or related to the performance of the services hereunder by Cardinal, regardless of whether such claim is based upon any of the above stated reasons or otherwise. Results relate only to the samples identified above. This report shall not be reproduced except in full with written approval of Cardinal Laboratories.

Celey D. Keene, Lab Director/Quality Manager



PHONE (575) 393-2326 • 101 E. MARLAND • HOBBS, NM 88240

Analytical Results For:

Rice Operating Company
Hack Conder
112 W. Taylor
Hobbs NM, 88240
Fax To: (575) 397-1471

Received: 10/08/2010
Reported: 10/14/2010
Project Name: BD SANTA RITA LEAK
Project Number: NOT GIVEN
Project Location: T22S R37E SEC27 A-LEA CTY., NM

Sampling Date: 10/06/2010
Sampling Type: Water
Sampling Condition: Cool & Intact
Sample Received By: Jodi Henson

Sample ID: RECOVERY WELL #1 (H021015-04)

BTEX 8021B

mg/L

Analyzed By: cms

Analyte	Result	Reporting Limit	Analyzed	Method Blank	BS	% Recovery	True Value QC	RPD	Qualifier
Benzene*	<0.001	0.001	10/12/2010	ND	0.018	88.5	0.0200		
Toluene*	<0.001	0.001	10/12/2010	ND	0.017	87.4	0.0200		
Ethylbenzene*	<0.001	0.001	10/12/2010	ND	0.018	89.2	0.0200		
Total Xylenes*	<0.003	0.003	10/12/2010	ND	0.052	86.1	0.0600		

Surrogate: 4-Bromofluorobenzene (PIL 100 % 80-120

Chloride, SM4500Cl-B

mg/L

Analyzed By: HM

Analyte	Result	Reporting Limit	Analyzed	Method Blank	BS	% Recovery	True Value QC	RPD	Qualifier
Chloride	930	4.00	10/13/2010	ND	100	100	100	0.00	

Sulfate 375.4

mg/L

Analyzed By: HM

Analyte	Result	Reporting Limit	Analyzed	Method Blank	BS	% Recovery	True Value QC	RPD	Qualifier
Sulfate	298	10.0	10/13/2010	ND	38.9	97.2	40.0	5.36	

TDS 160.1

mg/L

Analyzed By: HM

Analyte	Result	Reporting Limit	Analyzed	Method Blank	BS	% Recovery	True Value QC	RPD	Qualifier
TDS	2360	5.00	10/13/2010	ND				10.8	

Cardinal Laboratories

*=Accredited Analyte

PLEASE NOTE: Liability and Damages. Cardinal's liability and client's exclusive remedy for any claim arising, whether based in contract or tort, shall be limited to the amount paid by client for analyses. All claims, including those for negligence and any other cause whatsoever shall be deemed waived unless made in writing and received by Cardinal within thirty (30) days after completion of the applicable service. In no event shall Cardinal be liable for incidental or consequential damages, including, without limitation, business interruptions, loss of use, or loss of profits incurred by client, its subsidiaries, affiliates or successors arising out of or related to the performance of the services hereunder by Cardinal, regardless of whether such claim is based upon any of the above stated reasons or otherwise. Results relate only to the samples identified above. This report shall not be reproduced except in full with written approval of Cardinal Laboratories.

Celey D. Keene, Lab Director/Quality Manager



PHONE (575) 393-2326 • 101 E. MARLAND • HOBBS, NM 88240

Notes and Definitions

ND	Analyte NOT DETECTED at or above the reporting limit
RPD	Relative Percent Difference
**	Samples not received at proper temperature of 6°C or below.
***	Insufficient time to reach temperature.
-	Chloride by SM4500Cl-B does not require samples be received at or below 6°C Samples reported on an as received basis (wet) unless otherwise noted on report

Cardinal Laboratories

*=Accredited Analyte

PLEASE NOTE: Liability and Damages. Cardinal's liability and client's exclusive remedy for any claim arising, whether based in contract or tort, shall be limited to the amount paid by client for analyses. All claims, including those for negligence and any other cause whatsoever shall be deemed waived unless made in writing and received by Cardinal within thirty (30) days after completion of the applicable service. In no event shall Cardinal be liable for incidental or consequential damages, including, without limitation, business interruptions, loss of use, or loss of profits incurred by client, its subsidiaries, affiliates or successors arising out of or related to the performance of the services hereunder by Cardinal, regardless of whether such claim is based upon any of the above stated reasons or otherwise. Results relate only to the samples identified above. This report shall not be reproduced except in full with written approval of Cardinal Laboratories.

Celey D. Keene, Lab Director/Quality Manager

Cardinal Laboratories, Inc.

101 East Marland - Hobbs, New Mexico 88240
Tel (575) 393-2326
Fax (575) 393-2476

Company Name: RICE Operating Company	BILL TO Company: RICE Operating Company
Project Manager: Hack Conder	Address: 122 W Taylor Street - Hobbs, New Mexico 88240
Address: 122 W Taylor Street - Hobbs, New Mexico 88240	Phone #: (575) 393-9174
Phone #: (575) 393-9174	Phone #: (575) 393-9174
Phone #: (575) 393-9174	Phone #: (575) 393-9174

Project #: _____ Project Name: _____
BD Santa Rita Leak
Project Location: _____
T22S R37E Sec27A - Lea County New Mexico
Sampler Signature: _____
Brazanne Johnson 5759831-8310
Brazanne Johnson 5759831-8310

20
 21
 22
 23
 24
 25
 26
 27
 28
 29
 30
 31
 32
 33
 34
 35
 36
 37
 38
 39
 40
 41
 42
 43
 44
 45
 46
 47
 48
 49
 50
 51
 52
 53
 54
 55
 56
 57
 58
 59
 60
 61
 62
 63
 64
 65
 66
 67
 68
 69
 70
 71
 72
 73
 74
 75
 76
 77
 78
 79
 80
 81
 82
 83
 84
 85
 86
 87
 88
 89
 90
 91
 92
 93
 94
 95
 96
 97
 98
 99
 100
 101
 102
 103
 104
 105
 106
 107
 108
 109
 110
 111
 112
 113
 114
 115
 116
 117
 118
 119
 120
 121
 122
 123
 124
 125
 126
 127
 128
 129
 130
 131
 132
 133
 134
 135
 136
 137
 138
 139
 140
 141
 142
 143
 144
 145
 146
 147
 148
 149
 150
 151
 152
 153
 154
 155
 156
 157
 158
 159
 160
 161
 162
 163
 164
 165
 166
 167
 168
 169
 170
 171
 172
 173
 174
 175
 176
 177
 178
 179
 180
 181
 182
 183
 184
 185
 186
 187
 188
 189
 190
 191
 192
 193
 194
 195
 196
 197
 198
 199
 200
 201
 202
 203
 204
 205
 206
 207
 208
 209
 210
 211
 212
 213
 214
 215
 216
 217
 218
 219
 220
 221
 222
 223
 224
 225
 226
 227
 228
 229
 230
 231
 232
 233
 234
 235
 236
 237
 238
 239
 240
 241
 242
 243
 244
 245
 246
 247
 248
 249
 250
 251
 252
 253
 254
 255
 256
 257
 258
 259
 260
 261
 262
 263
 264
 265
 266
 267
 268
 269
 270
 271
 272
 273
 274
 275
 276
 277
 278
 279
 280
 281
 282
 283
 284
 285
 286
 287
 288
 289
 290
 291
 292
 293
 294
 295
 296
 297
 298
 299
 300
 301
 302
 303
 304
 305
 306
 307
 308
 309
 310
 311
 312
 313
 314
 315
 316
 317
 318
 319
 320
 321
 322
 323
 324
 325
 326
 327
 328
 329
 330
 331
 332
 333
 334
 335
 336
 337
 338
 339
 340
 341
 342
 343
 344
 345
 346
 347
 348
 349
 350
 351
 352
 353
 354
 355
 356
 357
 358
 359
 360
 361
 362
 363
 364
 365
 366
 367
 368
 369
 370
 371
 372
 373
 374
 375
 376
 377
 378
 379
 380
 381
 382
 383
 384
 385
 386
 387
 388
 389
 390
 391
 392
 393
 394
 395
 396
 397
 398
 399
 400
 401
 402
 403
 404
 405
 406
 407
 408
 409
 410
 411
 412
 413
 414
 415
 416
 417
 418
 419
 420
 421
 422
 423
 424
 425
 426
 427
 428
 429
 430
 431
 432
 433
 434
 435
 436
 437
 438
 439
 440
 441
 442
 443
 444
 445
 446
 447
 448
 449
 450
 451
 452
 453
 454
 455
 456
 457
 458
 459
 460
 461
 462
 463
 464
 465
 466
 467
 468
 469
 470
 471
 472
 473
 474
 475
 476
 477
 478
 479
 480
 481
 482
 483
 484
 485
 486
 487
 488
 489
 490
 491
 492
 493
 494
 495
 496
 497
 498
 499
 500
 501
 502
 503
 504
 505
 506
 507
 508
 509
 510
 511
 512
 513
 514
 515
 516
 517
 518
 519
 520
 521
 522
 523
 524
 525
 526
 527
 528
 529
 530
 531
 532
 533
 534
 535
 536
 537
 538
 539
 540
 541

[illegible]

Relinquished by: Rozanne Johnson Date: 10-2-2010 Time: 11:09
Received by: _____ Date: _____ Time: _____

Relinquished by:	Date:	Time:
Received By: (Laboratory Staff)	Date:	Time:

Mr. Jensen *6/8/10* *11:10*

Delivered By: <u> </u>	(Circle One)	Sample Condition	Checked By: <u> </u>
UPS	Bus	Other	(Initials)
Yes	Yes	Yes	
No	No	No	
Intact			

#26

CHAIN-OF-CUSTODY AND ANALYSIS REQUEST

LAB Order ID #:

ANALYSIS REQUEST
(Circle or Specify Method No.)[illegible]

Phone Results	Yes	No
Fax Results	Yes	No
Additional Fax Number		

REMARKS:

Em Email Results & hconder@nceswd.com
twelnhelmer@nceswd.com
rkidnes@nceswd.com
rozanne@valonet.com