

DATE IN 4/24/12	SUSPENSE	ENGINEER DB	LOGGED IN 4/24/12	TYPE NSL	APP NO. 1211538481
-----------------	----------	-------------	-------------------	----------	--------------------

ABOVE THIS LINE FOR DIVISION USE ONLY

**NEW MEXICO OIL CONSERVATION DIVISION**  
 - Engineering Bureau -  
 1220 South St. Francis Drive, Santa Fe, NM 87505



C06

Ehony State II 3  
 30-015-39411

**ADMINISTRATIVE APPLICATION CHECKLIST**

THIS CHECKLIST IS MANDATORY FOR ALL ADMINISTRATIVE APPLICATIONS FOR EXCEPTIONS TO DIVISION RULES AND REGULATIONS WHICH REQUIRE PROCESSING AT THE DIVISION LEVEL IN SANTA FE

**Application Acronyms:**

[NSL-Non-Standard Location] [NSP-Non-Standard Proration Unit] [SD-Simultaneous Dedication]  
 [DHC-Downhole Commingling] [CTB-Lease Commingling] [PLC-Pool/Lease Commingling]  
 [PC-Pool Commingling] [OLS - Off-Lease Storage] [OLM-Off-Lease Measurement]  
 [WFX-Waterflood Expansion] [PMX-Pressure Maintenance Expansion]  
 [SWD-Salt Water Disposal] [IPI-Injection Pressure Increase]  
 [EOR-Qualified Enhanced Oil Recovery Certification] [PPR-Positive Production Response]

6623

[1] **TYPE OF APPLICATION** - Check Those Which Apply for [A]

[A] Location - Spacing Unit - Simultaneous Dedication  
☒ NSL ☐ NSP ☐ SD

Check One Only for [B] or [C]

[B] Commingling - Storage - Measurement  
☐ DHC ☐ CTB ☐ PLC ☐ PC ☐ OLS ☐ OLM

[C] Injection - Disposal - Pressure Increase - Enhanced Oil Recovery  
☐ WFX ☐ PMX ☐ SWD ☐ IPI ☐ EOR ☐ PPR

[D] Other: Specify \_\_\_\_\_

H-25-175-27E  
 2012 APR 24 A 10:04  
 RECEIVED OOD

[2] **NOTIFICATION REQUIRED TO:** - Check Those Which Apply, or ☐ Does Not Apply

INTEREST ARE THE SAME

[A] ☐ Working, Royalty or Overriding Royalty Interest Owners

[B] ☒ Offset Operators, Leaseholders or Surface Owner

[C] ☐ Application is One Which Requires Published Legal Notice

[D] ☐ Notification and/or Concurrent Approval by BLM or SLO  
 U.S. Bureau of Land Management - Commissioner of Public Lands, State Land Office

[E] ☒ For all of the above, Proof of Notification or Publication is Attached, and/or,

[F] ☐ Waivers are Attached

[3] **SUBMIT ACCURATE AND COMPLETE INFORMATION REQUIRED TO PROCESS THE TYPE OF APPLICATION INDICATED ABOVE.**

[4] **CERTIFICATION:** I hereby certify that the information submitted with this application for administrative approval is **accurate** and **complete** to the best of my knowledge. I also understand that **no action** will be taken on this application until the required information and notifications are submitted to the Division.

**Note:** Statement must be completed by an individual with managerial and/or supervisory capacity.

Kelly J. Holly  
 Print or Type Name

Signature

Permitting Tech  
 Title

4-23-12  
 Date

(432) 685-4384  
 Phone Number

kholly@concho.com  
 E-mail Address

**Ebony State #3  
Eddy County, NM**

COG proposes to drill a **VERTICAL** SE/4 NE/4, 40 acre spacing  
Red Lake; Glorieta Yeso, Northeast oil well  
TD of approximately 4750'

**Location:**

1515' FNL & 990' FEL      Sec 25, T17S, R27E, Unit H

**This well had to be drilled at a non-standard location due to electrical lines too close to original location.**

The plan for this well is to complete it in the Yeso formation.

We won't know the exact perms until we drill & log it, but it will be very similar to the Kool Aid State #3 (2160' FNL & 2310' FEL, Section 24, T17S, R28E, UL G) which was completed in March 2009.

The Kool Aid State #3 completion has Yeso perms from 4280' – 5070', divided into 3 perm/stimulation intervals.

1<sup>st</sup> interval: 4280' – 4480',  
acidized w/ 2500 gals,  
frac w/ 111,450 gal Slvr Stm gel, 140,141# White, & 33,172# CRC.

2<sup>nd</sup> interval: 4590' – 4790',  
acidized w/ 2500 gals,  
frac w/ 112,168 gal Slvr Stm gel, 132,583# White, & 34,283# CRC.

3<sup>rd</sup> interval: 4870' – 5070',  
acidized w/ 2500 gals,  
frac w/ 115,495 gal Slvr Stm gel, 143,285# White, & 36,640# CRC.

**Attachment 1**

Plat & map

**Attachment 2**

Map & legend of offset wells.

**Attachment 3**

Updated land plat showing COG Operating LLC acreage.

The acreage we are encroaching on is the NE/4 NE/4, NW/4 NE/4 and SW/4 NE/4 of Section 25.

Offset acreage is owned by Oxy USA ~~WTP LP~~, Chase Oil Corp, Mack C. Chase & Marilyn Y Chase Trust, Robert C. Chase, Richard L. Chase & Gerene Dianne Chase.

Proof of Notification is enclosed.

OG Operating LLC respectfully requests permission to have this NSL approved.

DISTRICT I  
1625 N. FRENCH DR., HOBBS, NM 88240  
DISTRICT II  
1301 W. GRAND AVENUE, ARTESIA, NM 88210  
DISTRICT III  
1000 RIO BRAZOS RD., AZTEC, NM 87410  
DISTRICT IV  
11885 S. ST. FRANCIS DR., SANTA FE, NM 87505

State of New Mexico  
Energy, Minerals & Natural Resources Department  
**OIL CONSERVATION DIVISION**  
1220 South St. Francis Dr.  
Santa Fe, New Mexico 87505

Form C-102  
Revised July 16, 2010  
Submit to Appropriate  
District Office

☐ AMENDED REPORT

**WELL LOCATION AND ACREAGE DEDICATION PLAT**

API Number 30-015	Pool Code 96836	Pool Name Red Lake; Glorieta-Yeso, Northeast
Property Code	Property Name <b>EBONY STATE</b>	Well Number 3
OGRID No. 229137	Operator Name <b>COG OPERATING, LLC</b>	Elevation 3535'

Surface Location

UL or lot No. H	Section 25	Township 17-S	Range 27-E	Lot Idn	Feet from the 1515	North/South line NORTH	Feet from the 990	East/West line EAST	County EDDY
--------------------	---------------	------------------	---------------	---------	-----------------------	---------------------------	----------------------	------------------------	----------------

Bottom Hole Location If Different From Surface

UL or lot No.	Section	Township	Range	Lot Idn	Feet from the	North/South line	Feet from the	East/West line	County
---------------	---------	----------	-------	---------	---------------	------------------	---------------	----------------	--------

Dedicated Acres 40	Joint or Infill	Consolidation Code	Order No.
-----------------------	-----------------	--------------------	-----------

NO ALLOWABLE WILL BE ASSIGNED TO THIS COMPLETION UNTIL ALL INTERESTS HAVE BEEN CONSOLIDATED OR A NON-STANDARD UNIT HAS BEEN APPROVED BY THE DIVISION

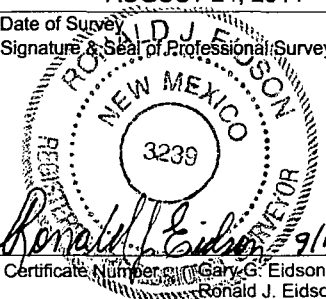
<p>GEODETIC COORDINATES NAD 27 NME SURFACE LOCATION Y=657693.2 N X=532867.2 E LAT.=32.808042° N LONG.=104.226360° W</p>	<p>1515'</p> <p>990'</p> <p>S.L. SEE DETAIL</p>	<p><b>OPERATOR CERTIFICATION</b></p> <p>I hereby certify that the information herein is true and complete to the best of my knowledge and belief, and that this organization either owns a working interest or unleased mineral interest in the land including the proposed bottom hole location or has a right to drill this well at this location pursuant to a contract with an owner of such mineral or working interest, or to a voluntary pooling agreement or a compulsory pooling order heretofore entered by the division.</p> <p> 9-15-11 Signature Date Kelly J. Holly Printed Name kholly@concho.com E-mail Address</p> <p><b>SURVEYOR CERTIFICATION</b></p> <p>I hereby certify that the well location shown on this plat was plotted from field notes of actual surveys made by me or under my supervision, and that the same is true and correct to the best of my belief.</p> <p>AUGUST 24, 2011 Date of Survey Signature &amp; Seal of Professional Surveyor:  Certificate Number 12641 Ronald J. Eidson 3239 LA JWSC W.O.: 11.11.1767</p>
---	---	---

**SECTION 25, TOWNSHIP 17 SOUTH, RANGE 27 EAST, N.M.P.M.**  
 EDDY COUNTY NEW MEXICO

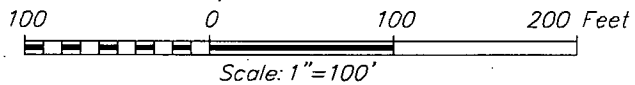
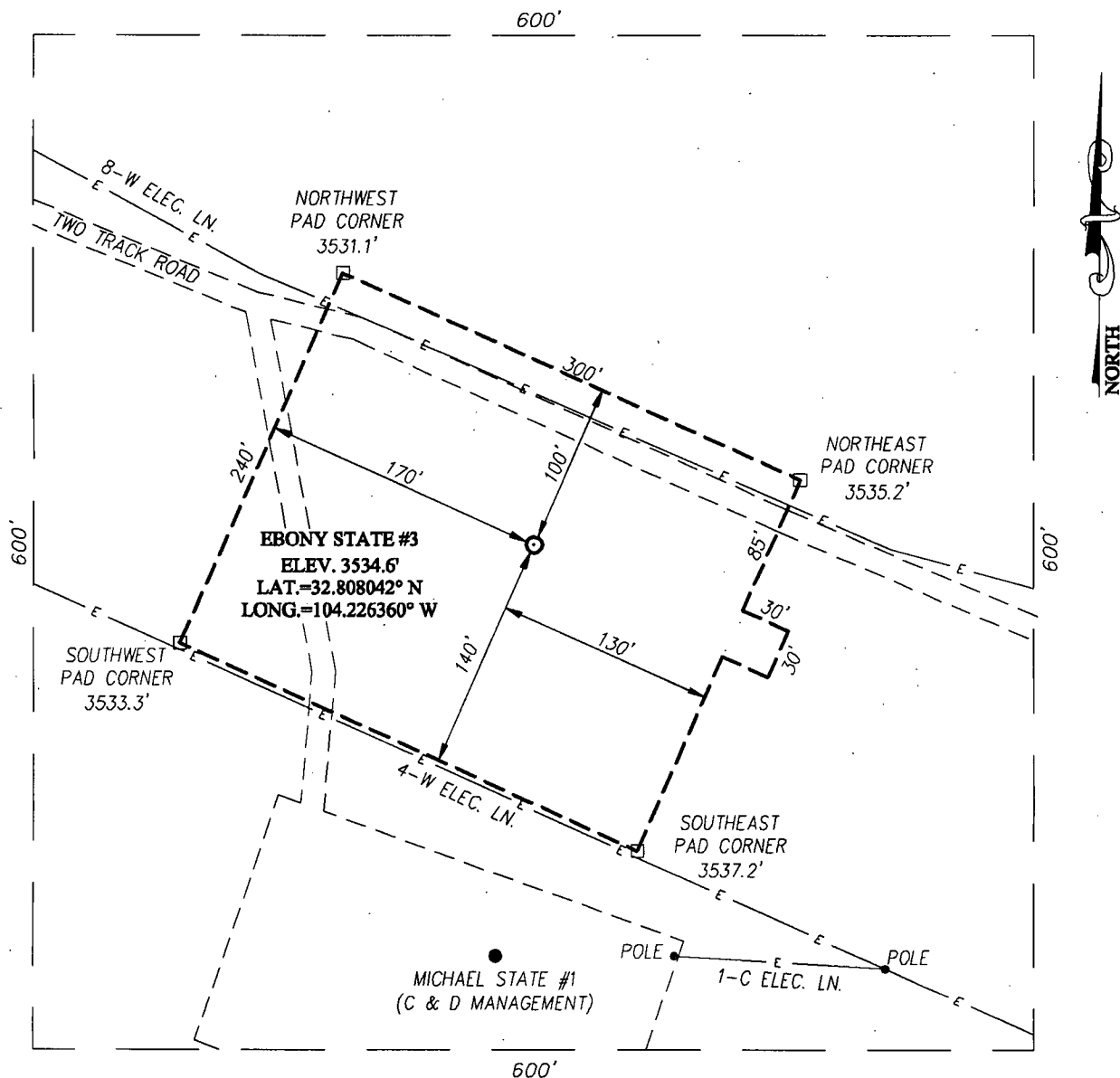

**DIRECTIONS TO LOCATION**

FROM THE INTERSECTION OF U.S. HWY. #82 AND CO. RD. #204 (HILLTOP), HEADING SOUTHEAST ON HWY. #82 ON APPROX. 1.0 MILES. TURN LEFT AND GO NORTH APPROX. 0.15 FEET. TURN LEFT AND GO NORTHWEST APPROX. 0.2 MILES. THE LOCATION STAKE IS APPROX. 300 FEET SOUTH.

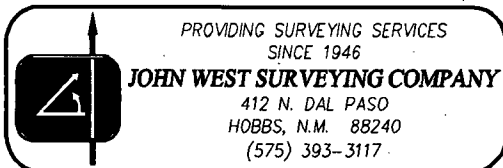

**COG OPERATING, LLC**

EBONY STATE #3 WELL  
 LOCATED 1515 FEET FROM THE NORTH LINE  
 AND 990 FEET FROM THE EAST LINE OF SECTION 25,  
 TOWNSHIP 17 SOUTH, RANGE 27 EAST, N.M.P.M.,  
 EDDY COUNTY, NEW MEXICO

Survey Date: 8/24/11	Sheet 1 of 1 Sheets
W.O. Number: 11.11.1767	Dr. By: LA
Date: 9/9/11	Rel. W.O.: 1111767
	Scale: 1"=100'

## Producing Wells in Sec 25, T17S, R27E, Eddy County

API#	Operator	Lease	Well#	County	Legal	Total Depth	Well Type	Well Status	First Prod.	Last Prod.	Avg. (BO/D)
30-015-01238	SDX RESOURCES INC	BERRY B	023	EDDY	S:25, T:17S, R:27E	0	O	Shut-in	Jan 1969	Jan 2000	0.03
30-015-24877	C&D MANAGEMENT COMPANY DBA FREEDOM VENTURES	MICHAEL STATE	001	EDDY	S:25, T:17S, R:27E	2,038	PG	Active	Oct 1984	Sep 2010	0.03
30-015-00525	GEORGE A CHASE JR DBA G AND C SERVICE	BRAINARD	002	EDDY	S:25, T:17S, R:27E	0	O	Temporarily Abandoned	Apr 1950	Aug 2011	0.06
30-015-00526	ASPEN OIL INC	BRAINARD	001	EDDY	S:25, T:17S, R:27E		PO	Temporarily Abandoned	Feb 1949	Jan 1996	0.10
30-015-32694	COG OPERATING LLC	REDBUD FEDERAL	001	EDDY	S:25, T:17S, R:27E	7,130	O	Active	Dec 2003	Aug 2011	0.13
30-015-32927	MACK ENERGY CORP	DOGWOOD FEDERAL	1	EDDY	S:25, T:17S, R:27E	7,331	O	Active	Dec 2003	Jan 2008	0.16
30-015-32927	COG OPERATING LLC	DOGWOOD FEDERAL	1	EDDY	S:25, T:17S, R:27E	7,331	O	Active	Jan 2008	Jan 2008	0.16
30-015-00526	BEDINGFIELD, J. E.	BRAINARD	001	EDDY	S:25, T:17S, R:27E		PO	Temporarily Abandoned	Jan 1948	Dec 1955	0.26
30-015-00525	BEDINGFIELD, J. E.	BRAINARD	002	EDDY	S:25, T:17S, R:27E	0	O	Temporarily Abandoned	Jan 1953	Dec 1955	0.29
30-015-00516	DORAL ENERGY CORP.	BERRY B	024	EDDY	S:25, T:17S, R:27E	0	PO	Active	Jan 1964	Oct 2010	0.32
30-015-24098	MWJ PRODUCING CO	ROPER FEDERAL	001	EDDY	S:25, T:17S, R:27E	0	PO	Pumping	May 1982	Jan 1991	0.32
30-015-32694	MACK ENERGY CORP	REDBUD FEDERAL	001	EDDY	S:25, T:17S, R:27E	7,130	O	Active	Oct 2003	Dec 2003	0.35
30-015-32299	LIME ROCK RESOURCES A, L.P.	ENRON FEDERAL	005	EDDY	S:25, T:17S, R:27E	3,185	O	Active	Aug 2002	Aug 2011	0.42
30-015-00525	MANN F FEDERAL	BRAINARD	002	EDDY	S:25, T:17S, R:27E	0	O	Temporarily Abandoned	Jan 1958	Dec 1971	0.42
30-015-00578	LATCH, LEONARD	BERRY	025	EDDY	S:25, T:17S, R:27E	0	O	Pumping	Nov 1955	Dec 1965	0.45
					S:25,						

30-015-00000	NIX & CURTIS	DELHI STATE	002	EDDY	T:17S, R:27E		O	Active	Jan 1953	Jul 1953	0.45
30-015-00000	NIX & CURTIS	DELHI STATE	'2-5	EDDY	S:25, T:17S, R:27E		O	Active	Jan 1956	Nov 1957	0.47
30-015-01238	LEONARD LATCH	BERRY B	023	EDDY	S:25, T:17S, R:27E	0	O	Shut-in	Jan 1958	Dec 1971	0.48
30-015-00578	LEONARD LATCH	BERRY B	025	EDDY	S:25, T:17S, R:27E	0	O	Pumping	Jan 1956	Dec 1971	0.48
30-015-32694	MACK ENERGY CORP	REDBUD FEDERAL	001	EDDY	S:25, T:17S, R:27E	7,130	O	Active	May 2003	Oct 2003	0.61
30-015-00000	DEAN WHITE OIL CO.	BERRY	023	EDDY	S:25, T:17S, R:27E		O	Active	Nov 1951	Dec 1952	0.65
30-015-30812	COG OPERATING LLC	BEECH FEDERAL	001	EDDY	S:25, T:17S, R:27E	7,244	O	Pumping	Jan 2000	Aug 2011	1.23
30-015-00516	LEONARD LATCH	BERRY B	024	EDDY	S:25, T:17S, R:27E	0	PO	Active	Jan 1959	Dec 1971	1.29
30-015-00000	LATCHE, LEONARD	BERRY	'23-24	EDDY	S:25, T:17S, R:27E		O	Active	Jan 1956	Dec 1957	1.61
30-015-00516	LATCH, LEONARD	BERRY	024	EDDY	S:25, T:17S, R:27E	0	PO	Active	Jan 1955	Dec 1965	1.61
30-015-01155		DELHI STATE	005	EDDY	S:25, T:17S, R:27E		O	Active	Jan 1959	Jun 1966	1.67
30-015-00000	BEDINGFIELD J.E.	BRAINARD	001	EDDY	S:25, T:17S, R:27E		O	Active	Apr 1947	Nov 1947	1.80
30-015-00000		DELHI STATE	002	EDDY	S:25, T:17S, R:27E		O	Active	Mar 1952	Feb 1964	2.00
30-015-31927	MARBOB ENERGY CORP	STATE 25	1	EDDY	S:25, T:17S, R:27E	8,130	O	Flowing	Sep 2001	Aug 2011	2.10
30-015-31994	MARBOB ENERGY CORP	STATE 25	002	EDDY	S:25, T:17S, R:27E	8,150	O	Flowing	Nov 2001	Aug 2011	2.13
30-015-01238	LATCH, LEONARD	BERRY	023	EDDY	S:25, T:17S, R:27E	0	O	Shut-in	Jan 1953	Dec 1955	2.16
30-015-32300	LIME ROCK RESOURCES A, L.P.	ENRON FEDERAL	006	EDDY	S:25, T:17S, R:27E	3,180	O	Active	Dec 2002	Aug 2011	2.61
					S:25,						

30-015-32551	LIME ROCK RESOURCES A, L.P.	ENRON FEDERAL	7	EDDY	T:17S, R:27E	3,223	O	Active	Apr 2009	Aug 2011	2.61
30-015-31283	LIME ROCK RESOURCES A, L.P.	RESLER STATE	1	EDDY	S:25, T:17S, R:27E	3,600	O	Pumping	Nov 2002	Aug 2011	2.71
30-015-32662	LIME ROCK RESOURCES A, L.P.	ENRON FEDERAL	008	EDDY	S:25, T:17S, R:27E	3,220	O	Active	May 2003	Aug 2011	3.45
30-015-38514	LIME ROCK RESOURCES A, L.P.	RESLER STATE	4	EDDY	S:25, T:17S, R:27E	3,862	U	Active Permit	May 2011	Aug 2011	4.03
30-015-32163	LIME ROCK RESOURCES A, L.P.	ENRON FEDERAL	3	EDDY	S:25, T:17S, R:27E	3,177	O	Pumping	Mar 2002	Aug 2011	4.39
30-015-32036	LIME ROCK RESOURCES A, L.P.	ENRON FEDERAL	9	EDDY	S:25, T:17S, R:27E	7,950	PO	Active	Sep 2006	Aug 2011	5.23
30-015-32927	COG OPERATING LLC	DOGWOOD FEDERAL	1	EDDY	S:25, T:17S, R:27E	7,331	O	Active	Feb 2008	Aug 2011	7.13
30-015-35973	LIME ROCK RESOURCES A, L.P.	RESLER STATE	2	EDDY	S:25, T:17S, R:27E	3,830	U	Active Permit	Jan 2009	Aug 2011	7.81
30-015-31283	SDX RESOURCES INC	RESLER STATE	1	EDDY	S:25, T:17S, R:27E	3,600	O	Pumping	Oct 2000	Oct 2002	10.35
30-015-37313	LIME ROCK RESOURCES A, L.P.	RESLER STATE	3	EDDY	S:25, T:17S, R:27E	3,855	O	Active Permit	Feb 2010	Aug 2011	12.39
30-015-37641	LIME ROCK RESOURCES A, L.P.	ENRON FEDERAL	11	EDDY	S:25, T:17S, R:27E	3,258	O	Active Permit	May 2010	Aug 2011	15.42
30-015-24092	COG OPERATING LLC	SPRUCE FEDERAL	001	EDDY	S:25, T:17S, R:27E	9,985	G	Pumping	Jan 2010	Aug 2011	17.16
30-015-32036	SDX RESOURCES INC	ENRON FEDERAL	9	EDDY	S:25, T:17S, R:27E	7,950	PO	Active	Sep 2006	Dec 2006	17.55
30-015-37217	LIME ROCK RESOURCES A, L.P.	ENRON FEDERAL	10	EDDY	S:25, T:17S, R:27E	3,233	O	Active Permit	Apr 2010	Aug 2011	24.52
30-015-31790	COG OPERATING LLC	BEECH FEDERAL	2	EDDY	S:25, T:17S, R:27E	7,800	PO	Pumping	Jul 2010	Aug 2011	52.10
30-015-31790	COG OPERATING LLC	BEECH FEDERAL	2	EDDY	S:25, T:17S, R:27E	7,800	PO	Pumping	Jul 2001	Jul 2010	62.77
30-015-00578	DORAL ENERGY CORP.	BERRY B	025	EDDY	S:25, T:17S, R:27E	0	O	Pumping	Jan 1964	Mar 2011	
					S:25,						

30-015-24092	COG OPERATING LLC	SPRUCE FEDERAL	001	EDDY	T:17S, R:27E	9,985	G	Pumping	Jul 1999	Dec 2009	
30-015-31991	OXY USA WTP LIMITED PARTNERSHIP	OXY MEARBALL STATE	001	EDDY	S:25, T:17S, R:27E	9,810	G	Pumping	Dec 2001	Aug 2011	
30-015-32069	COG OPERATING LLC	FIR FEDERAL	001	EDDY	S:25, T:17S, R:27E	7,208	O	Pumping	Feb 2002	Aug 2011	



### Producing Wells in Sec 25, T17S, R27E, Eddy County

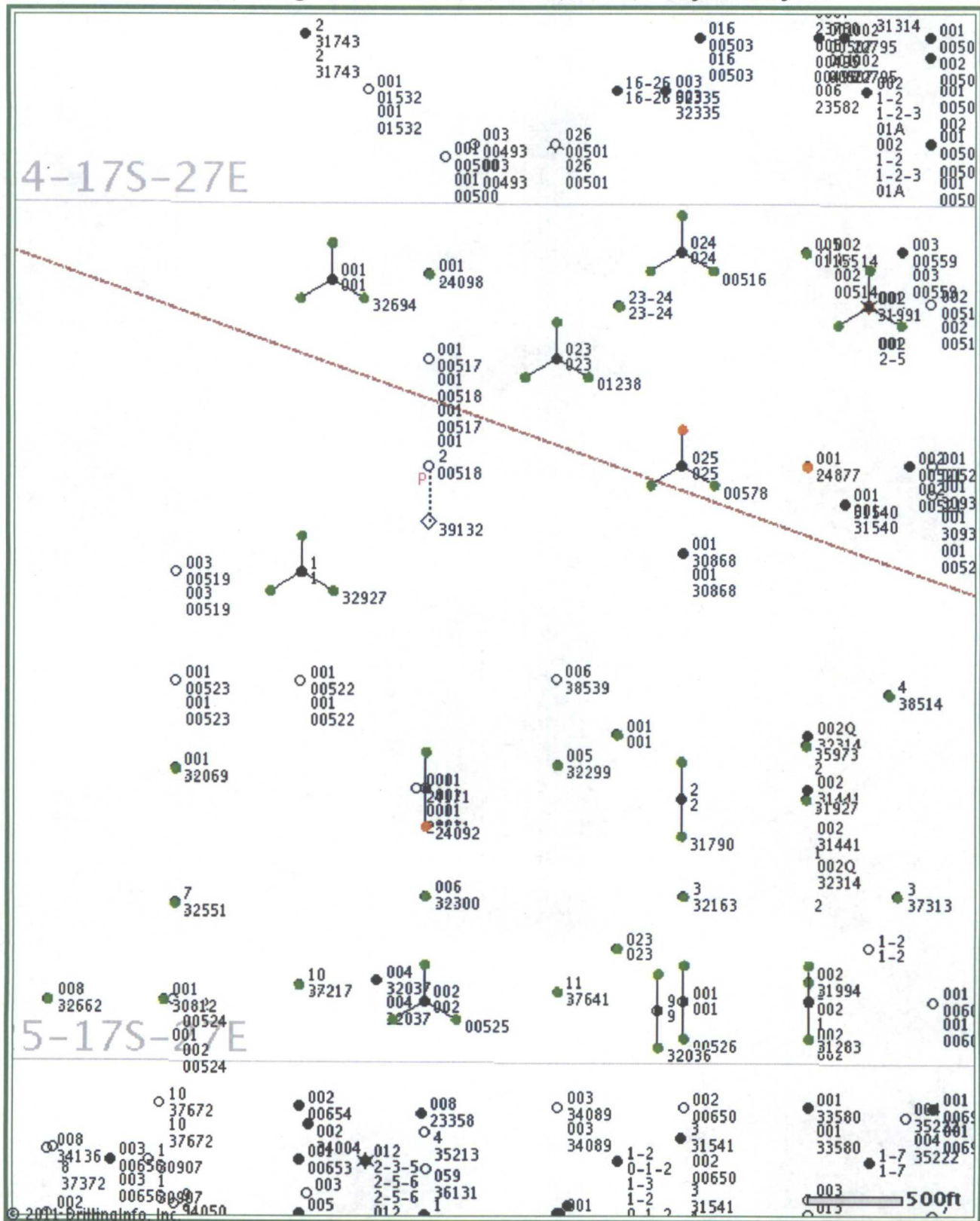

© 2011 Drilling Info, Inc. All rights reserved. All data and information is provided "As Is" and subject to the [DI subscription agreement](#).



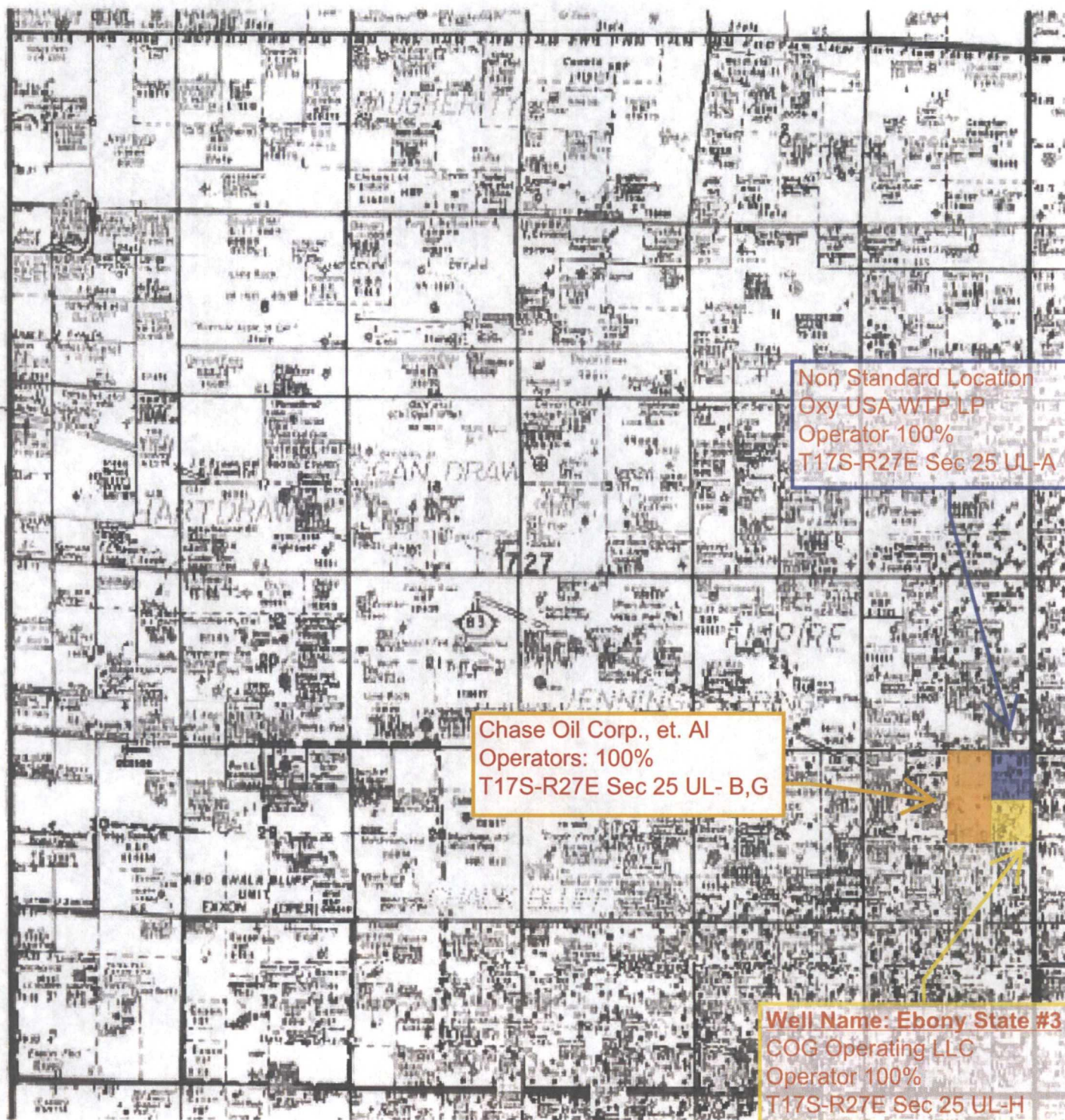

Non Standard Location  
Oxy USA WTP LP  
Operator 100%  
T17S-R27E Sec 25 UL-A

Chase Oil Corp., et. Al  
Operators: 100%  
T17S-R27E Sec 25 UL- B,G

Well Name: Ebony State #3  
COG Operating LLC  
Operator 100%  
T17S-R27E Sec 25 UL-H

Chase Oil Corporation P.O. Box 1767 Artesia, NM 88211	65%
Mack C. Chase & Marilyn Y. Chase Trust ut dated 11/1/1983 P.O. Box 693 Artesia NM 88211	25%
Robert C. Chase P.O. Box 960 Artesia NM 88211	5%
Richard L. Chase P.O. Box 960 Artesia NM 88211	3%
Gerene Dianne Chase P.O. Box 693 Artesia NM	2%

**COG OPERATING LLC  
550 W. TEXAS, SUITE 100  
MIDLAND, TX 79701**

March 28, 2012

Richard L. Chase  
P.O. Box 960  
Artesia NM 88211

Re: Request for Unorthodox Well Location

To Whom It May Concern:

This letter will serve as notice under Rule 104.F (3) that COG Operating LLC has requested administrative approval from the Oil Conservation Division in Santa Fe, NM for an unorthodox Red Lake; Glorieta Yeso oil well.

**Ebony State #3  
Eddy County, NM  
1515' FNL & 990' FEL    Sec 25, T17S, R27E, Unit H**

Should your company have any objection, it must be filed in writing within twenty (20) days from the date of this notice. The Division Director may allow COG to produce from the unorthodox location after the well is drilled, if no objection has been made within the 20 days after the application has been received.

Sincerely,

COG Operating LLC



Kelly J. Holly  
Permitting Tech

**COG OPERATING LLC  
550 W. TEXAS, SUITE 100  
MIDLAND, TX 79701**

March 28, 2012

Robert C. Chase  
P.O. Box 960  
Artesia NM 88211

Re: Request for Unorthodox Well Location

To Whom It May Concern:

This letter will serve as notice under Rule 104.F (3) that COG Operating LLC has requested administrative approval from the Oil Conservation Division in Santa Fe, NM for an unorthodox Red Lake; Glorieta Yeso oil well.

**Ebony State #3  
Eddy County, NM  
1515' FNL & 990' FEL      Sec 25, T17S, R27E, Unit H**



Should your company have any objection, it must be filed in writing within twenty (20) days from the date of this notice. The Division Director may allow COG to produce from the unorthodox location after the well is drilled, if no objection has been made within the 20 days after the application has been received.

Sincerely,

COG Operating LLC

A handwritten signature in black ink, appearing to read 'Kelly J. Holly', with a stylized flourish extending to the right.

Kelly J. Holly  
Permitting Tech

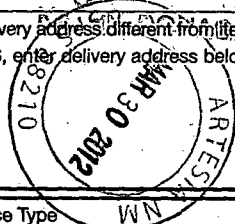
SENDER: COMPLETE THIS SECTION		COMPLETE THIS SECTION ON DELIVERY	
<ul style="list-style-type: none"> <li>■ Complete items 1, 2, and 3. Also complete item 4 if Restricted Delivery is desired.</li> <li>■ Print your name and address on the reverse so that we can return the card to you.</li> <li>■ Attach this card to the back of the mailpiece, or on the front if space permits.</li> </ul>		A. Signature  <input type="checkbox"/> Agent <input type="checkbox"/> Addressee	
1. Article Addressed to: Richard L Chase Robert C Chase PO Box 960 Artesia NM 88211		B. Received by (Printed Name) _____ C. Date of Delivery _____ D. Is delivery address different from item 1? <input type="checkbox"/> Yes If YES, enter delivery address below: <input type="checkbox"/> No	
2. Article Number (Transfer from service label)		3. Service Type <input type="checkbox"/> Certified Mail <input type="checkbox"/> Express Mail <input type="checkbox"/> Registered <input type="checkbox"/> Return Receipt for Merchandise <input type="checkbox"/> Insured Mail <input type="checkbox"/> C.O.D.	
PS Form 3811, February 2004		4. Restricted Delivery? (Extra Fee) <input type="checkbox"/> Yes	
			
Domestic Return Receipt		102595-02-M-1540	

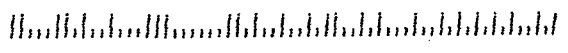
UNITED STATES POSTAL SERVICE		First-Class Mail Postage & Fees Paid USPS Permit No. G-10
<p>• Sender: Please print your name, address, and ZIP+4 in this box •</p> <p>COG operating  Attn: Kelly Holly  550 W Texas Suite 100  Midland TX 79701</p>		
		

**COG OPERATING LLC  
550 W. TEXAS, SUITE 100  
MIDLAND, TX 79701**

March 28, 2012

Mack C. Chase & Marilyn Y. Chase Trust  
uta dated 11/1/1983  
P.O. Box 693  
Artesia NM 88211

Re: Request for Unorthodox Well Location

To Whom It May Concern:

This letter will serve as notice under Rule 104.F (3) that COG Operating LLC has requested administrative approval from the Oil Conservation Division in Santa Fe, NM for an unorthodox Red Lake; Glorieta Yeso oil well.

**Ebony State #3  
Eddy County, NM  
1515' FNL & 990' FEL      Sec 25, T17S, R27E, Unit H**

Should your company have any objection, it must be filed in writing within twenty (20) days from the date of this notice. The Division Director may allow COG to produce from the unorthodox location after the well is drilled, if no objection has been made within the 20 days after the application has been received.

Sincerely,

COG Operating LLC

  
Kelly J. Holly  
Permitting Tech

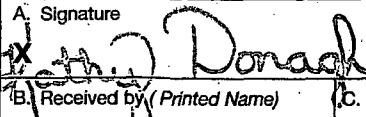

SENDER: COMPLETE THIS SECTION		COMPLETE THIS SECTION ON DELIVERY	
<ul style="list-style-type: none"> <li>Complete items 1, 2, and 3. Also complete item 4 if Restricted Delivery is desired.</li> <li>Print your name and address on the reverse so that we can return the card to you.</li> <li>Attach this card to the back of the mailpiece, or on the front if space permits.</li> </ul>		A. Signature  <input type="checkbox"/> Agent <input checked="" type="checkbox"/> Addressee	
1. Article Addressed to: Mack C Chase + Marilyn Chase Trust Gerene Dianne Chase PO Box 693 Artesia, NM 88211		B. Received by (Printed Name) KATHY DONAGHE C. Date of Delivery MAR 30 2009 ARTEZIA, NM 88210	
2. Article Number (Transfer from service label)		D. Is delivery address different from item 1? <input type="checkbox"/> Yes If YES, enter delivery address below: <input type="checkbox"/> No	
3. Service Type <input type="checkbox"/> Certified Mail <input checked="" type="checkbox"/> Express Mail <input type="checkbox"/> Registered <input type="checkbox"/> Return Receipt for Merchandise <input type="checkbox"/> Insured Mail <input type="checkbox"/> C.O.D.		4. Restricted Delivery? (Extra Fee) <input type="checkbox"/> Yes	
PS Form 3811, February 2004		Domestic Return Receipt	
102595-02-M-1540		91 7199 9991 7030 4014 4283	

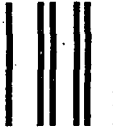
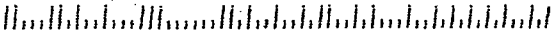
UNITED STATES POSTAL SERVICE		First-Class Mail Postage & Fees Paid USPS Permit No. G-10
<p>• Sender: Please print your name, address, and ZIP+4 in this box •</p> <p>COG operating  Attn: Kelly Holly  550 W Texas Suite 100  Midland TX 79701</p>		
		



**COG OPERATING LLC  
550 W. TEXAS, SUITE 100  
MIDLAND, TX 79701**

March 28, 2012

Chase Oil Corporation  
PO Box 1767  
Artesia, NM 88211

Re: Request for Unorthodox Well Location

To Whom It May Concern:

This letter will serve as notice under Rule 104.F (3) that COG Operating LLC has requested administrative approval from the Oil Conservation Division in Santa Fe, NM for an unorthodox Red Lake; Glorieta Yeso oil well.

**Ebony State #3  
Eddy County, NM  
1515' FNL & 990' FEL      Sec 25, T17S, R27E, Unit H**

Should your company have any objection, it must be filed in writing within twenty (20) days from the date of this notice. The Division Director may allow COG to produce from the unorthodox location after the well is drilled, if no objection has been made within the 20 days after the application has been received.



Sincerely,

COG Operating LLC

A handwritten signature in black ink, appearing to be 'KJ Holly', written over a circular stamp or seal.

Kelly J. Holly  
Permitting Tech

SENDER: COMPLETE THIS SECTION		COMPLETE THIS SECTION ON DELIVERY	
<p>■ Complete items 1, 2, and 3. Also complete item 4 if Restricted Delivery is desired.</p> <p>■ Print your name and address on the reverse so that we can return the card to you.</p> <p>■ Attach this card to the back of the mailpiece, or on the front if space permits.</p>		<p>A. Signature <i>Donaghy</i> <input type="checkbox"/> Agent <input type="checkbox"/> Addressee</p>	
<p>1. Article Addressed to:</p> <p>Chase Oil Corp PO Box 1767 Artesia NM 88211</p>		<p>B. Received by (Printed Name) <i>E</i> C. Date of Delivery</p>	
<p>2. Article Number: (Transfer from service label)</p> <p>90 2199 9990 2030 4014 4269</p>		<p>D. Is delivery address different from item 1? <input type="checkbox"/> Yes <input type="checkbox"/> No If YES, enter delivery address below:</p>	
		<p>3. Service Type</p> <p><input type="checkbox"/> Certified Mail <input type="checkbox"/> Express Mail</p> <p><input type="checkbox"/> Registered <input type="checkbox"/> Return Receipt for Merchandise</p> <p><input type="checkbox"/> Insured Mail <input type="checkbox"/> C.O.D.</p>	
		<p>4. Restricted Delivery? (Extra Fee) <input type="checkbox"/> Yes</p>	
<p>PS Form 3811, February 2004 Domestic Return Receipt 102595-02-M-1540</p>			

UNITED STATES POSTAL SERVICE		First-Class Mail Postage & Fees Paid USPS Permit No. G-10
<p>• Sender: Please print your name, address, and ZIP+4 in this box •</p> <p>COG operating Attn: Kelly Holly 550 W Texas Suite 100 Midland, Tx 79701</p>		
<p></p>		

**COG OPERATING LLC  
550 W. TEXAS, SUITE 100  
MIDLAND, TX 79701**

March 28, 2012

Oxy USA WTP LP  
PO Box 4294  
Houston, TX 77210

Re: Request for Unorthodox Well Location

To Whom It May Concern:

This letter will serve as notice under Rule 104.F (3) that COG Operating LLC has requested administrative approval from the Oil Conservation Division in Santa Fe, NM for an unorthodox Red Lake; Glorieta Yeso oil well.

**Ebony State #3  
Eddy County, NM  
1515' FNL & 990' FEL      Sec 25, T17S, R27E, Unit H**

Should your company have any objection, it must be filed in writing within twenty (20) days from the date of this notice. The Division Director may allow COG to produce from the unorthodox location after the well is drilled, if no objection has been made within the 20 days after the application has been received.

Sincerely,

COG Operating LLC



Kelly J. Holly  
Permitting Tech

**SENDER: COMPLETE THIS SECTION**

- Complete items 1, 2, and 3. Also complete item 4 if Restricted Delivery is desired.
- Print your name and address on the reverse so that we can return the card to you.
- Attach this card to the back of the mailpiece, or on the front if space permits.

1. Article Addressed to:

Oxy USA WTP LP  
PO Box 4294  
Houston TX 77210

2. Article Number  
(Transfer from service label)

1181 12199 9981 7030 4004 4252

PS Form 3811, February 2004

Domestic Return Receipt

102595-02-M-1540

**COMPLETE THIS SECTION ON DELIVERY**

A. Signature

☐ Agent☐ Addressee

B. Received by (Printed Name)

C. Date of Delivery

APR 02 2012

D. Is delivery address different from item 1? ☐ Yes  
If YES, enter delivery address below: ☐ No

3. Service Type

☐ Certified Mail☐ Express Mail☐ Registered☐ Return Receipt for Merchandise☐ Insured Mail☐ C.O.D.

4. Restricted Delivery? (Extra Fee)

☐ Yes

UNITED STATES POSTAL SERVICE

First-Class Mail  
Postage & Fees Paid  
USPS  
Permit No. G-10

• Sender: Please print your name, address, and ZIP+4 in this box •

COG Operating  
Attn: Kelly Holly  
550 W Texas Suite 100  
Midland TX 79701

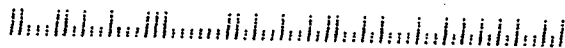

**COG OPERATING LLC  
550 W. TEXAS, SUITE 100  
MIDLAND, TX 79701**

March 28, 2012

Gerene Dianne Chase  
P.O. Box 693  
Artesia NM, 88211

Re: Request for Unorthodox Well Location

To Whom It May Concern:

This letter will serve as notice under Rule 104.F (3) that COG Operating LLC has requested administrative approval from the Oil Conservation Division in Santa Fe, NM for an unorthodox Red Lake; Glorieta Yeso oil well.

**Ebony State #3  
Eddy County, NM  
1515' FNL & 990' FEL      Sec 25, T17S, R27E, Unit H**

Should your company have any objection, it must be filed in writing within twenty (20) days from the date of this notice. The Division Director may allow COG to produce from the unorthodox location after the well is drilled, if no objection has been made within the 20 days after the application has been received.

Sincerely,

COG Operating LLC



Kelly J. Holly  
Permitting Tech

SENDER: COMPLETE THIS SECTION		COMPLETE THIS SECTION ON DELIVERY	
<ul style="list-style-type: none"> <li>■ Complete items 1, 2, and 3. Also complete item 4 if Restricted Delivery is desired.</li> <li>■ Print your name and address on the reverse so that we can return the card to you.</li> <li>■ Attach this card to the back of the mailpiece, or on the front if space permits.</li> </ul>		A. Signature <i>Johny Donaghe</i> <input type="checkbox"/> Agent <input type="checkbox"/> Addressee	
1. Article Addressed to:  <p style="text-align: center;">Gerene Dianne Chase PO Box 693 Artesia, NM 88211</p>		B. Received by (Printed Name) <i>Johny Donaghe</i>	C. Date of Delivery <p style="text-align: center;">APR 19 2012 USPS</p>
2. Article Number (Transfer from service label)		D. Is delivery address different from item 1? <input checked="" type="checkbox"/> Yes If YES, enter delivery address below:	
3. Service Type <input type="checkbox"/> Certified Mail <input type="checkbox"/> Express Mail <input type="checkbox"/> Registered <input type="checkbox"/> Return Receipt for Merchandise <input type="checkbox"/> Insured Mail <input type="checkbox"/> C.O.D.		4. Restricted Delivery? (Extra Fee) <input type="checkbox"/> Yes	
PS Form 3811, February 2004		Domestic Return Receipt	

UNITED STATES POSTAL SERVICE	
<p style="text-align: center;">COG Operating LLC Attn: Kelly Holly 550 W Texas Ave, Suite 100 Midland, TX 79701</p>	
<p style="text-align: center;">• Sender: Please print your name, address, and ZIP+4 in this box •</p>	