



PHILLIPS PETROLEUM COMPANY

ODESSA, TEXAS 79762
4001 PENBROOK

EXPLORATION AND PRODUCTION GROUP
Permian Basin Area

OIL CONSERVATION DIVISION
RECEIVED

NOV 18 1993

November 18, 1993

Re: Sims Well No. 10
Tubb Gas Pool
Lea County, NM

State of New Mexico
Energy, Minerals and Natural Resources Dept.
Oil Conservation Division
P.O. Box 2088
Santa Fe, New Mexico 87504-2088

Attn: Mr. Michael Stogner

Dear Mr. Stogner

Phillips Petroleum Company respectfully requests an administrative approval of an unorthodox location for the Sims Well No. 10. This well was recently recompleted in the Tubb formation by abandoning the Granite Wash with a CIBP and 3 sacks of cement and perforating the Tubb. The high gas oil ratio of approximately 50000/1 will require the well to be classified as a gas completion.

The location of 1980' FNL and 550' FWL was a standard location while the Sims Well No. 10 was classified as an oil well. The field rules for a gas well require the location to be 660' from the outer boundary of the proration unit.

Attached for your reference is a plat of this lease indicating the ownership of all operators offsetting the proration unit. A copy of this request is being furnished to each of these operators along with a waiver request.

Direct any questions regarding this request to Ken Schramko at (915) 368-1399 or Joy Maples at (915) 368-1667.

Yours very truly,

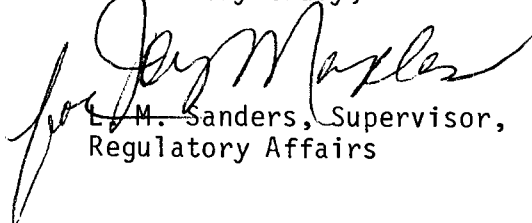
L. M. Sanders, Supervisor,
Regulatory Affairs

Submit to Appropriate
District Office
State Lease - 4 copies
Fee Lease - 3 copies

State of New Mexico
Energy, Minerals and Natural Resources Department

Form C-102
Revised 1-1-89

OIL CONSERVATION DIVISION

DISTRICT I
P.O. Box 1980, Hobbs, NM 88240

P.O. Box 2088
Santa Fe, New Mexico 87504-2088

DISTRICT II
P.O. Drawer DD, Artesia, NM 88210

DISTRICT III
1000 Rio Brazos Rd., Aztec, NM 87410

WELL LOCATION AND ACREAGE DEDICATION PLAT

All Distances must be from the outer boundaries of the section

Operator Phillips Petroleum Company			Lease Sims		Well No. 10
Unit Letter E	Section 24	Township 22-S	Range 37-E	County NMPM	Lea
Actual Footage Location of Well: 1980 feet from the North line and 550 feet from the West line					
Ground level Elev. 3317.5' GR		Producing Formation Tubb		Pool Tubb Gas	Dedicated Acreage: 160 Acres

1. Outline the acreage dedicated to the subject well by colored pencil or hatchure marks on the plat below.

2. If more than one lease is dedicated to the well, outline each and identify the ownership thereof (both as to working interest and royalty).

3. If more than one lease of different ownership is dedicated to the well, have the interest of all owners been consolidated by communitization, unitization, force-pooling, etc.?

☐ Yes ☐ No If answer is "yes" type of consolidation _____

If answer is "no" list the owners and tract descriptions which have actually been consolidated. (Use reverse side of this form if necessary.) _____

No allowable will be assigned to the well until all interests have been consolidated (by communitization, unitization, forced-pooling, or otherwise) or until a non-standard unit, eliminating such interest, has been approved by the Division.

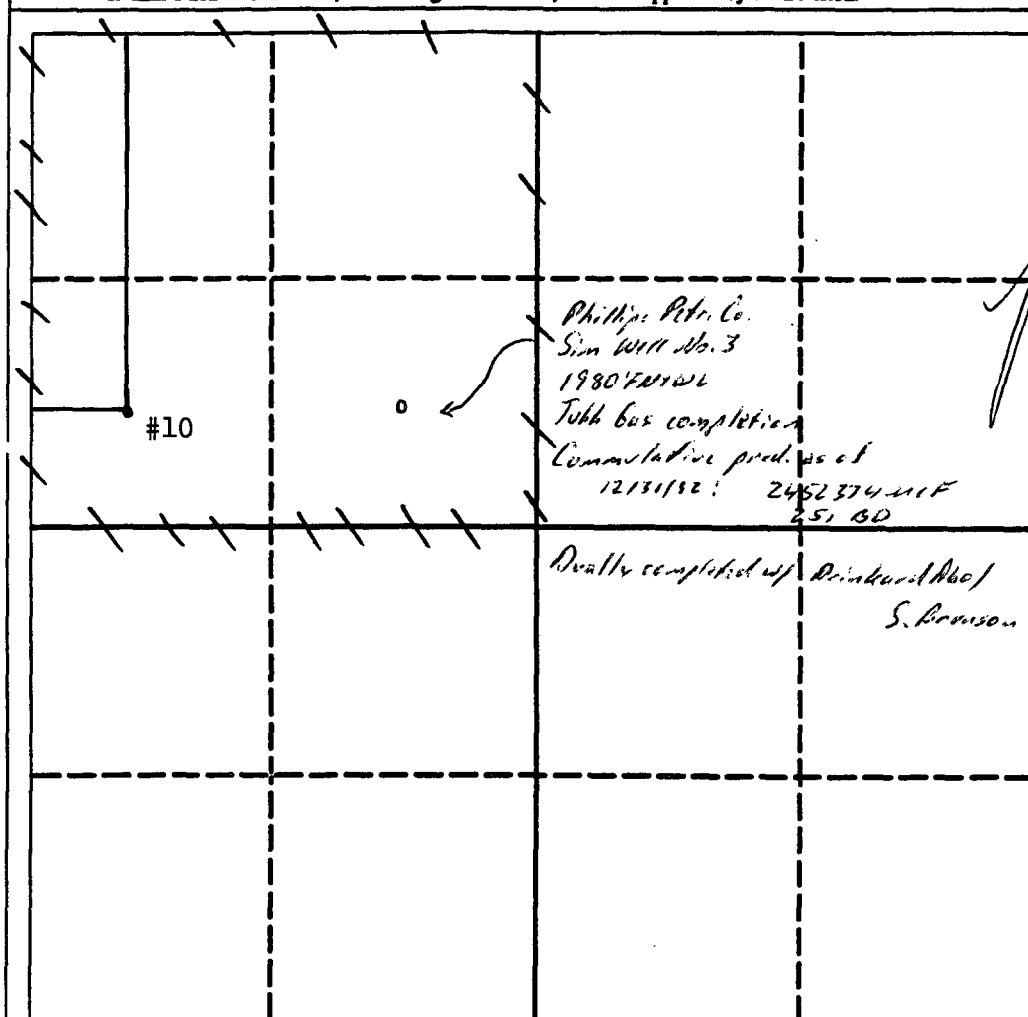

OPERATOR CERTIFICATION

I hereby certify that the information contained herein is true and complete to the best of my knowledge and belief.

Signature

Printed Name

L. M. Sanders

Position

Supv., Reg. Affairs

Company

Phillips Petroleum Co.

Date

11-18-93

SURVEYOR CERTIFICATION

I hereby certify that the well location shown on this plat was plotted from field notes of actual surveys made by me or under my supervision, and that the same is true and correct to the best of my knowledge and belief.

Date Surveyed

Signature & Seal of
Professional Surveyor

Certificate No.

0 330 660 990 1320 1650 1980 2310 2640 2000 1500 1000 500 0



STATE OF NEW MEXICO
ENERGY, MINERALS AND NATURAL RESOURCES DEPARTMENT

OIL CONSERVATION DIVISION
HOBBS DISTRICT OFFICE

OIL CONSERVATION DIVISION
RECEIVED

93 DE 1 PM 8 22

BRUCE KING
GOVERNOR

POST OFFICE BOX 1980
HOBBS, NEW MEXICO 88241-1980
(505) 393-6161

11-23-93

OIL CONSERVATION DIVISION
P. O. BOX 2088
SANTA FE, NEW MEXICO 87501

RE: Proposed:

MC _____
DHC _____
NSL X _____
NSP _____
SWD _____
WFX _____
PMX _____

7 SD

Gentlemen:

I have examined the application for the:

Phillips Petroleum Co Sims #1D-E 24-22-37
Operator Lease & Well No. Unit S-T-R

and my recommendations are as follows:

OK

Yours very truly,

Jerry Sexton
Supervisor, District 1

/ed

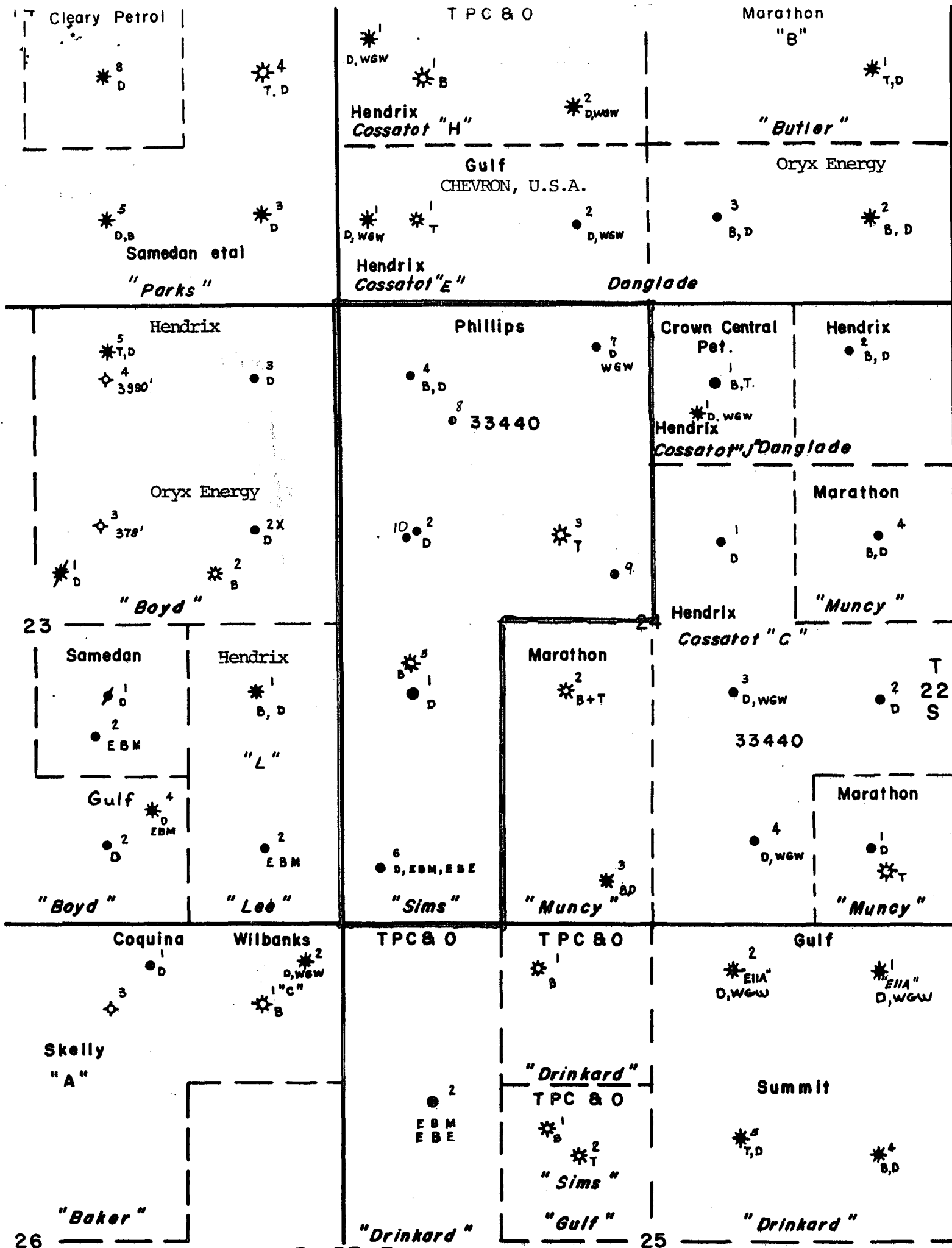

Phillips Petroleum Company
Sims Well Number 10

Offset Operators:

John H. Hendrix Corporation
223 W. Wall, Ste. 525
Midland, Texas 79701

Marathon Oil Company
Box 552, 125 W. Missouri St.
Midland, Texas 79702

Chevron, U.S.A., Inc.
Box 1150, 15 Smith Rd.
Midland, Texas 79701

Samedan Oil Corporation
350 Glenborough Dr., Ste. 240
Houston, Texas 77067

Oryx Energy Company
Box 2880
Dallas, Texas 75221

Crown Central Petroleum Corp.
P. O. Box 1168
Baltimore, MD 21203-1168