

8/12/05 -

DHC-3634

pwwJ052753136

District I
1621 N. French Drive, Hobbs, NM 88240

District II
1301 W. Grand Avenue, Artesia, NM 88210

District III
1000 Rio Brazos Road, Aztec, NM 87410

District IV
1220 S. St Francis Dr., Santa Fe, NM 87505

State of New Mexico
Energy, Minerals and Natural Resources Department

Form C-107A
Revised June 10, 2003

Oil Conservation Division
1220 South St. Francis Dr.
Santa Fe, New Mexico 87505

APPLICATION TYPE
X Single Well
X Establish Pre-Approved Pools
EXISTING WELLBORE
X Yes No

APPLICATION FOR DOWNHOLE COMMINGLING

Mack Energy Corporation

P.O. Box 960, Artesia, NM 88211-0960

Operator

Address

McIntyre DK Federal

9

P-17-17S-30E

Eddy

Lease

Well No.

Unit Letter-Section-Township-Range

County

OGRID No. 013837 Property Code 6143 API No. 30-015-27423 Lease Type: X Federal State Fee

DATA ELEMENT	UPPER ZONE	INTERMEDIATE ZONE	LOWER ZONE
Pool Name	Grayburg Jackson SR Q G SA		Loco Hills Paddock
Pool Code	28509		96718
Top and Bottom of Pay Section (Perforated or Open-Hole Interval)	2748-4161'		4246-4609'
Method of Production (Flowing or Artificial Lift)	Artificial Lift		Artificial Lift
Bottomhole Pressure (Note: Pressure data will not be required if the bottom perforation in the lower zone is within 150% of the depth of the top perforation in the upper zone)			
Oil Gravity or Gas BTU (Degree API or Gas BTU)	38.1		38.1
Producing, Shut-In or New Zone	New Zone		Producing
Date and Oil/Gas/Water Rates of Last Production. (Note: For new zones with no production history, applicant shall be required to attach production estimates and supporting data.)	Date: _____ Rates: _____	Date: _____ Rates: _____	Date: <u>5/31/2005</u> Rates: <u>8/39/9</u>
Fixed Allocation Percentage (Note: If allocation is based upon something other than current or put production, supporting data or explanation will be required.)	Oil _____ Gas _____ % %	Oil _____ Gas _____ % %	Oil _____ Gas _____ % %

ADDITIONAL DATA

Are all working, royalty and overriding royalty interests identical in all commingled zones?
If not, have all working, royalty and overriding royalty interest owners been notified by certified mail?

Yes X No
Yes No

Are all produced fluids from all commingled zones compatible with each other?

Yes X No

Will commingling decrease the value of production?

Yes No X

If this well is on, or communitized with, state or federal lands, has either the Commissioner of Public Lands or the United States Bureau of Land Management been notified in writing of this application?

Yes No

NMOCD Reference Case No. applicable to this well: _____

Attachments:

- C- 1 02 for each zone to be commingled showing its spacing unit and acreage dedication.
- Production curve for each zone for at least one year. (If not available, attach explanation.)
- For zones with no production history, estimated production rates and supporting data.
- Data to support allocation method or formula.
- Notification list of working, royalty and overriding royalty interests for uncommon interest cases.
- Any additional statements, data or documents required to support commingling.

PRE-APPROVED POOLS

If application is to establish Pre-Approved Pools, the following additional information will be required:

- List of other orders approving downhole commingling within the proposed Pre-Approved Pools
- List of all operators within the proposed Pre-Approved Pools
- Proof that all operators within the proposed Pre-Approved Pools were provided notice of this application.
- Bottomhole pressure data.

I hereby certify that the information above is true and complete to the best of my knowledge and belief

SIGNATURE Jerry W. Sherrell TITLE Production Clerk DATE 8/4/2005

TYPE OR PRINT NAME Jerry W. Sherrell TELEPHONE NO. (505) 748-1288

E-MAIL ADDRESS jerrys@mackenergycorp.com

OIL CONSERVATION DIVISION
P.O. Box 2088
Santa Fe, New Mexico 87504-2088

☐ AMENDED REPORT

WELL LOCATION AND ACREAGE DEDICATION PLAT

API Number 30-015-29423	Pool Code 96718	Pool Name Loco Hills Paddock
Property Code 006143	Property Name McINTYRE DK Federal	Well Number 9
OGRID No. 013837	Operator Name MACK ENERGY CORPORATION	Elevation 3657

Surface Location

UL or lot No.	Section	Township	Range	Lot Idn	Feet from the	North/South line	Feet from the	East/West line	County
P	17	17 S	30 E		330	SOUTH	990	EAST	EDDY

Bottom Hole Location If Different From Surface

UL or lot No.	Section	Township	Range	Lot Idn	Feet from the	North/South line	Feet from the	East/West line	County
Dedicated Acres 40	Joint or Infill	Consolidation Code	Order No.						

NO ALLOWABLE WILL BE ASSIGNED TO THIS COMPLETION UNTIL ALL INTERESTS HAVE BEEN CONSOLIDATED
OR A NON-STANDARD UNIT HAS BEEN APPROVED BY THE DIVISION

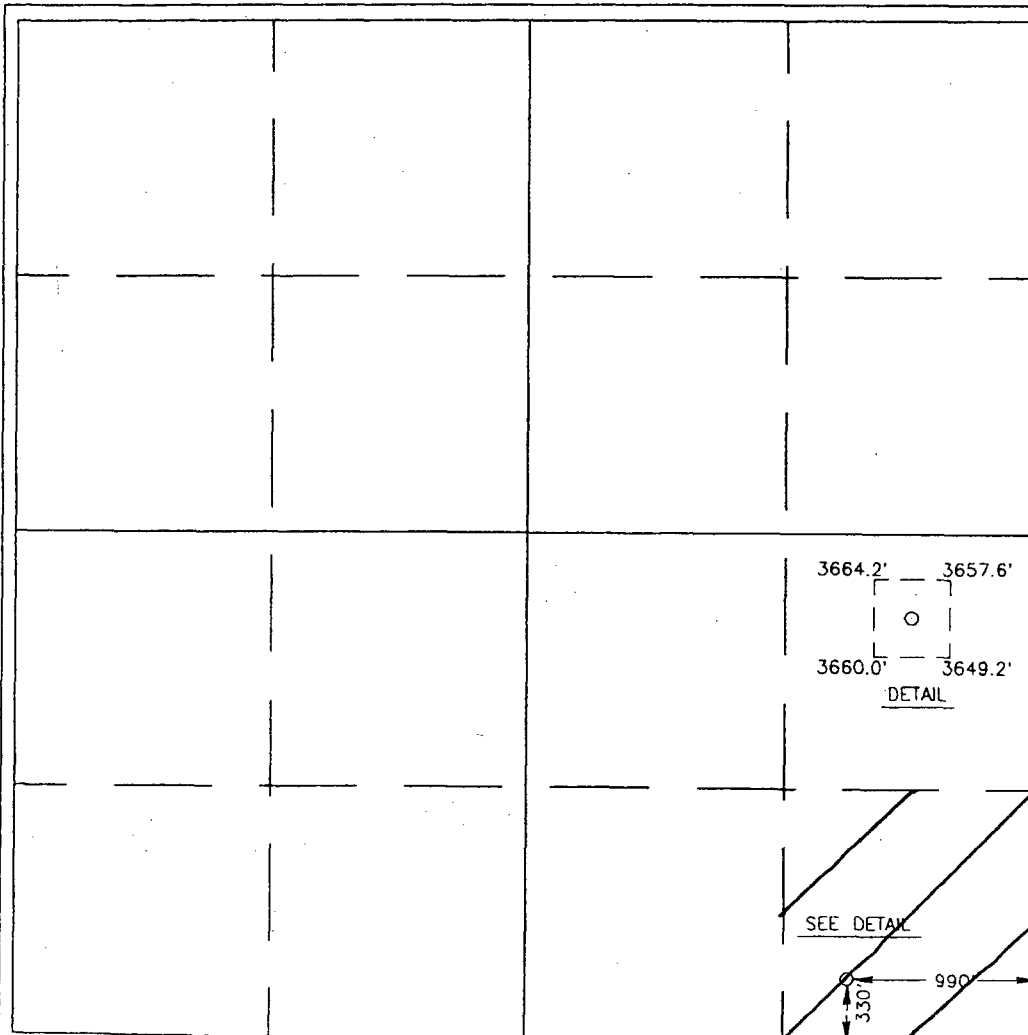

OPERATOR CERTIFICATION

I hereby certify the the information
contained herein is true and complete to the
best of my knowledge and belief.

Crissa D. Carter
Signature

Crissa D. Carter
Printed Name

Production Clerk
Title

2/4/97
Date

SURVEYOR CERTIFICATION

I hereby certify that the well location shown
on this plat was plotted from field notes of
actual surveys made by me or under my
supervision, and that the same is true and
correct to the best of my belief.

DEC. 30, 1996

Date Surveyed
Signature of Surveyor
Professional Surveyor

NEW MEXICO
REGISTERED PROFESSIONAL SURVEYOR
RONALD EIDSON
3239
12-31-96
676
3239
12641

I
800, Hobbs, NM 88241-1980DISTRICT II
Drawer DII, Artesia, NM 88211-0719DISTRICT III
1000 Rio Brazos Rd., Aztec, NM 87410DISTRICT IV
P.O. BOX 2088, SANTA FE, N.M. 87504-2088

OIL CONSERVATION DIVISION

P.O. Box 2088

Santa Fe, New Mexico 87504-2088

☐ AMENDED REPORT

WELL LOCATION AND ACREAGE DEDICATION PLAT

API Number 30-015-29423	Pool Code 28509	Pool Name Grayburg Jackson 7RVS-QN-GB-SA
Property Code 006143	Property Name McINTYRE DK Federal	Well Number 9
OGRID No. 013837	Operator Name MACK ENERGY CORPORATION	Elevation 3657

Surface Location

UL or lot No. P	Section 17	Township 17 S	Range 30 E	Lot Idn	Feet from the 330	North/South line SOUTH	Feet from the 990	East/West line EAST	County EDDY
---------------------------	----------------------	-------------------------	----------------------	---------	-----------------------------	----------------------------------	-----------------------------	-------------------------------	-----------------------

Bottom Hole Location If Different From Surface

UL or lot No.	Section	Township	Range	Lot Idn	Feet from the	North/South line	Feet from the	East/West line	County
---------------	---------	----------	-------	---------	---------------	------------------	---------------	----------------	--------

Dedicated Acres 40	Joint or Infill	Consolidation Code	Order No.
------------------------------	-----------------	--------------------	-----------

NO ALLOWABLE WILL BE ASSIGNED TO THIS COMPLETION UNTIL ALL INTERESTS HAVE BEEN CONSOLIDATED
OR A NON-STANDARD UNIT HAS BEEN APPROVED BY THE DIVISION

				3664.2' — 3657.6'	
				3660.0' — 3649.2'	
				DETAIL	
				SEE DETAIL	
				330' — 990'	

OPERATOR CERTIFICATION

I hereby certify the the information contained herein is true and complete to the best of my knowledge and belief.

Crissa D. Carter
Signature

Crissa D. Carter
Printed Name

Production Clerk
Title

2/4/97
Date

SURVEYOR CERTIFICATION

I hereby certify that the well location shown on this plat was plotted from field notes of actual surveys made by me or under my supervision, and that the same is true and correct to the best of my belief.

DEC. 30, 1996

Date Surveyed
Signature & Seal
Professional Surveyor

DMCC

12-31-96

3239

676
3239
12641

JOHN W. EIDSON
RONALD EIDSON
REGISTERED PROFESSIONAL SURVEYOR



P.O. Box 960
Artesia, NM 88211-0960
Office (505) 748-1288
Fax (505) 746-9539

August 4, 2005

Oil Conservation Division
Attn: David Catanach
1220 South St. Francis Dr.
Santa Fe, NM 87505

Re: Downhole Commingling, and measurement of
Hydrocarbon Production for:
McIntyre DK #1,3,7,8,9,10,11,12Y,13
Section 17, T17S, R30E
Eddy County, New Mexico

Mack Energy Corporation as operator of the aforementioned (9) wells respectfully requests administrative approval for down hole commingling and measurement of production.

Mack Energy proposes to commingle Grayburg Jackson;SR-Q-G-SA(28509) and Loco Hills Paddock(96718) production in the above mentioned McIntyre DK wells(Lease NMNM-86025). Production of both pools will be measured at the McIntyre DK Tank Battery located in the SE/4 SW/4 Sec. 17 T17S R30E. This lease has common interest in both pools. Notification has been made to all parties owning an interest in this lease, including the oil purchaser, of the intent to commingle. Testing will be conducted and allocation percentages will be sent to OCD after completion of these wells.

Should you require any additional information concerning this application, please call Jerry W. Sherrell at the above number. Thank you for your consideration of this request.

Sincerely,

MACK ENERGY CORPORATION

Jerry W. Sherrell
Production Clerk
jerrys@mackenergycorp.com

JWS/

Enclosures