

UNITED STATES
DEPARTMENT OF THE INTERIOR
GEOLOGICAL SURVEY

APPLICATION FOR PERMIT TO DRILL, DEEPEN, OR PLUG BACK

1A. TYPE OF WORK

DRILL ☒RECEIVED
DEEPEN ☐PLUG BACK ☐

B. TYPE OF WELL

OIL
WELL ☐GAS
WELL ☒OTHER ☐

2. NAME OF OPERATOR

TEXACO INC.

3. ADDRESS OF OPERATOR

O. C. C. C.
ARTEBIA, OFFICE

P. O. BOX 3109, MIDLAND, TEXAS 79701

4. LOCATION OF WELL (Report location clearly and in accordance with any State requirements.)

At surface

1980' FNL & 2310' FWL, Section 12, T-25-S, R-31-E

At proposed prod. zone

14. DISTANCE IN MILES AND DIRECTION FROM NEAREST TOWN OR POST OFFICE

20 miles southeast of Malaga, New Mexico

15. DISTANCE FROM PROPOSED

LOCATION TO NEAREST

PROPERTY OR LEASE LINE, FT.

(Also to nearest drilg. unit line, if any)

10,230'

18. DISTANCE FROM PROPOSED LOCATION

TO NEAREST WELL, DRILLING COMPLETED,
OR APPLIED FOR, ON THIS LEASE, FT.

6,200'

16. NO. OF ACRES IN LEASE

35,146.30

19. PROPOSED DEPTH

16,500'

17. NO. OF ACRES ASSIGNED

TO THIS WELL

30

20. ROTARY OR CABLE TOOL

Rotary

21. ELEVATIONS (Show whether DF, RT, GR, etc.)

GR - 3435'

22. APPROX. DATE WORK WILL START

Late 1963

23.

PROPOSED CASING AND CEMENTING PROGRAM

SIZE OF HOLE	SIZE OF CASING	WEIGHT PER FOOT	SETTING DEPTH	QUANTITY OF CEMENT
26"	20"	94#	750'	*2380 sx-350% to circ.
17 1/2"	13 3/8"	54.5# 61# 68#	4,425'	***3650 sx-Calip. Vol. + 25%
12 1/4"	9 5/8"	53.5# 47#	12,600'	***3100 sx-Calip. Vol. + 25%
8 1/2"	7 5/8" (liner)	39#	12,300'-16,000'	****320 sx-Calip. Vol. + 25%
6 1/2"	5" (liner)	18#	15,700'-16,500'	*****75 sx-Calip. Vol. + 25%
				305 sx-Calip. Vol. + 20% to tie back to 12,000'

1980 sx TLW, 12#/gal followed by 500 sx cl. "C", 14.8#/gal. Use 1/4#/sx flocele to 1st. 500 sx TLW. Cement must circ. (350% to circ.)***3150 sx TLW w/10% salt. 12.44#/gal followed by 1000 sx cl. "C" w/ 1/4# salt, 14.8#/gal Calip. Vol. + 25%.***1st State-Stage cementing tool @ 7900 -1200 sx TLW, 12# followed by 760 sx cl. "C" w/10% sx salt, 14.8#/gal. Add 1/4#/sx flocele to 1st 1000 sx TLW. 2nd Stage-1240 sx TLW w/5# sx gilsonite, 12#/gal. Add 1/4#/sx flocele to 1st 500 sx TLW Calip. Vol. + 25% on both stages. Cl. "C" to 11,000'. Preced each stage w/500 gal mud flush followed by 30 bbls. fresh wtr.***320 sx cl. "C" (Incor) w/0.6% Halid 9, 1.4% CFR-2, 1/4#/sx flocele and 5#/sx gilsonite, 14.2#/gal Calip. Vol. + 25%. Preced cmt. w/500 gal mud flush & 30 bbls fresh wtr. *****75 sx Cl. (Incor) w/0.40% CFR-2, 0.6 Halid 9 1/4#/sx flocele & 5#/sx gilsonite, 14.0#/gal Calip. Vol. + 25%. Preced cmt. w/500 gal mud flush & 15 bbls fresh wtr. 305 sx Cl. (Incor) w/0.40% CFR-2 0.6% Halid 9, 14.8#/gal. Calculate Vol. Add 20%--Cementing Co. to run lab. w/samples of cmt. & wtr. to be used in cementing prior to cementing at 12,600', 16,000', & 16,500'.

COMPLETION PROGRAM

1. Run production equipment-Place inhibited fluid in Csg-Annulus. 2. Perforate Devonian section with underbalanced pressure. 3. Test as a natural completion. 4. Treat Devonian as required with E. Acid, if necessary.

IN ABOVE SPACE DESCRIBE PROPOSED PROGRAM: If proposal is to deepen or plug back, give data on present productive zone and proposed new productive zone. If proposal is to drill or deepen directionally, give pertinent data on subsurface locations and measured and true vertical depths. Give blowout preventer program, if any.

24.

SIGNED

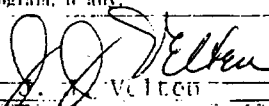

TITLE

Division Civ. Engineer

DATE November 26, 1969

(This space for Federal or State office use)

NOV 28 1969

PERMIT NO.

APPROVAL DATE

APPROVED BY

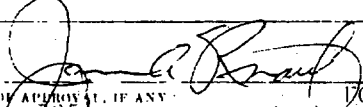

DISTRICT ENGINEER

DATE

NOV 12 1969

CONDITIONS OF APPROVAL, IF ANY

FORMATION TOPS EXPECTED

Foster
Lamar Lime
Bone Spring10,500'
8,395'
8,305'Dean (Mc)
Wolfcamp pay
Strawn11,132'
12,830'
13,653'Hollow Class.
Lower Miss.
Devonian14,320'
13,955'
16,365'Total Depth
16,500'

*See Instructions On Reverse Side

NEW MEXICO OIL CONSERVATION COMMISSION
WELL LOCATION AND ACREAGE DEDICATION PLAT

Form C-102
Supersedes C-128
Effective 1-1-65

All distances must be from the outer boundaries of the Section.

Operator TEXACO Inc.		Lease Cotton Draw Unit		Well No. 68
Unit Letter F	Section 12	Township 25 South	Range 31 East	County Eddy
Actual True North Location of Well: 1980 feet from the North line on 2310 West Sec. 12				
Gross Level Elev. 3435'	Producing Formation Siluro - Devonian	Pool Paduca - Devonian Gas	Dedicated Acreage: 320 Acres	

1. Outline the acreage dedicated to the subject well by colored pencil or hatchure marks on the plat below.
2. If more than one lease is dedicated to the well, outline each and identify the ownership thereof (both as to working interest and royalty).
3. If more than one lease of different ownership is dedicated to the well, have the interests of all owners been consolidated by communitization, unitization, force-pooling, etc?

☒ Yes ☐ No If answer is "yes," type of consolidation **Unitization & Development Agreement**

If answer is "no," list the owners and tract descriptions which have actually been consolidated. (Use reverse side of this form if necessary.)

No allowable will be assigned to the well until all interests have been consolidated (by communitization, unitization, forced-pooling, or otherwise) or until a non-standard unit, eliminating such interests, has been approved by the Commission.

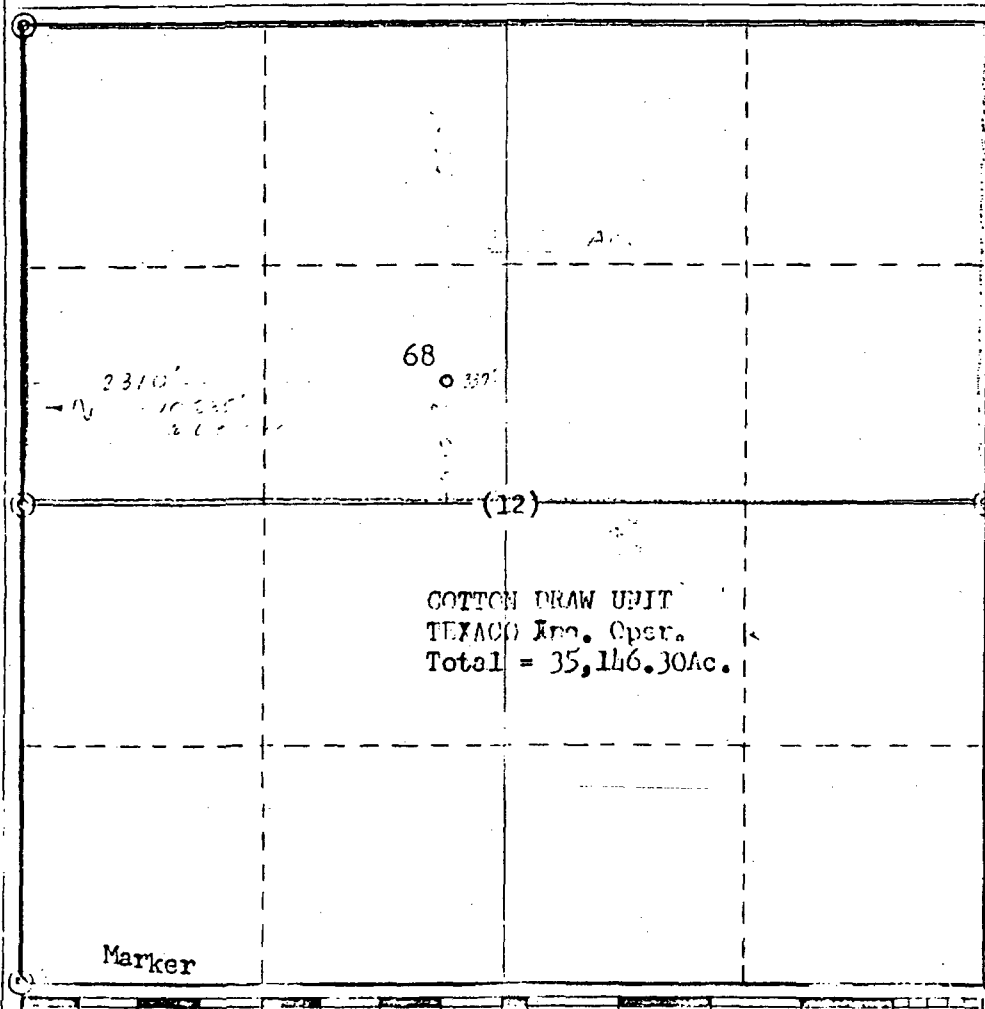

CERTIFICATION	
I hereby certify that the information contained herein is true and complete to the best of my knowledge and belief.	
Signature <i>J. J. Velten</i>	Name J. J. Velten
Position Division Civil Engineer	
Company TEXACO Inc.	
Date 11/26/69	
I hereby certify that the well location shown on this plat was plotted from field notes of actual surveys made by me or under my supervision, and that the same is true and correct to the best of my knowledge and belief.	
Date Surveyed 11/21/69	
By State Licensed Professional Engineer and State Licensed Surveyor <i>J. J. Velten</i> J. J. Velten	
Certificate No. 817h	

REVISED *

SUBMIT IN TRIPLICATE
(Other instruct. on reverse side)Form approved.
Budget Bureau No. 42-R1425.UNITED STATES
DEPARTMENT OF THE INTERIOR
GEOLOGICAL SURVEY

APPLICATION FOR PERMIT TO DRILL, DEEPEN, OR PLUG BACK

1a. TYPE OF WORK

DRILL ☒ (Anchored) DEEPEN ☐ PLUG BACK ☐

b. TYPE OF WELL

OIL
WELL ☐GAS
WELL ☒OTHER ☐SINGLE
ZONE ☒MULTIPLE
ZONE ☐

2. NAME OF OPERATOR

TEXACO INC.

3. ADDRESS OF OPERATOR

P. O. BOX 3109, MIDLAND, TEXAS 79701

4. LOCATION OF WELL (Report location clearly and in accordance with any State requirements.)

At surface

2310' FNL & 1980' FWL, Section 12, T-25-S, R-31-E

At proposed plug zone

* Revised to change location from 2310' FWL & 1980' FNL, Sec 12

14. DISTANCE IN FEET AND DIRECTION FROM NEAREST TOWN OR POST OFFICE*

20 miles southeast of Malaga, New Mexico

15. DISTANCE FROM PROPOSED

LOCATION TO NEAREST

PROPERTY OR LEASE LINE, FT.

(Also to nearest drg. unit line, if any)

9,900'

18. DISTANCE FROM PROPOSED LOCATION*

TO NEAREST WELL, DRILLING, COMPLETED,
OR APPLIED FOR, ON THIS LEASE, FT.

6,300'

21. ELEVATIONS (Show whether DF, RT, GR, etc.)

GR - 3434'

23.

PROPOSED CASING AND CEMENTING PROGRAM

SIZE OF HOLE	SIZE OF CASING	WEIGHT PER FOOT	SETTING DEPTH	QUANTITY OF CEMENT
26"	20"	94#	750'	*2380 sx-350% to circ.
17 1/2"	13 3/8"	54.5# 61# 68#	4,425'	**3650 sx-Calip. Vol. + 25%
12 1/4"	9 5/8"	53.5# 47#	12,600'	***3100 sx-Calip. Vol. + 25%
8 1/2"	7 5/8" (liner)	39#	12,300'-16,000'	****320 sx-Calip. Vol. + 25%
6 1/2"	5" (liner)	18#	15,700'-16,500'	*****75 sx-Calip. Vol. + 25%
				305 sx-Calip. Vol.+20% to tie back to 12,000'

1980 sx TLW, 12#/gal followed by 500 sx cl. "C", 14.8#/gal. Use 1/4#/sx flocele in 1st. 500 sx TLW, cement must circ. (350% to circ.) **3150 sx TLW w/10% salt, 12.44#/gal followed by 500 sx cl. "C" w/ 10% salt, 14.8#/gal Calip. Vol. + 25%. ***1st Stage-Stage cementing tool @ 7900'-1100 sx TLW, 12#/gal followed by 760 sx cl. "C" w/10% salt, 14.8#/gal. Add 1/4#/sx flocele to 1st 500 sx TLW. 2nd Stage-1240 sx TLW w/5# sx gilsonite, 12#/gal. Add 1/4#/sx flocele to 1st 500 sx TLW Calip. Vol. + 25% on both stages. Cl. "C" to 11,000. Preceed each stage w/500 gal mud flush followed by 30 bbls fresh wtr. ****320 sx cl. "C" (Incor) w/0.6% Halid 9, .4% CFR-2, 1/4#/sx flocele and 5#/sx gilsonite 12#/gal Calip. Vol. + 25%. Preceed cmt. w/500 gal mud flush & 30 bbls fresh wtr. *****75 sx Cl. "C" (Incor) w/0.40% CFR-2, 0.6 Halid 9 1/4#/sx flocele & 5#/sx gilsonite, 14.0#/gal Calip. Vol. + 25%. Preceed cmt. w/500 gal mud flush & 15 bbls fresh wtr. 305 sx Cl. "C" (Incor) w/0.40% CFR-2 0.6 Halid 9, 14.8#/gal. Calculate Vol.-Add 20%--Cementing Co. to run lab test w/samples of cmt. & wtr. to be used in cementing prior to cementing at 12,600', 16,000', & 16,500'.

COMPLETION PROGRAM

Run production equipment-Place inhibited fluid in Csg-Tbg annulus. 2. Perforate Devonian section with underbalanced pressure. 3. Test as a natural completion. 4. Treat Devonian as required with E. Acid, if necessary.

IN ABOVE SPACE DESCRIBE PROPOSED PROGRAM: If proposal is to deepen or plug back, give data on present productive zone and proposed new productive zone. If proposal is to drill or deepen directionally, give pertinent data on subsurface locations and measured and true vertical depths. Give blowout preventer program, if any.

24.

SIGNED

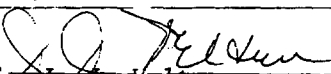

TITLE

Division Civil Engineer

DATE

December 3, 1969

(This space for Federal or State office use)

PERMIT NO.



APPROVAL DATE

DEC 4 - 1969

APPROVED BY

ROBERT L. BEEKMAN

ACTING DISTRICT ENGINEER

DATE

DEC 4 - 1969

CONDITIONS OF APPROVAL, IF ANY:

FORMATION

TOPS EXPECTED

1st Layer	705'	Dean (Wc)	11,132'	Morrow Clastics	14,829'	Total Depth
2nd Layer	4,395'	Wolfcamp pay	12,830'	Lower Miss.	15,955'	16,500'
3rd Layer	8,305'	Strawn	13,653'	Devonian	16,365'	

*See Instructions On Reverse Side

THIS APPROVAL IS VOID IF OPERATIONS
ARE NOT COMMENCED WITHIN 3 MONTHS.

NEW MEXICO OIL CONSERVATION COMMISSION
WELL LOCATION AND ACREAGE DEDICATION PLAT

Form O-1
Supersedes O-128
Effective 1-1-65

All distances must be from the outer boundaries of the Section.

Operator TEXACO Inc.		Lease Cotton Draw Unit		Well No. 68
Unit Letter F	Section 12	Township 25 South	Range 31 East	County Eddy
Actual Footage Location of Well:				
2310 feet from the North line and		1980 feet from the West line		Sec. 12
Ground Level Elev. 3434'	Producing Formation Siluro - Devonian	Pool Paduca - Devonian Gas	Dedicated Acreage: 320	

1. Outline the acreage dedicated to the subject well by colored pencil or hatchure marks on the plat below.
2. If more than one lease is dedicated to the well, outline each and identify the ownership thereof (both as to working interest and royalty).
3. If more than one lease of different ownership is dedicated to the well, have the interests of all owners been consolidated by communitization, unitization, force-pooling, etc?

☒ Yes ☐ No If answer is "yes," type of consolidation Unitization & Development Agreement

If answer is "no," list the owners and tract descriptions which have actually been consolidated. (Use reverse side of this form if necessary.)

No allowable will be assigned to the well until all interests have been consolidated (by communitization, unitization, forced-pooling, or otherwise) or until a non-standard unit, eliminating such interests, has been approved by the Commission.

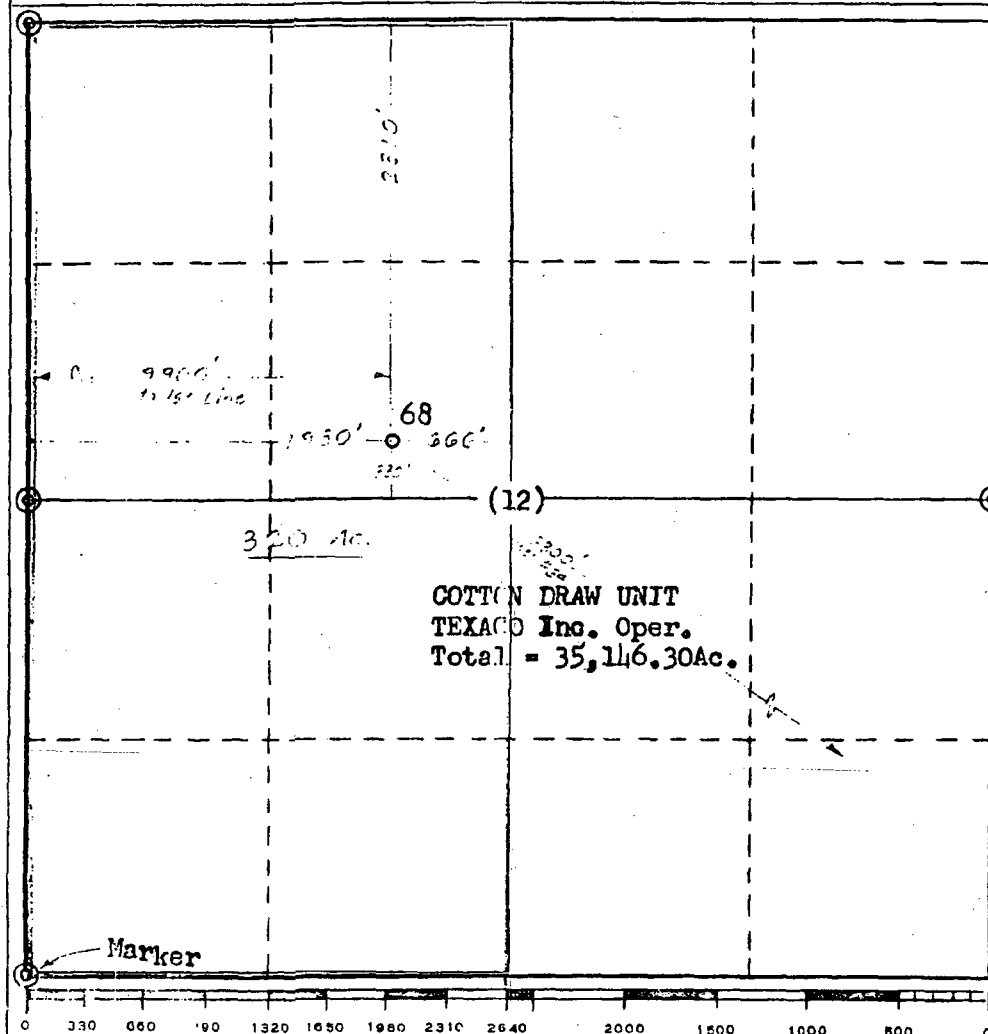

CERTIFICATION

I hereby certify that the information contained herein is true and complete to the best of my knowledge and belief.

Name J. J. Velten

Position Division Civil Engineer

Company TEXACO Inc.

Date 12/3/69

I hereby certify that the well location shown on this plat was plotted from field notes of actual surveys made by me or under my supervision, and that the same is true and correct to the best of my knowledge and belief.

Date Surveyed

12/2/69

Registered Professional Engineer and/or Land Surveyor

J. J. Velten

Certificate No.

8174

UNITED STATES
DEPARTMENT OF THE INTERIOR
GEOLOGICAL SURVEYSUBMIT IN TRIPLI
(Other instructions
verse side)Form approved.
Budget Bureau No. 42-R1424.

5. LEASE DESIGNATION AND SERIAL NO.

NA 0503

6. IF INDIAN, ALLOTTEE OR TRIBE NAME

7. UNIT AGREEMENT NAME

8. FARM OR LEASE NAME

Cotton Draw Unit

9. WELL NO.

68

10. FIELD AND POOL, OR WILDCAT

Undesignated

11. SEC., T., R., M., OR BLK. AND
SURVEY OR AREA

Section 12, T-25-S, R-31-E

12. COUNTY OR PARISH

Eddy

13. STATE

New Mexico

SUNDRY NOTICES AND REPORTS ON WELLS

(Do not use this form for proposals to drill or to deepen or plug back to a different reservoir.
Use "APPLICATION FOR PERMIT—" for such proposals.)1. OIL WELL ☐ GAS WELL ☒ OTHER

2. NAME OF OPERATOR

TEXACO Inc.

3. ADDRESS OF OPERATOR

P. O. Box 728, Hobbs, New Mexico 88240

4. LOCATION OF WELL (Report location clearly and in accordance with any State requirements.
See also space 17 below.)At surface
Well is located 2310' from the North line and 1980' from the
West line of Section 12, T-25-S, R-31-E, Unit Letter F,
Eddy County, New Mexico.

14. PERMIT NO.

Regular

15. ELEVATIONS (Show whether DF, RT, GR, etc.)

3434' (GR)

16. Check Appropriate Box To Indicate Nature of Notice, Report, or Other Data

NOTICE OF INTENTION TO:

TEST WATER SHUT-OFF

PULL OR ALTER CASING

FRACTURE TREAT

MULTIPLE COMPLETE

SHOOT OR ACIDIZE

ABANDON*

REPAIR WELL

CHANGE PLANS

(Other)

SUBSEQUENT REPORT OF:

WATER SHUT-OFF

FRACTURE TREATMENT

SHOOTING OR ACIDIZING

(Other)

REPAIRING WELL

ALTERING CASING

ABANDONMENT*

(Note: Report results of multiple completion on Well
Completion or Recompletion Report and Log form.)17. DESCRIBE PROPOSED OR COMPLETED OPERATIONS (Clearly state all pertinent details, and give pertinent dates, including estimated date of starting any
proposed work. If well is directionally drilled, give subsurface locations and measured and true vertical depths for all markers and zones perti-
nent to this work.)*

Total Depth 755'

Spudded 26" hole 12:00 noon, December 19, 1969.

Ran 751' (25 joints) 20" O.D. 94# casing and set @755'.

Cement w/1600 sx TLW and 500 sx Class 'C' cement.

Plug @723'. Cement circulated. Job complete 2:30 AM, December 22, 1969.

Tested 20" O.D. casing w/600# for 30 minutes from 6:00 PM to 6:30 PM,

December 22, 1969. Tested OK. Drilled out cement plug and re-tested

w/600# for 30 minutes from 7:00 PM to 7:30 PM, December 22, 1969. Tested

OK. Job complete 7:30 PM December 22, 1969.

18. I hereby certify that the foregoing is true and correct

SIGNED

TITLE District Superintendent

DATE December 29, 1969

(This space for Federal or State office use)

APPROVED BY

TITLE

DATE

CONDITIONS OF APPROVAL, IF ANY:

ACCEPTED FOR RECORD PURPOSES
DEC 31 1969

Date

ACTING District Engineer

*See Instructions on Reverse Side

RECEIVED
JAN 2 1970
RECEIVED O. C. C.
ARTESIA, OFFICE
DEC 31 1969
U. S. G. I.
ALBUQUERQUE

N. M. O. C. C. COPY
UNITED STATES
DEPARTMENT OF THE INTERIOR
GEOLOGICAL SURVEYSUBMIT IN TRIPlicate
(Other instructions
reverse side)Form approved
Budget Bureau No. 42-R1424

5. LEASE DESIGNATION AND SERIAL NO.

NMO503

6. IF INDIAN, ALLOTTEE OR TRIBE NAME

7. UNIT AGREEMENT NAME

8. FARM OR LEASE NAME

Cotton Draw Unit

9. WELL NO.

68

10. FIELD AND POOL OR WILDCAT

Undesignated

11. SEC. T., R., M. OR B.L. AND
SURVEY OR AREA

Section 12, T-25-S, R-31-E

12. COUNTY OR PARISH

Eddy

13. STATE

New Mexico

SUNDRY NOTICES AND REPORTS ON WELLS

(Do not use this form for proposals to drill or to deepen or plug back to a different reservoir.
Use "APPLICATION FOR PERMIT—" for such proposals.)

1. OIL WELL <input type="checkbox"/> GAS WELL <input checked="" type="checkbox"/> OTHER <input type="checkbox"/>	2. NAME OF OPERATOR TEXACO Inc.	3. ADDRESS OF OPERATOR P. O. Box 728 - Hobbs, New Mexico 88240	4. LOCATION OF WELL (Report location clearly and in accordance with any State requirements.* See also space 17 below.) At surface Well is located 2310' from the North line and 1980' from the West line of Section 12, T-25-S, R-31-E, Unit Letter F, Eddy County, New Mexico.
14. PERMIT NO. Regular	15. ELEVATIONS (Show whether DF, RT, CR, etc.) 3434' (GR)	12. COUNTY OR PARISH Eddy	13. STATE New Mexico

16. Check Appropriate Box To Indicate Nature of Notice, Report, or Other Data

NOTICE OF INTENTION TO:

TEST WATER SHUT-OFF

FRACTURE TREAT

SHOOT OR ACIDIZE

REPAIR WELL

(Other)

PULL OR ALTER CASING

MULTIPLE COMPLETE

ABANDON*

CHANGE PLANS

SUBSEQUENT REPORT OF:

WATER SHUT-OFF

FRACTURE TREATMENT

SHOOTING OR ACIDIZING

(Other)

REPAIRING WELL

ALTERING CASING

ABANDONMENT*

(NOTE: Report results of multiple completion on Well Completion or Recompletion Report and Log form.)

17. DESCRIBE PROPOSED OR COMPLETED OPERATIONS (Clearly state all pertinent details, and give pertinent dates, including estimated date of starting any proposed work. If well is directionally drilled, give subsurface locations and measured and true vertical depths for all markers and zones pertinent to this work.)*

TOTAL DEPTH 4415'
20" O.D. 94# Casing Set @ 755'

Ran 4379' (106 joints) 13-3/8" O.D. 48# casing and cemented @ 4415' w/6900 Sx TLW, 500 Sx Class C, 650 Sx Class C Neat and 200 Sx Class C w/2% CaCl. Plug @ 4373'. Cement circulated. Job complete 10:00 AM, January 3, 1970.

Tested 13-3/8" O.D. casing w/1000# for 30 minutes from 4:00 PM to 4:30 PM, January 4, 1970. Tested OK. Drilled out cement plug and retested w/1000# for 30 minutes from 5:00 PM to 5:30 PM, January 4, 1970. Tested OK. Job complete 5:30 PM January 4, 1970.

RECEIVED

JAN 16 1970

D. C. C.
ARTESIAN OFFICERECEIVED
JAN 14 1970

18. I hereby certify that the foregoing is true and correct

SIGNED

TITLE

Assistant District
Superintendent

DATE January 13, 1970

(This space for Federal or State office use)

APPROVED BY

TITLE

DATE

CONDITIONS OF APPROVAL, IF ANY:

ACCEPTED FOR RECORD PURPOSE
JAN 15 1970
Date
ACTING District Engineer

*See Instructions on Reverse Side

UNITED STATES
DEPARTMENT OF THE INTERIOR
GEOLOGICAL SURVEYSUBMIT IN TR
(Other instructi
verse side)CATE*
on re-Form approved.
Budget Bureau No. 42-R1424.

5. LEASE DESIGNATION AND SERIAL NO.

N M 0503

6. IF INDIAN, ALLOTTEE OR TRIBE NAME

7. UNIT AGREEMENT NAME

8. FARM OR LEASE NAME

Cotton Draw Unit

9. WELL NO.

68

10. FIELD AND POOL, OR WILDCAT

Undesignated

11. SEC., T., R., M., OR BLK. AND
SURVEY OR AREA

Sec. 12, T-25-S, R-31-E

12. COUNTY OR PARISH

Eddy

13. STATE

New Mexico

SUNDRY NOTICES AND REPORTS ON WELLS

(Do not use this form for proposals to drill or to deepen or plug back to a different reservoir.
Use "APPLICATION FOR PERMIT—" for such proposals.)1. ☐ OIL
WELL ☐ GAS
WELL ☒ OTHER

2. NAME OF OPERATOR

TEXACO Inc.

3. ADDRESS OF OPERATOR

P. O. Box 728, Hobbs, New Mexico 88240

4. LOCATION OF WELL (Report location clearly and in accordance with any State requirements.*
See also space 17 below.)
At surfaceWell is located 2310' from the North line and
1980' from the West line of Section 12, T-25-S, R-31-E, Unit
Letter F, Eddy County, New Mexico.

14. PERMIT NO.

Regular

15. ELEVATIONS (Show whether DF, RT, GR, etc.)

3457 (DF)

16.

Check Appropriate Box To Indicate Nature of Notice, Report, or Other Data

NOTICE OF INTENTION TO:

TEST WATER SHUT-OFF

FRACTURE TREAT

SHOOT OR ACIDIZE

REPAIR WELL

(Other)

PULL OR ALTER CASING

MULTIPLE COMPLETE

ABANDON*

CHANGE PLANS

SUBSEQUENT REPORT OF:

WATER SHUT-OFF

FRACTURE TREATMENT

SHOOTING OR ACIDIZING

(Other)

REPAIRING WELL

ALTERING CASING

ABANDONMENT*

(NOTE: Report results of multiple completion on Well
Completion or Recompletion Report and Log form.)17. DESCRIBE PROPOSED OR COMPLETED OPERATIONS (Clearly state all pertinent details, and give pertinent dates, including estimated date of starting any
proposed work. If well is directionally drilled, give subsurface locations and measured and true vertical depths for all markers and zones perti-
nent to this work.)*

TOTAL DEPTH 12650'

13-3/8" OD 48# casing set @4415'

Ran 12620' (307 joints) 9-5/8" OD 53.50# and 47# casing and set @12650' w/DV tool @7915'. Cemented first stage w/1250 sx TLW w/.4% LWL and 1/4# flocele per sack followed w/500 sx Class C w/.5% ER7 w/10# salt per sack. Plug @12520'. Complete @11:45 PM, February 3, 1970. Cemented second stage through DV tool @7915' w/1800 sx TLW w/5# gilsonite and 3.7# salt per sack, 1/4# flocele per sack in first 500 sx. Full returns while cementing and displacing plug. Job complete @3:30 PM, February 4, 1970.

Ran drill pipe to 7900', tested 9-5/8" casing to 2400# from 11:00 - 11:30 PM, February 6, 1970 - tested OK. Drilled DV tool. Tested 9-5/8" casing to 3900# from 1:30 AM to 2:00 AM, February 7, 1970 - tested OK. Ran RTTS packer to 5000', tested 9-5/8" casing to 5000# from 5000' to surface - tested OK. Pulled packer and ran bit, drilled cement and shoe and tested to 1650# from 4:30 PM to 5:00 PM, February 8, 1970 - tested OK. Job complete 5:00 PM, February 8, 1970.

RECEIVED

FEB 12 1970

RECEIVED

FEB 11 1970

GEOLOGICAL SURVEY
NEW MEXICO

18. I hereby certify that the foregoing is true and correct

SIGNED

TITLE Superintendent

DATE February 9, 1970

(This space for Federal or State office use)

APPROVED BY

CONDITIONS OF APPROVAL, IF ANY:

TITLE

DATE

ACCEPTED FOR RECORD PURPOSES

FEB 11 1970
Date

ACTING District Engineer

*See Instructions on Reverse Side

UNITED STATES
DEPARTMENT OF THE INTERIOR
GEOLOGICAL SURVEY

SUBMIT IN T
(Other instruc
verse side)

ICATE
OR re

Form approved.
Budget Bureau No. 42-R1424.

SUNDRY NOTICES AND REPORTS ON WELLS

(Do not use this form for proposals to drill or to deepen or plug back to a different reservoir.
Use "APPLICATION FOR PERMIT—" for such proposals.)

1. NAME OF OPERATOR TEXACO Inc.	5. LEASE DESIGNATION AND SERIAL NO. NM 0503
2. ADDRESS OF OPERATOR P.O. Box 728, Hobbs, New Mexico 88240	6. IF INDIAN, ALLOTTEE OR TRIBE NAME
3. LOCATION OF WELL (Report location clearly and in accordance with any State requirements. See also space 17 below.) Well located 2310' from the North line and 1980' from the West line of Section 12, T-25-S, R-31-E, Unit Letter F, Eddy County, New Mexico.	7. UNIT AGREEMENT NAME
4. TYPE OF WELL (Check appropriate box) <input type="checkbox"/> OIL WELL <input type="checkbox"/> GAS WELL <input checked="" type="checkbox"/> OTHER	8. FARM OR LEASE NAME Cotton Draw Unit
9. WELL NO. 68	10. FIELD AND POOL OR WILDCAT Undesignated
11. SEC., T., R., OR S.E. AND SURVEY OR AREA Sec. 12, T-25-S, R-31-E	12. COUNTY OR PARISH 13. STATE Eddy New Mexico
14. DEPTH (Show whether DF, RT, GR, etc.) Regular 3457' (DF)	

Check Appropriate Box To Indicate Nature of Notice, Report, or Other Data

NOTICE OF INTENTION TO:		SUBSEQUENT REPORT OF:	
TEST WATER SHUT-OFF <input type="checkbox"/>	PULL OR ALTER CASING <input type="checkbox"/>	WATER SHUT-OFF <input checked="" type="checkbox"/>	REPAIRING WELL <input type="checkbox"/>
FRACTURE TREAT <input type="checkbox"/>	MULTIPLE COMPLETE <input type="checkbox"/>	FRACTURE TREATMENT <input type="checkbox"/>	ALTERING CASING <input type="checkbox"/>
SHOOT OR ACIDIZE <input type="checkbox"/>	ABANDON* <input type="checkbox"/>	SHOOTING OR ACIDIZING <input type="checkbox"/>	ABANDONMENT* <input type="checkbox"/>
REPAIR WELL <input type="checkbox"/>	CHANGE PLANS <input type="checkbox"/>	(Other) <input type="checkbox"/>	

15. DESCRIBE PROPOSED OR COMPLETED OPERATIONS (Clearly state all pertinent details, and give pertinent dates, including estimated date of starting and proposed work. If well is directionally drilled, give subsurface locations and measured and true vertical depths for all markers and spots pertinent to this work.)

TOTAL DEPTH 14680'
9-5/8" OD 53.50# and 47# casing set at 12650'

Ran 2410' (60 joints) 7-5/8" OD 39# P-110 liner on TIW liner hanger to 14680'.
Test liner to 9000#. Cement liner at 14680' w/133 sx Class C cement w/.6%
Hallide 9, 1% CFR-2 and 1/4# flocele per sack. Top of liner at 12270'. Plug at
14600'. Plug down at 1:30 AM, March 20, 1970. Ran cement retainer and set at
12080'. Squeeze top of 7-5/8" liner w/175 sx Class C w/.6% Hallide 9 and 1%
CFR-2 in first stage. Squeeze top of liner at 12270' through re alner set at
12080', w/second stage of 175 sx Class C w/.6% Hallide 9 and 1% CFR-2. Drill
cement retainer at 12080 and cement to top of liner at 12270'. Test 7-5/8"
casing to 2000# from 10:30 PM to 11:00 PM, March 23, 1970. Tested OK. Drill out
cement plug and retested to 1000# from 2:00 AM to 2:30 AM March 24, 1970. Tested
OK.

RECEIVED

MAR 26 1970

U. S. G. S.
ARTESIA, OFFICE

RECEIVED

MAR 25 1970

U. S. GEOLOGICAL SURVEY
ARTESIA, NEW MEXICO

16. I hereby certify that the foregoing is true and correct

SIGNED

TITLE

Assistant District
Superintendent

DATE

March 24, 1970

APPROVED BY

CONDITIONS OF APPROVALS ANY:

TITLE

DATE

ACCEPTED FOR RECORD PURPOSES ANY:

MAR 25 1970
Date

ACTING District Engineer

*See Instructions on Reverse Side

UNITED STATES
DEPARTMENT OF THE INTERIOR
GEOLOGICAL SURVEYSUBMIT IN
(Other instructions
reverse side)

LICATE*

Form approved.
Budget Bureau No. 42-R1424.

5. LEASE DESIGNATION AND SERIAL NO.

NM-0503

6. IF INDIAN, ALLOTTEE OR TRIBE NAME

SUNDRY NOTICES AND REPORTS ON WELLS

(Do not use this form for proposals to drill or to deepen or plug back to a different reservoir.
Use "APPLICATION FOR PERMIT—" for such proposals.)

1. OIL WELL <input type="checkbox"/> GAS WELL <input checked="" type="checkbox"/> OTHER <input type="checkbox"/>	7. UNIT AGREEMENT NAME
2. NAME OF OPERATOR TEXACO Inc. ✓	8. FARM OR LEASE NAME Cotton Draw Unit
3. ADDRESS OF OPERATOR P.O. Box 728, Hobbs, New Mexico 88240	9. WELL NO. 68
4. LOCATION OF WELL (Report location clearly and in accordance with any State requirements.* See also space 17 below.) At surface 2310/W 1980/W	10. FIELD AND POOL OR WILDCAT Undesignated
14. PERMIT NO. Regular	11. SEC., T. R., M., OR BLK. AND SURVEY OR AREA Sec. 12, T-25-S, R-31-E
15. ELEVATIONS (Show whether DF, RT, GR, etc.) 3457' (DF)	12. COUNTY OR PARISH Eddy
	13. STATE New Mexico

16. Check Appropriate Box To Indicate Nature of Notice, Report, or Other Data

NOTICE OF INTENTION TO:		SUBSEQUENT REPORT OF:	
TEST WATER SHUT-OFF <input type="checkbox"/>	PULL OR ALTER CASING <input type="checkbox"/>	WATER SHUT-OFF <input checked="" type="checkbox"/>	REPAIRING WELL <input type="checkbox"/>
FRACTURE TREAT <input type="checkbox"/>	MULTIPLE COMPLETE <input type="checkbox"/>	FRACTURE TREATMENT <input type="checkbox"/>	ALTERING CASING <input type="checkbox"/>
SHOOT OR ACIDIZE <input type="checkbox"/>	ABANDON* <input type="checkbox"/>	SHOOTING OR ACIDIZING <input type="checkbox"/>	ABANDONMENT* <input type="checkbox"/>
REPAIR WELL <input type="checkbox"/>	CHANGE PLANS <input type="checkbox"/>	(Other) <input type="checkbox"/>	
(Other) <input type="checkbox"/>			

(NOTE: Report results of multiple completion on Well Completion or Recompletion Report and Log form.)

17. DESCRIBE PROPOSED OR COMPLETED OPERATIONS (Clearly state all pertinent details, and give pertinent dates, including estimated date of starting any proposed work. If well is directionally drilled, give subsurface locations and measured and true vertical depths for all markers and zones pertinent to this work.)

TOTAL DEPTH 16,460'

9-5/8" OD 53.50# & 47# casing set @12,650'

7-5/8" OD 39# P-110 Liner set from 12,270' to 14,680'

Ran 2180' (53 jts) 5-1/2" OD 23# C-75 Hydril liner and set @16,456'. Top of liner @14,276'. Cement bottom of liner w/80 sx Class 'H' Cement containing 40% Silica Flour & 1% Halad-14. Plug @16,376'. Job complete 4:35 AM, April 24, 1970.

Set cement retainer @13,980'. Cemented top of liner w/105 sx. Class 'H' cement containing 40% Silica Flour & 1% Halad-14. Job complete 9:30 AM, April 24, 1970.

Drill cement to top of liner @14,276'.

Test 9-5/8" casing, 7-5/8" & 5-1/2" liner w/4000# for 30 minutes from 4:15 AM to 10:30 AM, April 30, 1970. Tested OK. Drill cement and retested for 30 minutes w/500# from 4:15 PM to 4:45 PM, April 30, 1970. Tested OK. Job complete 4:45 PM, April 30, 1970.

18. I hereby certify that the foregoing is true and correct

SIGNED

(This space for Federal or State office use)

Assistant District
Superintendent

DATE May 1, 1970

APPROVED BY

CONDITIONS OF APPROVAL, IF ANY:

TITLE

DATE

MAY 6 1970

ACCEPTED FOR RECORD PURPOSES
MAY 5 - 1970

Date

ACTING District Engineer

*See Instructions on Reverse Side

O. C. C.
ARTESIA, OFFICE

N. M. O. C. C. COPY
UNITED STATES
DEPARTMENT OF THE INTERIOR
GEOLOGICAL SURVEYSUBMIT IN APPLICATION
(Other instructions on reverse side)Copy to ST
Form approved.
Budget Bureau No. 42-R1424.
5. LEASE DESIGNATION AND SERIAL NO.

NM-0503

6. IF INDIAN, ALLOTTEE OR TRIBE NAME

7. UNIT AGREEMENT NAME

8. FARM OR LEASE NAME

Cotton Draw Unit

9. WELL NO.

68

10. FIELD AND POOL OR WILDCAT

Undesignated

11. SEC., T., R., M., OR BLK. AND
SURVEY OR AREA

Sec. 12, T-25-S, R-31-E

12. COUNTY OR PARISH

Eddy

13. STATE

New Mexico

SUNDRY NOTICES AND REPORTS ON WELLS

(Do not use this form for proposals to drill or to deepen or plug back to a different reservoir.
Use "APPLICATION FOR PERMIT" for such proposals.)OIL WELL ☐ GAS WELL ☒ OTHER ☐

2. NAME OF OPERATOR

TEXACO Inc.

3. ADDRESS OF OPERATOR

P. O. Box 728 - Hobbs, New Mexico 88240

4. LOCATION OF WELL (Report location clearly and in accordance with any State requirements.
See also space 17 below.)
At surface:Well is located 2310' from the North Line and 1980' from the
West Line of Section 12, T-25-S, R-31-E, Unit Letter "F",
Eddy County, New Mexico.

11. PERMIT NO.

Regular

12. ELEVATIONS (Show whether DF, RT, GR, etc.)

3457' (DF)

Check Appropriate Box To Indicate Nature of Notice, Report, or Other Data

NOTICE OF INTENTION TO:

TEST WATER SHUT-OFF

FRACTURE TREAT

SHOOT OR ACIDIZE

REPAIR WELL

(Other)

PULL OR ALTER CASING

MULTIPLE COMPLETE

ABANDON*

CHANGE PLANS

SUBSEQUENT REPORT OF:

WATER SHUT-OFF

FRACTURE TREAT

SHOOTING OR ACIDIZING

(Other)

REPAIRING WELL

ALTERING CASING

ABANDONMENT*

17. DESCRIBE PROPOSED OR COMPLETED OPERATIONS. (Clearly state all pertinent details, and give pertinent data, including estimated date of starting any proposed work. If well is directionally drilled, give subsurface locations and measured angles and depths for all markers and zones pertinent to this work.)

Total Depth 16,868'

Plug Back Total Depth 14,728'

9-5/8" OD 53.50# and 47# casing set @ 12,650'

7-5/8" OD 39# P-110 Liner set from 12,270' to 14,680'

5-1/2" OD 23# C-75 Liner set from 14,276' to 16,456'

- Set cement retainer @ 16,300' and squeeze open hole 16,456' - 16,868' w/60 Sx.
Class "H" cement. Plug Back Total Depth 16,300'. Job complete 11:30 PM, May 17, 1970
- Set Otis WC packer @ 14,600'.
- Ran 14,571' (453 joints) - 2-7/8" OD 6.50# (82 joints - 2670')
3-1/2" OD 9.30# (285 joints - 9275')
3-1/2" OD 10.30# (86 joints - 2626')
- Set tubing in packer @ 14,600'.
- Perforate 5-1/2" OD Liner w/2 JSPF from 14,940' - 14,954' and 14,959' - 14,992'.
Test. Pull tubing.
- Set CIBP @ 14,798' and packer @ 14,150'. PBTD 14,798'.
- Ran 14,120' (437 joints) 2-7/8" and 3-1/2" OD tubing and set in packer @ 14,150'.
- Perforate 5-1/2" OD Liner w/4 JSPF from 14,731' - 14,750' and 14,759' - 14,763'.
- Acidize perforations 14,731' - 14,763' w/1000 gals 15% NE Acid w/scale inhibitors and 20% alcohol followed w/1000 gals MA w/scale inhibitor and 20% Alcohol. Follow w/1000 gals 7-1/2% NE Acid w/scale inhibitor and 20% Alcohol. Flush w/brine water.
- Test and place well on production.

18. I hereby certify that the foregoing is true and correct

SIGNED

Assistant District

TITLE

Superintendent

DATE June 23, 1970

(This space for Federal or State office use)

APPROVED BY

TITLE

DATE

CONDITIONS OF APPROVAL, IF ANY:

ACCEPTED FOR RECORD PURPOSES
JUN 26 1970
ACTING District Engineer

*See Instructions on Reverse Side

I, J. A. Schaffer, being of lawful age and being the Assistant District Superintendent for TEXACO Inc., do state that the deviation record which appears on this form is true and correct to the best of my knowledge.

J. A. Schaffer
J. A. Schaffer

Subscribed and sworn to before me this 24th day of June, 1970.

My Commission expires February 24, 1973

B. F. Hohimer
B. F. Hohimer - Notary Public,
in and for Lea County, State of
New Mexico

Lease Cotton Draw Unit

Well No. 68

DEVIATION RECORD

<u>DEPTH</u>	<u>DEGREES OFF</u>
190	3/4
450	3/4
755	1
863	3/4
1,080	1
1,260	1
1,480	1-3/4
1,772	2-1/4
2,085	3
2,504	2-1/2
2,817	3/4
3,100	2
3,351	3/4
3,820	1-1/2
3,996	1-3/4
4,410	1
4,826	1/4
5,288	1/2
5,820	3/4
6,134	1/2
6,636	1
7,176	1
7,650	1
8,140	1/2
8,640	1-3/4
9,140	1-1/4
9,528	1-1/4
10,053	1-1/4
10,600	1-3/4
11,110	1
11,611	1
12,053	1
12,453	1-1/2
12,650	1-1/2
12,791	1-1/4
13,106	1
13,746	1-1/2
13,954	1-1/4
14,296	2
14,507	2
14,665	2-1/2
14,820	1
15,387	2-3/4
16,077	3-1/4
16,400	2-1/4
16,868	2-1/4
16,868 Total Depth	

RECEIVED

JUN 24 1970

O. C. C.
ARTESIA, OFFICE

RECEIVED
JUN 25 1970
U. S. GEOLOGICAL SURVEY
ARTESIA, NEW MEXICO

N. M. D. C. C. COPY
UNITED STATES
DEPARTMENT OF THE INTERIOR
GEOLOGICAL SURVEY

SUBMIT IN DUPLICATE

(See other instructions on reverse side)

Form approved.
Budget Bureau No. 42-R355.5.

WELL COMPLETION OR RECOMPLETION REPORT AND LOG *

1a. TYPE OF WELL: OIL WELL ☐ GAS WELL ☒ DRY ☐ Other ☐

b. TYPE OF COMPLETION: NEW WELL ☒ WORK OVER ☐ DEEP-EN ☐ PLUG BACK ☐ DIFF. RESVR. ☐

2. NAME OF OPERATOR
TEXACO Inc.

3. ADDRESS OF OPERATOR
P.O. Box 728 - Hobbs, New Mexico 88240

4. LOCATION OF WELL (Report location clearly and in accordance with any State requirements)*
At surface **Well is located 2310' from the North Line & 1080' from the West Line of Section 12, T-25-S, R-31-E, Unit 'F', Eddy County, New Mexico.**
At total depth **At surface**

5. LEASE DESIGNATION AND SERIAL NO.
NM-0503

6. IF INDIAN, ALLOTTEE OR TRIBE NAME

7. UNIT AGREEMENT NAME

8. FARM OR LEASE NAME
Cotton Draw Unit

9. WELL NO.
68

10. FIELD AND POOL, OR WILDCAT
Undesignated

11. SEC., T., R., M., OR BLOCK AND SURVEY
Sec. 12, T-25-S, R-31-E Unit Letter 'F'

12. COUNTY OR PARISH
Eddy

13. STATE
New Mexico

14. PERMIT NO.
Regular

DATE ISSUED
Unknown

15. DATE SCHEDULED
June 19, 1970

16. DATE T.D. REACHED
June 9, 1970

17. DATE COMPL. (Ready to prod.)
June 9, 1970

18. ELEVATIONS (DF, RES, RT, GR, ETC.)*
3457' (DF)

19. ELEV. CASINGHEAD
3428'

20. TOTAL DEPTH, MD & TVD
16,868'

21. PLUG, BACK T.D., MD & TVD
14,798'

22. IF MULTIPLE COMPL., HOW MANY*

23. INTERVALS DRILLED BY
0 to 16,868

ROTARY TOOLS
-0-

CABLE TOOLS
-0-

24. PRODUCING INTERVAL(S), OF THIS COMPLETION—TOP, BOTTOM, NAME (MD AND TVD)*
Perforated 5-1/2" OD Liner w/4 JSPF from 14,731'-14,750' & 14,759'-14,763'

25. WAS DIRECTIONAL SURVEY MADE
Yes

26. TYPE ELECTRIC AND OTHER LOGS RUN
Caliper Log, Borehole Compensated Acoustic and Dual Induction Log

27. WAS WELL CORED
No

28. CASING RECORD (Report all strings set in well)

CASING SIZE	WEIGHT, LB./FT.	DEPTH SET (MD)	HOLE SIZE	CEMENTING RECORD	AMOUNT PULLED
20"	94	755'	26"	2100 Sx.	-0-
13-3/8"	48	4415'	17-1/2"	8250 Sx.	-0-
9-5/8"	47 & 52.50	12,650'	12-1/4"	3550 Sx.	-0-

29. LINER RECORD

SIZE	TOP (MD)	BOTTOM (MD)	SACKS CEMENT*	SCREEN (MD)
7-5/8"	12,270'	14,680'	483	---
5-1/2"	14,276'	16,456'	185	---

30. TUBING RECORD

SIZE	DEPTH SET (MD)	PACKER SET (MD)
2-7/8 & 3-1/2"	14,150'	14,150'

31. PERFORATION RECORD (Interval, size and number)
Perforated 5-1/2" OD Liner w/4 JSPF from 14,731' - 14,750' and 14,759' - 14,763'

32. ACID, SHOT, FRACTURE, CEMENT SQUEEZE, ETC.

DEPTH INTERVAL (MD)	AMOUNT AND KIND OF MATERIAL USED
14,731' - 14,763'	1000 gals 15% NE Acid w/20% alcohol
	1000 gals. NA acid w/20% alcohol
	1000 gals. 7-1/2% NE acid w/20% alcohol

33. PRODUCTION

DATE FIRST PRODUCTION
6-18-70

PRODUCTION METHOD (Flowing, gas lift, pumping—size and type of pump)
Flow

WELL STATUS (Producing or shut-in)
Producing

DATE OF TEST
6-18-70

HOURS TESTED
24 Hr. Rate

CHOKE SIZE
14/64"

PROD'N. FOR TEST PERIOD

OIL—BBL.
-0-

GAS—MCF.
1650 MCFD

WATER—BBL.
-0-

GAS-OIL RATIO
-

FLOW. TUBING PRESS.
5995

CASING PRESSURE
-

CALCULATED 24-HOUR RATE

OIL—BBL.
-

GAS—MCF.
1650 MCFD

WATER—BBL.
-0-

OIL GRAVITY-API (CORR.)
-0-

34. DISPOSITION OF GAS (Sold, used for fuel, vented, etc.)
Vented

TEST WITNESSED BY
B. C. O'Kief

35. LIST OF ATTACHMENTS

36. I hereby certify that the foregoing and attached information is complete and correct as determined from all available records

SIGNED **[Signature]** TITLE **Assistant District Superintendent** DATE **June 23, 1970**

*(See Instructions and Spaces for Additional Data on Reverse Side)

INSTRUCTIONS

General: This form is designed for submitting a complete and correct well completion report and log on all types of lands and leases to either a Federal agency or a State agency, or both, pursuant to applicable Federal and/or State laws and regulations. Any necessary special instructions concerning the use of this form and the number of copies to be submitted, particularly with regard to local, area, or regional procedures and practices, either are shown below or will be issued by, or may be obtained from, the local Federal and/or State office. See instructions on Items 22 and 24, and 38, below regarding separate reports for separate completions.

If not filed prior to the time this summary record is submitted, copies of all currently available logs (drillers, geologists, sample and core analysis, all types electric, etc.), formation and pressure tests, and directional surveys, should be attached hereto, to the extent required by applicable Federal and/or State laws and regulations. All attachments should be listed on this form, see Item 35.

Item 4: If there are no applicable State requirements, locations on Federal or Indian land should be described in accordance with Federal requirements. Consult local State or Federal office for specific instructions.

Item 18: Indicate which elevation is used as reference (where not otherwise shown) for depth measurements given in other spaces on this form and in any attachments.

Items 22 and 24: If this well is completed for separate production from more than one interval zone (multiple completion), so state in Item 22, and in Item 24 show the producing interval, or intervals, top(s), bottom(s) and name(s) (if any) for only the interval reported in Item 38. Submit a separate report (page) on this form, adequately identified, for each additional interval to be separately produced, showing the additional data pertinent to such interval.

Item 29: "Sacks Cement": Attached supplemental records for this well should show the details of any multiple stage cementing and the location of the cementing tool.

Item 33: Submit a separate completion report on this form for each interval to be separately produced. (See instruction for Items 22 and 24 above.)

37. SUMMARY OF POROUS ZONES:				38. GEOLOGIC MARKERS	
SHOW ALL IMPORTANT ZONES OF POROSITY AND CONTENTS THEREOF: CORED INTERVALS; AND ALL DRILL-STEM TESTS, INCLUDING DEPTH INTERVAL TESTED, CUSHION USED, TIME TOOL OPEN, FLOWING AND SHUT-IN PRESSURES, AND RECOVERIES					
FORMATION	TOP	BOTTOM	DESCRIPTION, CONTENTS, ETC.	NAME	MEAS. DEPTH TRUE VERT. DEPTH
			DST #1 - 16,456' - 16,548' Tool open 1-1/2 hr. w/weak blow. Final flow 4 hr. 50 mins. Rec 558' Gas Cut water blanket, 2232' Gas Cut Mud.	Lamar Lime	4380'
				Delaware Sand	4420'
				Bone Springs	8315'
				Dean Sand	11,015'
			DST #2 - 16,456' - 16,660' Tool open 85 mins w/weak blow. No fluid to surface. Final Flow 3 hrs. Rec 4320' Gas Cut Mud. Gas rate @ 340 MCFD.	Wolfcamp	12,890'
				Strom	13,720'
				Morrow SL-Low	14,940'
				Lower Miss.	16,110'
				Devonian	16,528'
			DST #3 - 16,456' - 16,868' Tool open 1-1/2 hr. w/weak blow. Final Flow 3 hrs. Rec 2700' Gas and salt water, 7900' Salt Water. Gas rate 1STM.		

OIL CONSERVATION COMMISSION

BOX 1930

HOBBS, NEW MEXICO

RECEIVED

JUL 28 1970

O.C.C.
ARTESIA, OFFICE

NOTICE OF GAS CONNECTION

DATE July 24, 1970

This is to notify the Oil Conservation Commission that connection for
the purchase of gas from the Texaco, Incorporated Cotton Draw Unit
Operator. Lease

#68 F 12-25-31 Paduca Morrow EPNG
Well Unit S.T.R. Pool Name of Purchaser

was made on July 24, 1970

El Paso Natural Gas Company
Purchaser

Thomas R. E. Smith
Representative

Gas Production Status Analyst
Title

cc: To operator
Oil Conservation Commission - Santa Fe
H. P. Logan
T. J. Crutchfield
Proration Department
File
Oil Conservation Commission - Artesia (2)

NO. OF COPIES RECEIVED	6
DISTRIBUTION	
SANTA FE	
FILE	
U.S.G.S.	
LAND OFFICE	
TRANSPORTER	OIL GAS
OPERATOR	
PRORATION OFFICE	

**NEW MEXICO OIL CONSERVATION COMMISSION
REQUEST FOR ALLOWABLE
AND
AUTHORIZATION TO TRANSPORT OIL AND NATURAL GAS**

Form C-104
Supersedes Old C-104 and C-110
Effective 1-1-65

RECEIVED

JUN 25 1970

I. OPERATOR

Operator **TEXACO Inc.**

Address **P. O. Box 728 - Hobbs, New Mexico 88240**

**O. C. C.
ARTESIA, OFFICE**

Reason(s) for filing (Check proper box)

New Well <input checked="" type="checkbox"/>	Change in Transporter of:	Other (Please explain)
Recompletion <input type="checkbox"/>	Oil <input type="checkbox"/>	New Well
Change in Ownership <input type="checkbox"/>	Casinghead Gas <input type="checkbox"/>	
	Dry Gas <input type="checkbox"/>	
	Condensate <input type="checkbox"/>	

If change of ownership give name and address of previous owner

II. DESCRIPTION OF WELL AND LEASE

Lease Name Cotton Draw Unit	Well No. 68	Pool Name, Including Formation Undesignated	Kind of Lease State, Federal or Fee	Lease No. NM-0503
Location				
Unit Letter F	2310	Feet From The North	Line and 1980	Feet From The West
Line of Section 12	Township 25-S	Range 31-E	NMPM	Eddy County

III. DESIGNATION OF TRANSPORTER OF OIL AND NATURAL GAS

Name of Authorized Transporter of Oil <input type="checkbox"/> or Condensate <input type="checkbox"/>	Address (Give address to which approved copy of this form is to be sent)
None	
Name of Authorized Transporter of Casinghead Gas <input type="checkbox"/> or Dry Gas <input checked="" type="checkbox"/>	Address (Give address to which approved copy of this form is to be sent)
P. Paso Natural Gas Co., TEXACO Inc.	P.O. Box 1384, Jal, New Mexico 88252 P.O. Box 728, Hobbs, New Mexico 88240
If well produces oil or liquids, give location of tanks.	Is gas actually connected? Yes
Unit	When actually connected? June 23, 1970

If this production is commingled with that from any other lease or pool, give commingling order number: ***50% Each on Split Connection**

IV. COMPLETION DATA

Designate Type of Completion - (X)	Oil Well <input type="checkbox"/>	Gas Well <input checked="" type="checkbox"/>	New Well <input checked="" type="checkbox"/>	Workover <input type="checkbox"/>	Deepen <input type="checkbox"/>	Plug Back <input type="checkbox"/>	Same Resv. <input type="checkbox"/>	Diff. Resv. <input type="checkbox"/>
Date Spudded December 19, 1969	Date Compl. Ready to Prod. June 9, 1970	Total Depth 16,868'	P.B.T.D. 14,798'					
Elevations (DF, RKB, RT, CR, etc.) 3457' (DF)	Name of Producing Formation Morrov	Top Oil/Gas Pay 14,731'	Tubing Depth 14,150'					
Perforations Perforated w/4 JSPP from 14,731' - 14,750' & 14,759' - 14,763'		Depth Casing Shoe 16,868'						

TUBING, CASING, AND CEMENTING RECORD

HOLE SIZE	CASING & TUBING SIZE	DEPTH SET	SACKS CEMENT
26"	20"	755'	2100
17-1/2"	13-3/8"	4415'	8250
12-1/4"	9-5/8"	12,650'	3550
8-1/2"	7-5/8" Liner	14,680'	483
6-1/2"	5-1/2" Liner	16,436'	105

V. TEST DATA AND REQUEST FOR ALLOWABLE OIL WELL

(Test must be after recovery of total volume of load oil and must be equal to or exceed top allowable for this depth or be for full 24 hours)

Date First New Oil Run To Tanks	Date of Test	Producing Method (Flow, pump, gas lift, etc.)	
Length of Test	Tubing Pressure	Casing Pressure	Choke Size
Actual Prod. During Test	Oil-Bbls.	Water-Bbls.	Gas-MCF

GAS WELL

Actual Prod. Test-MCF/D 1650 MCFD	Length of Test 24 Hours	Bbls. Condensate/MMCF -0-	Gravity of Condensate -0-
Testing Method (prior, back pr.) Back Pressure	Tubing Pressure (Shut-in) 5995	Casing Pressure (Shut-in) -	Choke Size 14/64"

VI. CERTIFICATE OF COMPLIANCE

I hereby certify that the rules and regulations of the Oil Conservation Commission have been complied with and that the information given above is true and complete to the best of my knowledge and belief.

OIL CONSERVATION COMMISSION

JUL 17 1970

APPROVED _____, 19____

BY *W. A. Gressett*

TITLE **OIL AND GAS INSPECTOR**

This form is to be filed in compliance with RULE 1104.

If this is a request for allowable for a newly drilled or deepened well, this form must be accompanied by a tabulation of the deviation tests taken on the well in accordance with RULE 111.

All sections of this form must be filled out completely for allowable on new and recompleted wells.

Fill out only Sections I, II, III, and VI for changes of owner, well name or number, or transporter, or other such change of condition.

Separate Forms C-104 must be filed for each pool in multiply

Assistant District Superintendent

June 24, 1970

UNITED STATES N. M. O. C. G. S.
DEPARTMENT OF THE INTERIOR
GEOLOGICAL SURVEYForm approved
Budget Bureau No. 42-R1424.

5. LEASE DESIGNATION AND SERIAL NO.

111 - 0573

6. IF INDIAN, ALLOTTEE OR TRIBE NAME

7. UNIT AGREEMENT NAME

8. FARM OR LEASE NAME

Cotton Draw Unit

9. WELL NO.

68

10. FIELD AND POOL, OR WILDCAT

Paduca Morrow Gas

11. SEC. T., R., M., OR BLE. AND
SURVEY OR AREA

Sec. 12, T-25-S, R-31-E

12. COUNTY OR PARISH

Eddy

13. STATE

New Mexico

1.

OIL WELL ☐ GAS WELL ☒ OTHER

2. NAME OF OPERATOR

TEXACO INC. ✓

3. ADDRESS OF OPERATOR

P. O. Box 728 - Hobbs, New Mexico 88240

4. LOCATION OF WELL (Report location clearly and in accordance with any State requirements.*

See also space 17 below.)
At surfaceWell is located 2310' from the North line and 1920' from
the West line.

14. PERMIT NO.

Regular

15. ELEVATIONS (Show whether DF, RT, OR, etc.)

3457' (DF)

16.

Check Appropriate Box To Indicate Nature of Notice, Report, or Other Data

NOTICE OF INTENTION TO:

TEST WATER SHUT-OFF

FRACTURE TREAT

SHOOT OR ACIDIZE

REPAIR WELL

(Other)

PULL OR ALTER CASING

MULTIPLE COMPLETE

ABANDON*

CHANGE PLANS

SUBSEQUENT REPORT OF:

WATER SHUT-OFF

FRACTURE TREATMENT

SHOOTING OR ACIDIZING

(Other)

REPAIRING WELL

ALTERING CASING

ABANDONMENT*

(Note: Report results of multiple completion on Well
Completion or Recompletion Report and Log form.)17. DESCRIBE PROPOSED OR COMPLETED OPERATIONS (Clearly state all pertinent details, and give pertinent dates, including estimated date of starting any
proposed work. If well is directionally drilled, give subsurface locations and measured and true vertical depths for all markers and zones perti-
nent to this work.)*

REMARKS

1. Well Status - TR-NG (To Be Reconditioned-Natural Gas)

2. Temporary Abandonment Date - December 4, 1975

3. Reason for Abandonment - Low gas production makes well uneconomical
to produce.4. Future Plans - Remedial work to acidize Cotton Draw Unit No. 67 will
start in the very near future. If remedial work proves
to be successful, similar work will be performed on
No. 68.

5. Date of Future Workover or Plugging - 1976

RECEIVED

DEC 10 1975

D. C. C.
ARTESIA, OFFICERECEIVED
U. S. GEO. SURVEY
ARTESIA, NEW MEXICO

18. I hereby certify that the foregoing is true and correct

SIGNED

TITLE Asst. District Supt.

DATE

12-5-75

(This space for Federal or State office use)

APPROVED BY
CONDITIONS OF APPROVAL IF ANY:UNLESS FURTHER APPROVED, WELL MUST
BE PUT TO BENEFICIAL USE OR PLUGGED BY
APRIL - OCTOBER 1 - 1976

DATE

*See Instructions on Reverse Side

UNITED STATES
DEPARTMENT OF THE INTERIOR
GEOLOGICAL SURVEYSUBMIT ON REVERSE SIDE
(Other Instructions)TE-
re-Form approved. *Copy to SF*
Budget Bureau No. 42-R1424

DESIGNATION AND SERIAL NO.

NM - 0503

INDIAN, ALLOTTEE OR TRIBE NAME

FUND AGREEMENT NAME

FARM OR LEASE NAME

Cotton Draw Unit

WELL NO.

68

FIELD AND POOL, OR WILDCAT

Paduca Morrow Gas

SEC., T., R., M., OR BLK. AND
SURVEY OR AREA

Sec. 12, T-25-S, R-31-E

COUNTY OR PARISH

Eddy

STATE

New Mexico

SUNDRY NOTICES AND REPORTS ON WELLS

(Do not use this form for proposals to drill or to deepen or plug back to a different reservoir.
Use "APPLICATION FOR PERMIT" for such proposals.)

RECEIVED

MAR 30 1976

O. C. C.

ARTESIA, OFFICE

1. OIL WELL ☐ GAS WELL ☒ OTHER

2. NAME OF OPERATOR

TEXACO INC. ✓

3. ADDRESS OF OPERATOR

P. O. Box 728 - Hobbs, New Mexico 88240

4. LOCATION OF WELL (Report location clearly and in accordance with any State requirements.
See also space 17 below.)
At surfaceWell is located 2310' from the North line and
1980' from the West line.

14. PERMIT NO.

Regular

15. ELEVATIONS (Show whether of, to, or, etc.)

3457' (DF)

16. Check Appropriate Box To Indicate Nature of Notice, Report, or Other Data

NOTICE OF INTENTION TO:

TEST WATER SHUT-OFF

FRACTURE TREAT

SHOOT OR ACIDIZE

REPAIR WELL

(Other) Extension

PULL OR ALTER CASING

MULTIPLE COMPLETE

ABANDON*

CHANGE PLANS

SUBSEQUENT REPORT OF:

WATER SHUT-OFF

FRACTURE TREATMENT

SHOOTING OR ACIDIZING

(Other)

REPAIRING WELL

ALTERING CASING

ABANDONMENT*

(Note: Report results of multiple completion on Well
Completion or Recompletion Report and Log form.)17. DESCRIBE PROPOSED OR COMPLETED OPERATIONS (Clearly state all pertinent details, and give pertinent dates, including estimated date of starting any
proposed work. If well is directionally drilled, give subsurface locations and measured and true vertical depths for all markers and zones perti-
nent to this work.)

REMARKS:

1. Well Status - TR-NG (To Be Reconditioned-Natural Gas)
2. Temporary Abandonment Date - December 4, 1975
3. Reason for Abandonment - Low gas production makes well uneconomical to produce.
4. Future Plans - Remedial work will be performed to open the Atoka formation.
5. Date of Future Workover or Plugging - June, 1976

RECEIVED

MAR 22 1976

U S GEOLOGICAL SURVEY
ARTESIA, NEW MEXICO

18. I hereby certify that the foregoing is true and correct

SIGNED

TITLE Asst. District Supt.

DATE 3-18-76

(This space for Federal or State office use)

APPROVED BY
CONDITIONS OF APPROVAL, IF ANY:

TITLE

UNLESS FURTHER APPROVED, WELL MUST
BE PUT TO BENEFICIAL USE OR PLUGGED BY
DATE OCT 1 - 1976
*See Instructions on Reverse Side

DATE

MAR 22 1976

L. BEEKHUIS
ACTING DISTRICT ENGINEER

UNITED STATES
DEPARTMENT OF THE INTERIOR
GEOLOGICAL SURVEYSUBMIT IN TRIPL
(Other instructions
reverse side)Form approved.
Budget Bureau No. 42-R1424.

SUNDRY NOTICES AND REPORTS ON WELLS

(Do not use this form for proposals to drill or to deepen or plug back to a different reservoir.
Use "APPLICATION FOR PERMIT—" for such proposals.)

1. OIL WELL <input type="checkbox"/> GAS WELL <input checked="" type="checkbox"/> OTHER <input type="checkbox"/>		2. NAME OF OPERATOR TEXACO INC.		3. ADDRESS OF OPERATOR P.O. Box 728 - Hobbs, New Mexico		4. LOCATION OF WELL (Report location clearly and in accordance with any State requirements. See also space 17 below.) At surface Well is located 2310' from the North line and 1930' from the West line.		5. LEASE DESIGNATION AND SERIAL NO. NM - 0503		6. IF INDIAN, ALLOTTEE OR TRIBE NAME		7. UNIT AGREEMENT NAME		8. FARM OR LEASE NAME Cotton Draw Unit		9. WELL NO. 69		10. FIELD AND POOL, OR WILDCAT Paduca Morrow Gas		11. SEC., T., R., M., OR BLK. AND SURVEY OR AREA Sec. 12, T-25-S, R-31-E		12. COUNTY OR PARISH Eddy		13. STATE New Mexico	
14. PERMIT NO. Regular		15. ELEVATIONS (Show whether DT, RT, GR, etc.) 3457' (DF)																							

16. Check Appropriate Box To Indicate Nature of Notice, Report, or Other Data

NOTICE OF INTENTION TO:

TEST WATER SHUT-OFF

FRACTURE TREAT

SHOOT OR ACIDIZE

REPAIR WELL

(Other) Extension

PULL OR ALTER CASING

MULTIPLE COMPLETION

ABANDON*

CHANGE PLANS

SUBSEQUENT REPORT OF:

WATER SHUT-OFF

FRACTURE TREATMENT

SHOOTING OR ACIDIZING

(Other)

REPAIRING WELL

ALTERING CASING

ABANDONMENT*

(Note: Report results of multiple completion on Well Completion or Recompletion Report and Log form.)

17. DESCRIBE PROPOSED OR COMPLETED OPERATIONS (Clearly state all pertinent details, and give pertinent dates, including estimated date of starting any proposed work. If well is directionally drilled, give subsurface locations and measured and true vertical depths for all markers and zones pertinent to this work.)

REMARKS:

- Well Status - TP-NG (To Be Reconditioned-Natural Gas)
- Temporary Abandonment Date - December 4, 1975
- Reason for Abandonment - Low gas production makes well uneconomical to produce.
- Future Plans - Remedial work will be performed to open the Atoka formation.
- Date of Future Workover or Plugging - September, 1976

RECEIVED
AUG 04 1976
U.S. GEOLOGICAL SURVEY
ARTESIA, NEW MEXICO

18. I hereby certify that the foregoing is true and correct

SIGNED

TITLE Asst. District Supt.

DATE 8-3-76

(This space for Federal or State office use)

TITLE

DATE

APPROVED
REASONS OF APPROVAL, IF ANY:AUG 7 1976
J. L. BEEKINWAY
ACTING DISTRICT ENGINEER

*See Instructions on Reverse Side

UNITED STATES
DEPARTMENT OF THE INTERIOR
GEOLOGICAL SURVEY

SUBMIT IN TRIPLICATE
(Other instructions on
reverse side)

Form approved
Budget Bureau No. 42-R1424.

SUNDRY NOTICES AND REPORTS ON WELLS

(Do not use this form for proposals to drill or to deepen or plug back to a different reservoir.
Use "APPLICATION FOR PERMIT" for such proposals.)

<p>1. <input type="checkbox"/> OIL WELL <input type="checkbox"/> GAS WELL <input checked="" type="checkbox"/> OTHER</p> <p>2. NAME OF OPERATOR TEXACO Inc.</p> <p>3. ADDRESS OF OPERATOR P. O. Box 728 - Hobbs, New Mexico 88240</p> <p>4. LOCATION OF WELL (Report location clearly and in accordance with any State requirements. See also space 17 below.) At surface Well is located 2310' FNL & 1930' FNL of Section 12, T-25-S, R-31-E, Unit Letter 'F', Eddy County, New Mexico.</p> <p>14. PERMIT NO. Regular</p>	<p>5. LEASE DESIGNATION AND SERIAL NO. NM - 0503</p> <p>6. IF INDIAN, ALLOTTEE OR TRIBE NAME</p> <p>7. UNIT AGREEMENT NAME</p> <p>8. FARM OR LEASE NAME Cotton Draw Unit</p> <p>9. WELL NO. 68</p> <p>10. FIELD AND POOL, OR WILDCAT Paduca Morrow Gas</p> <p>11. SEC., T., R., M., OR BLK. AND SURVEY OR AREA Sec. 12, T-25-S, R-31-E</p> <p>12. COUNTY OR PARISH Eddy</p> <p>13. STATE New Mexico</p>
<p>15. ELEVATIONS (Show whether DF, RT, GR, etc.) 3457' (DF)</p>	

16. Check Appropriate Box To Indicate Nature of Notice, Report, or Other Data

NOTICE OF INTENTION TO:

TEST WATER SHUT-OFF <input type="checkbox"/>	PULL OR ALTER CASING <input type="checkbox"/>
FRACTURE TREAT <input type="checkbox"/>	MULTIPLE COMPLETE <input type="checkbox"/>
SHOOT OR ACIDIZE <input type="checkbox"/>	ABANDON* <input checked="" type="checkbox"/>
REPAIR WELL <input type="checkbox"/>	CHANGE PLANS <input type="checkbox"/>

(Other) *Morrow - Recomplete in Wolf- ☒ camp

SUBSEQUENT REPORT OF:

WATER SHUT-OFF <input type="checkbox"/>	REPAIRING WELL <input type="checkbox"/>
FRACTURE TREATMENT <input type="checkbox"/>	ALTERING CASING <input type="checkbox"/>
SHOOTING OR ACIDIZING <input type="checkbox"/>	ABANDONMENT* <input type="checkbox"/>

(Other) _____

(NOTE: Report results of multiple completion on Well Completion or Recompletion Report and Log form.)

17. DESCRIBE PROPOSED OR COMPLETED OPERATIONS (Clearly state all pertinent details, and give pertinent dates, including estimated date of starting any proposed work. If well is directionally drilled, give subsurface locations and measured and true vertical depths for all markers and zones pertinent to this work.)*

1. Rig up. Kill well. Install BOP. Pull production equipment.
2. Set CIBP @ 14,100'. Dump 10 sx Class H Cement on plug. Abandon Morrow zone.
3. Perforate 5-1/2" OD csg w/1 JSPF in Wolfcamp @ 12,895', 12,939', 44', 63', 68' & 12,972'.
4. If necessary, acidize perforations 12,895'-12,972' w/3000 gals 20% super retarded acid containing 350 SCF Nitrogen/bbl.
5. Flush w/2% KCL water. Swab.
6. Install production equipment. Test and place on production.

RECEIVED RECEIVED

JUL 21 1976

JUL 19 1976

O. C. C.
ARTESIA, OFFICE

U. S. GEOLOGICAL SURVEY
ARTESIA, NEW MEXICO

18. I hereby certify that the foregoing is true and correct

SIGNED *[Signature]* TITLE Asst. Dist. Supt. DATE 7-15-76

(This space for Federal or State office use)

APPROVED BY *[Signature]* TITLE _____ DATE _____

CONDITIONS OF APPROVAL IF ANY:

JUL 19 1976
L. L. BECKWITH
ACTING DISTRICT ENGINEER

*See Instructions on Reverse Side

GEOLOGICAL SURVEY WELL STATUS REPORT

(To be submitted in quintuplicate on all inactive wells)

NAME AND ADDRESS OF OPERATOR

TEXACO INC. - P. O. Box 728 - Hobbs, New Mexico 88240

WELL NO. AND LEASE NAME

Cotton Draw Unit No. 68

LEASE NO.

NM-0503

Section

12

Township

25-S

Range

31-E

Footage Location of Well:

2310 feet from North line

1980 feet from West line

Pool

Paduca Morrow

COUNTY

Eddy

STATE

New Mexico

1. When Was Well Shut-in or Last Produced?

November, 1975

RECEIVED

NOV 3 1976

2. Type Well

☐

Oil Well

☒

Gas Well

☒

Temp. Abd. Well

O. G. C.

ARTESIA, OFFICE

3. Producing Capability

BOPD

MCFGPD 78

BWPD

Date Last Tested November, 1975

4. Is Well Considered Capable of Production in Paying Quantities?

☐

Yes

☒

No

5. If Capable of Producing in Paying Quantities, Give Reasons For Not Producing Well.

RECEIVED

OCT 19 1976

6. If Not Capable of Producing in Paying Quantities, Give Reasons For Not Producing Well At This Time.

The Wolfcamp formation will be tested before plugging.

RECEIVED
OCT 19 1976
GEOLOGICAL SURVEY
ARTESIA, NEW MEXICO

7. What Are Future Plans For Operating Well (Include Estimated Dates)?

Remedial work will be performed in the first quarter of 1977 to recomplete in the Wolfcamp formation.

I hereby certify that the foregoing is true and correct

SIGNED

TITLE

Asst. Dist. Supt.

DATE

10-18-76

(This space for Federal or State office use)

APPROVED BY

TITLE

ACTING DISTRICT ENGINEER

DATE

NOV 2 1976

CONDITIONS OF APPROVAL, IF ANY:

UNLESS FURTHER APPROVED, WELL MUST
BE PUT TO BENEFICIAL USE OR PLUGGED BY
APRIL OCTONE

OCT 17 - 1977

UNITED STATES DEPARTMENT OF THE INTERIOR
GEOLOGICAL SURVEY

MOCC COPY

SUBMIT IN TRIPlicate
(Other instructions on
reverse side)

Form approved.
Budget Bureau No. 42-R1424.

SUNDRY NOTICES AND REPORTS ON WELLS

(Do not use this form for proposals to drill or to deepen or plug back to a different reservoir.
Use "APPLICATION FOR PERMIT" for such proposals.)

RECEIVED

1. OIL WELL ☐ GAS WELL ☒ OTHER ☐

2. NAME OF OPERATOR TEXACO Inc.

3. ADDRESS OF OPERATOR P.O. Box 728 Hobbs, New Mexico 88240

4. LOCATION OF WELL (Report location clearly and in accordance with any State requirements.
See also space 17 below.)
At surface 2310' FNL & 1980' FWL Sec 12, T-25-S, R-31-E, Unit "F" Eddy County, New Mexico

MAY 10 1977

O. C. C.
OFFICE

5. LEASE DESIGNATION AND SERIAL NO. NM 503

6. IF INDIAN, ALLOTTEE OR TRIBE NAME

7. UNIT AGREEMENT NAME

8. FARM OR LEASE NAME Cotton Draw Unit

9. WELL NO. 68

10. FIELD AND POOL, OR WILDCAT Packee Wolfcamp

11. SEC., T., R., M., OR BLK. AND SURVEY OR AREA Sec 12, T-25-S, R-31-E.

12. COUNTY OR PARISH Eddy 13. STATE NM

14. PERMIT NO. Regular

15. ELEVATIONS (Show whether DF, RT, GR, etc.) 3457' (DF)

16. Check Appropriate Box To Indicate Nature of Notice, Report, or Other Data

NOTICE OF INTENTION TO:

TEST WATER SHUT-OFF <input type="checkbox"/>	PULL OR ALTER CASING <input type="checkbox"/>
FRACTURE TREAT <input type="checkbox"/>	MULTIPLE COMPLETE <input type="checkbox"/>
SHOOT OR ACIDIZE <input type="checkbox"/>	ABANDON* <input type="checkbox"/>
REPAIR WELL <input type="checkbox"/>	CHANGE PLANS <input type="checkbox"/>
(Other) <input type="checkbox"/>	

SUBSEQUENT REPORT OF:

WATER SHUT-OFF <input type="checkbox"/>	REPAIRING WELL <input type="checkbox"/>
FRACTURE TREATMENT <input type="checkbox"/>	ALTERING CASING <input type="checkbox"/>
SHOOTING OR ACIDIZING <input type="checkbox"/>	ABANDONMENT* <input checked="" type="checkbox"/>
(Other) <u>Morrow Recompl in Wlfcamp</u> <input checked="" type="checkbox"/>	

(NOTE: Report results of multiple completion on Well Completion or Recompletion Report and Log form.)

17. DESCRIBE PROPOSED OR COMPLETED OPERATIONS (Clearly state all pertinent details, and give pertinent dates, including estimated date of starting any proposed work. If well is directionally drilled, give subsurface locations and measured and true vertical depths for all markers and zones pertinent to this work.)

1. Rigged up, kill well. Install BOP. Pulled tubing.
2. Set CIBP @ 14,070' and spot 10 sx cement on plug from 14,070' to 14,030'. Morrow Zone abandoned.
3. Set packer @ 12,855'. Perforate w/1-JSPF @ 12,895', 939', 44', 63', 68', & 12,972'.
4. Install production equipment. On 24 hr PT ending 5-2-77, Well produced 5 bbls. Condensate & 1.9 MMCF gas. Well completed in Wolfcamp.

RECEIVED

MAY 06 1977

U.S. GEOLOGICAL SURVEY
ARTESIA, NEW MEXICO

18. I hereby certify that the foregoing is true and correct

SIGNED [Signature] TITLE Asst. Dist. Supt. DATE 5-5-77

(This space for Federal or State office use)

APPROVED BY [Signature] TITLE ACTING DISTRICT ENGINEER DATE MAY 9 - 1977

CONDITIONS OF APPROVAL, IF ANY:

*See Instructions on Reverse Side

RECEIVED

MAY 16 1977

O. C. C.
MEDIA. OFFICE



PETROLEUM PRODUCTS
May 12, 1977

TEXACO INC.
DRAWER 728
HOBBS, NEW MEXICO 88240

Cotton Draw Unit Well #68
Wolfcamp Zone

New Mexico Oil Conservation Commission
Drawer DD
Artesia, New Mexico 88210

Attention: Mr. W. A. Gressett

Gentlemen:

The subject well was recompleted in the Wolfcamp Zone on April 25, 1977, and flowed at 1,000 MCFD rate until May 6, 1977, at which time it was shut in for a seventy-two hour build-up prior to multi-point back pressure test. The well head pressure was recorded at 4202 psig after the seventy-two hour build-up from the original 8100 psig and building at a rate of 8 psi per hour. The well was put back on production.

It appears from the above that the well is either being depleted at a rapid rate or that the producing zone is extremely dense, which in either case, it would be very difficult to conduct a reliable test. Therefore, Texaco requests an exemption from Rule 1122 (4 Point Test) and to continue to produce the well until depletion.

Yours very truly,

J. V. GANNON
District Superintendent

REL:dl

RVS



Working to keep
your trust for
75 years

NEW MEXICO OIL CONSERVATION COMMISSION
WELL LOCATION AND ACREAGE DEDICATION PLAT

Form C-102
Supersedes C-128
Effective 1-1-65

All distances must be from the outer boundaries of the Section.

Operator TEXACO Inc.			Lease Cotton Draw Unit		Well No. 68
Unit Letter F	Section 12	Township 25 South	Range 31 East	County Eddy	
Actual Footage Location of Well: 2310 feet from the North line and 1980 feet from the West line Sec. 12					
Ground Level Elev. 3434'	Producing Formation Wolfcamp (Gas)		Pool Wolfcamp (Gas)	Dedicated Acreage: 320 Acres	

1. Outline the acreage dedicated to the subject well by colored pencil or hachure marks on the plat below.
2. If more than one lease is dedicated to the well, outline each and identify the ownership thereof (both as to working interest and royalty).
3. If more than one lease of different ownership is dedicated to the well, have the interests of all owners been consolidated by communitization, unitization, force-pooling, etc?

☒ Yes ☐ No If answer is "yes," type of consolidation Unitization & Development Agreement

If answer is "no," list the owners and tract descriptions which have actually been consolidated. (Use reverse side of this form if necessary.)

No allowable will be assigned to the well until all interests have been consolidated (by communitization, unitization, forced-pooling, or otherwise) or until a non-standard unit, eliminating such interests, has been approved by the Commission.

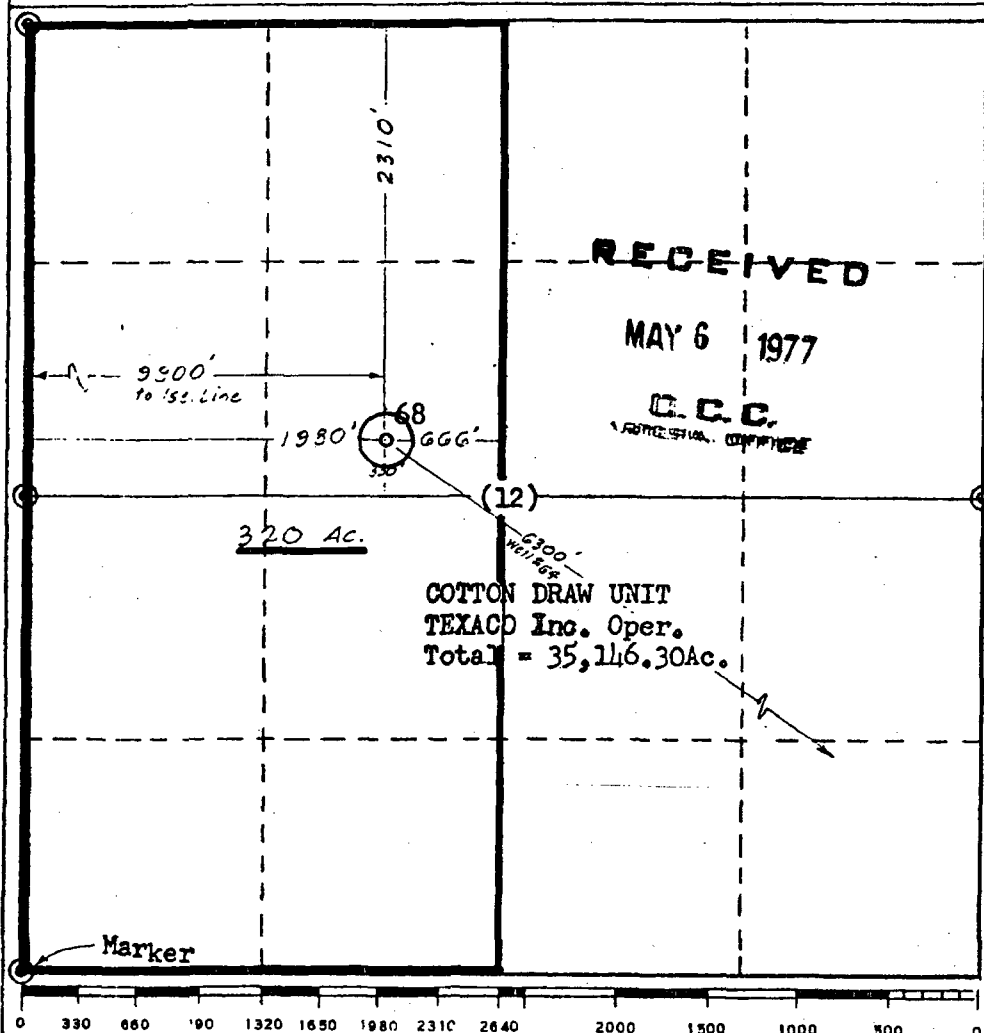

CERTIFICATION

I hereby certify that the information contained herein is true and complete to the best of my knowledge and belief.

B. L. Eiland
Name
B. L. Eiland

Position
Division Surveyor

Company
Texaco Inc.

Date
March 18, 1977

I hereby certify that the well location shown on this plot was plotted from field notes of actual surveys made by me or under my supervision, and that the same is true and correct to the best of my knowledge and belief.

Date Surveyed

12/2/69

Registered Professional Engineer and/or Land Surveyor

B. L. Eiland
B. L. Eiland

Certificate No.

4386

UNITED STATES
DEPARTMENT OF THE INTERIOR
GEOLOGICAL SURVEY

SUBMIT IN DUPLICATE

(Set in-
struc- s on
reverse side)Copy 10-37
Form approved
Budget Bureau No. 42-R355.5.

WELL COMPLETION OR RECOMPLETION REPORT AND LOG*

5. LEASE DESIGNATION AND SERIAL NO.

NM-0503

6. IF INDIAN, ALLOTTEE OR TRIBE NAME

UNIT AGREEMENT NAME

5. FARM OR LEASE NAME

Cotton Draw Unit

9. WELL NO.

68

10. FIELD AND POOL, OR WILDCAT

Pacifica Wolfcamp

11. SEC. T. R. M. OR BLOCK AND SURVEY
OR AREA

Sec 12, T-25-S, R-31-E

1a. TYPE OF WELL: OIL WELL ☐ GAS WELL ☒ DRY ☐ Other: **RECEIVED**

b. TYPE OF COMPLETION:

NEW WELL ☐ WORK OVER ☒ DEEP-EN ☐ PLUG BACK ☒ DIFF. RESVR. ☒ Other: **MAY 10 1977**

2. NAME OF OPERATOR

TEXACO Inc.

3. ADDRESS OF OPERATOR

P.O. Box 728 Hobbs, New Mexico 88240 **D.C.C. ARTESIA, OFFICE**

4. LOCATION OF WELL (Report location clearly and in accordance with any State requirements)*

At surface 2310' FNL & 1980' FWL of Section 12, T-25-S,
R-31-E

At top prod. interval reported below Unit Letter 'F' Eddy Co, NM

At total depth

14. PERMIT NO.

DATE ISSUED

Regular

Unknown

12. COUNTY OR
PARISH

Eddy

13. STATE

NM

15. DATE SPUDDED

12-19-69

16. DATE T.D. REACHED

17. DATE COMPL. (Ready to prod.)

5-2-77

18. ELEVATIONS (DF, RES, RT, OR, ETC.)*

3457' (DF)

19. ELEV. CASINGHEAD

3428'

20. TOTAL DEPTH, MD & TVD

16,868

21. PLUG, BACK T.D., MD & TVD

14,030'

22. IF MULTIPLE COMPL.,
HOW MANY*23. INTERVALS
DRILLED BY

b-16,868

ROTARY TOOLS

CABLE TOOLS

-0-

24. PRODUCING INTERVAL(S), OF THIS COMPLETION—TOP, BOTTOM, NAME (MD AND TVD)*

Perforate 7 5/8" Csg w/1-JSPF @ 12,895, 939', 44', 63', 68',
& 12,972'.25. WAS DIRECTIONAL
SURVEY MADE

Yes

26. TYPE ELECTRIC AND OTHER LOGS RUN on original completion

27. WAS WELL CORRED

Borehole compensated Acoustic, Caliper Log, Dual Induction

No

28. CASING RECORD (Report all strings set in well) Log

CASING SIZE	WEIGHT, LB./FT.	DEPTH SET (MD)	HOLE SIZE	CEMENTING RECORD	AMOUNT PULLED
20"	94#	755'	26"	2100 SX	-0-
13 3/8"	48#	4415'	17 1/2"	8250 SX	-0-
9 5/8"	47.50, 53#	12,650'	12 1/4"	3550 SX	-0-

29. LINER RECORD

SIZE	TOP (MD)	BOTTOM (MD)	SACKS CEMENT*	SCREEN (MD)	SIZE	DEPTH SET (MD)	PACKER SET (MD)
7 5/8"	12,270	14,680'	483	-			
5 1/2"	14,276	16,456'	185	-			

31. PERFORATION RECORD (Interval, size and number)

Perforate 7 5/8" OD Csg W/1-JSPF @
12,895', 939', 944', 963', 968',
12,972.

32. ACID, SHOT, FRACTURE, CEMENT SQUEEZE, ETC.

DEPTH INTERVAL (MD)

12,895'-12,972'

AMOUNT AND KIND OF MATERIAL USED

MAY 06 1977

33.*

PRODUCTION

DATE FIRST PRODUCTION PRODUCTION METHOD (Flowing, gas lift, pumping—size and type of pump)

5-1-76

Gas

DATE OF TEST	HOURS TESTED	CHOKE SIZE	PROD'N. FOR TEST PERIOD	OIL—BBL.	GAS—MCF.	WATER—BBL.	GAS-OIL RATIO
5-2-77	24	12/64"	→	5	19,000	0	-
FLOW. TUBING PRESS.	CASING PRESSURE	CALCULATED 24-HOUR RATE	OIL—BBL.	GAS—MCF.	WATER—BBL.	OIL GRAVITY-API (CORR.)	
1200#	-	→	5		0		-

34. DISPOSITION OF GAS (Sold, used for fuel, vented, etc.)

Sold

TEST WITNESSED BY

F.M. Reynolds

35. LIST OF ATTACHMENTS

36. I hereby certify that the foregoing and attached information is complete and correct as determined from all available records

SIGNED

TITLE Asst. Dist. Supt.

DATE 5-5-77

*(See Instructions and Spaces for Additional Data on Reverse Side)

INSTRUCTIONS

General: This form is designed for submitting a complete and correct well completion report and log on all types of lands and leases to either a Federal agency or a State agency, or both, pursuant to applicable Federal and/or State laws and regulations. Any necessary special instructions concerning the use of this form and the number of copies to be submitted, particularly with regard to local, area, or regional procedures and practices, either are shown below or will be issued by, or may be obtained from, the local Federal and/or State office. See instructions on items 22 and 24, and 33, below regarding separate reports for separate completions. If not filed prior to the time this summary record is submitted, copies of all currently available logs (drillers, geologists, sample and core analysis, all types electric, etc.), formations and pressure tests, and directional surveys, should be attached hereto, to the extent required by applicable Federal and/or State laws and regulations. All attachments should be listed on this form, see item 35.

Item 4: If there are no applicable State requirements, locations on Federal or Indian land should be described in accordance with Federal requirements. Consult local State or Federal office for specific instructions.

Item 18: Indicate which elevation is used as reference (where not otherwise shown) for depth measurements given in other spaces on this form and in any attachments. Items 22 and 24: If this well is completed for separate production from more than one interval zone (multiple completion), so state in item 22, and in item 24 show the producing interval, or intervals, top(s), bottom(s) and name(s) (if any) for only the interval reported in item 33. Submit a separate report (page) on this form, adequately identified, for each additional interval to be separately produced, showing the additional data pertinent to such interval.

Item 29: "Sacks Cement": Attached supplemental records for this well should show the details of any multiple stage cementing and the location of the cementing tool.

Item 33: Submit a separate completion report on this form for each interval to be separately produced. (See instruction for items 22 and 24 above.)

37. SUMMARY OF POROUS ZONES:			38. GEOLOGIC MARKERS		
FORMATION	TOP	BOTTOM	DESCRIPTION, CONTENTS, ETC.	TOP	
				MEAS. DEPTH	TRUE VERT. DEPTH
<div style="text-align: center;"> RECEIVED MAY 10 1977 D.C.C. ARTERIAL OFFICE </div>				Lamar Lime	4380'
				Delaware Sand	4420'
				Bone Springs	831.5'
				Dean Sand	1101.5'
				Wolfcamp	12890'
				Strawn	13720'
				Morrow	14940'
			L. Miss.	16110'	
			Devonian	16528'	

RECEIVED

MAY 10 1977

OIL CONSERVATION COMMISSION

BOX 1980

O. C. C.
ANTHONY OFFICE

HOBBS, NEW MEXICO

NOTICE OF GAS CONNECTION

DATE May 5, 1977

This is to notify the Oil Conservation Commission that connection for the purchase of gas from the Texaco, Inc.^v

Cotton Draw #68 (Wolfcamp)	Operator Tea <u>Eddy</u>	12-25-31
Lease, Well No. and Unit	County <u>1</u>	S-T-R
Wildcat Proration Wolfcamp	El Paso Natural Gas Company	
Pool	Name of Purchaser	

was made on April 26, 1977
Date

El Paso Natural Gas Co.
Purchaser

Francis R. Elliott
Representative

Gas Production Status Analyst
Title

TRE: b1
cc: To Operator
Oil Conservation Commission - Santa Fe
H. P. Logan
T. J. Crutchfield
Proration
File

DISTRIBUTION	5
ANTA FE	1
ILE	1
S.G.S.	
AND OFFICE	
TRANSPORTER	OIL GAS 2
OPERATOR	1
PRORATION OFFICE	

NEW MEXICO OIL CONSERVATION COMMISSION
REQUEST FOR ALLOWABLE
AND
AUTHORIZATION TO TRANSPORT OIL AND NATURAL GAS
RECEIVED

Form C-104
Supersedes Old C-104 and C-11
Effective 1-1-65

MAY 6 1977

I. OPERATOR
TEXACO Inc.
Address: **P.O. Box 728 Hobbs, New Mexico 88240**
Reason(s) for filing (Check proper box):
New Well ☐ Change in Transporter ☐ Other (Please explain): **Recompleted from Morrow to Wolfcamp**
Recompletion ☒ Change in Ownership ☐

If change of ownership give name and address of previous owner:

II. DESCRIPTION OF WELL AND LEASE

Lease Name: **Cotton Draw Unit** Well No.: **68** Pool Name, including Formation: **Paduca Wolfcamp** Kind of Lease: **Fed** Lease No.: **NM-0503**
Location: Unit Letter **F** Section **2310** Township **North** Range **1980** Feet From The **West**
Line of Section **12** Township **25-S** Range **31-E** County **Eddy**

III. DESIGNATION OF TRANSPORTER OF OIL AND NATURAL GAS

Name of Authorized Transporter of Oil or Condensate: **El Paso Natural Gas Co - TEXACO Inc** Address (Give address to which approved copy of this form is to be sent): **P.O. Box 1384 Jal, NM / P.O. Box 728**
If well produces oil or liquids, give location of tanks: **Yes** When: **5-2-77**

If this production is commingled with that from any other lease or pool, give commingling order number:

IV. COMPLETION DATA

Designate Type of Completion - (X)	Old Well	New Well	Workover	Deepen	Plug Back	Same Resv.	Diff. Resv.
	X		X		X		X
Date Spudded: 12-19-69	Date Comp. Ready to Prod.: 5-2-77	Total Depth: 16,868	F.B.T.D. 14,030				
Elevations (DF, RKB, RT, GA, etc.): 3457' (DF)	Name of Producing Formation: Wolfcamp	Top Oil/Gas Pay: 12,895' & 12,972'	Tubing Depth: -				
Perforations: 7 5/8" OD Csg perforated w/1-JSPF @ 12,895, 939', 963', 968'		Depth Casing Shoe: -					
TUBING, CASING, AND CEMENTING RECORD							
HOLE SIZE	CASING & TUBING SIZE	DEPTH SET	SACKS CEMENT				
26"	20"	755'	2100				
17 1/2"	13 3/8"	4415'	8250				
12 1/4"	9 5/8"	12650'	3550				
8 1/2" & 6 1/2"	7 5/8" & 5 1/2"	16,456"	668				

V. TEST DATA AND REQUEST FOR ALLOWABLE OIL WELL

(Test must be after recovery of total volume of load oil and must be equal to or exceed top allowable for this depth or be for full 24 hours)

Date First New Oil Run To Tanks: 5-2-77	Date of Test: 5-2-77	Producing Method (Flow, pump, gas lift, etc.): Flow Gas	
Length of Test: 24 Hrs.	Tubing Pressure: 1200#	Casing Pressure: -	Choke Size: 12/64"
Actual Prod. During Test:	Oil - Bbls.: 5	Water - Bbls.: 0	Gas - MCF: 19,000

GAS WELL

Actual Prod. Test-MCF/D: 19,000	Length of Test: 24 Hrs	Bbls. Condensate/MMCF: 5	Gravity of Condensate: -0-
Testing Method (pilot, back pr.): Back Pressure	Tubing Pressure (shut-in): 8150#	Casing Pressure (shut-in): -	Choke Size: 12/64"

VI. CERTIFICATE OF COMPLIANCE

I hereby certify that the rules and regulations of the Oil Conservation Commission have been complied with and that the information given above is true and complete to the best of my knowledge and belief.

OIL CONSERVATION COMMISSION

MAY 26 1977

APPROVED: **W. A. Grissett**
BY: **W. A. Grissett**
TITLE: **SUPERVISOR, DISTRICT II**

This form is to be filed in compliance with RULE 1104.

If this is a request for allowable for a newly drilled or deepened well, this form must be accompanied by a tabulation of the deviation tests taken on the well in accordance with RULE 1111.

All sections of this form must be filled out completely for allowable on new and recompleted wells.

Fill out only Sections I, II, III, and VI for changes of owner, well name or number, or transporter, or other such change of condition.

Separate Forms C-104 must be filed for each pool in multiply

W. A. Grissett
(Signature)
W. A. Grissett
(Title)
5/5/77
(Date)

REQUEST FOR THE EXTENSION OF AN EXISTING POOL
RECEIVED

MAY 25 1977

OR

THE CREATION OF A NEW POOL

O. C. C.
ARTS & CRAFTS OFFICE

TO: The Oil Conservation Commission
State of New Mexico

Date May 24, 1977

The TEXACO INC. Cotton Draw Unit
Name of Operator Name of Lease

68 Located 2310 feet from the North line and 1980 feet
Well No.
from the West line of 12 25-South 31-East
Section Township Range

is outside the boundaries of any pool producing from the same formation. On the basis of the information submitted here-
with on form C-105, we hereby request that the
pool be extended to include the following described area

or that a new pool be created to include the following described area W/2 of Section 12, Township 25
South, Range 31 East

Suggested name: South Paduca Wolfcamp (Gas)

TEXACO INC.
Operator

Name of Producing Formation: Wolfcamp (Gas)

J. Hannon
Representative

R-5511
S. Paduca Wolfcamp Gas

NEW MEXICO OIL CONSERVATION COMMISSION

Artesia, New Mexico

Texaco, Inc.
P.O. Box 728
Hobbs, NM 88240

Re: Well~~XX~~ placed in pool~~X~~

Gentlemen:

As the result of Commission Order R-5511 the following described well (X) (has-~~XXXX~~) been placed in the pool (X) shown below. This change in nomenclature has been made in our files. Please change your records to reflect the proper pool name. All subsequent reports must show this nomenclature until further notice.

South. Paduca - Wolfcamp Gas ✓

Cotton Draw Unit #68-F-12-25-31

Transporters are advised, by copy of this letter, to change their records to reflect the pool name as established by this order.

Very truly yours,

OIL CONSERVATION COMMISSION

W. A. Gressett

Dist.
Orig. Operator
cc: Each transporter EPG

NO. OF COPIES RECEIVED		
DISTRIBUTION		
SANTA FE		1
FILE		1
U.S.G.S.		1
NAME OF FIELD		
TRANSPORTER	OIL	1
	GAS	2
OPERATOR		1
PRODUCTION OFFICE		
Operator		

NEW MEXICO OIL CONSERVATION COMMISSION
REQUEST FOR ALLOWABLE
AND
AUTHORIZATION TO TRANSPORT OIL AND NATURAL GAS

Form C-104
Supersedes Old C-104 and C-11
Effective 1-1-65

RECEIVED

NOV 3 1977

TEXACO Inc		O. C. C.
Address		ARTESIA, OFFICE
P.O. Box 728 Hobbs, New Mexico 88240		
Reason(s) for filing (check proper box)		Other (Please explain)
New Well	<input type="checkbox"/>	
Recompletion	<input type="checkbox"/>	
Change in Ownership	<input type="checkbox"/>	
Designate	Transporter of:	
Oil	<input type="checkbox"/>	
Condensate	<input type="checkbox"/>	
Dry Gas	<input type="checkbox"/>	
Condensate	<input checked="" type="checkbox"/>	

If change of ownership, give name and address of previous owner

II. DESIGNATION OF WELL AND LEASE

Lease Name	Well No.	Field Name, including Formation	Kind of Lease	Lease No.
Cotton Draw Unit	68	Paduca Wolfcamp South Gas	State, Federal or Free	Federal NMO503
Location				
Well Lett	F	2310 Feet From The North Line and 1980 Feet From The West		
Line of Section	12	Township	25-S	Range
			31-E	N.M.P.M.
			Eddy	County

III. DESIGNATION OF TRANSPORTER OF OIL AND NATURAL GAS

Name of Authorized Transporter of Oil	or Condensate	Address (Give address to which approved copy of this form is to be sent)
Koch Oil Company	<input checked="" type="checkbox"/>	P.O. 1558 Breckenridge, Tx 76024
Name of Authorized Transporter of Gas	or Dry Gas	Address (Give address to which approved copy of this form is to be sent)
El Paso Natural Gas Company	<input type="checkbox"/>	P.O. Box 1384 Jal, New Mexico 88252
Texaco Inc.	<input type="checkbox"/>	P.O. Box 728 Hobbs, New Mexico 88240
If well produces oil or liquids, give location of tanks.	Unit	Sec.
	F	12
	25S	31E
	Yes	4-26-77
	Yes	5-2-77

If this production is commingled with that from any other lease or pool, give commingling order number

IV. COMPLETION DATA

Designate Type of Completion - (X)	Oil Well	Gas Well	New Well	Workover	Deepen	Plug Back	Partial Plug	Full Plug
Designate								
Date Comp. Ready to Prod.	Total Depth		P.B.T.D.					
Elevations (B.F., R.R., R.F., G.R., etc.)	Name of Producing Formation		Top Oil/Gas Pay		Tubing Depth			
Perforations					Depth Casing Shoe			

TUBING, CASING, AND CEMENTING RECORD

HOLE SIZE	CASING & TUBING SIZE	DEPTH SET	SACKS CEMENT

V. TEST DATA AND REQUEST FOR ALLOWABLE OIL WELL

(Test must be after recovery of total volume of lost oil and must be equal to or exceed top allowable for this depth or be for full 24 hours)

Date First New Oil Run To Tanks	Date of Test	Producing Method (Flow, pump, gas lift, etc.)	
Length of Test	Testing Pressure	Casing Pressure	Choke Size
Actual Prod. During Test	Oil-Bbls.	Water-bbls.	Gas-MCF

GAS WELL

Actual Prod. Test-MCF/D	Length of Test	Lb./in. Condensate/MCF	Gravity of Condensate
Testing Method (flow, back pr.)	Testing Pressure (psit-in)	Casing Pressure (psit-in)	Choke Size

VI. CERTIFICATE OF COMPLIANCE

I hereby certify that the rules and regulations of the Oil Conservation Commission have been complied with and that the information given above is true and complete to the best of my knowledge and belief.

OIL CONSERVATION COMMISSION

NOV 3 1977

APPROVED _____ 19_____
BY W.A. Gressett
TITLE SUPERVISOR, DISTRICT II

This form is to be filed in compliance with RULE 1104.

If this is a request for allowable for a newly drilled or deepened well, this form must be accompanied by a certification of the well's completion on the well in accordance with RULE 1111.

All portions of this form must be filled out completely for all wells except in the case of a recompletion.

Fill out only Sections I, II, III, and VI for change of term, well name or number, or transporter, or other such change of condition.

Assistant District Superintendent

11-2-77

STATE OF NEW MEXICO
ENERGY AND MINERALS DEPARTMENT

NO. OF COPIES RECEIVED	
DISTRIBUTION	
SANTA FE	<input checked="" type="checkbox"/>
FILE	<input checked="" type="checkbox"/>
U.S.G.S.	<input type="checkbox"/>
LAND OFFICE	<input type="checkbox"/>
TRANSPORTER	<input checked="" type="checkbox"/>
OPERATOR	<input checked="" type="checkbox"/>
PRODUCTION OFFICE	<input checked="" type="checkbox"/>

OIL CONSERVATION DIVISION

P. O. BOX 2088

SANTA FE, NEW MEXICO 87501

Form C-104
Revised 10-01-78
Format 06-01-83
Page 1

RECEIVED BY

MAY 02 1986

OAG
ARTESIA, OFFICE

REQUEST FOR ALLOWABLE
AND

AUTHORIZATION TO TRANSPORT OIL AND NATURAL GAS

I. Operator
Texaco Inc.

Address
P.O. Box 728, Hobbs, New Mexico, 88240

Reason(s) for filing (Check proper box)

<input type="checkbox"/> New Well	Change in Transporter of:	<input type="checkbox"/> Dry Gas	Other (Please explain) To delete El Paso Natural Gas as gas transporter
<input type="checkbox"/> Recompletion	<input type="checkbox"/> Oil	<input checked="" type="checkbox"/> Condensate	
<input type="checkbox"/> Change in Ownership	<input type="checkbox"/> Casinghead Gas		

If change of ownership give name and address of previous owner

II. DESCRIPTION OF WELL AND LEASE

Lease Name Cotton Draw Unit	Well No. 68	Pool Name, including Formation Paduca Wolfcamp South Gas	Kind of Lease State, Federal or Fee Federal	Lease No. NM0503
Location Unit Letter <u>F</u> ; <u>2310</u> Feet From The <u>North</u> Line and <u>1980</u> Feet From The <u>West</u> Line of Section <u>12</u> Township <u>25S</u> Range <u>31E</u> , NMPM, <u>Eddy</u> County				

III. DESIGNATION OF TRANSPORTER OF OIL AND NATURAL GAS

Name of Authorized Transporter of Oil <input type="checkbox"/> or Condensate <input checked="" type="checkbox"/> Koch Oil Company	Address (Give address to which approved copy of this form is to be sent) P.O. Box 1558, Breckenridge, Texas, 76024
Name of Authorized Transporter of Casinghead Gas <input type="checkbox"/> or Dry Gas <input checked="" type="checkbox"/> Texaco Inc.	Address (Give address to which approved copy of this form is to be sent) P.O. Box 728, Hobbs, New Mexico, 88240
If well produces oil or liquids, give location of tanks.	Unit Sec. Twp. Rge. Is gas actually connected? When
	F 12 25S 31E Yes 5-2-77

If this production is commingled with that from any other lease or pool, give commingling order number:

NOTE: Complete Parts IV and V on reverse side if necessary.

VI. CERTIFICATE OF COMPLIANCE

I hereby certify that the rules and regulations of the Oil Conservation Division have been complied with and that the information given is true and complete to the best of my knowledge and belief.

W. Beuning
(Signature)
District Administrative Supervisor
(Title)
April 23, 1986
(Date)

OIL CONSERVATION DIVISION

APPROVED MAY 9 1986, 19

BY Original Signed By
Mike Williams
TITLE Oil & Gas Inspector

This form is to be filed in compliance with RULE 1104.

If this is a request for allowable for a newly drilled or deepened well, this form must be accompanied by a tabulation of the deviation tests taken on the well in accordance with RULE 111.

All sections of this form must be filled out completely for allowable on new and recompleted wells.

Fill out only Sections I, II, III, and VI for changes of owner, well name or number, or transporter, or other such change of condition.

Separate Forms C-104 must be filed for each pool in multiply completed wells.

STATE OF NEW MEXICO
ENERGY AND MINERALS DEPARTMENT

CO. OR LEASE NUMBER	
DISTRIBUTION	
SANTA FE	<input checked="" type="checkbox"/>
FILE	<input checked="" type="checkbox"/>
U.S.D.A.	
LAND OFFICE	
TRANSPORTER	<input checked="" type="checkbox"/>
OIL	<input checked="" type="checkbox"/>
GAS	<input checked="" type="checkbox"/>
OPERATOR	<input checked="" type="checkbox"/>
PROMOTION OFFICE	

RECEIVED BY CONSERVATION DIVISION
P. O. BOX 2088
SANTA FE, NEW MEXICO 87501
SEP - 5 1986
O. C. D. REQUEST FOR ALLOWABLE
ARTESIA, OFFICE AND
AUTHORIZATION TO TRANSPORT OIL AND NATURAL GAS

Form C-104
Revised 10-01-78
Format 06-01-83
Page 1

I. Operator
Texaco Inc. ✓
Address
P.O. Box 728, Hobbs, New Mexico 88240
Reason(s) for filing (Check proper box)
☐ New Well ☐ Change in Transporter of:
☐ Recompletion ☐ Oil ☐ Dry Gas
☐ Change in Ownership ☐ Casinghead Gas ☒ Condensate
Other (Please explain)
Effective September 1, 1986

If change of ownership give name and address of previous owner

II. DESCRIPTION OF WELL AND LEASE

Lease Name Cotton Draw Unit	Well No. 68	Pool Name, including Formation Paduca Wolfcamp South Gas	Kind of Lease State, Federal or Fee Federal	Lease No. NM0503
Location Unit Letter <u>F</u> [°] <u>2310</u> Feet From The <u>North</u> Line and <u>1980</u> Feet From The <u>West</u> Line of Section <u>12</u> Township <u>25S</u> Range <u>31E</u> , NMPM, <u>Eddy</u> County				

III. DESIGNATION OF TRANSPORTER OF OIL AND NATURAL GAS

Name of Authorized Transporter of Oil <input type="checkbox"/> or Condensate <input checked="" type="checkbox"/> Texaco Trading & Transportation Inc. 1075-1361	Address (Give address to which approved copy of this form is to be sent) P.O. Box 6196, Midland, TX 79711-0196
Name of Authorized Transporter of Casinghead Gas <input type="checkbox"/> or Dry Gas <input checked="" type="checkbox"/> Texaco Inc.	Address (Give address to which approved copy of this form is to be sent) P.O. Box 728, Hobbs, New Mexico 88240
If well produces oil or liquids, give location of tanks. Unit <u>F</u> Sec. <u>12</u> Twp. <u>25S</u> Rge. <u>31E</u>	Is gas actually connected? <u>Yes</u> When <u>May 2, 1977</u> <u>Post ID-3</u>

If this production is commingled with that from any other lease or pool, give commingling order number: 12-19-86

NOTE: Complete Parts IV and V on reverse side if necessary.

ch. LT: WOC

VI. CERTIFICATE OF COMPLIANCE

I hereby certify that the rules and regulations of the Oil Conservation Division have been complied with and that the information given is true and complete to the best of my knowledge and belief.

J. W. Branning
(Signature)
District Administrative Supervisor
(Title)
August 28, 1986
(Date)

OIL CONSERVATION DIVISION

APPROVED SEP 12 1986, 19
BY Original Signed By
Les A. Clements
TITLE Supervisor District II

This form is to be filed in compliance with RULE 1104.
If this is a request for allowable for a newly drilled or deepened well, this form must be accompanied by a tabulation of the deviation tests taken on the well in accordance with RULE 111.
All sections of this form must be filled out completely for allowable on new and recompleted wells.
Fill out only Sections I, II, III, and VI for changes of owner, well name or number, or transporter, or other such change of condition.
Separate Forms C-104 must be filled for each pool in multiply completed wells.

OIL CONSERVATION DIVISION

P.O. Box 2088

Santa Fe, New Mexico 87504-2088

clsf
b1
op

REQUEST FOR ALLOWABLE AND AUTHORIZATION
TO TRANSPORT OIL AND NATURAL GAS

Operator Texaco Exploration and Production Inc.		Well API No. 30 015-02072-22272
Address P. O. Box 730 Hobbs, New Mexico 88240-2528		
Reason(s) for Filing (Check proper box) <input checked="" type="checkbox"/> Other (Please explain) New Well <input type="checkbox"/> Change in Transporter of: EFFECTIVE 6-1-91 Recompletion <input type="checkbox"/> Oil <input type="checkbox"/> Dry Gas <input type="checkbox"/> Change in Operator <input checked="" type="checkbox"/> Casinghead Gas <input type="checkbox"/> Condensate <input type="checkbox"/>		
If change of operator give name and address of previous operator Texaco Inc. P. O. Box 730 Hobbs, New Mexico 88240-2528		

II. DESCRIPTION OF WELL AND LEASE

Lease Name COTTON DRAW UNIT	Well No. 68	Pool Name, Including Formation PADUCA WOLFCAMP, SOUTH (GAS)	Kind of Lease State, Federal or Fee FEDERAL	Lease No. 145870
Location Unit Letter F : 2310-2330- Foot From The NORTH Line and 1980- Foot From The EAST Line Section 12 Township 25S Range 31E , NMPM, EDDY County				

III. DESIGNATION OF TRANSPORTER OF OIL AND NATURAL GAS

Name of Authorized Transporter of Oil Texaco Trading & Transport Inc.	or Condensate <input checked="" type="checkbox"/>	Address (Give address to which approved copy of this form is to be sent) 18825 Northchase Blvd., Ste. 600 Houston, Texas 770
Name of Authorized Transporter of Casinghead Gas TI	or Dry Gas <input checked="" type="checkbox"/>	Address (Give address to which approved copy of this form is to be sent)
If well produces oil or liquids, give location of tanks.	Unit F Sec. 12 Twp. 25S Rgn. 31E	Is gas actually connected? YES When? 05/02/77

If this production is commingled with that from any other lease or pool, give commingling order number:

IV. COMPLETION DATA

Designate Type of Completion - (X)	Oil Well	Gas Well	New Well	Workover	Deepen	Plug Back	Same Res'v	Diff Res'v
Date Spudded	Date Compl. Ready to Prod.		Total Depth			P.B.T.D.		
Elevations (DF, RKB, RT, GR, etc.)	Name of Producing Formation		Top Oil/Gas Pay			Tubing Depth		
Perforations						Depth Casing Shoe		
TUBING, CASING AND CEMENTING RECORD								
HOLE SIZE	CASING & TUBING SIZE		DEPTH SET		SACKS CEMENT put 10-3 5-31-91 this is name			

V. TEST DATA AND REQUEST FOR ALLOWABLE

OIL WELL (Test must be after recovery of total volume of load oil and must be equal to or exceed top allowable for this depth or be for full 24 hours.)

Date First New Oil Run To Tank	Date of Test	Producing Method (Flow, pump, gas lift, etc.)	
Length of Test	Tubing Pressure	Casing Pressure	Choke Size
Actual Prod. During Test	Oil - Bbls.	Water - Bbls.	Gas - MCF

GAS WELL

Actual Prod. Test - MCF/D	Length of Test	Bbls. Condensate/MMCF	Gravity of Condensate
Testing Method (pilot, back pr.)	Tubing Pressure (Shut-in)	Casing Pressure (Shut-in)	Choke Size

VI. OPERATOR CERTIFICATE OF COMPLIANCE

I hereby certify that the rules and regulations of the Oil Conservation Division have been complied with and that the information given above is true and complete to the best of my knowledge and belief.

Signature K. M. Miller
K. M. Miller Div. Ops. Engr.
Printed Name Title
May 2, 1991 915-688-4834
Date Telephone No.

OIL CONSERVATION DIVISION

Date Approved MAY 24 1991

By ORIGINAL SIGNED BY
MIKE WILLIAMS
Title SUPERVISOR, DISTRICT II

INSTRUCTIONS: This form is to be filed in compliance with Rule 1104

- 1) Request for allowable for newly drilled or deepened well must be accompanied by tabulation of deviation tests taken in accordance with Rule 111.
- 2) All sections of this form must be filled out for allowable on new and recompleted wells.
- 3) Fill out only Sections I, II, III, and VI for changes of operator, well name or number, transporter, or other such changes.
- 4) Separate Form C-104 must be filed for each pool in multiply completed wells.

UNITED STATES
DEPARTMENT OF THE INTERIOR
BUREAU OF LAND MANAGEMENT

NM L CONS COMMISSION
Drawer DD
Artesia, NM 88210

FORM APPROVED
Budget Bureau No. 1004-0135
Expires: March 31, 1993

SUNDRY NOTICES AND REPORTS ON WELLS
Do not use this form for proposals to drill or to deepen or reentry to a different reservoir.
Use "APPLICATION FOR PERMIT --" for such proposals

SUBMIT IN TRIPLICATE

1. Type of Well: ☒ OIL WELL ☐ GAS WELL ☐ OTHER

2. Name of Operator
TEXACO EXPLORATION & PRODUCTION INC.

3. Address and Telephone No. P.O. BOX 730, HOBBS, NM 88240 397-0426

4. Location of Well (Footage, Sec., T., R., M., or Survey Description)
Unit Letter F : 2310 Feet From The 1780 NORTH Line and 770 Feet From The
West Line Section 12 Township 25S Range 31E

5. Lease Designation and Serial No.
NM 0503

6. If Indian, Alottee or Tribe Name

7. If Unit or CA, Agreement Designation

8. Well Name and Number
COTTON DRAW UNIT
68

9. API Well No.
3001502672 20272

10. Field and Pool, Exploratory Area
PADUCA WOLFCAMP, SOUTH (GAS)

11. County or Parish, State
EDDY, NEW MEXICO

12. Check Appropriate Box(s) To Indicate Nature of Notice, Report, or Other Data

TYPE OF SUBMISSION

- ☒ Notice of Intent
☐ Subsequent Report
☐ Final Abandonment Notice

TYPE OF ACTION

- ☐ Abandonment
☐ Recompletion
☐ Plugging Back
☐ Casing Repair
☐ Altering Casing
☒ OTHER: EXTEND TA STATUS
☐ Change of Plans
☐ New Construction
☐ Non-Routine Fracturing
☐ Water Shut-Off
☐ Conversion to Injection
☐ Dispose Water

(Note: Report results of multiple completion on Well Completion or Recompletion Report and Log Form.)

13. Describe Proposed or Completed Operations (Clearly state all pertinent details, and give pertinent dates, including estimated date of starting any proposed work. If well is directionally drilled, give subsurface locations and measured and true vertical depths for all markers and zones pertinent to this work.)

Texaco Exploration and Production Inc. respectfully submits it's plans concerning notice 0162 (067A).

Texaco requests an extended TA status for the above well. The following procedure to test casing and plug integrity will be performed and a subsequent 3160-5 will be submitted requesting official TA status.

1. Notify BLM 24 hours in advance of work.
2. Test casing and plug with 500 psi for 30 min.
3. Classify well to TA status. TEPI will submit pressure chart and subsequent report requesting Temporarily Abandonment Status on this well.

OCT 31 1 24 PM '94
RECEIVED

I hereby certify that the foregoing is true and correct

SIGNATURE [Signature] TITLE Engineering Assistant DATE 10/27/94

TYPE OR PRINT NAME Darrell J. Carriger

(This space for Federal or State) (ORIG. SGD.) JOE G. LARA

APPROVED BY [Signature] TITLE PETROLEUM ENGINEER DATE 11/30/94

CONDITIONS OF APPROVAL, IF ANY: See attached. Test to be performed within 90 days.

Title 18 U.S.C. Section 1001, makes it a crime for any person knowingly and willfully to make to any department or agency of the United States any false, fictitious or fraudulent statements or representations as to any matter within its jurisdiction.

UNITED STATES
DEPARTMENT OF THE INTERIOR
BUREAU OF LAND MANAGEMENT

FORM APPROVED
Budget Bureau No. 1004-0135
Expires: March 31, 1993

SUNDRY NOTICES AND REPORTS ON WELLS

Do not use this form for proposals to drill or to deepen or reentry to a different reservoir.
Use "APPLICATION FOR PERMIT -" for such proposals

SUBMIT IN TRIPLICATE

1. Type of Well: ☒ OIL WELL ☐ GAS WELL ☐ OTHER

2. Name of Operator
TEXACO EXPLORATION & PRODUCTION INC.

3. Address and Telephone No. P.O. BOX 730, HOBBS, NM 88240 397-0426

4. Location of Well (Footage, Sec., T., R., M., or Survey Description)
Unit Letter F : 2310 Feet From The NORTH Line and 1780 Feet From The
EAST Line Section 12 Township 25S Range 31E

5. Lease Designation and Serial No.

NM 0503

6. If Indian, Allottee or Tribe Name

7. If Unit or CA, Agreement Designation

8. Well Name and Number

COTTON DRAW UNIT

68

9. API Well No.

30 015 02672 20272

10. Field and Pool, Exploratory Area
PADUCA WOLFCAMP, SOUTH (GAS)

11. County or Parish, State

EDDY, NEW MEXICO

12. Check Appropriate Box(s) To Indicate Nature of Notice, Report, or Other Data

TYPE OF SUBMISSION

- ☐ Notice of Intent
☒ Subsequent Report
☐ Final Abandonment Notice

TYPE OF ACTION

- ☐ Abandonment
☐ Recompletion
☐ Plugging Back
☐ Casing Repair
☐ Altering Casing
☒ OTHER: EXTEND TA STATUS
☐ Change of Plans
☐ New Construction
☐ Non-Routine Fracturing
☐ Water Shut-Off
☐ Conversion to Injection
☐ Dispose Water

(Note: Report results of multiple completion on Well Completion or Recompletion Report and Log Form.)

13. Describe Proposed or Completed Operations (Clearly state all pertinent details, and give pertinent dates, including estimated date of starting any proposed work. If well is directionally drilled, give subsurface locations and measured and true vertical depths for all markers and zones pertinent to this work).*

Texaco Exploration and Production Inc. respectfully submits it's plans concerning notice AJM-049-95.

Texaco requests an extended TA status for the above well. The following procedure to test casing and plug integrity was performed 3/31/95.

1. Notified BLM 24 hours in advance of work.

2. Tested casing and plug with 500 psi for 30 min. <held>. Test was witnessed by Andy Cortez of the BLM (4/5/95).

3. Classified well to TA status. The original pressure chart was sent to the NMOCD and a copy can be found on the reverse side of this form.

Justification: A \$2,400,000 Cotton Draw 3D seismic acquisition was completed in early March of 1995. Texaco is currently processing the 3D survey. Texaco would like to hold the deeper Cotton Draw wells in TA status until the seismic data can be completely analyzed. The subject well successfully passed a casing integrity pressure test and presents no danger to the surrounding environment. A one year TA status time period should be sufficient to draw accurate conclusions from the 3D seismic work and present a plan to return this well to production.

14. I hereby certify that the foregoing is true and correct.

SIGNATURE [Signature] TITLE Engineering Assistant DATE 4/11/95

TYPE OR PRINT NAME Darrell J. Camiger

(This space for Federal or State office use)

APPROVED BY _____ TITLE _____ DATE _____

CONDITIONS OF APPROVAL, IF ANY:

Title 18 U.S.C. Section 1001, makes it a crime for any person knowingly and willfully to make to any department or agency of the United States any false, fictitious or fraudulent statements or representations as to any matter within its jurisdiction.

UNITED STATES
DEPARTMENT OF THE INTERIOR
BUREAU OF LAND MANAGEMENT

NM OIL CONS. COMMISSION
Drawer DD
Artesia, NM 88210
FORM APPROVED
Budget Bureau No. 1004-0135
Expires: March 31, 1993

SUNDRY NOTICES AND REPORTS ON WELLS

Do not use this form for proposals to drill or to deepen or reentry to a different reservoir.

Use "APPLICATION FOR PERMIT -" for such proposals

SUBMIT IN TRIPLICATE

1. Type of Well: ☒ OIL WELL ☐ GAS WELL ☐ OTHER

2. Name of Operator
TEXACO EXPLORATION & PRODUCTION INC.

3. Address and Telephone No. P.O. BOX 730, HOBBS, NM 88240 397-0426

4. Location of Well (Footage, Sec., T., R., M., or Survey Description)
Unit Letter F : 2310 Feet From The NORTH Line and 1780 Feet From The
EAST Line Section 12 Township 25S Range 31E

5. Lease Designation and Serial No.
NM 0503

6. If Indian, Alottee or Tribe Name

7. If Unit or CA, Agreement Designation

8. Well Name and Number
COTTON DRAW UNIT
68

9. API Well No.
30 015 02072

10. Field and Pool, Exploratory Area
PADUCA WOLFCAMP, SOUTH (GAS)

11. County or Parish, State
EDDY, NEW MEXICO

12. Check Appropriate Box(s) To Indicate Nature of Notice, Report, or Other Data

TYPE OF SUBMISSION

- ☐ Notice of Intent
☒ Subsequent Report
☐ Final Abandonment Notice

TYPE OF ACTION

- ☐ Abandonment
☐ Recompletion
☐ Plugging Back
☐ Casing Repair
☐ Altering Casing
☒ OTHER: EXTEND TA STATUS
☐ Change of Plans
☐ New Construction
☐ Non-Routine Fracturing
☐ Water Shut-Off
☐ Conversion to Injection
☐ Dispose Water

(Note: Report results of multiple completion on Well Completion or Recompletion Report and Log Form.)

13. Describe Proposed or Completed Operations (Clearly state all pertinent details, and give pertinent dates, including estimated date of starting any proposed work. If well is directionally drilled, give subsurface locations and measured and true vertical depths for all markers and zones pertinent to this work.)

Texaco Exploration and Production Inc. respectfully submits it's plans concerning notice AJM-049-95.

Texaco requests an extended TA status for the above well. The following procedure to test casing and plug integrity was performed 3/31/95.

1. Notified BLM 24 hours in advance of work.

2. Tested casing and plug with 500 psi for 30 min. <held>. Test was witnessed by Andy Cortez of the BLM.

3. Classified well to TA status. The original pressure chart was sent to the NMOCD and a copy can be found on the reverse side of this form.

Justification: A \$2,400,000 Cotton Draw 3D seismic acquisition was completed in early March of 1995. Texaco is currently processing the 3D survey. Texaco would like to hold the deeper Cotton Draw wells in TA status until the seismic data can be completely analyzed. The subject well successfully passed a casing integrity pressure test and presents no danger to the surrounding environment. A one year TA status time period should be sufficient to draw accurate conclusions from the 3D seismic work and present a plan to return this well to production.

TA APPROVED FOR 12 MONTH PERIOD
ENDING 4/5/96

14. I hereby certify that the foregoing is true and correct

SIGNATURE [Signature] TITLE Engineering Assistant DATE 4/11/95

TYPE OR PRINT NAME Darrell J. Carriger

(This space for Federal or (ORIG. SCD.) JOE G. LARA

APPROVED BY [Signature] TITLE PETROLEUM ENGINEER DATE 5/17/95

CONDITIONS OF APPROVAL, IF ANY:

Title 18 U.S.C. Section 1001, makes it a crime for any person knowingly and willfully to make to any department or agency of the United States any false, fictitious or fraudulent statements or representations as to any matter within its jurisdiction.

UNITED STATES
DEPARTMENT OF THE INTERIOR
BUREAU OF LAND MANAGEMENT

BOX 1980
NEW MEXICO 88240

FORM APPROVED
Budget Bureau No. 1004-0135
Expires: March 31, 1993

SUNDRY NOTICES AND REPORTS ON WELLS

Do not use this form for proposals to drill or to deepen or reentry to a different reservoir.

Use "APPLICATION FOR PERMIT --" for such proposals

SUBMIT IN TRIPLICATE

1. Type of Well: ☒ OIL WELL ☐ GAS WELL ☐ OTHER

2. Name of Operator
TEXACO EXPLORATION & PRODUCTION INC.

3. Address and Telephone No. 205 E. Bender, HOBBS, NM 88240 397-0418

4. Location of Well (Footage, Sec., T., R., M., or Survey Description) 1750
Unit Letter F : 2310 Feet From The NORTH Line and 720 Feet From The
EAST Line Section 12 Township 25S Range 31E

5. Lease Designation and Serial No.
NM-0503

6. If Indian, Allottee or Tribe Name

7. If Unit or CA, Agreement Designation

8. Well Name and Number
COTTON DRAW UNIT
68

9. API Well No.
30-015-02072

10. Field and Pool, Exploratory Area
PADUCA WOLFCAMP, SOUTH (GAS)

11. County or Parish, State
EDDY, NEW MEXICO

12. Check Appropriate Box(s) To Indicate Nature of Notice, Report, or Other Data

TYPE OF SUBMISSION	TYPE OF ACTION
<input type="checkbox"/> Notice of Intent	<input type="checkbox"/> Abandonment
<input checked="" type="checkbox"/> Subsequent Report	<input type="checkbox"/> Recompletion
<input type="checkbox"/> Final Abandonment Notice	<input type="checkbox"/> Plugging Back
	<input type="checkbox"/> Casing Repair
	<input type="checkbox"/> Altering Casing
	<input checked="" type="checkbox"/> OTHER: EXTENSION OF TA STATUS
	<input type="checkbox"/> Change of Plans
	<input type="checkbox"/> New Construction
	<input type="checkbox"/> Non-Routine Fracturing
	<input type="checkbox"/> Water Shut-Off
	<input type="checkbox"/> Conversion to Injection
	<input type="checkbox"/> Dispose Water

(Note: Report results of multiple completion on Well Completion or Recompletion Report and Log Form.)

13. Describe Proposed or Completed Operations (Clearly state all pertinent details, and give pertinent dates, including estimated date of starting any proposed work. If well is directionally drilled, give subsurface locations and measured and true vertical depths for all markers and zones pertinent to this work.)

Texaco Exploration and Production Inc requests an extension of one year of the temporary abandonment status of the above well which ends on 4/5/96. The temporary abandonment status was approved on 5/17/95 based upon the results of a casing integrity test conducted on 3/31/95 and witnessed by BLM representative Andy Cortez, (4/5/95). The casing and plug were successfully tested to 500 psi for 30 minutes. TEPI requests TA status on this well through 4/5/97. A copy of the 4/5/95 test chart is on back.

Justification: A \$2,400,000 Cotton Draw 3D seismic acquisition was completed in late 1995. Texaco is currently processing the 3D survey. Texaco would like to hold the deeper Cotton Draw wells in idle/TA status until the seismic data can be completely analyzed. A one year status time period should be sufficient to draw accurate conclusions from the 3D seismic work and present a plan to return this well to production.

TA APPROVED FOR 12 MONTH PERIOD
ENDING 4/5/97

14. I hereby certify that the foregoing is true and correct

SIGNATURE Monte C. Duncan TITLE Engr Asst DATE 5/3/96

TYPE OR PRINT NAME Monte C. Duncan

(This space for Federal or Private Signature)

APPROVED BY (ORIG. SCD.) JOE G. LARA TITLE PETROLEUM ENGINEER

DATE 5/17/96

CONDITIONS OF APPROVAL, IF ANY:

Title 18 U.S.C. Section 1001, makes it a crime for any person knowingly and willfully to make to any department or agency of the United States any false, fictitious or fraudulent statements or representations as to any matter within its jurisdiction.

UNITED STATES
DEPARTMENT OF THE INTERIOR
BUREAU OF LAND MANAGEMENT

N.M. Oil Cons. Division
311 S. 1st
Ar.

FORM APPROVED

Budget Bureau No. 1004-0135

Expires: March 31, 1993
8210-2834

SUNDRY NOTICES AND REPORTS ON WELLS

Do not use this form for proposals to drill or to deepen or reentry to a different reservoir.

Use "APPLICATION FOR PERMIT -" for such proposals

SUBMIT IN TRIPLICATE

1. Type of Well: ☒ OIL WELL ☐ GAS WELL ☐ OTHER

2. Name of Operator
TEXACO EXPLORATION & PRODUCTION INC.

3. Address and Telephone No. 205 E. Bender, HOBBS, NM 88240 397-0418

4. Location of Well (Footage, Sec., T., R., M., or Survey Description)
Unit Letter F 2310 Feet From The NORTH Line and 770 Feet From The
EAST Line Section 12 Township 25S Range 31E

5. Lease Designation and Serial No.

NM-0503

6. If Indian, Allottee or Tribe Name

7. If Unit or CA, Agreement Designation

8. Well Name and Number

COTTON DRAW UNIT

68

9. API Well No.

20272
30-015-02072

10. Field and Pool, Exploratory Area
PADUCA WOLFCAMP, SOUTH (GAS)

11. County or Parish, State

EDDY, NEW MEXICO

12. Check Appropriate Box(s) To Indicate Nature of Notice, Report, or Other Data

TYPE OF SUBMISSION

- ☐ Notice of Intent
☒ Subsequent Report
☐ Final Abandonment Notice

TYPE OF ACTION

- ☐ Abandonment
☐ Recompletion
☐ Plugging Back
☐ Casing Repair
☐ Altering Casing
☒ OTHER: EXTENSION OF TA STATUS
☐ Change of Plans
☐ New Construction
☐ Non-Routine Fracturing
☐ Water Shut-Off
☐ Conversion to Injection
☐ Dispose Water

(Note: Report results of multiple completion on Well Completion or Recompletion Report and Log Form.)

13. Describe Proposed or Completed Operations (Clearly state all pertinent details, and give pertinent dates, including estimated date of starting any proposed work. If well is directionally drilled, give subsurface locations and measured and true vertical depths for all markers and zones pertinent to this work.)

Texaco Exploration and Production Inc requests an extension of one year of the temporary abandonment status of the above well which ended on 4/5/97. The original temporary abandonment status was approved on 5/17/95 based upon the results of a casing integrity test conducted on 3/31/95 and witnessed by BLM representative Andy Cortez. The casing and plug were successfully tested to 520 psi for 30 minutes. TEPI requests TA status on this well through 4/5/99. A copy of the 4/5/95 test chart is on back.

Justification: A \$2,400,000 Cotton Draw 3D seismic acquisition was completed in late 1995. Texaco is processing the 3D survey. Texaco would like to hold the deeper Cotton Draw wells in idle/TA status until the seismic data can be completely analyzed.

(INTERNAL TEPI STATUS REMAINS TR-NG)

APPROVED FOR 12 MONTH PERIOD
ENDING APR 05 1999



14. I hereby certify that the foregoing is true and correct.

SIGNATURE [Signature] TITLE Engr Asst DATE 1/13/98

TYPE OR PRINT NAME Monte C. Duncan

(This space for Federal or State office use)

APPROVED BY [Signature] DAVID B. CLARK TITLE PETROLEUM ENGINEER DATE FEB 05 1998

CONDITIONS OF APPROVAL, IF ANY:

Title 18 U.S.C. Section 1001, makes it a crime for any person knowingly and willfully to make to any department or agency of the United States any false, fictitious or fraudulent statements or representations as to any matter within its jurisdiction.

UNITED STATES
DEPARTMENT OF THE INTERIOR
BUREAU OF LAND MANAGEMENT

N.M. Oil & Gas Division
811 S. 1st Street
Artesia, NM 87210-2834

FORM APPROVED
Budget Bureau No. 1004-0135
Expires: March 31, 1993

SUNDRY NOTICES AND REPORTS ON WELLS
Do not use this form for proposals to drill or to deepen or reentry to a different reservoir.
Use "APPLICATION FOR PERMIT --" for such proposals

SUBMIT IN TRIPLICATE

1. Type of Well: ☒ OIL WELL ☐ GAS WELL ☐ OTHER
2. Name of Operator: **TEXACO EXPLORATION & PRODUCTION INC.**
3. Address and Telephone No.: **205 E. Bender, HOBBS, NM 88240** **397-0444**
4. Location of Well (Footage, Sec., T., R., M., or Survey Description)
Unit Letter **F** : **2300** Feet From The **NORTH** Line and **770** Feet From The **WEST** Line **2310** Section **12** Township **25S** Range **31E**

5. Lease Designation and Serial No.
NM-0503
6. If Indian, Alottee or Tribe Name
7. If Unit or CA, Agreement Designation
8. Well Name and Number
COTTON DRAW UNIT
68
9. API Well No.
30-015-02072 20272
10. Field and Pool, Exploratory Area
PADUCA WOLFCAMP, SOUTH (GAS)
11. County or Parish, State
EDDY, NEW MEXICO

12. **Check Appropriate Box(s) To Indicate Nature of Notice, Report, or Other Data**

TYPE OF SUBMISSION	TYPE OF ACTION	
<input type="checkbox"/> Notice of Intent	<input type="checkbox"/> Abandonment	<input type="checkbox"/> Change of Plans
<input checked="" type="checkbox"/> Subsequent Report	<input type="checkbox"/> Recompletion	<input type="checkbox"/> New Construction
<input type="checkbox"/> Final Abandonment Notice	<input type="checkbox"/> Plugging Back	<input type="checkbox"/> Non-Routine Fracturing
	<input type="checkbox"/> Casing Repair	<input type="checkbox"/> Water Shut-Off
	<input type="checkbox"/> Altering Casing	<input type="checkbox"/> Conversion to Injection
	<input checked="" type="checkbox"/> OTHER: EXTENSION OF TA STATUS	<input type="checkbox"/> Dispose Water

(Note: Report results of multiple completion on Well Completion or Recompletion Report and Log Form.)

13. Describe Proposed or Completed Operations (Clearly state all pertinent details, and give pertinent dates, including estimated date of starting any proposed work. If well is directionally drilled, give subsurface locations and measured and true vertical depths for all markers and zones pertinent to this work.)

Texaco Exploration and Production Inc requests an extension of one year of the temporary abandonment status of the above well which ended on 4/5/99. The original temporary abandonment status was approved on 5/17/95 based upon the results of a casing integrity test conducted on 3/31/95 and witnessed by BLM representative Andy Cortez. The casing and plug were successfully tested to 520 psi for 30 minutes. TEPI requests TA status on this well through 4/5/2000. A copy of the 4/5/95 test chart is on back.

Justification: A \$2,400,000 Cotton Draw 3D seismic acquisition was completed in late 1995. Texaco is processing the 3D survey. Texaco would like to hold the deeper Cotton Draw wells in idle/TA status until the seismic data can be completely analyzed.

(INTERNAL TEPI STATUS REMAINS TA-03)

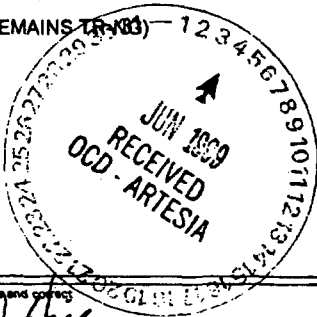

7A APPROVED FOR 12 MONTH PERIOD
ENDING 4/5/2000

14. I hereby certify that the foregoing is true and correct

SIGNATURE Bobby J. Hill TITLE Engineering Assistant DATE 5/13/99

TYPE OR PRINT NAME Bobby J. Hill

(This space for Federal or State office use)

APPROVED BY _____ TITLE PETROLEUM ENGINEER DATE JUN 03 1999

CONDITIONS OF APPROVAL, IF ANY:

Title 18 U.S.C. Section 1001, makes it a crime for any person knowingly and willfully to make to any department or agency of the United States any false, fictitious or fraudulent statements or representations as to any matter within its jurisdiction.

UNITED STATES
DEPARTMENT OF THE INTERIOR
BUREAU OF LAND MANAGEMENT

N.M. Oil Cons. Commission
811 S. 1st Street
Artesia, NM 88210-2834

FORM APPROVED
Budget Bureau No. 1004-0135
Expires: March 31, 1993

C/SF

SUNDRY NOTICES AND REPORTS ON WELLS
Do not use this form for proposals to drill or to deepen or reentry to a different reservoir.
Use "APPLICATION FOR PERMIT --" for such proposals

SUBMIT IN TRIPLICATE

1. Type of Well: ☒ OIL WELL ☐ GAS WELL ☐ OTHER

2. Name of Operator
TEXACO EXPLORATION & PRODUCTION INC.

3. Address and Telephone No. 205 E. Bender, HOBBS, NM 88240 397-0444

4. Location of Well (Footage, Sec., T., R., M., or Survey Description)

Unit Letter F : 2300- Feet From The NORTH Line and 770- Feet From The
WEST R310
EAST Line Section 12 Township 25S Range 31E

5. Lease Designation and Serial No.
NM-0503

6. If Indian, Alottee or Tribe Name

7. If Unit or CA, Agreement Designation

8. Well Name and Number
COTTON DRAW UNIT

68

9. API Well No. 20272
30-015-02072

10. Field and Pool, Exploratory Area
PADUCA WOLFCAMP, SOUTH (GAS)

11. County or Parish, State
EDDY, NEW MEXICO

12. Check Appropriate Box(s) To Indicate Nature of Notice, Report, or Other Data

TYPE OF SUBMISSION

- ☒ Notice of Intent
☐ Subsequent Report
☐ Final Abandonment Notice

TYPE OF ACTION

- ☐ Abandonment
☐ Recompletion
☐ Plugging Back
☐ Casing Repair
☐ Attering Casing
☒ OTHER: EXTENSION OF TA STATUS
☐ Change of Plans
☐ New Construction
☐ Non-Routine Fracturing
☐ Water Shut-Off
☐ Conversion to Injection
☐ Dispose Water

(Note: Report results of multiple completion on Well Completion or Recompletion Report and Log Form.)

13. Describe Proposed or Completed Operations (Clearly state all pertinent details, and give pertinent dates, including estimated date of starting any proposed work. If well is directionally drilled, give subsurface locations and measured and true vertical depths for all markers and zones pertinent to this work.)*

Texaco Exploration and Production Inc respectively gives notice of intent for an extension of one year of the temporary abandonment status of the above well. The present extension ended on 4/5/00. The original temporary abandonment status was approved on 5/17/95 based upon the results of a casing integrity test conducted on 3/31/95 and witnessed by BLM representative Andy Cortez. The casing and plug were successfully tested to 520 psi for 30 minutes. TEPI requests TA status on this well through 4/5/2001.

Ms. Alexis Swoboda of the BLM in Roswell has requested that TEPI conduct a new casing integrity test for the well, which will be done upon approval of the notice of intent.

Justification: At this time, workover procedures are planned for this well to restore it to production in the Wolfcamp zone. The workover is pending drilling projects in this area, which are presently being completed. Texaco would like to hold the Cotton Draw well # 87 in TA status until the drilling projects can be completely evaluated.

(INTERNAL TEPI STATUS REMAINS TR-NG)

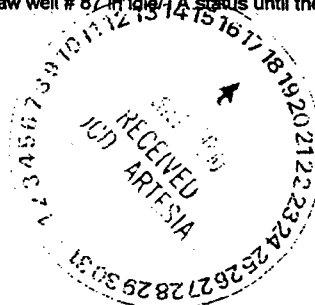

14. I hereby certify that the foregoing is true and correct.

SIGNATURE Bobby J Hill TITLE Engineering Assistant DATE 4/17/00

TYPE OR PRINT NAME Bobby J. Hill

(This space for Federal or State office use)

APPROVED BY (Orig. Sign.) JOE G. LARA TITLE Petroleum Engineer DATE 5/15/2000

CONDITIONS OF APPROVAL, IF ANY:

Title 18 U.S.C. Section 1001, makes it a crime for any person knowingly and willfully to make to any department or agency of the United States any false, fictitious or fraudulent statements or representations as to any matter within its jurisdiction.

UNITED STATES
DEPARTMENT OF THE INTERIOR
BUREAU OF LAND MANAGEMENT

FORM APPROVED
Budget Bureau No. 1004-0135
Expires: March 31, 1993

SUNDRY NOTICES AND REPORTS ON WELLS

Do not use this form for proposals to drill or to deepen or reentry to a different reservoir.

Use "APPLICATION FOR PERMIT --" for such proposals

5. Lease Designation and Serial No.
NM-0503

6. If Indian, Allottee or Tribe Name

7. If Unit or CA, Agreement Designation

SUBMIT IN TRIPLICATE

1. Type of Well: ☒ OIL WELL ☐ GAS WELL ☐ OTHER

8. Well Name and Number
COTTON DRAW UNIT

2. Name of Operator
TEXACO EXPLORATION & PRODUCTION INC.

68

3. Address and Telephone No.
205 E. Bender, HOBBS, NM 88240

397-0405

9. API Well No.
20272
30-015-02072

4. Location of Well (Footage, Sec., T., R., M., or Survey Description)

Unit Letter F ~~2390~~ Feet From The NORTH Line and ~~770~~ Feet From The
West ~~EAST~~ 1370 Line Section 12 Township 25S Range 31E 1980

10. Field and Pool, Exploratory Area
PADUCA WOLFCAMP, SOUTH (GAS)

11. County or Parish, State
EDDY, NEW MEXICO

12. Check Appropriate Box(s) To Indicate Nature of Notice, Report, or Other Data

TYPE OF SUBMISSION

☐ Notice of Intent
☒ Subsequent Report
☐ Final Abandonment Notice

TYPE OF ACTION

☐ Abandonment
☐ Recompletion
☐ Plugging Back
☐ Casing Repair
☐ Altering Casing
☒ OTHER: REQUEST TA STATUS

☐ Change of Plans
☐ New Construction
☐ Non-Routine Fracturing
☐ Water Shut-Off
☐ Conversion to Injection
☐ Dispose Water

(Note: Report results of multiple completion on Well Completion or Recompletion Report and Log Form.)

13. Describe Proposed or Completed Operations (Clearly state all pertinent details, and give pertinent dates, including estimated date of starting any proposed work. If well is directionally drilled, give subsurface locations and measured and true vertical depths for all markers and zones pertinent to this work.)

9-06-00: NOTIFIED BLM. TEST CSG TO 520 PSI FOR 30 MINUTES - OK

ORIGINAL CHART & COPY OF CHART ATTACHED.

TA Approved For 12 Month Period
Ending 9/6/2001



14. I hereby certify that the foregoing is true and correct

SIGNATURE J. Denise Leake TITLE Engineering Assistant

TYPE OR PRINT NAME J. Denise Leake

(This space for Federal or State office use)

APPROVED (1016.907) JOE G. LARA

CONDITIONS OF APPROVAL IF ANY TITLE

Petroleum Engineer

DATE 10/2/2000

Title 18 U.S.C. Section 1001 makes it a crime for any person knowingly and willfully to make to any department or agency of the United States any false, fictitious or fraudulent statements or representations as to any matter within its jurisdiction

District I
1625 N. French Dr., Hobbs, NM 88240
District II
1301 W. Grand Avenue, Artesia, NM 88210
District III
1000 Rio Brazos Road, Aztec, NM 87410
District IV
1220 S. St. Francis Dr., Santa Fe, NM 87505

State of New Mexico
Energy Minerals and Natural Resources

Form C-104A
March 19, 2001

Oil Conservation Division
1220 South St. Francis Dr.
Santa Fe, NM 87505

Submit 1 copy of the final affected wells
list along with 1 copy of this form per
number of wells on that list to appropriate
District Office

Change of Operator

Previous Operator Information:

OGRID: 22351
Name: Texaco Exploration & Production, Inc.
Address: P.O. Box 3109
Address: _____
City, State, Zip: Midland, Texas 79702

New Operator Information:

Effective Date: May, 01, 2002
New Ogrid: 4323
New Name: Chevron U.S.A.
Address: P.O. Box 1150
Address: 15 Smith Road
City, State, Zip: Midland, Texas 79705

I hereby certify that the rules of the Oil Conservation Division have been complied with and that the information on this form and the attached list of wells is true and complete to the best of my knowledge and belief.

New Operator

Signature: M. K. DeBerry

Printed name: M. K. DeBerry

Title: Attorney-In-Fact

Date: April 26, 2002 Phone: 281-561-3618



Previous operator complete below:

Previous
Operator: Texaco Exploration & Production Inc
Previous
OGRID: 22351
Signature: D. T. Yellowlees
Printed
Name: D. T. Yellowlees

NMOCD Approval	
Signature: <u>Jim W. Brown</u>	
Printed Name: <u>District Supervisor</u>	
District: _____	
Date: <u>MAY 17 2002</u>	

District I

1625 N. French Dr., Hobbs, NM
88240State of New Mexico
Energy, Minerals and Natural Resources

Form C-104A

Permit 1412

Oil Conservation Division

1220 S. St Francis Dr.

Santa Fe, NM 87505

Change of Operator

Previous Operator Information

OGRID: 4323
Name: CHEVRON U S A INC
Address: 15 Smith Road
Address: _____
City, State, Zip: Midland, TX 79705

New Operator Information

Effective Date: 09/01/2004
OGRID: 6137
Name: DEVON ENERGY PRODUCTION
Address: COMPANY, LP
Address: 20 N. Broadway
Address: Suite 1500
City, State, Zip: Oklahoma City, OK 73102

I hereby certify that the rules of the Oil Conservation Division have been complied with and that the information on this form and the certified list of wells is true to the best of my knowledge and belief.

Previous Operator

Signature: *Denise Pinkerton*
Printed Name: Denise Pinkerton

Title: Regulatory SpecialistDate: 8-26-2004 Phone: 432-687-7375

New Operator

Signature: *Ray Payne*
Printed Name: Ray Payne

Title: Dist. Oper. Engr. SupvDate: 9/1/04 Phone: 405-235-3611

NMOCD Approval

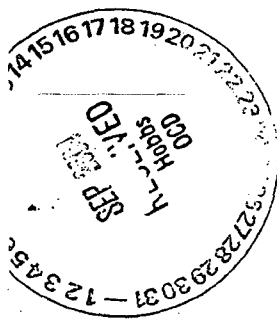
Electronic Signature: Chris Williams, District IElectronic Signature: Tim Gum, District IIDate: September 13, 2004

UNITED STATES
DEPARTMENT OF THE INTERIOR
BUREAU OF LAND MANAGEMENT
N.M. Oil Cons. DIV-Dist. 2
1301 W. Grand Avenue
Alamosa, NM 88210

FORM APPROVED
Budget Bureau No. 1004-0135
Expires March 31, 1993

SUNDRY NOTICES AND REPORTS ON WELLS

Do not use this form for proposals to drill or to deepen or reentry to a different reservoir.
Use "APPLICATION FOR PERMIT—" for such proposals

SUBMIT IN TRIPLICATE

RECEIVED

OCT 28 2004

OOD-ARTESIA

1. Type of Well
☐ Oil Well ☒ Gas Well ☐ Other _____

2. Name of Operator
DEVON ENERGY PRODUCTION COMPANY, LP.

3. Address and Telephone No.
20 NORTH BROADWAY, SUITE 1500, OKLAHOMA CITY, OKLAHOMA 73102 (405) 552-4615

4. Location of Well (Footage. Sec., T., R., M., or Survey Description)
2310' FNL 1980' FWL, SEC 12-T25S-R31E, Unit Letter F

5. Lease Designation and Serial No.

NM-0503

6. If Indian, Allottee or Tribe Name

NA

7. If Unit or CA, Agreement Designation

8. Well Name and No.

Cotton Draw Unit 68

9. API Well No.

30-015-20272

10. Field and Pool, or Exploratory Area

Paduca South, Wolfcamp

11. County or Parish, State

Eddy County, NM

CHECK APPROPRIATE BOX(S) TO INDICATE NATURE OF NOTICE, REPORT, OR OTHER DATA

TYPE OF SUBMISSION

TYPE OF ACTION

- ☒ Notice of Intent
☐ Subsequent Report
☐ Final Abandonment Notice

- ☒ Abandonment
☐ Recompletion
☐ Plugging Back
☐ Casing Repair
☐ Altering Casing
☐ Other _____

- ☐ Change of Plans
☐ New Construction
☐ Non-Routine Fracturing
☐ Water Shut-Off
☐ Conversion to Injection
☐ Dispose Water

(Note: Report results of multiple completion on Well Completion or Recompletion Report and Log form.)

13. Describe Proposed or Completed Operations (Clearly state all pertinent details, and give pertinent dates, including estimated date of starting any proposed work. If well is directionally drilled, give subsurface locations and measured and true vertical depths for all markers and zones pertinent to this work.)*

1. Pull existing production tubing and packer from well
2. Set CIBP at 12860'. Pump 50' cement on top.
3. Circulate hole with 9 ppg mud.
4. Set 150' cement plug from 10710' to 10860'. WOC and tag.
5. Set 150' cement plug from 8300' to 8450'. WOC and tag.
6. Set 150' cement plug from 6300' to 6450'. WOC and tag.
7. Set 150' cement plug from 4340' to 4490'. WOC and tag.
8. Cut 9-5/8" casing at 2730' and pull from hole. Set 150' cement plug from 2655' to 2805'. WOC and tag.
9. Set 150' cement plug from 680' to 830'. WOC and tag.
10. Set 60' cement plug at surface.
11. Cut casings off 3' below ground level and install P&A marker.
12. Clean up location.

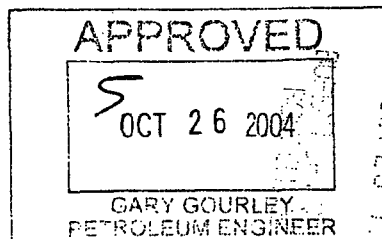

2004 OCT 25 11:08

RECEIVED

Note: Cement class "C" at 14.8 ppg with a yield of 1.32 cu. ft/sx

14. I hereby certify that the foregoing is true and correct

Signed Ronnie Slack

Accepted for record - NMOCD

Ronnie Slack

Title Engineering Technician

Date 10/22/04

Approved by _____
Conditions of approval, if any:

Title _____

Date _____

Title 18 U.S.C. Section 1001, makes it a crime for any person knowingly and willfully to make to any department or agency of the United States any false, fictitious or fraudulent statements or representation to any matter within its jurisdiction.

*See Instruction on Reverse Side

DEVON ENERGY PRODUCTION COMPANY LP

Well Name: Cotton Draw Unit 68		Field: Paduca	
Location: Sec 12-T255-R31E; 2310' FNL & 1980' FWL		County: Eddy	State: NM
Elevation: 3457' DF; 3428' CH		Spud Date: 12-19-69	Compl Date: 6-9-70
API#: 30-015-20272	Prepared by: Ronnie Slack	Date: 10-21-04	Rev:

PROPOSED P&A

26" Hole
20" 94# @ 755'
Cmt'd w/ 2100 sx. Cement circulated.

TOC @ 2880' - Temp Survey

17-1/2" Hole
13-3/8" 48# @ 4415'
Cmt'd w/ 8250 sx. Cement circulated

DV Tool @ 7915'

TOL @ 12270'

12-1/4" Hole
9-5/8" 53.5# & 47# @ 12650'
Cmt'd w/ 1250 sx 1st stage. DV tool at 7915'
Cmt'd w/ 1800 sx 2nd stage thru DV tool at 7915'
Full returns

WOLFCAMP (5/2/77)
12895' - 12972'

TOL @ 14276'

7-5/8" 39# P110 from 12270' to 14680'
Cmt'd liner w/ 483 sx. Cement @ TOL.

MORROW (6/9/70)
14731' - 14750'
14759' - 14763'

MORROW (tested 5/23/70)
14940' - 14954'; 14959' - 14992'

5-1/2" 23# C75 Hydril from 14276' to 16456'
Cmt'd w/ 185 sx. Cement @ TOL

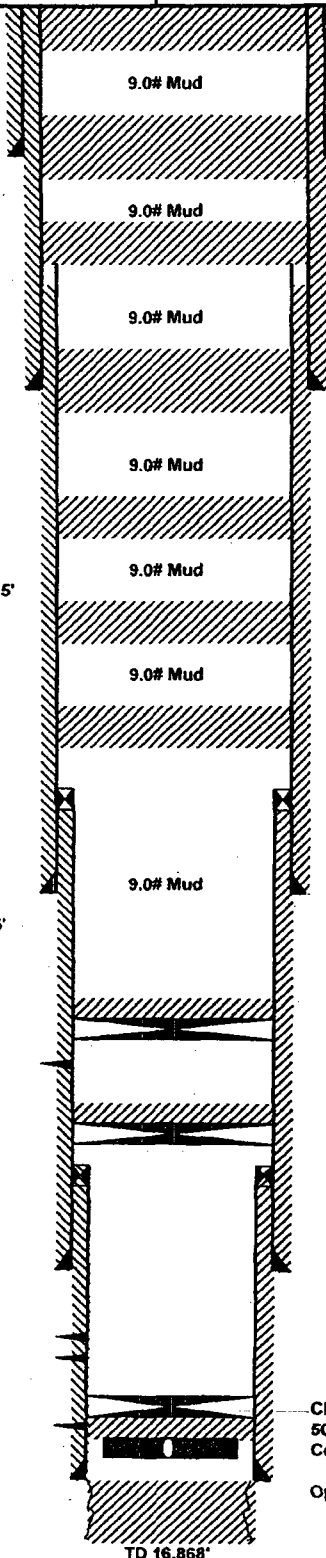

PROPOSED
Pump 60' cement plug from surface to 60'

PROPOSED
Pump 150' cement plug from 680' to 830'

PROPOSED
Pump 150' cement plug from 2655' to 2805'
Cut and pull 9-5/8" casing at 2730'

PROPOSED
150' Cement plug @ 4340' - 4490'

PROPOSED
150' Cement plug @ 6300' - 6450'

PROPOSED
150' Cement plug @ 8300' - 8450
Note: Top of Bone Spring @ 8315'

PROPOSED
150' Cement plug @ 10710' - 10860'

PROPOSED
Cap w/ 50' cement
CIBP @ 12860'

PBD @ 14030' (5/2/77)
CIBP @ 14070' w/ 10 sx cement on top (5/2/77)

CIBP @ 14798' (6/8/70)
50 sx cement spotted. Cement drilled to 14825'
Cement retainer milled & pushed to 15240'

Open hole sqzd w/ 60 sx from 16456' - 16868'

TD 16,868'

DEVON ENERGY PRODUCTION COMPANY LP

Well Name: Cotton Draw Unit 68		Field: Paduca	
Location: Sec 12-T25S-R31E; 2310' FNL & 1980' FWL		County: Eddy	State: NM
Elevation: 3457' DF; 3428' CH		Spud Date: 12-19-69	Compl Date: 6-9-70
API#: 30-015-20272	Prepared by: Ronnie Slack	Date: 10-21-04	Rev:

CURRENT

26" Hole
20", 94#, @ 755'
 Cmt'd w/ 2100 sx. Cement circulated.

TOC @ 2880' - Temp Survey

17-1/2" Hole
13-3/8", 48#, @ 4415'
 Cmt'd w/ 8250 sx. Cement circulated

DV Tool @ 7915'

TOL @ 12270'

12-1/4" Hole
9-5/8", 53.5# & 47#, @ 12650'
 Cmt'd w/ 1250 sx 1st stage. DV tool at 7915'
 Cmt'd w/ 1800 sx 2nd stage thru DV tool at 7915'
 Full returns

WOLFCAMP (5/2/77)
 12895' - 12972'

TOL @ 14276'

7-5/8", 39#, P110, from 12270' to 14680'
 Cmt'd liner w/ 483 sx. Cement @ TOL.

MORROW (6/9/70)
 14731' - 14750'
 14759' - 14763'

MORROW (tested 5/23/70)
 14940' - 14954'; 14959' - 14992'

5-1/2", 23#, C75 Hydril from 14276' to 16456'
 Cmt'd w/ 185 sx. Cement @ TOL

Production tubing--per multipoint test (5/9/77)
2-7/8", 6.5# @ 12855'

Packer @ 12855' (5/2/77)

PBD @ 14030' (5/2/77)
 CIBP @ 14070', w/ 10 sx cement on top (5/2/77)

CIBP @ 14798' (6/8/70)
 50 sx cement spotted. Cement drilled to 14825'
 Cement retainer milled & pushed to 15240'

Open hole sqzd w/ 60 sx from 16456' - 16868'

TD 16,868'