



OIL CONSERVATION DIVISION  
RECEIVED

APR 8 1996

Southern

Rockies

Business

Unit

BHC 4.29.96

1273

April 4, 1996

Mr. William J. LeMay, Director  
New Mexico Oil Conservation Division  
2040 S. Pacheco Street  
P. O. Box 6429  
Santa Fe, NM 87505

**Application for Exception to Rule 303-C**  
**Downhole Commingling**  
**Jack Frost B#1 Well**  
**Unit P Section 27-T27N-R10W**  
**Angels Peak Gallup (Pool IDN 2170) and Basin Dakota (Pool IDN 71599) Pools**  
**San Juan County, New Mexico**

Enclosed please find an administrative application form (Form C-107-A) and attachments for downhole commingling for the captioned well.

Should you have questions concerning this matter, please contact me at (303) 830-5344.

Sincerely,

  
Pamela W. Staley

Enclosures

cc: Steve Webb  
Gail Jefferson  
Wellfile  
Proration File

Frank Chavez, Supervisor  
NMOCD District III  
1000 Rio Brazos Road  
Aztec, NM 87410

Duane Spencer  
Bureau of Land Management  
1235 La Plata Hwy  
Farmington, NM 87401

DISTRICT I  
P.O. Box 1980, Hobbs NM 88241-1980

State of New Mexico  
Energy, Minerals and Natural Resources Department

Form C-107-A  
New 3-12-96

DISTRICT II  
811 South First St., Artesia, NM 88210-2835

2040 S. Pacheco  
Santa Fe, New Mexico 87505-6429

DISTRICT III  
1000 Rio Brazos Rd. Aztec, NM 87410-1693

OIL CONSERVATION DIVISION  
APPLICATION FOR DOWNHOLE COMMINGLING

APPROVAL PROCESS:

☒ Administrative ☐ Hearing

EXISTING WELLBORE

☒ YES ☐ NO

Amoco Production Company

P.O. Box 800 Denver, CO 80201

Operator  
Jack Frost B

1

Address  
P-27-27N-10W

San Juan

Lessee

Well No.

Unit Ltr. - Sec Twp - Rge

County

Spacing Unit Lease Types: (check 1 or more)

OGRID NO. 000778 Property Code 000563 API NO. 3004506222 Federal ☒ State ☐ (and/or) Fee ☒

The following facts are submitted in support of downhole commingling:	Upper Zone	Intermediate Zone	Lower Zone
1. Pool Name and Pool Code	ANGELS PEAK GALLUP 2170		BASIN DAKOTA 71599
2. Top and Bottom of Pay Section (Perforations)	6161 - 6187'		6824' - 6925'
3. Type of production (Oil or Gas)	GAS		GAS
4. Method of Production (Flowing or Artificial Lift)	FLOWING		FLOWING
5. Bottomhole Pressure Oil Zones - Artificial Lift: Gas & Oil - Flowing: Estimated Current All Gas Zones: Measured Current Estimated or Measured Original	a. (Current) 855 PSI b. (Original) 1110 PSI	a. b.	a. 996 PSI b. 2304 PSI
6. Oil Gravity (° API) or Gas BTU Content	1190 BTU		1276 BTU /59.3 DEG API
7. Producing or Shut-In?	SHUT-IN (NEVER CONNECTED TO SALES)		PRODUCING
Production Marginal? (yes or no)	YES		YES
• If Shut-In, give data and oil/gas/water rates of last production Note: For new zones with no production history, applicant shall be required to attach production estimates and supporting data	Date: (EST) Rates: 40 MCFD 2 BCPD 0 BWPD	Date: Rates:	Date: Rates:
• If Producing, give date and oil/gas/water rates of recent test (within 60 days)	Date: Rates:	Date: Rates:	Date: 1/96 Rates: 74 MCFD 1.04 BCPD 0 BWPD
8. Fixed Percentage Allocation Formula -% for each zone	Oil: 66 % Gas 35 %	Oil: % Gas %	Oil: 34 % Gas 65 %

9. If allocation formula is based upon something other than current or past production, or is based upon some other method, submit attachments with supporting data and/or explaining method and providing rate projections or other required data.

10. Are all working, overriding, and royalty interests identical in all commingled zones?  
If not, have all working, overriding, and royalty interests been notified by certified mail?  
Have all offset operators been given written notice of the proposed downhole commingling?

☒ Yes ☐ No  
☐ Yes ☐ No  
☒ Yes ☐ No

11. Will cross-flow occur? ☐ Yes ☒ No If yes, are fluids compatible, will the formations not be damaged, will any cross-flowed production be recovered, and will the allocation formula be reliable. ☐ Yes ☐ No (If No, attach explanation)

12. Are all produced fluids from all commingled zones compatible with each other? ☒ Yes ☐ No

13. Will the value of production be decreased by commingling? ☐ Yes ☒ No (If Yes, attach explanation)

15. If this well is on, or communitized with, state or federal lands, either the Commissioner of Public Lands or the United States Bureau of Land Management has been notified in writing of this application. ☒ Yes ☐ No SF-077951-A

16. ATTACHMENTS:

- \* C-102 for each zone to be commingled showing its spacing unit and acreage dedication.
- \* Production curve for each zone for at least one year. (If not available, attach explanation.)
- \* For zones with no production history, estimated production rates and supporting data.
- \* Data to support allocation method or formula.
- \* Notification list of all offset operators.
- \* Notification list of working, overriding, and royalty interests for uncommon interest cases.
- \* Any additional statements, data, or documents required to support commingling.

I hereby certify that the information above is true and complete to the best of my knowledge and belief.

SIGNATURE

TITLE

REGULATORY AFFAIRS REP

DATE

4/4/96

TYPE OR PRINT NAME

PAMELA W. STALEY

TELEPHONE NO. ( 303 ) 830-5344

## Well Location and Acreage Dedication Plat

Section A.

Date February 19, 1959

Operator PAN AMERICAN PETROLEUM CORPORATION Lease JACK FROST "B"  
 Well No. 1 Unit Letter P Section 27 Township 27 NORTH Range 10 WEST NMPM  
 Located 1190 Feet From SOUTH Line, 895 Feet From EAST Line  
 County SAN JUAN G. L. Elevation \* Dedicated Acreage 160 Acres  
 Name of Producing Formation Dakota Pool Angels Peak Dakota

1. Is the Operator the only owner in the dedicated acreage outlined on the plat below?  
 Yes \_\_\_\_\_ No X \*To be reported later
2. If the answer to question one is "no", have the interests of all the owners been consolidated by communitization agreement or otherwise? Yes X No \_\_\_\_\_. If answer is "yes", Type of Consolidation.

## Communitized Acreage

3. If the answer to question two is "no", list all the owners and their respective interests below:

Owner

Land Description

(REVISED PLAT TO SHOW CHANGE IN WELL LOCATION)

## Section B.

Note: All distances must be from outer boundaries of section.

This is to certify that the information in Section A above is true and complete to the best of my knowledge and belief.

PAN AMERICAN PETROLEUM CORPORATION

(Operator)

R. M. Bauer, Jr. *RMBauer Jr.*

(Representative)

Box 487, Farmington, New Mexico

(Address)

REF. GLO PLAT DATED 19 JULY 1915

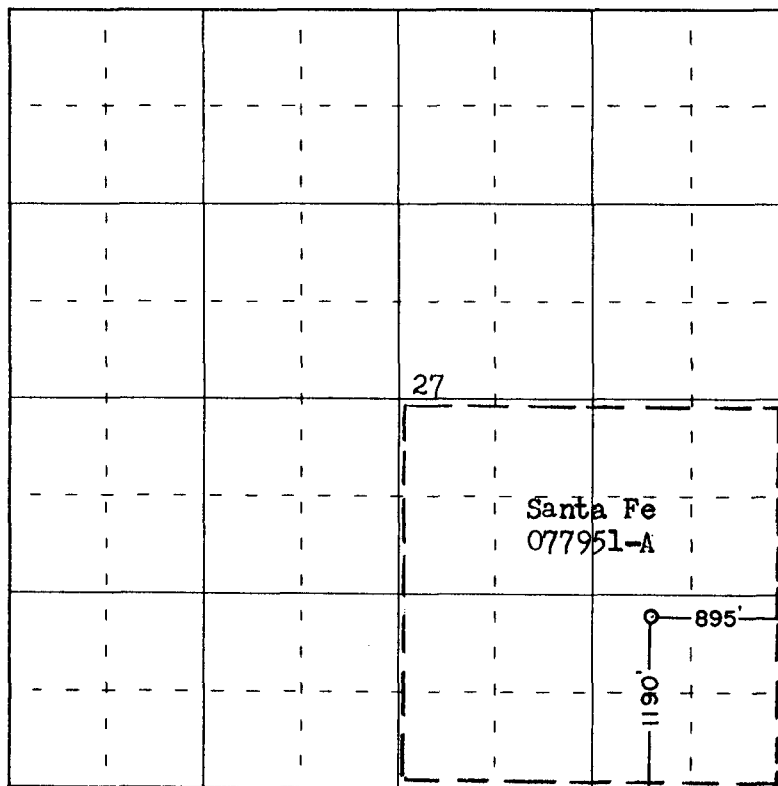

0 330 660 990 1320 1650 1980 2310 2640 2000 1500 1000 500 0

Scale 4 inches equal 1 mile

This is to certify that the above plat was prepared from field notes of actual surveys made by me or under my supervision and that the same are true and correct to the best of my knowledge and belief.

(Seal)

Farmington, New Mexico

Date Surveyed 14 February 1959

*James P. Leese*  
 Registered Professional Engineer and/or Land Surveyor

James P. Leese N. Mex. Reg. No. 2116

Engr: zdws22

JACK FROST B 1

Operator- AMOCO PRODUCTION CO

300450622200DK

P272710-001 DK

APC\_WI - 0.62500000

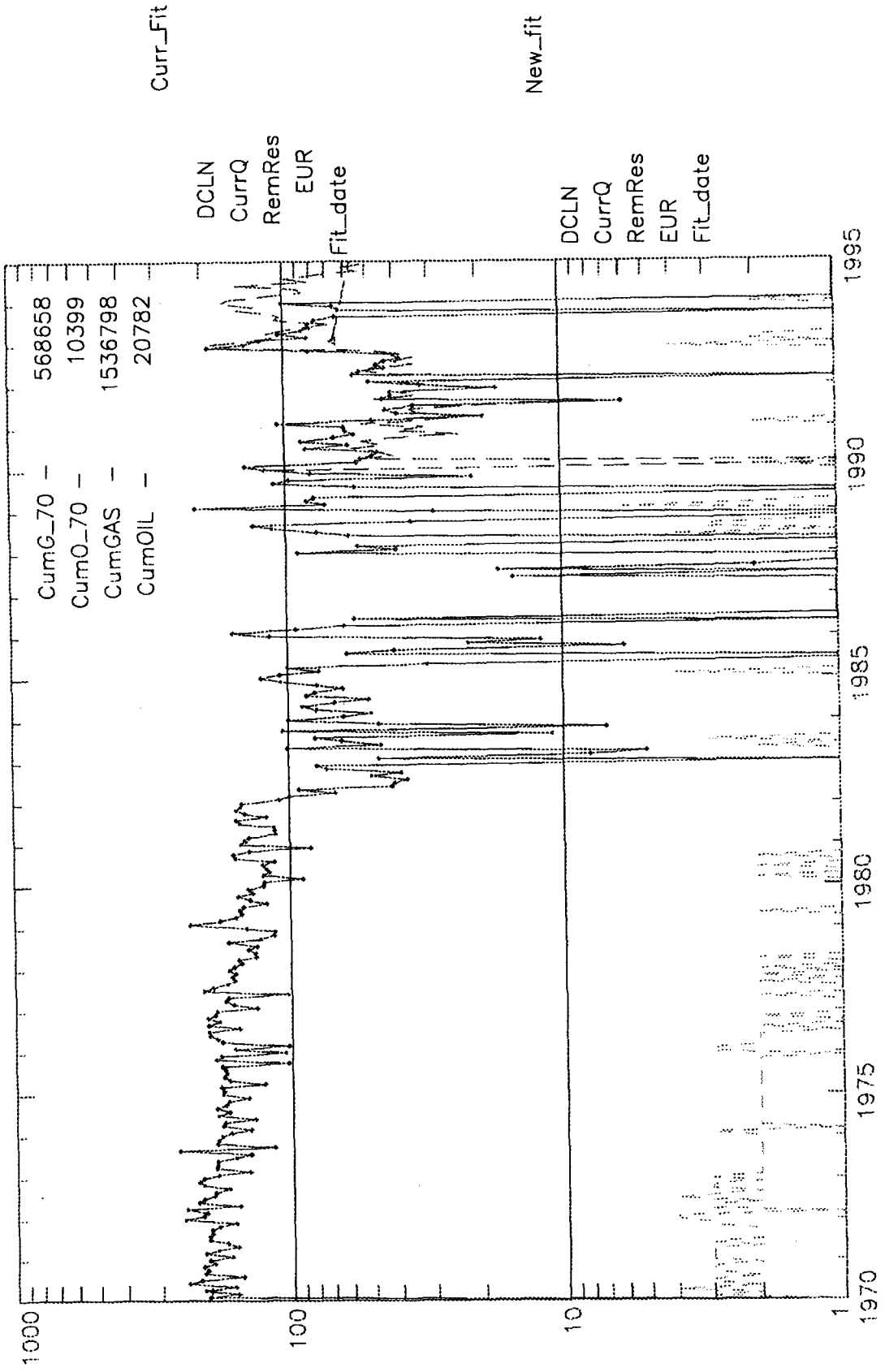

Engr: zdws22

JACK FROST B 1

Operator- AMOCO PRODUCTION CO

300450622200GP P272710-001 GP APC\_WI - 0.62500000

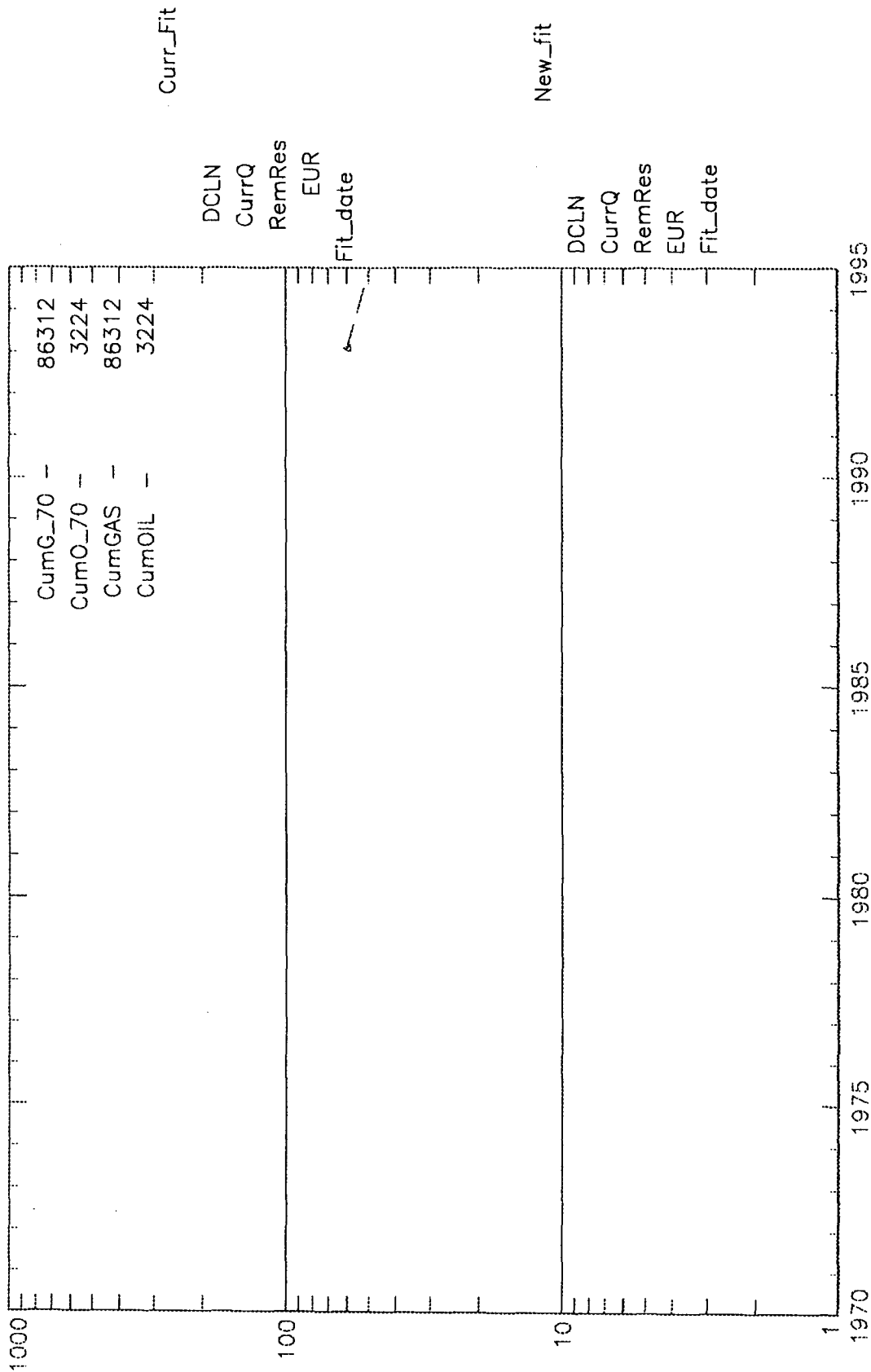

- GP WELLS -

EMP\_zslw11

APC  
+ JC GORDON D#2E  
192/60

(22)

APC  
CA McADAMS B#2  
248/50  
+ DHC W/DK  
+ APC  
CA McADAMS B#2E  
25/60  
DHC W/DK

APC  
JACK FROST B#2E  
102/40

APC  
CA McADAMS B#1E  
0/40  
DHC W/DK  
+ APC  
CA McADAMS B#1  
309/30

APC  
JACK FROST B#1E  
139/25  
+ DHC W/DK

APC  
JACK FROST B#1  
86/0  
+

27N

(28)

(27)

(32)

(34)

(35)

MOI  
+ HUERT 113  
6118/0

WEAVER  
McADAMS#5  
3/0  
+

MOI  
+ HUERT 107  
857/0

MOI  
HUERT 106  
7428/456  
+

LITTLE  
WISDEMERE  
+

+  
DUGAN  
McADAMS#3  
1164/5

DUGAN  
McADAMS#4  
3298/0  
+

DUGAN  
McADAMS#2  
4521/60  
+

(4)

(32)

26N

OFFSET USED TO ESTIMATE  
GALLUP PRODUCTION

Engr: zslw11

J C GORDON D 2E  
300452410000GP M222710-002EGP  
Operator- AMOCO PRODUCTION CO  
APC\_WI - 0.62500000

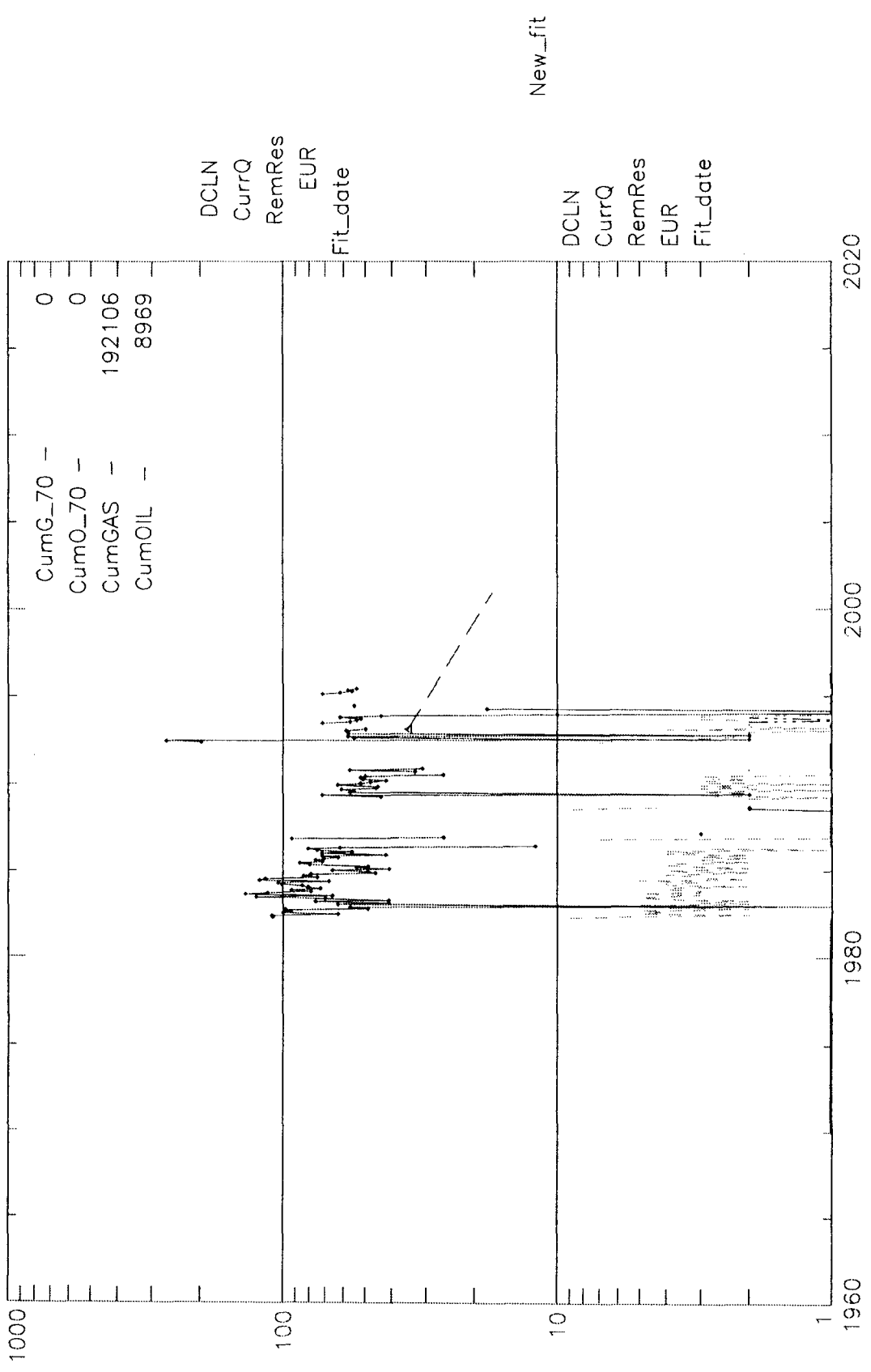

Engr: zslw11

JACK FROST B 2E

Operator- AMOCO PRODUCTION CO

300452437200GP

H272710-002EGP

APC\_WI - 0.62500000

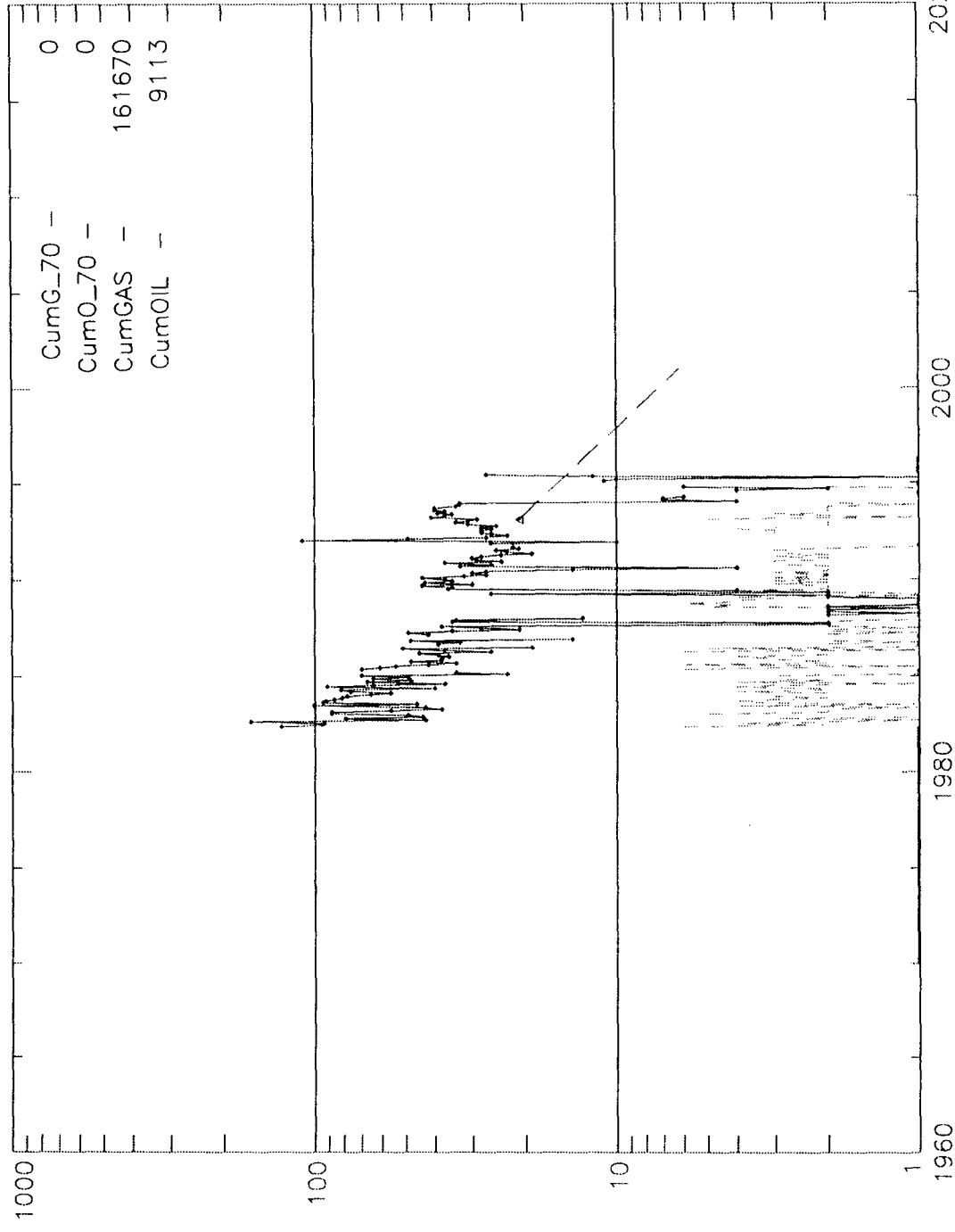



Engr: zslw11

JACK FROST B 1E  
300452435600GP M272710-001EGP  
Operator- AMOCO PRODUCTION CO  
APC\_WI - 0.62500000

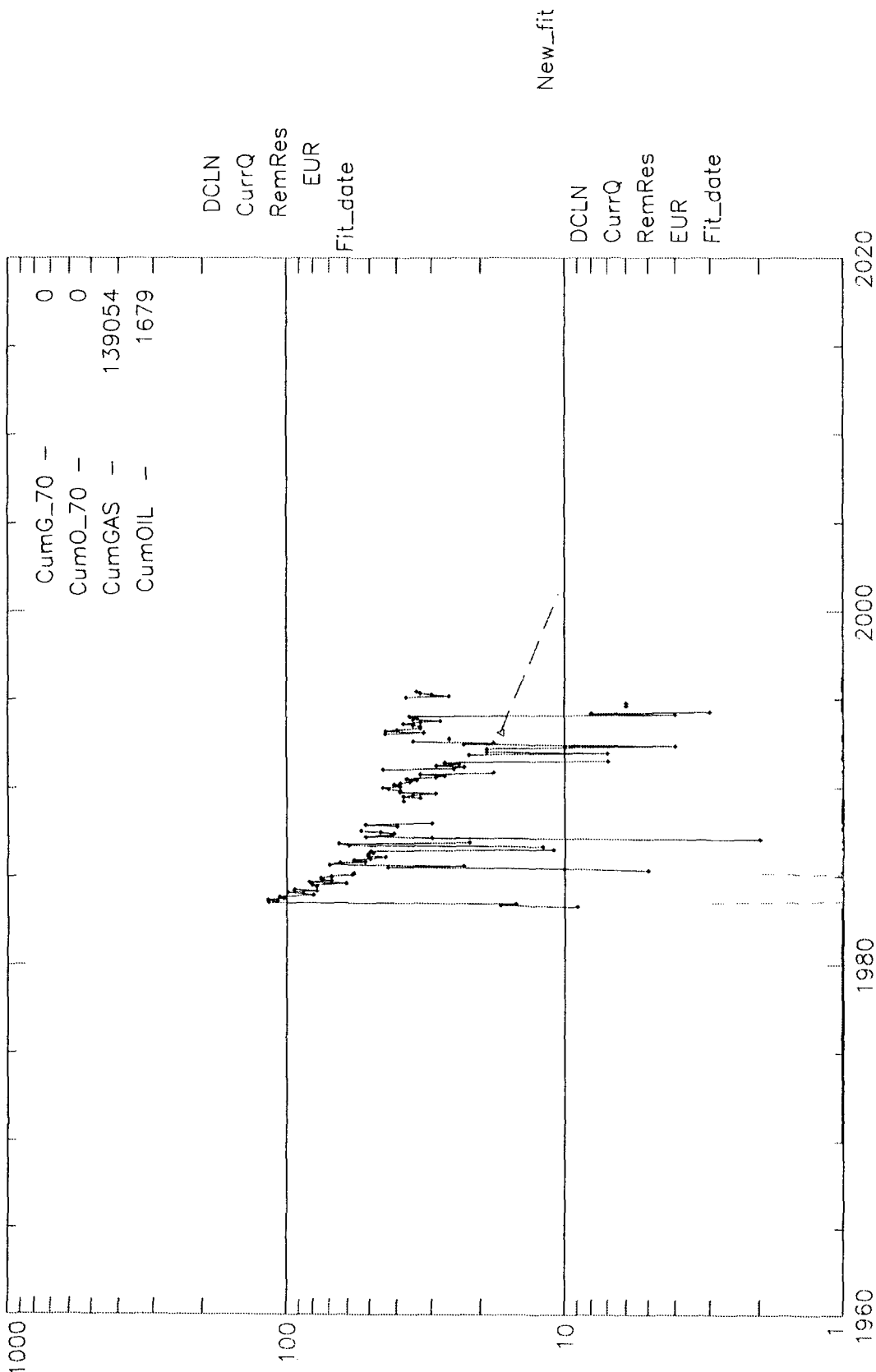

# OFFSET USED TO ESTIMATE GALLUP PRODUCTION

Engr: zslw11

C A MCADAMS B 2E

Operator-- AMOCO PRODUCTION CO

300452632300GP

B282710-002EGP

APC\_WI - 0.62500000

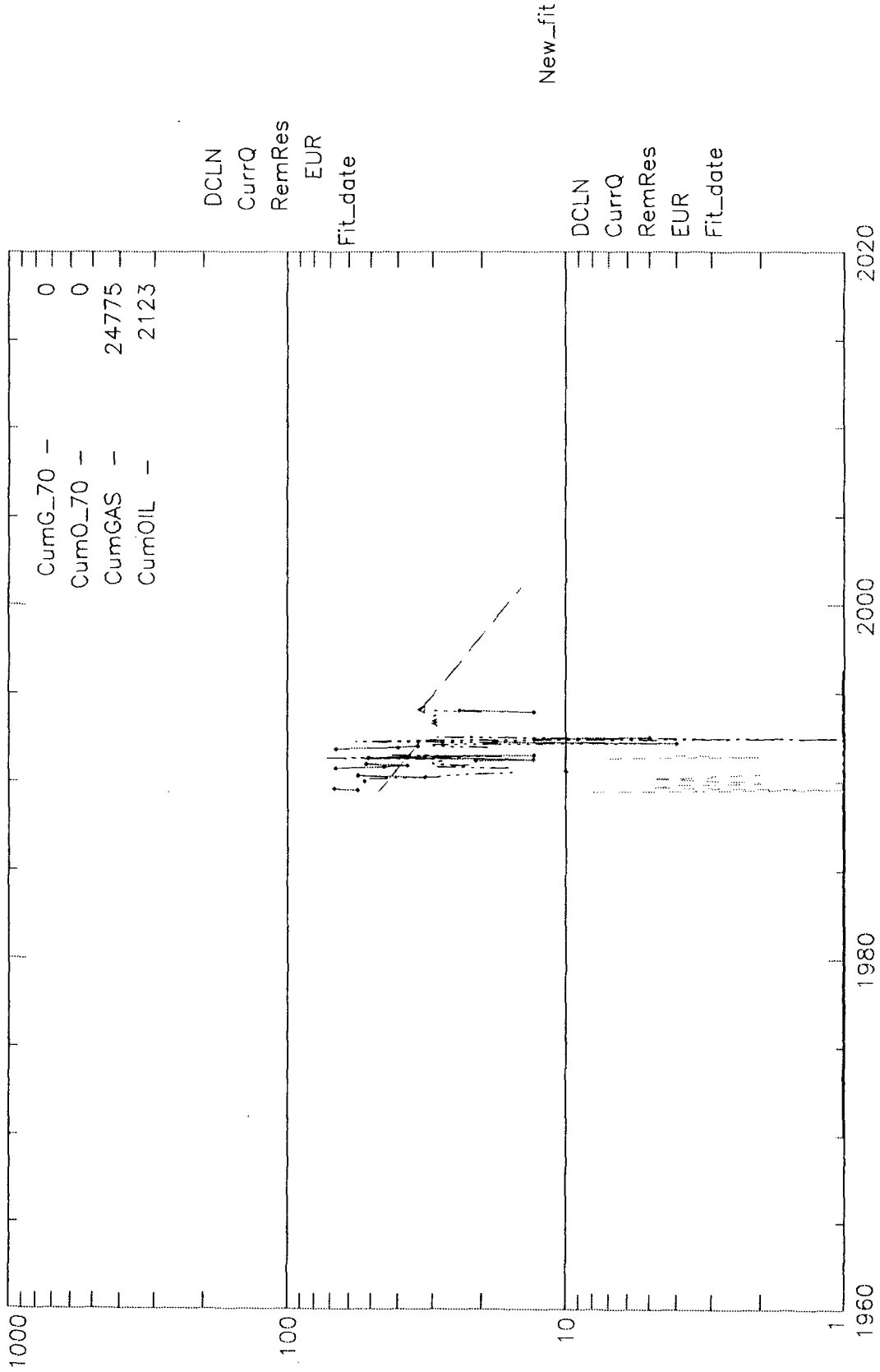

**LIST OF ADDRESSES FOR OFFSET OPERATORS**  
**Jack Frost B#1 Well**

Meridian Oil, Inc.  
P.O. Box 4289  
Farmington, NM 87499

Conoco, Inc.  
10 Desta Drive West  
Midland, Texas 79705

Dugan Production Corporation  
P.O. Box 420  
Farmington, New Mexico 87499