

Linn Energy Turner B North #11

CLOSURE REPORT

BLM Event #NU13100MB

API No. 30-015-22264

Release Date: 5/15/2013

Unit Letter A, Section 28, Township 17 South, Range 31 East

February 20, 2014

Prepared by:

Environmental Department
Diversified Field Service, Inc.
3412 N. Dal Paso
Hobbs, NM 88240
Phone: (575)964-8394
Fax: (575)393-8396

Table of Contents

- 1 Introduction
- 2 Site Activities
- 3 Conclusion

Figure – Site Diagram with Sample Data

APPENDICES

Appendix I – Initial Form C-141

Appendix II – Site Photographs

Appendix III – Groundwater Data

Appendix IV – Seed Report

Appendix V – Laboratory Analysis

Appendix VI – Final Form C-141

Turner B North #11

1 INTRODUCTION

Linn Energy (Linn) has retained Diversified Field Service, Inc. (DFSI) to address environmental issues for the site detailed herein.

The site is located west of Maljamar NM, in Eddy County. The site resulted from a produced water leak in a buried casing at the thread joint. The line rupture released produced water onto approximately 20 square feet of the well pad. The system was shut in and the line repaired. An initial form C-141 was submitted to the NMOCD on October 13, 2011 (Appendix I).

2 SITE ACTIVITIES

On October 31, 2013 DFSI personnel collected surface soil samples from the site (Figure). The samples were field screened for chloride and showed elevated levels in both of the sample points. The samples were submitted to a commercial laboratory for chloride, TPH, and BTEX analyses (Appendix IV).

Visually impacted soils were excavated throughout the entire leak area and removed to a NMOCD approved disposal facility. Simultaneous soil field testing revealed low chloride and hydrocarbon levels at 1 to 2 ft. below ground surface (bgs) (Figure). Soil samples were collected from the excavation floor and submitted to a laboratory for confirmation (Appendix IV). Chlorides were reduced at SP1 near the source of the leak to 394 mg/kg at 2 ft. bgs. The second sample on the west end of the pad contained 384 mg/kg. at 2 ft. bgs TPH totaled less than 10.0 mg/kg GRO and less than 10.0 mg/kg DRO, and BTEX totaled less than 130.9 mg/kg in all samples. Photographs of site activities can be viewed in Appendix II.

On November 13, 2013, DFSI submitted a backfill request to NMOCD and NMBLM. On July 23, 2013, NMOCD and BLM representatives approved backfill of the excavation. The excavated area on the well pad was backfilled with imported caliche and leveled. The pasture excavation was backfilled with imported topsoil and the site was contoured to the surrounding landscape. On January 06, 2014, the site was seeded with 25 lbs. of Lesser Prairie Chicken seed mix per BLM requirements.

3 CONCLUSION

According to the U.S. Geological Survey and the NM Office of the State Engineer, depth to groundwater in the area averages greater than 236 ft. bgs (Appendix III). Based on the removal
Diversified Field Service, Inc.

of soils containing elevated chloride and visual staining at the site, DFSI, on behalf of Linn, submits the final form C-141 (Appendix V) and respectfully requests the closure of the regulatory file for the site.

Excavation Diagram

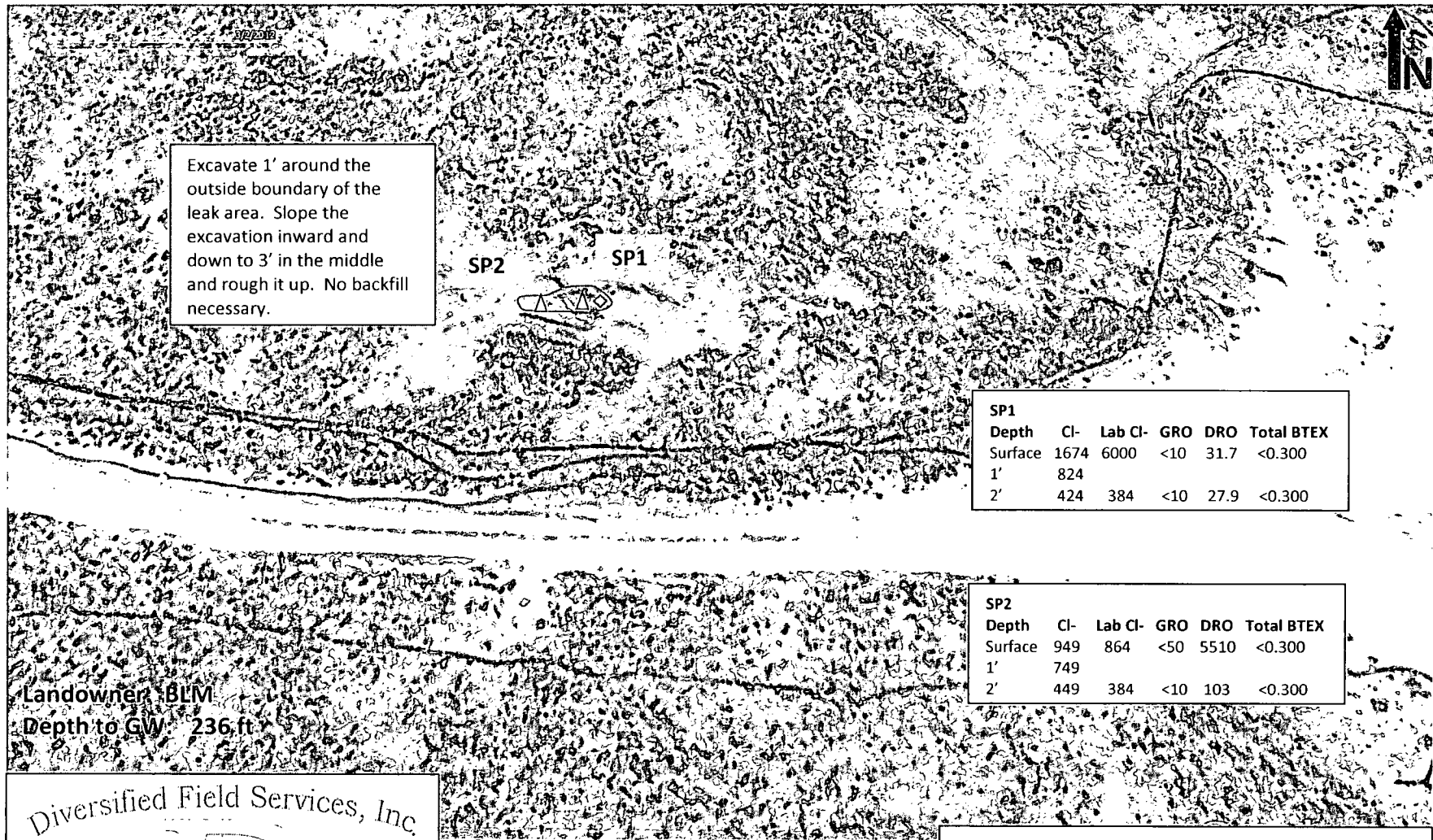

SP1					
Depth	Cl-	Lab Cl-	GRO	DRO	Total BTEX
Surface	1674	6000	<10	31.7	<0.300
1'	824				
2'	424	384	<10	27.9	<0.300

SP2					
Depth	Cl-	Lab Cl-	GRO	DRO	Total BTEX
Surface	949	864	<50	5510	<0.300
1'	749				
2'	449	384	<10	103	<0.300

Diversified Field Services, Inc.

C.C. & Co, LLC

J & M Welding and Fabrication, Inc.

Diversified Construction

Legend

Stained Area (total 200 ft²)

Leak Source

Sample Point

Linn Energy Turner B #11

UL/H, Sec 20, T17S R31E

Eddy County, NM

Drafted By: A.C. Ruth, 11/12/13

Not to Scale

Appendix I

INITIAL FORM C-141

Diversified Field Service, Inc.
3412 N. Dal Paso
Hobbs, NM 88240
(575) 964-8394

District I
1625 N. French Dr., Hobbs, NM 88240
District II
1301 W. Grand Avenue, Artesia, NM 88210
District III
1000 Rio Brazos Road, Aztec, NM 87410
District IV
1220 S. St. Francis Dr., Santa Fe, NM 87505

State of New Mexico
Energy Minerals and Natural Resources

Oil Conservation Division
1220 South St. Francis Dr.
Santa Fe, NM 87505

RECEIVED

SEP 29 2011

Form C-141
Revised October 10, 2003

Submit 2 Copies to appropriate
NMOC District Office in accordance
with Rule 116 on back
side of form

30-015-05283

Release Notification and Corrective Action

nmlb 1128648672

OPERATOR

☒ Initial Report ☐ Final Report

Name of Company: LINN Energy	269324	Contact: Joe Hernandez
Address: 2130 W Bender Blvd. - Hobbs, NM		Telephone No.: 575-942-8675
Facility Name: Turner B North #11 Injection Line		Facility Type: Produced Water Injection System

Surface Owner: BLM	Mineral Owner: BLM	Lease No.: LC-029395-B
--------------------	--------------------	------------------------

LOCATION OF RELEASE

Unit Letter	Section 20	Township 17S	Range 31E	Feet from the 1980	North/South Line N	Feet from the 660	East/West Line E	County Eddy
-------------	---------------	-----------------	--------------	-----------------------	-----------------------	----------------------	---------------------	----------------

Latitude: 32.821955 Longitude: -103.885953

NATURE OF RELEASE

Type of Release: Produced Water	Volume of Release: 5	Volume Recovered: 0
Source of Release: Line Leak	Date and Hour of Occurrence: 09/23/11 - 1500	Date and Hour of Discovery: 09/23/11 - 1530
Was Immediate Notice Given? <input checked="" type="checkbox"/> Yes <input type="checkbox"/> No <input type="checkbox"/> Not Required	If YES, To Whom? T. Gregston BLM. Mike Bratcher NMOCD	
By Whom? Fred Holmes	Date and Hour: 09/16/11 -0900	
Was a Watercourse Reached? <input type="checkbox"/> Yes <input checked="" type="checkbox"/> No	If YES, Volume Impacting the Watercourse.	

If a Watercourse was Impacted, Describe Fully.*:

Describe Cause of Problem and Remedial Action Taken.*: Thread joint worn out casing burned line to leak. SYstem was shut in and the line repaired.

Describe Area Affected and Cleanup Action Taken.*: Area is approximately 20 square feet with an estiamted 3-4 feet vertical. Corrective action plan, photographs and site map attached.

I hereby certify that the information given above is true and complete to the best of my knowledge and understand that pursuant to NMOCD rules and regulations all operators are required to report and/or file certain release notifications and perform corrective actions for releases which may endanger public health or the environment. The acceptance of a C-141 report by the NMOCD marked as "Final Report" does not relieve the operator of liability should their operations have failed to adequately investigate and remediate contamination that pose a threat to ground water, surface water, human health or the environment. In addition, NMOCD acceptance of a C-141 report does not relieve the operator of responsibility for compliance with any other federal, state, or local laws and/or regulations.

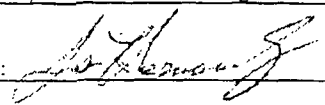
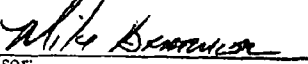
Signature: 	OIL CONSERVATION DIVISION	
Printed Name: Jose Hernandez	Signed By  Approved by District Supervisor:	
Title: Foreman	Approval Date: OCT 13 2011	Expiration Date:
E-mail Address: jhernandez@linneenrgy.com Date: 09/29/11 Phone: 575-738-1739	Conditions of Approval: Remediation per OCD Rules & Guidelines. SUBMIT REMEDIATION PROPOSAL NOT LATER THAN: 11/13/2011	Attached <input type="checkbox"/>

* Attach Additional Sheets If Necessary

2RP-915

Appendix II

SITE PHOTOGRAPHS

Diversified Field Service, Inc.
3412 N. Dal Paso
Hobbs, NM 88240
(575) 964-8394

Linn Energy Turner B North #11

Section 20, T17S R31E

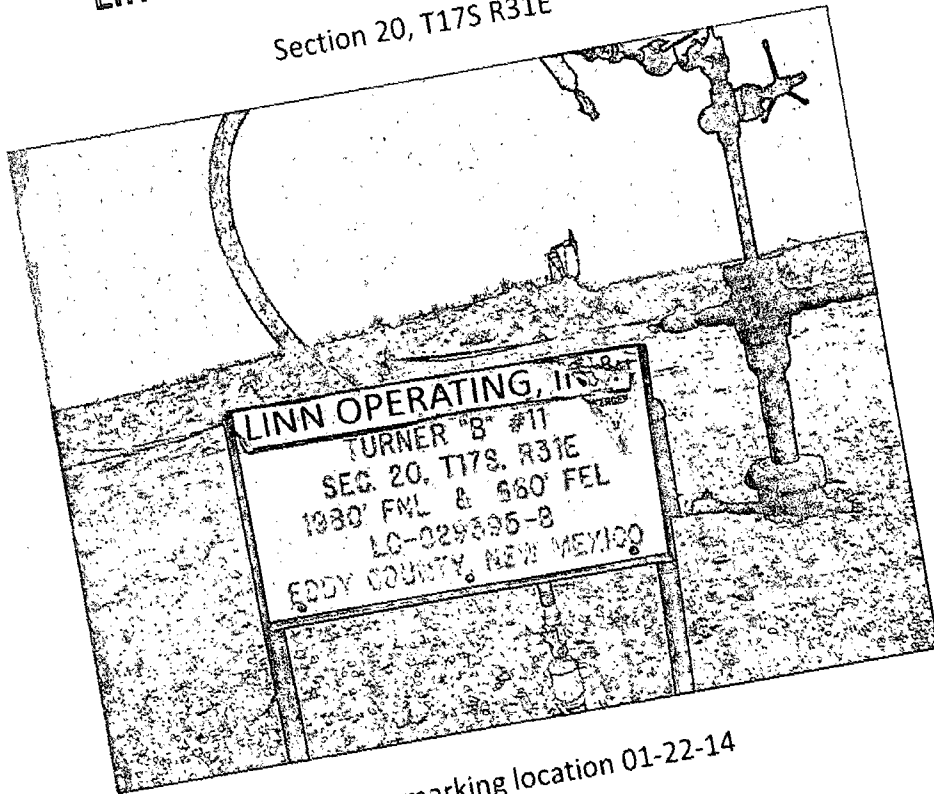

Sign marking location 01-22-14



Markers at sample points 11/02/13

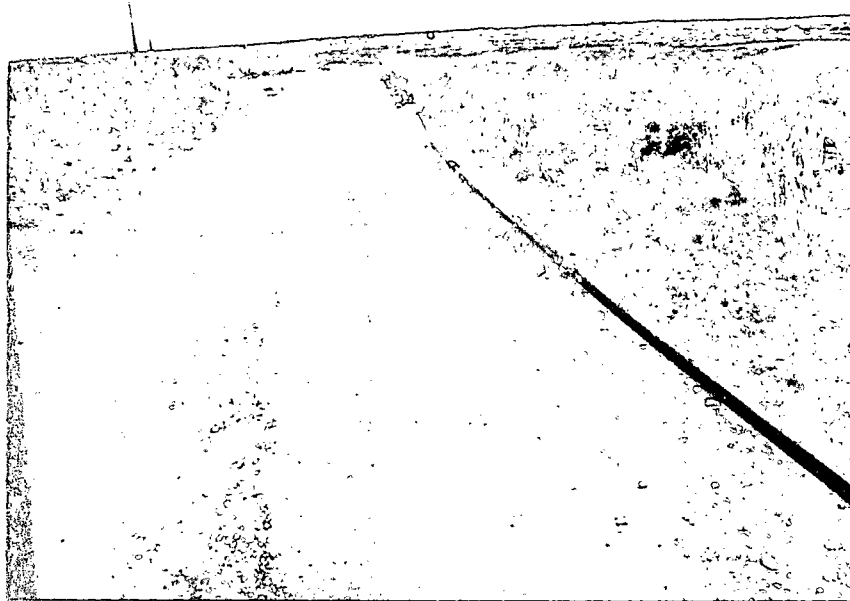

Repaired buried casing in lease road 11-02-13



Site at completion 02/05/14

Appendix III

GROUNDWATER DATA

Diversified Field Service, Inc.
3412 N. Dal Paso
Hobbs, NM 88240
(575) 964-8394

GROUND WATER SEARCH

Linn Energy Turner B #11

UL: H

Sec: 20

T: 17S

R: 31E

Groundwater Depth: 236 ft.

○ = NM Office of the State Engineer

● = U.S. Geological Survey (unknown well)

✕ = Site Location

Date: 11/12/13

By: Amy Ruth

	16S 30E	288'○ 314'○ 16S 31E	65' 260'○ 248' 275'○ 254'○ 16S 32E 210'○ 215'○ 221'○ 200'○	
	17S 30E	17S 31E ✕	132'○ 17S 32E	
	18S 30E 44'○	98'○ 18S 31E	65'○ 430'○ 18S 32E 460'○	



New Mexico Office of the State Engineer **Water Column/Average Depth to Water**

No records found.

PLSS Search:

Township: 16S Range: 30E

The data is furnished by the NMOSE/ISC and is accepted by the recipient with the expressed understanding that the OSE/ISC make no warranties, expressed or implied, concerning the accuracy, completeness, reliability, usability, or suitability for any particular purpose of the data.

4/29/13 12:38 PM

Page 1 of 1

WATER COLUMN/ AVERAGE
DEPTH TO WATER



New Mexico Office of the State Engineer

Water Column/Average Depth to Water

(A CLW##### in the
POD suffix indicates the
POD has been replaced
& no longer serves a
water right file.)

(R=POD has
been replaced,
O=orphaned,
C=the file is

closed) (quarters are 1=NW 2=NE 3=SW 4=SE)
(quarters are smallest to largest) (NAD83 UTM in meters)

(In feet)

POD Number	POD Sub-Code	basin	County	Q 64	Q 16	Q 4	Sec	Tws	Rng	X	Y	Depth Well	Depth Water	Water Column
L 03435	L	LE		1	1	05	16S	31E		602954	3646955*			
L 03852	R	L	LE	2	2	2	14	16S	31E	609126	3643913*	370	314	56
L 03852 POD4	L	LE		3	4	3	13	16S	31E	609744	3642516*	333	299	34
L 03852 POD5	L	LE		3	2	13	16S	31E		610238	3643427*	328	295	33
L 03852 X	R	L	LE	4	4	4	13	16S	31E	610749	3642526*	333	299	34
L 03852 X2	L	LE		3	2	2	13	16S	31E	610535	3643733*	330	287	43
L 04671	L	LE		1	1	2	12	16S	31E	610114	3645538*	340	288	52
L 10203	L	LE		4	4	3	14	16S	31E	608334	3642495*	310		
L 10206	L	LE		2	2	23	16S	31E		609045	3642204*	280		

Average Depth to Water: **297 feet**

Minimum Depth: **287 feet**

Maximum Depth: **314 feet**

Record Count: 9

PLSS Search:

Township: 16S

Range: 31E

*UTM location was derived from PLSS - see Help

The data is furnished by the NMOSE/ISC and is accepted by the recipient with the expressed understanding that the OSE/ISC make no warranties, expressed or implied, concerning the accuracy, completeness, reliability, usability, or suitability for any particular purpose of the data.



New Mexico Office of the State Engineer

Water Column/Average Depth to Water

(A CLW##### in the
POD suffix indicates the
POD has been replaced
& no longer serves a
water right file.)

(R=POD has
been replaced,
O=orphaned,

C=the file is
closed)

(quarters are 1=NW 2=NE 3=SW 4=SE)

(quarters are smallest to largest) (NAD83 UTM in meters)

(In feet)

POD Number	POD Sub-Code	basin	County	Q 64	Q 16	Q 4	Sec	Tws	Rng	X	Y	Depth Well	Depth Water	Water Column
<u>L 02381</u>	L	LE		3	1	13	16S	32E		619086	3643515*	308	215	93
<u>L 02434</u>	L	LE				01	16S	32E		619661	3646531*	337		
<u>L 02449</u>	L	LE				01	16S	32E		619661	3646531*	330	265	65
<u>L 02617</u>	L	LE		4	4	02	16S	32E		618656	3645924*	322	270	52
<u>L 02752</u>	L	LE		1	3	26	16S	32E		617521	3639880*	324	280	44
<u>L 02846</u>	L	LE		4	2	11	16S	32E		617956	3645413*	328	275	53
<u>L 02954</u>	L	LE		2	4	03	16S	32E		617043	3646310*	120	65	55
<u>L 02993</u>	L	LE		3	3	215	16S	32E		616572	3643391*	100		
<u>L 03631</u>	L	LE		1	2	02	16S	32E		618240	3647126*	315	250	65
<u>L 04930</u>	L	LE		1	23		16S	32E		617698	3642092*	307	210	97
<u>L 05494</u>	L	LE				36	16S	32E		619758	3638489*	303	200	103
<u>L 06557</u>	L	LE		1	4	21	16S	32E		615089	3641466*	295	210	85
<u>L 06807</u>	L	LE		1	4	09	16S	32E		615356	3644383*	290	248	42
<u>L 07823</u>	L	LE		2	2	16	16S	32E		615561	3643981*	269	247	22
<u>L 08084</u>	L	LE		1	1	116	16S	32E		614157	3643970*	317	260	57
<u>L 08084 POD4</u>	L	LE				226	16S	32E		618522	3640492*	303	233	70
<u>L 08084 POD5</u>	L	LE		4	1	426	16S	32E		618425	3639788*	296	165	131
<u>L 08084 S3</u>	L	LE				226	16S	32E		618522	3640492*	305	205	100
<u>L 08241</u>	L	LE		4	4	02	16S	32E		618656	3645924*	316		
<u>L 10204</u>	L	LE		4	2	04	16S	32E		615524	3646993*	319		
<u>L 10205</u>	L	LE		4	1	08	16S	32E		613038	3645066*	330		
<u>L 11189</u>	L	LE		1	1	404	16S	32E		614932	3646391*	350		

*UTM location was derived from PLSS - see Help

The data is furnished by the NMOSE/ISC and is accepted by the recipient with the expressed understanding that the OSE/ISC make no warranties, expressed or implied, concerning the accuracy, completeness, reliability, usability, or suitability for any particular purpose of the data.

Average Depth to Water: **224 feet**

Minimum Depth: **65 feet**

Maximum Depth: **280 feet**

Record Count: 22

PLSS Search:

Township: 16S

Range: 32E



New Mexico Office of the State Engineer **Water Column/Average Depth to Water**

No records found.

PLSS Search:

Township: 17S Range: 30E

The data is furnished by the NMOSE/ISC and is accepted by the recipient with the expressed understanding that the OSE/ISC make no warranties, expressed or implied, concerning the accuracy, completeness, reliability, usability, or suitability for any particular purpose of the data.

4/29/13 12:40 PM

Page 1 of 1

WATER COLUMN/ AVERAGE
DEPTH TO WATER



New Mexico Office of the State Engineer Water Column/Average Depth to Water

(A CLW##### in the
POD suffix indicates the
POD has been replaced
& no longer serves a
water right file.)

(R=POD has
been replaced,
O=orphaned,
C=the file is

closed) (quarters are 1=NW 2=NE 3=SW 4=SE)

(quarters are smallest to largest) (NAD83 UTM in meters)

(In feet)

POD Number	POD Sub-Code	basin	County	Q 64	Q 16	Q 4	Sec	Tws	Rng	X	Y	Depth Well	Depth Water Column
RA 11590 POD1		ED		2	1	3	32	17S	31E	603315	3628545	158	
RA 11590 POD3		ED		3	1	2	32	17S	31E	603932	3629260	60	
RA 11590 POD4		ED		4	1	1	32	17S	31E	603308	3629253	55	

Average Depth to Water: --

Minimum Depth: --

Maximum Depth: --

Record Count: 3

PLSS Search:

Township: 17S

Range: 31E

The data is furnished by the NMOSE/ISC and is accepted by the recipient with the expressed understanding that the OSE/ISC make no warranties, expressed or implied, concerning the accuracy, completeness, reliability, usability, or suitability for any particular purpose of the data.



New Mexico Office of the State Engineer

Water Column/Average Depth to Water

(A CLW##### in the
POD suffix indicates the
POD has been replaced
& no longer serves a
water right file.)

(R=POD has
been replaced,
O=orphaned,
C=the file is

(quarters are 1=NW 2=NE 3=SW 4=SE)
(quarters are smallest to largest) (NAD83 UTM in meters)

(In feet)

POD Number	POD Sub-Code	basin	County	Q 64	Q 16	Q 4	Sec	Tws	Rng	X	Y	Depth Well	Depth Water	Water Column
<u>L 04019</u>	L	LE		4	3	4	02	17S	32E	618468	3636166*	182		
<u>L 04020</u>	L	LE		3	3	4	02	17S	32E	618268	3636166*	200		
<u>L 04021</u>	R	L	LE	3	4	4	02	17S	32E	618670	3636170*	190		
<u>L 04021 POD3</u>	L	LE		3	4	03	17S	32E	616761	3636252*		247		
<u>L 04021 S</u>	L	LE		2	4	4	03	17S	32E	617262	3636354*	260		
<u>L 13047 POD1</u>	L	LE					11	17S	32E	618187	3635254*	140		
<u>L 13050 POD1</u>	L	LE		2	2	1	10	17S	32E	616463	3635945*	156	132	24
<u>RA 08855</u>		LE		4	1	1	10	17S	32E	616061	3635742*	158		
<u>RA 09505</u>		LE		2	2	1	10	17S	32E	616462	3635944	147		
<u>RA 09505 S</u>		LE		2	2	1	10	17S	32E	616463	3635945*	144		
<u>RA 10175</u>		LE		2	1	28	17S	32E	614814	3631005*		158		
<u>RA 11684 POD1</u>		LE		1	1	4	11	17S	32E	618216	3635124	275		
<u>RA 11684 POD2</u>		LE		1	1	4	11	17S	32E	618313	3635248	275		
<u>RA 11684 POD3</u>		LE		3	3	1	11	17S	32E	618262	3635371	275		
<u>RA 11684 POD4</u>		LE		1	3	2	11	17S	32E	618334	3635521	275		
<u>RA 11684 POD5</u>		LE		3	1	4	11	17S	32E	618353	3635047	275		
<u>RA 11734 POD1</u>		LE		2	2	1	10	17S	32E	616556	3635929	165		

Average Depth to Water: **132 feet**

Minimum Depth: **132 feet**

Maximum Depth: **132 feet**

Record Count: 17

PLSS Search:

Township: 17S

Range: 32E

*UTM location was derived from PLSS - see Help

The data is furnished by the NMOSE/ISC and is accepted by the recipient with the expressed understanding that the OSE/ISC make no warranties, expressed or implied, concerning the accuracy, completeness, reliability, usability, or suitability for any particular purpose of the data.



New Mexico Office of the State Engineer

Water Column/Average Depth to Water

(A CLW##### in the
POD suffix indicates the
POD has been replaced
& no longer serves a
water right file.)



(R=POD has
been replaced,
O=orphaned,

C=the file is
closed)

(quarters are 1=NW 2=NE 3=SW 4=SE)

(quarters are smallest to largest) (NAD83 UTM in meters)

(In feet)

POD Number	POD		Q Q Q							X	Y	Depth Well	Depth Water	Water Column
	Sub-Code	basin	County	64	16	4	Sec	Tws	Rng					
<u>CP 00818</u>			LE	1	4	26	18S	30E	599289	3620364*		240		
<u>CP 00819</u>			LE	2	4	32	18S	30E	594878	3618720*		150		
L 01978	L	LE		1	3	23	18S	30E	598469	3621964*		65	44	21

Average Depth to Water: 44 feet

Minimum Depth: 44 feet

Maximum Depth: 44 feet

Record Count: 3

PLSS Search:

Township: 18S

Range: 30E

*UTM location was derived from PLSS - see Help

The data is furnished by the NMOSE/ISC and is accepted by the recipient with the expressed understanding that the OSE/ISC make no warranties, expressed or implied, concerning the accuracy, completeness, reliability, usability, or suitability for any particular purpose of the data.



New Mexico Office of the State Engineer Water Column/Average Depth to Water

(A CLW##### in the
POD suffix indicates the
POD has been replaced
& no longer serves a
water right file.)

(R=POD has
been replaced,
O=orphaned,

C=the file is (quarters are 1=NW 2=NE 3=SW 4=SE)

closed) (quarters are smallest to largest) (NAD83 UTM in meters) (In feet)

POD Number	POD Sub-	Code	basin	County	Q Q Q	64	16	4	Sec	Tws	Rng	X	Y	Depth Well	Depth Water	Water Column
L 11092	L	LE	2	3	15	18S	31E	606849	3623669*					160	98	62

Average Depth to Water: 98 feet

Minimum Depth: 98 feet

Maximum Depth: 98 feet

Record Count: 1

PLSS Search:

Township: 18S Range: 31E

*UTM location was derived from PLSS - see Help

The data is furnished by the NMOSE/ISC and is accepted by the recipient with the expressed understanding that the OSE/ISC make no warranties, expressed or implied, concerning the accuracy, completeness, reliability, usability, or suitability for any particular purpose of the data.



New Mexico Office of the State Engineer

Water Column/Average Depth to Water

(A CLW##### in the
POD suffix indicates the
POD has been replaced
& no longer serves a
water right file.)

(R=POD has
been replaced,
O=orphaned,
C=the file is

closed) (quarters are 1=NW 2=NE 3=SW 4=SE)

(quarters are smallest to largest) (NAD83 UTM in meters)

(In feet)

POD Number	POD Sub- Code	basin	County	Q Q Q			Sec	Tws	Rng	X	Y	Depth Well	Depth Water	Water Column
				64	16	4								
CP 00566			LE	4	4	1	04	18S	32E	614960	3627280*	133	65	68
CP 00672			LE	4	4	07	18S	32E	612475	3624947*	524	430	94	
CP 00672 CLW475398	O		LE	4	4	07	18S	32E	612475	3624947*	540	460	80	
CP 00677			LE	1	1	26	18S	32E	617750	3621373*	700			

Average Depth to Water: 318 feet

Minimum Depth: 65 feet

Maximum Depth: 460 feet

Record Count: 4

PLSS Search:

Township: 18S

Range: 32E

*UTM location was derived from PLSS - see Help

The data is furnished by the NMOSE/ISC and is accepted by the recipient with the expressed understanding that the OSE/ISC make no warranties, expressed or implied, concerning the accuracy, completeness, reliability, usability, or suitability for any particular purpose of the data.

Appendix IV

SEED REPORT

Diversified Field Service, Inc.
3412 N. Dal Paso
Hobbs, NM 88240
(575) 964-8394

DIVERSIFIED FIELD SERVICES, INC.

Project: Turner B 11 Project No.: _____ Date Started: 1-6-2014

Seed and lbs used: 25 # Date Completed: 1-6-2014

Bamert Seed Company Inc.

1897 CR 10th Puleshoe, TX 79347

(800) 262-9892

Permit # TX00905

L1 Sand Shinnery W/RW & SB 400 #

INV51920

Description	Pure Seed	Germ	Dormant	Origin
Bluestem Big, "Raw" (Caryopsis) (Andropogon gerardii)	20.37%	80.00%	0.00%	TX
Bluestem Little, "Cimarron" (Schizachyrium scoparium)	8.78%	89.00%	3.00%	TX
Bristlegrass, Plains, "VNS" (Setaria vulpiseta)	4.84%	28.00%	62.00%	TX
Dropseed, Sand, "VNS" (Sporobolus cryptandrus)	3.22%	8.00%	77.00%	CO
Fourwing saltbush, "VNS" (Atriplex canescens)	20.59%	18.00%	34.00%	NM
PLAINS COREOPSIS (Coreopsis tinctoria)	0.00%	89.00%	0.00%	
PLAINS COREOPSIS (Coreopsis tinctoria)	4.98%	89.00%	0.00%	
Ragweed, "Western" (Ambrosia L.)	7.00%	85.00%	0.00%	AL
Switchgrass "Blackwell" (Panicum virgatum)	13.69%	84.00%	0.00%	TX
Purity: 93.46%	Inert Matter: 5.81%	Other Crop Seed: 0.57%	Weed Seed: 0.16%	

Noxious Weeds: None

Test Date: 05/2013

Net Wt: 25.00 lbs

Supervisor: _____

Stephen Masher

Appendix V

LABORATORY ANALYSIS

Diversified Field Service, Inc.
3412 N. Dal Paso
Hobbs, NM 88240
(575) 964-8394

November 06, 2013

BRIAN WALL

LINN OPERATING-HOBBS

2130 W. BENDER

HOBBS, NM 88240

RE: TURNER B #11

Enclosed are the results of analyses for samples received by the laboratory on 10/31/13 13:50.

Cardinal Laboratories is accredited through Texas NELAP under certificate number T104704398-11-3. Accreditation applies to drinking water, non-potable water and solid and chemical materials. All accredited analytes are denoted by an asterisk (*). For a complete list of accredited analytes and matrices visit the TCEQ website at www.tceq.texas.gov/field/qa/lab_accred_certif.html.

Cardinal Laboratories is accredited through the State of Colorado Department of Public Health and Environment for:

Method EPA 552.2	Haloacetic Acids (HAA-5)
Method EPA 524.2	Total Trihalomethanes (TTHM)
Method EPA 524.4	Regulated VOCs (V1, V2, V3)

Accreditation applies to public drinking water matrices.

This report meets NELAP requirements and is made up of a cover page, analytical results, and a copy of the original chain-of-custody. If you have any questions concerning this report, please feel free to contact me.

Sincerely,



Celey D. Keene

Lab Director/Quality Manager

Analytical Results For:

LINN OPERATING-HOBBS
 BRIAN WALL
 2130 W. BENDER
 HOBBS NM, 88240
 Fax To: (575) 738-1740

Received: 10/31/2013
 Reported: 11/06/2013
 Project Name: TURNER B #11
 Project Number: NONE GIVEN
 Project Location: EDDY COUNTY, NM

Sampling Date: 10/31/2013
 Sampling Type: Soil
 Sampling Condition: ** (See Notes)
 Sample Received By: Jodi Henson

Sample ID: SP 1 SURFACE (H302655-01)

BTX 8021B			mg/kg		Analyzed By: MS				
Analyte	Result	Reporting Limit	Analyzed	Method Blank	BS	% Recovery	True Value QC	RPD	Qualifier
Benzene*	<0.050	0.050	11/05/2013	ND	1.90	94.9	2.00	2.12	
Toluene*	<0.050	0.050	11/05/2013	ND	1.89	94.7	2.00	2.22	
Ethylbenzene*	<0.050	0.050	11/05/2013	ND	1.90	95.2	2.00	2.41	
Total Xylenes*	<0.150	0.150	11/05/2013	ND	5.57	92.9	6.00	2.39	
Total BTX	<0.300	0.300	11/05/2013	ND					

Surrogate: 4-Bromofluorobenzene (PIE) 106 % 89.4-126

Chloride, SM4500Cl-B			mg/kg		Analyzed By: AP				
Analyte	Result	Reporting Limit	Analyzed	Method Blank	BS	% Recovery	True Value QC	RPD	Qualifier
Chloride	6000	16.0	11/01/2013	ND	400	100	400	0.00	

TPH 8015M			mg/kg		Analyzed By: MS				
Analyte	Result	Reporting Limit	Analyzed	Method Blank	BS	% Recovery	True Value QC	RPD	Qualifier
GRO C6-C10	<10.0	10.0	11/01/2013	ND	175	87.6	200	8.35	
DRO >C10-C28	31.7	10.0	11/01/2013	ND	165	82.6	200	10.0	

Surrogate: 1-Chlorooctane 82.6 % 65.2-140

Surrogate: 1-Chlorooctadecane 88.6 % 63.6-154

Cardinal Laboratories

*=Accredited Analyte

PLEASE NOTE: Liability and Damages. Cardinal's liability and client's exclusive remedy for any claim arising, whether based in contract or tort, shall be limited to the amount paid by client for analyses. All claims, including those for negligence and any other cause whatsoever shall be deemed waived unless made in writing and received by Cardinal within thirty (30) days after completion of the applicable service. In no event shall Cardinal be liable for incidental or consequential damages, including, without limitation, business interruptions, loss of use, or loss of profits incurred by client, its subsidiaries, affiliates or successors arising out of or related to the performance of the services hereunder by Cardinal, regardless of whether such claim is based upon any of the above stated reasons or otherwise. Results relate only to the samples identified above. This report shall not be reproduced except in full with written approval of Cardinal Laboratories.

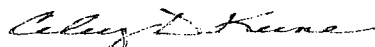

Celey D. Keene, Lab Director/Quality Manager

Analytical Results For:

LINN OPERATING-HOBBS
 BRIAN WALL
 2130 W. BENDER
 HOBBS NM, 88240
 Fax To: (575) 738-1740

Received: 10/31/2013
 Reported: 11/06/2013
 Project Name: TURNER B #11
 Project Number: NONE GIVEN
 Project Location: EDDY COUNTY, NM

Sampling Date: 10/31/2013
 Sampling Type: Soil
 Sampling Condition: ** (See Notes)
 Sample Received By: Jodi Henson

Sample ID: SP 2 SURFACE (H302655-02)

BTX 8021B			mg/kg		Analyzed By: MS				
Analyte	Result	Reporting Limit	Analyzed	Method Blank	BS	% Recovery	True Value QC	RPD	Qualifier
Benzene*	<0.050	0.050	11/05/2013	ND	1.90	94.9	2.00	2.12	
Toluene*	<0.050	0.050	11/05/2013	ND	1.89	94.7	2.00	2.22	
Ethylbenzene*	<0.050	0.050	11/05/2013	ND	1.90	95.2	2.00	2.41	
Total Xylenes*	<0.150	0.150	11/05/2013	ND	5.57	92.9	6.00	2.39	
Total BTX	<0.300	0.300	11/05/2013	ND					

Surrogate: 4-Bromofluorobenzene (PIL) 106 % 89.4-126

Chloride, SM4500CI-B			mg/kg		Analyzed By: AP				
Analyte	Result	Reporting Limit	Analyzed	Method Blank	BS	% Recovery	True Value QC	RPD	Qualifier
Chloride	864	16.0	11/01/2013	ND	400	100	400	0.00	

TPH 8015M			mg/kg		Analyzed By: MS					S-06
Analyte	Result	Reporting Limit	Analyzed	Method Blank	BS	% Recovery	True Value QC	RPD	Qualifier	
GRO C6-C10	<50.0	50.0	11/01/2013	ND	175	87.6	200	8.35		
DRO >C10-C28	5510	50.0	11/01/2013	ND	165	82.6	200	10.0		

Surrogate: 1-Chlorooctane 81.5 % 65.2-140

Surrogate: 1-Chlorooctadecane 244 % 63.6-154

Cardinal Laboratories

*=Accredited Analyte

PLEASE NOTE: Liability and Damages. Cardinal's liability and client's exclusive remedy for any claim arising, whether based in contract or tort, shall be limited to the amount paid by client for analyses. All claims, including those for negligence and any other cause whatsoever shall be deemed waived unless made in writing and received by Cardinal within thirty (30) days after completion of the applicable service. In no event shall Cardinal be liable for incidental or consequential damages, including, without limitation, business interruptions, loss of use, or loss of profits incurred by client, its subsidiaries, affiliates or successors arising out of or related to the performance of the services hereunder by Cardinal, regardless of whether such claim is based upon any of the above stated reasons or otherwise. Results relate only to the samples identified above. This report shall not be reproduced except in full with written approval of Cardinal Laboratories.

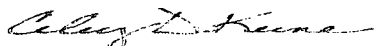

Celey D. Keene, Lab Director/Quality Manager

Notes and Definitions

S-06	The recovery of this surrogate is outside control limits due to sample dilution required from high analyte concentration and/or matrix interference's.
ND	Analyte NOT DETECTED at or above the reporting limit
RPD	Relative Percent Difference
**	Samples not received at proper temperature of 6°C or below.
***	Insufficient time to reach temperature.
-	Chloride by SM4500Cl-B does not require samples be received at or below 6°C Samples reported on an as received basis (wet) unless otherwise noted on report

Cardinal Laboratories

*=Accredited Analyte

PLEASE NOTE: Liability and Damages. Cardinal's liability and client's exclusive remedy for any claim arising, whether based in contract or tort, shall be limited to the amount paid by client for analyses. All claims, including those for negligence and any other cause whatsoever shall be deemed waived unless made in writing and received by Cardinal within thirty (30) days after completion of the applicable service. In no event shall Cardinal be liable for incidental or consequential damages, including, without limitation, business interruptions, loss of use, or loss of profits incurred by client, its subsidiaries, affiliates or successors arising out of or related to the performance of the services hereunder by Cardinal, regardless of whether such claim is based upon any of the above stated reasons or otherwise. Results relate only to the samples identified above. This report shall not be reproduced except in full with written approval of Cardinal Laboratories.

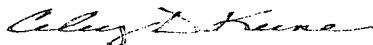

Celey D. Keene, Lab Director/Quality Manager



Page 5 of 5

Company Name: Wan Energy				BILL TO				ANALYSIS REQUEST																			
Project Manager: Brita Wall				P.O. #:																							
Address:				Company:																							
City:		State:		Zip:		Attn:																					
Phone #:		Fax #:		Address:																							
Project #:		Project Owner:		City:																							
Project Name: Turner B #11				State: Zip:																							
Project Location: Eddie County				Phone #:																							
Sampler Name: Leah Cantor				Fax #:																							
FOR LAB USE ONLY																											
Lab I.D. H302655		Sample I.D.		GIRAB OR (C)OMP.	# CONTAINERS	MATRIX					PRESERV.		SAMPLING		<div style="display: flex; justify-content: space-around; align-items: center;"> <div style="text-align: center;"> Chloride <input checked="" type="checkbox"/> </div> <div style="text-align: center;"> pH <input checked="" type="checkbox"/> </div> <div style="text-align: center;"> BTEX <input checked="" type="checkbox"/> </div> </div>												
						GROUNDWATER	WASTEWATER	SOIL	OIL	SLUDGE	OTHER:	ACID/BASE	ICE / COOL	OTHER:													DATE
1		SP1 Surface		G	1			✓				✓		10/21													
2		SP2 Surface		G	1			✓				✓		10/31													
<small>PLEASE NOTE: Liability and Damages. Cardinal's liability and client's exclusive remedy for any claim arising whether based in contract or tort, shall be limited to the amount paid by the client for the analysis. All claims including those for negligence and any other cause whatsoever shall be deemed waived unless made in writing and received by Cardinal within 90 days after completion of the applicable service. In no event shall Cardinal be liable for incidental or consequential damages, including without limitation, business interruptions, loss of use, or loss of profits incurred by client, its subsidiaries, affiliates or successors arising out of or related to the performance of services hereunder by Cardinal, regardless of whether such claim is based upon any of the above stated reasons or otherwise.</small>																											
Relinquished By: Leah Cantor				Date: 10/21/13 Time: 1:50		Received By: Jodi Henson				Date: _____		Time: _____		Phone Result: <input type="checkbox"/> Yes <input type="checkbox"/> No Add'l Phone #: _____ Fax Result: <input type="checkbox"/> Yes <input type="checkbox"/> No Add'l Fax #: _____ REMARKS:													
Delivered By: (Circle One) Sampler - UPS - Bus - Other:				Sample Condition Cool Intact <input type="checkbox"/> Yes <input checked="" type="checkbox"/> No <input type="checkbox"/> Yes <input checked="" type="checkbox"/> No				CHECKED BY: (Initials) [Signature]																			

† Cardinal cannot accept verbal changes. Please fax written changes to (575) 393-2826

#54

November 11, 2013

BRIAN WALL

LINN ENERGY

RR1, BOX 24 B

KINGFISHER, OK 73750

RE: TURNER B #11

Enclosed are the results of analyses for samples received by the laboratory on 11/06/13 16:20.

Cardinal Laboratories is accredited through Texas NELAP under certificate number T104704398-11-3. Accreditation applies to drinking water, non-potable water and solid and chemical materials. All accredited analytes are denoted by an asterisk (*). For a complete list of accredited analytes and matrices visit the TCEQ website at www.tceq.texas.gov/field/qa/lab_accred_certif.html.

Cardinal Laboratories is accredited through the State of Colorado Department of Public Health and Environment for:

Method EPA 552.2	Haloacetic Acids (HAA-5)
Method EPA 524.2	Total Trihalomethanes (TTHM)
Method EPA 524.4	Regulated VOCs (V1, V2, V3)

Accreditation applies to public drinking water matrices.

This report meets NELAP requirements and is made up of a cover page, analytical results, and a copy of the original chain-of-custody. If you have any questions concerning this report, please feel free to contact me.

Sincerely,

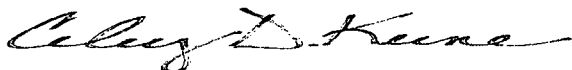

Celey D. Keene

Lab Director/Quality Manager

Analytical Results For:

LINN ENERGY
 BRIAN WALL
 RR1, BOX 24 B
 KINGFISHER OK, 73750
 Fax To: (405) 375-6693

Received: 11/06/2013
 Reported: 11/11/2013
 Project Name: TURNER B # 11
 Project Number: NONE GIVEN
 Project Location: NOT GIVEN

Sampling Date: 11/06/2013
 Sampling Type: Soil
 Sampling Condition: Cool & Intact
 Sample Received By: Jodi Henson

Sample ID: SP 1 @ 2' (H302716-01)

BTX 8021B		mg/kg		Analyzed By: MS					
Analyte	Result	Reporting Limit	Analyzed	Method Blank	BS	% Recovery	True Value QC	RPD	Qualifier
Benzene*	<0.050	0.050	11/10/2013	ND	1.96	97.9	2.00	2.18	
Toluene*	<0.050	0.050	11/10/2013	ND	1.97	98.6	2.00	2.94	
Ethylbenzene*	<0.050	0.050	11/10/2013	ND	1.99	99.7	2.00	3.11	
Total Xylenes*	<0.150	0.150	11/10/2013	ND	5.89	98.2	6.00	3.70	
Total BTX	<0.300	0.300	11/10/2013	ND					

Surrogate: 4-Bromofluorobenzene (PIE) 110 % 89.4-126

Chloride, SM4500Cl-B		mg/kg		Analyzed By: AP					
Analyte	Result	Reporting Limit	Analyzed	Method Blank	BS	% Recovery	True Value QC	RPD	Qualifier
Chloride	384	16.0	11/08/2013	ND	416	104	400	0.00	

TPH 8015M		mg/kg		Analyzed By: MS					
Analyte	Result	Reporting Limit	Analyzed	Method Blank	BS	% Recovery	True Value QC	RPD	Qualifier
GRO C6-C10	<10.0	10.0	11/08/2013	ND	192	96.2	200	0.759	
DRO >C10-C28	27.9	10.0	11/08/2013	ND	195	97.6	200	1.32	

Surrogate: 1-Chlorooctane 88.6 % 65.2-140

Surrogate: 1-Chlorooctadecane 96.3 % 63.6-154

Cardinal Laboratories

*=Accredited Analyte

PLEASE NOTE: Liability and Damages. Cardinal's liability and client's exclusive remedy for any claim arising, whether based in contract or tort, shall be limited to the amount paid by client for analyses. All claims, including those for negligence and any other cause whatsoever shall be deemed waived unless made in writing and received by Cardinal within thirty (30) days after completion of the applicable service. In no event shall Cardinal be liable for incidental or consequential damages, including, without limitation, business interruptions, loss of use, or loss of profits incurred by client, its subsidiaries, affiliates or successors arising out of or related to the performance of the services hereunder by Cardinal, regardless of whether such claim is based upon any of the above stated reasons or otherwise. Results relate only to the samples identified above. This report shall not be reproduced except in full with written approval of Cardinal Laboratories.

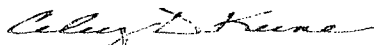

Celey D. Keene, Lab Director/Quality Manager

Analytical Results For:

LINN ENERGY
 BRIAN WALL
 RR1, BOX 24 B
 KINGFISHER OK, 73750
 Fax To: (405) 375-6693

Received:	11/06/2013	Sampling Date:	11/06/2013
Reported:	11/11/2013	Sampling Type:	Soil
Project Name:	TURNER B #11	Sampling Condition:	Cool & Intact
Project Number:	NONE GIVEN	Sample Received By:	Jodi Henson
Project Location:	NOT GIVEN		

Sample ID: SP 2 @ 2' (H302716-02)

BTX 8021B		mg/kg		Analyzed By: MS						
Analyte	Result	Reporting Limit	Analyzed	Method Blank	BS	% Recovery	True Value QC	RPD	Qualifier	
Benzene*	<0.050	0.050	11/10/2013	ND	1.96	97.9	2.00	2.18		
Toluene*	<0.050	0.050	11/10/2013	ND	1.97	98.6	2.00	2.94		
Ethylbenzene*	<0.050	0.050	11/10/2013	ND	1.99	99.7	2.00	3.11		
Total Xylenes*	<0.150	0.150	11/10/2013	ND	5.89	98.2	6.00	3.70		
Total BTX	<0.300	0.300	11/10/2013	ND						

Surrogate: 4-Bromofluorobenzene (PIE) 110 % 89.4-126

Chloride, SM4500Cl-B		mg/kg		Analyzed By: AP						
Analyte	Result	Reporting Limit	Analyzed	Method Blank	BS	% Recovery	True Value QC	RPD	Qualifier	
Chloride	384	16.0	11/08/2013	ND	416	104	400	0.00		

TPH 8015M		mg/kg		Analyzed By: MS						
Analyte	Result	Reporting Limit	Analyzed	Method Blank	BS	% Recovery	True Value QC	RPD	Qualifier	
GRO C6-C10	<10.0	10.0	11/08/2013	ND	192	96.2	200	0.759		
DRO >C10-C28	103	10.0	11/08/2013	ND	195	97.6	200	1.32		

Surrogate: 1-Chlorooctane 106 % 65.2-140

Surrogate: 1-Chlorooctadecane 120 % 63.6-154

Cardinal Laboratories

*=Accredited Analyte

PLEASE NOTE: Liability and Damages. Cardinal's liability and client's exclusive remedy for any claim arising, whether based in contract or tort, shall be limited to the amount paid by client for analyses. All claims, including those for negligence and any other cause whatsoever shall be deemed waived unless made in writing and received by Cardinal within thirty (30) days after completion of the applicable service. In no event shall Cardinal be liable for incidental or consequential damages, including, without limitation, business interruptions, loss of use, or loss of profits incurred by client, its subsidiaries, affiliates or successors arising out of or related to the performance of the services hereunder by Cardinal, regardless of whether such claim is based upon any of the above stated reasons or otherwise. Results relate only to the samples identified above. This report shall not be reproduced except in full with written approval of Cardinal Laboratories.

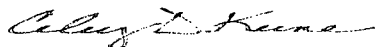

Celey D. Keene, Lab Director/Quality Manager

Notes and Definitions

ND	Analyte NOT DETECTED at or above the reporting limit
RPD	Relative Percent Difference
**	Samples not received at proper temperature of 6°C or below.
***	Insufficient time to reach temperature.
-	Chloride by SM4500Cl-B does not require samples be received at or below 6°C Samples reported on an as received basis (wet) unless otherwise noted on report

Cardinal Laboratories

*=Accredited Analyte

PLEASE NOTE: Liability and Damages. Cardinal's liability and client's exclusive remedy for any claim arising, whether based in contract or tort, shall be limited to the amount paid by client for analyses. All claims, including those for negligence and any other cause whatsoever shall be deemed waived unless made in writing and received by Cardinal within thirty (30) days after completion of the applicable service. In no event shall Cardinal be liable for incidental or consequential damages, including, without limitation, business interruptions, loss of use, or loss of profits incurred by client, its subsidiaries, affiliates or successors arising out of or related to the performance of the services hereunder by Cardinal, regardless of whether such claim is based upon any of the above stated reasons or otherwise. Results relate only to the samples identified above. This report shall not be reproduced except in full with written approval of Cardinal Laboratories.

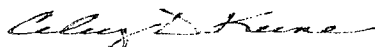

Celey D. Keene, Lab Director/Quality Manager



CARDINAL Laboratories

CHAIN-OF-CUSTODY AND ANALYSIS REQUEST

101 East Marland, Hobbs, NM 88240

(575) 393-2326 FAX (575) 393-2476

[illegible]

PLEASE NOTE: Liability and Damages. Cardinal's liability and client's exclusive remedy for any claim arising whether based in contract or tort, shall be limited to the amount paid by the client for the analyses. All claims including those for negligence and any other cause whatsoever shall be deemed waived unless made in writing and received by Cardinal within 30 days after completion of the applicable service. In no event shall Cardinal be liable for incidental or consequential damages, including without limitation, business interruptions, loss of use, or loss of profits incurred by client, its subsidiaries, affiliates or successors arising out of or related to the performance of services hereunder by Cardinal, regardless of whether such claim is based upon any of the above stated reasons or otherwise.

Relinquished By: Miguel Gomez		Date: 11/6/13	Received By: Jodi Alenson	Phone Result: <input type="checkbox"/> Yes <input type="checkbox"/> No	Add'l Phone #:
Time: 4:20				Fax Result: <input type="checkbox"/> Yes <input type="checkbox"/> No	Add'l Fax #:
Relinquished By:		Date:	Received By:	REMARKS:	
Time:				Bwalia@LinEnergy.com	
Delivered By: (Circle One)		Sample Condition		CHECKED BY:	
Sampler - UPS - Bus - Other:		Cool Intact		(Initials)	
5.8°C		<input checked="" type="checkbox"/> Yes <input type="checkbox"/> No <input checked="" type="checkbox"/> Yes <input type="checkbox"/> No		ARuth@diversifiedSI.com	

† Cardinal cannot accept verbal changes. Please fax written changes to (575) 393-2326



CHAIN-OF-CUSTODY AND ANALYSIS REQUEST

101 East Marland, Hobbs, NM 88240

(575) 393-2326 FAX (575) 393-2476

[illegible]

PLEASE NOTE: Liability and Damages. Cardinal's liability and client's exclusive remedy for any claim arising whether based in contract or tort, shall be limited to the amount paid by the client for the analyses. All claims, including those for negligence and any other cause whatsoever shall be deemed waived unless made in writing and received by Cardinal within 30 days after completion of the applicable service. In no event shall Cardinal be liable for incidental or consequential damages, including without limitation, business interruptions, loss of use, or loss of profits incurred by client, its subsidiaries, affiliates or successors arising out of or related to the performance of services hereunder by Cardinal, regardless of whether such claim is based upon any of the above stated reasons or otherwise.

Relinquished By:		Date:	Received By:	Phone Result:	<input type="checkbox"/> Yes <input type="checkbox"/> No	Add'l Phone #:
Luis Gonzalez		10/21/13	Jodi Henson	Fax Result:	<input type="checkbox"/> Yes <input type="checkbox"/> No	Add'l Fax #:
Relinquished By:		Date:	Received By:	REMARKS:		
		Time:				
		Time:				
Delivered By: (Circle One)		Sample Condition	CHECKED BY:			
Sampler - UPS - Bus - Other:		Cool Intact	(Initials)			
9.8°C		<input type="checkbox"/> Yes <input type="checkbox"/> Yes				
		<input type="checkbox"/> No <input type="checkbox"/> No				

† Cardinal cannot accept verbal changes. Please fax written changes to (575) 393-2826

4-51



CHAIN-OF-CUSTODY AND ANALYSIS REQUEST

Page 5 of 5

PLEASE NOTE: Liability and Damages. Cardinal's liability and client's exclusive remedy for any claim arising whether based in contract or tort, shall be limited to the amount paid by the client for the analyses. All claims, including those for negligence and any other cause whatsoever shall be deemed waived unless made in writing and received by Cardinal within 30 days after completion of the applicable service. In no event shall Cardinal be liable for incidental or consequential damages, including without limitation, business interruptions, loss of use, or loss of profits incurred by client, its subsidiaries, affiliates or successors arising out of or related to the performance of services hereunder by Cardinal, regardless of whether such claim is based upon any of the above stated reasons or otherwise.

† Cardinal cannot accept verbal changes. Please fax written changes to (575) 393-2326

Appendix VI

FINAL FORM C-141

Diversified Field Service, Inc.
3412 N. Dal Paso
Hobbs, NM 88240
(575) 964-8394

District I
1625 N. French Dr., Hobbs, NM 88240
District II
811 S. First St., Artesia, NM 88210
District III
1000 Rio Brazos Road, Aztec, NM 87410
District IV
1220 S. St. Francis Dr., Santa Fe, NM 87505

State of New Mexico
Energy Minerals and Natural Resources

Oil Conservation Division
1220 South St. Francis Dr.
Santa Fe, NM 87505

Form C-141
Revised August 8, 2011

Submit 1 Copy to appropriate District Office in
accordance with 19.15.29 NMAC.

Release Notification and Corrective Action

OPERATOR

☐ Initial Report ☒ Final Report

Name of Company Linn Operating, Inc.	Contact: Brian Wall
Address: 2130 W Bender Blvd.- Hobbs, NM 88240	Telephone No. 575-738-1739
Facility Name: Turner B North #11 injection line	Facility Type: Produced Water Injection System

Surface Owner BLM	Mineral Owner BLM	API No. LC-029395-B
-------------------	-------------------	---------------------

LOCATION OF RELEASE

Unit Letter	Section 20	Township 17S	Range 31E	Feet from the 1980	North/South Line N	Feet from the 600	East/West Line East	County Eddy
-------------	---------------	-----------------	--------------	-----------------------	-----------------------	----------------------	------------------------	-------------

Latitude 32.821955 Longitude -103.885953

NATURE OF RELEASE

Type of Release: Produced Water	Volume of Release 5 bbls	Volume Recovered 0
Source of Release Line Leak	Date and Hour of Occurrence 09/23/11 - 3:00 P.M.	Date and Hour of Discovery 09/23/11 3:30 P.M.
Was Immediate Notice Given? <input checked="" type="checkbox"/> Yes <input type="checkbox"/> No <input type="checkbox"/> Not Required	If YES, To Whom? T. Gregston BLM and Mike Bratcher NMOCD	
By Whom?	Date and Hour 09-06-11 9:00 A.M.	
Was a Watercourse Reached? <input type="checkbox"/> Yes <input checked="" type="checkbox"/> No	If YES, Volume Impacting the Watercourse.	

If a Watercourse was Impacted, Describe Fully.*
NA

Describe Cause of Problem and Remedial Action Taken.*
Thread Joint worn out and casing burned line to leak. The system was shut in and the line repaired.

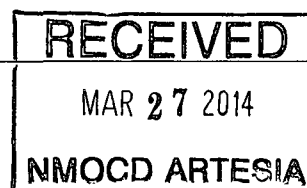

Describe Area Affected and Cleanup Action Taken.*
The affected area was approximately a 20 square foot area with an estimated 3-4 ft. vertical. DFSI was retained for the remediation of this leak site. All Impacted soils were removed to an NMOCD approved facility. Pasture area was restored to its natural state according to BLM guidelines.

I hereby certify that the information given above is true and complete to the best of my knowledge and understand that pursuant to NMOCD rules and regulations all operators are required to report and/or file certain release notifications and perform corrective actions for releases which may endanger public health or the environment. The acceptance of a C-141 report by the NMOCD marked as "Final Report" does not relieve the operator of liability should their operations have failed to adequately investigate and remediate contamination that pose a threat to ground water, surface water, human health or the environment. In addition, NMOCD acceptance of a C-141 report does not relieve the operator of responsibility for compliance with any other federal, state, or local laws and/or regulations.

Signature:		OIL CONSERVATION DIVISION	
Printed Name: Brian Wall		Approved by Environmental Specialist:	
Title: Construction Foreman II		Approval Date:	Expiration Date:
E-mail Address: bwall@linenergy.com		Conditions of Approval:	
Date:	Phone:	Attached <input type="checkbox"/>	

Attach Additional Sheets If Necessary

District I
1625 N. French Dr., Hobbs, NM 88240
District II
811 S. First St., Artesia, NM 88210
District III
1000 Rio Brazos Road, Aztec, NM 87410
District IV
1220 S. St. Francis Dr., Santa Fe, NM 87505

State of New Mexico
Energy Minerals and Natural Resources
Oil Conservation Division
1220 South St. Francis Dr.
Santa Fe, NM 87505

Form C-141
Revised August 8, 2011

Submit 1 Copy to appropriate District Office in
accordance with 19.15.29 NMAC.

Release Notification and Corrective Action

OPERATOR

☐ Initial Report ☒ Final Report

Name of Company	Linn Operating, Inc.	Contact:	Brian Wall
Address:	2130 W Bender Blvd.- Hobbs, NM 88240	Telephone No.	575-738-1739
Facility Name:	Turner B North #11 injection line	Facility Type:	Produced Water Injection System
Surface Owner	BLM	Mineral Owner	BLM
		API No.	LC-029395-B

LOCATION OF RELEASE

Unit Letter	Section	Township	Range	Feet from the	North/South Line	Feet from the	East/West Line	County Eddy
	20	17S	31E	1980	N	600	East	

Latitude 32.821955 Longitude -103.885953

NATURE OF RELEASE

Type of Release: Produced Water	Volume of Release 5 bbls	Volume Recovered 0
Source of Release Line Leak	Date and Hour of Occurrence 09/23/11 - 3:00 P.M.	Date and Hour of Discovery 09/23/11 3:30 P.M.
Was Immediate Notice Given? <input checked="" type="checkbox"/> Yes <input type="checkbox"/> No <input type="checkbox"/> Not Required	If YES, To Whom? T. Gregston BLM and Mike Bratcher NMOCD	
By Whom?	Date and Hour 09-06-11 9:00 A.M.	
Was a Watercourse Reached? <input type="checkbox"/> Yes <input checked="" type="checkbox"/> No	If YES, Volume Impacting the Watercourse.	
If a Watercourse was Impacted, Describe Fully.* NA		
Describe Cause of Problem and Remedial Action Taken.* Thread Joint worn out and casing burned line to leak. The system was shut in and the line repaired.		
Describe Area Affected and Cleanup Action Taken.* The affected area was approximately a 20 square foot area with an estimated 3-4 ft. vertical. DFSI was retained for the remediation of this leak site. All Impacted soils were removed to an NMOCD approved facility. Pasture area was restored to its natural state according to BLM guidelines.		
I hereby certify that the information given above is true and complete to the best of my knowledge and understand that pursuant to NMOCD rules and regulations all operators are required to report and/or file certain release notifications and perform corrective actions for releases which may endanger public health or the environment. The acceptance of a C-141 report by the NMOCD marked as "Final Report" does not relieve the operator of liability should their operations have failed to adequately investigate and remediate contamination that pose a threat to ground water, surface water, human health or the environment. In addition, NMOCD acceptance of a C-141 report does not relieve the operator of responsibility for compliance with any other federal, state, or local laws and/or regulations.		
Signature: 	OIL CONSERVATION DIVISION	
Printed Name: Brian Wall	Approved by Environmental Specialist:	
Title: Construction Foreman II	Approval Date:	Expiration Date:
E-mail Address: bwall@linenergy.com	Conditions of Approval:	Attached <input type="checkbox"/>
Date:	Phone:	

* Attach Additional Sheets If Necessary