

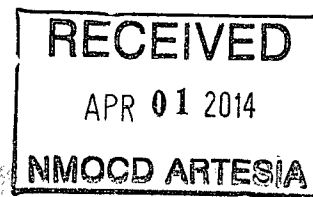

Amanda Trujillo
Senior Environmental Coordinator

March 26, 2014

Oil Conservation Division
District 2 – Artesia
811 S. First St.
Artesia, NM 88210



Mr. Bratcher,

On January 15, 2014 a release occurred at the Nervous Horz State Com. #4H (30-015-37146). Initially 7 bbls of oil was released due to a worn backpressure valve. The release resulted in a spray across location and in the pasture. Repairs were made to the equipment and the impacted area was addressed per OCD Guidelines Leaks, Spills and Releases (1993).

Sampling analysis indicates all RRALs, outlined in the previously mentioned guidelines, recommended for a site ranking of ten have been met. At this time COG Operating LLC is requesting closure.

Sincerely,

Amanda Trujillo

Enclosed

- (1) C-141 Final
- (2) C-141 Initial
- (3) Site Diagram
- (4) Area Map
- (5) Laboratory Analysis

District I
1625 N. French Dr., Hobbs, NM 88240
District II
1301 W. Grand Avenue, Artesia, NM 88210
District III
1000 Rio Brazos Road, Aztec, NM 87410
District IV
1220 S. St. Francis Dr., Santa Fe, NM 87505

State of New Mexico
Energy Minerals and Natural Resources

Oil Conservation Division
1220 South St. Francis Dr.
Santa Fe, NM 87505

Form C-141
Revised October 10, 2003

Submit 2 Copies to appropriate
District Office in accordance
with Rule 116 on back
side of form

Release Notification and Corrective Action

OPERATOR

☐ Initial Report ☒ Final Report

Name of Company	COG OPERATING LLC	Contact	Robert McNeill
Address	600 West Illinois Avenue, Midland, TX 79701	Telephone No.	432-230-0077
Facility Name	Nervous Horz Com #004H	Facility Type	Well Pad

Surface Owner	State	Mineral Owner	Lease No. (API#) 30-015-37146
---------------	-------	---------------	-------------------------------

LOCATION OF RELEASE

Unit Letter	Section	Township	Range	Feet from the	North/South Line	Feet from the	East/West Line	County
D	36	18S	31E					Eddy

Latitude 32.71041

Longitude 103.83032

NATURE OF RELEASE

Type of Release	Oil	Volume of Release	7bbls	Volume Recovered	2bbls
Source of Release	Tee on well head	Date and Hour of Occurrence	01-15-2014	Date and Hour of Discovery	01-15-2014 12:00pm
Was Immediate Notice Given?	<input type="checkbox"/> Yes <input checked="" type="checkbox"/> No <input checked="" type="checkbox"/> Not Required	If YES, To Whom?			
By Whom?		Date and Hour			
Was a Watercourse Reached?	<input type="checkbox"/> Yes <input checked="" type="checkbox"/> No	If YES, Volume Impacting the Watercourse.			

If a Watercourse was Impacted, Describe Fully.*

Describe Cause of Problem and Remedial Action Taken.*

The tee coming off the backpressure valve was worn out and a hole was developed. The tee has been replaced.

Describe Area Affected and Cleanup Action Taken.*

Initially 7bbls of oil were released. We were able to recover 2bbls of oil with a vacuum truck. All free fluids have been recovered and the remaining impact consisted of a spray to the pad and pasture. The area was scraped and treated with microblaze. COG had the spill site sampled to delineate any possible contamination from the release, sampling analysis is attached.

I hereby certify that the information given above is true and complete to the best of my knowledge and understand that pursuant to NMOCD rules and regulations all operators are required to report and/or file certain release notifications and perform corrective actions for releases which may endanger public health or the environment. The acceptance of a C-141 report by the NMOCD marked as "Final Report" does not relieve the operator of liability should their operations have failed to adequately investigate and remediate contamination that pose a threat to ground water, surface water, human health or the environment. In addition, NMOCD acceptance of a C-141 report does not relieve the operator of responsibility for compliance with any other federal, state, or local laws and/or regulations.

Signature: <i>A Trujillo</i>		OIL CONSERVATION DIVISION	
Printed Name: Amanda Trujillo		Approved by District Supervisor:	
Title: Senior Environmental Coordinator		Approval Date:	Expiration Date:
E-mail Address: atrujillo@concho.com		Conditions of Approval:	
Date: 3-26-2014 Phone: 575-748-6940		Attached <input type="checkbox"/>	

* Attach Additional Sheets If Necessary

District I
1625 N. French Dr., Hobbs, NM 88240
District II
1301 W. Grand Avenue, Artesia, NM 88210
District III
200 Rio Brazos Road, Aztec, NM 87410
District IV
20 S. St. Francis Dr., Santa Fe, NM 87505

State of New Mexico
Energy Minerals and Natural Resources

Oil Conservation Division
1220 South St. Francis Dr.
Santa Fe, NM 87505

Form C-141
Revised October 10, 2003

Submit 2 Copies to appropriate
District Office in accordance
with Rule 1.16 on back
side of form

Release Notification and Corrective Action

OPERATOR

☒ Initial Report ☐ Final Report

Name of Company	COG OPERATING LLC	Contact	Robert McNeill
Address	600 West Illinois Avenue, Midland, TX 79701	Telephone No.	432-230-0077
Facility Name	Nervous Horz Com #004H	Facility Type	Well Pad
Surface Owner	State	Mineral Owner	
		Lease No. (API#)	30-015-37146

LOCATION OF RELEASE

Unit Letter	Section	Township	Range	Feet from the	North/South Line	Feet from the	East/West Line	County
D	36	18S	31E					Eddy

Latitude 32.71041

Longitude 103.83032

NATURE OF RELEASE

Type of Release	Oil	Volume of Release	7bbls	Volume Recovered	2bbls
Source of Release	Tee on well head	Date and Hour of Occurrence	01-15-2014	Date and Hour of Discovery	01-15-2014 12:00pm
Was Immediate Notice Given?	<input type="checkbox"/> Yes <input checked="" type="checkbox"/> No <input checked="" type="checkbox"/> Not Required	If YES, To Whom?			
By Whom?		Date and Hour			
Was a Watercourse Reached?	<input type="checkbox"/> Yes <input checked="" type="checkbox"/> No	If YES, Volume Impacting the Watercourse.			

If a Watercourse was Impacted, Describe Fully.*

Describe Cause of Problem and Remedial Action Taken.*

The tee coming off the backpressure valve was worn out and a hole was developed. The tee has been replaced.

Describe Area Affected and Cleanup Action Taken.*

Initially 7bbls of oil were released. We were able to recover 2bbls of oil with a vacuum truck. All free fluids have been recovered. Concho will have the spill site sampled to delineate any possible contamination from the release and we will present a remediation work plan to the NMOCD for approval prior to any significant remediation work.

I hereby certify that the information given above is true and complete to the best of my knowledge and understand that pursuant to NMOCD rules and regulations all operators are required to report and/or file certain release notifications and perform corrective actions for releases which may endanger public health or the environment. The acceptance of a C-141 report by the NMOCD marked as "Final Report" does not relieve the operator of liability should their operations have failed to adequately investigate and remediate contamination that pose a threat to ground water, surface water, human health or the environment. In addition, NMOCD acceptance of a C-141 report does not relieve the operator of responsibility for compliance with any other federal, state, or local laws and/or regulations.

OIL CONSERVATION DIVISION

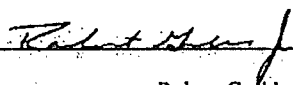
Signature: 	Approved by District Supervisor:		
Printed Name: Robert Grubbs Jr.			
Title: Senior Environmental Coordinator	Approval Date:	Expiration Date:	
E-mail Address: rgrubbs@concho.com	Conditions of Approval:		Attached <input type="checkbox"/>
Date: 1-17-2014	Phone: 432-661-6601		

* Attach Additional Sheets If Necessary

March 26, 2014

Nervous Horz State Com #4H

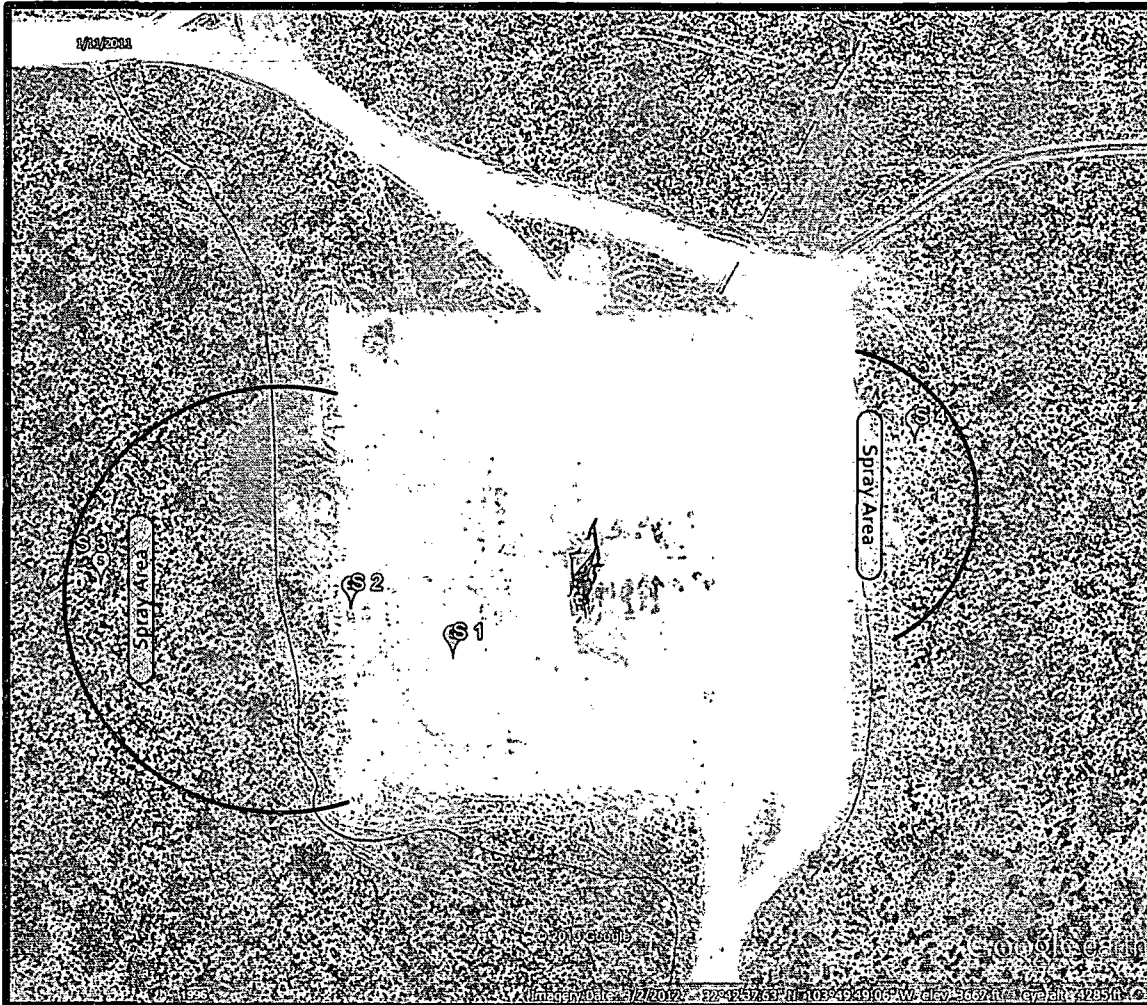

Site Ranking: Ten

Depth to GW per SEO: 98'

S1	DRO	GRO	TPH	BTEX	CI
6"	< 10.0	< 10.0	< 10.0	<0.300	432
S2	DRO	GRO	TPH	BTEX	CI
6"	< 10.0	< 10.0	< 10.0	<0.300	<16.0
S3	DRO	GRO	TPH	BTEX	CI
6"	< 10.0	< 10.0	< 10.0	<0.300	<16.0
S4	DRO	GRO	TPH	BTEX	CI
6"	< 10.0	< 10.0	< 10.0	<0.300	<16.0

Bold values exceed RRALs per NMOCD Guidelines (1993)



Nervous Horz Com #4H

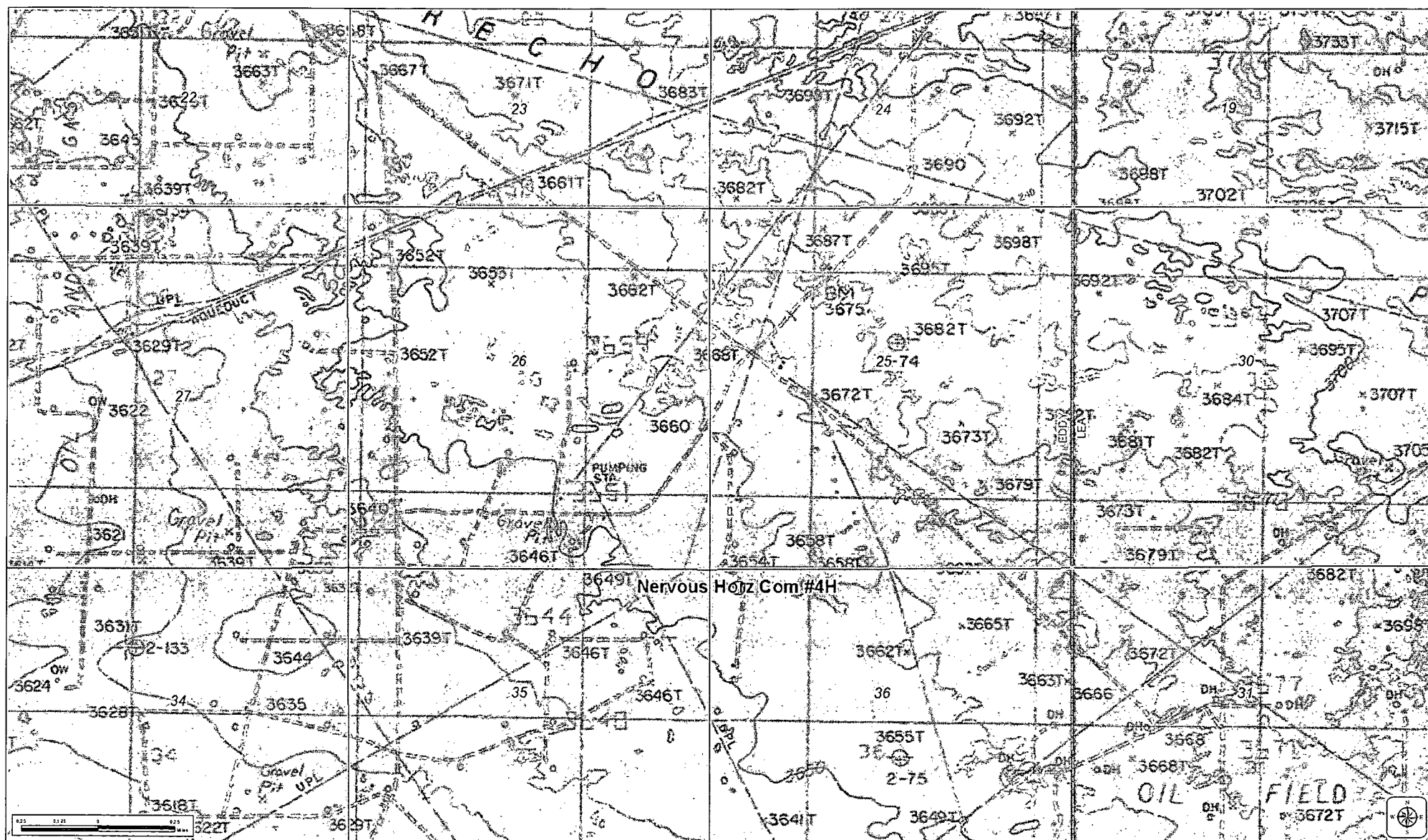



PHONE (575) 393-2326 ° 101 E. MARLAND ° HOBBS, NM 88240

March 24, 2014

AMANDA TRUJILLO

COG OPERATING

P. O. BOX 1630

ARTESIA, NM 88210

RE: NERVOUS HORZ #4

Enclosed are the results of analyses for samples received by the laboratory on 03/17/14 11:45.

Cardinal Laboratories is accredited through Texas NELAP under certificate number T104704398-13-5. Accreditation applies to drinking water, non-potable water and solid and chemical materials. All accredited analytes are denoted by an asterisk (*). For a complete list of accredited analytes and matrices visit the TCEQ website at www.tceq.texas.gov/field/qa/lab_accred_certif.html.

Cardinal Laboratories is accredited through the State of Colorado Department of Public Health and Environment for:

Method EPA 552.2	Haloacetic Acids (HAA-5)
Method EPA 524.2	Total Trihalomethanes (TTHM)
Method EPA 524.4	Regulated VOCs (V1, V2, V3)

Accreditation applies to public drinking water matrices.

This report meets NELAP requirements and is made up of a cover page, analytical results, and a copy of the original chain-of-custody. If you have any questions concerning this report, please feel free to contact me.

Sincerely,

A handwritten signature in cursive script that reads "Celey D. Keene".

Celey D. Keene

Lab Director/Quality Manager

Analytical Results For:

 COG OPERATING
 AMANDA TRUJILLO
 P. O. BOX 1630
 ARTESIA NM, 88210
 Fax To: NONE

 Received: 03/17/2014
 Reported: 03/24/2014
 Project Name: NERVOUS HORZ #4
 Project Number: NONE GIVEN
 Project Location: NOT GIVEN

 Sampling Date: 03/12/2014
 Sampling Type: Soil
 Sampling Condition: Cool & Intact
 Sample Received By: Jodi Henson

Sample ID: S1 (H400793-01)

BTEX 8021B		mg/kg	Analyzed By: MS						
Analyte	Result	Reporting Limit	Analyzed	Method Blank	BS	% Recovery	True Value QC	RPD	Qualifier
Benzene*	<0.050	0.050	03/19/2014	ND	2.39	119	2.00	3.72	
Toluene*	<0.050	0.050	03/19/2014	ND	2.30	115	2.00	4.96	
Ethylbenzene*	<0.050	0.050	03/19/2014	ND	2.27	114	2.00	6.01	
Total Xylenes*	<0.150	0.150	03/19/2014	ND	6.62	110	6.00	6.80	
Total BTEX	<0.300	0.300	03/19/2014	ND					

Surrogate: 4-Bromofluorobenzene (PIC) 104 % 89.4-126

Chloride, SM4500Cl-B		mg/kg	Analyzed By: AP						
Analyte	Result	Reporting Limit	Analyzed	Method Blank	BS	% Recovery	True Value QC	RPD	Qualifier
Chloride	432	16.0	03/19/2014	ND	416	104	400	0.00	

TPH 8015M		mg/kg	Analyzed By: ms						
Analyte	Result	Reporting Limit	Analyzed	Method Blank	BS	% Recovery	True Value QC	RPD	Qualifier
GRO C6-C10	<10.0	10.0	03/19/2014	ND	225	112	200	5.05	
DRO >C10-C28	<10.0	10.0	03/19/2014	ND	213	106	200	2.35	

Surrogate: 1-Chlorooctane 88.2 % 65.2-140

Surrogate: 1-Chlorooctadecane 98.7 % 63.6-154

Cardinal Laboratories

*=Accredited Analyte

PLEASE NOTE: Liability and Damages. Cardinal's liability and client's exclusive remedy for any claim arising, whether based in contract or tort, shall be limited to the amount paid by client for analyses. All claims, including those for negligence and any other cause whatsoever shall be deemed waived unless made in writing and received by Cardinal within thirty (30) days after completion of the applicable service. In no event shall Cardinal be liable for incidental or consequential damages, including, without limitation, business interruptions, loss of use, or loss of profits incurred by client, its subsidiaries, affiliates or successors arising out of or related to the performance of the services hereunder by Cardinal, regardless of whether such claim is based upon any of the above stated reasons or otherwise. Results relate only to the samples identified above. This report shall not be reproduced except in full with written approval of Cardinal Laboratories.



Celey D. Keene, Lab Director/Quality Manager

Analytical Results For:

 COG OPERATING
 AMANDA TRUJILLO
 P. O. BOX 1630
 ARTESIA NM, 88210
 Fax To: NONE

 Received: 03/17/2014
 Reported: 03/24/2014
 Project Name: NERVOUS HORZ #4
 Project Number: NONE GIVEN
 Project Location: NOT GIVEN

 Sampling Date: 03/12/2014
 Sampling Type: Soil
 Sampling Condition: Cool & Intact
 Sample Received By: Jodi Henson

Sample ID: S2 (H400793-02)

BTEX 8021B		mg/kg	Analyzed By: MS						
Analyte	Result	Reporting Limit	Analyzed	Method Blank	BS	% Recovery	True Value QC	RPD	Qualifier
Benzene*	<0.050	0.050	03/19/2014	ND	2.39	119	2.00	3.72	
Toluene*	<0.050	0.050	03/19/2014	ND	2.30	115	2.00	4.96	
Ethylbenzene*	<0.050	0.050	03/19/2014	ND	2.27	114	2.00	6.01	
Total Xylenes*	<0.150	0.150	03/19/2014	ND	6.62	110	6.00	6.80	
Total BTEX	<0.300	0.300	03/19/2014	ND					

Surrogate: 4-Bromofluorobenzene (PIC) 103 % 89.4-126

Chloride, SM4500Cl-B		mg/kg	Analyzed By: AP						
Analyte	Result	Reporting Limit	Analyzed	Method Blank	BS	% Recovery	True Value QC	RPD	Qualifier
Chloride	<16.0	16.0	03/19/2014	ND	416	104	400	0.00	

TPH 8015M		mg/kg	Analyzed By: ms						
Analyte	Result	Reporting Limit	Analyzed	Method Blank	BS	% Recovery	True Value QC	RPD	Qualifier
GRO C6-C10	<10.0	10.0	03/19/2014	ND	225	112	200	5.05	
DRO >C10-C28	<10.0	10.0	03/19/2014	ND	213	106	200	2.35	

Surrogate: 1-Chlorooctane 89.7 % 65.2-140

Surrogate: 1-Chlorooctadecane 79.9 % 63.6-154

Cardinal Laboratories

*=Accredited Analyte

PLEASE NOTE: Liability and Damages. Cardinal's liability and client's exclusive remedy for any claim arising, whether based in contract or tort, shall be limited to the amount paid by client for analyses. All claims, including those for negligence and any other cause whatsoever shall be deemed waived unless made in writing and received by Cardinal within thirty (30) days after completion of the applicable service. In no event shall Cardinal be liable for incidental or consequential damages, including, without limitation, business interruptions, loss of use, or loss of profits incurred by client, its subsidiaries, affiliates or successors arising out of or related to the performance of the services hereunder by Cardinal, regardless of whether such claim is based upon any of the above stated reasons or otherwise. Results relate only to the samples identified above. This report shall not be reproduced except in full with written approval of Cardinal Laboratories.



Celey D. Keene, Lab Director/Quality Manager

Analytical Results For:

 COG OPERATING
 AMANDA TRUJILLO
 P. O. BOX 1630
 ARTESIA NM, 88210
 Fax To: NONE

 Received: 03/17/2014
 Reported: 03/24/2014
 Project Name: NERVOUS HORZ #4
 Project Number: NONE GIVEN
 Project Location: NOT GIVEN

 Sampling Date: 03/12/2014
 Sampling Type: Soil
 Sampling Condition: Cool & Intact
 Sample Received By: Jodi Henson

Sample ID: S3 (H400793-03)

BTEX 8021B			mg/kg		Analyzed By: MS				
Analyte	Result	Reporting Limit	Analyzed	Method Blank	BS	% Recovery	True Value QC	RPD	Qualifier
Benzene*	<0.050	0.050	03/19/2014	ND	2.01	101	2.00	0.775	
Toluene*	<0.050	0.050	03/19/2014	ND	1.92	96.0	2.00	0.201	
Ethylbenzene*	<0.050	0.050	03/19/2014	ND	1.88	94.1	2.00	0.709	
Total Xylenes*	<0.150	0.150	03/19/2014	ND	5.43	90.5	6.00	0.115	
Total BTEX	<0.300	0.300	03/19/2014	ND					

Surrogate: 4-Bromofluorobenzene (PIL) 102 % 89.4-126

Chloride, SM4500Cl-B			mg/kg		Analyzed By: AP				
Analyte	Result	Reporting Limit	Analyzed	Method Blank	BS	% Recovery	True Value QC	RPD	Qualifier
Chloride	<16.0	16.0	03/19/2014	ND	416	104	400	0.00	

TPH 8015M			mg/kg		Analyzed By: ms				
Analyte	Result	Reporting Limit	Analyzed	Method Blank	BS	% Recovery	True Value QC	RPD	Qualifier
GRO C6-C10	<10.0	10.0	03/19/2014	ND	225	112	200	5.05	
DRO >C10-C28	<10.0	10.0	03/19/2014	ND	213	106	200	2.35	

Surrogate: 1-Chlorooctane 77.7 % 65.2-140

Surrogate: 1-Chlorooctadecane 68.5 % 63.6-154

Cardinal Laboratories

*=Accredited Analyte

PLEASE NOTE: Liability and Damages. Cardinal's liability and client's exclusive remedy for any claim arising, whether based in contract or tort, shall be limited to the amount paid by client for analyses. All claims, including those for negligence and any other cause whatsoever shall be deemed waived unless made in writing and received by Cardinal within thirty (30) days after completion of the applicable service. In no event shall Cardinal be liable for incidental or consequential damages, including, without limitation, business interruptions, loss of use, or loss of profits incurred by client, its subsidiaries, affiliates or successors arising out of or related to the performance of the services hereunder by Cardinal, regardless of whether such claim is based upon any of the above stated reasons or otherwise. Results relate only to the samples identified above. This report shall not be reproduced except in full with written approval of Cardinal Laboratories.

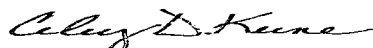

Celey D. Keene, Lab Director/Quality Manager

Analytical Results For:

 COG OPERATING
 AMANDA TRUJILLO
 P. O. BOX 1630
 ARTESIA NM, 88210
 Fax To: NONE

 Received: 03/17/2014
 Reported: 03/24/2014
 Project Name: NERVOUS HORZ #4
 Project Number: NONE GIVEN
 Project Location: NOT GIVEN

 Sampling Date: 03/12/2014
 Sampling Type: Soil
 Sampling Condition: Cool & Intact
 Sample Received By: Jodi Henson

Sample ID: S4 (H400793-04)

BTEX 8021B		mg/kg		Analyzed By: MS					
Analyte	Result	Reporting Limit	Analyzed	Method Blank	BS	% Recovery	True Value QC	RPD	Qualifier
Benzene*	<0.050	0.050	03/19/2014	ND	2.01	101	2.00	0.775	
Toluene*	<0.050	0.050	03/19/2014	ND	1.92	96.0	2.00	0.201	
Ethylbenzene*	<0.050	0.050	03/19/2014	ND	1.88	94.1	2.00	0.709	
Total Xylenes*	<0.150	0.150	03/19/2014	ND	5.43	90.5	6.00	0.115	
Total BTEX	<0.300	0.300	03/19/2014	ND					

Surrogate: 4-Bromofluorobenzene (PIB) 102 % 89.4-126

Chloride, SM4500Cl-B		mg/kg		Analyzed By: AP					
Analyte	Result	Reporting Limit	Analyzed	Method Blank	BS	% Recovery	True Value QC	RPD	Qualifier
Chloride	<16.0	16.0	03/19/2014	ND	416	104	400	0.00	

TPH 8015M		mg/kg		Analyzed By: ms					
Analyte	Result	Reporting Limit	Analyzed	Method Blank	BS	% Recovery	True Value QC	RPD	Qualifier
GRO C6-C10	<10.0	10.0	03/19/2014	ND	225	112	200	5.05	
DRO >C10-C28	<10.0	10.0	03/19/2014	ND	213	106	200	2.35	

Surrogate: 1-Chlorooctane 89.2 % 65.2-140

Surrogate: 1-Chlorooctadecane 87.9 % 63.6-154

Cardinal Laboratories

*=Accredited Analyte

PLEASE NOTE: Liability and Damages. Cardinal's liability and client's exclusive remedy for any claim arising, whether based in contract or tort, shall be limited to the amount paid by client for analyses. All claims, including those for negligence and any other cause whatsoever shall be deemed waived unless made in writing and received by Cardinal within thirty (30) days after completion of the applicable service. In no event shall Cardinal be liable for incidental or consequential damages, including, without limitation, business interruptions, loss of use, or loss of profits incurred by client, its subsidiaries, affiliates or successors arising out of or related to the performance of the services hereunder by Cardinal, regardless of whether such claim is based upon any of the above stated reasons or otherwise. Results relate only to the samples identified above. This report shall not be reproduced except in full with written approval of Cardinal Laboratories.

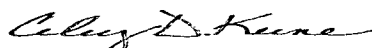

Celey D. Keene, Lab Director/Quality Manager

Notes and Definitions

ND	Analyte NOT DETECTED at or above the reporting limit
RPD	Relative Percent Difference
**	Samples not received at proper temperature of 6°C or below.
***	Insufficient time to reach temperature.
-	Chloride by SM4500Cl-B does not require samples be received at or below 6°C Samples reported on an as received basis (wet) unless otherwise noted on report

Cardinal Laboratories

*=Accredited Analyte

PLEASE NOTE: Liability and Damages. Cardinal's liability and client's exclusive remedy for any claim arising, whether based in contract or tort, shall be limited to the amount paid by client for analyses. All claims, including those for negligence and any other cause whatsoever shall be deemed waived unless made in writing and received by Cardinal within thirty (30) days after completion of the applicable service. In no event shall Cardinal be liable for incidental or consequential damages, including, without limitation, business interruptions, loss of use, or loss of profits incurred by client, its subsidiaries, affiliates or successors arising out of or related to the performance of the services hereunder by Cardinal, regardless of whether such claim is based upon any of the above stated reasons or otherwise. Results relate only to the samples identified above. This report shall not be reproduced except in full with written approval of Cardinal Laboratories.

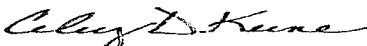

Celey D. Keene, Lab Director/Quality Manager



101 East Marland, Hobbs, NM 88240
(575) 393-2326 FAX (575) 393-2476

CHAIN-OF-CUSTODY AND ANALYSIS REQUEST

Page 7 of 7

[illegible]

† Cardinal cannot accept verbal changes. Please fax written changes to 575-393-2476

#54