

Bratcher, Mike, EMNRD

From: Chase Settle <CSettle@yatespetroleum.com>
Sent: Wednesday, February 12, 2014 9:19 AM
To: Bratcher, Mike, EMNRD
Cc: jamos@blm.gov; Duncan Whitlock (dwhitloc@blm.gov); Bob Asher
Subject: Llama ALL Federal #1
Attachments: Llama ALL Federal #1 (02-12-14 C141 Final & Sundry).pdf

RE: Llama ALL Federal #1

30-015-28093

Section 7, T22S-R31E

Eddy County, NM

Mr. Bratcher,

Enclosed please find a Form C-141, Final Report for the above captioned site regarding the release on 01/04/2014 (20 bbls of oil and 10 bbls of produced water with 0 bbls of oil and 0 bbls of produced water recovered). The cause of the release was due to a steel flow line experiencing a puncture and releasing oil and produced water. The release area was sampled on 01/23/2014 and sent for analysis (TPH, BTEX, and chlorides for documentation) at an NMOCD approved laboratory. The results for BTEX and Total TPH are below the RRAL's for the site ranking of 0 and depth to groundwater is approximately 150' per the ChevronTexaco trend map. Based on the enclosed analytical sampling results and depth to groundwater, Yates Petroleum Corporation requests closure. The affected soils were excavated and taken to an approved NMOCD facility and we believe the vertical chloride elevation at 4' is due to naturally occurring chlorides since that area has received no precipitation to leach the chlorides deeper into the soil and the 2 sample areas having the same chloride level at 4' even though saturation levels differed between the S1 and S2 sample areas (S1 was much more saturated).

If you have any questions, please call me at 575-748-4171.

Thank you,

Chase Settle
Environmental Regulatory Agent
Yates Petroleum Corporation
105 S. 4th Street
Artesia, NM 88210
575-748-4171 (Office)
575-703-6537 (Cell)

This message may contain confidential information and is intended for the named recipient only. If you are not the intended recipient you are notified that disclosing, copying, distributing or taking any action in reliance on the contents of this information is strictly prohibited. E-mail transmission cannot be

guaranteed to be secure or error-free as information could be intercepted, corrupted, lost, destroyed, arrive late or incomplete, or contain viruses. The sender therefore does not accept liability for any errors or omissions in the contents of this message, which arise as a result of e-mail transmission. If verification is required please request a hard-copy version.

UNITED STATES
DEPARTMENT OF THE INTERIOR
BUREAU OF LAND MANAGEMENT

FORM APPROVED
OMB No. 1004-0137
Expires: October 31, 2014

SUNDRY NOTICES AND REPORTS ON WELLS
Do not use this form for proposals to drill or to re-enter an abandoned well. Use Form 3160-3 (APD) for such proposals.

5. Lease Serial No.
NM-81952

6. If Indian, Allottee or Tribe Name

SUBMIT IN TRIPLICATE – Other instructions on page 2.

1. Type of Well

☐ Oil Well ☐ Gas Well ☒ Other

2. Name of Operator
Yates Petroleum Corporation

3a. Address
105 S. 4th St., Artesia, NM 88210

3b. Phone No. (include area code)
575-748-4171

4. Location of Well (Footage, Sec., T., R., M., or Survey Description)
330' FSL & 950' FWL, Section 7, T22S-R31E

7. If Unit of CA/Agreement, Name and/or No.

8. Well Name and No.
Llama ALL Federal #1

9. API Well No.
30-015-28093

10. Field and Pool or Exploratory Area

11. County or Parish, State
Eddy County, New Mexico

12. CHECK THE APPROPRIATE BOX(ES) TO INDICATE NATURE OF NOTICE, REPORT OR OTHER DATA

TYPE OF SUBMISSION	TYPE OF ACTION			
<input type="checkbox"/> Notice of Intent	<input type="checkbox"/> Acidize	<input type="checkbox"/> Deepen	<input type="checkbox"/> Production (Start/Resume)	<input type="checkbox"/> Water Shut-Off
<input checked="" type="checkbox"/> Subsequent Report	<input type="checkbox"/> Alter Casing	<input type="checkbox"/> Fracture Treat.	<input type="checkbox"/> Reclamation	<input type="checkbox"/> Well Integrity
<input type="checkbox"/> Final Abandonment Notice	<input type="checkbox"/> Casing Repair	<input type="checkbox"/> New Construction	<input type="checkbox"/> Recomplete	<input checked="" type="checkbox"/> Other Completion of
	<input type="checkbox"/> Change Plans	<input type="checkbox"/> Plug and Abandon	<input type="checkbox"/> Temporarily Abandon	clean-up actions.
	<input type="checkbox"/> Convert to Injection	<input type="checkbox"/> Plug Back	<input type="checkbox"/> Water Disposal	

13. Describe Proposed or Completed Operation: Clearly state all pertinent details, including estimated starting date of any proposed work and approximate duration thereof. If the proposal is to deepen directionally or recompleate horizontally, give subsurface locations and measured and true vertical depths of all pertinent markers and zones. Attach the Bond under which the work will be performed or provide the Bond No. on file with BLM/BIA. Required subsequent reports must be filed within 30 days following completion of the involved operations. If the operation results in a multiple completion or recompleation in a new interval, a Form 3160-4 must be filed once testing has been completed. Final Abandonment Notices must be filed only after all requirements, including reclamation, have been completed and the operator has determined that the site is ready for final inspection.)

Steel flow line developed a leak releasing 20 B crude oil and 10 B produced water with no volume recovered. A new connection and line were installed to alleviate the problem. Release affected approximately 5' of the berm and an area outside of the berm flowing NW of the location. The outside area affected is 50' N of the berm, along a line 110' W, then follow a line 60' S, then a line 75' SE back to the berm at a point approximately 5 feet from the NW corner of the berm. The affected berm is to be excavated and removed, along with the area off of location to be excavated and back dragged. Vertical and horizontal delineation samples will be taken and analysis ran for TPH & BTEX (chlorides for documentation). If initial analytical results for TPH & BTEX are under RRAL's (site ranking is 0) a Final Report, C-141 will be submitted to the OCD requesting closure. If the analytical results are above the RRAL a work plan will be submitted to the OCD. TPH & BTEX analytical results are under RRAL's (site ranking is 0). Impacted soils were excavated and hauled to a NMOCD approved facility. Depth to Ground Water: >100' (approximately 150', Section 7, T22S-R31E, per Trend Map); Wellhead Protection Area: No; Distance to Surface Water Body: > 1000'. SITE RANKING IS 0. Based on analytical results, impacted soils excavated and depth to groundwater, Yates Petroleum Corporation requests closure.

14. I hereby certify that the foregoing is true and correct. Name (Printed/Typed)
Chase Settle

Title NM Environmental Regulatory Agent

Signature

Date 02/11/2014

THIS SPACE FOR FEDERAL OR STATE OFFICE USE

Approved by:

Title

Date

Conditions of approval, if any, are attached. Approval of this notice does not warrant or certify that the applicant holds legal or equitable title to those rights in the subject lease which would entitle the applicant to conduct operations thereon.

Office

Title 18 U.S.C. Section 1001 and Title 43 U.S.C. Section 1212, make it a crime for any person knowingly and willfully to make to any department or agency of the United States any false, fictitious or fraudulent statements or representations as to any matter within its jurisdiction.

(Instructions on page 2)

District I
1625 N. French Dr., Hobbs, NM 88240
District II
1301 W. Grand Avenue, Artesia, NM 88210
District III
1000 Rio Brazos Road, Aztec, NM 87410
District IV
1220 S. St. Francis Dr., Santa Fe, NM 87505

State of New Mexico
Energy Minerals and Natural Resources

Oil Conservation Division
1220 South St. Francis Dr.
Santa Fe, NM 87505

RECEIVED

FEB 12 2014

Form C-141
Revised October 10, 2003

NMOCD ARTESIA

Submit 2 copies to appropriate
District Office in accordance
with Rule 116 on back
side of form

Release Notification and Corrective Action

OPERATOR

☐ Initial Report ☒ Final Report

Name of Company Yates Petroleum Corporation	OGRID Number 25575	Contact Chase Settle
Address 104 S. 4 TH Street		Telephone No. 575-748-4171
Facility Name Llama ALL Federal #1 Battery	API Number 30-015-28093	Facility Type Battery

Surface Owner Federal	Mineral Owner Federal	Lease No. NM-81952
--------------------------	--------------------------	-----------------------

LOCATION OF RELEASE

Unit Letter M	Section 7	Township 22S	Range 31E	Feet from the 330'	North/South Line South	Feet from the 950'	East/West Line West	County Eddy
------------------	--------------	-----------------	--------------	-----------------------	---------------------------	-----------------------	------------------------	----------------

Latitude 32.39957 Longitude -103.82199

NATURE OF RELEASE

Type of Release Crude Oil/ Produced Water	Volume of Release 20 B/O 10 B/PW	Volume Recovered 0 B/O 0 B/PW
Source of Release Rupture of flow line	Date and Hour of Occurrence 01/04/2014; PM	Date and Hour of Discovery 01/04/2014; PM
Was Immediate Notice Given? <input checked="" type="checkbox"/> Yes <input type="checkbox"/> No <input type="checkbox"/> Not Required	If YES, To Whom? Mike Bratcher, Randy Dade, Jim Amos	
By Whom? Robert Asher	Date and Hour 01/05/2014 7:41 am	
Was a Watercourse Reached? <input type="checkbox"/> Yes <input checked="" type="checkbox"/> No	If YES, Volume Impacting the Watercourse. N/A	
If a Watercourse was Impacted, Describe Fully.* N/A		

Describe Cause of Problem and Remedial Action Taken.*
Steel flow line developed a leak releasing crude oil and produced water, new connection and line were installed to alleviate the problem.

Describe Area Affected and Cleanup Action Taken.*
Release affected approximately 5' of the berm and an area outside of the berm flowing NW of the location. The outside area affected is 50' N of the berm, along a line 110' W, then follow a line 60' S, then a line 75' SE back to the berm at a point approximately 5 feet from the NW corner of the berm. The affected berm is to be excavated and removed, along with the area off of location to be excavated and back dragged. Vertical and horizontal delineation samples will be taken and analysis ran for TPH & BTEX (chlorides for documentation). If initial analytical results for TPH & BTEX are under RRAL's (site ranking is 0) a Final Report, C-141 will be submitted to the OCD requesting closure. If the analytical results are above the RRAL a work plan will be submitted to the OCD. TPH & BTEX analytical results are under RRAL's (site ranking is 0). Impacted soils were excavated and hauled to a NMOCD approved facility. Depth to Ground Water: >100' (approximately 150', Section 7, T22S-R31E, per Trend Map), Wellhead Protection Area: No, Distance to Surface Water Body: > 1000', SITE RANKING IS 0. Based on analytical results, impacted soils excavated and depth to groundwater, Yates Petroleum Corporation requests closure.

I hereby certify that the information given above is true and complete to the best of my knowledge and understand that pursuant to NMOCD rules and regulations all operators are required to report and/or file certain release notifications and perform corrective actions for releases which may endanger public health or the environment. The acceptance of a C-141 report by the NMOCD marked as "Final Report" does not relieve the operator of liability should their operations have failed to adequately investigate and remediate contamination that pose a threat to ground water, surface water, human health or the environment. In addition, NMOCD acceptance of a C-141 report does not relieve the operator of responsibility for compliance with any other federal, state, or local laws and/or regulations.

OIL CONSERVATION DIVISION

Signature: 	Approved by District Supervisor:	
Printed Name: Chase Settle		
Title: NM Environmental Regulatory Agent	Approval Date:	Expiration Date:
E-mail Address: csettle@yatespetroleum.com	Conditions of Approval:	Attached <input type="checkbox"/>
Date: Tuesday, February 11, 2014 Phone: 575-748-4171	2RP-	

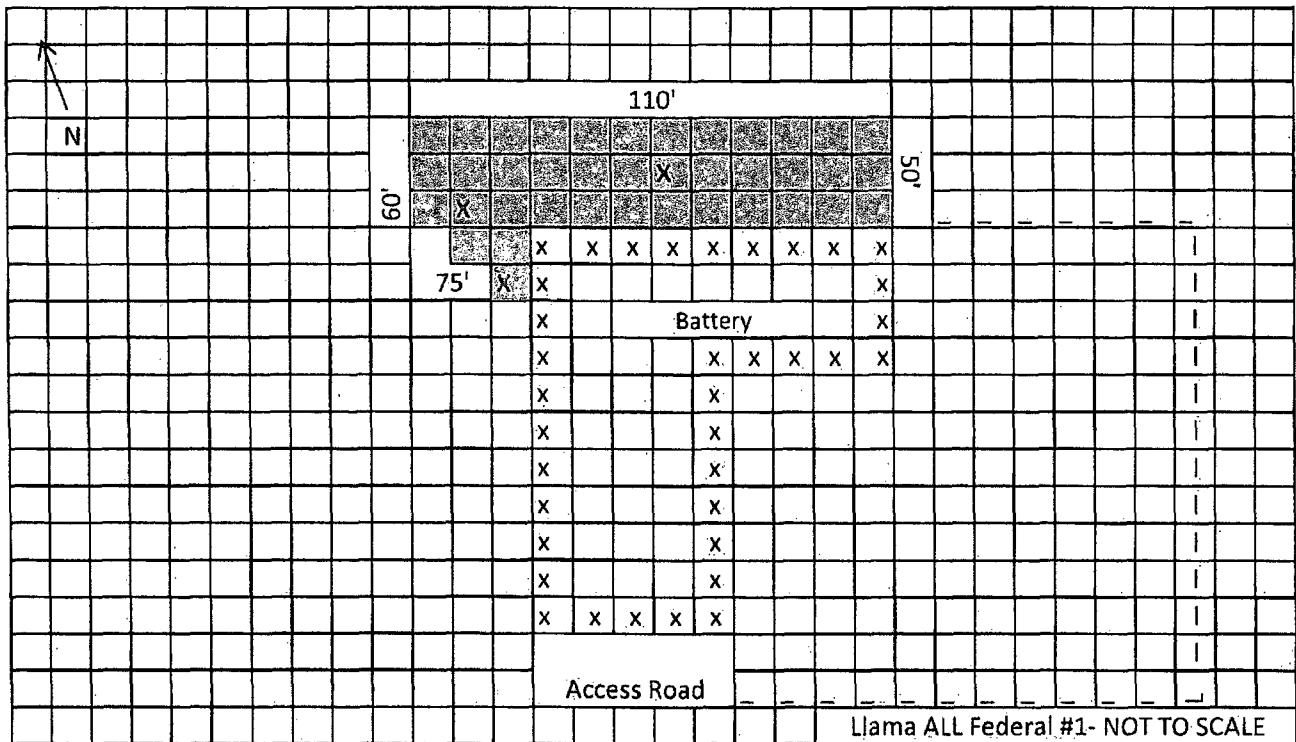

Release Area



S1 Sample Location



S2 Sample Location

Analytical Report- H400297 (Cardinal)	Sample Area	Sample Date	Sample Type	Depth	BTEX	GRO	DRO	Chlorides
S1 1'	Release Area	1/23/2014	Backhoe	1'	<0.3	<10.0	<10.0	208
S1 2'	Release Area	1/23/2014	Backhoe	2'	<0.3	<10.0	<10.0	336
S1 3'	Release Area	1/23/2014	Backhoe	3'	<0.3	<10.0	<10.0	416
S1 4'	Release Area	1/23/2014	Backhoe	4'	<0.3	<10.0	<10.0	480
S2 1'	Release Area	1/23/2014	Backhoe	1'	<0.3	<10.0	<10.0	80
S2 2'	Release Area	1/23/2014	Backhoe	2'	<0.3	<10.0	<10.0	96
S2 3'	Release Area	1/23/2014	Backhoe	3'	<0.3	<10.0	<10.0	128
S2 4'	Release Area	1/23/2014	Backhoe	4'	<0.3	<10.0	<10.0	480

Site Ranking is Zero (0). DTGW >100' (approx 150', Section 7, T22S-R31E, Trend Map)

All results are ppm, Chlorides for documentation.

Released: 20 B/O, 10 B/PW; Recovered: 0 B/O, 0 B/PW Release Date: 1/4/2014



PHONE (575) 393-2326 • 101 E. MARLAND • HOBBS, NM 88240

February 07, 2014

CHASE SETTLE

YATES PETROLEUM CORPORATION

105 S 4th Street

Artesia, NM 88210

RE: LLAMA ALL FEDERAL #1

Enclosed are the results of analyses for samples received by the laboratory on 01/30/14 11:06.

Cardinal Laboratories is accredited through Texas NELAP under certificate number T104704398-13-5. Accreditation applies to drinking water, non-potable water and solid and chemical materials. All accredited analytes are denoted by an asterisk (*). For a complete list of accredited analytes and matrices visit the TCEQ website at www.tceq.texas.gov/field/qa/lab_accred_certif.html.

Cardinal Laboratories is accredited through the State of Colorado Department of Public Health and Environment for:

Method EPA 552.2	Haloacetic Acids (HAA-5)
Method EPA 524.2	Total Trihalomethanes (TTHM)
Method EPA 524.4	Regulated VOCs (V1, V2, V3)

Accreditation applies to public drinking water matrices.

This report meets NELAP requirements and is made up of a cover page, analytical results, and a copy of the original chain-of-custody. If you have any questions concerning this report, please feel free to contact me.

Sincerely,

Celey D. Keene

Lab Director/Quality Manager

Analytical Results For:

 YATES PETROLEUM CORPORATION
 CHASE SETTLE
 105 S 4th Street
 Artesia NM, 88210
 Fax To: (505) 748-4635

 Received: 01/30/2014
 Reported: 02/07/2014
 Project Name: LLAMA ALL FEDERAL #1
 Project Number: NOT GIVEN
 Project Location: LLAMA ALL FEDERAL #1

 Sampling Date: 01/23/2014
 Sampling Type: Soil
 Sampling Condition: Cool & Intact
 Sample Received By: Kathy Perez

Sample ID: S1 1' (H400297-01)

BTX 8021B		mg/kg		Analyzed By: MS					
Analyte	Result	Reporting Limit	Analyzed	Method Blank	BS	% Recovery	True Value QC	RPD	Qualifier
Benzene*	<0.050	0.050	02/05/2014	ND	2.30	115	2.00	1.86	
Toluene*	<0.050	0.050	02/05/2014	ND	2.23	112	2.00	1.91	
Ethylbenzene*	<0.050	0.050	02/05/2014	ND	2.21	111	2.00	2.01	
Total Xylenes*	<0.150	0.150	02/05/2014	ND	6.38	106	6.00	1.74	
Total BTX	<0.300	0.300	02/05/2014	ND					

Surrogate: 4-Bromofluorobenzene (PIC) 113 % 89.4-126

Chloride, SM4500Cl-B		mg/kg		Analyzed By: AP					
Analyte	Result	Reporting Limit	Analyzed	Method Blank	BS	% Recovery	True Value QC	RPD	Qualifier
Chloride	208	16.0	02/05/2014	ND	416	104	400	0.00	

TPH 8015M		mg/kg		Analyzed By: ms					
Analyte	Result	Reporting Limit	Analyzed	Method Blank	BS	% Recovery	True Value QC	RPD	Qualifier
GRO C6-C10	<10.0	10.0	02/01/2014	ND	214	107	200	2.00	
DRO >C10-C28	<10.0	10.0	02/01/2014	ND	214	107	200	2.09	

Surrogate: 1-Chlorooctane 82.4 % 65.2-140

Surrogate: 1-Chlorooctadecane 94.4 % 63.6-154

Cardinal Laboratories

*=Accredited Analyte

PLEASE NOTE: Liability and Damages. Cardinal's liability and client's exclusive remedy for any claim arising, whether based in contract or tort, shall be limited to the amount paid by client for analysis. All claims, including those for negligence and any other cause whatsoever shall be deemed waived unless made in writing and received by Cardinal within thirty (30) days after completion of the applicable service. In no event shall Cardinal be liable for incidental or consequential damages, including, without limitation, business interruptions, loss of use, or loss of profits incurred by client, its subsidiaries, affiliates or successors arising out of or related to the performance of the services hereunder by Cardinal, regardless of whether such claim is based upon any of the above stated reasons or otherwise. Results relate only to the samples identified above. This report shall not be reproduced except in full with written approval of Cardinal Laboratories.

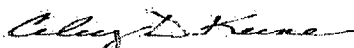

Celey D. Keene, Lab Director/Quality Manager

Analytical Results For:

 YATES PETROLEUM CORPORATION
 CHASE SETTLE
 105 S 4th Street
 Artesia NM, 88210
 Fax To: (505) 748-4635

Received:	01/30/2014	Sampling Date:	01/23/2014
Reported:	02/07/2014	Sampling Type:	Soil
Project Name:	LLAMA ALL FEDERAL #1	Sampling Condition:	Cool & Intact
Project Number:	NOT GIVEN	Sample Received By:	Kathy Perez
Project Location:	LLAMA ALL FEDERAL #1		

Sample ID: S1 2' (H400297-02)

BTX 8021B		mg/kg		Analyzed By: MS					
Analyte	Result	Reporting Limit	Analyzed	Method Blank	BS	% Recovery	True Value QC	RPD	Qualifier
Benzene*	<0.050	0.050	02/05/2014	ND	2.30	115	2.00	1.86	
Toluene*	<0.050	0.050	02/05/2014	ND	2.23	112	2.00	1.91	
Ethylbenzene*	<0.050	0.050	02/05/2014	ND	2.21	111	2.00	2.01	
Total Xylenes*	<0.150	0.150	02/05/2014	ND	6.38	106	6.00	1.74	
Total BTX	<0.300	0.300	02/05/2014	ND					

Surrogate: 4-Bromofluorobenzene (PIC) 115 % 89.4-126

Chloride, SM4500Cl-B		mg/kg		Analyzed By: AP					
Analyte	Result	Reporting Limit	Analyzed	Method Blank	BS	% Recovery	True Value QC	RPD	Qualifier
Chloride	336	16.0	02/07/2014	ND	416	104	400	0.00	

TPH 8015M		mg/kg		Analyzed By: ms					
Analyte	Result	Reporting Limit	Analyzed	Method Blank	BS	% Recovery	True Value QC	RPD	Qualifier
GRO C6-C10	<10.0	10.0	02/01/2014	ND	214	107	200	2.00	
DRO >C10-C28	<10.0	10.0	02/01/2014	ND	214	107	200	2.09	

Surrogate: 1-Chlorooctane 85.4 % 65.2-140

Surrogate: 1-Chlorooctadecane 94.5 % 63.6-154

Cardinal Laboratories

* = Accredited Analyte

PLEASE NOTE: Liability and Damages. Cardinal's liability and client's exclusive remedy for any claim arising, whether based in contract or tort, shall be limited to the amount paid by client for analyses. All claims, including those for negligence and any other cause whatsoever shall be deemed waived unless made in writing and received by Cardinal within thirty (30) days after completion of the applicable service. In no event shall Cardinal be liable for incidental or consequential damages, including, without limitation, business interruptions, loss of use, or loss of profits incurred by client, its subsidiaries, affiliates or successors arising out of or related to the performance of the services hereunder by Cardinal, regardless of whether such claim is based upon any of the above stated reasons or otherwise. Results relate only to the samples identified above. This report shall not be reproduced except in full with written approval of Cardinal Laboratories.



Celey D. Keene, Lab Director/Quality Manager

Analytical Results For:

 YATES PETROLEUM CORPORATION
 CHASE SETTLE
 105 S 4th Street
 Artesia NM, 88210
 Fax To: (505) 748-4635

 Received: 01/30/2014
 Reported: 02/07/2014
 Project Name: LLAMA ALL FEDERAL #1
 Project Number: NOT GIVEN
 Project Location: LLAMA ALL FEDERAL #1

 Sampling Date: 01/23/2014
 Sampling Type: Soil
 Sampling Condition: Cool & Intact
 Sample Received By: Kathy Perez

Sample ID: S1 3' (H400297-03)

BTX 8021B			mg/kg							Analyzed By: MS	
Analyte	Result	Reporting Limit	Analyzed	Method Blank	BS	% Recovery	True Value QC	RPD	Qualifier		
Benzene*	<0.050	0.050	02/05/2014	ND	2.30	115	2.00	1.86			
Toluene*	<0.050	0.050	02/05/2014	ND	2.23	112	2.00	1.91			
Ethylbenzene*	<0.050	0.050	02/05/2014	ND	2.21	111	2.00	2.01			
Total Xylenes*	<0.150	0.150	02/05/2014	ND	6.38	106	6.00	1.74			
Total BTX	<0.300	0.300	02/05/2014	ND							

Surrogate: 4-Bromofluorobenzene (PIL) 113 % 89.4-126

Chloride, SM4500Cl-B			mg/kg		Analyzed By: AP				
Analyte	Result	Reporting Limit	Analyzed	Method Blank	BS	% Recovery	True Value QC	RPD	Qualifier
Chloride	416	16.0	02/07/2014	ND	416	104	400	0.00	

TPH 8015M			mg/kg		Analyzed By: ms				
Analyte	Result	Reporting Limit	Analyzed	Method Blank	BS	% Recovery	True Value QC	RPD	Qualifier
GRO C6-C10	<10.0	10.0	02/01/2014	ND	214	107	200	2.00	
DRO >C10-C28	<10.0	10.0	02/01/2014	ND	214	107	200	2.09	

Surrogate: 1-Chlorooctane 81.0 % 65.2-140

Surrogate: 1-Chlorooctadecane 82.4 % 63.6-154

Cardinal Laboratories

* = Accredited Analyte

PLEASE NOTE: Liability and Damages. Cardinal's liability and client's exclusive remedy for any claim arising, whether based in contract or tort, shall be limited to the amount paid by client for analyses. All claims, including those for negligence and any other cause whatsoever shall be deemed waived unless made in writing and received by Cardinal within thirty (30) days after completion of the applicable service. In no event shall Cardinal be liable for incidental or consequential damages, including, without limitation, business interruptions, loss of use, or loss of profits incurred by client, its subsidiaries, affiliates or successors arising out of or related to the performance of the services hereunder by Cardinal, regardless of whether such claim is based upon any of the above stated reasons or otherwise. Results relate only to the samples identified above. This report shall not be reproduced except in full with written approval of Cardinal Laboratories.

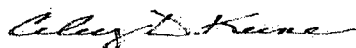

Celey D. Keene, Lab Director/Quality Manager

Analytical Results For:

 YATES PETROLEUM CORPORATION
 CHASE SETTLE
 105 S 4th Street
 Artesia NM, 88210
 Fax To: (505) 748-4635

Received:	01/30/2014	Sampling Date:	01/23/2014
Reported:	02/07/2014	Sampling Type:	Soil
Project Name:	LLAMA ALL FEDERAL #1	Sampling Condition:	Cool & Intact
Project Number:	NOT GIVEN	Sample Received By:	Kathy Perez
Project Location:	LLAMA ALL FEDERAL #1		

Sample ID: S1 4' (H400297-04)

BTEX 8021B		mg/kg		Analyzed By: MS					
Analyte	Result	Reporting Limit	Analyzed	Method Blank	BS	% Recovery	True Value QC	RPD	Qualifier
Benzene*	<0.050	0.050	02/05/2014	ND	2.30	115	2.00	1.86	
Toluene*	<0.050	0.050	02/05/2014	ND	2.23	112	2.00	1.91	
Ethylbenzene*	<0.050	0.050	02/05/2014	ND	2.21	111	2.00	2.01	
Total Xylenes*	<0.150	0.150	02/05/2014	ND	6.38	106	6.00	1.74	
Total BTEX	<0.300	0.300	02/05/2014	ND					

Surrogate: 4-Bromofluorobenzene (PIE) 114 % 89.4-126

Chloride, SM4500Cl-B		mg/kg		Analyzed By: AP					
Analyte	Result	Reporting Limit	Analyzed	Method Blank	BS	% Recovery	True Value QC	RPD	Qualifier
Chloride	480	16.0	02/07/2014	ND	416	104	400	0.00	

TPH 8015M		mg/kg		Analyzed By: ms					
Analyte	Result	Reporting Limit	Analyzed	Method Blank	BS	% Recovery	True Value QC	RPD	Qualifier
GRO C6-C10	<10.0	10.0	02/01/2014	ND	214	107	200	2.00	
DRO >C10-C28	<10.0	10.0	02/01/2014	ND	214	107	200	2.09	

Surrogate: 1-Chlorooctane 85.3 % 65.2-140

Surrogate: 1-Chlorooctadecane 84.5 % 63.6-154

Cardinal Laboratories

*=Accredited Analyte

PLEASE NOTE: Liability and Damages. Cardinal's liability and client's exclusive remedy for any claim arising, whether based in contract or tort, shall be limited to the amount paid by client for analyses. All claims, including those for negligence and any other cause whatsoever, shall be deemed waived unless made in writing and received by Cardinal within thirty (30) days after completion of the applicable service. In no event shall Cardinal be liable for incidental or consequential damages, including, without limitation, business interruptions, loss of use, or loss of profits incurred by client, its subsidiaries, affiliates or successors arising out of or related to the performance of the services hereunder by Cardinal, regardless of whether such claim is based upon any of the above stated reasons or otherwise. Results relate only to the samples identified above. This report shall not be reproduced except in full with written approval of Cardinal Laboratories.

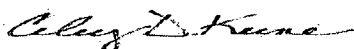

Celey D. Keene, Lab Director/Quality Manager

Analytical Results For:

 YATES PETROLEUM CORPORATION
 CHASE SETTLE
 105 S 4th Street
 Artesia NM, 88210
 Fax To: (505) 748-4635

 Received: 01/30/2014
 Reported: 02/07/2014
 Project Name: LLAMA ALL FEDERAL #1
 Project Number: NOT GIVEN
 Project Location: LLAMA ALL FEDERAL #1

 Sampling Date: 01/23/2014
 Sampling Type: Soil
 Sampling Condition: Cool & Intact
 Sample Received By: Kathy Perez

Sample ID: S2 1' (H400297-05)

BTX 80218		mg/kg		Analyzed By: MS					
Analyte	Result	Reporting Limit	Analyzed	Method Blank	BS	% Recovery	True Value QC	RPD	Qualifier
Benzene*	<0.050	0.050	02/05/2014	ND	2.54	127	2.00	0.915	
Toluene*	<0.050	0.050	02/05/2014	ND	2.49	125	2.00	0.516	
Ethylbenzene*	<0.050	0.050	02/05/2014	ND	2.49	124	2.00	0.462	
Total Xylenes*	<0.150	0.150	02/05/2014	ND	7.18	120	6.00	0.427	
Total BTX	<0.300	0.300	02/05/2014	ND					

Surrogate: 4-Bromofluorobenzene (PIC) 113 % 89.4-126

Chloride, SM4500Cl-B		mg/kg		Analyzed By: AP					
Analyte	Result	Reporting Limit	Analyzed	Method Blank	BS	% Recovery	True Value QC	RPD	Qualifier
Chloride	80.0	16.0	02/07/2014	ND	416	104	400	0.00	

TPH 8015M		mg/kg		Analyzed By: ms					
Analyte	Result	Reporting Limit	Analyzed	Method Blank	BS	% Recovery	True Value QC	RPD	Qualifier
GRO C6-C10	<10.0	10.0	02/01/2014	ND	214	107	200	2.00	
DRO >C10-C28	<10.0	10.0	02/01/2014	ND	214	107	200	2.09	

Surrogate: 1-Chlorooctane 91.4 % 65.2-140

Surrogate: 1-Chlorooctadecane 99.2 % 63.6-154

Cardinal Laboratories

*=Accredited Analyte

PLEASE NOTE: Liability and Damages. Cardinal's liability and client's exclusive remedy for any claim arising, whether based in contract or tort, shall be limited to the amount paid by client for analysis. All claims, including those for negligence and any other cause whatsoever shall be deemed waived unless made in writing and received by Cardinal within thirty (30) days after completion of the applicable service. In no event shall Cardinal be liable for incidental or consequential damages, including, without limitation, business interruptions, loss of use, or loss of profits incurred by client, its subsidiaries, affiliates or successors arising out of or related to the performance of the services hereunder by Cardinal, regardless of whether such claim is based upon any of the above stated reasons or otherwise. Results relate only to the samples identified above. This report shall not be reproduced except in full with written approval of Cardinal Laboratories.

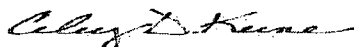

Celey D. Keene, Lab Director/Quality Manager

Analytical Results For:

YATES PETROLEUM CORPORATION
CHASE SETTLE
105 S 4th Street
Artesia NM, 88210
Fax To: (505) 748-4635

Received: 01/30/2014
Reported: 02/07/2014
Project Name: LLAMA ALL FEDERAL #1
Project Number: NOT GIVEN
Project Location: LLAMA ALL FEDERAL #1

Sampling Date: 01/23/2014
Sampling Type: Soil
Sampling Condition: Cool & Intact
Sample Received By: Kathy Perez

Sample ID: S2 2' (H400297-06)

BTX 8021B		mg/kg		Analyzed By: MS					
Analyte	Result	Reporting Limit	Analyzed	Method Blank	BS	% Recovery	True Value QC	RPD	Qualifier
Benzene*	<0.050	0.050	02/05/2014	ND	2.54	127	2.00	0.915	
Toluene*	<0.050	0.050	02/05/2014	ND	2.49	125	2.00	0.516	
Ethylbenzene*	<0.050	0.050	02/05/2014	ND	2.49	124	2.00	0.462	
Total Xylenes*	<0.150	0.150	02/05/2014	ND	7.18	120	6.00	0.427	
Total BTX	<0.300	0.300	02/05/2014	ND					

Surrogate: 4-Bromofluorobenzene (PIL) 114 % 89.4-126

Chloride, SM4500Cl-B		mg/kg		Analyzed By: AP					
Analyte	Result	Reporting Limit	Analyzed	Method Blank	BS	% Recovery	True Value QC	RPD	Qualifier
Chloride	96.0	16.0	02/07/2014	ND	416	104	400	0.00	

TPH 8015M		mg/kg		Analyzed By: ms					
Analyte	Result	Reporting Limit	Analyzed	Method Blank	BS	% Recovery	True Value QC	RPD	Qualifier
GRO C6-C10	<10.0	10.0	02/01/2014	ND	214	107	200	2.00	
DRO >C10-C28	<10.0	10.0	02/01/2014	ND	214	107	200	2.09	

Surrogate: 1-Chlorooctane 90.8 % 65.2-140

Surrogate: 1-Chlorodecane 97.9 % 63.6-154

Cardinal Laboratories

*=Accredited Analyte

PLEASE NOTE: Liability and Damages. Cardinal's liability and client's exclusive remedy for any claim arising, whether based in contract or tort, shall be limited to the amount paid by client for analyses. All claims, including those for negligence and any other cause whatsoever, shall be deemed waived unless made in writing and received by Cardinal within thirty (30) days after completion of the applicable service. In no event shall Cardinal be liable for incidental or consequential damages, including, without limitation, business interruptions, loss of use, or loss of profits incurred by client, its subsidiaries, affiliates or successors arising out of or related to the performance of the services hereunder by Cardinal, regardless of whether such claim is based upon any of the above stated reasons or otherwise. Results relate only to the samples identified above. This report shall not be reproduced except in full with written approval of Cardinal Laboratories.

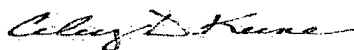

Celey D. Keene, Lab Director/Quality Manager

Analytical Results For:

YATES PETROLEUM CORPORATION
CHASE SETTLE
105 S 4th Street
Artesia NM, 88210
Fax To: (505) 748-4635

Received: 01/30/2014
Reported: 02/07/2014
Project Name: LLAMA ALL FEDERAL #1
Project Number: NOT GIVEN
Project Location: LLAMA ALL FEDERAL #1

Sampling Date: 01/23/2014
Sampling Type: Soil
Sampling Condition: Cool & Intact
Sample Received By: Kathy Perez

Sample ID: S2 3' (H400297-07)

BTX 8021B		mg/kg		Analyzed By: MS					
Analyte	Result	Reporting Limit	Analyzed	Method Blank	BS	% Recovery	True Value QC	RPD	Qualifier
Benzene*	<0.050	0.050	02/05/2014	ND	2.54	127	2.00	0.915	
Toluene*	<0.050	0.050	02/05/2014	ND	2.49	125	2.00	0.516	
Ethylbenzene*	<0.050	0.050	02/05/2014	ND	2.49	124	2.00	0.462	
Total Xylenes*	<0.150	0.150	02/05/2014	ND	7.18	120	6.00	0.427	
Total BTX	<0.300	0.300	02/05/2014	ND					

Surrogate: 4-Bromofluorobenzene (PIL) 116 % 89.4-126

Chloride, SM4500Cl-B		mg/kg		Analyzed By: AP					
Analyte	Result	Reporting Limit	Analyzed	Method Blank	BS	% Recovery	True Value QC	RPD	Qualifier
Chloride	128	16.0	02/07/2014	ND	416	104	400	0.00	

TPH 8015M		mg/kg		Analyzed By: ms					
Analyte	Result	Reporting Limit	Analyzed	Method Blank	BS	% Recovery	True Value QC	RPD	Qualifier
GRO C6-C10	<10.0	10.0	02/01/2014	ND	214	107	200	2.00	
DRO >C10-C28	<10.0	10.0	02/01/2014	ND	214	107	200	2.09	

Surrogate: 1-Chlorooctane 95.3 % 65.2-140

Surrogate: 1-Chlorooctadecane 95.6 % 63.6-154

Cardinal Laboratories

*=Accredited Analyte

PLEASE NOTE: Liability and Damages: Cardinal's liability and client's exclusive remedy for any claim arising, whether based in contract or tort, shall be limited to the amount paid by client for analyses. All claims, including those for negligence and any other cause whatsoever shall be deemed waived unless made in writing and received by Cardinal within thirty (30) days after completion of the applicable service. In no event shall Cardinal be liable for incidental or consequential damages, including, without limitation, business interruptions, loss of use, or loss of profits incurred by client, its subsidiaries, affiliates or successors arising out of or related to the performance of the services hereunder by Cardinal, regardless of whether such claim is based upon any of the above stated reasons or otherwise. Results relate only to the samples identified above. This report shall not be reproduced except in full with written approval of Cardinal Laboratories.

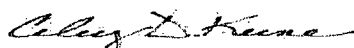

Celey D. Keene, Lab Director/Quality Manager

Analytical Results For:

 YATES PETROLEUM CORPORATION
 CHASE SETTLE
 105 S 4th Street
 Artesia NM, 88210
 Fax To: (505) 748-4635

 Received: 01/30/2014
 Reported: 02/07/2014
 Project Name: LLAMA ALL FEDERAL #1
 Project Number: NOT GIVEN
 Project Location: LLAMA ALL FEDERAL #1

 Sampling Date: 01/23/2014
 Sampling Type: Soil
 Sampling Condition: Cool & Intact
 Sample Received By: Kathy Perez

Sample ID: S2 4' (H400297-08)

BTEX 8021B			mg/kg		Analyzed By: MS				
Analyte	Result	Reporting Limit	Analyzed	Method Blank	BS	% Recovery	True Value QC	RPD	Qualifier
Benzene*	<0.050	0.050	02/05/2014	ND	2.54	127	2.00	0.915	
Toluene*	<0.050	0.050	02/05/2014	ND	2.49	125	2.00	0.516	
Ethylbenzene*	<0.050	0.050	02/05/2014	ND	2.49	124	2.00	0.462	
Total Xylenes*	<0.150	0.150	02/05/2014	ND	7.18	120	6.00	0.427	
Total BTEX	<0.300	0.300	02/05/2014	ND					

Surrogate: 4-Bromofluorobenzene (PIL) 115 % 89.4-126

Chloride, SM4500Cl-B			mg/kg		Analyzed By: AP				
Analyte	Result	Reporting Limit	Analyzed	Method Blank	BS	% Recovery	True Value QC	RPD	Qualifier
Chloride	480	16.0	02/07/2014	ND	416	104	400	0.00	

TPH 8015M			mg/kg		Analyzed By: ms				
Analyte	Result	Reporting Limit	Analyzed	Method Blank	BS	% Recovery	True Value QC	RPD	Qualifier
GRO C6-C10	<10.0	10.0	02/01/2014	ND	214	107	200	2.00	
DRO >C10-C28	<10.0	10.0	02/01/2014	ND	214	107	200	2.09	

Surrogate: 1-Chlorooctane 99.8 % 65.2-140

Surrogate: 1-Chlorooctadecane 99.7 % 63.6-154

Cardinal Laboratories

* = Accredited Analyte

PLEASE NOTE: Liability and Damages. Cardinal's liability and client's exclusive remedy for any claim arising, whether based in contract or tort, shall be limited to the amount paid by client for analyses. All claims, including those for negligence and any other cause whatsoever shall be deemed waived unless made in writing and received by Cardinal within thirty (30) days after completion of the applicable service. In no event shall Cardinal be liable for incidental or consequential damages, including, without limitation, business interruptions, loss of use, or loss of profits incurred by client, its subsidiaries, affiliates or successors arising out of or related to the performance of the services hereunder by Cardinal, regardless of whether such claim is based upon any of the above stated reasons or otherwise. Results relate only to the samples identified above. This report shall not be reproduced except in full with written approval of Cardinal Laboratories.

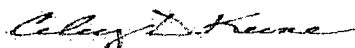

Celey D. Keene, Lab Director/Quality Manager

Notes and Definitions

ND	Analyte NOT DETECTED at or above the reporting limit
RPD	Relative Percent Difference
**	Samples not received at proper temperature of 6°C or below.
***	Insufficient time to reach temperature.
-	Chloride by SM4500Cl-B does not require samples be received at or below 6°C Samples reported on an as received basis (wet) unless otherwise noted on report

Cardinal Laboratories

* = Accredited Analyte

PLEASE NOTE: Liability and Damages. Cardinal's liability and client's exclusive remedy for any claim arising, whether based in contract or tort, shall be limited to the amount paid by client for analyses. All claims, including those for negligence and any other cause whatsoever, shall be deemed waived unless made in writing and received by Cardinal within thirty (30) days after completion of the applicable service. In no event shall Cardinal be liable for incidental or consequential damages, including, without limitation, business interruptions, loss of use, or loss of profits incurred by client, its subsidiaries, affiliates or successors arising out of or related to the performance of the services hereunder by Cardinal, regardless of whether such claim is based upon any of the above stated reasons or otherwise. Results relate only to the samples identified above. This report shall not be reproduced except in full with written approval of Cardinal Laboratories.

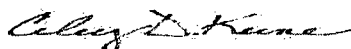

Celey D. Keene, Lab Director/Quality Manager



ARDINAL LABORATORIES
101 East Marland, Hobbs, NM 88240

(505) 393-2326 FAX (505) 393-2476

CHAIN OF CUSTODY RECORD AND ANALYSIS REQUEST

Page 11 of 11

Project Manager: Chase Settle

Project Name: Hama/ALL Federal #1

Company: (505) 393-2326 Yates Petroleum Corporation

Project #:

Company Address: 105 South 4th Street

Project Loc: Hama/ALL Federal #1

City/State/Zip: Artesia, NM 88210

PO #: 205750

Telephone No: 575-748-4171

Fax No: 575-748-4131

Report Format: ☒ Standard ☐ TRRP ☐ NPDES

Sampler Signature: [Signature] e-mail: csettle@yatespetroleum.com

(lab use only)

ORDER #:

H400297

LAB # (lab use only)	FIELD CODE	Beginning Depth	Ending Depth	Date Sampled	Time Sampled	Field Filtered	Total #. of Containers	Ice	HNO ₃	HCl	H ₂ SO ₄	NaOH	Na ₂ S ₂ O ₃	None	Other (Specify)	DW=Drinking Water SL=Sludge GW = Groundwater S=Soil/Solid NP=Non-Potable Specify Other	TPH: 418.1 8015M 8015E	TPH: TX 1005 TX 1008	Cations (Ca, Mg, Na, K)	Anions (Cl, SO ₄ , Alkalinity)	SAR/ESP/CEC	Metals: As Ag Ba Cd Cr Pb Hg Se	Volatiles	Semivolatiles	BTEX 8021B/8030 or BTEX 8260	RCI	N.O.M.	Chlorides	SAR	RUSH TAT (Pre-Schedule) 24, 48, 72 hrs	Standard TAT	
1	S1 1'			1/23/2014	2:25 PM	1	X									S	X							X				X				
2	S1 2'			1/23/2014	2:25 PM	1	X									S	X							X				X				
3	S1 3'			1/23/2014	2:25 PM	1	X									S	X							X				X				
4	S1 4'			1/23/2014	2:25 PM	1	X									S	X							X				X				
5	S2 1'			1/23/2014	2:25 PM	1	X									S	X							X				X				
6	S2 2'			1/23/2014	2:25 PM	1	X									S	X							X				X				
7	S2 3'			1/23/2014	2:25	1	X									S	X							X				X				
8	S2 4'			1/23/2014	2:25	1	X									S	X							X				X				

Special Instructions:

Laboratory Comments:

Relinquished by: [Signature] Date: 1-30-14 Time: 11:00 AM Received by: [Signature] Date: 1/30/14 Time: 11:00

Sample Containers Intact? (Y) N

VOCs Free of Headspace? (Y) N

Labels on container(s)? (Y) N

Custody seals on container(s)? (Y) N

Custody seals on cooler(s)? (Y) N

Sample Hand Delivered? (Y) N

by Sample/Client Rep.? (Y) N

by Courier? (Y) N

Temperature Upon Receipt: 22 °C