

# Closure Report

Site Description		
Site Name:	Mckittrick 11-5	<div>RECEIVED</div> <div>APR 01 2013</div> <div>NMOCD ARTESIA</div>
Company:	Oxy Permian Ltd.	
Legal Description:	U/L L, Section 11, T22S, R24E	
County:	Eddy County, NM	
GPS Coordinates:	N 32.41427° W 104.47447°	

Release Data	
Date of Release:	07/05/2011
Type of Release:	Produced Water
Source of Release:	Injection pump
Volume of Release:	85 bbls
Volume Recovered:	80 bbls

Remediation Specifications	
Remediation Parameters:	Excavate and remove 6 inches to 1 foot of impacted soil. Obtain confirmation samples per BLM request. Then, backfill all the excavated areas with clean soil.
Remediation Activities:	11/3/2011 to 01/03/2012

Plan Sent to OCD:	08/26/2011	Email from Cliff Brunson to Mike Bratcher
OCD Approval of Plan:	08/26/2011	Email from Mike Bratcher to Cliff Brunson
Plan Sent to BLM:	10/13/2011	Email from Cliff Brunson to Amos/Gregston
BLM Approval of Plan:	11/17/2011	Email from Terry Gregston to Cliff Brunson

Supporting Documentation	
Initial C-141	Signed 07/06/2011
Final C-141	Signed 12/19/2011
Site Diagram	November 2011
Groundwater Plot	100'
TOPO Maps	November 2011
Lab Summary	08/02/2011 to 08/03/2011 and 11/09/2011
Lab Analysis	08/02/2011 to 08/03/2011 and 11/09/2011
Correspondence	Request and approval of remediation plan via email

Request for Closure	
Based on the completion of the remediation plan as agreed upon, BBC International requests closure approval from NMOCD.	
Cliff Brunson, President of BBC International Inc.	03/29/2013

District I  
1625 N. French Dr., Hobbs, NM 88240  
District II  
1301 W. Grand Avenue, Artesia, NM 88210  
District III  
1000 Rio Brazos Road, Aztec, NM 87410  
District IV  
1220 S. St. Francis Dr., Santa Fe, NM 87505

State of New Mexico  
Energy Minerals and Natural Resources

Oil Conservation Division  
1220 South St. Francis Dr.  
Santa Fe, NM 87505

Form C-141  
Revised October 10, 2003

Submit 2 Copies to appropriate  
District Office in accordance  
with Rule 116 on back  
side of form.

**Release Notification and Corrective Action**

**OPERATOR**

☒ Initial Report ☐ Final Report

Name of Company OXY USA	Contact Kelton Beaird
Address 1502 W. Commerce Carlsbad, NM 88220	Telephone No. (O) 575-628-4100
Facility Name Mckittrick 11-5	Facility Type SWD

Surface Owner	Mineral Owner	Lease No. API: 3001533611
---------------	---------------	---------------------------

**LOCATION OF RELEASE**

Unit Letter	Section	Township	Range	Feet from the	North/South Line	Feet from the	East/West Line	County
L	11	22S	24E					Eddy

Latitude \_\_\_\_\_ Longitude \_\_\_\_\_

**NATURE OF RELEASE**

Type of Release Produced Water	Volume of Release 85	Volume Recovered 80
Source of Release Injection Pump	Date and Hour of Occurrence	Date and Hour of Discovery 7-5-11 @ 10:00am
Was Immediate Notice Given? <input checked="" type="checkbox"/> Yes <input type="checkbox"/> No <input type="checkbox"/> Not Required	If YES, To Whom? Mike Bratcher: NMOCD	
By Whom? Kelton Beaird (Oxy)	Date and Hour See above	
Was a Watercourse Reached? <input type="checkbox"/> Yes <input checked="" type="checkbox"/> No	If YES, Volume Impacting the Watercourse.	

If a Watercourse was Impacted, Describe Fully.\*

Describe Cause of Problem and Remedial Action Taken.\*

Injection pump cracked and leaked. Vacuum Truck was called to pick up standing fluid

Describe Area Affected and Cleanup Action Taken.\*

Area affected was inside the berms. Area will be sampled and cleaned up per NMOCD and BLM guidelines

I hereby certify that the information given above is true and complete to the best of my knowledge and understand that pursuant to NMOCD rules and regulations all operators are required to report and/or file certain release notifications and perform corrective actions for releases which may endanger public health or the environment. The acceptance of a C-141 report by the NMOCD marked as "Final Report" does not relieve the operator of liability should their operations have failed to adequately investigate and remediate contamination that pose a threat to ground water, surface water, human health or the environment. In addition, NMOCD acceptance of a C-141 report does not relieve the operator of responsibility for compliance with any other federal, state, or local laws and/or regulations.

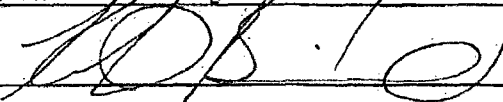
Signature: 		<b>OIL CONSERVATION DIVISION</b>	
Printed Name: Kelton Beaird		Approved by District Supervisor:	
Title: HES Specialist		Approval Date:	Expiration Date:
E-mail Address: kelton_beaird@oxy.com		Conditions of Approval:	Attached <input type="checkbox"/>
Date: 7-6-11			

\* Attach Additional Sheets If Necessary

District I  
1625 N. French Dr., Hobbs, NM 88240  
District II  
1301 W. Grand Avenue, Artesia, NM 88210  
District III  
1000 Rio Brazos Road, Aztec, NM 87410  
District IV  
1220 S. St. Francis Dr., Santa Fe, NM 87505

State of New Mexico  
Energy Minerals and Natural Resources

Oil Conservation Division  
1220 South St. Francis Dr.  
Santa Fe, NM 87505

Form C-141  
Revised October 10, 2003

Submit 2 Copies to appropriate  
District Office in accordance  
with Rule 116 on back  
side of form

**Release Notification and Corrective Action**

**OPERATOR**

☐ Initial Report ☒ Final Report

Name of Company	Oxy Permian LTD	Contact	Dusty Wilson
Address	1017 W. Stanolind Rd, Hobbs NM	Telephone No.	(575) 397-8247
Facility Name	McKittrick 11-5	Facility Type	SWD
Surface Owner	Mineral Owner	Lease No. 30-015-33611	

**LOCATION OF RELEASE API #30-015-28305**

Unit Letter	Section	Township	Range	Feet from the	North/South Line	Feet from the	East/West Line	County
L	11	22S	24E					Eddy

Latitude \_\_\_\_\_ Longitude \_\_\_\_\_

**NATURE OF RELEASE**

Type of Release	Produced water	Volume of Release	85	Volume Recovered	80
Source of Release	Injection Pump	Date and Hour of Occurrence	Date and Hour of Discovery: 07/05/2011 @ 10:00am		
Was Immediate Notice Given?	<input checked="" type="checkbox"/> Yes <input type="checkbox"/> No <input type="checkbox"/> Not Required				
By Whom?	Kelton Beaird- Oxy	If YES, To Whom?	Mike Bratcher- NMOCD		
Was a Watercourse Reached?	<input type="checkbox"/> Yes <input checked="" type="checkbox"/> No				
If a Watercourse was Impacted, Describe Fully.*		Date and Hour See above			
N/A		If YES, Volume Impacting the Watercourse.			

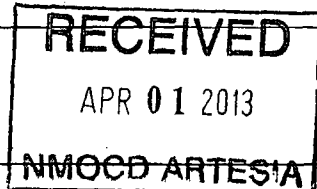

Describe Cause of Problem and Remedial Action Taken.\*  
Injection pump cracked and leaked. Standing fluids were recovered via vacuum truck. Remediation complete as described in the OCD and BLM approved remediation plans.

Describe Area Affected and Cleanup Action Taken.\*  
Area affected was inside the berms. Clean up was performed by excavating the impacted soil and backfilling the site with clean soil. Confirmation sampling was performed and results were provided to the BLM and NMOCD. Closure was granted on 11/17/2011 by the BLM. Remediation approval was granted by the NMOCD on 08/26/2011.

I hereby certify that the information given above is true and complete to the best of my knowledge and understand that pursuant to NMOCD rules and regulations all operators are required to report and/or file certain release notifications and perform corrective actions for releases which may endanger public health or the environment. The acceptance of a C-141 report by the NMOCD marked as "Final Report" does not relieve the operator of liability should their operations have failed to adequately investigate and remediate contamination that pose a threat to ground water, surface water, human health or the environment. In addition, NMOCD acceptance of a C-141 report does not relieve the operator of responsibility for compliance with any other federal, state, or local laws and/or regulations.

**OIL CONSERVATION DIVISION**

Signature:	Approved by District Supervisor:		
Printed Name: Dusty Wilson			
Title: HES Specialist	Approval Date:	Expiration Date:	
E-mail Address: Dusty_Wilson@oxy.com	Conditions of Approval:		Attached <input type="checkbox"/>
Date: 12-19-2011	Phone: (575) 397-8210		

\* Attach Additional Sheets If Necessary

Oxy  
McKittrick 11 #5

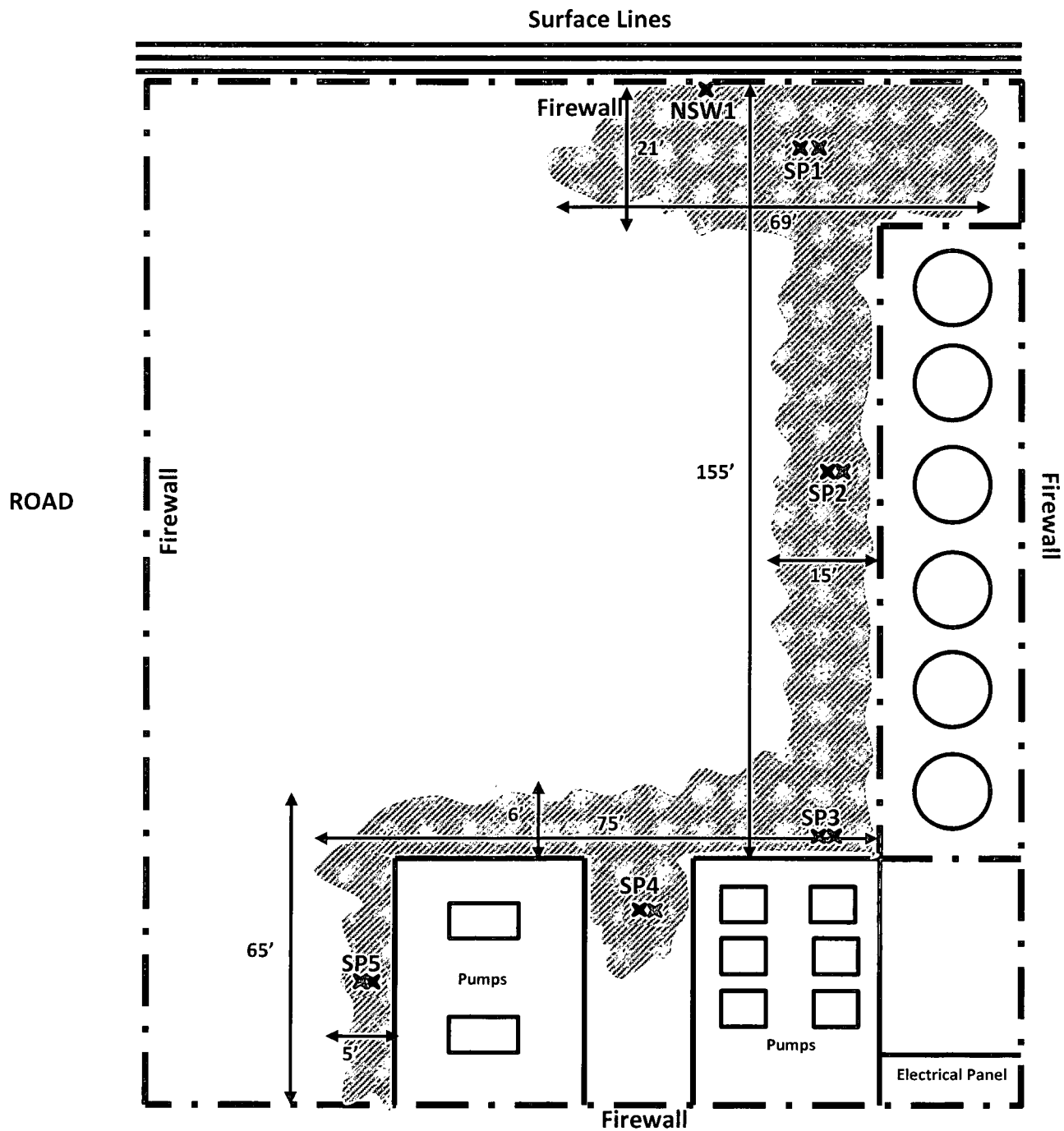

- ✕ Delineation sampling
- ✕ Confirmation sampling

BBC International, Inc.	
Oxy McKittrick 11 #5	
Date: 11/10/11	DRWG by: KAP
Not to Scale	File: Carlsbad 11



# Groundwater Plot

## Oxy McKittrick 11-5

County  
Eddy

Unit Letter  
L

Section  
11

Township  
22S

Range  
24E

Trend Map 100'

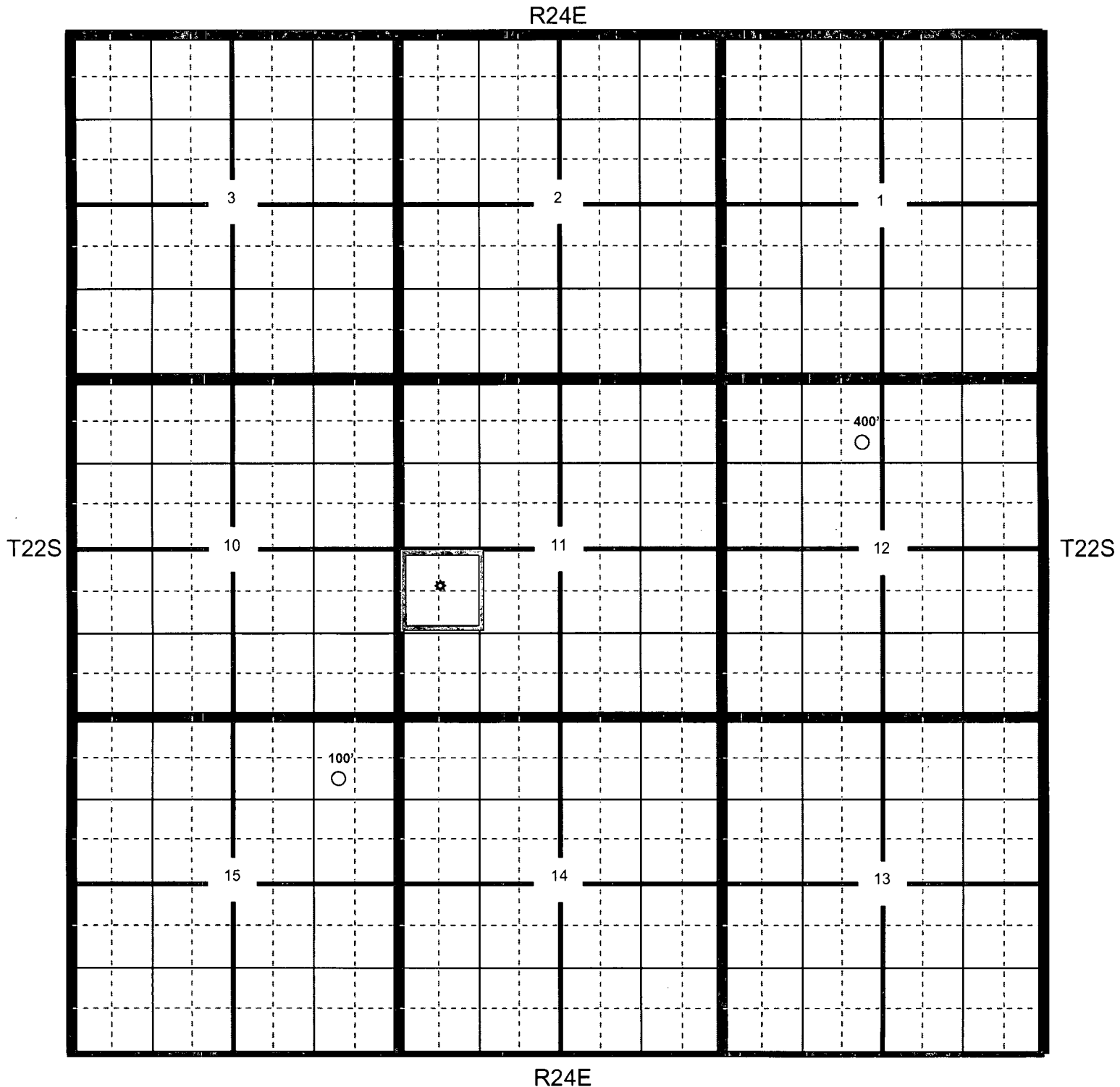

★ Location

○ OCD

○ USGS

○ SEO

● All Databases

# Oxy McKittrick 11-5

County Eddy      Unit Letter L      Section 11      Township 22S      Range 24E

Trend Map 100'

1

2

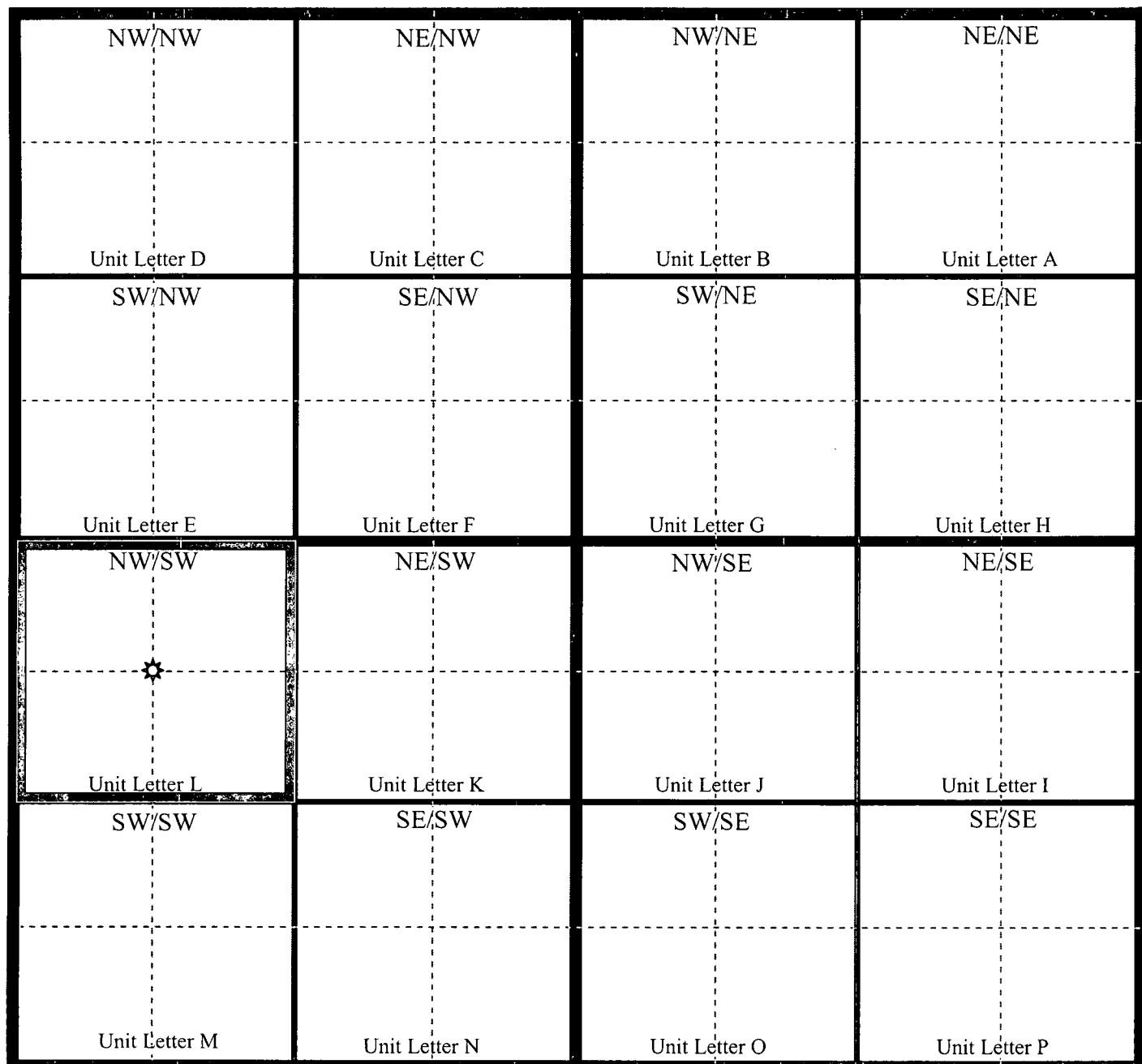

3

4



# McKittrick 11-5

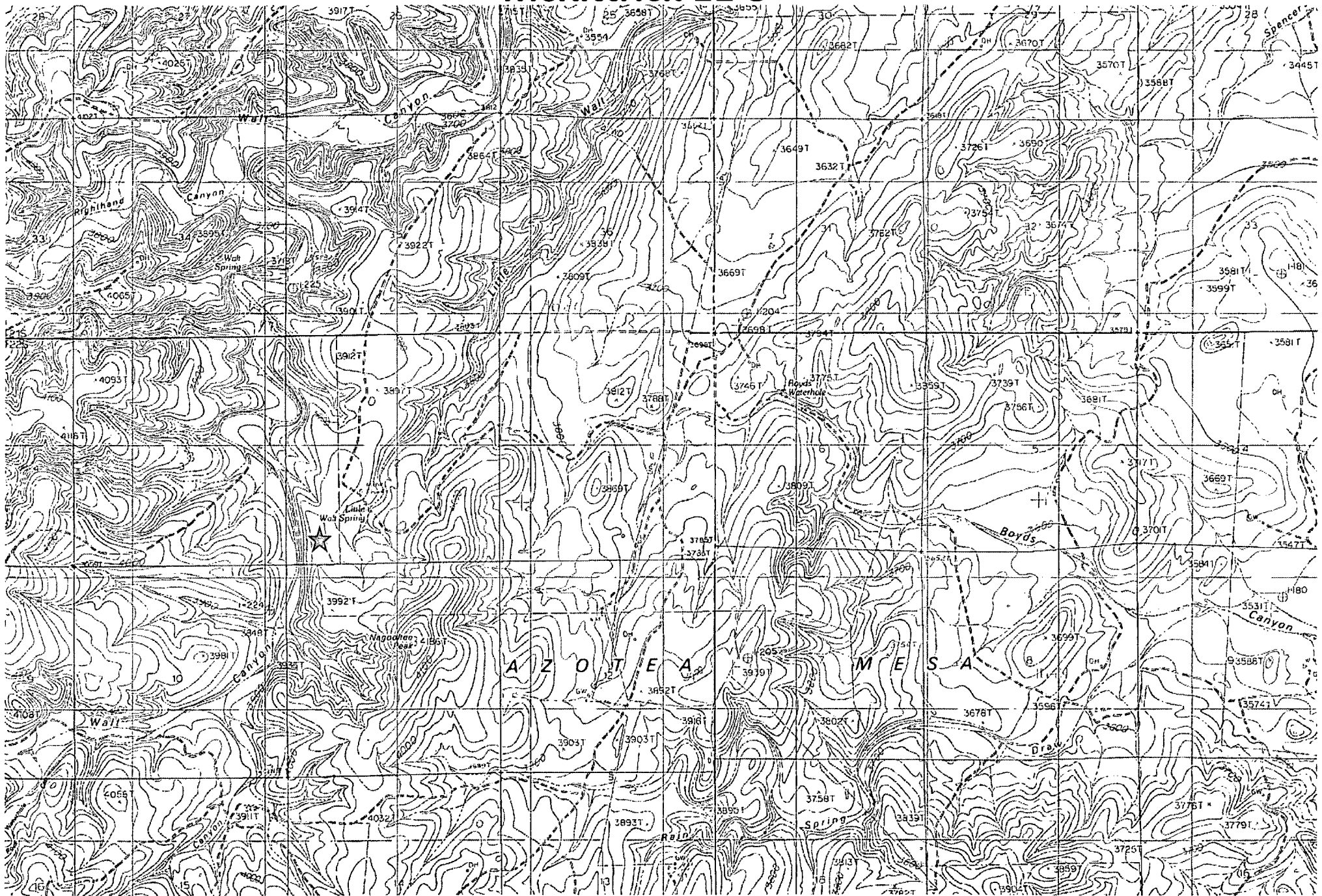



**Laboratory Analytical Results Summary**  
**OXY, McKittrick 11-5**

		Sample	SP1 @ SURFACE	SP1 @ 1'	SP2 @ SURFACE	SP2 @ 1'	SP3 @ SURFACE	SP3 @ 1'	SP4 @ SURFACE	SP5 @ SURFACE	SP5 @ 1'
Analyte	Method	Date	8/2/11	8/2/11	8/3/11	8/3/11	8/3/11	8/3/11	8/3/11	8/3/11	8/3/11
			mg/Kg	mg/Kg	mg/Kg	mg/Kg	mg/Kg	mg/Kg	mg/Kg	mg/Kg	mg/Kg
Chloride	SM4500Cl-B		832	16	1180	48	48	80	80	1150	96
GRO	TPH 8015M		N/A	<10.0	N/A	N/A	N/A	N/A	N/A	N/A	<10.0
DRO	TPH 8015M		N/A	12.3	N/A	N/A	N/A	N/A	N/A	N/A	25.5

	Confirmation Results	Sample	SP1	SP2	SP3	SP4	SP5	NSW1
Analyte	Method	Date	11/9/11	11/9/11	11/9/11	11/9/11	11/9/11	11/9/11
			mg/Kg	mg/Kg	mg/Kg	mg/Kg	mg/Kg	mg/Kg
Benzene	BTEX 8021B		<0.050	<0.050	<0.050	<0.050	<0.050	<0.050
Toluene	BTEX 8021B		<0.050	<0.050	<0.050	<0.050	<0.050	<0.050
Ethylbenzene	BTEX 8021B		<0.050	<0.050	<0.050	<0.050	<0.050	<0.050
Total Xylenes	BTEX 8021B		<0.150	<0.150	<0.150	<0.150	<0.150	<0.150
Chloride	SM4500Cl-B		304	112	528	272	272	96
GRO	TPH 8015M		<10.0	<10.0	<10.0	<10.0	<10.0	<10.0
DRO	TPH 8015M		<10.0	81.9	<10.0	<10.0	246	<10.0

August 12, 2011

Cliff Brunson

BBC International, Inc.

P.O. Box 805

Hobbs, NM 88241

RE: MCKITTRICK 11 #5

Enclosed are the results of analyses for samples received by the laboratory on 08/05/11 16:50.

Cardinal Laboratories is accredited through Texas NELAP for:

Method SW-846 8021	Benzene, Toluene, Ethyl Benzene, and Total Xylenes
Method SW-846 8260	Benzene, Toluene, Ethyl Benzene, and Total Xylenes
Method TX 1005	Total Petroleum Hydrocarbons

Certificate number T104704398-08-TX. Accreditation applies to solid and chemical materials and non-potable water matrices.

Cardinal Laboratories is accredited through the State of Colorado Department of Public Health and Environment for:

Method EPA 552.2	Haloacetic Acids (HAA-5)
Method EPA 524.2	Total Trihalomethanes (TTHM)
Method EPA 524.4	Regulated VOCs (V2, V3)

Accreditation applies to public drinking water matrices.

This report meets NELAP requirements and is made up of a cover page, analytical results, and a copy of the original chain-of-custody. If you have any questions concerning this report, please feel free to contact me.

Sincerely,

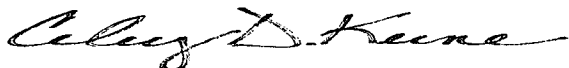

Celey D. Keene

Lab Director/Quality Manager

**Analytical Results For:**

BBC International, Inc.  
Cliff Brunson  
P.O. Box 805  
Hobbs NM, 88241  
Fax To: (505) 397-0397

Received: 08/05/2011  
Reported: 08/12/2011  
Project Name: MCKITTRICK 11 #5  
Project Number: NONE GIVEN  
Project Location: INDIAN BASIN

Sampling Date: 08/02/2011  
Sampling Type: Soil  
Sampling Condition: Cool & Intact  
Sample Received By: Jodi Henson

**Sample ID: SP 1 @ SURFACE (H101647-01)**

Chloride, SM4500CI-B		mg/kg		Analyzed By: CK					
Analyte	Result	Reporting Limit	Analyzed	Method Blank	BS	% Recovery	True Value QC	RPD	Qualifier
Chloride	832	16.0	08/08/2011	ND	432	108	400	7.14	

**Sample ID: SP 1 @ 1 FT (H101647-02)**

Chloride, SM4500CI-B		mg/kg		Analyzed By: CK					
Analyte	Result	Reporting Limit	Analyzed	Method Blank	BS	% Recovery	True Value QC	RPD	Qualifier
Chloride	16.0	16.0	08/08/2011	ND	432	108	400	7.14	
TPH 8015M		mg/kg		Analyzed By: ab					
Analyte	Result	Reporting Limit	Analyzed	Method Blank	BS	% Recovery	True Value QC	RPD	Qualifier
GRO C6-C10	<10.0	10.0	08/11/2011	ND	161	80.3	200	1.10	
DRO >C10-C28	12.3	10.0	08/11/2011	ND	148	73.9	200	1.09	

Surrogate: 1-Chlorooctane 67.6 % 70-130

Surrogate: 1-Chlorooctadecane 71.0 % 70-130

**Sample ID: SP 2 @ SURFACE (H101647-03)**

Chloride, SM4500CI-B		mg/kg		Analyzed By: CK					
Analyte	Result	Reporting Limit	Analyzed	Method Blank	BS	% Recovery	True Value QC	RPD	Qualifier
Chloride	1180	16.0	08/08/2011	ND	432	108	400	7.14	

Cardinal Laboratories

\*=Accredited Analyte

PLEASE NOTE: Liability and Damages. Cardinal's liability and client's exclusive remedy for any claim arising, whether based in contract or tort, shall be limited to the amount paid by client for analyses. All claims, including those for negligence and any other cause whatsoever shall be deemed waived unless made in writing and received by Cardinal within thirty (30) days after completion of the applicable service. In no event shall Cardinal be liable for incidental or consequential damages, including, without limitation, business interruptions, loss of use, or loss of profits incurred by client, its subsidiaries, affiliates or successors arising out of or related to the performance of the services hereunder by Cardinal, regardless of whether such claim is based upon any of the above stated reasons or otherwise. Results relate only to the samples identified above. This report shall not be reproduced except in full with written approval of Cardinal Laboratories.

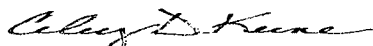

Celey D. Keene, Lab Director/Quality Manager

**Analytical Results For:**

 BBC International, Inc.  
 Cliff Brunson  
 P.O. Box 805  
 Hobbs NM, 88241  
 Fax To: (505) 397-0397

 Received: 08/05/2011  
 Reported: 08/12/2011  
 Project Name: MCKITTRICK 11 #5  
 Project Number: NONE GIVEN  
 Project Location: INDIAN BASIN

 Sampling Date: 08/03/2011  
 Sampling Type: Soil  
 Sampling Condition: Cool & Intact  
 Sample Received By: Jodi Henson

**Sample ID: SP 2 @ 1 FT (H101647-04)**

Chloride, SM4500Cl-B		mg/kg	Analyzed By: CK						
Analyte	Result	Reporting Limit	Analyzed	Method Blank	BS	% Recovery	True Value QC	RPD	Qualifier
Chloride	48.0	16.0	08/08/2011	ND	432	108	400	7.14	

**Sample ID: SP3 @ SURFACE (H101647-05)**

Chloride, SM4500Cl-B		mg/kg	Analyzed By: CK							
Analyte	Result	Reporting Limit	Analyzed	Method Blank	BS	% Recovery	True Value QC	RPD	Qualifier	
Chloride	2440	16.0	08/08/2011	ND	432	108	400	7.14		

**Sample ID: SP 3 @ 1 FT (H101647-06)**

Chloride, SM4500Cl-B		mg/kg	Analyzed By: CK						
Analyte	Result	Reporting Limit	Analyzed	Method Blank	BS	% Recovery	True Value QC	RPD	Qualifier
Chloride	80.0	16.0	08/08/2011	ND	432	108	400	7.14	

**Sample ID: SP 4 @ SURFACE (H101647-07)**

Chloride, SM4500Cl-B		mg/kg		Analyzed By: CK					
Analyte	Result	Reporting Limit	Analyzed	Method Blank	BS	% Recovery	True Value QC	RPD	Qualifier
Chloride	80.0	16.0	08/08/2011	ND	432	108	400	7.14	

**Sample ID: SP 5 @ SURFACE (H101647-08)**

Chloride, SM4500Cl-B		mg/kg	Analyzed By: CK							
Analyte	Result	Reporting Limit	Analyzed	Method Blank	BS	% Recovery	True Value QC	RPD	Qualifier	
Chloride	1150	16.0	08/08/2011	ND	432	108	400	7.14		

Cardinal Laboratories

\*=Accredited Analyte

PLEASE NOTE: Liability and Damages. Cardinal's liability and client's exclusive remedy for any claim arising, whether based in contract or tort, shall be limited to the amount paid by client for analyses. All claims, including those for negligence and any other cause whatsoever shall be deemed waived unless made in writing and received by Cardinal within thirty (30) days after completion of the applicable service. In no event shall Cardinal be liable for incidental or consequential damages, including, without limitation, business interruptions, loss of use, or loss of profits incurred by client, its subsidiaries, affiliates or successors arising out of or related to the performance of the services hereunder by Cardinal, regardless of whether such claim is based upon any of the above stated reasons or otherwise. Results relate only to the samples identified above. This report shall not be reproduced except in full with written approval of Cardinal Laboratories.

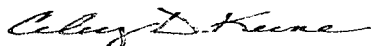

Celey D. Keene, Lab Director/Quality Manager

**Analytical Results For:**

 BBC International, Inc.  
 Cliff Brunson  
 P.O. Box 805  
 Hobbs NM, 88241  
 Fax To: (505) 397-0397

 Received: 08/05/2011  
 Reported: 08/12/2011  
 Project Name: MCKITTRICK 11 #5  
 Project Number: NONE GIVEN  
 Project Location: INDIAN BASIN

 Sampling Date: 08/03/2011  
 Sampling Type: Soil  
 Sampling Condition: Cool & Intact  
 Sample Received By: Jodi Henson

**Sample ID: SP 5 @ 1 FT (H101647-09)**

Chloride, SM4500Cl-B		mg/kg		Analyzed By: CK					
Analyte	Result	Reporting Limit	Analyzed	Method Blank	BS	% Recovery	True Value QC	RPD	Qualifier
Chloride	96.0	16.0	08/08/2011	ND	432	108	400	7.14	
TPH 8015M		mg/kg		Analyzed By: ab					
Analyte	Result	Reporting Limit	Analyzed	Method Blank	BS	% Recovery	True Value QC	RPD	Qualifier
GRO C6-C10	<10.0	10.0	08/11/2011	ND	161	80.3	200	1.10	
DRO >C10-C28	25.5	10.0	08/11/2011	ND	148	73.9	200	1.09	
Surrogate: 1-Chlorooctane	87.3 %	70-130							
Surrogate: 1-Chlorooctadecane	89.9 %	70-130							

Cardinal Laboratories

\*=Accredited Analyte

PLEASE NOTE: Liability and Damages. Cardinal's liability and client's exclusive remedy for any claim arising, whether based in contract or tort, shall be limited to the amount paid by client for analyses. All claims, including those for negligence and any other cause whatsoever shall be deemed waived unless made in writing and received by Cardinal within thirty (30) days after completion of the applicable service. In no event shall Cardinal be liable for incidental or consequential damages, including, without limitation, business interruptions, loss of use, or loss of profits incurred by client, its subsidiaries, affiliates or successors arising out of or related to the performance of the services hereunder by Cardinal, regardless of whether such claim is based upon any of the above stated reasons or otherwise. Results relate only to the samples identified above. This report shall not be reproduced except in full with written approval of Cardinal Laboratories.

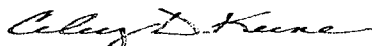

Celey D. Keene, Lab Director/Quality Manager

### Notes and Definitions

S-04	The surrogate recovery for this sample is outside of established control limits due to a sample matrix effect.
ND	Analyte NOT DETECTED at or above the reporting limit
RPD	Relative Percent Difference
**	Samples not received at proper temperature of 6°C or below.
***	Insufficient time to reach temperature.
-	Chloride by SM4500Cl-B does not require samples be received at or below 6°C Samples reported on an as received basis (wet) unless otherwise noted on report

---

Cardinal Laboratories

\*=Accredited Analyte

PLEASE NOTE: Liability and Damages. Cardinal's liability and client's exclusive remedy for any claim arising, whether based in contract or tort, shall be limited to the amount paid by client for analyses. All claims, including those for negligence and any other cause whatsoever shall be deemed waived unless made in writing and received by Cardinal within thirty (30) days after completion of the applicable service. In no event shall Cardinal be liable for incidental or consequential damages, including, without limitation, business interruptions, loss of use, or loss of profits incurred by client, its subsidiaries, affiliates or successors arising out of or related to the performance of the services hereunder by Cardinal, regardless of whether such claim is based upon any of the above stated reasons or otherwise. Results relate only to the samples identified above. This report shall not be reproduced except in full with written approval of Cardinal Laboratories.

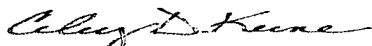

---

Celey D. Keene, Lab Director/Quality Manager



101 East Marland, Hobbs, NM 88240

(505) 393-2326 FAX (505) 393-2476

## CHAIN-OF-CUSTODY AND ANALYSIS REQUEST

PLEASE NOTE: Liability and Damages. Cardinal's liability and client's exclusive remedy for any claim arising whether based in contract or tort, shall be limited to the amount paid by the client for the analyses. All claims including those for negligence and any other cause whatsoever shall be deemed waived unless made in writing and received by Cardinal within 30 days after completion of the applicable service. In no event shall Cardinal be liable for incidental or consequential damages, including without limitation, business interruptions, loss of use, or loss of profits incurred by client, its subsidiaries, affiliates or successors arising out of or related to the performance of services hereunder by Cardinal, regardless of whether such claim is based upon any of the above stated reasons or otherwise.

Relinquished By: <i>[Signature]</i>	Date: 8.5.11 Time:	Received By: <i>[Signature]</i>	Phone Result: <input type="checkbox"/> Yes <input type="checkbox"/> No Add'l Phone #:
Relinquished By:	Date: Time:	Received By:	Fax Result: <input type="checkbox"/> Yes <input type="checkbox"/> No Add'l Fax #:
Delivered By: (Circle One) Sampler - UPS - Bus - Other:		Sample Condition Cool Intact <input type="checkbox"/> Yes <input checked="" type="checkbox"/> No <input type="checkbox"/> Yes <input type="checkbox"/> No	CHECKED BY: (Initials) <i>[Signature]</i>

† Cardinal cannot accept verbal changes. Please fax written changes to 505-393-2476

Page 6 of 6

November 14, 2011

Cliff Brunson

BBC International, Inc.

P.O. Box 805

Hobbs, NM 88241

RE: MCKITTRICK 11 #5

Enclosed are the results of analyses for samples received by the laboratory on 11/10/11 10:34.

Cardinal Laboratories is accredited through Texas NELAP for:

Method SW-846 8021	Benzene, Toluene, Ethyl Benzene, and Total Xylenes
Method SW-846 8260	Benzene, Toluene, Ethyl Benzene, and Total Xylenes
Method TX 1005	Total Petroleum Hydrocarbons

Certificate number T104704398-08-TX. Accreditation applies to solid and chemical materials and non-potable water matrices.

Cardinal Laboratories is accredited through the State of Colorado Department of Public Health and Environment for:

Method EPA 552.2	Haloacetic Acids (HAA-5)
Method EPA 524.2	Total Trihalomethanes (TTHM)
Method EPA 524.4	Regulated VOCs (V2, V3)

Accreditation applies to public drinking water matrices.

This report meets NELAP requirements and is made up of a cover page, analytical results, and a copy of the original chain-of-custody. If you have any questions concerning this report, please feel free to contact me.

Sincerely,

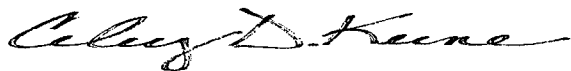

Celey D. Keene

Lab Director/Quality Manager



**Analytical Results For:**

 BBC International, Inc.  
 Cliff Brunson  
 P.O. Box 805  
 Hobbs NM, 88241  
 Fax To: (505) 397-0397

 Received: 11/10/2011  
 Reported: 11/14/2011  
 Project Name: MCKITTRICK 11 #5  
 Project Number: NONE GIVEN  
 Project Location: INDIAN BASIN

 Sampling Date: 11/09/2011  
 Sampling Type: Soil  
 Sampling Condition: Cool & Intact  
 Sample Received By: Jodi Henson

**Sample ID: SP 1 (H102440-01)**

BTEx 8021B		mg/kg		Analyzed By: MS						
Analyte	Result	Reporting Limit	Analyzed	Method Blank	BS	% Recovery	True Value QC	RPD	Qualifier	
Benzene*	<0.050	0.050	11/11/2011	ND	2.02	101	2.00	2.54		
Toluene*	<0.050	0.050	11/11/2011	ND	2.02	101	2.00	4.88		
Ethylbenzene*	<0.050	0.050	11/11/2011	ND	2.24	112	2.00	2.22		
Total Xylenes*	<0.150	0.150	11/11/2011	ND	6.45	108	6.00	1.97		

Surrogate: 4-Bromofluorobenzene (PIE) 99.2 % 70.7-118

Chloride, SM4500Cl-B		mg/kg		Analyzed By: AP						
Analyte	Result	Reporting Limit	Analyzed	Method Blank	BS	% Recovery	True Value QC	RPD	Qualifier	
Chloride	304	16.0	11/14/2011	ND	464	116	400	7.14		

TPH 8015M		mg/kg		Analyzed By: ZZZ					
Analyte	Result	Reporting Limit	Analyzed	Method Blank	BS	% Recovery	True Value QC	RPD	Qualifier
GRO C6-C10	<10.0	10.0	11/11/2011	ND	183	91.6	200	7.83	
DRO >C10-C28	<10.0	10.0	11/11/2011	ND	185	92.4	200	12.2	

Surrogate: 1-Chlorooctane 88.4 % 55.5-154

Surrogate: 1-Chlorooctadecane 107 % 57.6-158

Cardinal Laboratories

\*=Accredited Analyte

PLEASE NOTE: Liability and Damages. Cardinal's liability and client's exclusive remedy for any claim arising, whether based in contract or tort, shall be limited to the amount paid by client for analyses. All claims, including those for negligence and any other cause whatsoever shall be deemed waived unless made in writing and received by Cardinal within thirty (30) days after completion of the applicable service. In no event shall Cardinal be liable for incidental or consequential damages, including, without limitation, business interruptions, loss of use, or loss of profits incurred by client, its subsidiaries, affiliates or successors arising out of or related to the performance of the services hereunder by Cardinal, regardless of whether such claim is based upon any of the above stated reasons or otherwise. Results relate only to the samples identified above. This report shall not be reproduced except in full with written approval of Cardinal Laboratories.

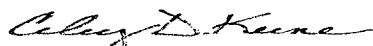

Celey D. Keene, Lab Director/Quality Manager

**Analytical Results For:**

 BBC International, Inc.  
 Cliff Brunson  
 P.O. Box 805  
 Hobbs NM, 88241  
 Fax To: (505) 397-0397

 Received: 11/10/2011  
 Reported: 11/14/2011  
 Project Name: MCKITTRICK 11 #5  
 Project Number: NONE GIVEN  
 Project Location: INDIAN BASIN

 Sampling Date: 11/09/2011  
 Sampling Type: Soil  
 Sampling Condition: Cool & Intact  
 Sample Received By: Jodi Henson

**Sample ID: SP 2 (H102440-02)**

BTEX 8021B			mg/kg		Analyzed By: MS					
Analyte	Result	Reporting Limit	Analyzed	Method Blank	BS	% Recovery	True Value QC	RPD	Qualifier	
Benzene*	<0.050	0.050	11/11/2011	ND	2.02	101	2.00	2.54		
Toluene*	<0.050	0.050	11/11/2011	ND	2.02	101	2.00	4.88		
Ethylbenzene*	<0.050	0.050	11/11/2011	ND	2.24	112	2.00	2.22		
Total Xylenes*	<0.150	0.150	11/11/2011	ND	6.45	108	6.00	1.97		

Surrogate: 4-Bromofluorobenzene (PIL) 98.5 % 70.7-118

Chloride, SM4500Cl-B			mg/kg		Analyzed By: AP					
Analyte	Result	Reporting Limit	Analyzed	Method Blank	BS	% Recovery	True Value QC	RPD	Qualifier	
Chloride	112	16.0	11/14/2011	ND	464	116	400	7.14		

TPH 8015M		mg/kg		Analyzed By: ZZZ					
Analyte	Result	Reporting Limit	Analyzed	Method Blank	BS	% Recovery	True Value QC	RPD	Qualifier
GRO C6-C10	<10.0	10.0	11/11/2011	ND	183	91.6	200	7.83	
DRO >C10-C28	81.9	10.0	11/11/2011	ND	185	92.4	200	12.2	

Surrogate: 1-Chlorooctane 72.2 % 55.5-154

Surrogate: 1-Chlorooctadecane 84.2 % 57.6-158

Cardinal Laboratories

\*=Accredited Analyte

PLEASE NOTE: Liability and Damages. Cardinal's liability and client's exclusive remedy for any claim arising, whether based in contract or tort, shall be limited to the amount paid by client for analyses. All claims, including those for negligence and any other cause whatsoever shall be deemed waived unless made in writing and received by Cardinal within thirty (30) days after completion of the applicable service. In no event shall Cardinal be liable for incidental or consequential damages, including, without limitation, business interruptions, loss of use, or loss of profits incurred by client, its subsidiaries, affiliates or successors arising out of or related to the performance of the services hereunder by Cardinal, regardless of whether such claim is based upon any of the above stated reasons or otherwise. Results relate only to the samples identified above. This report shall not be reproduced except in full with written approval of Cardinal Laboratories.

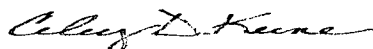

Celey D. Keene, Lab Director/Quality Manager

**Analytical Results For:**

 BBC International, Inc.  
 Cliff Brunson  
 P.O. Box 805  
 Hobbs NM, 88241  
 Fax To: (505) 397-0397

 Received: 11/10/2011  
 Reported: 11/14/2011  
 Project Name: MCKITTRICK 11 #5  
 Project Number: NONE GIVEN  
 Project Location: INDIAN BASIN

 Sampling Date: 11/09/2011  
 Sampling Type: Soil  
 Sampling Condition: Cool & Intact  
 Sample Received By: Jodi Henson

**Sample ID: SP 3 (H102440-03)**

BTEX 8021B		mg/kg		Analyzed By: MS						
Analyte	Result	Reporting Limit	Analyzed	Method Blank	BS	% Recovery	True Value QC	RPD	Qualifier	
Benzene*	<0.050	0.050	11/11/2011	ND	2.02	101	2.00	2.54		
Toluene*	<0.050	0.050	11/11/2011	ND	2.02	101	2.00	4.88		
Ethylbenzene*	<0.050	0.050	11/11/2011	ND	2.24	112	2.00	2.22		
Total Xylenes*	<0.150	0.150	11/11/2011	ND	6.45	108	6.00	1.97		

Surrogate: 4-Bromofluorobenzene (PIL) 98.5 % 70.7-118

Chloride, SM4500Cl-B		mg/kg		Analyzed By: AP					
Analyte	Result	Reporting Limit	Analyzed	Method Blank	BS	% Recovery	True Value QC	RPD	Qualifier
Chloride	528	16.0	11/14/2011	ND	464	116	400	7.14	

TPH 8015M		mg/kg		Analyzed By: ZZZ						
Analyte	Result	Reporting Limit	Analyzed	Method Blank	BS	% Recovery	True Value QC	RPD	Qualifier	
GRO C6-C10	<10.0	10.0	11/11/2011	ND	183	91.6	200	7.83		
DRO >C10-C28	<10.0	10.0	11/11/2011	ND	185	92.4	200	12.2		

Surrogate: 1-Chlorooctane 88.3 % 55.5-154

Surrogate: 1-Chlorooctadecane 107 % 57.6-158

Cardinal Laboratories

\*=Accredited Analyte

PLEASE NOTE: Liability and Damages. Cardinal's liability and client's exclusive remedy for any claim arising, whether based in contract or tort, shall be limited to the amount paid by client for analyses. All claims, including those for negligence and any other cause whatsoever shall be deemed waived unless made in writing and received by Cardinal within thirty (30) days after completion of the applicable service. In no event shall Cardinal be liable for incidental or consequential damages, including, without limitation, business interruptions, loss of use, or loss of profits incurred by client, its subsidiaries, affiliates or successors arising out of or related to the performance of the services hereunder by Cardinal, regardless of whether such claim is based upon any of the above stated reasons or otherwise. Results relate only to the samples identified above. This report shall not be reproduced except in full with written approval of Cardinal Laboratories.



Celey D. Keene, Lab Director/Quality Manager

**Analytical Results For:**

 BBC International, Inc.  
 Cliff Brunson  
 P.O. Box 805  
 Hobbs NM, 88241  
 Fax To: (505) 397-0397

 Received: 11/10/2011  
 Reported: 11/14/2011  
 Project Name: MCKITTRICK 11 #5  
 Project Number: NONE GIVEN  
 Project Location: INDIAN BASIN

 Sampling Date: 11/09/2011  
 Sampling Type: Soil  
 Sampling Condition: Cool & Intact  
 Sample Received By: Jodi Henson

**Sample ID: SP 4 (H102440-04)**

BTEX 8021B			mg/kg		Analyzed By: MS				
Analyte	Result	Reporting Limit	Analyzed	Method Blank	BS	% Recovery	True Value QC	RPD	Qualifier
Benzene*	<0.050	0.050	11/11/2011	ND	2.02	101	2.00	2.54	
Toluene*	<0.050	0.050	11/11/2011	ND	2.02	101	2.00	4.88	
Ethylbenzene*	<0.050	0.050	11/11/2011	ND	2.24	112	2.00	2.22	
Total Xylenes*	<0.150	0.150	11/11/2011	ND	6.45	108	6.00	1.97	

Surrogate: 4-Bromofluorobenzene (PIL) 99.0 % 70.7-118

Chloride, SM4500Cl-B			mg/kg		Analyzed By: AP				
Analyte	Result	Reporting Limit	Analyzed	Method Blank	BS	% Recovery	True Value QC	RPD	Qualifier
Chloride	272	16.0	11/14/2011	ND	464	116	400	7.14	

TPH 8015M			mg/kg		Analyzed By: ZZZ				
Analyte	Result	Reporting Limit	Analyzed	Method Blank	BS	% Recovery	True Value QC	RPD	Qualifier
GRO C6-C10	<10.0	10.0	11/11/2011	ND	183	91.6	200	7.83	
DRO >C10-C28	<10.0	10.0	11/11/2011	ND	185	92.4	200	12.2	

Surrogate: 1-Chlorooctane 101 % 55.5-154

Surrogate: 1-Chlorooctadecane 122 % 57.6-158

Cardinal Laboratories

\*=Accredited Analyte

PLEASE NOTE: Liability and Damages. Cardinal's liability and client's exclusive remedy for any claim arising, whether based in contract or tort, shall be limited to the amount paid by client for analyses. All claims, including those for negligence and any other cause whatsoever shall be deemed waived unless made in writing and received by Cardinal within thirty (30) days after completion of the applicable service. In no event shall Cardinal be liable for incidental or consequential damages, including, without limitation, business interruptions, loss of use, or loss of profits incurred by client, its subsidiaries, affiliates or successors arising out of or related to the performance of the services hereunder by Cardinal, regardless of whether such claim is based upon any of the above stated reasons or otherwise. Results relate only to the samples identified above. This report shall not be reproduced except in full with written approval of Cardinal Laboratories.



Celey D. Keene, Lab Director/Quality Manager

**Analytical Results For:**

BBC International, Inc.  
Cliff Brunson  
P.O. Box 805  
Hobbs NM, 88241  
Fax To: (505) 397-0397

Received: 11/10/2011  
Reported: 11/14/2011  
Project Name: MCKITTRICK 11 #5  
Project Number: NONE GIVEN  
Project Location: INDIAN BASIN

Sampling Date: 11/09/2011  
Sampling Type: Soil  
Sampling Condition: Cool & Intact  
Sample Received By: Jodi Henson

**Sample ID: SP 5 (H102440-05)**

BTEX 8021B		mg/kg		Analyzed By: MS						
Analyte	Result	Reporting Limit	Analyzed	Method Blank	BS	% Recovery	True Value QC	RPD	Qualifier	
Benzene*	<0.050	0.050	11/11/2011	ND	2.02	101	2.00	2.54		
Toluene*	<0.050	0.050	11/11/2011	ND	2.02	101	2.00	4.88		
Ethylbenzene*	<0.050	0.050	11/11/2011	ND	2.24	112	2.00	2.22		
Total Xylenes*	<0.150	0.150	11/11/2011	ND	6.45	108	6.00	1.97		

Surrogate: 4-Bromofluorobenzene (PIL) 98.6 % 70.7-118

Chloride, SM4500Cl-B		mg/kg		Analyzed By: AP					
Analyte	Result	Reporting Limit	Analyzed	Method Blank	BS	% Recovery	True Value QC	RPD	Qualifier
Chloride	272	16.0	11/14/2011	ND	464	116	400	7.14	
TPH 8015M	mg/kg		Analyzed By: ZZZ						

TPH 8015M		mg/kg		Analyzed By: ZZZ					
Analyte	Result	Reporting Limit	Analyzed	Method Blank	BS	% Recovery	True Value QC	RPD	Qualifier
GRO C6-C10	<10.0	10.0	11/11/2011	ND	183	91.6	200	7.83	
DRO >C10-C28	246	10.0	11/11/2011	ND	185	92.4	200	12.2	

Surrogate: 1-Chlorooctane 83.5 % 55.5-154

Surrogate: 1-Chlorooctadecane 109 % 57.6-158

Cardinal Laboratories

\*=Accredited Analyte

PLEASE NOTE: Liability and Damages. Cardinal's liability and client's exclusive remedy for any claim arising, whether based in contract or tort, shall be limited to the amount paid by client for analyses. All claims, including those for negligence and any other cause whatsoever shall be deemed waived unless made in writing and received by Cardinal within thirty (30) days after completion of the applicable service. In no event shall Cardinal be liable for incidental or consequential damages, including, without limitation, business interruptions, loss of use, or loss of profits incurred by client, its subsidiaries, affiliates or successors arising out of or related to the performance of the services hereunder by Cardinal, regardless of whether such claim is based upon any of the above stated reasons or otherwise. Results relate only to the samples identified above. This report shall not be reproduced except in full with written approval of Cardinal Laboratories.

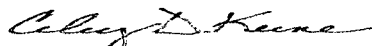

Celey D. Keene, Lab Director/Quality Manager

**Analytical Results For:**

BBC International, Inc.  
Cliff Brunson  
P.O. Box 805  
Hobbs NM, 88241  
Fax To: (505) 397-0397

Received: 11/10/2011  
Reported: 11/14/2011  
Project Name: MCKITTRICK 11 #5  
Project Number: NONE GIVEN  
Project Location: INDIAN BASIN

Sampling Date: 11/09/2011  
Sampling Type: Soil  
Sampling Condition: Cool & Intact  
Sample Received By: Jodi Henson

**Sample ID: NSW 1 (H102440-06)**

BTEx 8021B		mg/kg		Analyzed By: MS						
Analyte	Result	Reporting Limit	Analyzed	Method Blank	BS	% Recovery	True Value QC	RPD	Qualifier	
Benzene*	<0.050	0.050	11/11/2011	ND	2.02	101	2.00	2.54		
Toluene*	<0.050	0.050	11/11/2011	ND	2.02	101	2.00	4.88		
Ethylbenzene*	<0.050	0.050	11/11/2011	ND	2.24	112	2.00	2.22		
Total Xylenes*	<0.150	0.150	11/11/2011	ND	6.45	108	6.00	1.97		

Surrogate: 4-Bromofluorobenzene (PIL) 96.5 % 70.7-118

Chloride, SM4500Cl-B		mg/kg		Analyzed By: AP					
Analyte	Result	Reporting Limit	Analyzed	Method Blank	BS	% Recovery	True Value QC	RPD	Qualifier
Chloride	96.0	16.0	11/14/2011	ND	464	116	400	7.14	
TPH 8015M		mg/kg		Analyzed By: ZZZ					

TPH 8015M		mg/kg		Analyzed By: ZZZ					
Analyte	Result	Reporting Limit	Analyzed	Method Blank	BS	% Recovery	True Value QC	RPD	Qualifier
GRO C6-C10	<10.0	10.0	11/12/2011	ND	183	91.6	200	7.83	
DRO >C10-C28	<10.0	10.0	11/12/2011	ND	185	92.4	200	12.2	

Surrogate: 1-Chlorooctane 73.8 % 55.5-154

Surrogate: 1-Chlorooctadecane 99.9 % 57.6-158

Cardinal Laboratories

\*=Accredited Analyte

PLEASE NOTE: Liability and Damages. Cardinal's liability and client's exclusive remedy for any claim arising, whether based in contract or tort, shall be limited to the amount paid by client for analyses. All claims, including those for negligence and any other cause whatsoever shall be deemed waived unless made in writing and received by Cardinal within thirty (30) days after completion of the applicable service. In no event shall Cardinal be liable for incidental or consequential damages, including, without limitation, business interruptions, loss of use, or loss of profits incurred by client, its subsidiaries, affiliates or successors arising out of or related to the performance of the services hereunder by Cardinal, regardless of whether such claim is based upon any of the above stated reasons or otherwise. Results relate only to the samples identified above. This report shall not be reproduced except in full with written approval of Cardinal Laboratories.



Celey D. Keene, Lab Director/Quality Manager

**Notes and Definitions**

ND	Analyte NOT DETECTED at or above the reporting limit
RPD	Relative Percent Difference
**	Samples not received at proper temperature of 6°C or below.
***	Insufficient time to reach temperature.
-	Chloride by SM4500Cl-B does not require samples be received at or below 6°C Samples reported on an as received basis (wet) unless otherwise noted on report

---

Cardinal Laboratories

\*=Accredited Analyte

PLEASE NOTE: Liability and Damages. Cardinal's liability and client's exclusive remedy for any claim arising, whether based in contract or tort, shall be limited to the amount paid by client for analyses. All claims, including those for negligence and any other cause whatsoever shall be deemed waived unless made in writing and received by Cardinal within thirty (30) days after completion of the applicable service. In no event shall Cardinal be liable for incidental or consequential damages, including, without limitation, business interruptions, loss of use, or loss of profits incurred by client, its subsidiaries, affiliates or successors arising out of or related to the performance of the services hereunder by Cardinal, regardless of whether such claim is based upon any of the above stated reasons or otherwise. Results relate only to the samples identified above. This report shall not be reproduced except in full with written approval of Cardinal Laboratories.

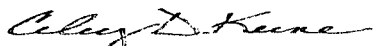

---

Celest D. Keene, Lab Director/Quality Manager

## CHAIN-OF-CUSTODY AND ANALYSIS REQUEST

101 East Marland, Hobbs, NM 88240  
(575) 393-2326 FAX (575) 393-2476

Company Name: <b>BRC INTERNATIONAL</b>				<b>BILL TO</b>				<b>ANALYSIS REQUEST</b>																	
Project Manager: <b>Cliff Brinson</b>				P.O. #:																					
Address:				Company:																					
City: State: <b>NM</b> Zip: <b>88240</b>				Attn:																					
Phone #: Fax #: <b>(575) 397-0397</b>				Address: <b>SAME</b>																					
Project #: Project Owner: <b>OKY</b>				City:																					
Project Name: <b>McKITTICK 11 #5</b>				State: Zip:																					
Project Location: <b>Carlsbad NM</b>				Phone #:																					
Sampler Name: <b>ROGER HERNANDEZ</b>				Fax #:																					
FOR LAB USE ONLY						MATRIX		PRESERV.		SAMPLING															
Lab I.D.	Sample I.D.	(G)RAB OR (C)OMP.	# CONTAINERS	GROUNDWATER	WASTEWATER	SOIL	SLUDGE	OTHER	ACID/BASE	ICE / COOL	OTHER	DATE	TIME												
<b>H102440</b>																									
1	SP 1	G	1	/	/	/	/	/	/	/	/	11.9.11	1100	<b>TPH</b>	<b>BTEX</b>	<b>CL-</b>									
2	SP 2	G	1	/	/	/	/	/	/	/	/	11.9.11	1050	/	/	/									
3	SP 3	G	1	/	/	/	/	/	/	/	/	11.9.11	1045	/	/	/									
4	SP 4	G	1	/	/	/	/	/	/	/	/	11.9.11	1040	/	/	/									
5	SP 5	G	1	/	/	/	/	/	/	/	/	11.9.11	1035	/	/	/									
6	NSW1	G	1	/	/	/	/	/	/	/	/	11.9.11	1030	/	/	/									

PLEASE NOTE: Liability and Damages. Cardinal's liability and client's exclusive remedy for any claim arising whether based in contract or tort, shall be limited to the amount paid by the client for the analyses. All claims including those for negligence and any other cause whatsoever shall be deemed waived unless made in writing and received by Cardinal within 30 days after completion of the applicable service. In no event shall Cardinal be liable for incidental or consequential damages, including without limitation, business interruptions, loss of use, or loss of profits incurred by client, its subsidiaries, affiliates or successors arising out of or related to the performance of service hereunder by Cardinal, regardless of whether such claim is based upon any of the above stated reasons or otherwise.

Relinquished By: <b>Roger Hernandez</b>	Date: <b>11-10-11</b> Time: <b>8:00</b>	Received By: <b>Cliff Brinson</b>	Phone Result: <input type="checkbox"/> Yes <input type="checkbox"/> No	Add'l Phone #:
Relinquished By:	Date:	Received By:	Fax Result: <input type="checkbox"/> Yes <input type="checkbox"/> No	Add'l Fax #:
Delivered By: (Circle One) Sampler - UPS - Bus - Other:			REMARKS:	
Sample Condition: Cool <input checked="" type="checkbox"/> Intact <input checked="" type="checkbox"/> Yes <input checked="" type="checkbox"/> No <input checked="" type="checkbox"/>		CHECKED BY: (Initials) <b>CB</b>		



## Kathy Purvis

---

**From:** Cliff P. Brunson <cbrunson@bbcinternational.com>  
**Sent:** Thursday, October 13, 2011 12:30 PM  
**To:** James Amos; Terry Gregston  
**Cc:** Dusty Wilson; C J Summers; Ken Swinney; Jennifer Gilkey; Kathy Purvis  
**Subject:** FW: Oxy-McKittrick 11-5  
**Attachments:** Remediation Packet- Oxy- McKittrick 11-5.pdf

Jim/Terry,

On behalf of Oxy, BBC would like to present the following remediation plan for the Oxy McKittrick 11-5 site. Oxy is proposing to excavate and remove 6 inches to 1 foot of impacted soil in the spill area as depicted on the attached site diagram. Oxy has already received the approval from the NMOCD as can be seen below. I have attached the site diagram, lab summary tables, and the lab data sheets for your review.

Oxy is asking for an approval from the BLM for this remediation plan so Oxy can move forward in remediating this site. If you could please respond back with your approval, it would be greatly appreciated. If you have any questions, please let us know.

Thank you for your time.

Sincerely,

Cliff Brunson

Cliff Brunson, CEI, CRS  
President  
BBC International, Inc.  
World-Wide Environmental Specialists  
Mailing Address:  
P. O. Box 805  
Hobbs, NM 88241-0805 USA  
Shipping Address:  
1324 W. Marland St.  
Hobbs, NM 88240 USA  
Phone: (575) 397-6388  
Fax: (575) 397-0397  
E-Mail: [cbrunson@bbcinternational.com](mailto:cbrunson@bbcinternational.com)

\*\*\*\*\*

Confidentiality Notice: This electronic transmission (and any attached documents) is intended only for the person(s) to whom it is addressed and may contain information that is privileged, confidential, or otherwise protected from disclosure. If you have received this transmission in error, please immediately notify the sender by e-mail or by telephone call to (575) 397-6388 for handling instructions. Any disclosure or distribution of the contents of this transmission by anyone other than the named recipient(s) is strictly prohibited.

\*\*\*\*\*

---

**From:** Mike Bratcher <[Mike.Bratcher@state.nm.us](mailto:Mike.Bratcher@state.nm.us)>  
**Date:** Fri, 26 Aug 2011 22:01:46 +0000  
**To:** Cliff Brunson <[cbrunson@bbcinternational.com](mailto:cbrunson@bbcinternational.com)>  
**Cc:** Dusty Wilson <[Dusty\\_Wilson@oxy.com](mailto:Dusty_Wilson@oxy.com)>, Ken Swinney <[kswinney@bbcinternational.com](mailto:kswinney@bbcinternational.com)>, Jennifer Gilkey <[jgilkey@bbcinternational.com](mailto:jgilkey@bbcinternational.com)>  
**Subject:** RE: Oxy-McKittrick 11-5

Reference: OXY USA \* McKittrick 11 Fed 005 \* 30-015-33611 \* L-11-22s-24e \* Eddy County, New Mexico

Cliff,

As discussed, the remediation proposal submitted for cleanup of the above referenced produced fluid release is approved with the following conditions/stipulations:

- Notify OCD District 2 office 48 hours prior to commencement of remedial activities.
- Notify OCD District 2 office 48 hours prior to obtaining samples, where the analyses will be submitted to OCD.
- Submit a Form C-141 Final Report and closure report upon satisfactory completion of project.
- Project is to be completed and closure documentation submitted to OCD not later than October 26, 2011.
- Like approval by BLM or any other regulatory authority as may be applicable.

Be advised, OCD approval does not relieve the operator of liability should their operations have failed to adequately investigate and remediate contamination that may pose a threat to ground water, surface water, human health or the environment. In addition, OCD approval does not relieve the operator of responsibility for compliance with any other federal, state, local laws and/or regulations.

If you have any questions or concerns, and for notifications, please contact me.

***Mike Bratcher***

NMOCD District 2  
811 S. First Street  
Artesia, NM 88210  
575-748-1283 Ext. 108  
575-626-0857  
[mike.bratcher@state.nm.us](mailto:mike.bratcher@state.nm.us)

---

**From:** Cliff P. Brunson [<mailto:cbrunson@bbcinternational.com>]  
**Sent:** Friday, August 26, 2011 9:13 AM  
**To:** Bratcher, Mike, EMNRD  
**Cc:** Dusty Wilson; Ken Swinney; Jennifer Gilkey  
**Subject:** Oxy-McKittrick 11-5

Mike,

This e-mail is to confirm our conversation of August 25, 2011 concerning the remediation plan for the Oxy McKittrick 11-5. As discussed, Oxy will remove 6 inches to 1 foot of impacted soil in the spill area as depicted in the attached map. The site will then be backfilled with clean soil. I have attached the map and lab data that we discussed for your files.

If you would please reply back with your concurrence on this path forward, it would be greatly appreciated.

Thank you for your time.

Cliff

Cliff Brunson, CEI, CRS  
President  
BBC International, Inc.  
World-Wide Environmental Specialists

Mailing Address:  
P. O. Box 805  
Hobbs, NM 88241-0805 USA  
Shipping Address:  
1324 W. Marland St.  
Hobbs, NM 88240 USA  
Phone: (575) 397-6388  
Fax: (575) 397-0397  
E-Mail: [cbrunson@bbcinternational.com](mailto:cbrunson@bbcinternational.com)

\*\*\*\*\*

Confidentiality Notice: This electronic transmission (and any attached documents) is intended only for the person(s) to whom it is addressed and may contain information that is privileged, confidential, or otherwise protected from disclosure. If you have received this transmission in error, please immediately notify the sender by e-mail or by telephone call to (575) 397-6388 for handling instructions. Any disclosure or distribution of the contents of this transmission by anyone other than the named recipient(s) is strictly prohibited.

\*\*\*\*\*

## Kathy Purvis

---

**From:** Gregston, Terry G <tgregsto@blm.gov>  
**Sent:** Thursday, November 17, 2011 12:08 PM  
**To:** Cliff P. Brunson  
**Cc:** Amos, James A; Dusty Wilson; C J Summers; Ken Swinney; Jennifer Gilkey; Kathy Purvis  
**Subject:** RE: Oxy McKittrick 11-5 - Confirmation sampling data

Mr. Brunson,

Lab results look great. Oxy has approval to close the excavation.

Thank you for your assistance in this matter,

**Terry Gregston**  
Environmental Protection Specialist  
Bureau of Land Management  
620 E. Greene St.  
Carlsbad, NM 88220  
Office (575) 234-5958  
Cell (575) 361-2635  
Fax (575) 234-5927

**Confidentiality Warning:** This message along with any attachments are intended only for use of the individual or entity to which it is addressed and may contain information that is privileged or confidential and exempt from disclosure under applicable law. If the reader of this message is not the intended recipient or the employee or agent responsible for delivering this message to the intended recipient, you are hereby notified that any dissemination, distribution, or copying of this communication is strictly prohibited. If you have received this communication in error, please notify the sender immediately.

---

**From:** Cliff P. Brunson [<mailto:cbrunson@bbcinternational.com>]  
**Sent:** Wednesday, November 16, 2011 7:09 PM  
**To:** Gregston, Terry G  
**Cc:** Amos, James A; Dusty Wilson; C J Summers; Ken Swinney; Jennifer Gilkey; Kathy Purvis  
**Subject:** Oxy McKittrick 11-5 - Confirmation sampling data

Terry,

I have attached a summary table and the lab data for your review of the confirmation sampling conducted on the Oxy McKittrick 11-5 on November 9, 2011. This sampling was conducted per the BLM stipulations in the remediation approval from the BLM. As you will see, the results are very good.

Therefore, Oxy is requesting approval to backfill the site will clean soil. If you would please review and respond back to me as soon as possible with the approval, it would be greatly appreciated so we could schedule this site to be backfilled and completed.

Thank you,

Cliff Brunson

Cliff Brunson, CEI, CRS  
President  
BBC International, Inc.  
World-Wide Environmental Specialists  
Mailing Address:  
P. O. Box 805  
Hobbs, NM 88241-0805 USA  
Shipping Address:  
1324 W. Marland St.  
Hobbs, NM 88240 USA  
Phone: (575) 397-6388  
Fax: (575) 397-0397  
E-Mail: [cbrunson@bbcinternational.com](mailto:cbrunson@bbcinternational.com)

\*\*\*\*\*

Confidentiality Notice: This electronic transmission (and any attached documents) is intended only for the person(s) to whom it is addressed and may contain information that is privileged, confidential, or otherwise protected from disclosure. If you have received this transmission in error, please immediately notify the sender by e-mail or by telephone call to (575) 397-6388 for handling instructions. Any disclosure or distribution of the contents of this transmission by anyone other than the named recipient(s) is strictly prohibited.

\*\*\*\*\*