

March 8, 2013

Mr. Mike Bratcher
NMOCD District 2
811 S. 1st Street
Artesia, NM 88210

AMARILLO
921 North Bivins
Amarillo, Texas 79107
Phone 806.467.0607
Fax 806.467.0622

ARTESIA
408 West Texas Ave.
Artesia, New Mexico 88210
Phone 575.746.8768
Fax 575.746.8905

AUSTIN
911 West Anderson Lane
Suite 202
Austin, Texas 78757
Phone 512.989.3428
Fax 512.989.3487

HOBBS
318 East Taylor Street
Hobbs, New Mexico 88240
Phone 575.393.4261
Fax 575.393.4658

MIDLAND
2901 State Hwy 349
Midland, Texas 79706
Phone 432.522.2133
Fax 432.522.2180

SAN ANTONIO
11 Commercial Place
Schertz, Texas 78154
Phone 210.265.8025
Fax 210.568.2191

TULSA
525 South Main Street
Suite 535
Tulsa, Oklahoma 74103
Phone 918.742.0871
Fax 918.382.0232

ENVIRONMENTAL CONSULTING
ENGINEERING
DRILLING
CONSTRUCTION
SPILL MANAGEMENT
GENERAL CONTRACTING

Subject: **Soil Assessment and Remediation Work Plan**
Oxy Permian LTD
Old Ranch Canyon 7 Federal No. 1
API # 30-015-28011

Dear Mr. Bratcher,

Oxy Permian LTD has contracted Talon/LPE (Talon) to perform soil assessment and remediation services at the referenced Old Ranch Canyon 7 Federal No. 1 release. The results of our soil assessment and proposed remediation activities consist of the following:

Incident Date

March 12, 2013

Background Information

The Old Ranch Canyon 7 Federal No. 1 is located approximately thirty-eight (38) miles southwest of Artesia, New Mexico. The legal location for the site is Section 7, Township 22 South and Range 24 East in Eddy County, New Mexico. More Specifically the latitude and longitude for the release are 32.410710 North and -104.5342 West.

According to the soil survey provided by the United States Department of Agriculture National Resources Conservation Services, the soil in this area is made up of Reeves-Reagan loam with a 0 to 3 percent slopes. The local surface and shallow geology, Paleozoic Age sedimentary deposits, is comprised of residuum weathered gypsum which includes alluvium and eolian sand soils underlain by gypsiferous material, clay loam and hard caliches. The New Mexico State Engineer web site indicates the nearest ground water data to be in S19-T22S-R24E. The ground water in Section 19 is reported to be a depth of 218' below ground surface (bgs). The referenced groundwater data is presented in Appendix I.

The ranking for this site is 0 based on the as following:

Depth to ground water	>100'
Wellhead Protection Area	>1000'
Distance to surface water body	>1000'

Toll Free: 866.742.0742
www.talonlpe.com

Incident Description

On March 12, 2013 a 6-inch steel flow line was found to be leaking due to corrosion causing a release of 60 barrels of produced water. A vac truck was immediately called to the location and recovered 25 barrels. The flow line was isolated, drained of all fluids, replaced and returned to service. The spill area measures approximately 300-feet long by 20 to 3 feet wide in areas.

Actions Taken

On March 15, 2013 Talon/LPE mobilized personnel to begin the site assessment and soil sampling for the construction of a work plan. Grab soil samples were collected utilizing a hand auger to a depth of 3-feet.

Soils samples were collected by Talon personnel wearing clean nitrile gloves. The samples were placed in laboratory provided glassware, iced and transported to Cardinal Laboratories in Hobbs, New Mexico for analysis. The samples were tested for Total Chlorides via Method SM4500Cl-B. The complete laboratory report is attached as Appendix II.

Analytical Results

Analytical results received from Cardinal Laboratories are summarized below:

March 21, 2013

<u>Sample</u>	<u>Depth</u>	<u>Chlorides (mg/kg)</u>
BG	0'	<16
S-1	0'	1250
	1'	192
	2'	224
	3'	256
S-2	0'	576
	1'	240
	2'	272
S-3	0'	752
	1'	112
	2'	240
	3'	240
S-4	0'	1260
	1'	224
	2'	240
	3'	224

March 21, 2013, continued

<u>Sample</u>	<u>Depth</u>	<u>Chlorides (mg/kg)</u>
S-5	0'	864
	1'	240
	2'	240
S-6	0'	768
	1'	208

For this site's ranking, the chloride remediation standard is considered to be 1,000 mg/kg.

Summary and Conclusions

- Ground water in the project vicinity is 218-feet below land surface per the New Mexico State Engineer Database.
- Based upon the results of the laboratory data obtained for this investigation, the vertical impacts of the chloride release have been documented to be 276 mg/kg at 3-feet below ground surface within the impacted area of the flow line release.
- Based on the depth to groundwater, it is unlikely that the impacts identified from this release will pose a threat to groundwater after proposed remediation activities are complete.

Proposed Remedial Actions

- The impacted soil from this release in the vicinity of sample locations S-1 and S-4 will be scraped with a backhoe to a depth of 1.5-feet deep. The impacted soil will be transported to a NMOCD approved solid waste disposal facility.
- The excavated areas will be backfilled and contoured to match existing terrain. The area will be seeded using BLM recommended seed mixture.
- A final closure report documenting all remedial actions and analytical results will be provided to the NMOCD Artesia Office along with a C-141 Form.

Should you have any questions or if further information is required, please do not hesitate to contact our office at 575.746.8768.

Respectfully submitted,

TALON/LPE

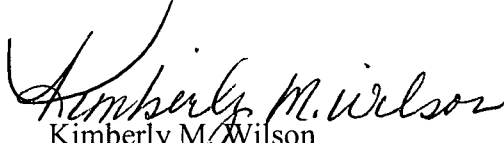
Kimberly M. Wilson
Environmental Scientist

David J. Adkins
District Manager

SITE MAP

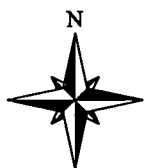
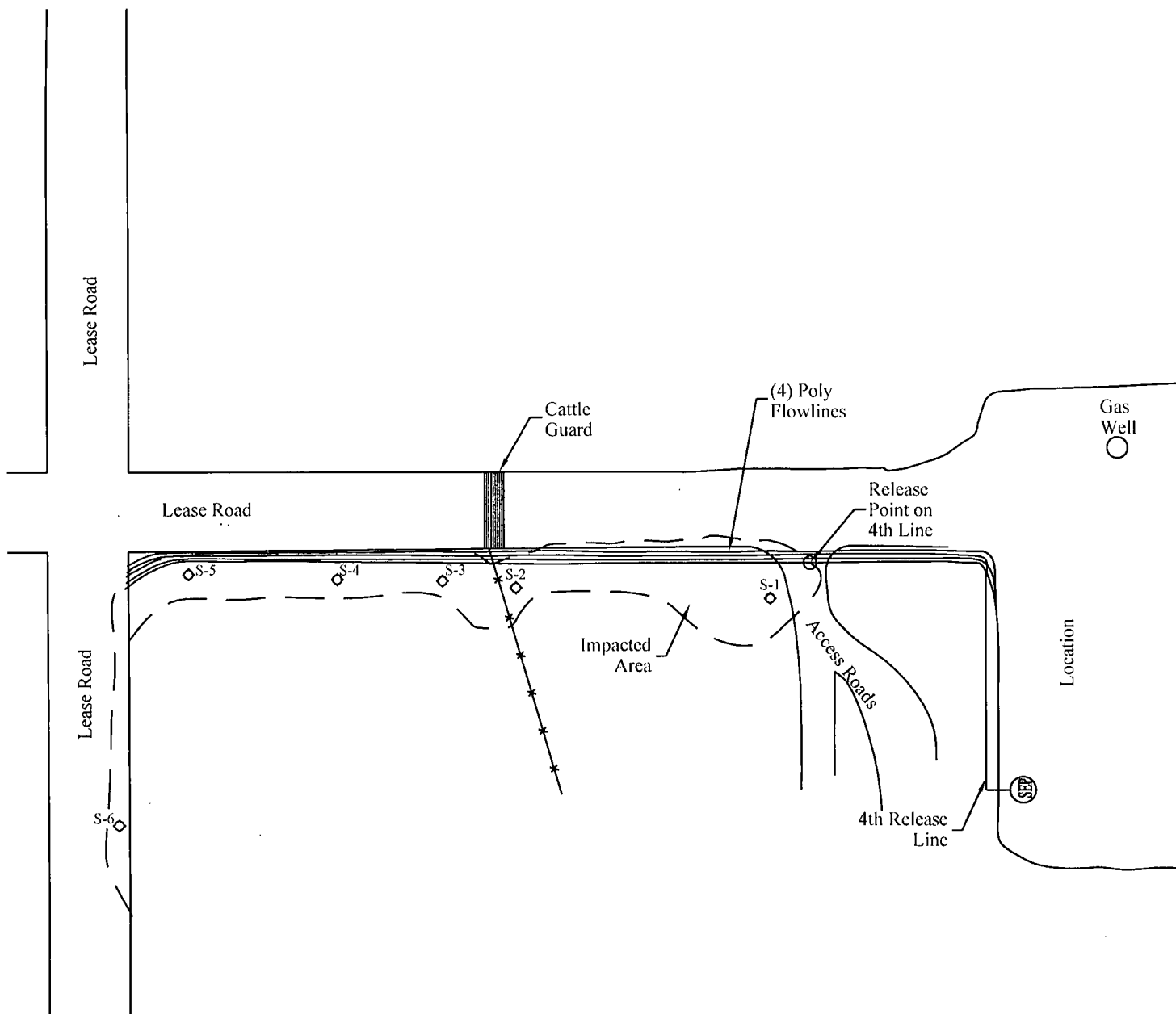

0 15 30
Scale in Feet

Legend

◇ - Sample Location



Date: 04/01/2013

Scale: 1" = 30'

Drawn By: WBS

Old Ranch Canyon 7 #1
Oxy - NM - North
Artesia, New Mexico
Figure 1 - Site Plan

APPENDIX I
GROUNDWATER DATA
INITIAL C-141



New Mexico Office of the State Engineer

Water Column/Average Depth to Water

(A CLW##### in the
POD suffix indicates the
POD has been replaced
& no longer serves a
water right file.)

(R=POD has
been replaced,
O=orphaned,
C=the file is
closed)

(quarters are 1=NW 2=NE 3=SW 4=SE)

(quarters are smallest to largest)

(NAD83 UTM in meters)

(In feet)

POD Number	POD Code	Subbasin	County	Q 64	Q 16	Q 4	Sec	Tws	Rng	X	Y	Distance	Depth Well	Depth Water	Water Column
C 02406	C	ED		3	08	22S	24E			544703	3585071*	2156	155		
C 02357		ED		4	3	3	19	22S	24E	543063	3581542*	4630	278	218	60
Average Depth to Water:													218 feet		
Minimum Depth:													218 feet		
Maximum Depth:													218 feet		

Record Count: 2

UTMNAD83 Radius Search (in meters):

Easting (X): 542846

Northing (Y): 3586167

Radius: 5000

*UTM location was derived from PLSS - see Help

The data is furnished by the NMOSE/ISC and is accepted by the recipient with the expressed understanding that the OSE/ISC make no warranties, expressed or implied, concerning the accuracy, completeness, reliability, usability, or suitability for any particular purpose of the data.

District I
1625 N. French Dr., Hobbs, NM 88240
District II
1301 W. Grand Avenue, Artesia, NM 88210
District III
1000 Rio Brazos Road, Aztec, NM 87410
District IV
1220 S. St. Francis Dr., Santa Fe, NM 87505

State of New Mexico
Energy Minerals and Natural Resources

Oil Conservation Division
1220 South St. Francis Dr.
Santa Fe, NM 87505

Form C-141
Revised October 10, 2003

Submit 2 Copies to appropriate
District Office in accordance
with Rule 116 on back
side of form

Release Notification and Corrective Action

OPERATOR

☒ Initial Report ☐ Final Report

Name of Company : Oxy Permian LTD (192463)	Contact : Chris Jones
Address : 1502 W. Commerce, Carlsbad, NM 88220	Telephone No. : 575-628-4121
Facility Name : Old Ranch Canyon 7 Federal #1	Facility Type: Well

Surface Owner : Federal	Mineral Owner	API#: 30-015-28011
-------------------------	---------------	--------------------

LOCATION OF RELEASE

Unit Letter B	Section 7	Township 22S	Range 24E	Feet from the 660'	North/South Line North	Feet from the 1980'	East/West Line East	County: Eddy
------------------	--------------	-----------------	--------------	-----------------------	---------------------------	------------------------	------------------------	--------------

Latitude 32.410710 N Longitude 104.5342 W

NATURE OF RELEASE

Type of Release : Produced Water	Volume of Release : 60 bbls	Volume Recovered: 25 bbls
Source of Release : Production Line	Date and Hour of Occurrence: 3/12/2013	Date and Hour of Discovery: 3/12/2013
Was Immediate Notice Given? <input checked="" type="checkbox"/> Yes <input type="checkbox"/> No <input type="checkbox"/> Not Required	If YES, To Whom? OCD/Mike Bratcher & BLM/Jim Amos	
By Whom: Nick Borovsky 575-200-7291	Date and Hour : 3/12/2013 10:18 am	
Was a Watercourse Reached? <input type="checkbox"/> Yes <input checked="" type="checkbox"/> No	If YES, Volume Impacting the Watercourse.	

If a Watercourse was Impacted, Describe Fully.*

Describe Cause of Problem and Remedial Action Taken.*

A 6-inch steel production flow line leaked causing a release of 60 barrels of produced water. A vac truck was immediately called to the location and recovered 25 barrels.

Describe Area Affected and Cleanup Action Taken.* The area impacted was 150'x300' down the canyon. Talon/LPE has been contracted to complete site assessment and remediation activities.

I hereby certify that the information given above is true and complete to the best of my knowledge and understand that pursuant to NMOCD rules and regulations all operators are required to report and/or file certain release notifications and perform corrective actions for releases which may endanger public health or the environment. The acceptance of a C-141 report by the NMOCD marked as "Final Report" does not relieve the operator of liability should their operations have failed to adequately investigate and remediate contamination that pose a threat to ground water, surface water, human health or the environment. In addition, NMOCD acceptance of a C-141 report does not relieve the operator of responsibility for compliance with any other federal, state, or local laws and/or regulations.

OIL CONSERVATION DIVISION

Signature:

Printed Name: Chris Jones

Title: HES Specialist

E-mail Address: Christopher Jones@oxy.com

Date: 3/14/2013 Phone: 575-628-4121

Approved by District Supervisor:

Approval Date:

Expiration Date:

Conditions of Approval:

Attached ☐

* Attach Additional Sheets If Necessary

APPENDIX II
LABORATORY RESULTS



PHONE (575) 393-2326 • 101 E. MARLAND • HOBBS, NM 88240

March 21, 2013

DAVID ADKINS

TALON LPE

408 W. TEXAS AVE.

ARTESIA, NM 88210

RE: OLD RANCH CANYON 7 #1

Enclosed are the results of analyses for samples received by the laboratory on 03/20/13 8:00.

Cardinal Laboratories is accredited through Texas NELAP under certificate number T104704398-11-3. Accreditation applies to drinking water, non-potable water and solid and chemical materials. All accredited analytes are denoted by an asterisk (*). For a complete list on accredited analytes and matrices visit the TCEQ website at www.tceq.texas.gov/field/qa/lab_accred_certif.html.

Cardinal Laboratories is accredited through the State of Colorado Department of Public Health and Environment for:

Method EPA 552.2	Haloacetic Acids (HAA-5)
Method EPA 524.2	Total Trihalomethanes (TTHM)
Method EPA 524.4	Regulated VOCs (V1, V2, V3)

Accreditation applies to public drinking water matrices.

This report meets NELAP requirements and is made up of a cover page, analytical results, and a copy of the original chain-of-custody. If you have any questions concerning this report, please feel free to contact me.

Sincerely,

Celey D. Keene

Lab Director/Quality Manager

Analytical Results For:

 TALON LPE
 DAVID ADKINS
 408 W. TEXAS AVE.
 ARTESIA NM, 88210
 Fax To: (575) 745-8905

Received:	03/20/2013	Sampling Date:	03/15/2013
Reported:	03/21/2013	Sampling Type:	Soil
Project Name:	OLD RANCH CANYON 7 #1	Sampling Condition:	Cool & Intact
Project Number:	700608.083.01	Sample Received By:	Jodi Henson
Project Location:	B-7-22-24		

Sample ID: BG 0' (H300669-01)

Chloride, SM4500Cl-B		mg/kg		Analyzed By: DW					
Analyte	Result	Reporting Limit	Analyzed	Method Blank	BS	% Recovery	True Value QC	RPD	Qualifier
Chloride	<16.0	16.0	03/21/2013	ND	432	108	400	0.00	

Sample ID: S-1 0' (H300669-02)

Chloride, SM4500Cl-B		mg/kg		Analyzed By: DW					
Analyte	Result	Reporting Limit	Analyzed	Method Blank	BS	% Recovery	True Value QC	RPD	Qualifier
Chloride	1250	16.0	03/21/2013	ND	432	108	400	0.00	

Sample ID: S-1 1' (H300669-03)

Chloride, SM4500Cl-B		mg/kg		Analyzed By: DW					
Analyte	Result	Reporting Limit	Analyzed	Method Blank	BS	% Recovery	True Value QC	RPD	Qualifier
Chloride	192	16.0	03/21/2013	ND	432	108	400	0.00	

Sample ID: S-1 2' (H300669-04)

Chloride, SM4500Cl-B		mg/kg		Analyzed By: DW					
Analyte	Result	Reporting Limit	Analyzed	Method Blank	BS	% Recovery	True Value QC	RPD	Qualifier
Chloride	224	16.0	03/21/2013	ND	432	108	400	0.00	

Cardinal Laboratories

*=Accredited Analyte

PLEASE NOTE: Liability and Damages. Cardinal's liability and client's exclusive remedy for any claim arising, whether based in contract or tort, shall be limited to the amount paid by client for analyses. All claims, including those for negligence and any other cause whatsoever shall be deemed waived unless made in writing and received by Cardinal within thirty (30) days after completion of the applicable service. In no event shall Cardinal be liable for incidental or consequential damages, including, without limitation, business interruptions, loss of use, or loss of profits incurred by client, its subsidiaries, affiliates or successors arising out of or related to the performance of the services hereunder by Cardinal, regardless of whether such claim is based upon any of the above stated reasons or otherwise. Results relate only to the samples identified above. This report shall not be reproduced except in full with written approval of Cardinal Laboratories.

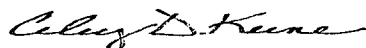

Celey D. Keene, Lab Director/Quality Manager

Analytical Results For:

TALON LPE
DAVID ADKINS
408 W. TEXAS AVE.
ARTESIA NM, 88210
Fax To: (575) 745-8905

Received:	03/20/2013	Sampling Date:	03/15/2013
Reported:	03/21/2013	Sampling Type:	Soil
Project Name:	OLD RANCH CANYON 7 #1	Sampling Condition:	Cool & Intact
Project Number:	700608.083.01	Sample Received By:	Jodi Henson
Project Location:	B-7-22-24		

Sample ID: S-1 3' (H300669-05)

Chloride, SM4500Cl-B		mg/kg		Analyzed By: DW					
Analyte	Result	Reporting Limit	Analyzed	Method Blank	BS	% Recovery	True Value QC	RPD	Qualifier
Chloride	256	16.0	03/21/2013	ND	432	108	400	0.00	

Sample ID: S-2 0' (H300669-06)

Chloride, SM4500Cl-B		mg/kg		Analyzed By: DW					
Analyte	Result	Reporting Limit	Analyzed	Method Blank	BS	% Recovery	True Value QC	RPD	Qualifier
Chloride	576	16.0	03/21/2013	ND	432	108	400	0.00	

Sample ID: S-2 1' (H300669-07)

Chloride, SM4500Cl-B		mg/kg		Analyzed By: DW						
Analyte	Result	Reporting Limit	Analyzed	Method Blank	BS	% Recovery	True Value QC	RPD	Qualifier	
Chloride	240	16.0	03/21/2013	ND	432	108	400	0.00		

Sample ID: S-2 2' (H300669-08)

Chloride, SM4500Cl-B		mg/kg		Analyzed By: DW						
Analyte	Result	Reporting Limit	Analyzed	Method Blank	BS	% Recovery	True Value QC	RPD	Qualifier	
Chloride	272	16.0	03/21/2013	ND	432	108	400	0.00		

Sample ID: S-3 0' (H300669-09)

Chloride, SM4500Cl-B		mg/kg		Analyzed By: DW						
Analyte	Result	Reporting Limit	Analyzed	Method Blank	BS	% Recovery	True Value QC	RPD	Qualifier	
Chloride	752	16.0	03/21/2013	ND	432	108	400	0.00		

Cardinal Laboratories

*=Accredited Analyte

PLEASE NOTE: Liability and Damages. Cardinal's liability and client's exclusive remedy for any claim arising, whether based in contract or tort, shall be limited to the amount paid by client for analyses. All claims, including those for negligence and any other cause whatsoever shall be deemed waived unless made in writing and received by Cardinal within thirty (30) days after completion of the applicable service. In no event shall Cardinal be liable for incidental or consequential damages, including, without limitation, business interruptions, loss of use, or loss of profits incurred by client, its subsidiaries, affiliates or successors arising out of or related to the performance of the services hereunder by Cardinal, regardless of whether such claim is based upon any of the above stated reasons or otherwise. Results relate only to the samples identified above. This report shall not be reproduced except in full with written approval of Cardinal Laboratories.

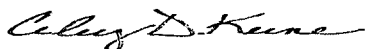

Celey D. Keene, Lab Director/Quality Manager

Analytical Results For:

TALON LPE
DAVID ADKINS
408 W. TEXAS AVE.
ARTESIA NM, 88210
Fax To: (575) 745-8905

Received:	03/20/2013	Sampling Date:	03/15/2013
Reported:	03/21/2013	Sampling Type:	Soil
Project Name:	OLD RANCH CANYON 7 #1	Sampling Condition:	Cool & Intact
Project Number:	700608.083.01	Sample Received By:	Jodi Henson
Project Location:	B-7-22-24		

Sample ID: S-3 1' (H300669-10)

Chloride, SM4500Cl-B		mg/kg		Analyzed By: DW					
Analyte	Result	Reporting Limit	Analyzed	Method Blank	BS	% Recovery	True Value QC	RPD	Qualifier
Chloride	112	16.0	03/21/2013	ND	432	108	400	0.00	

Sample ID: S-3 2' (H300669-11)

Chloride, SM4500Cl-B		mg/kg		Analyzed By: DW						
Analyte	Result	Reporting Limit	Analyzed	Method Blank	BS	% Recovery	True Value QC	RPD	Qualifier	
Chloride	240	16.0	03/21/2013	ND	432	108	400	0.00		

Sample ID: S-3 3' (H300669-12)

Chloride, SM4500Cl-B		mg/kg		Analyzed By: DW					
Analyte	Result	Reporting Limit	Analyzed	Method Blank	BS	% Recovery	True Value QC	RPD	Qualifier
Chloride	240	16.0	03/21/2013	ND	432	108	400	0.00	

Sample ID: S-4 0' (H300669-13)

Chloride, SM4500Cl-B		mg/kg		Analyzed By: DW					
Analyte	Result	Reporting Limit	Analyzed	Method Blank	BS	% Recovery	True Value QC	RPD	Qualifier
Chloride	1260	16.0	03/21/2013	ND	432	108	400	0.00	

Sample ID: S-4 1' (H300669-14)

Chloride, SM4500Cl-B		mg/kg		Analyzed By: DW					
Analyte	Result	Reporting Limit	Analyzed	Method Blank	BS	% Recovery	True Value QC	RPD	Qualifier
Chloride	224	16.0	03/21/2013	ND	432	108	400	0.00	

Cardinal Laboratories

*=Accredited Analyte

PLEASE NOTE: Liability and Damages. Cardinal's liability and client's exclusive remedy for any claim arising, whether based in contract or tort, shall be limited to the amount paid by client for analyses. All claims, including those for negligence and any other cause whatsoever shall be deemed waived unless made in writing and received by Cardinal within thirty (30) days after completion of the applicable service. In no event shall Cardinal be liable for incidental or consequential damages, including, without limitation, business interruptions, loss of use, or loss of profits incurred by client, its subsidiaries, affiliates or successors arising out of or related to the performance of the services hereunder by Cardinal, regardless of whether such claim is based upon any of the above stated reasons or otherwise. Results relate only to the samples identified above. This report shall not be reproduced except in full with written approval of Cardinal Laboratories.

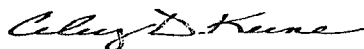

Celey D. Keene, Lab Director/Quality Manager

Analytical Results For:

TALON LPE
DAVID ADKINS
408 W. TEXAS AVE.
ARTESIA NM, 88210
Fax To: (575) 745-8905

Received: 03/20/2013
Reported: 03/21/2013
Project Name: OLD RANCH CANYON 7 #1
Project Number: 700608.083.01
Project Location: B-7-22-24

Sampling Date: 03/15/2013
Sampling Type: Soil
Sampling Condition: Cool & Intact
Sample Received By: Jodi Henson

Sample ID: S-4 2' (H300669-15)

Chloride, SM4500Cl-B		mg/kg		Analyzed By: DW					
Analyte	Result	Reporting Limit	Analyzed	Method Blank	BS	% Recovery	True Value QC	RPD	Qualifier
Chloride	240	16.0	03/21/2013	ND	432	108	400	0.00	

Sample ID: S-4 3' (H300669-16)

Chloride, SM4500Cl-B		mg/kg		Analyzed By: DW					
Analyte	Result	Reporting Limit	Analyzed	Method Blank	BS	% Recovery	True Value QC	RPD	Qualifier
Chloride	224	16.0	03/21/2013	ND	432	108	400	0.00	

Sample ID: S-5 0' (H300669-17)

Chloride, SM4500Cl-B		mg/kg		Analyzed By: DW					
Analyte	Result	Reporting Limit	Analyzed	Method Blank	BS	% Recovery	True Value QC	RPD	Qualifier
Chloride	864	16.0	03/21/2013	ND	432	108	400	0.00	

Sample ID: S-5 1' (H300669-18)

Chloride, SM4500Cl-B		mg/kg		Analyzed By: DW					
Analyte	Result	Reporting Limit	Analyzed	Method Blank	BS	% Recovery	True Value QC	RPD	Qualifier
Chloride	240	16.0	03/21/2013	ND	432	108	400	0.00	

Sample ID: S-5 2' (H300669-19)

Chloride, SM4500Cl-B		mg/kg		Analyzed By: DW					
Analyte	Result	Reporting Limit	Analyzed	Method Blank	BS	% Recovery	True Value QC	RPD	Qualifier
Chloride	240	16.0	03/21/2013	ND	432	108	400	0.00	

Cardinal Laboratories

*=Accredited Analyte

PLEASE NOTE: Liability and Damages. Cardinal's liability and client's exclusive remedy for any claim arising, whether based in contract or tort, shall be limited to the amount paid by client for analyses. All claims, including those for negligence and any other cause whatsoever shall be deemed waived unless made in writing and received by Cardinal within thirty (30) days after completion of the applicable service. In no event shall Cardinal be liable for incidental or consequential damages, including, without limitation, business interruptions, loss of use, or loss of profits incurred by client, its subsidiaries, affiliates or successors arising out of or related to the performance of the services hereunder by Cardinal, regardless of whether such claim is based upon any of the above stated reasons or otherwise. Results relate only to the samples identified above. This report shall not be reproduced except in full with written approval of Cardinal Laboratories.

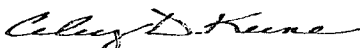

Celey D. Keene, Lab Director/Quality Manager

Analytical Results For:

TALON LPE
DAVID ADKINS
408 W. TEXAS AVE.
ARTESIA NM, 88210
Fax To: (575) 745-8905

Received: 03/20/2013
Reported: 03/21/2013
Project Name: OLD RANCH CANYON 7 #1
Project Number: 700608.083.01
Project Location: B-7-22-24

Sampling Date: 03/15/2013
Sampling Type: Soil
Sampling Condition: Cool & Intact
Sample Received By: Jodi Henson

Sample ID: S-6 0' (H300669-20)

Chloride, SM4500Cl-B		mg/kg		Analyzed By: DW					
Analyte	Result	Reporting Limit	Analyzed	Method Blank	BS	% Recovery	True Value QC	RPD	Qualifier
Chloride	768	16.0	03/21/2013	ND	432	108	400	0.00	

Sample ID: S-6 1' (H300669-21)

Chloride, SM4500Cl-B		mg/kg		Analyzed By: DW					
Analyte	Result	Reporting Limit	Analyzed	Method Blank	BS	% Recovery	True Value QC	RPD	Qualifier
Chloride	208	16.0	03/21/2013	ND	432	108	400	0.00	

Cardinal Laboratories

*=Accredited Analyte

PLEASE NOTE: Liability and Damages. Cardinal's liability and client's exclusive remedy for any claim arising, whether based in contract or tort, shall be limited to the amount paid by client for analyses. All claims, including those for negligence and any other cause whatsoever shall be deemed waived unless made in writing and received by Cardinal within thirty (30) days after completion of the applicable service. In no event shall Cardinal be liable for incidental or consequential damages, including, without limitation, business interruptions, loss of use, or loss of profits incurred by client, its subsidiaries, affiliates or successors arising out of or related to the performance of the services hereunder by Cardinal, regardless of whether such claim is based upon any of the above stated reasons or otherwise. Results relate only to the samples identified above. This report shall not be reproduced except in full with written approval of Cardinal Laboratories.

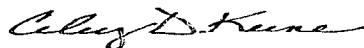

Celey D. Keene, Lab Director/Quality Manager

Notes and Definitions

ND	Analyte NOT DETECTED at or above the reporting limit
RPD	Relative Percent Difference
**	Samples not received at proper temperature of 6°C or below.
***	Insufficient time to reach temperature.
-	Chloride by SM4500Cl-B does not require samples be received at or below 6°C
	Samples reported on an as received basis (wet) unless otherwise noted on report

Cardinal Laboratories

*=Accredited Analyte

PLEASE NOTE: Liability and Damages. Cardinal's liability and client's exclusive remedy for any claim arising, whether based in contract or tort, shall be limited to the amount paid by client for analyses. All claims, including those for negligence and any other cause whatsoever shall be deemed waived unless made in writing and received by Cardinal within thirty (30) days after completion of the applicable service. In no event shall Cardinal be liable for incidental or consequential damages, including, without limitation, business interruptions, loss of use, or loss of profits incurred by client, its subsidiaries, affiliates or successors arising out of or related to the performance of the services hereunder by Cardinal, regardless of whether such claim is based upon any of the above stated reasons or otherwise. Results relate only to the samples identified above. This report shall not be reproduced except in full with written approval of Cardinal Laboratories.

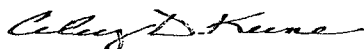

Celey D. Keene, Lab Director/Quality Manager



CHAIN-OF-CUSTODY AND ANALYSIS REQUEST

Page 8 of 10

101 East Marland, Hobbs, NM 88240
(575) 393-2326 FAX (575) 393-2476

Company Name: <u>Jalon/LPE</u>		BILL TO		ANALYSIS REQUEST																																
Project Manager: <u>David Perkins</u>		P.O. #:																																		
Address: <u>408 W. Texas</u>		Company: <u>Jalon</u>																																		
City: <u>Artesia</u> State: <u>NM</u> Zip: <u>88210</u>		Attn:																																		
Phone #: <u>575-746-8768</u> Fax #: <u>575-746-8905</u>		Address:																																		
Project #: <u>700608.083.01</u> Project Owner: <u>DX4</u>		City:																																		
Project Name: <u>Old Ranch Canyon 7 #1</u>		State: Zip:																																		
Project Location: <u>B-7-22-24</u>		Phone #:																																		
Sampler Name: <u>Kimberly M. Wilson</u>		Fax #:		<i>Chlorides</i>																																
FOR LAB USE ONLY																																				
Lab I.D.	Sample I.D.	# CONTAINERS	MATRIX													PRESERV	SAMPLING																			
			GROUNDWATER													WASTEWATER	SOIL	OIL	SLUDGE	OTHER	ACID/BASE	ICE / COOL	OTHER	DATE	TIME											
<u>H300ldd9</u>																																				
<u>1</u>	<u>BG 0'</u>	<u>6</u>															<u>1</u>						<u>1</u>	<u>3.15.13</u>	<u>9:00</u>	<u>1</u>										
<u>2</u>	<u>S-1 0'</u>	<u>6</u>															<u>1</u>						<u>1</u>	<u>3.15.13</u>	<u>9:10</u>	<u>1</u>										
<u>3</u>	<u>S-1 1'</u>	<u>6</u>															<u>1</u>						<u>1</u>	<u>3.15.13</u>	<u>9:12</u>	<u>1</u>										
<u>4</u>	<u>S-1 2'</u>	<u>6</u>															<u>1</u>						<u>1</u>	<u>3.15.13</u>	<u>9:15</u>	<u>1</u>										
<u>5</u>	<u>S-1 3'</u>	<u>6</u>															<u>1</u>						<u>1</u>	<u>3.15.13</u>	<u>9:16</u>	<u>1</u>										
<u>6</u>	<u>S-2 0'</u>	<u>6</u>			<u>1</u>						<u>1</u>	<u>3.15.13</u>	<u>9:18</u>	<u>1</u>																						
<u>7</u>	<u>S-2 1'</u>	<u>6</u>			<u>1</u>						<u>1</u>	<u>3.15.13</u>	<u>9:20</u>	<u>1</u>																						
<u>8</u>	<u>S-2 2'</u>	<u>6</u>			<u>1</u>						<u>1</u>	<u>3.15.13</u>	<u>9:25</u>	<u>1</u>																						
<u>9</u>	<u>S-3 0'</u>	<u>6</u>			<u>1</u>						<u>1</u>	<u>3.15.13</u>	<u>9:27</u>	<u>1</u>																						
<u>10</u>	<u>S-3 1'</u>	<u>6</u>			<u>1</u>						<u>1</u>	<u>3.15.13</u>	<u>9:29</u>	<u>1</u>																						
PLEASE NOTE: Liability and Damages. Cardinal's liability and client's exclusive remedy for any claim arising whether based in contract or tort, shall be limited to the amount paid by the client for the analyses. All claims including those for negligence and any other cause whatsoever shall be deemed waived unless made in writing and received by Cardinal within 30 days after completion of the applicable service. In no event shall Cardinal be liable for incidental or consequential damages, including without limitation, business interruptions, loss of use, or loss of profits incurred by client, its subsidiaries, affiliates or successors arising out of or related to the performance of services hereunder by Cardinal, regardless of whether such claim is based upon any of the above stated reasons or otherwise.																																				
Relinquished By: <u>Kimberly M. Wilson</u>		Date: <u>3/20/13</u>		Received By: <u>[Signature]</u>		Phone Result: <input type="checkbox"/> Yes <input type="checkbox"/> No		Add'l Phone #:																												
Time: <u>8:00 a.m.</u>						Fax Result: <input type="checkbox"/> Yes <input type="checkbox"/> No		Add'l Fax #:																												
Relinquished By:		Date:		Received By:																																
Time:																																				
Delivered By: (Circle One)				Sample Condition		CHECKED BY:																														
Sampler - UPS - Bus - Other:				Cool Intact <input checked="" type="checkbox"/> Yes <input type="checkbox"/> No <input type="checkbox"/> Yes <input type="checkbox"/> No		(Initials)																														

† Cardinal cannot accept verbal changes. Please fax written changes to 505-393-2476

#26



CHAIN-OF-CUSTODY AND ANALYSIS REQUEST

101 East Marland, Hobbs, NM 88240
(575) 393-2326 FAX (575) 393-2476

Page 9 of 10

Company Name: <u>Jalon/LPE</u>		BILL TO		ANALYSIS REQUEST																							
Project Manager: <u>David Adkins</u>		P.O. #:		<div>Chloride</div>																							
Address: <u>408 W. Texas</u>		Company: <u>Jalon</u>																									
City: <u>Artesia</u> State: <u>NM</u> Zip: <u>88210</u>		Attn:																									
Phone #: <u>575-746-8768</u> Fax #: <u>575-746-8905</u>		Address:																									
Project #: <u>700608.083.01</u> Project Owner: <u>DX4</u>		City:																									
Project Name: <u>Old Ranch Canyon 7 #1</u>		State: Zip:																									
Project Location: <u>B-7-22-24</u>		Phone #:																									
Sampler Name: <u>Kimberly M. Wilson</u>		Fax #:																									
FOR LAB USE ONLY		MATRIX		PRESERV.		SAMPLING																					
Lab I.D.	Sample I.D.	(G)RAB OR (C)OMP.	# CONTAINERS	GROUNDWATER	WASTEWATER	SOIL	OIL	SLUDGE	OTHER	ACID/BASE	ICE / COOL	OTHER	DATE	TIME													
H3001069																											
11	S-3 2'	6				1						1	3.15.13	9:31	1												
12	S-3 3'	6				1						1	3.15.13	9:33	1												
13	S-4 0'	6				1						1	3.15.13	9:37	1												
14	S-4 1'	6				1						1	3.15.13	9:40	1												
15	S-4 2'	6				1						1	3.15.13	9:41	1												
16	S-4 3'	6				1						1	3.15.13	9:42	1												
17	S-5 0'	6				1						1	3.15.13	9:46	1												
18	S-5 1'	6				1						1	3.15.13	9:48	1												
19	S-5 2'	6				1						1	3.15.13	9:50	1												
20	S-6 0'	6				1						1	3.15.13	9:55	1												

PLEASE NOTE: Liability and Damages. Cardinal's liability and client's exclusive remedy for any claim arising whether based in contract or tort, shall be limited to the amount paid by the client for the analyses. All claims including those for negligence and any other cause whatsoever shall be deemed waived unless made in writing and received by Cardinal within 30 days after completion of the applicable service. In no event shall Cardinal be liable for incidental or consequential damages, including without limitation, business interruptions, loss of use, or loss of profits incurred by client, its subsidiaries, affiliates or successors arising out of or related to the performance of services hereunder by Cardinal, regardless of whether such claim is based upon any of the above stated reasons or otherwise.

Relinquished By: <u>Kimberly M. Wilson</u>	Date: <u>3/10/13</u>	Received By: <u>Paul Wilson</u>	Phone Result: <input type="checkbox"/> Yes <input type="checkbox"/> No	Add'l Phone #:
	Time: <u>8:00 am</u>		Fax Result: <input type="checkbox"/> Yes <input type="checkbox"/> No	Add'l Fax #:
Relinquished By:	Date:	Received By:	REMARKS:	
	Time:			
Delivered By: (Circle One)	Sample Condition	CHECKED BY:		
Sampler - UPS - Bus - Other:	Cool <input type="checkbox"/> Intact <input type="checkbox"/>	(Initials)		
	Yes <input type="checkbox"/> No <input type="checkbox"/>			

† Cardinal cannot accept verbal changes. Please fax written changes to 505-393-2476

#26



Page 10 of 10

[illegible]

† Cardinal cannot accept verbal changes. Please fax written changes to (575) 393-2326