

Bratcher, Mike, EMNRD

From: Bratcher, Mike, EMNRD
Sent: Wednesday, June 26, 2013 3:53 PM
To: 'Amos, James'; Kimberly M. Wilson
Cc: Christopher_Jones@oxy.com; David Adkins
Subject: RE: OXY USA Old Ranch Canyon Federal #1

OCD concurs. Please proceed.

Mike Bratcher
NMOCD District 2
811 S. First Street
Artesia, NM 88210
O: 575-748-1283 X108
C: 575-626-0857
F: 575-748-9720

From: Amos, James [<mailto:jamos@blm.gov>]
Sent: Wednesday, June 26, 2013 3:27 PM
To: Kimberly M. Wilson
Cc: Bratcher, Mike, EMNRD; Christopher_Jones@oxy.com; David Adkins
Subject: Re: OXY USA Old Ranch Canyon Federal #1

Have at it. Thanks

J. Amos

On Wed, Jun 26, 2013 at 1:59 PM, Kimberly M. Wilson <kwilson@talonlpe.com> wrote:

Reference: OXY USA * Old Ranch Canyon 7 Federal 1 * 30-015-28011 * B-7-22s-24e * Eddy County, New Mexico
OCD Tracking Number: 2RP-1593 * Date of Release: 3/12/2013 *

Gentlemen please find attached the confirmation samples on the above referenced location. We would like backfilling this location tomorrow, Thursday June 26, 2013.

Kimberly M. Wilson

Project Manager

Talon/LPE

408 West Texas Avenue

Artesia, New Mexico 88210

Office: 575.746.8768

Fax: 575.746.8905

Cell: 575.602.3826

Emergency: 866.742.0742

Email: kwilson@talonlpe.com

Web: www.talonlpe.com



Better Business Bureau Torch Award for Marketplace Ethics: 2010 Winner, 2009 Finalist

Staples Foundation for Learning Hall of Fame Recipient: 2010

ICIC and Business Week- Top 100: 2010, 2009, 2008, 2007, 2006

Inc. 500/5000: 2012, 2011, 2010, 2009, 2008, 2007

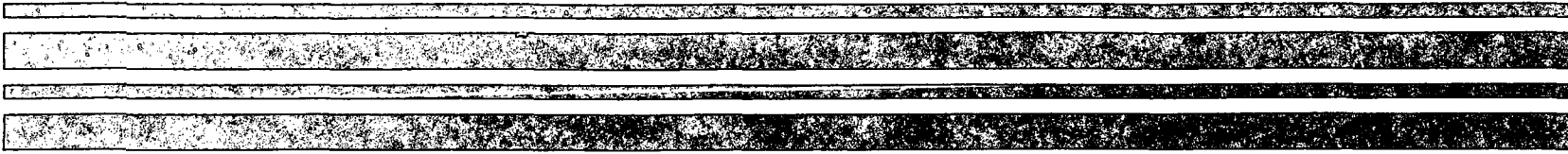

This is a Patch T type separator sheet.



Form Type = "Well file form"
CODE128 type barcode

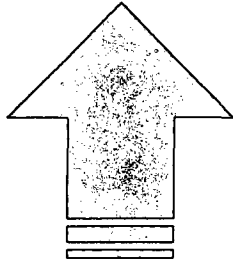

Landscape Feed
New Form Follows...

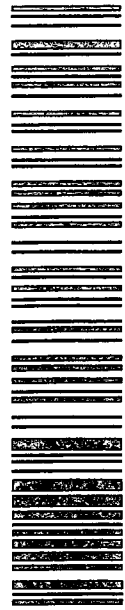

This is a Patch T type separator sheet.

Form Type = "Well file form"
CODE128 type barcode

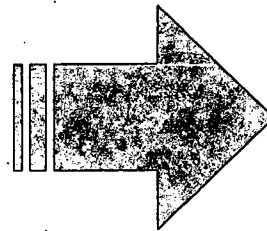

Portrait Feed
New Form Follows...

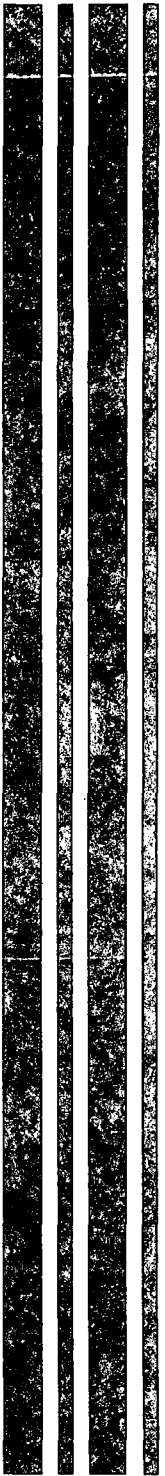



July 2, 2013

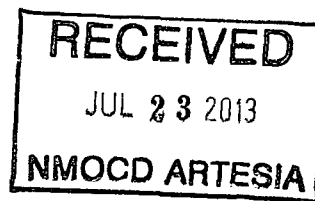

Mr. Mike Bratcher
NMOCD District 2
811 S. 1st Street
Artesia, NM 88210

AMARILLO
921 North Bivins
Amarillo, Texas 79107
Phone 806.467.0607
Fax 806.467.0622

ARTESIA
408 West Texas Ave.
Artesia, New Mexico 88210
Phone 575.746.8768
Fax 575.746.8905

AUSTIN
911 West Anderson Lane
Suite 202
Austin, Texas 78757
Phone 512.989.3428
Fax 512.989.3487

HOBBS
318 East Taylor Street
Hobbs, New Mexico 88240
Phone 575.393.4261
Fax 575.393.4658

MIDLAND
2901 State Hwy 349
Midland, Texas 79706
Phone 432.522.2133
Fax 432.522.2180

SAN ANTONIO
11 Commercial Place
Schertz, Texas 78154
Phone 210.265.8025
Fax 210.568.2191

TULSA
525 South Main Street
Suite 535
Tulsa, Oklahoma 74103
Phone 918.742.0871
Fax 918.382.0232

ENVIRONMENTAL CONSULTING
ENGINEERING
DRILLING
CONSTRUCTION
SPILL MANAGEMENT
GENERAL CONTRACTING

Subject: **Remediation and Closure Report**
Oxy Permian LTD
Old Ranch Canyon 7 Federal No. 1
API # 30-015-28011 – 2RP-1593

Dear Mr. Bratcher,

Oxy Permian LTD has contracted Talon/LPE (Talon) to perform soil assessment and remediation services at the referenced Old Ranch Canyon 7 Federal No. 1 release. The results of our soil assessment, completed remediation activities and closure request are submitted herein.

Incident Date

March 12, 2013

Background Information

The Old Ranch Canyon 7 Federal No. 1 is located approximately thirty-eight (38) miles southwest of Artesia, New Mexico. The legal location for the site is Section 7, Township 22 South and Range 24 East in Eddy County, New Mexico. More Specifically the latitude and longitude for the release are 32.410710 North and -104.5342 West.

According to the soil survey provided by the United States Department of Agriculture National Resources Conservation Services, the soil in this area is made up of Reeves-Reagan loam with a 0 to 3 percent slopes. The local surface and shallow geology, Paleozoic Age sedimentary deposits, is comprised of residuum weathered gypsum which includes alluvium and eolian sand soils underlain by gypsiferous material, clay loam and hard caliches. The New Mexico State Engineer web site indicates the nearest ground water data to be in S19-T22S-R24E. The ground water in Section 19 is reported to be a depth of 218' below ground surface (bgs). The referenced groundwater data is presented in Appendix I.

The ranking for this site is 0 based on the as following:

Depth to ground water	>100'
Wellhead Protection Area	>1000'
Distance to surface water body	>1000'

Toll Free: 866.742.0742
www.talonlpe.com

Incident Description

On March 12, 2013 a 6-inch steel flow line was found to be leaking due to corrosion causing a release of 60 barrels of produced water. A vac truck was immediately called to the location and recovered 25 barrels. The flow line was isolated, drained of all fluids, replaced and returned to service. The spill area measures approximately 300-feet long by 20 to 3 feet wide in areas. A site plan is attached.

Remedial Actions Taken

On May 21, 2013 Talon personnel mobilized to the site to begin excavation of the impacted areas in accordance with the approved work plan. The impacted areas were excavated to a depth of 1-foot deep and transported to Lea Land LLC, an approved NMOCD disposal facility.

On June 12, 2013 Talon personnel mobilized to the site to begin closure soil sampling activities on the bottom of the excavation per NMOCD requirements. Grab soil samples were collected and submitted for laboratory analysis.

Soils samples were collected by Talon personnel wearing clean nitrile gloves. The samples were placed in laboratory provided glassware, iced and transported to Cardinal Laboratories in Hobbs, New Mexico for analysis. The samples were tested for TPH (Total Petroleum Hydrocarbons) using EPA Method 8015M, volatile organics (BTEX) using EPA Method 8021B and Chlorides via Method SM4500Cl-B. The complete laboratory report is attached as Appendix II.

Analytical Results

Analytical results received from Cardinal Laboratories are summarized below:

June 24, 2013 Report Date

<u>Sample</u>	<u>Depth</u>	<u>BTEX</u>	<u>Chlorides</u>	<u>TPH mg/kg</u>
S-1	1'	<0.300	144	<10
S-4	1'	<0.300	208	<10

Summary and Conclusions

- Ground water in the project vicinity is 218-feet below land surface per the New Mexico State Engineer Database.
- The impacted soil was excavated to a depth of 1-foot deep in the vicinity of sample locations S-1 and S-4. The impacted soil was transported to a NMOCD approved solid waste disposal facility, Lea Land LLC.

- Upon NMOCD's approval of the confirmation samples, the excavated area was backfilled to grade using new material transported from a local borrow pit.
- The excavated areas were contoured to match existing terrain. The areas were seeded using BLM Falcon Rocky seed mixture. The seeding label is attached.
- Based on the depth to groundwater, it is unlikely that the impacts identified from this release will pose a threat to groundwater after remediation activities were complete.

Closure

Therefore, on behalf of Oxy Permian LTD, we respectfully request that no further actions be required and that closure with respect to this release be granted.

Should you have any questions or if further information is required, please do not hesitate to contact our office at 575.746.8768.

Respectfully submitted,

TALON/LPE



Kimberly M. Wilson
Project Manager



David J. Adkins
District Manager

SITE MAP

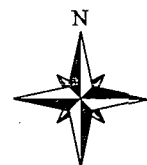
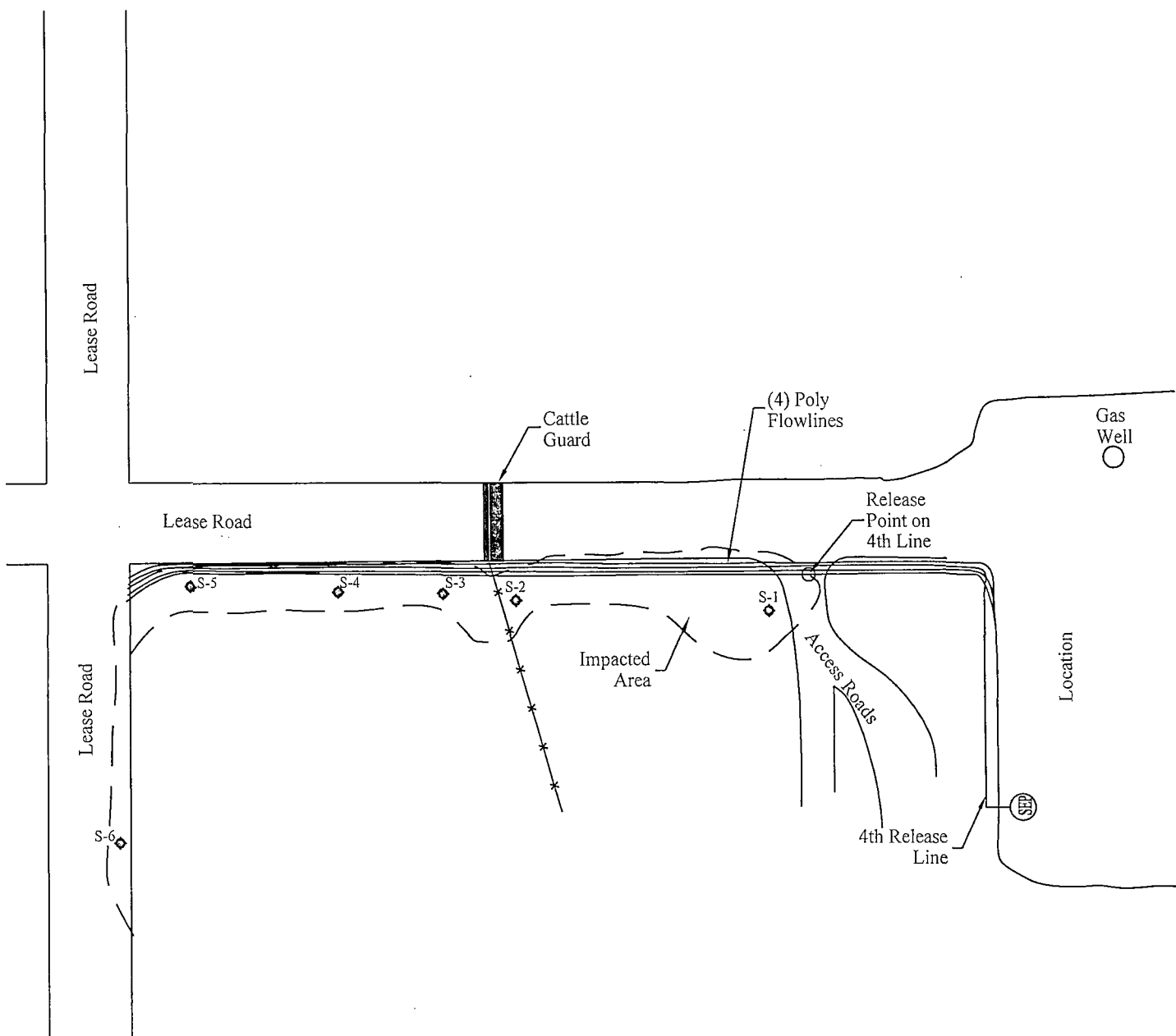

0 15 30
Scale in Feet

Legend

◆ - Sample Location



Date: 04/01/2013

Scale: 1" = 30'

Drawn By: WBS

Old Ranch Canyon 7 #1

Oxy - NM - North
Artesia, New Mexico

Figure 1 - Site Plan

APPENDIX I
GROUNDWATER DATA



New Mexico Office of the State Engineer

Water Column/Average Depth to Water

(A CLW##### in the
POD suffix indicates the
POD has been replaced
& no longer serves a
water right file.)

(R=POD has
been replaced,
O=orphaned,
C=the file is
closed)

(quarters are 1=NW 2=NE 3=SW 4=SE)

(quarters are smallest to largest)

(NAD83 UTM in meters)

(In feet)

POD Number	POD Code	Subbasin	County	Q 64	Q 16	Q 4	Sec	Tws	Rng	X	Y	Distance	Depth Well	Depth Water	Water Column
<u>C 02406</u>	C	ED		3	08	22S	24E			544703	3585071*	2156	155		
<u>C 02357</u>		ED		4	3	3	19	22S	24E	543063	3581542*	4630	278	218	60
													Average Depth to Water:		218 feet
													Minimum Depth:		218 feet
													Maximum Depth:		218 feet

Record Count: 2

UTM NAD83 Radius Search (in meters):

Easting (X): 542846

Northing (Y): 3586167

Radius: 5000

*UTM location was derived from PLSS - see Help

The data is furnished by the NMOSE/ISC and is accepted by the recipient with the expressed understanding that the OSE/ISC make no warranties, expressed or implied, concerning the accuracy, completeness, reliability, usability, or suitability for any particular purpose of the data.

APPENDIX II
LABORATORY RESULTS



PHONE (575) 393-2326 ° 101 E. MARLAND ° HOBBS, NM 88240

June 24, 2013

DAVID ADKINS

TALON LPE

408 W. TEXAS AVE.

ARTESIA, NM 88210

RE: OLD RANCH CANYON 7 #1

Enclosed are the results of analyses for samples received by the laboratory on 06/18/13 8:00.

Cardinal Laboratories is accredited through Texas NELAP under certificate number T104704398-11-3. Accreditation applies to drinking water, non-potable water and solid and chemical materials. All accredited analytes are denoted by an asterisk (*). For a complete list of accredited analytes and matrices visit the TCEQ website at www.tceq.texas.gov/field/qa/lab_accred_certif.html.

Cardinal Laboratories is accredited through the State of Colorado Department of Public Health and Environment for:

Method EPA 552.2	Haloacetic Acids (HAA-5)
Method EPA 524.2	Total Trihalomethanes (TTHM)
Method EPA 524.4	Regulated VOCs (V1, V2, V3)

Accreditation applies to public drinking water matrices.

This report meets NELAP requirements and is made up of a cover page, analytical results, and a copy of the original chain-of-custody. If you have any questions concerning this report, please feel free to contact me.

Sincerely,

A handwritten signature in black ink that reads "Coley D. Keene". The signature is fluid and cursive, with the first name "Coley" being more prominent.

Celey D. Keene

Lab Director/Quality Manager

Analytical Results For:

TALON LPE
DAVID ADKINS
408 W. TEXAS AVE.
ARTESIA NM, 88210
Fax To: (575) 745-8905

Received: 06/18/2013
Reported: 06/24/2013
Project Name: OLD RANCH CANYON 7 #1
Project Number: 700608.083.01
Project Location: B-7-22-24

Sampling Date: 06/12/2013
Sampling Type: Soil
Sampling Condition: Cool & Intact
Sample Received By: Daniel Wade

Sample ID: S-1 (H301401-01)

BTEX 8021B		mg/kg		Analyzed By: MS					
Analyte	Result	Reporting Limit	Analyzed	Method Blank	BS	% Recovery	True Value QC	RPD	Qualifier
Benzene*	<0.050	0.050	06/21/2013	ND	1.81	90.7	2.00	8.53	
Toluene*	<0.050	0.050	06/21/2013	ND	1.95	97.5	2.00	7.49	
Ethylbenzene*	<0.050	0.050	06/21/2013	ND	2.11	106	2.00	7.27	
Total Xylenes*	<0.150	0.150	06/21/2013	ND	6.35	106	6.00	6.93	
Total BTEX	<0.300	0.300	06/21/2013	ND					

Surrogate: 4-Bromofluorobenzene (PIC) 109 % 89.4-126

Chloride, SM4500Cl-B		mg/kg		Analyzed By: DW					
Analyte	Result	Reporting Limit	Analyzed	Method Blank	BS	% Recovery	True Value QC	RPD	Qualifier
Chloride	144	16.0	06/20/2013	ND	432	108	400	3.77	

TPH 8015M		mg/kg		Analyzed By: MS					
Analyte	Result	Reporting Limit	Analyzed	Method Blank	BS	% Recovery	True Value QC	RPD	Qualifier
GRO C6-C10	<10.0	10.0	06/20/2013	ND	220	110	200	1.01	
DRO >C10-C28	<10.0	10.0	06/20/2013	ND	231	116	200	0.0575	

Surrogate: 1-Chlorooctane 86.0 % 65.2-140

Surrogate: 1-Chlorooctadecane 90.5 % 63.6-154

Cardinal Laboratories

*=Accredited Analyte

PLEASE NOTE: Liability and Damages. Cardinal's liability and client's exclusive remedy for any claim arising, whether based in contract or tort, shall be limited to the amount paid by client for analyses. All claims, including those for negligence and any other cause whatsoever shall be deemed waived unless made in writing and received by Cardinal within thirty (30) days after completion of the applicable service. In no event shall Cardinal be liable for incidental or consequential damages, including, without limitation, business interruptions, loss of use, or loss of profits incurred by client, its subsidiaries, affiliates or successors arising out of or related to the performance of the services hereunder by Cardinal, regardless of whether such claim is based upon any of the above stated reasons or otherwise. Results relate only to the samples identified above. This report shall not be reproduced except in full with written approval of Cardinal Laboratories.

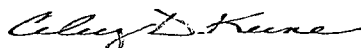

Celey D. Keene, Lab Director/Quality Manager

Analytical Results For:

TALON LPE
DAVID ADKINS
408 W. TEXAS AVE.
ARTESIA NM, 88210
Fax To: (575) 745-8905

Received:	06/18/2013	Sampling Date:	06/12/2013
Reported:	06/24/2013	Sampling Type:	Soil
Project Name:	OLD RANCH CANYON 7 #1	Sampling Condition:	Cool & Intact
Project Number:	700608.083.01	Sample Received By:	Daniel Wade
Project Location:	B-7-22-24		

Sample ID: S-4 (H301401-02)

BTX 8021B		mg/kg		Analyzed By: MS					
Analyte	Result	Reporting Limit	Analyzed	Method Blank	BS	% Recovery	True Value QC	RPD	Qualifier
Benzene*	<0.050	0.050	06/21/2013	ND	1.81	90.7	2.00	8.53	
Toluene*	<0.050	0.050	06/21/2013	ND	1.95	97.5	2.00	7.49	
Ethylbenzene*	<0.050	0.050	06/21/2013	ND	2.11	106	2.00	7.27	
Total Xylenes*	<0.150	0.150	06/21/2013	ND	6.35	106	6.00	6.93	
Total BTX	<0.300	0.300	06/21/2013	ND					

Surrogate: 4-Bromofluorobenzene (PID) 108 % 89.4-126

Chloride, SM4500Cl-B		mg/kg		Analyzed By: DW					
Analyte	Result	Reporting Limit	Analyzed	Method Blank	BS	% Recovery	True Value QC	RPD	Qualifier
Chloride	208	16.0	06/20/2013	ND	432	108	400	3.77	

TPH 8015M		mg/kg		Analyzed By: MS					
Analyte	Result	Reporting Limit	Analyzed	Method Blank	BS	% Recovery	True Value QC	RPD	Qualifier
GRO C6-C10	<10.0	10.0	06/20/2013	ND	220	110	200	1.01	
DRO >C10-C28	<10.0	10.0	06/20/2013	ND	231	116	200	0.0575	

Surrogate: 1-Chlorooctane 90.6 % 65.2-140

Surrogate: 1-Chlorooctadecane 94.0 % 63.6-154

Cardinal Laboratories

*=Accredited Analyte

PLEASE NOTE: Liability and Damages. Cardinal's liability and client's exclusive remedy for any claim arising, whether based in contract or tort, shall be limited to the amount paid by client for analyses. All claims, including those for negligence and any other cause whatsoever, shall be deemed waived unless made in writing and received by Cardinal within thirty (30) days after completion of the applicable service. In no event shall Cardinal be liable for incidental or consequential damages, including, without limitation, business interruptions, loss of use, or loss of profits incurred by client, its subsidiaries, affiliates or successors arising out of or related to the performance of the services hereunder by Cardinal, regardless of whether such claim is based upon any of the above stated reasons or otherwise. Results relate only to the samples identified above. This report shall not be reproduced except in full with written approval of Cardinal Laboratories.

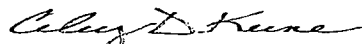

Celey D. Keene, Lab Director/Quality Manager

Notes and Definitions

ND	Analyte NOT DETECTED at or above the reporting limit
RPD	Relative Percent Difference
**	Samples not received at proper temperature of 6°C or below.
***	Insufficient time to reach temperature.
-	Chloride by SM4500Cl-B does not require samples be received at or below 6°C
	Samples reported on an as received basis (wet) unless otherwise noted on report

Cardinal Laboratories

*=Accredited Analyte

PLEASE NOTE: Liability and Damages. Cardinal's liability and client's exclusive remedy for any claim arising, whether based in contract or tort, shall be limited to the amount paid by client for analyses. All claims, including those for negligence and any other cause whatsoever shall be deemed waived unless made in writing and received by Cardinal within thirty (30) days after completion of the applicable service. In no event shall Cardinal be liable for incidental or consequential damages, including, without limitation, business interruptions, loss of use, or loss of profits incurred by client, its subsidiaries, affiliates or successors arising out of or related to the performance of the services hereunder by Cardinal, regardless of whether such claim is based upon any of the above stated reasons or otherwise. Results relate only to the samples identified above. This report shall not be reproduced except in full with written approval of Cardinal Laboratories.

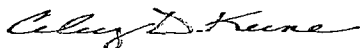

Celey D. Keene, Lab Director/Quality Manager

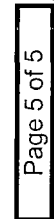

101 East Marland, Hobbs, NM 88240
(575) 393-2326 FAX (575) 393-2476

† Cardinal cannot accept verbal changes. Please fax written changes to 505-393-2476

Kimberly M. Wilson

From: Amos, James [jamos@blm.gov]
Sent: Wednesday, May 22, 2013 7:26 AM
To: Kimberly M. Wilson
Cc: Christopher_Jones@oxy.com; Chancey_Summers@oxy.com; David Adkins
Subject: Re: Old Ranch Canyon 7 Federal #1 -- 30-015-28011 -- B-7-22S-24E

Kimberly, The BLM is in agreement with OCDs findings and stipulations, and will approve the work plan with the conditions that the composite samples be taken from the bottom of the excavation and be tested for TPH and BTEX, with copy of the findings submitted to BLM prior to backfill. Keep me in the loop as far as start and sampling. thanks

On Tue, May 21, 2013 at 3:11 PM, Kimberly M. Wilson <kwilson@talonlpe.com> wrote:

Mr. Amos:

Please find attached the work plan, site map, initial C-141, lab data and the notification with stipulations from Mike Bratcher, of the OCD, on the above referenced location.

Thank you.

Respectfully,

Kimberly M. Wilson

Environmental Scientist

Talon/LPE

408 West Texas Avenue

Artesia, New Mexico 88210

Office: 575.746.8768

Fax: 575.746.8905

Cell: 575.602.3826

Emergency: 866.742.0742

SEEDING LABEL

Clayton, NM 88401

Curtis & Curtis, Inc.
4300 North Prince
Clayton, NM 88401
Phone: (505) 762-4759

Talon Drilling LP
1 - 1 Acre Bag @ 27.80 Bulk Pounds Each
1 - 1/4 Acre Bag @ 13.98 Bulk Pounds
Job: Oxy Releasing Spring 14 Seed #3
27.80 Bulk Pounds Per Acre

7/1/13
Old Ranch
Canyon 7

Lot#: M-11349

Item	Origin	Purity	Germ	Dormant	Germ & Dormant	Test Date	Total PLS Pounds
Buffalograss	Texas	14.84%	95.00%	2.00%	97.00%	12/12	8.00
Texoka	Texas	3.75%	34.00%	62.00%	96.00%	11/12	2.00
Blue Grama	OR	21.42%	84.00%	0.00%	84.00% TZ	11/12	10.00
Alma	Texas	26.45%	52.00%	16.00%	68.00%	11/12	10.00
Prairie Junegrass	Oregon	22.97%	94.00%	0.00%	94.00%	03/13	12.00
VNS							
Sideoats Grama							
Vaughn							
Annual Ryegrass							
Gulf							
Other Crop:		0.15%					
Weed Seed:		0.16%					
Inert Matter:		10.26%					

There Are 3 Bags For This Mix
This Bag Weighs 13.88 Bulk Pounds
Use This Bag For 1/2 Acre

Total Bulk Pounds:

FINAL C-141

District I
1625 N. French Dr., Hobbs, NM 88240
District II
1301 W. Grand Avenue, Artesia, NM 88210
District III
1000 Rio Brazos Road, Aztec, NM 87410
District IV
1220 S. St. Francis Dr., Santa Fe, NM 87505

State of New Mexico
Energy Minerals and Natural Resources
Oil Conservation Division
1220 South St. Francis Dr.
Santa Fe, NM 87505

RECEIVED

JUL 23 2013

NMOCD ARTESIA

Form C-141
Revised October 10, 2003

Submit 2 Copies to appropriate District Office in accordance with Rule 116 on back side of form

Release Notification and Corrective Action

OPERATOR

☐ Initial Report ☒ Final Report

Name of Company : Oxy Permian LTD (192463)	Contact : Chris Jones
Address : 1502 W. Commerce, Carlsbad, NM 88220	Telephone No. : 575-628-4121
Facility Name : Old Ranch Canyon 7 Federal #1	Facility Type: Well
Surface Owner : Federal	Mineral Owner
API#: Lease #: 30-015-28011 2RP-1593	

LOCATION OF RELEASE

Unit Letter B	Section 7	Township 22S	Range 24E	Feet from the 660'	North/South Line North	Feet from the 1980'	East/West Line East	County: Eddy
------------------	--------------	-----------------	--------------	-----------------------	---------------------------	------------------------	------------------------	--------------

Latitude N 32.41071 Longitude W -104.5342

NATURE OF RELEASE

Type of Release : Produced Water	Volume of Release : 60 bbls	Volume Recovered: 25 bbls
Source of Release : Production Line	Date and Hour of Occurrence: 3/12/2013	Date and Hour of Discovery: 3/12/2013
Was Immediate Notice Given? <input checked="" type="checkbox"/> Yes <input type="checkbox"/> No <input type="checkbox"/> Not Required	If YES, To Whom? OCD/Mike Bratcher & BLM/Jim Amos	
By Whom: Nick Borovsky 575-200-7291	Date and Hour : 3/12/2013 10:18 am	
Was a Watercourse Reached? <input type="checkbox"/> Yes <input checked="" type="checkbox"/> No	If YES, Volume Impacting the Watercourse.	

If a Watercourse was Impacted, Describe Fully.*

Describe Cause of Problem and Remedial Action Taken.* A 6-inch steel flow line was found to be leaking due to corrosion causing a release of 60 barrels of produced water. A vac truck was immediately called to the location and recovered 25 barrels. The flow line was isolated, drained of all fluids, replaced and returned to service. The spill area measures approximately 300-feet long by 20 to 3 feet wide in areas.

Describe Area Affected and Cleanup Action Taken.* Talon/LPE was contracted for the correction of this release. The impacted area from sample location S-1 and S-3 of this release was excavated to a depth of 1-foot deep. The impacted soil was transported to Lea Land, LLC, an approved NMOCD disposal facility. Analytical testing was completed and following NMOCD approval of the confirmation sample, the excavation was backfilled to grade using new material. The area was contoured to match the surrounding location and seeded on 7/1/2013 using BLM seed mix Falcon Rocky.

I hereby certify that the information given above is true and complete to the best of my knowledge and understand that pursuant to NMOCD rules and regulations all operators are required to report and/or file certain release notifications and perform corrective actions for releases which may endanger public health or the environment. The acceptance of a C-141 report by the NMOCD marked as "Final Report" does not relieve the operator of liability should their operations have failed to adequately investigate and remediate contamination that pose a threat to ground water, surface water, human health or the environment. In addition, NMOCD acceptance of a C-141 report does not relieve the operator of responsibility for compliance with any other federal, state, or local laws and/or regulations.

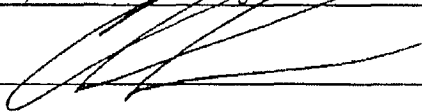
Signature: 		OIL CONSERVATION DIVISION	
Printed Name: Chris Jones		Approved by District Supervisor:	
Title: HES Specialist		Approval Date:	Expiration Date:
E-mail Address: Christopher Jones@oxy.com		Conditions of Approval:	Attached <input type="checkbox"/>
Date: 7/22/2013 Phone: 575-628-4121			

* Attach Additional Sheets If Necessary