

ABOVE THIS LINE FOR DIVISION USE ONLY

NEW MEXICO OIL CONSERVATION DIVISION

- Engineering Bureau -

1220 South St. Francis Drive, Santa Fe, NM 87505



ADMINISTRATIVE APPLICATION CHECKLIST

THIS CHECKLIST IS MANDATORY FOR ALL ADMINISTRATIVE APPLICATIONS FOR EXCEPTIONS TO DIVISION RULES AND REGULATIONS WHICH REQUIRE PROCESSING AT THE DIVISION LEVEL IN SANTA FE

Application Acronyms:

[NSL-Non-Standard Location] **[NSP-Non-Standard Proration Unit]** **[SD-Simultaneous Dedication]**
[DHC-Downhole Commingling] **[CTB-Lease Commingling]** **[PLC-Pool/Lease Commingling]**
[PC-Pool Commingling] **[OLS - Off-Lease Storage]** **[OLM-Off-Lease Measurement]**
[WFX-Waterflood Expansion] **[PMX-Pressure Maintenance Expansion]**
[SWD-Salt Water Disposal] **[IPI-Injection Pressure Increase]**
[EOR-Qualified Enhanced Oil Recovery Certification] **[PPR-Positive Production Response]**

[1] TYPE OF APPLICATION - Check Those Which Apply for [A]

[A] Location - Spacing Unit - Simultaneous Dedication
☐ NSL ☐ NSP ☐ SD

Check One Only for [B] or [C]

[B] Commingling - Storage - Measurement

☐ DHC ☐ CTB ☒ PLC ☐ PC ☐ OLS ☐ OLM

[C] Injection - Disposal - Pressure Increase - Enhanced Oil Recovery

☐ WFX ☐ PMX ☐ SWD ☐ IPI ☐ EOR ☐ PPR

[D] Other: Specify _____

[2] NOTIFICATION REQUIRED TO: - Check Those Which Apply, or ☐ Does Not Apply

[A] ☒ Working, Royalty or Overriding Royalty Interest Owners

[B] ☐ Offset Operators, Leaseholders or Surface Owner

[C] ☐ Application is One Which Requires Published Legal Notice

[D] ☒ Notification and/or Concurrent Approval by BLM or SLO
 U.S. Bureau of Land Management - Commissioner of Public Lands, State Land Office

[E] ☒ For all of the above, Proof of Notification or Publication is Attached, and/or,

[F] ☐ Waivers are Attached

[3] SUBMIT ACCURATE AND COMPLETE INFORMATION REQUIRED TO PROCESS THE TYPE OF APPLICATION INDICATED ABOVE.

[4] **CERTIFICATION:** I hereby certify that the information submitted with this application for administrative approval is **accurate** and **complete** to the best of my knowledge. I also understand that **no action** will be taken on this application until the required information and notifications are submitted to the Division.

Note: Statement must be completed by an individual with managerial and/or supervisory capacity.

Toya Colvin

Print or Type Name

Toya Colvin

Signature

Regulatory Analyst

Title

06/08/15

Date

Toya.Colvin@bp.com
 e-mail Address

2015 JUN 11 P 3:10

RECEIVED OGD

COAL

PLC 423
 Well: State of New Mexico
 2 & 3
 API: 30-045-29030
 Pool: Kutz
 Pictured cliffs
 West gas
 - Basin Fracturing

Submit 1 Copy To Appropriate District Office
District I - (575) 393-6161
1625 N. French Dr., Hobbs, NM 88240
District II - (575) 748-1283
811 S. First St., Artesia, NM 88210
District III - (505) 334-6178
1000 Rio Brazos Rd., Aztec, NM 87410
District IV - (505) 476-3460
1220 S. St. Francis Dr., Santa Fe, NM 87505

State of New Mexico
Energy, Minerals and Natural Resources

Form C-103
Revised July 18, 2013

OIL CONSERVATION DIVISION
1220 South St. Francis Dr.
Santa Fe, NM 87505

SUNDRY NOTICES AND REPORTS ON WELLS (DO NOT USE THIS FORM FOR PROPOSALS TO DRILL OR TO DEEPEN OR PLUG BACK TO A DIFFERENT RESERVOIR. USE "APPLICATION FOR PERMIT" (FORM C-101) FOR SUCH PROPOSALS.)		WELL API NO. 30-045-29030, 30-045-29031
1. Type of Well: Oil Well <input type="checkbox"/> Gas Well <input checked="" type="checkbox"/> Other <input type="checkbox"/>		5. Indicate Type of Lease STATE <input checked="" type="checkbox"/> FEE <input type="checkbox"/>
2. Name of Operator BP America Production Company		6. State Oil & Gas Lease No. State of New Mexico #2- B13303 State of New Mexico #3- E9229
3. Address of Operator 501 Westlake Park Blvd., Three Eldridge Place 12.181A Houston, TX 77079		7. Lease Name or Unit Agreement Name State of New Mexico #2, State of New Mexico #3
4. Well Location Unit Letter <u>A (#2) B (#3)</u> : <u>1100' (#2) 790' (#3)</u> feet from the <u>North</u> line and <u>790' (#2), 1780' (#3)</u> feet from the <u>East</u> line Section <u>16</u> Township <u>29N</u> Range <u>12W</u> NMPM County <u>San Juan</u>		8. Well Number
11. Elevation (Show whether DR, RKB, RT, GR, etc.) <u>5785' GL-State of New Mexico #2, 5783' GL-State of New Mexico #3</u>		9. OGRID Number <u>000778</u>
		10. Pool name or Wildcat W. Kutz Pictured Cliffs State of New Mexico #2 Basin Fruitland Coal State of New Mexico #3

12. Check Appropriate Box to Indicate Nature of Notice, Report or Other Data

NOTICE OF INTENTION TO:

PERFORM REMEDIAL WORK ☐ PLUG AND ABANDON ☐
TEMPORARILY ABANDON ☐ CHANGE PLANS ☐
PULL OR ALTER CASING ☐ MULTIPLE COMPL ☐
DOWNHOLE COMMINGLE ☐
CLOSED-LOOP SYSTEM ☐
OTHER: Surface Commingle ☒

SUBSEQUENT REPORT OF:

REMEDIAL WORK ☐ ALTERING CASING ☐
COMMENCE DRILLING OPNS. ☐ P AND A ☐
CASING/CEMENT JOB ☐

OTHER: ☐

13. Describe proposed or completed operations. (Clearly state all pertinent details, and give pertinent dates, including estimated date of starting any proposed work). SEE RULE 19.15.7.14 NMAC. For Multiple Completions: Attach wellbore diagram of proposed completion or recompletion.

BP respectfully requests approval to continue surface commingling the subject wells. The State of New Mexico #2 well (API 30-045-29030) is located in a 160 acre spacing unit comprised of the Northeast quarter of 16-T29N-R12W and is producing from the West Kutz Pictured Cliffs pool (79680). The State of New Mexico #3 well (API 30-045-29031) is located in a 320 acre spacing unit comprised of the East half of 16-T29N-R12W and is producing from the Basin Fruitland Coal pool (71629).

As part of efforts to reconfigure the compressor configuration for these wells, BP conducted a file review and was unable to locate authorization to surface commingle these 2 wells. These wells were acquired from BHP in 1996 and have been commingled since before the acquisition. Each well has a dedicated allocation meter used to allocate production and the allocation method will not be changed as a result of the compressor reconfiguration. After separation, the team will ensure that the production from each of the two wells is metered individually prior to commingling. The commingled gas will then be sent through compression prior to entering the sales meter. The difference between what is measured prior to commingling and what is sold through the sales meter is the fuel usage. The fuel usage is allocated back to each well based on the well production (see attached schematic).

The working interest ownership is not identical between these wells, but the royalty interest ownership is identical. Notification is required and was sent by certified mail to the New Mexico State Land Office, Burlington Resources and Four Star Oil & Gas. Please see attached Land Letter.

Surface commingling production from the existing State Of New Mexico #2 (W. Kutz PC) and State of New Mexico #3 (FC) will not reduce the economic life of the wells. The proposed commingling of production is to reduce operating expenses between the 2 wells and will result in increased economic life of the wells.

Spud Date: 02/01/1994 #2, 04/19/1994 #3

Rig Release Date:

I hereby certify that the information above is true and complete to the best of my knowledge and belief.

SIGNATURE Toya Colvin TITLE Regulatory Analyst DATE 06/08/2015

Type or print name Toya Colvin E-mail address: Toya.Colvin@bp.com PHONE: 281-366-7148

For State Use Only

APPROVED BY: TITLE DATE

District I
1625 N. French Drive, Hobbs, NM 88240
District II
811 S. First St., Artesia, NM 88210
District III
1000 Rio Brazos Road, Aztec, NM 87410
District IV
1220 S. St Francis Dr, Santa Fe, NM
87505

State of New Mexico
Energy, Minerals and Natural Resources Department

Form C-107-B
Revised August 1, 2011

OIL CONSERVATION DIVISION
1220 S. St Francis Drive
Santa Fe, New Mexico 87505

Submit the original
application to the Santa Fe
office with one copy to the
appropriate District Office.

APPLICATION FOR SURFACE COMMINGLING (DIVERSE OWNERSHIP)

OPERATOR NAME: BP America Production Company
OPERATOR ADDRESS: 501 Westlake Park Blvd., Three Eldridge Place 12.181A, Houston, TX 77079
APPLICATION TYPE:
☐ Pool Commingling ☐ Lease Commingling ☒ Pool and Lease Commingling ☐ Off-Lease Storage and Measurement (Only if not Surface Commingled)
LEASE TYPE: ☐ Fee ☒ State ☐ Federal

Is this an Amendment to existing Order? ☐ Yes ☒ No If "Yes", please include the appropriate Order No. _____
Have the Bureau of Land Management (BLM) and State Land office (SLO) been notified in writing of the proposed commingling
☒ Yes ☐ No

(A) POOL COMMINGLING

Please attach sheets with the following information

(1) Pool Names and Codes	Gravities / BTU of Non-Commingled Production	Calculated Gravities / BTU of Commingled Production		Calculated Value of Commingled Production	Volumes
State of New Mexico #2 West Kutz Pictured Cliffs (79680)	1030 BTU	1019 BTU		127 mcf	74 mcf
State of New Mexico #3 Basin Fruitland Coal (71629)	1004 BTU				53 mcf

- (2) Are any wells producing at top allowables? ☐ Yes ☒ No
(3) Has all interest owners been notified by certified mail of the proposed commingling? ☒ Yes ☐ No.
(4) Measurement type: ☒ Metering ☐ Other (Specify)
(5) Will commingling decrease the value of production? ☐ Yes ☒ No If "yes", describe why commingling should be approved

(B) LEASE COMMINGLING

Please attach sheets with the following information

- (1) Pool Name and Code.
(2) Is all production from same source of supply? ☐ Yes ☐ No
(3) Has all interest owners been notified by certified mail of the proposed commingling? ☐ Yes ☐ No
(4) Measurement type: ☐ Metering ☐ Other (Specify)

(C) POOL and LEASE COMMINGLING

Please attach sheets with the following information

- (1) Complete Sections A and E.

(D) OFF-LEASE STORAGE and MEASUREMENT

Please attached sheets with the following information

- (1) Is all production from same source of supply? ☐ Yes ☐ No
(2) Include proof of notice to all interest owners.

(E) ADDITIONAL INFORMATION (for all application types)

Please attach sheets with the following information

- (1) A schematic diagram of facility, including legal location.
(2) A plat with lease boundaries showing all well and facility locations. Include lease numbers if Federal or State lands are involved.
(3) Lease Names, Lease and Well Numbers, and API Numbers.

I hereby certify that the information above is true and complete to the best of my knowledge and belief.

SIGNATURE: Toya Colvin TITLE: Regulatory Analyst DATE: 06/08/2015
TYPE OR PRINT NAME: Toya Colvin TELEPHONE NO.: 281-366-7148 E-MAIL ADDRESS: Toya.Colvin@bp.com

State of NM CDP Shared Compression

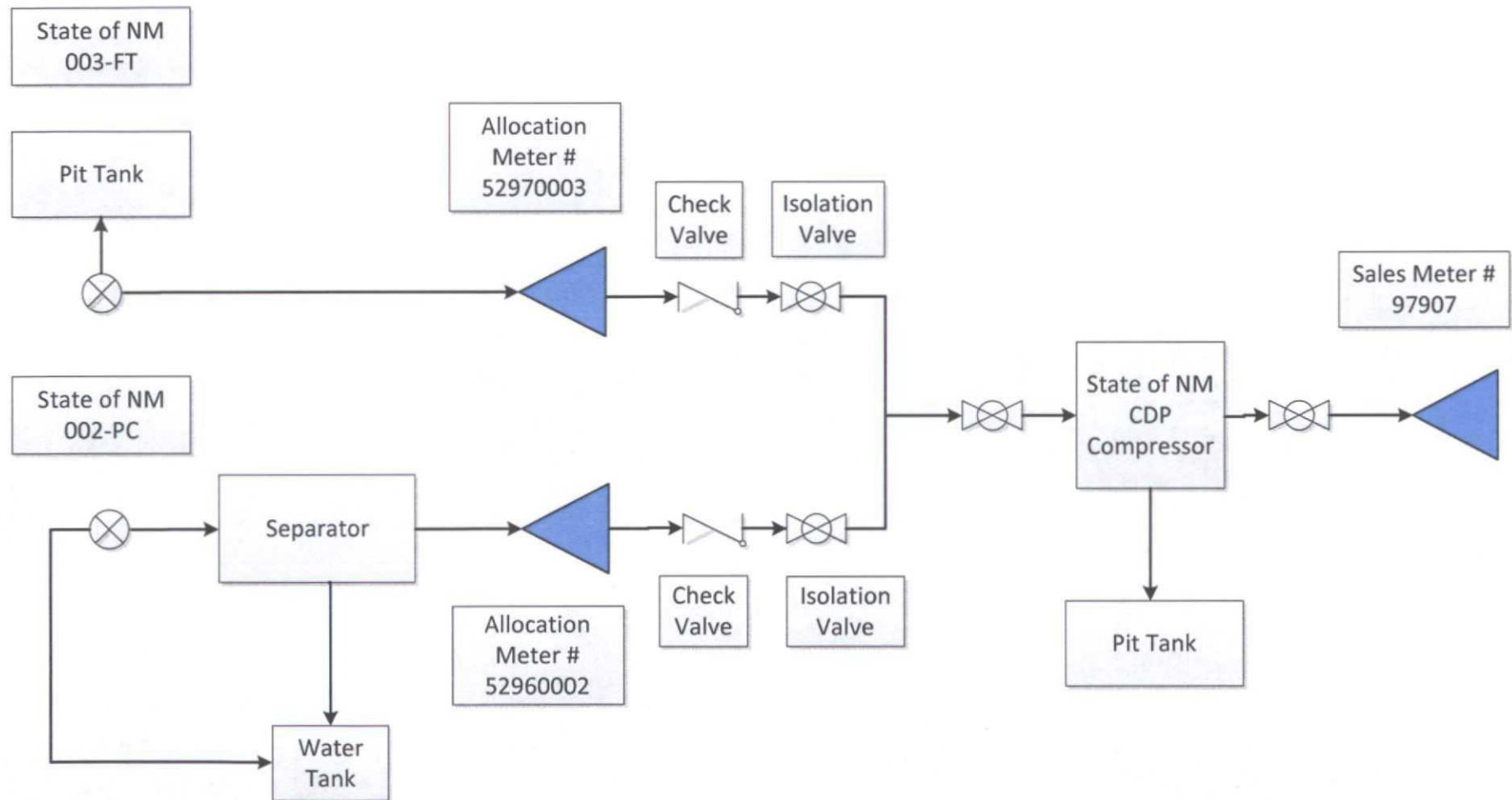

Note: This drawing is not to scale,
actual equipment is site specific



BP America Production Co.
Lower 48 Onshore

Craig T. Ferguson
craig.ferguson@bp.com
281-366-1988 (direct)

E3, 12.173B
501 Westlake Park Boulevard
Houston, Texas 77079

June 5, 2015

Ms. Toya Colvin – Regulatory Analyst
BP America Production Company
501 Westlake Park Blvd.
Houston, TX 77079

RE: Surface Commingle
API # 30-045-29030
NE4 Section 16-T29N-R12W
San Juan County, NM, and
API #30-045-29031
NE4 Section 16-T29N-R12W
San Juan County, NM

Ms. Colvin:

On behalf of BP America Production Company ("BP"), operator of the State Of NM #2 (West Kutz Pictured Cliffs) 160.0 acre unit defined as the NE/4 and the State of NM #3 (Basin Fruitland Coal) 320 acre unit defined as the E/2, I have reviewed BP's division order records and other title records concerning the above reference wells and determined the following WI and RI interest for both:

The State of NM #2 and #3 consists of 4 State of New Mexico leases:

B-11303: 40 Acres, 1/8th Royalty
B-10870: 40 Acres, 1/8th Royalty
E-9229: 200 Acres, 1/8th Royalty
E-2447: 40 Acres, 1/8th Royalty

State of NM #2 (API #3004529030)	WI
BP America Production Cos.	58.33333%
Burlington Resources	41.66667%

State of NM #3 (API #3004529031)	WI
BP America Production Cos.	35.41667%
Burlington Resources	52.08333%
Four Stars	12.50000%

Please contact me at x1988 if you have any questions concerning this topic.

Sincerely,

A handwritten signature in black ink, appearing to read 'Craig T. Ferguson', with a long horizontal line extending to the right.

Craig T. Ferguson
Land Negotiator
San Juan Asset

District I
1625 N. French Dr., Hobbs, NM 88240
District II
1301 W. Grand Avenue, Artesia, NM 88210
District III
1000 Rio Brazos Rd., Aztec, NM 87410
District IV
1220 S. St. Francis Dr., Santa Fe, NM 87505

State of New Mexico
Energy, Minerals & Natural Resources Department
OIL CONSERVATION DIVISION
1220 South St. Francis Dr.
Santa Fe, NM 87505

Form C-102
Revised July 16, 2010
Submit one copy to appropriate
District Office
☐ AMENDED REPORT

WELL LOCATION AND ACREAGE DEDICATION PLAT

¹ API Number 30-045-29030	² Pool Code 79680	³ Pool Name West Kutz Pictured Cliffs
⁴ Property Code 018879	⁵ Property Name State of New Mexico	⁶ Well Number 2
⁷ OGRID No. 000778	⁸ Operator Name BP America Production Company	⁹ Elevation 5785

¹⁰ Surface Location

UL or lot no. A	Section 16	Township 29N	Range 12W	Lot Idn	Feet from the 1100	North/South line North	Feet from the 790	East/West line East	County San Juan
---------------------------	----------------------	------------------------	---------------------	---------	------------------------------	----------------------------------	-----------------------------	-------------------------------	---------------------------

¹¹ Bottom Hole Location If Different From Surface

UL or lot no.	Section	Township	Range	Lot Idn	Feet from the	North/South line	Feet from the	East/West line	County
¹² Dedicated Acres 160	¹³ Joint or Infill	¹⁴ Consolidation Code	¹⁵ Order No.						

No allowable will be assigned to this completion until all interests have been consolidated or a non-standard unit has been approved by the division.

¹⁶										¹⁷ OPERATOR CERTIFICATION <i>I hereby certify that the information contained herein is true and complete to the best of my knowledge and belief, and that this organization either owns a working interest or unleased mineral interest in the land including the proposed bottom hole location or has a right to drill this well at this location pursuant to a contract with an owner of such a mineral or working interest, or to a voluntary pooling agreement or a compulsory pooling order heretofore entered by the division.</i>  Signature Date Toya Colvin Printed Name Toya.Colvin@bp.com E-mail Address
										¹⁸ SURVEYOR CERTIFICATION <i>I hereby certify that the well location shown on this plat was plotted from field notes of actual surveys made by me or under my supervision, and that the same is true and correct to the best of my belief.</i> Date of Survey Signature and Seal of Professional Surveyor: Previously Filed Certificate Number

District I
1625 N. French Dr., Hobbs, NM 88240

District II
1301 W. Grand Avenue, Artesia, NM 88210

District III
1000 Rio Brazos Rd., Aztec, NM 87410

District IV
1220 S. St. Francis Dr., Santa Fe, NM 87505

State of New Mexico
Energy, Minerals & Natural Resources Department
OIL CONSERVATION DIVISION
1220 South St. Francis Dr.
Santa Fe, NM 87505

Form C-102
Revised July 16, 2010
Submit one copy to appropriate
District Office

☐ AMENDED REPORT

WELL LOCATION AND ACREAGE DEDICATION PLAT

¹ API Number 30-045-29031		² Pool Code 71629		³ Pool Name Basin Fruitland Coal	
⁴ Property Code 018879		⁵ Property Name State of New Mexico			⁶ Well Number 3
⁷ OGRID No. 000778		⁸ Operator Name BP America Production Company			⁹ Elevation 5783

¹⁰ Surface Location

UL or lot no. B	Section 16	Township 29N	Range 12W	Lot Idn	Feet from the 790	North/South line North	Feet from the 1780	East/West line East	County San Juan
---------------------------	----------------------	------------------------	---------------------	---------	-----------------------------	----------------------------------	------------------------------	-------------------------------	---------------------------

¹¹ Bottom Hole Location If Different From Surface

UL or lot no.	Section	Township	Range	Lot Idn	Feet from the	North/South line	Feet from the	East/West line	County
---------------	---------	----------	-------	---------	---------------	------------------	---------------	----------------	--------

¹² Dedicated Acres 320	¹³ Joint or Infill	¹⁴ Consolidation Code	¹⁵ Order No.
---	-------------------------------	----------------------------------	-------------------------

No allowable will be assigned to this completion until all interests have been consolidated or a non-standard unit has been approved by the division.

16			<p>17 OPERATOR CERTIFICATION I hereby certify that the information contained herein is true and complete to the best of my knowledge and belief, and that this organization either owns a working interest or unleased mineral interest in the land including the proposed bottom hole location or has a right to drill this well at this location pursuant to a contract with an owner of such a mineral or working interest, or to a voluntary pooling agreement or a compulsory pooling order heretofore entered by the division.</p> <p><i>Toya Colvin</i> 4/08/15 Signature Date</p> <p>Toya Colvin Printed Name</p> <p>Toya.Colvin@bp.com E-mail Address</p>	
				<p>18 SURVEYOR CERTIFICATION I hereby certify that the well location shown on this plat was plotted from field notes of actual surveys made by me or under my supervision, and that the same is true and correct to the best of my belief.</p>
				<p>Date of Survey</p> <p>Signature and Seal of Professional Surveyor:</p>
				<p>Previously Filed</p> <p>Certificate Number</p>

SENDER: COMPLETE THIS SECTION		COMPLETE THIS SECTION ON DELIVERY	
<ul style="list-style-type: none"> Complete items 1, 2, and 3. Also complete item 4 if Restricted Delivery is desired. Print your name and address on the reverse so that we can return the card to you. Attach this card to the back of the mailpiece, or on the front if space permits. 		A. Signature X <input type="checkbox"/> Agent <input type="checkbox"/> Addressee	
		B. Received by (Printed Name)	C. Date of Delivery
1. Article Addressed to: <i>The New Mexico State Land Office</i> <i>PO Box 1148</i> <i>Santa Fe, NM 87504-1148</i>		D. Is delivery address different from item 1? <input type="checkbox"/> Yes If YES, enter delivery address below: <input type="checkbox"/> No	
		3. Service Type <input checked="" type="checkbox"/> Certified Mail <input type="checkbox"/> Express Mail <input type="checkbox"/> Registered <input checked="" type="checkbox"/> Return Receipt for Merchandise <input type="checkbox"/> Insured Mail <input type="checkbox"/> C.O.D.	
		4. Restricted Delivery? (Extra Fee) <input type="checkbox"/> Yes	
2. Article Number (Transfer from serv		7008 1140 0001 9414 9245	

PS Form 3811, February 2004

Domestic Return Receipt

102595-02-M-1540

7008 1140 0001 9414 9245
7008 1140 0001 9414 9245

U.S. Postal Service™	
CERTIFIED MAIL™ RECEIPT	
(Domestic Mail Only; No Insurance Coverage Provided)	
For delivery information, visit our website at www.usps.com	
OFFICIAL USE	
Postage	\$
Certified Fee	
Return Receipt Fee (Endorsement Required)	
Restricted Delivery Fee (Endorsement Required)	
Total Postage & Fees	\$
Postmark Here	
Sent To <i>The New Mexico State Land Office</i> Street, Apt. No., or PO Box No. <i>PO Box 1148</i> City, State, ZIP+4 <i>Santa Fe, NM 87504-1148</i>	
PS Form 3800, August 2006 See Reverse for Instructions	

SENDER: COMPLETE THIS SECTION		COMPLETE THIS SECTION ON DELIVERY	
<ul style="list-style-type: none"> Complete items 1, 2, and 3. Also complete item 4 if Restricted Delivery is desired. Print your name and address on the reverse so that we can return the card to you. Attach this card to the back of the mailpiece, or on the front if space permits. 		A. Signature X <div style="text-align: right;"> <input type="checkbox"/> Agent <input type="checkbox"/> Addressee </div>	
		B. Received by (Printed Name)	C. Date of Delivery
1. Article Addressed to: Four Star Oil & Gas c/o Chevron USA Inc. Attn: Land Dept. 1400 Smith Street Houston, TX 77002		D. Is delivery address different from item 1? <input type="checkbox"/> Yes If YES, enter delivery address below: <input type="checkbox"/> No	
		3. Service Type <input checked="" type="checkbox"/> Certified Mail <input type="checkbox"/> Express Mail <input type="checkbox"/> Registered <input checked="" type="checkbox"/> Return Receipt for Merchandise <input type="checkbox"/> Insured Mail <input type="checkbox"/> C.O.D.	
2. Article Number: (Transfer from si) 7008 1140 0001 9414 9238		4. Restricted Delivery? (Extra Fee) <input type="checkbox"/> Yes	
PS Form 3811, February 2004		Domestic Return Receipt	
		102595-02-M-1540	

PLACE STICKER AT TOP OF ENVELOPE TO THE RIGHT OF THE RETURN ADDRESS, FOLD AT DOTTED LINE
CERTIFIED MAIL™

7008 1140 0001 9414 9238
7008 1140 0001 9414 9238

U.S. Postal Service™	
CERTIFIED MAIL™ RECEIPT	
(Domestic Mail Only; No Insurance Coverage Provided)	
For delivery information visit our website at www.usps.com	
OFFICIAL USE	
Postage \$	Postmark Here
Certified Fee	
Return Receipt Fee (Endorsement Required)	
Restricted Delivery Fee (Endorsement Required)	
Total Postage & Fees \$	
Sent To Four Star c/o Chevron USA Inc. Street, Apt. No., or PO Box No. 1400 Smith Street City, State, ZIP+4 Houston, TX 77002	
PS Form 3800, August 2006 See Reverse for Instructions	

SENDER: COMPLETE THIS SECTION		COMPLETE THIS SECTION ON DELIVERY	
<ul style="list-style-type: none"> Complete items 1, 2, and 3. Also complete item 4 if Restricted Delivery is desired. Print your name and address on the reverse so that we can return the card to you. Attach this card to the back of the mailpiece, or on the front if space permits. 		A. Signature X <input type="checkbox"/> Agent <input type="checkbox"/> Addressee	
1. Article Addressed to: Burlington Resources Attn: Land Dept. PO Box 4289 Farmington, NM 87499-4289		B. Received by (Printed Name) C. Date of Delivery D. Is delivery address different from item 1? <input type="checkbox"/> Yes If YES, enter delivery address below: <input type="checkbox"/> No	
2. Article Number (Transfer from ser) 7008 1140 0001 9414 9252		3. Service Type <input checked="" type="checkbox"/> Certified Mail <input type="checkbox"/> Express Mail <input type="checkbox"/> Registered <input checked="" type="checkbox"/> Return Receipt for Merchandise <input type="checkbox"/> Insured Mail <input type="checkbox"/> C.O.D. 4. Restricted Delivery? (Extra Fee) <input type="checkbox"/> Yes	
PS Form 3811, February 2004 Domestic Return Receipt 102595-02-M-1540			

PLACE STICKER AT TOP OF ENVELOPE TO THE RIGHT
OF THE RETURN ADDRESS. FOLD AT DOTTED LINE
CERTIFIED MAIL™

7008 1140 0001 9414 9252
7008 1140 0001 9414 9252

U.S. Postal Service™	
CERTIFIED MAIL™ RECEIPT	
(Domestic Mail Only; No Insurance Coverage Provided)	
For delivery information visit our website at www.usps.com	
OFFICIAL USE	
Postage \$	Postmark Here
Certified Fee	
Return Receipt Fee (Endorsement Required)	
Restricted Delivery Fee (Endorsement Required)	
Total Postage & Fees \$	
Sent to Burlington Resources Street, Apt. No., or PO Box No. PO Box 4289 City, State, ZIP+4 Farmington, NM 87499-4289	
PS Form 3800, August 2006 See Reverse for Instructions	

nm State #2 I/I

SIGN-IN HELP

Time Frame	Production				Injection				Pressure	Wells	Operator Data
	Oil (BBLS)	Gas (MCF)	Water (BBLS)	Days P/I	Water (BBLS)	Co2 (MCF)	Gas (MCF)	Other			
2000	0	96067	2139	366	0	0	0	0	N/A		
2001	0	124193	2075	362	0	0	0	0	N/A		
2002	0	103431	1686	365	0	0	0	0	N/A		
2003	0	94554	2015	352	0	0	0	0	N/A		
2004	0	93977	1830	337	0	0	0	0	N/A		
2005	0	77686	1940	354	0	0	0	0	N/A		
2006	0	71797	1800	365	0	0	0	0	N/A		
2007	0	27439	630	207	0	0	0	0	N/A		
2008	0	13494	1800	182	0	0	0	0	N/A		
2009	0	34447	2769	339	0	0	0	0	N/A		
2010	0	40182	2775	359	0	0	0	0	N/A		
2011	0	26600	1666	356	0	0	0	0	N/A		
2012	0	19737	2213	259	0	0	0	0	N/A		
2013	0	22206	1195	365	0	0	0	0	N/A		
2014											
KUTZ PICTURED CLIFFS, WEST (GAS)											
Jan	0	118	0	31	0	0	0	0	0		
Feb	0	2171	500	28	0	0	0	0	0		
Mar	0	2400	225	31	0	0	0	0	0		
Apr	0	2704	226	30	0	0	0	0	0		
May	0	2611	300	31	0	0	0	0	0		
Jun	0	2392	175	30	0	0	0	0	0		
Jul	0	2621	207	31	0	0	0	0	0		
Aug	0	2197	150	31	0	0	0	0	0		
Sep	0	2476	141	30	0	0	0	0	0		
Oct	0	1953	102	31	0	0	0	0	0		
Nov	0	1269	0	30	0	0	0	0	0		
Dec	0	1354	25	31	0	0	0	0	0		

SIGN-IN HELP

Time Frame	Production				Injection				Pressure	Wells	Operator Data
	Oil (BBLs)	Gas (MCF)	Water (BBLs)	Days P/I	Water (BBLs)	Co2 (MCF)	Gas (MCF)	Other			
Pool Total:	0	24266	2051	365	0	0	0	0	N/A		
Annual Total:	0	24266	2051	365	0	0	0	0	N/A		
2015											
KUTZ PICTURED CLIFFS, WEST (GAS)											
Jan	0	284	0	31	0	0	0	0	0		
Feb	0	1205	375	28	0	0	0	0	0		
Mar	0	2119	225	31	0	0	0	0	0		
Pool Total:	0	3608	600	90	0	0	0	0	N/A		
Annual Total:	0	3608	600	90	0	0	0	0	N/A		
Grand Total:	0	1177567	37687	6642	0	0	0	0	N/A		

Transporters

Transporter	Product	Most Recent for Property
[7057] EL PASO NATURAL GAS CO	Gas	3/2015

Points of Disposition

ID	Type	Description	Pool(s)
2812144	Water	STATE OF NM #2	[79680] KUTZ PICTURED CLIFFS, WEST (GAS)
2812142	Gas	STATE OF NM #2	[79680] KUTZ PICTURED CLIFFS, WEST (GAS)

Time Frame	Production				Injection				Pressure	Wells	Operator Data
	Oil (BBLs)	Gas (MCF)	Water (BBLs)	Days P/I	Water (BBLs)	Co2 (MCF)	Gas (MCF)	Other			
2010	0	6695	87	179	0	0	0	0	N/A		
2011	0	16839	134	250	0	0	0	0	N/A		
2012	0	30200	205	366	0	0	0	0	N/A		
2013	0	24431	155	356	0	0	0	0	N/A		
2014											
BASIN FRUITLAND COAL (GAS)											
Jan	0	1439	45	31	0	0	0	0	0		
Feb	0	1225	93	28	0	0	0	0	0		
Mar	0	975	0	31	0	0	0	0	0		
Apr	0	1299	0	30	0	0	0	0	0		
May	0	1259	0	31	0	0	0	0	0		
Jun	0	1174	0	30	0	0	0	0	0		
Jul	0	1178	0	31	0	0	0	0	0		
Aug	0	965	0	31	0	0	0	0	0		
Sep	0	667	0	30	0	0	0	0	0		
Oct	0	720	0	31	0	0	0	0	0		
Nov	0	699	0	30	0	0	0	0	0		
Dec	0	1015	50	31	0	0	0	0	0		
Pool Total:	0	12615	188	365	0	0	0	0	N/A		
Annual Total:	0	12615	188	365	0	0	0	0	N/A		
2015											
BASIN FRUITLAND COAL (GAS)											
Jan	0	440	0	31	0	0	0	0	0		
Feb	0	1195	0	28	0	0	0	0	0		
Mar	0	1433	0	31	0	0	0	0	0		
Pool Total:	0	3068	0	90	0	0	0	0	N/A		
Annual Total:	0	3068	0	90	0	0	0	0	N/A		
Grand Total:	0	1236944	3056	6756	0	0	0	0	N/A		