

DATE: 6/12/2015	SUSPENSE	ENGINEER: MAM	LOGGED IN: 6/14/2015	TYPE: NSL	APP NO: PLAMIS/6359837
-----------------	----------	---------------	----------------------	-----------	------------------------

ABOVE THIS LINE FOR DIVISION USE ONLY

**NEW MEXICO OIL CONSERVATION DIVISION**  
 - Engineering Bureau -  
 1220 South St. Francis Drive, Santa Fe, NM 87505



**ADMINISTRATIVE APPLICATION CHECKLIST**

THIS CHECKLIST IS MANDATORY FOR ALL ADMINISTRATIVE APPLICATIONS FOR EXCEPTIONS TO DIVISION RULES AND REGULATIONS WHICH REQUIRE PROCESSING AT THE DIVISION LEVEL IN SANTA FE

**Application Acronyms:**

**[NSL-Non-Standard Location] [NSP-Non-Standard Proration Unit] [SD-Simultaneous Dedication]**  
**[DHC-Downhole Commingling] [CTB-Lease Commingling] [PLC-Pool/Lease Commingling]**  
**[PC-Pool Commingling] [OLS - Off-Lease Storage] [OLM-Off-Lease Measurement]**  
**[WFX-Waterflood Expansion] [PMX-Pressure Maintenance Expansion]**  
**[SWD-Salt Water Disposal] [IPI-Injection Pressure Increase]**  
**[EOR-Qualified Enhanced Oil Recovery Certification] [PPR-Positive Production Response]**

**[1] TYPE OF APPLICATION - Check Those Which Apply for [A]**

- [A] Location - Spacing Unit - Simultaneous Dedication  
☒ NSL ☐ NSP ☐ SD

Check One Only for [B] or [C]

- [B] Commingling - Storage - Measurement  
☐ DHC ☐ CTB ☐ PLC ☐ PC ☐ OLS ☐ OLM

- [C] Injection - Disposal - Pressure Increase - Enhanced Oil Recovery  
☐ WFX ☐ PMX ☐ SWD ☐ IPI ☐ EOR ☐ PPR

- [D] Other: Specify \_\_\_\_\_

**[2] NOTIFICATION REQUIRED TO: - Check Those Which Apply, or Does Not Apply**

- [A] ☐ Working, Royalty or Overriding Royalty Interest Owners

- [B] ☒ Offset Operators, Leaseholders or Surface Owner

- [C] ☐ Application is One Which Requires Published Legal Notice

- [D] ☒ Notification and/or Concurrent Approval by BLM or SLO  
 U. S. Bureau of Land Management - Commissioner of Public Lands, State Land Office

- [E] ☐ For all of the above, Proof of Notification or Publication is Attached, and/or,

- [F] ☐ Waivers are Attached

**[3] SUBMIT ACCURATE AND COMPLETE INFORMATION REQUIRED TO PROCESS THE TYPE OF APPLICATION INDICATED ABOVE.**

**[4] CERTIFICATION:** I hereby certify that the information submitted with this application for administrative approval is **accurate** and **complete** to the best of my knowledge. I also understand that **no action** will be taken on this application until the required information and notifications are submitted to the Division.

**Note:** Statement must be completed by an individual with managerial and/or supervisory capacity.

Jordan L. Kessler  
 Print or Type Name

Signature

\_\_\_\_\_  
 Title

jlkessler@hollandhart.com  
 e-mail Address

Date

RECEIVED OCD  
 015 JUN 12 P 4: 18

-NSL-7318  
 -EDG Resources, Inc  
 7377

-WCH  
 -Nephtale 1067042.com  
 7014

30-025-42575  
 POU  
 -WC-025G-09  
 S2433UP, 4ppen  
 WOLFcamp  
 98135

6/12/15

June 12, 2015

**VIA HAND DELIVERY**

David Catanach  
Oil Conservation Division  
New Mexico Department of Energy,  
Minerals and Natural Resources  
1220 South Saint Francis Drive  
Santa Fe, New Mexico 87505

RECEIVED OGD  
2015 JUN 12 P 4:18

**Re: Application of EOG Resources, Inc. for administrative approval of an unorthodox well location for its Neptune 10 State Com No. 701H Well in the W/2 E/2 of Section 10, Township 24 South, Range 33 East, N.M.P.M., Lea County, New Mexico.**

Dear Mr. Catanach:

EOG Resources, Inc. (OGRID No. 7377) seeks administrative approval of an unorthodox well location for its **Neptune 10 State Com No. 701H Well** to be completed within the WC-025 G-09 S243310P; Upper Wolf Camp (Pool Code 98135) underlying Section 10, Township 24 South, Range 33 East, N.M.P.M., Lea County, New Mexico. This well will be drilled from a surface location 250 feet from the South line and 580 feet from the East line (Unit P) of Section 10. The upper most perforation will be located 330 feet from South line and 1380 feet from the East line (Unit O) of Section 10 and the lower most perforation will be 330 feet from the North line and 1380 feet from the East line of Section 10 (Unit B). Since this acreage is governed by the Division's statewide rules which provides for wells to be located no closer than 330 feet to the outer boundary of the spacing unit, the completed interval for this well will be unorthodox because it is closer than 330 feet to the northeastern, eastern, and southeastern boundaries of the project area. Approval of the unorthodox completed interval will allow for efficient spacing of horizontal wells and thereby prevent waste.

**Exhibit A** is the Well Location and Acreage Dedication Plat (Form C-102), which shows that the completed interval of the proposed **Neptune 10 State Com No. 701H Well** encroaches on the spacing and proration units to the Northeast, East, and Southeast.

**Exhibit B** is a land plat for Section 10 and the surrounding sections that shows the proposed **Neptune 10 State Com No. 701H Well** in relation to adjoining units and existing wells.

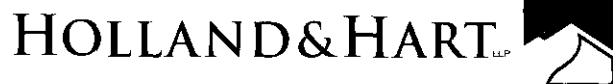

**Exhibit C** is a list of the parties affected by the encroachment to the Northeast, East, and Southeast. EOG is the operator of the offsetting acreage to the Northeast and East. However, as a working interest owner, Devon Energy Production Company is entitled to notice. Each of the parties listed on Exhibit C have been provided notice of this application by certified mail, and has been advised that if they have an objection it must be filed in writing with the Division within 20 days from the date the Division receives this application. In addition, a courtesy copy of this application has been provided to the New Mexico State Land Office.

Your attention to this matter is appreciated.

Sincerely,

A handwritten signature in black ink, appearing to read "J. L. Kessler".

Jordan L. Kessler

**ATTORNEY FOR EOG RESOURCES, INC.**

cc: New Mexico State Land Office  
P.O. Box 1148  
Santa Fe, NM 87504

S:\SURVEY\EOG MIDLAND\NEPTUNE 10 STATE\FINAL PRODUCTS\ILO NEPTUNE10STATE.COM 701H REV1.DWG 5/14/2015 11:32:52 AM avillagrana

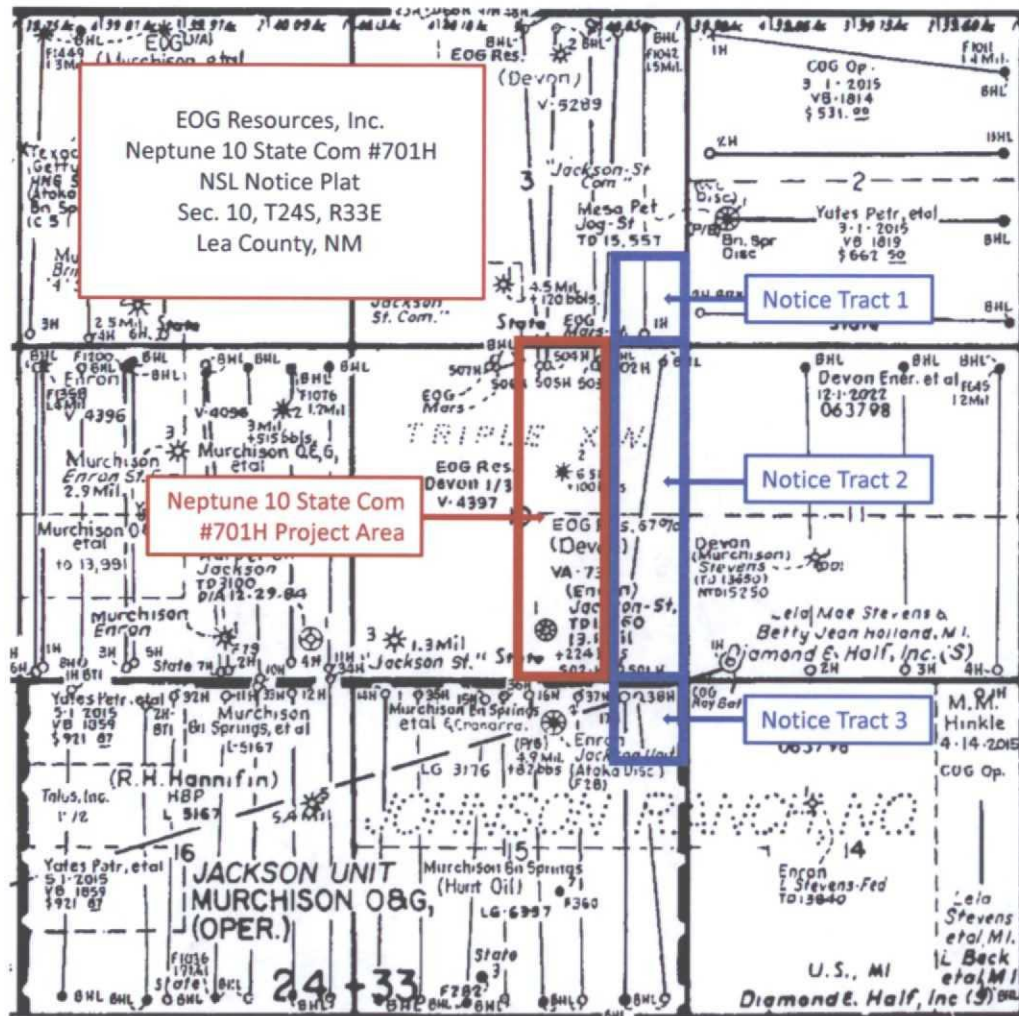

**Exhibit C**

Devon Energy Production Company  
333 W. Sheridan  
Oklahoma City, OK 73102

Murchison Oil & Gas, Inc.  
Legacy Tower One  
7520 Dallas Parkway, Suite 1400  
Plano, TX 75024

**HOLLAND & HART**



**Jordan L. Kessler**  
**Associate**

**Phone** (505) 988-4421

**Fax** (505) 983-6043

[jlkessler@hollandhart.com](mailto:jlkessler@hollandhart.com)

June 15, 2015

**VIA CERTIFIED MAIL**  
**RETURN RECEIPT REQUESTED**

**TO AFFECTED PARTIES**

**Re: Application of EOG Resources, Inc. for administrative approval of an unorthodox well location for its Neptune 10 State Com No. 701H Well in the W/2 E/2 of Section 10, Township 24 South, Range 33 East, N.M.P.M., Lea County, New Mexico.**

Ladies and Gentlemen:

Enclosed is a copy of the above-referenced application which was filed with the New Mexico Oil Conservation Division on this date. Any objection to this application must be filed in writing within twenty days from this date with the applicant and the New Mexico Oil Conservation Division, 1220 South St. Francis Drive, Santa Fe, New Mexico, 87505. If no objection is received within this twenty-day period, this application may be approved administratively by the Division.

If you have any questions about this application, please contact the following:

Matt Phillips  
EOG Resources, Inc.  
(432) 686-3649  
[Matthew\\_Phillips@eogresources.com](mailto:Matthew_Phillips@eogresources.com)

Sincerely,

Jordan L. Kessler

**ATTORNEY FOR EOG RESOURCES, INC.**

**Holland & Hart LLP**

**Phone** (505) 988-4421 **Fax** (505) 983-6043 **www.hollandhart.com**

110 North Guadalupe Suite 1 Santa Fe, New Mexico 87501 **Mailing Address** P.O. Box 2208 Santa Fe, NM 87504-2208

Aspen Boulder Carson City Colorado Springs Denver Denver Tech Center Billings Boise Cheyenne Jackson Hole Las Vegas Reno Salt Lake City Santa Fe Washington, D.C. ☐