



Texaco E & P

205 E. Bender Blvd.  
Hobbs NM 88240  
505 393 7191

OIL FIELD DIVISION  
OCT 21 1996

96 OCT 21 8 52

1400

October 21, 1996

NMOCD  
2040 South Pacheco  
Santa Fe, New Mexico 87505

Attn: Mr. William J. LeMay

**Subject: Application to DHC C. H. Weir "A" #4, E-12-20S-37E, in the Monument Tubb (47090)  
and Skaggs Drinkard (57000) Pools.**

Dear Mr. LeMay:

Texaco Exploration and Production, Inc. respectfully requests administrative approval to downhole commingle the C. H. Weir "A" #4 in the Monument Tubb and Skaggs Drinkard Pools. Notification of this application has been sent to the offset operators and a statement of notification has been included in this package. Currently, the Tubb is being beam pumped with the Drinkard plugged back.

The proposed downhole commingling will provide a more economical means of production by allowing both intervals to be artificially lifted simultaneously. This will extend the productive life of both completions.

This well meets all of the requirements set forth by Rule 303(C). Due to the recency of the Tubb completion, a full year of production data is not available. The allocation factors were calculated in the following manner:

$$\% \text{ DRINKARD} = \frac{\text{DRINKARD STABILIZED PRODUCTION}}{\text{DRINKARD} + \text{TUBB STABILIZED PRODUCTION}}$$

$$\% \text{ TUBB} = 100\% - \% \text{ DRINKARD.}$$

If you have any questions concerning this application, please contact Britton M. McQuien at (505) 397-0427.

Sincerely

Britton M. McQuien  
Production Engineer  
Texaco Exploration and Production, Inc.

cc: Mr. J. T. Sexton

enc

## EXHIBIT "B" - CASE NO. 11353, ORDER NO. R-10470-A

## DISTRICT I

P.O. Box 1980, Hobbs, NM 88240

## DISTRICT II

811 South First St., Artesia, NM 88210

## DISTRICT III

1000 Rio Brazos Rd., Aztec, NM 87410

State of New Mexico  
Energy, Minerals and Natural Resources Department

## OIL CONSERVATION DIVISION

2040 S. Pacheco  
Santa Fe, New Mexico 87505-6429Form C-107-A  
New 3-12-96

APPROVAL PROCESS:

☐ Administrative ☐ Hearing

EXISTING WELLBORE

☐ YES ☐ NO

## APPLICATION FOR DOWNHOLE COMMINGLING

Texaco Exploration & Producing Inc. 205 East Bender Hobbs, New Mexico 88240  
Operator AddressC. H. Weir "A" 4 E-12-20S-37E Lea  
Lease Well No. Unit Ltr. - Sec - Tws - Rge County

Spacing Unit Lease Types: (check 1 or more)

OGRID NO. 022351 Property Code 011130 API NO. 30-025-29731 Federal ☐ State ☒ (and/or) Fee ☐

The following facts are submitted in support of downhole commingling:	Lower Zone	Intermediate Zone	Upper Zone
1. Pool Name and Pool Code	Skaggs Drinkard 57000		Monument Tubb 47090
2. Top And Bottom of Pay Section (Perforations)	6605-6828		6406-6474
3. Type of production (Oil or Gas)	oil		oil
4. Method of Production (Flowing or Artificial Lift)	flowing		flowing
5. Bottomhole Pressure Oil Zones - Artificial Lift: Estimated Current	(Current) a. 700 psi	a.	a. 908 psi
Gas & Oil - Flowing: Measured Current	(Original) b.	b.	b.
All Gas Zones: Estimated Or Measured Original			
6. Oil Gravity (* API) or Gas BTU Content	34.6		34.6
7. Producing or Shut-In? Production Marginal? (yes or no)	shut-in yes		producing yes
* If Shut-In, give date and oil/gas/ water rates of last production Note: For new zones with no production history, applicant shall be required to attach production estimates and supporting data	Date: 7/23/96 Rates: 0.1/323/0		
* If Producing, give date and oil/gas/ water rates of recent test (within 60 days)	Date: Rates:		8/2/96 1/256/8
8. Fixed Percentage Allocation Formula - % for each zone	Oil: 9% Gas: 56%	Oil: % Gas: %	Oil: 91% Gas: 44%

9. If allocation Formula is based upon something other than current or past production, or is based upon some other method, submit attachments with supporting data and/or explaining method and providing rate projections or other required data.
10. Are all working, overriding, and royalty interests identical in all commingled zones? ☒ Yes ☐ No  
If not, have all working, overriding, and royalty interests been notified by certified mail? ☐ Yes ☐ No  
Have all offset operators been given written notice of the proposed downhole commingling? ☒ Yes ☐ No
11. Will cross-flow occur? ☐ Yes ☒ No If yes, are fluids compatible, will the Formations not be damaged, will any cross-flowed production be recovered, and will the allocation formula be reliable. ☐ Yes ☐ No (If No, attach explanation)
12. Are all produced fluids from all commingled zones compatible with other? ☒ Yes ☐ No
13. Will the value of production be decreased by commingling? ☐ Yes ☒ No (If Yes, attach explanation)
14. If this well is on, or communitized with, state or federal lands, either the Commissioner of Public Land or the United States Bureau of Land Management has been notified in writing of this application. ☒ Yes ☐ No
15. NMOC Reference Cases for Rule 303(C) Exceptions: ORDER NO(S). \_\_\_\_\_
16. ATTACHMENTS:

- \* C-102 for each zone to be commingled showing its spacing unit and acreage deication.
- \* Production curve for each zone for at lease one year. (If not available, attach explanation.)
- \* For zones with no production history, estimated production rates and supporting data.
- \* Notification list of all offset operators.
- \* Notification list of working, overriding, and royalty interests for uncommon interest cases.
- \* Any additional statements, data or documents required to support commingling.

I hereby certify that the information above is true and complete to the best of my knowledge and belief

SIGNATURE Britton M. McQuien TITLE Engineer DATE 10-21-96TYPE OR PRINT NAME Britton M. McQuien TELEPHONE NO. ( 505 ) 397-0427

DISTRICT I  
P.O. Box 1980, Hobbs, NM 88241-1980

DISTRICT II  
P.O. Box Drawer DD, Artesia, NM 88211-0719

DISTRICT III  
1000 Rio Brazos Rd., Aztec, NM 87410

DISTRICT IV  
P.O. Box 2088, Santa Fe, NM 87504-2088

State of New Mexico  
Energy, Minerals and Natural Resources Department

**OIL CONSERVATION DIVISION**

P.O. Box 2088  
Santa Fe, New Mexico 87504-2088

Form C-102  
Revised February 10, 1994  
Instructions on back  
Submit to Appropriate District Office  
State Lease - 4 Copies  
Fee Lease - 3 Copies  
☐ AMENDED REPORT

**WELL LOCATION AND ACREAGE DEDICATION PLAT**

<sup>1</sup> API Number 30 025 06070	<sup>2</sup> Pool Code 57000	<sup>3</sup> Pool Name SKAGGS DRINKARD
<sup>4</sup> Property Code 011130	<sup>5</sup> Property Name WEIR, C. H. -A-	<sup>6</sup> Well No. 4
<sup>7</sup> OGRID Number 022351	<sup>8</sup> Operator Name TEXACO EXPLORATION & PRODUCTION INC.	<sup>9</sup> Elevation 3585 DF

**<sup>10</sup> Surface Location**

UI or lot no.	Section	Township	Range	Lot.Idn	Feet From The	North/South Line	Feet From The	East/West Line	County
E	12	20S	37E		1984	NORTH	660	WEST	LEA

**<sup>11</sup> Bottom Hole Location If Different From Surface**

UI or lot no.	Section	Township	Range	Lot.Idn	Feet From The	North/South Line	Feet From The	East/West Line	County

<sup>12</sup> Dedicated Acres 40	<sup>13</sup> Joint or Infill No	<sup>14</sup> Consolidation Code	<sup>15</sup> Order No.
-------------------------------------	-------------------------------------	----------------------------------	-------------------------

NO ALLOWABLE WILL BE ASSIGNED TO THIS COMPLETION UNTIL ALL INTERESTS HAVE BEEN CONSOLIDATED  
OR A NON-STANDARD UNIT HAS BEEN APPROVED BY THE DIVISION

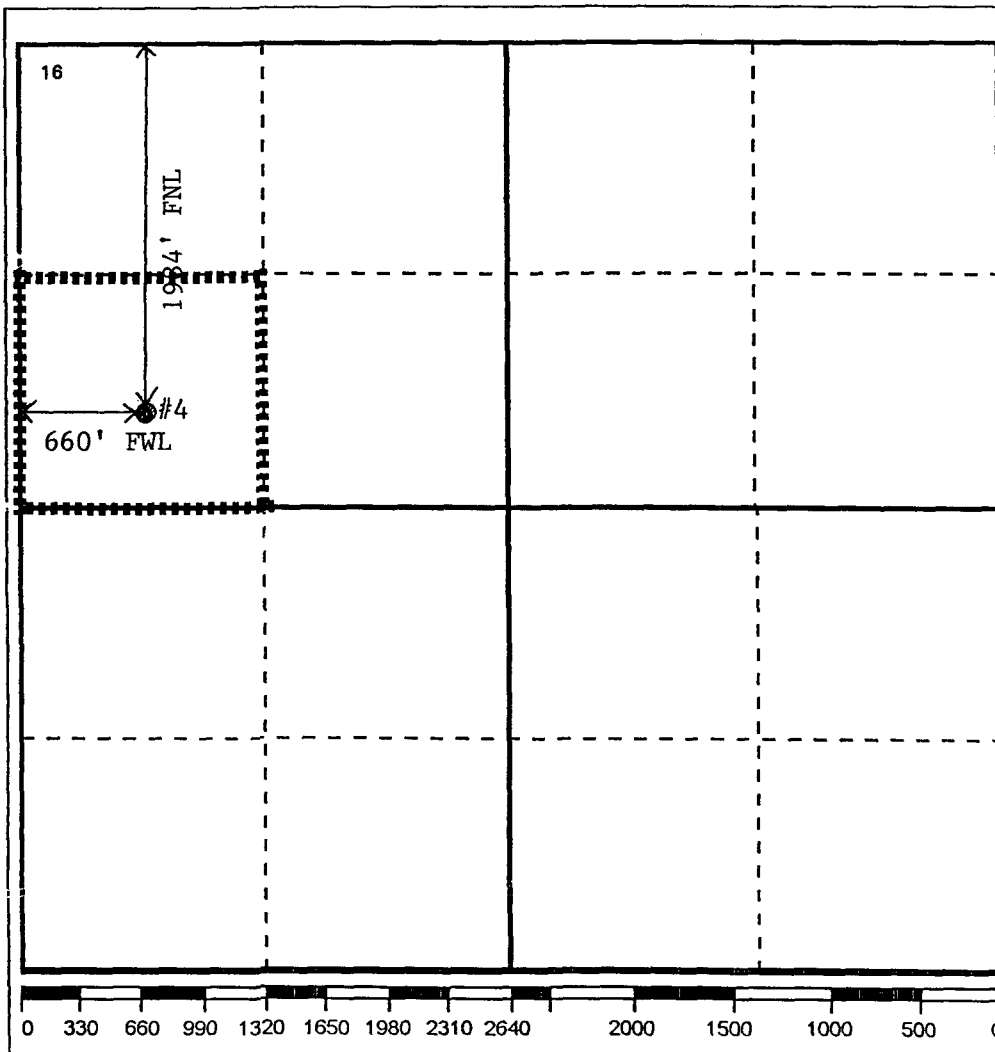

**17 OPERATOR CERTIFICATION**

I hereby certify that the information  
contained herein is true and complete to the  
best of my knowledge and belief

Signature

Printed Name

Paula S. Ives

Position

Engineering Assistant

Date

9/23/96

**18 SURVEYOR CERTIFICATION**

I hereby certify that the well location shown  
on this plat was plotted from field notes of  
actual surveys made by me or under my  
supervision, and that the same is true and  
correct to the best of my knowledge and  
belief.

Date Surveyed

Signature & Seal of  
Professional Surveyor

Certificate No.

DISTRICT I  
P.O. Box 1980, Hobbs, NM 88241-1980  
DISTRICT II  
P.O. Box Drawer DD, Artesia, NM 88211-0719  
DISTRICT III  
1000 Rio Brazos Rd., Aztec, NM 87410  
DISTRICT IV  
P.O. Box 2088, Santa Fe, NM 87504-2088

State of New Mexico  
Energy, Minerals and Natural Resources Department

Form C-102  
Revised February 10, 1994  
Instructions on back  
Submit to Appropriate District Office  
State Lease - 4 Copies  
Fee Lease - 3 Copies  
☐ AMENDED REPORT

OIL CONSERVATION DIVISION  
P.O. Box 2088  
Santa Fe, New Mexico 87504-2088

WELL LOCATION AND ACREAGE DEDICATION PLAT

<sup>1</sup> API Number 30 025 06070		<sup>2</sup> Pool Code 47090		<sup>3</sup> Pool Name MONUMENT TUBB	
<sup>4</sup> Property Code 011130		<sup>5</sup> Property Name WEIR, C. H. -A-			<sup>6</sup> Well No. 4
<sup>7</sup> OGRID Number 022351		<sup>8</sup> Operator Name TEXACO EXPLORATION & PRODUCTION INC.			<sup>9</sup> Elevation 3585 DF

<sup>10</sup> Surface Location

UI or lot no.	Section	Township	Range	Lot.Idn	Feet From The	North/South Line	Feet From The	East/West Line	County
E	12	20S	37E		1984	NORTH	660	WEST	LEA

<sup>11</sup> Bottom Hole Location If Different From Surface

UI or lot no.	Section	Township	Range	Lot.Idn	Feet From The	North/South Line	Feet From The	East/West Line	County
---------------	---------	----------	-------	---------	---------------	------------------	---------------	----------------	--------

<sup>12</sup> Dedicated Acres 80	<sup>13</sup> Joint or Infill No	<sup>14</sup> Consolidation Code	<sup>15</sup> Order No.
-------------------------------------	-------------------------------------	----------------------------------	-------------------------

NO ALLOWABLE WILL BE ASSIGNED TO THIS COMPLETION UNTIL ALL INTERESTS HAVE BEEN CONSOLIDATED  
OR A NON-STANDARD UNIT HAS BEEN APPROVED BY THE DIVISION

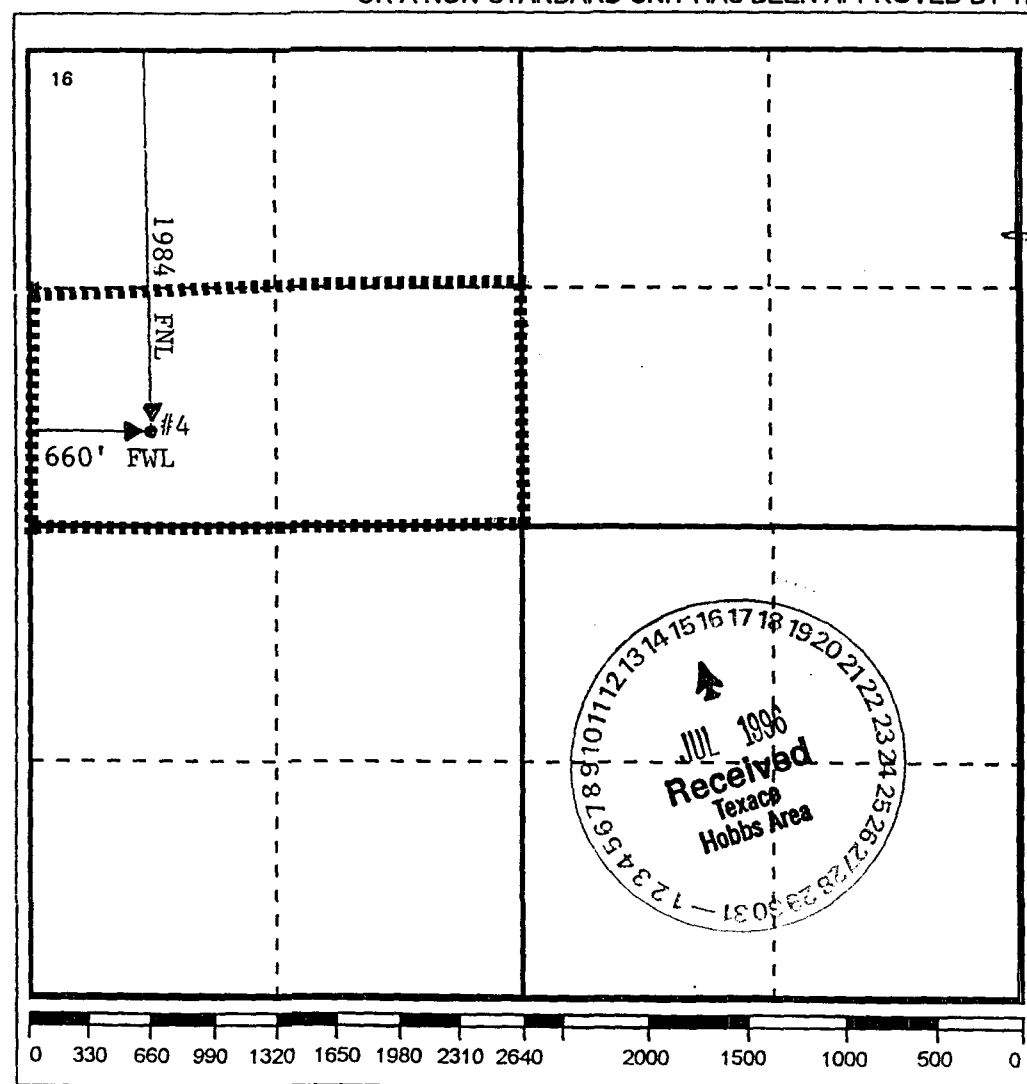

<p><b>17 OPERATOR CERTIFICATION</b></p> <p>I hereby certify that the information contained herein is true and complete to the best of my knowledge and belief</p> <p>Signature: <i>Paula S. Ives</i></p> <p>Printed Name: Paula S. Ives</p> <p>Position: Engineering Assistant</p> <p>Date: 7/8/96</p>
<p><b>18 SURVEYOR CERTIFICATION</b></p> <p>I hereby certify that the well location shown on this plat was plotted from field notes of actual surveys made by me or under my supervision, and that the same is true and correct to the best of my knowledge and belief.</p> <p>Date Surveyed:</p> <p>Signature &amp; Seal of Professional Surveyor:</p> <p>Certificate No.:</p>

# WEIR, C. H. -A- 4 SKAGGS DRINKARD

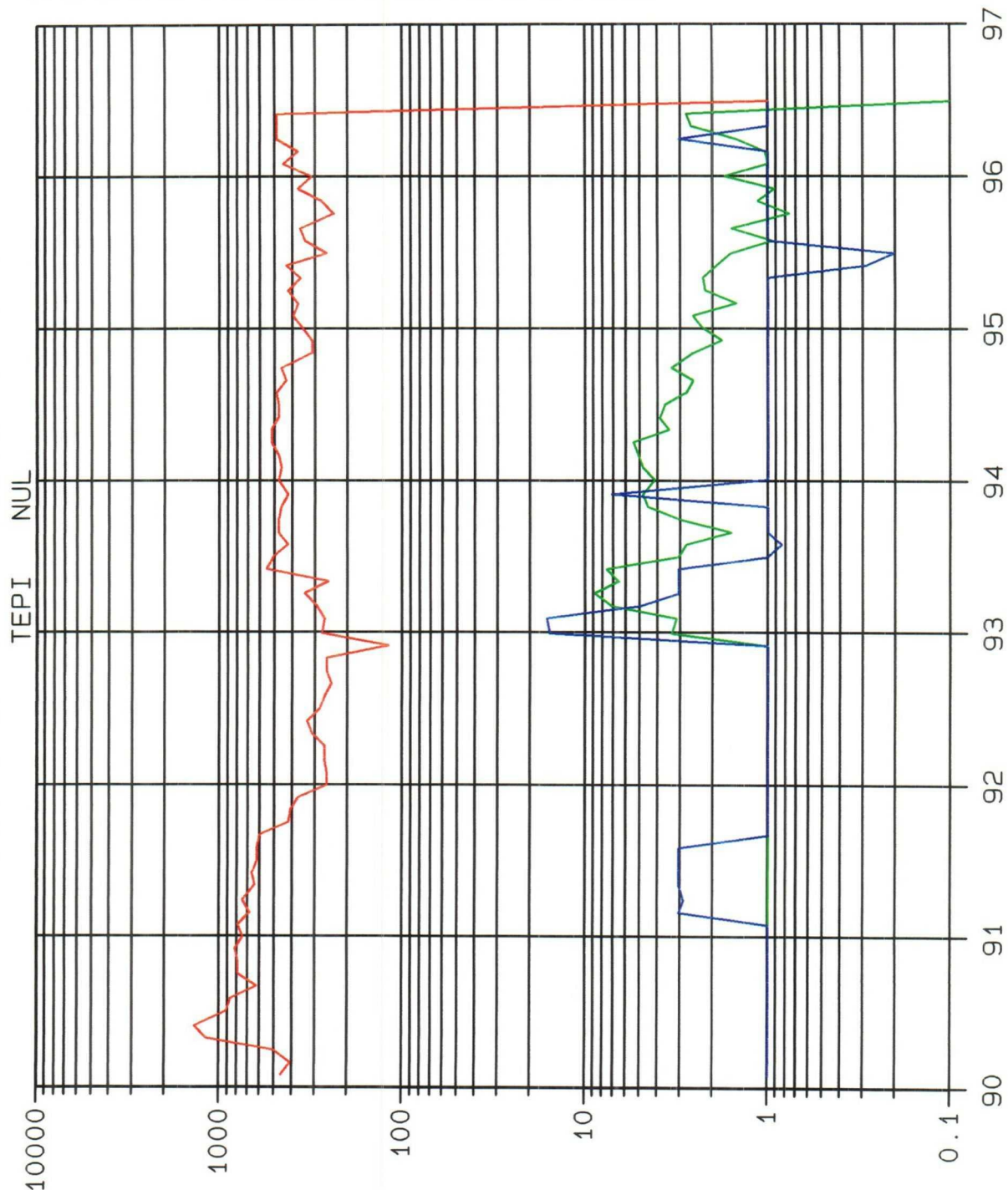

YEARS

LEASE DATA  
 LSE 011130  
 FLD 57000  
 OPER TEPI  
 ZONE NUL  
 --  
 COUNTY 025  
 STATE 30  
 30025060700001  
 STATUS 6-96  
 CO 4 MBO  
 CG 1092 MMCF  
 CW 2 MBW  
 BOPD 0  
 BWPD 0  
 MCFPD 0  
 WELLS 1  
 CI 0 MBWI  
 BWIPD 0

BOPD  
 BWPD  
 MCFPD

Offset Operators and all Lessees of Record  
C. H. Weir "A" No. 4 Well  
SW/4 NW/4 of Section 12, T-20-S, R-37-E  
Monument Tubb/Skaggs Drinkard Formations  
Lea County, New Mexico  
September 16, 1996

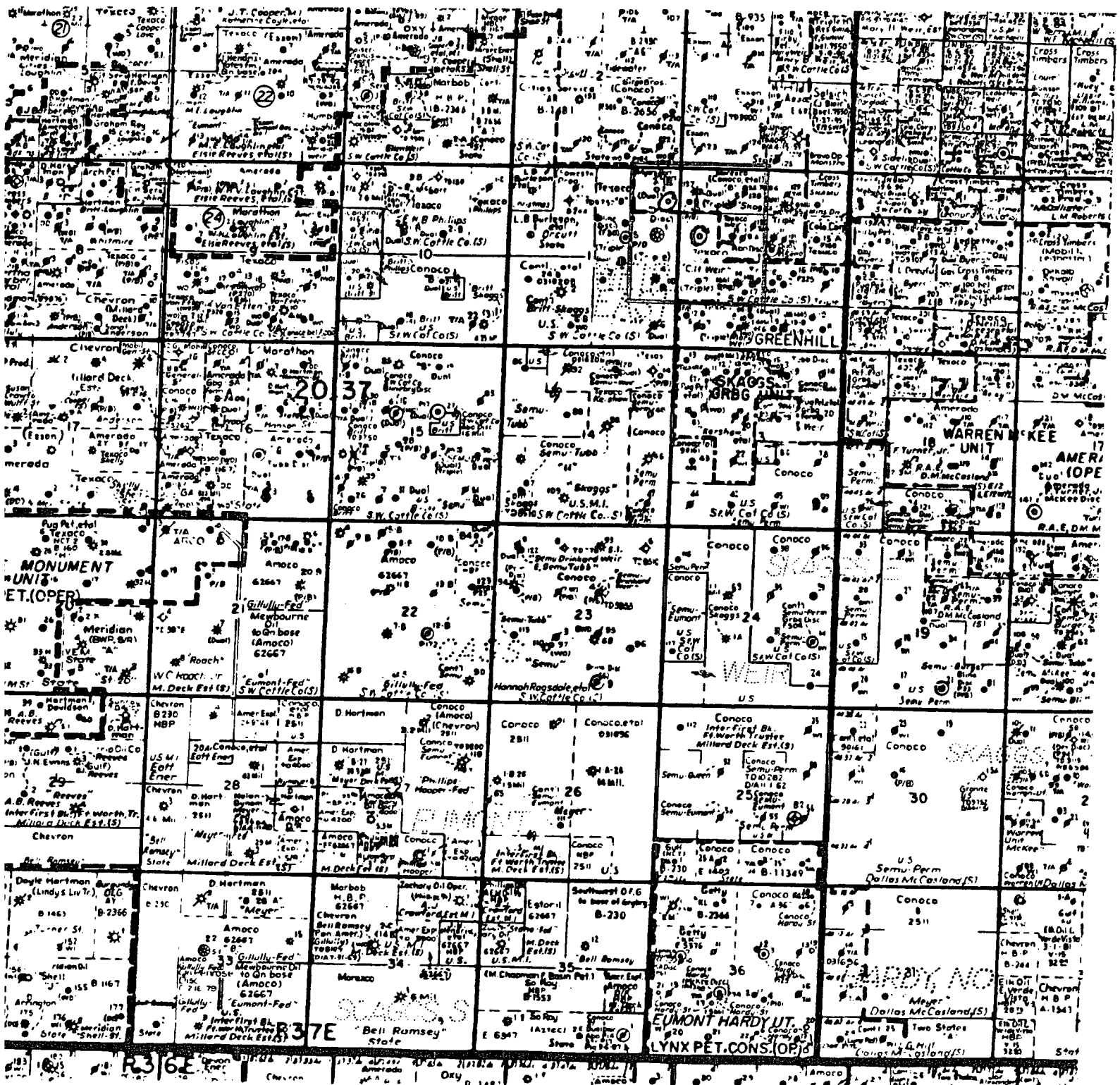

Offset Operators and all Lessees of Record  
C. H. Weir "A" No. 4 Well  
SW/4 NW/4 of Section 12, T-20-S, R-37-E  
Monument Tubb/Skaggs Drinkard Formations  
Lea County, New Mexico  
September 16, 1996

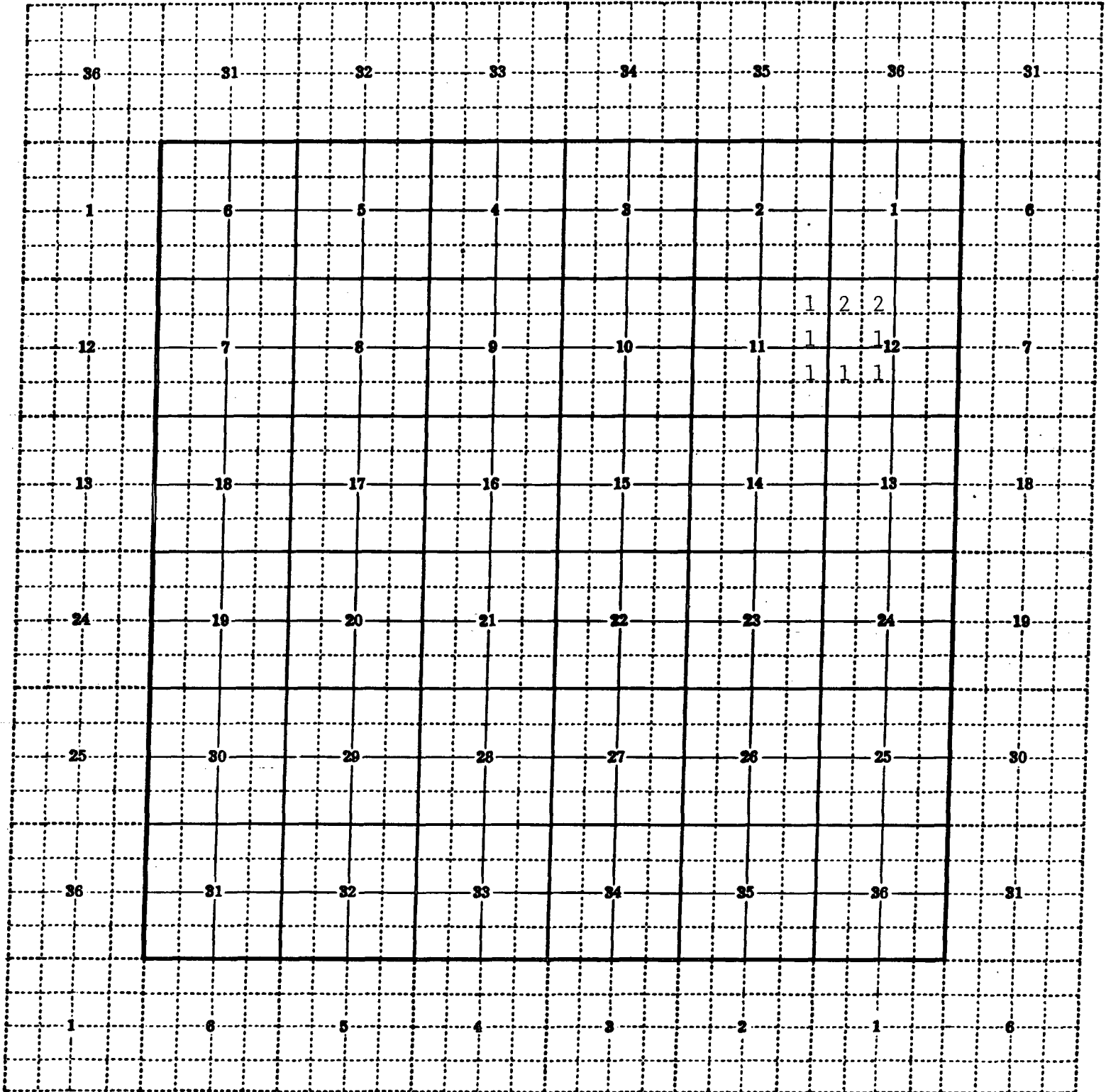

Offset Operators and all Lessees of Record  
C. H. Weir "A" No. 4 Well  
SW/4 NW/4 of Section 12, T-20-S, R-37-E  
Monument Tubb/Skaggs Drinkard Formations  
Lea County, New Mexico  
September 16, 1996

Number 1

---

Texaco Exploration and Production Inc.  
P. O. Box 3109  
Midland, Texas 79702

Number 2

---

Conoco Inc.  
10 Desta Dr., Suite 100W  
Midland, Texas 79705

915 686-5400

686-6548



**SENDER:**

- Complete items 1 and/or 2 for additional services.
- Complete items 3, 4a, and 4b.
- Print your name and address on the reverse of this form so that we can return this card to you.
- Attach this form to the front of the mailpiece, or on the back if space does not permit.
- Write "Return Receipt Requested" on the mailpiece below the article number.
- The Return Receipt will show to whom the article was delivered and the date delivered.

I also wish to receive the following services (for an extra fee):

1. ☐ Addressee's Address
2. ☐ Restricted Delivery

Consult postmaster for fee.

**3. Article Addressed to:**

Conoco Inc.  
10 Destu Dr., Suite 100W  
Midland, Texas 79705

**4a. Article Number****4b. Service Type**

- |   |   |
|---|---|
| <input type="checkbox"/> Registered                     | <input checked="" type="checkbox"/> Certified |
| <input type="checkbox"/> Express Mail                   | <input type="checkbox"/> Insured              |
| <input type="checkbox"/> Return Receipt for Merchandise | <input type="checkbox"/> COD                  |

**7. Date of Delivery**

10-16-96

**5. Received By: (Print Name)****6. Signature (Addressee or Agent)**

*Anita Gonzalez*

**8. Addressee's Address (Only if requested and fee is paid)**