

ABOVE THIS LINE FOR DIVISION USE ONLY

NEW MEXICO OIL CONSERVATION DIVISION

- Engineering Bureau -

Bolack C LS #14

ADMINISTRATIVE APPLICATION COVERSHEET

THIS COVERSHEET IS MANDATORY FOR ALL ADMINISTRATIVE APPLICATIONS FOR EXCEPTIONS TO DIVISION RULES AND REGULATIONS

Application Acronyms:

[NSP-Non-Standard Proration Unit] [NSL-Non-Standard Location]  
 [DD-Directional Drilling] [SD-Simultaneous Dedication]  
 [DHC-Downhole Commingling] [CTB-Lease Commingling] [PLC-Pool/Lease Commingling]  
 [PC-Pool Commingling] [OLS - Off-Lease Storage] [OLM-Off-Lease Measurement]  
 [WFX-Waterflood Expansion] [PMX-Pressure Maintenance Expansion]  
 [SWD-Salt Water Disposal] [IPI-Injection Pressure Increase]  
 [EOR-Qualified Enhanced Oil Recovery Certification] [PPR-Positive Production Response]

[1] TYPE OF APPLICATION - Check Those Which Apply for [A]

[A] Location - Spacing Unit - Directional Drilling  
☐ NSL ☐ NSP ☐ DD ☐ SD

Check One Only for [B] or [C]

[B] Commingling - Storage - Measurement  
☒ DHC ☐ CTB ☐ PLC ☐ PC ☐ OLS ☐ OLM

[C] Injection - Disposal - Pressure Increase - Enhanced Oil Recovery  
☐ WFX ☐ PMX ☐ SWD ☐ IPI ☐ EOR ☐ PPR

[2] NOTIFICATION REQUIRED TO: - Check Those Which Apply, or ☐ Does Not Apply

[A] ☐ Working, Royalty or Overriding Royalty Interest Owners

[B] ☒ Offset Operators, Leaseholders or Surface Owner

[C] ☐ Application is One Which Requires Published Legal Notice

[D] ☒ Notification and/or Concurrent Approval by BLM or SLO  
 U.S. Bureau of Land Management - Commissioner of Public Lands, State Land Office

[E] ☐ For all of the above, Proof of Notification or Publication is Attached, and/or,

[F] ☐ Waivers are Attached

[3] INFORMATION / DATA SUBMITTED IS COMPLETE - Statement of Understanding

I hereby certify that I, or personnel under my supervision, have read and complied with all applicable Rules and Regulations of the Oil Conservation Division. Further, I assert that the attached application for administrative approval is accurate and complete to the best of my knowledge and where applicable, verify that all interest (WI, RI, ORRI) is common. I further verify that all applicable API Numbers are included. I understand that any omission of data, information or notification is cause to have the application package returned with no action taken.

Note: Statement must be completed by an individual with supervisory capacity.

PAMELA W. STALEY  
 Print or Type Name

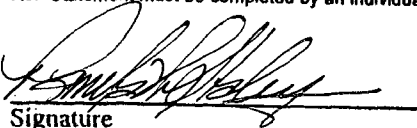
  
 Signature

REGULATORY AFFAIRS ENGR.  
 Title

12/16/96  
 Date

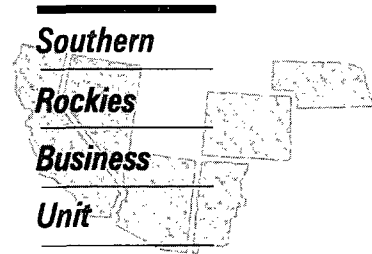

December 16, 1996

Mr. William J. LeMay, Director  
New Mexico Oil Conservation Division  
2040 S. Pacheco Street  
P. O. Box 6429  
Santa Fe, NM 87505

**Application for Exception to Rule 303-A- Downhole Commingling**  
**Bolack C LS #14 Well**  
**Unit B Section 30-T27N-R8W**  
**South Blanco Pictured Cliffs and Blanco Mesaverde Pools**  
**San Juan County, New Mexico**

Enclosed please find an administrative application form (C-107-A) and attachments for downhole commingling for the captioned well. By copy of this application by certified mail, return receipt requested, Amoco is notifying all offset operators in the formations captioned above as well as all affected interest owners if the ownership of those formations is not common. The Division Director may approve the proposed downhole commingling in the absence of a valid objection from any offset operator or any interest owner in those instances where ownership is not common in the zones to be commingled within 20 days after the receipt of the application if, in his opinion, waste will not result thereby, and correlative rights will not be violated.

Should there be questions concerning this matter, please contact me at (303) 830-5344.

Sincerely,

  
Pamela W. Staley

Enclosures

cc: Mark Rothenberg  
Pat Archuleta  
Wellfile  
Proration File  
Frank Chavez, Supervisor  
NMOC District III  
1000 Rio Brazos Road  
Aztec, NM 87410

Duane Spencer  
Bureau of Land Management  
1235 La Plata Hwy.  
Farmington, NM 87401

DISTRICT I  
P.O. Box 1980, Hobbs NM 88241-1980

State of New Mexico  
Energy, Minerals and Natural Resources Department

Form C-107-A  
New 3-12-96

OIL CONSERVATION DIVISION

APPROVAL PROCESS:

DISTRICT II  
811 South First St., Artesia, NM 88210-2835

2040 S. Pacheco  
Santa Fe, New Mexico 87505-6429

☒ Administrative ☐ Hearing

DISTRICT III  
1000 Rio Brazos Rd. Aztec, NM 87410-1693

APPLICATION FOR DOWNHOLE COMMINGLING

EXISTING WELLBORE  
☒ YES ☐ NO

Amoco Production Company

P.O. Box 800 Denver, CO 80201

Operator  
BOLACK C LS

14

Address  
B-30-27N-8W

San Juan

Lease

Well No.

Unit Ltr. - Sec Twp - Rge

County

Spacing Unit Lease Types: (check 1 or more)

OGRID NO. 000778 Property Code 000327 API NO. 3004506281 Federal ☒ State ☐ (and/or) Fee ☐

The following facts are submitted in support of downhole commingling:	Upper Zone	Intermediate Zone	Lower Zone
1. Pool Name and Pool Code	SOUTH BLANCO PICTURED CLIFFS 72439		BLANCO MESAVERDE 72319
2. Top and Bottom of Pay Section (Perforations)	2094' - 2150'		4362' - 4510'
3. Type of production (Oil or Gas)	GAS		GAS
4. Method of Production (Flowing or Artificial Lift)	FLOWING		FLOWING
5. Bottomhole Pressure Oil Zones - Artificial Lift: Estimated Current Gas & Oil - Flowing: Measured Current All Gas Zones: Estimated or Measured Original	a. (Current) 260 PSI b. (Original) 734 PSI	a. b.	a. 475 PSI b. 1027 PSI
6. Oil Gravity (° API) or Gas BTU Content	1173 BTU		1148 BTU / 49 DEG API
7. Producing or Shut-In?	PRODUCING		PRODUCING
Production Marginal? (yes or no)	YES		YES
• If Shut-In, give data and oil/gas/water rates of last production Note: For new zones with no production history, applicant shall be required to attach production estimates and supporting data	Date: Rates:	Date: Rates:	Date: Rates:
• If Producing, give date and oil/gas/water rates of recent test (within 60 days)	Date: 10/96 Rates: 57 MCFD 0 BCPD 0 BWPD	Date: Rates:	Date: 10/96 Rates: 0 MCFD(SEE ATTACHED) 0 BCPD 0 BWPD
8. Fixed Percentage Allocation Formula -% for each zone	Oil: 0 % Gas 33 %	Oil: % Gas %	Oil: 100 % Gas 67 %

9. If allocation formula is based upon something other than current or past production, or is based upon some other method, submit attachments with supporting data and/or explaining method and providing rate projections or other required data.

10. Are all working, overriding, and royalty interests identical in all commingled zones? ☒ Yes ☐ No  
If not, have all working, overriding, and royalty interests been notified by certified mail? ☐ Yes ☐ No  
Have all offset operators been given written notice of the proposed downhole commingling? ☒ Yes ☐ No

11. Will cross-flow occur? ☐ Yes ☒ No If yes, are fluids compatible, will the formations not be damaged, will any cross-flowed production be recovered, and will the allocation formula be reliable. ☐ Yes ☐ No (If No, attach explanation)

12. Are all produced fluids from all commingled zones compatible with each other? ☒ Yes ☐ No

13. Will the value of production be decreased by commingling? ☐ Yes ☒ No (If Yes, attach explanation)

14. If this well is on, or communitized with, state or federal lands, either the Commissioner of Public Lands or the United States Bureau of Land Management has been notified in writing of this application. ☒ Yes ☐ No SF-079232

15. NMOCD Reference Cases for Rule 303(D) Exceptions: ORDER NO(S) \_\_\_\_\_

16. ATTACHMENTS:

- \* C-102 for each zone to be commingled showing its spacing unit and acreage dedication.
- \* Production curve for each zone for at least one year. (If not available, attach explanation.)
- \* For zones with no production history, estimated production rates and supporting data.
- \* Data to support allocation method or formula. (SEE ATTACHED)
- \* Notification list of all offset operators.
- \* Notification list of working, overriding, and royalty interests for uncommon interest cases.
- \* Any additional statements, data, or documents required to support commingling.

I hereby certify that the information above is true and complete to the best of my knowledge and belief.

SIGNATURE Pamela W. Staley TITLE REGULATORY AFFAIRS ENGR DATE 12/16/96

TYPE OR PRINT NAME PAMELA W. STALEY TELEPHONE NO. ( 303 ) 830-5344

## Well Location and Acreage Dedication Plat

Section A.

Date **MARCH 4, 1958**

Operator **EL PASO NATURAL GAS COMPANY** Lease **BOLACK** SF **079232**  
 Well No. **14-C (PM)** Unit Letter **B** Section **30** Township **27-N** Range **8-W** NMPM  
 Located **800** Feet From **NORTH** Line, **1640** Feet From **EAST** Line  
 County **SAN JUAN** G. L. Elevation **6090** Dedicated Acreage **320 & 160** Acres  
 Name of Producing Formation **MESA VERDE & PICTURED CLIFF** Pool **BLANCO MV EXT. - SO. BLANCO P.C.**

1. Is the Operator the only owner in the dedicated acreage outlined on the plat below?  
 Yes ☒ No ☐
2. If the answer to question one is "no", have the interests of all the owners been consolidated by communitization agreement or otherwise? Yes ☐ No ☐ If answer is "yes", Type of Consolidation.
3. If the answer to question two is "no", list all the owners and their respective interests below:

Owner

Land Description

RECEIVED

MAR 7 1958

U. S. GEOLOGICAL SURVEY  
FARMINGTON, N. M.

Section B.

Note: All distances must be from outer boundaries of section.

This is to certify that the information in Section A above is true and complete to the best of my knowledge and belief.

**El Paso Natural Gas Company****Original Signed D. C. Johnston**

(Representative)

**Box 997**

(Address)

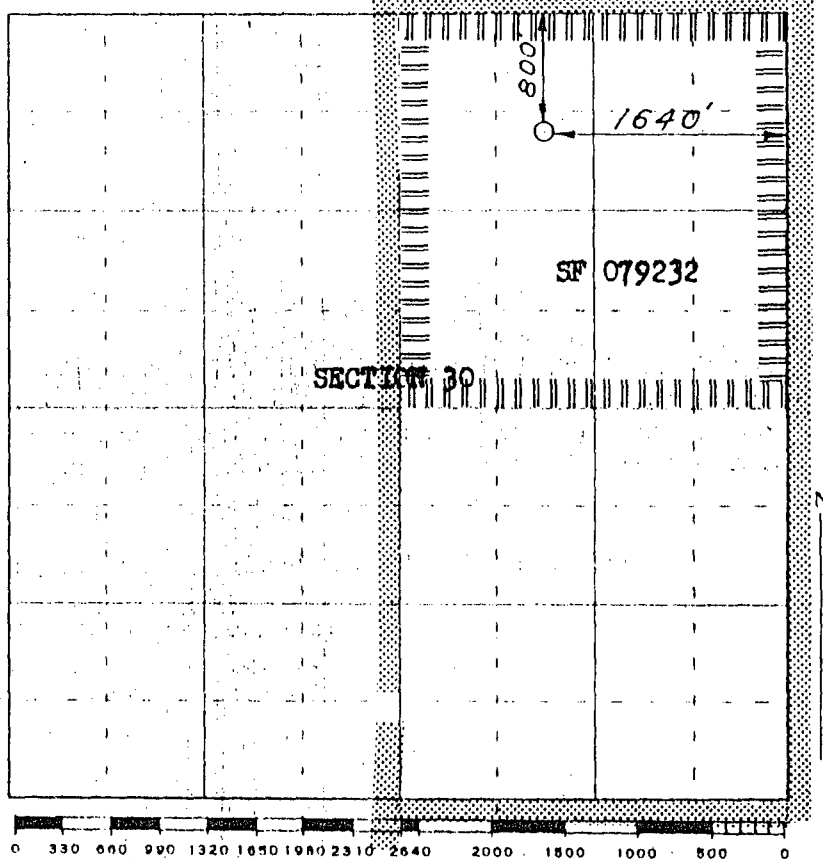
**Farmington, New Mexico**

Scale 4 inches equal 1 mile

This is to certify that the above plat was prepared from field notes of actual surveys made by me or under my supervision and that the same are true and correct to the best of my knowledge and belief.

Date Surveyed **FEBRUARY 26, 1958**

*David O. Kilmer*  
 Registered Professional Engineer and/or Land Surveyor

(Seal)

Farmington, New Mexico

User: zmdr16  
Owner: 2DMHF

# Single Well Gas3D

Description 1  
Mon Oct 28 09:37:18 1996

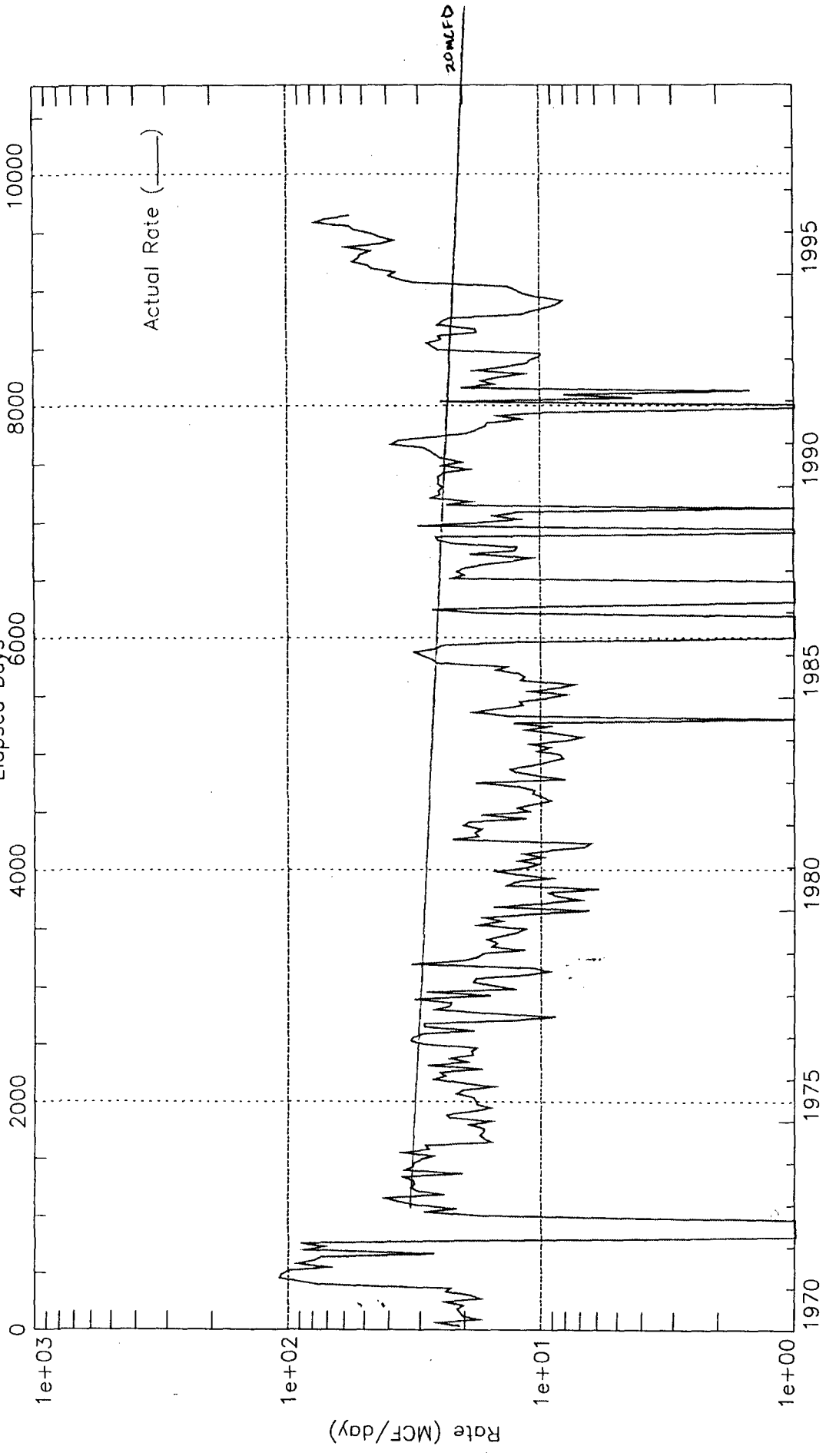

Cum Gas= 204.62 MMCF

Date (Years)

Well ID: 300450628100 604PCCF  
Well Name: BOLACK C LS 1-9,11-14 /PC/ 014B30  
Operator: AMOCO PRODUCTION COMPANY

User: zmdr16  
Owner: ZDMHF

# Single Well Gas3D

Description 1  
Mon Oct 28 09:37:21 1996

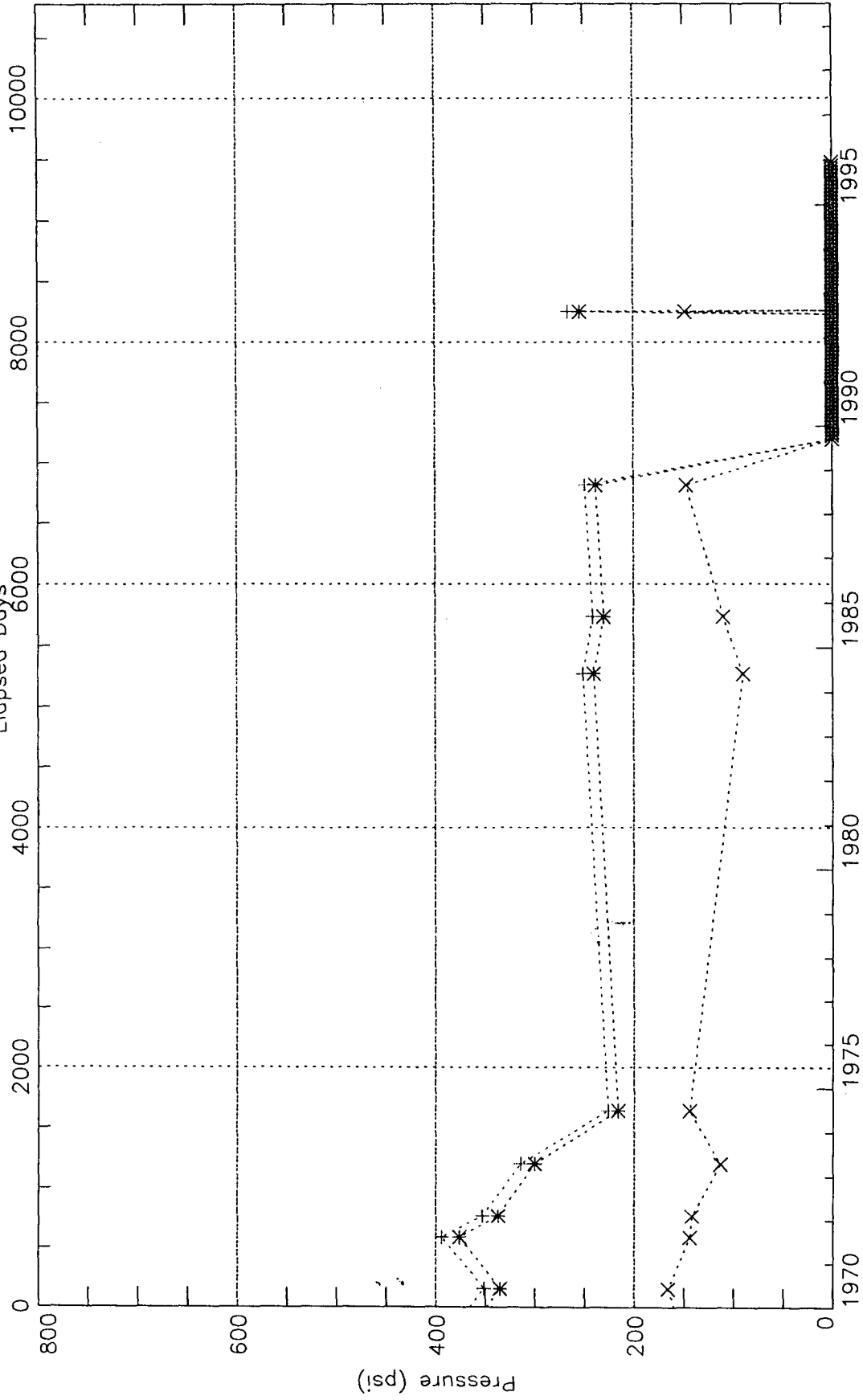

Date (Years)

WH\_SIP (\*)  
BHP (+)  
WH\_FTP (x)

Well ID: 300450628100 604PCCF  
Well Name: BOLACK C LS 1-9,11-14 /PC/ 014B30  
Operator: AMOCO PRODUCTION COMPANY

User: zmdr16  
Owner: 2DMHF

# Single Well Gas3D

Description 1  
Mon Oct 28 09:37:34 1996

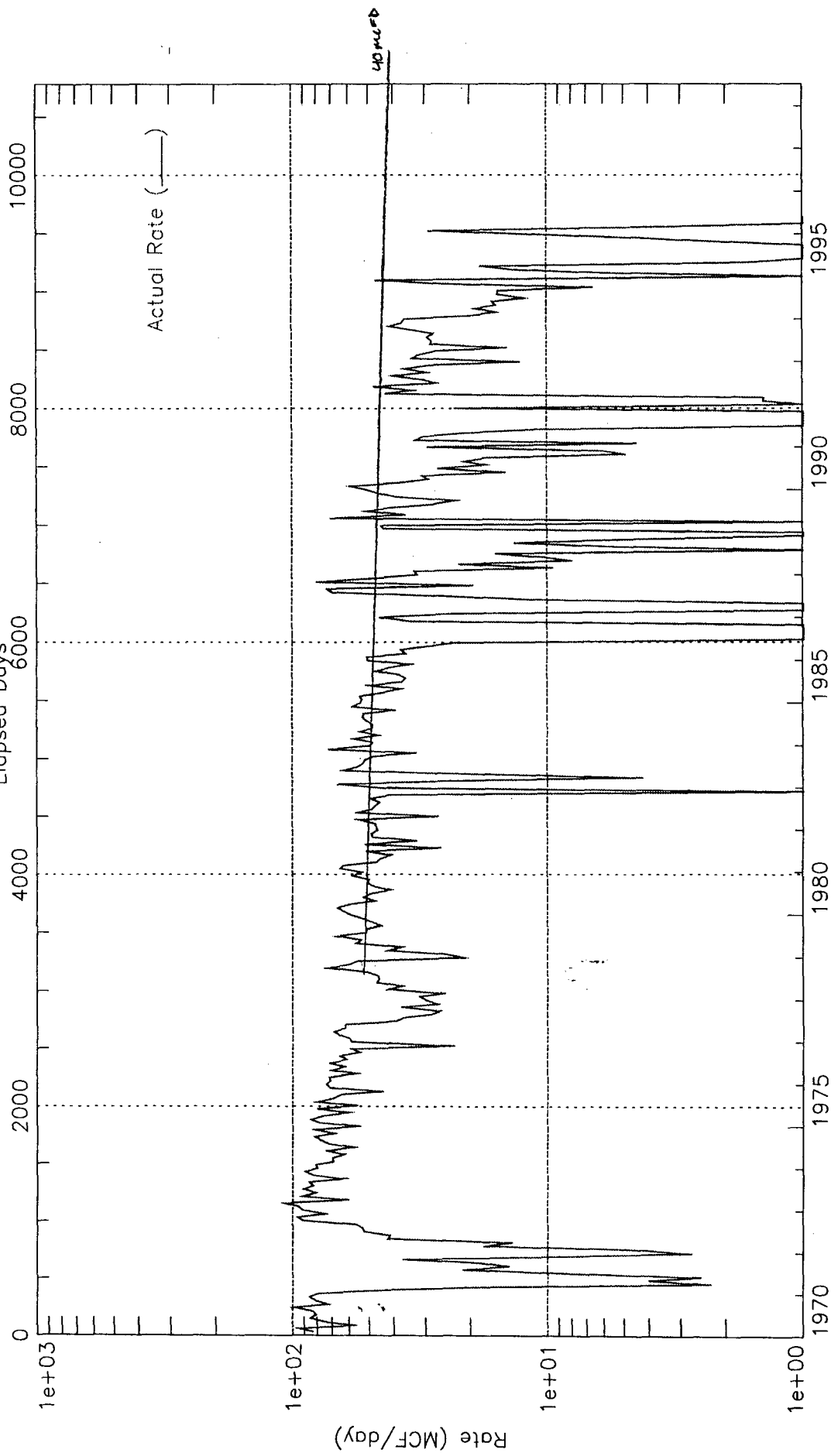

Cum Gas= 393.20 MMCF

Date (Years)

Well ID: 300450628100 604MVRD

Well Name: BOLACK C 9-16,12A,14A,15A /MV/ 9 014B30

Operator: AMOCO PRODUCTION COMPANY

User: zmdr16  
Owner: 2DMHF

# Single Well Gas3D

Description 1  
Mon Oct 28 09:37:37 1996

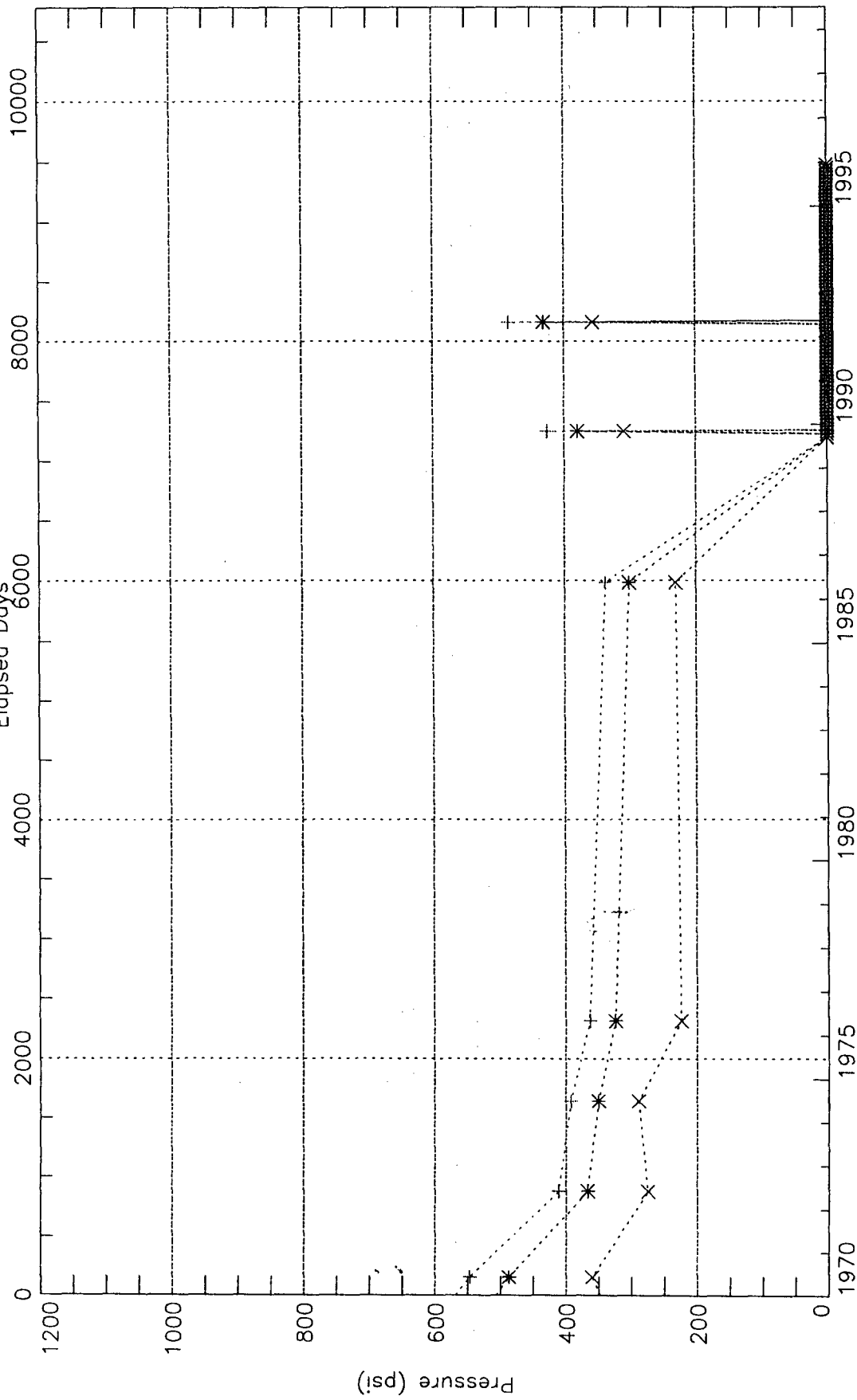

WH\_SIP (\*)  
BHP (+)  
WH\_FTP (x)

Date (Years)

Well ID: 300450628100 604MVRD  
Well Name: BOLACK C 9-16,12A,14A,15A /MV/ 9 014B30  
Operator: AMOCO PRODUCTION COMPANY



UWI	FM	Press Rec date	test code	SICP	SI days
300450628100	MVRD	580508	ISIP	1027	0
300450628100	MVRD	700604	DEL	487	7
300450628100	MVRD	720601	DEL	367	7
300450628100	MVRD	720629	BH		
300450628100	MVRD	740701	DEL	350	7
300450628100	MVRD	760503	DEL	324	7
300450628100	MVRD	860520	DEL	302	7
300450628100	MVRD	871116	PLT	221	
300450628100	MVRD	891107	DEL	380	7
300450628100	MVRD	900514	PLT	212	
300450628100	MVRD	920505	DEL	431	7
300450628100	MVRD	920629	BH		
300450628100	MVRD	950519	PLT	190	
300450628100	PCCF	580508	ISIP	734	0
300450628100	PCCF	700604	DEL	335	7
300450628100	PCCF	710810	DEL	376	7
300450628100	PCCF	720209	DEL	337	7
300450628100	PCCF	730417	DEL	300	7
300450628100	PCCF	740701	DEL	216	7
300450628100	PCCF	840604	DEL	240	7
300450628100	PCCF	850913	DEL	230	7
300450628100	PCCF	880901	DEL	238	7
300450628100	PCCF	920806	DEL	254	7

**OFFSET OPERATORS**  
**Bolack C LS #14**

Burlington Resources Oil and Gas Co.  
P.O. Box 4289  
Farmington, NM 87499

Snyder Oil Corp.  
1625 Broadway  
Denver, Co. 80202

\*\*\*\*\*

**ALLOCATION EXPLANATION**

Recent production tests are misleading due to a packer leak. Following the workover it is expected that the well will return to it's natural decline as indicated on the historic production plots.

Rates estimated from historic production are as follows:

	<u>MV</u>	<u>PC</u>
<b>GAS</b>	40 MCFD (67%)	20 MCFD (33%)
<b>OIL</b>	1 BCPD (100%)	0 BCPD (0%)
<b>WATER</b>	1 BWPD (100%)	0 BWPD (0%)

These rates are also consistent with offsetting production.