

DATE 1/9/06	SUSPENSE	ENGINEER WJS	LOGGED IN	TYPE DHC 3624	APP NO. PWVS
----------------	----------	-----------------	-----------	---------------------	-----------------

ABOVE THIS LINE FOR DIVISION USE ONLY

NEW MEXICO OIL CONSERVATION DIVISION

- Engineering Bureau -

1220 South St. Francis Drive, Santa Fe, NM 87505



ADMINISTRATIVE APPLICATION CHECKLIST

THIS CHECKLIST IS MANDATORY FOR ALL ADMINISTRATIVE APPLICATIONS FOR EXCEPTIONS TO DIVISION RULES AND REGULATIONS WHICH REQUIRE PROCESSING AT THE DIVISION LEVEL IN SANTA FE

Application Acronyms:

[NSL-Non-Standard Location] [NSP-Non-Standard Proration Unit] [SD-Simultaneous Dedication]
 [DHC-Downhole Commingling] [CTB-Lease Commingling] [PLC-Pool/Lease Commingling]
 [PC-Pool Commingling] [OLS - Off-Lease Storage] [OLM-Off-Lease Measurement]
 [WFX-Waterflood Expansion] [PMX-Pressure Maintenance Expansion]
 [SWD-Salt Water Disposal] [IPI-Injection Pressure Increase]
 [EOR-Qualified Enhanced Oil Recovery Certification] [PPR-Positive Production Response]

2006 JUN 3 PM 3 25

- [1] **TYPE OF APPLICATION** - Check Those Which Apply for [A]
 [A] Location - Spacing Unit - Simultaneous Dedication
☐ NSL ☐ NSP ☐ SD
- Check One Only for [B] or [C]
 [B] Commingling - Storage - Measurement
☒ DHC ☐ CTB ☐ PLC ☐ PC ☐ OLS ☐ OLM
- [C] Injection - Disposal - Pressure Increase - Enhanced Oil Recovery
☐ WFX ☐ PMX ☐ SWD ☐ IPI ☐ EOR ☐ PPR
- [D] Other: Specify _____
- [2] **NOTIFICATION REQUIRED TO:** - Check Those Which Apply, or ☐ Does Not Apply
 [A] ☒ Working, Royalty or Overriding Royalty Interest Owners
 [B] ☐ Offset Operators, Leaseholders or Surface Owner
 [C] ☐ Application is One Which Requires Published Legal Notice
 [D] ☒ Notification and/or Concurrent Approval by BLM or SLO
U.S. Bureau of Land Management - Commissioner of Public Lands, State Land Office
 [E] ☐ For all of the above, Proof of Notification or Publication is Attached, and/or,
 [F] ☐ Waivers are Attached
- [3] **SUBMIT ACCURATE AND COMPLETE INFORMATION REQUIRED TO PROCESS THE TYPE OF APPLICATION INDICATED ABOVE.**
- [4] **CERTIFICATION:** I hereby certify that the information submitted with this application for administrative approval is **accurate** and **complete** to the best of my knowledge. I also understand that no action will be taken on this application until the required information and notifications are submitted to the Division.

Note: Statement must be completed by an individual with managerial and/or supervisory capacity.

Jerry W. Sherrell
 Print or Type Name

Jerry W. Sherrell
 Signature

Production Clerk
 Title

12/29/2005
 Date

jerrys@mackenergycorp.com
 e-mail Address



P.O. Box 960
Artesia, NM 88211-0960
Office (505) 748-1288
Fax (505) 746-9539

December 27, 2005

Oil Conservation Division
Attn: Will Jones
1220 South St. Francis Dr.
Santa Fe, NM 87505

Re: Down hole Commingling, and measurement of
Hydrocarbon Production for:
Schley Federal #2,4,5,6,7,8,9,11,12,13,15
Section 29, T17S, R29E
Eddy County, New Mexico

Mack Energy Corporation as operator of the aforementioned (11) wells respectfully requests administrative approval for down hole commingling and measurement of production.

Mack Energy proposes to commingle Grayburg Jackson SR-Q-G-SA and Empire Yeso East production in the Schley Federal wells (NM-29281). Production of both pools will be measured at the Schley Federal TB located in the NE/4 SW/4, Sec. 29 T17S R29E. This lease has common interest in both pools. Notification has been made to all parties owning an interest in this lease, including the oil purchaser, of the intent to commingle. Testing will be conducted and allocation percentages will be sent to OCD after completion of these wells. These wells have produced for some time from the Yeso formation. The subtraction method will be used to allocate production based on increased production from the San Andres formation.

Should you require any additional information concerning this application, please call Jerry W. Sherrell at the above number. Thank you for your consideration of this request.

Sincerely,

MACK ENERGY CORPORATION

Jerry W. Sherrell
Production Clerk
jerrys@mackenergycorp.com

JWS/
Enclosures

SIGNATURE PAGE

The undersigned approves of Mack Energy Corporation's request to Downhole Commingle the following pools. Grayburg Jackson;SR-Q-G-SA and the Empire Yeso East in the Schley Federal wells #2,4,5,6,7,8,9,11,12,13,15 Sec 29 T17S R29E.

Schley Federal Lease DHC Approval

CHASE OIL CORPORATION

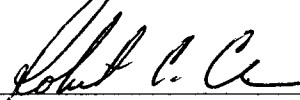
By: 
Robert C. Chase, President

Date: 1-6-2006

ROBERT C. CHASE

By: 
Robert C. Chase

Date: 1-6-2006

RICHARD L. CHASE

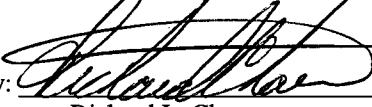
By: 
Richard L. Chase

Date: 1-9-2006

GERENE DIANNE CHASE CROUCH
Dealing in her sole and separate property

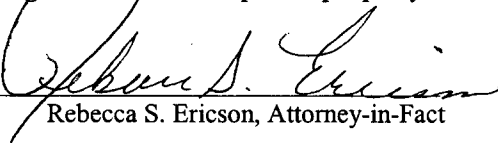
By: 
Rebecca S. Ericson, Attorney-in-Fact

Date: 12-28-2005

UNITED STATES
DEPARTMENT OF THE INTERIOR
BUREAU OF LAND MANAGEMENT

FORM APPROVED
Budget Bureau No 1004-0135
Expires March 31, 1993

SUNDRY NOTICES AND REPORTS ON WELLS

Do not use this form for proposals to drill or to deepen or reentry to a different reservoir.
Use "APPLICATION FOR PERMIT—" for such proposals

SUBMIT IN TRIPLICATE

1 Type of Well

☒ Oil Well ☐ Gas Well ☐ Other

2 Name of Operator

Mack Energy Corporation

3 Address and Telephone No.

P.O. Box 960, Artesia, NM 88211-0960 (505)748-1288

4 Location of Well (Footage, Sec., T., R., M. or Survey Description)

Units E, F & L, Sec. 29 T17S R29E

5 Lease Designation and Serial No

NMNM-29281

6 If Indian, Allottee or Tribe Name

7 If Unit or CA, Agreement Designation

8 Well Name and No

Schley Federal Lease

9 API Well No

Multiple see below

10 Field and Pool, or Exploratory Area

Grayburg Jackson SR Q G SA/Yeso

11 County or Parish, State

Eddy, NM

12 CHECK APPROPRIATE BOX(s) TO INDICATE NATURE OF NOTICE, REPORT, OR OTHER DATA

TYPE OF SUBMISSION

- ☒ Notice of Intent
☐ Subsequent Report
☐ Final Abandonment Notice

TYPE OF ACTION

- ☐ Abandonment
☐ Recompletion
☐ Plugging Back
☐ Casing Repair
☐ Altering Casing
☒ Other Downhole Commingle
☐ Change of Plans
☐ New Construction
☐ Non-Routine Fracturing
☐ Water Shut-Off
☐ Conversion to Injection
☐ Dispose Water

(Note: Report results of multiple completion on Well Completion or Recompletion Report and Log form.)

13 Describe Proposed or Completed Operations (Clearly state all pertinent details, and give pertinent dates, including estimated date of starting any proposed work. If well is directionally drilled, give subsurface locations and measured and true vertical depths for all markers and zones pertinent to this work.)*

Mack Energy Corporation would like approval to downhole commingle production in the Schley Federal wells #2,4,5,6,7,8,9,11,12,13,15. We propose to commingle production from the Grayburg Jackson, SR-Q-G-SA and Empire Yeso East formations. Testing will be conducted after completion operations. Allocation percentages will be determined using increased production.

#2 30-015-30301
#4 30-015-30451
#5 30-015-30302
#6 30-015-30459
#7 30-015-30303
#8 30-015-30307
#9 30-015-31988
#11 30-015-32134
#12 30-015-32243
#13 30-015-32244
#15 30-015-32368

14 I hereby certify that the foregoing is true and correct

Signed George W. Sherrill

Title Production Clerk

Date 12/29/2005

(This space for Federal or State office use)

Approved by _____
Conditions of approval, if any

Title _____

Date _____

Title 18 U.S.C. Section 1001, makes it a crime for any person knowingly and willfully to make to any department or agency of the United States any false, fictitious or fraudulent statements or representations as to any matter within its jurisdiction

•See Instruction on Reverse Side

District I
1621 N. French Drive, Hobbs, NM 88240
District 11
1301 W. Grand Avenue, Artesia, NM 88210
District III
1000 Rio Brazos Road, Aztec, NM 87410
District IV
1220 S. St Francis Dr., Santa Fe, NM 87505

State of New Mexico
Energy, Minerals and Natural Resources Department

Form C-107A
Revised June 10, 2003

Oil Conservation Division
1220 South St. Francis Dr.
Santa Fe, New Mexico 87505

APPLICATION TYPE
☒ Single Well
☒ Establish Pre-Approved Pools
EXISTING WELLBORE
☒ Yes ☐ No

APPLICATION FOR DOWNHOLE COMMINGLING

Mack Energy Corporation P.O. Box 960, Artesia, NM 88211-0960
Operator Address
Schley Federal 2 L-29-17S-29E Eddy
Lease Well No. Unit Letter-Section-Township-Range County
OGRID No. 013837 Property Code 22367 API No. 30-015-30301 Lease Type: ☒ Federal ☐ State ☐ Fee

DATA ELEMENT	UPPER ZONE	INTERMEDIATE ZONE	LOWER ZONE
Pool Name	Grayburg Jackson SR Q G SA		East Empire Yeso
PoolCode	28509		96610
Top and Bottom of Pay Section (Perforated or Open-Hole Interval)	2493-3978'		4620-4994'
Method of Production (Flowing or Artificial Lift)	Artificial Lift		Artificial Lift
Bottomhole Pressure (Note: Pressure data will not be required if the bottom perforation in the lower zone is within 150% of the depth of the top perforation in the upper zone)			
Oil Gravity or Gas BTU (Degree API or Gas BTU)	38.1		38.1
Producing, Shut-In or New Zone	New Zone		Producing
Date and Oil/Gas/Water Rates of Last Production. (Note: For new zones with no production history, applicant shall be required to attach production estimates and supporting data.)	Date: _____ Rates: _____	Date: _____ Rates: _____	Date: 10/31/2005 Rates: 60/75/30
Fixed Allocation Percentage (Note: If allocation is based upon something other than current or put production, supporting data or explanation will be required.)	Oil Gas % %	Oil Gas % %	Oil Gas % %

ADDITIONAL DATA

Are all working, royalty and overriding royalty interests identical in all commingled zones? Yes ☒ No ☐
If not, have all working, royalty and overriding royalty interest owners been notified by certified mail? Yes ☒ No ☐
Are all produced fluids from all commingled zones compatible with each other? Yes ☒ No ☐
Will commingling decrease the value of production? Yes ☐ No ☒
If this well is on, or communitized with, state or federal lands, has either the Commissioner of Public Lands or the United States Bureau of Land Management been notified in writing of this application? Yes ☐ No ☐
NMOCD Reference Case No. applicable to this well: _____

Attachments:

- C- 1 02 for each zone to be commingled showing its spacing unit and acreage dedication.
- Production curve for each zone for at least one year. (If not available, attach explanation.)
- For zones with no production history, estimated production rates and supporting data.
- Data to support allocation method or formula.
- Notification list of working, royalty and overriding royalty interests for uncommon interest cases.
- Any additional statements, data or documents required to support commingling.

PRE-APPROVED POOLS

If application is to establish Pre-Approved Pools, the following additional information will be required:

List of other orders approving downhole commingling within the proposed Pre-Approved Pools
List of all operators within the proposed Pre-Approved Pools
Proof that all operators within the proposed Pre-Approved Pools were provided notice of this application.
Bottomhole pressure data.

I hereby certify that the information above is true and complete to the best of my knowledge and belief

SIGNATURE Jerry W. Sherrell TITLE Production Clerk DATE 12/29/2005
TYPE OR PRINT NAME Jerry W. Sherrell TELEPHONE NO. (505) 748-1288
E-MAIL ADDRESS jerrys@mackenergycorp.com

District I
1621 N. French Drive, Hobbs, NM 88240

District II
1301 W. Grand Avenue, Artesia, NM 88210

District III
1000 Rio Brazos Road, Aztec, NM 87410

District IV
1220 S. St Francis Dr., Santa Fe, NM 87505

State of New Mexico
Energy, Minerals and Natural Resources Department

Form C-107A
Revised June 10, 2003

Oil Conservation Division
1220 South St. Francis Dr.
Santa Fe, New Mexico 87505

APPLICATION TYPE
☒ Single Well
☒ Establish Pre-Approved Pools
EXISTING WELLBORE
☒ Yes ☐ No

APPLICATION FOR DOWNHOLE COMMINGLING

Mack Energy Corporation P.O. Box 960, Artesia, NM 88211-0960
Operator Address
Schley Federal 4 L-29-17S-29E Eddy
Lease Well No. Unit Letter-Section-Township-Range County
OGRID No. 013837 Property Code 22367 API No. 30-015-30451 Lease Type: ☒ Federal ☐ State ☐ Fee

DATA ELEMENT	UPPER ZONE	INTERMEDIATE ZONE	LOWER ZONE
Pool Name	Grayburg Jackson SR Q G SA		East Empire Yeso
Pool Code	28509		96610
Top and Bottom of Pay Section (Perforated or Open-Hole Interval)	2444-3902'		4037-4322'
Method of Production (Flowing or Artificial Lift)	Artificial Lift		Artificial Lift
Bottomhole Pressure (Note: Pressure data will not be required if the bottom perforation in the lower zone is within 150% of the depth of the top perforation in the upper zone)			
Oil Gravity or Gas BTU (Degree API or Gas BTU)	38.1		38.1
Producing, Shut-In or New Zone	New Zone		Producing
Date and Oil/Gas/Water Rates of Last Production. (Note: For new zones with no production history, applicant shall be required to attach production estimates and supporting data.)	Date: _____ Rates: _____	Date: _____ Rates: _____	Date: 10/31/2005 Rates: 24/132/53
Fixed Allocation Percentage (Note: If allocation is based upon something other than current or put production, supporting data or explanation will be required.)	Oil _____ Gas _____ % %	Oil _____ Gas _____ % %	Oil _____ Gas _____ % %

ADDITIONAL DATA

Are all working, royalty and overriding royalty interests identical in all commingled zones? Yes ☒ No ☐
If not, have all working, royalty and overriding royalty interest owners been notified by certified mail? Yes ☒ No ☐
Are all produced fluids from all commingled zones compatible with each other? Yes ☒ No ☐
Will commingling decrease the value of production? Yes ☐ No ☒
If this well is on, or communitized with, state or federal lands, has either the Commissioner of Public Lands or the United States Bureau of Land Management been notified in writing of this application? Yes ☐ No ☐
NMOCD Reference Case No. applicable to this well: _____

Attachments:
C- 1 02 for each zone to be commingled showing its spacing unit and acreage dedication.
Production curve for each zone for at least one year. (If not available, attach explanation.)
For zones with no production history, estimated production rates and supporting data.
Data to support allocation method or formula.
Notification list of working, royalty and overriding royalty interests for uncommon interest cases.
Any additional statements, data or documents required to support commingling.

PRE-APPROVED POOLS

If application is to establish Pre-Approved Pools, the following additional information will be required:

List of other orders approving downhole commingling within the proposed Pre-Approved Pools
List of all operators within the proposed Pre-Approved Pools
Proof that all operators within the proposed Pre-Approved Pools were provided notice of this application.
Bottomhole pressure data.

I hereby certify that the information above is true and complete to the best of my knowledge and belief
SIGNATURE Jerry W. Sherrell TITLE Production Clerk DATE 12/29/2005
TYPE OR PRINT NAME Jerry W. Sherrell TELEPHONE NO. (505) 748-1288
E-MAIL ADDRESS jerrys@mackenergycorp.com

District I
1621 N. French Drive, Hobbs, NM 88240
District II
1301 W. Grand Avenue, Artesia, NM 88210
District III
1000 Rio Brazos Road, Aztec, NM 87411
District IV
1220 S. St Francis Dr., Santa Fe, NM 87505

State of New Mexico
Energy, Minerals and Natural Resources Department

Form C-107A
Revised June 10, 2003

Oil Conservation Division
1220 South St. Francis Dr.
Santa Fe, New Mexico 87505

APPLICATION TYPE
☒ Single Well
☒ Establish Pre-Approved Pools
EXISTING WELLBORE
☒ Yes ☐ No

APPLICATION FOR DOWNHOLE COMMINGLING

Mack Energy Corporation P.O. Box 960, Artesia, NM 88211-0960
Operator Address
Schley Federal 5 E-29-17S-29E Eddy
Lease Well No. Unit Letter-Section-Township-Range County
OGRID No. 013837 Property Code 22367 API No. 30-015-30302 Lease Type: ☒ Federal ☐ State ☐ Fee

DATA ELEMENT	UPPER ZONE	INTERMEDIATE ZONE	LOWER ZONE
Pool Name	Grayburg Jackson SR Q G SA		East Empire Yeso
Pool Code	28509		96610
Top and Bottom of Pay Section (Perforated or Open-Hole Interval)	2374-3818'		3952-4281'
Method of Production (Flowing or Artificial Lift)	Artificial Lift		Artificial Lift
Bottomhole Pressure (Note: Pressure data will not be required if the bottom perforation in the lower zone is within 150% of the depth of the top perforation in the upper zone)			
Oil Gravity or Gas BTU (Degree API or Gas BTU)	38.1		38.1
Producing, Shut-In or New Zone	New Zone		Producing
Date and Oil/Gas/Water Rates of Last Production. (Note: For new zones with no production history, applicant shall be required to attach production estimates and supporting data.)	Date: _____ Rates: _____	Date: _____ Rates: _____	Date: 10/31/2005 Rates: 7/39/16
Fixed Allocation Percentage (Note: If allocation is based upon something other than current or put production, supporting data or explanation will be required.)	Oil Gas % %	Oil Gas % %	Oil Gas % %

ADDITIONAL DATA

Are all working, royalty and overriding royalty interests identical in all commingled zones? Yes ☒ No ☐
If not, have all working, royalty and overriding royalty interest owners been notified by certified mail? Yes ☒ No ☐
Are all produced fluids from all commingled zones compatible with each other? Yes ☒ No ☐
Will commingling decrease the value of production? Yes ☐ No ☒
If this well is on, or communitized with, state or federal lands, has either the Commissioner of Public Lands or the United States Bureau of Land Management been notified in writing of this application? Yes ☐ No ☐
NMOCD Reference Case No. applicable to this well: _____

Attachments:

- C- 1 02 for each zone to be commingled showing its spacing unit and acreage dedication.
- Production curve for each zone for at least one year. (If not available, attach explanation.)
- For zones with no production history, estimated production rates and supporting data.
- Data to support allocation method or formula.
- Notification list of working, royalty and overriding royalty interests for uncommon interest cases.
- Any additional statements, data or documents required to support commingling.

PRE-APPROVED POOLS

If application is to establish Pre-Approved Pools, the following additional information will be required:

- List of other orders approving downhole commingling within the proposed Pre-Approved Pools
- List of all operators within the proposed Pre-Approved Pools
- Proof that all operators within the proposed Pre-Approved Pools were provided notice of this application.
- Bottomhole pressure data.

I hereby certify that the information above is true and complete to the best of my knowledge and belief

SIGNATURE Jerry W. Sherrell TITLE Production Clerk DATE 12/29/2005
TYPE OR PRINT NAME Jerry W. Sherrell TELEPHONE NO. (505) 748-1288
E-MAIL ADDRESS jerrys@mackenergycorp.com

District I
1621 N. French Drive, Hobbs, NM 88240

District II
1301 W. Grand Avenue, Artesia, NM 88210

District III
1000 Rio Brazos Road, Aztec, NM 87410

District IV
1220 S. St Francis Dr., Santa Fe, NM 87505

State of New Mexico
Energy, Minerals and Natural Resources Department

Oil Conservation Division
1220 South St. Francis Dr.
Santa Fe, New Mexico 87505

Form C-107A
Revised June 10, 2003

APPLICATION TYPE
☒ Single Well
☒ Establish Pre-Approved Pools
EXISTING WELLBORE
☒ Yes ☐ No

APPLICATION FOR DOWNHOLE COMMINGLING

Mack Energy Corporation

P.O. Box 960, Artesia, NM 88211-0960

Operator

Address

Schley Federal

6

F-29-17S-29E

Eddy

Lease

Well No.

Unit Letter-Section-Township-Range

County

OGRID No. 013837 Property Code 22367 API No. 30-015-30459 Lease Type: ☒ Federal ☐ State ☐ Fee

DATA ELEMENT	UPPER ZONE	INTERMEDIATE ZONE	LOWER ZONE
Pool Name	Grayburg Jackson SR Q G SA		East Empire Yeso
Pool Code	28509		96610
Top and Bottom of Pay Section (Perforated or Open-Hole Interval)	2394-3846'		3970-4303'
Method of Production (Flowing or Artificial Lift)	Artificial Lift		Artificial Lift
Bottomhole Pressure (Note: Pressure data will not be required if the bottom perforation in the lower zone is within 150% of the depth of the top perforation in the upper zone)			
Oil Gravity or Gas BTU (Degree API or Gas BTU)	38.1		38.1
Producing, Shut-In or New Zone	New Zone		Producing
Date and Oil/Gas/Water Rates of Last Production. (Note: For new zones with no production history, applicant shall be required to attach production estimates and supporting data.)	Date: _____ Rates: _____	Date: _____ Rates: _____	Date: 10/31/2005 Rates: 23/127/51
Fixed Allocation Percentage (Note: If allocation is based upon something other than current or put production, supporting data or explanation will be required.)	Oil Gas % %	Oil Gas % %	Oil Gas % %

ADDITIONAL DATA

Are all working, royalty and overriding royalty interests identical in all commingled zones?
If not, have all working, royalty and overriding royalty interest owners been notified by certified mail?

Yes ☒ No ☐
Yes ☒ No ☐

Are all produced fluids from all commingled zones compatible with each other?

Yes ☒ No ☐

Will commingling decrease the value of production?

Yes ☐ No ☒

If this well is on, or communitized with, state or federal lands, has either the Commissioner of Public Lands or the United States Bureau of Land Management been notified in writing of this application?

Yes ☐ No ☐

NMOCD Reference Case No. applicable to this well: _____

Attachments:

- C- 1 02 for each zone to be commingled showing its spacing unit and acreage dedication.
- Production curve for each zone for at least one year. (If not available, attach explanation.)
- For zones with no production history, estimated production rates and supporting data.
- Data to support allocation method or formula.
- Notification list of working, royalty and overriding royalty interests for uncommon interest cases.
- Any additional statements, data or documents required to support commingling.

PRE-APPROVED POOLS

If application is to establish Pre-Approved Pools, the following additional information will be required:

- List of other orders approving downhole commingling within the proposed Pre-Approved Pools
- List of all operators within the proposed Pre-Approved Pools
- Proof that all operators within the proposed Pre-Approved Pools were provided notice of this application.
- Bottomhole pressure data.

I hereby certify that the information above is true and complete to the best of my knowledge and belief

SIGNATURE Jerry W. Sherrell TITLE Production Clerk DATE 12/29/2005

TYPE OR PRINT NAME Jerry W. Sherrell TELEPHONE NO. (505) 748-1288

E-MAIL ADDRESS jerrys@mackenergycorp.com

District I
1621 N. French Drive, Hobbs, NM 88240

District II
1301 W. Grand Avenue, Artesia, NM 88210

District III
1000 Rio Brazos Road, Aztec, NM 87410

District IV
1220 S. St Francis Dr., Santa Fe, NM 87505

State of New Mexico
Energy, Minerals and Natural Resources Department

Oil Conservation Division
1220 South St. Francis Dr.
Santa Fe, New Mexico 87505

Form C-107A
Revised June 10, 2003

APPLICATION TYPE
☒ Single Well
☒ Establish Pre-Approved Pools
EXISTING WELLBORE
☒ Yes ☐ No

APPLICATION FOR DOWNHOLE COMMINGLING

Mack Energy Corporation

P.O. Box 960, Artesia, NM 88211-0960

Operator

Address

Schley Federal

7

E-29-17S-29E

Eddy

Lease

Well No.

Unit Letter-Section-Township-Range

County

OGRID No. 013837 Property Code 22367 API No. 30-015-30303 Lease Type: ☒ Federal ☐ State ☐ Fee

DATA ELEMENT	UPPER ZONE	INTERMEDIATE ZONE	LOWER ZONE
Pool Name	Grayburg Jackson SR Q G SA		East Empire Yeso
Pool Code	28509		96610
Top and Bottom of Pay Section (Perforated or Open-Hole Interval)	2332-3788'		3913-4259'
Method of Production (Flowing or Artificial Lift)	Artificial Lift		Artificial Lift
Bottomhole Pressure (Note: Pressure data will not be required if the bottom perforation in the lower zone is within 150% of the depth of the top perforation in the upper zone)			
Oil Gravity or Gas BTU (Degree API or Gas BTU)	38.1		38.1
Producing, Shut-In or New Zone	New Zone		Producing
Date and Oil/Gas/Water Rates of Last Production. (Note: For new zones with no production history, applicant shall be required to attach production estimates and supporting data.)	Date: _____ Rates: _____	Date: _____ Rates: _____	Date: 10/31/2005 Rates: 6/33/13
Fixed Allocation Percentage (Note: If allocation is based upon something other than current or put production, supporting data or explanation will be required.)	Oil _____ Gas _____ % %	Oil _____ Gas _____ % %	Oil _____ Gas _____ % %

ADDITIONAL DATA

Are all working, royalty and overriding royalty interests identical in all commingled zones?
If not, have all working, royalty and overriding royalty interest owners been notified by certified mail?

Yes ☒ No ☐
Yes ☒ No ☐

Are all produced fluids from all commingled zones compatible with each other?

Yes ☒ No ☐

Will commingling decrease the value of production?

Yes ☐ No ☒

If this well is on, or communitized with, state or federal lands, has either the Commissioner of Public Lands or the United States Bureau of Land Management been notified in writing of this application?

Yes ☐ No ☐

NMOCD Reference Case No. applicable to this well: _____

Attachments:

- C- 1 02 for each zone to be commingled showing its spacing unit and acreage dedication.
- Production curve for each zone for at least one year. (If not available, attach explanation.)
- For zones with no production history, estimated production rates and supporting data.
- Data to support allocation method or formula.
- Notification list of working, royalty and overriding royalty interests for uncommon interest cases.
- Any additional statements, data or documents required to support commingling.

PRE-APPROVED POOLS

If application is to establish Pre-Approved Pools, the following additional information will be required:

- List of other orders approving downhole commingling within the proposed Pre-Approved Pools
- List of all operators within the proposed Pre-Approved Pools
- Proof that all operators within the proposed Pre-Approved Pools were provided notice of this application.
- Bottomhole pressure data.

I hereby certify that the information above is true and complete to the best of my knowledge and belief

SIGNATURE Jerry W. Sherrell TITLE Production Clerk DATE 12/29/2005

TYPE OR PRINT NAME Jerry W. Sherrell TELEPHONE NO. (505) 748-1288

E-MAIL ADDRESS jerrys@mackenergycorp.com

District I
1621 N. French Drive, Hobbs, NM 88240
District II
1301 W. Grand Avenue, Artesia, NM 88210
District III
1000 Rio Brazos Road, Aztec, NM 87410
District IV
1220 S. St Francis Dr., Santa Fe, NM 87505

State of New Mexico
Energy, Minerals and Natural Resources Department

Form C-107A
Revised June 10, 2003

Oil Conservation Division
1220 South St. Francis Dr.
Santa Fe, New Mexico 87505

APPLICATION TYPE
☒ Single Well
☒ Establish Pre-Approved Pools
EXISTING WELLBORE
☒ Yes ☐ No

APPLICATION FOR DOWNHOLE COMMINGLING

Mack Energy Corporation P.O. Box 960, Artesia, NM 88211-0960
Operator Address
Schley Federal 8 F-29-17S-29E Eddy
Lease Well No. Unit Letter-Section-Township-Range County
OGRID No. 013837 Property Code 22367 API No. 30-015-30307 Lease Type: ☒ Federal ☐ State ☐ Fee

DATA ELEMENT	UPPER ZONE	INTERMEDIATE ZONE	LOWER ZONE
Pool Name	Grayburg Jackson SR Q G SA		East Empire Yeso
Pool Code	28509		96610
Top and Bottom of Pay Section (Perforated or Open-Hole Interval)	2350-3795'		3929-4240'
Method of Production (Flowing or Artificial Lift)	Artificial Lift		Artificial Lift
Bottomhole Pressure (Note: Pressure data will not be required if the bottom perforation in the lower zone is within 150% of the depth of the top perforation in the upper zone)			
Oil Gravity or Gas BTU (Degree API or Gas BTU)	38.1		38.1
Producing, Shut-In or New Zone	New Zone		Producing
Date and Oil/Gas/Water Rates of Last Production. (Note: For new zones with no production history, applicant shall be required to attach production estimates and supporting data.)	Date: _____ Rates: _____	Date: _____ Rates: _____	Date: 10/31/2005 Rates: 10/55/22
Fixed Allocation Percentage (Note: If allocation is based upon something other than current or put production, supporting data or explanation will be required.)	Oil Gas % %	Oil Gas % %	Oil Gas % %

ADDITIONAL DATA

Are all working, royalty and overriding royalty interests identical in all commingled zones? Yes ☒ No ☐
If not, have all working, royalty and overriding royalty interest owners been notified by certified mail? Yes ☒ No ☐
Are all produced fluids from all commingled zones compatible with each other? Yes ☒ No ☐
Will commingling decrease the value of production? Yes ☐ No ☒
If this well is on, or communitized with, state or federal lands, has either the Commissioner of Public Lands or the United States Bureau of Land Management been notified in writing of this application? Yes ☐ No ☐
NMOCD Reference Case No. applicable to this well: _____

Attachments:

- C- 1 02 for each zone to be commingled showing its spacing unit and acreage dedication.
- Production curve for each zone for at least one year. (If not available, attach explanation.)
- For zones with no production history, estimated production rates and supporting data.
- Data to support allocation method or formula.
- Notification list of working, royalty and overriding royalty interests for uncommon interest cases.
- Any additional statements, data or documents required to support commingling.

PRE-APPROVED POOLS

If application is to establish Pre-Approved Pools, the following additional information will be required:

- List of other orders approving downhole commingling within the proposed Pre-Approved Pools
- List of all operators within the proposed Pre-Approved Pools
- Proof that all operators within the proposed Pre-Approved Pools were provided notice of this application.
- Bottomhole pressure data.

I hereby certify that the information above is true and complete to the best of my knowledge and belief

SIGNATURE Jerry W. Sherrell TITLE Production Clerk DATE 12/29/2005
TYPE OR PRINT NAME Jerry W. Sherrell TELEPHONE NO. (505) 748-1288
E-MAIL ADDRESS jerrys@mackenergycorp.com

District I
1621 N. French Drive, Hobbs, NM 88240

District II
1301 W. Grand Avenue, Artesia, NM 88210

District III
1000 Rio Brazos Road, Aztec, NM 87410

District IV
1220 S. St Francis Dr., Santa Fe, NM 87505

State of New Mexico
Energy, Minerals and Natural Resources Department

Oil Conservation Division
1220 South St. Francis Dr.
Santa Fe, New Mexico 87505

Form C-107A
Revised June 10, 2003

APPLICATION TYPE
☒ Single Well
☒ Establish Pre-Approved Pools
EXISTING WELLBORE
☒ Yes ☐ No

APPLICATION FOR DOWNHOLE COMMINGLING

Mack Energy Corporation

P.O. Box 960, Artesia, NM 88211-0960

Operator

Address

Schley Federal

9

L-29-17S-29E

Eddy

Lease

Well No.

Unit Letter-Section-Township-Range

County

OGRID No. 013837 Property Code 22367 API No. 30-015-31988 Lease Type: ☒ Federal ☐ State ☐ Fee

DATA ELEMENT	UPPER ZONE	INTERMEDIATE ZONE	LOWER ZONE
Pool Name	Grayburg Jackson SR Q G SA		East Empire Yeso
Pool Code	28509		96610
Top and Bottom of Pay Section (Perforated or Open-Hole Interval)	2490-3987'		4774-4866'
Method of Production (Flowing or Artificial Lift)	Artificial Lift		Artificial Lift
Bottomhole Pressure (Note: Pressure data will not be required if the bottom perforation in the lower zone is within 150% of the depth of the top perforation in the upper zone)			
Oil Gravity or Gas BTU (Degree API or Gas BTU)	38.1		38.1
Producing, Shut-In or New Zone	New Zone		Producing
Date and Oil/Gas/Water Rates of Last Production. (Note: For new zones with no production history, applicant shall be required to attach production estimates and supporting data.)	Date: _____ Rates: _____	Date: _____ Rates: _____	Date: 10/31/2005 Rates: 26/176/2
Fixed Allocation Percentage (Note: If allocation is based upon something other than current or put production, supporting data or explanation will be required.)	Oil _____ Gas _____ % %	Oil _____ Gas _____ % %	Oil _____ Gas _____ % %

ADDITIONAL DATA

Are all working, royalty and overriding royalty interests identical in all commingled zones?
If not, have all working, royalty and overriding royalty interest owners been notified by certified mail?

Yes ☒ No ☐
Yes ☒ No ☐

Are all produced fluids from all commingled zones compatible with each other?

Yes ☒ No ☐

Will commingling decrease the value of production?

Yes ☐ No ☒

If this well is on, or communitized with, state or federal lands, has either the Commissioner of Public Lands or the United States Bureau of Land Management been notified in writing of this application?

Yes ☐ No ☐

NMOCD Reference Case No. applicable to this well: _____

Attachments:

- C- 1 02 for each zone to be commingled showing its spacing unit and acreage dedication.
- Production curve for each zone for at least one year. (If not available, attach explanation.)
- For zones with no production history, estimated production rates and supporting data.
- Data to support allocation method or formula.
- Notification list of working, royalty and overriding royalty interests for uncommon interest cases.
- Any additional statements, data or documents required to support commingling.

PRE-APPROVED POOLS

If application is to establish Pre-Approved Pools, the following additional information will be required:

- List of other orders approving downhole commingling within the proposed Pre-Approved Pools
- List of all operators within the proposed Pre-Approved Pools
- Proof that all operators within the proposed Pre-Approved Pools were provided notice of this application.
- Bottomhole pressure data.

I hereby certify that the information above is true and complete to the best of my knowledge and belief

SIGNATURE Jerry W. Sherrell TITLE Production Clerk DATE 12/29/2005

TYPE OR PRINT NAME Jerry W. Sherrell TELEPHONE NO. (505) 748-1288

E-MAIL ADDRESS jerrys@mackenergycorp.com

District I
1621 N. French Drive, Hobbs, NM 88240

District II
1301 W. Grand Avenue, Artesia, NM 88210

District III
1000 Rio Brazos Road, Aztec, NM 87410

District IV
1220 S. St Francis Dr., Santa Fe, NM 87505

State of New Mexico
Energy, Minerals and Natural Resources Department

Oil Conservation Division
1220 South St. Francis Dr.
Santa Fe, New Mexico 87505

Form C-107A
Revised June 10, 2003

APPLICATION TYPE
☒ Single Well
☒ Establish Pre-Approved Pools
EXISTING WELLBORE
☒ Yes ☐ No

APPLICATION FOR DOWNHOLE COMMINGLING

Mack Energy Corporation

P.O. Box 960, Artesia, NM 88211-0960

Operator

Address

Schley Federal

11

F-29-17S-29E

Eddy

Lease

Well No.

Unit Letter-Section-Township-Range

County

OGRID No. 013837 Property Code 22367 API No. 30-015-32134 Lease Type: ☒ Federal ☐ State ☐ Fee

DATA ELEMENT	UPPER ZONE	INTERMEDIATE ZONE	LOWER ZONE
Pool Name	Grayburg Jackson SR Q G SA		East Empire Yeso
Pool Code	28509		96610
Top and Bottom of Pay Section (Perforated or Open-Hole Interval)	2485-3838'		3972-4257'
Method of Production (Flowing or Artificial Lift)	Artificial Lift		Artificial Lift
Bottomhole Pressure (Note: Pressure data will not be required if the bottom perforation in the lower zone is within 150% of the depth of the top perforation in the upper zone)			
Oil Gravity or Gas BTU (Degree API or Gas BTU)	38.1		38.1
Producing, Shut-In or New Zone	New Zone		Producing
Date and Oil/Gas/Water Rates of Last Production. (Note: For new zones with no production history, applicant shall be required to attach production estimates and supporting data.)	Date: _____ Rates: _____	Date: _____ Rates: _____	Date: 10/31/2005 Rates: 15/83/33
Fixed Allocation Percentage (Note: If allocation is based upon something other than current or put production, supporting data or explanation will be required.)	Oil _____ Gas _____ % %	Oil _____ Gas _____ % %	Oil _____ Gas _____ % %

ADDITIONAL DATA

Are all working, royalty and overriding royalty interests identical in all commingled zones?
If not, have all working, royalty and overriding royalty interest owners been notified by certified mail?

Yes ☒ No ☐
Yes ☒ No ☐

Are all produced fluids from all commingled zones compatible with each other?

Yes ☒ No ☐

Will commingling decrease the value of production?

Yes ☐ No ☒

If this well is on, or communitized with, state or federal lands, has either the Commissioner of Public Lands or the United States Bureau of Land Management been notified in writing of this application?

Yes ☐ No ☐

NMOCD Reference Case No. applicable to this well: _____

Attachments:

- C- 1 02 for each zone to be commingled showing its spacing unit and acreage dedication.
- Production curve for each zone for at least one year. (If not available, attach explanation.)
- For zones with no production history, estimated production rates and supporting data.
- Data to support allocation method or formula.
- Notification list of working, royalty and overriding royalty interests for uncommon interest cases.
- Any additional statements, data or documents required to support commingling.

PRE-APPROVED POOLS

If application is to establish Pre-Approved Pools, the following additional information will be required:

- List of other orders approving downhole commingling within the proposed Pre-Approved Pools
- List of all operators within the proposed Pre-Approved Pools
- Proof that all operators within the proposed Pre-Approved Pools were provided notice of this application.
- Bottomhole pressure data.

I hereby certify that the information above is true and complete to the best of my knowledge and belief

SIGNATURE Jerry W. Sherrell TITLE Production Clerk DATE 12/29/2005

TYPE OR PRINT NAME Jerry W. Sherrell TELEPHONE NO. (505) 748-1288

E-MAIL ADDRESS jerrys@mackenergycorp.com

District I
1621 N. French Drive, Hobbs, NM 88240
District 11
1301 W. Grand Avenue, Artesia, NM 88210
District III
1000 Rio Brazos Road, Aztec, NM 87410
District IV
1220 S. St Francis Dr., Santa Fe, NM 87505

State of New Mexico
Energy, Minerals and Natural Resources Department

Form C-107A
Revised June 10, 2003

Oil Conservation Division
1220 South St. Francis Dr.
Santa Fe, New Mexico 87505

APPLICATION TYPE
☒ Single Well
☒ Establish Pre-Approved Pools
EXISTING WELLBORE
☒ Yes ☐ No

APPLICATION FOR DOWNHOLE COMMINGLING

Mack Energy Corporation P.O. Box 960, Artesia, NM 88211-0960
Operator Address
Schley Federal 12 L-29-17S-29E Eddy
Lease Well No. Unit Letter-Section-Township-Range County
OGRID No. 013837 Property Code 22367 API No. 30-015-32243 Lease Type: ☒ Federal ☐ State ☐ Fee

DATA ELEMENT	UPPER ZONE	INTERMEDIATE ZONE	LOWER ZONE
Pool Name	Grayburg Jackson SR Q G SA		East Empire Yeso
PoolCode	28509		96610
Top and Bottom of Pay Section (Perforated or Open-Hole Interval)	2451-3920'		3971-4342'
Method of Production (Flowing or Artificial Lift)	Artificial Lift		Artificial Lift
Bottomhole Pressure (Note: Pressure data will not be required if the bottom perforation in the lower zone is within 150% of the depth of the top perforation in the upper zone)			
Oil Gravity or Gas BTU (Degree API or Gas BTU)	38.1		38.1
Producing, Shut-In or New Zone	New Zone		Producing
Date and Oil/Gas/Water Rates of Last Production. (Note: For new zones with no production history, applicant shall be required to attach production estimates and supporting data.)	Date: _____ Rates: _____	Date: _____ Rates: _____	Date: 10/31/2005 Rates: 47/59/24
Fixed Allocation Percentage (Note: If allocation is based upon something other than current or put production, supporting data or explanation will be required.)	Oil Gas % %	Oil Gas % %	Oil Gas % %

ADDITIONAL DATA

Are all working, royalty and overriding royalty interests identical in all commingled zones? Yes ☒ No ☐
If not, have all working, royalty and overriding royalty interest owners been notified by certified mail? Yes ☒ No ☐
Are all produced fluids from all commingled zones compatible with each other? Yes ☒ No ☐
Will commingling decrease the value of production? Yes ☐ No ☒
If this well is on, or communitized with, state or federal lands, has either the Commissioner of Public Lands or the United States Bureau of Land Management been notified in writing of this application? Yes ☐ No ☐

NMOCD Reference Case No. applicable to this well: _____

Attachments:

- C- 1 02 for each zone to be commingled showing its spacing unit and acreage dedication.
- Production curve for each zone for at least one year. (If not available, attach explanation.)
- For zones with no production history, estimated production rates and supporting data.
- Data to support allocation method or formula.
- Notification list of working, royalty and overriding royalty interests for uncommon interest cases.
- Any additional statements, data or documents required to support commingling.

PRE-APPROVED POOLS

If application is to establish Pre-Approved Pools, the following additional information will be required:

List of other orders approving downhole commingling within the proposed Pre-Approved Pools
List of all operators within the proposed Pre-Approved Pools
Proof that all operators within the proposed Pre-Approved Pools were provided notice of this application.
Bottomhole pressure data.

I hereby certify that the information above is true and complete to the best of my knowledge and belief

SIGNATURE Jerry W. Sherrell TITLE Production Clerk DATE 12/29/2005
TYPE OR PRINT NAME Jerry W. Sherrell TELEPHONE NO. (505) 748-1288
E-MAIL ADDRESS jerrys@mackenergycorp.com

District I
1621 N. French Drive, Hobbs, NM 88240

District II
1301 W. Grand Avenue, Artesia, NM 88210

District III
1000 Rio Brazos Road, Aztec, NM 87410

District IV
1220 S. St Francis Dr., Santa Fe, NM 87505

State of New Mexico
Energy, Minerals and Natural Resources Department

Oil Conservation Division
1220 South St. Francis Dr.
Santa Fe, New Mexico 87505

Form C-107A
Revised June 10, 2003

APPLICATION TYPE
☒ Single Well
☒ Establish Pre-Approved Pools
EXISTING WELLBORE
☒ Yes ☐ No

APPLICATION FOR DOWNHOLE COMMINGLING

Mack Energy Corporation

P.O. Box 960, Artesia, NM 88211-0960

Operator

Address

Schley Federal

13

E-29-17S-29E

Eddy

Lease

Well No.

Unit Letter-Section-Township-Range

County

OGRID No. 013837 Property Code 22367 API No. 30-015-32244 Lease Type: ☒ Federal ☐ State ☐ Fee

DATA ELEMENT	UPPER ZONE	INTERMEDIATE ZONE	LOWER ZONE
Pool Name	Grayburg Jackson SR Q G SA		East Empire Yeso
Pool Code	28509		96610
Top and Bottom of Pay Section (Perforated or Open-Hole Interval)	2322-3782'		3900-4197'
Method of Production (Flowing or Artificial Lift)	Artificial Lift		Artificial Lift
Bottomhole Pressure (Note: Pressure data will not be required if the bottom perforation in the lower zone is within 150% of the depth of the top perforation in the upper zone)			
Oil Gravity or Gas BTU (Degree API or Gas BTU)	38.1		38.1
Producing, Shut-In or New Zone	New Zone		Producing
Date and Oil/Gas/Water Rates of Last Production. (Note: For new zones with no production history, applicant shall be required to attach production estimates and supporting data.)	Date: _____ Rates: _____	Date: _____ Rates: _____	Date: 10/31/2005 Rates: 7/39/16
Fixed Allocation Percentage (Note: If allocation is based upon something other than current or put production, supporting data or explanation will be required.)	Oil Gas % %	Oil Gas % %	Oil Gas % %

ADDITIONAL DATA

Are all working, royalty and overriding royalty interests identical in all commingled zones?
If not, have all working, royalty and overriding royalty interest owners been notified by certified mail?

Yes ☒ No ☐
Yes ☒ No ☐

Are all produced fluids from all commingled zones compatible with each other?

Yes ☒ No ☐

Will commingling decrease the value of production?

Yes ☐ No ☒

If this well is on, or communitized with, state or federal lands, has either the Commissioner of Public Lands or the United States Bureau of Land Management been notified in writing of this application?

Yes ☐ No ☐

NMOCD Reference Case No. applicable to this well: _____

Attachments:

- C- 1 02 for each zone to be commingled showing its spacing unit and acreage dedication.
- Production curve for each zone for at least one year. (If not available, attach explanation.)
- For zones with no production history, estimated production rates and supporting data.
- Data to support allocation method or formula.
- Notification list of working, royalty and overriding royalty interests for uncommon interest cases.
- Any additional statements, data or documents required to support commingling.

PRE-APPROVED POOLS

If application is to establish Pre-Approved Pools, the following additional information will be required:

- List of other orders approving downhole commingling within the proposed Pre-Approved Pools
- List of all operators within the proposed Pre-Approved Pools
- Proof that all operators within the proposed Pre-Approved Pools were provided notice of this application.
- Bottomhole pressure data.

I hereby certify that the information above is true and complete to the best of my knowledge and belief

SIGNATURE Jerry W. Sherrell TITLE Production Clerk DATE 12/29/2005

TYPE OR PRINT NAME Jerry W. Sherrell TELEPHONE NO. (505) 748-1288

E-MAIL ADDRESS jerrys@mackenergycorp.com

District I
1621 N. French Drive, Hobbs, NM 88240

District II
1301 W. Grand Avenue, Artesia, NM 88210

District III
1000 Rio Brazos Road, Aztec, NM 87410

District IV
1220 S. St Francis Dr., Santa Fe, NM 87505

State of New Mexico
Energy, Minerals and Natural Resources Department

Oil Conservation Division
1220 South St. Francis Dr.
Santa Fe, New Mexico 87505

Form C-107A
Revised June 10, 2003

APPLICATION TYPE
☒ Single Well
☒ Establish Pre-Approved Pools
EXISTING WELLBORE
☒ Yes ☐ No

APPLICATION FOR DOWNHOLE COMMINGLING

Mack Energy Corporation

P.O. Box 960, Artesia, NM 88211-0960

Operator

Address

Schley Federal

15

E-29-17S-29E

Eddy

Lease

Well No.

Unit Letter-Section-Township-Range

County

OGRID No. 013837 Property Code 22367 API No. 30-015-32368 Lease Type: ☒ Federal ☐ State ☐ Fee

DATA ELEMENT	UPPER ZONE	INTERMEDIATE ZONE	LOWER ZONE
Pool Name	Grayburg Jackson SR Q G SA		East Empire Yeso
Pool Code	28509		96610
Top and Bottom of Pay Section (Perforated or Open-Hole Interval)	2364-3822'		3951-4287'
Method of Production (Flowing or Artificial Lift)	Artificial Lift		Artificial Lift
Bottomhole Pressure (Note: Pressure data will not be required if the bottom perforation in the lower zone is within 150% of the depth of the top perforation in the upper zone)			
Oil Gravity or Gas BTU (Degree API or Gas BTU)	38.1		38.1
Producing, Shut-In or New Zone	New Zone		Producing
Date and Oil/Gas/Water Rates of Last Production. (Note: For new zones with no production history, applicant shall be required to attach production estimates and supporting data.)	Date: _____ Rates: _____	Date: _____ Rates: _____	Date: 10/31/2005 Rates: 6/33/13
Fixed Allocation Percentage (Note: If allocation is based upon something other than current or put production, supporting data or explanation will be required.)	Oil Gas % %	Oil Gas % %	oil Gas % %

ADDITIONAL DATA

Are all working, royalty and overriding royalty interests identical in all commingled zones?

Yes ☒ No ☐

If not, have all working, royalty and overriding royalty interest owners been notified by certified mail?

Yes ☒ No ☐

Are all produced fluids from all commingled zones compatible with each other?

Yes ☒ No ☐

Will commingling decrease the value of production?

Yes ☐ No ☒

If this well is on, or communitized with, state or federal lands, has either the Commissioner of Public Lands or the United States Bureau of Land Management been notified in writing of this application?

Yes ☐ No ☐

NMOCD Reference Case No. applicable to this well: _____

Attachments:

- C- 1 02 for each zone to be commingled showing its spacing unit and acreage dedication.
- Production curve for each zone for at least one year. (If not available, attach explanation.)
- For zones with no production history, estimated production rates and supporting data.
- Data to support allocation method or formula.
- Notification list of working, royalty and overriding royalty interests for uncommon interest cases.
- Any additional statements, data or documents required to support commingling.

PRE-APPROVED POOLS

If application is to establish Pre-Approved Pools, the following additional information will be required:

- List of other orders approving downhole commingling within the proposed Pre-Approved Pools
- List of all operators within the proposed Pre-Approved Pools
- Proof that all operators within the proposed Pre-Approved Pools were provided notice of this application.
- Bottomhole pressure data.

I hereby certify that the information above is true and complete to the best of my knowledge and belief

SIGNATURE Jerry W. Sherrell TITLE Production Clerk DATE 12/29/2005

TYPE OR PRINT NAME Jerry W. Sherrell TELEPHONE NO. (505) 748-1288

E-MAIL ADDRESS jerrys@mackenergycorp.com

DISTRICT I

P.O. Box 1980, Hobbs, NM 88241-1980

State of New Mexico

Energy, Minerals and Natural Resources Department

Form C-102

Revised February 10, 1994

Submit to Appropriate District Office

State Lease - 4 Copies

Fee Lease - 3 Copies

DISTRICT II

P.O. Drawer DD, Artesia, NM 88211-0719

DISTRICT III

1000 Rio Brazos Rd., Aztec, NM 87410

DISTRICT IV

P.O. BOX 2088, SANTA FE, N.M. 87504-2088

OIL CONSERVATION DIVISION

P.O. Box 2088

Santa Fe, New Mexico 87504-2088

☐ AMENDED REPORT

WELL LOCATION AND ACREAGE DEDICATION PLAT

API Number 30-015-30301	Pool Code 28509	Pool Name Grayburg Jackson SR Q G SA
Property Code 022367	Property Name SCHLEY Federal	Well Number 2
OGRID No. 013837	Operator Name MACK ENERGY CORPORATION	Elevation 3609

Surface Location

UL or lot No.	Section	Township	Range	Lot Idn	Feet from the	North/South line	Feet from the	East/West line	County
BL	29	17 S	29 E		1650	SOUTH	990	WEST	EDDY

Bottom Hole Location If Different From Surface

UL or lot No.	Section	Township	Range	Lot Idn	Feet from the	North/South line	Feet from the	East/West line	County
Dedicated Acres 40		Joint or Infill	Consolidation Code		Order No.				

NO ALLOWABLE WILL BE ASSIGNED TO THIS COMPLETION UNTIL ALL INTERESTS HAVE BEEN CONSOLIDATED
OR A NON-STANDARD UNIT HAS BEEN APPROVED BY THE DIVISION

	OPERATOR CERTIFICATION I hereby certify the the information contained herein is true and complete to the best of my knowledge and belief. <u>Matt J. Brewer</u> Signature Matt J. Brewer Printed Name Geological Engineer Title <u>5/13/98</u> Date
	SURVEYOR CERTIFICATION I hereby certify that the well location shown on this plat was plotted from field notes of actual surveys made by me or under my supervision, and that the same is true and correct to the best of my belief. APRIL 28, 1998 Date Surveyed Signature <u>[Signature]</u> Professional Surveyor NEW MEXICO 5-04-98 98-11-06 Certificate No. RONALD L. McDONALD 3239 GARY L. FIDSON 12641 McDONALD 12185

P.O. Box 1980, Hobbs, NM 88241-1980

Energy, Minerals and Natural Resources Department

Revised February 10, 1994

Submit to Appropriate District Office

State Lease - 4 Copies

Fee Lease - 3 Copies

P.O. Drawer DD, Artesia, NM 88211-0719

1000 Rio Brazos Rd., Artec, NM 87410

P.O. Box 2088

Santa Fe, New Mexico 87504-2088

P.O. BOX 2088, SANTA FE, N.M. 87504-2088

☐ AMENDED REPORT

WELL LOCATION AND ACREAGE DEDICATION PLAT

API Number 30-015-30301	Pool Code 96610	Pool Name East Empire Yeso
Property Code 022367	Property Name SCHLEY Federal	Well Number 2
OGRID No. 013837	Operator Name MACK ENERGY CORPORATION	Elevation 3609

Surface Location

UL or lot No.	Section	Township	Range	Lot Idn	Feet from the	North/South line	Feet from the	East/West line	County
0 L	29	17 S	29 E		1650	SOUTH	990	WEST	EDDY

Bottom Hole Location If Different From Surface

UL or lot No.	Section	Township	Range	Lot Idn	Feet from the	North/South line	Feet from the	East/West line	County
Dedicated Acres 40	Joint or Infill	Consolidation Code		Order No.					

NO ALLOWABLE WILL BE ASSIGNED TO THIS COMPLETION UNTIL ALL INTERESTS HAVE BEEN CONSOLIDATED
OR A NON-STANDARD UNIT HAS BEEN APPROVED BY THE DIVISION

	OPERATOR CERTIFICATION <i>I hereby certify the information contained herein is true and complete to the best of my knowledge and belief.</i> <u>Matt J. Brewer</u> Signature <u>Matt J. Brewer</u> Printed Name <u>Geological Engineer</u> Title <u>5/13/98</u> Date
	SURVEYOR CERTIFICATION <i>I hereby certify that the well location shown on this plat was plotted from field notes of actual surveys made by me or under my supervision, and that the same is true and correct to the best of my belief.</i> <p>APRIL 28, 1998</p> <p>Date Surveyed _____ DMCC</p> <p>Signature of Sealer _____ Professional Surveyor</p> <p> 504-98</p> <p>Associate No. _____ 3239 _____ 12641 _____ 12185</p>

DISTRICT I
P.O. Box 1980, Hobbs, NM 88241-1980

DISTRICT II
P.O. Drawer DD, Artesia, NM 88211-0719

DISTRICT III
1000 Rio Brazos Rd., Aztec, NM 87410

DISTRICT IV
P.O. Box 2088, Santa Fe, N.M. 87504-2088

State of New Mexico
Energy, Minerals and Natural Resources Department

Form C-102
Revised February 10, 1994
Submit to Appropriate District Office
State Lease - 4 Copies
Fee Lease - 3 Copies

OIL CONSERVATION DIVISION

P.O. Box 2088
Santa Fe, New Mexico 87504-2088

☐ AMENDED REPORT

WELL LOCATION AND ACREAGE DEDICATION PLAT

API Number 30-015-30451	Pool Code 96610	Pool Name East Empire Yeso
Property Code 022367	Property Name SCHLEY Federal	Well Number 4
OGRID No. 013837	Operator Name MACK ENERGY CORPORATION	Elevation 3616'

Surface Location

UL or lot No. L	Section 29	Township 17 S	Range 29 E	Lot Idn	Feet from the 2180	North/South line SOUTH	Feet from the 430	East/West line WEST	County EDDY
---------------------------	----------------------	-------------------------	----------------------	---------	------------------------------	----------------------------------	-----------------------------	-------------------------------	-----------------------

Bottom Hole Location If Different From Surface

UL or lot No.	Section	Township	Range	Lot Idn	Feet from the	North/South line	Feet from the	East/West line	County
Dedicated Acres 40	Joint or Infill	Consolidation Code	Order No.						

NO ALLOWABLE WILL BE ASSIGNED TO THIS COMPLETION UNTIL ALL INTERESTS HAVE BEEN CONSOLIDATED
OR A NON-STANDARD UNIT HAS BEEN APPROVED BY THE DIVISION

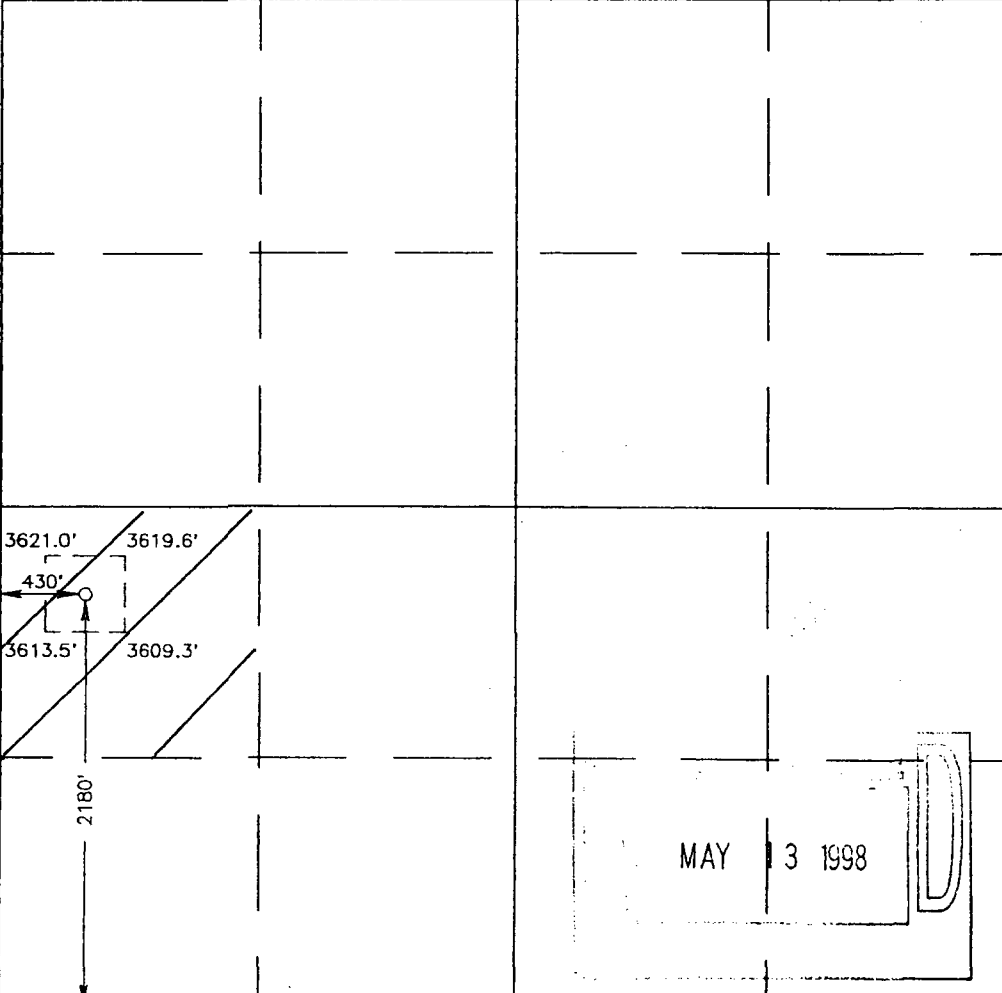
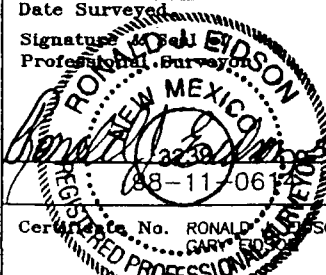
	<p>OPERATOR CERTIFICATION</p> <p>I hereby certify the the information contained herein is true and complete to the best of my knowledge and belief.</p> <p><u>Matt J. Brewer</u> Signature</p> <p><u>Matt J. Brewer</u> Printed Name</p> <p><u>Geological Engineer</u> Title</p> <p><u>5/13/98</u> Date</p> <p>SURVEYOR CERTIFICATION</p> <p>I hereby certify that the well location shown on this plat was plotted from field notes of actual surveys made by me or under my supervision and that the same is true and correct to the best of my belief.</p> <p>MAY 11, 1998</p> <p>Date Surveyed _____ CDG</p> <p>Signature <u>Ronald J. Edison</u> Professional Surveyor</p> <p></p> <p>Certified No. <u>3239</u> 12641</p>
--	---

DISTRICT I
P.O. Box 1980, Hobbs, NM 88241-1980

DISTRICT II
P.O. Drawer DD, Artesia, NM 88211-0719

DISTRICT III
1000 Rio Brazos Rd., Aztec, NM 87410

DISTRICT IV
P.O. BOX 2088, SANTA FE, N.M. 87504-2088

State of New Mexico
Energy, Minerals and Natural Resources Department

Form C-102
Revised February 10, 1994
Submit to Appropriate District Office
State Lease - 4 Copies
Fee Lease - 3 Copies

OIL CONSERVATION DIVISION

P.O. Box 2088
Santa Fe, New Mexico 87504-2088

☐ AMENDED REPORT

WELL LOCATION AND ACREAGE DEDICATION PLAT

API Number 30-015-30451	Pool Code 28509	Pool Name Grayburg Jackson SR QGSA
Property Code 022367	Property Name SCHLEY Federal	Well Number 4
OGRID No. 013837	Operator Name MACK ENERGY CORPORATION	Elevation 3616'

Surface Location

UL or lot No. L	Section 29	Township 17 S	Range 29 E	Lot Idn	Feet from the 2180	North/South line SOUTH	Feet from the 430	East/West line WEST	County EDDY
---------------------------	----------------------	-------------------------	----------------------	---------	------------------------------	----------------------------------	-----------------------------	-------------------------------	-----------------------

Bottom Hole Location If Different From Surface

UL or lot No.	Section	Township	Range	Lot Idn	Feet from the	North/South line	Feet from the	East/West line	County
Dedicated Acres 40	Joint or Infill	Consolidation Code	Order No.						

NO ALLOWABLE WILL BE ASSIGNED TO THIS COMPLETION UNTIL ALL INTERESTS HAVE BEEN CONSOLIDATED
OR A NON-STANDARD UNIT HAS BEEN APPROVED BY THE DIVISION

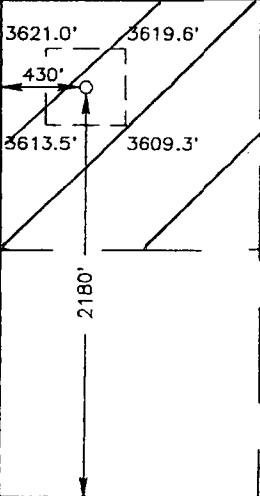
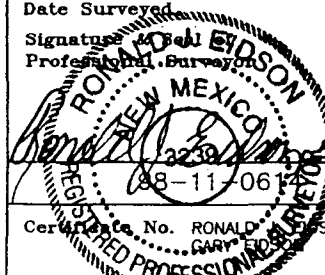
	<p>MAY 13 1998</p>	<p>OPERATOR CERTIFICATION</p> <p>I hereby certify the the information contained herein is true and complete to the best of my knowledge and belief.</p> <p><u>Matt J. Brewer</u> Signature</p> <p><u>Matt J. Brewer</u> Printed Name</p> <p><u>Geological Engineer</u> Title</p> <p><u>5/13/98</u> Date</p>
		<p>SURVEYOR CERTIFICATION</p> <p>I hereby certify that the well location shown on this plat was plotted from field notes of actual surveys made by me or under my supervision, and that the same is true and correct to the best of my belief.</p> <p>MAY 11, 1998</p> <p>Date Surveyed _____ CDG</p> <p>Signature <u>Ronald E. Eydson</u> Professional Surveyor</p> <p></p> <p>Certification No. <u>RONALD E. EYDSON</u> 3239 12641</p>

DISTRICT I
P.O. Box 1980, Hobbs, NM 88241-1980

DISTRICT II
P.O. Drawer DD, Artesia, NM 88211-0719

DISTRICT III
1000 Rio Brazos Rd., Aztec, NM 87410

DISTRICT IV
P.O. BOX 2088, SANTA FE, N.M. 87504-2088

State of New Mexico
Energy, Minerals and Natural Resources Department

Form C-102
Revised February 10, 1994
Submit to Appropriate District Office
State Lease - 4 Copies
Fee Lease - 3 Copies

OIL CONSERVATION DIVISION

P.O. Box 2088
Santa Fe, New Mexico 87504-2088

MAY 11 1998

AMENDED REPORT

WELL LOCATION AND ACREAGE DEDICATION PLAT

API Number 30-015-30302	Pool Code 28509	Pool Name Graybury Jackson SRQGSA
Property Code 022367	Property Name SCHLEY Federal	Well Number 5
OGRID No. 013837	Operator Name MACK ENERGY CORPORATION	Elevation 3612

Surface Location

UL or lot No.	Section	Township	Range	Lot Idn	Feet from the	North/South line	Feet from the	East/West line	County
E	29	17 S	29 E		2230	NORTH	990	WEST	EDDY

Bottom Hole Location If Different From Surface

UL or lot No.	Section	Township	Range	Lot Idn	Feet from the	North/South line	Feet from the	East/West line	County

Dedicated Acres 40	Joint or Infill	Consolidation Code	Order No.
-----------------------	-----------------	--------------------	-----------

NO ALLOWABLE WILL BE ASSIGNED TO THIS COMPLETION UNTIL ALL INTERESTS HAVE BEEN CONSOLIDATED
OR A NON-STANDARD UNIT HAS BEEN APPROVED BY THE DIVISION

	<p>OPERATOR CERTIFICATION</p> <p>I hereby certify the information contained herein is true and complete to the best of my knowledge and belief.</p> <p><u>Matt J. Brewer</u> Signature</p> <p><u>Matt J. Brewer</u> Printed Name</p> <p><u>Geological Engineer</u> Title</p> <p><u>5/13/98</u> Date</p>
	<p>SURVEYOR CERTIFICATION</p> <p>I hereby certify that the well location shown on this plat was plotted from field notes of actual surveys made by me or under my supervision and that the same is true and correct to the best of my belief.</p> <p>APRIL 22, 1998</p> <p>Date Surveyed</p> <p><u>Ronald J. Eidson</u> Signature of Registered Professional Surveyor</p> <p><u>5-07-98</u> Date</p> <p>DMCC</p> <p>REGISTERED PROFESSIONAL SURVEYOR No. 3239 RONALD J. EIDSON McDONALD 12641 12185</p>

DISTRICT I
P.O. Box 1980, Hobbs, NM 88241-1980

DISTRICT II
P.O. Drawer DD, Artesia, NM 88211-0719

DISTRICT III
1000 Rio Brazos Rd., Aztec, NM 87410

DISTRICT IV
P.O. BOX 2088, SANTA FE, N.M. 87504-2088

State of New Mexico
Energy, Minerals and Natural Resources Department

Form C-102
Revised February 10, 1994
Submit to Appropriate District Office
State Lease - 4 Copies
Fee Lease - 3 Copies

OIL CONSERVATION DIVISION

P.O. Box 2088
Santa Fe, New Mexico 87504-2088

MAY 11 1998

AMENDED REPORT

WELL LOCATION AND ACREAGE DEDICATION PLAT

API Number 30-015-30302	Pool Code 96610	Pool Name East Empire Yeso
Property Code 022367	Property Name SCHLEY Federal	Well Number 5
OGRID No. 013837	Operator Name MACK ENERGY CORPORATION	Elevation 3612

Surface Location

UL or lot No. E	Section 29	Township 17 S	Range 29 E	Lot Idn	Feet from the 2230	North/South line NORTH	Feet from the 990	East/West line WEST	County EDDY
--------------------	---------------	------------------	---------------	---------	-----------------------	---------------------------	----------------------	------------------------	----------------

Bottom Hole Location If Different From Surface

UL or lot No.	Section	Township	Range	Lot Idn	Feet from the	North/South line	Feet from the	East/West line	County
Dedicated Acres 40	Joint or Infill	Consolidation Code	Order No.						

NO ALLOWABLE WILL BE ASSIGNED TO THIS COMPLETION UNTIL ALL INTERESTS HAVE BEEN CONSOLIDATED
OR A NON-STANDARD UNIT HAS BEEN APPROVED BY THE DIVISION

	<p>OPERATOR CERTIFICATION</p> <p>I hereby certify the the information contained herein is true and complete to the best of my knowledge and belief.</p> <p><u>Matt J. Brewer</u> Signature</p> <p>Matt J. Brewer Printed Name</p> <p><u>Geological Engineer</u> Title</p> <p><u>5/13/98</u> Date</p>
	<p>SURVEYOR CERTIFICATION</p> <p>I hereby certify that the well location shown on this plat was plotted from field notes of actual surveys made by me or under my supervision, and that the same is true and correct to the best of my belief.</p> <p>APRIL 22, 1998</p> <p>Date Surveyed</p> <p><u>Ronald J. Eidson</u> Signature</p> <p>Ronald J. Eidson Professional Surveyor</p> <p>NEW MEXICO 3239 5-07-98 12641 12185</p>

DISTRICT I
P.O. Box 1980, Hobbs, NM 88241-1980

DISTRICT II
P.O. Drawer DD, Artesia, NM 88211-0719

DISTRICT III
1000 Rio Brazos Rd., Aztec, NM 87410

DISTRICT IV
P.O. Box 2088, Santa Fe, N.M. 87504-2088

State of New Mexico
Energy, Minerals and Natural Resources Department

Form C-102
Revised February 10, 1994
Submit to Appropriate District Office
State Lease - 4 Copies
Fee Lease - 3 Copies

OIL CONSERVATION DIVISION

P.O. Box 2088
Santa Fe, New Mexico 87504-2088

☐ AMENDED REPORT

WELL LOCATION AND ACREAGE DEDICATION PLAT

API Number 30-015-30459	Pool Code 96610	Pool Name East Empire Yeso
Property Code 022367	Property Name SCHLEY FEDERAL	Well Number 6
OGRID No. 013837	Operator Name MACK ENERGY CORPORATION	Elevation 3604

Surface Location

UL or lot No. F	Section 29	Township 17 S	Range 29 E	Lot Idn	Feet from the 2035	North/South line NORTH	Feet from the 2450	East/West line WEST	County EDDY
---------------------------	----------------------	-------------------------	----------------------	---------	------------------------------	----------------------------------	------------------------------	-------------------------------	-----------------------

Bottom Hole Location If Different From Surface

UL or lot No.	Section	Township	Range	Lot Idn	Feet from the	North/South line	Feet from the	East/West line	County
Dedicated Acres 40	Joint or Infill	Consolidation Code	Order No.						

NO ALLOWABLE WILL BE ASSIGNED TO THIS COMPLETION UNTIL ALL INTERESTS HAVE BEEN CONSOLIDATED
OR A NON-STANDARD UNIT HAS BEEN APPROVED BY THE DIVISION

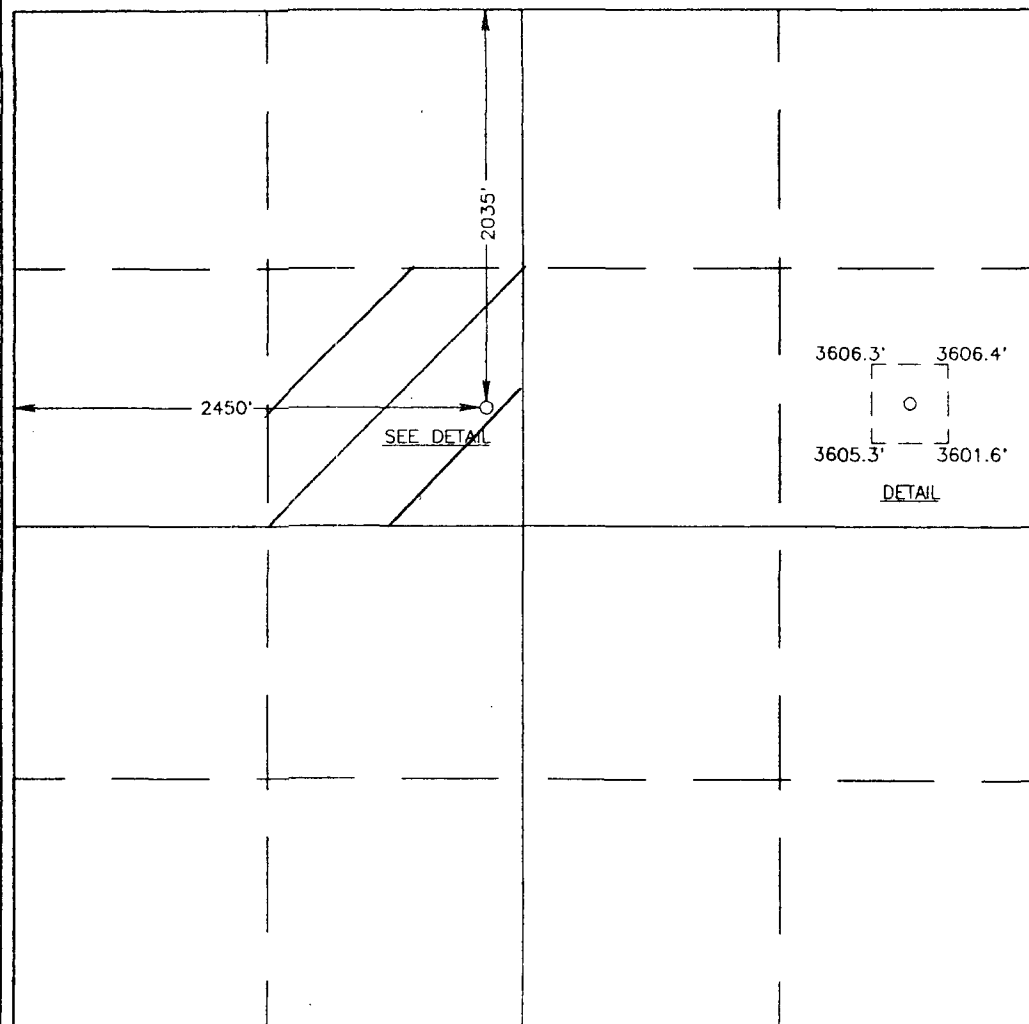
	<p>OPERATOR CERTIFICATION</p> <p>I hereby certify the the information contained herein is true and complete to the best of my knowledge and belief.</p> <p><i>Matt J. Brewer</i> Signature</p> <p>Matt J. Brewer Printed Name</p> <p>Geological Engineer Title</p> <p>7/27/98 Date</p> <p>SURVEYOR CERTIFICATION</p> <p>I hereby certify that the well location shown on this plat was plotted from field notes of actual survey made by me or under my supervision, and that the same is true and correct to the best of my belief.</p> <p>JUL 27 1998</p> <p>JULY 10, 1998 Date Surveyed</p> <p>DMCC</p> <p>Ronald E. Edison Professional Surveyor</p> <p>7-21-98 7-21-98</p> <p>78-11-101 78-11-101</p> <p>Certificate No. RONALD E. EDISON 3239 GARY E. EDISON 12641 RONALD E. EDISON 12185</p>
---	---

DISTRICT II
P.O. Drawer DD, Artesia, NM 88211-0719

DISTRICT III
1000 Rio Brazos Rd., Aztec, NM 87410

DISTRICT IV
P.O. BOX 2088, SANTA FE, N.M. 87504-2088

OIL CONSERVATION DIVISION

P.O. Box 2088

Santa Fe, New Mexico 87504-2088

☐ AMENDED REPORT

WELL LOCATION AND ACREAGE DEDICATION PLAT

API Number 30-015-30459		Pool Code 28509	Pool Name Grayburg Jackson SR & G SA
Property Code 022367	Property Name SCHLEY FEDERAL		Well Number 6
OGRID No. 013837	Operator Name MACK ENERGY CORPORATION		Elevation 3604

Surface Location

UL or lot No.	Section	Township	Range	Lot Idn	Feet from the	North/South line	Feet from the	East/West line	County
F	29	17 S	29 E		2035	NORTH	2450	WEST	EDDY

Bottom Hole Location If Different From Surface

UL or lot No.	Section	Township	Range	Lot Idn	Feet from the	North/South line	Feet from the	East/West line	County
Dedicated Acres 40	Joint or Infill	Consolidation Code		Order No.					

NO ALLOWABLE WILL BE ASSIGNED TO THIS COMPLETION UNTIL ALL INTERESTS HAVE BEEN CONSOLIDATED
OR A NON-STANDARD UNIT HAS BEEN APPROVED BY THE DIVISION

	<div style="border: 1px solid black; padding: 5px;"> <h3 style="text-align: center; margin: 0;">OPERATOR CERTIFICATION</h3> <p style="font-size: small; margin: 5px 0;">I hereby certify the the information contained herein is true and complete to the best of my knowledge and belief.</p> <p style="margin: 5px 0;"> <u>Matt J. Brewer</u> Signature </p> <p style="margin: 5px 0;"> <u>Matt J. Brewer</u> Printed Name </p> <p style="margin: 5px 0;"> <u>Geological Engineer</u> Title </p> <p style="margin: 5px 0;"> <u>7/27/98</u> Date </p> </div> <div style="border: 1px solid black; padding: 5px; margin-top: 10px;"> <h3 style="text-align: center; margin: 0;">SURVEYOR CERTIFICATION</h3> <p style="font-size: small; margin: 5px 0;">I hereby certify that the well location shown on this plan was plotted from field notes of actual surveys made by me or under my supervision, and that the same is true and correct to the best of my belief.</p> <p style="text-align: center; margin: 5px 0;"> <u>JUL 27 1998</u> Date Surveyed </p> <p style="text-align: right; margin: 5px 0;"> <u>DMCC</u> Professional Surveyor </p> <div style="text-align: center; margin: 10px 0;"> </div> <p style="margin: 5px 0;"> <u>3239</u> Certification No. </p> <p style="margin: 5px 0;"> <u>7-21-98</u> Date </p> <p style="margin: 5px 0;"> <u>12641</u> Expiration Date </p> <p style="margin: 5px 0;"> <u>12185</u> Renewal Date </p> </div>
--	--

ACT I

Box 1980, Hobbs, NM 88241-1980

State of New Mexico

Energy, Minerals and Natural Resources Department

Form C-102

Revised February 10, 1994

Submit to Appropriate District Office

State Lease - 4 Copies

Fee Lease - 3 Copies

DISTRICT II

P.O. Drawer DD, Artesia, NM 88211-0719

DISTRICT III

1000 Rio Brazos Rd., Aztec, NM 87410

DISTRICT IV

P.O. BOX 2088, SANTA FE, N.M. 87504-2088

OIL CONSERVATION DIVISION

P.O. Box 2088

Santa Fe, New Mexico 87504-2088

MAY 5

☐ AMENDED REPORT

WELL LOCATION AND ACREAGE DEDICATION PLAT

API Number 30-015-30303	Pool Code 28509	Pool Name Grayburg Jackson SR QG SA
Property Code 022367	Property Name SCHLEY Federal	Well Number 7
OGRID No. 013837	Operator Name MACK ENERGY CORPORATION	Elevation 3617

Surface Location

UL or lot No. E	Section 29	Township 17 S	Range 29 E	Lot Idn	Feet from the 1710	North/South line NORTH	Feet from the 330	East/West line WEST	County EDDY
--------------------	---------------	------------------	---------------	---------	-----------------------	---------------------------	----------------------	------------------------	----------------

Bottom Hole Location If Different From Surface

UL or lot No.	Section	Township	Range	Lot Idn	Feet from the	North/South line	Feet from the	East/West line	County
Dedicated Acres 40	Joint or Infill	Consolidation Code	Order No.						

NO ALLOWABLE WILL BE ASSIGNED TO THIS COMPLETION UNTIL ALL INTERESTS HAVE BEEN CONSOLIDATED
OR A NON-STANDARD UNIT HAS BEEN APPROVED BY THE DIVISION

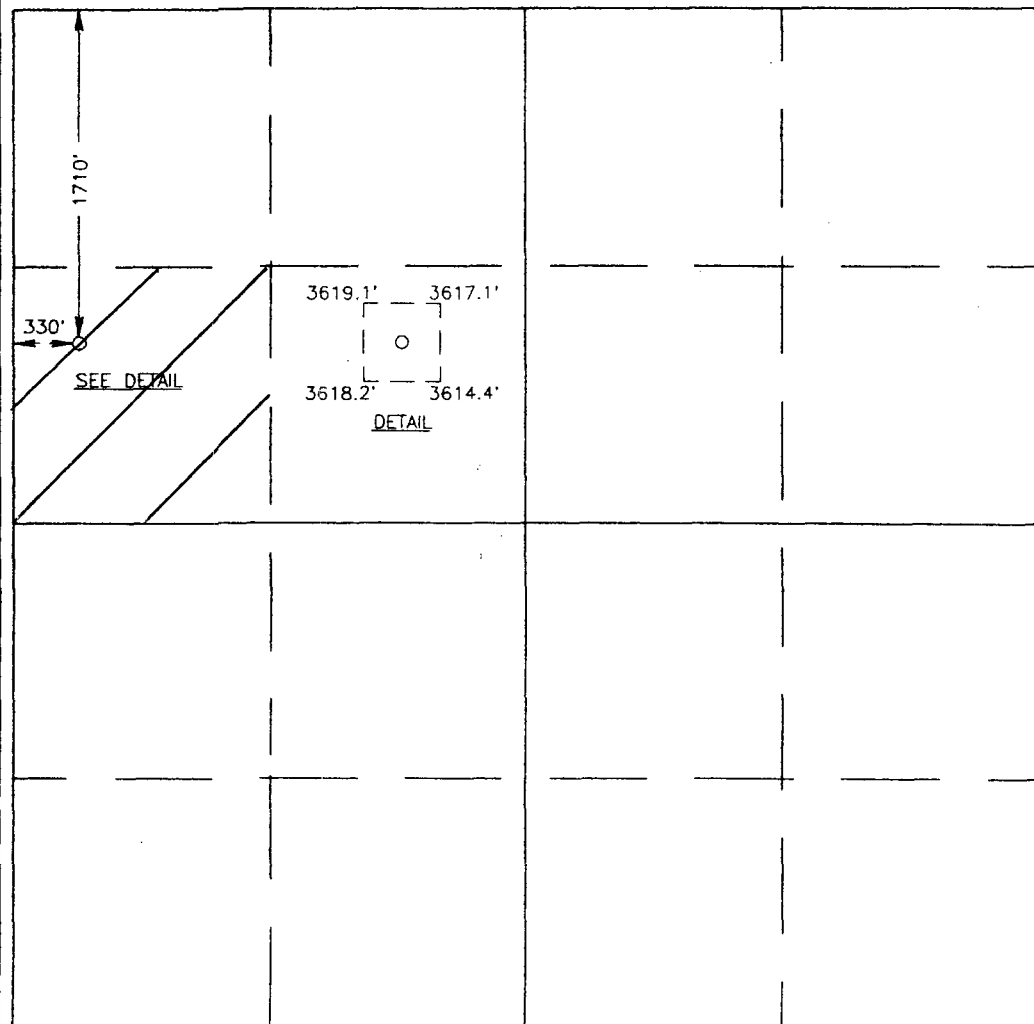
	OPERATOR CERTIFICATION I hereby certify the the information contained herein is true and complete to the best of my knowledge and belief. Signature <u>Matt J. Brewer</u> Printed Name <u>Matt J. Brewer</u> Title <u>Geological Engineer</u> Date <u>5/13/98</u>
	SURVEYOR CERTIFICATION I hereby certify that the well location shown on this plat was plotted from field notes of actual surveys made by me or under my supervision, and that the same is true and correct to the best of my belief. APRIL 22, 1998 Date Surveyed Signature <u>Ronald J. Edson</u> DMCC Professional Stamp: RONALD J. EDSON, NEW MEXICO, 5-04-98, 98-11-0610 Certificate No. <u>RONALD J. EDSON</u> 3239 Professional Seal: <u>RONALD J. EDSON</u> 12641 Professional Seal: <u>RONALD J. EDSON</u> 12185

DISTRICT II
P.O. Drawer DD, Artesia, NM 88211-0719

DISTRICT III
1000 Rio Brazos Rd., Aztec, NM 87410

DISTRICT IV
P.O. BOX 2088, SANTA FE, N.M. 87504-2088

OIL CONSERVATION DIVISION

P.O. Box 2088
Santa Fe, New Mexico 87504-2088

☐ AMENDED REPORT

WELL LOCATION AND ACREAGE DEDICATION PLAT

API Number 30-015-30303	Pool Code 96610	Pool Name East Empire Yeso
Property Code 022367	Property Name SCHLEY Federal	Well Number 7
OGRID No. 013837	Operator Name MACK ENERGY CORPORATION	Elevation 3617

Surface Location

UL or lot No.	Section	Township	Range	Lot Idn	Feet from the	North/South line	Feet from the	East/West line	County
E	29	17 S	29 E		1710	NORTH	330	WEST	EDDY

Bottom Hole Location If Different From Surface

UL or lot No.	Section	Township	Range	Lot Idn	Feet from the	North/South line	Feet from the	East/West line	County
Dedicated Acres 40	Joint or Infill	Consolidation Code	Order No.						

NO ALLOWABLE WILL BE ASSIGNED TO THIS COMPLETION UNTIL ALL INTERESTS HAVE BEEN CONSOLIDATED
OR A NON-STANDARD UNIT HAS BEEN APPROVED BY THE DIVISION

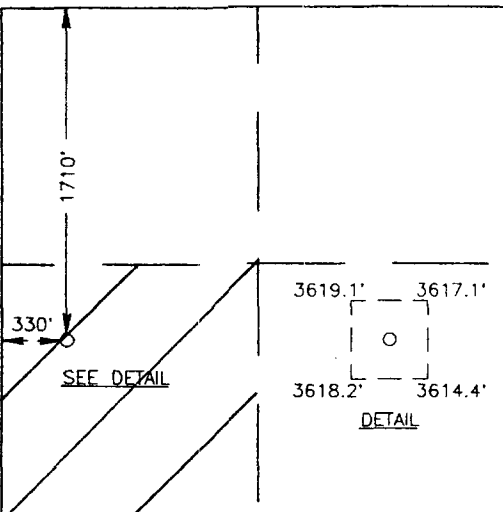
	OPERATOR CERTIFICATION I hereby certify the the information contained herein is true and complete to the best of my knowledge and belief. <u>Matt J. Brewer</u> Signature Matt J. Brewer Printed Name Geological Engineer Title 5/13/98 Date
	SURVEYOR CERTIFICATION I hereby certify that the well location shown on this plat was plotted from field notes of actual surveys made by me or under my supervision, and that the same is true and correct to the best of my belief. APRIL 22, 1998 Date Surveyed Signature of Surveyor Professional Surveyor RONALD J. EDSON 3-04-98 98-11-0615 REGISTERED PROFESSIONAL SURVEYOR Certificate No. RONALD J. EDSON 3239 CARTER EDSON 12641 RONALD J. EDSON 12185

P.O. BOX 2088, SANTA FE, N.M. 87504-2088

Santa Fe, New Mexico 87504-2088

MAY 5 AMENDED REPORT

API Number 30-015-30307	Pool Code 28509	Pool Name Grayburg Jackson SR Q B SA
Property Code 022367	Property Name SCHLEY Federal	Well Number 8
OGRID No. 013837	Operator Name MACK ENERGY CORPORATION	Elevation 3607

UL or lot No.	Section	Township	Range	Lot Idn	Feet from the	North/South line	Feet from the	East/West line	County
F	29	17 S	29 E		1580	NORTH	1650	WEST	EDDY

UL or lot No.	Section	Township	Range	Lot ldn	Feet from the	North/South line	Feet from the	East/West line	County
---------------	---------	----------	-------	---------	---------------	------------------	---------------	----------------	--------

Order No.

40

NO ALLOWABLE WILL BE ASSIGNED TO THIS COMPLETION UNTIL ALL INTERESTS HAVE BEEN CONSOLIDATED
OR A NON-STANDARD UNIT HAS BEEN APPROVED BY THE DIVISION

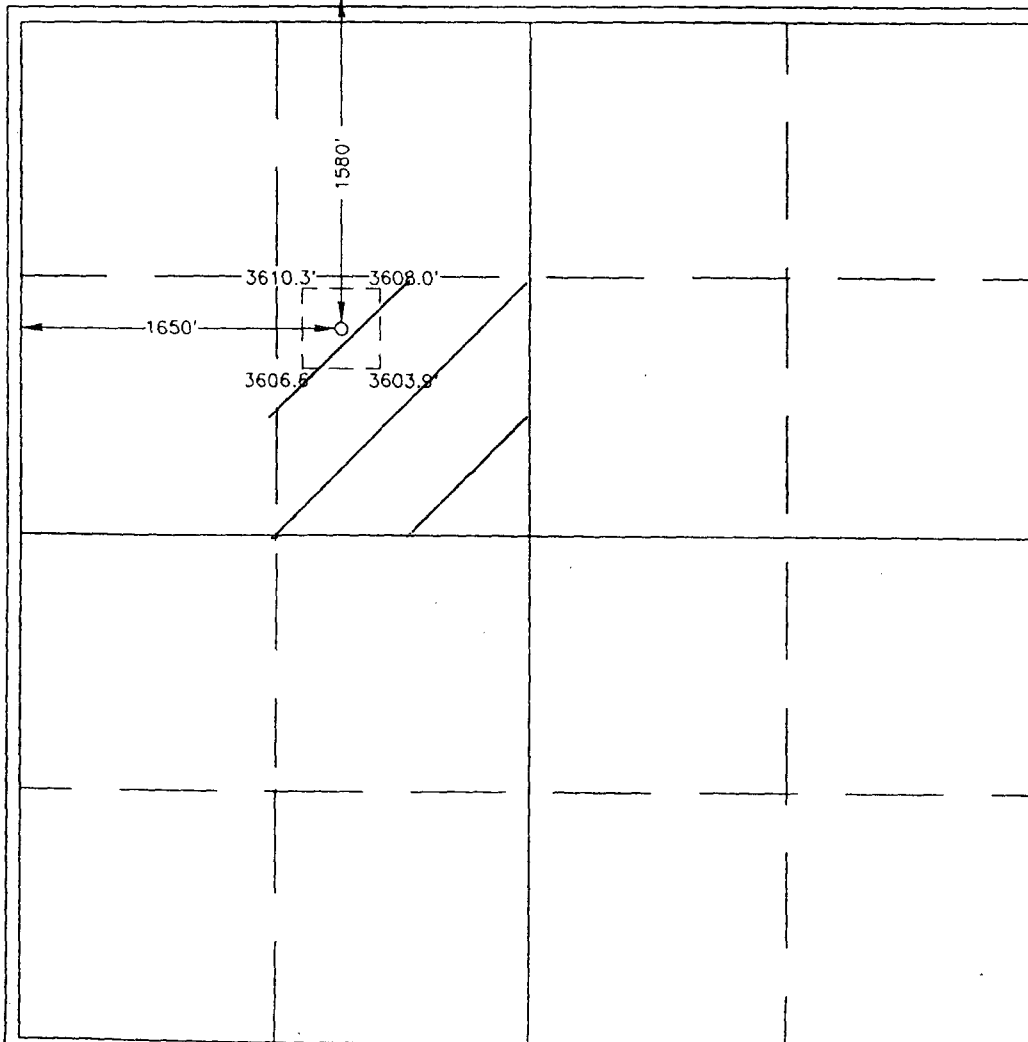

I hereby certify the the information
contained herein is true and complete to the
best of my knowledge and belief.

Matt J. Brewer
Signature

Matt J. Brewer
Printed Name

Geological Engineer
Title

5/13/98
Date

SURVEYOR CERTIFICATION

I hereby certify that the well location shown on this plat was plotted from field notes of actual surveys made by me or under my supervision and that the same is true and correct to the best of my belief.

APRIL 22, 1998

Date Suggested _____

Signature LD

Professional

110

...

Amir D.

[Handwritten signature]

088



Certificate No. 1150

FROM

[illegible]

DMCC

ALL

079

3239
12641

12185

— — —

State of New Mexico

Energy, Minerals and Natural Resources Department

Form C-102

Revised February 10, 1994

Submit to Appropriate District Office

State Lease - 4 Copies

Fee Lease - 3 Copies

Box 1980, Hobbs, NM 88241-1980

DISTRICT II

P.O. Drawer DD, Artesia, NM 88211-0719

DISTRICT III

1000 Rio Brazos Rd., Aztec, NM 87410

DISTRICT IV

P.O. BOX 2088, SANTA FE, N.M. 87504-2088

OIL CONSERVATION DIVISION

P.O. Box 2088

Santa Fe, New Mexico 87504-2088

MAY 1998 AMENDED REPORT

WELL LOCATION AND ACREAGE DEDICATION PLAT

API Number 30-015-30307	Pool Code 96610	Pool Name East Empire Yeso
Property Code 022367	Property Name SCHLEY Federal	Well Number 8
OGRID No. 013837	Operator Name MACK ENERGY CORPORATION	Elevation 3607

Surface Location

UL or lot No. F	Section 29	Township 17 S	Range 29 E	Lot Idn	Feet from the 1580	North/South line NORTH	Feet from the 1650	East/West line WEST	County EDDY
---------------------------	----------------------	-------------------------	----------------------	---------	------------------------------	----------------------------------	------------------------------	-------------------------------	-----------------------

Bottom Hole Location If Different From Surface

UL or lot No.	Section	Township	Range	Lot Idn	Feet from the	North/South line	Feet from the	East/West line	County
---------------	---------	----------	-------	---------	---------------	------------------	---------------	----------------	--------

Dedicated Acres 40	Joint or Infill	Consolidation Code	Order No.
------------------------------	-----------------	--------------------	-----------

NO ALLOWABLE WILL BE ASSIGNED TO THIS COMPLETION UNTIL ALL INTERESTS HAVE BEEN CONSOLIDATED
OR A NON-STANDARD UNIT HAS BEEN APPROVED BY THE DIVISION

	OPERATOR CERTIFICATION I hereby certify the the information contained herein is true and complete to the best of my knowledge and belief. <u>Matt J. Brewer</u> Signature Matt J. Brewer Printed Name Geological Engineer Title <u>5/13/98</u> Date
	SURVEYOR CERTIFICATION I hereby certify that the well location shown on this plat was plotted from field notes of actual surveys made by me or under my supervision, and that the same is true and correct to the best of my belief. APRIL 22, 1998 Date Surveyed Signature of Surveyor Professional Surveyor NEW MEXICO DMCC 5-04-98 Certification No. RONALD J. EIDSON 3239 GARY McDONALD 12641 McDONALD 12185

Form C-102
Revised February 10, 1994
Submit to Appropriate District Office
State Lease - 4 Copies
Fee Lease - 3 Copies

State of New Mexico
Energy, Minerals and Natural Resources Department

Form C-102
Revised February 10, 1994
Submit to Appropriate District Office
State Lease - 4 Copies
Fee Lease - 3 Copies

DISTRICT I
1980, Hobbs, NM 88241-1980

DISTRICT II
Drawer DD, Artesia, NM 88211-0719

DISTRICT III
1000 Rio Brazos Rd., Artec, NM 87410

DISTRICT IV
P.O. BOX 2088, SANTA FE, N.M. 87504-2088

OIL CONSERVATION DIVISION

P.O. Box 2088
Santa Fe, New Mexico 87504-2088

☐ AMENDED REPORT

WELL LOCATION AND ACREAGE DEDICATION PLAT

API Number 30-015-31988	Pool Code 28509	Pool Name Grayburg Jackson SR Q G SA
Property Code 022367	Property Name SCHLEY FEDERAL	Well Number 9
OGRID No. 013837	Operator Name MACK ENERGY CORPORATION	Elevation 3613

Surface Location

UL or lot No. L	Section 29	Township 17 S	Range 29 E	Lot Idn	Feet from the 1650	North/South line SOUTH	Feet from the 490	East/West line WEST	County EDDY
--------------------	---------------	------------------	---------------	---------	-----------------------	---------------------------	----------------------	------------------------	----------------

Bottom Hole Location If Different From Surface

UL or lot No.	Section	Township	Range	Lot Idn	Feet from the	North/South line	Feet from the	East/West line	County
Dedicated Acres 40	Joint or Infill	Consolidation Code	Order No.						

NO ALLOWABLE WILL BE ASSIGNED TO THIS COMPLETION UNTIL ALL INTERESTS HAVE BEEN CONSOLIDATED
OR A NON-STANDARD UNIT HAS BEEN APPROVED BY THE DIVISION

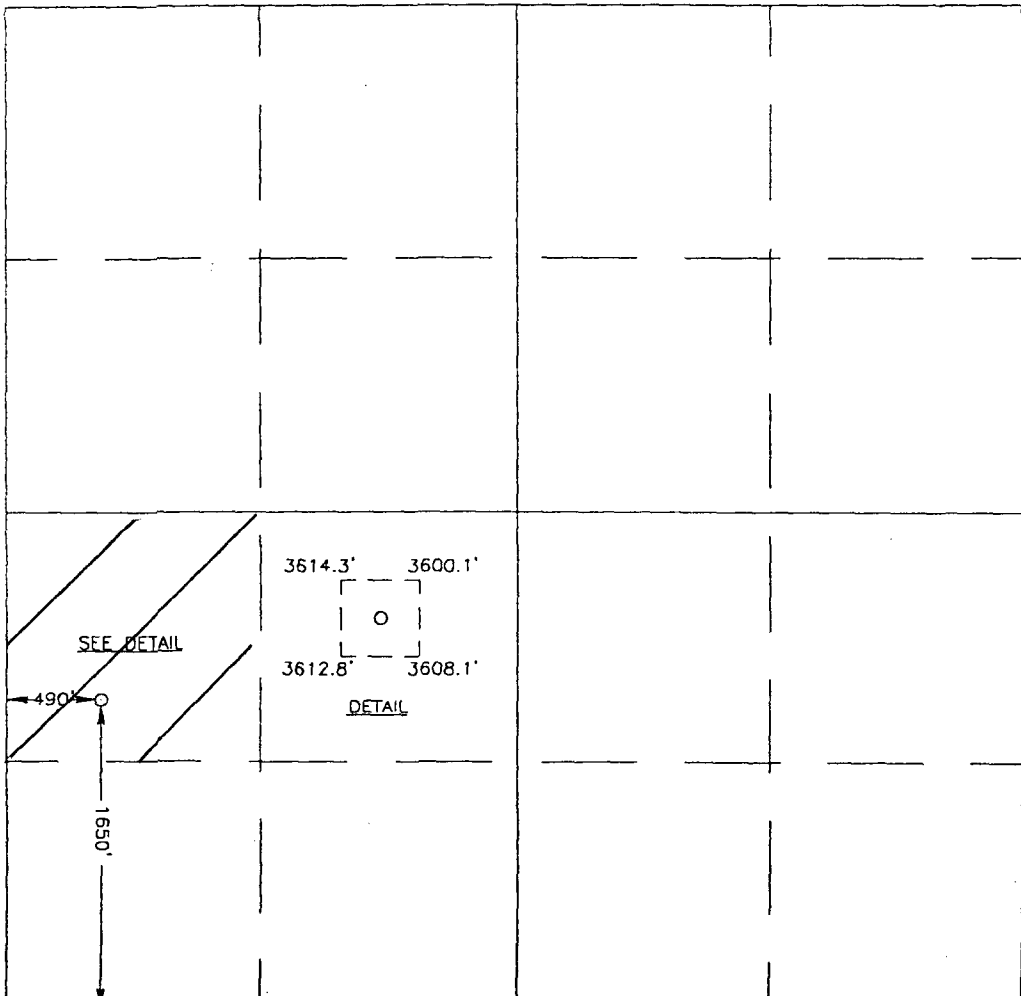
	<p>OPERATOR CERTIFICATION</p> <p>I hereby certify the the information contained herein is true and complete to the best of my knowledge and belief.</p> <p><i>Crissa D. Carter</i></p> <p>Signature</p> <p>Crissa D. Carter</p> <p>Printed Name</p> <p>Production Analyst</p> <p>Title</p> <p>7/11/2001</p> <p>Date</p>
	<p>SURVEYOR CERTIFICATION</p> <p>I hereby certify that the well location shown on this plat was plotted from field notes of actual surveys made by me or under my supervision, and that the same is true and correct to the best of my belief.</p> <p>JUNE 28, 2001</p> <p>Date Surveyed</p> <p><i>Gary Eidson</i></p> <p>Signature & Seal of Professional Surveyor</p> <p>NEW MEXICO</p> <p>7/2/01</p> <p>01-11-0794</p> <p>Certificate No. RONALD J. EIDSON 3239 GARY EIDSON 12841</p>

T I
1980, Hobbs, NM 88241-1980

DISTRICT II
Drawer DD, Artesia, NM 88211-0719

DISTRICT III
1000 Rio Brazos Rd., Artec, NM 87410

DISTRICT IV
P.O. BOX 2088, SANTA FE, N.M. 87504-2088

State of New Mexico
Energy, Minerals and Natural Resources Department

Form C-102
Revised February 10, 1994
Submit to Appropriate District Office
State Lease - 4 Copies
Fee Lease - 3 Copies

OIL CONSERVATION DIVISION
P.O. Box 2088
Santa Fe, New Mexico 87504-2088

☐ AMENDED REPORT

WELL LOCATION AND ACREAGE DEDICATION PLAT

API Number 30-015-31988	Pool Code 96610	Pool Name East Empire Yeso
Property Code 022367	Property Name SCHLEY FEDERAL	Well Number 9
OGRID No. 013837	Operator Name MACK ENERGY CORPORATION	Elevation 3613

Surface Location

UL or lot No.	Section	Township	Range	Lot Idn	Feet from the	North/South line	Feet from the	East/West line	County
L	29	17 S	29 E		1650	SOUTH	490	WEST	EDDY

Bottom Hole Location If Different From Surface

UL or lot No.	Section	Township	Range	Lot Idn	Feet from the	North/South line	Feet from the	East/West line	County
Dedicated Acres 40	Joint or Infill	Consolidation Code	Order No.						

NO ALLOWABLE WILL BE ASSIGNED TO THIS COMPLETION UNTIL ALL INTERESTS HAVE BEEN CONSOLIDATED
OR A NON-STANDARD UNIT HAS BEEN APPROVED BY THE DIVISION

<p>SEE DETAIL</p> <p>490'</p> <p>1650'</p> <p>3614.3'</p> <p>3600.1'</p> <p>3612.8'</p> <p>3608.1'</p> <p>DETAIL</p>	<p>OPERATOR CERTIFICATION</p> <p>I hereby certify the the information contained herein is true and complete to the best of my knowledge and belief.</p> <p><i>Crissa D. Carter</i></p> <p>Signature</p> <p>Crissa D. Carter</p> <p>Printed Name</p> <p>Production Analyst</p> <p>Title</p> <p>7/11/2001</p> <p>Date</p>
	<p>SURVEYOR CERTIFICATION</p> <p>I hereby certify that the well location shown on this plat was plotted from field notes of actual surveys made by me or under my supervision and that the same is true and correct to the best of my belief.</p> <p>JUNE 28, 2001</p> <p>Date Surveyed</p> <p>Signature & Seal of Professional Surveyor</p> <p><i>Ronald J. Eidson</i> 7/2/01</p> <p>01-11-0794</p> <p>Certificate No. RONALD J. EIDSON 3239 CARY EIDSON 12641</p>

DISTRICT I

P.O. Box 1980, Hobbs, NM 88241-1980

State of New Mexico

Energy, Minerals and Natural Resources Department

Form C-102

Revised February 10, 1994

Submit to Appropriate District Office

State Lease - 4 Copies

Fee Lease - 3 Copies

DISTRICT II

P.O. Drawer DD, Artesia, NM 88211-0719

OIL CONSERVATION DIVISION

P.O. Box 2088

Santa Fe, New Mexico 87504-2088

DISTRICT III

1000 Rio Brazos Rd., Aztec, NM 87410

DISTRICT IV

P.O. BOX 2088, SANTA FE, N.M. 87504-2088

WELL LOCATION AND ACREAGE DEDICATION PLAT

☐ AMENDED REPORT

API Number 30-015-32134	Pool Code 96610	Pool Name East Empire Yeso
Property Code 022367	Property Name SCHLEY FEDERAL	Well Number 11
OGRID No. 013837	Operator Name MACK ENERGY CORPORATION	Elevation 3604'

Surface Location

UL or lot No.	Section	Township	Range	Lot Idn	Feet from the	North/South line	Feet from the	East/West line	County
F	29	17-S	29-E		2185	NORTH	1650	WEST	EDDY

Bottom Hole Location If Different From Surface

UL or lot No.	Section	Township	Range	Lot Idn	Feet from the	North/South line	Feet from the	East/West line	County
Dedicated Acres 40	Joint or Infill	Consolidation Code	Order No.						

NO ALLOWABLE WILL BE ASSIGNED TO THIS COMPLETION UNTIL ALL INTERESTS HAVE BEEN CONSOLIDATED
OR A NON-STANDARD UNIT HAS BEEN APPROVED BY THE DIVISION

	OPERATOR CERTIFICATION I hereby certify the information contained herein is true and complete to the best of my knowledge and belief. Signature Crissa D. Carter Printed Name Production Analyst Title 10/22/01 Date
	SURVEYOR CERTIFICATION I hereby certify that the well location shown on this plat was plotted from field notes of actual surveys made by me or under my supervision, and that the same is true and correct to the best of my belief. OCTOBER 16, 2001 Date Surveyed AWB Signature & Seal of Professional Surveyor RONALD J. EDSON Certificate No. 3239 GARY EDSON 12641

State of New Mexico

Energy, Minerals and Natural Resources Department

Form C-102

Revised February 10, 1994

Submit to Appropriate District Office

State Lease - 4 Copies

Fee Lease - 3 Copies

DISTRICT I

P.O. Box 1980, Hobbs, NM 88241-1980

DISTRICT II

P.O. Drawer DD, Artesia, NM 88211-0719

DISTRICT III

1000 Rio Brazos Rd., Aztec, NM 87410

DISTRICT IV

P.O. BOX 2088, SANTA FE, N.M. 87504-2088

OIL CONSERVATION DIVISION

P.O. Box 2088

Santa Fe, New Mexico 87504-2088

WELL LOCATION AND ACREAGE DEDICATION PLAT

☐ AMENDED REPORT

API Number 30-015-32134	Pool Code 28509	Pool Name Grayburg Jackson SR QG SA
Property Code 022367	Property Name SCHLEY FEDERAL	Well Number 11
OGRID No. 013837	Operator Name MACK ENERGY CORPORATION	Elevation 3604'

Surface Location

UL or lot No. F	Section 29	Township 17-S	Range 29-E	Lot Idn	Feet from the 2185	North/South line NORTH	Feet from the 1650	East/West line WEST	County EDDY
--------------------	---------------	------------------	---------------	---------	-----------------------	---------------------------	-----------------------	------------------------	----------------

Bottom Hole Location If Different From Surface

UL or lot No.	Section	Township	Range	Lot Idn	Feet from the	North/South line	Feet from the	East/West line	County
Dedicated Acres 40	Joint or Infill	Consolidation Code	Order No.						

NO ALLOWABLE WILL BE ASSIGNED TO THIS COMPLETION UNTIL ALL INTERESTS HAVE BEEN CONSOLIDATED
OR A NON-STANDARD UNIT HAS BEEN APPROVED BY THE DIVISION

	OPERATOR CERTIFICATION I hereby certify the information contained herein is true and complete to the best of my knowledge and belief. Signature Crissa D. Carter Printed Name Production Analyst Title 10/22/9 Date
	SURVEYOR CERTIFICATION I hereby certify that the well location shown on this plat was plotted from field notes of actual surveys made by me or under my supervision, and that the same is true and correct to the best of my belief. OCTOBER 16, 2001 Date Surveyed Signature & Seal of Professional Surveyor RONALD J. EDISON 10/19/01 01.11.1141
	Certificate No. RONALD J. EDISON 3239 GARY EIDSON 12641

State of New Mexico

Energy, Minerals and Natural Resources Department

Form C-102

Revised February 10, 1994

Submit to Appropriate District Office

State Lease - 4 Copies

Fee Lease - 3 Copies

OIL CONSERVATION DIVISION

P.O. Box 2088

Santa Fe, New Mexico 87504-2088

Abbe, NM 86241-1080

District II
P.O. Box 2088, Santa Fe, NM 87504-2088District III
P.O. Box 2088, Santa Fe, NM 87504-2088District IV
P.O. Box 2088, Santa Fe, NM 87504-2088

WELL LOCATION AND ACREAGE DEDICATION PLAT

☐ AMENDED REPORT

API Number 30-015-32243	Pool Code 28509	Pool Name Grayburg Jackson SR QGSA
Property Code 022367	Property Name SCHLEY FEDERAL	Well Number 12
OGRID No. 013837	Operator Name MACK ENERGY CORPORATION	Elevation 3616'



Surface Location

UL or lot No. L	Section 29	Township 17-S	Range 29-E	Lot Idn	Feet from the 2215	North/South line SOUTH	Feet from the 990	East/West line WEST	County EDDY
---------------------------	----------------------	-------------------------	----------------------	---------	------------------------------	----------------------------------	-----------------------------	-------------------------------	-----------------------

Bottom Hole Location If Different From Surface

UL or lot No.	Section	Township	Range	Lot Idn	Feet from the	North/South line	Feet from the	East/West line	County
Dedicated Acres 40	Joint or Infill	Consolidation Code	Order No.						

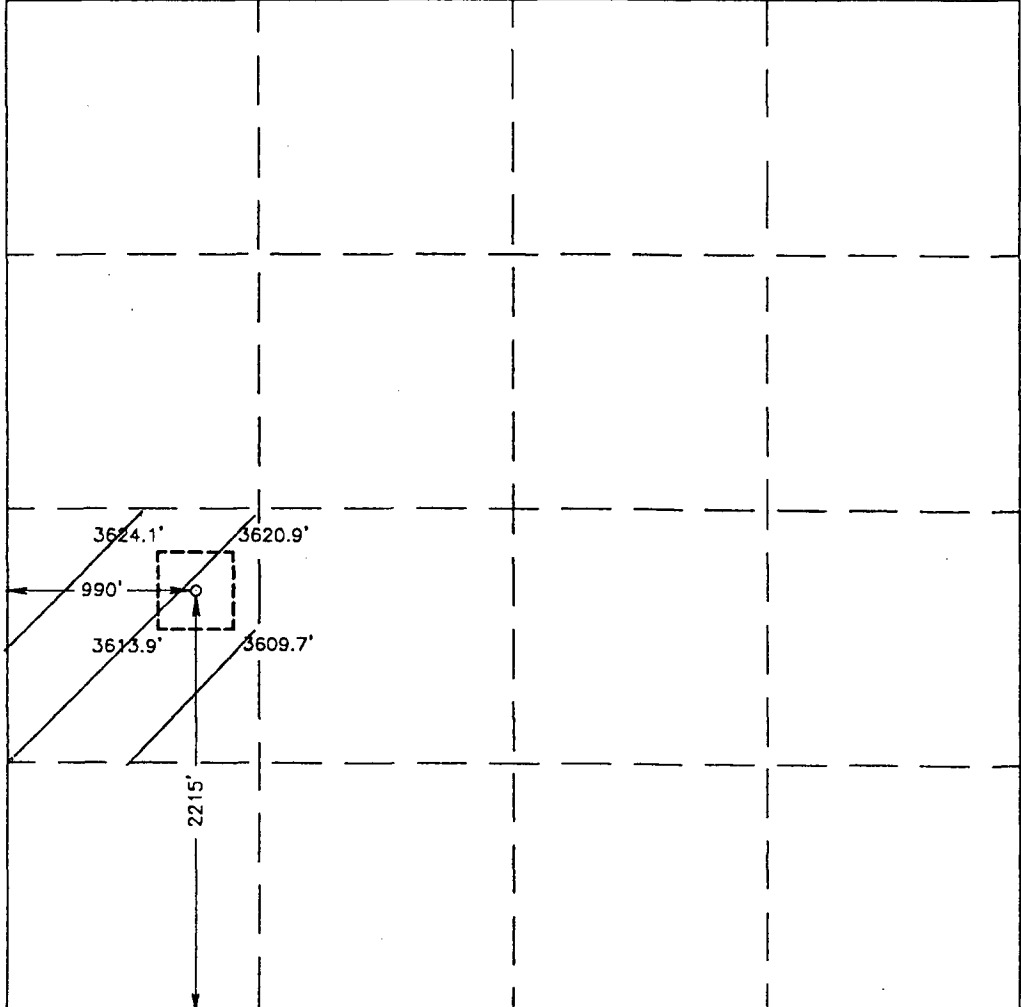
NO ALLOWABLE WILL BE ASSIGNED TO THIS COMPLETION UNTIL ALL INTERESTS HAVE BEEN CONSOLIDATED
OR A NON-STANDARD UNIT HAS BEEN APPROVED BY THE DIVISION

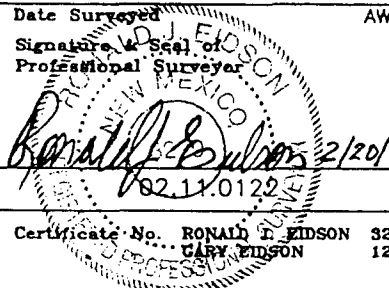
	OPERATOR CERTIFICATION I hereby certify the the information contained herein is true and complete to the best of my knowledge and belief.  Signature Jerry W. Sherrell Printed Name Production Clerk Title 2/28/2002 Date
	SURVEYOR CERTIFICATION I hereby certify that the well location shown on this plat was plotted from field notes of actual surveys made by me or under my supervision, and that the same is true and correct to the best of my belief. FEBRUARY 19, 2002 Date Surveyed AWB Signature & Seal of Professional Surveyor  Certificate No. RONALD E. EDSON 3239 GARY EDSON 12641

OIL CONSERVATION DIVISION

P.O. Box 2088

Santa Fe, New Mexico 87504-2088

II

DD, Artesia, NM 86211-0719

DISTRICT III

Rio Brazos Rd., Aztec, NM 87410

DISTRICT IV

P.O. BOX 2088, SANTA FE, N.M. 87504-2088

WELL LOCATION AND ACREAGE DEDICATION PLAT

☐ AMENDED REPORT

API Number 30-015-32243		Pool Code 96610	Pool Name East Empire Yeso
Property Code 022367	Property Name SCHLEY FEDERAL		Well Number 12
OGRID No. 013837	Operator Name MACK ENERGY CORPORATION		Elevation 3616'

Surface Location

UL or lot No.	Section	Township	Range	Lot Idn	Feet from the	North/South line	Feet from the	East/West line	County
L	29	17-S	29-E		2215	SOUTH	990	WEST	EDDY

Bottom Hole Location If Different From Surface

UL or lot No.	Section	Township	Range	Lot Idn	Feet from the	North/South line	Feet from the	East/West line	County
Dedicated Acres 40	Joint or Infill	Consolidation Code	Order No.						

NO ALLOWABLE WILL BE ASSIGNED TO THIS COMPLETION UNTIL ALL INTERESTS HAVE BEEN CONSOLIDATED
OR A NON-STANDARD UNIT HAS BEEN APPROVED BY THE DIVISION

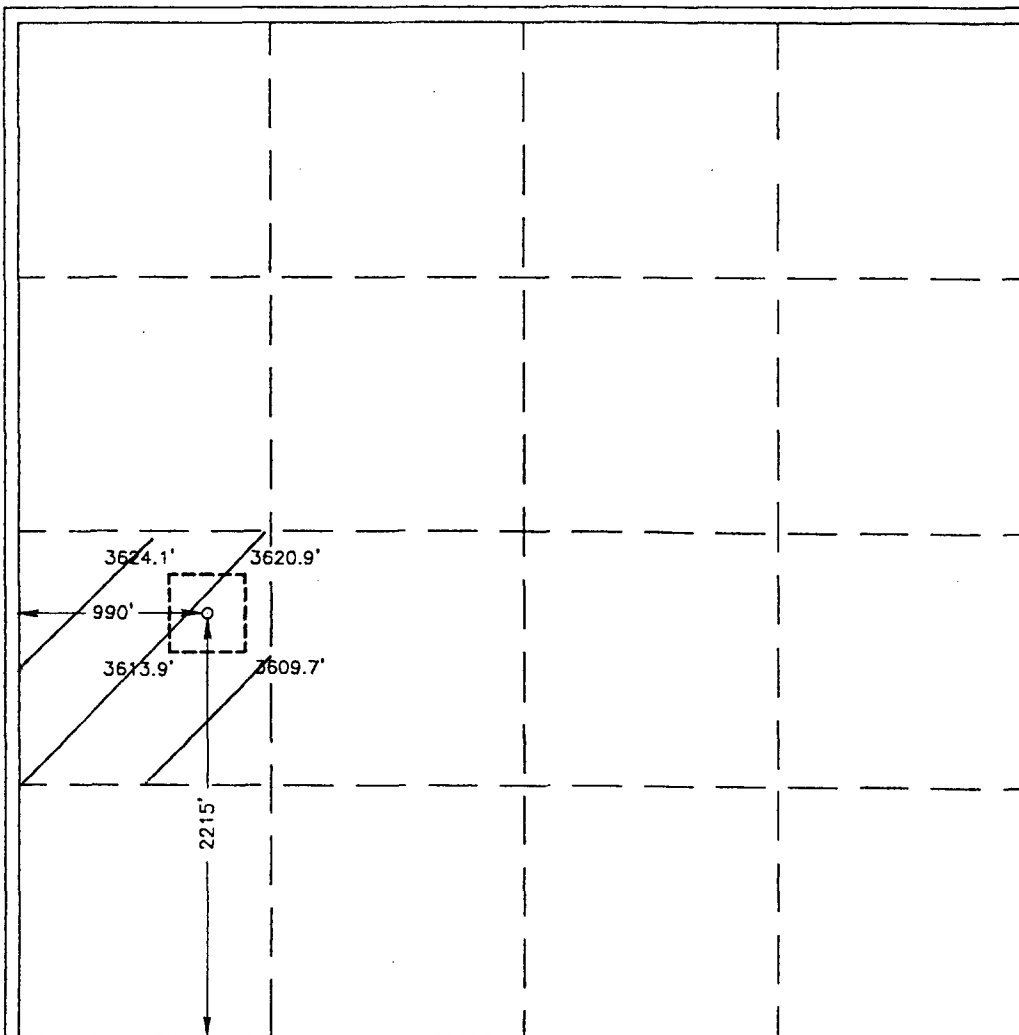

OPERATOR CERTIFICATION

I hereby certify the the information
contained herein is true and complete to the
best of my knowledge and belief.

Jerry W. Sherrell
Signature

Jerry W. Sherrell
Printed Name

Production Clerk
Title

2/28/2002
Date

SURVEYOR CERTIFICATION

I hereby certify that the well location shown
on this plat was plotted from field notes of
actual surveys made by me or under my
supervision, and that the same is true and
correct to the best of my belief.

FEBRUARY 19, 2002

Date Surveyed AWB

Signature & Seal of
Professional Surveyor
Ronald T. Edson
2/20/02
02.11.0122

Certificate No. RONALD T. EDSON 3239
TARY EDSON 12641

DISTRICT II
P.O. Drawer DD, Artesia, NM 88211-0719

OIL CONSERVATION DIVISION

P.O. Box 2088
Santa Fe, New Mexico 87504-2088

DISTRICT III
1000 Rio Brazos Rd., Aztec, NM 87410

DISTRICT IV
P.O. BOX 2088, SANTA FE, N.M. 87504-2088

WELL LOCATION AND ACREAGE DEDICATION PLAT

☐ AMENDED REPORT

API Number 30-015-32244	Pool Code 96610	Pool Name East Empire Yeso
Property Code 022367	Property Name SCHLEY FEDERAL	Well Number 13
OGRID No. 013837	Operator Name MACK ENERGY CORPORATION	Elevation 3610'

Surface Location

UL or lot No.	Section	Township	Range	Lot Idn	Feet from the	North/South line	Feet from the	East/West line	County
E	29	17-S	29-E		1525	NORTH	990	WEST	EDDY

Bottom Hole Location If Different From Surface

UL or lot No.	Section	Township	Range	Lot Idn	Feet from the	North/South line	Feet from the	East/West line	County
---------------	---------	----------	-------	---------	---------------	------------------	---------------	----------------	--------

Dedicated Acres	Joint or Infill	Consolidation Code	Order No.
40			

NO ALLOWABLE WILL BE ASSIGNED TO THIS COMPLETION UNTIL ALL INTERESTS HAVE BEEN CONSOLIDATED
OR A NON-STANDARD UNIT HAS BEEN APPROVED BY THE DIVISION

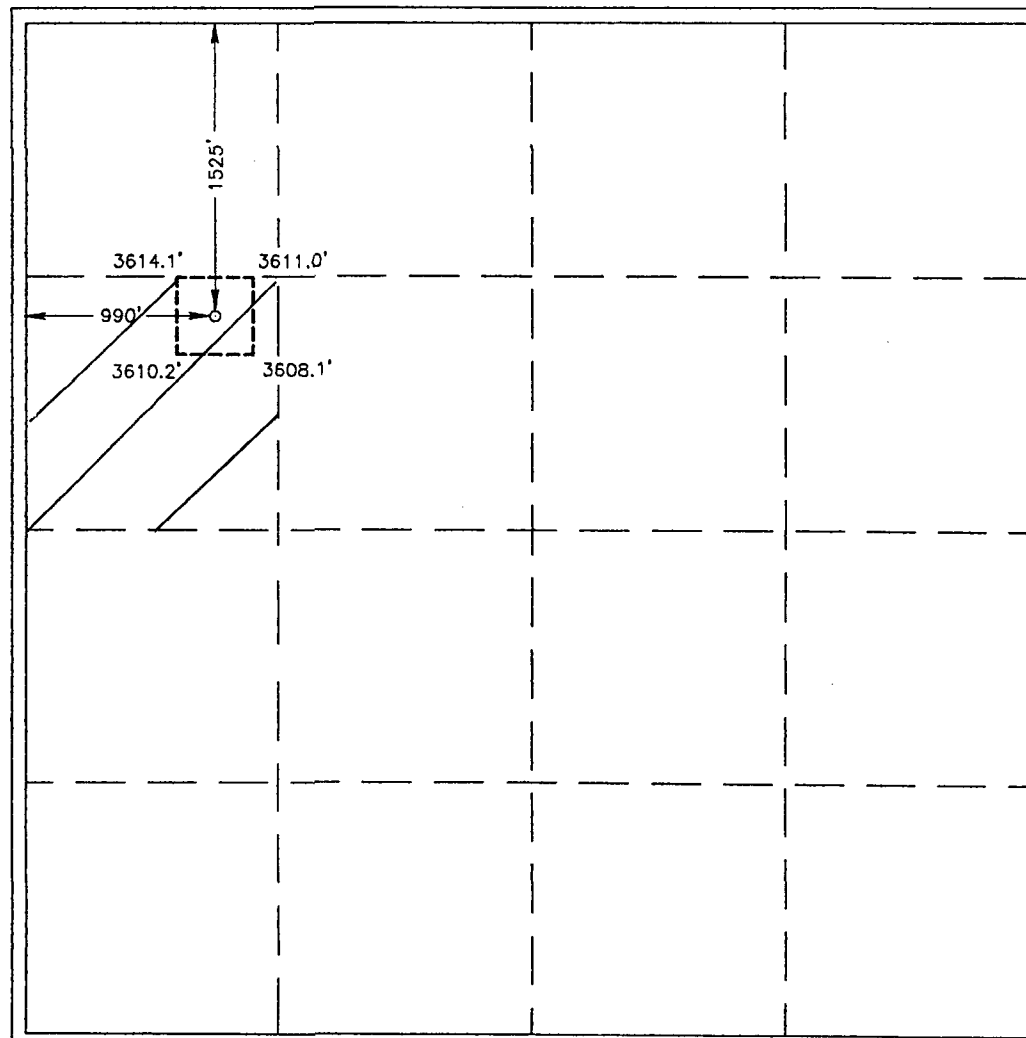

OPERATOR CERTIFICATION

I hereby certify the the information
contained herein is true and complete to the
best of my knowledge and belief.

Jerry W. Sherrell
Signature

Jerry W. Sherrell
Printed Name

Production Clerk
Title

2/28/2002
Date

SURVEYOR CERTIFICATION

I hereby certify that the well location shown on this plat was plotted from field notes of actual surveys made by me or under my supervision, and that the same is true and correct to the best of my belief.

FEBRUARY 19, 2002

Date Surveyed _____ AWB
Signature & Seal of _____
Professional Surveyor _____

02-11-0128 VER 2/20/02

Certificate No.: RONALD J. EIDSON 3239
GARY EIDSON 12641

DISTRICT I

P.O. Box 1980, Hobbs, NM 88241-1980

DISTRICT II

P.O. Drawer DD, Artesia, NM 80211-0719

DISTRICT III

1000 Rio Brazos Rd., Aztec, NM 87410

DISTRICT IV

P.O. BOX 2088, SANTA FE, N.M. 87504-2088

State of New Mexico

Energy, Minerals and Natural Resources Department

Form C-102

Revised February 10, 1994

Submit to Appropriate District Office

State Lease - 4 Copies

Fee Lease - 3 Copies

OIL CONSERVATION DIVISION

P.O. Box 2088

Santa Fe, New Mexico 87504-2088

WELL LOCATION AND ACREAGE DEDICATION PLAT

☐ AMENDED REPORT

API Number 30-015-32244	Pool Code 28509	Pool Name Grayburg Jackson SR OG-S4
Property Code 022367	Property Name SCHLEY FEDERAL	Well Number 13
GRID No. 013837	Operator Name MACK ENERGY CORPORATION	Elevation 3610'

Surface Location

UL or lot No.	Section	Township	Range	Lot Idn	Feet from the	North/South line	Feet from the	East/West line	County
E	29	17-S	29-E		1525	NORTH	990	WEST	EDDY

Bottom Hole Location If Different From Surface

UL or lot No.	Section	Township	Range	Lot Idn	Feet from the	North/South line	Feet from the	East/West line	County
Dedicated Acres 40	Joint or Infill	Consolidation Code	Order No.						

NO ALLOWABLE WILL BE ASSIGNED TO THIS COMPLETION UNTIL ALL INTERESTS HAVE BEEN CONSOLIDATED
OR A NON-STANDARD UNIT HAS BEEN APPROVED BY THE DIVISION

	OPERATOR CERTIFICATION I hereby certify that the information contained herein is true and complete to the best of my knowledge and belief. <i>Jerry W. Sherrell</i> Signature Jerry W. Sherrell Printed Name Production Clerk Title 2/28/2002 Date
	SURVEYOR CERTIFICATION I hereby certify that the well location shown on this plat was plotted from field notes of actual surveys made by me or under my supervision, and that the same is true and correct to the best of my belief. FEBRUARY 19, 2002 Date Surveyed <i>Ronald J. Eidson</i> Signature & Seal of Professional Surveyor NEW MEXICO 02.11.0123 Certificate No. RONALD J. EIDSON 3239 CARY EIDSON 12641
	AWB 2/20/02

DISTRICT I
P.O. Box 1980, Hobbs, NM 88241-1980

DISTRICT II
P.O. Drawer DD, Artesia, NM 88211-0719

DISTRICT III
1000 Rio Brazos Rd., Aztec, NM 87410

DISTRICT IV
P.O. BOX 2088, SANTA FE, N.M. 87504-2088

State of New Mexico
Energy, Minerals and Natural Resources Department

OIL CONSERVATION DIVISION

P.O. Box 2088
Santa Fe, New Mexico 87504-2088

Form C-102
Revised February 10, 1994
Submit to Appropriate District Office
State Lease - 4 Copies
Fee Lease - 3 Copies

WELL LOCATION AND ACREAGE DEDICATION PLAT

☐ AMENDED REPORT

API Number 30-015-32368	Pool Code 96610	Pool Name East Empire Yeso
Property Code 022367	Property Name SCHLEY FEDERAL	Well Number 15
OGRID No. 013837	Operator Name MACK ENERGY CORPORATION	Elevation 3619'

Surface Location

UL or lot No. E	Section 29	Township 17-S	Range 29-E	Lot Idn	Feet from the 2185	North/South line NORTH	Feet from the 455	East/West line WEST	County EDDY
--------------------	---------------	------------------	---------------	---------	-----------------------	---------------------------	----------------------	------------------------	----------------

Bottom Hole Location If Different From Surface

UL or lot No.	Section	Township	Range	Lot Idn	Feet from the	North/South line	Feet from the	East/West line	County
Dedicated Acres 40	Joint or Infill	Consolidation Code	Order No.						

NO ALLOWABLE WILL BE ASSIGNED TO THIS COMPLETION UNTIL ALL INTERESTS HAVE BEEN CONSOLIDATED
OR A NON-STANDARD UNIT HAS BEEN APPROVED BY THE DIVISION

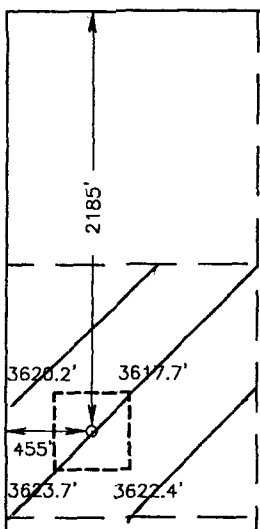
	<p>GEOGRAPHIC COORDINATES SPC NME NAD 1927 Y = 657280.5 X = 570584.6 LAT. = 32°48'24.27"N LONG. = 104°06'12.97"W</p>
<p>OPERATOR CERTIFICATION</p> <p>I hereby certify the the information contained herein is true and complete to the best of my knowledge and belief.</p> <p><i>Crissa D. Carter</i> Signature</p> <p>Crissa D. Carter Printed Name</p> <p>Production Analyst Title</p> <p>6/14/2002 Date</p>	
<p>SURVEYOR CERTIFICATION</p> <p>I hereby certify that the well location shown on this plat was plotted from field notes of actual surveys made by me or under my supervision, and that the same is true and correct to the best of my belief.</p> <p>JUNE 05, 2002</p> <p>Date Surveyed _____ AWB</p> <p>Signature & Seal of Professional Surveyor <i>Ronald J. Eidson</i> RONALD J. EIDSON 02.11.0405</p> <p>Certificate No. RONALD J. EIDSON 3239 GARY EIDSON 12641</p>	

DISTRICT I
P.O. Box 1980, Hobbs, NM 88241-1980

State of New Mexico

Energy, Minerals and Natural Resources Department

Form C-102
Revised February 10, 1994
Submit to Appropriate District Office
State Lease - 4 Copies
Fee Lease - 3 Copies

DISTRICT II
P.O. Drawer DD, Artesia, NM 88211-0719

OIL CONSERVATION DIVISION

P.O. Box 2088

Santa Fe, New Mexico 87504-2088

DISTRICT III
1000 Rio Brazos Rd., Aztec, NM 87410

DISTRICT IV
P.O. BOX 2088, SANTA FE, N.M. 87504-2088

WELL LOCATION AND ACREAGE DEDICATION PLAT

☐ AMENDED REPORT

API Number 30-015-32368	Pool Code 28509	Pool Name Grayburg Jackson SR QGSA
Property Code 022367	Property Name SCHLEY FEDERAL	Well Number 15
OGRID No. 013837	Operator Name MACK ENERGY CORPORATION	Elevation 3619'

Surface Location

UL or lot No.	Section	Township	Range	Lot Idn	Feet from the	North/South line	Feet from the	East/West line	County
E	29	17-S	29-E		2185	NORTH	455	WEST	EDDY

Bottom Hole Location If Different From Surface

UL or lot No.	Section	Township	Range	Lot Idn	Feet from the	North/South line	Feet from the	East/West line	County
Dedicated Acres 40	Joint or Infill	Consolidation Code	Order No.						

NO ALLOWABLE WILL BE ASSIGNED TO THIS COMPLETION UNTIL ALL INTERESTS HAVE BEEN CONSOLIDATED
OR A NON-STANDARD UNIT HAS BEEN APPROVED BY THE DIVISION

<p>GEOGRAPHIC COORDINATES SPC NME NAD 1927 Y = 657280.5 X = 570584.6 LAT. = 32°48'24.27"N LONG. = 104°06'12.97"W</p>	<p>OPERATOR CERTIFICATION</p> <p>I hereby certify the information contained herein is true and complete to the best of my knowledge and belief.</p> <p><u>Crissa D. Carter</u> Signature <u>Crissa D. Carter</u> Printed Name <u>Production Analyst</u> Title <u>6/14/2002</u> Date</p> <p>SURVEYOR CERTIFICATION</p> <p>I hereby certify that the well location shown on this plat was plotted from field notes of actual surveys made by me or under my supervision, and that the same is true and correct to the best of my belief.</p> <p><u>JUNE 05, 2002</u></p> <p>Date Surveyed _____ AWB Signature & Seal of Professional Surveyor <u>Ronald E. Eidson</u> 6/16/02 02.11.0405 Certification No. <u>RONALD E. EIDSON</u> 3239 <u>GARY EIDSON</u> 12841</p>
--	--