

DATE IN 8/15/97	SUSPENSE 9/4/97	ENGINEER DC	LOGGED BY KV	TYPE DHC
-----------------	-----------------	-------------	--------------	----------

ABOVE THIS LINE FOR DIVISION USE ONLY

NEW MEXICO OIL CONSERVATION DIVISION

- Engineering Bureau -

ADMINISTRATIVE APPLICATION COVERSHEET

THIS COVERSHEET IS MANDATORY FOR ALL ADMINISTRATIVE APPLICATIONS FOR EXCEPTIONS TO DIVISION RULES AND REGULATIONS

Application Acronyms:

[NSP-Non-Standard Proration Unit] [NSL-Non-Standard Location]
 [DD-Directional Drilling] [SD-Simultaneous Dedication]
 [DHC-Downhole Commingling] [CTB-Lease Commingling] [PLC-Pool/Lease Commingling]
 [PC-Pool Commingling] [OLS - Off-Lease Storage] [OLM-Off-Lease Measurement]
 [WFX-Waterflood Expansion] [PMX-Pressure Maintenance Expansion]
 [SWD-Salt Water Disposal] [IPI-Injection Pressure Increase]
 [EOR-Qualified Enhanced Oil Recovery Certification] [PPR-Positive Production Response]

[1] TYPE OF APPLICATION - Check Those Which Apply for [A]

[A] Location - Spacing Unit - Directional Drilling

☐ NSL ☐ NSP ☐ DD ☐ SD

AUG 15 1997

Check One Only for [B] and [C]

[B] Commingling - Storage - Measurement

☒ DHC ☐ CTB ☐ PLC ☐ PC ☐ OLS ☐ OLM

[C] Injection - Disposal - Pressure Increase - Enhanced Oil Recovery

☐ WFX ☐ PMX ☐ SWD ☐ IPI ☐ EOR ☐ PPR

[2] NOTIFICATION REQUIRED TO: - Check Those Which Apply, or ☐ Does Not Apply

[A] ☐ Working, Royalty or Overriding Royalty Interest Owners

[B] ☒ Offset Operators, Leaseholders or Surface Owner

[C] ☐ Application is One Which Requires Published Legal Notice

[D] ☒ Notification and/or Concurrent Approval by BLM or SLO

U.S. Bureau of Land Management - Commissioner of Public Lands, State Land Office

[E] ☐ For all of the above, Proof of Notification or Publication is Attached, and/or,

[F] ☐ Waivers are Attached

[3] INFORMATION / DATA SUBMITTED IS COMPLETE - Statement of Understanding

I hereby certify that I, or personnel under my supervision, have read and complied with all applicable Rules and Regulations of the Oil Conservation Division. Further, I assert that the attached application for administrative approval is accurate and complete to the best of my knowledge and where applicable, verify that all interest (WI, RI, ORRI) is common. I understand that any omission of data, information or notification is cause to have the application package returned with no action taken.

Note: Statement must be completed by an individual with supervisory capacity.

Ann E. Ritchie

Print or Type Name

Signature

Regulatory Agent

Title

Date

8-12-97

DISTRICT I
P.O. Box 1980, Hobbs, NM 88241 1980

DISTRICT II
811 South First St. Artesia NM 88210 2835

DISTRICT III
1000 Rio Brazos Rd. Aztec, NM 87410 1693

State of New Mexico
Energy, Minerals and Natural Resources Department

OIL CONSERVATION DIVISION

2040 S. Pacheco
Santa Fe, New Mexico 87505-6429

Form C-107-A
New 3-12-96

APPROVAL PROCESS:

☒ Administrative ☐ Hearing

EXISTING WELLBORE

☒ YES ☐ NO

APPLICATION FOR DOWNHOLE COMMINGLING

Conoco Inc.

10 Desta Dr. Ste 100W, Midland, Tx. 79705-4500

Operator

Address

JICARILLA

A#10

L-30-T26N-R4W

RIO ARRIBA

Lease

Well No

Unit Ltr Sec Twp Rge

County

Spacing Unit Lease Types: (check 1 or more)

OGRID NO. 005073 Property Code 18018 API NO. 30039-20117 Federal ☒ State ☐ (and/or) Fee ☐

The following facts are submitted in support of downhole commingling:	Upper Zone	Intermediate Zone	Lower Zone
1. Pool Name and Pool Code	PICTURED CLIFF 85920	MESA VERDE 72319	BASIN DAKOTA 71599
2. TOP and Bottom of Pay Section (Perforations)	3556' - 3584'	5621' - 5823'	7772' - 7986'
3. Type of production (Oil or Gas)	GAS	GAS	GAS
4. Method of Production (Flowing or Artificial Lift)	FLOWING	FLOWING	FLOWING
5. Bottomhole Pressure	a. (Current)	a.	a.
Oil Zones - Artificial Lift: Estimated Current	334 PSIA	590 PSIA	726 PSIA
Gas & Oil - Flowing: Measured Current	b.(Original)	b.	b.
All Gas Zones: Estimated Or Measured Original	1173 PSIA	1369 PSIA	2650 PSIA
6. Oil Gravity (*API) or Gas BT Content	1250	1294	1322
7. Producing or Shut-In?	PRODUCING	PRODUCING	SHUT IN
Production Marginal? (yes or no)	YES	YES	YES
• If Shut-In give date and oil/gas/ water rates of last production	Date Rates	Date Rates	Date Rates
Note For new zones with no production history applicant shall be required to attach production estimates and supporting data			
• If Producing, date and oil/gas/ water rates of recent test (within 60 days)	Date Rates	Date Rates	Date Rates
	EST. 10/97 109 MCFD 0 BOPD/0 BWPD	EST. 10/97 15 MCFD 0 BOPD/0 BWPD	EST. 10/97 37 MCFD 1 BOPD/0 BWPD
8. Fixed Percentage Allocation Formula - % for each zone	oil 0 % Gas 68 %	oil 1 % Gas 9 %	oil 99 % Gas 23 %

9. If allocation formula is based upon something other than current or past production, or is based upon some other method, submit attachments with supporting data and/or explaining method and providing rate projections or other required data.

10. Are all working, overriding, and royalty interests identical in all commingled zones? ☒ Yes ☐ No
If not, have all working, overriding, and royalty interests been notified by certified mail? ☐ Yes ☐ No
Have all offset operators been given written notice of the proposed downhole commingling? ☐ Yes ☐ No

11. Will cross-flow occur? ☒ Yes ☐ No If yes, are fluids compatible, will the formations not be damaged, will any cross-flowed production be recovered, and will the allocation formula be reliable. ☒ Yes ☐ No (If No, attach explanation)

12. Are all produced fluids from all commingled zones compatible with each others ☒ Yes ☐ No

13. Will the value of production be decreased by commingling? ☐ Yes ☒ No (If Yes, attach explanation)

14. If this well is on, or communitized with, state or federal lands, either the Commissioner of Public Lands or the United States Bureau of Land Management has been notified in writing of this application. ☐ Yes ☐ No

15. NMOCD Reference Cases for Rule 303(D) Exceptions: ORDER NO(S):

16. ATTACHMENTS

- * C-102 for each zone to be commingled showing its spacing unit and acreage dedication.
- * Production curve for each zone for at least one year. (If not available, attach explanation.)
- * For zones with no production history, estimated production rates and supporting data.
- * Data to support allocation method or formula.
- * Notification list of all offset operators.
- * Notification list of working, overriding and royalty interests for uncommon interest cases.
- * Any additional statements, data, or documents required to support commingling.

I hereby certify that the information above is true and complete to the best of my knowledge and belief.

SIGNATURE *Jerry W. Hoover* TITLE Sr. Conservation Coord DATE 8-11-97

TYPE OR PRINT NAME Jerry W. Hoover TELEPHONE NO. (915) 686-6548

NEW MEXICO OIL CONSERVATION COMMISSION WELL LOCATION AND AGERAGE DEDICATION PLAT

All distances must be from the outer boundaries of the Section

Operator SOUTHERN UNION PRODUCTION COMPANY			Lease JICARTILLA "A"		Well No 10
Unit Letter 0	Section 23	Township 26 NORTH	Range 4 WEST	County RIO ARriba	
Actual Footage Location of Well: 1080 feet from the SOUTH line and 1750 feet from the EAST line					
Ground Level Elev. 6933.0	Producing Formation Dakota Pictured Cliffs	Pool Basin Dakota Topocito Pictured Cliffs	Dedicated Avereage: E/2 320 SE/4 160 Acres		

1. Outline the acreage dedicated to the subject well by colored pencil or hatchure marks on the plat below.
2. If more than one lease is dedicated to the well, outline each and identify the ownership thereof (both as to working interest and royalty).
3. If more than one lease of different ownership is dedicated to the well, have the interests of all owners been consolidated by communization, unitization, force-pooling, etc?

() Yes () No If answer is "yes," type of consolidation _____

If answer is "no," list the owners and tract descriptions which have actually consolidated. (Use reverse side of this Form if necessary.) _____

No allowable will be assigned to the well until all interests have been consolidated (by communization, unitization, forced-pooling, or otherwise) or until a non standard unit, eliminating such interests, has been approved by the Commission.

Dedicated Dakota Acreage

Dedicated Pictured Cliffs Acreage

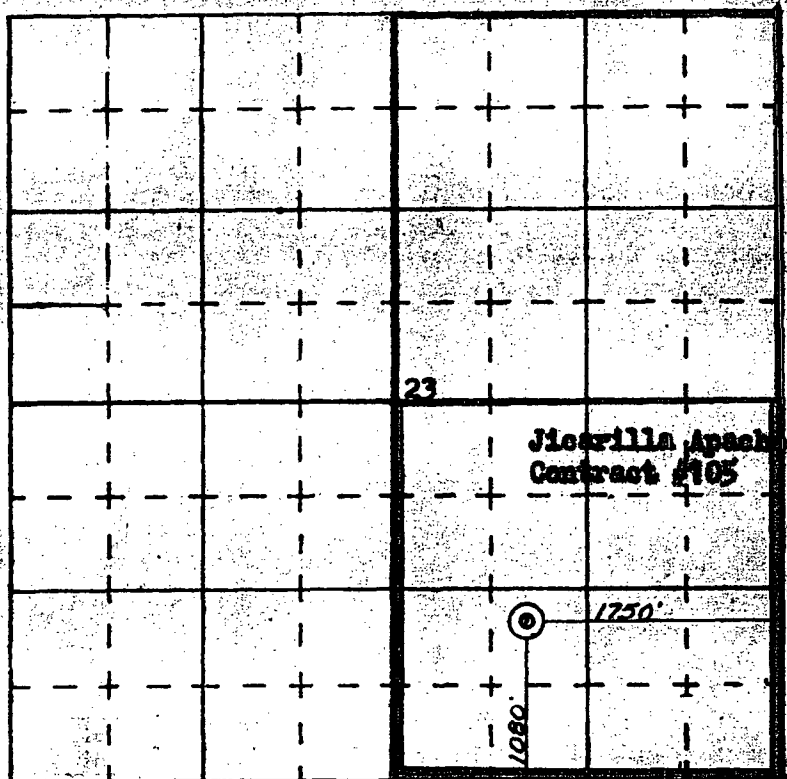

SCALE—4 INCHES EQUALS 1 MILE

CERTIFICATION

I hereby certify that the information contained herein is true and complete to the best of my knowledge and belief.

ORIGINAL SIGNED BY

B. R. VANDERSLICE

Name

B. R. Vanderslice

Position

Area Superintendent

Company

Southern Union Production Co.

Date

July 3, 1968

I hereby certify that the well location shown on this plat was plotted from field notes of actual surveys made by me or under my supervision, and that the same is true and correct to the best of my knowledge and belief.

8 May 1967

Date Surveyed

Registered Professional Engineer
and/or Land Surveyor

Certificate No.

SAN JUAN ENGINEERING COMPANY,

FARMINGTON, N. M.

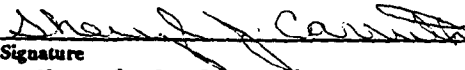
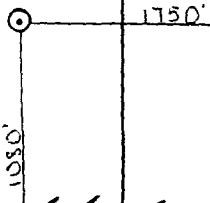

16			17 OPERATOR CERTIFICATION <i>I hereby certify that the information contained herein is true and complete to the best of my knowledge and belief</i>
			 Signature Sheryl J. Carruth Printed Name Regulatory Manager Title 11-9-94 Date
			18 SURVEYOR CERTIFICATION <i>I hereby certify that the well location shown on this plat was plotted from field notes of actual surveys made by me or under my supervision, and that the same is true and correct to the best of my belief.</i>
		 <p>1050'</p> <p>1750'</p>	Date of Survey Signature and Seal of Professional Surveyer: Certificate Number

**JICARILLA A 10 PICTURED CLIFFS PRODUCTION
SECTION 230-26N-04W**

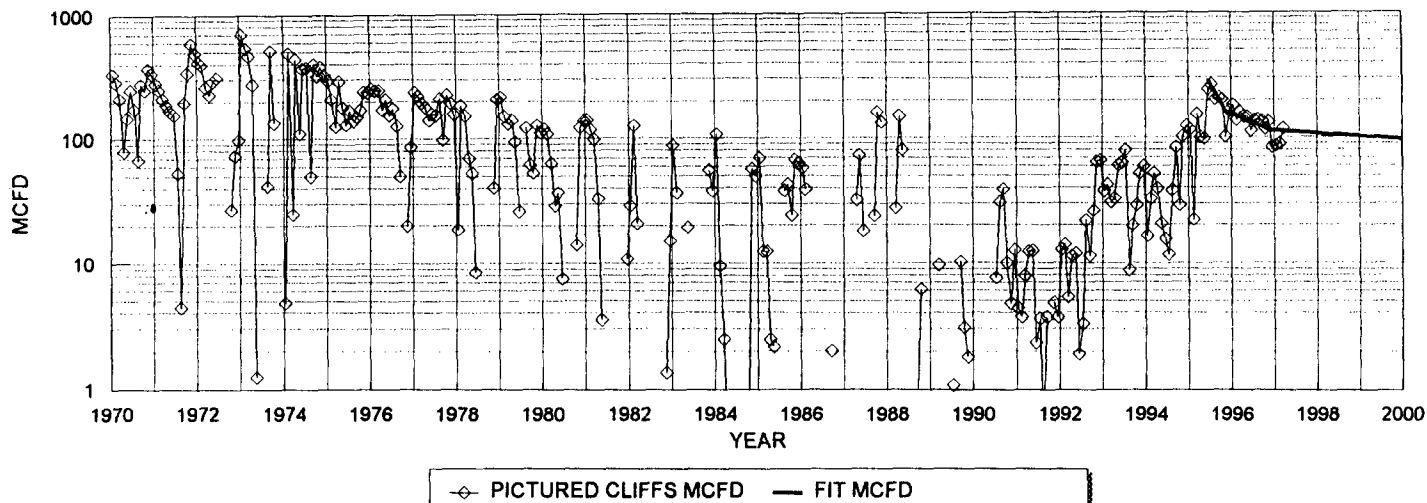

HISTORICAL DATA:

1ST PROD: 11/68

OIL CUM: 0.00 MBO
GAS CUM: 1070.0 MMCF
OIL YIELD: 0.0000 BBL/MCF

PICTURED CLIFFS PROJECTED DATA

10/1/97 Q1: 109 MCDF
DECLINE RATE: 5.0% (EXPONENTIAL 12/96 FORWARD)

**JICARILLA A 10 MESAVERDE PRODUCTION
SECTION 230-26N-04W**

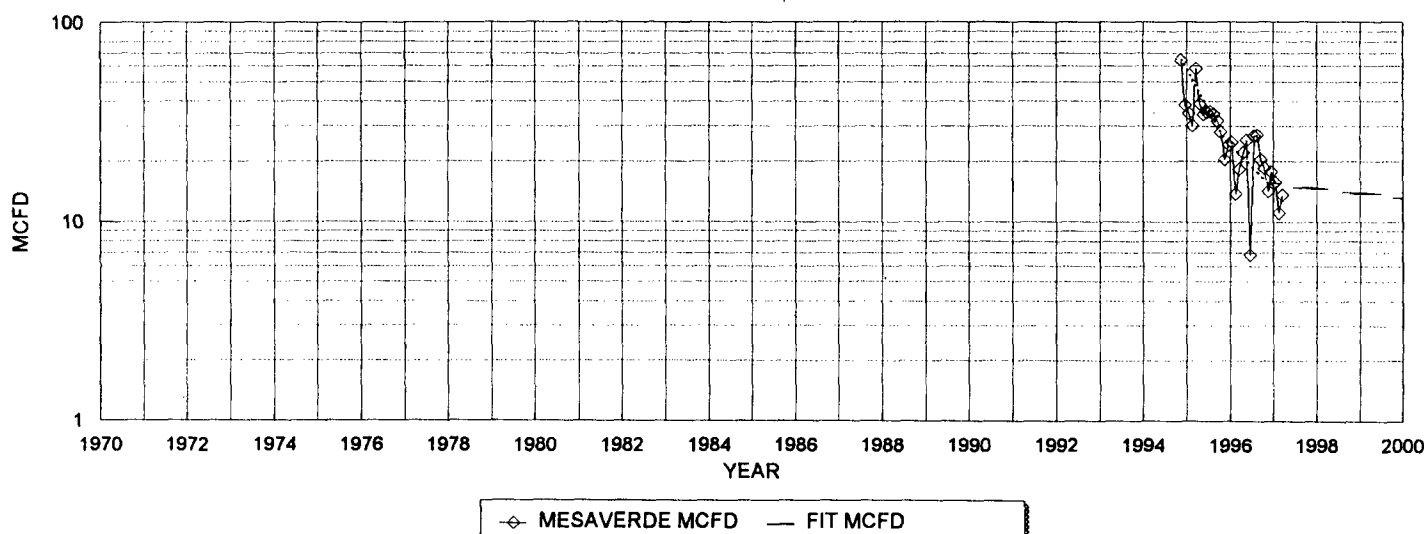

HISTORICAL DATA

1ST PROD: 11/94

OIL CUM: 0.0 MBO
GAS CUM: 23.9 MMCF
OIL YIELD: 0.0009 BBL/MCF

MESAVERDE PROJECTED DATA

10/1/97 Q1: 15 MCDF
DECLINE RATE: 5.0% (EXPONENTIAL)

**JICARILLA A 10 DAKOTA PRODUCTION
SECTION 230-26N 04W**

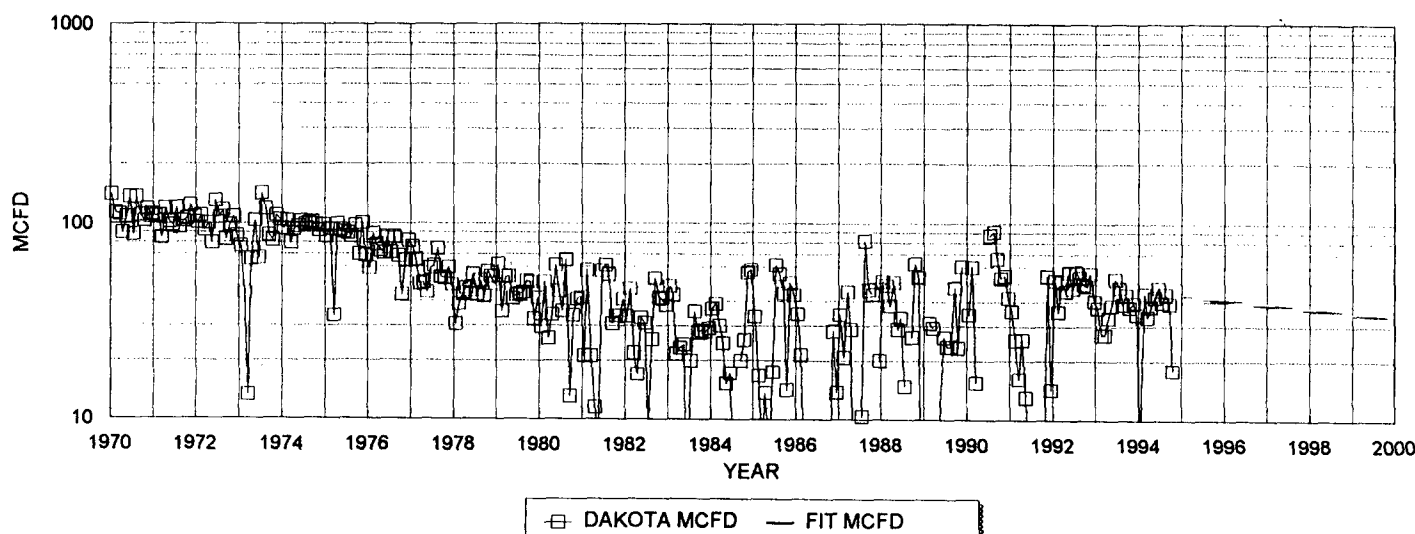

HISTORICAL DATA

1ST PROD: 11/68

OIL CUM: 17.2 MBO
GAS CUM: 526.5 MMCF
OIL YIELD: 0.0326 BBL/MCF

DAKOTA PROJECTED DATA

10/1/97 Q1: 37 MCDF
DECLINE RATE: 5.0% (EXPONENTIAL)

FIXED COMMINGLE ALLOCATION FACTORS:

	GAS	OIL
PICTURED CLIFFS	68%	0%
MESAVERDE	9%	1%
DAKOTA:	23%	99%

OIL ALLOCATION BASED ON WEIGHTED CUM OIL YIELDS

Conoco, Inc.
Jicarilla, Well #A10
Rio Arriba, New Mexico
Attachment to Form C-107-A

Offset Operators-other than Conoco:

Burlington O & G Resources Co.
P.O. Box 4289
Farmington, NM 87499

Copies of C-107-A and attachments sent to above 8-12-97.
