

DATE IN 10/7/97	SUSPENSE 10/27/97	ENGINEER DC	LOGGED KW	TYPE DHC
--------------------	----------------------	----------------	--------------	-------------

ABOVE THIS LINE FOR DIVISION USE ONLY

NEW MEXICO OIL CONSERVATION DIVISION
- Engineering Bureau -

1710

ADMINISTRATIVE APPLICATION COVERSHEET

THIS COVERSHEET IS MANDATORY FOR ALL ADMINISTRATIVE APPLICATIONS FOR EXCEPTIONS TO DIVISION RULES AND REGULATIONS

Application Acronyms:

[NSP-Non-Standard Proration Unit] [NSL-Non-Standard Location]
[DD-Directional Drilling] [SD-Simultaneous Dedication]
[DHC-Downhole Commingling] [CTB-Lease Commingling] [PLC-Pool/Lease Commingling]
[PC-Pool Commingling] [OLS - Off-Lease Storage] [OLM-Off-Lease Measurement]
[WFX-Waterflood Expansion] [PMX-Pressure Maintenance Expansion]
[SWD-Salt Water Disposal] [IPI-Injection Pressure Increase]
[EOR-Qualified Enhanced Oil Recovery Certification] [PPR-Positive Production Response]

[1] **TYPE OF APPLICATION** - Check Those Which Apply for [A]

[A] Location - Spacing Unit - Directional Drilling
☐ NSL ☐ NSP ☐ DD ☐ SD

Check One Only for [B] and [C]

[B] Commingling - Storage - Measurement
☒ DHC ☐ CTB ☐ PLC ☐ PC ☐ OLS ☐ OLM

[C] Injection - Disposal - Pressure Increase - Enhanced Oil Recovery
☐ WFX ☐ PMX ☐ SWD ☐ IPI ☐ EOR ☐ PPR

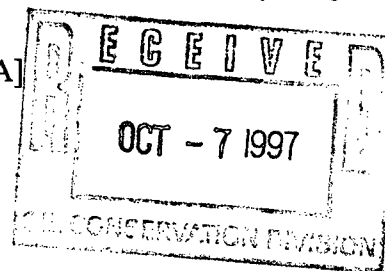

[2] **NOTIFICATION REQUIRED TO:** - Check Those Which Apply, or ☐ Does Not Apply

- [A] ☐ Working, Royalty or Overriding Royalty Interest Owners
- [B] ☐ Offset Operators, Leaseholders or Surface Owner
- [C] ☐ Application is One Which Requires Published Legal Notice
- [D] ☒ Notification and/or Concurrent Approval by BLM or SLO
U.S. Bureau of Land Management - Commissioner of Public Lands, State Land Office
- [E] ☐ For all of the above, Proof of Notification or Publication is Attached, and/or,
- [F] ☐ Waivers are Attached

[3] **INFORMATION / DATA SUBMITTED IS COMPLETE** - Statement of Understanding

I hereby certify that I, or personnel under my supervision, have read and complied with all applicable Rules and Regulations of the Oil Conservation Division. Further, I assert that the attached application for administrative approval is accurate and complete to the best of my knowledge and where applicable, verify that all interest (WI, RI, ORRI) is common. I understand that any omission of data, information or notification is cause to have the application package returned with no action taken.

Note: Statement must be completed by an individual with supervisory capacity.

Peggy Bradfield
Print or Type Name

Signature

Regulatory/Compliance Administrator
Title

10-3-97
Date

BURLINGTON RESOURCES

SAN JUAN DIVISION

October 3, 1997

Mr. William LeMay
New Mexico Oil Conservation Division
2040 South Pacheco Street
Santa Fe, New Mexico 87505

Re: San Juan 28-6 Unit #142M
1830'FNL, 2525'FWL Section 21, T-28-N, R-06-W, Rio Arriba County, NM
API #30-039-not yet assigned

Dear Mr. LeMay:

This is a request for administrative approval for downhole commingling the Blanco Mesa Verde and Basin Dakota pools in the subject well. This is a new drill Mesa Verde/Dakota well for the 1998 Program.

To comply with the New Mexico Oil Conservation Division rules, Burlington Resources Oil & Gas Company is submitting the following for your approval of this commingling:

1. Form C107A - Application for Downhole Commingling;
2. C-102 plat for each zone showing its spacing unit and acreage dedication;
3. Anticipated production curve for the Mesa Verde and Dakota for at least year;
4. Notification list of offset operators - Burlington is the operator of the unit;
5. Shut in wellhead pressure and calculated down hole pressure of surrounding wells;
6. Nine-section plats for the Mesa Verde and Dakota.

Notification of Mesa Verde and Dakota interest owners is covered under Order R-10696 dated November 12, 1996.

We will consult with the Supervisor of the Aztec District Office of the New Mexico Oil Conservation Division to establish an allocation formula.

Please let me know if you require additional data.

Sincerely,



Peggy Bradfield
Regulatory/Compliance Administrator

Xc: Bureau of Land Management - Farmington
NMOCD - Aztec

DISTRICT I
P.O. Box 1980, Hobbs, NM 88241-1980
DISTRICT II
811 South First St., Artesia, NM 88210-2835
DISTRICT III
1000 Rio Brazos Rd, Aztec, NM 87410-1693

State of New Mexico
Energy, Minerals and Natural Resources Department
OIL CONSERVATION DIVISION
2040 S. Pacheco
Santa Fe, New Mexico 87505-6429

Form C-107-A
New 3-12-96
APPROVAL PROCESS :
X Administrative ___Hearing
EXISTING WELLBORE
___ YES _X_ NO

APPLICATION FOR DOWNHOLE COMMINGLING

Burlington Resources Oil & Gas Company PO Box 4289, Farmington, NM 87499

Operator Address
SAN JUAN 28-6 UNIT 142M D 21-28N-6W Rio Arriba
Lease Well No. Unit Ltr. - Sec - Twp - Rge County
Spacing Unit Lease Types: (check 1 or more)
OGRID NO. 14538 Property Code 7462 API NO. 30-039-not assigned Federal _X_ State (and/or) Fee

The following facts are submitted in support of downhole commingling:	Upper Zone	Intermediate Zone	Lower Zone
1. Pool Name and Pool Code	Blanco Mesaverde - 72319		Basin Dakota - 71599
2. Top and Bottom of Pay Section (Perforations)	will be supplied upon completion		will be supplied upon completion
3. Type of production (Oil or Gas)	gas		gas
4. Method of Production (Flowing or Artificial Lift)	flowing		flowing
5. Bottomhole Pressure Oil Zones - Artificial Lift: Estimated Current Gas & Oil - Flowing: Measured Current All Gas Zones: Estimated or Measured Original	(Current) a. 514 psi (see attachment) (Original) b. 1288 psi (see attachment)	a. b.	a. 1019 psi (see attachment) b. 3196 psi (see attachment)
6. Oil Gravity (°API) or Gas BTU Content	BTU 1101		BTU 1037
7. Producing or Shut-In?	shut-in		shut-in
Production Marginal? (yes or no)	no		yes
* If Shut-In and oil/gas/water rates of last production Note: For new zones with no production history, applicant shall be required to attach production estimates and supporting data	Date: n/a Rates:	Date: Rates:	Date: n/a Rates:
* If Producing, give data and oil/gas/water water of recent test (within 60 days)	Date: n/a Rates:	Date: Rates:	Date: n/a Rates:
8. Fixed Percentage Allocation Formula -% for each zone (total of %'s to equal 100%)	Oil: % Gas: % will be supplied upon completion	Oil: % Gas: %	Oil: % Gas: % will be supplied upon completion

9. If allocation formula is based upon something other than current or past production, or is based upon some other method, submit attachments with supporting data and/or explaining method and providing rate projections or other required data.
10. Are all working, overriding, and royalty interests identical in all commingled zones? ___Yes ___X_ No
If not, have all working, overriding, and royalty interests been notified by certified mail? ___Yes ___X_ No
Have all offset operators been given written notice of the proposed downhole commingling? ___X_Yes ___No
11. Will cross-flow occur? ___X_ Yes ___ No If yes, are fluids compatible, will the formations not be damaged, will any cross-flowed production be recovered, and will the allocation formula be reliable. ___X_ Yes ___No (If No, attach explanation)
12. Are all produced fluids from all commingled zones compatible with each other? ___X_ Yes ___ No
13. Will the value of production be decreased by commingling? ___ Yes _X_ No (If Yes, attach explanation)
14. If this well is on, or communitized with, state or federal lands, either the Commissioner of Public Lands or the United States Bureau of Land Management has been notified in writing of this application. _X_Yes ___ No
15. NMOCD Reference Cases for Rule 303(D) Exceptions: ORDER NO(S). R-10696
16. ATTACHMENTS:
* C-102 for each zone to be commingled showing its spacing unit and acreage dedication.
* Production curve for each zone for at least one year. (If not available, attach explanation.)
* For zones with no production history, estimated production rates and supporting data.
* Data to support allocation method or formula.
* Notification list of all offset operators.
* Notification list of working, overriding, and royalty interests for uncommon interest cases.
* Any additional statements, data, or documents required to support commingling.

I hereby certify that the information above is true and complete to the best of my knowledge and belief.

SIGNATURE Sean Woolverton TITLE Production Engineer DATE 10/02/97

TYPE OR PRINT NAME Sean C. Woolverton TELEPHONE NO. (505) 326-9700

District I
PO Box 1980, Hobbs, NM 88241-1980

District II
PO Drawer 00, Artesia, NM 88211-0719

District III
1000 Rio Brazos Rd., Aztec, NM 87410

District IV
PO Box 2088, Santa Fe, NM 87504-2088

State of New Mexico
Energy, Minerals & Natural Resources Department

OIL CONSERVATION DIVISION
PO Box 2088
Santa Fe, NM 87504-2088

Form C-1
Revised February 21, 19
Instructions on be
Submit to Appropriate District Offi
State Lease - 4 Copi
Fee Lease - 3 Copi

☐ AMENDED REPORT

WELL LOCATION AND ACREAGE DEDICATION PLAT

1 API Number		2 Pool Code		3 Pool Name	
4 Property Code		5 Property Name SAN JUAN 28-6 UNIT			6 Well Number 142M
7 OGRID No.		8 Operator Name BURLINGTON RESOURCES OIL & GAS COMPANY			9 Elevation 6461'

10 Surface Location

UL or lot no.	Section	Township	Range	Lot Idn	Feet from the	North/South line	Feet from the	East/West line	County
F	21	28	6		1830	North	2525	WEST	RIO ARriba

11 Bottom Hole Location If Different From Surface

UL or lot no.	Section	Township	Range	Lot Idn	Feet from the	North/South line	Feet from the	East/West line	County

12 Dedicated Acres	13 Joint or Infill	14 Consolidation Code	15 Order No.

NO ALLOWABLE WILL BE ASSIGNED TO THIS COMPLETION UNTIL ALL INTERESTS HAVE BEEN CONSOLIDATED
OR A NON-STANDARD UNIT HAS BEEN APPROVED BY THE DIVISION

<p>16</p> <p>NMSF-079193</p> <p>5278.68'</p> <p>1830'</p> <p>2525'</p> <p>21</p> <p>5274.72'</p>		<p>17 OPERATOR CERTIFICATION</p> <p>I hereby certify that the information contained herein is true and complete to the best of my knowledge and belief.</p> <p>Signature _____</p> <p>Printed Name _____</p> <p>Title _____</p> <p>Date _____</p> <p>18 SURVEYOR CERTIFICATION</p> <p>I hereby certify that the well location shown on this plat was plotted from field notes of actual surveys made by me or under my supervision, and that the same is true and correct to the best of my belief.</p> <p>NEALE C. EDWARDS NEW MEXICO 6857 REGISTERED PROFESSIONAL SURVEYOR</p> <p>Date of Survey JUL 9, 1999</p> <p>Signature _____</p> <p>Certificate Number 6857</p>
--	--	--

Expected Production Curve

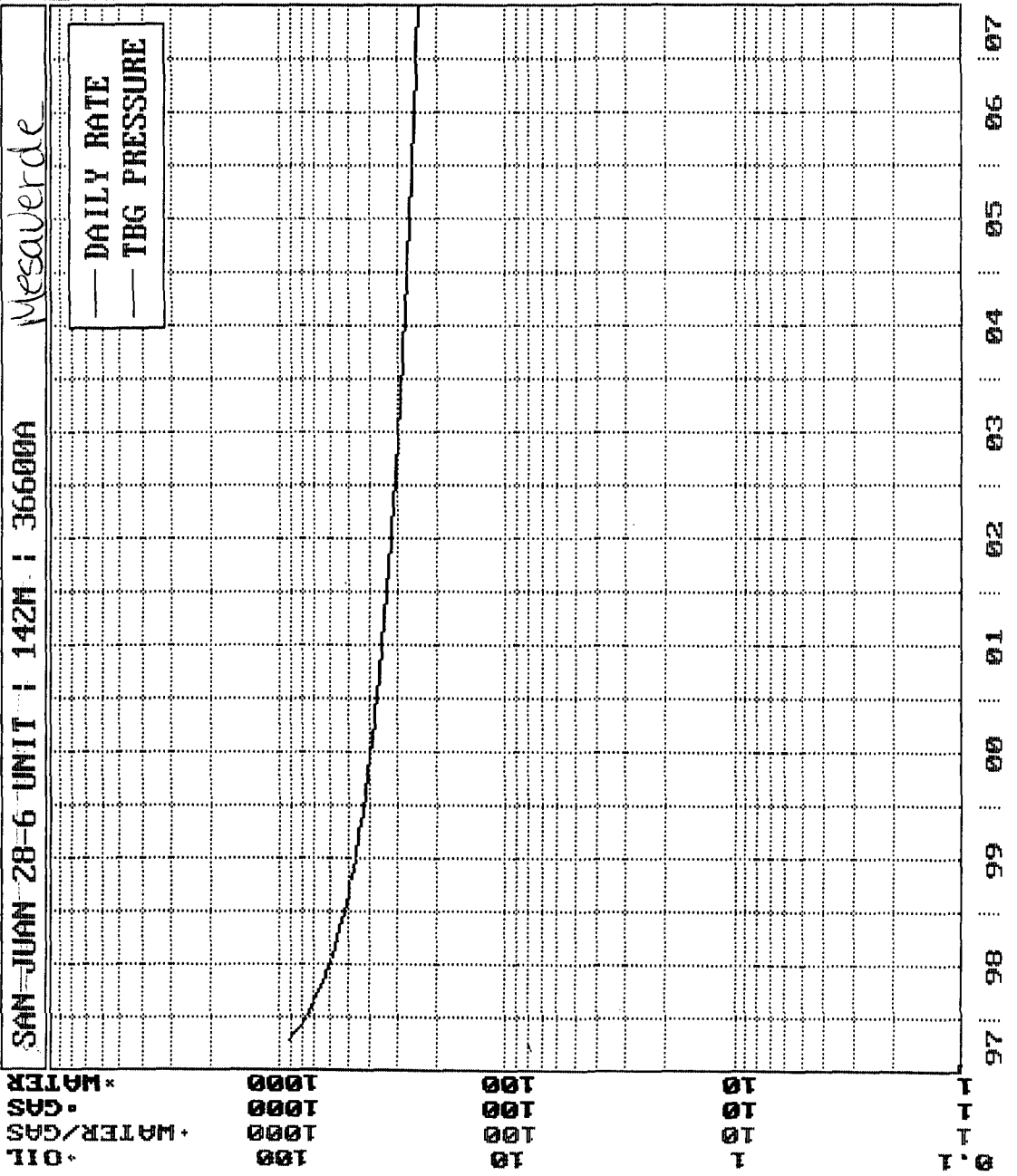

EXPECTED PRODUCTION CURVE

SAN JUAN 28-6 UNIT : 142M : 36600A

Dakota

• OIL
• WATER/GAS
• GAS
• WATER

— DAILY RATE
— TBG PRESSURE

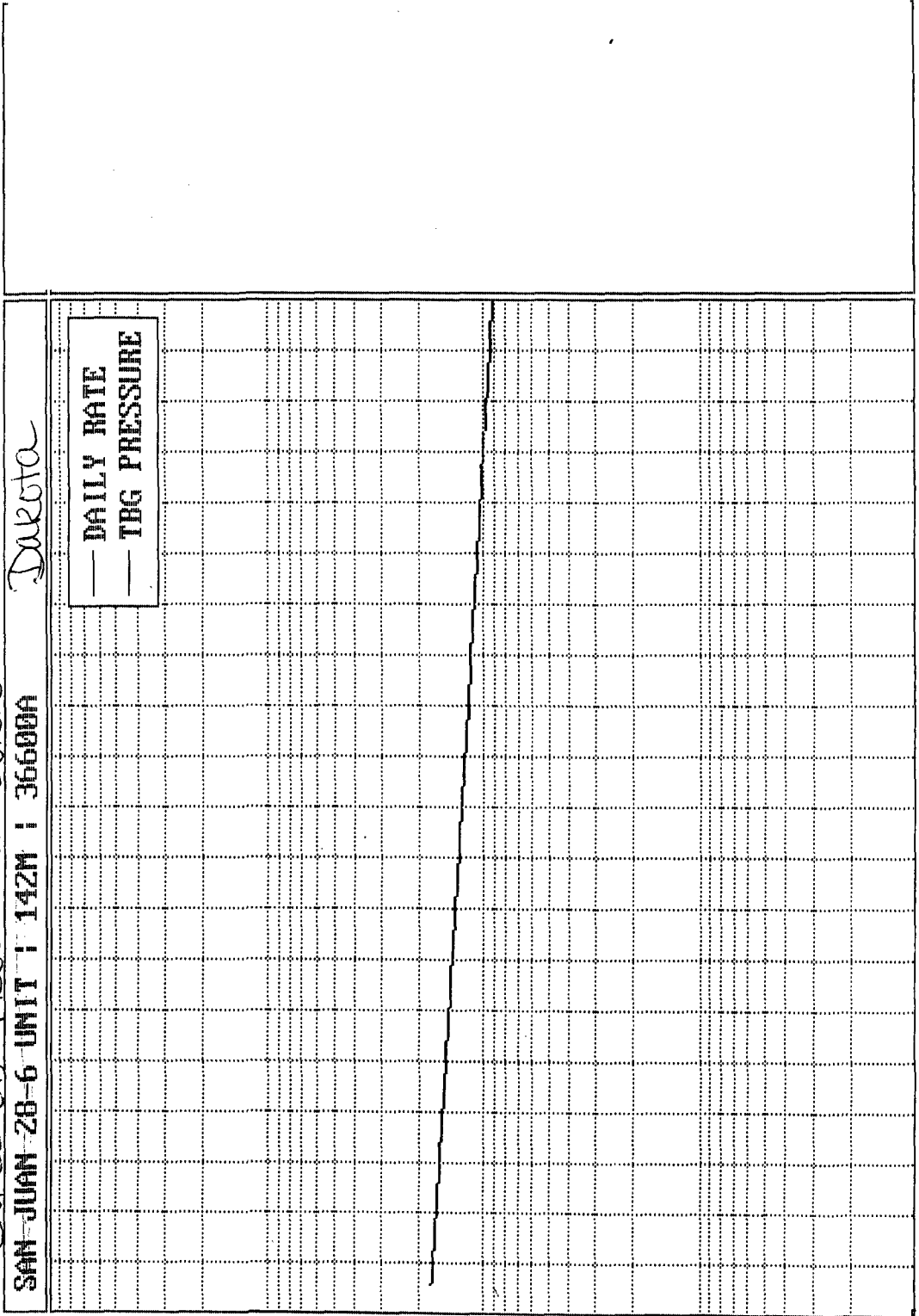

Major = GAS

BURLINGTON RESOURCES OIL AND GAS COMPANY

**San Juan 28-6 Unit #142M
OFFSET OPERATOR \ OWNER PLAT**

Mesaverde / Dakota Formations Commingle Well

Township 28 North, Range 6 West

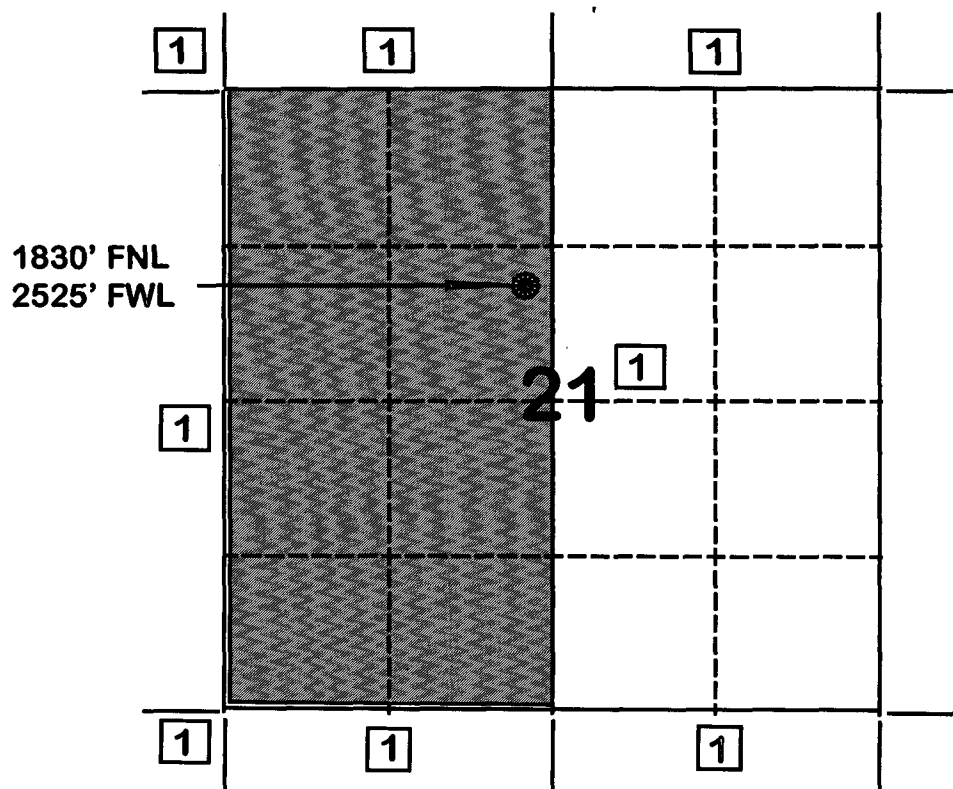

1) Burlington Resources Oil and Gas Company

SJ 28-6 Unit #142M

Bottom Hole Pressures
Flowing and Static BHP
Cullender and Smith Method
Version 1.0 3/13/94

Mesaverde	Dakota
<u>MV-Current</u>	<u>DK-Current</u>
GAS GRAVITY 0.632	GAS GRAVITY 0.604
COND. OR MISC. (C/M) C	COND. OR MISC. (C/M) C
%N2 0.11	%N2 0.13
%CO2 0.51	%CO2 1.34
%H2S 0	%H2S 0
DIAMETER (IN) 2	DIAMETER (IN) 2.375
DEPTH (FT) 5664	DEPTH (FT) 7626
SURFACE TEMPERATURE (DEG F) 60	SURFACE TEMPERATURE (DEG F) 60
BOTTOMHOLE TEMPERATURE (DEG F) 137	BOTTOMHOLE TEMPERATURE (DEG F) 198
FLOWRATE (MCFPD) 0	FLOWRATE (MCFPD) 0
SURFACE PRESSURE (PSIA) 452	SURFACE PRESSURE (PSIA) 866
BOTTOMHOLE PRESSURE (PSIA) 514.3	BOTTOMHOLE PRESSURE (PSIA) 1019.3
<u>MV-Original</u>	<u>DK-Original</u>
GAS GRAVITY 0.632	GAS GRAVITY 0.604
COND. OR MISC. (C/M) C	COND. OR MISC. (C/M) C
%N2 0.11	%N2 0.13
%CO2 0.51	%CO2 1.34
%H2S 0	%H2S 0
DIAMETER (IN) 2	DIAMETER (IN) 2.375
DEPTH (FT) 5664	DEPTH (FT) 7626
SURFACE TEMPERATURE (DEG F) 60	SURFACE TEMPERATURE (DEG F) 60
BOTTOMHOLE TEMPERATURE (DEG F) 137	BOTTOMHOLE TEMPERATURE (DEG F) 198
FLOWRATE (MCFPD) 0	FLOWRATE (MCFPD) 0
SURFACE PRESSURE (PSIA) 1117	SURFACE PRESSURE (PSIA) 2687
BOTTOMHOLE PRESSURE (PSIA) 1287.8	BOTTOMHOLE PRESSURE (PSIA) 3196.1

Page No.: 1
 Print Time: Mon Aug 18 13:01:53 1997
 Property ID: 4050
 Property Name: SAN JUAN 28-6 UNIT | 60 | 51875A-1
 Table Name: K:\ARIES\RR98PDP\TEST.DBF

San Juan 28-6 Unit

142 M

Mesaverde Offset

--DATE--	---CUM GAS--	M SIWHP
-----	-----Mcf-----	-----Psi-----

04/13/56	0	1117.0 - original
12/30/57	239000	897.0
10/29/58	437000	656.0
06/14/59	562000	683.0
06/14/60	722000	694.0
06/13/61	902000	665.0
09/10/62	1054000	705.0
05/16/63	1125000	705.0
05/26/64	1270000	675.0
03/08/65	1342000	692.0
04/12/66	1476000	656.0
11/01/67	1662000	595.0
04/01/68	1708000	615.0
06/23/69	1858000	548.0
05/25/70	1956615	555.0
05/04/71	2061478	498.0
05/22/72	2176352	499.0
08/21/73	2305983	487.0
07/31/74	2393908	489.0
01/01/76	2527805	441.0
11/01/76	2615554	441.0
05/15/78	2783574	444.0
12/04/79	2948073	404.0
04/18/80	2980089	404.0
05/18/82	3070584	432.0
06/22/84	3161528	443.0
10/17/86	3241095	434.0
11/26/89	3313005	556.0
08/25/91	3331150	550.0
09/10/91	3332540	562.0
05/03/93	3398816	452.0 - current

Page No.: 3

Print Time: Mon Aug 18 13:01:54 1997

Property ID: 1842

Property Name: SAN JUAN 28-6 UNIT | 126 | 52204A-1

Table Name: K:\ARIES\RR98PDP\TEST.DBF

San Juan 28-6 Unit

142 M

Dakota Offset

--DATE-- ---CUM GAS-- M SIWHP
-----Mcf-----Psi-----

08/26/67	0	2687.0	-original
09/07/67	0	2686.0	
12/08/67	22000	1830.0	
07/12/68	96000	1317.0	
09/09/69	174000	1104.0	
08/19/70	230018	1059.0	
03/23/71	260311	1030.0	
08/08/72	332132	762.0	
09/04/75	467553	632.0	
08/01/77	525349	812.0	
05/08/79	572109	772.0	
04/15/83	680632	777.0	
05/23/85	740853	895.0	
07/08/88	814628	1052.0	
06/05/90	878588	882.0	
07/01/92	934728	866.0	-current

San Juan 28-6 Unit #142M
Mesaverde / Dakota
21-28N-06W

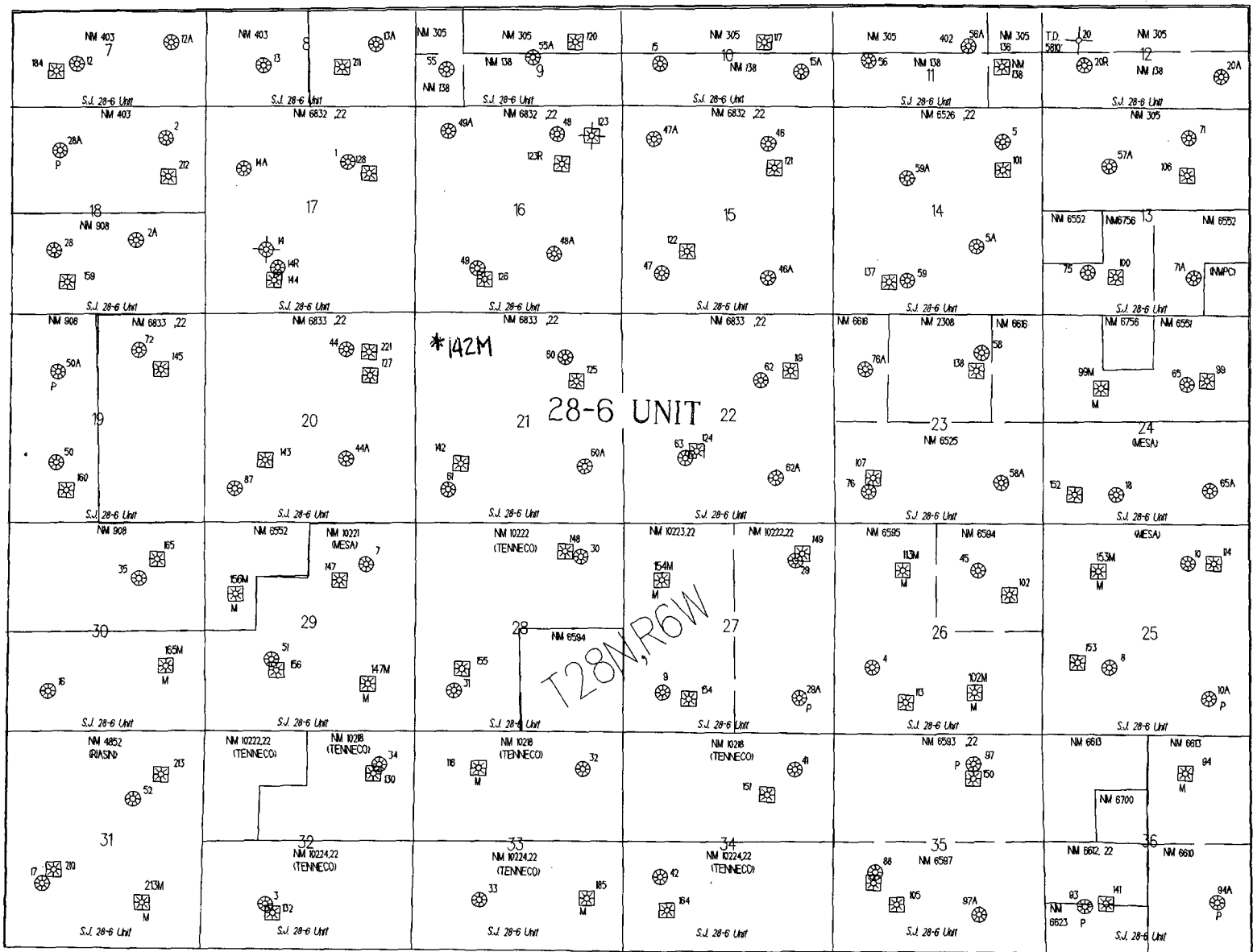

**STATE OF NEW MEXICO
ENERGY, MINERALS AND NATURAL RESOURCES DEPARTMENT
OIL CONSERVATION DIVISION**

**IN THE MATTER OF THE HEARING
CALLED BY THE OIL CONSERVATION
DIVISION FOR THE PURPOSE OF
CONSIDERING:**

**CASE NO. 11628
ORDER NO. R-10696**

**APPLICATION OF BURLINGTON RESOURCES
OIL & GAS COMPANY FOR THE ESTABLISHMENT
OF A DOWNHOLE COMMINGLING "REFERENCE
CASE" FOR ITS SAN JUAN 28-6 UNIT PURSUANT
TO DIVISION RULE 303.E. AND THE ADOPTION
OF SPECIAL ADMINISTRATIVE RULES THEREFOR.
SAN JUAN COUNTY, NEW MEXICO..**

ORDER OF THE DIVISION

BY THE DIVISION:

This cause came on for hearing at 8:15 a.m. on October 17 and November 7, 1996, at Santa Fe, New Mexico, before Examiners David R. Catanach and Michael E. Stogner, respectively.

NOW, on this 12th day of November, 1996, the Division Director, having considered the testimony, the record and the recommendations of the Examiner, and being fully advised in the premises,

FINDS THAT:

(1) Due public notice having been given as required by law, the Division has jurisdiction of this cause and the subject matter thereof.

(2) The applicant, Burlington Resources Oil & Gas Company (Burlington), pursuant to the provisions of Division Rule 303.E., seeks to establish a downhole commingling "reference case" to provide exceptions for (a) marginal economic criteria, (b) pressure criteria, (c) allocation formulas and (d) modification of notification rules on a unit-wide basis for downhole commingling of Dakota, Mesaverde, Fruitland Coal and Pictured Cliffs gas production within existing or future drilled wells within the San Juan 28-6 Unit, San Juan County, New Mexico.

(3) Division Rule No. 303.E., amended by Order No. R-10470-A, currently states:

- c) establish a "reference case" whereby the Division utilizes the data presented in the immediate case to endorse or approve certain methods of allocating production whereby the applicant need not submit additional data or justification when proposing a certain method of allocating production on Form C-107-A's subsequently filed for wells within the San Juan 28-6 Unit; and,
- d) establish a "reference case" or an administrative procedure for authorizing the downhole commingling of existing or future drilled wells within the San Juan 28-6 Unit without additional notice to each affected interest owner as required by Division Rule No. 303.D.

(7) In support of its request to except marginal economic criteria, the applicant presented geologic and engineering evidence and testimony which indicates that within the San Juan 28-6 Unit:

- a) the structure and thickness of the Dakota and Pictured Cliffs formations are very consistent;
- b) the average recoverable Dakota and Pictured Cliffs gas reserves underlying an undeveloped drill block are approximately 449 MMCFG and 186 MMCFG, respectively;
- c) the average initial producing rate for a newly drilled or recompleted Dakota and Pictured Cliffs gas well is approximately 254 MCFGD and 216 MCFGD, respectively; and,
- d) the estimated ultimate gas recoveries and initial producing rates from the Dakota and Pictured Cliffs formations are insufficient to justify drilling stand alone wells and/or dually completed wells to recover such gas reserves.

(8) The evidence and testimony presented by the applicant indicates that the Dakota and Pictured Cliffs formations within the San Juan 28-6 Unit should be properly classified as "marginal".

(9) In support of its request to except pressure criteria within the Dakota and Pictured Cliffs formations within the San Juan 28-6 Unit, the applicant presented engineering evidence and testimony which indicates that:

- c) providing notice to each interest owner within the San Juan 28-6 Unit of subsequent downhole comminglings is unnecessary and is an excessive burden on the applicant;
- d) the downhole commingling of wells within the San Juan 28-6 Unit Area will benefit working, royalty, and overriding royalty interest owners. In addition, the downhole commingling of wells within the San Juan 28-6 Unit should not violate the correlative rights of any interest owner;
- e) no interest owner appeared at the hearing in opposition to the establishment of a "reference case" or administrative procedure for notice.

(14) An administrative procedure should be established within the San Juan 28-6 Unit for obtaining approval for subsequent downhole commingled wells without notice to Unit interest owners, provided however that, all other provisions contained within Division Rule No. 303.C. are complied with.

(15) Approval of the proposed "reference cases" for marginal economic criteria, pressure criteria, allocation formulas and notice will lessen the burden on the applicant insofar as providing the data required pursuant to Division Rule No. 303.D. and Form C-107-A, will provide the applicant a streamlined method for obtaining downhole commingling approvals within the San Juan 28-6 Unit, and will not violate correlative rights.

IT IS THEREFORE ORDERED THAT:

(1) The application of Burlington Resources Oil & Gas Company to establish a "reference case" for (a) marginal economic criteria, (b) pressure criteria, (c) allocation formulas and (d) modification of notification rules on a unit-wide basis for downhole commingling of Dakota, Mesaverde, Fruitland Coal and Pictured Cliffs gas production within existing or future drilled wells within the San Juan 28-6 Unit, San Juan County, New Mexico, is hereby approved.