

PMESD-605334210

Sup: 2-8-06

LONE WOLF OPERATING COMPANY

RECEIVED

January 18, 2006

JAN 19 2006

Mr. Stogner
State of New Mexico
Oil Conservation Division
1220 South St. Francis Dr.
Santa Fe, New Mexico 87505

Oil Conservation Division
1220 S. St. Francis Drive
Santa Fe, NM 87505

Cc: Charlie Perrin
Cc: Steve Hayden

Re: Celso Gomez #2
Rio Arriba County, New Mexico

Dear Mr. Stogner:

Please let this letter serve as our request for a Location Exception so that the well may be drilled at its current staked location. Enclosed you will find a structure map indicating the top of the Dakota which illustrates the geological importance of drilling up dip to the Celso Gomez #1 and on strike with the structure. Also, this location is topographically advantageous.

While lease information is not on the map please be advised that all of Section 19 - T32N - R2E is owned by Gomez y Gomez, Inc. and is under lease to The Revere Corporation who is a participant in this project. The contact for Gomez y Gomez is Tim Gomez; Gobernador Route, Blanco, New Mexico, 87412; phone # is 505-330-6646.

If you need additional information please contact me at you earliest convenience.

Sincerely,

Mike Benetatos
Operations Manager
Lone Wolf New Mexico, LLC

RECEIVED

JAN 19 2006

Oil Conservation Division
1220 S. St. Francis Drive
Santa Fe, NM 87505

RECEIVED

JAN 19 2006

Oil Conservation Divi
1220 S. St. Francis
Santa Fe, NM 87505

1E

2E

32N

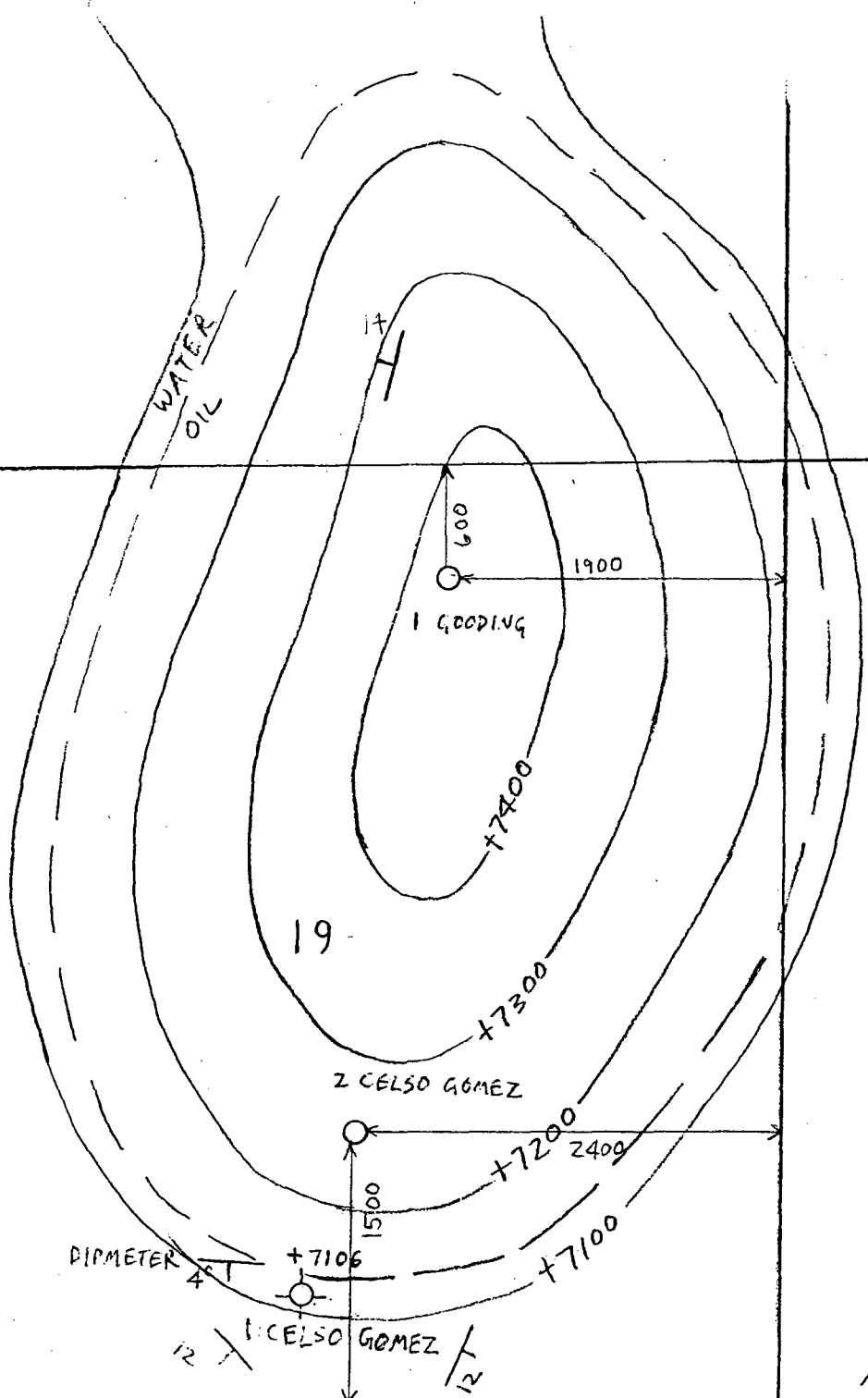

GOMEZ RANCH
GONZALES RANCH

CONTINENTAL DIVIDE PROSPECT
STRUCTURE TOP DAKOTA (Kd)
C.I. 100'
SCALE 1" = 1000'
T. WRIGHT

District I
1625 N. French Dr., Hobbs, NM 88240
District II
1301 W. Grand Avenue, Artesia, NM 88210
District III
1000 Rio Brazos Rd., Aztec, NM 87410
District IV
1220 S. St. Francis Dr., Santa Fe, NM 87505

State of New Mexico
Energy, Minerals & Natural Resources Department
OIL CONSERVATION DIVISION
1220 South St. Francis Dr.
Santa Fe, NM 87505

Form C-102
Revised October 12, 2005
Submit to Appropriate District Office
State Lease - 4 Copies
Fee Lease - 3 Copies

☐ AMENDED REPORT

WELL LOCATION AND ACREAGE DEDICATION PLAT

API Number		Pool Code		WC 32N 2E 19, Entrada		Pool Name	
Property Code		Property Name				Well Number	
34841		Celso Gomez				#2	
OGRID No.		Operator Name				Elevation	
232512		Lone Wolf New Mexico, LLC				8130	

10 Surface Location



UL or lot no.	Section	Township	Range	Lot Idn	Feet from the	North/South line	Feet from the	East/West line	County
	**19	32N	02E		1500'	South	2400'	East	Rio Arriba

11 Bottom Hole Location If Different From Surface

UL or lot no.	Section	Township	Range	Lot Idn	Feet from the	North/South line	Feet from the	East/West line	County

12 Dedicated Acres	13 Joint or Infill	14 Consolidation Code	15 Order No.

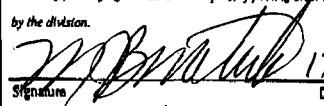
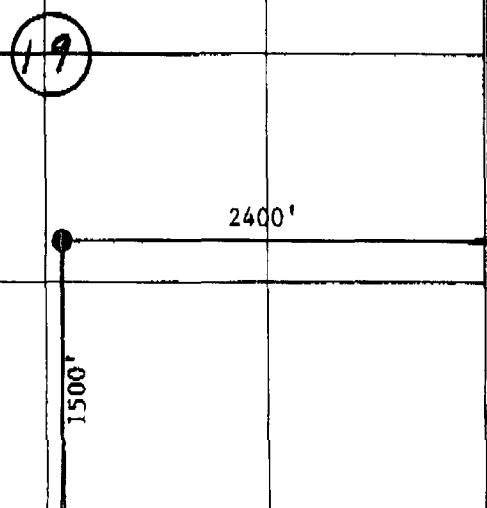
No allowable will be assigned to this completion until all interests have been consolidated or a non-standard unit has been approved by the division.

16 ** Sectionization was graphically taken from the projected subdivision map as filed in Book of Plats Cabinet L-54, page 2579 in the records of the Rio Arriba County Clerk on 30 June 1992.				17 OPERATOR CERTIFICATION I hereby certify that the information contained herein is true and complete to the best of my knowledge and belief, and that this organization either owns a working interest or mineral interest in the land including the proposed bottom hole location or has a right to drill this well at this location pursuant to a contract with an owner of such a mineral or working interest, or to a voluntary pooling agreement or a compulsory pooling order heretofore entered by the division.  Signature Date MICHAEL J. BENETATOS Printed Name	
Coordinates of the well head are on the New Mexico State Plane Coordinate System - Central Zone. x - 352,094.5560 y - 2,173,912.9000					
				18 SURVEYOR CERTIFICATION I hereby certify that the well location shown on this plat was plotted from field notes of actual surveys made by me or under my supervision, and that the same is true and correct to the best of my belief. 29 November 2006 Date of Survey Signature and Title of Professional Surveyor  Gilberto Archuleta NMPS 13976 Certificate Number	

COPY