

County San Juan Pool Angels Peak - Gallup Associated
 TOWNSHIP 27 North RANGE 10 West NEW MEXICO PRINCIPAL MERIDIAN

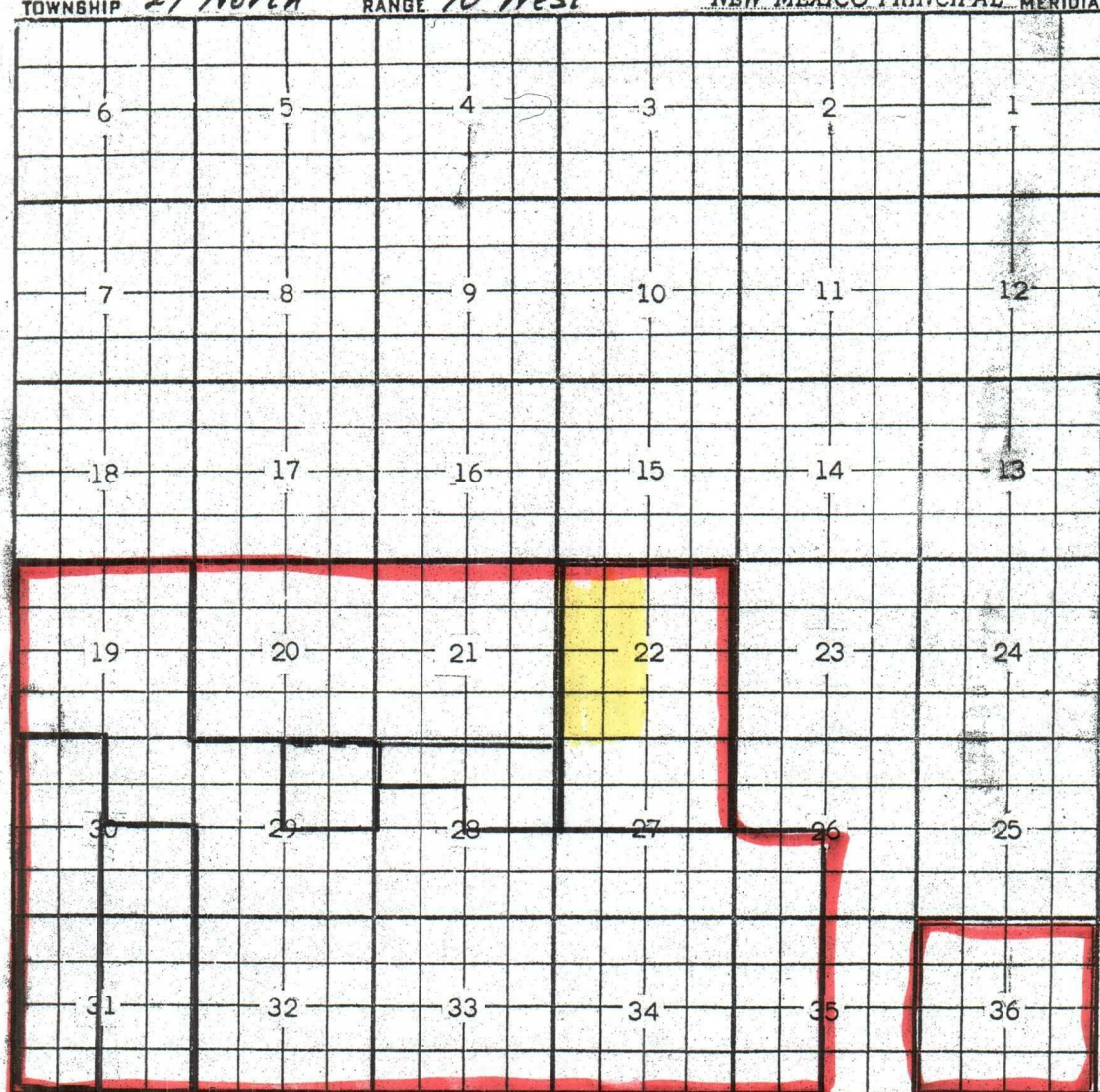

Description: $\frac{SW}{4}$ Sec. 26; $\frac{S}{2}$ Sec. 27; $\frac{SE}{4}$ Sec. 28; $\frac{E}{2}$ Sec. 33;

All Sec. 34; $\frac{W}{2}$ Sec. 35 (R-1167, 5-1-58)

Reclassified as an Oil Pool (R-1357, 4-1-59)

Ext: $\frac{SW}{4}$ Sec. 28; $\frac{S}{2}$ Sec. 29; All Sec. 32; $\frac{W}{2}$ Sec. 33 (R-1373, 5-1-59)

- $\frac{S}{2}$ $\frac{NW}{4}$ Sec. 28 (R-1489, 10-1-59) - $\frac{SE}{4}$ Sec. 19; $\frac{NW}{4}$ Sec. 29; $\frac{NE}{4}$ Sec. 30 (R-1453, 5-1-60)

- $\frac{W}{2}$ Sec. 19 (R-1443, 5-1-61) - $\frac{NE}{4}$ Sec. 19 (R-2102, 11-1-61)

Ext: All Sec. 36 (R-5339, 2-1-77)

Ext: All Sec. 22, $\frac{N}{2}$ Sec. 27 (R-7046, 8-6-82)

Ext: $\frac{NE}{4}$ and $\frac{N}{2}$ $\frac{NW}{4}$ Sec. 28 (R-8273, 8-6-86)

Ext: $\frac{SE}{4}$ Sec. 30, $\frac{E}{2}$ Sec. 31 (R-9667, 5-6-92) Ext: $\frac{W}{2}$ Sec. 30, $\frac{W}{2}$ Sec. 31

(R-9801, 12-16-92) Ext: $\frac{NE}{4}$ Sec. 29 (R-10344, 4-24-95)

Ext: All Secs. 20 and 21 (R-10557, 3-11-96)

Stogner, Michael, EMNRD

From: Hayden, Steven, EMNRD
To: Stogner, Michael, EMNRD
Cc:
Subject: XTO's JC Gordon D #2F
Attachments:

Sent: Fri 3/10/2006 2:06 PM

Mike

I got a call from XTO about this well. It lies within the pool boundaries of the Angel's Peak Gallup and I held the C-104 for a NSL for the Gllp. They said they got a letter back stating that it should be in the Basin Mancos so that it would not need an order. The Basin Mancos was supposed to take up the spaces between the old Gallup pools where there is no real Gallup Formation and to provide uniformity of spacing with the other gas pools. We can't stick wells within the old pool boundaries in it without going to hearing, can we?

Thanks

Steve Hayden	steven.hayden@state.nm.us
District Geologist	505-334-6178 ext 14
NM OCD District II	505-320-0545 Cell
1000 Rio Brazos Rd	505-334-6170 FAX
Aztec, NM 87410	