

DATE IN 06/29/15	SUSPENSE	ENGINEER PRG	LOGGED IN 06/29/15	TYPE SWD	APP NO. PRG 1518050104
------------------	----------	--------------	--------------------	----------	------------------------

ABOVE THIS LINE FOR DIVISION USE ONLY

NEW MEXICO OIL CONSERVATION DIVISION
 - Engineering Bureau -
 1220 South St. Francis Drive, Santa Fe, NM 87505



ADMINISTRATIVE APPLICATION CHECKLIST

THIS CHECKLIST IS MANDATORY FOR ALL ADMINISTRATIVE APPLICATIONS FOR EXCEPTIONS TO DIVISION RULES AND REGULATIONS WHICH REQUIRE PROCESSING AT THE DIVISION LEVEL IN SANTA FE

Application Acronyms:

[NSL-Non-Standard Location] [NSP-Non-Standard Proration Unit] [SD-Simultaneous Dedication]
[DHC-Downhole Commingling] [CTB-Lease Commingling] [PLC-Pool/Lease Commingling]
[PC-Pool Commingling] [OLS - Off-Lease Storage] [OLM-Off-Lease Measurement]
[WFX-Waterflood Expansion] [PMX-Pressure Maintenance Expansion]
[SWD-Salt Water Disposal] [IPI-Injection Pressure Increase]
[EOR-Qualified Enhanced Oil Recovery Certification] [PPR-Positive Production Response]

[1] TYPE OF APPLICATION - Check Those Which Apply for [A]

[A] Location - Spacing Unit - Simultaneous Dedication
☐ NSL ☐ NSP ☐ SD

Check One Only for [B] or [C]

[B] Commingling - Storage - Measurement
☐ DHC ☐ CTB ☐ PLC ☐ PC ☐ OLS ☐ OLM

[C] Injection - Disposal - Pressure Increase - Enhanced Oil Recovery
☐ WFX ☐ PMX ☒ SWD ☐ IPI ☐ EOR ☐ PPR

[D] Other: Specify _____

[2] NOTIFICATION REQUIRED TO: - Check Those Which Apply, or ☐ Does Not Apply

[A] ☐ Working, Royalty or Overriding Royalty Interest Owners

[B] ☒ Offset Operators, Leaseholders or Surface Owner

[C] ☒ Application is One Which Requires Published Legal Notice

[D] ☒ Notification and/or Concurrent Approval by BLM or SLO
U.S. Bureau of Land Management - Commissioner of Public Lands, State Land Office

[E] ☒ For all of the above, Proof of Notification or Publication is Attached, and/or,

[F] ☐ Waivers are Attached

RECEIVED OGD
2015 JUN 29 A 11:23

OWL SWD Operating

Brininstool Ranch SWD #3
42760
30-025 - Pending
M-19-233-3SE
Devonian / Upper Ord.

Commercial

[3] SUBMIT ACCURATE AND COMPLETE INFORMATION REQUIRED TO PROCESS THE TYPE OF APPLICATION INDICATED ABOVE.

[4] CERTIFICATION: I hereby certify that the information submitted with this application for administrative approval is **accurate** and **complete** to the best of my knowledge. I also understand that **no action** will be taken on this application until the required information and notifications are submitted to the Division.

Note: Statement must be completed by an individual with managerial and/or supervisory capacity.

Ben Stone

 Print or Type Name

 Signature

Agent for Owl SWD Operating, LLC 6/17/15

 Title
ben@sosconsulting.us

 e-mail Address



June 24, 2015

New Mexico Oil Conservation Division
1220 South St. Francis Drive
Santa Fe, New Mexico 87505

Attn: Mr. David Catanach, Director

Re: Application of Owl SWD Operating, LLC to permit for salt water disposal the proposed well Brininstool Ranch SWD No.3 well, to be located in Section 19, Township 23 South, Range 33 East, NMPM, Lea County, New Mexico.

Dear Mr. Catanach,

Please find enclosed form C-108 Application for Authority to Inject, supporting the above-referenced request to for disposal in the undrilled Brininstool Ranch SWD Well No.3.

Owl SWD Operating seeks to create additional solutions for disposal in various locations in southeast New Mexico. Approval of this application is consistent with that goal as well as the NMOCD's mission of preventing waste and protection of correlative rights.

Published legal notice ran in the June 2, 2015 edition of the Hobbs News-Sun and all offset operators and other interested parties have been notified individually. The legal notice affidavit is included in this application. The application also includes wellbore schematics, area of review maps, leaseholder plats and other required information for a complete Form C-108. The well is located on private land and federal minerals. The BLM APD is in process.

I respectfully request that the approval of this salt water disposal well proceed swiftly and if you or your staff requires additional information or has any questions, please do not hesitate to call or email me.

Best regards,

A handwritten signature in black ink, appearing to read 'Ben Stone'.

Ben Stone, Partner
SOS Consulting, LLC
Agent for Owl SWD Operating, LLC

Cc: Application attachment and file

APPLICATION FOR AUTHORIZATION TO INJECT

- I. PURPOSE: **Salt Water Disposal** and the application **QUALIFIES** for administrative approval.
- II. OPERATOR: **Owl SWD Operating, LLC**
ADDRESS: **8214 Westchester Dr., Ste.850, Dallas, TX 75255**

CONTACT PARTY: **Agent: SOS Consulting, LLC – Ben Stone (903) 488-9850**
- III. WELL DATA: **To be Drilled (BLM APD in Process). All well data and applicable wellbore diagrams are ATTACHED.**
- IV. **This is not an expansion of an existing project.**
- V. **A map is attached** that identifies all wells and leases within two miles of any proposed injection well with a one-half mile radius circle drawn around each proposed injection well. This circle identifies the well's area of review.
- *VI. A tabulation is attached of data on all wells of public record within the area of review which penetrate the proposed injection zone. **ALL wells in the ½ mile AOR have been P&A'd and NO WELLS penetrate the subject interval of Devonian formation.** The data includes a description of each well's type, construction, date drilled, location, depth, and a schematic of any plugged well illustrating all plugging detail. **NONE.**
- VII. **The following data is ATTACHED** on the proposed operation, including:
1. Proposed average and maximum daily rate and volume of fluids to be injected;
 2. Whether the system is open or closed;
 3. Proposed average and maximum injection pressure;
 4. Sources and an appropriate analysis of injection fluid and compatibility with the receiving formation if other than reinjected produced water; and,
 5. If injection is for disposal purposes into a zone not productive of oil or gas at or within one mile of the proposed well, attach a chemical analysis of the disposal zone formation water (may be measured or inferred from existing literature, studies, nearby wells, etc.).
- *VIII. **Appropriate geologic data on the injection zone is ATTACHED** including appropriate lithologic detail, geologic name, thickness, and depth. Give the geologic name, and depth to bottom of all underground sources of drinking water (aquifers containing waters with total dissolved solids concentrations of 10,000 mg/l or less) overlying the proposed injection zone as well as any such sources known to be immediately underlying the injection interval. **Due to limited information in the immediate vicinity, geologic information is inferred from existing studies in the region.**
- IX. **Stimulation program – a conventional acid job may be conducted upon completion of the well.**
- *X. **During drilling, mudlogging will ensure only Devonian interval is targeted. After drilling, logs will be run from TD to approximately 14,000' and will be submitted to the OCD. CBL logs will be run after setting casing.**
- *XI. **There are 2 domestic water wells within one mile of the proposed salt water disposal well. Samples are being analyzed and will be forwarded upon receipt.**
- XII. **An affirmative statement is ATTACHED that available geologic and engineering data has been examined and no evidence was found** of open faults or any other hydrologic connection between the disposal zone and any underground sources of drinking water.
- XIII. **"Proof of Notice" section on the next page of this form has been completed and ATTACHED. There are 3 offset lessees and/or operators within ½ mile and BLM minerals - all have been noticed. ATTACHED.**
- XIV. Certification: I hereby certify that the information submitted with this application is true and correct to the best of my knowledge and belief.

NAME: **Ben Stone** TITLE: **SOS Consulting, LLC agent for Owl SWD Operating, LLC**

SIGNATURE:  DATE: **6/17/2015**

E-MAIL ADDRESS: **ben@sosconsulting.us**

- * If the information required under Sections VI, VIII, X, and XI above has been previously submitted, it need not be resubmitted. Please show the date and circumstances of the earlier submittal:

III. WELL DATA – *The following information and data is included (See ATTACHED Wellbore Schematic):*

A. The following well data must be submitted for each injection well covered by this application. The data must be both in tabular and schematic form and shall include:

- (1) Lease name; Well No., Location by Section, Township and Range; and footage location within the section.
- (2) Each casing string used with its size, setting depth, sacks of cement used, hole size, top of cement, and how such top was determined.
- (3) A description of the tubing to be used including its size, lining material, and setting depth.
- (4) The name, model, and setting depth of the packer used or a description of any other seal system or assembly used.

Division District Offices have supplies of Well Data Sheets which may be used or which may be used as models for this purpose. Applicants for several identical wells may submit a "typical data sheet" rather than submitting the data for each well.

B. The following must be submitted for each injection well covered by this application. All items must be addressed for the initial well. Responses for additional wells need be shown only when different. Information shown on schematics need not be repeated.

- (1) The name of the injection formation and, if applicable, the field or pool name.
- (2) The injection interval and whether it is perforated or open-hole.
- (3) State if the well was drilled for injection or, if not, the original purpose of the well.
- (4) Give the depths of any other perforated intervals and detail on the sacks of cement or bridge plugs used to seal off such perforations.
- (5) Give the depth to and the name of the next higher and next lower oil or gas zone in the area of the well, if any.

XIV. PROOF OF NOTICE *pursuant to the following criteria is ATTACHED.*

All applicants must furnish proof that a copy of the application has been furnished, by certified or registered mail, to the owner of the surface of the land on which the well is to be located and to each leasehold operator within one-half mile of the well location.

Where an application is subject to administrative approval, a proof of publication must be submitted. Such proof shall consist of a copy of the legal advertisement which was published in the county in which the well is located. The contents of such advertisement must include:

- (1) The name, address, phone number, and contact party for the applicant;
- (2) The intended purpose of the injection well; with the exact location of single wells or the Section, Township, and Range location of multiple wells;
- (3) The formation name and depth with expected maximum injection rates and pressures; and,
- (4) A notation that interested parties must file objections or requests for hearing with the Oil Conservation Division, 1220 South St. Francis Dr., Santa Fe, New Mexico 87505, within 15 days.

NO ACTION WILL BE TAKEN ON THE APPLICATION UNTIL PROPER PROOF OF NOTICE HAS BEEN SUBMITTED.

NOTICE: Surface owners or offset operators must file any objections or requests for hearing of administrative applications within 15 days from the date this application was mailed to them.

Wed, Sept. 23rd BLM E-mail

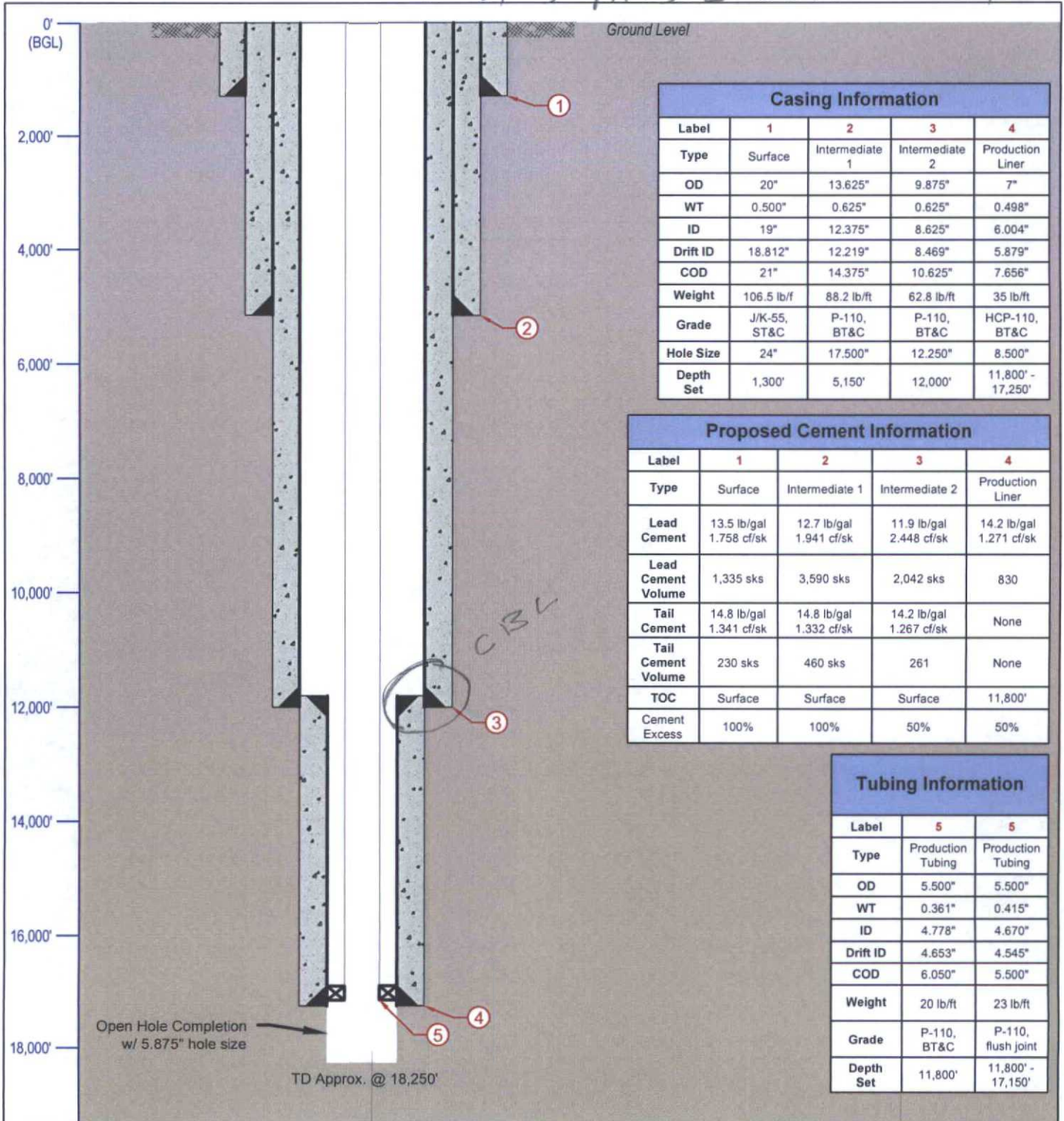

LONQUIST & CO. LLC

PETROLEUM ENGINEERS ENERGY ADVISORS

AUSTIN HOUSTON WICHITA CALGARY

Texas License F-8952

3345 Bee Cave Road, Suite 201
Austin, Texas 78746
Tel: 512.732.9812
Fax: 512.732.9816

OWL SWD Operating, Inc

Country: USA

Survey/STR:

API No.:

State ID No.:

Drawn: MMC

Rev No:

Brininstool SWD No. 3

State/Province: New Mexico

Site:

Field:

Project No:

Reviewed: RSC

Notes: Devonian completion.

County/Parish: Lea

Status: To Be Drilled

Ground Elevation: 3,710'

Date: 9/21/2015

Approved: SLP

APD Calculation Summary -
C295:K384.

2nd Dia	20	surface csg in a	24	inch hole.	Design Factors			SURFACE	
	Segment	#/ft	Grade	Coupling	Joint	Collapse	Burst	Length	Weight
	"A"	106.50	K 55	ST&C	6.93	1.14	0.83	1,300	138,450
	"B"							0	0
	w/8.4#/g mud, 30min Sfc Csg Test psig: 1,120				Tail Cmt	does not	circ to sfc.	Totals:	1,300 138,450
	Comparison of Proposed to Minimum Required Cement Volumes								
	Hole	Annular	1 Stage	1 Stage	Min	1 Stage	Drilling	Calc	Req'd
	Size	Volume	Cmt Sx	CuFt Cmt	Cu Ft	% Excess	Mud Wt	MASP	BOPE
	24	0.9599	1565	2655	1327	100	10.00	1756	2M
	Burst Frac Gradient(s) for Segment(s) A, B = , b All > 0.70, OK.								

3rd Dia	13 5/8	casing inside the	20		Design Factors			INTERMEDIATE	
	Segment	#/ft	Grade	Coupling	Joint	Collapse	Burst	Length	Weight
	"A"	88.20	P 110	BUTT	4.76	1.58	1.22	5,150	454,230
	"B"							0	0
	w/8.4#/g mud, 30min Sfc Csg Test psig:							Totals:	5,150 454,230
	The cement volume(s) are intended to achieve a top of				0	ft from surface or a		1300	overlap.
	Hole	Annular	1 Stage	1 Stage	Min	1 Stage	Drilling	Calc	Req'd
	Size	Volume	Cmt Sx	CuFt Cmt	Cu Ft	% Excess	Mud Wt	MASP	BOPE
	17 1/2	0.6578	4050	7581	3813	99	10.80	4591	5M
	MASP is within 10% of 5000psig, need								

4th Dia	9 7/8	casing inside the	13 5/8		Design Factors			PRODUCTION	
	Segment	#/ft	Grade	Coupling	Joint	Collapse	Burst	Length	Weight
	"A"	62.80	p 110	BUTT	2.10	1.42	1.01	12,000	753,600
	"B"							0	0
	w/8.4#/g mud, 30min Sfc Csg Test psig: 2,640							Totals:	12,000 753,600
	The cement volume(s) are intended to achieve a top of				0	ft from surface or a		5150	overlap.
	Hole	Annular	1 Stage	1 Stage	Min	1 Stage	Drilling	Calc	Req'd
	Size	Volume	Cmt Sx	CuFt Cmt	Cu Ft	% Excess	Mud Wt	MASP	BOPE
	12 1/4	0.2866	2303	5330	3543	50	11.60	8302	10M
	Class 'H' tail cmt yld > 1.20 MASP is within 10% of 5000psig, need exrta equip?								

5th Dia	7	Liner w/top @	11800		Design Factors			LINER	
	Segment	#/ft	Grade	Coupling	Joint	Collapse	Burst	Length	Weight
	"A"	35.00	HCP 110	BUTT	1.82	1.15	0.96	5,450	190,750
	"B"							0	0
	w/8.4#/g mud, 30min Sfc Csg Test psig: 621							Totals:	5,450 190,750
	The cement volume(s) are intended to achieve a top of				11800	ft from surface or a		200	overlap.
	Hole	Annular	1 Stage	1 Stage	Min	1 Stage	Drilling	Calc	Req'd
	Size	Volume	Cmt Sx	CuFt Cmt	Cu Ft	% Excess	Mud Wt	MASP	BOPE
	8 1/2	0.1268	830	1055	702	50	13.50		0.422
	Capitan Reef est top XXXX. MASP is within 10% of 5000psig, need exrta equip?								

Brininstool Ranch SWD Well No.3 - Area of Review - 2 Miles

(Attachment to NMOCD Form C-108 - Item V)

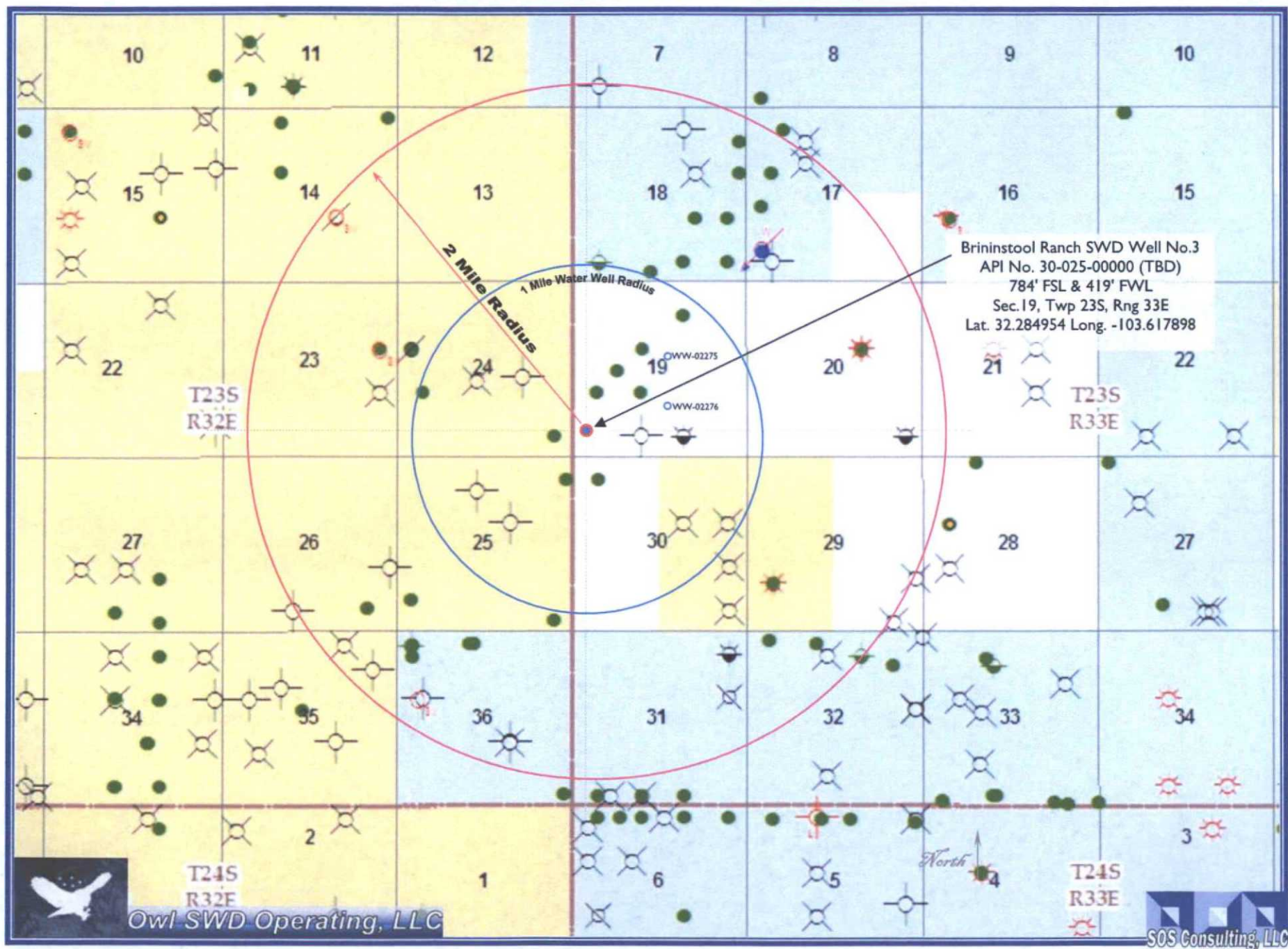

Brininstool Ranch SWD Well No.3 - Area of Review / Overview Map

(Attachment to NMOCD Form C-108, Application for Authority to Inject.)

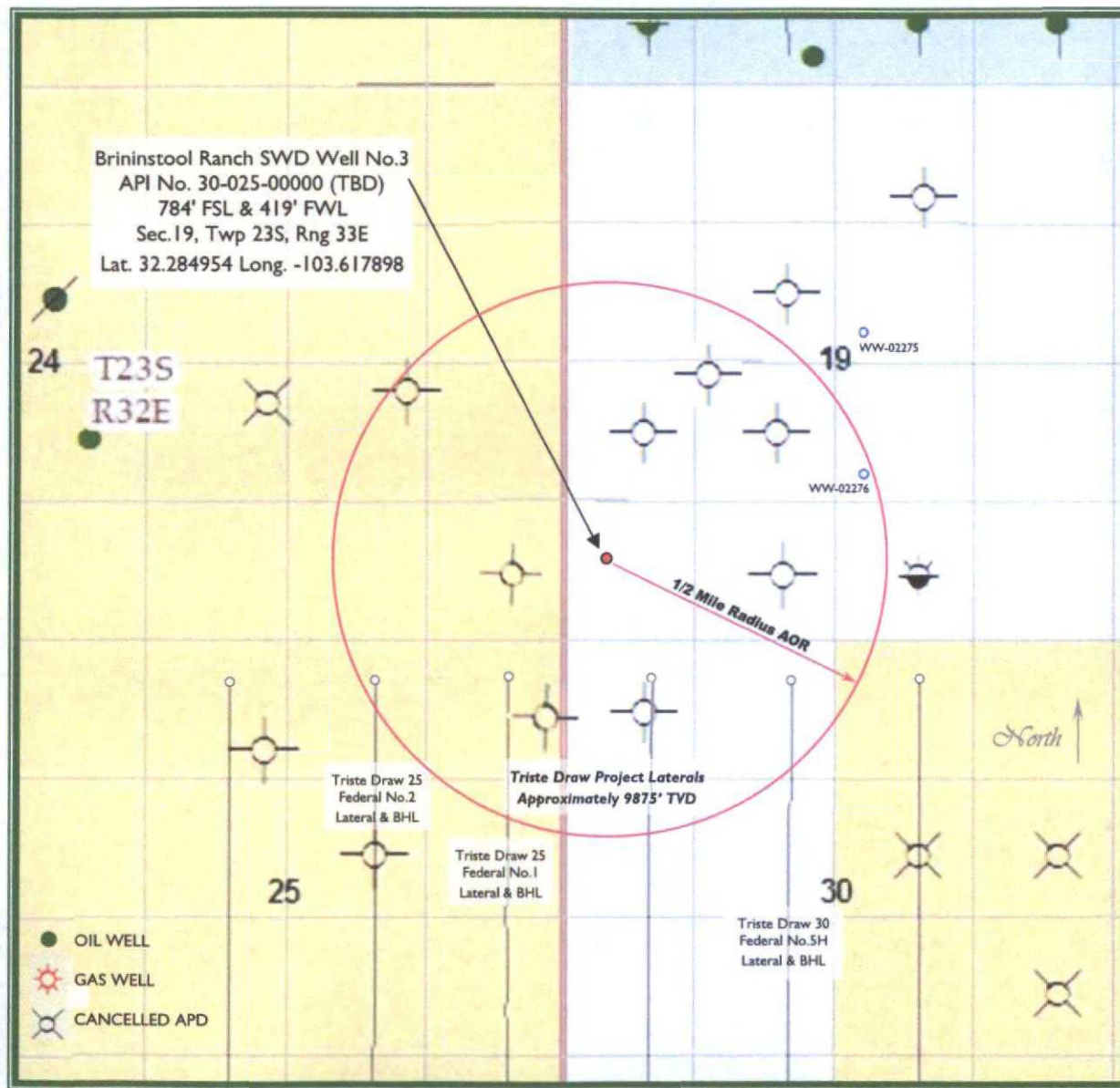

~32 miles Northwest of Jal, NM

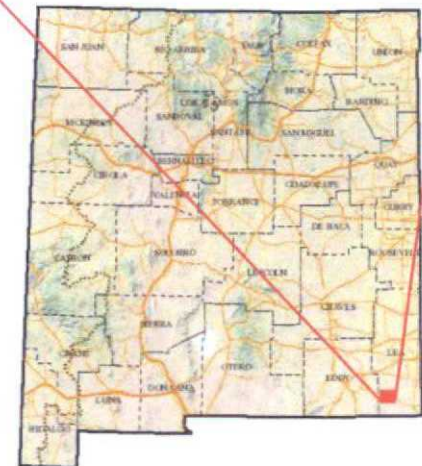

Lea County, New Mexico



Owl SWD Operating, LLC



C-108 - Item VI

Area of Review Well Data

**THERE ARE NO WELLS WHICH PENETRATE THE
PROPOSED DEVONIAN FORMATION IN THE
ONE-HALF MILE AREA of REVIEW.**

All wells in the AOR have been P&A'd.

**Several horizontal laterals enter the AOR from the south.
These wells are in Cimerex Energy Company's Triste Draw Bone
Spring Project with the lateral completions running
approximately 9875' True Vertical Depth.**

}

C-108 ITEM VII – PROPOSED OPERATION

Brininstool Ranch SWD Well No.3

Commercial SWD Facility

Upon approval of all permits for SWD, operations would begin within 30 days. Completion of the well operations will take six to seven weeks. Facility construction including installation of the tank battery, berms, plumbing and other and associated equipment would be occurring during the same interval but at a different location from the well. In any event, it is not expected for the construction phase of the project to last more than 60 days, depending on availability of contractors and equipment. At the time of this submittal, and subject to the availability of the drilling contractor, the anticipated start date is August 15, 2015.

Configure for Salt Water Disposal

Prior to commencing any work, an NOI sundry(ies) will be submitted to configure the well for SWD and will detail the completion workover including all work otherwise described above, any change to the procedure noted herein and to perform mechanical integrity pressure test per OCD test procedures. (Notify NMOCD 24 hours prior.) The casing/tubing annulus will be monitored for communication with injection fluid or loss of casing integrity.

Operational Summary

The SWD facility will be fenced with only the offloading station located outside so that trucks may access for load disposal 24/7.

The well and injection equipment will be a closed system and equipped with pressure limiting devices and volume meters. The annulus, loaded with an inert, anti-corrosion packer fluid, will be monitored for pressure.

The tanks will be equipped with telemetry devices and visual alarms to alert the operator and customers of full tanks or an overflow situation.

Anticipated daily maximum volume is 20,000 bpd and an average of 15,000 bpd at a maximum surface injection pressure of 3200 psi (.2 psi/ft gradient) with an average pressure of approximately 580 psi.

Potential releases will be contained and cleaned up immediately. The operator shall repair or otherwise correct the situation within 48 hours before resuming operations. OCD will be notified within 24 hours of any release greater than 5 bbls. If required, remediation will start as soon as practicable. Operator shall comply with 19.15.29 NMAC and 19.15.30 NMAC, as necessary and appropriate.

C-108 - Item VII.5

Water Analysis - Disposal Zone - DEVONIAN

NM WAIDS DATA				
S-T-R	FIELD	FORMATION	TDS	CHLRD
24-23S-29E	REMUDA	DEVONIAN	64582	37500
24-23S-29E	REMUDA	DEVONIAN	56922	29000
06-23S-34E	BELL LAKE NORTH	DEVONIAN	71078	42200
34-23S-34E	ANTELOPE RIDGE	DEVONIAN	80187	47900

Water Analysis - Source Zone - BONE SPRING



BioTech Ink

Laboratory Analysis
Endurance
Jazzmaster 17 State #4H

Sample Date: 1/31/2014
Lea Co. NM

Requested by: T. Ratliff

Water Analysis Measurements		Cations (+)		Anions (-)	
	mg/L		mg/L		mg/L
Oxygen (mg/L)	1.00	Barium (Ba)	0	Carbonate (CO ₃)	0
Carbon Dioxide (mg/L)	660.18	Calcium (Ca)	16.440	Bicarbonate (HCO ₃)	91.60
Hydrogen Sulfide (mg/L)	0.0	Magnesium (Mg)	360	Chloride (mg/L)	118.520
pH	5.7	Sodium (Na) (cal)	54.270	Sulfate (SO ₄)	319
Temperature °F	73	Iron (Fe)	3.00		
		Manganese (Mn)	0.00		
Oil in Water (ppm)	NA				
Specific Gravity	1.150				
Total Dissolved Solids (TDS)	180 (m)				
(mg/L) (cal)	18.000				
Total Hardness (mg/L)	18.000				

Water Analysis - Source Zone - DELAWARE

P. O. BOX 1000
MCKINNEY, TEXAS 75069
TEL: 972-322-0000 FAX: 972-322-0000

Martin Water Laboratories, Inc.

700 W. HODGINS
MCKINNEY, TEXAS 75069
PHONE: 972-322-0000

RESULT OF WATER ANALYSES

TO: Mr. Lou Small LABORATORY NO. 99293
P. O. Box 31810, Midland, TX 79710 SAMPLE RECEIVED 9-16-92
RESULTS REPORTED 9-18-92

COUNTY Meridian Oil Company LEASE Dagger Lake #1
FIELD OR POOL Wildcat
SECTION BLOCK SURVEY COUNTY Lea STATE NM
SOURCE OF SAMPLE AND DATE TAKEN:
NO. 1 Recovered water - taken from Dagger Lake #1. 9-9-92
NO. 2
NO. 3
NO. 4

REMARKS: Delaware

CHEMICAL AND PHYSICAL PROPERTIES				
	NO. 1	NO. 2	NO. 3	NO. 4
Specific Gravity at 60°F.	1.1462			
per liter Sampled				
per liter Recovered	6.26			
Barium as Ba	145			
Sodium as Na				
Sulfate as SO ₄				
Chloride as Cl				
Iron as Fe				
Manganese as Mn				
Barium as Ba				
Calcium as Ca				
Magnesium as Mg				
Sodium as Na				
Sulfate as SO ₄				
Chloride as Cl				
Iron as Fe				
Manganese as Mn				
Barium as Ba				
Calcium as Ca				
Magnesium as Mg				
Sodium as Na				
Sulfate as SO ₄				
Chloride as Cl				
Iron as Fe				
Manganese as Mn				
Barium as Ba				
Calcium as Ca				
Magnesium as Mg				
Sodium as Na				
Sulfate as SO ₄				
Chloride as Cl				
Iron as Fe				
Manganese as Mn				
Barium as Ba				
Calcium as Ca				
Magnesium as Mg				
Sodium as Na				
Sulfate as SO ₄				
Chloride as Cl				
Iron as Fe				
Manganese as Mn				
Barium as Ba				
Calcium as Ca				
Magnesium as Mg				
Sodium as Na				
Sulfate as SO ₄				
Chloride as Cl				
Iron as Fe				
Manganese as Mn				
Barium as Ba				
Calcium as Ca				
Magnesium as Mg				
Sodium as Na				
Sulfate as SO ₄				
Chloride as Cl				
Iron as Fe				
Manganese as Mn				
Barium as Ba				
Calcium as Ca				
Magnesium as Mg				
Sodium as Na				
Sulfate as SO ₄				
Chloride as Cl				
Iron as Fe				
Manganese as Mn				
Barium as Ba				
Calcium as Ca				
Magnesium as Mg				
Sodium as Na				
Sulfate as SO ₄				
Chloride as Cl				
Iron as Fe				
Manganese as Mn				
Barium as Ba				
Calcium as Ca				
Magnesium as Mg				
Sodium as Na				
Sulfate as SO ₄				
Chloride as Cl				
Iron as Fe				
Manganese as Mn				
Barium as Ba				
Calcium as Ca				
Magnesium as Mg				
Sodium as Na				
Sulfate as SO ₄				
Chloride as Cl				
Iron as Fe				
Manganese as Mn				
Barium as Ba				
Calcium as Ca				
Magnesium as Mg				
Sodium as Na				
Sulfate as SO ₄				
Chloride as Cl				
Iron as Fe				
Manganese as Mn				
Barium as Ba				
Calcium as Ca				
Magnesium as Mg				
Sodium as Na				
Sulfate as SO ₄				
Chloride as Cl				
Iron as Fe				
Manganese as Mn				
Barium as Ba				
Calcium as Ca				
Magnesium as Mg				
Sodium as Na				
Sulfate as SO ₄				
Chloride as Cl				
Iron as Fe				
Manganese as Mn				
Barium as Ba				
Calcium as Ca				
Magnesium as Mg				
Sodium as Na				
Sulfate as SO ₄				
Chloride as Cl				
Iron as Fe				
Manganese as Mn				
Barium as Ba				
Calcium as Ca				
Magnesium as Mg				
Sodium as Na				
Sulfate as SO ₄				
Chloride as Cl				
Iron as Fe				
Manganese as Mn				
Barium as Ba				
Calcium as Ca				
Magnesium as Mg				
Sodium as Na				
Sulfate as SO ₄				
Chloride as Cl				
Iron as Fe				
Manganese as Mn				
Barium as Ba				
Calcium as Ca				
Magnesium as Mg				
Sodium as Na				
Sulfate as SO ₄				
Chloride as Cl				
Iron as Fe				
Manganese as Mn				
Barium as Ba				
Calcium as Ca				
Magnesium as Mg				
Sodium as Na				
Sulfate as SO ₄				
Chloride as Cl				
Iron as Fe				
Manganese as Mn				
Barium as Ba				
Calcium as Ca				
Magnesium as Mg				
Sodium as Na				
Sulfate as SO ₄				
Chloride as Cl				
Iron as Fe				
Manganese as Mn				
Barium as Ba				
Calcium as Ca				
Magnesium as Mg				
Sodium as Na				
Sulfate as SO ₄				
Chloride as Cl				
Iron as Fe				
Manganese as Mn				
Barium as Ba				
Calcium as Ca				
Magnesium as Mg				
Sodium as Na				
Sulfate as SO ₄				
Chloride as Cl				
Iron as Fe				
Manganese as Mn				
Barium as Ba				
Calcium as Ca				
Magnesium as Mg				
Sodium as Na				
Sulfate as SO ₄				
Chloride as Cl				
Iron as Fe				
Manganese as Mn				
Barium as Ba				
Calcium as Ca				
Magnesium as Mg				
Sodium as Na				
Sulfate as SO ₄				
Chloride as Cl				
Iron as Fe				
Manganese as Mn				
Barium as Ba				
Calcium as Ca				
Magnesium as Mg				
Sodium as Na				
Sulfate as SO ₄				
Chloride as Cl				
Iron as Fe				
Manganese as Mn				
Barium as Ba				
Calcium as Ca				
Magnesium as Mg				
Sodium as Na				
Sulfate as SO ₄				
Chloride as Cl				
Iron as Fe				
Manganese as Mn				
Barium as Ba				
Calcium as Ca				
Magnesium as Mg				
Sodium as Na				
Sulfate as SO ₄				
Chloride as Cl				
Iron as Fe				
Manganese as Mn				
Barium as Ba				
Calcium as Ca				
Magnesium as Mg				
Sodium as Na				
Sulfate as SO ₄				
Chloride as Cl				
Iron as Fe				
Manganese as Mn				
Barium as Ba				
Calcium as Ca				
Magnesium as Mg				
Sodium as Na				
Sulfate as SO ₄				
Chloride as Cl				
Iron as Fe				
Manganese as Mn				
Barium as Ba				
Calcium as Ca				
Magnesium as Mg				
Sodium as Na				
Sulfate as SO ₄				
Chloride as Cl				
Iron as Fe				
Manganese as Mn				
Barium as Ba				
Calcium as Ca				
Magnesium as Mg				
Sodium as Na				
Sulfate as SO ₄				
Chloride as Cl				
Iron as Fe				
Manganese as Mn				
Barium as Ba				
Calcium as Ca				
Magnesium as Mg				
Sodium as Na				
Sulfate as SO ₄				
Chloride as Cl				
Iron as Fe				
Manganese as Mn				
Barium as Ba				
Calcium as Ca				
Magnesium as Mg				
Sodium as Na				
Sulfate as SO ₄				
Chloride as Cl				
Iron as Fe				
Manganese as Mn				
Barium as Ba				
Calcium as Ca				
Magnesium as Mg				
Sodium as Na				
Sulfate as SO ₄				
Chloride as Cl</				

C-108 – Item VIII

Geologic Information

The Devonian formation is comprised of carbonate and chert rocks and is found throughout the Permian Basin. In the area of this proposed well, the Devonian formation can be found at approximately 16,000' feet in total depth (~ -12,300' SS). The nearest Devonian production is in the Bell Lake Field about five miles east of this location. The Devonian in this area is estimated to be from 800'-1200' in total thickness and consists of a somewhat porous, tan dolomite capable of taking water from an injection well. Regional dip of the Devonian formation is to the southeast at a rate of about 100 feet per mile.

Immediately above the Devonian is the Woodford Shale. This shale formation is approximately 150-200 feet thick and is found immediately above the top of the Devonian in this region. Additional barrier geology above the Devonian and the Woodford would be the Wolfcamp shale and the massive Rustler formation, both of which are found between the proposed injection interval within the Devonian and the lowermost underground source of drinking water (USDW). In the region of this proposed well, these formations can be found at 14,800' (-11,100' SS) and 1200' (2500' SS) respectively.

At the proposed depth of 17,500', the well should TD approximately 1500 feet below the estimated top of the Devonian. Casing shoe depth and final TD will be determined by mud logging, drilling records, and openhole logging to ensure that the target interval remains Devonian and possibly upper Montoya. Once the Devonian has been determined, the casing shoe depth will be set at the top of the Devonian with the gross injection interval being the openhole section found within the formation. *In any event, the interval will likely be contracted between a maximum of 16,000' to 18,000'*

Fresh water in the area is generally available from the Santa Rosa formation. State Engineer's records show water wells in the area to have an average depth of 347 feet and a minimum of 225 feet.

There are 2 water wells located within one mile (both to NE) of the proposed SWD. Analyses will be forwarded to NMOCD upon receipt.

C-108 – Item VIII

Geologic Information – Depth to Groundwater (2 water wells within 1 mile of proposed SWD.)



New Mexico Office of the State Engineer Water Column/Average Depth to Water

(A CLW##### in the
POD suffix indicates the
POD has been replaced
& no longer serves a
water right file.)

(R=POD has
been replaced,
O=orphaned,
C=the file is
closed)

(quarters are 1=NW 2=NE 3=SW 4=SE)

(quarters are smallest to largest) (NAD83 UTM in meters)

(In feet)

POD Number	POD Sub- Code	basin	County	Q 64	Q 16	Q 4	Sec	Tws	Rng	X	Y	Depth Well	Depth Water	Water Column
C 02275		LE		3	3	2	19	23S	33E	630843	3573557*	650	400	250
C 02276		LE		3	1	4	19	23S	33E	630848	3573154*	650	400	250
C 02277		LE		2	3	4	20	23S	33E	632663	3572970*	550	400	150
C 02278		LE		3	4	2	28	23S	33E	634484	3571989*	650	400	250
C 02279		LE		3	4	3	28	23S	33E	633691	3571173*	650	400	250
C 02280		LE		3	2	4	28	23S	33E	634489	3571586*	650	400	250
C 02281		LE		3	4	4	28	23S	33E	634495	3571183*	545	400	145
C 02282		LE		3	1	1	25	23S	33E	638098	3572436*	325	225	100
C 02283		LE		4	2	2	26	23S	33E	637896	3572431*	325	225	100
C 02284		LE		4	2	4	26	23S	33E	637907	3571626*	325	225	100
C 03582 POD1	C	LE		4	1	1	14	23S	33E	636583	3575666	590		

Average Depth to Water: 347 feet

Minimum Depth: 225 feet

Maximum Depth: 400 feet

Record Count: 11

PLSS Search:

Township: 23S

Range: 33E

*UTM location was derived from PLSS - see Help

The data is furnished by the NMOSE/ISC and is accepted by the recipient with the expressed understanding that the OSE/ISC make no warranties, expressed or implied, concerning the accuracy, completeness, reliability, usability, or suitability for any particular purpose of the data.

4/1/15 10:51 AM

Page 1 of 1

WATER COLUMN/ AVERAGE
DEPTH TO WATER

C-108 ITEM XII – GEOLOGIC AFFIRMATION

We have examined available geologic and engineering data and have found no evidence of open faults or other hydrologic connection between the disposal interval and any underground sources of drinking water.



Ben Stone, Partner
SOS Consulting, LLC

Project: Owl SWD Operating, LLC
Brininstool SWD No.3
Reviewed 5/28/2015

Brininstool SWD Well No.3 - Leasehold Plat
(Attachment to NMOCD Form C-108, Application for Authority to Inject.)

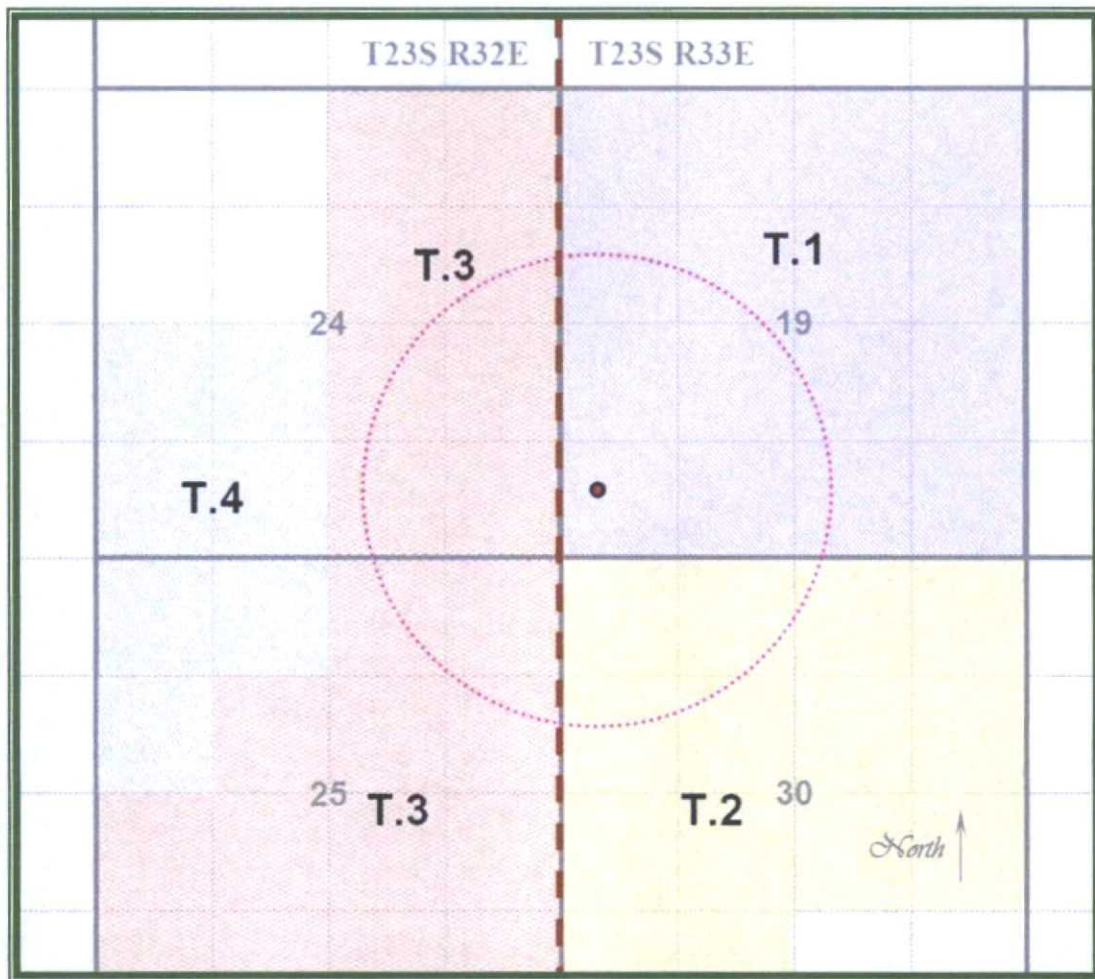

Owl SWD Operating, LLC

LEGEND

T.1 – NMLC-0068848 – ConocoPhillips Company

(Private Surface – Brininstool Ranch)

T.2 – NMNM-031224 – ConocoPhillips Company

T.3 – NMLC-063228 – ConocoPhillips Company

T.4 – NMNM-086154 – Devon Energy Production Co.

**C-108 ITEM XIII – PROOF OF NOTIFICATION
INTERESTED PARTIES LIST**

SURFACE OWNER

- 1 BRININSTOOL XL RANCH, LLC
P.O. Box 940
Jal, New Mexico 88252

MINERALS LESSEES and OPERATORS (*Including Offsetting*)

(All Notified via USPS Certified Mail)

BLM Leases NMLC-0068848; NMNM-031224; NMLC-063228

Lessee

- 2 CONOCOPHILLIPS
P.O. Box 7500
Bartlesville , OK 74005

Operator

- 3 CIMEREX ENERGY COMPANY
600 N. Marienfeld Street, Ste.600
Midland, TX 79701

BLM Leases NMLC-0068848

Lessee / Operator

- 4 DEVON ENERGY PRODUCTION COMPANY, LP
333 W. Sheridan
OKC, OK 73102

MINERALS OWNER (*Including Offsetting*)

(All Notified via USPS Certified Mail)

- 5 U.S. DEPARTMENT OF INTERIOR
Bureau of Land Management
Oil & Gas Division
620 E. Greene St.
Carlsbad, NM 88220

REGULATORY

NEW MEXICO OIL CONSERVATION DIVISION (FedEx'ed original and copy)
1220 S. St. Francis Dr.
Santa Fe, NM 87505

NEW MEXICO OIL CONSERVATION DIVISION (FedEx'ed copy)
1625 S. French Drive
Hobbs, NM 88240



June 24, 2015

NOTIFICATION TO INTERESTED PARTIES

via U.S. Certified Mail

To Whom It May Concern:

Owl SWD Operating, LLC, Dallas, Texas, has made application to the New Mexico Oil Conservation Division to drill and complete for salt water disposal the Brininstool Ranch SWD Well No.3. The proposed SWD will be for commercial use. As indicated in the notice below, the well will be located in Section 19, Township 23 South, Range 33 East in Lea County, New Mexico.

The disposal interval will be through openhole from 16,000 feet to 18,000 feet in the Devonian formation.

Following is the legal notice published in the Hobbs News-Sun, Hobbs, New Mexico on or about June 2, 2015.

LEGAL NOTICE

Owl SWD Operating, LLC, 8214 Westchester Dr., Ste.850, Dallas, TX 75255 is filing Form C-108 (Application for Authority to Inject) with the New Mexico Oil Conservation Division for administrative approval to [drill and] permit for salt water disposal its Brininstool Ranch SWD Well No.3. The well will be located 784' FSL & 419' FWL in Section 19, Township 23 South, Range 33 East in Lea County, New Mexico. Produced water from area production will be commercially disposed into the Devonian and Silurian (Upper Montoya) formations, as encountered and identified by log analysis, through an openhole completion between a maximum applied for top of 16,000 feet to maximum depth of 18,000 feet. (Actual interval will vary only by depth setting of casing and DTD when desired porosity interval is exposed meaning, total depth of the well could be slightly shallower and casing shoe deeper.) The maximum injection pressure will be 3200 psi surface (or 0.2 psi/ft gradient to uppermost injection interval) and a maximum rate limited only by such pressure.

Interested parties wishing to object to the proposed application must file with the New Mexico Oil Conservation Division, 1220 St. Francis Dr., Santa Fe, NM 87505, (505)476-3460 within 15 days of the date of this notice. Additional information may be obtained from the applicant's agent, SOS Consulting, LLC, (903)488-9850 or, email info@sosconsulting.us.

You have been identified as a party who may be interested as an offset lessee or operator.

You are entitled to a full copy of the application. A full copy in PDF format on a mini-CD will be arriving within a few days of this notice. If you do not receive it, please call or email SOS Consulting, LLC at 903-488-9850, info@sosconsulting.us, and a copy will be expedited to you and may also be sent via email if preferred.

Thank you for your attention in this matter.

Best regards,

A handwritten signature in black ink, appearing to read "Ben Stone". The signature is fluid and cursive, with the first name "Ben" and last name "Stone" clearly distinguishable.

Ben Stone, SOS Consulting, LLC
Agent for Owl SWD Operating, LLC

Cc: Application File

C-108 - Item XIV

Proof of Notice (Certified Mail Receipts)

7015 0640 0007 9482 5073

U.S. Postal Service™
CERTIFIED MAIL® RECEIPT
Domestic Mail Only

For delivery information, visit our website at www.usps.com®.

OFFICIAL USE

Certified Mail Fee \$ 345

Extra Services & Fees (check box, add fee as appropriate)

☐ Return Receipt (hardcopy) \$ 285

☐ Return Receipt (electronic) \$

☐ Certified Mail Restricted Delivery \$

☐ Adult Signature Required \$

☐ Adult Signature Restricted Delivery \$

Postage \$ 49

Total Postage and Fees \$ 674

Sent To

Street and Apt. BRININSTOOL XL RANCH, LLC

City, State, Zip P.O. Box 940
Jal, New Mexico 88252

PS Form 3800

For delivery information, visit our website at www.usps.com®.

OFFICIAL USE

Certified Mail Fee \$ 345

Extra Services & Fees (check box, add fee as appropriate)

☐ Return Receipt (hardcopy) \$ 285

☐ Return Receipt (electronic) \$

☐ Certified Mail Restricted Delivery \$

☐ Adult Signature Required \$

☐ Adult Signature Restricted Delivery \$

Postage \$ 49

Total Postage and Fees \$ 674

Sent To

Street and Apt. CIMEREX ENERGY COMPANY

City, State, Zip 600 N. Marienfeld Street, Ste.600
Midland, TX 79701

PS Form 3800

Postmark Here JUN 26 2015

7015 0640 0007 9482 5080

U.S. Postal Service™
CERTIFIED MAIL® RECEIPT
Domestic Mail Only

For delivery information, visit our website at www.usps.com®.

OFFICIAL USE

Certified Mail Fee \$ 345

Extra Services & Fees (check box, add fee as appropriate)

☐ Return Receipt (hardcopy) \$ 285

☐ Return Receipt (electronic) \$

☐ Certified Mail Restricted Delivery \$

☐ Adult Signature Required \$

☐ Adult Signature Restricted Delivery \$

Postage \$ 49

Total Postage and Fees \$ 674

Sent To

Street and Apt. CONOCO PHILLIPS

City, State, Zip P.O. Box 7500
Bartlesville, OK 74005-7500

PS Form 3800

For delivery information, visit our website at www.usps.com®.

OFFICIAL USE

Certified Mail Fee \$ 345

Extra Services & Fees (check box, add fee as appropriate)

☐ Return Receipt (hardcopy) \$ 285

☐ Return Receipt (electronic) \$

☐ Certified Mail Restricted Delivery \$

☐ Adult Signature Required \$

☐ Adult Signature Restricted Delivery \$

Postage \$ 49

Total Postage and Fees \$ 674

Sent To

Street and Apt. DEVON ENERGY PROD. CO., LP

City, State, Zip 333 W. Sheridan
OKC, OK 73102

PS Form 3800

Postmark Here JUN 26 2015

7015 0640 0007 9482 51

For delivery information, visit our website at www.usps.com®.

OFFICIAL USE

Certified Mail Fee \$ 345

Extra Services & Fees (check box, add fee as appropriate)

☐ Return Receipt (hardcopy) \$ 285

☐ Return Receipt (electronic) \$

☐ Certified Mail Restricted Delivery \$

☐ Adult Signature Required \$

☐ Adult Signature Restricted Delivery \$

Postage \$ 49

Total Postage and Fees \$ 674

Sent To

Street and Apt. Bureau of Land Management

City, State, Zip Carlsbad Field Office - O&G Division
620 E. Greene St.
Carlsbad, NM 88220

PS Form 3800

Postmark Here JUN 26 2015

Affidavit of Publication

STATE OF NEW MEXICO
COUNTY OF LEA

I, Daniel Russell, Publisher of the Hobbs News-Sun, a newspaper published at Hobbs, New Mexico, solemnly swear that the clipping attached hereto was published in the regular and entire issue of said newspaper, and not a supplement thereof for a period of 1 issue(s).

Beginning with the issue dated
June 02, 2015
and ending with the issue dated
June 02, 2015.

Publisher

Sworn and subscribed to before me this
2nd day of June 2015.

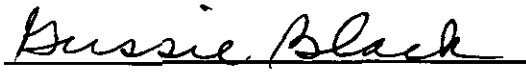
Business Manager

My commission expires
January 29, 2019
(Seal)

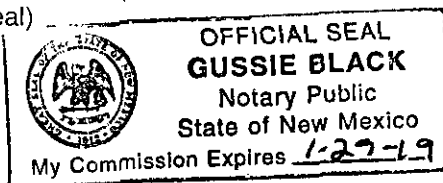

This newspaper is duly qualified to publish legal notices or advertisements within the meaning of Section 3, Chapter 167, Laws of 1937 and payment of fees for said

LEGALS

LEGAL NOTICE June 2, 2015

Owl SWD Operating, LLC,
8214 Westchester Dr.,
Ste. 850, Dallas, TX 75255 is
filing Form C-108
(Application for Authority to
Inject) with the New Mexico
Oil Conservation Division for
administrative approval to
[drill and] permit for salt
water disposal its Brinistool
Ranch SWD Well No.3. The
well will be located 784' FSL
& 419' FWL in Section 19,
Township 23 South, Range
33 East in Lea County, New
Mexico. Produced water
from area production will be
commercially disposed into
the Devonian and Silurian
(Upper Montoya) formations,
as encountered and
identified by log analysis;
through an openhole
completion between a
maximum applied for top of
16,000 feet to maximum
depth of 18,000 feet. (Actual
interval will vary only by
depth setting of casing and
DTD when desired porosity
interval is exposed meaning,
total depth of the well could
be slightly shallower and
casing shoe deeper.) The
maximum injection pressure
will be 3200 psi surface (or
0.2 psi/ft gradient to
uppermost injection interval)
and a maximum rate limited
only by such pressure.

Interested parties wishing to
object to the proposed
application must file with the
New Mexico Oil
Conservation Division, 1220
St. Francis Dr., Santa Fe,
NM 87505, (505)476-3460
within 15 days of the date of
this notice. Additional
information may be obtained
from the applicant's agent,
SOS Consulting, LLC,
(903)488-9850 or email
info@sosconsulting.us.
#30072

67104420

00157416

BEN STONE
SOS CONSULTING, LLC.
P.O. BOX 300
COMO, TX 75431



C-108 Review Checklist: Received 10/15/2015 Add. Request: 925 Reply Date: 10/6 Suspended: _____ [Ver 15]

ORDER TYPE: WFX / PMX / (SWD) Number: _____ Order Date: _____ Legacy Permits/Orders: _____

Well No. 3 Well Name(s): Brinninstool SWD

API: 30-0 25-42760 Spud Date: PBN New or Old: N (UIC Class II Primacy 03/07/1982)

Footages 784 FSL 419 FSL Lot (9) or Unit _____ Sec 14 Tsp 23S Rge 33E County Lea

General Location: 220miles NW JAI Pool: SWD, Devonian Pool No.: _____

BLM 100K Map: JAI Operator: SWD operating, LK OGRID: 30837 Contact: Ben Stone

COMPLIANCE RULE 5.9: Total Wells: 16 Inactive: 0 Fincl Assur: Y Compl. Order? Y IS 5.9 OK? Y Date: 10-14-2015

WELL FILE REVIEWED ☐ Current Status: Proposed

WELL DIAGRAMS: NEW: Proposed ☒ or RE-ENTER: Before Conv. ☐ After Conv. ☐ Logs in Imaging: _____

Planned Rehab Work to Well: CBL N/W Liner & 2nd intermediate

Well Construction Details		Sizes (in) Borehole / Pipe	Setting Depths (ft)	Cement Sx or Cf	Cement Top and Determination Method
Planned ___ or Existing ___ Surface		<u>24 / 20</u>	<u>1300</u>	<u>1471</u>	<u>SURFCEAL / VIS44</u>
Planned ___ or Existing ___ Interm/Prod		<u>17 1/2 / 13 3/8</u>	<u>5150</u>	<u>4233</u>	<u>SURFCEAL / VIS44</u>
Planned ___ or Existing ___ Interm/Prod		<u>12 1/4 / 9 1/8</u>	<u>12000</u>	<u>2803</u>	<u>SURFCEAL / VIS44</u>
Planned ___ or Existing ___ Prod/Liner					
Planned ___ or Existing ___ Liner		<u>8 1/2" / 7"</u>	<u>17000</u>	<u>691</u>	<u>11800 / CBL</u>
Planned ___ or Existing ___ OH / PERF		<u>17000 / 17000</u>		<u>150</u>	

Injection Lithostratigraphic Units	Depths (ft)	Injection or Confining Units	Tops
Adjacent Unit: Litho. Struc. Por.	<u>WJ</u>		<u>16850</u>
Confining Unit: Litho. Struc. Por.		<u>DV</u>	<u>17000</u>
Proposed Inj Interval TOP:			
Proposed Inj Interval BOTTOM:			
Confining Unit: Litho. Struc. Por.			
Adjacent Unit: Litho. Struc. Por.			

Completion/Operation Details:	
Drilled TD <u>17000</u>	PBTD _____
NEW TD _____	NEW PBTD _____
NEW Open Hole <input checked="" type="radio"/> or NEW Perfs <input type="radio"/>	
Tubing Size <u>5 1/2</u> in.	Inter Coated? <u>Y</u>
Proposed Packer Depth <u>16300</u> ft	
Min. Packer Depth <u>15300</u> (100-ft limit)	
Proposed Max. Surface Press. <u>3700</u> psi	
Admin. Inj. Press. <u>3700</u> (0.2 psi per ft)	

AOR: Hydrologic and Geologic Information

POTASH: R-111-P _____ Noticed? MA BLM Sec Ord ☐ WIPP ☐ Noticed? _____ Salt/Salado T: _____ B: _____ NW: Cliff House fm _____

FRESH WATER: Aquifer Dockum Max Depth 400 HYDRO AFFIRM STATEMENT By Qualified Person ☒

NMOSE Basin: CARLSBAD CAPITAN REEF: thru adj NA No. Wells within 1-Mile Radius? _____ FW Analysis _____

Disposal Fluid: Formation Source(s) Bone Springs Analysis? Y On Lease ☐ Operator Only ☐ or Commercial ☒

Disposal Int: Inject Rate (Avg/Max BWPD): 15000/3000 Protectable Waters? Y Source: _____ System: Closed ☒ or Open

HC Potential: Producing Interval? NA Formerly Producing? _____ Method: Logs ☒ DST ☐ P&A ☐ Other PSCTH 2-Mile Radius Pool Map ☐

AOR Wells: 1/2-M Radius Map? Y Well List? _____ Total No. Wells Penetrating Interval: 0 Horizontals? 0

Penetrating Wells: No. Active Wells 1 Num Repairs? _____ on which well(s)? _____ Diagrams? _____

Penetrating Wells: No. P&A Wells _____ Num Repairs? _____ on which well(s)? _____ Diagrams? _____

NOTICE: Newspaper Date 9-21-2015 Mineral Owner BLM Surface Owner Brinninstool N. Date 6-26

RULE 26.7(A): Identified Tracts? Y Affected Persons: Cimarex, BLM N. Date 6-26-2015

Order Conditions: Issues: _____

Add Order Cond: _____



New Mexico Office of the State Engineer

Water Column/Average Depth to Water

(A CLW##### in the
POD suffix indicates the
POD has been replaced
& no longer serves a
water right file.)

(R=POD has
been replaced,
O=orphaned,
C=the file is

closed) (quarters are 1=NW 2=NE 3=SW 4=SE)
(quarters are smallest to largest)

(NAD83 UTM in meters) (In feet)

POD Number	POD Sub-Code	basin	County	Q	Q	Q	Sec	Tws	Rng	X	Y	Depth Well	Depth Water	Water Column
C 02275		LE		3	3	2	19	23S	33E	630843	3573557*	650	400	250
C 02276		LE		3	1	4	19	23S	33E	630848	3573154*	650	400	250
C 02277		LE		2	3	4	20	23S	33E	632663	3572970*	550	400	150

Average Depth to Water: 400 feet

Minimum Depth: 400 feet

Maximum Depth: 400 feet

Record Count: 3

PLSS Search:

Section(s): 17-20

Township: 23S

Range: 33E

*UTM location was derived from PLSS - see Help

The data is furnished by the NMOSE/ISC and is accepted by the recipient with the expressed understanding that the OSE/ISC make no warranties, expressed or implied, concerning the accuracy, completeness, reliability, usability, or suitability for any particular purpose of the data.

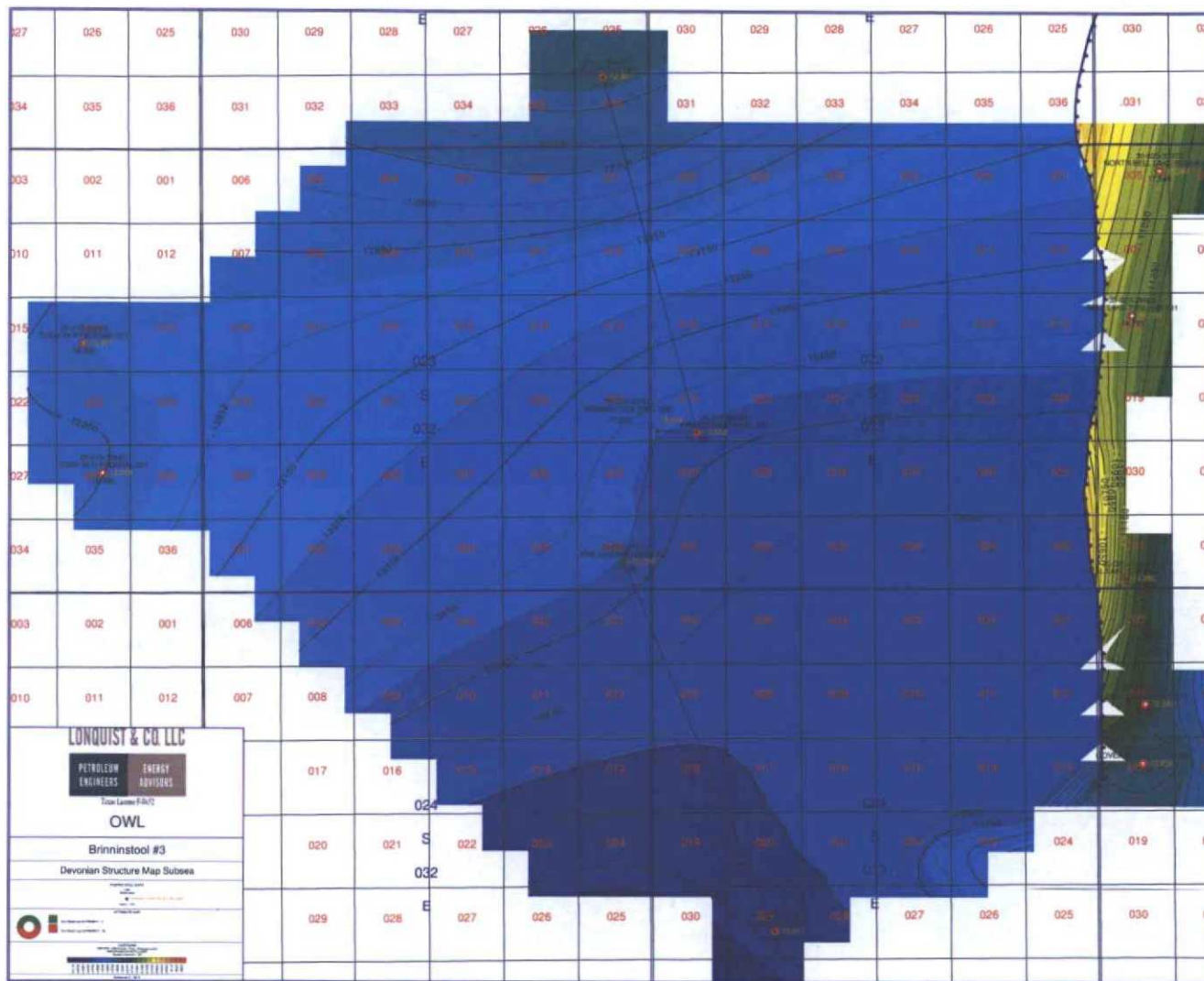

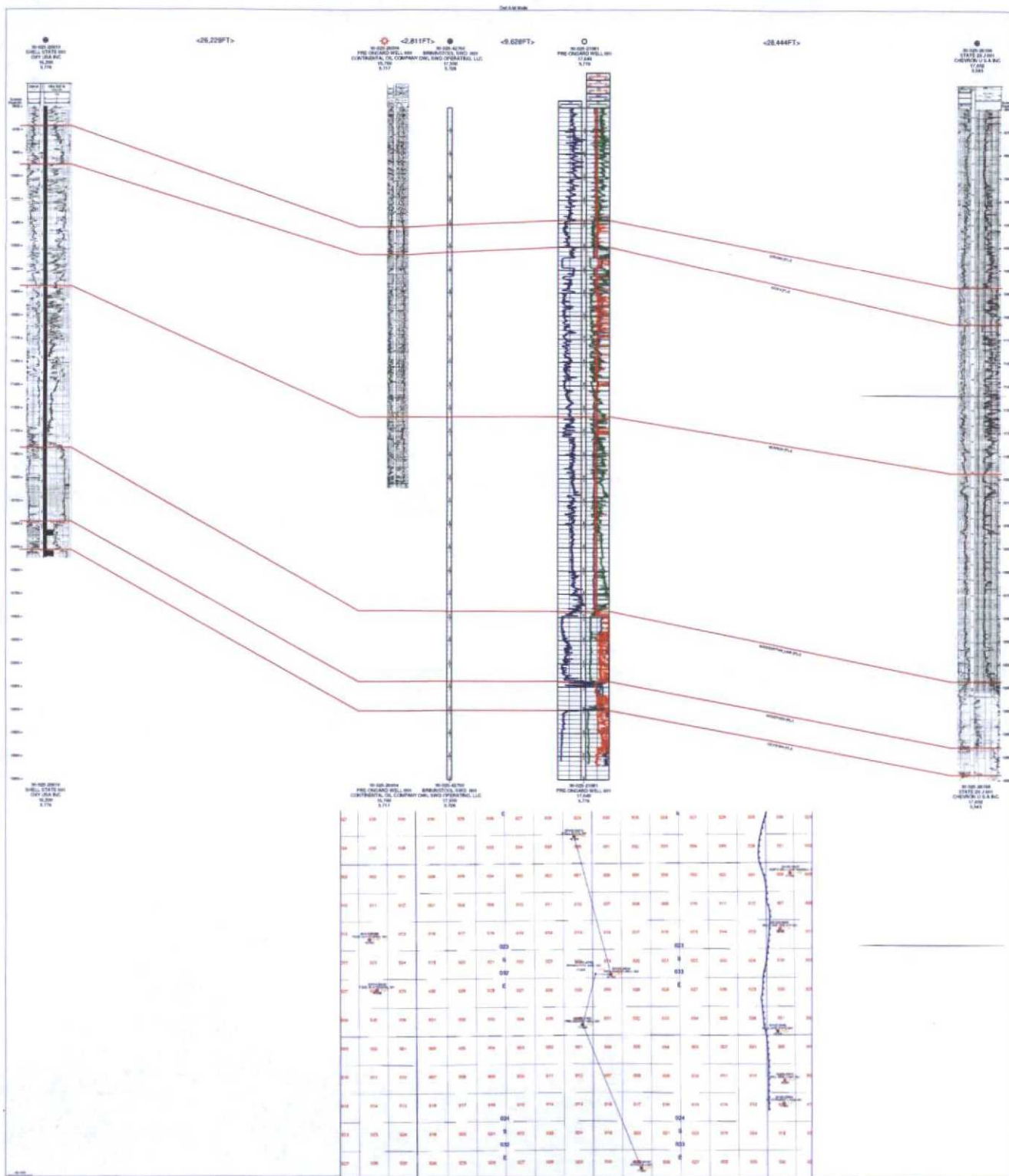

Affidavit of Publication

STATE OF NEW MEXICO
COUNTY OF LEA

I, Gussie Black, Business Manager of the Hobbs News-Sun, a newspaper published at Hobbs, New Mexico, solemnly swear that the clipping attached hereto was published in the regular and entire issue of said newspaper, and not a supplement thereof for a period of 1 issue(s).

Beginning with the issue dated
September 27, 2015
and ending with the issue dated
September 27, 2015.

Gussie Black
Business Manager

Sworn and subscribed to before me this
27th day of September 2015.

Yezenia Calderon
Circulation Coordinator

My commission expires
February 28, 2016
(Seal)

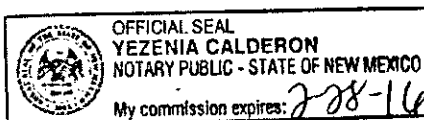

This newspaper is duly qualified to publish legal notices or advertisements within the meaning of Section 3, Chapter 167, Laws of 1937 and payment of fees for said

received
10-05-2015

LEGAL NOTICE
September 27, 2015

Owl SWD Operating, LLC, 8214 Westchester Dr., Ste. 850, Dallas, TX 75255 is filing Form C-108 (Application for Authority to Inject) with the New Mexico Oil Conservation Division for administrative approval to [drill and] permit for salt water disposal its Brininstool Ranch SWD Well No.3. The well will be located 784' FSL & 419' FWL in Section 19, Township 23 South, Range 33 East in Lea County, New Mexico. Produced water from area production will be commercially disposed into the Devonian and Silurian (Upper Montoya) formations, as encountered and identified by log analysis, through an openhole completion between a maximum applied for top of 17,000 feet to maximum depth of 18,500 feet. (Actual interval will vary only by depth setting of casing and DTD when desired porosity interval is exposed meaning total depth of the well could be slightly shallower and casing shoe deeper.) The maximum injection pressure will be 3400 psi surface (or 0.2 psi/ft gradient to uppermost injection interval) and a maximum rate limited only by such pressure.

Interested parties wishing to object to the proposed application must file with the New Mexico Oil Conservation Division, 1220 St. Francis Dr., Santa Fe, NM 87505, (505) 476-3460 within 15 days of the date of this notice. Additional information may be obtained from the applicant's agent SOS Consulting, LLC, (903) 488-9850 or email info@sosconsulting.us. #30349

67104420

00163777

BEN STONE
SOS CONSULTING, LLC.
P.O. BOX 300
COMO, TX 75431

Affidavit of Publication

STATE OF NEW MEXICO
COUNTY OF LEA

RECEIVED OCD

2015 OCT -6 A 2:55

I, Gussie Black, Business Manager of the Hobbs News-Sun, a newspaper published at Hobbs, New Mexico, solemnly swear that the clipping attached hereto was published in the regular and entire issue of said newspaper, and not a supplement thereof for a period of 1 issue(s).

Beginning with the issue dated
September 27, 2015
and ending with the issue dated
September 27, 2015.

Gussie Black

Business Manager

Sworn and subscribed to before me this
27th day of September 2015.

Yezenia Calderon

Circulation Coordinator

My commission expires
February 28, 2016
(Seal)

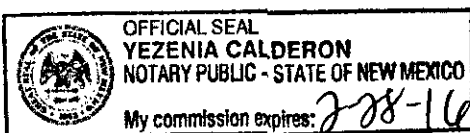

This newspaper is duly qualified to publish legal notices or advertisements within the meaning of Section 3, Chapter 167, Laws of 1937 and payment of fees for said

LEGAL NOTICE September 27, 2015

Owl SWD Operating, LLC, 8214 Westchester Dr., Ste. 850, Dallas, TX 75255 is filing Form C-108 (Application for Authority to Inject) with the New Mexico Oil Conservation Division for administrative approval to [drill and] permit for salt water disposal its Brininstool Ranch SWD Well No.3. The well will be located 784' FSL & 419' FWL in Section 19, Township 23 South, Range 33 East in Lea County, New Mexico. Produced water from area production will be commercially disposed into the Devonian and Silurian (Upper Montoya) formations, as encountered and identified by log analysis, through an openhole completion between a maximum applied for top of 17,000 feet to maximum depth of 18,500 feet. (Actual interval will vary only by depth setting of casing and DTD when desired porosity interval is exposed meaning, total depth of the well could be slightly shallower and casing shoe deeper.) The maximum injection pressure will be 3400 psi surface (or 0.2 psi/ft gradient to uppermost injection interval) and a maximum rate limited only by such pressure.

Interested parties wishing to object to the proposed application must file with the New Mexico Oil Conservation Division, 1220 St. Francis Dr., Santa Fe, NM 87505, (505)476-3460 within 15 days of the date of this notice. Additional information may be obtained from the applicant's agent, SOS Consulting, LLC, (903)488-9850 or, email info@sosconsulting.us. #30349

67104420

00163777

BEN STONE
SOS CONSULTING, LLC.
P.O. BOX 300
COMO, TX 75431

LEGAL NOTICE
September 27, 2015

Owl SWD Operating, LLC,
8214 Westchester Dr.,
Ste.850, Dallas, TX 75255 is
filing Form C-108
(Application for Authority to
Inject) with the New Mexico
Oil Conservation Division for
administrative approval to
(drill and) permit for salt
water disposal its Brininstool
Ranch SWD Well No.3. The
well will be located 784' FSL
& 419' FWL in Section 19,
Township 23 South, Range
33 East in Lea County, New
Mexico. Produced water
from area production will be
commercially disposed into
the Devonian and Silurian
(Upper Montoya) formations,
as encountered and
identified by log analysis,
through an openhole
completion between a
maximum applied for top of
17,000 feet to maximum
depth of 18,500 feet. (Actual
interval will vary only by
depth setting of casing and
DTD when desired porosity
interval is exposed meaning,
total depth of the well could
be slightly shallower and
casing shoe deeper.) The
maximum injection pressure
will be 3400 psi surface (or
0.2 psi/ft gradient to
uppermost injection interval)
and a maximum rate limited
only by such pressure.

Interested parties wishing to
object to the proposed
application must file with the
New Mexico Oil
Conservation Division, 1220
St. Francis Dr., Santa Fe,
NM 87505, (505)476-3460
within 15 days of the date of
this notice. Additional
information may be obtained
from the applicant's agent,
SOS Consulting, LLC,
(903)488-9850 or, email
info@sosconsulting.us.
#30349