

11/06/2015 DATE IN	SUSPENSE	MAM ENGINEER	W03/2015 LOGGED IN	NSL TYPE	PMAM1531331046 APP NO.
-----------------------	----------	-----------------	-----------------------	-------------	---------------------------

ABOVE THIS LINE FOR DIVISION USE ONLY

NEW MEXICO OIL CONSERVATION DIVISION
- Engineering Bureau -
1220 South St. Francis Drive, Santa Fe, NM 87505



ADMINISTRATIVE APPLICATION CHECKLIST

THIS CHECKLIST IS MANDATORY FOR ALL ADMINISTRATIVE APPLICATIONS FOR EXCEPTIONS TO DIVISION RULES AND REGULATIONS WHICH REQUIRE PROCESSING AT THE DIVISION LEVEL IN SANTA FE

Application Acronyms:

[NSL-Non-Standard Location] [NSP-Non-Standard Proration Unit] [SD-Simultaneous Dedication]
[DHC-Downhole Commingling] [CTB-Lease Commingling] [PLC-Pool/Lease Commingling]
[PC-Pool Commingling] [OLS - Off-Lease Storage] [OLM-Off-Lease Measurement]
[WFX-Waterflood Expansion] [PMX-Pressure Maintenance Expansion]
[SWD-Salt Water Disposal] [IPI-Injection Pressure Increase]
[EOR-Qualified Enhanced Oil Recovery Certification] [PPR-Positive Production Response]

[1] **TYPE OF APPLICATION** - Check Those Which Apply for [A]

[A] ☒ Location - Spacing Unit - Simultaneous Dedication
☒ NSL ☐ NSP ☐ SD

Check One Only for [B] or [C]

[B] ☐ Commingling - Storage - Measurement
☐ DHC ☐ CTB ☐ PLC ☐ PC ☐ OLS ☐ OLM

[C] ☐ Injection - Disposal - Pressure Increase - Enhanced Oil Recovery
☐ WFX ☐ PMX ☐ SWD ☐ IPI ☐ EOR ☐ PPR

[D] Other: Specify _____

[2] **NOTIFICATION REQUIRED TO:** - Check Those Which Apply, or Does Not Apply

[A] ☒ Working, Royalty or Overriding Royalty Interest Owners

[B] ☒ Offset Operators, Leaseholders or Surface Owner

[C] ☐ Application is One Which Requires Published Legal Notice

[D] ☒ Notification and/or Concurrent Approval by BLM or SLO
U.S. Bureau of Land Management - Commissioner of Public Lands, State Land Office

[E] ☐ For all of the above, Proof of Notification or Publication is Attached, and/or, _____

[F] ☐ Waivers are Attached

[3] **SUBMIT ACCURATE AND COMPLETE INFORMATION REQUIRED TO PROCESS THE TYPE OF APPLICATION INDICATED ABOVE.**

[4] **CERTIFICATION:** I hereby certify that the information submitted with this application for administrative approval is **accurate** and **complete** to the best of my knowledge. I also understand that **no action** will be taken on this application until the required information and notifications are submitted to the Division.

Note: Statement must be completed by an individual with managerial and/or supervisory capacity.

Jordan L. Kessler
Print or Type Name

Signature

Attorney
Title

jlkessler@hollandhart.com
e-mail Address

Date

- NSL 7359
- EOG Resources
7377
WCH
- Brown Bear 36 State
47054
30-025-42840
2015 NOV - 6 P 4:19
RECEIVED OCD
PO4
- W-025 G-09
5253336 D: uppen
WAF&and
98094



November 6, 2015

VIA HAND DELIVERY

David Catanach
Oil Conservation Division
New Mexico Department of Energy,
Minerals and Natural Resources
1220 South Saint Francis Drive
Santa Fe, New Mexico 87505

RECEIVED OGD
2015 NOV - 6 P 4: 19

Re: Application of EOG Resources, Inc. for administrative approval of an unorthodox well location for its Brown Bear 36 State No. 705H Well in the E/2 W/2 of Section 36, Township 25 South, Range 33 East, N.M.P.M., Lea County, New Mexico.

Dear Mr. Catanach:

EOG Resources, Inc. (OGRID No. 7377) seeks administrative approval of an unorthodox well location for its **Brown Bear 36 State No. 705H Well** to be completed within the WC-025 G-09 S5253336D; Upper Wolfcamp (Pool Code 98094) underlying Section 36, Township 25 South, Range 33 East, N.M.P.M., Lea County, New Mexico. This well will be drilled from a surface location 220 feet from the South line and 1995 feet from the West line (Unit N) of Section 36. The upper most perforation will be located 330 feet from South line and 2633 feet from the West line (Unit N) and the lower most perforation will be 330 feet from the North line and 2633 feet from the West line of Section 36 (Unit C). Since this acreage is governed by the Division's statewide rules which provides for wells to be located no closer than 330 feet to the outer boundary of the spacing unit, the completed interval for this well will be unorthodox because it is closer than 330 feet to the eastern, southeastern, and northeastern boundaries of the project area. Approval of the unorthodox completed interval will allow for efficient spacing of horizontal wells and thereby prevent waste.

Exhibit A is the Well Location and Acreage Dedication Plat (Form C-102), which shows that the completed interval of the proposed **Brown Bear 36 State No. 705H Well** encroaches on the spacing and proration units to the East, Northeast, and Southeast.

Exhibit B is a land plat for Section 36 and the surrounding sections that shows the proposed **Brown Bear 36 State No. 705H Well** in relation to adjoining units and existing wells.

HOLLAND & HART^{LLP}



Exhibit C is a list of the parties affected by the encroachment to the East, Northeast, and Southeast. Each of these parties have been provided notice of this application by certified mail. EOG is the sole operator and mineral lessee of the state leases covering Section 36. Accordingly, there are no affected parties by the encroachment to the East. Nonetheless, a copy of this application has been provided to the New Mexico State Land Office and the Bureau of Land Management.

Your attention to this matter is appreciated.

Sincerely,

Jordan L. Kessler

ATTORNEY FOR EOG RESOURCES, INC.

cc: New Mexico State Land Office
P.O. Box 1148
Santa Fe, NM 87504

Bureau of Land Management
620 E. Green Street
Carlsbad, NM 88220

District I
1625 N. French Dr., Hobbs, NM 88240
Phone: (575) 393-6161 Fax: (575) 393-0720
District II
811 S First St., Artesia, NM 88210
Phone: (575) 748-1283 Fax: (575) 748-0720
District III
1000 Rio Brazos Road, Aztec, NM 87410
Phone: (505) 334-6178 Fax: (505) 334-6170
District IV
1220 S St. Francis Dr., Santa Fe, NM 87505
Phone: (505) 476-3460 Fax: (505) 476-3462

State of New Mexico
Energy, Minerals & Natural Resources
Department
OIL CONSERVATION DIVISION
1220 South St. Francis Dr.
Santa Fe, NM 87505

FORM C-102
Revised August 1, 2011
Submit one copy to appropriate
District Office

☐ AMENDED REPORT

WELL LOCATION AND ACREAGE DEDICATION PLAT

¹ API Number 30-025- 42840	² Pool Code 98094	³ Pool Name WC-025 G-09 S5253336D; Upper Wolfcamp
⁴ Property Code 38961	⁵ Property Name BROWN BEAR 36 STATE	
⁶ OGRIID No. 7377	⁷ Operator Name EOG RESOURCES, INC.	⁸ Well Number #705H
		⁹ Elevation 3319'

¹⁰ Surface Location									
UL or lot no. N	Section 36	Township 25-S	Range 33-E	Lot ldn -	Feet from the 220'	North/South line SOUTH	Feet from the 1995'	East/West line WEST	County LEA

UL or lot no. C	Section 36	Township 25-S	Range 33-E	Lot ldn -	Feet from the 230'	North/South line NORTH	Feet from the 2633'	East/West line WEST	County LEA
---------------------------	----------------------	-------------------------	----------------------	---------------------	------------------------------	----------------------------------	-------------------------------	-------------------------------	----------------------

¹¹ Dedicated Acres 160.00	¹² Joint or lot?	¹³ Consolidation Code	¹⁴ Order No.
--	-----------------------------	----------------------------------	-------------------------

No allowable will be assigned to this completion until all interests have been consolidated or a non-standard unit has been approved by the division.

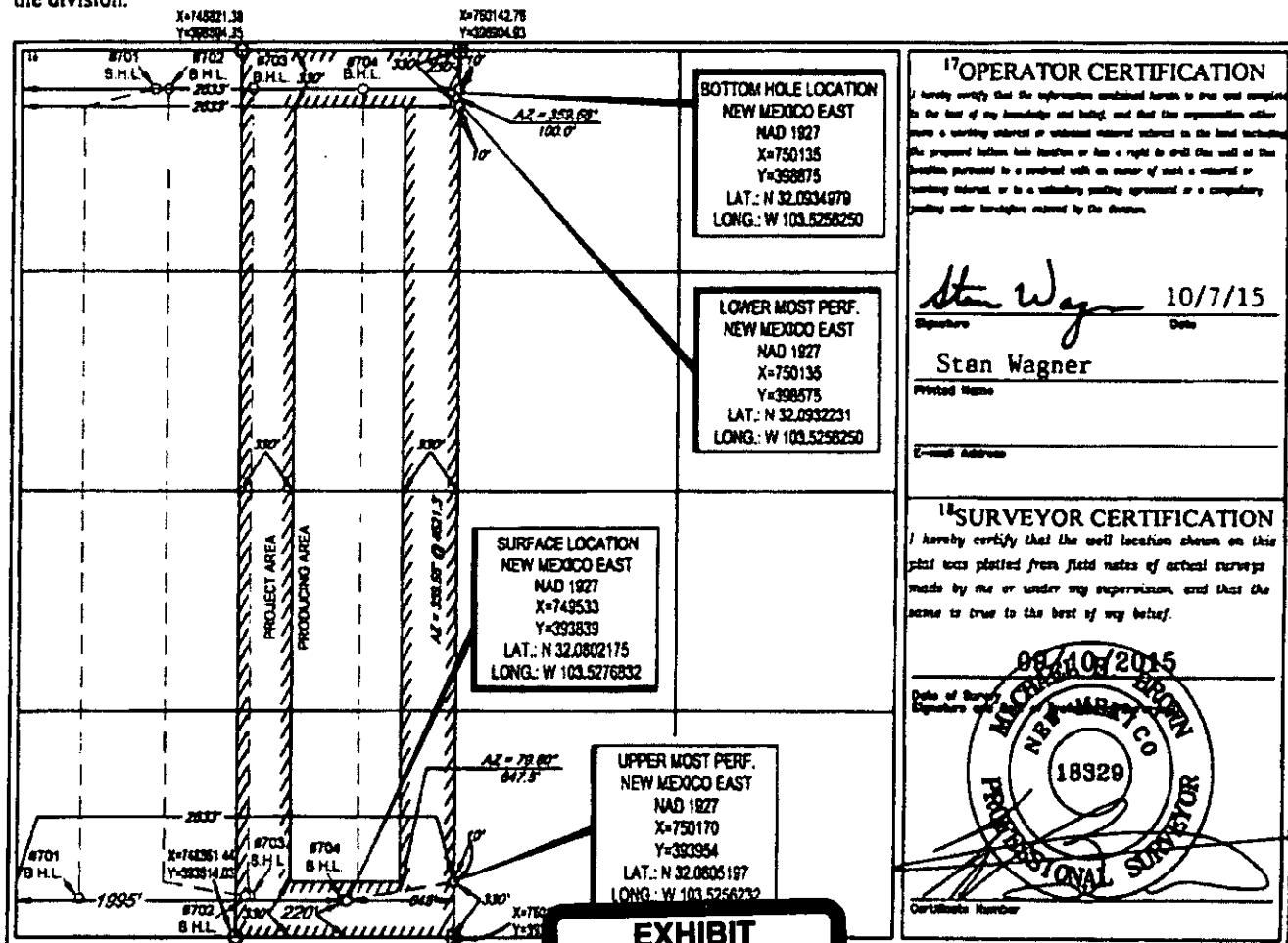

OCT 18 2015

**BROWN BEAR 36 STATE #705H UNORTHODOX LOCATION NOTICE TRACT PLAT
TOWNSHIPS 25 & 26 SOUTH RANGE 33 EAST, LEA COUNTY, NM**

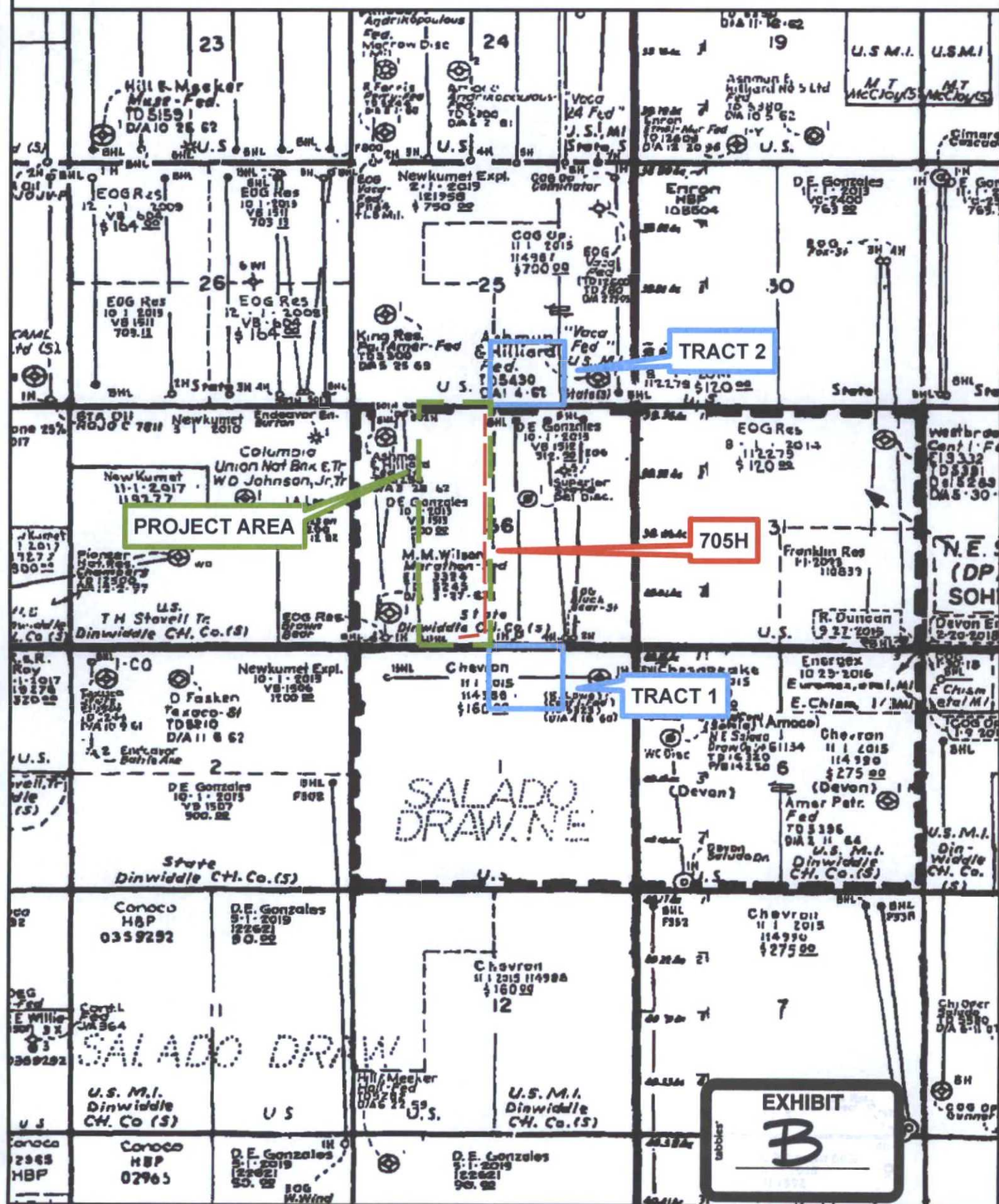

Exhibit C

Chevron USA, Inc. 1400 Smith St. Houston, TX 77002	Devon Energy Production, LP 333 W. Sheridan Ave. Oklahoma City, OK 73102
Endeavor Energy Resources, LP a Texas limited partnership 110 N. Marienfeld Ste. #200 Midland, TX 79701	COG Operating, LLC a Delaware limited liability company 600 W. Illinois Ave. Midland, TX 79701
Bradley S. Bates 101 Blackberry Court Midland, TX 79705	WBA Resources, Ltd. a Texas limited partnership 110 W. Louisiana Ste. #300 Midland, TX 79701
Sagebrush Interests, LLC 2450 Fondren Ste. #112 Houston, TX 77063	RSC Resources, LP a Texas limited partnership 6824 Island Circle Midland, TX 79707
Newkumet Exploration, Inc. Box 11330 Midland, TX 79702	Petras Energy, LP Box 4127 Midland, TX 79704

HOLLAND & HART^{LLP}



Jordan L. Kessler

Associate

Phone (505) 988-4421

Fax (505) 983-6043

jlkessler@hollandhart.com

November 6, 2015

VIA CERTIFIED MAIL
RETURN RECEIPT REQUESTED

TO AFFECTED PARTIES

Re: Application of EOG Resources, Inc. for administrative approval of an unorthodox well location for its Brown Bear 36 State No. 705H Well in the E/2 W/2 of Section 36, Township 25 South, Range 33 East, N.M.P.M., Lea County, New Mexico.

Ladies and Gentlemen:

Enclosed is a copy of the above-referenced application which was filed with the New Mexico Oil Conservation Division on this date. Any objection to this application must be filed in writing within twenty days from this date with the applicant and the New Mexico Oil Conservation Division, 1220 South St. Francis Drive, Santa Fe, New Mexico, 87505. If no objection is received within this twenty-day period, this application may be approved administratively by the Division.

If you have any questions about this application, please contact the following:

Paul Boland
EOG Resources, Inc.
(432) 686-3666
Paul_Boland@eogresources.com

Sincerely,

Jordan L. Kessler

ATTORNEY FOR EOG RESOURCES, INC.

Holland & Hart LLP

Phone [505] 988-4421 **Fax** [505] 983-6043 **www.hollandhart.com**

110 North Guadalupe Suite 1 Santa Fe, New Mexico 87501 **Mailing Address** P.O. Box 2208 Santa Fe, NM 87504-2208

Aspen Boulder Carson City Colorado Springs Denver Denver Tech Center Billings Boise Cheyenne Jackson Hole Las Vegas Reno Salt Lake City Santa Fe Washington, D.C. ☏