

**Stephens & Johnson Operating Company
Horse Pen
Section 12, Township 15 South, Range 37 East
Lea County, New Mexico**

Work Plan

July 28, 2009



Prepared for:

**Stephens & Johnson Operating Company
811 Sixth Street, Suite 300
Wichita Falls, Texas 76301-2509**

By:

***Safety & Environmental Solutions, Inc.
703 East Clinton
Hobbs, New Mexico 88240
(575) 397-0510***

I. Background

Safety & Environmental Solutions, Inc. (SESI) was engaged by Stephens & Johnson Operating Company to perform a site assessment located in Section 12, Township 15 South, and Range 37 East in Lea County, New Mexico. The area was impacted by the spillage of an undetermined amount of produced water from an injection line associated with production in the area. This remediation has been active since September 2003, however this site has been dormant for several years.

II. Surface and Ground Water

The nearest groundwater of record with the New Mexico State Engineer's Office is in Section 12 of 15 South, 37 East. According to measurements taken January 10, 1996, the depth to water in this well is 52.48 feet.

III. Soils

The soils in the area are predominantly sand and sandy loam.

IV. Work Performed

On May 12, 2009 Safety & Environmental Solutions, Inc was onsite to retrieve samples. Samples were retrieved 0 to 6 inches in depth throughout the bottom and sides of the excavation. All samples were transported under Chain of Custody to Ana-Lab of Kilgore, Texas for analysis. The samples were analyzed for Chlorides (EPA Method 300.00). The results of the analysis are as follows:

| DATE | ID | Cl ⁻ (mg/kg) |
|---------|-------|----------------------------|
| 5/12/09 | #1 | 1240 |
| 5/12/09 | #2 | 380 |
| 5/12/09 | #3 | 399 |
| 5/12/09 | #4 | 11800 |
| 5/12/09 | #5 | 3980 |
| 5/12/09 | #6 | 292 |
| 5/12/09 | #7 | 539 |
| 5/12/09 | #8 | 334 |
| 5/12/09 | #9 | 6.25 |
| 5/12/09 | #10 | 5690 |
| 5/12/09 | #11 | 81.3 |
| 5/12/09 | #12 | 2580 |
| 5/12/09 | SW #1 | 1630 |
| 5/12/09 | SW #2 | 7680 |
| 5/12/09 | SW #3 | 7390 |
| 5/12/09 | EW #1 | 8330 |
| 5/12/09 | EW #2 | 11600 |
| 5/12/09 | NW | 15500 |

V. Action Plan

The site will be delineated for vertical extent using an air rig. Samples will be retrieved in five (5) foot intervals. The samples collected will be properly preserved and transported along with Chain of Custody to Cardinal Laboratories, of Hobbs, New Mexico, for testing. Laboratory samples will be analyzed for Chlorides (EPA method 300.00).

After completion of the delineation, a report of the findings and an appropriate work plan will be filed with the New Mexico Oil Conservation Division (NMOCD).

VI. Figures & Appendices

Figure 1 - Vicinity Map

Figure 2 - Site Plan

Appendix A – Analytical Results

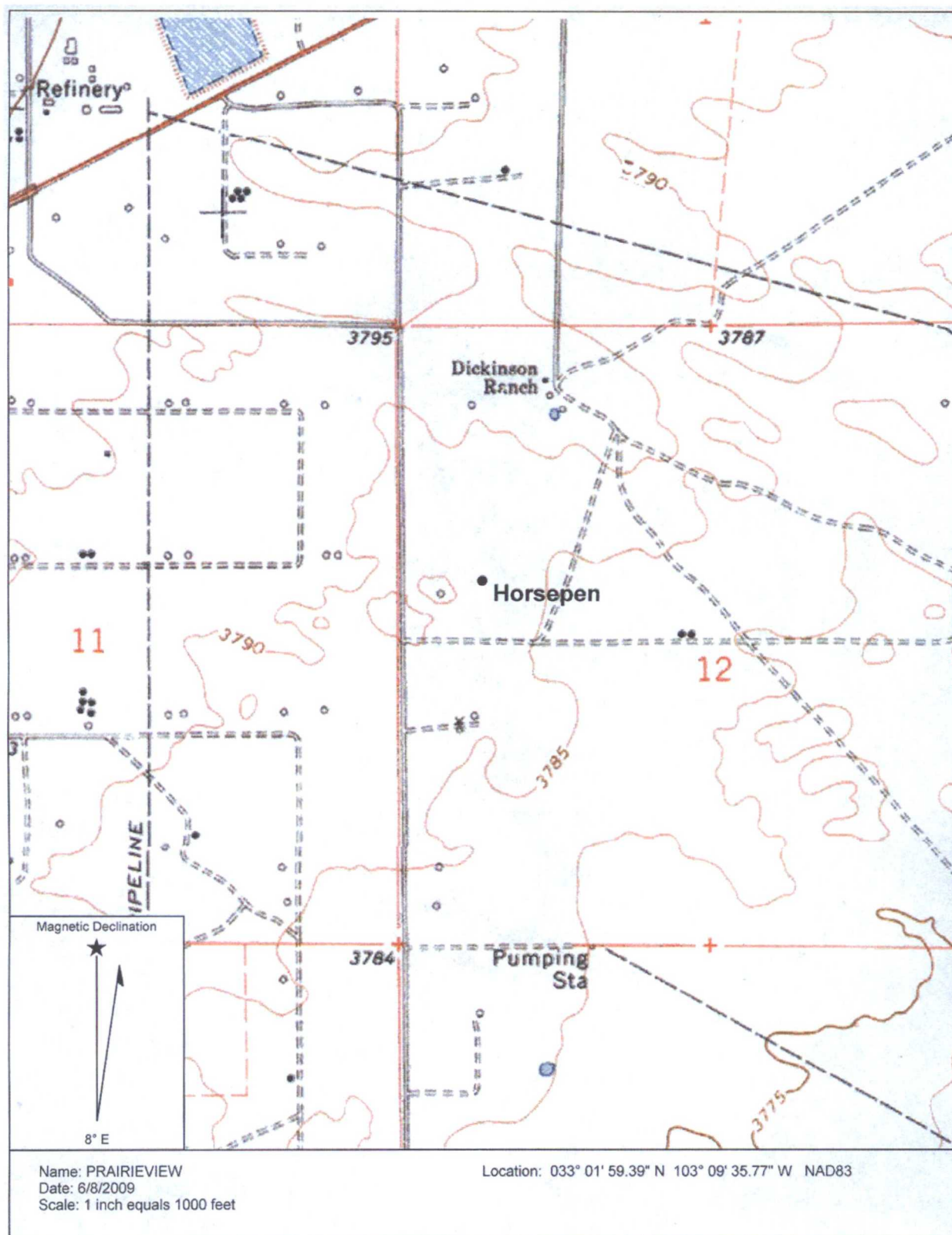

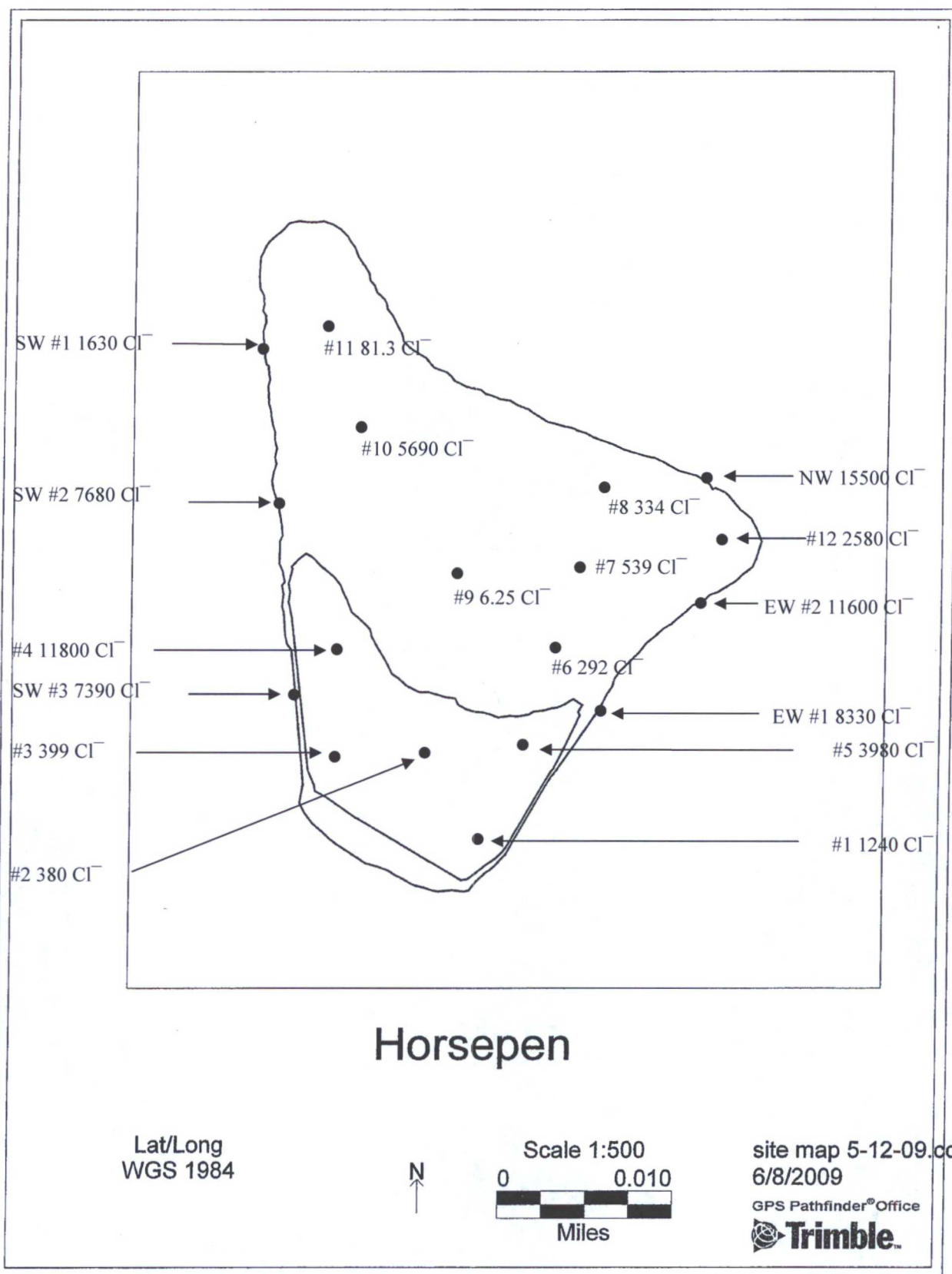



Ana-Lab Corp. P.O. Box 9000 Kilgore, TX 75663

Phone 903/764-0551 FAX 903/984-5914 e-Mail corp@ana-lab.com

LELAP-accredited #02008

Printed 05/22/2009 Page 1 of 1

Analytical Results

Report Table of Contents

Report To

Brian Cuellar
Safety & Environmental Solutio
703 E. Clinton
Hobbs, NM 88240

Account

SESF

Project

442485

Stevens & Johnson Horse Pen

This report consists of this Table of Contents and the following pages:

| <u>Report Name</u> | <u>Description</u> | <u>Pages</u> |
|-------------------------------|--|--------------|
| 442485_r03_03_ProjectResults | Ana-Lab Project P:442485 C:SESF Project Results | 7 |
| 442485_r10_05_PROJQCG | Ana-Lab Project P:442485 C:SESF Project Quality Control Groups | 2 |
| 442485_r99_09_CoC_SESF_1_of_1 | Ana-Lab CoC SESF 442485_1_of_1 | 3 |
| Total Pages: | | 12 |

Corporate Shipping: 2600 Dudley Rd. Kilgore, TX 75662



0-17025 # 0637-01

NELAP-accredited #T104704201-08-TX



2008 Seal of Excellence



Ana-Lab Corp. P.O. Box 9000 Kilgore, TX 75663

Phone 903/984-0551 FAX 903/984-5914 e-Mail corp@ana-lab.com

LELAP-accredited #02008

Results

Printed:

05/22/2009

Page 1 of 7

Report To

Brian Cuellar
Safety & Environmental Solutio
703 E. Clinton
Hobbs, NM 88240

Account
SESF-P

Project
442485

Stevens & Johnson Horse Pen

Results

| accredited | Parameter | Results | Units | RL | Flags | CAS | Bottle |
|---------------------------------|-----------|-------------------------|-------|---------------|----------------------|------------|----------------|
| 101342 | #1 | Received: 05/14/2009 | | | | | |
| Soil | | Collected by: I Kincaid | | Affiliation: | Safety & Environment | 05/12/2009 | 11:24 |
| SW-846 9056 | | | | Analyzed: LCY | 05/16/2009 | 1629 | QCgroup 318122 |
| AN Chloride (water extractable) | | 1240 | mg/kg | 60.0 | | | 02 |
| 101343 | #2 | Received: 05/14/2009 | | | | | |
| Soil | | Collected by: I Kincaid | | Affiliation: | Safety & Environment | 05/12/2009 | 11:26 |
| SW-846 9056 | | | | Analyzed: LCY | 05/16/2009 | 1647 | QCgroup 318122 |
| AN Chloride (water extractable) | | 380 | mg/kg | 30.0 | | | 02 |
| 101344 | #3 | Received: 05/14/2009 | | | | | |
| Soil | | Collected by: | | Affiliation: | Safety & Environment | 05/12/2009 | 11:28 |
| SW-846 9056 | | | | Analyzed: LCY | 05/16/2009 | 1704 | QCgroup 318122 |
| AN Chloride (water extractable) | | 399 | mg/kg | 30.0 | | | 02 |
| 101345 | #4 | Received: 05/14/2009 | | | | | |
| Soil | | Collected by: I Kincaid | | Affiliation: | Safety & Environment | 05/12/2009 | 11:30 |
| SW-846 9056 | | | | Analyzed: LCY | 05/16/2009 | 1722 | QCgroup 318122 |
| AN Chloride (water extractable) | | 11800 | mg/kg | 750 | | | 02 |
| 101346 | #5 | Received: 05/14/2009 | | | | | |
| Soil | | Collected by: I Kincaid | | Affiliation: | Safety & Environment | 05/12/2009 | 11:32 |
| SW-846 9056 | | | | Analyzed: LCY | 05/16/2009 | 1739 | QCgroup 318122 |
| AN Chloride (water extractable) | | 3980 | mg/kg | 150 | | | 02 |
| 101347 | #6 | Received: 05/14/2009 | | | | | |
| Soil | | Collected by: I Kincaid | | Affiliation: | Safety & Environment | 05/12/2009 | 11:36 |
| SW-846 9056 | | | | Analyzed: LCY | 05/16/2009 | 1757 | QCgroup 318122 |
| Chloride (water extractable) | | 292 | mg/kg | 15.0 | | | 02 |

Corporate Shipping: 2600 Dudley Rd. Kilgore, TX 75662

Panhandle Region: 4515 S. Georgia Suite 129 Amarillo TX 79110



917-17025 # 0637-01



NELAP-accredited #T104704201-08-TX



2008 Seal of Excellence



Ana-Lab Corp. P.O. Box 9000 Kilgore, TX 75663

Phone 903/984-0551 FAX 903/984-5914 e-Mail corp@ana-lab.com

LELAP-accredited #02008

Results

Printed:

05/22/2009

Page 2 of 7

Report To

Brian Cuellar
Safety & Environmental Solutio
703 E. Clinton
Hobbs, NM 88240

Account
SESF-P

Project
442485

Stevens & Johnson Horse Pen

Results

| Accredited | Parameter | Results | Units | RL | Flags | CAS | Bottle |
|-------------|------------------------------|-------------------------|--------------|----------------------|------------|--------|--------|
| 101348 | #7 | Received: 05/14/2009 | | | | | |
| Soil | | Collected by: I Kincaid | Affiliation: | Safety & Environment | 05/12/2009 | 11:38 | |
| SW-846 9056 | | Analyzed: LCY | 05/16/2009 | 1815 | QCgroup | 318122 | |
| AN | Chloride (water extractable) | 539 | mg/kg | 6.00 | | 02 | |
| 101349 | #8 | Received: 05/14/2009 | | | | | |
| Soil | | Collected by: I Kincaid | Affiliation: | Safety & Environment | 05/12/2009 | 11:48 | |
| SW-846 9056 | | Analyzed: LCY | 05/16/2009 | 1832 | QCgroup | 318122 | |
| AN | Chloride (water extractable) | 334 | mg/kg | 15.0 | | 02 | |
| 101350 | #9 | Received: 05/14/2009 | | | | | |
| Soil | | Collected by: I Kincaid | Affiliation: | Safety & Environment | 05/12/2009 | 11:52 | |
| SW-846 9056 | | Analyzed: LCY | 05/18/2009 | 0953 | QCgroup | 318122 | |
| AN | Chloride (water extractable) | 6.25 | mg/kg | 3.00 | | 02 | |
| 101351 | #10 | Received: 05/14/2009 | | | | | |
| Soil | | Collected by: I Kincaid | Affiliation: | Safety & Environment | 05/12/2009 | 11:55 | |
| SW-846 9056 | | Analyzed: LCY | 05/16/2009 | 2222 | QCgroup | 318131 | |
| AN | Chloride (water extractable) | 5690 | mg/kg | 300 | | 02 | |
| 101352 | #11 | Received: 05/14/2009 | | | | | |
| Soil | | Collected by: I Kincaid | Affiliation: | Safety & Environment | 05/12/2009 | 12:00 | |
| SW-846 9056 | | Analyzed: LCY | 05/16/2009 | 2239 | QCgroup | 318131 | |
| AN | Chloride (water extractable) | 81.3 | mg/kg | 30.0 | | 02 | |
| 101353 | SW#1 | Received: 05/14/2009 | | | | | |
| Soil | | Collected by: I Kincaid | Affiliation: | Safety & Environment | 05/12/2009 | 12:02 | |
| SW-846 9056 | | Analyzed: LCY | 05/16/2009 | 2257 | QCgroup | 318131 | |
| AN | Chloride (water extractable) | 1630 | mg/kg | 150 | | 02 | |

Corporate Shipping: 2600 Dudley Rd. Kilgore, TX 75662

Panhandle Region: 4515 S. Georgia Suite 129 Amarillo TX 79110



D-17025 # 0637-01

NELAP-accredited #T104704201-08-TX

2008 Seal of Excellence

Client v1.0.1.252

www.ana-lab.com

Form rptPROJRES Created 10/13/2004 v1.2



Ana-Lab Corp. P.O. Box 9000 Kilgore, TX 75663

Phone 903/984-0551 FAX 903/984-5914 e-Mail corp@ana-lab.com

LELAP-accredited #02008

Results

Printed:

05/22/2009

Page 3 of 7

Report To

Brian Cuellar
Safety & Environmental Solutio
703 E. Clinton
Hobbs, NM 88240

Account
SESF-P

Project
442485

Stevens & Johnson Horse Pen

Results

| Accredited | Parameter | Results | Units | RL | Flags | CAS | Bottle |
|-------------|------------------------------|-------------------------|--------------|----------------------|------------|--------|--------|
| 101354 | SW#2 | Received: 05/14/2009 | | | | | |
| Soil | | Collected by: I Kincaid | Affiliation: | Safety & Environment | 05/12/2009 | 12:05 | |
| SW-846 9056 | | Analyzed: LCY | 05/16/2009 | 2314 | QCgroup | 318131 | |
| AN | Chloride (water extractable) | 7680 | mg/kg | 600 | | 02 | |
| 101355 | SW#3 | Received: 05/14/2009 | | | | | |
| Soil | | Collected by: I Kincaid | Affiliation: | Safety & Environment | 05/12/2009 | 12:07 | |
| SW-846 9056 | | Analyzed: LCY | 05/16/2009 | 2332 | QCgroup | 318131 | |
| AN | Chloride (water extractable) | 7390 | mg/kg | 600 | | 02 | |
| 101356 | EW#1 | Received: 05/14/2009 | | | | | |
| Soil | | Collected by: I Kincaid | Affiliation: | Safety & Environment | 05/12/2009 | 12:10 | |
| SW-846 9056 | | Analyzed: LCY | 05/17/2009 | 1207 | QCgroup | 318131 | |
| AN | Chloride (water extractable) | 8330 | mg/kg | 600 | | 02 | |
| 01357 | EW#2 | Received: 05/14/2009 | | | | | |
| Soil | | Collected by: | Affiliation: | Safety & Environment | 05/12/2009 | 12:13 | |
| SW-846 9056 | | Analyzed: LCY | 05/17/2009 | 1225 | QCgroup | 318131 | |
| AN | Chloride (water extractable) | 11600 | mg/kg | 1500 | | 02 | |
| 01358 | NW | Received: 05/14/2009 | | | | | |
| Soil | | Collected by: | Affiliation: | Safety & Environment | 05/12/2009 | 12:15 | |
| SW-846 9056 | | Analyzed: LCY | 05/17/2009 | 1243 | QCgroup | 318131 | |
| AN | Chloride (water extractable) | 15500 | mg/kg | 6000 | | 02 | |
| 101359 | #12 | Received: 05/14/2009 | | | | | |
| Soil | | Collected by: I Kincaid | Affiliation: | Safety & Environment | 05/13/2009 | 16:00 | |
| SW-846 9056 | | Analyzed: LCY | 05/17/2009 | 0100 | QCgroup | 318131 | |
| AN | Chloride (water extractable) | 2580 | mg/kg | 150 | | 02 | |

Corporate Shipping: 2600 Dudley Rd. Kilgore, TX 75662

Panhandle Region: 4515 S. Georgia Suite 129 Amarillo TX 79110



17025 # 0637-01

2008 Seal of Excellence

Client v1.0.1.252

www.ana-lab.com

Form rptPROJRES Created 10/13/2004 v1.2



Ana-Lab Corp. P.O. Box 9000 Kilgore, TX 75663

Phone 903/984-0551 FAX 903/984-5914 e-Mail corp@ana-lab.com

LELAP-accredited #02008

Results

Printed:

05/22/2009

Page 4 of 7

Report To

Brian Cuellar
Safety & Environmental Solutio
703 E. Clinton
Hobbs, NM 88240

Account
SESF-P

Project
442485

Stevens & Johnson Horse Pen

Results

| Accredited | Parameter | Results | Units | RL | Flags | CAS | Bottle |
|------------|-----------|---------|-------|----|-------|-----|--------|
|------------|-----------|---------|-------|----|-------|-----|--------|

Sample Preparation

101342 #1

Received: 05/14/2009

SW-846 9056

Analyzed: LCY 05/16/2009 0900 QCgroup 318046

AN Water Extract-Ion Chromatography 40/4 grams 01

101343 #2

Received: 05/14/2009

SW-846 9056

Analyzed: LCY 05/16/2009 0900 QCgroup 318046

AN Water Extract-Ion Chromatography 40/4 grams 01

101344 #3

Received: 05/14/2009

SW-846 9056

Analyzed: LCY 05/16/2009 0900 QCgroup 318046

AN Water Extract-Ion Chromatography 40/4 grams 01

101345 #4

Received: 05/14/2009

SW-846 9056

Analyzed: LCY 05/16/2009 0900 QCgroup 318046

AN Water Extract-Ion Chromatography 40/4 grams 01

101346 #5

Received: 05/14/2009

SW-846 9056

Analyzed: LCY 05/16/2009 0900 QCgroup 318046

AN Water Extract-Ion Chromatography 40/4 grams 01

101347 #6

Received: 05/14/2009

Corporate Shipping: 2600 Dudley Rd. Kilgore, TX 75662

Panhandle Region: 4515 S. Georgia Suite 129 Amarillo TX 79110



1017025 # 0637-01



NELAP-accredited #T104704201-08-TX



2008 Seal of Excellence



Ana-Lab Corp. P.O. Box 9000 Kilgore, TX 75663

Phone 903/984-0551 FAX 903/984-5914 e-Mail corp@ana-lab.com

LELAP-accredited #02008

Results

Printed:

05/22/2009

Page 5 of 7

Report To

Brian Cuellar
Safety & Environmental Solutio
703 E. Clinton
Hobbs, NM 88240

Account

SESF-P

Project

442485

Stevens & Johnson Horse Pen

Sample Preparation

101347 #6

Received: 05/14/2009

SW-846 9056

Analyzed: LCY 05/16/2009 0900 QCgroup 318046

AN Water Extract-Ion Chromatography 40/4 grams 01

101348 #7

Received: 05/14/2009

SW-846 9056

Analyzed: LCY 05/16/2009 0900 QCgroup 318046

AN Water Extract-Ion Chromatography 40/4 grams 01

101349 #8

Received: 05/14/2009

SW-846 9056

Analyzed: LCY 05/16/2009 0900 QCgroup 318046

AN Water Extract-Ion Chromatography 40/4 grams 01

101350 #9

Received: 05/14/2009

SW-846 9056

Analyzed: LCY 05/16/2009 0900 QCgroup 318046

AN Water Extract-Ion Chromatography 40/4 grams 01

101351 #10

Received: 05/14/2009

SW-846 9056

Analyzed: LCY 05/16/2009 1000 QCgroup 318047

AN Water Extract-Ion Chromatography 40/4 grams 01

101352 #11

Received: 05/14/2009

SW-846 9056

Analyzed: LCY 05/16/2009 1000 QCgroup 318047

Water Extract-Ion Chromatography 40/4 grams 01

Corporate Shipping: 2600 Dudley Rd. Kilgore, TX 75662

Panhandle Region: 4515 S. Georgia Suite 129 Amarillo TX 79110



1017025 # 0637-01

NELAP-accredited #T104704201-08-TX

2008 Seal of Excellence

Client v1.0.1.252

www.ana-lab.com

Form rptPROJRES Created 10/13/2004 v1.2



Ana-Lab Corp. P.O. Box 9000 Kilgore, TX 75663

Phone 903/984-0551 FAX 903/984-5914 e-Mail corp@ana-lab.com

LELAP-accredited #02008

Results

Printed:

05/22/2009

Page 6 of 7

Report To

Brian Cuellar
Safety & Environmental Solutio
703 E. Clinton
Hobbs, NM 88240

Account
SESF-P

Project
442485

Stevens & Johnson Horse Pen

Sample Preparation

101353 SW#1

Received: 05/14/2009

SW-846 9056

Analyzed: LCY 05/16/2009 1000 QCgroup 318047

AN Water Extract-Ion Chromatography 40/4 grams 01

101354 SW#2

Received: 05/14/2009

SW-846 9056

Analyzed: LCY 05/16/2009 1000 QCgroup 318047

AN Water Extract-Ion Chromatography 40/4 grams 01

101355 SW#3

Received: 05/14/2009

SW-846 9056

Analyzed: LCY 05/16/2009 1000 QCgroup 318047

AN Water Extract-Ion Chromatography 40/4 grams 01

101356 EW#1

Received: 05/14/2009

SW-846 9056

Analyzed: LCY 05/16/2009 1000 QCgroup 318047

AN Water Extract-Ion Chromatography 40/4 grams 01

101357 EW#2

Received: 05/14/2009

SW-846 9056

Analyzed: LCY 05/16/2009 1000 QCgroup 318047

AN Water Extract-Ion Chromatography 40/4 grams 01

101358 NW

Received: 05/14/2009

SW-846 9056

Analyzed: LCY 05/16/2009 1000 QCgroup 318047

Water Extract-Ion Chromatography 40/4 grams 01

Corporate Shipping: 2600 Dudley Rd. Kilgore, TX 75662

Panhandle Region: 4515 S. Georgia Suite 129 Amarillo TX 79110



10-17025 # 0637-01

NELAP-accredited #T104704201-08-TX

2008 Seal of Excellence



Ana-Lab Corp. P.O. Box 9000 Kilgore, TX 75663

Phone 903/984-0551 FAX 903/984-5914 e-Mail corp@ana-lab.com

LELAP-accredited #02008

Results

Printed:

05/22/2009

Page 7 of 7

Report To

Brian Cuellar
Safety & Environmental Solutio
703 E. Clinton
Hobbs, NM 88240

Account
SESF-P

Project
442485

Stevens & Johnson Horse Pen

Sample Preparation

101359 #12

Received: 05/14/2009

SW-846 9056

Analyzed: LCY 05/16/2009 1000 QCgroup 318047

Water Extract-Ion Chromatography 40/4 grams

01

Qualifiers:

We report results on an 'As Received' or wet basis unless marked 'Dry Weight'. Unless otherwise noted, testing was performed at Ana-lab's corporate laboratory that holds the following Federal and State certificates: Texas Department of Health Lead Firm Certificate 2110076, EPA National Lead Laboratory Accreditation Program #637.01, US Consumer Product Safety Commission #1095, US Department of Agriculture Soil Import Permit S-37592, Texas Commission on Environmental Quality Drinking Water Laboratory Certificate TX219, Texas Commission on Environmental Quality NELAP T104704201-06-TX, Oklahoma Department of Environmental Quality Drinking Water Certification Lab ID# D9913, EPA Lab Number TX00063, USEPA Approved Perchlorate Testing Lab, USEPA UCMR2 Approved Lab, Oklahoma Department of Environmental Quality Laboratory Certificate 8125, Arkansas Department of Environmental Quality Certification #03-070-0, Louisiana Department of Environmental Quality Laboratory Certification (NELAP, LELAP) #02008, Louisiana Department of Health and Hospitals Drinking Water (NELAP) # LA030020, US Department of Energy Approved, State of Kansas Department of Health and Environment Waste Water and Solid/Hazardous Waste Cert. E-10365, Alabama Department of Environmental Management Drinking Water #41540. Ana-Lab is also accredited to the international ISO-17025 standard by the American Association for Laboratory Accreditation (A2LA Certificate # 0637-01). The Accredited column designates accreditation by U -- UCMR2 (EPA), A -- A2LA, N -- NELAC, or z -- not covered under one of these scopes of accreditation.

These analytical results relate to the sample tested. This report may NOT be reproduced EXCEPT in FULL without written approval of Ana-Lab Corp. Unless otherwise specified, these test results meet the requirements of NELAC.

RL is the Reporting Limit (sample specific quantitation limit) and is at or above the Method Detection Limit (MDL). CAS is Chemical Abstract Service number.

C. H. Whiteside

C. H. Whiteside, Ph.D., President



Corporate Shipping: 2600 Dudley Rd. Kilgore, TX 75662

Panhandle Region: 4515 S. Georgia Suite 129 Amarillo TX 79110



ISO-17025 # 0637-01



NELAP-accredited #T104704201-08-TX



2008 Seal of Excellence



Ana-Lab Corp. P.O. Box 9000 Kilgore, TX 75663

Phone 903/984-0551 FAX 903/984-5914 e-Mail corp@ana-lab.com

LELAP-accredited #02008

Quality Control

Printed 05/22/2009 Page 1 of 2

Project

442485

Brian Cuellar
Safety & Environmental Solutio
703 E. Clinton
Hobbs, NM 88240

18122 I Soil SW-846 9056

Blank

| Parameter | PrepSet | Reading | MDL | MDL | Units | Out | File |
|------------------------------|---------|---------|--------|-------|-------|-----|------------|
| Chloride (water extractable) | 318046 | ND | 0.0534 | 0.300 | mg/kg | | 0000840894 |

CCV

| Parameter | Reading | Known | Units | Recover% | Limits% | Out | File |
|------------------------------|---------|-------|-------|----------|------------|-----|------------|
| Chloride (water extractable) | 10.1 | 10.0 | mg/kg | 101 | 90.0 - 110 | | 0000840893 |
| Chloride (water extractable) | 10.1 | 10.0 | mg/kg | 101 | 90.0 - 110 | | 0000840906 |
| Chloride (water extractable) | 10.1 | 10.0 | mg/kg | 101 | 90.0 - 110 | | 0000840916 |
| Chloride (water extractable) | 10.3 | 10.0 | mg/kg | 103 | 90.0 - 110 | | 0000840917 |
| Chloride (water extractable) | 10.3 | 10.0 | mg/kg | 103 | 90.0 - 110 | | 0000840920 |

LCS

| Parameter | PrepSet | Reading | Known | Units | Recover% | Limits | File | Out |
|------------------------------|---------|---------|-------|-------|----------|------------|------------|-----|
| Chloride (water extractable) | 318046 | 0.982 | 1.00 | mg/kg | 98.2 | 90.0 - 110 | 0000840895 | |

LCS Dup

| Parameter | PrepSet | LCS | LCSD | Known | Limits% | LCS% | LCSD% | Units | RPD | Limit% |
|------------------------------|---------|-------|-------|-------|------------|------|-------|-------|------|--------|
| Chloride (water extractable) | 318046 | 0.982 | 0.962 | 1.00 | 90.0 - 110 | 98.2 | 96.2 | mg/kg | 2.06 | 20.0 |

8131 I Soil SW-846 9056

Blank

| Parameter | PrepSet | Reading | MDL | MDL | Units | Out | File |
|------------------------------|---------|---------|---------|--------|-------|-----|------------|
| Chloride (water extractable) | 318047 | ND | 0.0534 | 0.300 | mg/kg | | 0000840975 |
| Nitrate | 318047 | ND | 0.0103 | 0.0500 | mg/kg | | 0000840975 |
| Nitrate-Nitrite Nitrogen | 318047 | ND | 0.00321 | 0.0200 | mg/kg | | 0000840975 |

CCV

| Parameter | Reading | Known | Units | Recover% | Limits% | Out | File |
|------------------------------|---------|-------|-------|----------|------------|-----|------------|
| Chloride (water extractable) | 10.1 | 10.0 | mg/kg | 101 | 90.0 - 110 | | 0000840974 |
| Chloride (water extractable) | 10.1 | 10.0 | mg/kg | 101 | 90.0 - 110 | | 0000840990 |
| Chloride (water extractable) | 10.3 | 10.0 | mg/kg | 103 | 90.0 - 110 | | 0000840998 |
| Chloride (water extractable) | 10.3 | 10.0 | mg/kg | 103 | 90.0 - 110 | | 0000841002 |
| Nitrate | 10.0 | 10.0 | mg/kg | 100 | 90.0 - 110 | | 0000840974 |
| Nitrate | 10.0 | 10.0 | mg/kg | 100 | 90.0 - 110 | | 0000840990 |
| Nitrate | 10.2 | 10.0 | mg/kg | 102 | 90.0 - 110 | | 0000841002 |
| Nitrate | 10.3 | 10.0 | mg/kg | 103 | 90.0 - 110 | | 0000840998 |
| Nitrate-Nitrite Nitrogen | 5.29 | 5.30 | mg/kg | 99.8 | 90.0 - 110 | | 0000840990 |
| Nitrate-Nitrite Nitrogen | 5.31 | 5.30 | mg/kg | 100 | 90.0 - 110 | | 0000840974 |
| Nitrate-Nitrite Nitrogen | 5.39 | 5.30 | mg/kg | 102 | 90.0 - 110 | | 0000841002 |

Corporate Shipping: 2600 Dudley Rd. Kilgore, TX 75662

Panhandle Region: 4515 S. Georgia Suite 129 Amarillo TX 79110



0-17025 # 0637-01

NELAP-accredited #T104704201-08-TX

2008 Seal of Excellence

Client v1.0.1.252

www.ana-lab.com

Form rptPROJOCGrpt Created 01/27/2005 v1.0



Quality Control

Printed 05/22/2009 Page 2 of 2

Report To:

Brian Cuellar
Safety & Environmental Solutio
703 E. Clinton
Hobbs, NM 88240

Project

442485

18131 I Soil SW-846 9056

CCV

| Parameter | Reading | Known | Units | Recover% | Limits | Out | File |
|--------------------------|---------|-------|-------|----------|------------|-----|------------|
| Nitrate-Nitrite Nitrogen | 5.41 | 5.30 | mg/kg | 102 | 90.0 - 110 | | 0000840998 |

LCS

| Parameter | PrepSet | Reading | Known | Units | Recover% | Limits | File | Out |
|------------------------------|---------|---------|-------|-------|----------|------------|------------|-----|
| Chloride (water extractable) | 318047 | 0.971 | 1.00 | mg/kg | 97.1 | 90.0 - 110 | 0000840976 | |
| Nitrate | 318047 | 0.994 | 1.00 | mg/kg | 99.4 | 90.0 - 110 | 0000840976 | |
| Nitrate-Nitrite Nitrogen | 318047 | 0.523 | 0.530 | mg/kg | 98.7 | 90.0 - 110 | 0000840976 | |

LCS Dup

| Parameter | PrepSet | LCS | LCSD | Known | Limits | LCS% | LCSD% | Units | RPD | Limit% |
|------------------------------|---------|-------|-------|-------|------------|------|-------|-------|-------|--------|
| Chloride (water extractable) | 318047 | 0.971 | 0.981 | 1.00 | 90.0 - 110 | 97.1 | 98.1 | mg/kg | 1.02 | 20.0 |
| Nitrate | 318047 | 0.994 | 0.997 | 1.00 | 90.0 - 110 | 99.4 | 99.7 | mg/kg | 0.301 | 10.0 |
| Nitrate-Nitrite Nitrogen | 318047 | 0.523 | 0.525 | 0.530 | 90.0 - 110 | 98.7 | 99.1 | mg/kg | 0.404 | 10.0 |

MS

| Parameter | Sample | MS | MSD | UNK | Known | Limits | MS% | MSD% | Units | RPD | Limit% |
|------------------------------|--------|------|------|------|-------|------------|--------|--------|-------|--------|--------|
| Chloride (water extractable) | 099906 | 358 | 350 | 87.4 | 10.0 | 80.0 - 120 | 2710 * | 2630 * | mg/kg | 3.00 | 10.0 |
| Nitrate | 099906 | 7.34 | 6.10 | ND | 10.0 | 80.0 - 120 | 73.4 * | 61.0 * | mg/kg | 18.5 * | 10.0 |
| Nitrate-Nitrite Nitrogen | 099906 | 5.03 | 4.49 | ND | 5.30 | 80.0 - 120 | 94.9 | 84.7 | mg/kg | 11.4 * | 10.0 |

RPD is Relative Percent Difference: $\text{abs}(r1-r2) / \text{mean}(r1,r2) * 100\%$

Recover% is Recovery Percent: $\text{result} / \text{known} * 100\%$





Panhandle Oklahoma North-TX Central-TX
 806.355.3556 405.292.6630 817.261.6404 512.821.0045
 Rio Grand Valley Ark-La-Miss Gulf Coast Alabama
 956.831.8437 318.219.9300 281.333.9414 256.830.0788



2600 Dudley Rd
 PO Box 9000
 Kilgore, TX 75662
 903.984.0551
 (fx) 903.984.5914
 e-mail: corp@ana-lab.com



Report to:

| | | | | | |
|---------------------------------------|--|---|--|---|--|
| Company name: SESF | | Project - Name / Location Stevens & Johnson Horse Pen | | Analysis Requested | |
| Client Code: | | Billing (if different) | | | |
| Address: 703 E Clinton | | City: Clinton | | State: TX | |
| Zip: 75640 | | Phone: 85840 | | Fax: 85840 | |
| E-mail: office2@sest-nm.com | | PG Number: 37E-03-023 | | | |
| Printed Name: Isaac Kincaid | | Affiliation: SESF | | | |
| Lab Number: 1130 | | Field Identification: #1 | | Date: 5/12/11 | |
| Do Not Use | | Time | | Matrix | |
| | | 1124 | | Soil | |
| | | 1126 | | Comp Grab | |
| | | 1128 | | Comp Grab | |
| | | 1130 | | Comp Grab | |
| | | 1132 | | Comp Grab | |
| | | 1136 | | Comp Grab | |
| | | 1138 | | Comp Grab | |
| | | 1148 | | Comp Grab | |
| | | 1152 | | Comp Grab | |
| | | 1155 | | Comp Grab | |
| Date: 5/19/11 | | Time: 1500 | | Is Hazardous for: <input type="checkbox"/> HF <input type="checkbox"/> CN <input type="checkbox"/> S= | |
| Relinquished by: Isaac Kincaid | | Signature: [Signature] | | Affiliation: SESF | |
| Printed Name: Isaac Kincaid | | Signature: [Signature] | | Affiliation: SESF | |
| Date: 5/19/11 | | Time: 0940 | | Received by: [Signature] | |
| | | | | Printed Name: Christi Parker | |
| | | | | Signature: [Signature] | |
| | | | | Affiliation: Ana-Lab | |
| | | | | Wastewater <input type="checkbox"/> Drinking Water <input type="checkbox"/> SW846 | |

Samples Received on Ice? ☐ Yes ☒ No
 Cooler/Sample Secure? ☐ Yes ☒ No
 Requested TAT: **4 day**
 Method of Shipment: ☐ Bus ☒ FedEx ☐ Lone Star
 Tracking or Shipping Number: **945210748**
☐ 2 Day ☐ 3 day ☐ next day
☐ DHL ☐ Hand delivered ☐ UPS
☐ other #comments: **003689**
003233
003532
003688



Panhandle Oklahoma North-TX Central-TX
806.355.3556 405.292.6630 817.261.6404 512.821.0045
Rio Grand Valley ArkLaMiss Gulf Coast Alabama
956.831.6437 318.219.9300 281.333.9414 256.830.0788



2600 Dudley Rd
PO Box 9000
Kilgore, TX 75662
903.984.0551
(fx) 903.984.5914
e-mail: corp@ana-lab.com



Report to:

| | | | | | |
|--|----------------------------|---|----------------------------|---------------------------------|------------|
| Company name: SESE | | Project- Name / Location SESE | | Analysis Requested | |
| Address: 705 E Clinton | | Client Code: SESE | | Billing (if different) | |
| City Hobbs | State NM | City SESE | State NM | Zip 88240 | |
| Phone 505-397-0510 | Fax 505-397-0510 | Phone 505-397-0510 | Fax 505-397-0510 | Zip 88240 | |
| Sampler Signature <i>[Signature]</i> | | Printed Name Isaac Kinard | | Affiliation SESE | |
| Lab Number 351 | | PO Number STE-03-003 | | Comments chlorides | |
| Field Identification | | Date | Time | Matrix | Containers |
| #11 | | 5/12/09 | 1200 | Soil | 1 |
| SW #1 | | 1202 | | | |
| SW #2 | | 1205 | | | |
| SW #3 | | 1207 | | | |
| EW #1 | | 1210 | | | |
| EW #2 | | 1213 | | | |
| NW | | 1215 | | | |
| #12 | | 5/13/09 | 1600 | Soil | 1 |
| Date | | Time | | Matrix | |
| 5/13/09 | 1700 | | | | |
| 5/13/09 | 1500 | | | | |
| 5/14/09 | 0940 | | | | |
| Relinquished by Isaac Kinard | | Signature <i>[Signature]</i> | | Affiliation SESE | |
| Printed Name Fred EX | | Signature <i>[Signature]</i> | | Affiliation ANA-LAB | |
| Is Hazardous for: <input type="checkbox"/> HF <input type="checkbox"/> CN <input type="checkbox"/> S= | | Received by Fred EX | | Signature <i>[Signature]</i> | |
| Other# | | Printed Name Christi Parker | | Affiliation ANA-LAB | |

Samples Received on Ice? ☒ Yes ☐ No
Cooler/Sample Secure? ☒ Yes ☐ No
Requested TAT **4 day**
Method of Shipment ☐ Bus ☒ FedEX ☐ Lone Star ☐ UPS ☐ Hand delivered ☐ DHL ☐ other
Tracking or Shipping Number **97592107482**
2 Day ☐ 3 day ☐ next day
25°C
003689 ☐
003233 ☐
003532 ☐
003688 ☐