

District I
1625 N. French Dr., Hobbs, NM 88240
District II
811 S. First St., Artesia, NM 88210
District III
1000 Rio Brazos Road, Aztec, NM 87410
District IV
1220 S. St. Francis Dr., Santa Fe, NM 87505

State of New Mexico
Energy Minerals and Natural Resources

Oil Conservation Division
1220 South St. Francis Dr.
Santa Fe, NM 87505

Form C-141
Revised August 8, 2011

Submit 1 Copy to appropriate District Office in
accordance with 19.15.29 NMAC.

Release Notification and Corrective Action

OPERATOR

☒ Initial Report ☐ Final Report

Name of Company: ConocoPhillips	Contact: David May
Address: 29 Vacuum Complex Lane	Telephone No. 575-391-3106
Facility Name: MCA 2F Header	Facility Type: Header

Surface Owner: BLM	Mineral Owner BLM	API No. 3002500718
---------------------------	--------------------------	---------------------------

LOCATION OF RELEASE

Unit Letter J	Section 27	Township 17S	Range 32E	Feet from the 1980	North/South Line South	Feet from the 1980	East/West Line East	County LEA
-------------------------	----------------------	------------------------	---------------------	-----------------------	----------------------------------	-----------------------	-------------------------------	----------------------

Latitude **32.8037075642669**

Longitude **-103.752155401928**

NATURE OF RELEASE

Type of Release: Spill	Volume of Release: 11.7 BBLS	Volume Recovered: 5 BBLS
Source of Release: 2 inch steel flow line	Date and Hour of Occurrence 10/17/13 7:20 am	Date and Hour of Discovery SAME
Was Immediate Notice Given? <input checked="" type="checkbox"/> Yes <input type="checkbox"/> No <input type="checkbox"/> Not Required	If YES, To Whom? Trish Bad Bear/Geoffrey Leking	
By Whom? David May	Date and Hour: 10/18/13 2:50 pm	
Was a Watercourse Reached? <input type="checkbox"/> Yes <input checked="" type="checkbox"/> No	If YES, Volume Impacting the Watercourse.	
If a Watercourse was Impacted, Describe Fully.*		
Describe Cause of Problem and Remedial Action Taken.* Release was caused by external corrosion. Abandoned line was connected to a 12" trunk line with a butterfly valve that was leaking. Line was disconnected from butterfly valve and was replaced with ball valve and plug.		
Describe Area Affected and Cleanup Action Taken.* . Affected area was 60 feet X 60 feet. Spill will be remediated according to BLM requirements.		
I hereby certify that the information given above is true and complete to the best of my knowledge and understand that pursuant to NMOCD rules and regulations all operators are required to report and/or file certain release notifications and perform corrective actions for releases which may endanger public health or the environment. The acceptance of a C-141 report by the NMOCD marked as "Final Report" does not relieve the operator of liability should their operations have failed to adequately investigate and remediate contamination that pose a threat to ground water, surface water, human health or the environment. In addition, NMOCD acceptance of a C-141 report does not relieve the operator of responsibility for compliance with any other federal, state, or local laws and/or regulations.		

OIL CONSERVATION DIVISION

Signature:	Approved by Environmental Specialist:	
Printed Name: David May		
Title: LEAD HSE	Approval Date:	Expiration Date:
E-mail Address: david.d.may@conocophillips.com	Conditions of Approval:	Attached <input type="checkbox"/>
Date: 10/18/13	Phone: 575-391-3106	

* Attach Additional Sheets If Necessary



HOBBS OCD

APR 22 2014

RECEIVED

CONOCOPHILLIPS

P.O. Box 2197
Houston, TX 77252-2197
Phone 281.293.1000

EXCAV PROPOSED TO 1'
BUT
VERT 1 DRO > 1000 TPH
@ 11"
VERT 2 CL > 500 TO
2.5'
VERT 4 CL > 500 TO
1.5'

MCA 2F Header

Corrective Action Plan

API No. 3002500718

Release Date: October 17th, 2013

Unit Letter J, Section 27, Township 17S, Range 32E



PO Box 2948 | Hobbs, NM 88241 | Phone 575.393.2967

April 15th, 2014

Geoffrey Leking

New Mexico Energy, Minerals, & Natural Resources
Oil Conservation Division, Environmental Bureau – District 1
1625 N. French Dr.
Hobbs, NM 88240-9273

**RE: Corrective Action Plan
ConocoPhillips MCA 2F Header
UL/J sec. 27 T17S R32E
API No. 3002500718**

Mr. Leking:

ConocoPhillips (CoP) has retained Rice Environmental Consulting and Safety (RECS) to address potential environmental concerns at the above-referenced site.

Background and Previous Work

The site is located approximately 3.6 miles south of Maljamar, New Mexico at UL/J sec. 27 T17S R32E. NM OSE records indicate that groundwater will likely be encountered at a depth of approximately 65 +/- feet.

On October 17th, 2013, CoP discovered a release of 11.7 barrels of fluid from an abandoned 2 inch steel line connected to a 12 inch truck line by butterfly valve. The butterfly valve leaked and the line was disconnected and replaced with a ball valve and plug. The release affected a total of 3,485 square feet of lease pad and pasture land. Five barrels of fluid was recovered from the site. NMOCD and BLM were notified of the release on October 18th, 2013 and an initial C-141 was sent to NMOCD for their approval (Appendix A).

RECS personnel were on site beginning on December 10th, 2013 to assess the release. The release was photographed and mapped. Beginning on April 7th, 2014, four points within the release area were sampled at the surface and with depth (Figure 1). The samples were field tested for chlorides and organic vapors, and representative samples were taken to a commercial laboratory for analysis (Appendix B).

Photo documentation of these activities can be found in Appendix C.

Corrective Action Plan

Based on the laboratory data, the release area will be scraped down one foot using a backhoe in the easily accessible areas and by hydrovac in southern area of the release where active lines

inhibit easy access. The remainder of the contamination from the release will be addressed during site abandonment. All excavated soils will be disposed of at a NMOCD approved facility. Clean soil will be imported to the site to serve as backfill and to contour the site to the surrounding location. A sample of the imported soil will be taken to a commercial laboratory for analysis to confirm that the constituents are below regulatory standards. Soil amendments will be added to the pasture area as needed and then seeded with a blend of native vegetation. Vegetation will provide an infiltration barrier for the site, since plants capture water through their roots thereby reducing the amount of water traveling through the vadose zone.

Once these activities are completed, a report will be submitted to NMOCD and BLM detailing these actions and asking for 'remediation termination' and site closure.

RECS appreciates the opportunity to work with you on this project. Please call Hack Conder at (575) 393-2967 or me if you have any questions or wish to discuss the site.

Sincerely,

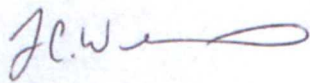
A handwritten signature in dark ink, appearing to read 'L. Weinheimer', with a long, sweeping horizontal line extending to the right.

Lara Weinheimer
Project Scientist
RECS
(575) 441-0431

Attachments:

- Figure 1 – Vertical Data
- Appendix A – Initial C-141
- Appendix B – Initial Sampling Labs
- Appendix C – Photo Documentation

Vertical Data

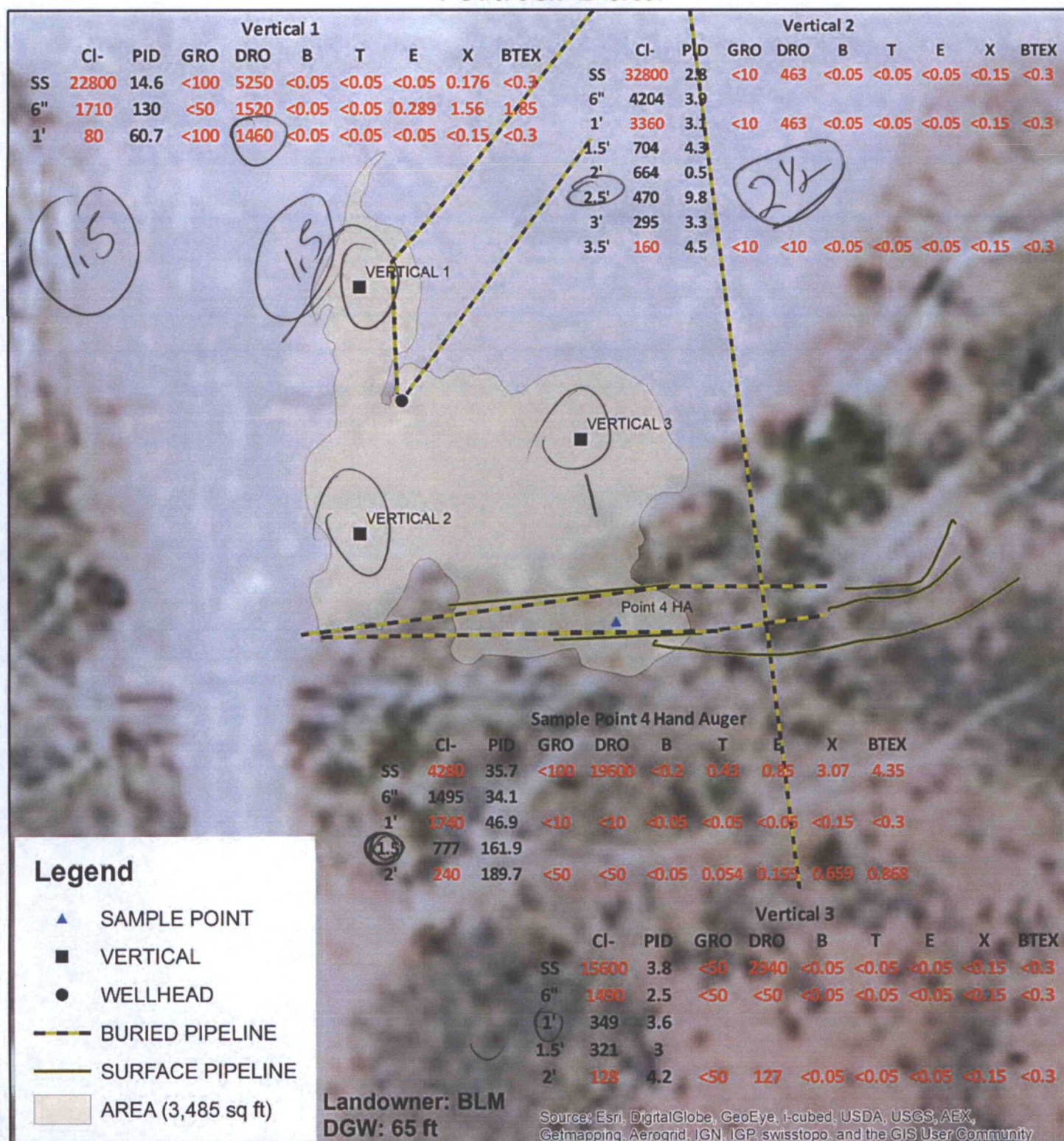

CONOCOPHILLIPS MCA 2F HEADER

LEGALS: UL/J sec. 27
T-17-S R-32-E
LEA COUNTY, NM

Figure 1



0 10 20
Feet

GPS date: 4/7/14 EC
Drawing date: 4/9/14
Drafted by: C. Ursanic

Vertical Data

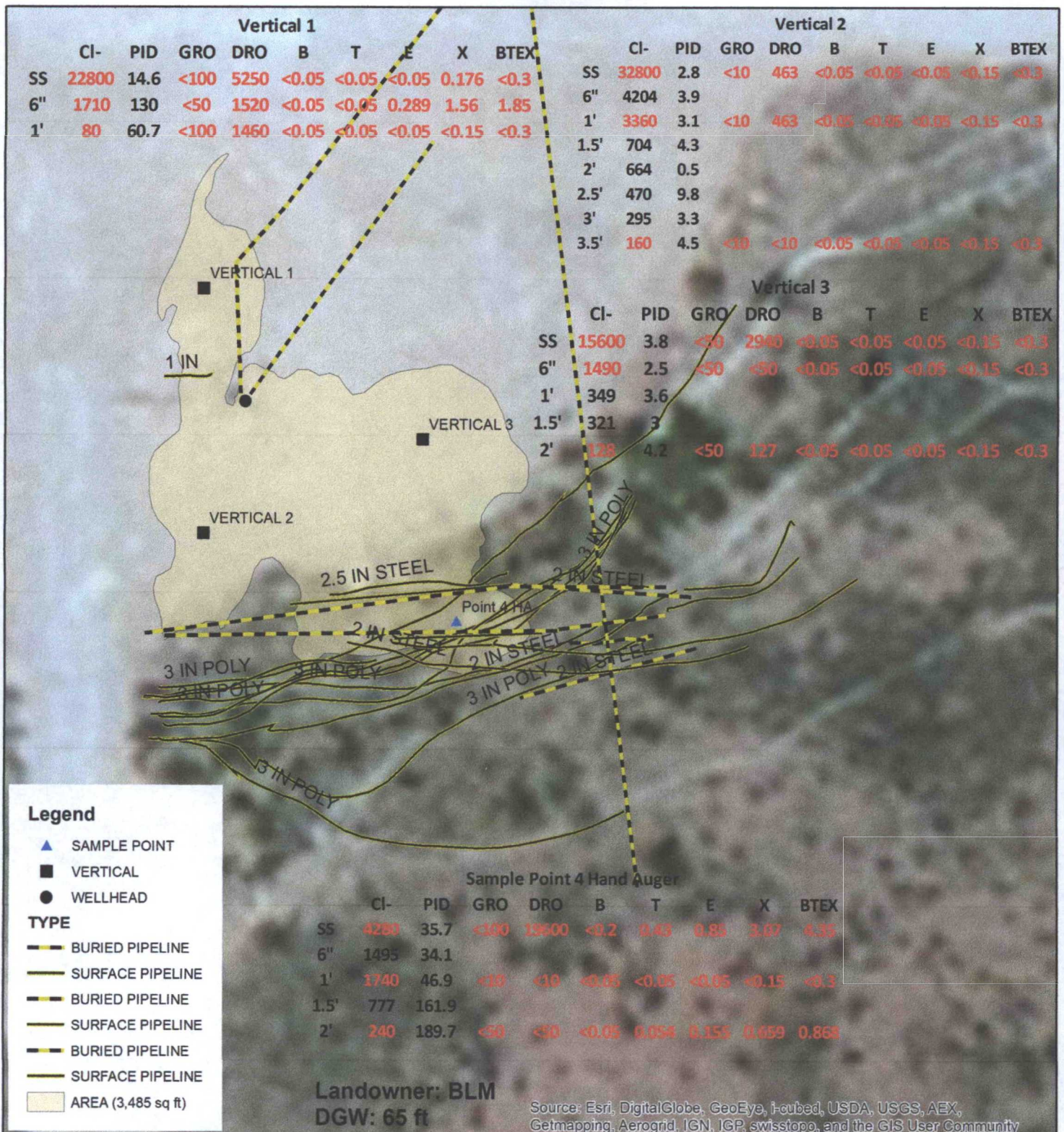



PHONE (575) 393-2326 • 101 E. MARLAND • HOBBS, NM 88240

April 08, 2014

KYLE NORMAN

RICE ENVIRONMENTAL CONSULTING & SAFETY LLC

419 W. CAIN

HOBBS, NM 88240

RE: MCA 2 F HEADER

Enclosed are the results of analyses for samples received by the laboratory on 04/07/14 16:15.

Cardinal Laboratories is accredited through Texas NELAP under certificate number T104704398-13-5. Accreditation applies to drinking water, non-potable water and solid and chemical materials. All accredited analytes are denoted by an asterisk (*). For a complete list of accredited analytes and matrices visit the TCEQ website at www.tceq.texas.gov/field/qa/lab_accred_certif.html.

Cardinal Laboratories is accredited through the State of Colorado Department of Public Health and Environment for:

Method EPA 552.2	Haloacetic Acids (HAA-5)
Method EPA 524.2	Total Trihalomethanes (TTHM)
Method EPA 524.4	Regulated VOCs (V1, V2, V3)

Accreditation applies to public drinking water matrices.

This report meets NELAP requirements and is made up of a cover page, analytical results, and a copy of the original chain-of-custody. If you have any questions concerning this report, please feel free to contact me.

Sincerely,

Celey D. Keene

Lab Director/Quality Manager

Analytical Results For:

 RICE ENVIRONMENTAL CONSULTING & SAFETY
 KYLE NORMAN
 419 W. CAIN
 HOBBS NM, 88240
 Fax To: (575) 397-1471

 Received: 04/07/2014
 Reported: 04/08/2014
 Project Name: MCA 2 F HEADER
 Project Number: NONE GIVEN
 Project Location: NONE GIVEN

 Sampling Date: 04/07/2014
 Sampling Type: Soil
 Sampling Condition: Cool & Intact
 Sample Received By: Jodi Henson

Sample ID: VERTICAL #1 SURFACE (H401054-01)

BTEX 8021B			mg/kg		Analyzed By: MS				
Analyte	Result	Reporting Limit	Analyzed	Method Blank	BS	% Recovery	True Value QC	RPD	Qualifier
Benzene*	<0.050	0.050	04/08/2014	ND	2.13	106	2.00	3.71	
Toluene*	<0.050	0.050	04/08/2014	ND	2.17	108	2.00	4.04	
Ethylbenzene*	<0.050	0.050	04/08/2014	ND	2.16	108	2.00	4.18	
Total Xylenes*	0.176	0.150	04/08/2014	ND	6.29	105	6.00	4.72	
Total BTEX	<0.300	0.300	04/08/2014	ND					

Surrogate: 4-Bromofluorobenzene (PIE) 125 % 89.4-126

Chloride, SM4500Cl-B			mg/kg		Analyzed By: AP				
Analyte	Result	Reporting Limit	Analyzed	Method Blank	BS	% Recovery	True Value QC	RPD	Qualifier
Chloride	22800	16.0	04/08/2014	ND	416	104	400	0.00	

TPH 8015M		mg/kg		Analyzed By: ms				S-06	
Analyte	Result	Reporting Limit	Analyzed	Method Blank	BS	% Recovery	True Value QC	RPD	Qualifier
GRO C6-C10	<100	100	04/08/2014	ND	188	94.2	200	2.05	
DRO >C10-C28	5250	100	04/08/2014	ND	206	103	200	1.70	

Surrogate: 1-Chlorooctane 112 % 65.2-140

Surrogate: 1-Chlorooctadecane 228 % 63.6-154

Cardinal Laboratories

*=Accredited Analyte

PLEASE NOTE: Liability and Damages. Cardinal's liability and client's exclusive remedy for any claim arising, whether based in contract or tort, shall be limited to the amount paid by client for analyses. All claims, including those for negligence and any other cause whatsoever shall be deemed waived unless made in writing and received by Cardinal within thirty (30) days after completion of the applicable service. In no event shall Cardinal be liable for incidental or consequential damages, including, without limitation, business interruptions, loss of use, or loss of profits incurred by client, its subsidiaries, affiliates or successors arising out of or related to the performance of the services hereunder by Cardinal, regardless of whether such claim is based upon any of the above stated reasons or otherwise. Results relate only to the samples identified above. This report shall not be reproduced except in full with written approval of Cardinal Laboratories.



Celey D. Keene, Lab Director/Quality Manager

Analytical Results For:

RICE ENVIRONMENTAL CONSULTING & SAFETY
KYLE NORMAN
419 W. CAIN
HOBBS NM, 88240
Fax To: (575) 397-1471

Received: 04/07/2014
Reported: 04/08/2014
Project Name: MCA 2 F HEADER
Project Number: NONE GIVEN
Project Location: NONE GIVEN

Sampling Date: 04/07/2014
Sampling Type: Soil
Sampling Condition: Cool & Intact
Sample Received By: Jodi Henson

Sample ID: VERTICAL #1 6" (H401054-02)

BTEX 8021B		mg/kg	Analyzed By: MS					S-04	
Analyte	Result	Reporting Limit	Analyzed	Method Blank	BS	% Recovery	True Value QC	RPD	Qualifier
Benzene*	<0.050	0.050	04/08/2014	ND	2.13	106	2.00	3.71	
Toluene*	<0.050	0.050	04/08/2014	ND	2.17	108	2.00	4.04	
Ethylbenzene*	0.289	0.050	04/08/2014	ND	2.16	108	2.00	4.18	
Total Xylenes*	1.56	0.150	04/08/2014	ND	6.29	105	6.00	4.72	
Total BTEX	1.85	0.300	04/08/2014	ND					

Surrogate: 4-Bromofluorobenzene (PIE) 221 % 89.4-126

Chloride, SM4500Cl-B		mg/kg	Analyzed By: AP						
Analyte	Result	Reporting Limit	Analyzed	Method Blank	BS	% Recovery	True Value QC	RPD	Qualifier
Chloride	1710	16.0	04/08/2014	ND	416	104	400	0.00	

TPH 8015M		mg/kg	Analyzed By: ms						
Analyte	Result	Reporting Limit	Analyzed	Method Blank	BS	% Recovery	True Value QC	RPD	Qualifier
GRO C6-C10	<50.0	50.0	04/08/2014	ND	188	94.2	200	2.05	
DRO >C10-C28	1520	50.0	04/08/2014	ND	206	103	200	1.70	

Surrogate: 1-Chlorooctane 108 % 65.2-140

Surrogate: 1-Chlorooctadecane 111 % 63.6-154

Cardinal Laboratories

*=Accredited Analyte

PLEASE NOTE: Liability and Damages. Cardinal's liability and client's exclusive remedy for any claim arising, whether based in contract or tort, shall be limited to the amount paid by client for analyses. All claims, including those for negligence and any other cause whatsoever shall be deemed waived unless made in writing and received by Cardinal within thirty (30) days after completion of the applicable service. In no event shall Cardinal be liable for incidental or consequential damages, including, without limitation, business interruptions, loss of use, or loss of profits incurred by client, its subsidiaries, affiliates or successors arising out of or related to the performance of the services hereunder by Cardinal, regardless of whether such claim is based upon any of the above stated reasons or otherwise. Results relate only to the samples identified above. This report shall not be reproduced except in full with written approval of Cardinal Laboratories.



Celey D. Keene, Lab Director/Quality Manager

Analytical Results For:

RICE ENVIRONMENTAL CONSULTING & SAFETY
KYLE NORMAN
419 W. CAIN
HOBBS NM, 88240
Fax To: (575) 397-1471

Received: 04/07/2014
Reported: 04/08/2014
Project Name: MCA 2 F HEADER
Project Number: NONE GIVEN
Project Location: NONE GIVEN

Sampling Date: 04/07/2014
Sampling Type: Soil
Sampling Condition: Cool & Intact
Sample Received By: Jodi Henson

Sample ID: VERTICAL #1 1' (H401054-03)

BTX 8021B			mg/kg		Analyzed By: MS			S-04		
Analyte	Result	Reporting Limit	Analyzed	Method Blank	BS	% Recovery	True Value QC	RPD	Qualifier	
Benzene*	<0.050	0.050	04/08/2014	ND	2.13	106	2.00	3.71		
Toluene*	<0.050	0.050	04/08/2014	ND	2.17	108	2.00	4.04		
Ethylbenzene*	<0.050	0.050	04/08/2014	ND	2.16	108	2.00	4.18		
Total Xylenes*	<0.150	0.150	04/08/2014	ND	6.29	105	6.00	4.72		
Total BTX	<0.300	0.300	04/08/2014	ND						

Surrogate: 4-Bromofluorobenzene (PIE) 129 % 89.4-126

Chloride, SM4500Cl-B			mg/kg					Analyzed By: AP	
Analyte	Result	Reporting Limit	Analyzed	Method Blank	BS	% Recovery	True Value QC	RPD	Qualifier
Chloride	80.0	16.0	04/08/2014	ND	416	104	400	0.00	

TPH 8015M		mg/kg		Analyzed By: ms				S-06	
Analyte	Result	Reporting Limit	Analyzed	Method Blank	BS	% Recovery	True Value QC	RPD	Qualifier
GRO C6-C10	<100	100	04/08/2014	ND	188	94.2	200	2.05	
DRO >C10-C28	1460	100	04/08/2014	ND	206	103	200	1.70	

Surrogate: 1-Chlorooctane 102 % 65.2-140

Surrogate: 1-Chlorooctadecane 169 % 63.6-154

Cardinal Laboratories

*=Accredited Analyte

PLEASE NOTE: Liability and Damages. Cardinal's liability and client's exclusive remedy for any claim arising, whether based in contract or tort, shall be limited to the amount paid by client for analyses. All claims, including those for negligence and any other cause whatsoever shall be deemed waived unless made in writing and received by Cardinal within thirty (30) days after completion of the applicable service. In no event shall Cardinal be liable for incidental or consequential damages, including, without limitation, business interruptions, loss of use, or loss of profits incurred by client, its subsidiaries, affiliates or successors arising out of or related to the performance of the services hereunder by Cardinal, regardless of whether such claim is based upon any of the above stated reasons or otherwise. Results relate only to the samples identified above. This report shall not be reproduced except in full with written approval of Cardinal Laboratories.



Celey D. Keene, Lab Director/Quality Manager

Analytical Results For:

RICE ENVIRONMENTAL CONSULTING & SAFETY
KYLE NORMAN
419 W. CAIN
HOBBS NM, 88240
Fax To: (575) 397-1471

Received: 04/07/2014
Reported: 04/08/2014
Project Name: MCA 2 F HEADER
Project Number: NONE GIVEN
Project Location: NONE GIVEN

Sampling Date: 04/07/2014
Sampling Type: Soil
Sampling Condition: Cool & Intact
Sample Received By: Jodi Henson

Sample ID: VERTICAL #2 SURFACE (H401054-04)

BTEX 8021B			mg/kg		Analyzed By: MS				
Analyte	Result	Reporting Limit	Analyzed	Method Blank	BS	% Recovery	True Value QC	RPD	Qualifier
Benzene*	<0.050	0.050	04/08/2014	ND	2.13	106	2.00	3.71	
Toluene*	<0.050	0.050	04/08/2014	ND	2.17	108	2.00	4.04	
Ethylbenzene*	<0.050	0.050	04/08/2014	ND	2.16	108	2.00	4.18	
Total Xylenes*	<0.150	0.150	04/08/2014	ND	6.29	105	6.00	4.72	
Total BTEX	<0.300	0.300	04/08/2014	ND					

Surrogate: 4-Bromofluorobenzene (PII) 118 % 89.4-126

Chloride, SM4500Cl-B			mg/kg		Analyzed By: AP				
Analyte	Result	Reporting Limit	Analyzed	Method Blank	BS	% Recovery	True Value QC	RPD	Qualifier
Chloride	32800	16.0	04/08/2014	ND	416	104	400	0.00	

TPH 8015M			mg/kg		Analyzed By: ms				
Analyte	Result	Reporting Limit	Analyzed	Method Blank	BS	% Recovery	True Value QC	RPD	Qualifier
GRO C6-C10	<10.0	10.0	04/08/2014	ND	188	94.2	200	2.05	
DRO >C10-C28	463	10.0	04/08/2014	ND	206	103	200	1.70	

Surrogate: 1-Chlorooctane 96.6 % 65.2-140

Surrogate: 1-Chlorooctadecane 96.9 % 63.6-154

Cardinal Laboratories

*=Accredited Analyte

PLEASE NOTE: Liability and Damages. Cardinal's liability and client's exclusive remedy for any claim arising, whether based in contract or tort, shall be limited to the amount paid by client for analyses. All claims, including those for negligence and any other cause whatsoever shall be deemed waived unless made in writing and received by Cardinal within thirty (30) days after completion of the applicable service. In no event shall Cardinal be liable for incidental or consequential damages, including, without limitation, business interruptions, loss of use, or loss of profits incurred by client, its subsidiaries, affiliates or successors arising out of or related to the performance of the services hereunder by Cardinal, regardless of whether such claim is based upon any of the above stated reasons or otherwise. Results relate only to the samples identified above. This report shall not be reproduced except in full with written approval of Cardinal Laboratories.



Celey D. Keene, Lab Director/Quality Manager

Analytical Results For:

RICE ENVIRONMENTAL CONSULTING & SAFETY
KYLE NORMAN
419 W. CAIN
HOBBS NM, 88240
Fax To: (575) 397-1471

Received: 04/07/2014
Reported: 04/08/2014
Project Name: MCA 2 F HEADER
Project Number: NONE GIVEN
Project Location: NONE GIVEN

Sampling Date: 04/07/2014
Sampling Type: Soil
Sampling Condition: Cool & Intact
Sample Received By: Jodi Henson

Sample ID: VERTICAL #2 1' (H401054-05)

BTEX 8021B		mg/kg		Analyzed By: MS						
Analyte	Result	Reporting Limit	Analyzed	Method Blank	BS	% Recovery	True Value QC	RPD	Qualifier	
Benzene*	<0.050	0.050	04/08/2014	ND	2.13	106	2.00	3.71		
Toluene*	<0.050	0.050	04/08/2014	ND	2.17	108	2.00	4.04		
Ethylbenzene*	<0.050	0.050	04/08/2014	ND	2.16	108	2.00	4.18		
Total Xylenes*	<0.150	0.150	04/08/2014	ND	6.29	105	6.00	4.72		
Total BTEX	<0.300	0.300	04/08/2014	ND						

Surrogate: 4-Bromofluorobenzene (PIC) 118 % 89.4-126

Chloride, SM4500Cl-B		mg/kg		Analyzed By: AP						
Analyte	Result	Reporting Limit	Analyzed	Method Blank	BS	% Recovery	True Value QC	RPD	Qualifier	
Chloride	3360	16.0	04/08/2014	ND	416	104	400	0.00		

TPH 8015M		mg/kg		Analyzed By: ms					
Analyte	Result	Reporting Limit	Analyzed	Method Blank	BS	% Recovery	True Value QC	RPD	Qualifier
GRO C6-C10	<10.0	10.0	04/08/2014	ND	188	94.2	200	2.05	
DRO >C10-C28	<10.0	10.0	04/08/2014	ND	206	103	200	1.70	

Surrogate: 1-Chlorooctane 92.3 % 65.2-140

Surrogate: 1-Chlorooctadecane 84.4 % 63.6-154

Cardinal Laboratories

*=Accredited Analyte

PLEASE NOTE: Liability and Damages. Cardinal's liability and client's exclusive remedy for any claim arising, whether based in contract or tort, shall be limited to the amount paid by client for analyses. All claims, including those for negligence and any other cause whatsoever shall be deemed waived unless made in writing and received by Cardinal within thirty (30) days after completion of the applicable service. In no event shall Cardinal be liable for incidental or consequential damages, including, without limitation, business interruptions, loss of use, or loss of profits incurred by client, its subsidiaries, affiliates or successors arising out of or related to the performance of the services hereunder by Cardinal, regardless of whether such claim is based upon any of the above stated reasons or otherwise. Results relate only to the samples identified above. This report shall not be reproduced except in full with written approval of Cardinal Laboratories.



Celey D. Keene, Lab Director/Quality Manager

Analytical Results For:

RICE ENVIRONMENTAL CONSULTING & SAFETY
KYLE NORMAN
419 W. CAIN
HOBBS NM, 88240
Fax To: (575) 397-1471

Received: 04/07/2014
Reported: 04/08/2014
Project Name: MCA 2 F HEADER
Project Number: NONE GIVEN
Project Location: NONE GIVEN

Sampling Date: 04/07/2014
Sampling Type: Soil
Sampling Condition: Cool & Intact
Sample Received By: Jodi Henson

Sample ID: VERTICAL #2 3.5' (H401054-06)

BTX 8021B			mg/kg		Analyzed By: MS					
Analyte	Result	Reporting Limit	Analyzed	Method Blank	BS	% Recovery	True Value QC	RPD	Qualifier	
Benzene*	<0.050	0.050	04/08/2014	ND	2.13	106	2.00	3.71		
Toluene*	<0.050	0.050	04/08/2014	ND	2.17	108	2.00	4.04		
Ethylbenzene*	<0.050	0.050	04/08/2014	ND	2.16	108	2.00	4.18		
Total Xylenes*	<0.150	0.150	04/08/2014	ND	6.29	105	6.00	4.72		
Total BTX	<0.300	0.300	04/08/2014	ND						

Surrogate: 4-Bromofluorobenzene (PIE) 120 % 89.4-126

Chloride, SM4500Cl-B		mg/kg		Analyzed By: AP						
Analyte	Result	Reporting Limit	Analyzed	Method Blank	BS	% Recovery	True Value QC	RPD	Qualifier	
Chloride	160	16.0	04/08/2014	ND	416	104	400	0.00		

TPH 8015M		mg/kg		Analyzed By: ms					
Analyte	Result	Reporting Limit	Analyzed	Method Blank	BS	% Recovery	True Value QC	RPD	Qualifier
GRO C6-C10	<10.0	10.0	04/08/2014	ND	188	94.2	200	2.05	
DRO >C10-C28	<10.0	10.0	04/08/2014	ND	206	103	200	1.70	

Surrogate: 1-Chlorooctane 112 % 65.2-140

Surrogate: 1-Chlorooctadecane 104 % 63.6-154

Cardinal Laboratories

*=Accredited Analyte

PLEASE NOTE: Liability and Damages. Cardinal's liability and client's exclusive remedy for any claim arising, whether based in contract or tort, shall be limited to the amount paid by client for analyses. All claims, including those for negligence and any other cause whatsoever shall be deemed waived unless made in writing and received by Cardinal within thirty (30) days after completion of the applicable service. In no event shall Cardinal be liable for incidental or consequential damages, including, without limitation, business interruptions, loss of use, or loss of profits incurred by client, its subsidiaries, affiliates or successors arising out of or related to the performance of the services hereunder by Cardinal, regardless of whether such claim is based upon any of the above stated reasons or otherwise. Results relate only to the samples identified above. This report shall not be reproduced except in full with written approval of Cardinal Laboratories.



Celey D. Keene, Lab Director/Quality Manager

Analytical Results For:

RICE ENVIRONMENTAL CONSULTING & SAFETY
KYLE NORMAN
419 W. CAIN
HOBBS NM, 88240
Fax To: (575) 397-1471

Received: 04/07/2014
Reported: 04/08/2014
Project Name: MCA 2 F HEADER
Project Number: NONE GIVEN
Project Location: NONE GIVEN

Sampling Date: 04/07/2014
Sampling Type: Soil
Sampling Condition: Cool & Intact
Sample Received By: Jodi Henson

Sample ID: VERTICAL #3 SURFACE (H401054-07)

BTEX 8021B		mg/kg		Analyzed By: MS					
Analyte	Result	Reporting Limit	Analyzed	Method Blank	BS	% Recovery	True Value QC	RPD	Qualifier
Benzene*	<0.050	0.050	04/08/2014	ND	2.13	106	2.00	3.71	
Toluene*	<0.050	0.050	04/08/2014	ND	2.17	108	2.00	4.04	
Ethylbenzene*	<0.050	0.050	04/08/2014	ND	2.16	108	2.00	4.18	
Total Xylenes*	<0.150	0.150	04/08/2014	ND	6.29	105	6.00	4.72	
Total BTEX	<0.300	0.300	04/08/2014	ND					

Surrogate: 4-Bromofluorobenzene (PIE) 118 % 89.4-126

Chloride, SM4500Cl-B		mg/kg		Analyzed By: AP					
Analyte	Result	Reporting Limit	Analyzed	Method Blank	BS	% Recovery	True Value QC	RPD	Qualifier
Chloride	15600	16.0	04/08/2014	ND	416	104	400	0.00	

TPH 8015M		mg/kg		Analyzed By: ms						S-06
Analyte	Result	Reporting Limit	Analyzed	Method Blank	BS	% Recovery	True Value QC	RPD	Qualifier	
GRO C6-C10	<50.0	50.0	04/08/2014	ND	188	94.2	200	2.05		
DRO >C10-C28	2940	50.0	04/08/2014	ND	206	103	200	1.70		

Surrogate: 1-Chlorooctane 104 % 65.2-140

Surrogate: 1-Chlorooctadecane 158 % 63.6-154

Cardinal Laboratories

*=Accredited Analyte

PLEASE NOTE: Liability and Damages. Cardinal's liability and client's exclusive remedy for any claim arising, whether based in contract or tort, shall be limited to the amount paid by client for analyses. All claims, including those for negligence and any other cause whatsoever shall be deemed waived unless made in writing and received by Cardinal within thirty (30) days after completion of the applicable service. In no event shall Cardinal be liable for incidental or consequential damages, including, without limitation, business interruptions, loss of use, or loss of profits incurred by client, its subsidiaries, affiliates or successors arising out of or related to the performance of the services hereunder by Cardinal, regardless of whether such claim is based upon any of the above stated reasons or otherwise. Results relate only to the samples identified above. This report shall not be reproduced except in full with written approval of Cardinal Laboratories.

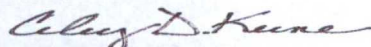

Caley D. Keene, Lab Director/Quality Manager

Analytical Results For:

RICE ENVIRONMENTAL CONSULTING & SAFETY
KYLE NORMAN
419 W. CAIN
HOBBS NM, 88240
Fax To: (575) 397-1471

Received: 04/07/2014
Reported: 04/08/2014
Project Name: MCA 2 F HEADER
Project Number: NONE GIVEN
Project Location: NONE GIVEN

Sampling Date: 04/07/2014
Sampling Type: Soil
Sampling Condition: Cool & Intact
Sample Received By: Jodi Henson

Sample ID: VERTICAL #3 6" (H401054-08)

BTX 8021B		mg/kg		Analyzed By: MS					
Analyte	Result	Reporting Limit	Analyzed	Method Blank	BS	% Recovery	True Value QC	RPD	Qualifier
Benzene*	<0.050	0.050	04/08/2014	ND	2.13	106	2.00	3.71	
Toluene*	<0.050	0.050	04/08/2014	ND	2.17	108	2.00	4.04	
Ethylbenzene*	<0.050	0.050	04/08/2014	ND	2.16	108	2.00	4.18	
Total Xylenes*	<0.150	0.150	04/08/2014	ND	6.29	105	6.00	4.72	
Total BTX	<0.300	0.300	04/08/2014	ND					

Surrogate: 4-Bromofluorobenzene (PIE) 119 % 89.4-126

Chloride, SM4500Cl-B		mg/kg		Analyzed By: AP					
Analyte	Result	Reporting Limit	Analyzed	Method Blank	BS	% Recovery	True Value QC	RPD	Qualifier
Chloride	1490	16.0	04/08/2014	ND	416	104	400	0.00	

TPH 8015M		mg/kg		Analyzed By: ms					
Analyte	Result	Reporting Limit	Analyzed	Method Blank	BS	% Recovery	True Value QC	RPD	Qualifier
GRO C6-C10	<50.0	50.0	04/08/2014	ND	188	94.2	200	2.05	
DRO >C10-C28	<50.0	50.0	04/08/2014	ND	206	103	200	1.70	

Surrogate: 1-Chlorooctane 100 % 65.2-140

Surrogate: 1-Chlorooctadecane 96.0 % 63.6-154

Cardinal Laboratories

*=Accredited Analyte

PLEASE NOTE: Liability and Damages. Cardinal's liability and client's exclusive remedy for any claim arising, whether based in contract or tort, shall be limited to the amount paid by client for analyses. All claims, including those for negligence and any other cause whatsoever shall be deemed waived unless made in writing and received by Cardinal within thirty (30) days after completion of the applicable service. In no event shall Cardinal be liable for incidental or consequential damages, including, without limitation, business interruptions, loss of use, or loss of profits incurred by client, its subsidiaries, affiliates or successors arising out of or related to the performance of the services hereunder by Cardinal, regardless of whether such claim is based upon any of the above stated reasons or otherwise. Results relate only to the samples identified above. This report shall not be reproduced except in full with written approval of Cardinal Laboratories.

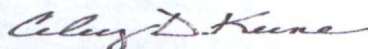

Celey D. Keene, Lab Director/Quality Manager

Analytical Results For:

RICE ENVIRONMENTAL CONSULTING & SAFETY
KYLE NORMAN
419 W. CAIN
HOBBS NM, 88240
Fax To: (575) 397-1471

Received: 04/07/2014
Reported: 04/08/2014
Project Name: MCA 2 F HEADER
Project Number: NONE GIVEN
Project Location: NONE GIVEN

Sampling Date: 04/07/2014
Sampling Type: Soil
Sampling Condition: Cool & Intact
Sample Received By: Jodi Henson

Sample ID: VERTICAL #3 2' (H401054-09)

BTX 8021B			mg/kg		Analyzed By: MS					
Analyte	Result	Reporting Limit	Analyzed	Method Blank	BS	% Recovery	True Value QC	RPD	Qualifier	
Benzene*	<0.050	0.050	04/08/2014	ND	2.13	106	2.00	3.71		
Toluene*	<0.050	0.050	04/08/2014	ND	2.17	108	2.00	4.04		
Ethylbenzene*	<0.050	0.050	04/08/2014	ND	2.16	108	2.00	4.18		
Total Xylenes*	<0.150	0.150	04/08/2014	ND	6.29	105	6.00	4.72		
Total BTX	<0.300	0.300	04/08/2014	ND						

Surrogate: 4-Bromofluorobenzene (PII) 120 % 89.4-126

Chloride, SM4500Cl-B		mg/kg		Analyzed By: AP					
Analyte	Result	Reporting Limit	Analyzed	Method Blank	BS	% Recovery	True Value QC	RPD	Qualifier
Chloride	128	16.0	04/08/2014	ND	416	104	400	0.00	

TPH 8015M		mg/kg		Analyzed By: ms					
Analyte	Result	Reporting Limit	Analyzed	Method Blank	BS	% Recovery	True Value QC	RPD	Qualifier
GRO C6-C10	<50.0	50.0	04/08/2014	ND	188	94.2	200	2.05	
DRO >C10-C28	127	50.0	04/08/2014	ND	206	103	200	1.70	

Surrogate: 1-Chlorooctane 85.5 % 65.2-140

Surrogate: 1-Chlorooctadecane 90.3 % 63.6-154

Cardinal Laboratories

*=Accredited Analyte

PLEASE NOTE: Liability and Damages. Cardinal's liability and client's exclusive remedy for any claim arising, whether based in contract or tort, shall be limited to the amount paid by client for analyses. All claims, including those for negligence and any other cause whatsoever shall be deemed waived unless made in writing and received by Cardinal within thirty (30) days after completion of the applicable service. In no event shall Cardinal be liable for incidental or consequential damages, including, without limitation, business interruptions, loss of use, or loss of profits incurred by client, its subsidiaries, affiliates or successors arising out of or related to the performance of the services hereunder by Cardinal, regardless of whether such claim is based upon any of the above stated reasons or otherwise. Results relate only to the samples identified above. This report shall not be reproduced except in full with written approval of Cardinal Laboratories.



Celey D. Keene, Lab Director/Quality Manager

Notes and Definitions

S-06	The recovery of this surrogate is outside control limits due to sample dilution required from high analyte concentration and/or matrix interference's.
S-04	The surrogate recovery for this sample is outside of established control limits due to a sample matrix effect.
ND	Analyte NOT DETECTED at or above the reporting limit
RPD	Relative Percent Difference
**	Samples not received at proper temperature of 6°C or below.
***	Insufficient time to reach temperature.
-	Chloride by SM4500Cl-B does not require samples be received at or below 6°C Samples reported on an as received basis (wet) unless otherwise noted on report

Cardinal Laboratories

*=Accredited Analyte

PLEASE NOTE: Liability and Damages. Cardinal's liability and client's exclusive remedy for any claim arising, whether based in contract or tort, shall be limited to the amount paid by client for analyses. All claims, including those for negligence and any other cause whatsoever shall be deemed waived unless made in writing and received by Cardinal within thirty (30) days after completion of the applicable service. In no event shall Cardinal be liable for incidental or consequential damages, including, without limitation, business interruptions, loss of use, or loss of profits incurred by client, its subsidiaries, affiliates or successors arising out of or related to the performance of the services hereunder by Cardinal, regardless of whether such claim is based upon any of the above stated reasons or otherwise. Results relate only to the samples identified above. This report shall not be reproduced except in full with written approval of Cardinal Laboratories.

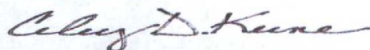

Celey D. Keene, Lab Director/Quality Manager

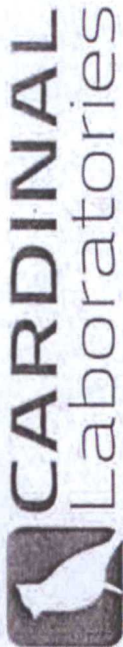

101 East Marland, Hobbs, NM 88240
(575) 393-2326 FAX (575) 393-2476

CHAIN-OF-CUSTODY AND ANALYSIS REQUEST

Company Name: RECS		P.O. #:		BILL TO		ANALYSIS REQUEST	
Project Manager: KYLE NORMAN		Company:		P.O. #:		P.O. #:	
Address:		Attn:		Address:		Address:	
City:		State:		City:		City:	
Phone #:		Fax #:		State:		State:	
Project #:		Project Owner:		Phone #:		Phone #:	
Project Name:		Project Location: COP MCA 2F HEADER		Fax #:		Fax #:	
Sampler Name: EDWARD CESAREO		Matrix:		PRESERV		SAMPLING	
Lab I.D.		Sample I.D.		DATE		TIME	
HYDID54	1 VERTICAL#1 Surface	0	1	4-7-14	10:15	TPH	
2	VERTICAL#1 6"	0	1	10:20		CLORIDES	
3	VERTICAL#1 1'	0	1	10:25		BTEX	
4	VERTICAL#2 Surface	0	1	11:50			
5	VERTICAL#2 1'	0	1	11:55			
6	VERTICAL#2 3.5'	0	1	12:00			
7	VERTICAL#3 Surface	0	1	12:50			
8	VERTICAL#3 6"	0	1	12:55			
9	VERTICAL#3 2'	0	1	1:00			

PLEASE NOTE: Liability and Damages. Cardinal's liability and client's exclusive remedy for any claim arising out of or from the use of the services provided by Cardinal shall be limited to the amount paid by the client for the analyses. All claims, including those for negligence and any other cause whatsoever shall be deemed waived unless made in writing and received by Cardinal within 30 days after completion of the applicable service. In no event shall Cardinal be liable for incidental or consequential damages, including without limitation, business interruption, loss of data, or loss of profits incurred by client, its subsidiaries, affiliates, or successors, arising out of or from the use of the services provided by Cardinal. Cardinal's responsibility of whether such claim is based upon any of the above stated reasons or otherwise.

Relinquished By:		Received By:		Phone Result:		Add'l Phone #:	
Date: 4-7-14		Date: 4-7-14		Fax Result:		Add'l Fax #:	
Time: 4:15		Time: 4:15		Fax Result:		Add'l Fax #:	
Relinquished By:		Received By:		REMARKS:		REMARKS:	
Edward Cesareo		Edi Benson		hronder@ricees.com		hronder@ricees.com	
				Knorman@ricees.com		Knorman@ricees.com	
				lweinniemer@ricees.com		lweinniemer@ricees.com	
				lcesareo@ricees.com		lcesareo@ricees.com	

Delivered By: (Circle One)
Sampler - UPS - Bus - Other:

* Cardinal cannot accept verbal changes. Please fax written changes to (575) 393-2326



PHONE (575) 393-2326 ° 101 E. MARLAND ° HOBBS, NM 88240

April 09, 2014

KYLE NORMAN

RICE ENVIRONMENTAL CONSULTING & SAFETY LLC

419 W. CAIN

HOBBS, NM 88240

RE: MCA 2 F HEADER

Enclosed are the results of analyses for samples received by the laboratory on 04/08/14 14:50.

Cardinal Laboratories is accredited through Texas NELAP under certificate number T104704398-13-5. Accreditation applies to drinking water, non-potable water and solid and chemical materials. All accredited analytes are denoted by an asterisk (*). For a complete list of accredited analytes and matrices visit the TCEQ website at www.tceq.texas.gov/field/qa/lab_accred_certif.html.

Cardinal Laboratories is accredited through the State of Colorado Department of Public Health and Environment for:

Method EPA 552.2	Haloacetic Acids (HAA-5)
Method EPA 524.2	Total Trihalomethanes (TTHM)
Method EPA 524.4	Regulated VOCs (V1, V2, V3)

Accreditation applies to public drinking water matrices.

This report meets NELAP requirements and is made up of a cover page, analytical results, and a copy of the original chain-of-custody. If you have any questions concerning this report, please feel free to contact me.

Sincerely,

Celey D. Keene

Lab Director/Quality Manager

Analytical Results For:

RICE ENVIRONMENTAL CONSULTING & SAFETY
KYLE NORMAN
419 W. CAIN
HOBBS NM, 88240
Fax To: (575) 397-1471

Received: 04/08/2014
Reported: 04/09/2014
Project Name: MCA 2 F HEADER
Project Number: NONE GIVEN
Project Location: NONE GIVEN

Sampling Date: 04/08/2014
Sampling Type: Soil
Sampling Condition: ** (See Notes)
Sample Received By: Jodi Henson

Sample ID: POINT 4 @ SURFACE (H401066-01)

BTEX 8021B		mg/kg		Analyzed By: MS					
Analyte	Result	Reporting Limit	Analyzed	Method Blank	BS	% Recovery	True Value QC	RPD	Qualifier
Benzene*	<0.200	0.200	04/09/2014	ND	2.19	109	2.00	4.47	
Toluene*	0.430	0.200	04/09/2014	ND	2.09	105	2.00	3.09	
Ethylbenzene*	0.850	0.200	04/09/2014	ND	2.02	101	2.00	3.47	
Total Xylenes*	3.07	0.600	04/09/2014	ND	5.81	96.8	6.00	3.75	
Total BTEX	4.35	1.20	04/09/2014	ND					

Surrogate: 4-Bromofluorobenzene (PIC) 123 % 89.4-126

Chloride, SM4500Cl-B		mg/kg		Analyzed By: AP					
Analyte	Result	Reporting Limit	Analyzed	Method Blank	BS	% Recovery	True Value QC	RPD	Qualifier
Chloride	4280	16.0	04/09/2014	ND	400	100	400	0.00	

TPH 8015M		mg/kg		Analyzed By: ms						S-06
Analyte	Result	Reporting Limit	Analyzed	Method Blank	BS	% Recovery	True Value QC	RPD	Qualifier	
GRO C6-C10	<100	100	04/09/2014	ND	203	101	200	3.60		
DRO >C10-C28	19600	100	04/09/2014	ND	219	109	200	6.96		

Surrogate: 1-Chlorooctane 152 % 65.2-140

Surrogate: 1-Chlorooctadecane 648 % 63.6-154

Cardinal Laboratories

*=Accredited Analyte

PLEASE NOTE: Liability and Damages. Cardinal's liability and client's exclusive remedy for any claim arising, whether based in contract or tort, shall be limited to the amount paid by client for analyses. All claims, including those for negligence and any other cause whatsoever shall be deemed waived unless made in writing and received by Cardinal within thirty (30) days after completion of the applicable service. In no event shall Cardinal be liable for incidental or consequential damages, including, without limitation, business interruptions, loss of use, or loss of profits incurred by client, its subsidiaries, affiliates or successors arising out of or related to the performance of the services hereunder by Cardinal, regardless of whether such claim is based upon any of the above stated reasons or otherwise. Results relate only to the samples identified above. This report shall not be reproduced except in full with written approval of Cardinal Laboratories.

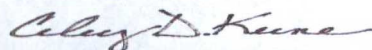

Celey D. Keene, Lab Director/Quality Manager

Analytical Results For:

 RICE ENVIRONMENTAL CONSULTING & SAFETY
 KYLE NORMAN
 419 W. CAIN
 HOBBS NM, 88240
 Fax To: (575) 397-1471

 Received: 04/08/2014
 Reported: 04/09/2014
 Project Name: MCA 2 F HEADER
 Project Number: NONE GIVEN
 Project Location: NONE GIVEN

 Sampling Date: 04/08/2014
 Sampling Type: Soil
 Sampling Condition: ** (See Notes)
 Sample Received By: Jodi Henson

Sample ID: POINT 4 @ 1' (H401066-02)

BTEX 8021B		mg/kg		Analyzed By: MS					
Analyte	Result	Reporting Limit	Analyzed	Method Blank	BS	% Recovery	True Value QC	RPD	Qualifier
Benzene*	<0.050	0.050	04/09/2014	ND	2.19	109	2.00	4.47	
Toluene*	<0.050	0.050	04/09/2014	ND	2.09	105	2.00	3.09	
Ethylbenzene*	<0.050	0.050	04/09/2014	ND	2.02	101	2.00	3.47	
Total Xylenes*	<0.150	0.150	04/09/2014	ND	5.81	96.8	6.00	3.75	
Total BTEX	<0.300	0.300	04/09/2014	ND					

Surrogate: 4-Bromofluorobenzene (PIE) 110 % 89.4-126

Chloride, SM4500Cl-B		mg/kg		Analyzed By: AP					
Analyte	Result	Reporting Limit	Analyzed	Method Blank	BS	% Recovery	True Value QC	RPD	Qualifier
Chloride	1740	16.0	04/09/2014	ND	400	100	400	0.00	

TPH 8015M		mg/kg		Analyzed By: ms					
Analyte	Result	Reporting Limit	Analyzed	Method Blank	BS	% Recovery	True Value QC	RPD	Qualifier
GRO C6-C10	<10.0	10.0	04/09/2014	ND	203	101	200	3.60	
DRO >C10-C28	<10.0	10.0	04/09/2014	ND	219	109	200	6.96	

Surrogate: 1-Chlorooctane 119 % 65.2-140

Surrogate: 1-Chlorooctadecane 109 % 63.6-154

Cardinal Laboratories

*=Accredited Analyte

PLEASE NOTE: Liability and Damages. Cardinal's liability and client's exclusive remedy for any claim arising, whether based in contract or tort, shall be limited to the amount paid by client for analyses. All claims, including those for negligence and any other cause whatsoever shall be deemed waived unless made in writing and received by Cardinal within thirty (30) days after completion of the applicable service. In no event shall Cardinal be liable for incidental or consequential damages, including, without limitation, business interruptions, loss of use, or loss of profits incurred by client, its subsidiaries, affiliates or successors arising out of or related to the performance of the services hereunder by Cardinal, regardless of whether such claim is based upon any of the above stated reasons or otherwise. Results relate only to the samples identified above. This report shall not be reproduced except in full with written approval of Cardinal Laboratories.

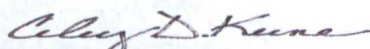

Celey D. Keene, Lab Director/Quality Manager

Analytical Results For:

RICE ENVIRONMENTAL CONSULTING & SAFETY
KYLE NORMAN
419 W. CAIN
HOBBS NM, 88240
Fax To: (575) 397-1471

Received: 04/08/2014
Reported: 04/09/2014
Project Name: MCA 2 F HEADER
Project Number: NONE GIVEN
Project Location: NONE GIVEN

Sampling Date: 04/08/2014
Sampling Type: Soil
Sampling Condition: ** (See Notes)
Sample Received By: Jodi Henson

Sample ID: POINT 4 @ 2' (H401066-03)

BTEX 8021B		mg/kg	Analyzed By: MS						
Analyte	Result	Reporting Limit	Analyzed	Method Blank	BS	% Recovery	True Value QC	RPD	Qualifier
Benzene*	<0.050	0.050	04/09/2014	ND	2.19	109	2.00	4.47	
Toluene*	0.054	0.050	04/09/2014	ND	2.09	105	2.00	3.09	
Ethylbenzene*	0.155	0.050	04/09/2014	ND	2.02	101	2.00	3.47	
Total Xylenes*	0.659	0.150	04/09/2014	ND	5.81	96.8	6.00	3.75	
Total BTEX	0.868	0.300	04/09/2014	ND					

Surrogate: 4-Bromofluorobenzene (PIL) 123 % 89.4-126

Chloride, SM4500CI-B		mg/kg	Analyzed By: AP						
Analyte	Result	Reporting Limit	Analyzed	Method Blank	BS	% Recovery	True Value QC	RPD	Qualifier
Chloride	240	16.0	04/09/2014	ND	400	100	400	0.00	

TPH 8015M		mg/kg	Analyzed By: ms						
Analyte	Result	Reporting Limit	Analyzed	Method Blank	BS	% Recovery	True Value QC	RPD	Qualifier
GRO C6-C10	<50.0	50.0	04/09/2014	ND	203	101	200	3.60	
DRO >C10-C28	<50.0	50.0	04/09/2014	ND	219	109	200	6.96	

Surrogate: 1-Chlorooctane 108 % 65.2-140

Surrogate: 1-Chlorooctadecane 106 % 63.6-154

Cardinal Laboratories

*=Accredited Analyte

PLEASE NOTE: Liability and Damages. Cardinal's liability and client's exclusive remedy for any claim arising, whether based in contract or tort, shall be limited to the amount paid by client for analyses. All claims, including those for negligence and any other cause whatsoever shall be deemed waived unless made in writing and received by Cardinal within thirty (30) days after completion of the applicable service. In no event shall Cardinal be liable for incidental or consequential damages, including, without limitation, business interruptions, loss of use, or loss of profits incurred by client, its subsidiaries, affiliates or successors arising out of or related to the performance of the services hereunder by Cardinal, regardless of whether such claim is based upon any of the above stated reasons or otherwise. Results relate only to the samples identified above. This report shall not be reproduced except in full with written approval of Cardinal Laboratories.



Celey D. Keene, Lab Director/Quality Manager

Notes and Definitions

S-06	The recovery of this surrogate is outside control limits due to sample dilution required from high analyte concentration and/or matrix interference's.
ND	Analyte NOT DETECTED at or above the reporting limit
RPD	Relative Percent Difference
**	Samples not received at proper temperature of 6°C or below.
***	Insufficient time to reach temperature.
-	Chloride by SM4500Cl-B does not require samples be received at or below 6°C Samples reported on an as received basis (wet) unless otherwise noted on report

Cardinal Laboratories

*=Accredited Analyte

PLEASE NOTE: Liability and Damages. Cardinal's liability and client's exclusive remedy for any claim arising, whether based in contract or tort, shall be limited to the amount paid by client for analyses. All claims, including those for negligence and any other cause whatsoever shall be deemed waived unless made in writing and received by Cardinal within thirty (30) days after completion of the applicable service. In no event shall Cardinal be liable for incidental or consequential damages, including, without limitation, business interruptions, loss of use, or loss of profits incurred by client, its subsidiaries, affiliates or successors arising out of or related to the performance of the services hereunder by Cardinal, regardless of whether such claim is based upon any of the above stated reasons or otherwise. Results relate only to the samples identified above. This report shall not be reproduced except in full with written approval of Cardinal Laboratories.



Celey D. Keene, Lab Director/Quality Manager

CHAIN-OF-CUSTODY AND ANALYSIS REQUEST

ARDINAL LABORATORIES

101 East Marland, Hobbs, NM 88240 2111 Beechwood, Abilene, TX 79603
(505) 393-2326 FAX (505) 393-2476 (325) 673-7001 FAX (325) 673-7020

Company Name: <i>RCS</i>		BILL TO		ANALYSIS REQUEST																			
Project Manager: <i>Kyle Newman</i>		P.O. #:		Company:		City:		State:		Zip:		Chlorides		TPH 8015 M		BTEX		Texas TPH		Complete Cations/Anions		TDS	
Address:		Attn:		Address:		City:		State:		Zip:		Phone #:		Fax #:									
Project #:		Project Owner:		Project #:		Project Owner:		Project #:		Project Owner:		Project #:		Project Owner:									
Project Name: <i>CoP</i>		Project Location: <i>MCA 2F Header</i>		Project Name:		Project Location:		Project Name:		Project Location:		Project Name:		Project Location:									
Sampler Name: <i>Chris Flores</i>		Matrix:		PRESERV		SAMPLING		DATE		TIME													
FOR LAB USE ONLY		GROUNDWATER		WASTEWATER		SLUDGE		OIL		SOIL		ACID/BASE		ICE / COOL		OTHER:							
Lab I.D.		Sample I.D.		# CONTAINERS		(G) RAB OR (C) OMP		DATE		TIME													
<i>H401000</i>		<i>Point 4 @ Surface</i>		<i>1</i>		<i>G</i>		<i>4-8-14</i>		<i>1:35 PM</i>		<i>X</i>		<i>X</i>		<i>X</i>		<i>X</i>		<i>X</i>		<i>X</i>	
<i>2</i>		<i>Point 4 @ 1'</i>		<i>1</i>		<i>G</i>		<i>4-8-14</i>		<i>1:40 PM</i>		<i>X</i>		<i>X</i>		<i>X</i>		<i>X</i>		<i>X</i>		<i>X</i>	
<i>3</i>		<i>Point 4 @ 2'</i>		<i>1</i>		<i>G</i>		<i>4-8-14</i>		<i>1:45 PM</i>		<i>X</i>		<i>X</i>		<i>X</i>		<i>X</i>		<i>X</i>		<i>X</i>	

PLEASE NOTE: Liability and Damages: Cardinal's liability and client's exclusive remedy for any claim arising whether based in contract or tort, shall be limited to the amount paid by the client for the analyses. All claims, including those for negligence and any other cause whatsoever shall be deemed waived unless made in writing and received by Cardinal within 30 days after completion of the applicable service. In no event shall Cardinal be liable for incidental or consequential damages, including without limitation, business interruptions, loss of use, or loss of profits incurred by client, its subsidiaries, affiliates or successors arising out of or related to the performance of services hereunder by Cardinal, regardless of whether such claim is based upon any of the above stated reasons or otherwise.

Relinquished By: <i>[Signature]</i>		Received By: <i>Chris Flores</i>		Date: <i>4-8-14</i>		Time: <i>2:50</i>		Phone Result: <input type="checkbox"/> Yes <input type="checkbox"/> No		Add'l Phone #: <i>lflores@</i>	
Relinquished By: <i>[Signature]</i>		Received By: <i>[Signature]</i>		Date: <i>4-8-14</i>		Time: <i>2:50</i>		Fax Result: <input type="checkbox"/> Yes <input type="checkbox"/> No		Add'l Fax #: <i>cflores@</i>	
Delivered By: (Circle One)		Sample Condition		Checked By: <i>[Signature]</i>		Initials: <i>[Signature]</i>		email results		<i>lflores@</i>	
Sampler - UPS - Bus - Other:		Cool Intact <input type="checkbox"/> Yes <input type="checkbox"/> No		Sample Condition		Initials: <i>[Signature]</i>		Kneenard@		<i>cflores@</i>	
		Yes <input type="checkbox"/> No <input type="checkbox"/>		Sample Condition		Initials: <i>[Signature]</i>		Kneenard@		<i>cflores@</i>	
		Yes <input type="checkbox"/> No <input type="checkbox"/>		Sample Condition		Initials: <i>[Signature]</i>		Kneenard@		<i>cflores@</i>	
		Yes <input type="checkbox"/> No <input type="checkbox"/>		Sample Condition		Initials: <i>[Signature]</i>		Kneenard@		<i>cflores@</i>	
		Yes <input type="checkbox"/> No <input type="checkbox"/>		Sample Condition		Initials: <i>[Signature]</i>		Kneenard@		<i>cflores@</i>	
		Yes <input type="checkbox"/> No <input type="checkbox"/>		Sample Condition		Initials: <i>[Signature]</i>		Kneenard@		<i>cflores@</i>	
		Yes <input type="checkbox"/> No <input type="checkbox"/>		Sample Condition		Initials: <i>[Signature]</i>		Kneenard@		<i>cflores@</i>	
		Yes <input type="checkbox"/> No <input type="checkbox"/>		Sample Condition		Initials: <i>[Signature]</i>		Kneenard@		<i>cflores@</i>	
		Yes <input type="checkbox"/> No <input type="checkbox"/>		Sample Condition		Initials: <i>[Signature]</i>		Kneenard@		<i>cflores@</i>	
		Yes <input type="checkbox"/> No <input type="checkbox"/>		Sample Condition		Initials: <i>[Signature]</i>		Kneenard@		<i>cflores@</i>	
		Yes <input type="checkbox"/> No <input type="checkbox"/>		Sample Condition		Initials: <i>[Signature]</i>		Kneenard@		<i>cflores@</i>	
		Yes <input type="checkbox"/> No <input type="checkbox"/>		Sample Condition		Initials: <i>[Signature]</i>		Kneenard@		<i>cflores@</i>	
		Yes <input type="checkbox"/> No <input type="checkbox"/>		Sample Condition		Initials: <i>[Signature]</i>		Kneenard@		<i>cflores@</i>	
		Yes <input type="checkbox"/> No <input type="checkbox"/>		Sample Condition		Initials: <i>[Signature]</i>		Kneenard@		<i>cflores@</i>	
		Yes <input type="checkbox"/> No <input type="checkbox"/>		Sample Condition		Initials: <i>[Signature]</i>		Kneenard@		<i>cflores@</i>	
		Yes <input type="checkbox"/> No <input type="checkbox"/>		Sample Condition		Initials: <i>[Signature]</i>		Kneenard@		<i>cflores@</i>	
		Yes <input type="checkbox"/> No <input type="checkbox"/>		Sample Condition		Initials: <i>[Signature]</i>		Kneenard@		<i>cflores@</i>	
		Yes <input type="checkbox"/> No <input type="checkbox"/>		Sample Condition		Initials: <i>[Signature]</i>		Kneenard@		<i>cflores@</i>	
		Yes <input type="checkbox"/> No <input type="checkbox"/>		Sample Condition		Initials: <i>[Signature]</i>		Kneenard@		<i>cflores@</i>	
		Yes <input type="checkbox"/> No <input type="checkbox"/>		Sample Condition		Initials: <i>[Signature]</i>		Kneenard@		<i>cflores@</i>	
		Yes <input type="checkbox"/> No <input type="checkbox"/>		Sample Condition		Initials: <i>[Signature]</i>		Kneenard@		<i>cflores@</i>	
		Yes <input type="checkbox"/> No <input type="checkbox"/>		Sample Condition		Initials: <i>[Signature]</i>		Kneenard@		<i>cflores@</i>	
		Yes <input type="checkbox"/> No <input type="checkbox"/>		Sample Condition		Initials: <i>[Signature]</i>		Kneenard@		<i>cflores@</i>	
		Yes <input type="checkbox"/> No <input type="checkbox"/>		Sample Condition		Initials: <i>[Signature]</i>		Kneenard@		<i>cflores@</i>	
		Yes <input type="checkbox"/> No <input type="checkbox"/>		Sample Condition		Initials: <i>[Signature]</i>		Kneenard@		<i>cflores@</i>	
		Yes <input type="checkbox"/> No <input type="checkbox"/>		Sample Condition		Initials: <i>[Signature]</i>		Kneenard@		<i>cflores@</i>	
		Yes <input type="checkbox"/> No <input type="checkbox"/>		Sample Condition		Initials: <i>[Signature]</i>		Kneenard@		<i>cflores@</i>	
		Yes <input type="checkbox"/> No <input type="checkbox"/>		Sample Condition		Initials: <i>[Signature]</i>		Kneenard@		<i>cflores@</i>	
		Yes <input type="checkbox"/> No <input type="checkbox"/>		Sample Condition		Initials: <i>[Signature]</i>		Kneenard@		<i>cflores@</i>	
		Yes <input type="checkbox"/> No <input type="checkbox"/>		Sample Condition		Initials: <i>[Signature]</i>		Kneenard@		<i>cflores@</i>	
		Yes <input type="checkbox"/> No <input type="checkbox"/>		Sample Condition		Initials: <i>[Signature]</i>		Kneenard@		<i>cflores@</i>	
		Yes <input type="checkbox"/> No <input type="checkbox"/>		Sample Condition		Initials: <i>[Signature]</i>		Kneenard@		<i>cflores@</i>	
		Yes <input type="checkbox"/> No <input type="checkbox"/>		Sample Condition		Initials: <i>[Signature]</i>		Kneenard@		<i>cflores@</i>	
		Yes <input type="checkbox"/> No <input type="checkbox"/>		Sample Condition		Initials: <i>[Signature]</i>		Kneenard@		<i>cflores@</i>	
		Yes <input type="checkbox"/> No <input type="checkbox"/>		Sample Condition		Initials: <i>[Signature]</i>		Kneenard@		<i>cflores@</i>	
		Yes <input type="checkbox"/> No <input type="checkbox"/>		Sample Condition		Initials: <i>[Signature]</i>		Kneenard@		<i>cflores@</i>	
		Yes <input type="checkbox"/> No <input type="checkbox"/>		Sample Condition		Initials: <i>[Signature]</i>		Kneenard@		<i>cflores@</i>	
		Yes <input type="checkbox"/> No <input type="checkbox"/>		Sample Condition		Initials: <i>[Signature]</i>		Kneenard@		<i>cflores@</i>	
		Yes <input type="checkbox"/> No <input type="checkbox"/>		Sample Condition		Initials: <i>[Signature]</i>		Kneenard@		<i>cflores@</i>	
		Yes <input type="checkbox"/> No <input type="checkbox"/>		Sample Condition		Initials: <i>[Signature]</i>		Kneenard@		<i>cflores@</i>	
		Yes <input type="checkbox"/> No <input type="checkbox"/>		Sample Condition		Initials: <i>[Signature]</i>		Kneenard@		<i>cflores@</i>	
		Yes <input type="checkbox"/> No <input type="checkbox"/>		Sample Condition		Initials: <i>[Signature]</i>		Kneenard@		<i>cflores@</i>	
		Yes <input type="checkbox"/> No <input type="checkbox"/>		Sample Condition		Initials: <i>[Signature]</i>		Kneenard@		<i>cflores@</i>	
		Yes <input type="checkbox"/> No <input type="checkbox"/>		Sample Condition		Initials: <i>[Signature]</i>		Kneenard@		<i>cflores@</i>	
		Yes <input type="checkbox"/> No <input type="checkbox"/>		Sample Condition		Initials: <i>[Signature]</i>		Kneenard@		<i>cflores@</i>	
		Yes <input type="checkbox"/> No <input type="checkbox"/>		Sample Condition		Initials: <i>[Signature]</i>		Kneenard@		<i>cflores@</i>	
		Yes <input type="checkbox"/> No <input type="checkbox"/>		Sample Condition		Initials: <i>[Signature]</i>		Kneenard@		<i>cflores@</i>	
		Yes <input type="checkbox"/> No <input type="checkbox"/>		Sample Condition		Initials: <i>[Signature]</i>		Kneenard@		<i>cflores@</i>	
		Yes <input type="checkbox"/> No <input type="checkbox"/>		Sample Condition		Initials: <i>[Signature]</i>		Kneenard@		<i>cflores@</i>	
		Yes <input type="checkbox"/> No <input type="checkbox"/>		Sample Condition		Initials: <i>[Signature]</i>		Kneenard@		<i>cflores@</i>	
		Yes <input type="checkbox"/> No <input type="checkbox"/>		Sample Condition		Initials: <i>[Signature]</i>		Kneenard@		<i>cflores@</i>	
		Yes <input type="checkbox"/> No <input type="checkbox"/>		Sample Condition		Initials: <i>[Signature]</i>		Kneenard@		<i>cflores@</i>	
		Yes <input type="checkbox"/> No <input type="checkbox"/>		Sample Condition		Initials: <i>[Signature]</i>		Kneenard@		<i>cflores@</i>	
		Yes <input type="checkbox"/> No <input type="checkbox"/>		Sample Condition		Initials: <i>[Signature]</i>		Kneenard@		<i>cflores@</i>	
		Yes <input type="checkbox"/> No <input type="checkbox"/>		Sample Condition		Initials: <i>[Signature]</i>		Kneenard@		<i>cflores@</i>	
		Yes <input type="checkbox"/> No <input type="checkbox"/>		Sample Condition		Initials: <i>[Signature]</i>		Kneenard@		<i>cflores@</i>	
		Yes <input type="checkbox"/> No <input type="checkbox"/>		Sample Condition		Initials: <i>[Signature]</i>		Kneenard@		<i>cflores@</i>	
		Yes <input type="checkbox"/> No <input type="checkbox"/>		Sample Condition		Initials: <i>[Signature]</i>		Kneenard@		<i>cflores@</i>	
		Yes <input type="checkbox"/> No <input type="checkbox"/>		Sample Condition		Initials: <i>[Signature]</i>		Kneenard@		<i>cflores@</i>	
		Yes <input type="checkbox"/> No <input type="checkbox"/>		Sample Condition		Initials: <i>[Signature]</i>		Kneenard@		<i>cflores@</i>	
		Yes <input type="checkbox"/> No <input type="checkbox"/>		Sample Condition		Initials: <i>[Signature]</i>		Kneenard@		<i>cflores@</i>	
		Yes <input type="checkbox"/> No <input type="checkbox"/>		Sample Condition		Initials: <i>[Signature]</i>		Kneenard@		<i>cflores@</i>	
		Yes <input type="checkbox"/> No <input type="checkbox"/>		Sample Condition		Initials: <i>[Signature]</i>		Kneenard@		<i>cflores@</i>	
		Yes <input type="checkbox"/> No <input type="checkbox"/>		Sample Condition		Initials: <i>[Signature]</i>		Kneenard@		<i>cflores@</i>	
		Yes <input type="checkbox"/> No <input type="checkbox"/>		Sample Condition		Initials: <i>[Signature]</i>		Kneenard@		<i>cflores@</i>	
		Yes <input type="checkbox"/> No <input type="checkbox"/>		Sample Condition		Initials: <i>[Signature]</i>		Kneenard@		<i>cflores@</i>	
		Yes <input type="checkbox"/> No <input type="checkbox"/>		Sample Condition		Initials: <i>[Signature]</i>		Kneenard@		<i>cflores@</i>	
		Yes <input type="checkbox"/> No <input type="checkbox"/>		Sample Condition		Initials: <i>[Signature]</i>		Kneenard@		<i>cflores@</i>	
		Yes <input type="checkbox"/> No <input type="checkbox"/>		Sample Condition		Initials: <i>[Signature]</i>		Kneenard@		<i>cflores@</i>	
		Yes <input type="checkbox"/> No <input type="checkbox"/>		Sample Condition		Initials: <i>[Signature]</i>		Kneenard@		<i>cflores@</i>	
		Yes <input type="checkbox"/> No <input type="checkbox"/>		Sample Condition		Initials: <i>[Signature]</i>		Kneenard@		<i>cflores@</i>	
		Yes <input type="checkbox"/> No <input type="checkbox"/>		Sample Condition		Initials: <i>[Signature]</i>		Kneenard@		<i>cflores@</i>	
		Yes <input type="checkbox"/> No <input type="checkbox"/>		Sample Condition		Initials: <i>[Signature]</i>		Kneenard@		<i>cflores@</i>	
		Yes <input type="checkbox"/> No <input type="checkbox"/>		Sample Condition		Initials: <i>[Signature]</i>		Kneenard@		<i>cflores@</i>	
		Yes <input type="checkbox"/> No <input type="checkbox"/>		Sample Condition		Initials: <i>[Signature]</i>		Kneenard@		<i>cflores@</i>	
		Yes <input type="checkbox"/> No <input type="checkbox"/>		Sample Condition		Initials: <i>[Signature]</i>		Kneenard@		<i>cflores@</i>	
		Yes <input type="checkbox"/> No <input type="checkbox"/>		Sample Condition		Initials: <i>[Signature]</i>		Kneenard@		<i>cflores@</i>	
		Yes <input type="checkbox"/> No <input type="checkbox"/>		Sample Condition		Initials: <i>[Signature]</i>		Kneenard@		<i>cflores@</i>	
		Yes <input type="checkbox"/> No <input type="checkbox"/>		Sample Condition		Initials: <i>[Signature]</i>		Kneenard@		<i>cflores@</i>	
		Yes <input type="checkbox"/> No <input type="checkbox"/>		Sample Condition		Initials: <i>[Signature]</i>		Kneenard@		<i>cflores@</i>	
		Yes <input type="checkbox"/> No <input type="checkbox"/>		Sample Condition		Initials: <i>[Signature]</i>		Kneenard@		<i>cflores@</i>	
		Yes <input type="checkbox"/> No <input type="checkbox"/>		Sample Condition		Initials: <i>[Signature]</i>		Kneenard@		<i>cflores@</i>	
		Yes <input type="checkbox"/> No <input type="checkbox"/>		Sample Condition		Initials: <i>[Signature]</i>		Kneenard@		<i>cflores@</i>	
		Yes <input type="checkbox"/> No <input type="checkbox"/>		Sample Condition		Initials: <i>[Signature]</i>		Kneenard@		<i>cflores@</i>	
		Yes <input type="checkbox"/> No <input type="checkbox"/>		Sample Condition		Initials: <i>[Signature]</i>		Kneenard@		<i>cflores@</i>	
		Yes <input type="checkbox"/> No <input type="checkbox"/>		Sample Condition		Initials: <i>[Signature]</i>		Kneenard@		<i>cflores@</i>	
		Yes <input type="checkbox"/> No <input type="checkbox"/>		Sample Condition		Initials: <i>[Signature]</i>		Kneenard@		<i>cflores@</i>	
		Yes <input type="checkbox"/> No <input type="checkbox"/>		Sample Condition		Initials: <i>[Signature]</i>		Kneenard@		<i>cflores@</i>	
		Yes <input type="checkbox"/> No <input type="checkbox"/>		Sample Condition		Initials: <i>[Signature]</i>		Kneenard@		<i>cflores@</i>	
		Yes <input type="checkbox"/> No <input type="checkbox"/>		Sample Condition		Initials: <i>[Signature]</i>		Kneenard@		<i>cflores@</i>	
		Yes <input type="checkbox"/> No <input type="checkbox"/>		Sample Condition		Initials: <i>[Signature]</i>		Kneenard@		<i>cflores@</i>	
		Yes <input type="checkbox"/> No <input type="checkbox"/>		Sample Condition		Initials: <i>[Signature]</i>		Kneenard@		<i>cflores@</i>	
		Yes <input type="checkbox"/> No <input type="checkbox"/>		Sample Condition		Initials: <i>[Signature]</i>		Kneenard@		<i>cflores@</i>	
		Yes <input type="checkbox"/> No <input type="checkbox"/>		Sample Condition		Initials: <i>[Signature]</i>		Kneenard@		<i>cflores@</i>	
		Yes <input type="checkbox"/> No <input type="checkbox"/>		Sample Condition		Initials: <i>[Signature]</i>		Kneenard@		<i>cflores@</i>	
		Yes <input type="checkbox"/> No <input type="checkbox"/>		Sample Condition		Initials: <i>[Signature]</i>		Kneenard@		<i>cflores@</i>	
		Yes <input type="checkbox"/> No <input type="checkbox"/>		Sample Condition		Initials: <i>[Signature]</i>		Kneenard@		<i>cflores@</i>	
		Yes <input type="checkbox"/> No <input type="checkbox"/>		Sample Condition		Initials: <i>[Signature]</i>		Kneenard@		<i>cflores@</i>	
		Yes <input type="checkbox"/> No <input type="checkbox"/>		Sample Condition		Initials: <i>[Signature]</i>		Kneenard@		<i>cflores@</i>	
		Yes <input type="checkbox"/> No <input type="checkbox"/>		Sample Condition		Initials: <i>[Signature]</i>		Kneenard@		<i>cflores@</i>	
		Yes <input type="checkbox"/> No <input type="checkbox"/>		Sample Condition		Initials: <i>[Signature]</i>		Kneenard@		<i>cflores@</i>	
		Yes <input type="checkbox"/> No <input type="checkbox"/>		Sample Condition		Initials: <i>[Signature]</i>		Kneenard@		<i>cflores@</i>	
		Yes <input type="checkbox"/> No									

ConocoPhillips MCA 2F Header

Unit Letter J, Section 27, T17S, R32E

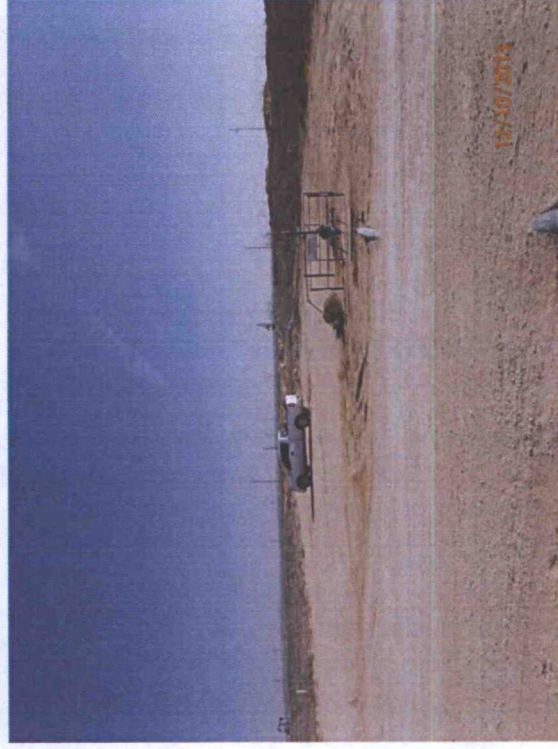

Initial site photo, facing east

12/10/13

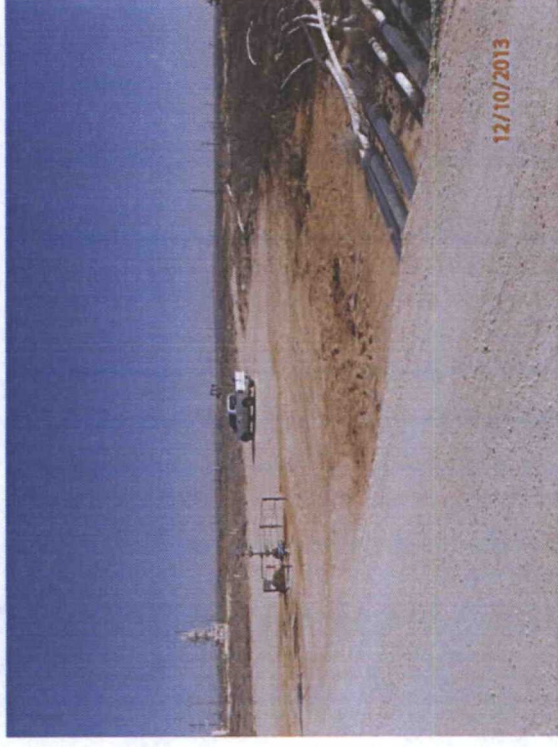

Initial site photo, facing northeast

12/10/13



Initial site photo, facing north

12/10/13



Installing verticals, facing northwest

4/7/14

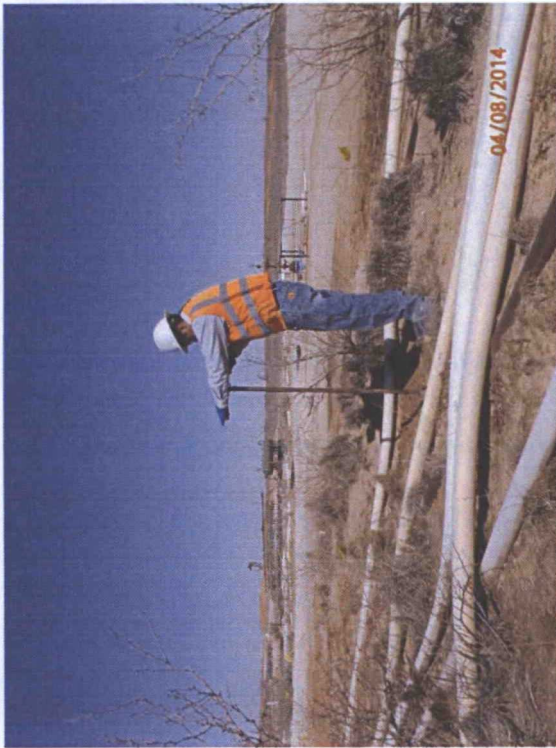

Hand auguring Point 4, facing northwest 4/8/14