

District I
1625 N. French Dr., Hobbs, NM 88240
District II
811 S. First St., Artesia, NM 88210
District III
1000 Rio Brazos Road, Aztec, NM 87410
District IV
1220 S. St. Francis Dr., Santa Fe, NM 87505

State of New Mexico
Energy Minerals and Natural Resources

Oil Conservation Division
1220 South St. Francis Dr.
Santa Fe, NM 87505

Form C-141
Revised August 8, 2011

Submit 1 Copy to appropriate District Office in
accordance with 19.15.29 NMAC.

Release Notification and Corrective Action

OPERATOR

☐ Initial Report ☒ Final Report

Name of Company DCP Midstream, LLC	Contact Patricia Grajeda	
Address 10 Desta Drive, Suite 400 W, Midland, TX 79705	Telephone No. 432-620-5403	
Facility Name M Extension Line	Facility Type Pipeline	
Surface Owner BLM	Mineral Owner	API No.

LOCATION OF RELEASE

Unit Letter	Section	Township	Range	Feet from the	North/South Line	Feet from the	East/West Line	County
A	5	19S	31E					LEA

Latitude N32.6955 Longitude W103.8857

NATURE OF RELEASE

Type of Release Gas and Liquid	Volume of Release ~1500 Mscf/15 bbls	Volume Recovered 0
Source of Release Pipeline	Date and Hour of Occurrence 4Jan12 1444hrs	Date and Hour of Discovery Same
Was Immediate Notice Given? <input type="checkbox"/> Yes <input type="checkbox"/> No <input checked="" type="checkbox"/> Not Required	If YES, To Whom? N/A	
By Whom? Johnnie Bradford	Date and Hour N/A	
Was a Watercourse Reached? <input type="checkbox"/> Yes <input checked="" type="checkbox"/> No	If YES, Volume Impacting the Watercourse. N/A	
If a Watercourse was Impacted, Describe Fully.* N/A	<div>RECEIVED MAR 5 2012 NMOCD ARTESIA</div>	
Describe Cause of Problem and Remedial Action Taken.* Pipe developed a hole on the bottom of the pipeline due to corrosion. Line was isolated, then replaced with poly pipe. All saturated soil that was excavated during repair, was stockpiled on plastic for transport during the remediation phase.		
Describe Area Affected and Cleanup Action Taken.* The affected area was a two-track ROW road and the immediate area near the point of release. The affected part of the road was approx 3'W x 1000'L. The area near the point of release was approx 30'W x 100'L x 10'D. Both areas were excavated with the material being stockpiled for transportation to a division approved facility. Soil samples were obtained and results presented to NM OCD's Mike Bratcher for closure approval. Approval was given and the area was backfilled with clean material, contoured and seeded with a BLM approved seed mixture. BLM's Jim Amos was notified by phone of the work plan as well and advised we could proceed. Jim was advised that the release remained on the ROW and no other area was affected.		

I hereby certify that the information given above is true and complete to the best of my knowledge and understand that pursuant to NMOCD rules and regulations all operators are required to report and/or file certain release notifications and perform corrective actions for releases which may endanger public health or the environment. The acceptance of a C-141 report by the NMOCD marked as "Final Report" does not relieve the operator of liability should their operations have failed to adequately investigate and remediate contamination that pose a threat to ground water, surface water, human health or the environment. In addition, NMOCD acceptance of a C-141 report does not relieve the operator of responsibility for compliance with any other federal, state, or local laws and/or regulations.

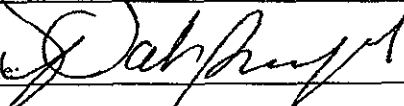
Signature: 	OIL CONSERVATION DIVISION	
Printed Name: Patricia Grajeda	Approved by Environmental Specialist:	
Title: Environmental Specialist	Approval Date:	Expiration Date:
E-mail Address: PGrajedaDeBabb@depmidstream.com	Conditions of Approval:	Attached <input type="checkbox"/>
Date: 1Mar12 Phone: 432-620-5403		

* Attach Additional Sheets If Necessary

District I
1625 N. French Dr., Hobbs, NM 88240
District II
1301 W. Grand Avenue, Artesia, NM 88210
District III
1000 Rio Brazos Road, Aztec, NM 87410
District IV
1220 S. St. Francis Dr., Santa Fe, NM 87505

State of New Mexico
Energy Minerals and Natural Resources

Oil Conservation Division
1220 South St. Francis Dr.
Santa Fe, NM 87505

Form C-141
Revised January 1, 2008

Submit 1 Copy to appropriate
District Office

Release Notification and Corrective Action

OPERATOR		<input checked="" type="checkbox"/> Initial Report	<input type="checkbox"/> Final Report
Name of Company: DCP Midstream, LP	Contact: Johnnie Bradford		
Address: 10 Desta Drive, Suite 400 W, Midland, TX., 79705	Telephone# & E-mail: 432.620.4166 / jbradford@dcpmidstream.com		
Facility Name: M-Extension	Facility Type: Pipeline		
Surface Owner:	Mineral Owner:	Well API No.:	

LOCATION OF RELEASE

Unit Letter	Section	Township	Range	Feet from the	North/South Line	Feet from the	East/West Line	County
A	5	19	31		S		E	Eddy

Latitude **N32.695560** Longitude **W103.885746**

NATURE OF RELEASE

Type of Release : Gas and Liquid	Volume of Release: ~1500 Mscf/15bbbls	Volume Recovered: 0
Source of Release: Pipeline	Date & Hour of Occurrence: 01/04/2012 - 14:44 hrs	Date & Hour of Discovery: Same
Was Immediate Notice Given OCD? <input type="checkbox"/> Yes <input type="checkbox"/> No <input checked="" type="checkbox"/> Not Required	If YES, To Whom @ OCD? NA	
By Whom? Johnnie Bradford	Date and Hour: NA	
Was a Watercourse Reached? <input type="checkbox"/> Yes <input checked="" type="checkbox"/> No	If YES, Volume Impacting the Watercourse. NA	

If a Watercourse was Impacted, Describe Fully.*
NA

Describe Cause of Problem and Remedial Action Taken. (If water spilled, give Chloride content)*

Pipeline developed a hole on the bottom of the pipeline due to corrosion. DCPM is investigating the cause of the corrosion and whether or not a different or more intensive chemical injection program should be implemented.

Describe Area Affected, Dimensions, and Cleanup Action Taken.*
30 ft x 100 ft with a run of 2ft wide by 800 - 1,000 ft.

RECEIVED

MAR - 5 2012

NMOCD ARTESIA

I hereby certify that the information given above is true and complete to the best of my knowledge and understand that pursuant to NMOCD rules and regulations all operators are required to report and/or file certain release notifications and perform corrective actions for releases which may endanger public health or the environment. The acceptance of a C-141 report by the NMOCD marked as "Final Report" does not relieve the operator of liability should their operations have failed to adequately investigate and remediate contamination that pose a threat to ground water, surface water, human health or the environment. In addition, NMOCD acceptance of a C-141 report does not relieve the operator of responsibility for compliance with any other federal, state, or local laws and/or regulations.

OIL CONSERVATION DIVISION

Approved by District Supervisor:

Signature:  on behalf of Johnnie Bradford

Printed Name: **Johnnie Bradford**

Title: **Sr. Environmental Specialist**

Approval Date:

Expiration Date:

E-mail Address: **jbradford@dcpmidstream.com**

Conditions of Approval:

RP#

Date: **01/16/2012**

Phone: **432.620.4166**

HUNGRY HORSE, LLC
ENVIRONMENTAL SERVICES

Dirt Work * On-Site Remediation * Soil Testing * Excavation

31Jan12

To: Mike Bratcher, NM QCD
Reference: Remediation Work Plan
Operator: DCP Midstream
Pipeline: M-Extension Line
Location: Eddy County
GPS: N32.6955 W103.8857
Legals: U.I.A, Sec. 5, T19, R31E

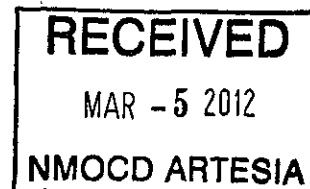

Dear Mike Bratcher,

This remediation work plan is submitted for review. The specifics of the site are listed above. The release is located approximately half a mile west of CR 222 about 300 feet north of the south intersection of CR222 and CR 249. The release was the result the pipeline developing a hole due to corrosion. The visually affected area is approximately 30' x 100' at the point of release and a 3' x 1000' strip along the south track of the two track road to the west.

Based upon the Eddy County Depth to Groundwater Map, depth to ground water is 200'. There are no known water wells and no known surface bodies of water within 1000' of the release site. The release is on BLM land and Mr. Jim Amos has been contact by a DCP representative as well as myself.

Work Conducted to Date

The weakened section of pipe was removed and replaced by a section of poly pipe. All contaminated soil that was removed during the repair process was stockpiled on plastic for transportation/disposal during the remediation process. The replaced line was covered and backfilled with clean material leaving the area at the point of release exposed to aid in the remediation.

Remediation Proposal

The "dig and haul" method of remediation will be used to remediate this release. We plan to mechanically excavate the area obtaining and analyzing soil samples until the lab results indicate the bottoms and sides of the excavation at the release site reach an acceptable level. Final lab analysis will be submitted to you for your review and approval for backfill.

Upon receipt of this approval, the area will backfilled and contoured to match the surrounding terrain. The affected area will be seeded with a BLM approved seed mixture.

A handwritten signature in black ink, appearing to read "V. Black".

Vernon K. Black, Hungry Horse, LLC

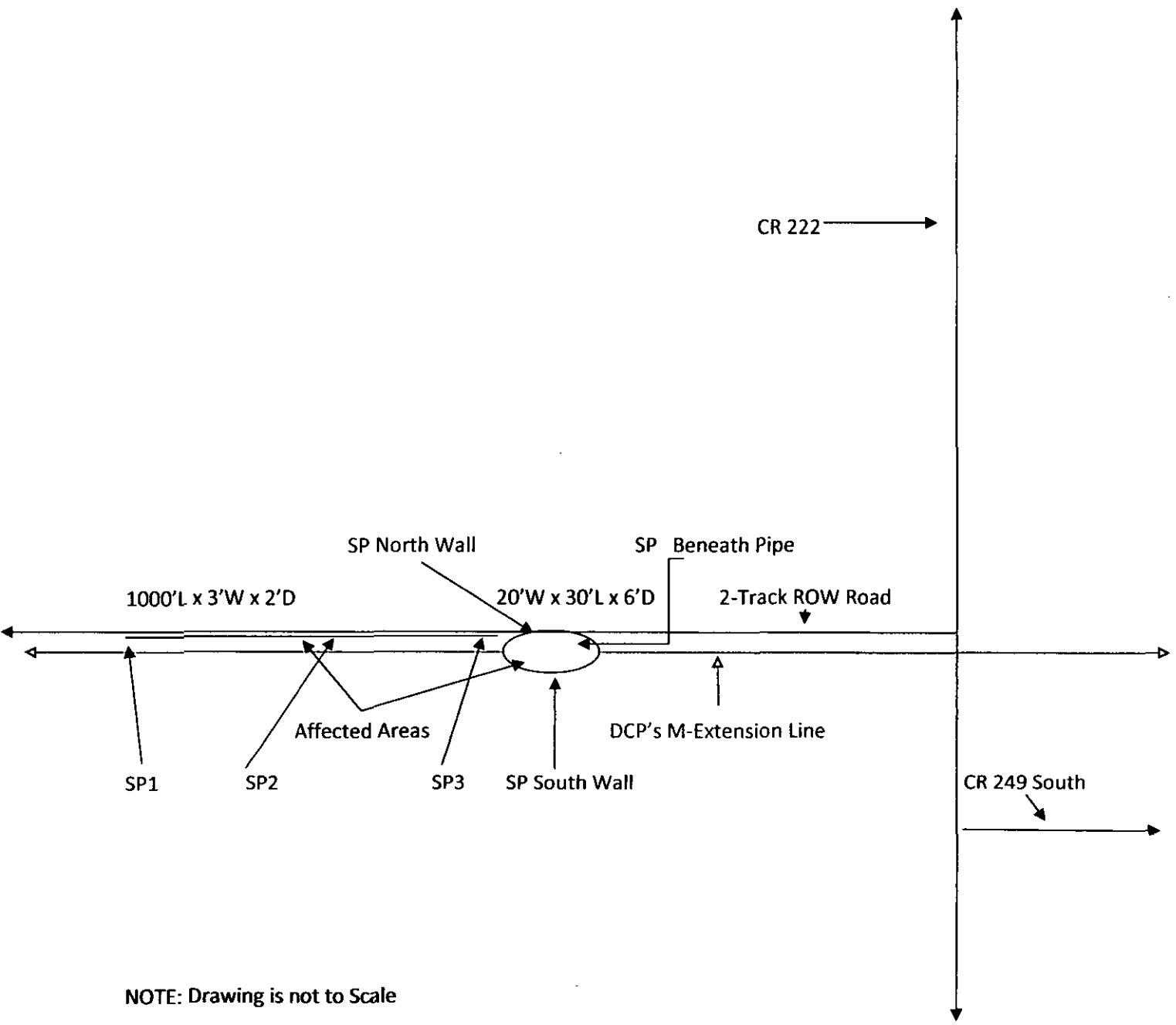
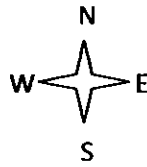

NOTE: Drawing is not to Scale

DCP's M-Extension Line Soil Analysis Results

SP1 Road	BTEX	Chlorides	GRO/DRO
3' BGS	<.05ppm	112ppm	<10/117ppm

SP2 Road	BTEX	Chlorides	GRO/DRO
3' BGS	<.05ppm	<16ppm	<10/63.9ppm

SP3 Road	BTEX	Chlorides	GRO/DRO
3' BGS	<.05ppm	32ppm	<10/153ppm

North Wall	BTEX	Chlorides	GRO/DRO
6' BGS	74.08ppm	368ppm	88.5/1490ppm

South Wall	BTEX	Chlorides	GRO/DRO
6' BGS	<.05ppm	80ppm	<10ppm

Beneath Pipe	BTEX	Chlorides	GRO/DRO
6' BGS	3.29ppm	352ppm	1010/6790ppm

Analytical Results For:

Hungry Horse Environmental
VERNON BLACK
P.O. Box 1058
Hobbs NM, 88240
Fax To: (505) 391-4585

Received: 02/10/2012
Reported: 02/17/2012
Project Name: M - EXTENSION LINE
Project Number: NONE GIVEN
Project Location: EDDY COUNTY, NM

Sampling Date: 02/10/2012
Sampling Type: Soil
Sampling Condition: ** (See Notes)
Sample Received By: Jodi Henson

Sample ID: SP #1 ROAD 3' BGS (H200348-01)

BTEX 8021B		mg/kg		Analyzed By: AP					
Analyte	Result	Reporting Limit	Analyzed	Method Blank	BS	% Recovery	True Value QC	RPD	Qualifier
Benzene*	<0.050	0.050	02/16/2012	ND	1.93	96.5	2.00	16.0	
Toluene*	<0.050	0.050	02/16/2012	ND	2.09	105	2.00	15.8	
Ethylbenzene*	<0.050	0.050	02/16/2012	ND	2.15	107	2.00	15.0	
Total Xylenes*	<0.150	0.150	02/16/2012	ND	6.65	111	6.00	15.5	

Surrogate: 4-Bromofluorobenzene (PIL) 114 % 64.4-134

Chloride, SM4500Cl-B		mg/kg		Analyzed By: AP						
Analyte	Result	Reporting Limit	Analyzed	Method Blank	BS	% Recovery	True Value QC	RPD	Qualifier	
Chloride	112	16.0	02/15/2012	ND	416	104	400	3.92		

TPH 8015M		mg/kg		Analyzed By: MS					
Analyte	Result	Reporting Limit	Analyzed	Method Blank	BS	% Recovery	True Value QC	RPD	Qualifier
GRO C6-C10	<10.0	10.0	02/14/2012	ND	166	83.0	200	4.76	
DRO >C10-C28	117	10.0	02/14/2012	ND	166	83.0	200	5.92	

Surrogate: 1-Chlorooctane 98.7 % 55.5-154

Surrogate: 1-Chlorooctadecane 97.3 % 57.6-158

Cardinal Laboratories

*=Accredited Analyte

PLEASE NOTE: Liability and Damages. Cardinal's liability and client's exclusive remedy for any claim arising, whether based in contract or tort, shall be limited to the amount paid by client for analyses. All claims, including those for negligence and any other cause whatsoever shall be deemed waived unless made in writing and received by Cardinal within thirty (30) days after completion of the applicable service. In no event shall Cardinal be liable for incidental or consequential damages, including, without limitation, business interruptions, loss of use, or loss of profits incurred by client, its subsidiaries, affiliates or successors arising out of or related to the performance of the services hereunder by Cardinal, regardless of whether such claim is based upon any of the above stated reasons or otherwise. Results relate only to the samples identified above. This report shall not be reproduced except in full with written approval of Cardinal Laboratories.



Celey D. Keene, Lab Director/Quality Manager

Analytical Results For:

 Hungry Horse Environmental
 VERNON BLACK
 P.O. Box 1058
 Hobbs NM, 88240
 Fax To: (505) 391-4585

 Received: 02/10/2012
 Reported: 02/17/2012
 Project Name: M - EXTENSION LINE
 Project Number: NONE GIVEN
 Project Location: EDDY COUNTY, NM

 Sampling Date: 02/10/2012
 Sampling Type: Soil
 Sampling Condition: ** (See Notes)
 Sample Received By: Jodi Henson

Sample ID: SP #2 ROAD 3' BGS (H200348-02)

BTX 8021B		mg/kg		Analyzed By: AP					
Analyte	Result	Reporting Limit	Analyzed	Method Blank	BS	% Recovery	True Value QC	RPD	Qualifier
Benzene*	<0.050	0.050	02/16/2012	ND	1.93	96.5	2.00	16.0	
Toluene*	<0.050	0.050	02/16/2012	ND	2.09	105	2.00	15.8	
Ethylbenzene*	<0.050	0.050	02/16/2012	ND	2.15	107	2.00	15.0	
Total Xylenes*	<0.150	0.150	02/16/2012	ND	6.65	111	6.00	15.5	

Surrogate: 4-Bromofluorobenzene (PIL) 112 % 64.4-134

Chloride, SM4500Cl-B		mg/kg		Analyzed By: AP					
Analyte	Result	Reporting Limit	Analyzed	Method Blank	BS	% Recovery	True Value QC	RPD	Qualifier
Chloride	<16.0	16.0	02/15/2012	ND	416	104	400	3.92	

TPH 8015M		mg/kg		Analyzed By: MS					
Analyte	Result	Reporting Limit	Analyzed	Method Blank	BS	% Recovery	True Value QC	RPD	Qualifier
GRO C6-C10	<10.0	10.0	02/14/2012	ND	166	83.0	200	4.76	
DRO >C10-C28	63.9	10.0	02/14/2012	ND	166	83.0	200	5.92	

Surrogate: 1-Chlorooctane 99.7 % 55.5-154

Surrogate: 1-Chlorooctadecane 102 % 57.6-158

Cardinal Laboratories

*=Accredited Analyte

PLEASE NOTE: Liability and Damages. Cardinal's liability and client's exclusive remedy for any claim arising, whether based in contract or tort, shall be limited to the amount paid by client for analyses. All claims, including those for negligence and any other cause whatsoever shall be deemed waived unless made in writing and received by Cardinal within thirty (30) days after completion of the applicable service. In no event shall Cardinal be liable for incidental or consequential damages, including, without limitation, business interruptions, loss of use, or loss of profits incurred by client, its subsidiaries, affiliates or successors arising out of or related to the performance of the services hereunder by Cardinal, regardless of whether such claim is based upon any of the above stated reasons or otherwise. Results relate only to the samples identified above. This report shall not be reproduced except in full with written approval of Cardinal Laboratories.

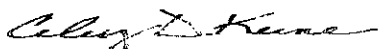

Celey D. Keene, Lab Director/Quality Manager

Analytical Results For:

 Hungry Horse Environmental
 VERNON BLACK
 P.O. Box 1058
 Hobbs NM, 88240
 Fax To: (505) 391-4585

 Received: 02/10/2012
 Reported: 02/17/2012
 Project Name: M - EXTENSION LINE
 Project Number: NONE GIVEN
 Project Location: EDDY COUNTY, NM

 Sampling Date: 02/10/2012
 Sampling Type: Soil
 Sampling Condition: ** (See Notes)
 Sample Received By: Jodi Henson

Sample ID: SP #3 ROAD 3' BGS (H200348-03)

BTEX 8021B		mg/kg		Analyzed By: AP						
Analyte	Result	Reporting Limit	Analyzed	Method Blank	BS	% Recovery	True Value QC	RPD	Qualifier	
Benzene*	<0.050	0.050	02/16/2012	ND	1.93	96.5	2.00	16.0		
Toluene*	<0.050	0.050	02/16/2012	ND	2.09	105	2.00	15.8		
Ethylbenzene*	<0.050	0.050	02/16/2012	ND	2.15	107	2.00	15.0		
Total Xylenes*	<0.150	0.150	02/16/2012	ND	6.65	111	6.00	15.5		

Surrogate: 4-Bromofluorobenzene (PIL) 112 % 64.4-134

Chloride, SM4500Cl-B		mg/kg		Analyzed By: AP						
Analyte	Result	Reporting Limit	Analyzed	Method Blank	BS	% Recovery	True Value QC	RPD	Qualifier	
Chloride	32.0	16.0	02/15/2012	ND	416	104	400	3.92		

TPH 8015M		mg/kg		Analyzed By: MS					
Analyte	Result	Reporting Limit	Analyzed	Method Blank	BS	% Recovery	True Value QC	RPD	Qualifier
GRO C6-C10	<10.0	10.0	02/14/2012	ND	166	83.0	200	4.76	
DRO >C10-C28	153	10.0	02/14/2012	ND	166	83.0	200	5.92	

Surrogate: 1-Chlorooctane 103 % 55.5-154

Surrogate: 1-Chlorooctadecane 104 % 57.6-158

Cardinal Laboratories

* = Accredited Analyte

PLEASE NOTE: Liability and Damages. Cardinal's liability and client's exclusive remedy for any claim arising, whether based in contract or tort, shall be limited to the amount paid by client for analyses. All claims, including those for negligence and any other cause whatsoever shall be deemed waived unless made in writing and received by Cardinal within thirty (30) days after completion of the applicable service. In no event shall Cardinal be liable for incidental or consequential damages, including, without limitation, business interruptions, loss of use, or loss of profits incurred by client, its subsidiaries, affiliates or successors arising out of or related to the performance of the services hereunder by Cardinal, regardless of whether such claim is based upon any of the above stated reasons or otherwise. Results relate only to the samples identified above. This report shall not be reproduced except in full with written approval of Cardinal Laboratories.



Celey D. Keene, Lab Director/Quality Manager

Analytical Results For:

 Hungry Horse Environmental
 VERNON BLACK
 P.O. Box 1058
 Hobbs NM, 88240
 Fax To: (505) 391-4585

 Received: 02/10/2012
 Reported: 02/17/2012
 Project Name: M - EXTENSION LINE
 Project Number: NONE GIVEN
 Project Location: EDDY COUNTY, NM

 Sampling Date: 02/10/2012
 Sampling Type: Soil
 Sampling Condition: ** (See Notes)
 Sample Received By: Jodi Henson

Sample ID: RELEASE POINT N WALL (H200348-04)

BTEX 8021B	mg/kg	Analyzed By: AP					S-04		
Analyte	Result	Reporting Limit	Analyzed	Method Blank	BS	% Recovery	True Value QC	RPD	Qualifier
Benzene*	<0.500	0.500	02/16/2012	ND	1.93	96.5	2.00	16.0	
Toluene*	7.04	0.500	02/16/2012	ND	2.09	105	2.00	15.8	
Ethylbenzene*	9.14	0.500	02/16/2012	ND	2.15	107	2.00	15.0	
Total Xylenes*	57.9	1.50	02/16/2012	ND	6.65	111	6.00	15.5	

Surrogate: 4-Bromofluorobenzene (PIL) 165 % 64.4-134

Chloride, SM4500Cl-B	mg/kg	Analyzed By: AP							
Analyte	Result	Reporting Limit	Analyzed	Method Blank	BS	% Recovery	True Value QC	RPD	Qualifier
Chloride	368	16.0	02/15/2012	ND	416	104	400	3.92	

TPH 8015M	mg/kg	Analyzed By: MS							
Analyte	Result	Reporting Limit	Analyzed	Method Blank	BS	% Recovery	True Value QC	RPD	Qualifier
GRO C6-C10	88.5	10.0	02/14/2012	ND	166	83.0	200	4.76	
DRO >C10-C28	1490	10.0	02/14/2012	ND	166	83.0	200	5.92	

Surrogate: 1-Chlorooctane 92.6 % 55.5-154

Surrogate: 1-Chlorooctadecane 59.7 % 57.6-158

Cardinal Laboratories

*=Accredited Analyte

PLEASE NOTE: Liability and Damages. Cardinal's liability and client's exclusive remedy for any claim arising, whether based in contract or tort, shall be limited to the amount paid by client for analyses. All claims, including those for negligence and any other cause whatsoever shall be deemed waived unless made in writing and received by Cardinal within thirty (30) days after completion of the applicable service. In no event shall Cardinal be liable for incidental or consequential damages, including, without limitation, business interruptions, loss of use, or loss of profits incurred by client, its subsidiaries, affiliates or successors arising out of or related to the performance of the services hereunder by Cardinal, regardless of whether such claim is based upon any of the above stated reasons or otherwise. Results relate only to the samples identified above. This report shall not be reproduced except in full with written approval of Cardinal Laboratories.

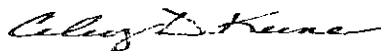

Celey D. Keene, Lab Director/Quality Manager

Analytical Results For:

 Hungry Horse Environmental
 VERNON BLACK
 P.O. Box 1058
 Hobbs NM, 88240
 Fax To: (505) 391-4585

 Received: 02/10/2012
 Reported: 02/17/2012
 Project Name: M - EXTENSION LINE
 Project Number: NONE GIVEN
 Project Location: EDDY COUNTY, NM

 Sampling Date: 02/10/2012
 Sampling Type: Soil
 Sampling Condition: ** (See Notes)
 Sample Received By: Jodi Henson

Sample ID: RELEASE POINT S WALL (H200348-05)

BTX 8021B			mg/kg		Analyzed By: AP				
Analyte	Result	Reporting Limit	Analyzed	Method Blank	BS	% Recovery	True Value QC	RPD	Qualifier
Benzene*	<0.050	0.050	02/16/2012	ND	1.93	96.5	2.00	16.0	
Toluene*	<0.050	0.050	02/16/2012	ND	2.09	105	2.00	15.8	
Ethylbenzene*	<0.050	0.050	02/16/2012	ND	2.15	107	2.00	15.0	
Total Xylenes*	<0.150	0.150	02/16/2012	ND	6.65	111	6.00	15.5	

Surrogate: 4-Bromofluorobenzene (PIL) 114 % 64.4-134

Chloride, SM4500Cl-B			mg/kg		Analyzed By: AP				
Analyte	Result	Reporting Limit	Analyzed	Method Blank	BS	% Recovery	True Value QC	RPD	Qualifier
Chloride	80.0	16.0	02/15/2012	ND	416	104	400	3.92	

TPH 8015M			mg/kg		Analyzed By: MS				
Analyte	Result	Reporting Limit	Analyzed	Method Blank	BS	% Recovery	True Value QC	RPD	Qualifier
GRO C6-C10	<10.0	10.0	02/14/2012	ND	190	95.2	200	3.43	
DRO >C10-C28	<10.0	10.0	02/14/2012	ND	181	90.3	200	5.09	

Surrogate: 1-Chlorooctane 96.3 % 55.5-154

Surrogate: 1-Chlorooctadecane 109 % 57.6-158

Cardinal Laboratories

* = Accredited Analyte

PLEASE NOTE: Liability and Damages. Cardinal's liability and client's exclusive remedy for any claim arising, whether based in contract or tort, shall be limited to the amount paid by client for analyses. All claims, including those for negligence and any other cause whatsoever shall be deemed waived unless made in writing and received by Cardinal within thirty (30) days after completion of the applicable service. In no event shall Cardinal be liable for incidental or consequential damages, including, without limitation, business interruptions, loss of use, or loss of profits incurred by client, its subsidiaries, affiliates or successors arising out of or related to the performance of the services hereunder by Cardinal, regardless of whether such claim is based upon any of the above stated reasons or otherwise. Results relate only to the samples identified above. This report shall not be reproduced except in full with written approval of Cardinal Laboratories.

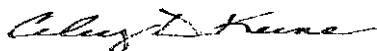

Celey D. Keene, Lab Director/Quality Manager

Analytical Results For:

 Hungry Horse Environmental
 VERNON BLACK
 P.O. Box 1058
 Hobbs NM, 88240
 Fax To: (505) 391-4585

 Received: 02/10/2012
 Reported: 02/17/2012
 Project Name: M - EXTENSION LINE
 Project Number: NONE GIVEN
 Project Location: EDDY COUNTY, NM

 Sampling Date: 02/10/2012
 Sampling Type: Soil
 Sampling Condition: ** (See Notes)
 Sample Received By: Jodi Henson

Sample ID: RELEASE POINT BENEATH PIPE (H200348-06)

BTX 8021B		mg/kg	Analyzed By: AP					S-04	
Analyte	Result	Reporting Limit	Analyzed	Method Blank	BS	% Recovery	True Value QC	RPD	Qualifier
Benzene*	<0.050	0.050	02/16/2012	ND	1.93	96.5	2.00	16.0	
Toluene*	0.335	0.050	02/16/2012	ND	2.09	105	2.00	15.8	
Ethylbenzene*	0.525	0.050	02/16/2012	ND	2.15	107	2.00	15.0	
Total Xylenes*	2.44	0.150	02/16/2012	ND	6.65	111	6.00	15.5	

Surrogate: 4-Bromofluorobenzene (PIL) 140 % 64.4-134

Chloride, SM4500Cl-B		mg/kg	Analyzed By: AP						
Analyte	Result	Reporting Limit	Analyzed	Method Blank	BS	% Recovery	True Value QC	RPD	Qualifier
Chloride	352	16.0	02/15/2012	ND	416	104	400	3.92	

TPH 8015M		mg/kg	Analyzed By: MS						
Analyte	Result	Reporting Limit	Analyzed	Method Blank	BS	% Recovery	True Value QC	RPD	Qualifier
GRO C6-C10	1010	50.0	02/15/2012	ND	190	95.2	200	3.43	
DRO >C10-C28	6790	50.0	02/15/2012	ND	181	90.3	200	5.09	

Surrogate: 1-Chlorooctane 174 % 55.5-154

Surrogate: 1-Chlorooctadecane 87.5 % 57.6-158

Cardinal Laboratories

* = Accredited Analyte

PLEASE NOTE: Liability and Damages. Cardinal's liability and client's exclusive remedy for any claim arising, whether based in contract or tort, shall be limited to the amount paid by client for analyses. All claims, including those for negligence and any other cause whatsoever shall be deemed waived unless made in writing and received by Cardinal within thirty (30) days after completion of the applicable service. In no event shall Cardinal be liable for incidental or consequential damages, including, without limitation, business interruptions, loss of use, or loss of profits incurred by client, its subsidiaries, affiliates or successors arising out of or related to the performance of the services hereunder by Cardinal, regardless of whether such claim is based upon any of the above stated reasons or otherwise. Results relate only to the samples identified above. This report shall not be reproduced except in full with written approval of Cardinal Laboratories.



Celey D. Keene, Lab Director/Quality Manager

Vernon Black

From: Bratcher, Mike, EMNRD [mike.bratcher@state.nm.us]
Sent: Tuesday, February 21, 2012 8:14 AM
To: Vernon Black
Cc: 'Grajeda De Babb, Patricia'
Subject: RE: DCP's M Exr Line Remediation Soil Analysis

Vernon,

As we discussed, OCD would like to see a little more material removed from the area "underneath the pipe" and the North wall. The concern is the BTEX in the wall and the elevated TPH (DRO @ 6790 and GRO @ 1010) in the bottom. Everything else looks good and you may proceed with backfilling the other areas as needed.

Thanks,

Mike Bratcher
NMOCD District 2
811 S. First Street
Artesia, NM 88210
575-748-1283 Ext. 108
575-626-0857
mike.bratcher@state.nm.us

From: Vernon Black [mailto:vernon@hungry-horse.com]
Sent: Friday, February 17, 2012 10:07 AM
To: Bratcher, Mike, EMNRD
Cc: 'Grajeda De Babb, Patricia'
Subject: DCP's M Exr Line Remediation Soil Analysis

Good Morning Mike,

Please see the attached documentation concerning the remediation at DCP's M Ext Line site. The depth to ground water is 200' based upon the map information. Looks like the chlorides are good to go at all sample points. There was no detectable levels of Benzene at any of the sample points. the only area of concern is the GRO/DRO levels underneath the pipe. They are a bit high. However, there was/is no visual evidence of hydrocarbon staining at the excavation site, so this is most likely aromatic in nature. The excavation has been open and airing out for over a week now, so much of this could have possibly flashed off by now. What are your thoughts and guidance?

Thanks,
Vernon

2/21/2012

Vernon Black

From: Bratcher, Mike, EMNRD [mike.bratcher@state.nm.us]
Sent: Tuesday, February 28, 2012 12:16 PM
To: Vernon K. Black
Subject: RE: M EXTENSION LINE

Vernon,

Looks great. Please proceed with backfilling.

Thanks,

Mike Bratcher
NMOCD District 2
811 S. First Street
Artesia, NM 88210
575-748-1283 Ext. 108
575-626-0857
mike.bratcher@state.nm.us

From: Vernon K. Black [mailto:vernon@hungry-horse.com]
Sent: Friday, February 24, 2012 4:20 PM
To: Bratcher, Mike, EMNRD
Subject: Fwd: M EXTENSION LINE

Hello Mike,

We went about 3'-4' deeper beneath the pipe and on the north wall as we discussed . Looks like we got it all. We'll back fill and get out of there with your approval.

Sent from my iPhone

Vernon K Black

Begin forwarded message:

From: "Celey Keene" <celey.keene@cardinallabsnm.com>
Date: February 24, 2012 15:09:38 MST
To: "Vernon K. Black" <vernon@hungry-horse.com>
Subject: M EXTENSION LINE

THANK YOU,

Celey Keene
Lab Director
Cardinal Laboratories
101 East Marland
Hobbs, NM 88240
T: (575) 393-2326
F: (575) 393-2476
e-mail: celey.keene@cardinallabsnm.com

3/1/2012