

5-26-2017 DATE IN	SUSPENSE	ENGINEER MAM	5-30-2017 LOGGED IN	TYPE PLC	APP NO. PKSC1715032025
----------------------	----------	--------------	------------------------	----------	------------------------

ABOVE THIS LINE FOR DIVISION USE ONLY

**NEW MEXICO OIL CONSERVATION DIVISION**  
- Engineering Bureau -  
1220 South St. Francis Drive, Santa Fe, NM 87505



**ADMINISTRATIVE APPLICATION CHECKLIST**

THIS CHECKLIST IS MANDATORY FOR ALL ADMINISTRATIVE APPLICATIONS FOR EXCEPTIONS TO DIVISION RULES AND REGULATIONS WHICH REQUIRE PROCESSING AT THE DIVISION LEVEL IN SANTA FE

**Application Acronyms:**

[NSL-Non-Standard Location] [NSP-Non-Standard Proration Unit] [SD-Simultaneous Dedication]  
[DHC-Downhole Commingling] [CTB-Lease Commingling] [PLC-Pool/Lease Commingling]  
[PC-Pool Commingling] [OLS - Off-Lease Storage] [OLM-Off-Lease Measurement]  
[WFX-Waterflood Expansion] [PMX-Pressure Maintenance Expansion]  
[SWD-Salt Water Disposal] [IPI-Injection Pressure Increase]  
[EOR-Qualified Enhanced Oil Recovery Certification] [PPR-Positive Production Response]

- [1] **TYPE OF APPLICATION** - Check Those Which Apply for [A] *Occidental Permian LTD (157984)*  
☐ [A] Location - Spacing Unit - Simultaneous Dedication  
☐ NSL ☐ NSP ☐ SD *South Mattix Unit Federal #2 30-025-1112*  
 Check One Only for [B] or [C] *Fowler; Upper Yesso (26680)*  
☐ [B] Commingling - Storage - Measurement  
☐ DHC ☐ CTB ☒ PLC ☐ PC ☐ OLS ☐ OLM  
☐ [C] Injection - Disposal - Pressure Increase - Enhanced Oil Recovery  
☐ WFX ☐ PMX ☐ SWD ☐ IPI ☐ EOR ☐ PPR  
☐ [D] Other: Specify \_\_\_\_\_
- [2] **NOTIFICATION REQUIRED TO:** - Check Those Which Apply, or ☐ Does Not Apply -  
☒ [A] Working, Royalty or Overriding Royalty Interest Owners  
☐ [B] Offset Operators, Leaseholders or Surface Owner  
☐ [C] Application is One Which Requires Published Legal Notice  
☒ [D] Notification and/or Concurrent Approval by BLM or SLO  
U.S. Bureau of Land Management - Commissioner of Public Lands, State Land Office  
☒ [E] For all of the above, Proof of Notification or Publication is Attached, and/or,  
☐ [F] Waivers are Attached
- [3] **SUBMIT ACCURATE AND COMPLETE INFORMATION REQUIRED TO PROCESS THE TYPE OF APPLICATION INDICATED ABOVE.**

[4] **CERTIFICATION:** I hereby certify that the information submitted with this application for administrative approval is **accurate and complete** to the best of my knowledge. I also understand that **no action** will be taken on this application until the required information and notifications are submitted to the Division.

**Note:** Statement must be completed by an individual with managerial and/or supervisory capacity.

JUSTIN MORRIS  
Print or Type Name

*Justin Morris*  
Signature

REGULATORY ENGINEER 05-23-2017  
Title Date

JUSTIN\_MORRIS@OXY.COM  
e-mail Address

District I  
1625 N. French Drive, Hobbs, NM 88240  
District II  
811 S. First St., Artesia, NM 88210  
District III  
1000 Rio Brazos Road, Aztec, NM 87410  
District IV  
1220 S. St Francis Dr, Santa Fe, NM  
87505

State of New Mexico  
Energy, Minerals and Natural Resources Department

Form C-107-B  
Revised August 1, 2011

**OIL CONSERVATION DIVISION**  
1220 S. St Francis Drive  
Santa Fe, New Mexico 87505

Submit the original  
application to the Santa Fe  
office with one copy to the  
appropriate District Office.

**APPLICATION FOR SURFACE COMMINGLING (DIVERSE OWNERSHIP)**

OPERATOR NAME: Occidental Permian LTD (157984)

OPERATOR ADDRESS: PO BOX 4294, Houston, TX 77210

APPLICATION TYPE:

☐ Pool Commingling ☐ Lease Commingling ☒ Pool and Lease Commingling ☐ Off-Lease Storage and Measurement (Only if not Surface Commingled)

LEASE TYPE: ☐ Fee ☐ State ☒ Federal

Is this an Amendment to existing Order? ☐ Yes ☒ No If "Yes", please include the appropriate Order No. \_\_\_\_\_  
Have the Bureau of Land Management (BLM) and State Land office (SLO) been notified in writing of the proposed commingling  
☒ Yes ☐ No

**(A) POOL COMMINGLING**

Please attach sheets with the following information

(1) Pool Names and Codes	Gravities / BTU of Non-Commingled Production	Calculated Gravities / BTU of Commingled Production		Calculated Value of Commingled Production	Volumes
Please see attached spreadsheet					

- (2) Are any wells producing at top allowables? ☐ Yes ☒ No  
(3) Has all interest owners been notified by certified mail of the proposed commingling? ☒ Yes ☐ No  
(4) Measurement type: ☐ Metering ☒ Other (Specify) See attachment.  
(5) Will commingling decrease the value of production? ☐ Yes ☒ No If "yes", describe why commingling should be approved

**(B) LEASE COMMINGLING**

Please attach sheets with the following information

- (1) Pool Name and Code.  
(2) Is all production from same source of supply? ☐ Yes ☐ No  
(3) Has all interest owners been notified by certified mail of the proposed commingling? ☐ Yes ☐ No  
(4) Measurement type: ☐ Metering ☐ Other (Specify)

**(C) POOL and LEASE COMMINGLING**

Please attach sheets with the following information

- (1) Complete Sections A and E.

**(D) OFF-LEASE STORAGE and MEASUREMENT**

Please attached sheets with the following information

- (1) Is all production from same source of supply? ☐ Yes ☐ No  
(2) Include proof of notice to all interest owners.

**(E) ADDITIONAL INFORMATION (for all application types)**

Please attach sheets with the following information

- (1) A schematic diagram of facility, including legal location.  
(2) A plat with lease boundaries showing all well and facility locations. Include lease numbers if Federal or State lands are involved.  
(3) Lease Names, Lease and Well Numbers, and API Numbers.

I hereby certify that the information above is true and complete to the best of my knowledge and belief.

SIGNATURE: Justin Morris TITLE: REGULATORY ENGINEER DATE: 05/24/2017  
TYPE OR PRINT NAME: JUSTIN MORRIS TELEPHONE NO.: (713) 366-5249  
E-MAIL ADDRESS: JUSTIN\_MORRIS@OXY.COM

**Oil & Gas metering:**

The central tank battery is located on the South Mattix Unit Federal lease (NMNM 0321613) located at 32.2171, -103.149 in section 15, T24S, R37E in Lea County, New Mexico.

Wells will be routed to one of two common three-phase production separators as shown in attached diagram. Oil production will flow to three common oil tanks after measurement and then be sent through a LACT meter (S/N \*). Gas production will be sent to ETC Sales Meter (S/N 14203) located at 32.2170, -103.1499 or ETC Sales Meter (S/N 63238) located at 32.2168, -103.1494. Water production will be sent to Fowler SWD for disposal.

All wells will be tested at least quarterly for a minimum of 24 hours through three-phase test separator with meters for gas (S/N 2104796), oil (S/N 435289) and water (S/N 434677) or three-phase test separator with meters for gas (S/N 2101483), oil (S/N 363735) and water (S/N 576327) for allocation purposes.

All meters will be proven, as per API, NMOCD, and BLM specifications, when installed, once per month for the first 3 months (to establish a consistent repeatability factor), and then quarterly thereafter. The factor obtained will be used to allocate the production volumes.

This commingle will result in maximum ultimate economic recovery of oil and gas with minimum waste, as wells would otherwise have to be plugged.

**Process and Flow Descriptions:**

The flow of production is shown in detail on enclosed facility diagram and map which shows the lease boundaries, Communitization agreement boundaries, location of wells, facility, and gas sales meter. The commingling of this production is the most effective means of producing the reserves.

Occidental Permian LTD understands the requested approval will not constitute the granting of any right-of-way or construction rights not granted by the lease instrument. These applications will be submitted separately for approval per NMOCD and BLM regulations.

The BLM and NMOCD will be notified of any future changes in the facilities.

Pursuant to Statewide rule 19.15.12.10(C)(4)(g) OXY USA INC requests the option to include additional pools or leases within the defined parameters set forth in the order for future additions.

The working interest, royalty interest and overriding royalty interest owners have been notified of this proposal by certified mail (see attached).

**PROJECT DATA:**  
 OCCIDENTAL PERMAN LTD  
 SOUTH MATTOX UNIT FEDERAL BATTERY  
 00000570  
 SWNE S16, T24S, R37E  
 LEA COUNTY, NEW MEXICO

**Diagram Labels:**  
 PW TANK W, PW TANK E, OIL, OIL, OIL, ETC SALES, TRANSFER PUMP, METER, FOWLER FOR DISPOSAL, S/N LR21817, OIL FILL LINE, TRUCK LOADOUT (SECONDARY SALES), PLAINS (PRIMARY SALES), LACT, S/N T80, TEST SEP, WHM, PROD SEP, WELL #20, 22, 27, 28, 40, 2, 1, 12, 13, 6, WELL #21, 14, 45, 30, 16, 8, 1, 24, 6, 17, 30, 37, 39, 16, 25.

**Equipment and S/Ns:**  
 GASE S/N 14000, GASE S/N 83238, S/N 2104708, S/N 430080, S/N 434877, S/N 303783, S/N 2101483, S/N 576027, S/N 303818, S/N 333483.

**Project Drawing Revision Table:**

NO.	DATE	BY	CHKD	DESCRIPTION
1	07-10-77	AM	WJH	ISSUED FOR CONSTRUCTION

**Notes:**  
 IN CASE OF DEVIATION A MARKED UP COPY SHALL BE SENT TO THE PROJECT ENGINEER  
 NOTES/REFERENCE DRAWINGS

**Master Drawing Revision Table:**

NO.	DATE	BY	CHKD	DESCRIPTION
1	07-10-77	AM	WJH	ISSUED FOR CONSTRUCTION

**Project Data:**  
 PROJECT: SOUTH MATTOX UNIT FEDERAL BATTERY - COMPLETION  
 DRAWN BY: PRO  
 CHECKED BY: CTB  
 SCALE: AS SHOWN  
 SHEET: 00001 OF 001  
 DATE: 07-10-77  
 PROJECT: LEA COUNTY, NEW MEXICO

14

	F	D	C
15			
16			
17			
18			
19			
20			
21			
22			
23			
24			
25			
26			
27			
28			
29			
30			
31			
32			
33			
34			
35			
36			
37			
38			
39			
40			
41			
42			
43			
44			
45			
46			
47			
48			
49			
50			
51			
52			
53			
54			
55			
56			
57			
58			
59			
60			
61			
62			
63			
64			
65			
66			
67			
68			
69			
70			
71			
72			
73			
74			
75			
76			
77			
78			
79			
80			
81			
82			
83			
84			
85			
86			
87			
88			
89			
90			
91			
92			
93			
94			
95			
96			
97			
98			
99			
100			

# APPLICATION FOR POOL AND LEASE COMMINGLE AT THE SOUTH MATTIX UNIT FEDERAL CTB

Occidental Permian LTD is requesting approval for Pool & Lease Commingle for all wells listed below, which will nullify previously approved commingle permit PC-796.

## Pool: Fowler; Upper Yeso (26680); Lease # NMLC 032450A (5% Royalty)

WELL NAME	API No.	LOCATION	BOPD	GRAVITY	MSCFD	BTU
SOUTH MATTIX UNIT FEDERAL #2 ✓	30-025-11112	N-15-24S-37E	0.8	36.9	3.9	1141
SOUTH MATTIX UNIT FEDERAL #3 ✓	30-025-11196	B-22-24S-37E	0	36.9	3.6	1141
SOUTH MATTIX UNIT FEDERAL #6 ✓	30-025-11114	L-15-24S-37E	13.5	36.9	77.1	1141
SOUTH MATTIX UNIT FEDERAL #12 ✓	30-025-11203	P-22-24S-37E	2.4	36.9	0	1141
SOUTH MATTIX UNIT FEDERAL #13 ✓	30-025-11204	I-22-24S-37E	0	36.9	0	1141

## Pool: Fowler; Upper Yeso (26680); Lease # NMLC 032450B (Schedule D)

WELL NAME	API No.	LOCATION	BOPD	GRAVITY	MSCFD	BTU
SOUTH MATTIX UNIT FEDERAL #20 ✓	30-025-21678	E-15-24S-37E	2	36.9	2.8	1141
SOUTH MATTIX UNIT FEDERAL #22 ✓	30-025-21922	C-15-24S-37E	2.6	36.9	39.2	1141
SOUTH MATTIX UNIT FEDERAL #27 ✓	30-025-25612	F-15-24S-37E	0.7	36.9	18.3	1141
SOUTH MATTIX UNIT FEDERAL #40 ✓	30-025-31475	K-15-24S-37E	0.8	36.9	63	1141

## Pool: Fowler; Upper Yeso (26680); Lease # NMNM 0321613 (Schedule D)

WELL NAME	API No.	LOCATION	BOPD	GRAVITY	MSCFD	BTU
SOUTH MATTIX UNIT FEDERAL #9 ✓	30-025-11117	B-15-24S-37E	0	36.9	1.2	1141
SOUTH MATTIX UNIT FEDERAL #10 ✓	30-025-11118	H-15-24S-37E	5.5	36.9	64	1141
SOUTH MATTIX UNIT FEDERAL #30 ✓	30-025-25747	P-15-24S-37E	2	36.9	0	1141
SOUTH MATTIX UNIT FEDERAL #33 ✓	30-025-26095	G-15-24S-37E	2.2	36.9	5.7	1141

## Pool: Fowler; Drinkard (26220); Lease # NMNM 0321613 (Schedule D)

WELL NAME	API No.	LOCATION	BOPD	GRAVITY	MSCFD	BTU
SOUTH MATTIX UNIT FEDERAL #24 ✓	30-025-22488	O-15-24S-37E	0	40.7	0.3	1291
SOUTH MATTIX UNIT FEDERAL #37 ✓	30-025-26355	I-15-24S-37E	0	40.7	1.7	1291
SOUTH MATTIX UNIT FEDERAL #39 ✓	30-025-26598	G-15-24S-37E	0.7	40.7	0	1291
SOUTH MATTIX UNIT FEDERAL #45 ✓	30-025-35292	J-15-24S-37E	1.7	40.7	128.2	1291

## Pool: Fowler; Drinkard (26220); Lease # NMLC 032450A (5% Royalty)

WELL NAME	API No.	LOCATION	BOPD	GRAVITY	MSCFD	BTU
SOUTH MATTIX A FEDERAL #5 ✓	30-025-11201	H-22-24S-37E	0.7	40.7	0	1291

## Pool: Fowler; Drinkard (26220); Lease # NMLC 032450B (Schedule D)

WELL NAME	API No.	LOCATION	BOPD	GRAVITY	MSCFD	BTU
SOUTH MATTIX UNIT FEDERAL #14 ✓	30-025-11110	K-15-24S-37E	1.6	40.7	0	1291

## Pool: Fowler; Drinkard (26220); Lease # NMLC 060579 (5% Royalty)

WELL NAME	API No.	LOCATION	BOPD	GRAVITY	MSCFD	BTU
SOUTH MATTIX UNIT FEDERAL #15 ✓	30-025-20513	A-22-24S-37E	2.3	40.7	0	1291

## Pool: Fowler; Ellenburger (26410); Lease # NMLC 0321613 (Schedule D)

WELL NAME	API No.	LOCATION	BOPD	GRAVITY	MSCFD	BTU
SOUTH MATTIX UNIT FEDERAL #1 ✓	30-025-11111	J-15-24S-37E	7.6	40.7	49	1291
SOUTH MATTIX UNIT FEDERAL #17 ✓	30-025-20298	G-15-24S-37E	36	40.7	38.5	1291

## Pool: Fowler; Ellenburger (26410); Lease # NMLC 032450B (Schedule D)

WELL NAME	API No.	LOCATION	BOPD	GRAVITY	MSCFD	BTU
SOUTH MATTIX UNIT FEDERAL #25 ✓	30-025-20298	G-15-24S-37E	3.7	40.7	7.4	1291

A map is enclosed showing the Federal leases and well locations.

# **South Mattix Unit CTB Production Data**

**SMUF #2 30-025-11112**

	Oil	Gas	Water
Oct	82	410	456
Nov	30	148	156
Dec	32	120	97
Jan	7	20	21
Feb	0	0	0
Mar	0	0	0
Daily Ave	0.8	3.9	4.1

**SMUF #3 30-025-11196**

	Oil	Gas	Water
Oct	0	0	0
Nov	0	0	0
Dec	0	0	0
Jan	0	0	0
Feb	0	371	0
Mar	0	283	0
Daily Ave	0.0	3.6	0.0

**SMUF #6 30-025-11114**

	Oil	Gas	Water
Oct	590	3066	7712
Nov	209	1400	3418
Dec	304	2229	4958
Jan	398	2214	6036
Feb	405	2191	5412
Mar	523	2776	7502
Daily Ave	13.5	77.1	194.7

**SMUF #12 30-025-11203**

	Oil	Gas	Water
Oct	99	0	93
Nov	45	0	54
Dec	51	0	62
Jan	69	8	100
Feb	80	0	84
Mar	93	0	115
Daily Ave	2.4	0.0	2.8

**SMUF #13 30-025-11204**

	Oil	Gas	Water
Oct	0	0	0
Nov	0	0	0
Dec	0	0	0
Jan	2	4	0
Feb	0	0	0
Mar	0	0	0
Daily Ave	0.0	0.0	0.0

**SMUF #20 30-025-21678**

	Oil	Gas	Water
Oct	105	195	91
Nov	0	0	0
Dec	0	0	0
Jan	12	28	13
Feb	41	146	67
Mar	195	134	90
Daily Ave	2.0	2.8	1.5

**SMUF #22 30-025-21922**

	Oil	Gas	Water
Oct	139	1626	68
Nov	60	935	27
Dec	87	1441	27
Jan	79	1133	31
Feb	53	901	64
Mar	58	1017	124
Daily Ave	2.6	39.2	1.9

**SMUF #27 30-025-25612**

	Oil	Gas	Water
Oct	99	2036	31
Nov	5	137	2
Dec	0	0	0
Jan	0	0	0
Feb	27	708	9
Mar	0	414	0
Daily Ave	0.7	18.3	0.2

**SMUF #40 30-025-31475**

	Oil	Gas	Water
Oct	33	2830	27
Nov	15	1606	14
Dec	22	2471	13
Jan	20	1777	16
Feb	20	1262	13
Mar	29	1388	16
Daily Ave	0.8	63.0	0.6

**SMUF #9 30-025-11117**

	Oil	Gas	Water
Oct	0	39	0
Nov	0	26	0
Dec	0	41	0
Jan	0	38	0
Feb	0	36	0
Mar	0	39	0
Daily Ave	0.0	1.2	0.0

**SMUF #10 30-025-11118**

	Oil	Gas	Water
Oct	206	2120	31
Nov	90	1311	13
Dec	122	2108	12
Jan	179	2048	16
Feb	186	1874	13
Mar	203	2062	16
Daily Ave	5.5	64.0	0.6

**SMUF #30 30-025-25747**

	Oil	Gas	Water
Oct	100	0	93
Nov	45	0	54
Dec	50	0	61
Jan	48	6	56
Feb	52	0	53
Mar	60	0	62
Daily Ave	2.0	0.0	2.1

**SMUF #33 30-025-26095**

	Oil	Gas	Water
Oct	74	199	179
Nov	38	124	98
Dec	51	162	104
Jan	69	161	114
Feb	80	180	106
Mar	87	198	124
Daily Ave	2.2	5.7	4.0

**SMUF #24 30-025-22488**

	Oil	Gas	Water
Oct	0	0	0
Nov	0	0	0
Dec	0	0	0
Jan	0	0	0
Feb	2	29	8
Mar	0	22	0
Daily Ave	0.0	0.3	0.0

**SMUF #37 30-025-26355**

	Oil	Gas	Water
Oct	0	51	0
Nov	0	38	0
Dec	0	69	0
Jan	0	58	0
Feb	0	43	0
Mar	0	50	0
Daily Ave	0.0	1.7	0.0

**SMUF #39 30-025-26598**

	Oil	Gas	Water
Oct	27	0	4
Nov	17	0	0
Dec	15	0	0
Jan	26	0	742
Feb	23	0	0
Mar	23	0	0
Daily Ave	0.7	0.0	4.1

**SMUF #45 30-025-35292**

	Oil	Gas	Water
Oct	80	4057	60
Nov	39	3003	36
Dec	30	3472	40
Jan	54	4686	52
Feb	45	3658	53
Mar	66	4208	60
Daily Ave	1.7	128.2	1.7

**SM A Fed #5 30-025-11201**

	Oil	Gas	Water
Oct	27	0	180
Nov	16	0	108
Dec	16	0	129
Jan	26	0	156
Feb	23	0	160
Mar	24	0	186
Daily Ave	0.7	0.0	5.1

**SMUF #14 30-025-11110**

	Oil	Gas	Water
Oct	81	0	65
Nov	39	0	36
Dec	31	0	43
Jan	52	0	52
Feb	45	0	51
Mar	48	0	62
Daily Ave	1.6	0.0	1.7

**SMUF #15 30-025-20513**

	Oil	Gas	Water
Oct	99	0	140
Nov	50	0	72
Dec	44	0	80
Jan	78	0	82
Feb	70	0	80
Mar	70	0	90
Daily Ave	2.3	0.0	3.0

**SMUF #1 30-025-11111**

	Oil	Gas	Water
Oct	314	1653	3350
Nov	157	1063	1768
Dec	160	1468	2298
Jan	218	1323	2124
Feb	258	1541	2658
Mar	257	1769	3003
Daily Ave	7.6	49.0	84.5

**SMUF #17 30-025-20298**

	Oil	Gas	Water
Oct	1230	1403	19712
Nov	767	898	11270
Dec	913	1281	14650
Jan	1334	1273	16532
Feb	1044	962	13344
Mar	1195	1117	13509
Daily Ave	36.0	38.5	494.5

**SMUF #25 30-025-20298**

	Oil	Gas	Water
Oct	152	246	0
Nov	83	189	0
Dec	73	223	0
Jan	131	243	0
Feb	117	203	0
Mar	117	223	0
Daily Ave	3.7	7.4	0.0



NUMBER OF COPIES RECEIVED	
DISTRIBUTION	
SANTA FE	
FILE	
U.S.O.S.	
LAND OFFICE	
TRANSPORTER	
OPERATION OFFICE	
OPERATOR	

**NEW MEXICO OIL CONSERVATION COMMISSION**  
**WELL LOCATION AND ACREAGE DEDICATION PLAT**  
 SEE INSTRUCTIONS FOR COMPLETING THIS FORM ON THE REVERSE SIDE

FORM C-128  
 Revised 5/1/57

OCT 9 8 19 AM '63

**SECTION A**

Operator <b>Pan American Petroleum Corporation</b>		Lease <b>South</b>		Well No. <b>1</b>
Unit Letter <b>J</b>	Section <b>35</b>	Township <b>21-S</b>	Range <b>37-E</b>	County <b>Lea</b>

Actual Footage Location of Well:

<b>1000</b> feet from the <b>South</b> line and <b>1000</b> feet from the <b>East</b> line
Ground Level Elev. <b>2551</b> Producing Formation <b>35</b> Pool <b>Section 35</b> Dedicated Acreage: <b>50</b> Acres

1. Is the Operator the only owner in the dedicated acreage outlined on the plat below? YES 1 NO     . ("Owner" means the person who has the right to drill into and to produce from any pool and to appropriate the production either for himself or for himself and another. (65-3-29 (e) NMSA 1935 Comp.)
2. If the answer to question one is "no," have the interests of all the owners been consolidated by communitization agreement or otherwise? YES      NO     . If answer is "yes," Type of Consolidation
3. If the answer to question two is "no," list all the owners and their respective interests below:

Owner	Land Description

**SECTION B**

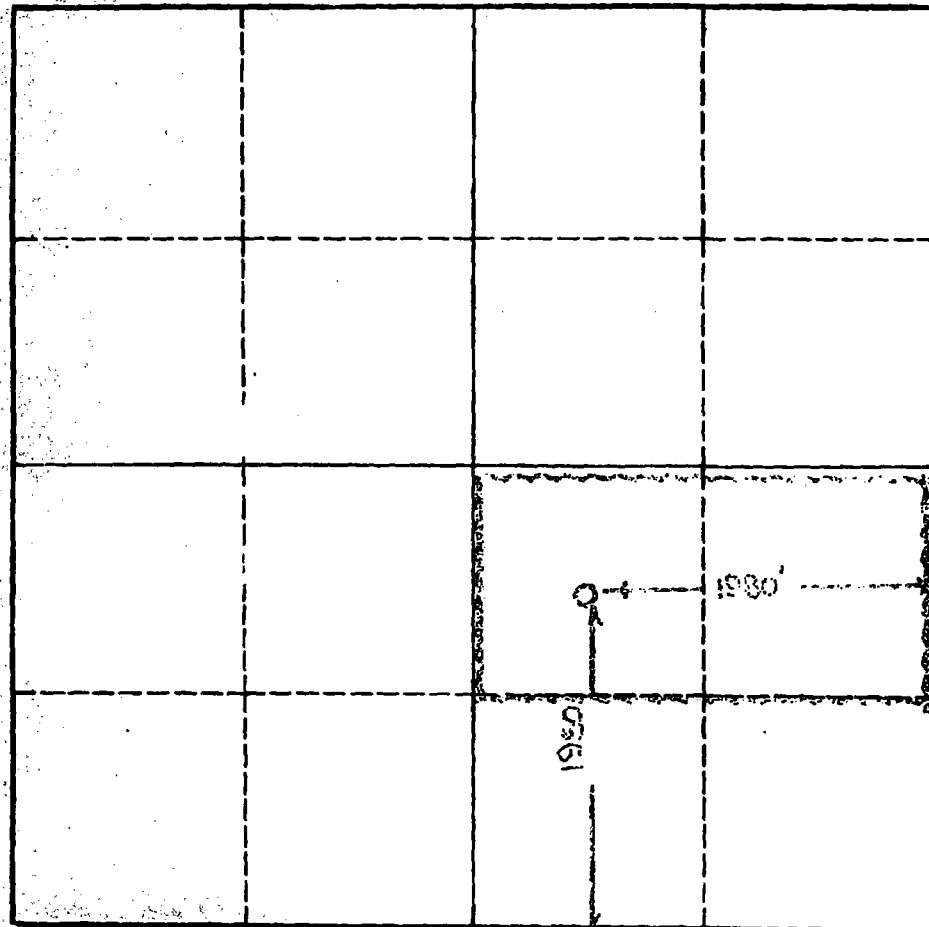

0 330 660 990 1320 1650 1980 2310 2640 2000 1500 1000 500 0

**CERTIFICATION**

I hereby certify that the information in SECTION A above is true and complete to the best of my knowledge and belief.

Name Original Signed by  
**V. E. STALEY**

Position

Area Surveyed  
 Company

Date  
**10-7-63**

I hereby certify that the well location shown on the plat in SECTION B was plotted from field notes of actual surveys made by me or under my supervision, and that the same is true and correct to the best of my knowledge and belief.

Date Surveyed

Registered Professional Engineer  
 and/or Land Surveyor

Certificate No.

District I  
PO Box 1980, Hobbs, NM 88241-1980  
District II  
811 S. 1st Street, Artesia, NM 88210-2834  
District III  
1000 Rio Brazos Rd., Aztec, NM 87410  
District IV  
2040 South Pacheco, Santa Fe, NM 87505

State of New Mexico  
Energy, Minerals & Natural Resources Department

**OIL CONSERVATION DIVISION**  
2040 South Pacheco  
Santa Fe, NM 87505

Form C-102  
Revised October 18, 1994  
Instructions on back  
Submit to Appropriate District Office  
State Lease - 4 Copies  
Fee Lease - 3 Copies

☐ AMENDED REPORT

**WELL LOCATION AND ACREAGE DEDICATION PLAT**

<sup>1</sup> API Number <b>30-025-11112</b>		<sup>2</sup> Pool Code <b>26220</b>		<sup>3</sup> Pool Name <b>Fowler; Drinkard</b>	
<sup>4</sup> Property Code <b>19582</b>		<sup>5</sup> Property Name <b>South Mattix Unit Federal</b>			<sup>6</sup> Well Number <b>2</b>
<sup>7</sup> OGRID No. <b>157984</b>		<sup>8</sup> Operator Name <b>Altura Energy LTD</b>			<sup>9</sup> Elevation <b>3726' DF</b>

<sup>10</sup> Surface Location

UL or lot no.	Section	Township	Range	Lot. Idn	Feet from the	North/South Line	Feet from the	East/West line	County
<b>N</b>	<b>15</b>	<b>24-S</b>	<b>37-E</b>		<b>660</b>	<b>South</b>	<b>1980</b>	<b>West</b>	<b>Lea</b>

<sup>11</sup> Bottom Hole Location If Different From Surface

UL or lot no.	Section	Township	Range	Lot. Idn	Feet from the	North/South Line	Feet from the	East/West line	County

<sup>12</sup> Dedicated Acres <b>40</b>	<sup>13</sup> Joint or Infill	<sup>14</sup> Consolidation Code	<sup>15</sup> Order No.
--	-------------------------------	----------------------------------	-------------------------

**NO ALLOWABLE WILL BE ASSIGNED TO THIS COMPLETION UNTIL ALL INTERESTS HAVE BEEN CONSOLIDATED  
OR A NON-STANDARD UNIT HAS BEEN APPROVED BY THE DIVISION**

				<sup>17</sup> <b>OPERATOR CERTIFICATION</b> I hereby certify that the information contained herein is true and complete to the best of my knowledge and belief.	
				Signature <u>Mark Stephens</u>	
				Printed Name <b>Mark Stephens</b>	
				Title <b>Business Analyst (SG)</b>	
Date <b>03/24/2000</b>				<sup>18</sup> <b>SURVEYOR CERTIFICATION</b> I hereby certify that the well location shown on this plat was plotted from field notes of actual surveys made by me or under my supervision, and that the same is true and correct to the best of my belief.	
				Date of Survey	
				Signature and Seal of Professional Surveyor:	
				Certificate Number	

NUMBER OF COPIES RECEIVED	
DISTRIBUTION	
SANTA FE	
FILE	
U.S.G.	
LAND OFFICE	
TRANSPORTER	
OPERATION OFFICE	
OPERATOR	

**NEW MEXICO OIL CONSERVATION COMMISSION**  
**WELL LOCATION AND ACREAGE DEDICATION PLAT**  
 SEE INSTRUCTIONS FOR COMPLETING THIS FORM ON THE REVERSE SIDE

FORM C-128  
 Revised 5/1/57

SECTION A					
Operator <b>Pan American Petroleum Corporation</b>			Lessee <b>South Mattix Unit</b>		Well No. <b>3</b>
Unit Letter <b>B</b>	Section <b>22</b>	Township <b>24-S</b>	Range <b>37-E</b>	County <b>Lea</b>	
Actual Footage Location of Well: <b>660</b> feet from the <b>North</b> line and <b>1980</b> feet from the <b>East</b> line					
Ground Level Elev. <b>3244' RDB</b>	Producing Formation <b>Blinbry</b>		Pool <b>Fowler Blinbry</b>		Dedicated Acreage: <b>80</b> Acres

1. Is the Operator the only owner in the dedicated acreage outlined on the plat below? YES ☒ NO ☐ . ("Owner" means the person who has the right to drill into and to produce from any pool and to appropriate the production either for himself or for himself and another. (63-3-29 (e) NMSA 1935 Comp.)
2. If the answer to question one is "no," have the interests of all the owners been consolidated by communitization agreement or otherwise? YES ☐ NO ☐ . If answer is "yes," Type of Consolidation \_\_\_\_\_
3. If the answer to question two is "no," list all the owners and their respective interests below:

Owner:	Land Description

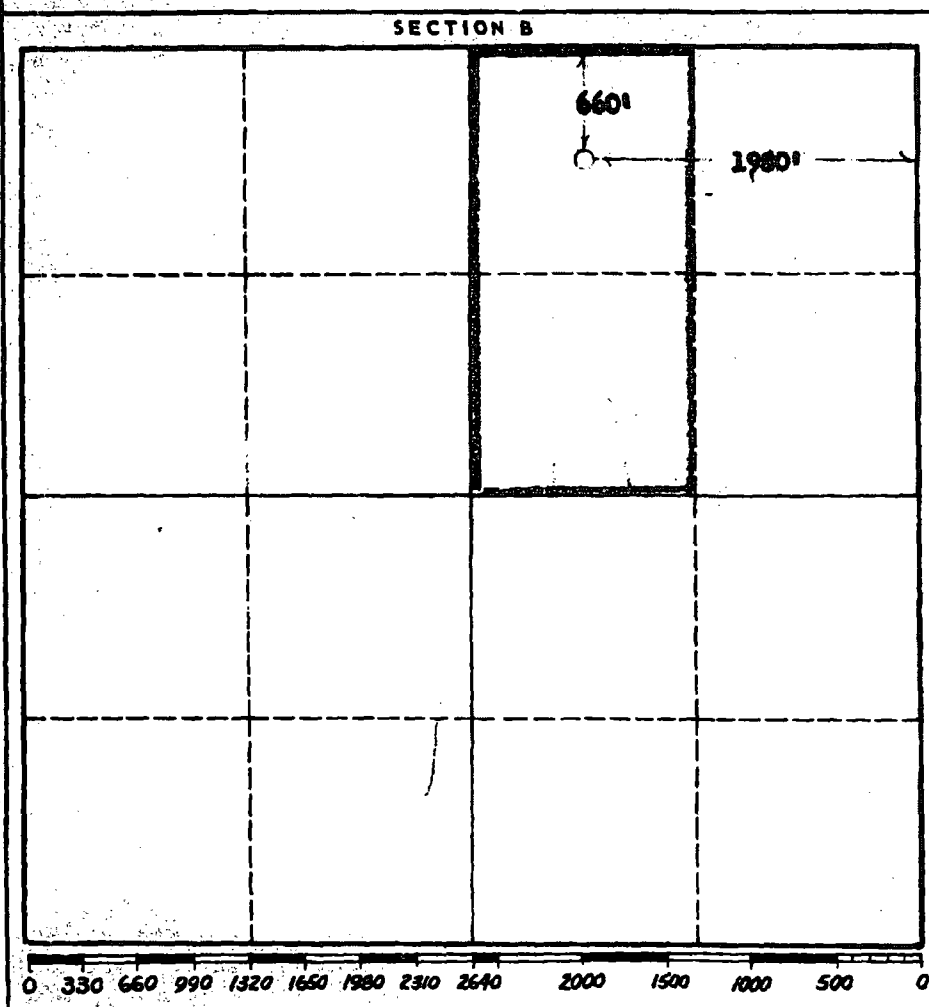

**CERTIFICATION**

I hereby certify that the information in SECTION A above is true and complete to the best of my knowledge and belief.

Name	Original Signed By: <b>V. E. STALEY</b>
Position	<b>Area Superintendent</b>
Company	<b>Pan American Petroleum Corp.</b>
Date	<b>August 9, 1963</b>

I hereby certify that the well location shown on the plat in SECTION B was plotted from field notes of actual surveys made by me or under my supervision, and that the same is true, and correct to the best of my knowledge and belief.

Date Surveyed	
Registered Professional Engineer and/or Land Surveyor	
Certificate No.	

**OIL CONSERVATION DIVISION**  
2040 South Pacheco  
Santa Fe, NM 87505

**Submit to Appropriate District Office**  
**State Lease - 4 Copies**  
**Fee Lease - 3 Copies**

☐ **AMENDED REPORT**

## WELL LOCATION AND ACREAGE DEDICATION PLAT

<sup>1</sup> API Number <b>30-025-11201</b>	<sup>2</sup> Pool Code <b>26640</b>	<sup>3</sup> Pool Name <b>Fowler; Upper Silurian</b>
<sup>4</sup> Property Code <b>19582</b>	<sup>5</sup> Property Name <b>A South Mattix Unit Federal</b>	<sup>6</sup> Well Number <b>5</b>
<sup>7</sup> OGRID No. <b>157984</b>	<sup>8</sup> Operator Name <b>Occidental Permian Limited Partnership</b>	<sup>9</sup> Elevation <b>3247' DF</b>

## <sup>10</sup> Surface Location

UL or lot no:	Section	Township	Range	Lot. Idn	Feet from the	North/South Line	Feet from the	East/West line	County
H	22	24-S	37-E		1980	North	660	East	Lea

<sup>11</sup> Bottom Hole Location If Different From Surface

UL or lot no.	Section	Township	Range	Lot. Idn	Feet from the	North/South Line	Feet from the	East/West line	County
---------------	---------	----------	-------	----------	---------------	------------------	---------------	----------------	--------

12 Dedicated Acres 40	13 Joint or Infill	14 Consolidation Code	15 Order No.
--------------------------	--------------------	-----------------------	--------------

NO ALLOWABLE WILL BE ASSIGNED TO THIS COMPLETION UNTIL ALL INTERESTS HAVE BEEN CONSOLIDATED  
OR A NON--STANDARD UNIT HAS BEEN APPROVED BY THE DIVISION

				1980'
				660'

17

OPERATOR CERTIFICATION

I hereby certify that the information contained herein is true and complete to the best of my knowledge and belief.

Mark Stephens

Signature

Mark Stephens

Printed Name

Business Analyst (SG)

Title

05/05/00

Date

18

SURVEYOR CERTIFICATION

I hereby certify that the well location shown on this plan was plotted from field notes of actual surveys made by me or under my supervision, and that the same is true and correct to the best of my belief.

Date of Survey

Signature and Seal of Professional Surveyor:

Certificate Number

NEW MEXICO OIL CONSERVATION COMMISSION  
WELL LOCATION AND ACREAGE DEDICATION PLAT

Form C-102  
Supersedes C-128  
Effective 1-1-65

All distances must be from the outer boundaries of the Section.

Amoco Production Company				South Mattix Unit Fed		Well No. 6
Section 15	Township 24-S	Range 37-E	County LEA			
1980 feet from the SOUTH line and 660 feet from the WEST line						
3282 RDB		Producing Formation UPPER YESO	Pool FOWLER UPPER YESO		Dedicated Acreage: 80 Acres	

1. Outline the acreage dedicated to the subject well by colored pencil or hatchure marks on the plat below.
2. If more than one lease is dedicated to the well, outline each and identify the ownership thereof (both as to working interest and royalty).
3. If more than one lease of different ownership is dedicated to the well, have the interests of all owners been consolidated by communitization, unitization, force-pooling, etc?

Yes ☐ No ☐

If answer is "yes," type of consolidation UNITIZATION

If answer is "no," list the owners and tract descriptions which have actually been consolidated. (Use reverse side of this form if necessary.)

No allowable will be assigned to the well until all interests have been consolidated (by communitization, unitization, forced-pooling, or otherwise) or until a non-standard unit, eliminating such interests, has been approved by the Commission.

CERTIFICATION

I hereby certify that the information contained herein is true and complete to the best of my knowledge and belief.

Name

Position  
AREA SUPERINTENDENT

Company  
Amoco Production Company

Date  
JAN 2 1973

I hereby certify that the well location shown on this plat was plotted from field notes of actual surveys made by me or under my supervision, and that the same is true and correct to the best of my knowledge and belief.

Date Surveyed

Registered Professional Engineer and/or Land Surveyor

Certificate No.

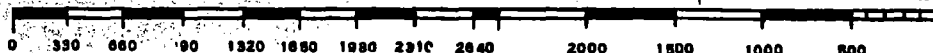
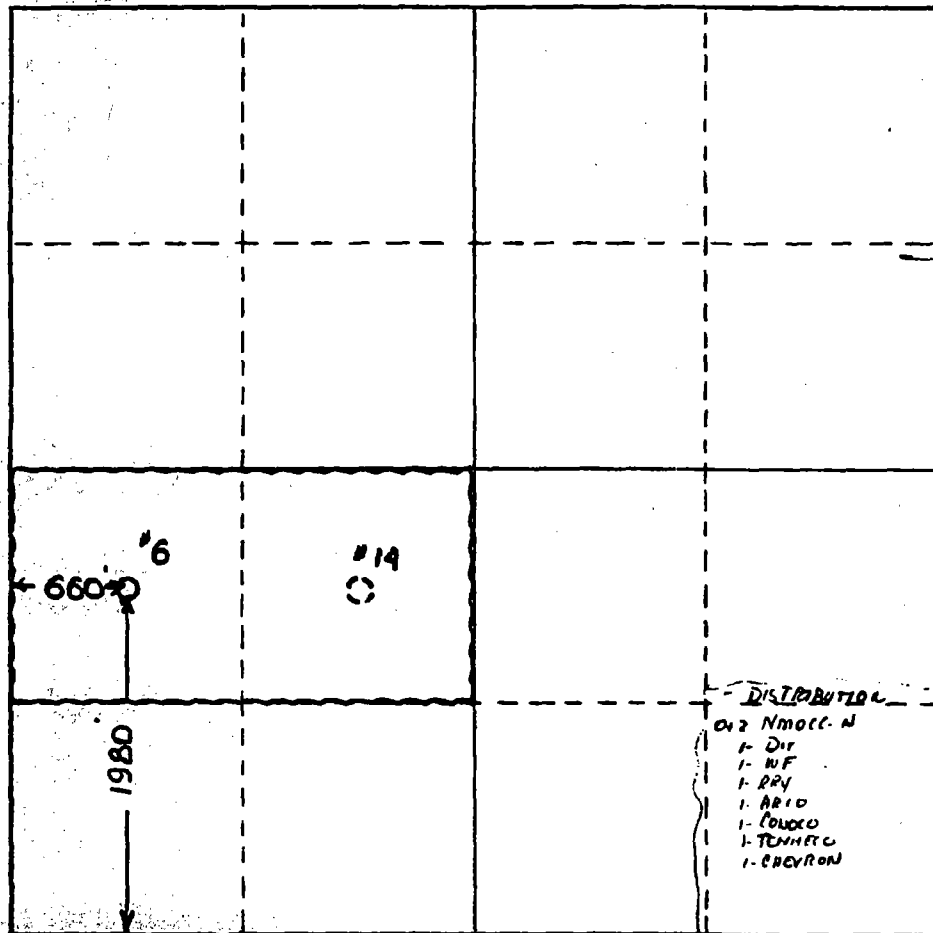

**NEW MEXICO OIL CONSERVATION COMMISSION  
WELL LOCATION AND ACREAGE DEDICATION PLAT**

Form C-102  
Supersedes C-128  
Effective 1-1-65

All distances must be from the outer boundaries of the Section.

Operator <b>Amoco Production Company</b>			Lease <b>South Mattix Unit <i>Federal</i></b>		Well No. <b>9</b>
Unit Letter <b>B</b>	Section <b>15</b>	Township <b>24-S</b>	Range <b>37-E</b>	County <b>Lea</b>	
Actual Footage Location of Well: <b>660</b> feet from the <b>North</b> line and <b>1980</b> feet from the <b>East</b> line.					
Ground Level Elev. <b>3267 RDB</b>	Producing Formation <b>Upper Yeso</b>		Pool <b>Fowler Upper Yeso</b>		Dedicated Acreage <b>80</b> Acres

1. Outline the acreage dedicated to the subject well by colored pencil or hatchure marks on the plat below.
2. If more than one lease is dedicated to the well, outline each and identify the ownership thereof (both as to working interest and royalty).
3. If more than one lease of different ownership is dedicated to the well, have the interests of all owners been consolidated by communitization, unitization, force-pooling, etc?

☐ Yes ☐ No If answer is "yes," type of consolidation \_\_\_\_\_

If answer is "no," list the owners and tract descriptions which have actually been consolidated. (Use reverse side of this form if necessary.) \_\_\_\_\_

No allowable will be assigned to the well until all interests have been consolidated (by communitization, unitization, forced-pooling, or otherwise) or until a non-standard unit, eliminating such interests, has been approved by the Commission.

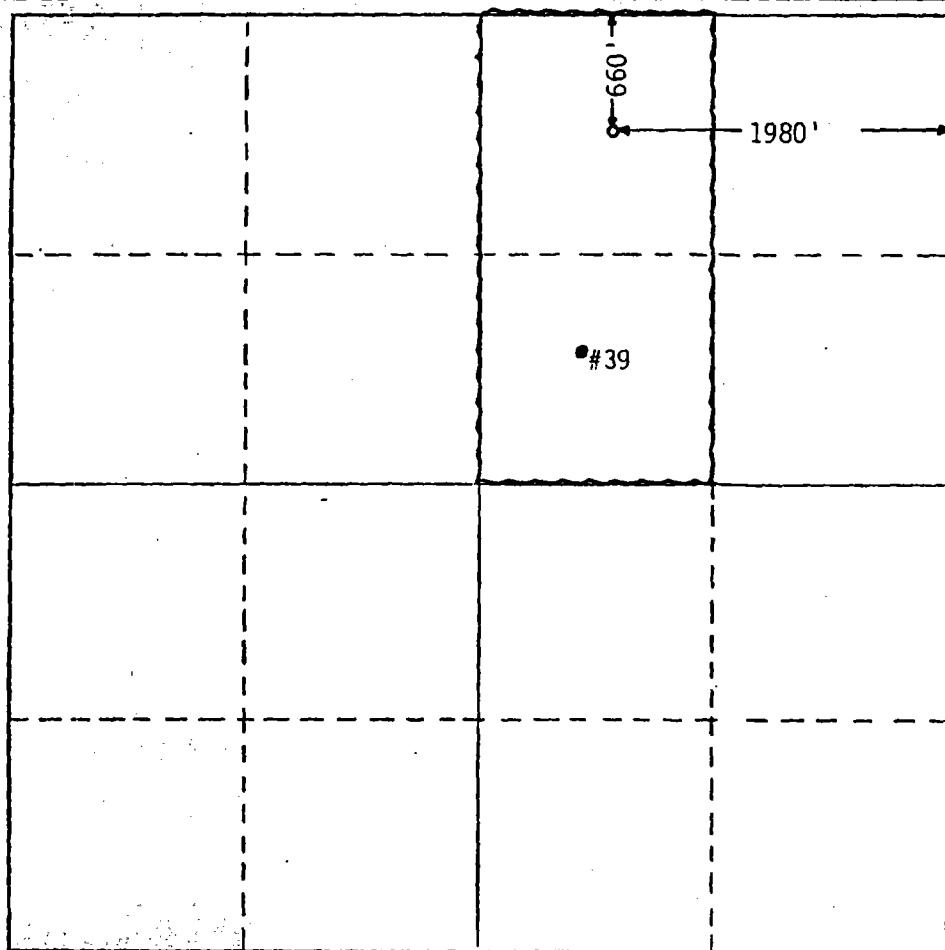

**CERTIFICATION**

I hereby certify that the information contained herein is true and complete to the best of my knowledge and belief.

Name ***Bob Davis***  
 Position **Admin. Analyst**  
 Company **Amoco Production Company**  
 Date **7-2-80**

I hereby certify that the well location shown on this plat was plotted from field notes of actual surveys made by me or under my supervision, and that the same is true and correct to the best of my knowledge and belief.

Date Surveyed \_\_\_\_\_

Registered Professional Engineer and/or Land Surveyor

Certificate No. \_\_\_\_\_

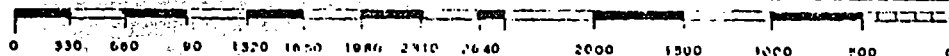

NUMBER OF COPIES RECEIVED	
DISTRIBUTION	
SANTA FE	
FILE	
M.S.S.	
LAND OFFICE	
TRANSPORTER	OIL
	GAS
PRODUCTION OFFICE	
OPERATOR	

**NEW MEXICO OIL CONSERVATION COMMISSION**  
**WELL LOCATION AND ACREAGE DEDICATION PLAT**  
 SEE INSTRUCTIONS FOR COMPLETING THIS FORM ON THE REVERSE SIDE

FORM C-128  
 Revised 5/1/57

**SECTION A**

Operator <b>Pan American Petroleum Corporation</b>		Lease <b>South Mattix Unit</b>		Well No. <b>10</b>
Unit Letter <b>H</b>	Section <b>15</b>	Township <b>24-S</b>	Range <b>37-E</b>	County <b>Los</b>
Actual Footage Location of Well: <b>1900</b> feet from the <b>North</b> line and <b>610</b> feet from the <b>East</b> line				
Ground Level Elev. <b>3040' RLB</b>	Producing Formation <b>Blindery</b>	Pool <b>Powler Blindery</b>	Dedicated Acreage: <b>80</b> Acres	

1. Is the Operator the only owner in the dedicated acreage outlined on the plat below? YES ☒ NO ☐ . ("Owner" means the person who has the right to drill into and to produce from any pool and to appropriate the production either for himself or for himself and another. (65-3-29 (e) NMSA 1935 Comp.)
2. If the answer to question one is "no," have the interests of all the owners been consolidated by communitization agreement or otherwise? YES ☐ NO ☐ . If answer is "yes," Type of Consolidation \_\_\_\_\_
3. If the answer to question two is "no," list all the owners and their respective interests below:

Owner	Land Description

**SECTION B**

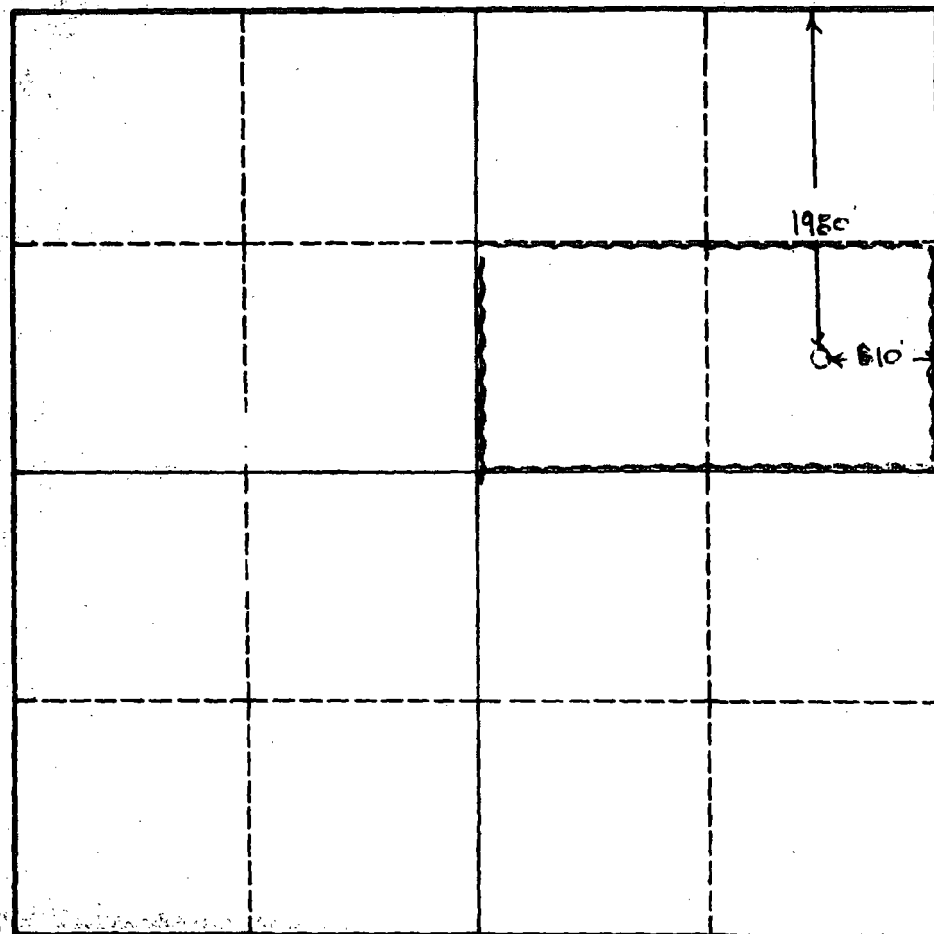

**CERTIFICATION**

I hereby certify that the information in SECTION A above is true and complete to the best of my knowledge and belief.

Original Signed By  
 Name **V. E. STALEY**

Position  
**Area Superintendent**

Company  
**Pan American Petroleum Corp.**

Date  
**October 30, 1964**

I hereby certify that the well location shown on the plat in SECTION B was plotted from field notes of actual surveys made by me or under my supervision, and that the same is true and correct to the best of my knowledge and belief.

Date Surveyed

Registered Professional Engineer  
 and/or Land Surveyor

Certificate No.

0 330 660 990 1320 1650 1980 2310 2640 2000 1500 1000 500 0

**NEW MEXICO OIL CONSERVATION COMMISSION  
WELL LOCATION AND ACREAGE DEDICATION PLAT**

Form C-102  
Supersedes C-128  
Effective 1-1-65

IND. REG. OFFICE O. C. C.

All distances must be from the outer boundaries of the Section.

Operator <b>PAN AMERICAN PETRO CORP</b>		Lease <b>SOUTH MATTHEW UNIST</b>		Well No. <b>12</b>
Unit Letter <b>P</b>	Section <b>22</b>	Township <b>24-S</b>	Range <b>37-E</b>	County <b>LEA</b>
Actual Location of Well: <b>766</b> feet from the <b>SOUTH</b> line and <b>554</b> feet from the <b>EAST</b> line				
Ground Level Elev. <b>3245 DF</b>	Producing Formation <b>BLINEBRY</b>	Pool <b>FOWLER BLINEBRY</b>	Dedicated Acreage <b>40</b> Acres	

1. Outline the acreage dedicated to the subject well by colored pencil or hatchure marks on the plat below.
2. If more than one lease is dedicated to the well, outline each and identify the ownership thereof (both as to working interest and royalty).
3. If more than one lease of different ownership is dedicated to the well, have the interests of all owners been consolidated by communitization, unitization, force-pooling, etc?

☐ Yes    ☐ No    If answer is "yes," type of consolidation \_\_\_\_\_

If answer is "no," list the owners and tract descriptions which have actually been consolidated. (Use reverse side of this form if necessary.) \_\_\_\_\_

No allowable will be assigned to the well until all interests have been consolidated (by communitization, unitization, forced-pooling, or otherwise) or until a non-standard unit, eliminating such interests, has been approved by the Commission.

**CERTIFICATION**

*I hereby certify that the information contained herein is true and complete to the best of my knowledge and belief.*

Name \_\_\_\_\_

Position \_\_\_\_\_

**AREA SUPERINTENDENT**

Company \_\_\_\_\_

**PAN AMERICAN PETRO. CORP.**

Date \_\_\_\_\_

**6-23-66**

*I hereby certify that the well location shown on this plat was plotted from field notes of actual surveys made by me or under my supervision, and that the same is true and correct to the best of my knowledge and belief.*

Date Surveyed \_\_\_\_\_

Registered Professional Engineer  
and/or Land Surveyor

Certificate No. \_\_\_\_\_

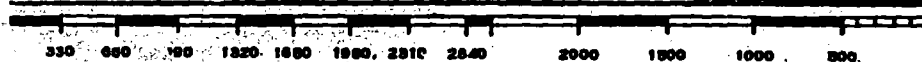



NEW MEXICO OIL CONSERVATION COMMISSION  
WELL LOCATION AND ACREAGE DEDICATION PLAT

Form C-102  
Supersedes C-128  
Effective 1-1-65

All distances must be from the outer boundaries of the Section.

Operator <i>Pan American Petroleum</i>		Lease <i>South Matias Unit</i>		Well No. <i>13</i>
Unit Letter <i>T</i>	Section <i>22</i>	Township <i>24-S</i>	Range <i>37-E</i>	County <i>Lea</i>
Actual Footage Location of Well: <i>2310</i> feet from the <i>South</i> line and <i>330</i> feet from the <i>East</i> line				
Ground Level Elev. <i>3245 RDS</i>	Producing Formation <i>Bolinebry</i>	Pool <i>Lower Bolinebry</i>	Dedicated Acreage: <i>80</i> Acres	

1. Outline the acreage dedicated to the subject well by colored pencil or hatchure marks on the plat below.
2. If more than one lease is dedicated to the well, outline each and identify the ownership thereof (both as to working interest and royalty).
3. If more than one lease of different ownership is dedicated to the well, have the interests of all owners been consolidated by communitization, unitization, force-pooling, etc?

☒ Yes ☐ No If answer is "yes," type of consolidation \_\_\_\_\_

If answer is "no," list the owners and tract descriptions which have actually been consolidated. (Use reverse side of this form if necessary.) \_\_\_\_\_

No allowable will be assigned to the well until all interests have been consolidated (by communitization, unitization, forced-pooling, or otherwise) or until a non-standard unit, eliminating such interests, has been approved by the Commission.

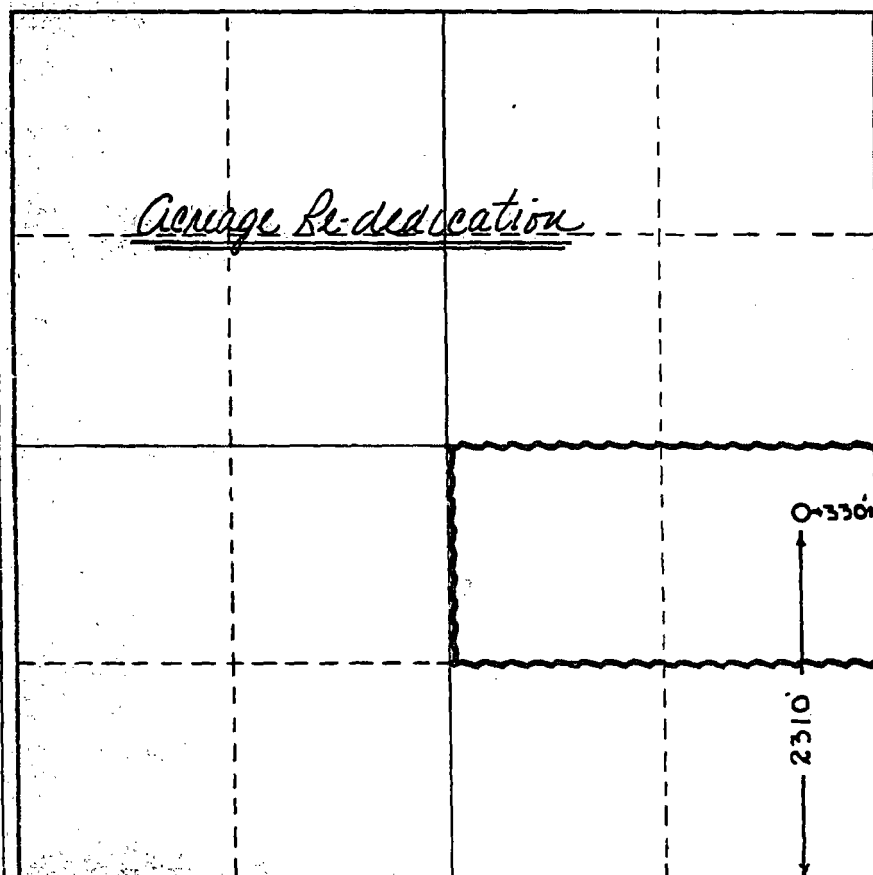

CERTIFICATION

I hereby certify that the information contained herein is true and complete to the best of my knowledge and belief.

Name Original Signed By:

*W. E. STALEY*

Position

*Area Supt*

Company

*Pan American Petro. Corp.*

Date

*March 25, 1965*

I hereby certify that the well location shown on this plat was plotted from field notes of actual surveys made by me or under my supervision, and that the same is true and correct to the best of my knowledge and belief.

Date Surveyed

Registered Professional Engineer and/or Land Surveyor

Certificate No.

0 320 640 960 1280 1600 1920 2240 2560 2880 3200 3520 3840 4160 4480 4800 5120 5440 5760 6080 6400

**NEW MEXICO OIL CONSERVATION COMMISSION  
WELL LOCATION AND ACREAGE DEDICATION PLAT**

Form C-102  
Supersedes C-128  
Effective 1-1-65

All distances must be from the outer boundaries of the Section.

Operator <b>Amoco Production Company</b>			Lease <b>South Mattix</b>		Well No. <b>14</b>
Unit Letter <b>K</b>	Section <b>15</b>	Township <b>24 South</b>	Range <b>37 East</b>	County <b>Lea</b>	
Actual Footage Location of Well: <div style="display: flex; justify-content: space-between;"> <span><b>1980</b> feet from the <b>South</b> line and <b>1980</b> feet from the <b>West</b> line</span> </div>					
Ground Level Elev. <b>3367 RDB</b>	Producing Formation <b>Paddock</b>	Pool <b>Fowler Paddock</b>	Dedicated Acreage: <b>320</b> Acres		

1. Outline the acreage dedicated to the subject well by colored pencil or hatchure marks on the plat below.
2. If more than one lease is dedicated to the well, outline each and identify the ownership thereof (both as to working interest and royalty).
3. If more than one lease of different ownership is dedicated to the well, have the interests of all owners been consolidated by communitization, unitization, force-pooling, etc?

☐ Yes   ☐ No   If answer is "yes," type of consolidation \_\_\_\_\_

If answer is "no," list the owners and tract descriptions which have actually been consolidated. (Use reverse side of this form if necessary.) \_\_\_\_\_

No allowable will be assigned to the well until all interests have been consolidated (by communitization, unitization, forced-pooling, or otherwise) or until a non-standard unit, eliminating such interests, has been approved by the Commission.

**CERTIFICATION**

*I hereby certify that the information contained herein is true and complete to the best of my knowledge and belief.*

Name **Ther Mitchell**  
 Position **Assistant Admin. Analyst**  
 Company **Amoco Production Company**  
 Date **2/25/80**

*I hereby certify that the well location shown on this plat was plotted from field notes of actual surveys made by me or under my supervision, and that the same is true and correct to the best of my knowledge and belief.*

Date Surveyed \_\_\_\_\_

Registered Professional Engineer  
and/or Land Surveyor

Certificate No. \_\_\_\_\_

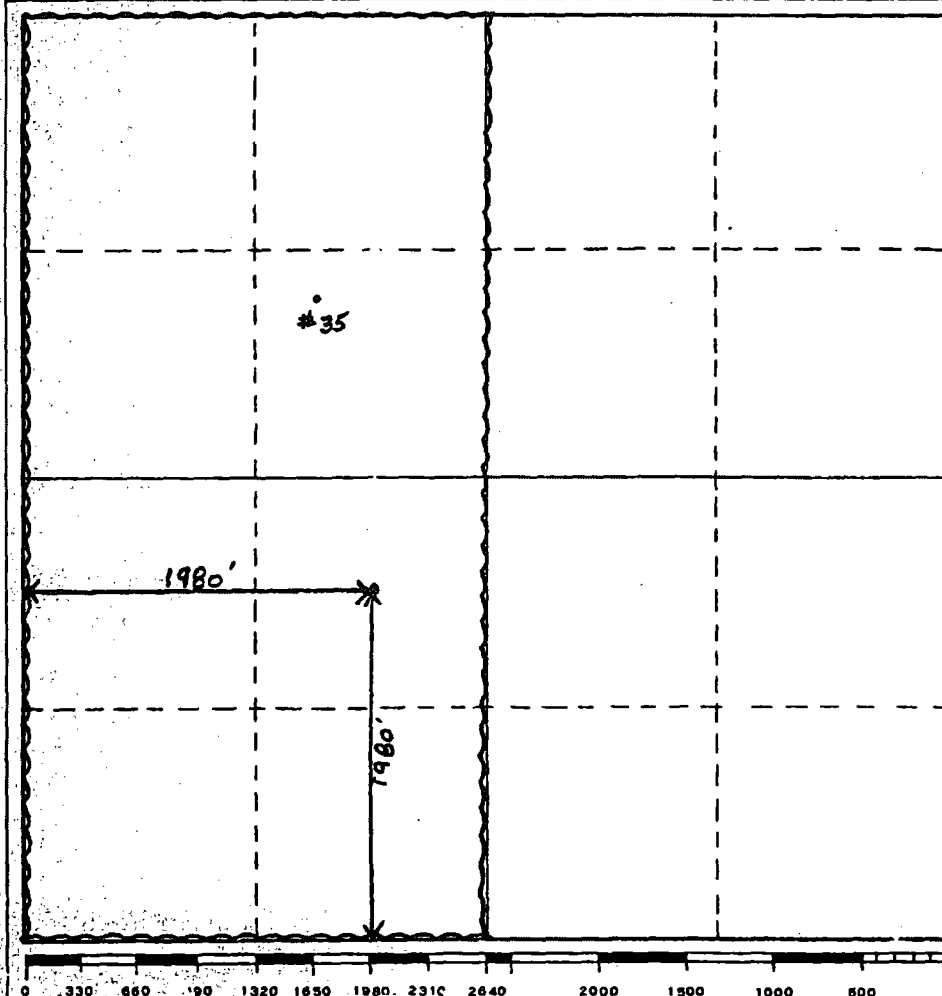

NEW MEXICO OIL CONSERVATION COMMISSION  
WE LOCATION AND ACREAGE DEDICATION PLAT

Form C-102  
Supersedes C-128  
Effective 1-1-65

All distances must be from the outer boundaries of the Section

Operator <b>Amoco Production Company</b>			Lease <b>South Mattix Unit</b>		Well No. <b>15</b>
Well Letter <b>A</b>	Section <b>22</b>	Township <b>24-S</b>	Range <b>37-E</b>	County <b>Lea</b>	
Actual Well Location of Well:					
<b>660</b>	feet from the	<b>North</b>	line and	<b>660</b>	feet from the <b>East</b> line
Sound Level Elev. <b>3243</b>	Producing Formation <b>Upper Silurian</b>		Foot <b>Fowler Upper Silurian Gas</b>	Dedicated Acreage <b>80</b>	

1. Outline the acreage dedicated to the subject well by colored pencil or hatchure marks on the plat below.
2. If more than one lease is dedicated to the well, outline each and identify the ownership thereof (both as to working interest and royalty).
3. If more than one lease of different ownership is dedicated to the well, have the interests of all owners been consolidated by communitization, unitization, force-pooling, etc?

☐ Yes ☐ No If answer is "yes," type of consolidation \_\_\_\_\_

If answer is "no," list the owners and tract descriptions which have actually been consolidated. (Use reverse side of this form if necessary.) \_\_\_\_\_

No allowable will be assigned to the well until all interests have been consolidated (by communitization, unitization, forced-pooling, or otherwise) or until a non-standard unit, eliminating such interests, has been approved by the Commission.

	<b>CERTIFICATION</b>
	I hereby certify that the information contained herein is true and complete to the best of my knowledge and belief.
	Name _____
	Position <b>Asst. Admin. Analyst</b>
	Company <b>Amoco Production Company</b>
	Date <b>3/2/90</b>
	I hereby certify that the well location shown on this plat was plotted from field notes of actual surveys made by me or under my supervision, and that the same is true and correct to the best of my knowledge and belief.
	Date Surveyed _____
	Registered Professional Engineer and/or Land Surveyor _____
	Certificate No. _____

330 660 990 1320 1650 1980 2310 2640 2970 3300 3630 3960 4290 4620 4950 5280 5610 5940 6270 6600

**NEW MEXICO OIL CONSERVATION COMMISSION**  
**WELL LOCATION AND ACREAGE DEDICATION PLAT**

FORM C-128  
 Revised 5/1/57

SEE INSTRUCTIONS FOR COMPLETING THIS FORM ON THE REVERSE SIDE

**SECTION A**

Operator <b>PAN AMERICAN PETROLEUM CORPORATION</b>		Lease <b>SOUTH MATYIX UNIT</b>		Vell No. <b>17</b>
Unit Letter <b>G</b>	Section <b>15</b>	Township <b>24 SOUTH</b>	Range <b>37 EAST</b>	County <b>LEA</b>
Actual Postage Location of Well: <b>1980</b> feet from the <b>NORTH</b> line and <b>1980</b> feet from the <b>EAST</b> line				
Ground Level Elev. <b>525</b>	Producing Formation <b>Elmendorf or Elmendorf</b>	Pool <b>Elmendorf, Elmendorf-Elmendorf</b>	Dedicated Acreage: <b>60</b> Acres	

1. Is the Operator the only owner in the dedicated acreage outlined on the plat below? YES ☒ NO ☐ ("Owner" means the person who has the right to drill into and to produce from any pool and to appropriate the production either for himself or for himself and another. (69-3-29 (e) NMSA 1955 Comp.)
2. If the answer to question one is "no," have the interests of all the owners been consolidated by communitization agreement or otherwise? YES ☐ NO ☐ If answer is "yes," Type of Consolidation \_\_\_\_\_
3. If the answer to question two is "no," list all the owners and their respective interests below:

Owner	Land Description

**SECTION B**

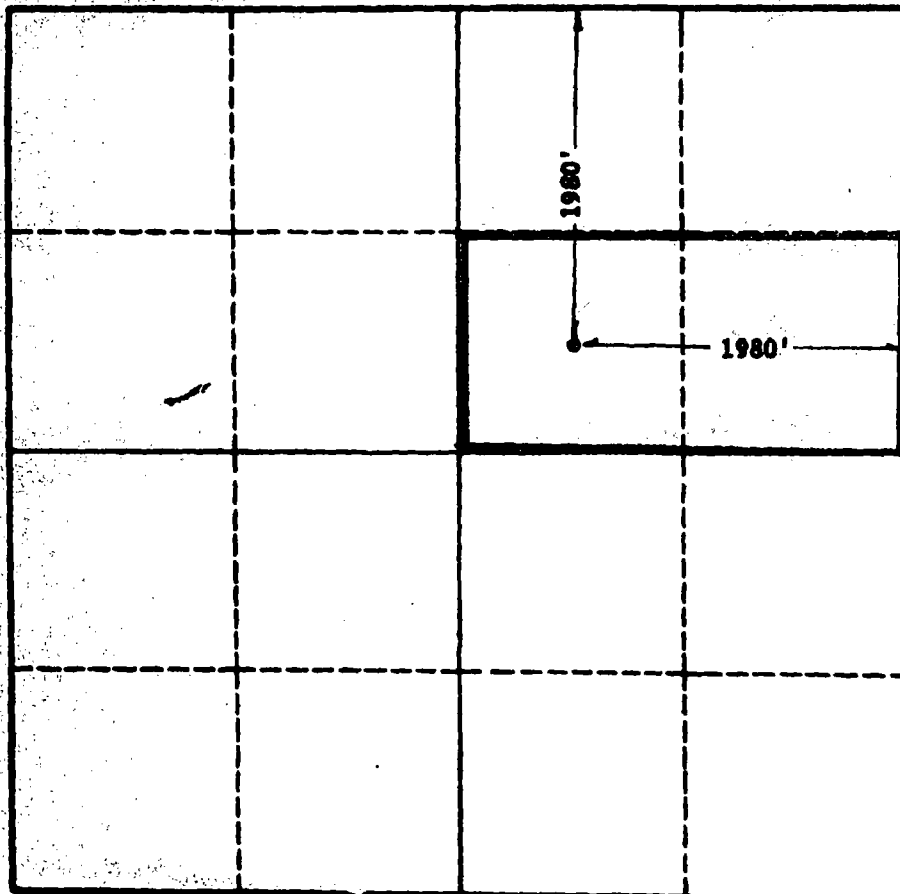

**CERTIFICATION**

I hereby certify that the information in SECTION A above is true and complete to the best of my knowledge and belief.

Name Original Signed by:  
**V. E. STALEY**

Position  
**Superintendent**

Company  
**Pan American Pet. Corp.**

Date  
**July 22, 1963**

I hereby certify that the well location shown on the plat in SECTION B was plotted from field notes of actual surveys made by me or under my supervision, and that the same is true and correct to the best of my knowledge and belief.

Date  
**7-18-63**

Registered Professional Engineer and/or Land Surveyor, **JOHN W. WEST**

Certificate No. **W. W. 1131**  
 N. M. - P. E. **NO. 670**



NEW MEXICO OIL CONSERVATION **HOBBS OFFICE O. O. G.**  
WELL LOCATION AND ACREAGE DEDICATION PLAT

Form C-102  
Supersedes C-128  
Effective 1-1-65

All distances must be from the outer boundary of the Section

Operator <b>PAN AMERICAN PETROLEUM CORP.</b>		Lease <b>SOUTH MATTIX UNIT</b>		Well <b>20</b>
Unit Letter <b>E</b>	Section <b>15</b>	Township <b>24 SOUTH</b>	Range <b>37 EAST</b>	County <b>LEA</b>
Actual Well Location of Well:				
<b>660</b>	feet from the <b>WEST</b>	line and <b>1980</b>	feet from the <b>NORTH</b>	line
Ground Level Elev.	Producing Formation <b>BLINE BRY</b>	Pool <b>FOWLER BLINE BRY</b>	Estimated Acreage <b>80</b> Acres	

1. Outline the acreage dedicated to the subject well by colored pencil or hatchure marks on the plat below.
2. If more than one lease is dedicated to the well, outline each and identify the ownership thereof (both as to working interest and royalty).
3. If more than one lease of different ownership is dedicated to the well, have the interests of all owners been consolidated by communitization, unitization, force-pooling, etc?

☒ Yes ☐ No If answer is "yes," type of consolidation **UNITIZATION**

If answer is "no," list the owners and tract descriptions which have actually been consolidated. (Use reverse side of this form if necessary.)

No allowable will be assigned to the well until all interests have been consolidated (by communitization, unitization, forced-pooling, or otherwise) or until a non-standard unit, eliminating such interests, has been approved by the Commission.

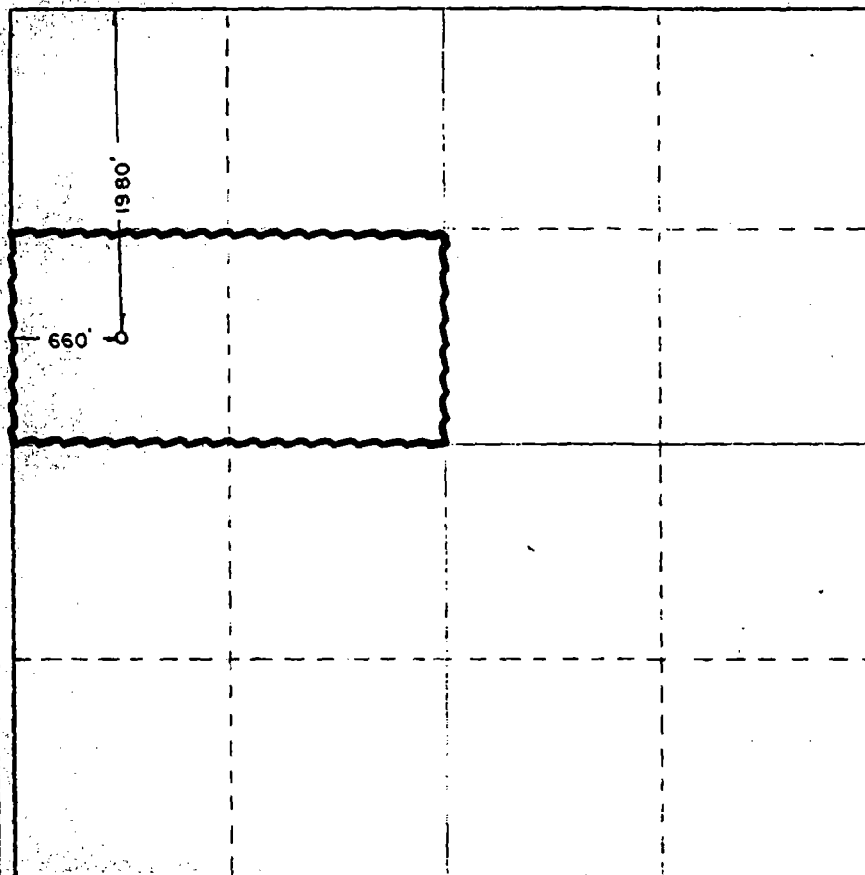

CERTIFICATION

I hereby certify that the information contained herein is true and complete to the best of my knowledge and belief.

AREA SUPERINTENDENT

**PAN AMERICAN PETROLEUM CO.**

Date

**2-17-66**

I hereby certify that the well location shown on this plat was plotted from field notes of actual surveys made by me or under my supervision, and that the same is true and correct to the best of my knowledge and belief.

Date Surveyed

**FEB. 15, 1966**

Registered Professional Land Surveyor

*John W. West*

**NEW MEXICO OIL CONSERVATION COMMISSION  
WELL LOCATION AND ACREAGE DEDICATION PLAT**

Form C-102  
Supersedes C-128  
Effective 1-1-65

All distances must be from the outer boundaries of the Section.

Owner <b>PAN AMERICAN PETROLEUM CORP.</b>			Lease <b>SOUTH MATTIX UNIT</b>		Well No. <b>22</b>
Unit Letter <b>C</b>	Section <b>15</b>	Township <b>24 SOUTH</b>	Range <b>37 EAST</b>	County <b>LEA</b>	
Actual Footage Location of Well:					
<b>710</b>	feet from the	<b>NORTH</b>	line and	<b>1930</b>	feet from the <b>WEST</b> line
Ground Level Elev.	Producing Formation <b>BLINEBRY</b>		Pool <b>FOWLER BLINEBRY</b>		Dedicated Acreage <b>80</b> Acres

1. Outline the acreage dedicated to the subject well by colored pencil or hatchure marks on the plat below.
2. If more than one lease is dedicated to the well, outline each and identify the ownership thereof (both as to working interest and royalty).
3. If more than one lease of different ownership is dedicated to the well, have the interests of all owners been consolidated by communitization, unitization, force-pooling, etc?

☒ Yes   ☐ No   If answer is "yes," type of consolidation **UNITIZATION**

If answer is "no," list the owners and tract descriptions which have actually been consolidated. (Use reverse side of this form if necessary.)

No allowable will be assigned to the well until all interests have been consolidated (by communitization, unitization, forced-pooling, or otherwise) or until a non-standard unit, eliminating such interests, has been approved by the Commission.

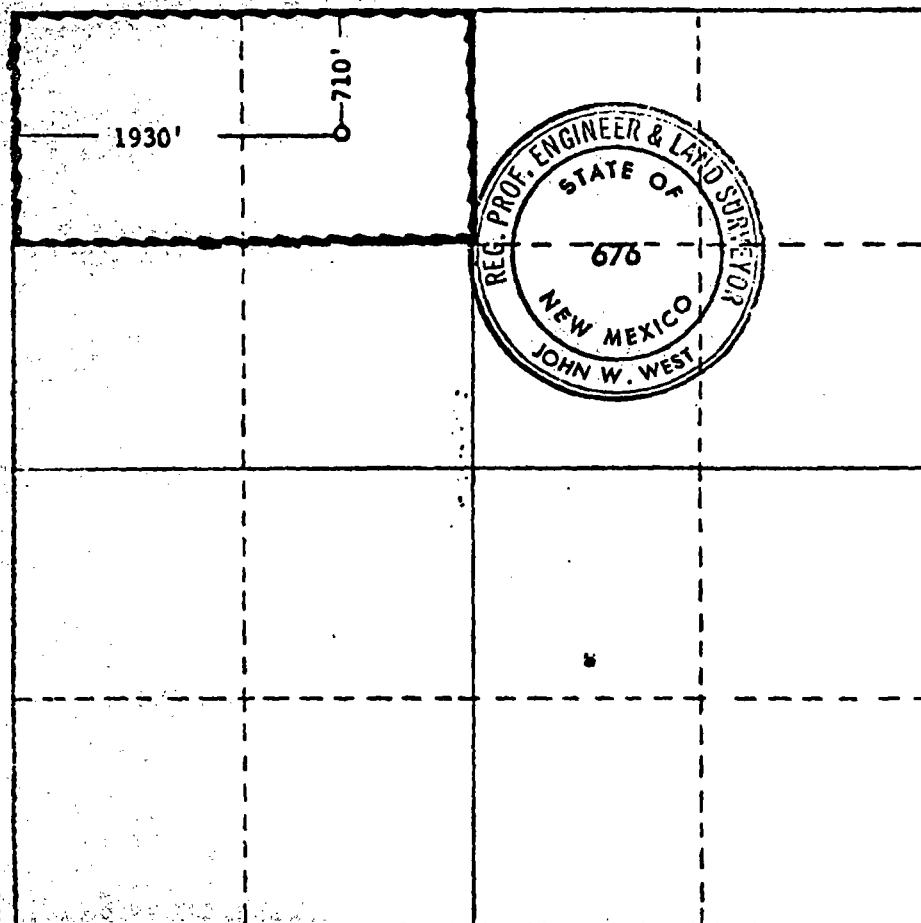

**CERTIFICATION**

I hereby certify that the information contained herein is true and complete to the best of my knowledge and belief.

Name \_\_\_\_\_

Position \_\_\_\_\_

**Area Superintendent**

Company \_\_\_\_\_

**Pan American Petroleum Corp.**

Date \_\_\_\_\_

**11-3-66**

I hereby certify that the well location shown on this plat was plotted from field notes of actual surveys made by me or under my supervision, and that the same is true and correct to the best of my knowledge and belief.

Date Surveyed \_\_\_\_\_

**OCTOBER 6, 1966**

Registered Professional Engineer and/or Land Surveyor

*John W. West*

Certificate No. \_\_\_\_\_

**NM PE & LS No. 676**



District I  
P.O. Box 1980, Hobbs, NM 88241-1980  
District II  
811 S. 1st Street, Artesia, NM 88210-2834  
District III  
1000 Rio Brazos Rd., Aztec, NM 87410  
District IV  
2040 South Pacheco, Santa Fe, NM 87505

State of New Mexico  
Energy, Minerals & Natural Resources Department

OIL CONSERVATION DIVISION  
2040 South Pacheco  
Santa Fe, NM 87505

Form C-102  
Revised October 18, 1994  
Instructions on back  
Submit to Appropriate District Office  
State Lease - 4 Copies  
Fee Lease - 3 Copies

☒ AMENDED REPORT

WELL LOCATION AND ACREAGE DEDICATION PLAT

<sup>1</sup> API Number <b>30-025-22488</b>		<sup>2</sup> Pool Code <b>96949</b>		<sup>3</sup> Pool Name <b>Wildcat; Upper Silurian</b>	
<sup>4</sup> Property Code <b>19582</b>		<sup>5</sup> Property Name <b>South Mattix Unit Federal</b>			<sup>6</sup> Well Number <b>24</b>
<sup>7</sup> OGRID No. <b>157984</b>		<sup>8</sup> Operator Name <b>Altura Energy Ltd.</b>			<sup>9</sup> Elevation <b>3260' RDB</b>

<sup>10</sup> Surface Location

UL or lot no.	Section	Township	Range	Lot. Idn	Feet from the	North/South Line	Feet from the	East/West line	County
<b>0</b>	<b>15</b>	<b>24-S</b>	<b>37-E</b>		<b>510</b>	<b>South</b>	<b>1830</b>	<b>East</b>	<b>Lea</b>

<sup>11</sup> Bottom Hole Location If Different From Surface

UL or lot no.	Section	Township	Range	Lot. Idn	Feet from the	North/South Line	Feet from the	East/West line	County

<sup>12</sup> Dedicated Acres <b>40</b>	<sup>13</sup> Joint or Infill	<sup>14</sup> Consolidation Code	<sup>15</sup> Order No.
--	-------------------------------	----------------------------------	-------------------------

NO ALLOWABLE WILL BE ASSIGNED TO THIS COMPLETION UNTIL ALL INTERESTS HAVE BEEN CONSOLIDATED  
OR A NON-STANDARD UNIT HAS BEEN APPROVED BY THE DIVISION

	<p><sup>17</sup> OPERATOR CERTIFICATION</p> <p>I hereby certify that the information contained herein is true and complete to the best of my knowledge and belief.</p> <p><i>Mark Stephens</i></p> <p>Signature</p> <p><b>Mark Stephens</b></p> <p>Printed Name</p> <p><b>Business Analyst (SG)</b></p> <p>Title</p> <p><b>08/13/99</b></p> <p>Date</p>	
	<p><sup>18</sup> SURVEYOR CERTIFICATION</p> <p>I hereby certify that the well location shown on this plat was plotted from field notes of actual surveys made by me or under my supervision, and that the same is true and correct to the best of my belief.</p> <p>_____</p> <p>Date of Survey</p> <p>Signature and Seal of Professional Surveyor:</p> <p>_____</p> <p>Certificate Number</p>	

NEW CO OIL CONSERVATION COMMISSION  
WELL LOCATION AND ACREAGE DEDICATION PLAT

Form C-102  
Supersedes C-128  
Effective 1-4-65

All distances must be from the outer boundaries of the Section.

Operator PAN AMERICAN PETROLEUM CORP.		Lease SOUTH MATTIX UNIT		Well No. 25	
Unit Letter C	Section 15	Township 24 SOUTH	Range 37 EAST	County LEA	
Actual Footage Location of Well: 910 feet from the NORTH line and 1980 feet from the WEST line					
Ground Level Elev.	Producing Formation ELLENBURGER		Pool FOWLER ELLENBURGER	Dedicated Acreage 80 Acres	

1. Outline the acreage dedicated to the subject well by colored pencil or hatchure marks on the plat below.
2. If more than one lease is dedicated to the well, outline each and identify the ownership thereof (both as to working interest and royalty).
3. If more than one lease of different ownership is dedicated to the well, have the interests of all owners been consolidated by communitization, unitization, force-pooling, etc?

☐ Yes ☐ No If answer is "yes," type of consolidation \_\_\_\_\_

If answer is "no," list the owners and tract descriptions which have actually been consolidated. (Use reverse side of this form if necessary.) \_\_\_\_\_

No allowable will be assigned to the well until all interests have been consolidated (by communitization, unitization, forced-pooling, or otherwise) or until a non-standard unit, eliminating such interests, has been approved by the Commission.

CERTIFICATION

I hereby certify that the information contained herein is true and complete to the best of my knowledge and belief.

Name \_\_\_\_\_

Position  
AREA SUPERINTENDENT

Company  
PAN AMERICAN PETROLEUM CORPORATION

Date  
OCT 22 1968

I hereby certify that the well location shown on this plat was plotted from field notes of actual surveys made by me or under my supervision, and that the same is true and correct to the best of my knowledge and belief.

Date Surveyed  
OCTOBER 21, 1968

Registered Professional Engineer  
and/or Land Surveyor

*John W. West*  
Certificate No. 676

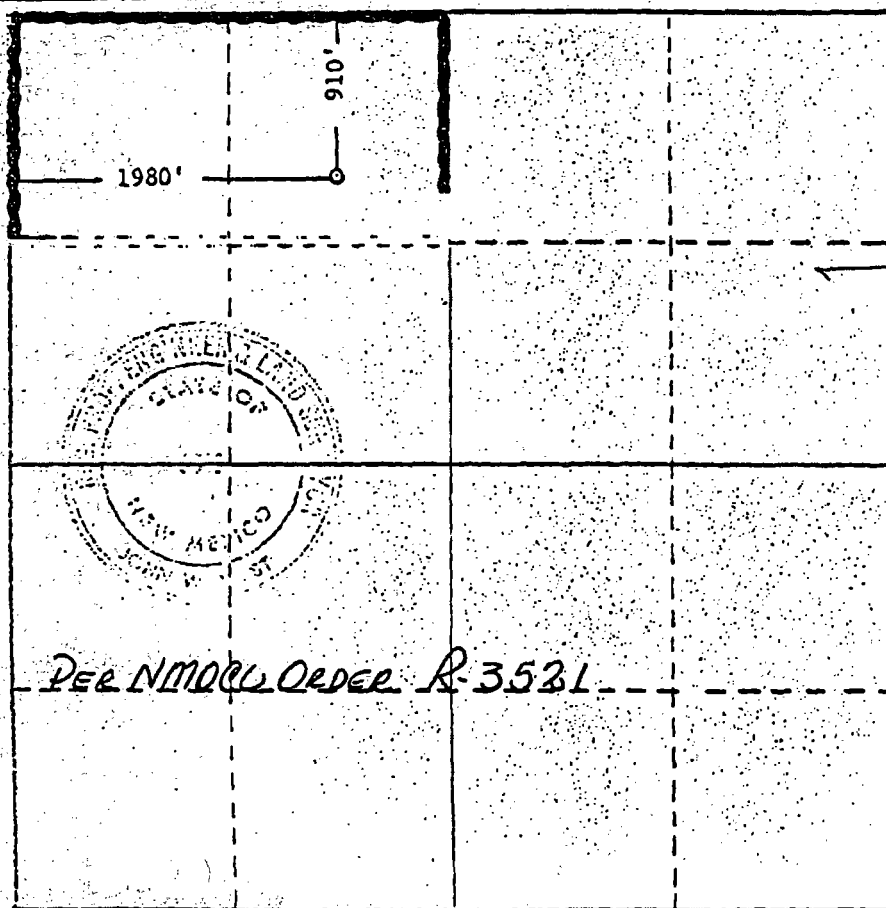

0 330 660 990 1320 1650 1980 2310 2640 2970 3300 3630 3960 4290 4620 4950 5280 5610 5940 6270 6600 6930 7260 7590 7920 8250 8580 8910 9240 9570 9900 0



NEW MEXICO OIL CONSERVATION COMMISSION  
WELL LOCATION AND ACREAGE DEDICATION PL

Form C-102  
Superseded C-128  
Effective 1-1-65

All distances must be from the outer boundaries of the Section

Operator <b>AMOCO PRODUCTION COMPANY</b>			Lease <b>South Mattix Unit</b>			Well No. <b>27</b>
Section Letter <b>F</b>	Section <b>15</b>	Township <b>24 South</b>	Range <b>37 East</b>	County <b>Lea</b>		
Actual Footage Location of Well:						
<b>2030</b> feet from the <b>north</b> line and		<b>1880</b> feet from the <b>west</b> line				
Ground Level Elev. <b>3250.4</b>	Producing Formation <b>UPPER YESO</b>		Pool <b>FOWLER UPPER YESO</b>	Dedicated Acreage: <b>80</b>		

- Outline the acreage dedicated to the subject well by colored pencil or hatchure marks on the plat below.
- If more than one lease is dedicated to the well, outline each and identify the ownership thereof (both as to working interest and royalty).
- If more than one lease of different ownership is dedicated to the well, have the interests of all owners been consolidated by communitization, unitization, force-pooling, etc?

☒ Yes ☐ No If answer is "yes," type of consolidation **UNITIZED**

If answer is "no," list the owners and tract descriptions which have actually been consolidated. (Use reverse side of this form if necessary.)

No allowable will be assigned to the well until all interests have been consolidated (by communitization, unitization, forced-pooling, or otherwise) or until a non-standard unit, eliminating such interests, has been approved by the Commission.

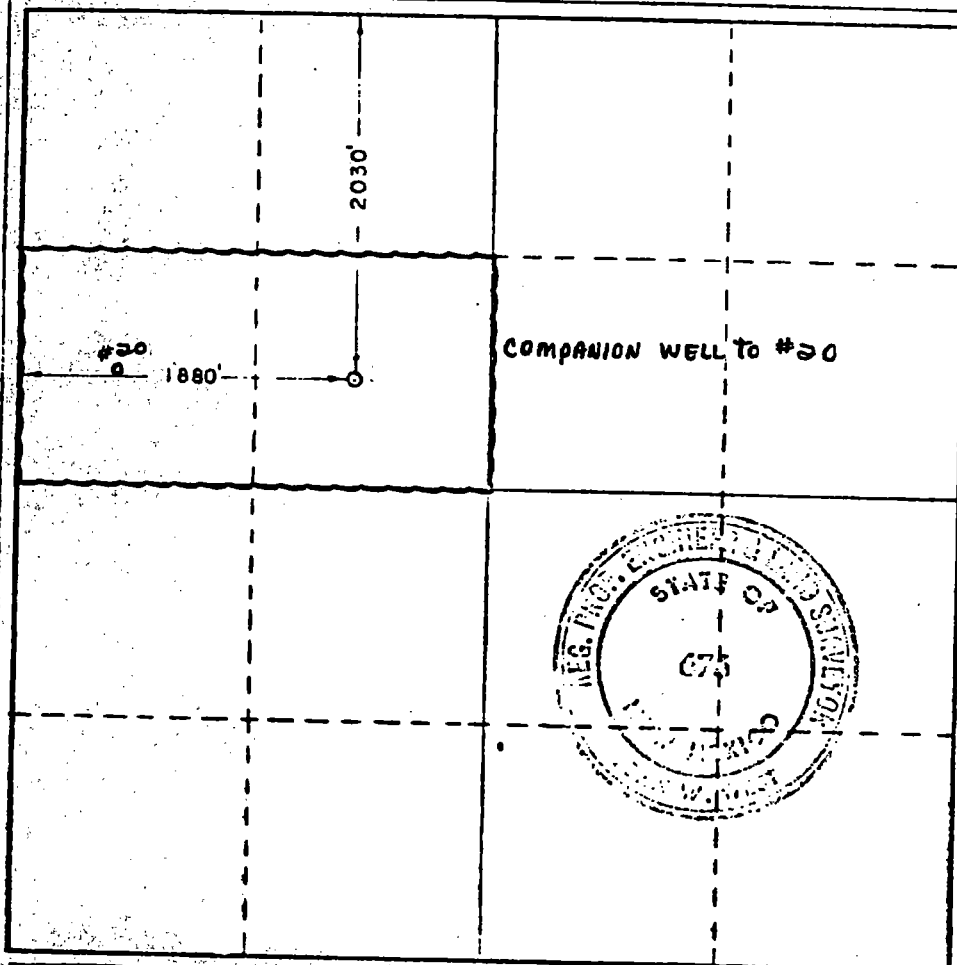

CERTIFICATION

I hereby certify that the information contained herein is true and complete to the best of my knowledge and belief.

Name: **Kenneth Brand**  
Position: **Senior Staff Assistant**  
Company: **Amoco Production Company**  
Date: **6-30-77**

I hereby certify that the well location shown on this plat was plotted from field notes of actual surveys made by me or under my supervision, and that the same is true and correct to the best of my knowledge and belief.

Date Surveyed:  
**June 9, 1977**  
Registered Professional Engineer  
and Land Surveyor

**John W. West**  
676

0 200 400 600 800 1000 1200 1400 1600 1800 2000 2200 2400 2600 2800 3000

NEW MEXICO OIL CONSERVATION COMMISSION  
WELL LOCATION AND ACREAGE DEDICATION PLAT

Supersedes 1-1-76  
File No. 1-1-76

All distances must be from the outer boundaries of the Section

Amoco Production Co.		South Mattix Unit		30
P	15	24 South	37 East	Leo
330	South	330	East	
3227.1	UPPER YESO	FOWLER UPPER YESO	80	

- Outline the acreage dedicated to the subject well by colored pencil or hatchure marks on the plat below.
- If more than one lease is dedicated to the well, outline each and identify the ownership thereof (both as to working interest and royalty)
- If more than one lease of different ownership is dedicated to the well, have the interests of all owners been consolidated by communitization, unitization, force-pooling, etc?

☐ Yes ☐ No If answer is "yes," type of consolidation \_\_\_\_\_

If answer is "no," list the owners and tract descriptions which have actually been consolidated (Use reverse side of this form if necessary.) \_\_\_\_\_

No allowable will be assigned to the well until all interests have been consolidated (by communitization, unitization, forced-pooling, or otherwise) or until a non-standard unit, eliminating such interests, has been approved by the Commission.

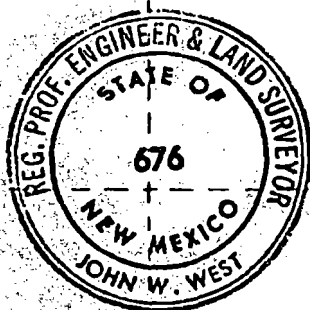
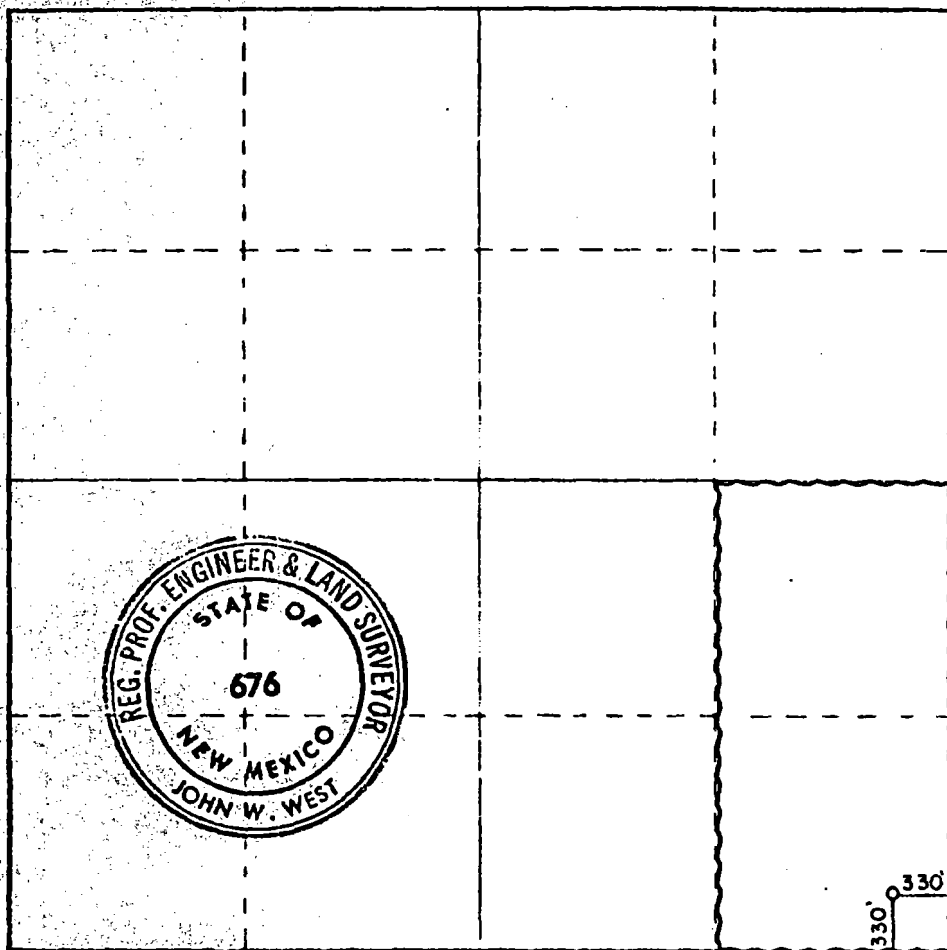

CERTIFICATION

I hereby certify that the information contained herein is true and complete to the best of my knowledge and belief.

*Ray W. Cox*  
Administrative Assistant

AMOCO PRODUCTION COMPANY

9-2 -77

I hereby certify that the well location shown on this plat was plotted from field notes of actual surveys made by me or under my supervision, and that the same is true and correct to the best of my knowledge and belief.

Date Surveyed:

August 16, 1977

Registered Professional Engineer and Land Surveyor

*John W. West*  
676

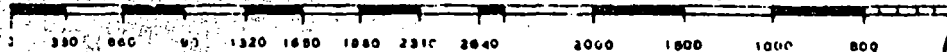

Submit to Appropriate  
District Office:  
State Lease - 4 copies  
Fee Lease - 3 copies

State of New Mexico  
Energy, Minerals and Natural Resources Department

Form C-182  
Revised 1-1-89

OIL CONSERVATION DIVISION

P.O. Box 2088  
Santa Fe, New Mexico 87504-2088

DISTRICT I  
P.O. Box 1980, Hobbs, NM 88240

DISTRICT II  
P.O. Drawer DD, Artesia, NM 88210

DISTRICT III  
1000 Rio Brazos Rd., Aztec, NM 87410

WELL LOCATION AND ACREAGE DEDICATION PLAT

All Distances must be from the outer boundaries of the section

Operator <b>Amoco Production Company</b>			Lease <b>South Mattix Unit</b>		Well No. <b>33</b>
Unit Letter <b>G</b>	Section <b>15</b>	Township <b>24-S</b>	Range <b>37-E</b>	County <b>NMPM</b>	<b>Lea, NM</b>
Actual Footage Location of Well: <b>1650'</b> feet from the <b>North</b> line and <b>1650'</b> feet from the <b>East</b> line					
Ground level Elev. <b>3245.7</b>	Producing Formation <b>Upper Yeso</b>		Pool <b>Fowler Upper Yeso</b>		Dedicated Acreage: <b>320 80</b> Acres

- Outline the acreage dedicated to the subject well by colored pencil or hatchure marks on the plat below.
- If more than one lease is dedicated to the well, outline each and identify the ownership thereof (both as to working interest and royalty).
- If more than one lease of different ownership is dedicated to the well, have the interest of all owners been consolidated by communitization, unitization, force-pooling, etc.?  
☐ Yes ☒ No If answer is "yes" type of consolidation \_\_\_\_\_  
If answer is "no" list the owners and tract descriptions which have actually been consolidated. (Use reverse side of this form if necessary.)  
No allowable will be assigned to the well until all interests have been consolidated (by communitization, unitization, forced-pooling, or otherwise) or until a non-standard unit, eliminating such interest, has been approved by the Division.

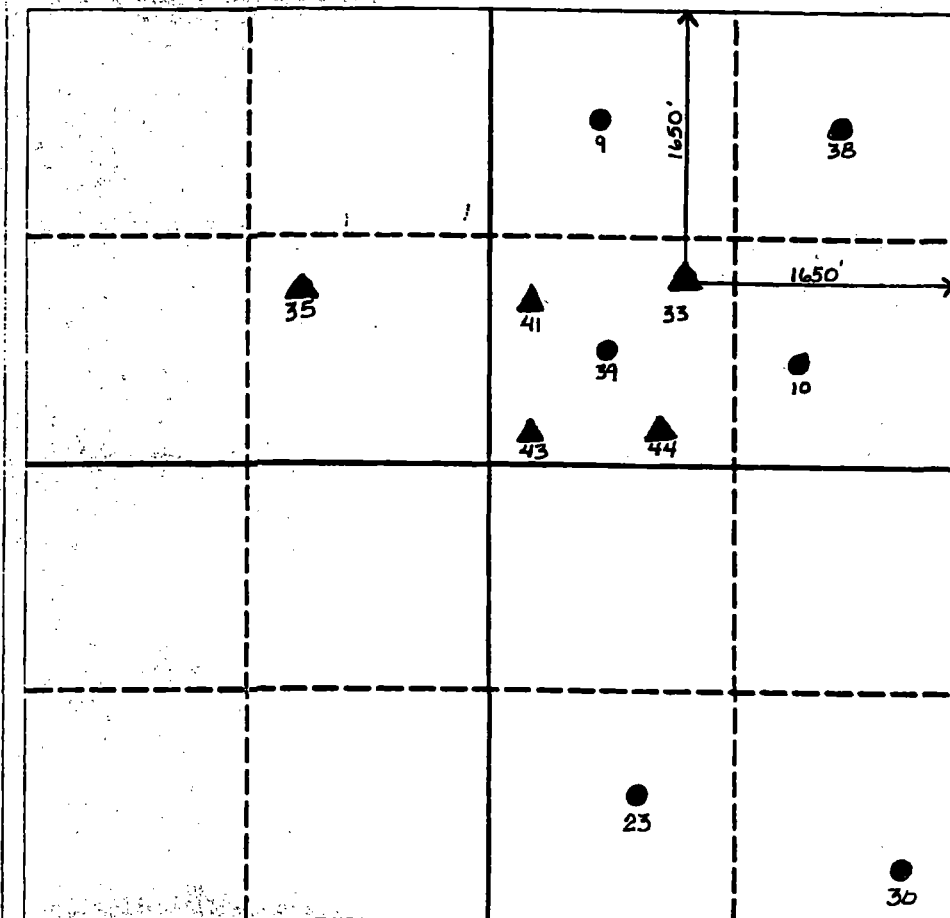

OPERATOR CERTIFICATION

I hereby certify that the information contained herein is true and complete to the best of my knowledge and belief.

Signature *Devina M. Prince*  
Printed Name **Devina M. Prince**  
Position **Staff Assistant**  
Company **Amoco Production Co.**  
Date **March 17, 1993**

SURVEYOR CERTIFICATION

I hereby certify that the well location shown on this plat was plotted from field notes of actual surveys made by me or under my supervision, and that the same is true and correct to the best of my knowledge and belief.

Date Surveyed

August 2, 1978

Registered Professional Engineer  
and/or Land Surveyor

*John W. West*  
Certificate No. **John W. West 676**  
**Donald J. Fiddis 9299**

NEW MEXICO OIL CONSERVATION COMMISSION  
WELL LOCATION AND ACREAGE DEDICATION PLAT

Form C-102  
Supersedes C-128  
Effective 1-1-65

All distances must be from the outer boundaries of the Section

Amoco Production Co.		Lease		South Mattix		Section	
15		24 South		37 East		Lea	
1840		South		660		East	
3230.9		Upper Yeso		Fowler Upper Yeso		80	

- Outline the acreage dedicated to the subject well by colored pencil or hatchure marks on the plat below.
- If more than one lease is dedicated to the well, outline each and identify the ownership thereof (both as to working interest and royalty).
- If more than one lease of different ownership is dedicated to the well, have the interests of all owners been consolidated by communitization, unitization, force-pooling, etc?

☒ Yes ☐ No If answer is "yes," type of consolidation Unitization

If answer is "no," list the owners and tract descriptions which have actually been consolidated (Use reverse side of this form if necessary.)

No allowable will be assigned to the well until all interests have been consolidated (by communitization, unitization, forced-pooling, or otherwise) or until a non-standard unit, eliminating such interests, has been approved by the Commission.

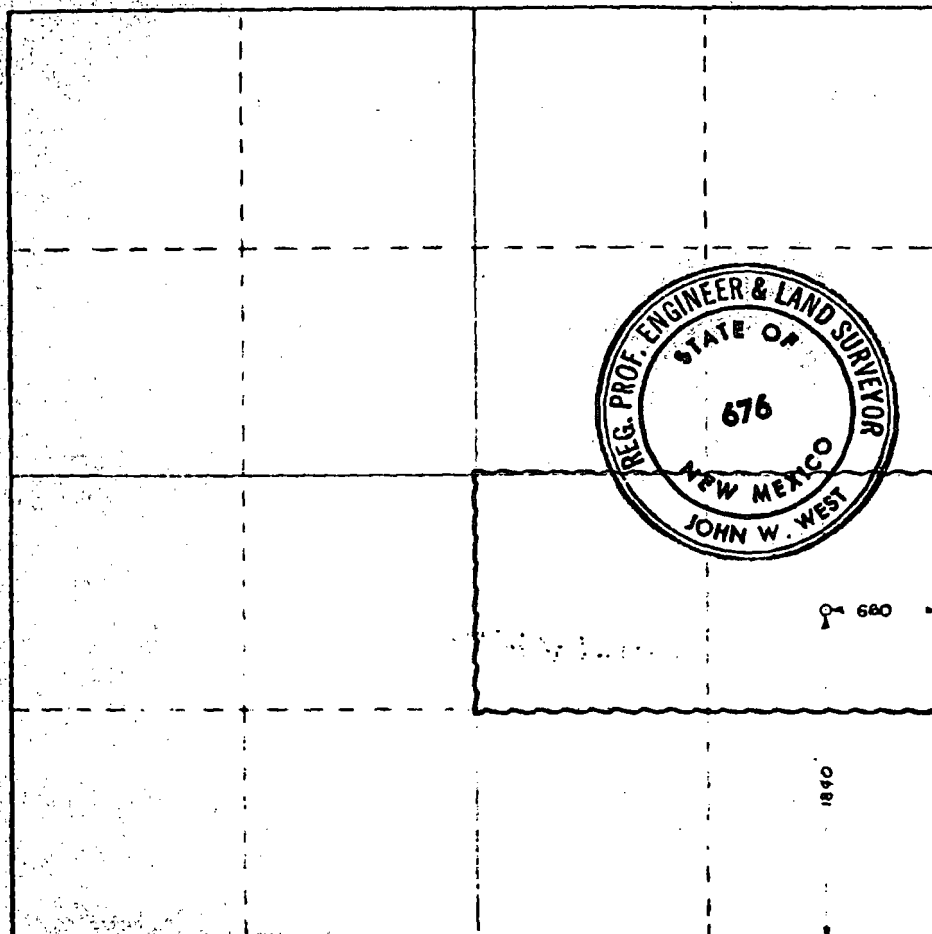

CERTIFICATION

I hereby certify that the information contained herein is true and complete to the best of my knowledge and belief.

*Randy Atkins*  
Position

Administrative Analyst

Company  
Amoco Production Company

Date  
May 8, 1979

I hereby certify that the well location shown on this plat was plotted from field notes of actual surveys made by me or under my supervision and that the same is true and correct to the best of my knowledge and belief.

Date  
May 1, 1979

Registered Professional Engineer  
and/or Land Surveyor

*John W. West*  
Signature

Certificate No. John W. West 676  
Ronald J. Eidson 3239

NEW MEXICO OIL CONSERVATION COMMISSION  
WELL LOCATION AND ACREAGE DEDICATION PLAT

Form C-102  
Supersedes C-128  
Effective 1-1-65

All distances must be from the outer boundaries of the Section

Operator <b>AMOCO PRODUCTION CO.</b>		Lease <b>South Mattix Unit</b>		Well No. <b>39</b>
Unit Letter <b>G</b>	Section <b>15</b>	Township <b>24 South</b>	Range <b>37 East</b>	County <b>Len</b>
Actual Footage Location of Well: <b>1890</b> feet from the <b>North</b> line and <b>2070</b> feet from the <b>East</b> line				
Ground Level Elev. <b>3243.1</b>	Producing Formation	Pool	Dedicated Acreage: Acres	

1. Outline the acreage dedicated to the subject well by colored pencil or hatchure marks on the plat below.
2. If more than one lease is dedicated to the well, outline each and identify the ownership thereof (both as to working interest and royalty).
3. If more than one lease of different ownership is dedicated to the well, have the interests of all owners been consolidated by communitization, unitization, force-pooling, etc?

☐ Yes ☐ No If answer is "yes," type of consolidation \_\_\_\_\_

If answer is "no," list the owners and tract descriptions which have actually been consolidated. (Use reverse side of this form if necessary.) \_\_\_\_\_

No allowable will be assigned to the well until all interests have been consolidated (by communitization, unitization, forced-pooling, or otherwise) or until a non-standard unit, eliminating such interests, has been approved by the Commission.

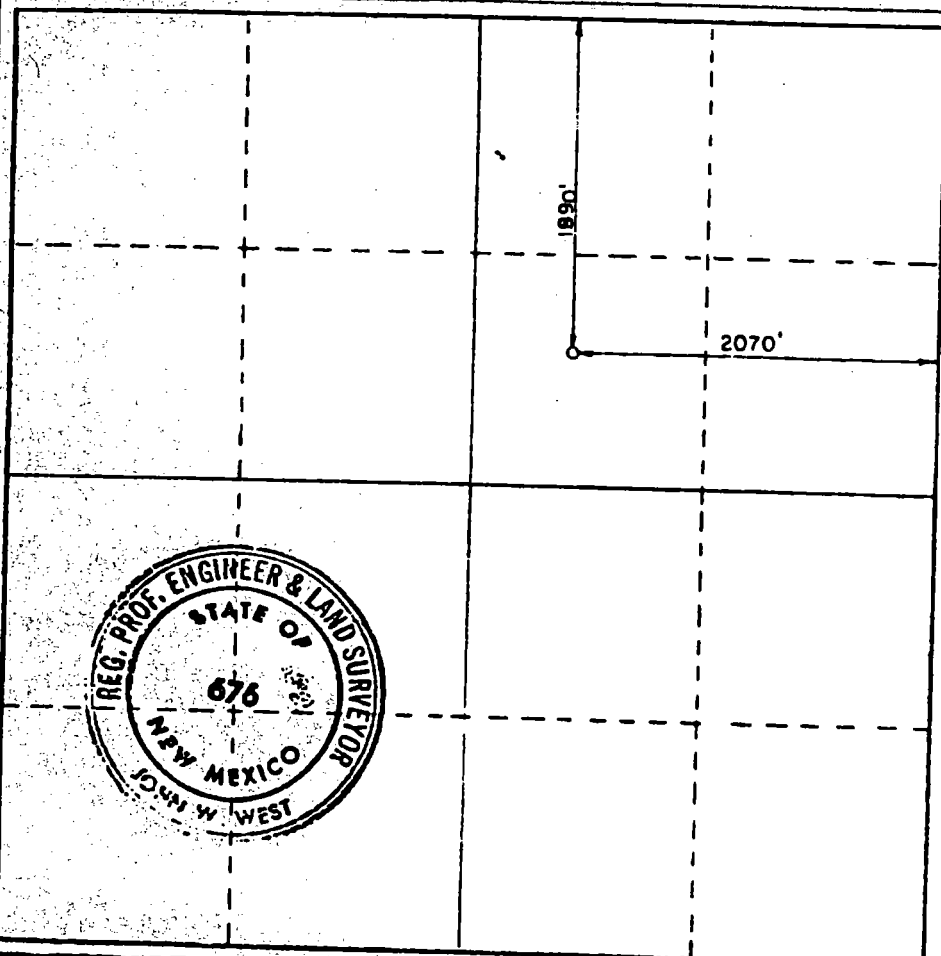

CERTIFICATION

I hereby certify that the information contained herein is true and complete to the best of my knowledge and belief.

Name

Position

Company

Date

I hereby certify that the well location shown on this plat was plotted from field notes of actual surveys made by me or under my supervision, and that the same is true and correct to the best of my knowledge and belief.

Date Surveyed

**October 18, 1979**

Registered Professional Engineer and Land Surveyor

Certification No. **John W. West**

**Ronald J. Eidsen 3239**

STATE OF NEW MEXICO  
ENERGY AND MINERALS DEPARTMENT

OIL CONSERVATION DIVISION

P. O. BOX 2088  
SANTA FE, NEW MEXICO 87501

Form C-102  
Revised 10-1-78

All distances must be from the outer boundaries of the Section.

Operator <b>Amoco Production Company</b>			Lease <b>South Mattix Unit Federal</b>		Well No. <b>40</b>
Unit Letter <b>K</b>	Section <b>15</b>	Township <b>24 South</b>	Range <b>37 East</b>	County <b>Lea</b>	
Actual Footage Location of Well:					
<b>2200</b> feet from the <b>West</b>		line and <b>2373</b>		feet from the <b>South</b> line	
Ground Level Elev. <b>3246.6</b>	Producing Formation <b>Lower Paddock</b>	Pool <b>Fowler (Upper Yeso)</b>		Dedicated Acreage <b>40 80</b>	Acreage

1. Outline the acreage dedicated to the subject well by colored pencil or hatchure marks on the plat below.
2. If more than one lease is dedicated to the well, outline each and identify the ownership thereof (both as to working interest and royalty).
3. If more than one lease of different ownership is dedicated to the well, have the interests of all owners been consolidated by communitization, unitization, force-pooling, etc?

☐ Yes ☐ No If answer is "yes," type of consolidation \_\_\_\_\_

If answer is "no," list the owners and tract descriptions which have actually been consolidated. (Use reverse side of this form if necessary.) \_\_\_\_\_

No allowable will be assigned to the well until all interests have been consolidated (by communitization, unitization, forced-pooling, or otherwise) or until a non-standard unit, eliminating such interests, has been approved by the Division.

CERTIFICATION

I hereby certify that the information contained herein is true and complete to the best of my knowledge and belief.

Name  
**Kim A. Colman**  
Position  
**Asst. Admin. Analyst**  
Company  
**Amoco Production Company**  
Date  
**10-14-91**

I hereby certify that the well location shown on this plat was plotted from field notes of actual surveys made by me or under my supervision, and that the same is true and correct to the best of my knowledge and belief.

**September 16, 1991**

Date Surveyed

Registered Land Surveyor  
**Larry A. Fisher**  
Larry A. Fisher

Certificate No.

**11013**

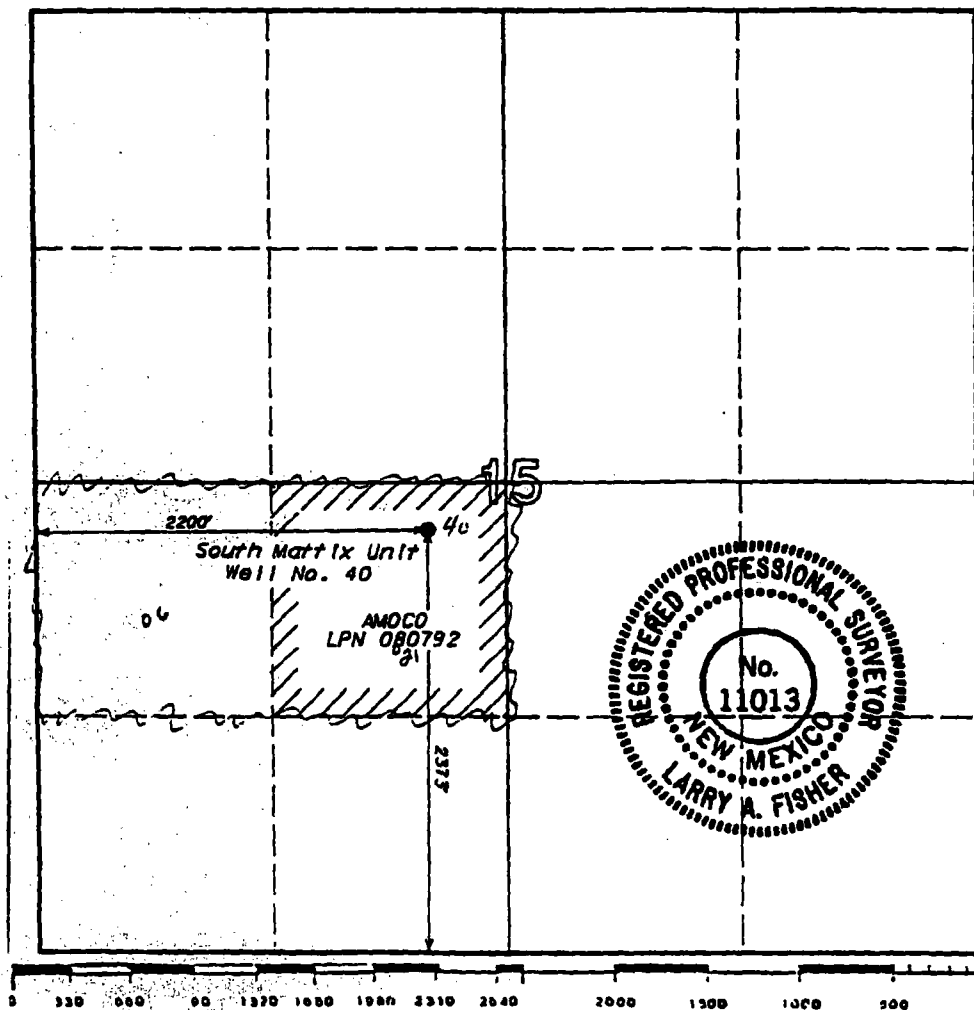

DISTRICT I  
1825 E. French Dr., Hobbs, NM 88240

DISTRICT II  
811 South First, Artesia, NM 88210

DISTRICT III  
1000 Rio Grande Rd., Artesia, NM 87410

DISTRICT IV  
2040 South Pacheco, Santa Fe, NM 87506

State of New Mexico  
Energy, Minerals and Natural Resources Department

Form C-102  
Revised March 17, 1999

Submit to Appropriate District Office  
State Lease - 4 Copies  
Fee Lease - 3 Copies

OIL CONSERVATION DIVISION

2040 South Pacheco  
Santa Fe, New Mexico 87504-2088

☐ AMENDED REPORT

WELL LOCATION AND ACREAGE DEDICATION PLAT

API Number 30-025-35292	Pool Code 26220	Pool Name Fowler Drinkard
Property Code 19582	Property Name SOUTH MATIX UNIT FEDERAL	Well Number 45
OGED No. 157984	Operator Name OCCIDENTAL PERMIAN LTD. PARTNERSHIP	Elevation 3238

Surface Location

UL or lot No. J	Section 15	Township 24 S	Range 37 E	Lot Idn	Feet from the 2005	North/South line SOUTH	Feet from the 1650	East/West line EAST	County LEA
--------------------	---------------	------------------	---------------	---------	-----------------------	---------------------------	-----------------------	------------------------	---------------

Bottom Hole Location If Different From Surface

UL or lot No.	Section	Township	Range	Lot Idn	Feet from the	North/South line	Feet from the	East/West line	County
Dedicated Acres 40	Joint or Infill N	Consolidation Code	Order No.						

NO ALLOWABLE WILL BE ASSIGNED TO THIS COMPLETION UNTIL ALL INTERESTS HAVE BEEN CONSOLIDATED  
OR A NON-STANDARD UNIT HAS BEEN APPROVED BY THE DIVISION

<p>OPL-SMUF-1 Fowler Ellnbrgr 3002511111</p>	<p>Lot - N32°12'56.5" Lon - W103°08'51.4"</p>	<p>46</p>	<p>3239.5 3235.6 3237.7 3235.2 685' 1004' 1850'</p>	<p>OPERATOR CERTIFICATION</p> <p>I hereby certify that the information contained herein is true and complete to the best of my knowledge and belief.</p> <p><i>David Stewart</i> Signature David Stewart Printed Name Regulatory Analyst Title e/e/00 Date</p>	
				<p>SURVEYOR CERTIFICATION</p> <p>I hereby certify that the well location shown on this plat was plotted from field notes of actual surveys made by me or under my supervision and that the same is true and correct to the best of my belief.</p> <p>DATE SURVEYED SIGNATURE PROFESSIONAL SURVEYOR No. 08964 7977 BASIN SURVEYS</p>	

OWNER NAME	TRACKING NUMBER
BALDWIN ROBERTSON FAMILY TRUST	7016 2140 0000 8665 1005
BLOCH,LEE DAWS	7016 2140 0000 8665 1012
BRILLE INSTITUTE OF AMERICA	7016 2140 0000 8665 1029
BYRON &,ROBERT P	7016 2140 0000 8665 1036
COX,NANCY MYERS	7016 2140 0000 8665 1043
DAWS,JOSEPH L	7016 2140 0000 8665 1050
DWYER,ANNE MYERS	7016 2140 0000 8665 1067
EASLEY FAMILY FUTURES LLC	7016 2140 0000 8665 1074
FDH,COMPANY LP	7016 2140 0000 8665 1081
FITTS,DAVID B	7016 2140 0000 8665 1098
FITTS,MICHAEL D	7016 2140 0000 8665 1104
FITTS,NANCY E	7016 2140 0000 8665 1111
HUGHES FAMILY,WARREN & MARYELLEN	7016 2140 0000 8665 1128
HUGHES,JEAN L	7016 2140 0000 8665 1135
JACK REVOCABLE TRUST,NANCY P	7016 2140 0000 8665 1142
LATADY JR,RICHARD D	7016 2140 0000 8665 1159
LATADY,CAMILLA H	7016 2140 0000 8665 1166
LATADY,CHARLES M	7016 2140 0000 8665 1173
LEE,VIRGINIA MITCHELL	7016 2140 0000 8665 1180
LOMA LINDA UNIV A CALIFORNIA COR	7016 2140 0000 8665 1197
MCKENZIE,DONALD C	7016 2140 0000 8665 1203
MESERVE TRUST,J ROBERT	7016 2140 0000 8665 1210
MESERVE FAMILY TRUST DTD 8-8-89	7016 2140 0000 8665 1227
MINERALS MANAGEMENT SERVICE	7016 2140 0000 8665 1234
MISSISSIPPI BAPTIST FDN	7016 2140 0000 8665 1241
MITCHELL,CHARLES SUMMERS	7016 2140 0000 8665 1258
MUMPER SEP PROP TRUST,KENNETH C	7016 2140 0000 8665 1265
MUMPER SEP PROP TRUST,WILLIAM H	7016 2140 0000 8665 1272
MUMPER,BRUCE N	7016 2140 0000 8665 1289
MYERS IV,CORTLAND	7016 2140 0000 8665 1296
MYERS JR,RICHARD HUGHES	7016 2140 0000 8665 1302
MYERS,SHIRLEY L	7016 2140 0000 8665 1319
MYERS,STEVEN D	7016 2140 0000 8665 1326
SHERRY-NEVADA OIL ROYALTY CO	7016 2140 0000 8665 1333
SILVERADO OIL & GAS LLP	7016 2140 0000 8665 1340
SIMPSON,LORAIN D	7016 2140 0000 8665 1357
SPINDLETOP EXPLORATION COMPANY INC	7016 2140 0000 8665 1364
WHITE STAR ENERGY INC	7016 2140 0000 8665 1371



WELL NAME	API No.
SOUTH MATTIX UNIT FEDERAL #2	30-025-11112
SOUTH MATTIX UNIT FEDERAL #3	30-025-11196
SOUTH MATTIX UNIT FEDERAL #6	30-025-11114
SOUTH MATTIX UNIT FEDERAL #12	30-025-11203
SOUTH MATTIX UNIT FEDERAL #13	30-025-11204
SOUTH MATTIX UNIT FEDERAL #20	30-025-21678
SOUTH MATTIX UNIT FEDERAL #22	30-025-21922
SOUTH MATTIX UNIT FEDERAL #27	30-025-25612
SOUTH MATTIX UNIT FEDERAL #40	30-025-31475
SOUTH MATTIX UNIT FEDERAL #9	30-025-11117
SOUTH MATTIX UNIT FEDERAL #10	30-025-11118
SOUTH MATTIX UNIT FEDERAL #30	30-025-25747
SOUTH MATTIX UNIT FEDERAL #33	30-025-26095
SOUTH MATTIX UNIT FEDERAL #24	30-025-22488
SOUTH MATTIX UNIT FEDERAL #37	30-025-26355
SOUTH MATTIX UNIT FEDERAL #39	30-025-26598
SOUTH MATTIX UNIT FEDERAL #45	30-025-35292
SOUTH MATTIX A FEDERAL #5	30-025-11201
SOUTH MATTIX UNIT FEDERAL #14	30-025-11110
SOUTH MATTIX UNIT FEDERAL #15	30-025-20513
SOUTH MATTIX UNIT FEDERAL #1	30-025-11111
SOUTH MATTIX UNIT FEDERAL #17	30-025-20298
SOUTH MATTIX UNIT FEDERAL #25	30-025-20298