



Texaco Exploration
and Production Inc.
Denver Region

3300 North Butler
Farmington, NM 87401
505 325-4397

DHC 12/8/98

2144

November 17, 1998

Mr. David Catanach
State of New Mexico
Oil Conservation Division
2040 S. Pacheco
Santa Fe, New Mexico 87505-6429

NOV 18 1998

RE: Downhole Commingle Application
C. W. Roberts #4
John Charles #6A

Please find enclosed applications to commingle downhole the subject wells.
The originals of the applications were incorrectly sent to the Aztec office.

Conservation with Ms. Kathy Valdez advised that the copies would be acceptable this time.

Please advise of any missing documents that should have been included.

Billy Bowen

Billy Bowen
Four Star Oil and Gas Company
(505) 325-4397 Ext. 14

Atchibeg
X 26

DISTRICT I

P.O. Box 1980, Hobbs, NM 88241-1980

DISTRICT II

811 South First St., Artesia, NM 88210-2835

DISTRICT III

1000 Rio Brazos Rd., Aztec, NM 87410

State of New Mexico
Energy, Minerals and Natural Resources Department

Form C-107-A

New 3-12-96

OIL CONSERVATION DIVISION

2040 S. Pacheco
Santa Fe, New Mexico 87505-6429

APPROVAL PROCESS:

☒ Administrative ☐ Hearing

EXISTING WELLBORE

☒ YES ☐ NO

APPLICATION FOR DOWNHOLE COMMINGLING

FOUR STAR OIL AND GAS COMPANY

3300 N. Butler Ave., Suite 100 Farmington

NM 87401

Operator

JOHN CHARLES

6A

I

Address

13

T27N

R09W

SAN JUAN

Lease

Well No.

Unit Ltr. - Sec - Twp - Rge

County

Spacing Unit Lease Types: (check 1 or more)

OGRID No. 131994

Property Code

011148

API No.

3004522660

Federal ☒State ☐(and/or) Fee ☐

| The following facts are submitted in support of downhole commingling: | Upper Zone | Intermediate Zone | Lower Zone |
|---|--|-------------------|---|
| 1. Pool Name and Pool Code | CHARCA | | MESA VERDE |
| 2. Top and Bottom of Pay Section (Perforations) | 2917-3121 | | 3700-4426 |
| 3. Type of Production (Oil or Gas) | GAS | | GAS |
| 4. Method of Production (Flowing or Artificial Lift) | FLOWING | | FLOWING |
| 5. Bottomhole Pressure Oil Zones - Artificial Lift: Estimated Current Gas Oil - Flowing: Measured Current All Gas Zones: Estimated Or Measured Original | a. (Current) 255 # SHUT IN SURF. b. (Original) | a. b. | a. 96 # SHUT IN SURF. b. |
| 6. Oil Gravity (*API) or Gas BTU Content | 1158 BTU | | 1324 BTU |
| 7. Producing or Shut-in? | PRODUCING | | PRODUCING |
| Production Marginal? (yes or no) | YES | | YES |
| * If Shut-in, give date and oil/gas/water rates of last production Note: For new zones with no production history applicant shall be required to attach production estimates and supporting data | Date: Rates: | Date: Rates: | Date: Rates: |
| * If Producing, give date and oil/gas/water rates of recent test (within 60 days) | Date: 6/28/98 Rates: 0/4/50 OIL/WTR/GA | Date: Rates: | Date: 5/31/98 Rates: 0/2/8 OIL/WTR/GA |
| 8. Fixed Percentage Allocation Formula - % for each zone | Oil: 0 % Gas: 86 % | Oil: % Gas: % | Oil: 0 % Gas: 14 % |

9. If allocation formula is based upon something other than current or past production, or is based on some other method, submit attachments with supporting data and/or explaining method and providing rate projections or other required data.

10. Are all working, overriding, and royalty interests identical in all commingled zones? ☒ Yes ☐ No
If not, have all working, overriding, and royalty interests been notified by certified mail? ☐ Yes ☐ No
Have all offset operators been given written notice of the proposed downhole commingling? ☒ Yes ☐ No11. Will cross-flow occur? ☐ Yes ☒ No If yes, are fluids compayable, will formations not be damaged, will any cross flowed production be recovered, and will the allocation formula be reliable. ☐ Yes ☐ No (If No, attach explanation)12. Are all produced fluids from all commingled zones compatible with each other ☒ Yes ☐ No13. Will the value of production be decreased by commingling? ☐ Yes ☒ No (If Yes, attach explanation)14. If this well is on, or communitized with, state or federal lands, either the Commissioner of Public Lands or the United States Bureau of Land Management has been notified in writing of this application ☒ Yes ☐ No

15. NMOCD Reference Cases for Rule 303(D) Exceptions: ORDER NO(S).

16. ATTACHMENTS:

- *C-102 for each zone to be commingled showing its spacing unit and acreage dedication.
- *Production curve for each zone for at least one year. (If not available, attach explanation.)
- *For zones with no production history, estimated production rates and supporting data.
- *Data to support allocation method or formula.
- *Notification list of all offset, operators.
- *Notification list of all working, overriding, and royalty interest for uncommon interest cases.
- *Any additional statements, data, or documents required to support commingling.

I hereby certify that the information above is true and complete to the best of my knowledge and belief.

Signature

Rached Hindi

Title

Senior Engineer

Date

9/25/98

TYPE OR PRINT NAME Rached Hindi

Telephone

325-4397

DISTRICT I

P.O. Box 1330, Hobbs, NM 88241-1980

DISTRICT II

P.O. Box Drawer DD, Artesia, NM 88211-0719

DISTRICT III

1000 Rio Brazos Rd., Aztec, NM 87410

DISTRICT IV

P.O. Box 2088, Santa Fe, NM 87504-2088

State of New Mexico

Energy, Minerals and Natural Resources Department

Form O-102

Revised February 10, 1999

Instructions on back

Submit to Appropriate District Office

State Lease - 4 Copies

Fee Lease - 3 Copies

☐ AMENDED REPORT

OIL CONSERVATION DIVISION

P.O. Box 2088

Santa Fe, New Mexico 87504-2088

WELL LOCATION AND ACREAGE DEDICATION PLAT

| | | |
|---------------------------------------|---|---|
| ¹ API Number 3004522660 | ² Pool Code 72319 | ³ Pool Name BLANCO MESAVERDE (PRORATED GAS) |
| ⁴ Property Code | ⁵ Property Name JOHN CHARLES | ⁶ Well No. 6A |
| ⁷ OGRID Number 131994 | ⁸ Operator Name FOUR STAR OIL AND GAS COMPANY | ⁹ Elevation |

¹⁰ Surface Location

| Ul or lot no | Section | Township | Range | Lot.Idn | Feet From The | North/South Line | Feet From The | East/West Line | County |
|--------------|---------|----------|-------|---------|---------------|------------------|---------------|----------------|----------|
| 1 | 13 | T27N | R09W | | 1850 | SOUTH | 840 | EAST | SAN JUAN |

¹¹ Bottom Hole Location If Different From Surface

| Ul or lot no. | Section | Township | Range | Lot.Idn | Feet From The | North/South Line | Feet From The | East/West Line | County |
|---------------|---------|----------|-------|---------|---------------|------------------|---------------|----------------|--------|
| | | | | | | | | | |

| | | | |
|-------------------------------------|-------------------------------------|----------------------------------|-------------------------|
| ¹² Dedicated Acre 320 | ¹³ Joint or Infill No | ¹⁴ Consolidation Code | ¹⁵ Order No. |
|-------------------------------------|-------------------------------------|----------------------------------|-------------------------|

NO ALLOWABLE WILL BE ASSIGNED TO THIS COMPLETION UNTIL ALL INTERESTS HAVE BEEN CONSOLIDATED
OR A NON-STANDARD UNIT HAS BEEN APPROVED BY THE DIVISION

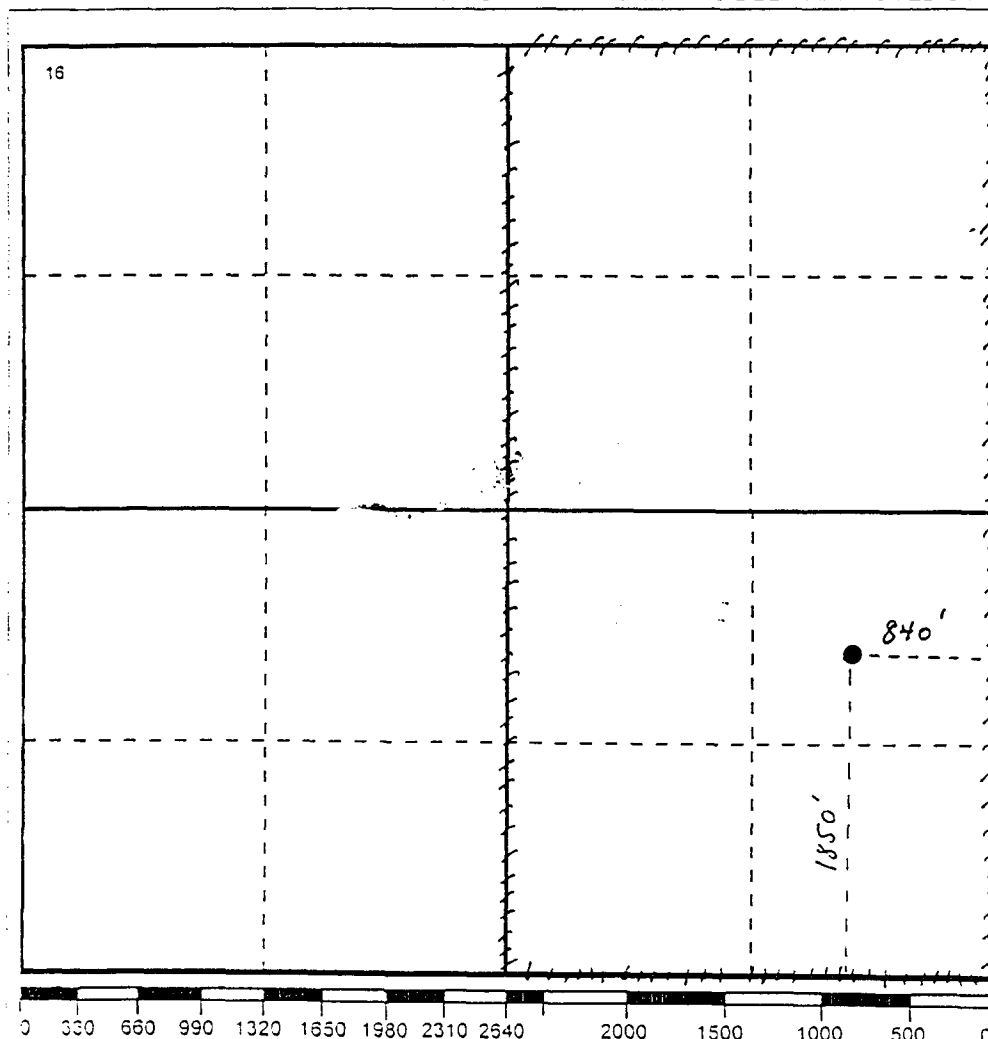
¹⁷ OPERATOR CERTIFICATION

I hereby certify that the information contained herein is true and complete to the best of my knowledge and belief

Signature

Printed Name

Rached Hindi

Positio

Senior Engineer

Date

9/25/98

¹⁸ SURVEYOR CERTIFICATION

I hereby certify that the well location shown on this plat was plotted from field notes of actual surveys made by me or under my supervision, and that the same is true and correct to the best of my knowledge and belief.

Date Surveyed

Signature & Seal of
Professional Surveyor

Certificate No.

DISTRICT II

P.O. Box Drawer DD, Artesia, NM 88211-0719

DISTRICT III

1000 Rio Brazos Rd., Aztec, NM 87410

DISTRICT IV

P.O. Box 2088, Santa Fe, NM 87504-2088

OIL CONSERVATION DIVISION

P.O. Box 2088

Santa Fe, New Mexico 87504-2088

Revised February 10, 1999

Instructions on back

Submit to Appropriate District Office

State Lease - 4 Copies

Fee Lease - 3 Copies

☐ AMENDED REPORT

WELL LOCATION AND ACREAGE DEDICATION PLAT

| | | |
|---------------------------------------|---|--|
| ¹ API Number 3004522660 | ² Pool Code 82329 | ³ Pool Name OTERO CHACRA (GAS) |
| ⁴ Property Code | ⁵ Property Name JOHN CHARLES | ⁶ Well No. 6A |
| ⁷ OGRID Number 131994 | ⁸ Operator Name FOUR STAR OIL AND GAS COMPANY | ⁹ Elevation |

¹⁰ Surface Location

| UI or lot no | Section | Township | Range | Lot.Idn | Feet From The | North/South Line | Feet From The | East/West Line | County |
|--------------|---------|----------|-------|---------|---------------|------------------|---------------|----------------|----------|
| 1 | 13 | T27N | R09W | | 1850 | SOUTH | 840 | EAST | SAN JUAN |

¹¹ Bottom Hole Location If Different From Surface

| UI or lot no. | Section | Township | Range | Lot.Idn | Feet From The | North/South Line | Feet From The | East/West Line | County |
|---------------|---------|----------|-------|---------|---------------|------------------|---------------|----------------|--------|
| | | | | | | | | | |

| | | | |
|-------------------------------------|-------------------------------------|----------------------------------|-------------------------|
| ¹² Dedicated Acre 180 | ¹³ Joint or Infill No | ¹⁴ Consolidation Code | ¹⁵ Order No. |
|-------------------------------------|-------------------------------------|----------------------------------|-------------------------|

NO ALLOWABLE WILL BE ASSIGNED TO THIS COMPLETION UNTIL ALL INTERESTS HAVE BEEN CONSOLIDATED
OR A NON-STANDARD UNIT HAS BEEN APPROVED BY THE DIVISION

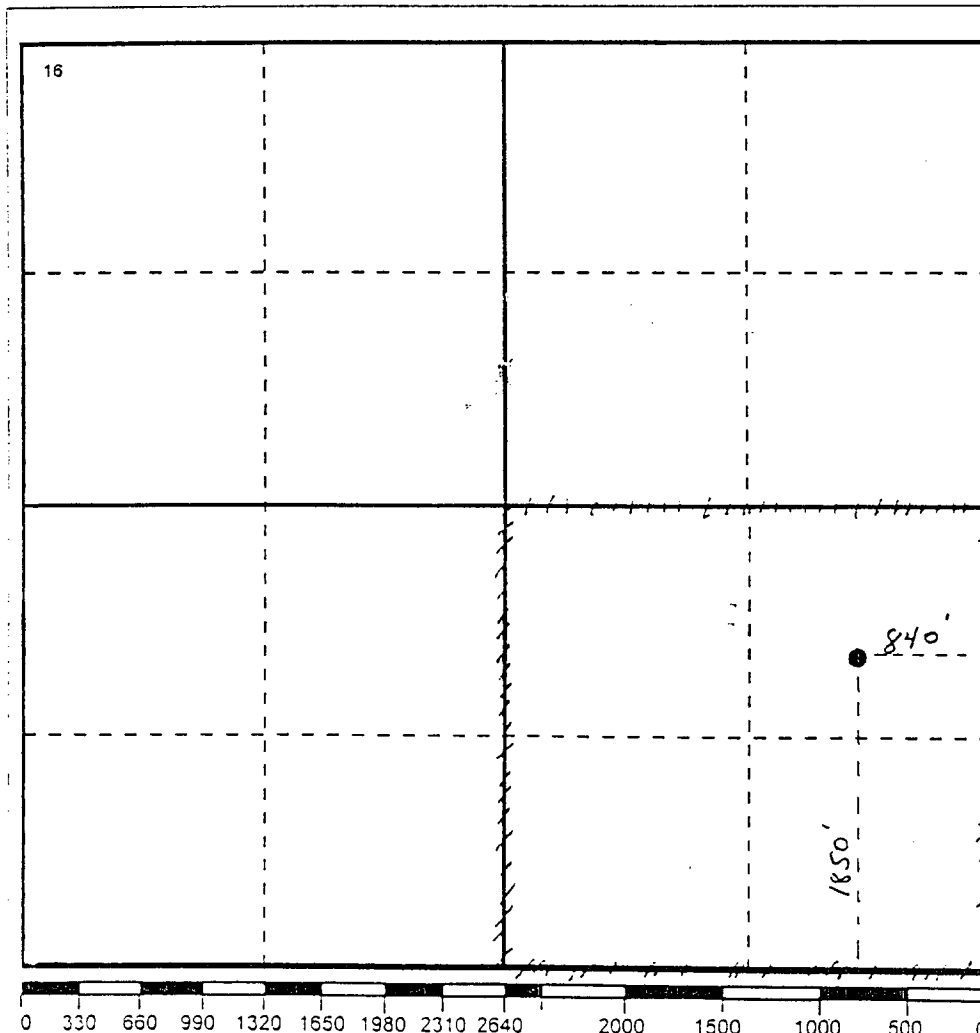

17 OPERATOR CERTIFICATION

I hereby certify that the information contained herein is true and complete to the best of my knowledge and belief

Signature

Rached Hindi

Printed Name

Rached Hindi

Position

Senior Engineer

Date

9/25/98

18 SURVEYOR CERTIFICATION

I hereby certify that the well location shown on this plat was plotted from field notes of actual surveys made by me or under my supervision, and that the same is true and correct to the best of my knowledge and belief.

Date Surveyed

Signature & Seal of

Professional Surveyor

Certificate No.

*OFFSET OPERATORS
FOR JOHN CHARLES #6A
T-27N, R-9W AND T-27N, R-8W
SAN JUAN COUNTY, NEW MEXICO*

- (1) All of Section 24-27N-9W (Mesaverde formation); W/2-Section 7-27N-8W (Mesaverde formation); W/2-Section 19-27N-8W (Mesaverde formation); NW/4-Section 19-27N-8W (Chacra formation); N/2-Section 24-27N-9W (Chacra formation)

Burlington Resources Oil & Gas Company
P. O. Box 4289
Farmington, NM 87499-4289

- (2) W/2-Section 18-27N-8W (Mesaverde formation); NW/4-Section 18-27N-8W (Chacra formation)

Amoco Production Company
P. O. Box 800
Denver, CO 80201

- (3) SW/4-Section 18-27N-8W (Chacra formation)

Gas:
Burlington Resources Oil & Gas Company
P. O. Box 4289
Farmington, NM 87499-4289

Oil:
50% -- Burlington Resources Oil & Gas Company
P. O. Box 4289
Denver, CO 87499-4289

50% -- Fina Oil & Chemical Co.
P. O. Box 2159
Dallas, TX 75221

- (4) All of Section 12-27N-9W (Mesaverde formation); All of Section 13-27N-9W (Chacra formation and Mesaverde formation)

Four Star Oil & Gas Company
P. O. Box 2100
Denver, CO 80201

LEASE NAME: CHARLES, JOHN
 TEX WELL NO: 6A
 CURR_LSE_NO: 017692

RSVR: CHACRA
 REG_FLD: 82329

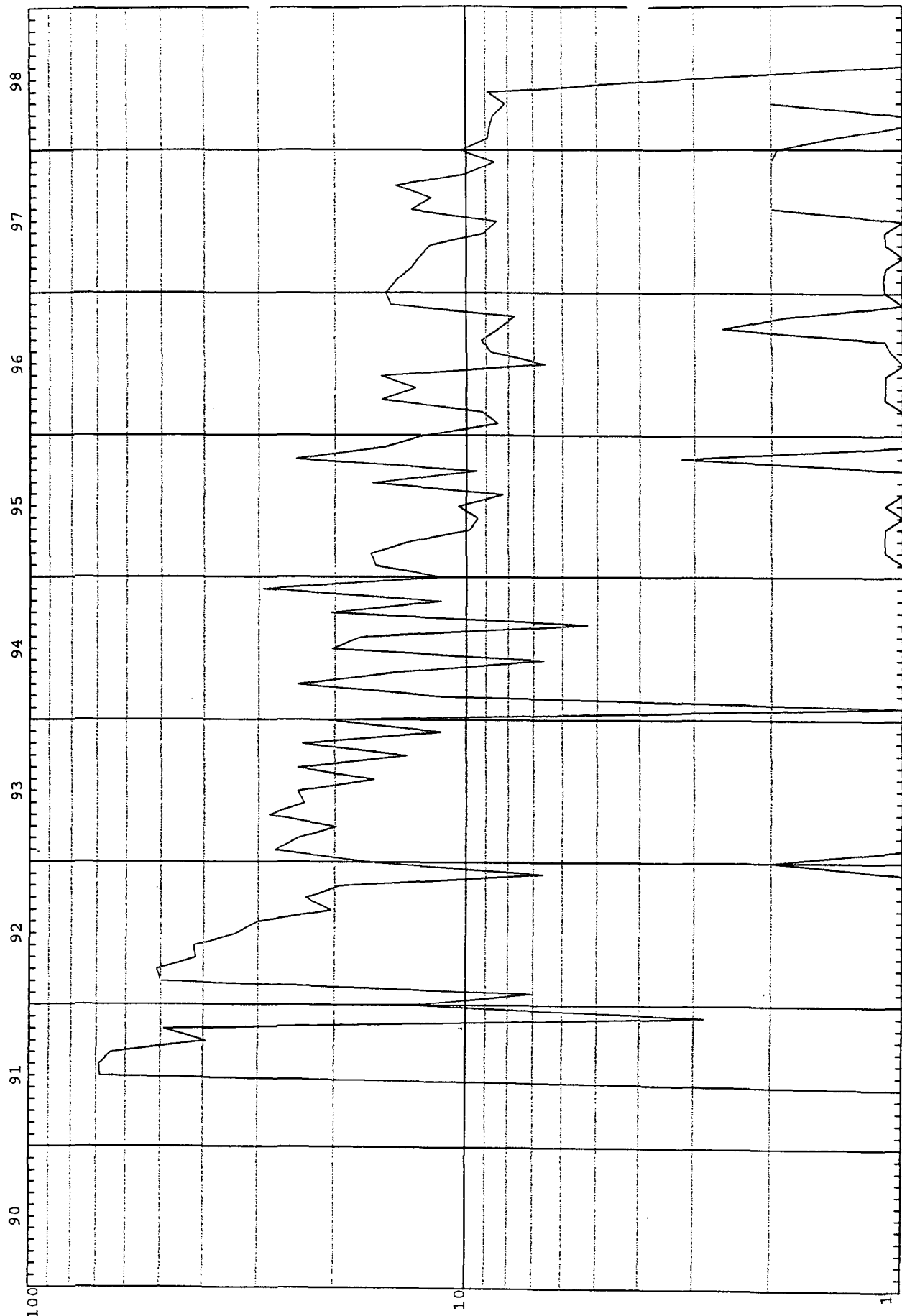

----- BOPD ----- MCFPD ----- BWPD ----- AVG INJ PRES / 1
 CURRENT CUMS: OIL: 0 bbl GAS: 47,636 mcf WTR: 1,579 bbl WINJ: 0 bbl

D A I L Y R A T E

LEASE NAME: CHARLES, JOHN RSVR: MV
 TEX WELL NO: 6A REG_FLD: 72319
 CURR_LSE_NO: 017692

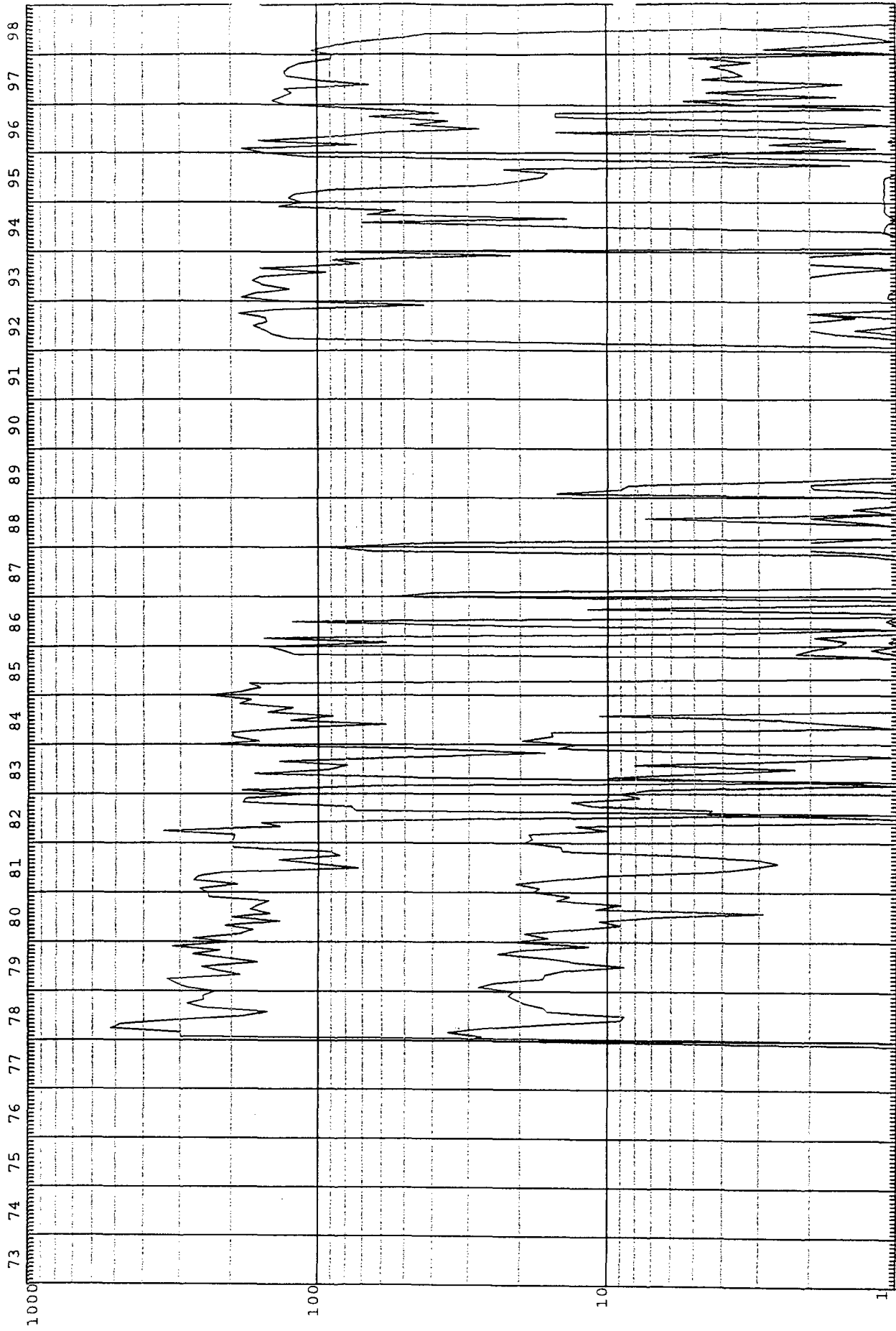

D
A
I
L
Y
R
A
T
E

----- BOPD ----- MCFPD ----- BWPD ----- AVG INJ PRES / 1
 CURRENT CUMS: OIL: 31,600 bbl GAS: 724,671 mcf WTR: 6,523 bbl WINJ: 0 bbl

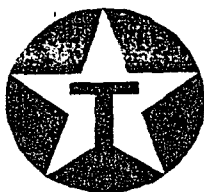

7/9/98

JOHN CHARLES No. 6A

PROPOSED COMMINGLE

LOCATION:

1850' FSL & 840' FEL
NE/SE, Sec. 13, T27N, R9W
San Juan County

ELEVATION: 5988' DF
5976' GR

SPUD DATE: 9-22-77

FORMATION TOPS:

Mesa Verde 3584'
Pt. Lookout 4214'

CHACRA PERFS:

| | | |
|-----------|-----------|-------------|
| 2917'-20' | 2949'-52' | 3080'-84' |
| 2925'-28' | 2954'-57' | 3099'-3102' |
| 2933'-37' | 2978'-88' | 3112'-21' |
| 2943'-45' | 3006'-09' | |

94 Shots w/ 2 SPF

MESA VERDE PERFS:

3700, 3710, 3802, 3812, 3932, 3942, 3990,
3998, 4080, 4085, 4150, 4159, 4180, 4186
14 Shots w/ 1 SPF

4283'-97', 4302'-33', 4342'-54', 4360'-79', 4382'-86', 4422'-26'
168 Shots w/ 2 SPF

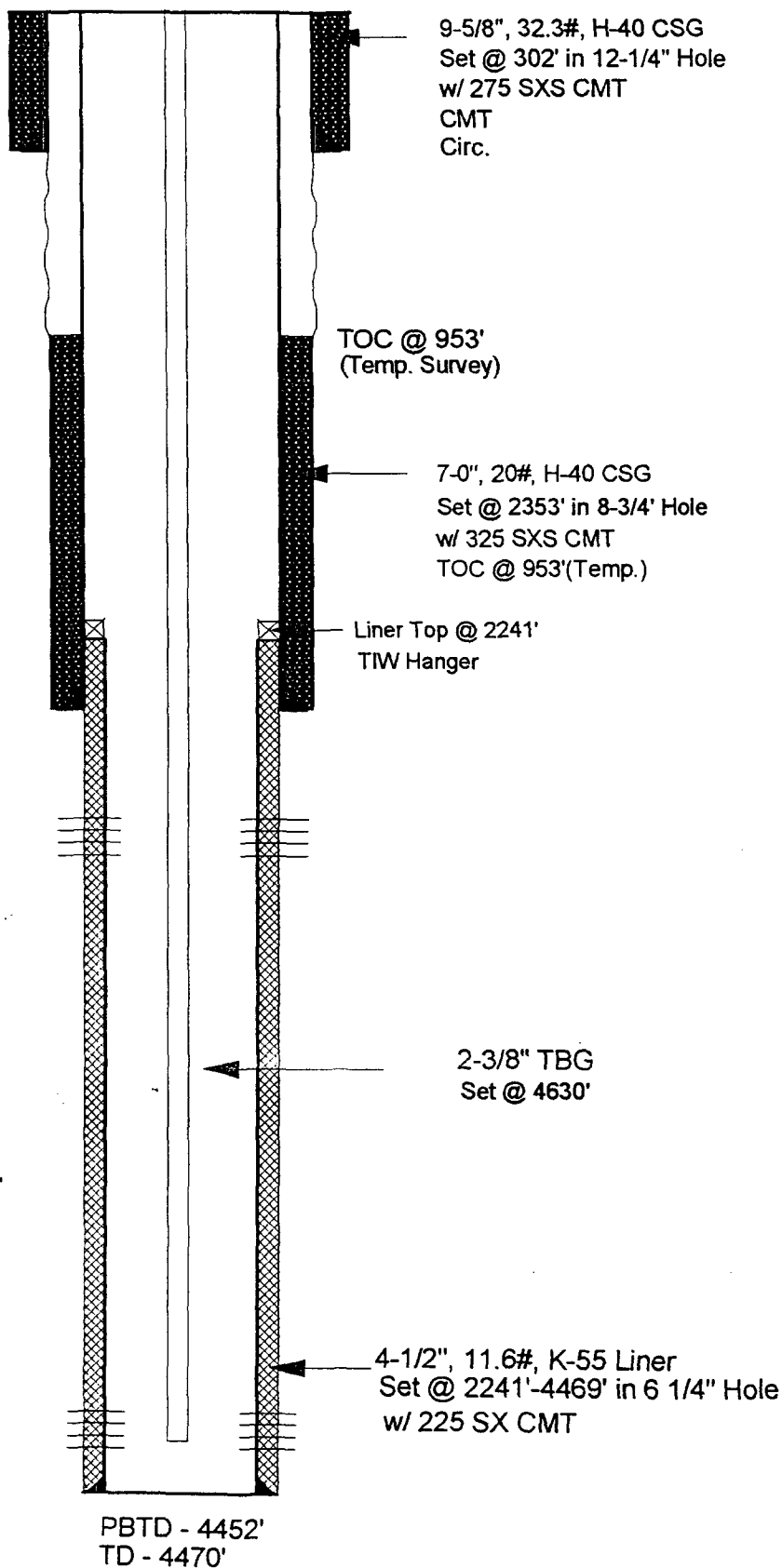



JOHN CHARLES No. 6A

CURRENT COMPLETION

LOCATION:

1850' FSL & 840' FEL
NE/SE, Sec. 13, T27N, R9W
San Juan County

ELEVATION: 5988' DF
5976' GR

SPUD DATE: 9-22-77

FORMATION TOPS:

Mesa Verde 3584'
Pt. Lookout 4214'

2205' of 2-1/16" TBG
887' of 1-0" TBG
Set @ 3092'

CHACRA PERFS:

| | | |
|-----------|-----------|-------------|
| 2917'-20' | 2949'-52' | 3080'-84' |
| 2925'-28' | 2954'-57' | 3099'-3102' |
| 2933'-37' | 2978'-88' | 3112'-21' |
| 2943'-45' | 3006'-09' | |

w/ 2 JSPF, 94 Holes, Total 47'

11-02-90 Acidized Chacra w/ 2500 gals 15% HCl
Frac w/ 43,000# gals Gelled water &
44,000# 20-40 Brady Sand

11-28-90 Tested for 3 Hrs at Daily rate 667 MCF
CAOF of 816 MCF

MESA VERDE PERFS:

3700, 3710, 3802, 3812, 3932, 3942, 3990,
3998, 4080, 4085, 4150, 4159, 4180, 4186'
(14 Shots) 1 SPF

| | |
|-------------------------|-------------------------|
| 4283'-97' (28 sh) 2 SPF | 4360'-79' (38 sh) 2 SPF |
| 4302'-33' (62 sh) 2 SPF | 4382'-86' (8 sh) 2 SPF |
| 4342'-54' (24 sh) 2 SPF | 4422'-26' (8 sh) 2 SPF |

11-15-90 (3700'-4426')

Acidized w/ 2500 gals 15% HCl

11-27-77 (4283'-4426', Pt. Lookout)

Acidized w/ 500 gals 15% HCl

Frac w/ 80,000 gals slick water &
40,000# 20-40 & 30,000# 10-20 Sand

11-04-77 (3700'-4186', Menefee)

Acid w/ 500 gals 15% HCl

Frac w/ 80,000 gals slick water &
80,000# 20-40 Sand

11-18-77 Tested IP @ 661 MCF (5288 MCFPD 24 hrs)

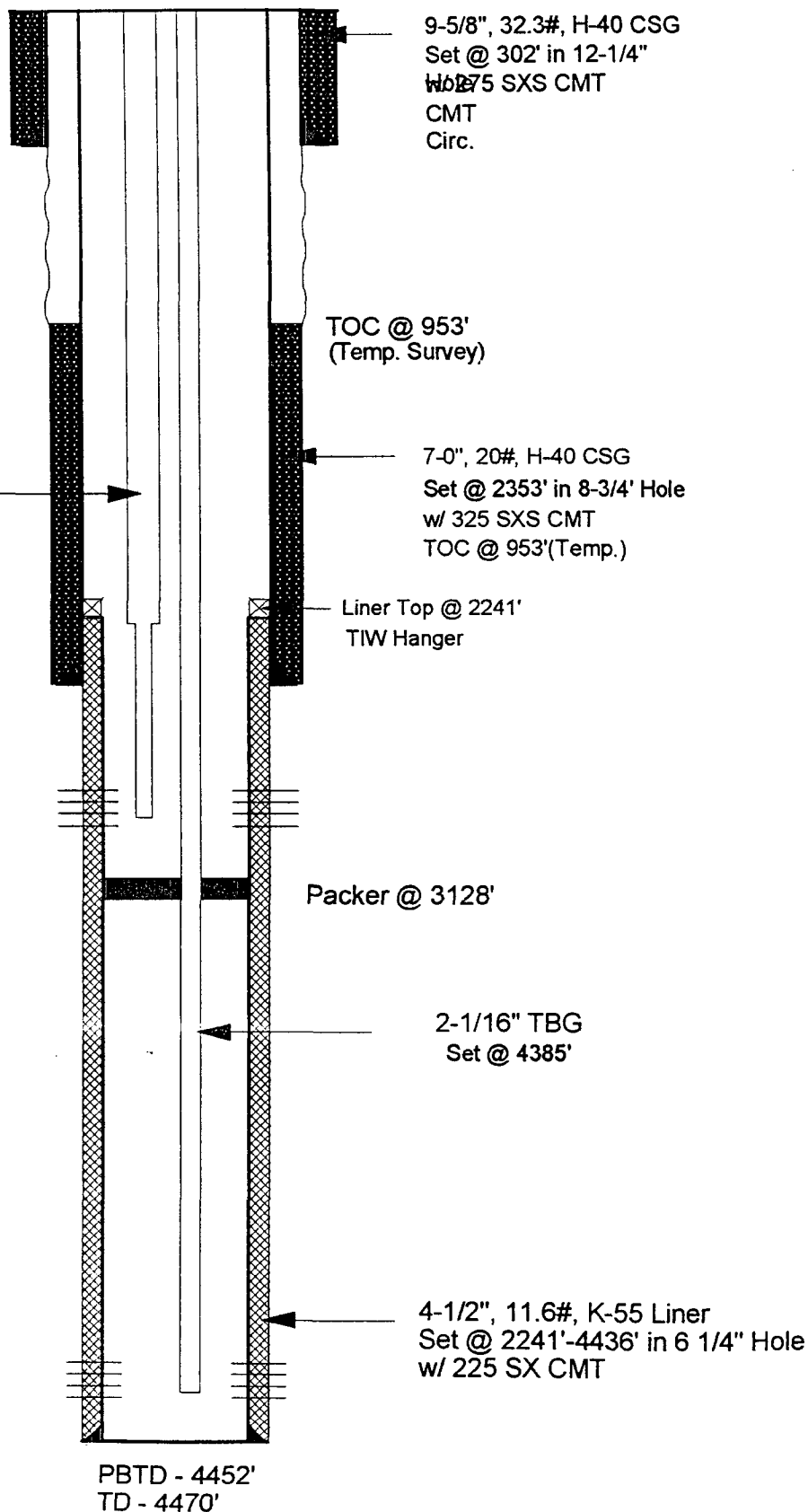

UNITED STATES
DEPARTMENT OF THE INTERIOR
BUREAU OF LAND MANAGEMENT

FORM APPROVED
Budget Bureau No. 1004-0135
Expires: March 31, 1993

SUNDRY NOTICES AND REPORTS ON WELLS

Do not use this form for proposals to drill or to deepen or reentry to a different reservoir.

Use "APPLICATION FOR PERMIT --" for such proposals

5. Lease Designation and Serial No.

I-149-IND-8466

6. If Indian, Alottee or Tribe Name

NAVAJO

7. If Unit or CA, Agreement Designation

SUBMIT IN TRIPLICATE

1. Type of Well: ☐ OIL WELL ☒ GAS WELL ☐ OTHER

2. Name of Operator
FOUR STAR OIL AND GAS COMPANY

3. Address and Telephone No.
3300 N. Butler Ave., Suite 100 Farmington NM 87401 325-4397

4. Location of Well (Footage, Sec., T., R., M., or Survey Description)
Unit Letter I : 1850 Feet From The SOUTH Line and 840 Feet From The
EAST Line Section 13 Township T27N Range R09W

8. Well Name and Number
JOHN CHARLES

6A

9. API Well No.
3004522660

10. Field and Pool, Exploratory Area
BLANCO MESAVERDE/DHC OTERO CHACRA

11. County or Parish, State
SAN JUAN, NM

12. Check Appropriate Box(s) To Indicate Nature of Notice, Report, or Other Data

TYPE OF SUBMISSION

TYPE OF ACTION

- ☒ Notice of Intent
☐ Subsequent Report
☐ Final Abandonment Notice

- ☐ Abandonment
☐ Recompletion
☐ Plugging Back
☐ Casing Repair
☐ Altering Casing
☒ OTHER: COMMINGLE

- ☐ Change of Plans
☐ New Construction
☐ Non-Routine Fracturing
☐ Water Shut-Off
☐ Conversion to Injection
☐ Dispose Water

(Note: Report results of multiple completion on Well Completion or Recompletion Report and Log Form.)

13. Describe Proposed or Completed Operations (Clearly state all pertinent details, and give pertinent dates, including estimated date of starting any proposed work. If well is directionally drilled, give subsurface locations and measured and true vertical depths for all markers and zones pertinent to this work.)*

FOUR STAR OIL & GAS CO. PROPOSES THE FOLLOWING ON THE SUBJECT WELL.

FOUR STAR OIL & GAS CO. REQUEST APPROVAL TO COMMINGLE THE CHARCA AND MESA VERDE FORMATIONS IN THE SUBJECT WELL, PLEASE REFER TO THE ATTACHED WELLBORE DIAGRAM FOR WELLBORE DETAILS.

CHARCA
2917-3121' PERFS.
GAS PRODUCTION
1158 BTU
0 OIL 4 WTR 50 GAS

MESA VERDE
3700-4426' PERFS.
GAS PRODUCTION
1324 BTU
0 OIL 2 WTR 8 GAS

THE WELL IS DUALY COMPLETED AND PRODUCTION HAS DECREASED DUE TO FLUID LOADING. IT IS UNECONOMICAL AND NOT MECHANILLY FEASIBLE TO ARTIFICALLY PUMP UNDER THE CURRENT WELLBORE COMPLETION. TO RECOVER THE REMAINING RESERVES THE WELL REQUIRES COMMINGLING AND ARTIFICIALLY PUMPED TO REMOVE FLUIDS.

FOR INFORMATION ONLY

14. I hereby certify that the foregoing is true and correct

SIGNATURE Rached Hindi TITLE Senior Engineer

DATE 9/25/98

TYPE OR PRINT NAME Rached Hindi

(This space for Federal or State office use)

APPROVED

CONDITIONS OF APPROVAL, IF ANY: _____ TITLE _____ DATE _____

Title 18 U.S.C. Section 1001, makes it a crime for any person knowingly and willfully to make to any department or agency of the United States any false, fictitious or fraudulent statements or representations as to any matter within its jurisdiction.



Texaco Exploration
and Production Inc.
Denver Region

3300 North Butler
Farmington, NM 87401
505 325-4397

September 25, 1998

Fina Oil & Chemical Co.
P.O. 2159
Dallas, TX 75221

RE: Commingling Application
John Charles #6A
Sec. 13-27N-9W
San Juan County, New Mexico

This letter is to advise your company, that Four Star Oil and Gas Co. has applied for commingling approval of subject well per the attached BLM report.

Billy Bowen



Texaco Exploration
and Production Inc.
Denver Region

3300 North Butler
Farmington, NM 87401
505 325-4397

September 25, 1998

Amoco Production Company
P.O. Box 800
Denver, CO 80201

RE: Commingling Application
John Charles #6A
Sec. 13-27N-9W
San Juan County, New Mexico

This letter is to advise your company, that Four Star Oil and Gas Co. has applied for commingling approval of subject well per the attached BLM report.

Billy Bowen



Texaco Exploration
and Production Inc.
Denver Region

3300 North Butler
Farmington, NM 87401
505 325-4397

September 25, 1998

Burlington Resources Oil & Gas Company
P.O. Box 4289
Farmington, NM 87499-4289

RE: Commingling Application
John Charles #6A
Sec. 13-27N-9W
San Juan County, New Mexico

This letter is to advise your company, that Four Star Oil and Gas Co. has applied for commingling approval of subject well per the attached BLM report.

Billy Bowen

Is your RETURN ADDRESS completed on the reverse side?

- Complete items 1 and/or 2 for additional services.
- Complete items 3, 4a, and 4b.
- Print your name and address on the reverse of this form so that we can return this card to you.
- Attach this form to the front of the mailpiece, or on the back if space does not permit.
- Write "Return Receipt Requested" on the mailpiece below the article number.
- The Return Receipt will show to whom the article was delivered and the date delivered.

I also wish to receive the following services (for an extra fee):

1. ☐ Addressee's Address
2. ☐ Restricted Delivery

Consult postmaster for fee.

3. Article Addressed to:

Fina Oil + Chemical Co.
PO Box 2159
Dallas, TX 75221

4a. Article Number

P160088773

4b. Service Type

- ☐ Registered ☒ Certified
☐ Express Mail ☐ Insured
☐ Return Receipt for Merchandise ☐ COD

7. Date of Delivery

SEP 30 1998

5. Received By: (Print Name)

6. Signature: (Addressee or Agent)

X

8. Addressee's Address (Only if requested and fee is paid)

PS Form 3811, December 1994

Domestic Return Receipt

Thank you for using Return Receipt Service.

Is your RETURN ADDRESS completed on the reverse side?

SENDER:

- Complete items 1 and/or 2 for additional services.
- Complete items 3, 4a, and 4b.
- Print your name and address on the reverse of this form so that we can return this card to you.
- Attach this form to the front of the mailpiece, or on the back if space does not permit.
- Write "Return Receipt Requested" on the mailpiece below the article number.
- The Return Receipt will show to whom the article was delivered and the date delivered.

I also wish to receive the following services (for an extra fee):

1. ☐ Addressee's Address
2. ☐ Restricted Delivery

Consult postmaster for fee.

3. Article Addressed to:

Burlington Resources Oil
+ Gas Company
P.O. Box 4289
Farmington, NM 87499-4289

4a. Article Number

P160088775

4b. Service Type

- ☐ Registered ☒ Certified
☐ Express Mail ☐ Insured
☐ Return Receipt for Merchandise ☐ COD

7. Date of Delivery

9-28-98

5. Received By: (Print Name)

Michelle Roberts

6. Signature: (Addressee or Agent)

X

8. Addressee's Address (Only if requested and fee is paid)

PS Form 3811, December 1994

Domestic Return Receipt

Thank you for using Return Receipt Service.

Is your RETURN ADDRESS completed on the reverse side?

SENDER:

- Complete items 1 and/or 2 for additional services.
- Complete items 3, 4a, and 4b.
- Print your name and address on the reverse of this form so that we can return this card to you.
- Attach this form to the front of the mailpiece, or on the back if space does not permit.
- Write "Return Receipt Requested" on the mailpiece below the article number.
- The Return Receipt will show to whom the article was delivered and the date delivered.

I also wish to receive the following services (for an extra fee):

1. ☐ Addressee's Address
2. ☐ Restricted Delivery

Consult postmaster for fee.

3. Article Addressed to:

Amoco Production Company
PO Box 800
Denver, CO 80201

4a. Article Number

P160088774

4b. Service Type

- ☐ Registered ☒ Certified
☐ Express Mail ☐ Insured
☐ Return Receipt for Merchandise ☐ COD

7. Date of Delivery

9-28-98

5. Received By: (Print Name)

6. Signature: (Addressee or Agent)

X

8. Addressee's Address (Only if requested and fee is paid)

PS Form 3811, December 1994

Domestic Return Receipt

Thank you for using Return Receipt Service.