

Revised March 23, 2017

RECEIVED: 12/11/2017	REVIEWER: MAM	TYPE: OLM	APP NO: pmAm1734559852
----------------------	---------------	-----------	------------------------

ABOVE THIS TABLE FOR OCD DIVISION USE ONLY

**NEW MEXICO OIL CONSERVATION DIVISION**  
- Geological & Engineering Bureau -  
1220 South St. Francis Drive, Santa Fe, NM 87505



### ADMINISTRATIVE APPLICATION CHECKLIST

THIS CHECKLIST IS MANDATORY FOR ALL ADMINISTRATIVE APPLICATIONS FOR EXCEPTIONS TO DIVISION RULES AND REGULATIONS WHICH REQUIRE PROCESSING AT THE DIVISION LEVEL IN SANTA FE

**Applicant:** COG Operating, LLC

**OGRID Number:** 229137

**Well Name:** Viking Helmet State Com #1H

**API:** 30-025-42782

430-025-42783

**Pool:** WC-025 G-09 S243532M; Wolfbone

**Pool Code:** 98098

### SUBMIT ACCURATE AND COMPLETE INFORMATION REQUIRED TO PROCESS THE TYPE OF APPLICATION INDICATED BELOW

#### 1) TYPE OF APPLICATION: Check those which apply for [A]

A. Location - Spacing Unit - Simultaneous Dedication

☐ NSL

☐ NSP (PROJECT AREA)

☐ NSP (PRORATION UNIT)

☐ SD

B. Check one only for [I] or [II]

[I] Completion - Storage - Measurement

☐ DHC ☐ CTB ☐ PLC ☐ PC ☐ OLS ☒ OLM

[II] Injection - Disposal - Pressure Increase - Enhanced Oil Recovery

☐ WEX ☐ PMX ☐ SWD ☐ IPI ☐ EOR ☐ PPR

#### 2) NOTIFICATION REQUIRED TO: Check those which apply.

A. ☒ Offset operators or lease holders

B. ☐ Royalty, overriding royalty owners, revenue owners

C. ☐ Application requires published notice

D. ☒ Notification and/or concurrent approval by SLO

E. ☐ Notification and/or concurrent approval by BLM

F. ☐ Surface owner

G. ☐ For all of the above, proof of notification or publication is attached, and/or,

H. ☐ No notice required

#### 3) CERTIFICATION: I hereby certify that the information submitted with this application for administrative approval is **accurate** and **complete** to the best of my knowledge. I also understand that **no action** will be taken on this application until the required information and notifications are submitted to the Division.

**Note:** Statement must be completed by an individual with managerial and/or supervisory capacity.

Bobbie J. Goodloe

Print or Type Name

Signature

December 11, 2017

Date

575-748-6952

Phone Number

bgoodloe@concho.com

e-mail Address

2017 DEC 11

RECEIVED

FOR OCD ONLY

☐ Notice Complete

☐ Application Content Complete



RECEIVED OOD

2017 DEC 27 P 3: 11

December 11, 2017

Attn: Michael McMillan  
NM Oil Conservation Division  
1220 South Saint Francis Drive  
Santa Fe, New Mexico 87505

Re: Application for Administrative Approval  
Off-lease Measurement – Oil Only

Dear Mr. McMillan,

COG Operating, LLC, respectfully requests approval for Off-lease Measurement for oil only for the following wells:

Viking Helmet State Com #1H  
API #30-025-42782  
WC-025 G-06 S243532M; Wolfbone  
SHL 190' FNL 380' FEL, Sec. 29-T24S-R35E  
BHL 2290' FNL 419' FEL, Sec. 32-T24S-R35E  
Lea County

Viking Helmet State Com #2H  
API #30-025-42783  
WC-025 G-06 S243532M; Wolfbone  
SHL 190' FNL 1980' FEL, Sec. 29-T24S-R35E  
BHL 2290' FNL 1959' FEL, Sec. 32-T24S-R35E  
Lea County

The oil production from this well may be transported by truck to the Red Hills Offload Station, located in Unit O, Section 4-T26S-R32E, Lea County, in the event the CTB on lease is over capacity or in the case of battery or pipeline repairs. Oil will remain segregated and will be measured by lact meter when offloading at the Red Hills Station. Notices have been sent to all interest owners as required.

Also, please see the attached Administrative Application Checklist, plats for referenced well, proof of notice to interest owners, diagrams of site facility, map with lease boundaries showing wells and facility locations and a copy of the letter to the New Mexico State Land Office.

Thank you for your attention to this matter.

Sincerely,

Bobbie Goodloe  
Regulatory Analyst

Enclosures

CORPORATE ADDRESS

ONE CONCHO CENTER | 600 WEST ILLINOIS AVENUE | MIDLAND, TEXAS 79701  
P432.683.7443 | F432.683.7441

ARTESIA WEST OFFICE

2208 MAIN STREET | ARTESIA, NEW MEXICO 88210  
P575.748.6940 | F575.746.2096

DISTRICT I  
1625 N. FRENCH DR., HOBBS, NM 88240  
Phone: (575) 393-6161 Fax: (575) 393-0720

DISTRICT II  
811 S. FIRST ST., ARTESIA, NM 88210  
Phone: (575) 748-1283 Fax: (575) 748-9720

DISTRICT III  
1000 RIO BRAZOS RD., AZTEC, NM 87410  
Phone: (505) 334-8178 Fax: (505) 334-8170

DISTRICT IV  
1220 S. ST. FRANCIS DR., SANTA FE, NM 87505  
Phone: (505) 476-3460 Fax: (505) 476-3462

State of New Mexico  
Energy, Minerals & Natural Resources Department  
**OIL CONSERVATION DIVISION**  
1220 SOUTH ST. FRANCIS DR.  
Santa Fe, New Mexico 87505

Form C-102  
Revised August 1, 2011  
Submit one copy to appropriate  
District Office

☐ AMENDED REPORT

**WELL LOCATION AND ACREAGE DEDICATION PLAT**

API Number 30-025-42782	Pool Code 98098	Pool Name WC-025 G-09 S243532M; Wolfbone
Property Code 315251	Property Name VIKING HELMET STATE COM	Well Number 1H
OGRID No. 229137	Operator Name COG OPERATING, LLC	Elevation 3309.1'

**Surface Location**

UL or lot No.	Section	Township	Range	Lot Idn	Feet from the	North/South line	Feet from the	East/West line	County
A	29	24-S	35-E		190	NORTH	380	EAST	LEA

**Bottom Hole Location If Different From Surface**

UL or lot No.	Section	Township	Range	Lot Idn	Feet from the	North/South line	Feet from the	East/West line	County
H	32	24-S	35-E		2290	NORTH	419	EAST	LEA

Dedicated Acres 240	Joint or Infill	Consolidation Code	Order No.
------------------------	-----------------	--------------------	-----------

NO ALLOWABLE WILL BE ASSIGNED TO THIS COMPLETION UNTIL ALL INTERESTS HAVE BEEN CONSOLIDATED  
OR A NON-STANDARD UNIT HAS BEEN APPROVED BY THE DIVISION

SEE PAGE 2

Property Code 315251	Property Name VIKING HELMET STATE COM	Well Number 1H
OGRID No. 229137	Operator Name COG OPERATING, LLC	Elevation 3309.1'

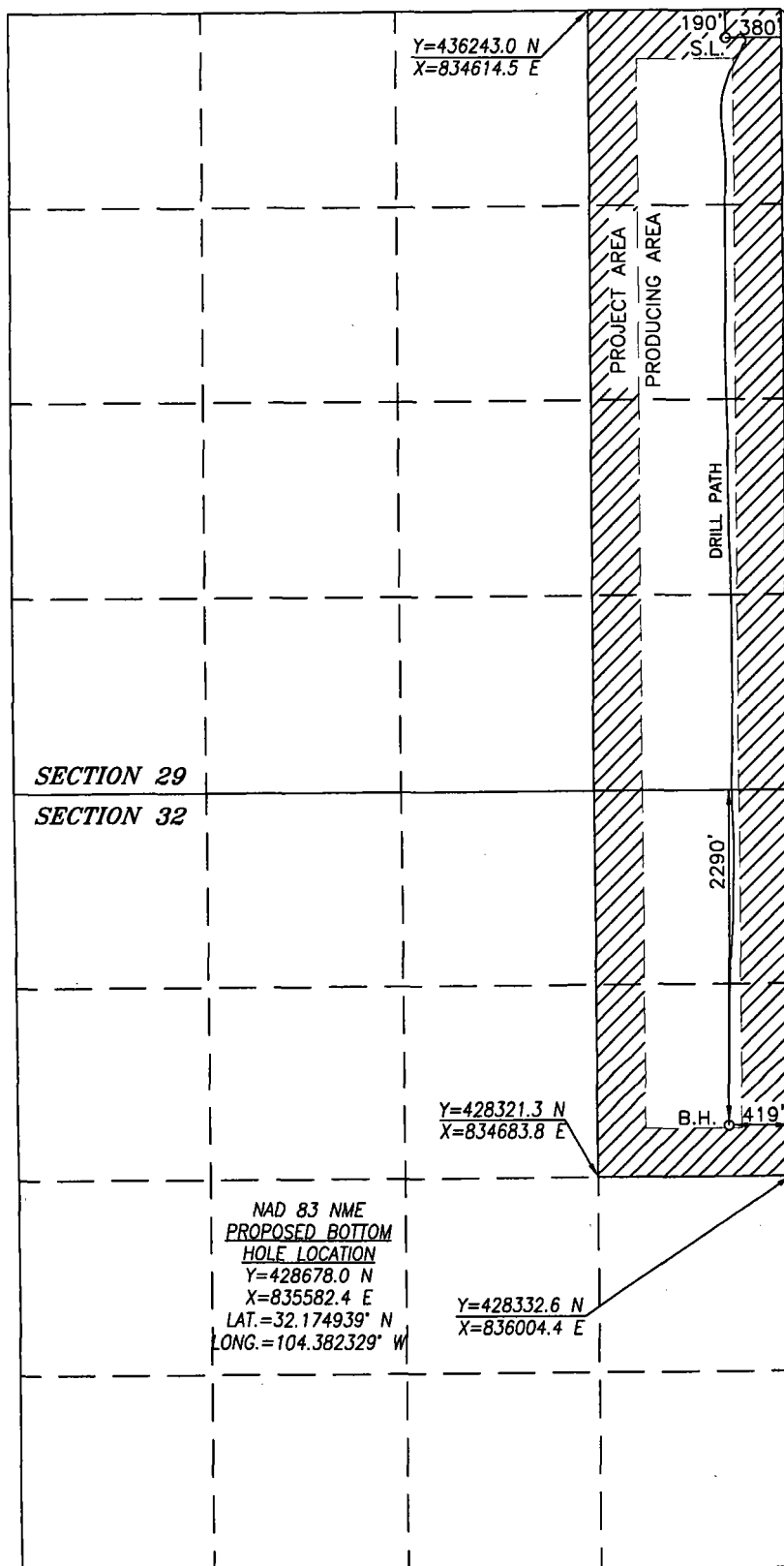

NAD 83 NME  
SURFACE LOCATION  
Y=436061.3 N  
X=835558.7 E  
LAT.=32.195233° N  
LONG.=104.382196° W

BOREPATH SHOWN HEREON IS BASED ON  
DIRECTIONAL SURVEY REPORT PROVIDED BY  
COG OPERATING, LLC FOR THE VIKING HELMET  
STATE COM #1H SUPPLIED TO HARCROW  
SURVEYING, LLC ON JUNE 8, 2017.

1200 0 1200  
SCALE: 1"=1200'

#### OPERATOR CERTIFICATION

I hereby certify that the information herein is true and complete to the best of my knowledge and belief, and that this organization either owns a working interest or unleased mineral interest in the land including the proposed bottom hole location or has a right to drill this well at this location pursuant to a contract with an owner of such mineral or working interest, or to a voluntary pooling agreement or a compulsory pooling order heretofore entered by the division.

*Bobbie J Goodloe* 11-17  
Signature Date

Bobbie J Goodloe

Printed Name

bgoodloe@concho.com

E-mail Address

#### SURVEYOR CERTIFICATION

I hereby certify that the well location shown on this plat was plotted from field notes of actual surveys made by me or under my supervision, and that the same is true and correct to the best of my belief.

APRIL 4, 2017

Date of Survey/Date of Geographic Survey

Signature & Seal of Professional Surveyor



*Chad Harcrow* 6/14/17  
Certificate No. CHAD HARCROW 17777

DISTRICT I  
1635 N. FRENCH DR., HOBBS, NM 88240  
Phone: (575) 393-8181 Fax: (575) 393-0720

DISTRICT II  
811 S. FIRST ST., ARTESIA, NM 88210  
Phone: (575) 748-1283 Fax: (575) 748-9720

DISTRICT III  
1000 RIO BRAZOS RD., AZTEC, NM 87410  
Phone: (505) 334-8178 Fax: (505) 334-6170

DISTRICT IV  
1220 S. ST. FRANCIS DR., SANTA FE, NM 87505  
Phone: (505) 476-3480 Fax: (505) 476-3482

State of New Mexico  
Energy, Minerals & Natural Resources Department  
**OIL CONSERVATION DIVISION**  
1220 SOUTH ST. FRANCIS DR.  
Santa Fe, New Mexico 87505

Form C-102  
Revised August 1, 2011  
Submit one copy to appropriate  
District Office

☐ AMENDED REPORT

**WELL LOCATION AND ACREAGE DEDICATION PLAT**

API Number <b>30-025-42783</b>	Pool Code <b>98098</b>	Pool Name <b>WC-025 G-09 S243532M; Wolfbone</b>
Property Code <b>315251</b>	Property Name <b>VIKING HELMET STATE COM</b>	Well Number <b>2H</b>
OGRID No. <b>229137</b>	Operator Name <b>COG OPERATING, LLC</b>	Elevation <b>3320.4'</b>

**Surface Location**

UL or lot No.	Section	Township	Range	Lot Idn	Feet from the	North/South line	Feet from the	East/West line	County
B	29	24-S	35-E		190	NORTH	1980	EAST	LEA

**Bottom Hole Location If Different From Surface**

UL or lot No.	Section	Township	Range	Lot Idn	Feet from the	North/South line	Feet from the	East/West line	County
G	32	24-S	35-E		2290	NORTH	1959	EAST	LEA

Dedicated Acres <b>240</b>	Joint or Infill	Consolidation Code	Order No.
-------------------------------	-----------------	--------------------	-----------

NO ALLOWABLE WILL BE ASSIGNED TO THIS COMPLETION UNTIL ALL INTERESTS HAVE BEEN CONSOLIDATED  
OR A NON-STANDARD UNIT HAS BEEN APPROVED BY THE DIVISION

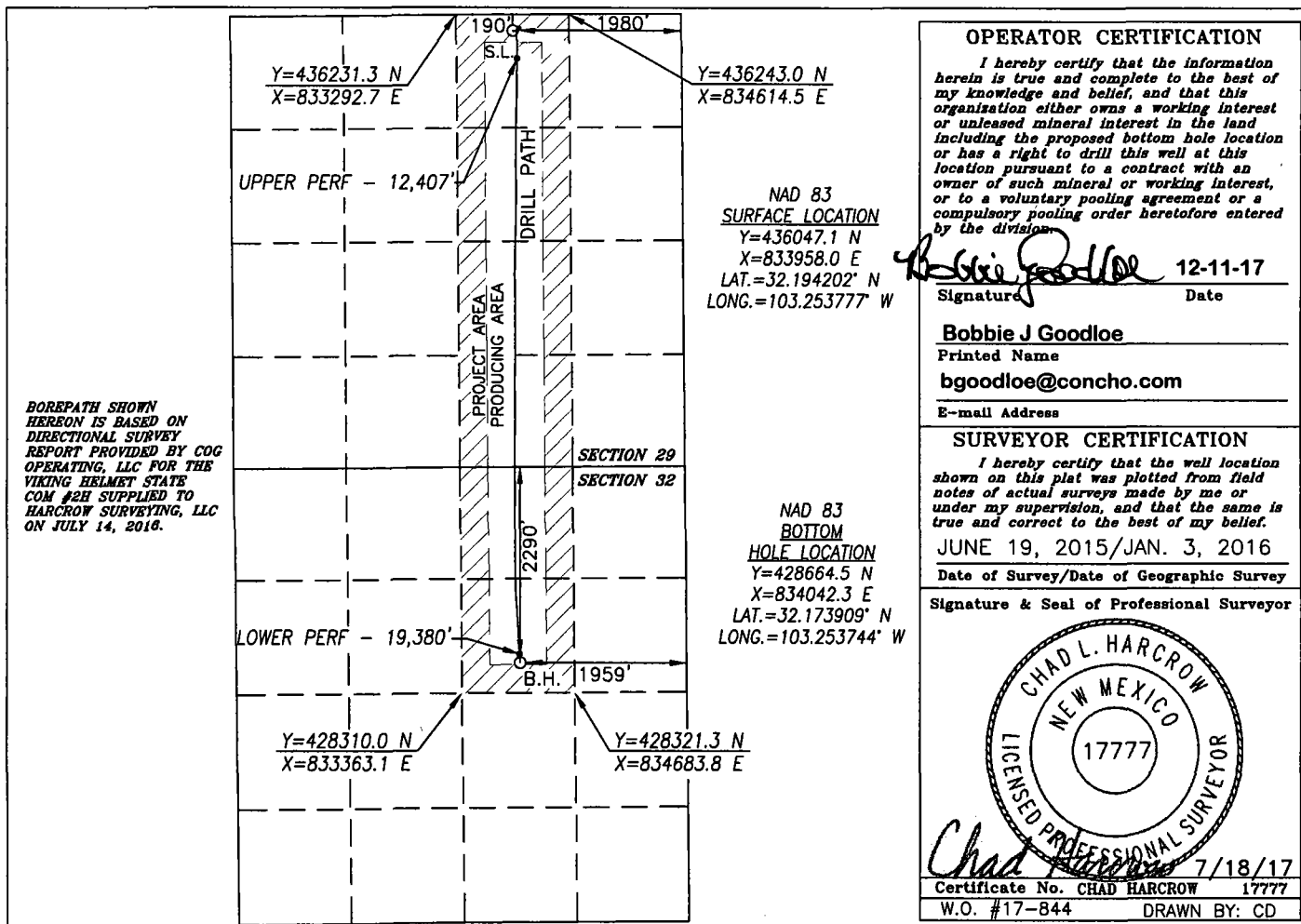

**VIKING HELMET STATE COM 2H BATTERY**  
NWNE SECTION 29, T24S, R35E, UNIT B  
LEA COUNTY, NM

**WELLS:**  
VIKING HELMET STATE COM #001H: 30-025-42782  
VIKING HELMET STATE COM #002H: 30-025-42783

**Production Phase - Oil Tank #1**

- Valve 1 open
- Valves 2, 3, and 4 closed
- Valves 5, 6, 7, and 8 open
- Valves 9, 10, 11, and 12 closed
- Valve 13 open
- Valves 14, 15, and 16 closed

**Sales Phase - Oil Tank #1**

- Valve 1 closed
- Valves 2, 3, and 4 open
- Valve 5 closed
- Valves 6, 7, and 8 open
- Valve 9 open
- Valves 10, 11, and 12 closed
- Valve 13 closed
- Valves 14, 15, or 16 open

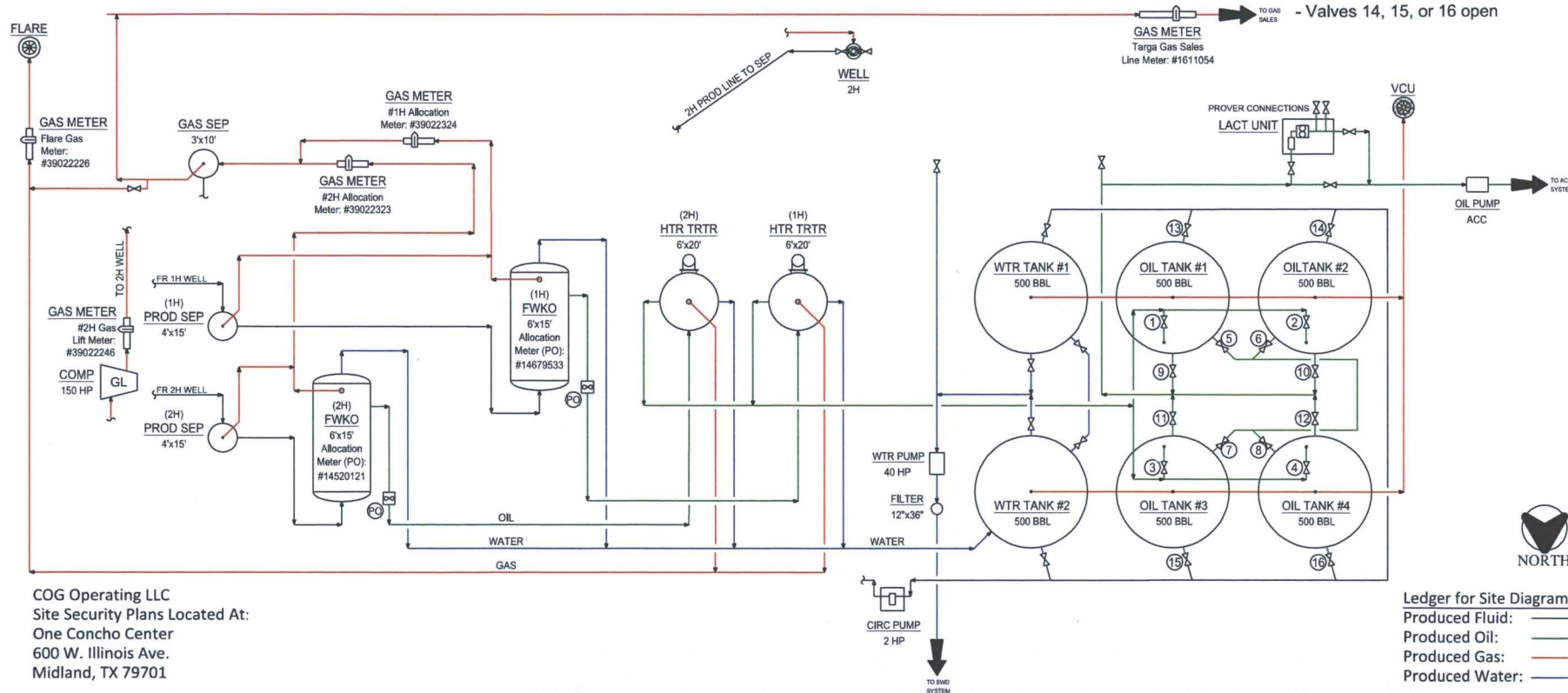

COG Operating LLC  
Site Security Plans Located At:  
One Concho Center  
600 W. Illinois Ave.  
Midland, TX 79701

**Ledger for Site Diagram**  
Produced Fluid: —  
Produced Oil: —  
Produced Gas: —  
Produced Water: —

NOTES:		CONFIDENTIALITY NOTICE		REFERENCE DRAWINGS		REVISIONS			ENGINEERING RECORD		
Type of Lease: State Property Code: 315251 OGRID #: 229137		THIS DRAWING IS PROPERTY OF COG OPERATING LLC AND IS LOANED TO THE SURVEYOR FOR CONFIDENTIAL USE ONLY AND IS SUBJECT TO RETURN UPON REQUEST AND SHALL NOT BE REPRODUCED, COPIED, LOANED OR OTHERWISE DISPOSED OF DIRECTLY OR INDIRECTLY, NOR USED FOR ANY PURPOSE OTHER THAN THAT WHICH IT IS SPECIFICALLY FURNISHED.		NO. TITLE		NO. DATE DESCRIPTION BY CHK. APP.			BY DATE		
						A 06/01/12 ISSUE FOR SITE PERMITTING CRB			DRN: CRB 06/01/12		
						B 07/03/17 UPDATED FOR VIKING HELMET SC 2H BTRY CMB			DES: CRB 06/01/12		
									CHK:		
									APP:		
									APP. NO.		
									DATE ENR: C. BLEDSCOE		
									OPER ENR: VARIES		
									SCALE: NONE		
									TOWNHIP/RANGE		
									D-1700-81-005		
									REV B		

**CONCHO**  
NORTHERN DELAWARE BASIN ASSET  
PRODUCTION FACILITIES  
SITE FACILITY DIAGRAM  
VIKING HELMET STATE COM 2H BATTERY  
LEA COUNTY, NM  
TOWNHIP/RANGE: MULTIPLE  
D-1700-81-005  
REV B



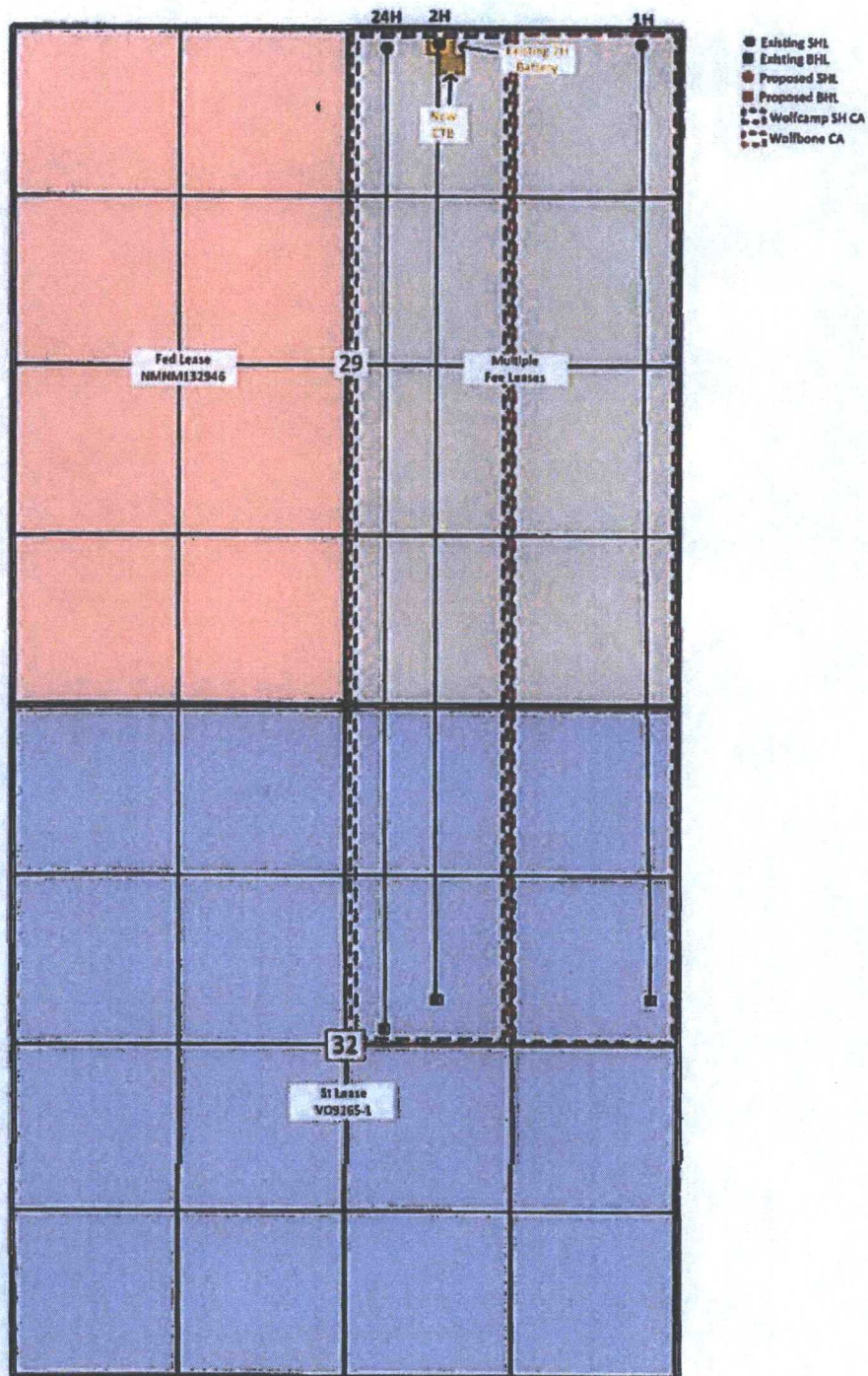

Viking Helmet State Com Wells  
 Secs. 29, 32-T24S-R35E  
 Lea County, NM



Viking Helmet #2H Battery  
(Viking Helmet #1H & 2H)

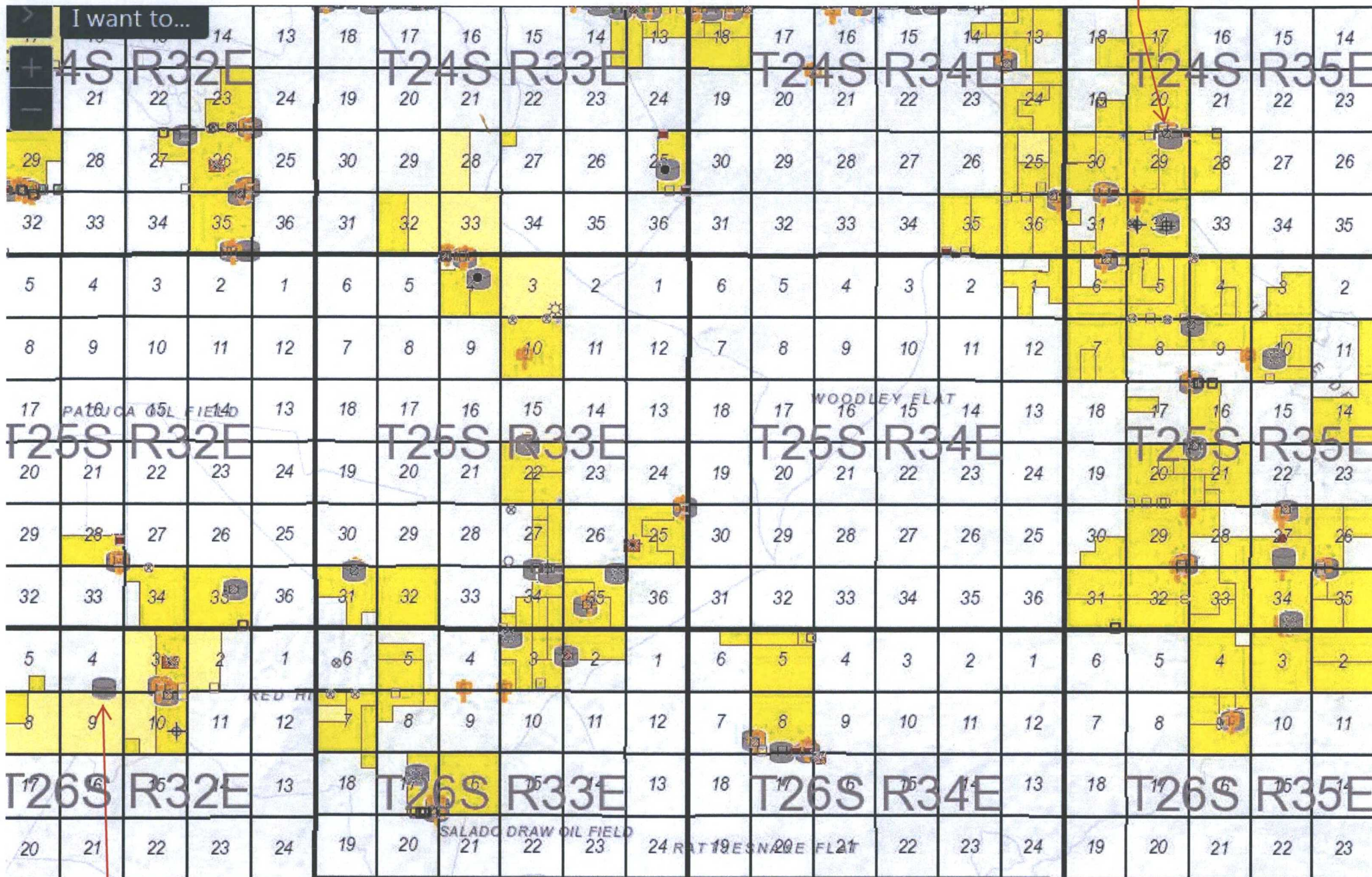

Red Hills Offload Station



# Viking Helmet State Com 1H, 2H & 24H



Sec. 29-T24S-R35E, Lea County, NM

# 30-025-42782 VIKING HELMET STATE COM #001H [315251]

## General Well Information

Operator: [229137] COG OPERATING LLC  
 Status: Active Direction: Horizontal  
 Well Type: Oil Multi-Lateral: No  
 Work Type: New Mineral Owner: State  
 Surface Owner: Private  
 Surface Location: A-29-24S-35E 190 FNL 380 FEL  
 Lat/Long: 32.19523274,-103.3821972 NAD83  
 GL Elevation: 3309  
 KB Elevation: Sing/Mult Compl: Single  
 DF Elevation: Potash Waiver: False

## Production / Injection

Earliest Production in OCD Records: 5/2017 Last 9/2017 [Show All Production](#) [Export to Excel](#)

Time Frame	Production				Injection				
	Oil(BBLS)	Gas(MCF)	Water (BBLS)	Days P/I	Water (BBLS)	Co2(MCF)	Gas(MCF)	Other	Pressure
2017									
WC-02S G-09 S243S32N;WOLFBORE									
Jun	42516	46832	51087	26	0	0	0	0	0
Jul	74687	79224	56639	31	0	0	0	0	0
Aug	35275	41363	30265	21	0	0	0	0	0
Sep	39669	40956	62956	30	0	0	0	0	0

# 30-025-42783 VIKING HELMET STATE COM #002H [315251]

## General Well Information

Operator: [229137] COG OPERATING LLC  
 Status: Active Direction: Horizontal  
 Well Type: Oil Multi-Lateral: No  
 Work Type: New Mineral Owner: State  
 Surface Owner:  
 Surface Location: B-29-24S-35E 190 FNL 1980 FEL  
 Lat/Long: 32.19523267,-103.3873685 NAD83  
 GL Elevation: 3320  
 KB Elevation: Sing/Mult Compl: Single  
 DF Elevation: Potash Waiver: False

## Production / Injection

Earliest Production in OCD Records: 7/2016 Last 9/2017 [Show All Production](#) [Export to Excel](#)

Time Frame	Production				Injection				
	Oil(BBLS)	Gas(MCF)	Water (BBLS)	Days P/I	Water (BBLS)	Co2(MCF)	Gas(MCF)	Other	Pressure
2017									
WC-025 G-09 S243532M;WOLFBONE									
Jan	20890	20960	12070	30	0	0	0	0	0
Feb	16922	15475	9712	28	0	0	0	0	0
Mar	25791	28918	18177	31	0	0	0	0	0
Apr	22381	24379	18152	30	0	0	0	0	0
May	3592	3852	16943	11	0	0	0	0	0
Jun	11305	13177	28520	30	0	0	0	0	0
Jul	10077	5531	14398	31	0	0	0	0	0
Aug	5331	1973	5564	14	0	0	0	0	0
Sep	4111	5241	17347	27	0	0	0	0	0



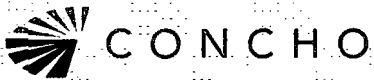

December 11, 2017

**Certified Mail – Return Receipt Requested**  
7017-1070-0000-9708-3479

Commissioner of Public Lands  
NM State Land Office  
P. O. Box 1148  
Santa Fe, NM 87504-1148

RE: Off-lease Measurement Application Fee

Viking Helmet State Com #1H  
API #30-025-42782  
WC-025 G-06 S243532M; Wolfbone  
SHL 190' FNL 380' FEL, Sec. 29-T24S-R35E  
BHL 2290' FNL 419' FEL, Sec. 32-T24S-R35E  
Lea County

Viking Helmet State Com #2H  
API #30-025-42783  
WC-025 G-06 S243532M; Wolfbone  
SHL 190' FNL 1980' FEL, Sec. 29-T24S-R35E  
BHL 2290' FNL 1959' FEL, Sec. 32-T24S-R35E  
Lea County

To Whom it May Concern:

Please find enclosed check in the amount of \$150.00, which constitutes payment of the required fee for the referenced Off-lease Measurement application.

If you have any questions, please do not hesitate to contact me at [bgoodloe@concho.com](mailto:bgoodloe@concho.com) or 575-748-6952.

Sincerely,

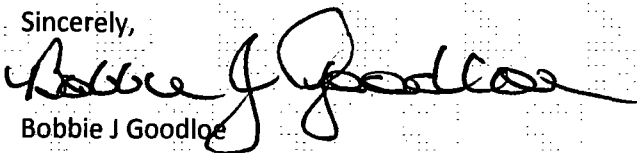
  
Bobbie J Goodloe  
Permitting Tech

**CORPORATE ADDRESS**

ONE CONCHO CENTER | 600 WEST ILLINOIS AVENUE | MIDLAND, TEXAS 79701  
P432.683.7443 | F432.683.7441

**ARTESIA WEST OFFICE**

2208 MAIN STREET | ARTESIA, NEW MEXICO 88210  
P575.748.6940 | F575.746.2096

# 30-025-42782 VIKING HELMET STATE COM #001H [315251]

## General Well Information

Operator: [229137] COG OPERATING LLC  
 Status: Active Direction: Horizontal  
 Well Type: Oil Multi-Lateral: No  
 Work Type: New Mineral Owner: State  
 Surface Owner: Private  
 Surface Location: A-29-24S-35E 190 FNL 390 FEL  
 Lat/Long: 32.19523274,-103.3821972 NAD83  
 GL Elevation: 3309  
 KB Elevation: Sing/Mult Compl: Single  
 DF Elevation: Potash Waiver: False

## Production / Injection

Earliest Production in OCD Records: 6/2017 Last 9/2017 [Show All Production](#) [Export to Excel](#)

Time Frame	Production				Injection				
	Oil(BBLS)	Gas(MCF)	Water (BBLS)	Days P/I	Water (BBLS)	Co2(MCF)	Gas(MCF)	Other	Pressure
2017									
WC-025 G-09 S2435S2M;WOLFBONE									
Jun	42516	46832	51087	26	0	0	0	0	0
Jul	74687	79224	56639	31	0	0	0	0	0
Aug	35275	41363	30265	21	0	0	0	0	0
Sep	39669	40356	62956	30	0	0	0	0	0

# 30-025-42783 VIKING HELMET STATE COM #002H [315251]

## General Well Information

Operator: [229137] COG OPERATING LLC  
 Status: Active Direction: Horizontal  
 Well Type: Oil Multi-Lateral: No  
 Work Type: New Mineral Owner: State  
 Surface Owner:  
 Surface Location: B-29-24S-35E 190 FNL 1980 FEL  
 Lat/Long: 32.19523267,-103.3873685 NAD83  
 GL Elevation: 3320  
 KB Elevation: Sing/Mult Compl: Single  
 DF Elevation: Potash Waiver: False

## Production / Injection

Earliest Production in OCD Records: 7/2016 Last 9/2017 Show All Production ☒ Export to Excel

Time Frame	Production				Injection				
	Oil(BBLS)	Gas(MCF)	Water (BBLS)	Days P/I	Water (BBLS)	Co2(MCF)	Gas(MCF)	Other	Pressure
2017									
WC-025 G-09 5243532M;WOLFBORE									
Jan	20690	20960	12070	30	0	0	0	0	0
Feb	16922	15475	9712	28	0	0	0	0	0
Mar	25791	28918	18177	31	0	0	0	0	0
Apr	22381	24379	18152	30	0	0	0	0	0
May	3592	3852	16943	11	0	0	0	0	0
Jun	11305	13177	28520	30	0	0	0	0	0
Jul	10077	5531	14398	31	0	0	0	0	0
Aug	5331	1978	5564	14	0	0	0	0	0
Sep	4111	5241	17347	27	0	0	0	0	0





December 11, 2017

**Certified Mail – Return Receipt Requested**  
**7017-1070-0000-9708-3912**

Arrakis Holdings LLC  
1202 Cherrywood Ct  
Allen, TX 75002 Owner

Re: Application for Administrative Approval  
Off-lease Measurement – Oil Only

Dear Interest Owner,

This letter will serve as notice, under Rule 19.15.12.9.B, that COG Operating LLC has requested administrative approval for the Oil and Gas Division in Santa Fe, NM, for Off-lease Measurement of oil only for the following wells:

Viking Helmet State Com #1H  
API #30-025-42782  
WC-025 G-06 S243532M; Wolfbone  
SHL 190' FNL 380' FEL, Sec. 29-T24S-R35E  
BHL 2290' FNL 419' FEL, Sec. 32-T24S-R35E  
Lea County

Viking Helmet State Com #2H  
API #30-025-42783  
WC-025 G-06 S243532M; Wolfbone  
SHL 190' FNL 1980' FEL, Sec. 29-T24S-R35E  
BHL 2290' FNL 1959' FEL, Sec. 32-T24S-R35E  
Lea County

The oil production from this well may be transported by truck to the Red Hills Offload Station, located in Unit O, Section 4-T26S-R32E, Lea County, in the event the CTB on lease is over capacity or in the case of battery or pipeline repairs. Oil will remain segregated and will be measured by lact meter when offloading at the Red Hills Station.

Should you or your company have an objection to this application regarding trucking of oil to the above mentioned off-load, it must be filed in writing within 20 days from the date of this notice. The Division Director may approve the Off-lease Measurement Facility if no objection has been made twenty (20) days after application is received.

Sincerely,

Bobbie Goodloe  
Regulatory Analyst

Enclosures

**CORPORATE ADDRESS**

One Concho Center | 600 West Illinois Avenue | Midland, Texas 79701  
PHONE 432.683.7443 | FAX 432.683.7441

**LOCAL ADDRESS**

Concho West | 2208 West Main Street | Artesia, New Mexico 88210  
PHONE 575.748.6940 | FAX 575.748.6968



December 11, 2017

**Certified Mail – Return Receipt Requested**  
**7017-1070-0000-9708-3639**

Michael Wayne Roye  
P O Box 3714  
Midland, TX 79702 Owner

Re: Application for Administrative Approval  
Off-lease Measurement – Oil Only

Dear Interest Owner,

This letter will serve as notice, under Rule 19.15.12.9.B, that COG Operating LLC has requested administrative approval for the Oil and Gas Division in Santa Fe, NM, for Off-lease Measurement of oil only for the following wells:

Viking Helmet State Com #1H  
API #30-025-42782  
WC-025 G-06 S243532M; Wolfbone  
SHL 190' FNL 380' FEL, Sec. 29-T24S-R35E  
BHL 2290' FNL 419' FEL, Sec. 32-T24S-R35E  
Lea County

Viking Helmet State Com #2H  
API #30-025-42783  
WC-025 G-06 S243532M; Wolfbone  
SHL 190' FNL 1980' FEL, Sec. 29-T24S-R35E  
BHL 2290' FNL 1959' FEL, Sec. 32-T24S-R35E  
Lea County

The oil production from this well may be transported by truck to the Red Hills Offload Station, located in Unit O, Section 4-T26S-R32E, Lea County, in the event the CTB on lease is over capacity or in the case of battery or pipeline repairs. Oil will remain segregated and will be measured by lact meter when offloading at the Red Hills Station.

Should you or your company have an objection to this application regarding trucking of oil to the above mentioned off-load, it must be filed in writing within 20 days from the date of this notice. The Division Director may approve the Off-lease Measurement Facility if no objection has been made twenty (20) days after application is received.

Sincerely,

  
Bobbie Goodloe  
Regulatory Analyst

Enclosures

**CORPORATE ADDRESS**

One Concho Center | 600 West Illinois Avenue | Midland, Texas 79701  
PHONE 432.683.7443 | FAX 432.683.7441

**LOCAL ADDRESS**

Concho West | 2208 West Main Street | Artesia, New Mexico 88210  
PHONE 575.748.6940 | FAX 575.748.6968



December 11, 2017

**Certified Mail – Return Receipt Requested**  
**7017-1070-0000-9708-3929**

Walter Cornell Royce  
6500 Cuesta Trail  
Austin, TX 78730 Owner

Re: Application for Administrative Approval  
Off-lease Measurement – Oil Only

Dear Interest Owner,

This letter will serve as notice, under Rule 19.15.12.9.B, that COG Operating LLC has requested administrative approval for the Oil and Gas Division in Santa Fe, NM, for Off-lease Measurement of oil only for the following wells:

Viking Helmet State Com #1H  
API #30-025-42782  
WC-025 G-06 S243532M; Wolfbone  
SHL 190' FNL 380' FEL, Sec. 29-T24S-R35E  
BHL 2290' FNL 419' FEL, Sec. 32-T24S-R35E  
Lea County

Viking Helmet State Com #2H  
API #30-025-42783  
WC-025 G-06 S243532M; Wolfbone  
SHL 190' FNL 1980' FEL, Sec. 29-T24S-R35E  
BHL 2290' FNL 1959' FEL, Sec. 32-T24S-R35E  
Lea County

The oil production from this well may be transported by truck to the Red Hills Offload Station, located in Unit O, Section 4-T26S-R32E, Lea County, in the event the CTB on lease is over capacity or in the case of battery or pipeline repairs. Oil will remain segregated and will be measured by lact meter when offloading at the Red Hills Station.

Should you or your company have an objection to this application regarding trucking of oil to the above mentioned off-load, it must be filed in writing within 20 days from the date of this notice. The Division Director may approve the Off-lease Measurement Facility if no objection has been made twenty (20) days after application is received.

Sincerely,

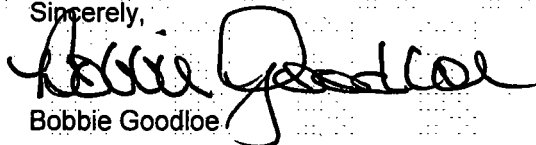

Bobbie Goodloe  
Regulatory Analyst

Enclosures





December 11, 2017

**Certified Mail – Return Receipt Requested**  
**7017-1070-0000-9708-3585**

Clay Sanford King  
3042 Walnut Bend Ln, #32  
Houston, TX 77042 Owner

Re: Application for Administrative Approval  
Off-lease Measurement – Oil Only

Dear Interest Owner,

This letter will serve as notice, under Rule 19.15.12.9.B, that COG Operating LLC has requested administrative approval for the Oil and Gas Division in Santa Fe, NM, for Off-lease Measurement of oil only for the following wells:

Viking Helmet State Com #1H  
API #30-025-42782  
WC-025 G-06 S243532M; Wolfbone  
SHL 190' FNL 380' FEL, Sec. 29-T24S-R35E  
BHL 2290' FNL 419' FEL, Sec. 32-T24S-R35E  
Lea County

Viking Helmet State Com #2H  
API #30-025-42783  
WC-025 G-06 S243532M; Wolfbone  
SHL 190' FNL 1980' FEL, Sec. 29-T24S-R35E  
BHL 2290' FNL 1959' FEL, Sec. 32-T24S-R35E  
Lea County

The oil production from this well may be transported by truck to the Red Hills Offload Station, located in Unit O, Section 4-T26S-R32E, Lea County, in the event the CTB on lease is over capacity or in the case of battery or pipeline repairs. Oil will remain segregated and will be measured by lact meter when offloading at the Red Hills Station.

Should you or your company have an objection to this application regarding trucking of oil to the above mentioned off-load, it must be filed in writing within 20 days from the date of this notice. The Division Director may approve the Off-lease Measurement Facility if no objection has been made twenty (20) days after application is received.

Sincerely,

Bobbie Goodloe  
Regulatory Analyst

Enclosures

**CORPORATE ADDRESS**

One Concho Center | 600 West Illinois Avenue | Midland, Texas 79701  
PHONE 432.683.7443 | FAX 432.683.7441

**LOCAL ADDRESS**

Concho West | 2208 West Main Street | Artesia, New Mexico 88210  
PHONE 575.748.6940 | FAX 575.748.6968



December 11, 2017

**Certified Mail – Return Receipt Requested**  
**7017-1070-0000-9708-3622**

Paul Doran Rev Trust Dtd 10/31/2014  
P O Box 151  
Vandalia, IL 62471 Owner

Re: Application for Administrative Approval  
Off-lease Measurement – Oil Only

Dear Interest Owner,

This letter will serve as notice, under Rule 19.15.12.9.B, that COG Operating LLC has requested administrative approval for the Oil and Gas Division in Santa Fe, NM, for Off-lease Measurement of oil only for the following wells:

Viking Helmet State Com #1H  
API #30-025-42782  
WC-025 G-06 S243532M; Wolfbone  
SHL 190' FNL 380' FEL, Sec. 29-T24S-R35E  
BHL 2290' FNL 419' FEL, Sec. 32-T24S-R35E  
Lea County

Viking Helmet State Com #2H  
API #30-025-42783  
WC-025 G-06 S243532M; Wolfbone  
SHL 190' FNL 1980' FEL, Sec. 29-T24S-R35E  
BHL 2290' FNL 1959' FEL, Sec. 32-T24S-R35E  
Lea County

The oil production from this well may be transported by truck to the Red Hills Offload Station, located in Unit O, Section 4-T26S-R32E, Lea County, in the event the CTB on lease is over capacity or in the case of battery or pipeline repairs. Oil will remain segregated and will be measured by lact meter when offloading at the Red Hills Station.

Should you or your company have an objection to this application regarding trucking of oil to the above mentioned off-load, it must be filed in writing within 20 days from the date of this notice. The Division Director may approve the Off-lease Measurement Facility if no objection has been made twenty (20) days after application is received.

Sincerely,

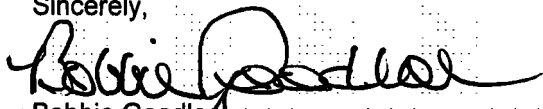

Bobbie Goodloe  
Regulatory Analyst

Enclosures

**CORPORATE ADDRESS**

One Concho Center | 600 West Illinois Avenue | Midland, Texas 79701  
PHONE 432.683.7443 | FAX 432.683.7441

**LOCAL ADDRESS**

Concho West | 2208 West Main Street | Artesia, New Mexico 88210  
PHONE 575.748.6940 | FAX 575.748.6968



December 11, 2017

**Certified Mail – Return Receipt Requested**  
**7017-1070-0000-9708-3530**

Frederick Tilmon King  
2510 Saratogo Drive  
Austin, TX 78733 Owner

Re: Application for Administrative Approval  
Off-lease Measurement – Oil Only

Dear Interest Owner,

This letter will serve as notice, under Rule 19.15.12.9.B, that COG Operating LLC has requested administrative approval for the Oil and Gas Division in Santa Fe, NM, for Off-lease Measurement of oil only for the following wells:

Viking Helmet State Com #1H  
API #30-025-42782  
WC-025 G-06 S243532M; Wolfbone  
SHL 190' FNL 380' FEL, Sec. 29-T24S-R35E  
BHL 2290' FNL 419' FEL, Sec. 32-T24S-R35E  
Lea County

Viking Helmet State Com #2H  
API #30-025-42783  
WC-025 G-06 S243532M; Wolfbone  
SHL 190' FNL 1980' FEL, Sec. 29-T24S-R35E  
BHL 2290' FNL 1959' FEL, Sec. 32-T24S-R35E  
Lea County

The oil production from this well may be transported by truck to the Red Hills Offload Station, located in Unit O, Section 4-T26S-R32E, Lea County, in the event the CTB on lease is over capacity or in the case of battery or pipeline repairs. Oil will remain segregated and will be measured by lact meter when offloading at the Red Hills Station.

Should you or your company have an objection to this application regarding trucking of oil to the above mentioned off-load, it must be filed in writing within 20 days from the date of this notice. The Division Director may approve the Off-lease Measurement Facility if no objection has been made twenty (20) days after application is received.

Sincerely,

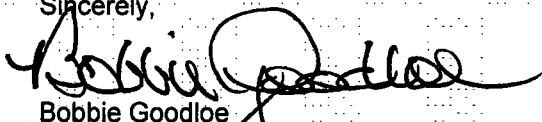
  
Bobbie Goodloe  
Regulatory Analyst

Enclosures

**CORPORATE ADDRESS**

One Concho Center | 600 West Illinois Avenue | Midland, Texas 79701  
PHONE 432.683.7443 | FAX 432.683.7441

**LOCAL ADDRESS**

Concho West | 2208 West Main Street | Artesia, New Mexico 88210  
PHONE 575.748.6940 | FAX 575.748.6968





December 11, 2017

**Certified Mail – Return Receipt Requested**  
**7017-1070-0000-9708-3592**

Rebecca King Goldsmith  
10004 Echo Hills Ct  
Austin, TX 78717 Owner

Re: Application for Administrative Approval  
Off-lease Measurement – Oil Only

Dear Interest Owner,

This letter will serve as notice, under Rule 19.15.12.9.B, that COG Operating LLC has requested administrative approval for the Oil and Gas Division in Santa Fe, NM, for Off-lease Measurement of oil only for the following wells:

Viking Helmet State Com #1H  
API #30-025-42782  
WC-025 G-06 S243532M; Wolfbone  
SHL 190' FNL 380' FEL, Sec. 29-T24S-R35E  
BHL 2290' FNL 419' FEL, Sec. 32-T24S-R35E  
Lea County

Viking Helmet State Com #2H  
API #30-025-42783  
WC-025 G-06 S243532M; Wolfbone  
SHL 190' FNL 1980' FEL, Sec. 29-T24S-R35E  
BHL 2290' FNL 1959' FEL, Sec. 32-T24S-R35E  
Lea County

The oil production from this well may be transported by truck to the Red Hills Offload Station, located in Unit O, Section 4-T26S-R32E, Lea County, in the event the CTB on lease is over capacity or in the case of battery or pipeline repairs. Oil will remain segregated and will be measured by lact meter when offloading at the Red Hills Station.

Should you or your company have an objection to this application regarding trucking of oil to the above mentioned off-load, it must be filed in writing within 20 days from the date of this notice. The Division Director may approve the Off-lease Measurement Facility if no objection has been made twenty (20) days after application is received.

Sincerely,

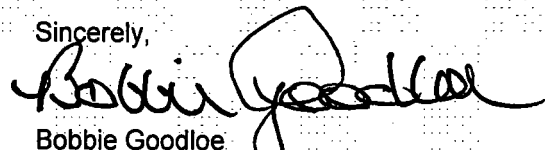

Bobbie Goodloe  
Regulatory Analyst

Enclosures

**CORPORATE ADDRESS**

One Concho Center | 600 West Illinois Avenue | Midland, Texas 79701  
PHONE 432.683.7443 | FAX 432.683.7441

**LOCAL ADDRESS**

Concho West | 2208 West Main Street | Artesia, New Mexico 88210  
PHONE 575.748.6940 | FAX 575.748.6968



December 11, 2017

**Certified Mail – Return Receipt Requested**  
**7017-1070-0000-9708-3578**

Clifton Forrest King  
4800 N. 10th Street  
Suite D  
McAllen, TX 78504 Owner

Re: Application for Administrative Approval  
Off-lease Measurement – Oil Only

Dear Interest Owner,

This letter will serve as notice, under Rule 19.15.12.9.B, that COG Operating LLC has requested administrative approval for the Oil and Gas Division in Santa Fe, NM, for Off-lease Measurement of oil only for the following wells:

Viking Helmet State Com #1H  
API #30-025-42782  
WC-025 G-06 S243532M; Wolfbone  
SHL 190' FNL 380' FEL, Sec. 29-T24S-R35E  
BHL 2290' FNL 419' FEL, Sec. 32-T24S-R35E  
Lea County

Viking Helmet State Com #2H  
API #30-025-42783  
WC-025 G-06 S243532M; Wolfbone  
SHL 190' FNL 1980' FEL, Sec. 29-T24S-R35E  
BHL 2290' FNL 1959' FEL, Sec. 32-T24S-R35E  
Lea County

The oil production from this well may be transported by truck to the Red Hills Offload Station, located in Unit O, Section 4-T26S-R32E, Lea County, in the event the CTB on lease is over capacity or in the case of battery or pipeline repairs. Oil will remain segregated and will be measured by lact meter when offloading at the Red Hills Station.

Should you or your company have an objection to this application regarding trucking of oil to the above mentioned off-load, it must be filed in writing within 20 days from the date of this notice. The Division Director may approve the Off-lease Measurement Facility if no objection has been made twenty (20) days after application is received.

Sincerely,

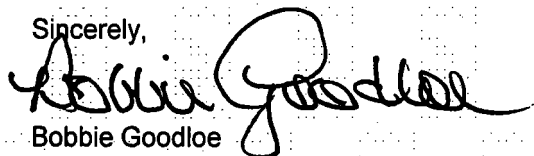

Bobbie Goodloe  
Regulatory Analyst

Enclosures

CORPORATE ADDRESS  
One Concho Center | 600 West Illinois Avenue | Midland, Texas 79701  
PHONE 432.683.7443 | FAX 432.683.7441

LOCAL ADDRESS  
Concho West | 2208 West Main Street | Artesia, New Mexico 88210  
PHONE 575.748.6940 | FAX 575.748.6968



December 11, 2017

**Certified Mail – Return Receipt Requested**  
**7017-1070-0000-9708-3905**

5588 Oil, LLC  
P O Box 470925  
Fort Worth, TX 76107 Owner

Re: Application for Administrative Approval  
Off-lease Measurement – Oil Only

Dear Interest Owner,

This letter will serve as notice, under Rule 19.15.12.9.B, that COG Operating LLC has requested administrative approval for the Oil and Gas Division in Santa Fe, NM, for Off-lease Measurement of oil only for the following wells:

Viking Helmet State Com #1H  
API #30-025-42782  
WC-025 G-06 S243532M; Wolfbone  
SHL 190' FNL 380' FEL, Sec. 29-T24S-R35E  
BHL 2290' FNL 419' FEL, Sec. 32-T24S-R35E  
Lea County

Viking Helmet State Com #2H  
API #30-025-42783  
WC-025 G-06 S243532M; Wolfbone  
SHL 190' FNL 1980' FEL, Sec. 29-T24S-R35E  
BHL 2290' FNL 1959' FEL, Sec. 32-T24S-R35E  
Lea County

The oil production from this well may be transported by truck to the Red Hills Offload Station, located in Unit O, Section 4-T26S-R32E, Lea County, in the event the CTB on lease is over capacity or in the case of battery or pipeline repairs. Oil will remain segregated and will be measured by lact meter when offloading at the Red Hills Station.

Should you or your company have an objection to this application regarding trucking of oil to the above mentioned off-load, it must be filed in writing within 20 days from the date of this notice. The Division Director may approve the Off-lease Measurement Facility if no objection has been made twenty (20) days after application is received.

Sincerely,

Bobbie Goodloe  
Regulatory Analyst

Enclosures

**CORPORATE ADDRESS**

One Concho Center | 600 West Illinois Avenue | Midland, Texas 79701  
PHONE 432.683.7443 | FAX 432.683.7441

**LOCAL ADDRESS**

Concho West | 2208 West Main Street | Artesia, New Mexico 88210  
PHONE 575.748.6940 | FAX 575.748.6968



December 11, 2017

**Certified Mail – Return Receipt Requested**  
**7017-1070-0000-9708-3653**

CEP Minerals LLC  
P O Box 50820  
Midland, TX 79710 Owner

Re: Application for Administrative Approval  
Off-lease Measurement – Oil Only

Dear Interest Owner,

This letter will serve as notice, under Rule 19.15.12.9.B, that COG Operating LLC has requested administrative approval for the Oil and Gas Division in Santa Fe, NM, for Off-lease Measurement of oil only for the following wells:

Viking Helmet State Com #1H  
API #30-025-42782  
WC-025 G-06 S243532M; Wolfbone  
SHL 190' FNL 380' FEL, Sec. 29-T24S-R35E  
BHL 2290' FNL 419' FEL, Sec. 32-T24S-R35E  
Lea County

Viking Helmet State Com #2H  
API #30-025-42783  
WC-025 G-06 S243532M; Wolfbone  
SHL 190' FNL 1980' FEL, Sec. 29-T24S-R35E  
BHL 2290' FNL 1959' FEL, Sec. 32-T24S-R35E  
Lea County

The oil production from this well may be transported by truck to the Red Hills Offload Station, located in Unit O, Section 4-T26S-R32E, Lea County, in the event the CTB on lease is over capacity or in the case of battery or pipeline repairs. Oil will remain segregated and will be measured by lact meter when offloading at the Red Hills Station.

Should you or your company have an objection to this application regarding trucking of oil to the above mentioned off-load, it must be filed in writing within 20 days from the date of this notice. The Division Director may approve the Off-lease Measurement Facility if no objection has been made twenty (20) days after application is received.

Sincerely,

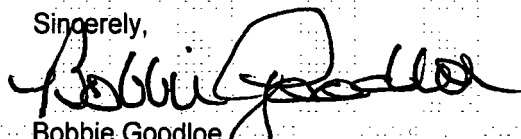

Bobbie Goodloe  
Regulatory Analyst

Enclosures

CORPORATE ADDRESS  
One Concho Center | 600 West Illinois Avenue | Midland, Texas 79701  
PHONE 432.683.7443 | FAX 432.683.7441

LOCAL ADDRESS  
Concho West | 2208 West Main Street | Artesia, New Mexico 88210  
PHONE 575.748.6940 | FAX 575.748.6968



December 11, 2017

**Certified Mail – Return Receipt Requested**  
**7017-1070-0000-9708-3882**

Mavros Minerals LLC  
P O Box 50820  
Midland, TX 79710 Owner

Re: Application for Administrative Approval  
Off-lease Measurement – Oil Only

Dear Interest Owner,

This letter will serve as notice, under Rule 19.15.12.9.B, that COG Operating LLC has requested administrative approval for the Oil and Gas Division in Santa Fe, NM, for Off-lease Measurement of oil only for the following wells:

Viking Helmet State Com #1H  
API #30-025-42782  
WC-025 G-06 S243532M; Wolfbone  
SHL 190' FNL 380' FEL, Sec. 29-T24S-R35E  
BHL 2290' FNL 419' FEL, Sec. 32-T24S-R35E  
Lea County

Viking Helmet State Com #2H  
API #30-025-42783  
WC-025 G-06 S243532M; Wolfbone  
SHL 190' FNL 1980' FEL, Sec. 29-T24S-R35E  
BHL 2290' FNL 1959' FEL, Sec. 32-T24S-R35E  
Lea County

The oil production from this well may be transported by truck to the Red Hills Offload Station, located in Unit O, Section 4-T26S-R32E, Lea County, in the event the CTB on lease is over capacity or in the case of battery or pipeline repairs. Oil will remain segregated and will be measured by lact meter when offloading at the Red Hills Station.

Should you or your company have an objection to this application regarding trucking of oil to the above mentioned off-load, it must be filed in writing within 20 days from the date of this notice. The Division Director may approve the Off-lease Measurement Facility if no objection has been made twenty (20) days after application is received.

Sincerely,

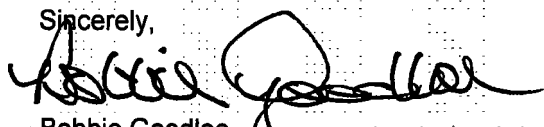

Bobbie Goodloe  
Regulatory Analyst

Enclosures

CORPORATE ADDRESS  
One Concho Center | 600 West Illinois Avenue | Midland, Texas 79701  
PHONE 432.683.7443 | FAX 432.683.7441

LOCAL ADDRESS  
Concho West | 2208 West Main Street | Artesia, New Mexico 88210  
PHONE 575.748.6940 | FAX 575.748.6968





December 11, 2017

**Certified Mail – Return Receipt Requested  
7017-1070-0000-9708-3875**

Bert Madera  
P O Box 2795  
Ruidoso, NM 88355 Owner

Re: Application for Administrative Approval  
Off-lease Measurement – Oil Only

Dear Interest Owner,

This letter will serve as notice, under Rule 19.15.12.9.B, that COG Operating LLC has requested administrative approval for the Oil and Gas Division in Santa Fe, NM, for Off-lease Measurement of oil only for the following wells:

Viking Helmet State Com #1H  
API #30-025-42782  
WC-025 G-06 S243532M; Wolfbone  
SHL 190' FNL 380' FEL, Sec. 29-T24S-R35E  
BHL 2290' FNL 419' FEL, Sec. 32-T24S-R35E  
Lea County

Viking Helmet State Com #2H  
API #30-025-42783  
WC-025 G-06 S243532M; Wolfbone  
SHL 190' FNL 1980' FEL, Sec. 29-T24S-R35E  
BHL 2290' FNL 1959' FEL, Sec. 32-T24S-R35E  
Lea County

The oil production from this well may be transported by truck to the Red Hills Offload Station, located in Unit O, Section 4-T26S-R32E, Lea County, in the event the CTB on lease is over capacity or in the case of battery or pipeline repairs. Oil will remain segregated and will be measured by lact meter when offloading at the Red Hills Station.

Should you or your company have an objection to this application regarding trucking of oil to the above mentioned off-load, it must be filed in writing within 20 days from the date of this notice. The Division Director may approve the Off-lease Measurement Facility if no objection has been made twenty (20) days after application is received.

Sincerely,

  
Bobbie Goodloe  
Regulatory Analyst

Enclosures



December 11, 2017

**Certified Mail – Return Receipt Requested**  
**7017-1070-0000-9708-3899**

Mary Jack Johnson  
1855 Garland Lane  
Boudler, CO 80304 Owner

Re: Application for Administrative Approval  
Off-lease Measurement – Oil Only

Dear Interest Owner,

This letter will serve as notice, under Rule 19.15.12.9.B, that COG Operating LLC has requested administrative approval for the Oil and Gas Division in Santa Fe, NM, for Off-lease Measurement of oil only for the following wells:

Viking Helmet State Com #1H  
API #30-025-42782  
WC-025 G-06 S243532M; Wolfbone  
SHL 190' FNL 380' FEL, Sec. 29-T24S-R35E  
BHL 2290' FNL 419' FEL, Sec. 32-T24S-R35E  
Lea County

Viking Helmet State Com #2H  
API #30-025-42783  
WC-025 G-06 S243532M; Wolfbone  
SHL 190' FNL 1980' FEL, Sec. 29-T24S-R35E  
BHL 2290' FNL 1959' FEL, Sec. 32-T24S-R35E  
Lea County

The oil production from this well may be transported by truck to the Red Hills Offload Station, located in Unit O, Section 4-T26S-R32E, Lea County, in the event the CTB on lease is over capacity or in the case of battery or pipeline repairs. Oil will remain segregated and will be measured by lact meter when offloading at the Red Hills Station.

Should you or your company have an objection to this application regarding trucking of oil to the above mentioned off-load, it must be filed in writing within 20 days from the date of this notice. The Division Director may approve the Off-lease Measurement Facility if no objection has been made twenty (20) days after application is received.

Sincerely,

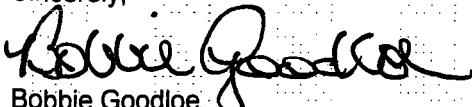
  
Bobbie Goodloe  
Regulatory Analyst

Enclosures

**CORPORATE ADDRESS**

One Concho Center | 600 West Illinois Avenue | Midland, Texas 79701  
PHONE 432.683.7443 | FAX 432.683.7441

**LOCAL ADDRESS**

Concho West | 2208 West Main Street | Artesia, New Mexico 88210  
PHONE 575.748.6940 | FAX 575.748.6968



December 11, 2017

**Certified Mail – Return Receipt Requested**  
**7017-1070-0000-9708-3608**

Michael F. Madera  
P O Box 645  
La Pine, OR 97739-0645 Owner

Re: Application for Administrative Approval  
Off-lease Measurement – Oil Only

Dear Interest Owner,

This letter will serve as notice, under Rule 19.15.12.9.B, that COG Operating LLC has requested administrative approval for the Oil and Gas Division in Santa Fe, NM, for Off-lease Measurement of oil only for the following wells:

Viking Helmet State Com #1H  
API #30-025-42782  
WC-025 G-06 S243532M; Wolfbone  
SHL 190' FNL 380' FEL, Sec. 29-T24S-R35E  
BHL 2290' FNL 419' FEL, Sec. 32-T24S-R35E  
Lea County

Viking Helmet State Com #2H  
API #30-025-42783  
WC-025 G-06 S243532M; Wolfbone  
SHL 190' FNL 1980' FEL, Sec. 29-T24S-R35E  
BHL 2290' FNL 1959' FEL, Sec. 32-T24S-R35E  
Lea County

The oil production from this well may be transported by truck to the Red Hills Offload Station, located in Unit O, Section 4-T26S-R32E, Lea County, in the event the CTB on lease is over capacity or in the case of battery or pipeline repairs. Oil will remain segregated and will be measured by lact meter when offloading at the Red Hills Station.

Should you or your company have an objection to this application regarding trucking of oil to the above mentioned off-load, it must be filed in writing within 20 days from the date of this notice. The Division Director may approve the Off-lease Measurement Facility if no objection has been made twenty (20) days after application is received.

Sincerely,

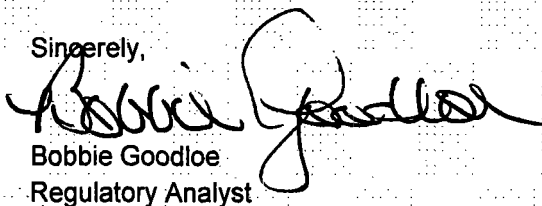

Bobbie Goodloe  
Regulatory Analyst

Enclosures



December 11, 2017

**Certified Mail – Return Receipt Requested**  
**7017-1070-0000-9708-3615**

Lela E. Madera  
187 George Strait  
Canyon Lake, TX 78133 Owner

Re: Application for Administrative Approval  
Off-lease Measurement – Oil Only

Dear Interest Owner,

This letter will serve as notice, under Rule 19.15.12.9.B, that COG Operating LLC has requested administrative approval for the Oil and Gas Division in Santa Fe, NM, for Off-lease Measurement of oil only for the following wells:

Viking Helmet State Com #1H  
API #30-025-42782  
WC-025 G-06 S243532M; Wolfbone  
SHL 190' FNL 380' FEL, Sec. 29-T24S-R35E  
BHL 2290' FNL 419' FEL, Sec. 32-T24S-R35E  
Lea County

Viking Helmet State Com #2H  
API #30-025-42783  
WC-025 G-06 S243532M; Wolfbone  
SHL 190' FNL 1980' FEL, Sec. 29-T24S-R35E  
BHL 2290' FNL 1959' FEL, Sec. 32-T24S-R35E  
Lea County

The oil production from this well may be transported by truck to the Red Hills Offload Station, located in Unit O, Section 4-T26S-R32E, Lea County, in the event the CTB on lease is over capacity or in the case of battery or pipeline repairs. Oil will remain segregated and will be measured by lact meter when offloading at the Red Hills Station.

Should you or your company have an objection to this application regarding trucking of oil to the above mentioned off-load, it must be filed in writing within 20 days from the date of this notice. The Division Director may approve the Off-lease Measurement Facility if no objection has been made twenty (20) days after application is received.

Sincerely,



Bobbie Goodloe  
Regulatory Analyst

Enclosures



December 11, 2017

**Certified Mail – Return Receipt Requested**  
**7017-1070-0000-9708-3523**

Pamela Madera  
4621 W. Agave Ave  
Eloy, AZ 85131 Owner

Re: Application for Administrative Approval  
Off-lease Measurement – Oil Only

Dear Interest Owner,

This letter will serve as notice, under Rule 19.15.12.9.B, that COG Operating LLC has requested administrative approval for the Oil and Gas Division in Santa Fe, NM, for Off-lease Measurement of oil only for the following wells:

Viking Helmet State Com #1H  
API #30-025-42782  
WC-025 G-06 S243532M; Wolfbone  
SHL 190' FNL 380' FEL, Sec. 29-T24S-R35E  
BHL 2290' FNL 419' FEL, Sec. 32-T24S-R35E  
Lea County

Viking Helmet State Com #2H  
API #30-025-42783  
WC-025 G-06 S243532M; Wolfbone  
SHL 190' FNL 1980' FEL, Sec. 29-T24S-R35E  
BHL 2290' FNL 1959' FEL, Sec. 32-T24S-R35E  
Lea County

The oil production from this well may be transported by truck to the Red Hills Offload Station, located in Unit O, Section 4-T26S-R32E, Lea County, in the event the CTB on lease is over capacity or in the case of battery or pipeline repairs. Oil will remain segregated and will be measured by lact meter when offloading at the Red Hills Station.

Should you or your company have an objection to this application regarding trucking of oil to the above mentioned off-load, it must be filed in writing within 20 days from the date of this notice. The Division Director may approve the Off-lease Measurement Facility if no objection has been made twenty (20) days after application is received.

Sincerely, .



Bobbie Goodloe  
Regulatory Analyst

Enclosures

**CORPORATE ADDRESS**

One Concho Center | 600 West Illinois Avenue | Midland, Texas 79701  
PHONE 432.683.7443 | FAX 432.683.7441

**LOCAL ADDRESS**

Concho West | 2208 West Main Street | Artesia, New Mexico 88210  
PHONE 575.748.6940 | FAX 575.748.6968





December 11, 2017

**Certified Mail – Return Receipt Requested**  
**7017-1070-0000-9708-3547**

Katherine Ross Madera  
P O Box 443  
Manhattan, NY 59741 Owner

Re: Application for Administrative Approval  
Off-lease Measurement – Oil Only

Dear Interest Owner,

This letter will serve as notice, under Rule 19.15.12.9.B, that COG Operating LLC has requested administrative approval for the Oil and Gas Division in Santa Fe, NM, for Off-lease Measurement of oil only for the following wells:

Viking Helmet State Com #1H  
API #30-025-42782  
WC-025 G-06 S243532M; Wolfbone  
SHL 190' FNL 380' FEL, Sec. 29-T24S-R35E  
BHL 2290' FNL 419' FEL, Sec. 32-T24S-R35E  
Lea County

Viking Helmet State Com #2H  
API #30-025-42783  
WC-025 G-06 S243532M; Wolfbone  
SHL 190' FNL 1980' FEL, Sec. 29-T24S-R35E  
BHL 2290' FNL 1959' FEL, Sec. 32-T24S-R35E  
Lea County

The oil production from this well may be transported by truck to the Red Hills Offload Station, located in Unit O, Section 4-T26S-R32E, Lea County, in the event the CTB on lease is over capacity or in the case of battery or pipeline repairs. Oil will remain segregated and will be measured by lact meter when offloading at the Red Hills Station.

Should you or your company have an objection to this application regarding trucking of oil to the above mentioned off-load, it must be filed in writing within 20 days from the date of this notice. The Division Director may approve the Off-lease Measurement Facility if no objection has been made twenty (20) days after application is received.

Sincerely,

  
Bobbie Goodloe  
Regulatory Analyst

Enclosures

**CORPORATE ADDRESS**

One Concho Center | 600 West Illinois Avenue | Midland, Texas 79701  
PHONE 432.683.7443 | FAX 432.683.7441

**LOCAL ADDRESS**

Concho West | 2208 West Main Street | Artesia, New Mexico 88210  
PHONE 575.748.6940 | FAX 575.748.6968



December 11, 2017

**Certified Mail – Return Receipt Requested**  
**7017-1070-0000-9708-3554**

Rebecca C. Hunter  
1903 Briarpark Drive  
Houston, TX 77042 Owner

Re: Application for Administrative Approval  
Off-lease Measurement – Oil Only

Dear Interest Owner,

This letter will serve as notice, under Rule 19.15.12.9.B, that COG Operating LLC has requested administrative approval for the Oil and Gas Division in Santa Fe, NM, for Off-lease Measurement of oil only for the following wells:

Viking Helmet State Com #1H  
API #30-025-42782  
WC-025 G-06 S243532M; Wolfbone  
SHL 190' FNL 380' FEL, Sec. 29-T24S-R35E  
BHL 2290' FNL 419' FEL, Sec. 32-T24S-R35E  
Lea County

Viking Helmet State Com #2H  
API #30-025-42783  
WC-025 G-06 S243532M; Wolfbone  
SHL 190' FNL 1980' FEL, Sec. 29-T24S-R35E  
BHL 2290' FNL 1959' FEL, Sec. 32-T24S-R35E  
Lea County

The oil production from this well may be transported by truck to the Red Hills Offload Station, located in Unit O, Section 4-T26S-R32E, Lea County, in the event the CTB on lease is over capacity or in the case of battery or pipeline repairs. Oil will remain segregated and will be measured by lact meter when offloading at the Red Hills Station.

Should you or your company have an objection to this application regarding trucking of oil to the above mentioned off-load, it must be filed in writing within 20 days from the date of this notice. The Division Director may approve the Off-lease Measurement Facility if no objection has been made twenty (20) days after application is received.

Sincerely,

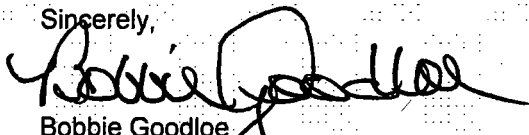

Bobbie Goodloe  
Regulatory Analyst

Enclosures

**CORPORATE ADDRESS**

One Concho Center | 600 West Illinois Avenue | Midland, Texas 79701  
PHONE 432.683.7443 | FAX 432.683.7441

**LOCAL ADDRESS**

Concho West | 2208 West Main Street | Artesia, New Mexico 88210  
PHONE 575.748.6940 | FAX 575.748.6968



December 11, 2017

**Certified Mail – Return Receipt Requested**  
**7017-1070-0000-9708-3561**

David F.K. Puckett  
106 South Friou Street  
Jefferson, TX 75657 Owner

Re: Application for Administrative Approval  
Off-lease Measurement – Oil Only

Dear Interest Owner,

This letter will serve as notice, under Rule 19.15.12.9.B, that COG Operating LLC has requested administrative approval for the Oil and Gas Division in Santa Fe, NM, for Off-lease Measurement of oil only for the following wells:

Viking Helmet State Com #1H  
API #30-025-42782  
WC-025 G-06 S243532M; Wolfbone  
SHL 190' FNL 380' FEL, Sec. 29-T24S-R35E  
BHL 2290' FNL 419' FEL, Sec. 32-T24S-R35E  
Lea County

Viking Helmet State Com #2H  
API #30-025-42783  
WC-025 G-06 S243532M; Wolfbone  
SHL 190' FNL 1980' FEL, Sec. 29-T24S-R35E  
BHL 2290' FNL 1959' FEL, Sec. 32-T24S-R35E  
Lea County

The oil production from this well may be transported by truck to the Red Hills Offload Station, located in Unit O, Section 4-T26S-R32E, Lea County, in the event the CTB on lease is over capacity or in the case of battery or pipeline repairs. Oil will remain segregated and will be measured by lact meter when offloading at the Red Hills Station.

Should you or your company have an objection to this application regarding trucking of oil to the above mentioned off-load, it must be filed in writing within 20 days from the date of this notice. The Division Director may approve the Off-lease Measurement Facility if no objection has been made twenty (20) days after application is received.

Sincerely,

  
Bobbie Goodloe  
Regulatory Analyst

Enclosures



December 11, 2017

**Certified Mail – Return Receipt Requested**  
**7017-1070-0000-9708-3509**

Sam Shackelford  
1096 Mechem Drive  
Suite G-16  
Ruidoso, NM 88345 Owner

Re: Application for Administrative Approval  
Off-lease Measurement – Oil Only

Dear Interest Owner,

This letter will serve as notice, under Rule 19.15.12.9.B, that COG Operating LLC has requested administrative approval for the Oil and Gas Division in Santa Fe, NM, for Off-lease Measurement of oil only for the following wells:

Viking Helmet State Com #1H  
API #30-025-42782  
WC-025 G-06 S243532M; Wolfbone  
SHL 190' FNL 380' FEL, Sec. 29-T24S-R35E  
BHL 2290' FNL 419' FEL, Sec. 32-T24S-R35E  
Lea County

Viking Helmet State Com #2H  
API #30-025-42783  
WC-025 G-06 S243532M; Wolfbone  
SHL 190' FNL 1980' FEL, Sec. 29-T24S-R35E  
BHL 2290' FNL 1959' FEL, Sec. 32-T24S-R35E  
Lea County

The oil production from this well may be transported by truck to the Red Hills Offload Station, located in Unit O, Section 4-T26S-R32E, Lea County, in the event the CTB on lease is over capacity or in the case of battery or pipeline repairs. Oil will remain segregated and will be measured by lact meter when offloading at the Red Hills Station.

Should you or your company have an objection to this application regarding trucking of oil to the above mentioned off-load, it must be filed in writing within 20 days from the date of this notice. The Division Director may approve the Off-lease Measurement Facility if no objection has been made twenty (20) days after application is received.

Sincerely,

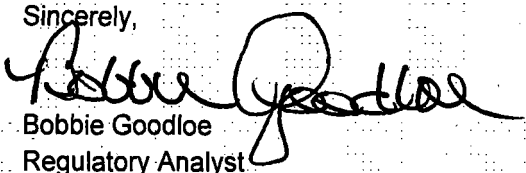
  
Bobbie Goodloe  
Regulatory Analyst

Enclosures

**CORPORATE ADDRESS**

One Concho Center | 600 West Illinois Avenue | Midland, Texas 79701  
PHONE 432.683.7443 | FAX 432.683.7441

**LOCAL ADDRESS**

Concho West | 2208 West Main Street | Artesia, New Mexico 88210  
PHONE 575.748.6940 | FAX 575.748.6968



December 11, 2017

**Certified Mail – Return Receipt Requested**  
**7017-1070-0000-9708-3646**

Mildred Maxine McCall  
1434 Hamblen Road  
Kingwood, TX 77339 Owner

Re: Application for Administrative Approval  
Off-lease Measurement – Oil Only

Dear Interest Owner,

This letter will serve as notice, under Rule 19.15.12.9.B, that COG Operating LLC has requested administrative approval for the Oil and Gas Division in Santa Fe, NM, for Off-lease Measurement of oil only for the following wells:

Viking Helmet State Com #1H  
API #30-025-42782  
WC-025 G-06 S243532M; Wolfbone  
SHL 190' FNL 380' FEL, Sec. 29-T24S-R35E  
BHL 2290' FNL 419' FEL, Sec. 32-T24S-R35E  
Lea County

Viking Helmet State Com #2H  
API #30-025-42783  
WC-025 G-06 S243532M; Wolfbone  
SHL 190' FNL 1980' FEL, Sec. 29-T24S-R35E  
BHL 2290' FNL 1959' FEL, Sec. 32-T24S-R35E  
Lea County

The oil production from this well may be transported by truck to the Red Hills Offload Station, located in Unit O, Section 4-T26S-R32E, Lea County, in the event the CTB on lease is over capacity or in the case of battery or pipeline repairs. Oil will remain segregated and will be measured by lact meter when offloading at the Red Hills Station.

Should you or your company have an objection to this application regarding trucking of oil to the above mentioned off-load, it must be filed in writing within 20 days from the date of this notice. The Division Director may approve the Off-lease Measurement Facility if no objection has been made twenty (20) days after application is received.

Sincerely,

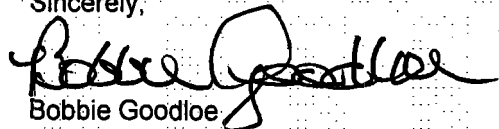
  
Bobbie Goodloe  
Regulatory Analyst

Enclosures

CORPORATE ADDRESS  
One Concho Center | 600 West Illinois Avenue | Midland, Texas 79701  
PHONE 432.683.7443 | FAX 432.683.7441

LOCAL ADDRESS  
Concho West | 2208 West Main Street | Artesia, New Mexico 88210  
PHONE 575.748.6940 | FAX 575.748.6968





December 11, 2017

**Certified Mail – Return Receipt Requested**  
**7017-1070-0000-9708-3516**

Doug Schutz  
P O Box 973  
Santa Fe, NM 87504-0973 Owner

Re: Application for Administrative Approval  
Off-lease Measurement – Oil Only

Dear Interest Owner,

This letter will serve as notice, under Rule 19.15.12.9.B, that COG Operating LLC has requested administrative approval for the Oil and Gas Division in Santa Fe, NM, for Off-lease Measurement of oil only for the following wells:

Viking Helmet State Com #1H  
API #30-025-42782  
WC-025 G-06 S243532M; Wolfbone  
SHL 190' FNL 380' FEL, Sec. 29-T24S-R35E  
BHL 2290' FNL 419' FEL, Sec. 32-T24S-R35E  
Lea County

Viking Helmet State Com #2H  
API #30-025-42783  
WC-025 G-06 S243532M; Wolfbone  
SHL 190' FNL 1980' FEL, Sec. 29-T24S-R35E  
BHL 2290' FNL 1959' FEL, Sec. 32-T24S-R35E  
Lea County

The oil production from this well may be transported by truck to the Red Hills Offload Station, located in Unit O, Section 4-T26S-R32E, Lea County, in the event the CTB on lease is over capacity or in the case of battery or pipeline repairs. Oil will remain segregated and will be measured by lact meter when offloading at the Red Hills Station.

Should you or your company have an objection to this application regarding trucking of oil to the above mentioned off-load, it must be filed in writing within 20 days from the date of this notice. The Division Director may approve the Off-lease Measurement Facility if no objection has been made twenty (20) days after application is received.

Sincerely,

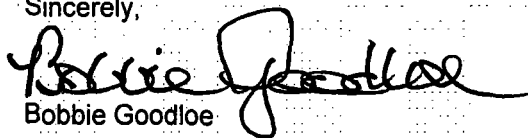
  
Bobbie Goodloe  
Regulatory Analyst

Enclosures

CORPORATE ADDRESS  
One Concho Center | 600 West Illinois Avenue | Midland, Texas 79701  
PHONE 432.683.7443 | FAX 432.683.7441

LOCAL ADDRESS  
Concho West | 2208 West Main Street | Artesia, New Mexico 88210  
PHONE 575.748.6940 | FAX 575.748.6968



December 11, 2017

**Certified Mail – Return Receipt Requested**  
**7017-1070-0000-9708-3493**

Oak Valley Mineral & Land LP  
P O Box 50820  
Midland, TX 79710 Owner

Re: Application for Administrative Approval  
Off-lease Measurement – Oil Only

Dear Interest Owner,

This letter will serve as notice, under Rule 19.15.12.9.B, that COG Operating LLC has requested administrative approval for the Oil and Gas Division in Santa Fe, NM, for Off-lease Measurement of oil only for the following wells:

Viking Helmet State Com #1H  
API #30-025-42782  
WC-025 G-06 S243532M; Wolfbone  
SHL 190' FNL 380' FEL, Sec. 29-T24S-R35E  
BHL 2290' FNL 419' FEL, Sec. 32-T24S-R35E  
Lea County

Viking Helmet State Com #2H  
API #30-025-42783  
WC-025 G-06 S243532M; Wolfbone  
SHL 190' FNL 1980' FEL, Sec. 29-T24S-R35E  
BHL 2290' FNL 1959' FEL, Sec. 32-T24S-R35E  
Lea County

The oil production from this well may be transported by truck to the Red Hills Offload Station, located in Unit O, Section 4-T26S-R32E, Lea County, in the event the CTB on lease is over capacity or in the case of battery or pipeline repairs. Oil will remain segregated and will be measured by lact meter when offloading at the Red Hills Station.

Should you or your company have an objection to this application regarding trucking of oil to the above mentioned off-load, it must be filed in writing within 20 days from the date of this notice. The Division Director may approve the Off-lease Measurement Facility if no objection has been made twenty (20) days after application is received.

Sincerely,



Bobbie Goodloe  
Regulatory Analyst

Enclosures

CORPORATE ADDRESS  
One Concho Center | 600 West Illinois Avenue | Midland, Texas 79701  
PHONE 432.683.7443 | FAX 432.683.7441

LOCAL ADDRESS  
Concho West | 2208 West Main Street | Artesia, New Mexico 88210  
PHONE 575.748.6940 | FAX 575.748.6968



December 11, 2017

**Certified Mail – Return Receipt Requested**  
**7017-1070-0000-9708-3486**

Chevron U.S.A., Inc.  
PO Box 73036  
Dallas, TX 75373-0436 Owner

Re: Application for Administrative Approval  
Off-lease Measurement – Oil Only

Dear Interest Owner,

This letter will serve as notice, under Rule 19.15.12.9.B, that COG Operating LLC has requested administrative approval for the Oil and Gas Division in Santa Fe, NM, for Off-lease Measurement of oil only for the following wells:

Viking Helmet State Com #1H  
API #30-025-42782  
WC-025 G-06 S243532M; Wolfbone  
SHL 190' FNL 380' FEL, Sec. 29-T24S-R35E  
BHL 2290' FNL 419' FEL, Sec. 32-T24S-R35E  
Lea County

Viking Helmet State Com #2H  
API #30-025-42783  
WC-025 G-06 S243532M; Wolfbone  
SHL 190' FNL 1980' FEL, Sec. 29-T24S-R35E  
BHL 2290' FNL 1959' FEL, Sec. 32-T24S-R35E  
Lea County

The oil production from this well may be transported by truck to the Red Hills Offload Station, located in Unit O, Section 4-T26S-R32E, Lea County, in the event the CTB on lease is over capacity or in the case of battery or pipeline repairs. Oil will remain segregated and will be measured by lact meter when offloading at the Red Hills Station.

Should you or your company have an objection to this application regarding trucking of oil to the above mentioned off-load, it must be filed in writing within 20 days from the date of this notice. The Division Director may approve the Off-lease Measurement Facility if no objection has been made twenty (20) days after application is received.

Sincerely,

Bobbie Goodloe  
Regulatory Analyst

Enclosures

**CORPORATE ADDRESS**

One Concho Center | 600 West Illinois Avenue | Midland, Texas 79701  
PHONE 432.683.7443 | FAX 432.683.7441

**LOCAL ADDRESS**

Concho West | 2208 West Main Street | Artesia, New Mexico 88210  
PHONE 575.748.6940 | FAX 575.748.6968



December 11, 2017

Attn: Michael McMillan  
NM Oil Conservation Division  
1220 South Saint Francis Drive  
Santa Fe, New Mexico 87505

Re: Application for Administrative Approval  
Off-lease Measurement – Oil Only

Dear Mr. McMillan,

COG Operating, LLC, respectfully requests approval for Off-lease Measurement for oil only for the following wells:

Viking Helmet State Com #1H  
API #30-025-42782  
WC-025 G-06 S243532M; Wolfbone  
SHL 190' FNL 380' FEL, Sec. 29-T24S-R35E  
BHL 2290' FNL 419' FEL, Sec. 32-T24S-R35E  
Lea County

Viking Helmet State Com #2H  
API #30-025-42783  
WC-025 G-06 S243532M; Wolfbone  
SHL 190' FNL 1980' FEL, Sec. 29-T24S-R35E  
BHL 2290' FNL 1959' FEL, Sec. 32-T24S-R35E  
Lea County

The oil production from this well may be transported by truck to the Red Hills Offload Station, located in Unit O, Section 4-T26S-R32E, Lea County, in the event the CTB on lease is over capacity or in the case of battery or pipeline repairs. Oil will remain segregated and will be measured by lact meter when offloading at the Red Hills Station. Notices have been sent to all interest owners as required.

Also, please see the attached Administrative Application Checklist, plats for referenced well, proof of notice to interest owners, diagrams of site facility, map with lease boundaries showing wells and facility locations and a copy of the letter to the New Mexico State Land Office.

Thank you for your attention to this matter.

Sincerely,

A handwritten signature in black ink, appearing to read "Bobbie Goodloe", written over a horizontal line.

Bobbie Goodloe  
Regulatory Analyst

Enclosures

**CORPORATE ADDRESS**

ONE CONCHO CENTER | 600 WEST ILLINOIS AVENUE | MIDLAND, TEXAS 79701  
P432.683.7443 | F432.683.7441

**ARTESIA WEST OFFICE**

2208 MAIN STREET | ARTESIA, NEW MEXICO 88210  
P575.748.6940 | F575.746.2096