



Santa Fe Energy Operating Partners, L.P.

Santa Fe Pacific Exploration Company
Managing General Partner

CERTIFIED MAIL - RETURN RECEIPT

May 4, 1989

PP-27

North American Royalties,
Inc. - Operator
ClayDesta Center Downtown
306 W. Wall, Suite 1400
Midland, Texas 79701

Re: Application of SFEOP, L.P. for
Directional Drilling
E/2 Sec. 15, T-16-S, R-36-E,
N.M.P.M., Lea County, New Mexico
Clydesdale "15" State Com #1
12,200' Atoka Test

Gentlemen:

This letter is to advise you that Santa Fe Energy Operating Partners, L.P. has filed an administrative application with the New Mexico Oil Conservation Division ("OCD") seeking approval to directionally drill a well on this E/2 pooled unit from an unorthodox surface location of 2300 feet from the South line and 500 feet from the East line to an orthodox bottom hole location within 100 feet of a standard bottom hole location at a point 2200 feet from the South line and 660 feet from the East line of Section 15, Township 16 South, Range 36 East, N.M.P.M., Lea County, New Mexico. This deviation is required due to topographical conditions.

As an offsetting owner, you have the right to be notified and present your objections, if any. Failure to enter an objection within 20 days with the OCD will preclude you from challenging the matter at a later date.

Santa Fe Energy Operating Partners, L.P. hereby requests you waive any objection to the above by signing and returning this letter to the OCD at P.O. Box 2088, Santa Fe, New Mexico 87504-2088 with a copy sent to the undersigned.

Permian Basin District
500 W. Illinois
Suite 500
Midland, Texas 79701
915/687-3551

Page 2
Offset Operators
May 4, 1989

Your prompt attention to this matter is most appreciated. Should you have any questions, feel free to give me a call.

Sincerely yours,

SANTA FE ENERGY OPERATING PARTNERS, L.P.
By: Santa Fe Pacific Exploration Company,
Managing General Partner

By: Patrick J. Tower
Patrick J. Tower, Senior Landman

PJT/efw

WE HEREBY WAIVE OUR RIGHT TO OBJECT TO SANTA FE ENERGY OPERATING PARTNERS, L.P.'s APPLICATION FOR DIRECTIONALLY DRILLING AS NOTED ABOVE.

INDIVIDUAL OR COMPANY
NORTH AMERICAN ROYALTIES, INC.

By: Gordon L. Smith, III
Gordon L. Smith, III
Title: Division Engineering Manager

Date: June 1, 1989



NORTH AMERICAN ROYALTIES, INC.

200 EAST EIGHTH STREET • CHATTANOOGA, TENNESSEE 37402 • TELEPHONE 615/265-8111

RECEIVED

June 1, 1989

JUN - 5 1989

OIL CONSERVATION DIV.
SANTA FE

New Mexico Oil Conservation Division
P. O. BOX 2088
Santa Fe, New Mexico 87504

pp-27

Dear Sir:

Attached is a letter dated May 4, 1989 from Santa Fe Energy Operating Partners, L.P. which has been signed by North American Royalties, Inc. (NAR) evidencing that NAR has no objection as an offset operator to SFEOP's application to drill the Clydesdale "15" State Com #1 well in E/2 Sec. 15, 16S-36E.

Very truly yours,

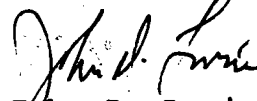
John D. Lavin
Landman

cc: Santa Fe Energy Operating Partners, L.P.

RECEIVED

SEP 26 1989

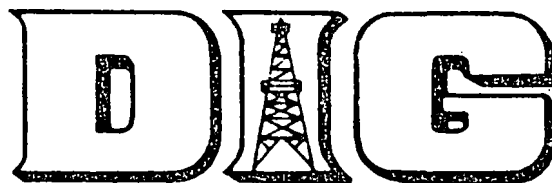
OIL CONSERVATION DIV.
SANTA FE

SUB-SURFACE
DIRECTIONAL
SURVEY
REPORT

SANTA FE ENERGY COMPANY

COMPANY

CLYDESDALE 15 STATE NO. 1

WELL NAME

LEA COUNTY, NEW MEXICO

STATE AND COUNTY

15-16-36

CERTIFIED REPORT

BHL: 2146.5/A J 734.7/E

SANTE FE ENERGY COMPANY

WELL # :
CLYDESDALE 15 STATE NO. 1

LOCATION :
LEA COUNTY, NEW MEXICO

DATE :
7/18/89, 7/28/89, 8/13/89

JOB TYPE :
CYRO. MULTISHOT

JOB # :
CS-2234, MS-2241, MS-2249

SURVEYOR :
MASSEY, MASSEY, EATON

DEPTHS :
0 - 12194'

DECL. :
9 DEGREES EAST

ELEV. :
0'

FILE # :
WT-PP35

FINAL STATION DATA:

MD. 12194.00
TVD. 12168.05
N/S -153.52
E/W -234.68

CLOSURE DISTANCE
280.43 FEET
CLOSURE DIRECTION
S 58.81 W

1 IN. = 50 FT.

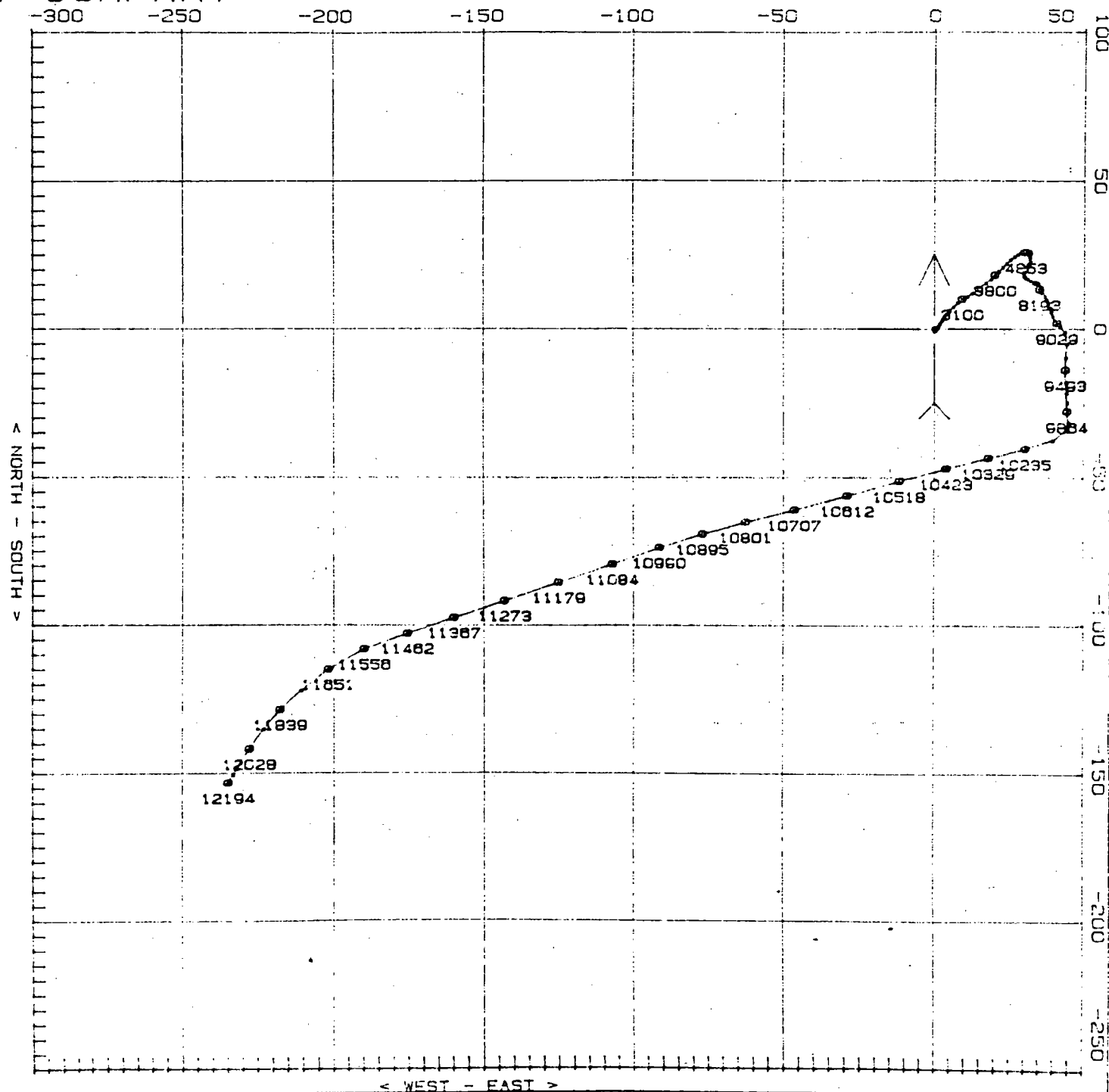

CUSTOMER : SANTE FE ENERGY COMPANY

WELL # : CLYDESDALE 15 STATE NO. 1

LOCATION : LEA COUNTY, NEW MEXICO

DATE : 7/7/89, 7/28/89, 8/13/89

LOG TYPE : GYRO, MULTISHOT

LOG # : GS-2234, MS-2241, MS-2249

SURVEYOR : MASSEY, MASSEY, EATON

DEPTHS : 0 - 12194'

DICL. : 9 DEGREES EAST

LEV. : 0'

FILE # : WT-PP3S

METHOD : RADIUS OF CURVATURE

SECTION : S58W

INITIAL STATION DATA!

THIS SURVEY IS CORRECT TO THE
BEST OF MY KNOWLEDGE AND IS
SUPPORTED BY ACTUAL FIELD DATA.

DIG REPRESENTATIVE

MEASURED INCL. HOLE COURSE VERTICAL VERTICAL RECTANGULAR CLOSURE DOG-LEG
DEPTH ANGLE DIRECTION LENGTH DEPTH SECTION COORDINATES DISTANCE DIRECTION SEVERITY
FEET DEGS. DEGS. FEET FEET FEET N/S feet E/W FEET DEGS. DG/100FT

12194.00 4.50 S 29.00 W 40.00 12160.00 200.37 153.52 S 234.60 W 200.43' S 56.81 W 0.00

SANTE FE ENERGY COMPANY
 CLYDESDALE 15 STATE NO. 1
 WT-PP35

PAGE 1
 02:23:58
 00/00/00

TRUE											
MEASURED	INCL.	HOLE	COURSE	VERTICAL	VERTICAL	RECTANGULAR	CLOSURE	DOG-LEG			
DEPTH	ANGLE	DIRECTION	LENGTH	DEPTH	SECTION	COORDINATES	DISTANCE	DIRECTION	SEVERITY		
FEET	DEGS.	DEGS.	FEET	FEET	FEET	N/S Feet E/W	FEET	DEGS.	DE/100FT		
0.00	0.00	*****	0.00	0.00	0.00	0.00 N 0.00 E	0.00	N 00.00 E	0.00		
100.00	0.00	*****	100.00	100.00	0.00	0.00 N 0.00 E	0.00	N 00.00 E	0.00		
200.00	0.00	*****	100.00	200.00	0.00	0.00 N 0.00 E	0.00	N 00.00 E	0.00		
300.00	0.00	*****	100.00	300.00	0.00	0.00 N 0.00 E	0.00	N 00.00 E	0.00		
400.00	.10	S 40.00 E	100.00	400.00	-.02	.06 S .06 E	.09	S 40.00 E	.10		
500.00	0.00	*****	100.00	500.00	-.05	.12 S .13 E	.17	S 40.00 E	.10		
600.00	.10	S 50.00 E	100.00	600.00	-.09	.16 S .20 E	.26	S 51.33 E	.10		
700.00	.10	S 62.00 E	100.00	700.00	-.17	.25 S .35 E	.43	S 54.80 E	.01		
800.00	.10	S 02.00 E	100.00	800.00	-.13	.39 S .45 E	.60	S 42.44 E	.09		
900.00	.10	S 05.00 W	100.00	900.00	-.09	.56 S .46 E	.72	S 39.25 E	.02		
1000.00	.10	N 74.00 W	100.00	1000.00	.00	.65 S .33 E	.73	S 27.10 E	.15		
1100.00	.20	N 14.00 W	100.00	1100.00	.11	.47 S .16 E	.49	S 10.77 E	.17		
1200.00	.20	N 17.00 W	100.00	1200.00	.01	.13 S .07 E	.15	S 28.55 E	.01		
1300.00	0.00	*****	100.00	1300.00	-.03	.04 N .01 E	.04	N 22.81 E	.20		
1400.00	0.00	*****	100.00	1400.00	-.03	.04 N .01 E	.04	N 22.81 E	0.00		
1500.00	.20	N 16.00 E	100.00	1500.00	-.16	.20 N .06 E	.21	N 17.32 E	.20		
1600.00	0.00	*****	100.00	1600.00	-.29	.37 N .11 E	.39	N 16.67 E	.20		
1700.00	0.00	*****	100.00	1700.00	-.29	.37 N .11 E	.39	N 16.67 E	0.00		
1800.00	.10	S 37.00 E	100.00	1800.00	-.30	.30 N .16 E	.34	N 20.51 E	.10		
1900.00	.20	S 45.00 E	100.00	1900.00	-.34	.10 N .34 E	.35	N 72.92 E	.10		
2000.00	0.00	*****	100.00	2000.00	-.30	.02 S .46 E	.46	S 87.53 E	.20		
2100.00	.20	N 61.00 E	100.00	2100.00	-.55	.06 N .61 E	.61	N 93.95 E	.20		
2200.00	.50	N 55.00 E	100.00	2199.99	-1.16	.39 N 1.13 E	1.19	N 71.02 E	.30		
2300.00	.50	N 20.00 E	100.00	2299.99	-1.97	1.07 N 1.65 E	1.97	N 57.07 E	.30		
2400.00	.60	N 27.00 E	100.00	2399.99	-2.75	1.95 N 2.03 E	2.82	N 46.22 E	.12		

SANTE FE ENERGY COMPANY
CLYDESDALE 15 STATE NO. 1
WT-PP3S

PAGE 2
02:24:48
00/00/00

MEASURED		INCL.	HOLE	COURSE	VERTICAL	VERTICAL	RECTANGULAR	CLOSURE	DOG-LEG
DEPTH	ANGLE	DIRECTION	LENGTH	DEPTH	SECTION	COORDINATES	DISTANCE	DIRECTION	SEVERITY
FEET	DEGS.	DEGS.	FEET	FEET	FEET	N/S feet E/W	FEET	DEGS.	DG/100FT
2500.00	.80	N 47.00 E	100.00	2499.98	-3.89	2.92 N 2.77 E	4.02	N 43.44 E	.31
2600.00	.70	N 34.00 E	100.00	2599.97	-5.14	3.91 N 3.61 E	5.33	N 42.72 E	.20
2700.00	.60	N 30.00 E	100.00	2699.96	-6.32	5.02 N 4.31 E	6.62	N 40.61 E	.11
2800.00	1.00	N 44.00 E	100.00	2799.95	-7.78	6.27 N 5.25 E	8.18	N 39.92 E	.30
2900.00	1.00	N 40.00 E	100.00	2899.93	-9.48	7.49 N 6.51 E	9.92	N 40.99 E	.07
3000.00	1.20	N 45.00 E	100.00	2999.92	-11.37	9.81 N 7.90 E	11.83	N 41.80 E	.21
3100.00	1.10	N 52.00 E	100.00	3099.90	-13.36	10.00 N 9.40 E	13.81	N 43.34 E	.30
3200.00	1.10	N 50.00 E	100.00	3199.88	-15.20	11.04 N 11.11 E	15.67	N 45.10 E	.02
3300.00	1.10	N 54.00 E	100.00	3299.86	-17.19	12.12 N 12.70 E	17.56	N 46.35 E	.00
3400.00	1.00	N 42.00 E	100.00	3399.84	-19.01	13.26 N 14.14 E	19.38	N 45.84 E	.14
3500.00	1.10	N 52.00 E	100.00	3499.83	-20.93	14.42 N 15.55 E	21.21	N 47.16 E	.11
3600.00	1.20	N 57.00 E	100.00	3599.80	-22.83	15.59 N 17.10 E	23.20	N 47.79 E	.14
3700.00	1.20	N 53.00 E	100.00	3699.78	-24.92	16.79 N 18.90 E	25.28	N 48.39 E	.08
3800.00	1.00	N 30.00 E	100.00	3799.76	-26.79	18.13 N 20.27 E	27.19	N 48.18 E	.35
3900.00	1.10	N 44.00 E	100.00	3899.75	-29.55	19.51 N 21.47 E	29.01	N 47.73 E	.15
4000.00	1.10	N 42.00 E	100.00	3999.73	-30.40	20.92 N 22.70 E	30.92	N 47.44 E	.04
4100.00	1.00	N 45.00 E	100.00	4099.71	-32.17	22.25 N 24.04 E	32.75	N 47.22 E	.11
4200.00	1.00	N 51.00 E	100.00	4199.70	-33.89	23.41 N 25.33 E	34.50	N 47.26 E	.10
4300.00	.90	N 53.00 E	100.00	4299.68	-35.54	24.43 N 26.64 E	36.15	N 47.47 E	.11
4400.00	.70	N 62.00 E	100.00	4399.67	-36.94	25.18 N 27.82 E	37.52	N 47.84 E	.24
4500.00	.50	N 54.00 E	100.00	4499.67	-37.90	25.74 N 29.70 E	38.55	N 48.12 E	.22
4600.00	.40	N 41.00 E	100.00	4599.67	-38.75	26.27 N 29.20 E	39.34	N 48.11 E	.14
4628.00	.30	N 51.00 E	20.00	4619.66	-38.87	26.35 N 29.37 E	39.46	N 48.10 E	.58
4853.00	.50	S 01.00 E	233.00	4850.66	-39.58	25.80 N 30.56 E	39.99	N 47.82 E	.31
4945.00	.40	N 41.00 E	92.00	4944.66	-39.95	25.61 N 31.00 E	40.27	N 50.50 E	.91

SANTE FE ENERGY COMPANY
 CLYDESDALE 15 STATE NO. 1
 WT-PP3S

PAGE 3
 02:25:43
 00/00/00

TRUE													
MEASURED	INCL.	HOLE	COURSE	VERTICAL	VERTICAL	RECTANGULAR	CLOSURE	DUG-LEG					
DEPTH	ANGLE	DIRECTION	LENGTH	DEPTH	SECTION	COORDINATES	DISTANCE	DIRECTION	SEVERITY				
FEET	DEGS.	DEGS.	FEET	FEET	FEET	N/S Feet E/W	FEET	DEGS.	DG/100FT				
5038.00	.20	S 57.00 E	93.00	5037.65	-40.34	25.67 N 31.52 E	40.65' N 50.84 E		.45				
5131.00	.20	N 49.00 E	93.00	5130.65	-40.60	25.69 N 31.83 E	40.90' N 51.09 E		.26				
5224.00	.20	N 21.00 E	93.00	5223.65	-40.90	25.95 N 32.01 E	41.21' N 50.96 E		.10				
5317.00	.10	N 73.00 W	93.00	5316.65	-40.92	26.15 N 31.92 E	41.26' N 50.87 E		.25				
5409.00	.10	N 73.00 W	92.00	5408.65	-40.82	26.20 N 31.76 E	41.17' N 50.49 E		0.00				
5502.00	.20	S 57.00 E	93.00	5501.65	-40.60	26.04 N 31.69 E	41.02' N 50.59 E		.32				
5595.00	.30	S 49.00 E	93.00	5594.60	-40.82	25.80 N 32.01 E	41.12' N 51.14 E		.11				
5688.00	.30	S 50.00 W	93.00	5687.65	-40.50	25.37 N 32.01 E	40.85' N 51.60 E		.49				
5781.00	.30	S 19.00 W	93.00	5780.60	-40.15	24.97 N 31.74 E	40.39' N 51.30 E		.17				
5873.00	.20	S 32.00 E	92.00	5872.65	-39.93	24.59 N 31.78 E	40.18' N 52.27 E		.25				
5966.00	.40	S 14.00 W	93.00	5965.65	-39.80	24.12 N 31.86 E	39.96' N 52.87 E		.32				
6059.00	.80	S 26.00 E	93.00	6058.64	-39.30	23.17 N 31.96 E	39.47' N 54.05 E		.60				
6152.00	.20	S 24.00 W	93.00	6151.64	-38.97	22.39 N 31.97 E	39.03' N 55.00 E		.74				
6245.00	.60	S 36.00 W	93.00	6244.63	-38.26	21.68 N 31.56 E	38.30' N 55.51 E		.65				
6337.00	.50	S 49.00 W	92.00	6336.65	-37.26	20.92 N 30.86 E	37.28' N 55.87 E		.36				
6430.00	.40	S 04.00 W	93.00	6429.62	-36.65	20.28 N 30.54 E	36.66' N 56.42 E		.38				
6523.00	.20	S 52.00 W	93.00	6522.62	-36.24	19.86 N 30.32 E	36.25' N 56.77 E		.33				
6616.00	.30	S 16.00 W	93.00	6615.62	-35.87	19.53 N 30.10 E	35.88' N 57.02 E		.20				
6709.00	.50	S 19.00 W	93.00	6708.61	-35.30	18.91 N 29.90 E	35.38' N 57.69 E		.22				
6801.00	.30	S 15.00 W	92.00	6800.62	-34.90	18.30 N 29.72 E	34.90' N 58.38 E		.22				
6894.00	.60	S 41.00 E	93.00	6893.62	-34.67	17.61 N 29.87 E	34.68' N 59.48 E		.54				
6987.00	.30	S 74.00 E	93.00	6986.61	-34.90	17.23 N 30.48 E	35.01' N 60.53 E		.41				
7080.00	.70	S 46.00 L	93.00	7079.61	-35.36	16.83 N 31.18 E	35.43' N 61.65 E		.49				
7173.00	.60	S 68.00 E	93.00	7172.60	-35.87	16.17 N 32.19 E	36.02' N 63.33 E		.33				
7265.00	.50	S 42.00 L	92.00	7264.62	-35.27	15.57 N 33.04 E	35.52' N 64.76 E		.45				

SANTE FE ENERGY COMPANY
CLYDESDALE 15 STATE NO. 1
WT-PP3S

PAGE 4
02:26:38
00/00/00

MEASURED	INCL.	HOLE	COURSE	TRUE	VERTICAL	VERTICAL	RECTANGULAR	CLOSURE	DOG-LEG
DEPTH	ANGLE	DIRECTION	LENGTH	DEPTH	SECTION	COORDINATES	DISTANCE	DIRECTION	SEVERITY
FEET	DEGS.	DEGS.	FEET	FEET	FEET	N/S feet E/W	FEET	DEGS.	DO/100FT
7358.00	.20	N 62.00 E	93.00	7357.59	-36.66	15.48 N 33.56 E	36.96	N 65.24 E	.53
7451.00	.20	N 54.00 E	93.00	7450.59	-36.99	15.65 N 33.83 E	37.28	N 65.17 E	.03
7544.00	0.00	* * * * *	93.00	7543.59	-37.15	15.75 N 33.96 E	37.44	N 65.12 E	.22
7637.00	.20	S 43.00 E	93.00	7636.59	-37.18	15.63 N 34.08 E	37.49	N 65.36 E	.22
7729.00	.30	S 81.00 E	92.00	7728.59	-37.38	15.44 N 34.42 E	37.73	N 65.84 E	.20
7822.00	.30	S 50.00 E	93.00	7821.59	-37.64	15.25 N 34.86 E	38.05	N 66.38 E	.17
7915.00	.30	S 35.00 W	93.00	7914.59	-37.46	14.81 N 34.92 E	37.93	N 67.02 E	.44
8008.00	.20	S 21.00 W	93.00	8007.59	-37.11	14.45 N 34.93 E	37.61	N 67.41 E	.13
8101.00	.30	S 30.00 E	93.00	8100.59	-36.93	14.06 N 34.76 E	37.49	N 67.98 E	.25
8193.00	.80	S 31.00 E	92.00	8192.59	-36.90	13.30 N 35.21 E	37.63	N 67.31 E	.54
8286.00	.90	S 48.00 E	93.00	8285.57	-36.99	12.17 N 36.01 E	38.01	N 71.32 E	.18
8379.00	.90	S 38.00 E	93.00	8378.55	-37.17	11.04 N 36.93 E	38.54	N 73.36 E	.03
8472.00	.90	S 18.00 E	93.00	8471.55	-37.00	9.76 N 37.61 E	38.85	N 75.46 E	.34
8565.00	.90	S 18.00 E	93.00	8564.54	-36.71	8.37 N 38.06 E	38.97	N 77.60 E	0.00
8657.00	1.00	S 28.00 E	92.00	8656.52	-36.47	6.96 N 38.66 E	39.20	N 79.79 E	.21
8750.00	.80	S 11.00 E	93.00	8749.51	-36.16	5.59 N 39.14 E	39.54	N 81.87 E	.36
8843.00	1.00	S 26.00 E	93.00	8842.50	-35.82	4.21 N 39.60 E	39.83	N 83.93 E	.33
8936.00	.80	S 29.00 E	93.00	8935.49	-35.70	2.91 N 40.28 E	40.38	N 85.86 E	.22
9029.00	.90	S 42.00 E	93.00	9028.48	-35.79	1.79 N 41.00 E	41.12	N 87.50 E	.23
9121.00	.90	S 52.00 E	92.00	9120.47	-36.16	.81 N 42.13 E	42.14	N 88.90 E	.17
9214.00	2.20	S 27.00 E	93.00	9213.43	-36.49	1.12 S 43.72 E	43.74	S 88.54 E	1.54
9307.00	2.90	S 07.00 W	93.00	9306.34	-34.96	5.13 S 44.43 E	44.72	S 83.41 E	1.76
9400.00	2.80	S 03.00 W	93.00	9399.22	-32.18	9.74 S 44.03 E	45.09	S 77.53 E	.24
9493.00	2.50	S 01.00 E	93.00	9492.13	-29.84	14.04 S 43.95 E	46.14	S 72.29 E	.38
9585.00	2.40	S 01.00 E	92.00	9584.04	-27.81	17.97 S 44.02 E	47.55	S 67.80 E	.11

TRUE												
MEASURED	INCL.	HOLE	COURSE	VERTICAL	VERTICAL	RECTANGULAR	CLOSURE	DOG-LEG				
DEPTH	ANGLE	DIRECTION	LENGTH	DEPTH	SECTION	COORDINATES	DISTANCE	DIRECTION	SEVERITY			
FEET	DEGS.	DEGS.	FEET	FEET	FEET	N/S feet E/W	FEET	DEGS.	DE/100FT			
9678.00	2.10	S 06.00 E	93.00	9676.97	-26.07	21.61 S 44.24 E	49.24' S 63.97 E		.39			
9771.00	1.90	S 01.00 E	93.00	9769.91	-24.52	24.85 S 44.44 E	50.92' S 60.79 E		.29			
9864.00	2.00	S 04.00 E	93.00	9862.86	-22.96	28.01 S 44.58 E	52.65' S 57.86 E		.15			
9957.00	2.00	S 08.00 E	93.00	9955.80	-21.54	31.24 S 44.92 E	54.71' S 55.18 E		.15			
9990.00	2.00	S 04.00 E	33.00	9988.78	-21.03	32.38 S 45.04 E	55.47' S 54.20 E		.42			
10046.00	2.25	S 41.00 W	56.00	10044.74	-19.47	34.30 S 44.40 E	56.10' S 52.31 E		2.93			
10140.00	4.75	S 69.00 W	94.00	10138.56	-13.80	37.56 S 39.74 E	54.68' S 46.62 E		3.15			
10235.00	7.00	S 76.00 W	95.00	10233.06	-4.39	40.48 S 30.47 E	50.67' S 36.97 E		2.48			
10329.00	8.50	S 76.00 W	94.00	10326.19	7.66	43.55 S 18.18 E	47.19' S 28.65 E		1.60			
10423.00	9.25	S 75.00 W	94.00	10419.07	21.49	47.18 S 4.14 E	47.36' S 05.01 E		.81			
10510.00	10.50	S 75.00 W	95.00	10512.66	37.07	51.40 S 11.60 W	52.69' S 12.72 W		1.32			
10612.00	11.50	S 73.00 W	94.00	10604.93	54.31	56.34 S 28.84 W	63.29' S 27.11 W		1.14			
10707.00	10.50	S 76.00 W	95.00	10698.18	71.69	61.18 S 46.31 W	76.73' S 37.12 W		1.21			
10801.00	9.75	S 75.00 W	94.00	10790.72	87.45	65.32 S 62.30 W	90.27' S 43.65 W		.82			
10895.00	9.75	S 74.00 W	94.00	10883.58	101.94	69.36 S 76.86 W	103.53' S 47.94 W		1.08			
10990.00	9.50	S 70.00 W	95.00	10977.29	116.55	74.01 S 91.19 W	117.45' S 50.94 W		1.03			
11084.00	11.00	S 71.00 W	94.00	11069.99	132.88	79.60 S 106.96 W	133.32' S 53.34 W		1.61			
11179.00	12.00	S 71.00 W	95.00	11162.83	151.34	85.76 S 124.86 W	151.48' S 55.52 W		1.05			
11273.00	11.50	S 71.00 W	94.00	11254.91	169.99	91.99 S 142.96 W	170.01' S 57.24 W		.53			
11367.00	10.25	S 71.00 W	94.00	11347.22	187.27	97.77 S 159.73 W	187.28' S 58.53 W		1.33			
11462.00	9.75	S 71.00 W	95.00	11440.78	203.34	103.14 S 175.33 W	203.42' S 59.53 W		.53			
11556.00	9.00	S 68.00 W	94.00	11533.52	218.35	108.50 S 189.67 W	218.51' S 60.23 W		.95			
11651.00	7.75	S 53.00 W	95.00	11627.51	232.13	115.30 S 201.68 W	232.31' S 60.24 W		2.64			
11745.00	6.25	S 50.00 W	94.00	11728.88	243.51	122.43 S 210.64 W	243.64' S 59.83 W		1.64			
11839.00	5.25	S 44.00 W	94.00	11814.33	252.75	128.85 S 217.53 W	252.82' S 59.36 W		1.24			

SANTE FE ENERGY COMPANY
CLYDESDALE 15 STATE NO. 1
WT-PP3S

PAGE 6
02:28:27
00/00/00

MEASURED	INCL.	HOLE	COURSE	VERTICAL	VERTICAL	RECTANGULAR	CLOSURE	DOG-LEG	
DEPTH	ANGLE	DIRECTION	LENGTH	DEPTH	SECTION	COORDINATES	DISTANCE	DIRECTION	SEVERITY
FEET	DEGS.	DEGS.	FEET	FEET	FEET	N/S feet E/W	FEET	DEGS.	DEG/100FT
11934.00	5.00	S 36.00 W	95.00	11900.95	260.82	135.34 S 222.98 W	260.84' S 58.74 W	.80	
12028.00	5.00	S 33.00 W	94.00	12002.59	268.33	142.09 S 227.62 W	268.33' S 58.03 W	.28	
12123.00	4.50	S 33.00 W	95.00	12097.27	275.46	148.69 S 231.90 W	275.48' S 57.33 W	.53	
12154.00	4.50	S 29.00 W	31.00	12128.17	277.62	150.77 S 233.15 W	277.66' S 57.11 W	1.01	
FINAL STATION IS PROJECTED									
12194.00	4.50	S 29.00 W	40.00	12168.05	280.37	153.52 S 234.68 W	280.43' S 56.81 W	0.00	

CLOSURE DISTANCE = 290.43 FEET.
CLOSURE DIRECTION = S 56.81 W

Santa Fe Energy Operating Partners, L.P.

Santa Fe Pacific Exploration Company
Managing General Partner

CERTIFIED MAIL - RETURN RECEIPT

May 4, 1989

PP-27

TOC-Gulf Coast, Inc.
14340 Torrey Chase Blvd.
Houston, Texas 77014

Re: Application of SFEOP, L.P. for
Directional Drilling
E/2 Sec. 15, T-16-S, R-36-E,
N.M.P.M., Lea County, New Mexico
Clydesdale "15" State Com #1
12,200' Atoka Test

Gentlemen:

This letter is to advise you that Santa Fe Energy Operating Partners, L.P. has filed an administrative application with the New Mexico Oil Conservation Division ("OCD") seeking approval to directionally drill a well on this E/2 pooled unit from an unorthodox surface location of 2300 feet from the South line and 500 feet from the East line to an orthodox bottom hole location within 100 feet of a standard bottom hole location at a point 2200 feet from the South line and 660 feet from the East line of Section 15, Township 16 South, Range 36 East, N.M.P.M., Lea County, New Mexico. This deviation is required due to topographical conditions.

As an offsetting owner, you have the right to be notified and present your objections, if any. Failure to enter an objection within 20 days with the OCD will preclude you from challenging the matter at a later date.

Santa Fe Energy Operating Partners, L.P. hereby requests you waive any objection to the above by signing and returning this letter to the OCD at P.O. Box 2088, Santa Fe, New Mexico 87504-2088 with a copy sent to the undersigned.

Permian Basin District
500 W. Illinois
Suite 500
Midland, Texas 79701
915/687-3551

An Affiliate of Santa Fe Southern Pacific Corporation

MAY 30 1989

OIL CONSERVATION DIV.
SANTA FE

Page 2
Offset Operators
May 4, 1989

Your prompt attention to this matter is most appreciated. Should you have any questions, feel free to give me a call.

Sincerely yours,

SANTA FE ENERGY OPERATING PARTNERS, L.P.
By: Santa Fe Pacific Exploration Company,
Managing General Partner

By: Patrick J. Tower
Patrick J. Tower, Senior Landman

PJT/efw

WE HEREBY WAIVE OUR RIGHT TO OBJECT TO SANTA FE ENERGY OPERATING PARTNERS, L.P.'s APPLICATION FOR DIRECTIONALLY DRILLING AS NOTED ABOVE.

INDIVIDUAL OR COMPANY
TOC-GULF COAST, INC.

By: Thomas M. Wadsworth
Thomas M. Wadsworth
Title: Attorney-in-Fact **ZED**
Date: May 23, 1989

**RETURN THIS COPY TO
SANTA FE ENERGY OPERATING PARTNERS, L.P.**

EFW377

JERRY L. WILLIAMS
ATTORNEY AT LAW
13 WEST WASHINGTON
POST OFFICE BOX 910
LOVINGTON, NM 88260
(505) 396-3053
May 26, 1989

DD-27

RECEIVED

MAY 30 1989

Oil Conservation Division
Attention: Michael Stogner
P. O. Box 2088
Santa Fe, NM 87504-2088

OIL CONSERVATION DIV.
SANTA FE

Re: Santa Energy Operating
Partners, L.P.; Clydesdale
State 15 No. 1; NE/4SE/4
of Section 15, T-16-S,
R-36-E, N.M.P.M., Lea
County, New Mexico

Gentlemen:

At the request of Mr. Vernon Dyer, District Land Manager for Santa Fe, I am forwarding to your office by way of this letter, copies of the following: Notice of Meeting of the Lovington--Lea County Extraterritorial Zoning Authority which was mailed to surrounding land owners along with the Proof of Notice concerning such mailing; a copy of the legal notice published in the Lovington Daily Leader on May 5, 1989, concerning the Lovington--Lea County Extraterritorial Zoning Authority meeting on May 24, 1989, at which the Authority voted to approve Santa Fe's request for a variance to drill the Clydesdale State 15 No. 1; and a copy of the legal notice published in the Lovington Daily Leader on May 16, 1989, concerning the directional drilling of the well.

Finally, I am enclosing herewith a copy of the form of Variance to Lovington--Lea County Extraterritorial Zoning Ordinance which was approved at the Authority meeting on May 24, 1989; and my understanding from the Authority's attorney is that the original of the Variance has been signed and is being processed and recorded. I trust that the enclosed copy will be sufficient for your records.

Very truly yours,

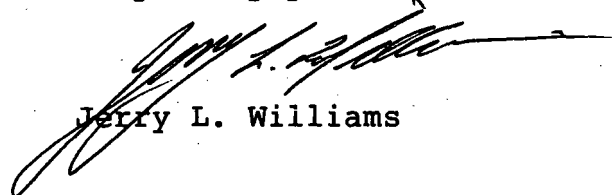

Jerry L. Williams

JLW/spc
Enclosures

Copy to: Vernon Dyer
District Land Manager
Santa Fe Energy Operating Partners, L.P.
500 West Illinois
Midland, TX 79701
(with enclosures)

NOTICE OF MEETING OF LOVINGTON--LEA COUNTY
EXTRATERRITORIAL ZONING AUTHORITY

NOTICE IS HEREBY GIVEN, pursuant to §3-21-6B, N.M.S.A., 1978 Comp., that upon petition of Santa Fe Energy Operating Partners, L.P., the Lovington--Lea County Extraterritorial Zoning Authority will meet on May 24, 1989, to consider a request to:

Grant a variance to the Lovington--Lea County Extraterritorial Zoning Ordinance for the purpose of allowing Santa Fe Energy Operating Partners, L.P., to drill and equip an oil and/or gas well in an area zoned R-3 (Commercial) at a location in the Northeast Quarter of the Southeast Quarter (NE/4SE/4) of Section 15, Township 16 South, Range 36 East, N.M.P.M., Lea County, New Mexico, at a site 2,300 feet from the south line and 500 feet from the east line of Section 15, Township 16 South, Range 36 East, or at a point within a radius of 300 feet of said location not within the Lovington city limits, and if such well is successfully completed, to equip and operate such well with production equipment, storage facilities and production and transportation facilities.

The petition and recommendation by the Extraterritorial Zoning Commission to approve said petition will be

TO: THE LOVINGTON--LEA COUNTY EXTRATERRITORIAL
ZONING AUTHORITY

IN THE MATTER OF THE PETITION OF)
SANTA FE ENERGY OPERATING PARTNERS, L.P.)
FOR VARIANCE TO THE CITY OF LOVINGTON--)
LEA COUNTY EXTRATERRITORIAL ZONING)
ORDINANCE)

PROOF OF NOTICE

STATE OF NEW MEXICO)
 : SS
COUNTY OF LEA)

The undersigned, JERRY L. WILLIAMS, states that a copy of the attached Petition for Variance to City of Lovington--Lea County Extraterritorial Zoning Ordinance and Notice of Meeting of the Lovington--Lea County Extraterritorial Zoning Authority on said Petition was delivered or mailed by Certified Mail, Return Receipt Requested, to the following owners of lots or land in the immediate area of the proposed well location proposed to be drilled by Santa Fe Energy Operating Partners, L.P. In support of the mailing, the undersigned states that the proposed well is to be drilled upon property owned by Dorothy Runnels Clendenen, whose address is Box 937, Lovington, New Mexico, 88260,. There are no land owners other than Dorothy Runnels Clendenen who are or may be within 100 feet of the proposed well location, exclusive of public right-of-way; however, there are other land owners whose lands are adjacent to or in the general area of the land upon which would be situated the oil and gas well for which a variance is sought; and mailing of Notice to all the following is appropriate, to-wit:

<u>Name</u>	<u>Address</u>	<u>Mailing Date</u>
Dorothy Runnels Clendenen	Box 937 Lovington, NM 88260	May 3, 1989
Liberty National Bank	P. O. Box 700 Hobbs, NM 88240	May 3, 1989
	P. O. Box 1627 Lovington, NM 88260	May 3, 1989
Rolla G. West	136 Rawlings Clinton, OK 73601	May 3, 1989

<u>Name</u>	<u>Address</u>	<u>Mailing Date</u>
Larry Bradford, Larry B. Bradford, or Larry V. Bradford	Box 783 Lovington, NM 88260	May 3, 1989
Earnest Robinson	705 West Polk Lovington, NM 88260	May 3, 1989
State Highway Depart- ment of New Mexico	Box 1149 Santa Fe, NM 87504	May 3, 1989
and	Box 1641 Santa Fe, NM 87501	May 3, 1989
Gerald Dean	Box 69 Capitan, NM 88316	May 3, 1989
Dorrel M. Ditmore	P. O. Box 1387 Lovington, NM 88260	May 3, 1989
Joanne Taylor, Darcy Devoll, Jr., and Joseph F. Devoll	211 W. Ave. O Lovington, NM 88260	May 3, 1989
Danny J. Watson	Rt. 1, Box 37W Lovington, NM 88260	May 3, 1989
I & W Transportation, Inc.	P. O. Box 939 Lovington, NM 88260	May 3, 1989
Clarke, Louie P.	Box 968 Lovington, NM 88260	May 3, 1989
Winfred L. Stroope	611 S. 13th St. Lovington, NM 88260	May 3, 1989
Elizabeth Lea Daugherty	P. O. Box 1356 Lovington, NM 88260	May 3, 1989
W.H.B., Inc.	Box 698 Lovington, NM 88260	May 3, 1989
Carol Sanders	1303 West Ave. H Lovington, NM 88260	May 3, 1989
Leroy Sumruld Trust & and Leroy Sumruld	Box 906 Lovington, NM 88260	May 3, 1989
Shelby H. Gilmore	Box 1865 Lovington, NM 88260	May 3, 1989
Connecticut Mutual Life Insurance Co.	140 Garden Street Mail Station 240 Hartford, CN 06154	May 3, 1989
Richard Henry Lovewell	125 Simpson Dr. Lovington, NM 88260	May 3, 1989
Elizabeth Herrera	102 S. 8th Lovington, NM 88260	May 3, 1989
Dave M. Gutierrez	113 Simpson Dr. Lovington, NM 88260	May 3, 1989
Joe York	P. O. Box 394 Tatum, NM 88267	May 3, 1989
Jerry Lee Olliff	109 Simpson Dr. Lovington, NM 88260	May 3, 1989

<u>Name</u>	<u>Address</u>	<u>Mailing Date</u>
Oscar Bernal & Vienna R. Bernal	105 Simpson Dr. Lovington, NM 88260	May 3, 1989
Glynn Weant	c/o Dennis Alder ESR, Box 19 Lovington, NM 88260	May 3, 1989
Bill Irwin & Barbara J. Irwin	1308 East Harrison Lovington, NM 88260	May 3, 1989
Ruth Mae Battles Trust & Monette Walker	2109 N. Cielo Hobbs, NM 88240	May 3, 1989
W. I. Green	Box 1227 Lovington, NM 88260	May 3, 1989
Dale Q. Wood	c/o Mrs. C. D. Rogers P. O. Box 327 Post, TX 79356	May 3, 1989
Harvey L. Blancet	Rt. 1, 710 E. Gum Lovington, NM 88260	May 3, 1989
Hector Javier Hernandez	917 W. Taylor Lovington, NM 88260	May 3, 1989
Nazario Hernandez	102 Simpson Dr. Lovington, NM 88260	May 3, 1989
Elvin Shipley	3323 S. Main Lovington, NM 88260	May 3, 1989
Alex Aguilar	3313 S. Main Lovington, NM 88260	May 3, 1989
Occupant	3303 S. Main Lovington, NM 88260	May 3, 1989
Occupant	3101 S. Main Lovington, NM 88260	May 3, 1989
Sandy E. Jones & Shirley Jones	3719 S. Main Lovington, NM 88260	May 3, 1989
Thomas G. Bill	HCR 70, Box 1 Lovington, NM 88260	May 3, 1989

DATED May 3, 1989.

JERRY L. WILLIAMS, Attorney
for Santa Fe Energy Operating
Partners, L.P.

SUBSCRIBED AND SWORN TO before me this 3rd day of
May, 1989.

My Commission Expires:

December 17, 1990

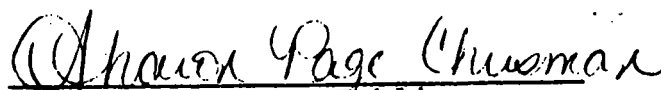
Notary Public

scribed in
at the in-
and State
New Mex-

scribed in
at the in-
Street and
ment, New

scribed in
d at the
intersection
nd State
New Mex-

scribed in
ed at the
intersection
nd State
New Mex-

scribed in
l at the
intersection
co. Highway

scribed in
the nor-
section of
highway 8

scribed in
ed at the
tersection
Highway
co.

is more
nder its
on on file
highway
ted New

Jct. NM
Mexico.
e hereby
amount
ensation,
umerical
is been

with the
ind a por-
ered may
aving an
property

the Peti-
er the ex-
filing of
I may be

he Court

hereby
erve an
w, to the
on thirty

s Notice
fter the
of this
ersonally
ear and
apply to
provided
I fix the

**LEGAL NOTICE
FIFTH JUDICIAL
DISTRICT COURT
COUNTY OF LEA
STATE OF
NEW MEXICO
IN THE MATTER OF THE
ESTATE OF MAGGIE BEATRICE
TARRY, DECEASED
PROBATE NO. PB89-11-J
NOTICE OF HEARING ON PETI-
TION FOR ORDER OF COM-
PLETE SETTLEMENT OF
ESTATE BY SPECIAL AD-
MINISTRATOR
THE STATE OF NEW MEXICO,
TO:**

Lester S. Tarry, Lester S. Tarry, Jr., Francis Pearl Spears, Kirby Bruce Tarry, Ruby Earl Pebsworth; the unknown heirs of Maggie Beatrice Tarry, deceased; and all unknown persons claiming any lien upon or right, title or interest in or to the Estate of Maggie Beatrice Tarry, deceased, GREETING:

You and each of you are hereby notified that Lester S. Tarry, Jr., Special Administrator of the estate of Maggie Beatrice Tarry, deceased, has filed his Petition for Order of Complete Settlement of Estate by Special Administrator; and you are further notified that on Monday, the 22nd day of May, 1989, at 9:00 o'clock A.M., at the District Courtroom in the Courthouse at Lovington, Lea County, New Mexico, the District Court of said County and State, pursuant to an Order duly made and entered, will hear objections, if any, to said Petition for Order of Complete Settlement of Estate by Special Administrator, and the settlement thereof, and the release and discharge of said Special Administrator, and will proceed to finally determine the intestacy and heirship of said decedent, the ownership of her estate, the interest of each respective claimant thereto or therein, and the persons entitled to the distribution thereof.

Jerry L. Williams, Post Office Box 910, Lovington, New Mexico, 88260, is the Attorney for the Special Administrator.

IN WITNESS WHEREOF, I have hereunto set my hand and affixed the seal of the District Court of Lea County, New Mexico, this 26th day of April, 1989.

GEORGIENAL SMITH
Clerk of the District Court
Lea County, New Mexico
(SEAL) By Debra Cleer
Deputy

Published in the Lovington Daily Leader April 28 and May 5, 1989.

STRAW
AND CLAY
WILMINGTON, Del. (AP)

**LEGAL NOTICE
There will be a meeting of the
Lovington-Lea County Extra Ter-
ritorial Zoning Authority on Wednes-
day, May 24, 1989, beginning at 8:00
o'clock A.M., in the County Commis-
sioners Meeting Room, Lea County
Courthouse, Lovington, NM.
Purpose of the meeting will be to
consider a request from Santa Fe
Energy Operating Partners, L.P. for
a variance to drill an oil well in the
Northeast Quarter of the Southeast
Quarter of Section 15, Township 16
South, Range 36 East, N.M.P.M.,
Lea County, New Mexico.
LOVINGTON-LEA COUNTY
EXTRA
TERRITORIAL ZONING
AUTHORITY**

Carl Baldwin
Chairman
Published in the Lovington Daily
Leader May 5, 1989.

**LEGAL NOTICE
INVITATION TO BID
Bid #30-88,89**

NOTICE IS HEREBY GIVEN
That sealed proposals for JAKE Mc-
CLURE RODEO ARENA TOILET
FACILITIES, LEA COUNTY
FAIRGROUNDS, LOVINGTON,
NEW MEXICO, FOR THE BOARD
OF COUNTY COMMISSIONERS,
LEA COUNTY, NEW MEXICO, will
be received by the County Manager
in the Commission Chambers, Lea
County Courthouse, Lovington, New
Mexico, until 2:00 p.m., local
prevailing time, on Thursday, May
18, 1989 and then publicly opened and
read aloud. Bids received after this
time will be returned unopened.

The proposal will embody
statements to the effect that the bid
is accompanied by an acceptable bid
bond, cashier's check or certified
check in a sum not less than five per-
cent (5%) of the maximum bid,
payable to the Owner, with the
understanding that if the proposal is
accepted the Bidder will within ten
(10) days thereafter enter into a con-
tract for such work.

Bids may not be withdrawn after
the bid opening for at least thirty
(30) days, or until Notice of Award of
Contract or Rejection of Proposal
has been received.

In case of failure of the successful
Bidder to enter into a contract and
give acceptable performance bond,
the bid bond or certified check shall
be forfeited to the Owner as li-
quidated damages; otherwise it will
be returned to the Bidder within thirty
(30) days from the date of opening
bids.

Sets of plans, specifications and
proposal forms are on file and may
be examined at: Office of the County

quired, the full amount of which will
be repaid to each actual bidder. Con-
tractor's sets must be returned to the
Architect not later than (5) days
after opening of bids. Supplier's sets
must be returned to the Architect
within ten (10) days after receipt of
same. Individual sheets of plans will
be furnished on request for ten
dollars (\$10.00) per sheet. Specifica-
tions will be furnished at twenty-five
dollars (\$25.00) per set.

The Contract, when awarded, may
be with or without alternates, or one
or more alternates may be accepted
and the other or others rejected.
Decision as to the base bid and as to
the alternates, or which one or ones,
if any or none, is the sole discretion
of the Owner. The Owner reserves
the right to reject any or all bids and
to accept any or all bids, to waive
defects, and to waive any or all for-
malities or irregularities or
technicalities. All bids may be held
thirty (30) days after receipt of bids.

Proposals not submitted in accor-
dance with the detailed plans and
specifications and not upon forms
provided for the purpose will be con-
sidered irregular and the Owner
reserves the right to reject bids so
submitted.

Attention of bidders is particularly
called to the requirements as to con-
ditions of employment to be observ-
ed and minimum wage rates to be
paid under contract.

**BOARD OF COUNTY
COMMISSIONERS
LEA COUNTY, NEW MEXICO
S/Carl Baldwin
Chairman**

Published in the Lovington Daily
Leader May 5, 1989.

COLUMBIA, S.C. (AP) —
The Rev. Jesse Jackson says
jailed soul singer James
Brown should be allowed to
give a television interview to
the French government as
part of its bicentennial
celebration.

Jackson visited Brown at
State Park Correctional
Center on Thursday and ask-
ed that the singer be allowed
to give the interview.

"James Brown's musical
contribution has earned him
that honor," Jackson said
after meeting with Brown.

Brown is serving a six-year
sentence for aggravated
assault and failing to stop for
police during a chase across
the Georgia-South Carolina
border.

Just do this show.' We'd all have to help her out."

According to the Radnor-based magazine, executive producer Matt Williams left the show after Barr said either he or she had to leave. Ellen Falcon, the show's director, also left the series in mid-season.

The magazine quoted unidentified insiders with the show as saying Barr and Williams disagreed strongly over her character's development.

MONTGOMERY, Ala. (AP) — Former Gov. George C. Wallace, bedridden and unable to hear or see well, promised a return to better health on the 17th anniversary of the assassination attempt that shattered his presidential dreams.

"I can't be as active as I've been," said the 69-year-old Wallace, who was left paralyzed in the legs after being shot by Arthur Bremer while campaigning in Laurel, Md., on May 15, 1972.

In an interview with The Alabama Journal published Monday, Wallace said complications in his left hip forced him to curtail his activities. The newspaper gave no details on the ailment.

Wallace said he hopes to resume duties this week for Troy State University, which he serves out of a Montgomery office. He said he has been signing letters seeking contributions for the school.

his show needs."

Goldberg said \$20 tickets for the July 1 show at the 9,000-seat Civic Center Arena would go on sale Saturday. He predicted a quick sellout in the town famed for the show-business phrase, "Will it play in Peoria?"

"His finally playing here shows that Peoria will support top-name talent," Goldberg said.

Other details about the tour were not announced.

IRVINE, Calif. (AP) — Margo Adams' lawyer said he will subpoena five teammates of Wade Boggs to testify in Adams' lawsuit against the Boston Red Sox third baseman.

Attorney James McGee said Monday the subpoenas order Jim Rice, Marty Barrett, Rich Gedman, Dennis "Oil Can" Boyd and Dwight Evans to testify in Boston June 12-15. They will be asked "to check the accuracy and truthfulness of what (Boggs and Adams) have given on their depositions," he said.

Adams claims that Boggs, her former lover, promised to support her when she quit her job to travel on the road with him during four seasons. In a deposition Monday to Boggs' attorney, she claimed her damages are "in excess of a half-million dollars and are continuing," McGee said.

Boggs was to continue his deposition today in McGee's Irvine office.

Livestock Market Report

We sold 356 hd of livestock Friday. The market was active with good buyer attendance. Packer cows sold from 43.00 to 50.00. Bulls 54.00 to 63.25. Feeder strers mostly 73.00 to 78.00. Hfrs 68.00 to 73.00. Stocker str calves 85.00 to 100.00. Hfrs 75.00 to 85.00. Cow and clf prs 550.00 to 750.00. Gred cows 400.00 to 600.00.

B&D Cattle, Hobbs, 10 corr str, 655, 61.00; Johnny Cartwright, Lov., hol str, 595, 63.50; E.W. Cox, Hobbs, 2 mix str, 550, 78.75; red wf str, 620, 85.50; Dasco Land & Cattle, 2 blk cow, 875, 48.00; blk cow, 780, 50.25; 4F Cattle, Denver City, blk cow & clf pr, 545.00; Larry Gregory, Hobbs, bwf str, 505, 85.00; and mix hfr, 480, 78.50;

I.R. Henry, Lov., char cow & clf pr, 680.00; Steve Herwig, Hobbs, red str, 695, 72.00; Delynn Jones, Hobbs, 4 red wf hfr, 380, 78.00; C.K. Cattle, Clovis, char cow & clf pr, 750.00; Dennis Nix, Lamesa, char cow per hd, 600.00; Richardson & Hidel, Lov, 15 mix hfr, 469, 80.00; 15 mix hfr, 528, 78.50; and 7 mix hfr, 540, 48.25; Rockview Dairy, Hobbs, hol cow, 1370, 48.25; Ed Steele, Lov., blk bull, 900, 63.75; Taylor & Heidel Inc., Lov., 2 blk hfr, 405, 84.00; blk bull, 430, 93.00; 3 mix bull, 225, 124.50; and 2 blk hfr, 305, 87.50; Mel Vuicich, Seminole, red bull, 1355, 63.25; Ray Whitman, Lov., 6 hol str, 664, 62.50; Marilyn Wiggins, Lov., 3 blk cow & clf pr, 625.00 and 4 blk cow & clf pr, 610.00.

LEGAL NOTICE BEFORE NMOCD

SANTA FE ENERGY OPERATING PARTNERS, L.P. has applied to the New Mexico Oil Conservation Division for approval to directionally drill a well on the E/2 of Section 15, T-16-S, R-36-E, N.M.P.M., Lea County, New Mexico from an unorthodox surface location of 2300' FSL and 500' FEL to a bottom hole location within 100' of an orthodox location at a point 2200' FSL and 660' FEL of said Section 15. This deviation is required due to topographical conditions.

Any offset mineral or leasehold interest owner has the right to present objections, if any, to this application. Failure of any offset mineral or leasehold interest owner to object by June 7, 1989 will preclude such offset owner from challenging the matter at a later date.

SANTA FE ENERGY OPERATING PARTNERS, L.P.

By: Santa Fe Pacific Exploration Company,
Managing General Partner
Published in the Lovington Daily Leader May 16, 1989.

SALE PRICE \$9,699

I'M GOING TO TRY TO
BREAK THE HIGH-
ALTITUDE RECORD!

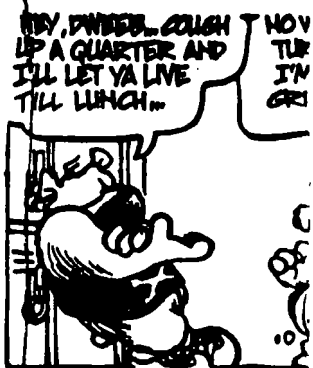
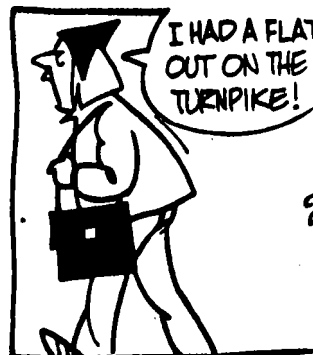

New Mexico Briefs

SIERRA VISTA, Ariz. (AP) — The Aerostat anti-drug radar balloon damaged by a dust devil last week in Arizona is being packed for shipment to North Carolina for repair, a Customs Service official said.

The balloon, which was damaged Wednesday while moored close to the ground at Fort Huachuca after being lowered in anticipation of high winds, has "at least one huge 15- to 20-foot rip" and possibly several smaller ones, said Gerald Young, head of the Tucson aviation

Customs Service.

As expected, the damage was at the mooring points on the fabric, Young said Monday. Also, representatives of Westinghouse Defense and Electronic Systems Co., the contractor, confirmed over the weekend that wind caused the damage, Young said.

The balloon is being packed this week and will be trucked to a Westinghouse factory in North Carolina for repair, a process expected to take at least four or five weeks, Young said. The

Affidavit of Publication

STATE OF NEW MEXICO)
) ss.
COUNTY OF LEA)

Joyce Clemens being first duly sworn on oath deposes and says that he is Adv. Director of THE LOVINGTON DAILY LEADER, a daily newspaper of general paid circulation published in the English language at Lovington, Lea County, New Mexico; that said newspaper has been so published in such county continuously and uninterruptedly for a period in excess of Twenty-six (26) consecutive weeks next prior to the first publication of the notice hereto attached as hereinafter shown; and that said newspaper is in all things duly qualified to publish legal notices within the meaning of Chapter 167 of the 1937 Session Laws of the State of New Mexico.

That the notice which is hereto attached, entitled

Legal Notice

Before NMOCD

and numbered in the

..... Court of Lea County, New Mexico, was published in a regular and entire issue of THE LOVINGTON DAILY LEADER and not in any supplement thereof, once each week on the same day of the week, for one (1)

consecutive weeks, beginning with the issue of

May 16, 19 89

and ending with the issue of

May 16, 19 89

And that the cost of publishing said notice is the sum of \$ 8.82

which sum has been (Paid) (Assessed) as Court Costs

Subscribed and sworn to before me this 24th

day of May, 19 89

Notary Public, Lea County, New Mexico

My Commission Expires Sept. 28, 19 90

LEGAL NOTICE BEFORE NMOCD

SANTA FE ENERGY OPERATING PARTNERS, L.P. has applied to the New Mexico Oil Conservation Division for approval to directionally drill a well on the E/2 of Section 15, T-16-S, R-36-E, N.M.P.M., Lea County, New Mexico from an unorthodox surface location of 2300' FSL and 500' FEL to a bottom hole location within 100' of an orthodox location at a point 2200' FSL and 660' FEL of said Section 15. This deviation is required due to topographical conditions.

Any offset mineral or leasehold interest owner has the right to present objections, if any, to this application. Failure of any offset mineral or leasehold interest owner to object by June 7, 1989 will preclude such offset owner from challenging the matter at a later date.

SANTA FE ENERGY
OPERATING PARTNERS, L.P.
By: Santa Fe Pacific
Exploration Company,
Managing General Partner
Published in the Lovington Daily
Leader May 16, 1989.

VARIANCE TO LOVINGTON--LEA COUNTY EXTRATERRITORIAL ZONING
ORDINANCE

CONCERNING A VARIANCE FROM THE LOVINGTON--LEA COUNTY EXTRATERRITORIAL ZONING ORDINANCE FOR AN OIL AND GAS WELL IN THE NORTHEAST QUARTER OF THE SOUTHEAST QUARTER (NE/4SE/4) OF SECTION 15, TOWNSHIP 16 SOUTH, RANGE 36 EAST, N.M.P.M., LEA COUNTY, NEW MEXICO

At a regularly called meeting of the Lovington--Lea County Extraterritorial Zoning Authority on the 24th day of May, 1989, held at the Lea County Courthouse in Lovington, New Mexico, at 8:00 A.M. in the meeting room of the County Commissioners, with a quorum of members of said Authority being present, and

WHEREAS, Santa Fe Energy Operating Partners, L.P., has filed a Petition with the Lovington--Lea County Extraterritorial Zoning Authority that a variance be granted allowing Petitioner to drill an oil and/or gas well, and if successful, to equip and operate said well with production and related facilities, in the Northeast Quarter of the Southeast Quarter (NE/4SE/4) of Section 15, Township 16 South, Range 36 East, N.M.P.M., Lea County, New Mexico, at a location which lies 2,300 feet from the south line and 500 feet from the east line of Section 15, Township 16 South, Range 36 East, or at a point within a radius of 300 feet of said location, and not within the Lovington city limits; and

WHEREAS, the Lovington--Lea County Extraterritorial Zoning Commission approved the Petition of the Petitioner on April 25, 1989, recommending that same be approved by the Lovington--Lea County Extraterritorial Zoning Authority, and

WHEREAS, the Lovington--Lea County Extraterritorial Zoning Authority finds that Petitioner has met all legal requirements herein, and due and proper notice of the meeting of the Lovington--Lea County Extraterritorial Zoning Authority has been had;

NOW, THEREFORE, BE IT RESOLVED that Petitioner, Santa Fe Energy Operating Partners, L.P., be, and it hereby is, granted a variance to the Lovington--Lea County Extraterritorial Zoning Ordinance for the purpose of allowing Santa Fe Energy Operating Partners, L.P., to drill and equip an oil and/or gas well at a location which lies 2,300 feet from the south line and 500 feet from the east line of Section 15, Township 16 South, Range 36 East, N.M.P.M., Lea County, New Mexico, and if such well is successfully completed, to obtain commercial production and to equip and operate said well with production equipment and related facilities necessary for the well's operation and marketing of product therefrom.

LOVINGTON--LEA COUNTY EXTRA-
TERRITORIAL ZONING AUTHORITY

By Cal B. Blum
Chairman

ATTEST:

Rinda Smith
Secretary

STATE OF NEW MEXICO
COUNTY OF LEA
FILED

MAY 26 1989

at 2:46 o'clock P. M.

and recorded in Book _____

Page _____

Shirley Hooper, Lea County Clerk

Shirley Hooper



046833



Santa Fe Energy Operating Partners, L.P.

Santa Fe Pacific Exploration Company
Managing General Partner

April 20, 1989

Mr. William J. Lemay
Director
Oil Conservation Division
P. O. Box 2088
Santa Fe, NM 87504-2088

Re: Clydesdale 15 State No. 1
660' FEL & 2200' FSL
Sec. 15, T-16S, R-36E
Lea County, New Mexico

Dear Sir:

Santa Fe Energy Operating Partners, L.P. respectfully requests administrative approval to directionally drill the subject well from an unorthodox surface location to an orthodox bottom hole location.

Because of topographical circumstances as outlined on the attached Form C-102 labeled Exhibit 1, an unorthodox surface location is necessary. The orthodox location is within the Lovington city limits and closer than 300' to an occupied house and an occupied business building as the plat shows.

Santa Fe proposes to use the surface location indicated on the attached Form C-102 labeled Exhibit 2 (500' FWL & 2300' FSL) and directionally drill the well such that all of the potentially productive pay zones would be encountered at orthodox locations and the wellbore at T.D. would be at the orthodox location of 660' FEL and 2200' FSL.

Exhibit 3 is a schematic drawing indicating the proposed path of the wellbore which would be necessary to accomplish this.

Permian Basin District
500 W. Illinois
Suite 500
Midland, Texas 79701
915/687-3551

RECEIVED

APR 25 1989

OCD

HOBS OFFICE

Mr. William J. Lemay
Page 2
April 20, 1989

All of the offset proration unit operators have been notified of this application.

If you need any more information from us, please advise.

Sincerely,

SANTA FE ENERGY OPERATING PARTNERS, LP
By Santa Fe Pacific Exploration Company
as Managing General Partner

By Michael R. Burton
Michael R. Burton
District Drilling Engineer

MRB:dw-1025

Attachment

cc: J. T. Sexton
Oil Conservation Division
District I, Hobbs, NM

RECEIVED
APR 22 1989
OCC
HOBBS OFFICE

RECEIVED

APR 25 1989

**OCD
MOBBS OFFICE**

Submit to Appropriate
District Office
State Lease - 6 copies
Fee Lease - 5 copies

State of New Mexico
Energy, Minerals and Natural Resources Department

Form C-101
Revised 1-1-89

OIL CONSERVATION DIVISION

DISTRICT I
P.O. Box 1980, Hobbs, NM 88240

DISTRICT II
P.O. Drawer DD, Artesia, NM 88210

DISTRICT III
1000 Rio Brazos Rd., Aztec, NM 87410

P.O. Box 2088

Santa Fe, New Mexico 87504-2088

API NO. (assigned by OCD on New Wells)

5. Indicate Type of Lease

STATE ☒

FEE ☐

6. State Oil & Gas Lease No.

APPLICATION FOR PERMIT TO DRILL, DEEPEN, OR PLUG BACK

1a. Type of Work:

DRILL ☒

RE-ENTER ☐

DEEPEN ☐

PLUG BACK ☐

b. Type of Well:

OIL
WELL ☐

GAS

WELL ☒

OTHER

SINGLE
ZONE ☐

MULTIPLE
ZONE ☐

7. Lease Name or Unit Agreement Name

Clydesdale 15 State

2. Name of Operator

Santa Fe Energy Operating Partners, L.P.

8. Well No.

1.

3. Address of Operator

500 W. Illinois, Suite 500, Midland, TX 79701

9. Pool name or Wildcat Wildcat &
North Lovington Atoka

4. Well Location

Unit Letter I : 660 Feet From The East Line and 2200 Feet From The South Line

Section 15

Township 16S

Range 36E

NMPM

Lea

County

10. Proposed Depth

12,200'

11. Formation

Atoka

12. Rotary or C.T.

Rotary

13. Elevations (Show whether DF, RT, GR, etc.)

3881.4'

14. Kind & Status Plug. Bond

Blanket - current

15. Drilling Contractor

To be determined

16. Approx. Date Work will start

ASAP

17. PROPOSED CASING AND CEMENT PROGRAM

SIZE OF HOLE	SIZE OF CASING	WEIGHT PER FOOT	SETTING DEPTH	SACKS OF CEMENT	EST. TOP
17 1/2"	13 3/8"	48.0	450'	500	Surface
11"	8 5/8"	24.0 & 32.0	4930'	3500	Surface
7 7/8"	5 1/2"	17.0	12200'	1200	Surface

Move in and rig up rotary tools. Drill a 17 1/2" hole to 450'. Run and cement 13 3/8" casing with 500 sacks Class C containing 2% CaCl₂. Nipple up BOP and test to 600 psi/30 minutes. Drill an 11" hole to 4930' (50'+ into San Andres). Run and cement 8 5/8" casing with sufficient lite cement containing 10% salt, 6% gel, and 1/4#/sk cellophane flakes to circulate to surface when followed by 350 sx Cl C, 2% CaCl₂. Nipple up BOP and test to 3000 psi. Drill a 7 7/8" hole to 9500'+. Run multishot survey. Directionally drill from 9500' to TD such that location of wellbore at TD will be a standard location. Run logs. Run and cement 5 1/2" casing or plug and abandon as per NMOCC rules.

IN ABOVE SPACE DESCRIBE PROPOSED PROGRAM: IF PROPOSAL IS TO DEEPEN OR PLUG BACK, GIVE DATA ON PRESENT PRODUCTIVE ZONE AND PROPOSED NEW PRODUCTIVE ZONE. GIVE BLOWOUT PREVENTER PROGRAM, IF ANY.

I hereby certify that the information above is true and complete to the best of my knowledge and belief.

SIGNATURE Michael R. Burton TITLE Sr. Drilling Engineer DATE 4-17-89

TYPE OR PRINT NAME MICHAEL R. BURTON TELEPHONE NO. 915-687-355

(This space for State Use)

APPROVED BY _____ TITLE _____ DATE _____

CONDITIONS OF APPROVAL, IF ANY:

OIL CONSERVATION DIVISION

DISTRICT I
P.O. Box 1980, Hobbs, NM 88240

DISTRICT II
P.O. Drawer DD, Artesia, NM 88210

DISTRICT III
1000 Rio Brazos Rd., Aztec, NM 87410

WELL LOCATION AND ACREAGE DEDICATION PLAT

All Distances must be from the outer boundaries of the section

Operator Santa Fe Energy Operating Partners LP		Lease		Well No. 1	
Unit Letter I	Section 15	Township 16 South	Range 36 East	County Lea	
Actual Footage Location of Well: 2200 feet from the south line and 660 feet from the east line					
Ground level Elev. 3882.8'	Producing Formation ATOKA		Pool WILDCAT -N. LOVINGTON ATOKA		Dedicated Acreage: 320 Acres

1. Outline the acreage dedicated to the subject well by colored pencil or hatchure marks on the plat below.
2. If more than one lease is dedicated to the well, outline each and identify the ownership thereof (both as to working interest and royalty).
3. If more than one lease of different ownership is dedicated to the well, have the interest of all owners been consolidated by communitization, unitization, force-pooling, etc.?
- ☒ Yes ☐ No If answer is "yes" type of consolidation COMMUNITIZATION
- If answer is "no" list the owners and tract descriptions which have actually been consolidated. (Use reverse side of this form if necessary.)
- No allowable will be assigned to the well until all interests have been consolidated (by communitization, unitization, forced-pooling, or otherwise) or until a non-standard unit, eliminating such interest, has been approved by the Division.

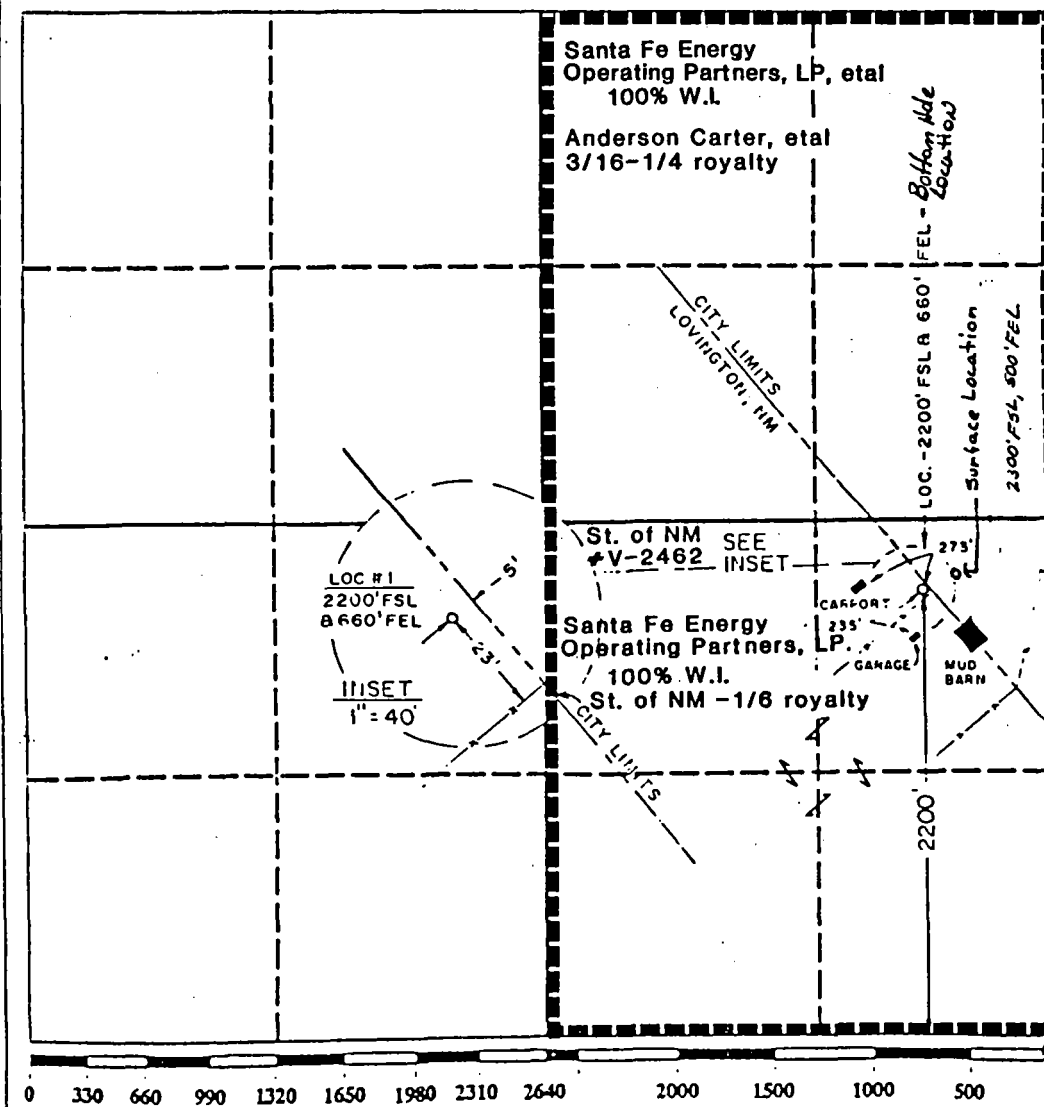

OPERATOR CERTIFICATION

I hereby certify that the information contained herein is true and complete to the best of my knowledge and belief.

Signature _____

Michael R. Burton

Printed Name _____

Michael R. Burton

Population

District Drilling Engineer

Company

Santa Fe Energy Operating, Partner
Date

Date _____

4/16/89

SURVEYOR CERTIFICATION

I hereby certify that the well location shown on this plat was plotted from field notes of actual surveys made by me or under my supervision, and that the same is true and correct to the best of my knowledge and belief.

Date Surveyed _____

February 22, 1989

Signature & Seal
Professional Surveyor

A circular professional seal for a Registered Professional Land Surveyor. The outer ring contains the text "REGISTERED PROFESSIONAL LAND SURVEYOR" at the top and "STATE OF NEW MEXICO" at the bottom. In the center, the name "JOHN W. WEST" is printed. Overlaid on the seal is a handwritten signature and the number "674". To the left of the seal, the text "Certificate No." is printed, with "John West" handwritten next to it.

State of New Mexico
Energy, Minerals and Natural Resources Department

OIL CONSERVATION DIVISION

P.O. Box 2088
Santa Fe, New Mexico 87504-2088

Submit to Appropriate
District Office
State Lease - 4 copies
Fee Lease - 3 copies

DISTRICT I
P.O. Box 1980, Hobbs, NM 88240

DISTRICT II
P.O. Drawer DD, Artesia, NM 88210

DISTRICT III
1000 Rio Brazos Rd., Aztec, NM 87410

WELL LOCATION AND ACREAGE DEDICATION PLAT

All Distances must be from the outer boundaries of the section

Operator Santa Fe Energy Operating Partners, LP			Lease Clydesdale State 15		Well No. 1
Unit Letter I	Section 15	Township 16 South	Range 35 East	County Lea	NMPM
Actual Footage Location of Well: 2300 feet from the south line and 500 feet from the east line					
Ground level Elev. 5881.4'		Producing Formation		Pool	Dedicated Acreage: Acres

1. Outline the acreage dedicated to the subject well by colored pencil or hatchure marks on the plat below.
2. If more than one lease is dedicated to the well, outline each and identify the ownership thereof (both as to working interest and royalty).
3. If more than one lease of different ownership is dedicated to the well, have the interest of all owners been consolidated by communitization, unitization, force-pooling, etc.?
☐ Yes ☐ No If answer is "yes" type of consolidation _____
If answer is "no" list the owners and tract descriptions which have actually been consolidated. (Use reverse side of this form if necessary).
No allowable will be assigned to the well until all interests have been consolidated (by communitization, unitization, forced-pooling, or otherwise) or until a non-standard unit, eliminating such interest, has been approved by the Division.

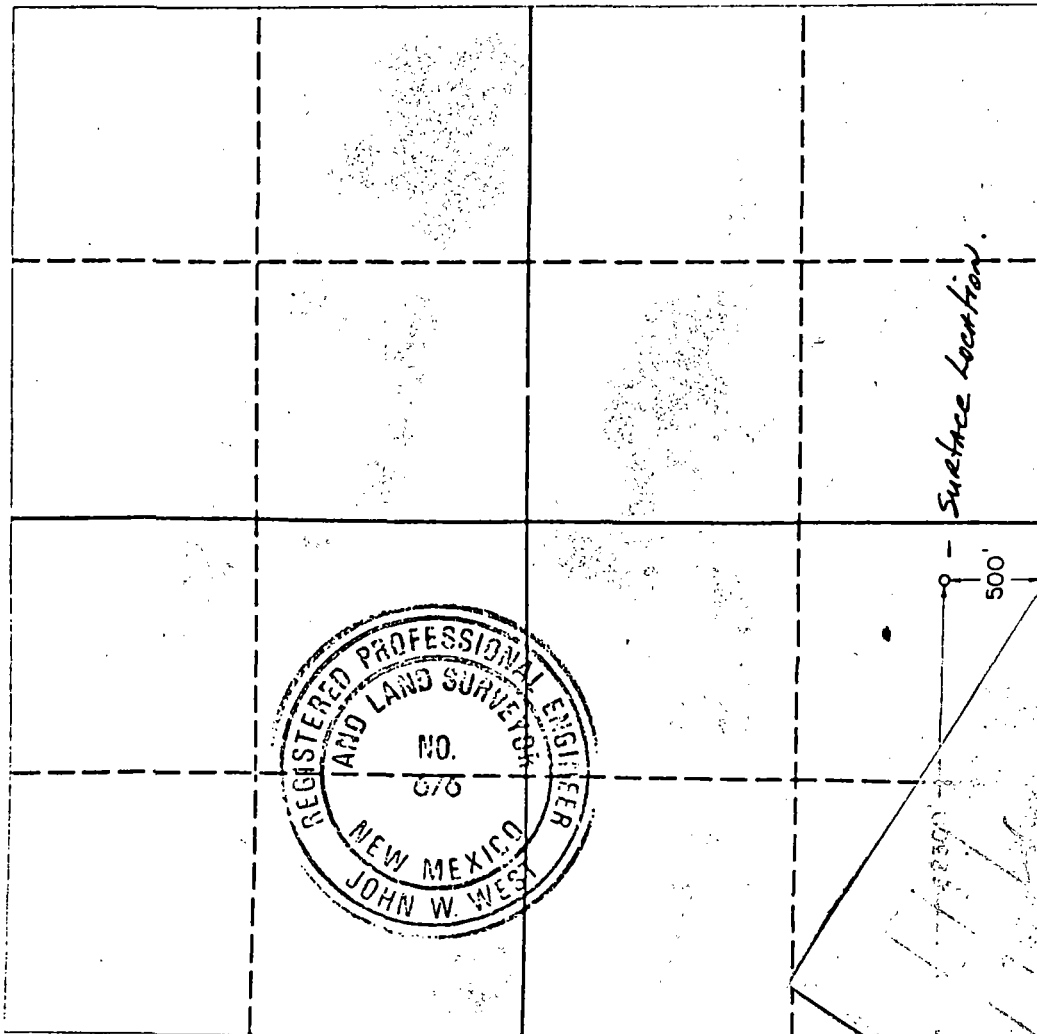

OPERATOR CERTIFICATE

I hereby certify that the
contained herein is true and
best of my knowledge and belief

Signature

Michael R.

Printed Name

Michael R.

Position

District Office

Company

Santa Fe

Date

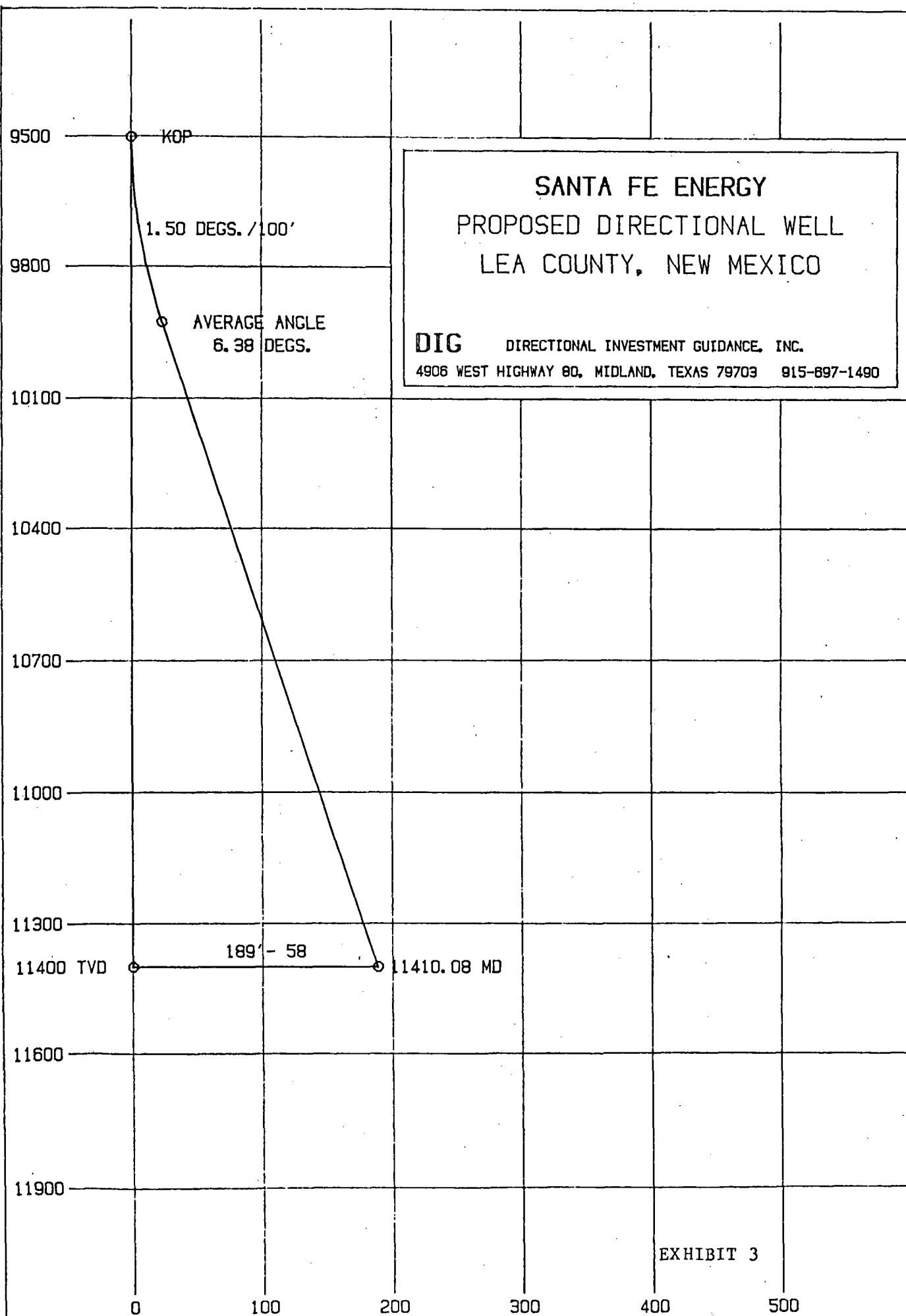

PAGE 1
00:56:05
00/00/00

CLOSURE DISTANCE = 188.68 FEET.
CLOSURE DIRECTION = N 58.00 E



Santa Fe Energy Operating Partners, L.P.

Santa Fe Pacific Exploration Company
Managing General Partner

CERTIFIED MAIL - RETURN RECEIPT

RECEIVED

MAY 15 1989

**OIL CONSERVATION DIV.
SANTA FE**

May 4, 1989

O'Neill Properties, LTD.
P.O. Box 2840
Midland, Texas 79702

Re: Application of SFEOP, L.P. for
Directional Drilling
E/2 Sec. 15, T-16-S, R-36-E,
N.M.P.M., Lea County, New Mexico
Clydesdale "15" State Com #1
12,200' Atoka Test

Gentlemen:

This letter is to advise you that Santa Fe Energy Operating Partners, L.P. has filed an administrative application with the New Mexico Oil Conservation Division ("OCD") seeking approval to directionally drill a well on this E/2 pooled unit from an unorthodox surface location of 2300 feet from the South line and 500 feet from the East line to an orthodox bottom hole location within 100 feet of a standard bottom hole location at a point 2200 feet from the South line and 660 feet from the East line of Section 15, Township 16 South, Range 36 East, N.M.P.M., Lea County, New Mexico. This deviation is required due to topographical conditions.

As an offsetting owner, you have the right to be notified and present your objections, if any. Failure to enter an objection within 20 days with the OCD will preclude you from challenging the matter at a later date.

Santa Fe Energy Operating Partners, L.P. hereby requests you waive any objection to the above by signing and returning this letter to the OCD at P.O. Box 2088, Santa Fe, New Mexico 87504-2088 with a copy sent to the undersigned.

Permian Basin District
500 W. Illinois
Suite 500
Midland, Texas 79701
915/687-3551

Page 2
Offset Operators
May 4, 1989

Your prompt attention to this matter is most appreciated. Should you have any questions, feel free to give me a call.

Sincerely yours,

SANTA FE ENERGY OPERATING PARTNERS, L.P.
By: Santa Fe Pacific Exploration Company,
Managing General Partner

By: *Patrick J. Power*
Patrick J. Power, Senior Landman

PJT/efw

WE HEREBY WAIVE OUR RIGHT TO OBJECT TO SANTA FE ENERGY OPERATING PARTNERS, L.P.'s APPLICATION FOR DIRECTIONALLY DRILLING AS NOTED ABOVE.

INDIVIDUAL OR COMPANY

O'Neill Properties, Ltd., O'Neill Producing Corp., General Partner

By: *H. Byrne O'Neill*

Title: Vice President

Date: May 11-1989



Santa Fe Energy Operating Partners, L.P.

Santa Fe Pacific Exploration Company
Managing General Partner

CERTIFIED MAIL - RETURN RECEIPT

RECEIVED

May 4, 1989

MAY 23 1989

**OIL CONSERVATION DIV.
SANTA FE**

Sohio Petroleum Company
aka Standard Oil Prod. Co.
5151 San Felipe
Houston, Texas 77210

Re: Application of SFEOP, L.P. for
Directional Drilling
E/2 Sec. 15, T-16-S, R-36-E,
N.M.P.M., Lea County, New Mexico
Clydesdale "15" State Com #1
12,200' Atoka Test

Gentlemen:

This letter is to advise you that Santa Fe Energy Operating Partners, L.P. has filed an administrative application with the New Mexico Oil Conservation Division ("OCD") seeking approval to directionally drill a well on this E/2 pooled unit from an unorthodox surface location of 2300 feet from the South line and 500 feet from the East line to an orthodox bottom hole location within 100 feet of a standard bottom hole location at a point 2200 feet from the South line and 660 feet from the East line of Section 15, Township 16 South, Range 36 East, N.M.P.M., Lea County, New Mexico. This deviation is required due to topographical conditions.

As an offsetting owner, you have the right to be notified and present your objections, if any. Failure to enter an objection within 20 days with the OCD will preclude you from challenging the matter at a later date.

Santa Fe Energy Operating Partners, L.P. hereby requests you waive any objection to the above by signing and returning this letter to the OCD at P.O. Box 2088, Santa Fe, New Mexico 87504-2088 with a copy sent to the undersigned.

Permian Basin District
500 W. Illinois
Suite 500
Midland, Texas 79701
915/687-3551

Page 2
Offset Operators
May 4, 1989

Your prompt attention to this matter is most appreciated. Should you have any questions, feel free to give me a call.

Sincerely yours,

SANTA FE ENERGY OPERATING PARTNERS, L.P.
By: Santa Fe Pacific Exploration Company,
Managing General Partner

By: Patrick J. Tower
Patrick J. Tower, Senior Landman

PJT/efw

WE HEREBY WAIVE OUR RIGHT TO OBJECT TO SANTA FE ENERGY OPERATING PARTNERS, L.P.'s APPLICATION FOR DIRECTIONALLY DRILLING AS NOTED ABOVE.

INDIVIDUAL OR COMPANY

BP Exploration Inc., formerly Sohio Petroleum Company

By: James D. Sikes
James D. Sikes
Title: Landman

Date: May 15, 1989



Santa Fe Energy Operating Partners, L.P.

Santa Fe Pacific Exploration Company
Managing General Partner

CERTIFIED MAIL - RETURN RECEIPT

HOUSTON EXPLORATION
LAND

1989 MAY -9 AM 9:03

RECEIVED

MAY 22 1989

OIL CONSERVATION DIV.
SANTA FE

May 4, 1989

Amerada Hess Corporation
1201 Louisiana
Houston, Texas 77002

Re: Application of SFEOP, L.P. for
Directional Drilling
E/2 Sec. 15, T-16-S, R-36-E,
N.M.P.M., Lea County, New Mexico
Clydesdale "15" State Com #1
12,200' Atoka Test

Gentlemen:

This letter is to advise you that Santa Fe Energy Operating Partners, L.P. has filed an administrative application with the New Mexico Oil Conservation Division ("OCD") seeking approval to directionally drill a well on this E/2 pooled unit from an unorthodox surface location of 2300 feet from the South line and 500 feet from the East line to an orthodox bottom hole location within 100 feet of a standard bottom hole location at a point 2200 feet from the South line and 660 feet from the East line of Section 15, Township 16 South, Range 36 East, N.M.P.M., Lea County, New Mexico. This deviation is required due to topographical conditions.

As an offsetting owner, you have the right to be notified and present your objections, if any. Failure to enter an objection within 20 days with the OCD will preclude you from challenging the matter at a later date.

Santa Fe Energy Operating Partners, L.P. hereby requests you waive any objection to the above by signing and returning this letter to the OCD at P.O. Box 2088, Santa Fe, New Mexico 87504-2088 with a copy sent to the undersigned.

Permian Basin District
500 W. Illinois
Suite 500
Midland, Texas 79701
915/687-3551

Page 2
Offset Operators
May 4, 1989

Your prompt attention to this matter is most appreciated. Should you have any questions, feel free to give me a call.

Sincerely yours,

SANTA FE ENERGY OPERATING PARTNERS, L.P.
By: Santa Fe Pacific Exploration Company,
Managing General Partner

By: 
Patrick J. Tower, Senior Landman

PJT/efw

WE HEREBY WAIVE OUR RIGHT TO OBJECT TO SANTA FE ENERGY OPERATING PARTNERS, L.P.'s APPLICATION FOR DIRECTIONALLY DRILLING AS NOTED ABOVE.

INDIVIDUAL OR COMPANY

By: 

Title: U.S. Onshore Land Manager

Date: May 16, 1989

EFW377



STATE OF NEW MEXICO
ENERGY AND MINERALS DEPARTMENT
OIL CONSERVATION DIVISION
HOBBS DISTRICT OFFICE

GARREY CARRUTHERS
GOVERNOR

POST OFFICE BOX 1980
HOBBS, NEW MEXICO 88241-1980
(505) 393-6161

OIL CONSERVATION DIVISION
P. O. BOX 2088
SANTA FE, NEW MEXICO 87501

RE: Proposed:

MC _____
DHC _____
NSL _____
NSP _____
SWD _____
WFX _____
PMX _____

SD X

RECEIVED

APR 27 1989

OIL CONSERVATION DIV.
SANTA FE

Gentlemen:

I have examined the application for the:

Santa Fe Energy Oper. Pkns. L.P. Clydesdale 15 St #1-Q 15-16-36
Operator Lease & Well No. Unit S-T-R

and my recommendations are as follows:

OK

Yours very truly,

Jerry Sexton
Jerry Sexton
Supervisor, District 1

/ed