



STATE OF NEW MEXICO

ENERGY AND MINERALS DEPARTMENT

OIL CONSERVATION DIVISION

HOBBS DISTRICT OFFICE

3-9-88

GARREY CARRUTHERS
GOVERNOR

MAR 11 1988

OIL CONSERVATION DIVISION
SANTA FE

POST OFFICE BOX 1980
HOBBS, NEW MEXICO 88241-1980
(505) 393-6161

M. S.

OIL CONSERVATION DIVISION
P. O. BOX 2088
SANTA FE, NEW MEXICO 87501

RE: Proposed:

MC _____
DHC _____
NSL _____
NSP _____
SWD _____
WFX _____
PMX _____

DB X amended

Gentlemen:

I have examined the application for the:

Shell Western E&P Inc. N. Hobbs GB/SA ut Sec. 33 #433
Operator Lease & Well No. Unit S-T-R

and my recommendations are as follows:

OK

Yours very truly,

Jerry Sexton
Jerry Sexton
Supervisor, District 1

/ed

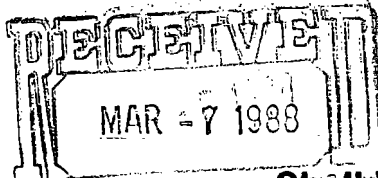

OIL CONSERVATION **Shell Western E&P Inc.**
SANTA FE A Subsidiary of Shell Oil Company



P.O. Box 576
Houston, TX 77001

March 3, 1988

State of New Mexico
Energy and Minerals Department
Oil Conservation Division
P. O. Box 2088
Santa Fe, New Mexico 87504-2088

Gentlemen:

SUBJECT: AMENDMENT TO DIRECTIONAL DRILL APPLICATION
NORTH HOBBS (GB/SA) UNIT SECTION 33
NO. 433, HOBBS (GB/SA) POOL
T18S-R38E, LEA COUNTY, NEW MEXICO

Shell Western E&P Inc. (SWEPI), as Operator of the North Hobbs Unit, hereby advises you that, due to surface use restrictions, it has become necessary to move the subject well to a new surface location. As indicated below, the bottomhole location will remain unchanged.

Original Surface Location

Unit Letter I
1862' FSL & 933' FEL

Bottomhole Location

1950' FSL & 400' FEL

Amended Surface Location

1847' FSL & 985' FEL

Bottomhole Location

1950' FSL & 400' FEL

NMOCD forms C-101 and C-102 submitted with this request indicates the amended location.

Inasmuch as the basis of our original application (submitted February 10, 1988) remains unchanged, we recommend your approval of SWEPI's proposal to drill this infill producer at the amended location.

We apologize for any inconvenience caused by this change.

Yours very truly,

A. J. Fore
FOR: A. J. Fore
Supervisor Regulatory & Permitting
Safety, Environmental, and Administration
Western Division

JMW:LGC

Attachments

cc: State of New Mexico
Energy and Minerals Department
Oil Conservation Division
P. O. Box 1980
Hobbs, New Mexico 88240-1980

BNBC8806302 - 0001.0.0

STATE OF NEW MEXICO
ENERGY AND MINERALS DEPARTMENT

OIL CONSERVATION DIVISION

P. O. BOX 2088

SANTA FE, NEW MEXICO 87501

Form C-101
Revised 10-1-78

| | |
|------------------------|--|
| NO. OF COPIES RECEIVED | |
| DISTRIBUTION | |
| SANTA FE | |
| FILE | |
| U.S.G.S. | |
| LAND OFFICE | |
| OPERATOR | |

5A. Indicate Type of Lease
STATE ☐ FEE ☒
5. State Oil & Gas Lease No.

APPLICATION FOR PERMIT TO DRILL, DEEPEN, OR PLUG BACK

| | | |
|--|--|--|
| 1a. Type of Work b. Type of Well OIL WELL <input checked="" type="checkbox"/> GAS WELL <input type="checkbox"/> OTHER <input type="checkbox"/> DRILL <input checked="" type="checkbox"/> (DIRECTIONAL) DEEPEN <input type="checkbox"/> PLUG BACK <input type="checkbox"/> SINGLE ZONE <input checked="" type="checkbox"/> MULTIPLE ZONE <input type="checkbox"/> | | 7. Unit Agreement Name N. HOBBS (G/SA) UNIT 8. Farm or Lease Name SECTION- 33 9. Well No. 433 10. Field and Pool, or Wildcat HOBBS (G/SA) |
| 2. Name of Operator SHELL WESTERN E&P INC. 3. Address of Operator P. O. BOX 576, HOUSTON, TX 77001 (WCK 4435) 4. Location of Well (SURFACE) UNIT LETTER I LOCATED 1847 FEET FROM THE SOUTH LINE AND 985 FEET FROM THE EAST LINE OF SEC. 33 TWP. 18S RGE. 38E NMPM | | 12. County LEA |
| 21. Elevations (Show whether DF, RT, etc.) 3631' GR 21A. Kind & Status Plug. Bond BLANKET 21B. Drilling Contractor UNDETERMINED | | 19. Proposed Depth 4350' 19A. Formation SAN ANDRES 20. Rotary or C.T. ROTARY 22. Approx. Date Work will start 3-21-88 |

23. PROPOSED CASING AND CEMENT PROGRAM

| SIZE OF HOLE | SIZE OF CASING | WEIGHT PER FOOT | SETTING DEPTH | SACKS OF CEMENT | EST. TOP |
|--------------|----------------|-----------------|---------------|-----------------|----------|
| 17-1/2" | 13-3/8" | CONDUCTOR | 40' | 60 | SURF |
| 12-1/4" | 9-5/8" | 32.3# | 1650' | 650 | SURF |
| 8-3/4" | 7" | 23# | 4350' | 1050 | SURF |

BHL: UNIT LTR "I", 1950' FSL & 400' FEL SEC. 33, T18S, R38E

BOP PROGRAM: 2000# ram preventer

IN ABOVE SPACE DESCRIBE PROPOSED PROGRAM; IF PROPOSAL IS TO DEEPEN OR PLUG BACK, GIVE DATA ON PRESENT PRODUCTIVE ZONE AND PROPOSED NEW PRODUCTIVE ZONE. GIVE BLOWOUT PREVENTER PROGRAM, IF ANY.

I hereby certify that the information above is true and complete to the best of my knowledge and belief.

Signed A. J. FORE Title SUPERVISOR REG. & PERMITTING Date 3-03-88

(This space for State Use)

APPROVED BY _____ TITLE _____ DATE _____
CONDITIONS OF APPROVAL, IF ANY:

Form C-102
Supersedes C-128
Effective 1-1-65

All distances must be from the outer boundaries of the Section

1. Outline the acreage dedicated to the subject well by colored pencil or hatchure marks on the plat below.
2. If more than one lease is dedicated to the well, outline each and identify the ownership thereof (both as to working interest and royalty).
3. If more than one lease of different ownership is dedicated to the well, have the interests of all owners been consolidated by communitization, unitization, force-pooling, etc?

No allowable will be assigned to the well until all interests have been consolidated (by communitization, unitization, forced-pooling, or otherwise) or until a non-standard unit, eliminating such interests, has been approved by the Commission.

Shell Western E&P Inc.

A Subsidiary of Shell Oil Company



P.O. Box 576
Houston, TX 77001

February 10, 1988

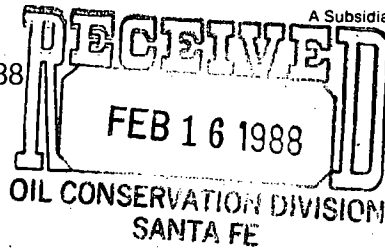

State of New Mexico
Energy & Minerals Department
Oil Conservation Division
P. O. Box 2088
Santa Fe, NM 87504-2088

Gentlemen:

SUBJECT: APPLICATION FOR ADMINISTRATIVE APPROVAL TO DIRECTIONALLY DRILL
NORTH HOBBS (GB/SA) UNIT SECTION 33
NO. 433
HOBBS (GB/SA) POOL
LEA COUNTY, NEW MEXICO

Shell Western respectfully requests administrative approval to directionally drill its North Hobbs (GB/SA) Unit No. 433. The location of the well is shown on the attachment.

The well will be drilled within the city limits of Hobbs, New Mexico where surface use restrictions prevent the drilling of a vertical hole at the desired location. The well is necessary to complete an efficient production and injection pattern, thereby maximizing oil recovery in areas where waterflood oil will be bypassed with the current injection-production well configuration.

By copy of this letter and attachments, we have notified by certified mail the operators shown on the attached service list.

Very truly yours,

A handwritten signature in cursive script, appearing to read "A. J. Fore".

A. J. Fore
Supervisor Regulatory and Permitting
Safety, Environmental, and Administration
Western Division

JMW:SJK

Attachments

cc: State of New Mexico
Energy & Minerals Department
Oil Conservation Division
P. O. Box 1980
Hobbs, NM 88240-1980

XAH8804002 - 0001.0.0

1988 NORTH HOBBS UNIT DRILLING PROGRAM
STAKED WELL LOCATION AND TARGET DEPTH

| <u>WELL NO.</u> | <u>SURFACE LOCATION</u> | <u>BOTTOM HOLE LOCATION (TARGET 100' RADIUS CIRCLE)</u> | <u>KICK-OFF DEPTH</u> | <u>DEPARTURE & DIRECTION DISTANCE</u> |
|-----------------|--|---|---------------------------|---|
| NHU-433 | 1862 FSL & 933 FEL Sec. 33, T-18-S, R-38-E | 1950 FSL & 400 FEL Sec. 33, T-18-S, R-38-E | 500' | 540 ENE |

1847 FSL + 985 FEL

*1847
 1320
 ———
 527*

*1950
 1320
 ———
 630*

STATE OF NEW MEXICO
ENERGY AND MINERALS DEPARTMENT

OIL CONSERVATION DIVISION

P. O. BOX 2088

SANTA FE, NEW MEXICO 87501

Form C-101
Revised 10-1-78

| | |
|------------------------|--|
| NO. OF COPIES RECEIVED | |
| DISTRIBUTION | |
| SANTA FE | |
| FILE | |
| U.S.G.S. | |
| LAND OFFICE | |
| OPERATOR | |

5A. Indicate Type of Lease
STATE ☐ FEE ☒
5. State Oil & Gas Lease No.

APPLICATION FOR PERMIT TO DRILL, DEEPEN, OR PLUG BACK

| | | | | | |
|---|--|--|--|--|--|
| 1a. Type of Work DRILL <input checked="" type="checkbox"/> (DIRECTIONAL) DEEPEN <input type="checkbox"/> PLUG BACK <input type="checkbox"/> | | | | 7. Unit Agreement Name N. HOBBS (G/SA) UNIT | |
| b. Type of Well OIL WELL <input checked="" type="checkbox"/> GAS WELL <input type="checkbox"/> OTHER <input type="checkbox"/> SINGLE ZONE <input checked="" type="checkbox"/> MULTIPLE ZONE <input type="checkbox"/> | | | | 8. Farm or Lease Name SECTION 33 | |
| 2. Name of Operator SHELL WESTERN E&P INC. | | | | 9. Well No. 433 | |
| 3. Address of Operator P. O. BOX 576, HOUSTON, TX 77001 (WCK 4435) | | | | 10. Field and Pool, or Wildcat HOBBS (G/SA) | |
| 4. Location of Well (SURFACE) UNIT LETTER <u>I</u> LOCATED <u>1862</u> FEET FROM THE <u>SOUTH</u> LINE AND <u>933</u> FEET FROM THE <u>EAST</u> LINE OF SEC. <u>33</u> TWP. <u>18S</u> RGE. <u>38E</u> NMPM | | | | 12. County LEA | |
| 11. Elevations (Show whether DF, KT, etc.) 3631' GR | | 21A. Kind & Status Plug. Bond BLANKET | | 19. Proposed Depth 4350' | |
| | | 21B. Drilling Contractor UNDETERMINED | | 19A. Formation SAN ANDRES | |
| | | | | 20. Rotary or C.T. ROTARY | |
| | | | | 22. Approx. Date Work will start 3-21-88 | |

PROPOSED CASING AND CEMENT PROGRAM

| SIZE OF HOLE | SIZE OF CASING | WEIGHT PER FOOT | SETTING DEPTH | SACKS OF CEMENT | EST. TOP |
|--------------|----------------|-----------------|---------------|-----------------|----------|
| 17-1/2" | 13-3/8" | CONDUCTOR | 40' | 60 | SURF |
| 12-1/4" | 9-5/8" | 32.3# | 1650' | 650 | SURF |
| 8-3/4" | 7" | 23# | 4350' | 1050 | SURF |

BHL: UNIT LTR "I", 1950' FSL & 400' FEL SEC. 33, T18S, R38E

BOP PROGRAM: 2000# ram preventer

IN ABOVE SPACE DESCRIBE PROPOSED PROGRAM; IF PROPOSAL IS TO DEEPEN OR PLUG BACK, GIVE DATA ON PRESENT PRODUCTIVE ZONE AND PROPOSED NEW PRODUCTIVE ZONE. GIVE BLOWOUT PREVENTER PROGRAM, IF ANY.

I hereby certify that the information above is true and complete to the best of my knowledge and belief.

Signed A. J. Fore A. J. FORE Title SUPERVISOR REG. & PERMITTING Date 2-10-88

(This space for State Use)

APPROVED BY _____ TITLE _____ DATE _____

CONDITIONS OF APPROVAL, IF ANY:

**NEW MEXICO OIL CONSERVATION COMMISSION
WELL LOCATION AND ACREAGE DEDICATION PLAT**

Form C-102
Supersedes C-128
Effective 1-1-65

All distances must be from the outer boundaries of the Section

| | | | | | |
|---|---|-----------------------------|---|----------------------|---------------------------------------|
| Operator SHELL WESTERN E. & P. INC. | | | Lease NORTH HOBBS UNIT SECTION 33 | | Well No. 433 |
| Unit Letter I | Section 33 | Township 18 SOUTH | Range 38 EAST | County LEA | |
| Actual Footage Location of Well: <div style="display: flex; justify-content: space-between;"> 1862 feet from the SOUTH line and 933 feet from the EAST line </div> | | | | | |
| Ground Level Elev. 3630.7 | Producing Formation GRAYBURG/SAN ANDRES | | Pool HOBBS (G/SA) | | Dedicated Acreage: 40 Acres |

1. Outline the acreage dedicated to the subject well by colored pencil or hachure marks on the plat below.
2. If more than one lease is dedicated to the well, outline each and identify the ownership thereof (both as to working interest and royalty).
3. If more than one lease of different ownership is dedicated to the well, have the interests of all owners been consolidated by communitization, unitization, force-pooling, etc?

☒ Yes ☐ No If answer is "yes," type of consolidation **UNITIZATION**

If answer is "no," list the owners and tract descriptions which have actually been consolidated. (Use reverse side of this form if necessary.) _____

No allowable will be assigned to the well until all interests have been consolidated (by communitization, unitization, forced-pooling, or otherwise) or until a non-standard unit, eliminating such interests, has been approved by the Commission.

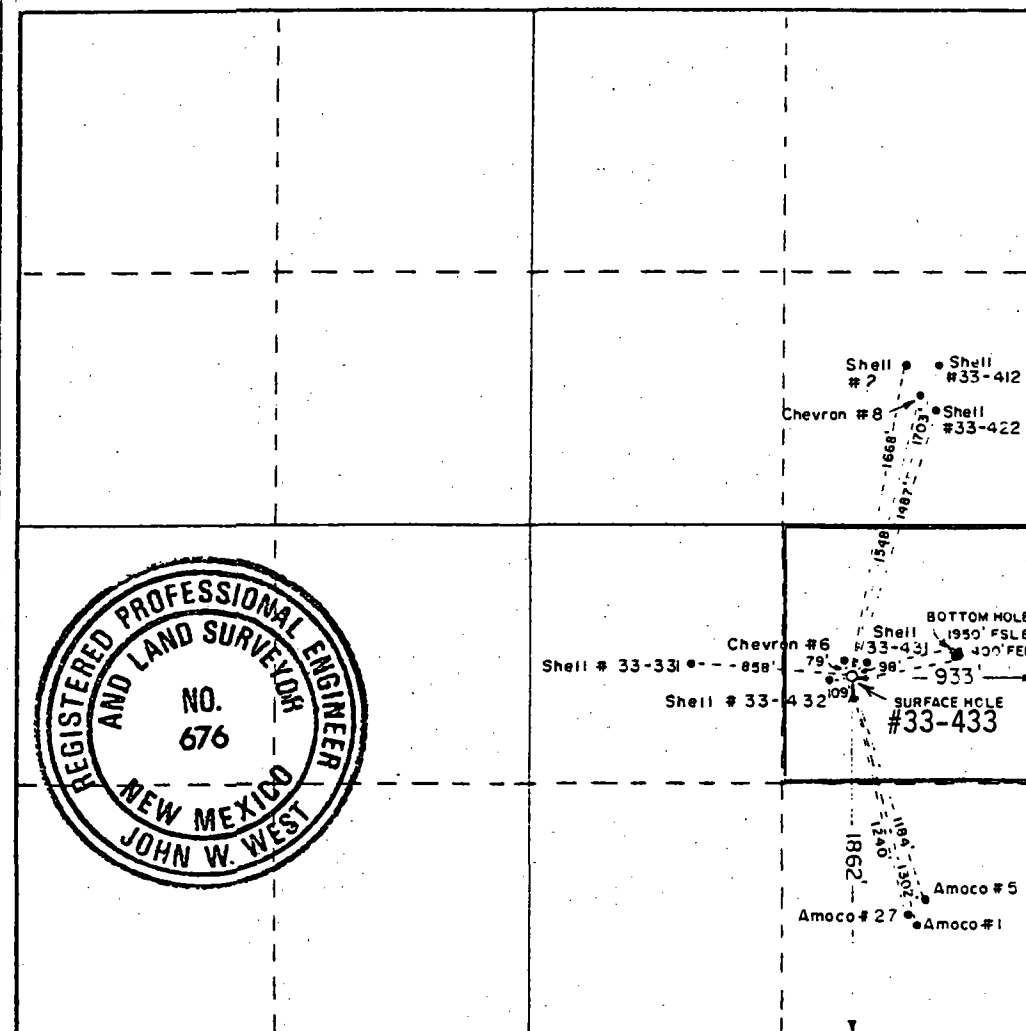

CERTIFICATION

I hereby certify that the information contained herein is true and complete to the best of my knowledge and belief.

Name
A. J. FORE **A. J. FORE**

Position
SUPV. REG. & PERMITS

Company
SHELL WESTERN E&P INC.

Date
2-10-88

I hereby certify that the well location shown on this plat was plotted from field notes of actual surveys made by me or under my supervision, and that the same is true and correct to the best of my knowledge and belief.

Date Surveyed
January 21, 1988

Registered Professional Engineer and/or Land Surveyor

John W. West

Certificate No. **JOHN W. WEST, 676**
RONALD J. EIDSON, 3239

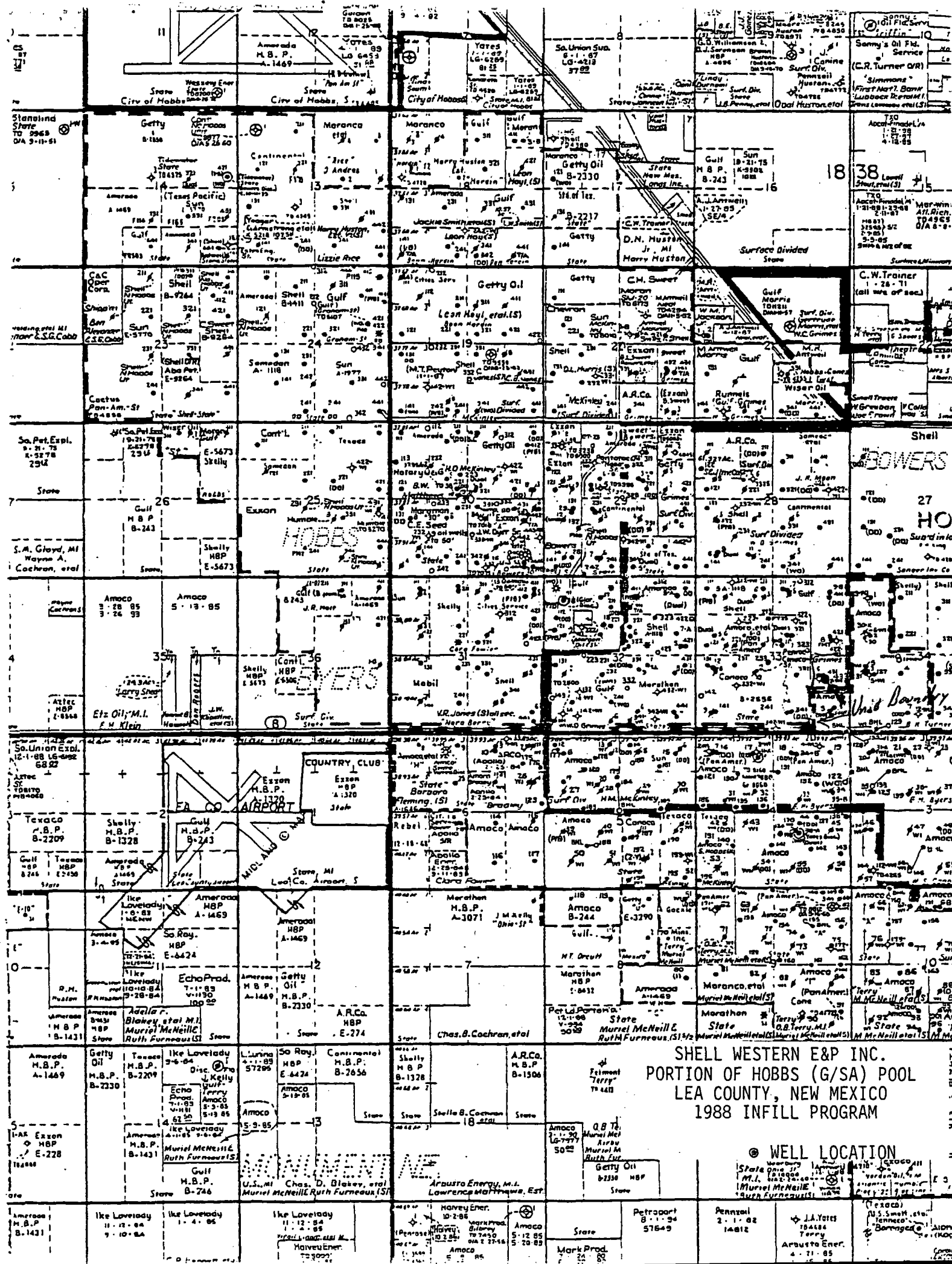

SERVICE LIST

Offset Operators

Amoco Production Company
P. O. Box 68
Hobbs, NM 88240-0068

Conoco, Inc.
P. O. Box 460
Hobbs, NM 88240-0460

Chevron USA
P. O. Box 670
Hobbs, NM 88240-0670



STATE OF NEW MEXICO
ENERGY AND MINERALS DEPARTMENT
OIL CONSERVATION DIVISION
HOBBS DISTRICT OFFICE

GARREY CARRUTHERS
GOVERNOR

POST OFFICE BOX 1980
HOBBS, NEW MEXICO 88241-1980
(505) 393-6161

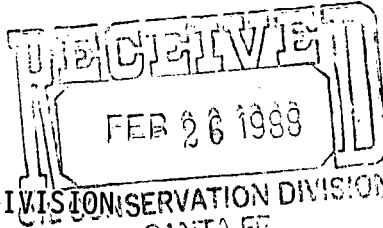

OIL CONSERVATION DIVISION
P. O. BOX 2088
SANTA FE, NEW MEXICO 87501

RE: Proposed:

MC _____
DHC _____
NSL _____
NSP _____
SWD _____
WFX _____
PMX _____

DD X

Gentlemen:

I have examined the application for the:

Shell Western E&P Inc. *N. Hobbs* *GB/SA Unit* *Sec. 33 #433*
Operator Lease & Well No. Unit S-T-R

and my recommendations are as follows:

Yours very truly,

Jerry Sexton
Jerry Sexton
Supervisor, District 1

/ed

Unit 1, Section 33, Township 18 South, Range 38 East, Murray, Iowa County

Intersection Point @
950.1551 - 400.1551

Surface Location
1841.1551 - 781.1551

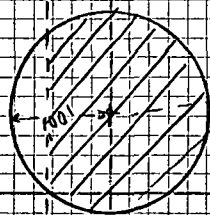

330'

330'

See Rule 7 of R-6199

Unit 1
Boundary

