

PKR/V0317455221

WFX 7/8/03 WVS

**JIM PIERCE**

200 WEST FIRST STREET  
SUITE 859  
ROSWELL, NEW MEXICO 88203-4697  
June 20, 2003

OIL AND GAS PROPERTIES  
RECEIVED

**JUN 23 2003**

Oil Conservation Division

PHONE 505-622-7246  
FAX 505-622-1711  
EMAIL: jplandman@dfn.com

State of New Mexico Energy, Minerals & Natural Resources Dept.  
Oil Conservation Division  
1220 South St. Francis Drive  
Santa Fe, NM 87505

**RE: Application For Authorization To Inject Request  
Form C-108 Approval  
Twin Lakes San Andres Unit  
Well # 302/API# 30-005-63191  
Well# 326/API# 30-005-63189  
Well# 333/API# 30-005-63193  
Chaves County, NM**

**Gentlemen:**

On behalf of M. E. W. Enterprises, Operator of the captioned Twin Lakes San Andres Unit, enclosed for approval is original and copies of Form C-108 Application For Authorization To Inject concerning the captioned three wells.

Also provided is all well information requested, maps reflecting Area(s) of Review, Certification.

Regarding Proof of Notice, M. E. W. Enterprises is the only operator within the Area of Review. No notice was published, however, the surface owner, Ganada, Inc., was formally notified via Certified Mail, as instructed.

Case - 9211 3/1/88  
R - 8611

The NMOCD Office in Santa Fe informed us, surprisingly, that there is no case number or division order number for the Twin Lakes San Andres Unit, consequently we were led to believe that this is not an expansion of an existing project, however, should be.

We request administrative approval, and appreciate your help and consideration in this matter.

Please contact us should you have questions or need additional information.

Truly,

  
Jim Pierce, RLP  
Agent

Xc: NMOCD/District II Office  
Xc: M.E.W. Enterprises

**APPLICATION FOR AUTHORIZATION TO INJECT**

I. PURPOSE: ☒ Secondary Recovery ☐ Pressure Maintenance ☒ Disposal ☐ Storage  
Application qualifies for administrative approval? ☒ Yes ☐ No

II. OPERATOR: M. E. W. Enterprises

ADDRESS: 300 S. Kentucky, Roswell, NM 88203

CONTACT PARTY: Russell Whited PHONE: (505) 627-2065

III. WELL DATA: Complete the data required on the reverse side of this form for each well proposed for injection.  
Additional sheets may be attached if necessary.

IV. Is this an expansion of an existing project? ☐ Yes ☒ No  
If yes, give the Division order number authorizing the project: \_\_\_\_\_

V. Attach a map that identifies all wells and leases within two miles of any proposed injection well with a one-half mile radius circle drawn around each proposed injection well. This circle identifies the well's area of review.

VI. Attach a tabulation of data on all wells of public record within the area of review which penetrate the proposed injection zone. Such data shall include a description of each well's type, construction, date drilled, location, depth, record of completion, and a schematic of any plugged well illustrating all plugging detail.

VII. Attach data on the proposed operation, including:

1. Proposed average and maximum daily rate and volume of fluids to be injected; 300 bwpd - 1,100 bwpd
2. Whether the system is open or closed; Closed
3. Proposed average and maximum injection pressure; Average 300, maximum 510.
4. Sources and an appropriate analysis of injection fluid and compatibility with the receiving formation if other than reinjected produced water; and, Reinjected Produced Water
5. If injection is for disposal purposes into a zone not productive of oil or gas at or within one mile of the proposed well, attach a chemical analysis of the disposal zone formation water (may be measured or inferred from existing literature, studies, nearby wells, etc.).

\*VIII. Attach appropriate geologic data on the injection zone including appropriate lithologic detail, geologic name, thickness, and depth. Give the geologic name, and depth to bottom of all underground sources of drinking water (aquifers containing waters with total dissolved solids concentrations of 10,000 mg/l or less) overlying the proposed injection zone as well as any such sources known to be immediately underlying the injection interval.

IX. Describe the proposed stimulation program, if any. None

\*X. Attach appropriate logging and test data on the well. (If well logs have been filed with the Division, they need not be resubmitted). Well logs have been previously submitted.

\*XI. Attach a chemical analysis of fresh water from two or more fresh water wells (if available and producing) within one mile of any injection or disposal well showing location of wells and dates samples were taken.

XII. Applicants for disposal wells must make an affirmative statement that they have examined available geologic and engineering data and find no evidence of open faults or any other hydrologic connection between the disposal zone and any underground sources of drinking water.

XIII. Applicants must complete the "Proof of Notice" section on the reverse side of this form.

XIV. Certification: I hereby certify that the information submitted with this application is true and correct to the best of my knowledge and belief.

NAME: Jim Pierce TITLE: Agent

SIGNATURE: [Signature] DATE: May 14, 2003

\* If the information required under Sections VI, VIII, X, and XI above has been previously submitted, it need not be resubmitted. Please show the date and circumstances of the earlier submittal: \_\_\_\_\_

DISTRIBUTION: Original and one copy to Santa Fe with one copy to the appropriate District Office

### III. WELL DATA

- A. The following well data must be submitted for each injection well covered by this application. The data must be both in tabular and schematic form and shall include:
- (1) Lease name; Well No.; Location by Section, Township and Range; and footage location within the section.
  - (2) Each casing string used with its size, setting depth, sacks of cement used, hole size, top of cement, and how such top was determined.
  - (3) A description of the tubing to be used including its size, lining material, and setting depth.
  - (4) The name, model, and setting depth of the packer used or a description of any other seal system or assembly used.

Division District Offices have supplies of Well Data Sheets which may be used or which may be used as models for this purpose. Applicants for several identical wells may submit a "typical data sheet" rather than submitting the data for each well.

- B. The following must be submitted for each injection well covered by this application. All items must be addressed for the initial well. Responses for additional wells need be shown only when different. Information shown on schematics need not be repeated.
- (1) The name of the injection formation and, if applicable, the field or pool name.
  - (2) The injection interval and whether it is perforated or open-hole.
  - (3) State if the well was drilled for injection or, if not, the original purpose of the well.
  - (4) Give the depths of any other perforated intervals and detail on the sacks of cement or bridge plugs used to seal off such perforations.
  - (5) Give the depth to and the name of the next higher and next lower oil or gas zone in the area of the well, if any.

### XIV. PROOF OF NOTICE

All applicants must furnish proof that a copy of the application has been furnished, by certified or registered mail, to the owner of the surface of the land on which the well is to be located and to each leasehold operator within one-half mile of the well location.

Where an application is subject to administrative approval, a proof of publication must be submitted. Such proof shall consist of a copy of the legal advertisement which was published in the county in which the well is located. The contents of such advertisement must include:

- (1) The name, address, phone number, and contact party for the applicant;
- (2) The intended purpose of the injection well; with the exact location of single wells or the Section, Township, and Range location of multiple wells;
- (3) The formation name and depth with expected maximum injection rates and pressures; and,
- (4) A notation that interested parties must file objections or requests for hearing with the Oil Conservation Division, 2040 South Pacheco, Santa Fe, New Mexico 87505, within 15 days.

**NO ACTION WILL BE TAKEN ON THE APPLICATION UNTIL PROPER PROOF OF NOTICE HAS BEEN SUBMITTED.**

---

**NOTICE:** Surface owners or offset operators must file any objections or requests for hearing of administrative applications within 15 days from the date this application was mailed to them.

**JIM PIERCE**

200 WEST FIRST STREET  
SUITE 859  
ROSWELL, NEW MEXICO 88203-4697

OIL AND GAS PROPERTIES

PHONE 505-622-7246  
FAX 505-622-1711  
EMAIL: jplandman@dfn.com

August 4, 2003

NMOCD  
Energy, Minerals and Natural Resources Dept.

Via Fax # (505) 476-3462

Attention: Mr. William V. Jones, Jr. PE

RE: Administrative Application for Water Flood Expansion  
Twin Lakes San Andres Unit/Order R-8611  
Chaves County, NM

Dear Mr. Jones:

Per our conversation this morning, included herewith is copy of Exhibit to NMOCD C-108 regarding the captioned application, concerning Well #17.

As discussed, subject well is an active water injection well, approved sometime in 1986 from the information provided to me.

Again, on behalf of M.E.W. Enterprises, we request approval at the earliest possible time.

Truly,



Jim Pierce, RLP

Encl.

Xc: MEW Enterprises

T. Anhy. 214'

T. Yates 778'

T. SaDR 1928'

T. PI 2408'

T. Slaughter 2544'

8 5/8" @ 320'  
Cemented w/ 125 sx.  
Circulated

T.O.C. @ +/- 2400'

SADR Perfs 2584'-2590'

4 1/2" @ 2602'  
Cemented w/ 50 sx.

**EXHIBIT TO NMOCD C-108**

**M E W Enterprise  
Twin Lakes SA Unit #17  
(Twin Lakes Oil Co.)  
(Citgo "A" State C #5)  
990' FNL & 1650' FWL  
Sec. 36C-T8S-R28E  
Chaves County, New Mexico**

**API No.: 30-005-60039  
Spud Date: 1-26-68**

**34**

8 5/8" x 11" = .2542 cu.ft./ft.

4 1/2" x 7 7/8" = .2278 cu.ft./ft.

231.8 ft. Fill

200 WEST FIRST STREET  
SUITE 859  
ROSWELL, NEW MEXICO 88203-4697

**JIM PIERCE**  
OIL AND GAS PROPERTIES

PHONE 505-622-7246  
FAX 505-622-1711  
EMAIL: jplandman@dfn.com

July 31, 2003

**RECEIVED**

AUG 04 2003

New Mexico Oil Conservation Division  
Energy, Minerals and Natural Resources Dept.  
1220 South St. Francis Drive  
Santa Fe, NM 87505

**OIL CONSERVATION  
DIVISION**

Attention: Mr. William V. Jones, Jr. PE

RE: Administrative Application for Water flood expansion  
Twin Lakes San Andres Unit  
Division Hearing Order R-8611  
Wells 302, 326 and 333  
Chaves County, NM

Dear Mr. Jones:

On behalf of M. E. W. Enterprises, and per our telephone conversation and your directive, enclosed is a copy of the original Application, dated May 14, 2003, regarding the captioned.

The original Application was not returned to this office under the July 10, 2003 letter, as it states.

Also provided is a copy of the notice letter to Ganada, Inc., surface owner, including a copy of the Certified Mail receipt.

As discussed, my client is the only operator within a two (2) mile radius of each well in question.

Again, we request approval at the earliest possible time.

Truly,



Jim Pierce, RLP

Encl.

Xc: M. E. W. Enterprises

200 WEST FIRST STREET  
SUITE 859  
ROSWELL, NEW MEXICO 88203-4697

**JIM PIERCE**  
OIL AND GAS PROPERTIES

PHONE 505-622-7246  
FAX 505-622-1711  
EMAIL: jplandman@dfn.com

**RECEIVED**

JUL 31 2003

**OIL CONSERVATION  
DIVISION**

July 28, 2003

New Mexico Energy, Minerals and Natural Resources Dept.  
1220 South St. Francis Drive  
Santa Fe, NM 87505

Attention: Mr. William V. Jones, PE

RE: Administrative Application for Water Flood Expansion  
Twin Lakes San Andres Unit  
Division Order Hearing Order R-8611  
Wells 302, 326 and 333  
Chaves County, NM

Dear Mr. Jones:

On behalf of M.E.W. Enterprises, provided is the additional information requested per your correspondence dated June 24, 2003.

Enclosed is the Affidavit concerning the published notice.

Regarding Form C-108.III.B(5), there are no upper (next higher) zones to be considered.

The lower zones in the area are the Fusselman @ 6,85'; the Atoka @ 7,720'; and the Devonian @ 7,200'.

Also enclosed is the affirmative statement from Mr. Bruce Stubbs, PE/Pecos Petroleum Engineering, Inc., who is responsible for 99% of the 'considerable work gathering offset well data' and 100% in "building well bore schematics".

We appreciate your consideration.

Truly,

  
Jim Pierce, RLP

Xc: M. E. W. Enterprises

AFFIDAVIT OF PUBLICATION

COUNTY OF CHAVES  
STATE OF NEW MEXICO

I, Fran Saunders,  
Legals Clerk

Of the Roswell Daily Record, a daily newspaper published at Roswell, New Mexico, do solemnly swear that the clipping hereto attached was published in the regular and entire issue of said paper and not in a supplement thereof for a period of:

one time

beginning with the issue dated

July 10th 2003

and ending with the issue dated

July 10th 2003

-----

*Fran Saunders*  
Clerk

Sworn and subscribed to before me

This 14th Day of July 2003

*Marylou Shipper*  
Notary Public

My Commission expires  
July 25, 2006

(SEAL)

**Publish July 10, 2003**

"M.E.W. Enterprises will convert the following Twin Lakes San Andres Unit wells to salt water disposal.

1. Unit Well #302, 950' FSL, 2310' FEL, Section 25, T8S, R28E;
2. Unit Well #326, 110' FSL, 2490' FWL, Section 31, T8S, R29E;
3. Unit Well #333, 1670' FSL, 1650' FEL, Section 6, T9S, R29E;

N.M.P.M. Chaves County, New Mexico.

Injection will be into the Twin Lake San Andres formation, into perforations from 2,572' to 2,756', with expected maximum rates and pressures of 1,100 bwpd and 510 psia, respectively. Any interested party must file objections or requests for hearing with the NMOCD, 1220 South St. Francis Drive, Santa Fe, NM 87505 within 15 days."



**PECOS PETROLEUM ENGINEERING, Inc.**

200 W. First St., Suite 536  
P. O. Box 2885  
Roswell, N.M. 88202  
505-624-2800  
FAX 505-623-1777

July 28, 2003

New Mexico Energy, Minerals and Natural Resources Dept.  
1220 South St. Francis Drive  
Santa Fe, NM 87505

Attention: Mr. William V. Jones, PE

RE: Administrative Application for Water Flood Expansion  
Twin Lakes San Andres Unit  
Division Order Hearing Order R-8611  
Wells 302, 326 and 333  
Chaves County, NM

Dear Mr. Jones:

On behalf of M.E.W. Enterprises, and as requested, please accept this as my affirmative statement that I have examined available geologic and engineering data and find no evidence of open faults or any other hydrologic connection between the disposal zone and any underground sources of drinking water regarding the captioned Application for subject wells.

Truly,

A handwritten signature in black ink, appearing to read 'B. Stubbs', with a horizontal line extending to the right.

Bruce Stubbs, PE

Xc:



# NEW MEXICO ENERGY, MINERALS and NATURAL RESOURCES DEPARTMENT

**BILL RICHARDSON**

Governor

**Joanna Prukop**  
Cabinet Secretary

**Lori Wrotenbery**

Director

**Oil Conservation Division**

July 10, 2003

M.E.W. Enterprises  
C/o Jim Pierce  
200 West First Street, Suite 859  
Roswell, New Mexico 88203

Re: Administrative Application for Water Flood Expansion  
Twin Lakes San Andres Unit defined by  
Division Hearing Order R-8611 as amended  
Wells 302, 326, and 333  
Chaves County, New Mexico

Dear Mr. Pierce:

The New Mexico Oil Conservation Division (Division) received your application June 23, 2003. On June 24, 2003, the Division mailed a letter requesting additional information, including the request to post notice of the application in the local newspaper. A copy of this request letter is attached.

To date the Division has not received a reply to the request letter and has not received a copy of the notice posted in the newspaper.

~~Your application is being returned to you pending completion of the items in the request letter. Please re-apply administratively as needed.~~

*Not Sent*

If I can be of further assistance, please call (505) 476-3448.

Sincerely,

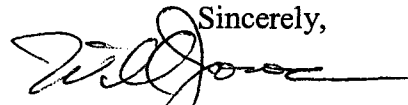
  
William V Jones Jr. PE

cc: Oil Conservation Division -- Artesia  
attachment



# NEW MEXICO ENERGY, MINERALS and NATURAL RESOURCES DEPARTMENT

**BILL RICHARDSON**

Governor

**Joanna Prukop**  
Cabinet Secretary

**Lori Wrotenbery**

Director

**Oil Conservation Division**

June 24, 2003

M.E.W. Enterprises  
C/o Jim Pierce  
200 West First Street, Suite 859  
Roswell, New Mexico 88203

Re: Administrative Application for Water Flood Expansion  
Twin Lakes San Andres Unit defined by  
Division Hearing Order R-8611 as amended  
Wells 302, 326, and 333  
Chaves County, New Mexico

Dear Mr. Pierce:

The New Mexico Oil Conservation Division (Division) received your application June 23, 2003. Your application shows considerable work gathering offset well data and building well bore schematics. After review, the following items must be submitted prior to completing your order administratively.

- (i) Post a notice of your intentions to convert these three wells to injection in the local newspaper and supply proof of this notice to the Division. We have a copy of your notice to the surface owner, Ganada, Inc.
- (ii) Please address the requirements in C-108.III.B.(5) which asks for depths and names of the next higher and next lower oil or gas zone in the area of these wells.
- (iii) As per the language in Form C108.XII, supply an affirmative statement signed by a geologist.

For your information, the latest Form C-108 on the Division web site has the correct Division address. The C108 Form you submitted is older and does not have the correct address, but should be otherwise sufficient. The administrative order permitting Well No. 302 for injection will be issued with the condition that Twin Lakes San Andres Unit Well No. 17 be adequately cemented.

As stated in Rule 701.C.2, we must wait 15 days after receiving your properly completed water injection application in this office – with proper proof of notifications including the newspaper notice - before it can be approved.

If I can be of further assistance, please call (505) 476-3448.

Sincerely,

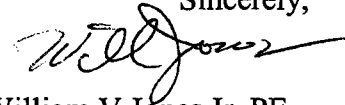
A handwritten signature in black ink, appearing to read "Will Jones", with a long horizontal flourish extending to the right.

William V Jones Jr. PE

cc: Oil Conservation Division - Artesia

EXHIBIT TO NMOCD C-108

Existing

Proposed

T. Salt 668'  
T. Yates 801'  
T. 7-RVRS 880'

T. Grayburg 1442'

T. SADR 1942'

8 5/8" @ 112'  
Cemented w/ 3 cu.yds. Redi-mix  
Circulated

SADR Perfs 2572'-2616'

5 1/2" @ 2695'  
Cemented w/ 985 sx.

**M E W Enterprise**  
**(Hanagan Petroleum)**  
**Twin Lakes SA Unit #302**  
**950' FSL & 2310' FEL**  
**Sec. 25O-T8S-R28E**  
**Chaves County, New Mexico**

**API No.: 30-005-63191**  
**Spud Date: 1-18-99**

**22**

2 3/8"-4.3 lb./ft. J-55  
Plastic Coated Tubing

Plastic coated injection packer  
+/- 2525'

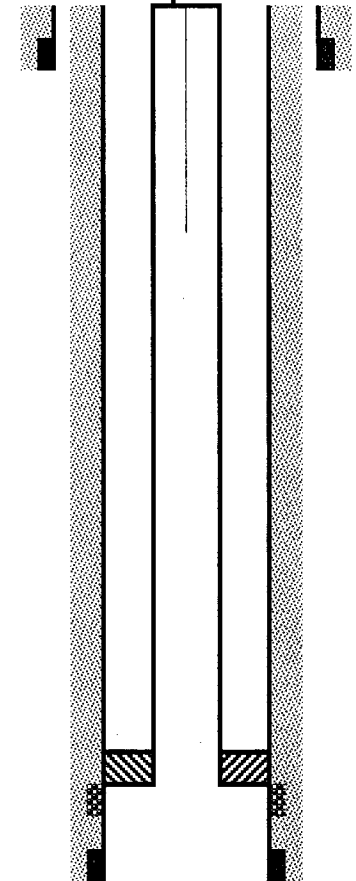

**Existing**

T Salt 787'  
T. Yates 934'  
T. 7- Rivers 1010'

T. Queen 1587'

T. SADR 2083'

8 5/8" @ 118'  
Cemented w/ 3 cu.yds. Redi-mix  
Circulated

SADR Perfs 2712'-2756'

5 1/2" @ 2850'  
Cemented w/ 900 sx.

**EXHIBIT TO NMOCD C-108**

**M E W Enterprise**

**(Hanagan Petroleum)  
Twin Lakes SA Unit #326  
110' FSL & 2490' FWL  
Sec. 31N-T8S-R29E  
Chaves County, New Mexico**

**API No.: 30-005-63189  
Spud Date: 12-1-98**

**36**

2 3/8"-4.3 lb./ft. J-55  
Plastic Coated Tubing

Plastic coated injection packer  
+/- 2675'

**Proposed**

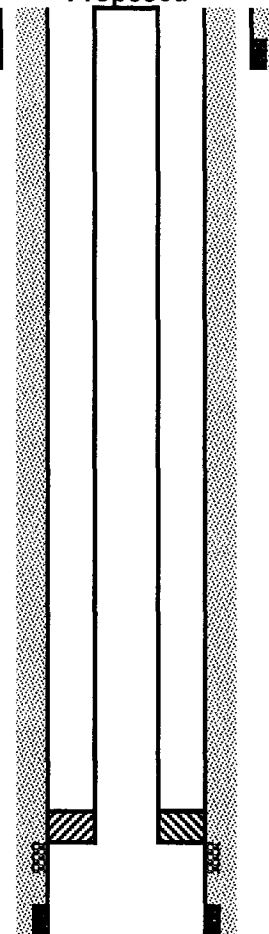

EXHIBIT TO NMOCD C-108

Existing

Proposed

T Salt 802'  
T. Yates 916'  
T. 7- Rivers 995'

8 5/8" @ 118'  
Cemented w/ 3 cu.yds. Redi-mix  
Circulated

**M E W Enterprise**  
**(Hanagan Petroleum)**  
**Twin Lakes SA Unit #333**  
**1670' FSL & 1650' FEL**  
**Sec. 6J-T9S-R29E**  
**Chaves County, New Mexico**

**API No.: 30-005-63193**  
**Spud Date: 11-29-98**

**35**

T. Queen 1550'

8 5/8" x 11" = .2542 cu.ft./ft.

4 1/2" x 7 7/8" = .2278 cu.ft./ft.

2 3/8"-4.3 lb./ft. J-55  
Plastic Coated Tubing

T. SADR 2062'

231.8 ft. Fill

Plastic coated injection packer  
+/- 2675'

SADR Perfs 2708'-2742'

5 1/2" @ 2830'  
Cemented w/ 900 sx.

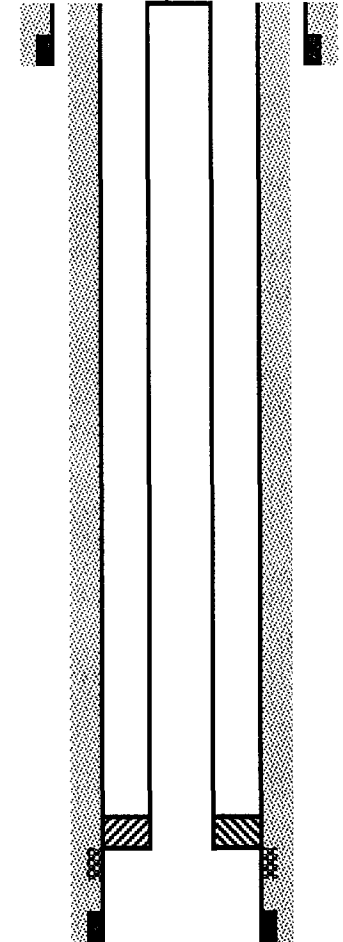

50SX only!!

API	WELL NAME	Short Operator	NS	EW	UL	Sec	Tsp	Rge	UL2	COUNTY	OGRD	TVD	LT	WT
30-005-62111	SANDCO #002	SANDCO	2310N	1650E	G	25	08S	28E	G	CHAVES	20233		P	O
30-005-62070	TWIN LAKES SAN ANDRES UNIT #001	ME W	2310N	2310W	F	25	08S	28E	F	CHAVES	160190	2691	P	I
30-005-60648	TWIN LAKES SAN ANDRES UNIT #002	ME W	1650S	2310W	K	25	08S	28E	K	CHAVES	160190	2770	P	I
30-005-60601	TWIN LAKES SAN ANDRES UNIT #003	ME W	1650S	1650E	J	25	08S	28E	J	CHAVES	160190		P	O
30-005-60579	TWIN LAKES SAN ANDRES UNIT #004	ME W	1650S	330E	I	25	08S	28E	I	CHAVES	160190		P	I
30-005-60492	TWIN LAKES SAN ANDRES UNIT #008	ME W	660S	660W	M	25	08S	28E	M	CHAVES	160190	2563	P	O
30-005-60598	TWIN LAKES SAN ANDRES UNIT #009	ME W	330S	990W	M	25	08S	28E	M	CHAVES	160190	2763	P	I
30-005-60571	TWIN LAKES SAN ANDRES UNIT #010	ME W	330S	2310W	N	25	08S	28E	N	CHAVES	160190		P	O
30-005-60563	TWIN LAKES SAN ANDRES UNIT #011	ME W	330S	1650E	O	25	08S	28E	O	CHAVES	160190		P	I
30-005-60578	TWIN LAKES SAN ANDRES UNIT #012	ME W	330S	330E	P	25	08S	28E	P	CHAVES	160190		P	O
30-005-60470	TWIN LAKES SAN ANDRES UNIT #016	ME W	660N	990W	D	36	08S	28E	D	CHAVES	160190		S	O
30-005-60039	TWIN LAKES SAN ANDRES UNIT #017	ME W	990N	1650W	C	36	08S	28E	C	CHAVES	160190		S	I
30-005-60536	TWIN LAKES SAN ANDRES UNIT #018	ME W	990N	2310E	B	36	08S	28E	B	CHAVES	160190		S	O
30-005-60560	TWIN LAKES SAN ANDRES UNIT #019	ME W	990N	990E	A	36	08S	28E	A	CHAVES	160190		S	I
30-005-60657	TWIN LAKES SAN ANDRES UNIT #039	ME W	1650S	330W	L	31	08S	29E	3	CHAVES	160190		P	O
30-005-60696	TWIN LAKES SAN ANDRES UNIT #040	ME W	1650S	1650W	K	31	08S	29E	K	CHAVES	160190		P	I
30-005-60768	TWIN LAKES SAN ANDRES UNIT #041	ME W	1650S	2310E	J	31	08S	29E	J	CHAVES	160190		P	O
30-005-60802	TWIN LAKES SAN ANDRES UNIT #042	ME W	1650S	990E	I	31	08S	29E	I	CHAVES	160190		P	O
30-005-60697	TWIN LAKES SAN ANDRES UNIT #048	ME W	570S	330W	M	31	08S	29E	4	CHAVES	160190		P	I
30-005-60767	TWIN LAKES SAN ANDRES UNIT #049	ME W	560S	1650W	N	31	08S	29E	N	CHAVES	160190		P	O
30-005-60796	TWIN LAKES SAN ANDRES UNIT #050	ME W	560S	2310E	O	31	08S	29E	O	CHAVES	160190		P	I
30-005-60810	TWIN LAKES SAN ANDRES UNIT #051	ME W	560S	990E	P	31	08S	29E	P	CHAVES	160190	2950	P	O
30-005-61031	TWIN LAKES SAN ANDRES UNIT #058	ME W	330N	330W	D	06	09S	29E	4	CHAVES	160190		P	O
30-005-60807	TWIN LAKES SAN ANDRES UNIT #059	ME W	330N	1750W	C	06	09S	29E	3	CHAVES	160190		P	I
30-005-60824	TWIN LAKES SAN ANDRES UNIT #060	ME W	330N	2310E	B	06	09S	29E	2	CHAVES	160190		P	O
30-005-60920	TWIN LAKES SAN ANDRES UNIT #061	ME W	330N	990E	A	06	09S	29E	1	CHAVES	160190		P	I
30-005-60984	TWIN LAKES SAN ANDRES UNIT #069	ME W	1650N	1650W	F	06	09S	29E	F	CHAVES	160190		P	O
30-005-60885	TWIN LAKES SAN ANDRES UNIT #070	ME W	1650N	2310E	G	06	09S	29E	G	CHAVES	160190		P	I
30-005-62212	TWIN LAKES SAN ANDRES UNIT #071	ME W	950N	1675E	B	06	09S	29E	2	CHAVES	160190		P	O
30-005-60886	TWIN LAKES SAN ANDRES UNIT #072	CONCHO	1650N	990E	H	06	09S	29E	H	CHAVES	193407		P	O
30-005-60995	TWIN LAKES SAN ANDRES UNIT #078	ME W	2310S	1650W	K	06	09S	29E	K	CHAVES	160190		P	I
30-005-60982	TWIN LAKES SAN ANDRES UNIT #079	ME W	2310S	2310E	J	06	09S	29E	J	CHAVES	160190		P	O
30-005-62213	TWIN LAKES SAN ANDRES UNIT #080	ME W	2310N	1675E	G	06	09S	29E	G	CHAVES	160190		P	O
30-005-60993	TWIN LAKES SAN ANDRES UNIT #081	ME W	2310S	990E	I	06	09S	29E	I	CHAVES	160190		P	I
30-005-60994	TWIN LAKES SAN ANDRES UNIT #082	CONCHO	2310S	330W	L	05	09S	29E	L	CHAVES	193407		P	O
30-005-61030	TWIN LAKES SAN ANDRES UNIT #087	ME W	990S	1650W	N	06	09S	29E	N	CHAVES	160190		P	O
30-005-61006	TWIN LAKES SAN ANDRES UNIT #088	ME W	990S	2310E	O	06	09S	29E	O	CHAVES	160190		P	I
30-005-61022	TWIN LAKES SAN ANDRES UNIT #089	ME W	990S	990E	P	06	09S	29E	P	CHAVES	160190		P	O
30-005-61033	TWIN LAKES SAN ANDRES UNIT #090	CONCHO	990S	330W	M	05	09S	29E	M	CHAVES	193407		P	I
30-005-61106	TWIN LAKES SAN ANDRES UNIT #094	ME W	330N	2310E	B	07	09S	29E	B	CHAVES	160190		P	O
30-005-61107	TWIN LAKES SAN ANDRES UNIT #095	ME W	330N	990E	A	07	09S	29E	A	CHAVES	160190		P	I
30-005-63140	TWIN LAKES SAN ANDRES UNIT #203	ME W	1625S	2310W	K	06	09S	29E	K	CHAVES	160190	2862	P	O
30-005-63191	TWIN LAKES SAN ANDRES UNIT #302	ME W	950S	2310E	N	25	08S	28E		CHAVES	160190	2700	P	O
30-005-63187	TWIN LAKES SAN ANDRES UNIT #319	ME W	2310S	1650E	J	31	08S	29E	J	CHAVES	160190	2903	P	O
30-005-63188	TWIN LAKES SAN ANDRES UNIT #321	ME W	1110S	990W		31	08S	29E	I	CHAVES	160190	2816	P	O
30-005-63189	TWIN LAKES SAN ANDRES UNIT #326	ME W	110S	2410W	N	31	08S	29E	N	CHAVES	160190	2855	P	O
30-005-63190	TWIN LAKES SAN ANDRES UNIT #329	ME W	1140N	2310W		06	09S	29E	3	CHAVES	160190	2855	P	O
30-005-63192	TWIN LAKES SAN ANDRES UNIT #331	ME W	2310N	2310W	F	06	09S	29E	F	CHAVES	160190	2830	P	O
30-005-63193	TWIN LAKES SAN ANDRES UNIT #333	ME W	1670S	1650E	J	06	09S	29E	J	CHAVES	160190	2830	P	O

2781 (5.5) 77 1/8" 2858' 50SX

See Letter Requesting  
ACTION 6/24/03



SENDER: COMPLETE THIS SECTION		COMPLETE THIS SECTION ON DELIVERY	
<p>■ Complete items 1, 2, and 3. Also complete item 4 if Restricted Delivery is desired.</p> <p>■ Print your name and address on the reverse so that we can return the card to you.</p> <p>■ Attach this card to the back of the mailpiece, or on the front if space permits.</p>		<p>A. Signature  <input checked="" type="checkbox"/> <i>Haleigh Richards</i> <input type="checkbox"/> Agent <input type="checkbox"/> Addressee</p>	
<p>1. Article Addressed to:</p> <p>Canada, Inc.  P. O. Box 9  Sudan. Texas 79371</p>		<p>B. Received by (Printed Name) C. Date of Delivery  <i>Haleigh Richards</i> <i>6-23-03</i></p>	
<p>2. Article Number  (Transfer from service label)</p>		<p>D. Is delivery address different from item 1? <input type="checkbox"/> Yes  If YES, enter delivery address below: <input type="checkbox"/> No</p>	
<p>PS Form 3811, August 2001</p>		<p>3. Service Type  <input checked="" type="checkbox"/> Certified Mail <input type="checkbox"/> Express Mail  <input type="checkbox"/> Registered <input type="checkbox"/> Return Receipt for Merchandise  <input type="checkbox"/> Insured Mail <input type="checkbox"/> C.O.D.</p>	
<p>Domestic Return Receipt</p>		<p>4. Restricted Delivery? (Extra Fee) <input type="checkbox"/> Yes</p>	
<p>7002 0460 0000 9342 3385</p>		<p>102695-01-M-0381</p>	

# JIM PIERCE

200 WEST FIRST STREET  
SUITE 859  
ROSWELL, NEW MEXICO 88203-4697

OIL AND GAS PROPERTIES

PHONE 505-622-7246  
FAX 505-622-1711  
EMAIL: jplandman@dfn.com

June 25, 2003

Mr. Will Jones  
c/o Energy, Minerals and Natural Resources Department  
NMOCD  
1220 South St. Francis Drive  
Santa Fe, NM 87505

Via Fax # (505) 476-3462

RE: Approval Request of Application For Authorization To Inject  
Form C-108/Twin Lakes San Andres Unit  
Chaves County, NM

Dear Mr. Jones:

Per the directive of Mr. Stogner, included herewith is copy of Certified Mail Receipt concerning the formal notification to surface owner Ganada, Inc. of the captioned application to convert three (3) wells to water disposal/injection in the subject unit.

A copy of the cover letter regarding the application is provided.

Again, on behalf of MEW Enterprises, operator, we appreciate your help and consideration.

Truly,



Jim Pierce, RLP  
Agent

Encl.

Xc: MEW Enterprises

JIM PIERCE

OIL AND GAS PROPERTIES  
SUITE 858  
PETROLEUM BUILDING  
200 WEST FIRST  
ROSWELL, NEW MEXICO 88203

PHONE 505-622-7246  
FAX 505-622-1711  
EMAIL: jplandman@dfc.com

June 17, 2003

Ganada, Inc.  
P. O. Box 9  
Sudan, Texas 79371

Attention: Mr. Kent Gable

RE: Formal Notice of Water Disposal Application  
Section 25: Unit Well #302/SW/4SE/4.  
T8S, R28E, NMPM

Section 31: Unit Well #326/SE/4SW/4  
T8S, R29E, NMPM

Section 6: Unit Well # 333/NW/4SE/4  
T9S, R29E, NMPM,  
Chaves County, NM

Dear Mr. Gable:

On behalf of Mr. Russell Whited, d/b/a/ M.E.W. Enterprises, owner and operator of the Twin Lakes San Andres Unit, this letter shall serve as formal notice that Application For Authorization To Inject, concerning the captioned wells (plat enclosed), has been submitted to the Oil Conservation Division of the State of New Mexico Energy, Minerals and Natural Resources Department for approval to designate subject wells for water disposal/injection into the producing offset San Andres formation.

This "unit" contains numerous, approved water disposal/injection wells, many of which are located on Ganada, Inc. surface estate.

Interested parties must file objections or requests for hearing with the Oil Conservation Division, 1220 South St. Francis Drive, Santa Fe, NM 87505, within fifteen (15) days of receipt of this notice.

We appreciate your help and consideration in this matter.

Truly,

Jim Pierce, RLP

Encl.

Xc: M.E.W. Enterprises

U.S. Postal Service  
**CERTIFIED MAIL RECEIPT**  
(Domestic Mail Only; No Insurance Coverage Provided)

7002 0940 0000 2466 5985

**OFFICIAL USE**

Postage	\$ 0.37	UNIT ID# 0602 ROSWELL NM 88201 Postmark Here JUN 18 2003 KCT7M4 06/18/03
Certified Fee	2.30	
Return Receipt Fee (Endorsement Required)	1.75	
Restricted Delivery Fee (Endorsement Required)		
Total Postage & Fees	\$ 4.42	

Sent To Canada, Inc.  
Street, Apt. No., or PO Box No. P. O. Box 9  
City, State, ZIP+ 4 Sudan, Texas 79371  
PS Form 3800, January 2001 See Reverse for Instructions

**SENDER: COMPLETE THIS SECTION**

- Complete items 1, 2, and 3. Also complete item 4 if Restricted Delivery is desired.
- Print your name and address on the reverse so that we can return the card to you.
- Attach this card to the back of the mailpiece, or on the front if space permits.

1. Article Addressed to:

Canada, Inc.  
P. O. Box 9  
Sudan. Texas 79371

**COMPLETE THIS SECTION ON DELIVERY**

A. Signature

X *Haleigh Richards* ☐ Agent  
☐ Addressee

B. Received by (Printed Name)

*Haleigh Richards*

C. Date of Delivery

*6-23-03*D. Is delivery address different from item 1? ☐ YesIf YES, enter delivery address below: ☐ No

3. Service Type

- ☒ Certified Mail ☐ Express Mail  
☐ Registered ☐ Return Receipt for Merchandise  
☐ Insured Mail ☐ C.O.D.

4. Restricted Delivery? (Extra Fee)

☐ Yes

2. Article Number

(Transfer from service label)

7002 0460 0000 9342 3385

PS Form 3811, August 2001

Domestic Return Receipt

102595-01-M-0381

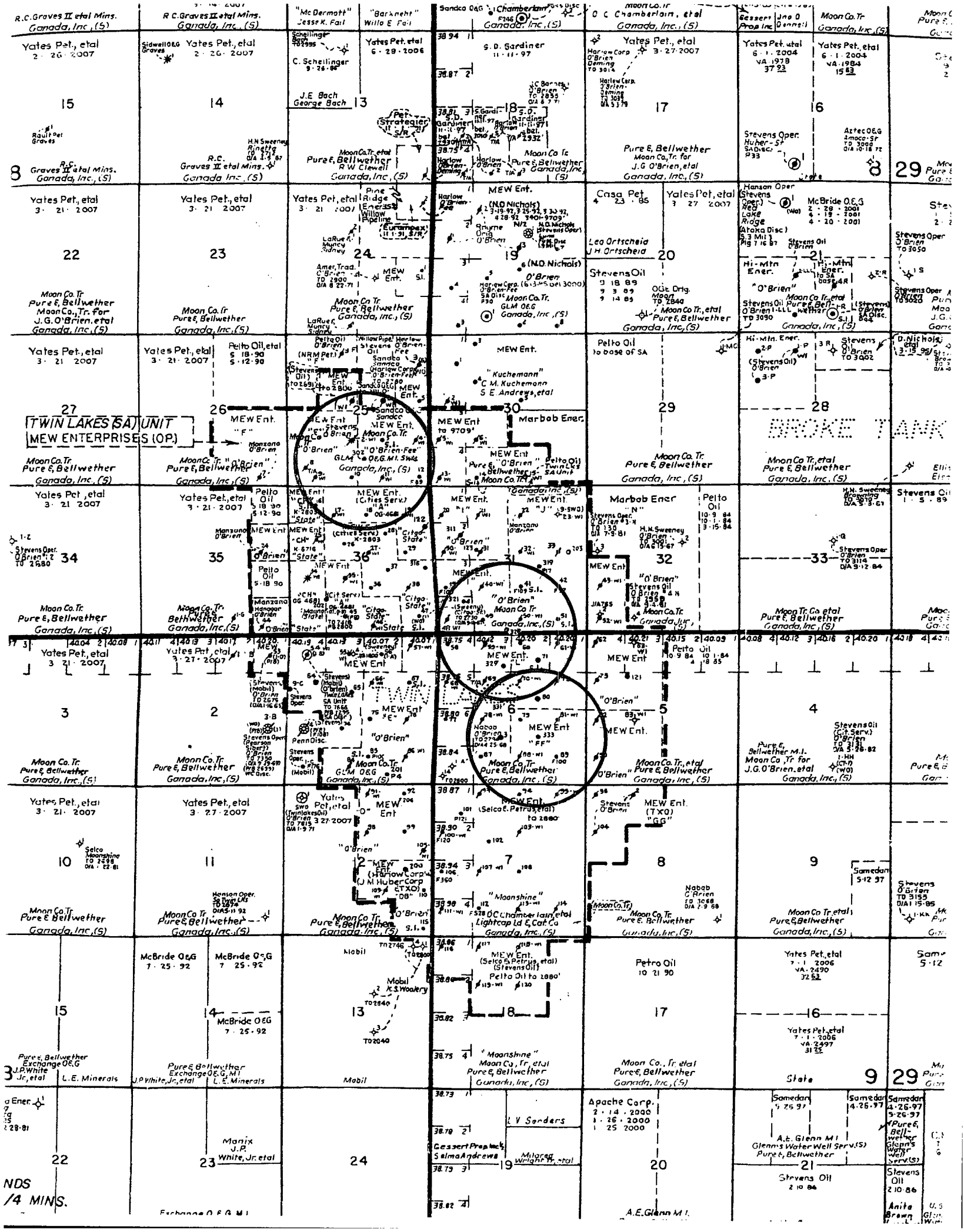

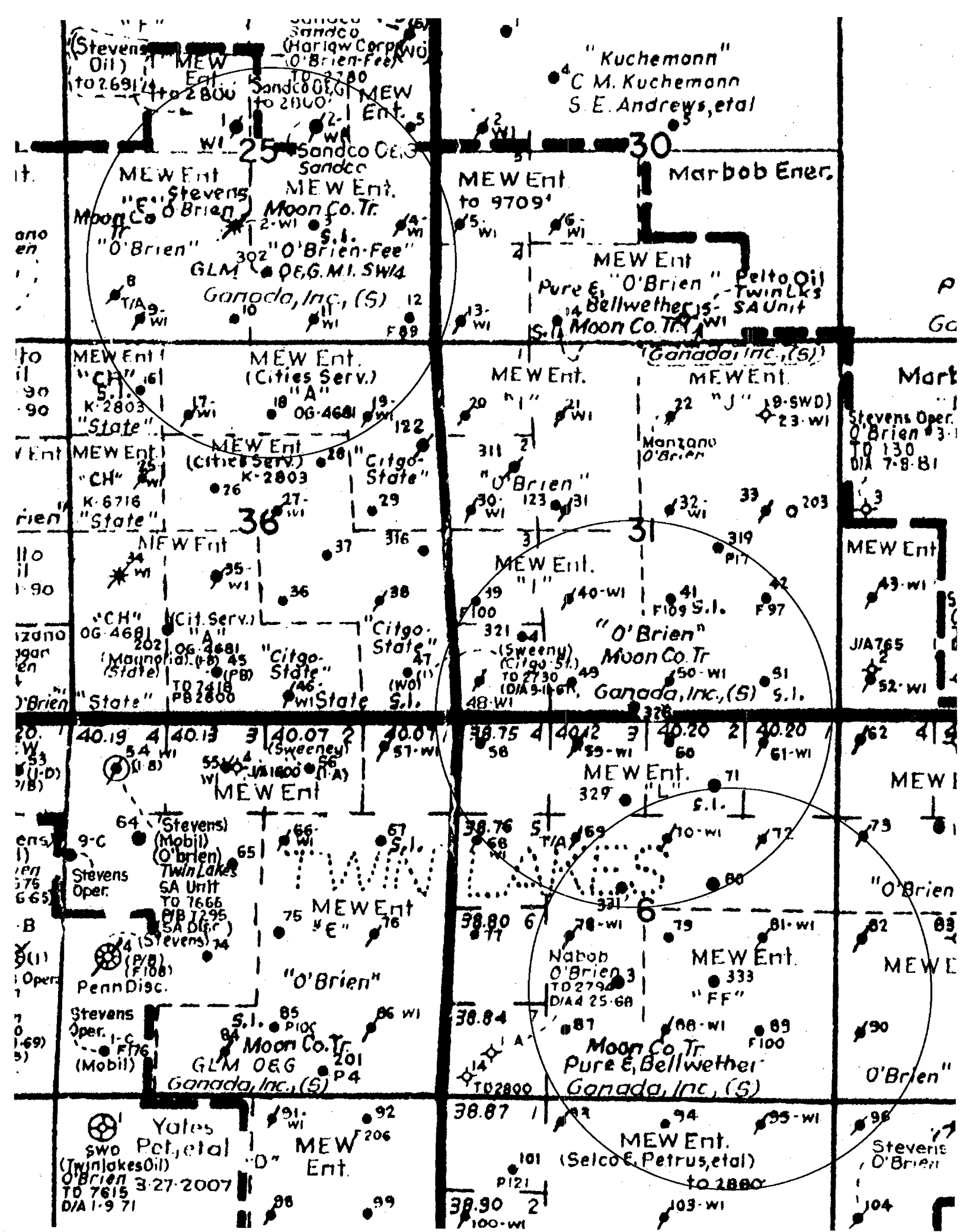

API	LEASE NAME	#	OPERATOR NAME	LOCATION	FIELD NAME	STATUS	OD ZONE	NAI	OIL CUM	GAS CUM	WTR CUM	LATITUDE	LONGITUDE
3000562070	TWIN LAKES SAN ANDRES UNI'	1	M E W ENTERPRISE	25F 8S 28E	TWIN LAKES	INA	SAN ANDRES		1,521	1,754	14,791	33.59149	-104.04282
3000562111	SANDCO	2	SANDCO OIL & GAS INC	25G 8S 28E	TWIN LAKES	P/A	SAN ANDRES		1,386	1,709	2,743	33.59151	-104.03852
3000560648	TWIN LAKES SAN ANDRES UNI'	2	M E W ENTERPRISE	25K 8S 28E	TWIN LAKES	ACT	SAN ANDRES		18,677	76,085	15,539	33.58783	-104.04282
3000560601	TWIN LAKES SAN ANDRES UNI'	3	M E W ENTERPRISE	25J 8S 28E	TWIN LAKES	INA	SAN ANDRES		62,011	55,885	526,886	33.58786	-104.03852
3000560579	TWIN LAKES SAN ANDRES UNI'	4	M E W ENTERPRISE	25I 8S 28E	TWIN LAKES	ACT	SAN ANDRES		16,868	5,530	29,707	33.58790	-104.03418
3000560492	TWIN LAKES SAN ANDRES UNI'	8	M E W ENTERPRISE	25M 8S 28E	TWIN LAKES	INA	SAN ANDRES		226	870	1,720	33.58506	-104.04825
3000560598	TWIN LAKES SAN ANDRES UNI'	9	M E W ENTERPRISE	25M 8S 28E	TWIN LAKES	ACT	SAN ANDRES		9,299	24,210	17,514	33.58416	-104.04717
3000560571	TWIN LAKES SAN ANDRES UNI'	10	M E W ENTERPRISE	25N 8S 28E	TWIN LAKES	INA	SAN ANDRES		69,820	140,310	59,016	33.58420	-104.04283
3000560563	TWIN LAKES SAN ANDRES UNI'	11	M E W ENTERPRISE	25O 8S 28E	TWIN LAKES	ACT	SAN ANDRES		83,735	60,447	118,218	33.58423	-104.03852
3000560578	TWIN LAKES SAN ANDRES UNI'	12	M E W ENTERPRISE	25P 8S 28E	TWIN LAKES	INA	SAN ANDRES		27,158	13,831	108,496	33.58427	-104.03418
3000560470	TWIN LAKES SAN ANDRES UNI'	16	M E W ENTERPRISE	36D 8S 28E	TWIN LAKES	ACT	SAN ANDRES		17,917	56,737	127,621	33.58144	-104.04711
3000560039	TWIN LAKES SAN ANDRES UNI'	17	M E W ENTERPRISE	36C 8S 28E	TWIN LAKES	ACT	SAN ANDRES		69,882	71,127	8,582	33.58055	-104.04492
3000560536	TWIN LAKES SAN ANDRES UNI'	18	M E W ENTERPRISE	36B 8S 28E	TWIN LAKES	INA	SAN ANDRES		93,179	58,665	1,428,036	33.58059	-104.04060
3000560560	TWIN LAKES SAN ANDRES UNI'	19	M E W ENTERPRISE	36A 8S 28E	TWIN LAKES	ACT	SAN ANDRES		75,711	90,736	7,998	33.58062	-104.03627
3000560334	TWIN LAKES SAN ANDRES UNI'	25	M E W ENTERPRISE	36E 8S 28E	TWIN LAKES	ACT	SAN ANDRES		12,898	43,690	4,459	33.57817	-104.04701
3000560031	TWIN LAKES SAN ANDRES UNI'	26	M E W ENTERPRISE	36F 8S 28E	TWIN LAKES	ACT	SAN ANDRES		115,060	72,681	129,162	33.57784	-104.04375
3000560521	TWIN LAKES SAN ANDRES UNI'	27	M E W ENTERPRISE	36G 8S 28E	TWIN LAKES	ACT	SAN ANDRES		80,432	65,966	2,918	33.57696	-104.04049
3000561633	TWIN LAKES SAN ANDRES UNI'	28	M E W ENTERPRISE	36G 8S 28E	TWIN LAKES	ACT	SAN ANDRES		30,650	14,417	446,873	33.57879	-104.03838
3000560695	TWIN LAKES SAN ANDRES UNI'	31	ENERGY DEVEL. CORP.	31F 8S 29E	TWIN LAKES	P/A	SAN ANDRES		50,093	59,640	81,456	33.57711	-104.02749
3000560795	TWIN LAKES SAN ANDRES UNI'	32	M E W ENTERPRISE	31G 8S 29E	TWIN LAKES	ACT	SAN ANDRES		60,696	37,355	7,692	33.57717	-104.02330
3000560657	TWIN LAKES SAN ANDRES UNI'	39	M E W ENTERPRISE	31 8S 29E	TWIN LAKES	ACT	SAN ANDRES		126,396	63,849	694,522	33.57345	-104.03171
3000560696	TWIN LAKES SAN ANDRES UNI'	40	M E W ENTERPRISE	31K 8S 29E	TWIN LAKES	ACT	SAN ANDRES		42,156	45,023	16,907	33.57348	-104.02737
3000560768	TWIN LAKES SAN ANDRES UNI'	41	M E W ENTERPRISE	31J 8S 29E	TWIN LAKES	INA	SAN ANDRES		73,506	82,368	297,248	33.57351	-104.02321
3000560802	TWIN LAKES SAN ANDRES UNI'	42	M E W ENTERPRISE	31I 8S 29E	TWIN LAKES	INA	SAN ANDRES		77,524	74,263	362,260	33.57354	-104.01888
3000560697	TWIN LAKES SAN ANDRES UNI'	48	M E W ENTERPRISE	31 8S 29E	TWIN LAKES	ACT	SAN ANDRES		22,423	45,825	30,165	33.57048	-104.03162
3000560767	TWIN LAKES SAN ANDRES UNI'	49	M E W ENTERPRISE	31N 8S 29E	TWIN LAKES	ACT	SAN ANDRES		86,239	45,742	781,626	33.57049	-104.02728
3000560796	TWIN LAKES SAN ANDRES UNI'	50	M E W ENTERPRISE	31O 8S 29E	TWIN LAKES	ACT	SAN ANDRES		83,791	114,755	15,026	33.57052	-104.02314
3000560810	TWIN LAKES SAN ANDRES UNI'	51	M E W ENTERPRISE	31P 8S 29E	TWIN LAKES	INA	SAN ANDRES		83,111	65,024	65,243	33.57055	-104.01881
3000561031	TWIN LAKES SAN ANDRES UNI'	58	M E W ENTERPRISE	6 9S 29E	TWIN LAKES	ACT	SAN ANDRES		42,000	21,885	82,737	33.56801	-104.03162
3000560807	TWIN LAKES SAN ANDRES UNI'	59	M E W ENTERPRISE	6 9S 29E	TWIN LAKES	ACT	SAN ANDRES		19,443	24,129	3,929	33.56804	-104.02695
3000560824	TWIN LAKES SAN ANDRES UNI'	60	M E W ENTERPRISE	6 9S 29E	TWIN LAKES	INA	SAN ANDRES		114,944	63,836	1,201,193	33.56807	-104.02315
3000560920	TWIN LAKES SAN ANDRES UNI'	61	M E W ENTERPRISE	6 9S 29E	TWIN LAKES	ACT	SAN ANDRES		53,698	61,617	1,479	33.56810	-104.01882
3000561007	TWIN LAKES SAN ANDRES UNI'	68	M E W ENTERPRISE	6 9S 29E	TWIN LAKES	ACT	SAN ANDRES		25,454	34,952	9,583	33.56438	-104.03183
3000560984	TWIN LAKES SAN ANDRES UNI'	69	M E W ENTERPRISE	6F 9S 29E	TWIN LAKES	ACT	SAN ANDRES		61,285	43,071	124,026	33.56441	-104.02749
3000560885	TWIN LAKES SAN ANDRES UNI'	70	M E W ENTERPRISE	6G 9S 29E	TWIN LAKES	ACT	SAN ANDRES		74,821	118,202	11,751	33.56444	-104.02333
3000562212	TWIN LAKES SAN ANDRES UNI'	71	M E W ENTERPRISE	6 9S 29E	TWIN LAKES	ACT	SAN ANDRES		41,400	2,550	1,349,105	33.56638	-104.02115
3000560886	TWIN LAKES SAN ANDRES UNI'	72	MANZANO OIL CORP.	6H 9S 29E	TWIN LAKES	P/A	SAN ANDRES		106,706	60,639	393,104	33.56447	-104.01900
3000560983	TWIN LAKES SAN ANDRES UNI'	73	MANZANO OIL CORP.	5E 9S 29E	TWIN LAKES	P/A	SAN ANDRES		40,641	24,055	5,446	33.56449	-104.01466
3000560995	TWIN LAKES SAN ANDRES UNI'	78	M E W ENTERPRISE	6K 9S 29E	TWIN LAKES	ACT	SAN ANDRES		90,881	139,282	7,292	33.56083	-104.02769
3000560982	TWIN LAKES SAN ANDRES UNI'	79	M E W ENTERPRISE	6J 9S 29E	TWIN LAKES	ACT	SAN ANDRES		158,986	59,487	845,653	33.56088	-104.02351
3000562213	TWIN LAKES SAN ANDRES UNI'	80	M E W ENTERPRISE	6G 9S 29E	TWIN LAKES	ACT	SAN ANDRES		64,522	17,812	1,127,548	33.56264	-104.02134
3000560993	TWIN LAKES SAN ANDRES UNI'	81	M E W ENTERPRISE	6I 9S 29E	TWIN LAKES	ACT	SAN ANDRES		88,540	50,197	12,216	33.56093	-104.01917
3000560994	TWIN LAKES SAN ANDRES UNI'	82	MANZANO OIL CORP.	5L 9S 29E	TWIN LAKES	P/A	SAN ANDRES		42,025	11,610	78,243	33.56095	-104.01483
3000561030	TWIN LAKES SAN ANDRES UNI'	87	M E W ENTERPRISE	6N 9S 29E	TWIN LAKES	INA	SAN ANDRES		5,198	8,592	4,743	33.55725	-104.02738
3000561006	TWIN LAKES SAN ANDRES UNI'	88	M E W ENTERPRISE	6O 9S 29E	TWIN LAKES	ACT	SAN ANDRES		66,252	33,513	5,010	33.55725	-104.02369
3000561022	TWIN LAKES SAN ANDRES UNI'	89	M E W ENTERPRISE	6P 9S 29E	TWIN LAKES	ACT	SAN ANDRES		127,074	75,320	743,975	33.55730	-104.01935
3000561033	TWIN LAKES SAN ANDRES UNI'	90	MANZANO OIL CORP.	5M 9S 29E	TWIN LAKES	P/A	SAN ANDRES		52,493	19,722	24,251	33.55732	-104.01501
3000561106	TWIN LAKES SAN ANDRES UNI'	94	M E W ENTERPRISE	7B 9S 29E	TWIN LAKES	ACT	SAN ANDRES		90,237	23,561	69,360	33.55362	-104.02382
3000561107	TWIN LAKES SAN ANDRES UNI'	95	M E W ENTERPRISE	7A 9S 29E	TWIN LAKES	ACT	SAN ANDRES		38,151	9,276	10,433	33.55367	-104.01949

3000561076	TWIN LAKES SAN ANDRES UNI'	96	MANZANO OIL CORP.	8D 9S 29E	TWIN LAKES	P/A	SAN ANDRES	7,648	1,099	15,414	33.55370	-104.01515
3000562845	TWIN LAKES SAN ANDRES UNI'	123	M E W ENTERPRISE	31F 8S 29E SE NW	TWIN LAKES	ACT	SAN ANDRES	27,553		550,620	33.57712	-104.02750
3000563191	TWIN LAKES SAN ANDRES UNI'	302	M E W ENTERPRISE	25N 8S 28E SW SE	TWIN LAKES	INA	SAN ANDRES	278		7,033	33.58592	-104.04069
3000563187	TWIN LAKES SAN ANDRES UNI'	319	M E W ENTERPRISE	31J 8S 29E NW SE	TWIN LAKES	ACT	SAN ANDRES	1,470		22,588	33.57534	-104.02109
3000563188	TWIN LAKES SAN ANDRES UNI'	321	M E W ENTERPRISE	31 8S 29E SW SW	TWIN LAKES	ACT	SAN ANDRES	2,820		20,273	33.57198	-104.02949
3000563189	TWIN LAKES SAN ANDRES UNI'	326	M E W ENTERPRISE	31N 8S 29E SE SW	TWIN LAKES	INA	SAN ANDRES	492		26,969	33.56927	-104.02475
3000563190	TWIN LAKES SAN ANDRES UNI'	329	M E W ENTERPRISE	6 9S 29E NE NW	TWIN LAKES	ACT	SAN ANDRES	4,709		37,384	33.56583	-104.02524
3000563192	TWIN LAKES SAN ANDRES UNI'	331	M E W ENTERPRISE	6F 9S 29E SE NW	TWIN LAKES	ACT	SAN ANDRES	5,512		29,460	33.56261	-104.02542
3000563193	TWIN LAKES SAN ANDRES UNI'	333	M E W ENTERPRISE	6J 9S 29E NW SE	TWIN LAKES	INA	SAN ANDRES	504		28,159	33.55914	-104.02143
								5,747,185	5,927,105	24,435,297		



# Wells within 1/2 mile radius of Injection wells

