

CMD :  
OG5SECT

ONGARD

INQUIRE LAND BY SECTION

07/12/06 09:45:29  
OGOMES -TPS2  
PAGE NO: 1

Sec : 26 Twp : 17S Rng : 34E Section Type : NORMAL

D 40.00 CS B01520 0002 MOBIL PRODUCING T U 12/17/38 A A	C 40.00 CS B01520 0002 MOBIL PRODUCING T U 12/17/38 P A	B 40.00 CS B01520 0003 XTO ENERGY, INC. U 12/17/38 A A	A 40.00 CS B01520 0003 XTO ENERGY, INC. U 12/17/38 P A A
E 40.00 CS B01520 0002 MOBIL PRODUCING T U 12/17/38 A A A	F 40.00 CS B01520 0002 MOBIL PRODUCING T U 12/17/38 A A	G 40.00 CS B01520 0003 XTO ENERGY, INC. U 12/17/38 A A	H 40.00 CS B01520 0003 XTO ENERGY, INC. U 12/17/38 C A A A
L 40.00 CS B01520 0002 MOBIL PRODUCING T U 12/17/38 A A	K 40.00 CS B01520 0002 MOBIL PRODUCING T U 12/17/38 A A	J 40.00 CS B01520 0003 XTO ENERGY, INC. U 12/17/38 P A A	I 40.00 CS B01520 0002 MOBIL PRODUCING T U 12/17/38 A A A A
M 40.00 CS B01520 0002 MOBIL PRODUCING T U 12/17/38 A A	N 40.00 CS B01520 0002 MOBIL PRODUCING T U 12/17/38 A A A	O 40.00 CS B01520 0003 XTO ENERGY, INC. U 12/17/38 A A A A	P 40.00 CS B01520 0002 MOBIL PRODUCING T U 12/17/38 P A A A

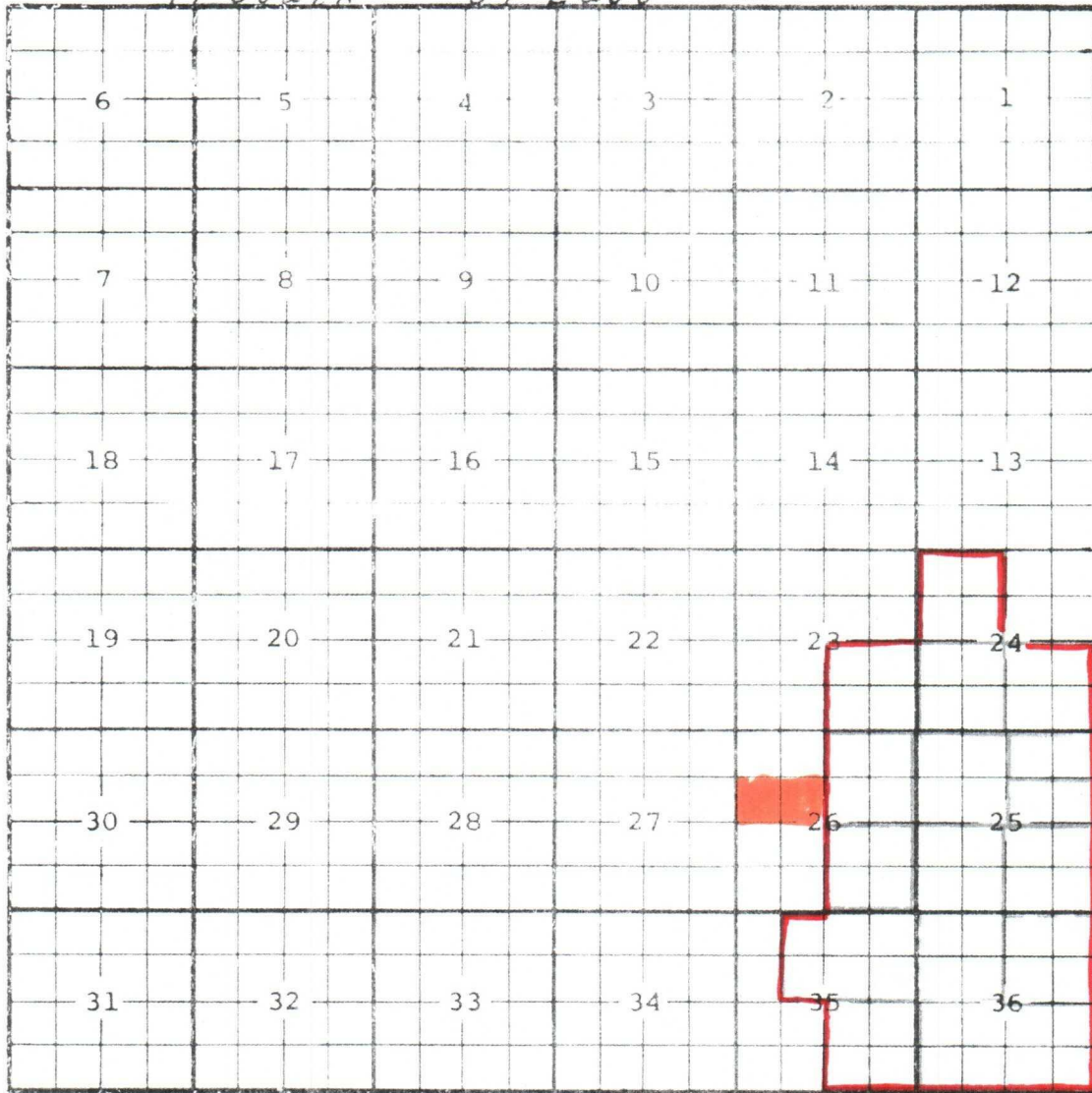
COUNTY LeaPOOL Vacuum-WolfcampTOWNSHIP 17-South RANGE 34-East NMFM

Description:  $\frac{SE}{4}$  Sec. 26, (R-2422, 2-13-63).  
 Ext:  $\frac{SW}{4}$  Sec. 25;  $\frac{NE}{4}$  Sec. 26;  $\frac{NE}{4}$  &  $\frac{E}{2}$   $\frac{NW}{4}$  Sec. 35;  $\frac{NW}{4}$  &  $\frac{S}{2}$  Sec. 36 (R-2527, 8-1-63)  
 -  $\frac{SE}{4}$  Sec. 25;  $\frac{NE}{4}$  Sec. 36 (R-2639, 2-1-64) -  $\frac{SE}{4}$  Sec. 35 (R-2705, 6-1-64)  
 -  $\frac{S}{2}$  &  $\frac{NE}{4}$  Sec. 25 (R-2781, 11-1-64) -  $\frac{N}{2}$  &  $\frac{NE}{4}$  Sec. 25 (R-2967, 10-1-65) -  $\frac{NW}{4}$  Sec. 25 (R-3043, 3-1-66)  
 -  $\frac{SW}{4}$  Sec. 24 (R-3104, 9-1-66) -  $\frac{SE}{4}$  Sec. 23 (R-3166, 1-1-67) -  $\frac{NW}{4}$  Sec. 24 (R-3280, 8-1-67)  
 -  $\frac{SE}{4}$  Sec. 24 (R-3895, 1-1-70)

BEFORE THE OIL CONSERVATION COMMISSION  
OF THE STATE OF NEW MEXICO

IN THE MATTER OF THE HEARING  
CALLED BY THE OIL CONSERVATION  
COMMISSION OF NEW MEXICO FOR  
THE PURPOSE OF CONSIDERING:

CASE No. 2740  
Order No. R-2422  
NOMENCLATURE

APPLICATION OF SOCONY MOBIL OIL  
COMPANY, INC., TO CREATE A NEW  
POOL FOR WOLFCAMP PRODUCTION AND  
FOR SPECIAL POOL RULES, LEA  
COUNTY, NEW MEXICO.

*See also R-2422*

ORDER OF THE COMMISSION

BY THE COMMISSION:

This cause came on for hearing at 9 o'clock a.m. on January 23, 1963, at Santa Fe, New Mexico, before Elvis A. Utz, Examiner duly appointed by the Oil Conservation Commission of New Mexico, hereinafter referred to as the "Commission," in accordance with Rule 1214 of the Commission Rules and Regulations.

NOW, on this 13th day of February, 1963, the Commission, a quorum being present, having considered the application, the evidence adduced, and the recommendations of the Examiner, Elvis A. Utz, and being fully advised in the premises,

FINDS:

(1) That due public notice having been given as required by law, the Commission has jurisdiction of this cause and the subject matter thereof.

(2) That the applicant, Socony Mobil Oil Company, Inc., seeks the creation of a new pool for Wolfcamp production and the promulgation of temporary special rules and regulations governing said pool, including a provision for 80-acre spacing units.

(3) That a new oil pool for Wolfcamp production should be created and designated the Vacuum-Wolfcamp Oil Pool. This pool was discovered by the Socony Mobil State Bridges Well No. 95, located in Unit P of Section 26, Township 17 South, Range 34 East, NMPM, Lea County, New Mexico. The top of the perforations in the Wolfcamp formation is at 9518 feet.

(4) That temporary special rules and regulations establishing 80-acre spacing should be promulgated for the subject pool in order to prevent the possibility of economic loss resulting from the drilling of unnecessary wells and in order to allow the

operators in the subject pool to gather information concerning the reservoir characteristics of the pool.

(5) That the temporary special rules and regulations should provide for limited well locations in order to assure orderly development of the pool and protect correlative rights.

(6) That the temporary special rules and regulations should be established for a one-year period and that during this one-year period all operators in the subject pool should gather all available information relative to drainage and recoverable reserves.

(7) That this case should be reopened at an examiner hearing in February, 1964, at which time the operators in the subject pool should appear and show cause why the Vacuum-Wolfcamp Oil Pool should not be developed on 40-acre proration units.

IT IS THEREFORE ORDERED:

(1) That a new pool in Lea County, New Mexico, classified as an oil pool for Wolfcamp production is hereby created and designated the Vacuum-Wolfcamp Oil Pool, consisting of the following-described area:

TOWNSHIP 17 SOUTH, RANGE 34 EAST, NMPM  
Section 26: SE/4

(2) That special rules and regulations for the Vacuum-Wolfcamp Oil Pool are hereby promulgated as follows, effective March 1, 1963.

SPECIAL RULES AND REGULATIONS  
FOR THE  
VACUUM-WOLFCAMP OIL POOL

RULE 1. Each well completed or recompleted in the Vacuum-Wolfcamp Oil Pool or in the Wolfcamp formation within one mile of the Vacuum-Wolfcamp Oil Pool, and not nearer to or within the limits of another designated Wolfcamp pool, shall be spaced, drilled, operated, and produced in accordance with the Special Rules and Regulations hereinafter set forth.

RULE 2. Each well completed or recompleted in the Vacuum-Wolfcamp Oil Pool shall be located on a standard unit containing 80 acres, more or less, consisting of the N/2, S/2, E/2, or W/2 of a single governmental quarter section; provided, however, that nothing contained herein shall be construed as prohibiting the drilling of a well on each of the quarter-quarter sections in the unit.

RULE 3. The Secretary-Director may grant an exception to the requirements of Rule 2 without notice and hearing when an application has been filed for a non-standard unit comprising a single quarter-quarter section or lot. All operators offsetting the proposed non-standard unit shall be notified of the application by registered or certified mail, and the application shall state that such notice has been furnished. The Secretary-Director may approve the application upon receipt of written waivers from all offset operators or if no offset operator has entered an objection to the formation of the non-standard unit within 30 days after the Secretary-Director has received the application.

RULE 4. The first well drilled on every standard or non-standard unit in the Vacuum-Wolfcamp Oil Pool shall be located within 200 feet of the center of either the NW/4 or the SE/4 of a governmental quarter section.

RULE 5. The Secretary-Director may grant an exception to the requirements of Rule 4 without notice and hearing when an application has been filed for an unorthodox location necessitated by topographical conditions or the recompletion of a well previously drilled to another horizon. All operators offsetting the proposed unorthodox location shall be notified of the application by registered or certified mail, and the application shall state that such notice has been furnished. The Secretary-Director may approve the application upon receipt of written waivers from all offset operators or if no offset operator has entered an objection to the unorthodox location within 20 days after the Secretary-Director has received the application.

RULE 6. A standard proration unit (79 through 81 acres) in the Vacuum-Wolfcamp Oil Pool shall be assigned an 80-acre proportional factor of 4.77 for allowable purposes, and in the event there is more than one well on an 80-acre proration unit, the operator may produce the allowable assigned to the unit from the wells on the unit in any proportion.

The allowable assigned to a non-standard proration unit shall bear the same ratio to a standard allowable in the Vacuum-Wolfcamp Oil Pool as the acreage in such non-standard unit bears to 80 acres.

IT IS FURTHER ORDERED:

(1) That any well presently drilling to or completed in the Wolfcamp formation within the Vacuum-Wolfcamp Oil Pool or within one mile of the Vacuum-Wolfcamp Oil Pool that will not comply with the well location requirements of Rule 4 is hereby granted an exception to the requirements of Rule 4. The operator shall notify the Hobbs District Office in writing of the name and location of the well on or before March 1, 1963.

-4-

CASE No. 2740  
Order No. R-2422

(2) That any operator desiring to dedicate 80 acres to a well presently drilling or completed in the Vacuum-Wolfcamp Oil Pool shall file a new Form C-128 with the Commission on or before March 1, 1963.

(3) That this case shall be reopened at an examiner hearing in February, 1964, at which time the operators in the subject pool may appear and show cause why the Vacuum-Wolfcamp Oil Pool should not be developed on 40-acre proration units.

(4) That jurisdiction of this cause is retained for the entry of such further orders as the Commission may deem necessary.

DONE at Santa Fe, New Mexico, on the day and year hereinabove designated.

STATE OF NEW MEXICO  
OIL CONSERVATION COMMISSION

JACK M. CAMPBELL, Chairman

E. S. WALKER, Member

A. L. PORTER, Jr., Member & Secretary

S E A L

esr/

BEFORE THE OIL CONSERVATION COMMISSION  
OF THE STATE OF NEW MEXICO

IN THE MATTER OF THE HEARING  
CALLED BY THE OIL CONSERVATION  
COMMISSION OF NEW MEXICO FOR  
THE PURPOSE OF CONSIDERING:

CASE No. 2740  
Order No. R-2422-A

APPLICATION OF SOCONY MOBIL OIL  
COMPANY, INC., TO CREATE A NEW  
POOL FOR WOLFCAMP PRODUCTION AND  
FOR SPECIAL POOL RULES, LEA  
COUNTY, NEW MEXICO.

ORDER OF THE COMMISSION

BY THE COMMISSION:

This cause came on for hearing at 9 o'clock a.m. on  
February 19, 1964, at Santa Fe, New Mexico, before Examiner  
Elvis A. Utz.

NOW, on this 13th day of March, 1964, the Commission, a  
quorum being present, having considered the testimony, the record,  
and the recommendations of the Examiner, and being fully advised  
in the premises,

FINDS:

(1) That due public notice having been given as required by  
law, the Commission has jurisdiction of this cause and the subject  
matter thereof.

(2) That by Order No. R-2422 dated February 13, 1963,  
temporary Special Rules and Regulations were promulgated for the  
Vacuum-Wolfcamp Oil Pool.

(3) That pursuant to the provisions of Order No. R-2422,  
this case was reopened to allow the operators in the subject pool  
to appear and show cause why the Vacuum-Wolfcamp Oil Pool should  
not be developed on 40-acre proration units.

(4) That the evidence establishes that one well in the  
Vacuum-Wolfcamp Oil Pool can efficiently and economically drain  
and develop 80 acres.

(5) That to prevent the economic loss caused by the drill-  
ing of unnecessary wells, to avoid the augmentation of risk  
arising from the drilling of an excessive number of wells, to  
prevent reduced recovery which might result from the drilling of

-2-

CASE No. 2740

Order No. R-2422-A

too few wells, and to otherwise prevent waste and protect correlative rights, the Special Rules and Regulations promulgated by Order No. R-2422 should be continued in full force and effect until further order of the Commission.

(6) That the Special Rules and Regulations promulgated by Order No. R-2422 have afforded and will afford to the owner of each property in the pool the opportunity to produce his just and equitable share of the oil in the pool.

IT IS THEREFORE ORDERED:

(1) That the Special Rules and Regulations governing the Vacuum-Wolfcamp Oil Pool promulgated by Order No. R-2422 are hereby continued in full force and effect until further order of the Commission.

(2) That jurisdiction of this cause is retained for the entry of such further orders as the Commission may deem necessary.

DONE at Santa Fe, New Mexico, on the day and year hereinabove designated.

STATE OF NEW MEXICO  
OIL CONSERVATION COMMISSION

JACK M. CAMPBELL, Chairman

E. S. WALKER, Member

S E A L

A. L. PORTER, Jr., Member & Secretary

esr/



COUNTY Lea

POOL

North Vacuum - Morrow Gas

320

TOWNSHIP 17 South

RANGE

34 East

NMPM

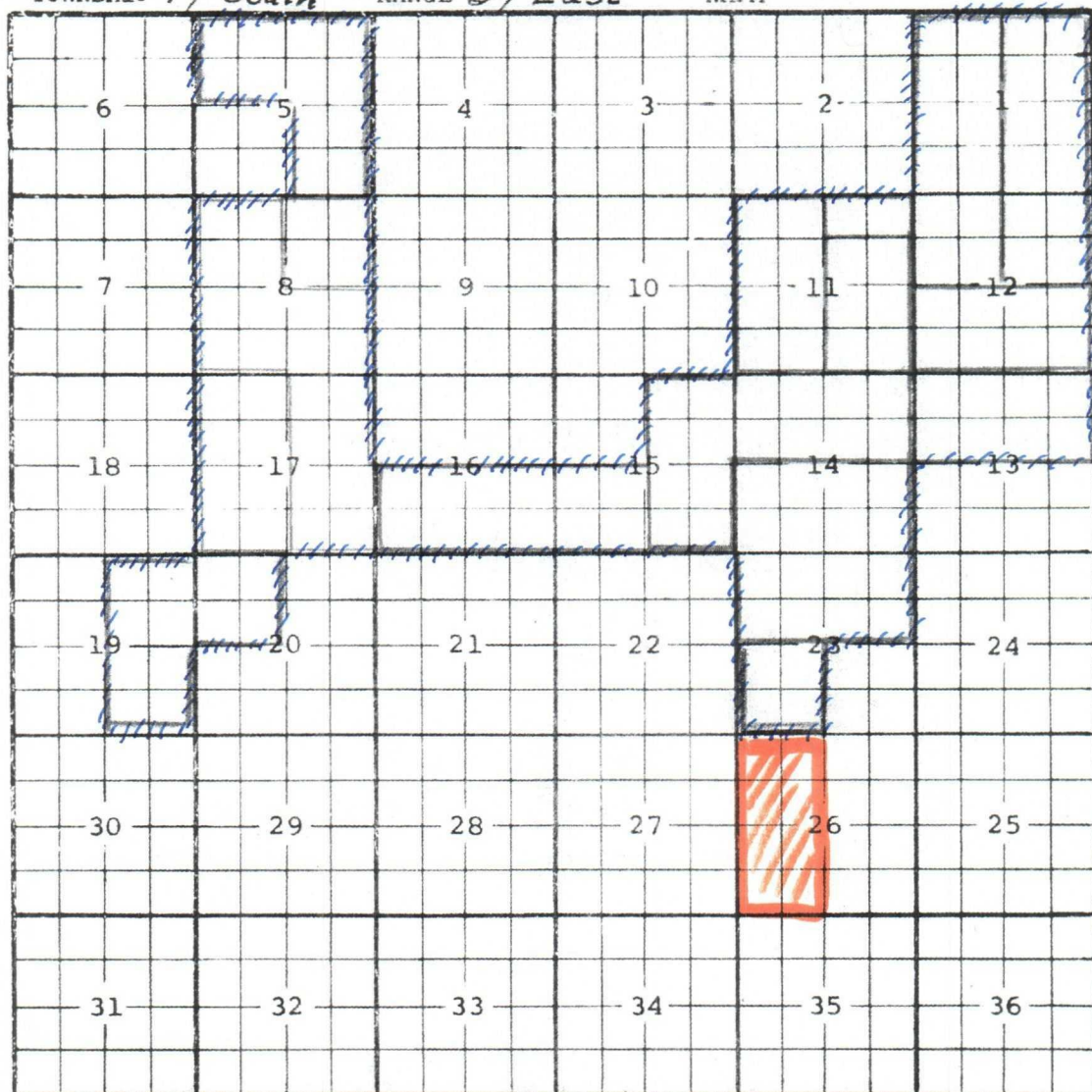

Description:  $\frac{N}{2} \frac{NE}{4}$  Sec. 11 (R-3084, 6-30-66)

Ext:  $\frac{SE}{4} \frac{NE}{4}$  &  $\frac{SE}{4}$  Sec. 11 (R-3562, 12-1-68)

Reclassified & Redefined: Reclassified as a gas pool and redesignated North Vacuum - Morrow Gas Pool comprising All Sec. 11 (R-3792, 7-15-69)

Ext:  $\frac{N}{2}$  Sec. 14;  $\frac{E}{2}$  Sec. 15 (R-4032, 10-1-70) -  $\frac{S}{2}$  Sec. 12;  $\frac{E}{2}$  Sec. 14;  $\frac{N}{2}$  Sec. 23 (R-4194, 10-1-71)

-  $\frac{N}{2}$  Sec. 13;  $\frac{SW}{4}$  Sec. 15;  $\frac{S}{2}$  Sec. 16 (R-4351, 8-1-72)

Ext:  $\frac{W}{2}$  &  $\frac{SE}{4}$  Sec. 8,  $\frac{E}{2}$  Sec. 17 (R-5215, 6-1-76)

Vertical limits extended to include Atoka Formation and pool redesignated North Vacuum - Atoka - Morrow Gas (R-5334, 12-1-76)

Ext:  $\frac{NE}{4}$  Sec. 8,  $\frac{W}{2}$  Sec. 17 (R-5511, 9-1-77)

Ext:  $\frac{E}{2}$  Sec. 1,  $\frac{NW}{4}$  Sec. 12 (R-2307, 6-14-83) Ext:  $\frac{E}{2}$  Sec. 19,  $\frac{NW}{4}$  Sec. 20 (R-1134, 1-12-00)

Ext:  $\frac{N}{2}$  and  $\frac{SE}{4}$  Sec. 5 (R-11475, 10-24-00) Ext:  $\frac{W}{2}$  Sec. 1,  $\frac{NW}{4}$  Sec. 12 (R-12141, 5-10-04)

Ext:  $\frac{SW}{4}$  Sec. 23 (R-12449, 10-27-05)

CMD :  
OG6IWCM

ONGARD  
INQUIRE WELL COMPLETIONS

07/12/06 10:57:16  
OGOMES -TPS2

API Well No : 30 25 36093 Eff Date : 04-01-2003 WC Status : A  
Pool Idn : 86800 VACUUM;ATOKA-MORROW, NORTH (GAS)  
OGRID Idn : 151416 FASKEN OIL & RANCH LTD  
Prop Idn : 31012 KIRBY 26 STATE

Well No : 001  
GL Elevation: 4032

	U/L	Sec	Township	Range	North/South	East/West	Prop/Act(P/A)
	---	---	-----	-----	-----	-----	-----
B.H. Locn	: E	26	17S	34E	FTG 1980 F N	FTG 1310 F W	A

Lot Identifier:  
Dedicated Acre: 320.00  
Lease Type : S  
Type of consolidation (Comm, Unit, Forced Pooling - C/U/F/O) :

E6317: No more recs. for this api well no.

PF01 HELP	PF02	PF03 EXIT	PF04 GoTo	PF05	PF06
PF07	PF08	PF09	PF10 NEXT-WC	PF11 HISTORY	PF12 NXTREC

CMD :  
OG6ACRE

ONGARD  
C102-DEDICATE ACREAGE

07/12/06 10:57:21  
OGOMES -TPS2  
Page No : 1

API Well No : 30 25 36093 Eff Date : 01-17-2003  
Pool Idn : 86800 VACUUM;ATOKA-MORROW, NORTH (GAS)  
Prop Idn : 31012 KIRBY 26 STATE Well No : 001  
Spacing Unit : 57281 OCD Order : Simultaneous Dedication:  
Sect/Twp/Rng : 26 17S 34E Acreage : 320.00 Revised C102? (Y/N) :  
Dedicated Land:

S	Base	U/L	Sec	Twp	Rng	Acreage	L/W	Ownership	Lot	Idn
	C	26		17S	34E	40.00	N	ST		
	D	26		17S	34E	40.00	N	ST		
	E	26		17S	34E	40.00	N	ST		
	F	26		17S	34E	40.00	N	ST		
	K	26		17S	34E	40.00	N	ST		
	L	26		17S	34E	40.00	N	ST		
	M	26		17S	34E	40.00	N	ST		
	N	26		17S	34E	40.00	N	ST		

E0005: Enter data to modify or PF keys to scroll

PF01 HELP	PF02	PF03 EXIT	PF04 GoTo	PF05	PF06 CONFIRM
PF07 BKWD	PF08 FWD	PF09	PF10 LAND	PF11 NXTSEC	PF12 RECONF

CMD :  
OG6IPRD

ONGARD  
INQUIRE PRODUCTION BY POOL/WELL

07/12/06 10:57:29  
OGOMES -TPS2  
Page No: 1

OGRID Identifier : 151416 FASKEN OIL & RANCH LTD  
Pool Identifier : 86800 VACUUM;ATOKA-MORROW, NORTH (GAS)  
API Well No : 30 25 36093 Report Period - From : 01 2000 To : 06 2006

API Well No	Property Name	Prod.	Days	Production Volumes	Well		
		MM/YY	Prod	Gas	Oil	Water	Stat
30 25 36093	KIRBY 26 STATE	03 03			209		S
30 25 36093	KIRBY 26 STATE	04 03					S
30 25 36093	KIRBY 26 STATE	05 03					S
30 25 36093	KIRBY 26 STATE	06 03	24	57491	8531	15	P
30 25 36093	KIRBY 26 STATE	07 03	31	69210	5832		P
30 25 36093	KIRBY 26 STATE	08 03	31	90328	4205		P
30 25 36093	KIRBY 26 STATE	09 03	30	70470	1971	40	P

Reporting Period Total (Gas, Oil) :

M0025: Enter PF keys to scroll

PF01 HELP	PF02	PF03 EXIT	PF04 GoTo	PF05	PF06 CONFIRM
PF07 BKWD	PF08 FWD	PF09	PF10 NXTPOOL	PF11 NXTOGD	PF12

CMD :  
OG6IPRD

ONGARD  
INQUIRE PRODUCTION BY POOL/WELL

07/12/06 10:57:34  
OGOMES -TPS2  
Page No: 2

OGRID Identifier : 151416 FASKEN OIL & RANCH LTD  
Pool Identifier : 86800 VACUUM;ATOKA-MORROW, NORTH (GAS)  
API Well No : 30 25 36093 Report Period - From : 01 2000 To : 06 2006

API Well No	Property Name	Prodn. Days MM/YY Prod	Production Volumes Gas Oil Water	Well Stat
30 25 36093	KIRBY 26 STATE	10 03 31	57492 1152	37 P
30 25 36093	KIRBY 26 STATE	11 03 30	44827 701	15 P
30 25 36093	KIRBY 26 STATE	12 03 31	38226 511	23 P
30 25 36093	KIRBY 26 STATE	01 04 31	30817 365	18 P
30 25 36093	KIRBY 26 STATE	02 04 27	30811 256	18 P
30 25 36093	KIRBY 26 STATE	03 04 31	30301 218	24 P
30 25 36093	KIRBY 26 STATE	04 04 30	24383 160	9 P

Reporting Period Total (Gas, Oil) :

E0049: User may continue scrolling.

PF01 HELP	PF02	PF03 EXIT	PF04 GoTo	PF05	PF06 CONFIRM
PF07 BKWD	PF08 FWD	PF09	PF10 NXTPOOL	PF11 NXTOGD	PF12

CMD :  
OG6IPRD

ONGARD  
INQUIRE PRODUCTION BY POOL/WELL

07/12/06 10:57:35  
OGOMES -TPS2  
Page No: 3

OGRID Identifier : 151416 FASKEN OIL & RANCH LTD  
Pool Identifier : 86800 VACUUM;ATOKA-MORROW, NORTH (GAS)  
API Well No : 30 25 36093 Report Period - From : 01 2000 To : 06 2006

API Well No	Property Name	Prodn. MM/YY	Days Prod	Production Gas	Volumes Oil	Water	Well Stat
30 25 36093	KIRBY 26 STATE	05 04	31	24732	143	12	P
30 25 36093	KIRBY 26 STATE	06 04	30	19977	93	3	P
30 25 36093	KIRBY 26 STATE	07 04	31	17256	84	18	P
30 25 36093	KIRBY 26 STATE	08 04	28	8536	18	3	P
30 25 36093	KIRBY 26 STATE	09 04	30	12762	45	18	P
30 25 36093	KIRBY 26 STATE	10 04	31	9482	44	15	P
30 25 36093	KIRBY 26 STATE	11 04	30	5605	42	12	P

Reporting Period Total (Gas, Oil) :

E0049: User may continue scrolling.

PF01 HELP	PF02	PF03 EXIT	PF04 GoTo	PF05	PF06 CONFIRM
PF07 BKWD	PF08 FWD	PF09	PF10 NXTPOOL	PF11 NXTOGD	PF12

CMD :  
OG6IPRD

ONGARD  
INQUIRE PRODUCTION BY POOL/WELL

07/12/06 10:57:37  
OGOMES -TPS2  
Page No: 4

OGRID Identifier : 151416 FASKEN OIL & RANCH LTD  
Pool Identifier : 86800 VACUUM;ATOKA-MORROW, NORTH (GAS)  
API Well No : 30 25 36093 Report Period - From : 01 2000 To : 06 2006

API Well No	Property Name	Prodn. MM/YY	Days Prod	Production Gas	Volumes Oil	Water	Well Stat
30 25 36093	KIRBY 26 STATE	12 04	30	3510	6	3	P
30 25 36093	KIRBY 26 STATE	01 05	31	3635	33	9	P
30 25 36093	KIRBY 26 STATE	02 05	28	6301	20	12	P
30 25 36093	KIRBY 26 STATE	03 05	31	5338	30	21	P
30 25 36093	KIRBY 26 STATE	04 05	29	4673	9	9	P
30 25 36093	KIRBY 26 STATE	05 05	31	4382		6	P
30 25 36093	KIRBY 26 STATE	06 05	30	3925			P

Reporting Period Total (Gas, Oil) :

E0049: User may continue scrolling.

PF01 HELP	PF02	PF03 EXIT	PF04 GoTo	PF05	PF06 CONFIRM
PF07 BKWD	PF08 FWD	PF09	PF10 NXTPOOL	PF11 NXTOGD	PF12

CMD :  
OG6IPRD

ONGARD  
INQUIRE PRODUCTION BY POOL/WELL

07/12/06 10:57:38  
OGOMES -TPS2  
Page No: 5

OGRID Identifier : 151416 FASKEN OIL & RANCH LTD  
Pool Identifier : 86800 VACUUM;ATOKA-MORROW, NORTH (GAS)  
API Well No : 30 25 36093 Report Period - From : 01 2000 To : 06 2006

API Well No	Property Name	Prod.	Days	Production Volumes	Well		
		MM/YY	Prod	Gas	Oil	Water	Stat
30 25 36093	KIRBY 26 STATE	07 05	28	2087		8	P
30 25 36093	KIRBY 26 STATE	08 05	31	2162		2	P
30 25 36093	KIRBY 26 STATE	09 05	26	2735		3	P
30 25 36093	KIRBY 26 STATE	10 05	31	2331			P
30 25 36093	KIRBY 26 STATE	11 05	21	1002			P
30 25 36093	KIRBY 26 STATE	12 05	31	2090			P
30 25 36093	KIRBY 26 STATE	01 06	31	1404	5	4	P

Reporting Period Total (Gas, Oil) :

E0049: User may continue scrolling.

PF01 HELP	PF02	PF03 EXIT	PF04 GoTo	PF05	PF06 CONFIRM
PF07 BKWD	PF08 FWD	PF09	PF10 NXTPOOL	PF11 NXTOGD	PF12



CMD :  
OG6IPRD

ONGARD  
INQUIRE PRODUCTION BY POOL/WELL

07/12/06 10:57:39  
OGOMES -TPS2  
Page No: 6

OGRID Identifier : 151416 FASKEN OIL & RANCH LTD  
Pool Identifier : 86800 VACUUM;ATOKA-MORROW, NORTH (GAS)  
API Well No : 30 25 36093 Report Period - From : 01 2000 To : 06 2006

API Well No	Property Name	Prodn. MM/YY	Days Prod	Production Volumes Gas	Oil	Water	Well Stat
30 25 36093	KIRBY 26 STATE	02 06	28	607			P
30 25 36093	KIRBY 26 STATE	03 06	14	74			S
30 25 36093	KIRBY 26 STATE	04 06					S
30 25 36093	KIRBY 26 STATE	05 06	1	1			S

Reporting Period Total (Gas, Oil) : 688963 24683 357

E0049: User may continue scrolling.

PF01 HELP	PF02	PF03 EXIT	PF04 GoTo	PF05	PF06 CONFIRM
PF07 BKWD	PF08 FWD	PF09	PF10 NXTPOOL	PF11 NXTOGD	PF12

Submit 3 Copies To Appropriate District  
Office  
District I  
1625 N. French Dr., Hobbs, NM 87240  
District II  
811 South First, Artesia, NM 87210  
District III  
1000 Rio Brazos Rd., Aztec, NM 87410  
District IV  
2040 South Pacheco, Santa Fe, NM 87505

State of New Mexico  
Energy, Minerals and Natural Resources  
OIL CONSERVATION DIVISION  
2040 South Pacheco  
Santa Fe, NM 87505

Form C-103  
Revised March 25, 1999

<b>SUNDRY NOTICES AND REPORTS ON WELLS</b> (DO NOT USE THIS FORM FOR PROPOSALS TO DRILL OR TO DEEPEN OR PLUG BACK TO A DIFFERENT RESERVOIR. USE "APPLICATION FOR PERMIT" (FORM C-101) FOR SUCH PROPOSALS.)		WELL API NO. 30-025-36093
1. Type of Well: Oil Well <input type="checkbox"/> Gas Well <input checked="" type="checkbox"/> Other <input type="checkbox"/>		5. Indicate Type of Lease STATE <input checked="" type="checkbox"/> FEE <input type="checkbox"/>
2. Name of Operator Fasken Oil and Ranch, Ltd.		6. State Oil & Gas Lease No.
3. Address of Operator 303 W. Wall Ave., Suite 1800, Midland, TX 79701-5116		7. Lease Name or Unit Agreement Name: Kirby "26" State
4. Well Location Unit Letter <u>E</u> : <u>1980</u> feet from the <u>north</u> line and <u>1310</u> feet from the <u>west</u> line Section <u>26</u> Township <u>17S</u> Range <u>34E</u> NMPM Lea County		8. Well No. 1
10. Elevation (Show whether DR, RKB, RT, GR, etc.) 4032' GR		9. Pool name or Wildcat North Vacuum Atoka Morrow

11. Check Appropriate Box to Indicate Nature of Notice, Report or Other Data

NOTICE OF INTENTION TO:		SUBSEQUENT REPORT OF:	
PERFORM REMEDIAL WORK <input type="checkbox"/>	PLUG AND ABANDON <input type="checkbox"/>	REMEDIAL WORK <input type="checkbox"/>	ALTERING CASING <input type="checkbox"/>
TEMPORARILY ABANDON <input type="checkbox"/>	CHANGE PLANS <input type="checkbox"/>	COMMENCE DRILLING OPNS. <input type="checkbox"/>	PLUG AND ABANDONMENT <input type="checkbox"/>
PULL OR ALTER CASING <input type="checkbox"/>	MULTIPLE COMPLETION <input type="checkbox"/>	CASING TEST AND CEMENT JOB <input type="checkbox"/>	
OTHER: <input type="checkbox"/>		OTHER: set intermediate & production casing/DST data <input checked="" type="checkbox"/>	

12. Describe proposed or completed operations. (Clearly state all pertinent details, and give pertinent dates, including estimated date of starting any proposed work). SEE RULE 1103. For Multiple Completions: Attach wellbore diagram of proposed completion or recompilation.

Fasken Oil and Ranch, Ltd. has set intermediate and production casing on the subject well. Attached is detailed information on both strings of casing and cement, along with DST information.

I hereby certify that the information above is true and complete to the best of my knowledge and belief.

SIGNATURE Jimmy D. Carlile TITLE Regulatory Affairs Coordinator DATE 3/4/03

Type or print name Jimmy D. Carlile Telephone No. (915) 687-1777

(This space for State use)  
ORIGINAL SIGNED BY

APPROVED BY GARY W. WINK TITLE OC FIELD REPRESENTATIVE II/STAFF MANAGER DATE MAR 06 2003

Conditions of approval, if any:

## Kirby "26" State No. 1

### Intermediate and Production Casing Detail

#### DST Detail

1-31-03

TD 5000'. Hydrotesting BOP. RU and run 9-5/8" casing, 2 hrs.

Casing Detail: 9-5/8" K-55

1 - Howco Float Shoe	1.50'
1 - jt. casing 40# HCK-55 LT&C	45.35'
1 - Howco Float Collar	1.00'
16 jts. 40# HCK-55 LT&C casing	720.37'
32 jts. 40# K-55 LT&C casing	1462.80'
<u>59 jts. 36# K-55 ST&amp;C casing</u>	<u>2721.84'</u>
108 jts. total	4952.86'
less cut-off	- 23.80'
	4929.06'
below KB	+ 19.00'
Landed @	4948.06'

Cement Detail: 1050 sx Halliburton Interfill "C" with 8# salt and 1/4# Flocele (s.w. 11.9 ppg, yield 2.46 ft<sup>3</sup>/sx) and 200 sx Class "C" neat (s.w. 14.8 ppg, yield 1.32 ft<sup>3</sup>/sx). Plug down at 6:50 pm CST 1-30-03. Did not circulate cement. TOC at 400' per temperature survey.

2/21/03

DST No. 1 (11,661' - 683')

Recovery: 5480' (64.5 bbls) drilling mud + 1402' (12.1 bbls) formation water, chlorides 26,000 ppm, pit chlorides 106,000 ppm.

Sampler- 1800 psi, 2400 cc formation water, chlorides 26,000 ppm, 0.1 cu/ft gas.

IHP	5982 psi
IPFP	634 psi
FPFP(5")	561 psi
ISIP(60")	5843 psi
IFP	898 psi
FFP(180")	1814 psi
FSIP(6 hrs)	5567 psi
FHP	5997 psi
BHT	174°

000  
5000  
01  
11  
15

2/25/03

**DST #2 (11,822' - 840')**

Opened tool @ 6:51 am 2-24-03 with strong blow

1"- blowing from bottom of bucket

3"- 6 psi on 1/8" choke

4"- 12 psi

5"- 21 psi, closed tool. Tool closed 60 minutes.

Reopened tool with no blow and small annular flow.

Tool opened 12 minutes with no blow and small annular flow. Closed tool for 5 minutes.

Reopened tool with no blow and heard noise in drillpipe in 3 minutes. Continuing annular flow, left tool opened 16 minutes. Closed tool for 34 minutes.

Opened tool with occasional bubble from hose, annulus boiling with gas breaking out, occasional bubbles from hose ceased, tool opened 14 minutes. Closed tool for 17 minutes.

Released packers, closed TIW valve below top jt. of drillpipe and noticed pressure leaking from stem packing. Closed valve on control head and valves on choke manifold. Found manifold plugged with formation fines and plastic coating. SIDPP- 1800 psi. Cleared manifold two more times while bleeding pressure to pit. Recovered water blanket and large slug of condensate.

Annulus continued to boil with gas breaking out but subsided substantially with all pressure bled off of drillpipe indicating leak in drillstring.

Recovery: 2450' of fluid, reversed out 18.4 bbls of 48.5° API @ 60°F condensate, 0.3 bbls drilling mud and water cushion, 6 bbls drilling mud.

Sampler: 2800 psi, 750 cc condensate, 13.1 cuft/gas, no water.

IHP-	7073 psi
IPFP(5")-	1506-1591 psi
ISIP(60")-	6578 psi
2 <sup>nd</sup> flow(12")-	1981-2590 psi
2 <sup>nd</sup> SIP(5")-	6316 psi
3 <sup>rd</sup> flow(16")-	2717-4401 psi
3 <sup>rd</sup> SIP(34")-	6479 psi
4 <sup>th</sup> flow(14")-	4434-5857 psi
4 <sup>th</sup> SIP(17")-	6476 psi
FHP-	7046 psi
BHT-	173°

Note- found washed tool jt 58 stds. from surface @ 5452'.

**3-1-03**

TD 11,950'.

Casing Detail: 5-1/2" N-80 LT&C

1 - Howco Float Shoe	1.30'	
1 jt. 20# casing	47.41'	
1 - Howco Float Collar	0.85'	11,914.54'
5 jts. 20# flint coated casing	280.28'	11,634.26'
1 jt. 20# marker	13.13'	11,621.13'
29 jts. 20# casing	1361.75'	10,259.38'
5 jts. 20# flint coated casing	234.51'	10,024.87'
10 jts. 20# casing	471.90'	9552.97'
1 Halliburton P-110 DV tool	2.10'	9550.87'
2 jts. 20# casing	94.85'	9456.02'
189 jts. 17# casing	8530.71'	925.31'

@

000  
SCQH  
07/03/03

20 jts. 20# casing	<u>938.31'</u>
262 jts. total	11,977.10'
less cut-off	<u>- 30.00'</u>
	11,947.10'
below KB	<u>+ 17.00'</u>
Landed @	11,964.10'

**Cement Detail:**

**1<sup>st</sup> Stage:** 10 bbls 3% KCl water, 500 gallons Mud Flush, 10 bbls 3% KCl water, 800 sx Halliburton Super "H" with 1# salt, 0.4% CFR-3, 0.5% Halad-344, 0.25% HR-7 and %3 Gilsonite (s.w. 13.0 ppg, yield 1.69 ft<sup>3</sup>/sx). Batch mixed all of the first stage slurry. Plug down at 1:00 pm CST 2-28-03. Opened DV tool at 1:45 pm and circulated 235 sx excess cement. Circulated 6 hrs between stages.

**2<sup>nd</sup> Stage:** 1100 sx Halliburton Lite "C" with 6% gel (s.w. 12.6 ppg, yield 1.90 ft<sup>3</sup>/sx) plus 200 sx Class "H" Neat (s.w. 15.6 ppg, yield 1.18 ft<sup>3</sup>/sx). Plug down at 9:40 pm 2-28-03. Top of cement at 4600' per temperature survey.

**Note:** Released rig at 7:00 am CST 3-1-03.

00  
500  
000

Submit 3 Copies To Appropriate District  
Office  
District I  
1625 N. French Dr., Hobbs, NM 87240  
District II  
811 South First, Artesia, NM 87210  
District III  
1000 Rio Brazos Rd., Aztec, NM 87410  
District IV  
2040 South Pacheco, Santa Fe, NM 87505

State of New Mexico  
Energy, Minerals and Natural Resources  
OIL CONSERVATION DIVISION  
2040 South Pacheco  
Santa Fe, NM 87505

Form C-103  
Revised March 25, 1999

<b>SUNDRY NOTICES AND REPORTS ON WELLS</b> (DO NOT USE THIS FORM FOR PROPOSALS TO DRILL OR TO DEEPEN OR PLUG BACK TO A DIFFERENT RESERVOIR. USE "APPLICATION FOR PERMIT" (FORM C-101) FOR SUCH PROPOSALS.)		WELL API NO. 30-025-36093
1. Type of Well: Oil Well <input type="checkbox"/> Gas Well <input checked="" type="checkbox"/> Other		5. Indicate Type of Lease STATE <input checked="" type="checkbox"/> FEE <input type="checkbox"/>
2. Name of Operator Fasken Oil and Ranch, Ltd.		6. State Oil & Gas Lease No.
3. Address of Operator 303 W. Wall Ave., Suite 1800, Midland, TX 79701-5116		7. Lease Name or Unit Agreement Name: Kirby "26" State
4. Well Location Unit Letter <u>E</u> : <u>1980</u> feet from the <u>North</u> line and <u>1310</u> feet from the <u>West</u> line Section <u>26</u> Township <u>17S</u> Range <u>34E</u> NMPM Lea County		8. Well No. 1
10. Elevation (Show whether DR, RKB, RT, GR, etc.) 4032' GR		9. Pool name or Wildcat North Vacuum Atoka Morrow

11. Check Appropriate Box to Indicate Nature of Notice, Report or Other Data  
NOTICE OF INTENTION TO:

PERFORM REMEDIAL WORK ☐ PLUG AND ABANDON ☐  
TEMPORARILY ABANDON ☐ CHANGE PLANS ☐  
PULL OR ALTER CASING ☐ MULTIPLE COMPLETION ☐

OTHER: ☐

SUBSEQUENT REPORT OF:

REMEDIAL WORK ☐ ALTERING CASING ☐  
COMMENCE DRILLING OPNS. ☒ PLUG AND ABANDONMENT ☐  
CASING TEST AND CEMENT JOB ☐

OTHER: spud, set surface casing ☒

12. Describe proposed or completed operations. (Clearly state all pertinent details, and give pertinent dates, including estimated date of starting any proposed work). SEE RULE 1103. For Multiple Completions: Attach wellbore diagram of proposed completion or recompletion.

Fasken Oil and Ranch, Ltd. spud the Kirby "26" State No. 1 at 11:30 pm CST on January 17, 2003.

Drilled a 17 1/2" hole to 521'. Ran 13 3/8", 48#, H-40, ST&C casing to 520'. Cemented with 550 sx Class C cement with 2% CaCl2 (sw 14.8 ppg, 1.34 cubic feet per sx). Circulated 197 sx excess cement to surface.

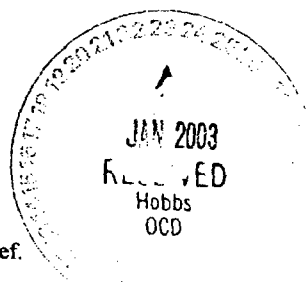

I hereby certify that the information above is true and complete to the best of my knowledge and belief.

SIGNATURE Jimmy D. Carlile TITLE Regulatory Affairs Coordinator DATE 1/22/03

Type or print name Jimmy D. Carlile Telephone No. (915) 687-1777  
(This space for State use)

APPROVED BY GARY W. WINK DATE JAN 24 2003  
Conditions of approval, if any: OC FIELD REPRESENTATIVE II/STAFF MANAGER

District I  
1625 N. French Dr., Hobbs, NM 88240  
District II  
1301 W. Grand Avenue, Artesia, NM 88210  
District III  
1000 Rio Brazos Road, Aztec, NM 87410  
District IV  
1220 S. Francis Dr., Santa Fe, NM 87505

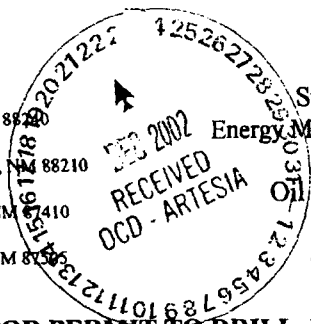

State of New Mexico  
Energy, Minerals and Natural Resources  
Oil Conservation Division  
1220 S. St. Francis Dr.  
Santa Fe, NM 87505

Form C-101  
Revised March 17, 1999

Submit to appropriate District Office  
State Lease - 6 Copies  
Fee Lease - 5 Copies

☐ AMENDED REPORT

### APPLICATION FOR PERMIT TO DRILL, RE-ENTER, DEEPEN, PLUGBACK, OR ADD A ZONE

<sup>1</sup> Operator Name and Address Fasken Oil and Ranch, Ltd. 303 West Wall, Suite 1800 Midland, TX 79701		<sup>2</sup> OGRID Number 151416
		<sup>3</sup> API Number 30-025-36093
<sup>4</sup> Property Code 31012	<sup>5</sup> Property Name Kirby "26" State	<sup>6</sup> Well No. 1

#### <sup>7</sup> Surface Location

UL or lot no.	Section	Township	Range	Lot Idn	Feet from the	North/South line	Feet from the	East/West line	County
E	26	17S	34E		1980	North	1310	West	Lea

#### <sup>8</sup> Proposed Bottom Hole Location If Different From Surface

UL or lot no.	Section	Township	Range	Lot Idn	Feet from the	North/South line	Feet from the	East/West line	County
<sup>9</sup> Proposed Pool 1 North Vacuum Atoka Morrow					<sup>10</sup> Proposed Pool 2				

<sup>11</sup> Work Type Code N	<sup>12</sup> Well Type Code G	<sup>13</sup> Cable/Rotary Rotary	<sup>14</sup> Lease Type Code S	<sup>15</sup> Ground Level Elevation 4032'
<sup>16</sup> Multiple N	<sup>17</sup> Proposed Depth 11,800'	<sup>18</sup> Formation Morrow	<sup>19</sup> Contractor Unknown	<sup>20</sup> Spud Date 1/15/03

#### <sup>21</sup> Proposed Casing and Cement Program

Hole Size	Casing Size	Casing weight/foot	Setting Depth	Sacks of Cement	Estimated TOC
17 1/2"	13 3/8"	48#	500'	550 sx C	surface
12 1/4"	9 5/8"	36/40#	5000'	1200 sx C	surface
8 3/4"	5 1/2"	17/20#	11,800'	1850 sx C/H	4500'

<sup>22</sup> Describe the proposed program. If this application is to DEEPEN or PLUG BACK, give the data on the present productive zone and proposed new productive zone. Describe the blowout prevention program, if any. Use additional sheets if necessary.

Please see the attached for procedure, casing program and BOP schematic.

Permit Expires 1 Year From Approval  
Date Unless Drilling Underway

<sup>23</sup> I hereby certify that the information given above is true and complete to the best of my knowledge and belief.		OIL CONSERVATION DIVISION	
Signature: <i>Jimmy D. Carille</i>		Approved by: ORIGINAL SIGNED BY	
Printed name: Jimmy D. Carille		PAUL F. KAUTZ	
Title: Regulatory Affairs Coordinator		PETROLEUM ENGINEER	
Date: 12/20/02		Approval Date: JAN 03 2003	
Phone: (915) 687-1777		Expiration Date:	
		Attached <input type="checkbox"/>	

*mp*

DISTRICT I  
1686 N. French Dr., Hobbs, NM 88240

DISTRICT II  
811 South First, Artesia, NM 88210

DISTRICT III  
1006 Rio Brazos Rd., Aztec, NM 87410

DISTRICT IV  
2040 South Pacheco, Santa Fe, NM 87505

State of New Mexico  
Energy, Minerals and Natural Resources Department

Form C-102  
Revised March 17, 1999

Submit to Appropriate District Office  
State Lease - 4 Copies  
Fee Lease - 3 Copies

OIL CONSERVATION DIVISION

2040 South Pacheco  
Santa Fe, New Mexico 87504-2088

☐ AMENDED REPORT

WELL LOCATION AND ACREAGE DEDICATION PLAT

API Number <b>30-025-36093</b>	Pool Code <b>86800</b>	Pool Name <b>North Vacuum Atoka Morrow</b>
Property Code <b>31012</b>	Property Name <b>KIRBY "26" STATE</b>	Well Number <b>1</b>
OGED No. <b>151416</b>	Operator Name <b>FASKEN OIL &amp; RANCH, LTD.</b>	Elevation <b>4032'</b>

Surface Location

UL or lot No. <b>E</b>	Section <b>26</b>	Township <b>17 S</b>	Range <b>34 E</b>	Lot Idn	Feet from the <b>1980</b>	North/South line <b>NORTH</b>	Feet from the <b>1310</b>	East/West line <b>WEST</b>	County <b>LEA</b>
---------------------------	----------------------	-------------------------	----------------------	---------	------------------------------	----------------------------------	------------------------------	-------------------------------	----------------------

Bottom Hole Location If Different From Surface

UL or lot No.	Section	Township	Range	Lot Idn	Feet from the	North/South line	Feet from the	East/West line	County
Dedicated Acres <b>320</b>		Joint or Infill	Consolidation Code	Order No.					

NO ALLOWABLE WILL BE ASSIGNED TO THIS COMPLETION UNTIL ALL INTERESTS HAVE BEEN CONSOLIDATED  
OR A NON-STANDARD UNIT HAS BEEN APPROVED BY THE DIVISION

	<p><b>OPERATOR CERTIFICATION</b></p> <p>I hereby certify the the information contained herein is true and complete to the best of my knowledge and belief.</p> <p><i>Jimmy D. Carlile</i> Signature <b>Jimmy D. Carlile</b> Printed Name <b>Regulatory Affairs Coord.</b> Title <b>December 20, 2002</b> Date</p>
	<p><b>SURVEYOR CERTIFICATION</b></p> <p>I hereby certify that the well location shown on this plat was plotted from field notes of actual surveys made by me or under my supervision and that the same is true and correct to the best of my belief.</p> <p><b>DECEMBER 06, 2002</b></p>
	<p>Date Surveyed</p> <p>Signature &amp; Seal of Professional Surveyor</p> <p><i>[Signature]</i> W.O. No. 2962</p> <p>Certificate No. Gary L. Jones 7977</p> <p>BASIN SURVEYS</p>



### Recommended Procedure

Kirby "26" State No. 1 ————— A.F.E. No. 627 ————— North Vacuum Atoka-Morrow Field  
1980' FNL and 1310' FWL  
Sec. 26, T17S, R34E  
Lea County, NM

1. Drilling contractor to set 30" conductor if necessary. MIRU rotary tools.
2. Drill 17-1/2" hole to 500' with spud mud. Set and cement 13-3/8" casing 550 sx Class "C" with 2%  $\text{CaCl}_2$  (s.w. 14.8 ppg, yield 1.32 ft<sup>3</sup>/sx). WOC 18 hrs.
3. Drill 12-1/4" hole to 5000' with 10 ppg brine water. Control seepage with paper.
4. Set and cement 9-5/8" casing at 5000' with estimated 1000 sx Halliburton Interfill "C" with 8# salt and 1/4# Flocele (s.w. 11.9 ppg, yield 2.46 ft<sup>3</sup>/sx) plus 200 sx Class "C" neat (s.w. 14.8 ppg, 1.32 ft<sup>3</sup>/sx). Run temperature survey and locate TOC if cement is not circulated.
5. Install 11" x 5000 psi intermediate spool. NU 11" 5000 psi B.O.P.'s, hydril and choke manifold. WOC 12 hours. Set up DST test line complete with test tank. RU mud gas separator with flare ignitor. Install H<sub>2</sub>S monitor equipment, escape packs and briefing stations.
6. Hydrostatically test 200' of 9-5/8" casing to 2800 psig, casing spool, BOP's, and choke manifold to 3000 psig, and hydril to 1500 psig. Install PVT equipment
8. Drill 8-3/4" hole to total depth of 11,800'. Drill out using fresh water to a depth of 9100'. Convert to 9.0 ppg cut brine water at 9100' just above the Wolfcamp shales. Mud up by 10,800' with starch and PAC mud system. Increase viscosity with salt gel or polymer as needed to clean hole. Maintain 9.0-9.5 ppg and 10 cc water loss to total depth.
9. DST all shows.
10. Log well with DLL-MSFL and CNL-LDT using Schlumberger Platform Express.
11. Install 5-1/2" BOP rams, run and cement 5-1/2" production casing (resin coated and centralized through pay zones) with DV tool at base of Abo (estimate 9000') as follows;  
  
First Stage: Note, batch mix lead slurry. 10 bfw + 500 gallons Mud Clean + 10 bfw and estimated 750 sx Halliburton Super "H" with 1# salt, 0.4% CFR-3, 0.5% Halad-344, 0.1% HR-7 and 5# Gilsomite (s.w. 13.0 ppg, yield 1.60 ft<sup>3</sup>/sx). Open DV tool and circulate 6 hours.  
  
Second stage: 1000 sx Halliburton Lite "C" with 6% gel (s.w. 12.6 ppg, yield 2.01 ft<sup>3</sup>/sx) plus 100 sx Class "H" neat (s.w. 15.6 ppg, yield 1.18 ft<sup>3</sup>/sx). Calculate second stage cement volume for TOC at 4500'.  
  
12. Set slips, nipple down BOP's and run temperature survey to locate cement top.  
13. Install 11"-5000 psi x 7-1/16"-5000 psi tubinghead and flow tree.  
14. Rig down and move out rotary tools.  
15. Level location, set mast anchors, move in and rig up completion unit.

Kirby "26" State No. 1 Recommended Procedure  
Page 2

16. RIW with 4-5/8" bit, 5-1/2" casing scraper, 6 3-1/2" drill collars and 2-3/8" 4.7# N-80 EUE 8<sup>th</sup> tubing. Drill out DV tool and reciprocate scraper through DV tool several times. Pressure test casing to 1500 psig. RIW and clean out to float collar. Circulate well clean and pressure test casing to 1500 psig. POW and LD tools.
17. RIW with packer, T.O.S.S.D. with "F" profile nipple and 2-3/8" tubing. Set packer, install flow tree, swab down tubing and perforate pay interval.
18. Flow test well , evaluate, and stimulate if necessary.
19. RDPU. Clean and level location.
20. Run C.A.O.F.P. and pressure build up.
21. Connect surface equipment.

TET  
(Kirby26State1drlgprc)

**Recommended Casing Program  
A.F.E. No. 627**

**Fasken Oil and Ranch, Ltd. ——— Kirby "26" State No. 1 ——— North Vacuum Atoka-Morrow Field  
Lea County, NM**

<b>String</b>	<b>Footage</b>	<b>Size</b>	<b>Weight</b>	<b>Grade</b>	<b>Thread</b>
Surface	500'	13-3/8"	48.00#	H-40	ST&C
Intermediate	2700'	9-5/8"	36.00#	K-55	ST&C
	1500'	9-5/8"	40.00#	K-55	ST&C
	800'	9-5/8"	40.00#	HCK-55	ST&C
	5000'				
Production	800'	5-1/2"	17.00#	N-80	BT&C
	10,000'	5-1/2"	17.00#	N-80	LT&C
	1,000'	5-1/2"	20.00#	N-80	LT&C
	11,800'				
Tubing	11,700'	2-3/8"	4.70#	N-80	EUE 8rd

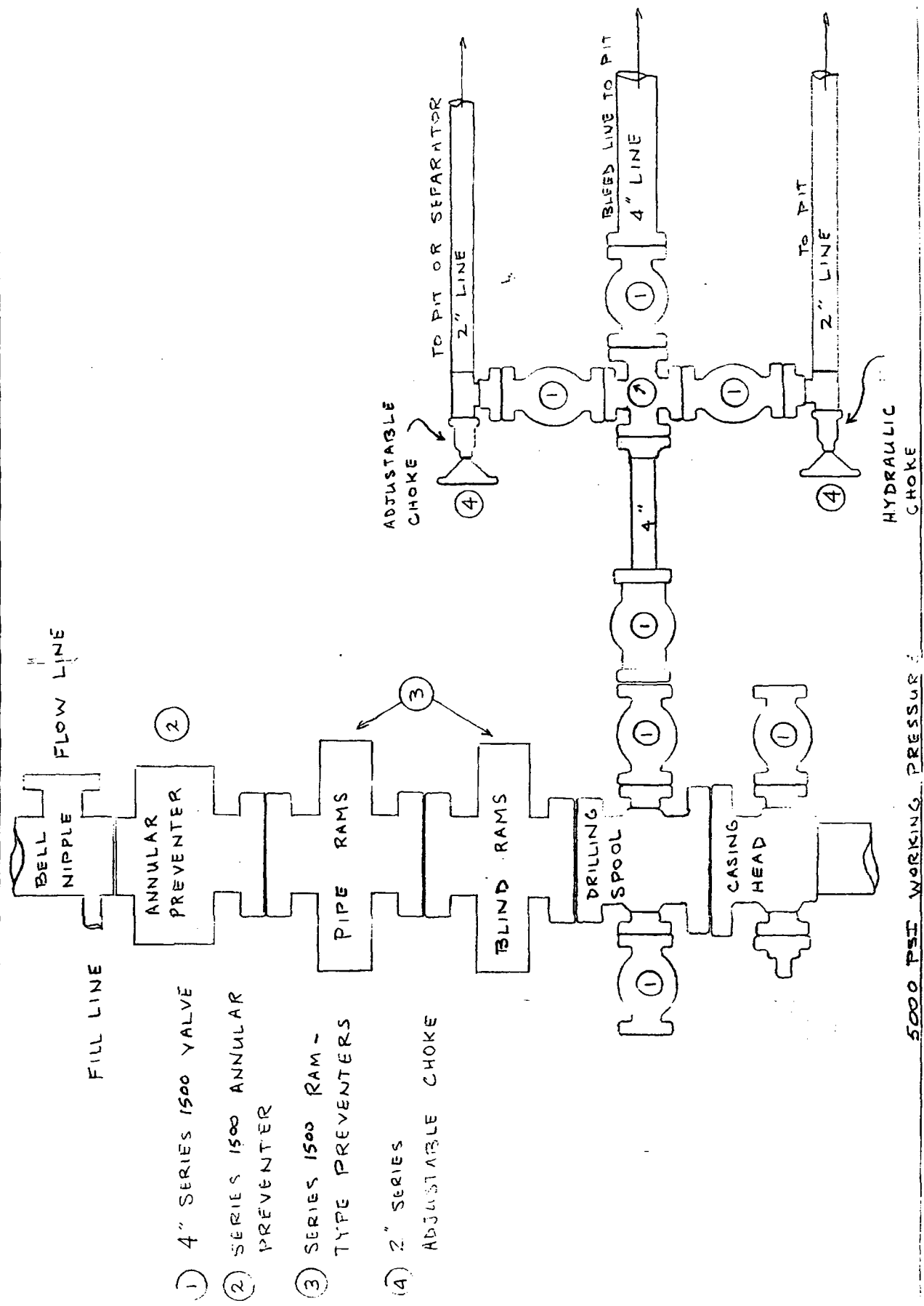

DISTRICT I  
1625 N. French Dr., Hobbs, NM 88240  
DISTRICT II  
811 South First, Artesia, NM 88210  
DISTRICT III  
1000 Rio Brazos Rd., Aztec, NM 87410  
DISTRICT IV  
2040 South Pacheco, Santa Fe, NM 87505

State of New Mexico  
Energy, Minerals and Natural Resources Department

Form C-102  
Revised March 17, 1999

Submit to Appropriate District Office  
State Lease - 4 Copies  
Fee Lease - 3 Copies

OIL CONSERVATION DIVISION

2040 South Pacheco  
Santa Fe, New Mexico 87504-2088

☐ AMENDED REPORT

WELL LOCATION AND ACREAGE DEDICATION PLAT

API Number 30-025-36093	Pool Code 86800	Pool Name North Vacuum Atoka Morrow
Property Code 31012	Property Name KIRBY "26" STATE	Well Number 1
GRID No. 151416	Operator Name FASKEN OIL & RANCH, LTD.	Elevation 4032'

Surface Location

UL or lot No. E	Section 26	Township 17 S	Range 34 E	Lot Idn	Feet from the 1980	North/South line NORTH	Feet from the 1310	East/West line WEST	County LEA
--------------------	---------------	------------------	---------------	---------	-----------------------	---------------------------	-----------------------	------------------------	---------------

Bottom Hole Location If Different From Surface

UL or lot No.	Section	Township	Range	Lot Idn	Feet from the	North/South line	Feet from the	East/West line	County
Dedicated Acres 320	Joint or Infill	Consolidation Code	Order No.						

NO ALLOWABLE WILL BE ASSIGNED TO THIS COMPLETION UNTIL ALL INTERESTS HAVE BEEN CONSOLIDATED  
OR A NON-STANDARD UNIT HAS BEEN APPROVED BY THE DIVISION

	<p><b>OPERATOR CERTIFICATION</b></p> <p>I hereby certify the the information contained herein is true and complete to the best of my knowledge and belief.</p> <p><i>Jimmy D. Carlile</i> Signature Jimmy D. Carlile Printed Name Regulatory Affairs Coordinator Title March 28, 2003 Date</p> <p><b>SURVEYOR CERTIFICATION</b></p> <p>I hereby certify that the well location shown on this plat was plotted from field notes of actual surveys made by me or under my supervision, and that the same is true and correct to the best of my belief.</p> <p>DECEMBER 06, 2002</p> <p>Date Surveyed Signature &amp; Seal of Professional Surveyor W.O. No. 2902 Certificate No. Gary L. Jones 7977 BASIN SURVEYS</p>
--	---

Submit in duplicate to  
appropriate district office.  
See Rule 401 & Rule 1122

State of New Mexico  
Energy Minerals and Natural Resources

Form C-122  
Revised October, 1999

Oil Conservation Division  
1220 South St. Francis Dr.  
Santa Fe, NM 87504

**MULTIPOINT AND ONE POINT BACK PRESSURE TEST FOR GAS WELL**

Operator <b>Fasken Oil and Ranch, Ltd.</b>					Lease or Unit Name <b>Kirby "26" State</b>				
Type Test <input checked="" type="checkbox"/> Initial <input type="checkbox"/> Annual <input type="checkbox"/> Special					Test Date <b>3-12-03</b>		Well No. <b>1</b>		
Completion Date <b>3-7-03</b>		Total Depth <b>11,950'</b>		Plug Back TD <b>11,915'</b>		Elevation <b>4032' GR</b>		Unit Ltr. - Sec. - TWP - Rge. <b>E 26 17S 31E</b>	
Csg. Size <b>5-1/2"</b>	Wt. <b>20</b>	d <b>4.778</b>	Set At <b>11,950'</b>	Perforations: From: <b>11819'</b> To: <b>11835'</b>				County <b>Lea</b>	
Tbg. Size <b>2-3/8"</b>	Wt. <b>4.7</b>	d <b>1.995</b>	Set At <b>11,736'</b>	Perforations: From: To:				Pool <b>North Vacuum</b>	
Type Well - Single - Bradenhead - G.G. or G.O. Multiple <b>Single</b>					Packer Set At <b>11,736'</b>		Formation <b>Morrow</b>		
Producing Thru Tubing		Reservoir Temp. °F <b>173</b>		Mean Annual Temp. °F <b>60</b>		Baro. Press - P <sub>a</sub> <b>13.2</b>		Connection <b>WOPL</b>	
L <b>11736'</b>	H <b>11736'</b>	Gg <b>0.683</b>	%CO <sub>2</sub> <b>0.346</b>	%N <sub>2</sub> <b>1.066</b>	%H <sub>2</sub> S <b>0.00</b>	Prover <b>Orifice</b>		Meter Run <b>4"</b>	Taps <b>Flange</b>

FLOW DATA					TUBING DATA		CASING DATA		Duration Of Flow
No.	Prover Line Size	X Orifice Size	Press. p.s.i.g.	Diff. h <sub>w</sub>	Temp. °F	Press. p.s.i.g.	Temp. °F	Press. p.s.i.g.	
SI						<b>4269</b>	<b>60</b>	<b>0</b>	<b>60</b>
1.	<b>4.026" x 1.75"</b>		<b>510</b>	<b>9.4</b>	<b>56</b>	<b>3705</b>	<b>70</b>	<b>50</b>	<b>70</b>
2.	<b>4.026" x 1.75"</b>		<b>510</b>	<b>23.4</b>	<b>69</b>	<b>3258</b>	<b>75</b>	<b>90</b>	<b>75</b>
3.	<b>4.026" x 1.75"</b>		<b>510</b>	<b>45</b>	<b>60</b>	<b>2797</b>	<b>80</b>	<b>154</b>	<b>80</b>
4.	<b>4.026" x 1.75"</b>		<b>525</b>	<b>72</b>	<b>55</b>	<b>2301</b>	<b>85</b>	<b>170</b>	<b>85</b>
5.									

RATE OF FLOW CALCULATIONS							
No.	COEFFICIENT (24 HOUR)	$\sqrt{h_w P_m}$	Pressure P <sub>m</sub>	Flow Temp. Factor Ft.	Gravity Factor F <sub>g</sub>	Super Compress. Factor, F <sub>pv</sub>	Rate of Flow Q, Mcfd
1.	<b>14.93</b>	<b>70.19</b>	<b>523.2</b>	<b>1.0040</b>	<b>1.210</b>	<b>1.062</b>	<b>1352</b>
2.	<b>14.93</b>	<b>114.31</b>	<b>523.2</b>	<b>0.9915</b>	<b>1.210</b>	<b>1.054</b>	<b>2089</b>
3.	<b>14.93</b>	<b>153.44</b>	<b>523.2</b>	<b>1.0000</b>	<b>1.210</b>	<b>1.062</b>	<b>2944</b>
4.	<b>14.93</b>	<b>196.85</b>	<b>538.2</b>	<b>1.0050</b>	<b>1.210</b>	<b>1.063</b>	<b>3796</b>
5.							

No.	P <sub>r</sub>	Temp. °R	T <sub>r</sub>	Z	Gas Liquid Hydrocarbon Ratio	Mcf/bbl.
1.	<b>0.78</b>	<b>516</b>	<b>1.347</b>	<b>0.886</b>	<b>6276</b>	
2.	<b>0.78</b>	<b>529</b>	<b>1.381</b>	<b>0.901</b>	<b>48.5</b>	
3.	<b>0.78</b>	<b>520</b>	<b>1.358</b>	<b>0.887</b>	<b>0.683</b>	<b>XXXXXXX</b>
4.	<b>0.80</b>	<b>515</b>	<b>1.345</b>	<b>0.885</b>	<b>0.786</b>	<b>1.13</b>
5.					<b>669</b>	<b>P.S.I.A.</b>
					<b>Critical Temperature</b>	<b>383</b>

No.	P <sub>r</sub>	P <sub>i</sub>	P <sub>s</sub>	P <sub>s</sub> <sup>2</sup> - P <sub>i</sub> <sup>2</sup>
1.	<b>6506.2</b>	<b>42330.6</b>	<b>5867.2</b>	<b>34420.4</b>
2.			<b>5361.2</b>	<b>28742.5</b>
3.			<b>4810.3</b>	<b>23139.0</b>
4.			<b>4235.1</b>	<b>24394.5</b>
5.				

(1)  $\frac{P_i^2}{P_s^2 - P_i^2} = \frac{42330.6}{24394.5}$

AOF = Q (3796)  $\left[ \frac{P_i^2}{P_s^2 - P_i^2} \right]^n = \frac{658700}{658700}$

(2)  $\left[ \frac{P_i^2}{P_s^2 - P_i^2} \right]^n = 1.7353$

Absolute Open Flow <b>6587</b>		Mcf/d @ 15.025	Angle of Slope θ: <b>45</b>	Slope, n: <b>1.00</b>
--------------------------------	--	----------------	-----------------------------	-----------------------

  

Remarks:  
**Bottom hole pressure measured with electronic 0-10,000 psi gauges at 11,736'.**

Approved By Division 	Conducted By: <b>Fasken Oil and Ranch, Ltd.</b>	Calculated By: <b>Carl Brown</b>	Checked By:
--------------------------	--	-------------------------------------	-------------

PETROLEUM ENGINEER **APR 23 2003**

Fasken Oil and Ranch, Ltd.  
 Kirby "26" State No. 1  
 Unit E, Sec 26, T17S, R34E  
 North Vacuum (Atoka-Morrow) Pool  
 Lea County, NM

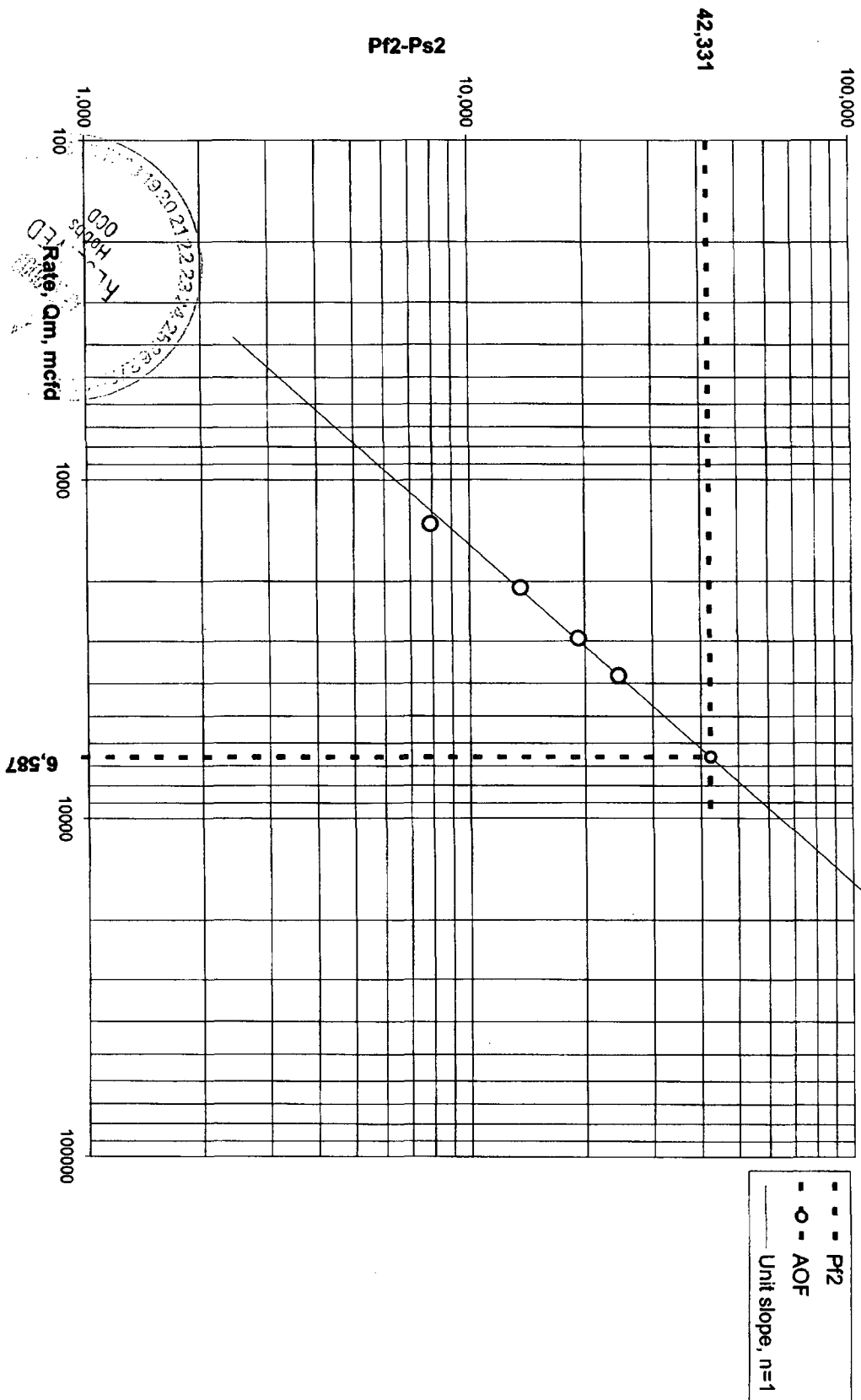

**Fasken Oil and Ranch, Ltd.**

**Kirby "26" State No. 1**

**DST Summary**

**2-21-03**

TD 11,683'

**DST No. 1 (11,661'-11,683')**

Opened tool @ 7:57 pm CST 2-20-03 with weak blow.

3" BOB.

4" 6-1/2 oz on 1/8" bubble hose

5" 7 oz

Closed tool 1 hr. Reopened tool at 9:04 pm

1" 3" in bubble bucket

5" 6"

9" BOB

10" 6 oz on 1/8" bubble hose

30" 11 oz

60" 22 oz

90" 3.2 psig on 1/8" bubble hose

120" 3.9 psig

Closed tool at 11:06 pm CST 2-20-03.

Note: Observed flow in drill pipe prior to initial DST opening. Lost 7 bbls/hr in annulus during DST. Recovered approximately 80 bbls drilling mud after DST. Pulled drill string wet and found wash box and pin in drill pipe at 81 stands (7654').

**2-22-03**

TD 11,790'

**DST No. 1 (11,661' - 683')**

Recovery: 5480' (64.5 bbls) drilling mud + 1402' (12.1 bbls) formation water, chlorides 26,000 ppm, pit chlorides 106,000 ppm.

Sampler- 1800 psi, 2400 cc formation water, chlorides 26,000 ppm, 0.1 cu/ft gas.

IHP 5982 psi

IPFP 634 psi

FPP(5") 561 psi

ISIP(60") 5843 psi

IFP 898 psi

FFP(180") 1814 psi

FSIP(6 hrs) 5567 psi

FHP 5997 psi

BHT 174°





2-25-03

TD 11,840'

**DST #2 (11,822' - 840')**

Opened tool @ 6:51 am 2-24-03 with strong blow

1"- blowing from bottom of bucket

3"- 6 psi on 1/8" choke

4"- 12 psi

5"- 21 psi, closed tool. Tool closed 60 minutes.

Reopened tool with no blow and small annular flow.

Tool opened 12 minutes with no blow and small annular flow. Closed tool for 5 minutes.

Reopened tool with no blow and heard noise in drillpipe in 3 minutes. Continuing annular flow, left tool opened 16 minutes. Closed tool for 34 minutes.

Opened tool with occasional bubble from hose, annulus boiling with gas breaking out, occasional bubbles from hose ceased, tool opened 14 minutes. Closed tool for 17 minutes.

Released packers, closed TIW valve below top jt. of drillpipe and noticed pressure leaking from stem packing. Closed valve on control head and valves on choke manifold. Found manifold plugged with formation fines and plastic coating. SIDPP- 1800 psi. Cleared manifold two more times while bleeding pressure to pit. Recovered water blanket and large slug of condensate.

Annulus continued to boil with gas breaking out but subsided substantially with all pressure bled off of drillpipe indicating leak in drillstring.

Recovery: 2450' of fluid, reversed out 18.4 bbls of 48.5° API @ 60°F condensate, 0.3 bbls drilling mud and water cushion, 6 bbls drilling mud.

Sampler: 2800 psi, 750 cc condensate, 13.1 cuft/gas, no water.

IHP-	7073 psi
IPFP(5")-	1506-1591 psi
ISIP(60")-	6578 psi
2 <sup>nd</sup> flow(12")-	1981-2590 psi
2 <sup>nd</sup> SIP(5")-	6316 psi
3 <sup>rd</sup> flow(16")-	2717-4401 psi
3 <sup>rd</sup> SIP(34")-	6479 psi
4 <sup>th</sup> flow(14")-	4434-5857 psi
4 <sup>th</sup> SIP(17")-	6476 psi
FHP-	7046 psi
BHT-	173°

Note- found washed tool jt 58 stds. from surface @ 5452'.

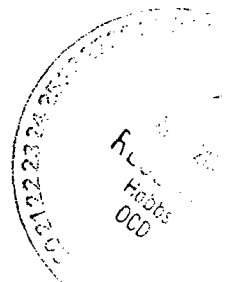

OPERATOR: MATADOR PETROLEUM CORP.  
WELL/LEASE: PIPELINE "A" 8 FED. 2  
COUNTY: LEA

046-0011

STATE OF NEW MEXICO  
DEVIATION REPORT

318	3/4	11,714	1/4
869	1	12,607	1 1/2
1,373	1/4	13,073	1
1,848	3/4	13,319	1/2
2,322	1/4	13,700	1/2
2,607	3/4		
2,766	1 1/4		
2,924	1 1/4		
3,083	1 3/4		
3,209	1 1/4		
3,366	1/2		
3,841	1		
3,968	1/2		
4,449	3/4		
4,949	3/4		
5,447	3/4		
5,949	3/4		
6,517	1 1/4		
6,950	1 1/4		
7,450	1		
7,950	1		
8,450	1 1/4		
8,955	1 3/4		
9,454	1 3/4		
9,954	3/4		
10,449	1 1/4		
10,947	1		
11,439	0		

By: 

STATE OF TEXAS

COUNTY OF MIDLAND

The foregoing instrument was acknowledged before me on this 4th day of June, 2002, by Steve Moore on behalf of Patterson-UTI Drilling Company LP, LLLP.

My Commission Expires: 3/31/2003

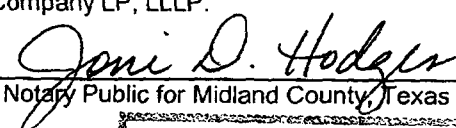
  
Notary Public for Midland County, Texas

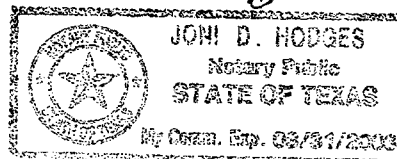

RECEIVED  
HODGES  
OCD

District I  
1625 N. French Dr., Hobbs, NM 88240

District II  
811 South First, Artesia, NM 88210

District III  
1000 Rio Brazos Rd., Aztec, NM 87410

District IV  
2040 South Pacheco, Santa Fe, NM 87505

State of New Mexico  
Energy, Minerals & Natural Resources

OIL CONSERVATION DIVISION  
2040 South Pacheco  
Santa Fe, NM 87505

Form C-104  
Revised March 25, 1999

Submit to Appropriate District Office  
5 Copies

☐ AMENDED REPORT

I. REQUEST FOR ALLOWABLE AND AUTHORIZATION TO TRANSPORT

Operator name and Address Fasken Oil and Ranch, Ltd. 303 W. Wall Ave., Suite 1800 Midland, TX 79701-5116		OGRID Number 151416
Reason for Filing Code RT 300		March 2003
API Number 30 - 025-36093	Pool Name North Vacuum Atoka Morrow (Gas)	Pool Code 86800
Property Code 31012	Property Name Kirby "26" State	Well Number 1

II. Surface Location

UL or lot no.	Section	Township	Range	Lot Idn	Feet from the	North/South Line	Feet from the	East/West line	County
E	26	17S	34E		1980	north	1310	west	Lea

Bottom Hole Location

UL or lot no.	Section	Township	Range	Lot Idn	Feet from the	North/South line	Feet from the	East/West line	County
Lea Code S	Producing Method Code F	Gas Connection Date Not Available	C-129 Permit Number	C-129 Effective Date	C-129 Expiration Date				

III. Oil and Gas Transporters

Transporter OGRID	Transporter Name and Address	POD	O/G	POD ULSTR Location and Description
036785	Duke Energy Field Services 3300 North A Street, Bldg. 7 Midland, TX 79705	2834420	G	
35103	Sunoco Partners Marketing P. O. Box 2039 Tulsa, OK 74102	2834419	O	

IV. Produced Water

POD	POD ULSTR Location and Description
2834421	

V. Well Completion Data

Spud Date 1/17/03	Ready Date 3/8/03	TD 11964'	PBTD 11910'	Perforations 11819' - 11835'	DHC, MC
Hole Size 17 1/2"	Casing & Tubing Size 13 3/8", H-40, 48#	Depth Set 520'	Backs Cement 550 sx C		
12 1/2"	9 5/8", K-55, 40#	4948'	1250 sx C		
8 3/4"	5 1/2", N-80, 20/17#	11964'	2100 sx C/H		
	2 3/8"	11833'			

VI. Well Test Data

Date New Oil 3/8/03	Gas Delivery Date testing	Test Date	Test Length 24	Tbg. Pressure 2850	Cog. Pressure 0
Choke Size	Oil 200 Bbls	Water 0 Bbls	Gas 3923 MCF	AOF	Test Method

I hereby certify that the rules of the Oil Conservation Division have been complied with and that the information given above is true and complete to the best of my knowledge and belief.

Signature: Jimmy D. Carille  
Printed name: Jimmy D. Carille  
Title: Regulatory Affairs Coordinator  
Date: 3/12/03 Phone: (915) 687-1777

OIL CONSERVATION DIVISION

Approved by: [Signature]  
Title: PETROLEUM ENGINEER  
Approval Date: APR 23 2003

If this is a change of operator fill in the OGRID number and name of the previous operator

Previous Operator Signature	Printed Name	Title	Date

District I  
1625 N. French Dr., Hobbs, NM 87240District II  
811 South First, Artesia, NM 87210District III  
1000 Rio Brazos Rd., Aztec, NM 87410District IV  
2040 South Pacheco, Santa Fe, NM 87505State of New Mexico  
Energy, Minerals and Natural Resources  
OIL CONSERVATION DIVISION  
2040 South Pacheco  
Santa Fe, NM 87505

WELL API NO.

30-025-36093

5. Indicate Type of Lease

STATE ☒ FEE ☐

State Oil &amp; Gas Lease No.

## WELL COMPLETION OR RECOMPLETION REPORT AND LOG

1a. Type of Well:

OIL WELL ☐ GAS WELL ☒ DRY ☐ OTHER \_\_\_\_\_

b. Type of Completion:

NEW WORK PLUG DIFF.  
WELL ☒ OVER ☐ DEEPEN ☐ BACK ☐ RESVR. ☐ OTHER \_\_\_\_\_

2. Name of Operator

Fasken Oil and Ranch, Ltd. (151416)

3. Address of Operator

303 W. Wall Ave., Suite 1800, Midland, TX 79701-5116

7. Lease Name or Unit Agreement Name

Kirby "26" State

8. Well No.

1

9. Pool name or Wildcat

North Vacuum Atoka Morrow

4. Well Location

Unit Letter E : 1980 Feet From The North Line and 1310 Feet From The West Line

Section 26

Township 17S

Range 34E

NMPM

County Lea

10. Date Spudded

1/17/03

11. Date T.D. Reached

2/26/03

12. Date Compl. (Ready to Prod.)

3/9/03

13. Elevations (DF&amp; RKB, RT, GR, etc.)

4032' GR

14. Elev. Casinghead

15. Total Depth

11964'

16. Plug Back T.D.

11915'

17. If Multiple Compl. How Many Zones?

18. Intervals Drilled By

Rotary Tools

All

Cable Tools

19. Producing Interval(s), of this completion - Top, Bottom, Name

11819' - 11835' Atoka Morrow

20. Was Directional Survey Made

Yes

21. Type Electric and Other Logs Run

GR/CCL

22. Was Well Cored

No

## 23. CASING RECORD (Report all strings set in well)

CASING SIZE	WEIGHT LB./FT.	DEPTH SET	HOLE SIZE	CEMENTING RECORD	AMOUNT PULLED
13 3/8"	48#	520'	17 1/2"	550 sx C	197 sx
9 5/8"	36/40#	4948'	12 1/4"	1250 sx C	TOC 400'
5 1/2"	20#	11964'	8 3/4"	1 <sup>st</sup> stage 800 sx C	235 sx
				2 <sup>nd</sup> stage 1300 C	TOC 4600'
					DV tool 9551'

## 24. LINER RECORD

SIZE	TOP	BOTTOM	SACKS CEMENT	SCREEN

## 25. TUBING RECORD

SIZE	DEPTH SET	PACKER SET
2 3/8"	11736'	11736'

26. Perforation record (interval, size, and number)

11819' - 11835' 4 jsfp, 90 degree phased, 65 holes

27. ACID, SHOT, FRACTURE, CEMENT, SQUEEZE, ETC.

DEPTH INTERVAL	AMOUNT AND KIND MATERIAL USED
11819'-11835'	154000 scf N2

## 28. PRODUCTION

Date First Production 3/9/03		Production Method (Flowing, gas lift, pumping - Size and type pump) flowing			Well Status (Prod or Shut-in) Shut in		
Date of Test 3/9/03	Hours Tested 24	Choke Size 15/64	Prod'n For Test Period	Oil - Bbl 324	Gas - MCF 1931	Water - Bbl 0	Gas - Oil Ratio 5960
Flow Tubing Press. 2301	Casing Pressure 170	Calculated 24-Hour Rate	Oil - Bbl 324	Gas - MCF 1931	Water - Bbl 0	Oil Gravity (API) (Corr.) 48.5	

29. Disposition of Gas (Sold, used for fuel, vented, etc.)

sold

Test Witnessed By

Calvin Turner

30. List Attachments

DST Summary, log confidentiality request, Logs, Deviation Report, C102, C104

31. I hereby certify that the information shown on both sides of this form as true and complete to the best of my knowledge and belief

Signature *Jimmy D. Carlile*Printed  
Name Jimmy D. Carlile

Title Regulatory Affairs Coord.

Date 3/31/03

## INSTRUCTIONS

This form is to be filed with the appropriate District Office of the Division not later than 20 days after the completion of any newly-drilled or deepened well. It shall be accompanied by one copy of all electrical and radio-activity logs run on the well and a summary of all special tests conducted, including drill stem tests. All depths reported shall be measured depths. In the case of directionally drilled wells, true vertical depths shall also be reported. For multiple completions, items 25 through 29 shall be reported for each zone. The form is to be filed in quintuplicate except on state land, where six copies are required. See Rule 1105.

INDICATE FORMATION TOPS IN CONFORMANCE WITH GEOGRAPHICAL SECTION OF STATE

## Southeastern New Mexico

T. Anhy \_\_\_\_\_  
T. Salt \_\_\_\_\_  
B. Salt \_\_\_\_\_  
T. Yates \_\_\_\_\_  
T. 7 Rivers \_\_\_\_\_  
T. Queen \_\_\_\_\_  
T. Grayburg \_\_\_\_\_  
T. San Andres \_\_\_\_\_  
T. Glorieta \_\_\_\_\_  
T. Paddock \_\_\_\_\_  
T. Blinebry \_\_\_\_\_  
T. Tubb 7404' \_\_\_\_\_  
T. Drinkard 7548' \_\_\_\_\_  
T. Abo 8078' \_\_\_\_\_  
T. Wolfcamp 9437' \_\_\_\_\_  
T. Penn 10321' \_\_\_\_\_  
T. Cisco (Bough C) \_\_\_\_\_

T. Canyon  
T. Strawn 11243'  
T. Atoka 11522'  
T. Miss  
T. Devonian  
T. Silurian  
T. Montoya  
T. Simpson  
T. McKee  
T. Ellenburger  
T. Gr. Wash  
T. Delaware Sand  
T. Bone Springs  
T. Morrow 11718'  
T.  
T.  
T.

## Northwestern New Mexico

T. Ojo Alamo \_\_\_\_\_  
T. Kirtland-Fruitland \_\_\_\_\_  
T. Pictured Cliffs \_\_\_\_\_  
T. Cliff House \_\_\_\_\_  
T. Menefee \_\_\_\_\_  
T. Point Lookout \_\_\_\_\_  
T. Mancos \_\_\_\_\_  
T. Gallup \_\_\_\_\_  
Base Greenhorn \_\_\_\_\_  
T. Dakota \_\_\_\_\_  
T. Morrison \_\_\_\_\_  
T. Todilto \_\_\_\_\_  
T. Entrada \_\_\_\_\_  
T. Wingate \_\_\_\_\_  
T. Chinle \_\_\_\_\_  
T. Permian \_\_\_\_\_  
T. Penn "A" \_\_\_\_\_

T. Penn. "B"  
T. Penn. "C"  
T. Penn. "D"  
T. Leadville  
T. Madison  
T. Elbert  
T. McCracken  
T. Ignacio Otzte  
T. Granite  
T.  
T.  
T.  
T.  
T.  
T.  
T.  
T.

## OIL OR GAS SANDS OR ZONES

No. 1, from	to
No. 2, from	to

No. 3, from	to
No. 4, from	to

## IMPORTANT WATER SANDS

**Include data on rate of water inflow and elevation to which water rose in hole.**

No. 1, from	to	feet
No. 2, from	to	feet
No. 3, from	to	feet

## LITHOLOGY RECORD (Attach additional sheet if necessary)

From	To	Thickness In Feet	Lithology

From	To	Thickness In Feet	Lithology

ELF 4 KB3  
 ABOVE DATE DOES NOT  
 INDICATE WHEN  
 CONFIDENTIAL LOGS  
 WILL BE RELEASED

District I  
1625 N. French Dr., Hobbs, NM 88240  
District II  
1301 W. Grand Avenue, Artesia, NM 88210  
District III  
1000 Rio Brazos Road, Aztec, NM 87410  
District IV  
1220 S. St. Francis Dr., Santa Fe, NM 87505

State of New Mexico  
Energy Minerals and Natural Resources

Form C-101  
May 27, 2004

Submit to appropriate District Office

Oil Conservation Division  
1220 South St. Francis Dr.  
Santa Fe, NM 87505

☐ AMENDED REPORT

APPLICATION FOR PERMIT TO DRILL, RE-ENTER, DEEPEN, PLUGBACK, OR ADD A ZONE

Operator Name and Address Fasken Oil and Ranch, Ltd. 303 W. Wall, Ste 1800 Midland, TX 79701		OGRID Number 151416
Property Code 31012	Property Name Kirby "26" State	API Number 30-025-36093
Well No. 1		
Proposed Pool 1 Vacuum; Wolfcamp		Proposed Pool 2

Surface Location

UL or lot no.	Section	Township	Range	Lot Idn	Feet from the	North/South line	Feet from the	East/West line	County
E	26	17S	34E		1980	North	1310	West	Lea

Proposed Bottom Hole Location If Different From Surface

UL or lot no.	Section	Township	Range	Lot Idn	Feet from the	North/South line	Feet from the	East/West line	County

Additional Well Information

Work Type Code P	Well Type Code O	Cable/Rotary R	Lease Type Code S	Ground Level Elevation 4032'
Multiple N	Proposed Depth 11765'	Formation Wolfcamp	Contractor unknown	Spud Date 6/20/06
Depth to Groundwater unknown		Distance from nearest fresh water well greater than 1 mile		Distance from nearest surface water greater than 1 mile
Pit: Liner: Synthetic <input type="checkbox"/> _____ mils thick Clay <input type="checkbox"/> Pit Volume: _____ bbls Drilling Method: _____				
Closed-Loop System <input type="checkbox"/> NO PIT Fresh Water <input type="checkbox"/> Brine <input type="checkbox"/> Diesel/Oil-based <input type="checkbox"/> Gas/Air <input type="checkbox"/>				

Proposed Casing and Cement Program

Hole Size	Casing Size	Casing weight/foot	Setting Depth	Sacks of Cement	Estimated TOC
17 1/2	13 3/8	48	520'	550 sx C	surface
12 1/4	9 5/8	36/40	4948'	1250 sx C	400'
8 3/4	5 1/2	20	11964'	2100 sx C	4600'

Describe the proposed program. If this application is to DEEPEN or PLUG BACK, give the data on the present productive zone and proposed new productive zone. Describe the blowout prevention program, if any. Use additional sheets if necessary.

Fasken Oil and Ranch, Ltd. proposes to recomplate the Kirby "26" State No. 1 to the Vacuum; Wolfcamp Pool. This work requires a non-standard location exception. An exception request is being prepared and will be forwarded to the NMOC Santa Fe office the week of May 22, 2006.

Permit Expires 1 Year From Approval  
Date Unless Drilling Underway  
Plugback

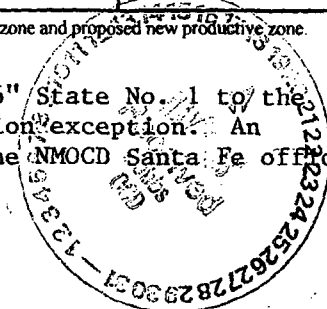

I hereby certify that the information given above is true and complete to the best of my knowledge and belief. I further certify that the drilling pit will be constructed according to NMOC guidelines <input type="checkbox"/> a general permit <input type="checkbox"/> or an (attached) alternative OGD-approved plan <input type="checkbox"/> NO PIT.		OIL CONSERVATION DIVISION	
Printed name: Jimmy C. Calie		Approved by: [Signature]	
Title: Regulatory Affairs Coordinator		Title: PETROLEUM ENGINEER	
E-mail Address: jimmyc@forl.com		Approval Date: MAY 22 2006 Expiration Date:	
Date: 5/18/06	Phone: 432 687-1777	Conditions of Approval Attached <input type="checkbox"/>	

DISTRICT I  
1825 N. French Dr., Hobbs, NM 88240  
DISTRICT II  
811 South First, Artesia, NM 88210

DISTRICT III  
1000 Rio Brazos Rd., Aztec, NM 87410

DISTRICT IV  
2040 South Pacheco, Santa Fe, NM 87505

State of New Mexico  
Energy, Minerals and Natural Resources Department

Form C-102  
Revised March 17, 1999

Submit to Appropriate District Office  
State Lease - 4 Copies  
Fee Lease - 3 Copies

OIL CONSERVATION DIVISION

2040 South Pacheco  
Santa Fe, New Mexico 87504-2088

☐ AMENDED REPORT

WELL LOCATION AND ACREAGE DEDICATION PLAT

API Number 30-025-36093	Pool Code 62340	Pool Name Vacuum;Wolfcamp
Property Code 31012	Property Name KIRBY "26" STATE	Well Number 1
OGRID No. 151416	Operator Name FASKEN OIL & RANCH, LTD.	Elevation 4032'

Surface Location

UL or lot No.	Section	Township	Range	Lot Idn	Feet from the	North/South line	Feet from the	East/West line	County
E	26	17 S	34 E		1980	NORTH	1310	WEST	LEA

Bottom Hole Location If Different From Surface

UL or lot No.	Section	Township	Range	Lot Idn	Feet from the	North/South line	Feet from the	East/West line	County
Dedicated Acreage 80		Joint or Infill		Consolidation Code		Order No.			

NO ALLOWABLE WILL BE ASSIGNED TO THIS COMPLETION UNTIL ALL INTERESTS HAVE BEEN CONSOLIDATED  
OR A NON-STANDARD UNIT HAS BEEN APPROVED BY THE DIVISION

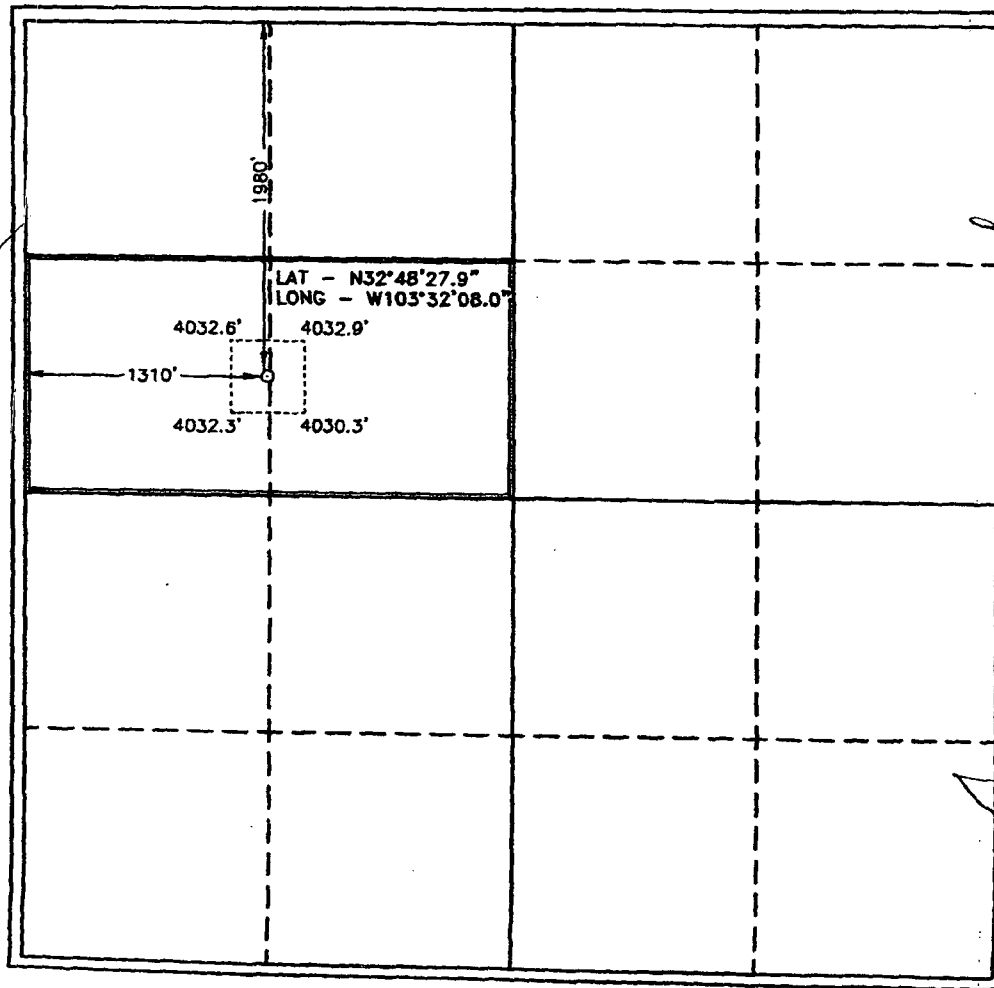
	<b>OPERATOR CERTIFICATION</b> I hereby certify the the information contained herein is true and complete to the best of my knowledge and belief.  <i>Jimmy D. Carlisle</i> Signature Jimmy D. Carlisle Printed Name Regulatory Affairs, Coord. Title 5/18/06 Date
	<b>SURVEYOR CERTIFICATION</b> I hereby certify that the well location shown on this plat was plotted from field notes of actual surveys made by me or under my supervision, and that the same is true and correct to the best of my belief.  DECEMBER 06, 2002 Date Surveyed Signature & Seal of Professional Surveyor W.O. No. 2902 Certificate No. Gary L. Jones 7977 BASIN SURVEYS

**FASKEN OIL AND RANCH, LTD.**

303 WEST WALL AVENUE, SUITE 1800  
MIDLAND, TEXAS 79701-5116

(432) 687-1777  
jimmyc@forl.com

**Jimmy D. Carlile**  
Regulatory Affairs Coordinator

May 18, 2006

Mr. Paul Kautz  
New Mexico Oil Conservation Division  
1625 N. French Drive  
Hobbs, NM 88240

Dear Mr. Kautz,

Re: Kirby "26" State No. 1  
Vacuum; Wolfcamp Pool  
H2S Contingency Plan

In our review of Wolfcamp production in this area of Lea County, including the drilling of this well in 2003, we have not identified any sour gas production. Therefore, no H2S Contingency Plan is necessary as we recomplete this well to the Vacuum; Wolfcamp Pool.

Yours truly,

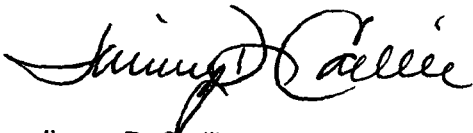

Jimmy D. Carlile  
Regulatory Affairs Coordinator





 The sender of this message has requested a read receipt. [Click here to send a receipt.](#)

**Mull, Donna, EMNRD**

**From:** Phillips, Dorothy, EMNRD  
**To:** Mull, Donna, EMNRD  
**Cc:**  
**Subject:** RE: Financial Assurance Requirement  
**Attachments:**

**Sent:** Mon 5/22/2006 9:24 AM

All but Apache are okay.

---

**From:** Mull, Donna, EMNRD  
**Sent:** Monday, May 22, 2006 8:27 AM  
**To:** Phillips, Dorothy, EMNRD  
**Cc:** Macquesten, Gail, EMNRD; Sanchez, Daniel J., EMNRD  
**Subject:** Financial Assurance Requirement

Dorothy,

Is the Financial Assurance Requirement for these Operators OK?

Cimarex Energy Co of Colorado (162683)  
ConocoPhillips Co (217817)  
Fasken Oil & Ranch LTD (151416)  
Range Operating New Mexico Inc (227588)  
Apache Corp (873)  
Nadel and Gussman Permian LLC (155615)

I have checked each operator for Inactive wells.

Please let me know. Thanks and have a nice day. Donna