

*Marathon*

DATE IN <i>6/20/06</i>	SUSPENSE <i>7-10-06</i>	ENGINEER <i>MIKE STOGNER</i>	LOGGED IN <i>6/20/06</i>	TYPE <i>NSP</i>	APP NO. <i>TD50617152641</i>
------------------------	-------------------------	------------------------------	--------------------------	-----------------	------------------------------

ABOVE THIS LINE FOR DIVISION USE ONLY

**NEW MEXICO OIL CONSERVATION DIVISION**

- Engineering Bureau -

1220 South St. Francis Drive, Santa Fe, NM 87505



*Blindry*

**ADMINISTRATIVE APPLICATION CHECKLIST**

THIS CHECKLIST IS MANDATORY FOR ALL ADMINISTRATIVE APPLICATIONS FOR EXCEPTIONS TO DIVISION RULES AND REGULATIONS WHICH REQUIRE PROCESSING AT THE DIVISION LEVEL IN SANTA FE

**Application Acronyms:**

[NSL-Non-Standard Location] [NSP-Non-Standard Proration Unit] [SD-Simultaneous Dedication]  
 [DHC-Downhole Commingling] [CTB-Lease Commingling] [PLC-Pool/Lease Commingling]  
 [PC-Pool Commingling] [OLS - Off-Lease Storage] [OLM-Off-Lease Measurement]  
 [WFX-Waterflood Expansion] [PMX-Pressure Maintenance Expansion]  
 [SWD-Salt Water Disposal] [IPI-Injection Pressure Increase]  
 [EOR-Qualified Enhanced Oil Recovery Certification] [PPR-Positive Production Response]

[1] **TYPE OF APPLICATION** - Check Those Which Apply for [A]

[A] Location - Spacing Unit - Simultaneous Dedication  
☐ NSL ☒ NSP ☐ SD

Check One Only for [B] or [C]

[B] Commingling - Storage - Measurement  
☐ DHC ☐ CTB ☐ PLC ☐ PC ☐ OLS ☐ OLM

[C] Injection - Disposal - Pressure Increase - Enhanced Oil Recovery  
☐ WFX ☐ PMX ☐ SWD ☐ IPI ☐ EOR ☐ PPR

[D] Other: Specify \_\_\_\_\_

2006 JUN 20 PM 1 59

[2] **NOTIFICATION REQUIRED TO:** - Check Those Which Apply, or Does Not Apply

[A] ☐ Working, Royalty or Overriding Royalty Interest Owners  
 [B] ☒ Offset Operators, Leaseholders or Surface Owner  
 [C] ☐ Application is One Which Requires Published Legal Notice  
 [D] ☐ Notification and/or Concurrent Approval by BLM or SLO  
U.S. Bureau of Land Management - Commissioner of Public Lands, State Land Office  
 [E] ☒ For all of the above, Proof of Notification or Publication is Attached, and/or,  
 [F] ☐ Waivers are Attached

[3] **SUBMIT ACCURATE AND COMPLETE INFORMATION REQUIRED TO PROCESS THE TYPE OF APPLICATION INDICATED ABOVE.**

[4] **CERTIFICATION:** I hereby certify that the information submitted with this application for administrative approval is **accurate** and **complete** to the best of my knowledge. I also understand that **no action** will be taken on this application until the required information and notifications are submitted to the Division.

**Note:** Statement must be completed by an individual with managerial and/or supervisory capacity.

Charles E. Kendrick  
 Print or Type Name

Charles E. Kendrick  
 Signature

Regulatory Compliance Rep 6/13/06  
 Title Date

cekendrix@marathonoil.com  
 e-mail Address



**Southern Business Unit**

P. O. Box 3487  
Houston, TX 77253-3487

5555 San Felipe Road  
Houston, TX 77056-2799

Telephone: (713) 296-2096  
FAX: (713) 499-6750

June 13, 2006

New Mexico Oil Conservation Division  
1220 South St. Francis Drive  
Santa Fe, New Mexico 87505

RE: W.S. Marshall B No. 4 Blinebry Gas

TO: Mr. Michael Stogner

Dear Mr. Stogner

This application is for a non-standard gas proration unit for the W.S. Marshall B No. 4 well (API # 30-025-06821). Marathon wishes to dedicate the 40 acres in UL "L", Section 27, Township 21 South, Range 37 East, to this well.

The No. 4 well was a producing gas well in the Blinebry pool until April 1987. The Blinebry completion was produced on a non-standard 120 acre proration unit under NSP 1460. The remaining 40 acres on Marathon's 160 acre lease was dedicated to the W.S. Marshall B No. 1 as a Blinebry gas well under NSP 1784. At the time the Blinebry completion was abandoned the No. 4 well was making approximately 51 mcf per day of gas and no liquids. Marathon later added two Blinebry oil wells to the W.S. Marshall B lease and 80 acres of the original 120 acre proration unit were subsequently dedicated to these two oil wells. These two wells, the W.S. Marshall B No.s 9 & 10 are still producing from the Blinebry formation. This situation leaves only 40 acres available for dedication to the No. 4 well in the Blinebry pool. Marathon does not anticipate that the well will be capable of making in excess of allowable for the Blinebry even with the restricted acreage, and we are requesting a non-standard proration unit so that the well can be downhole commingled.

Marathon is in the process of trying to permit the No. 4 well for downhole commingling in the Blinebry, Drinkard, and Paddock pools in order to completely produce all recoverable reserves in the three pools in an economic fashion.

Offset operators are being notified of Marathon's application for a non-standard proration unit for the W.S. Marshall B No. 4 Blinebry completion. I have enclosed C-102 plats for the three W.S. Marshall B, active Blinebry wells. These plats are also being sent to the NMOCD in Hobbs to update their records, and a copy will be sent with the downhole commingle application to Mr. Will Jones with an explanation that the filing is contingent upon Marathon's receiving an NSP for the Blinebry. I have also included a map of the W.S. Marshall lease with all three wells active Blinebry wells highlighted on it. I have also included with this application a list of offset operators and their active Blinebry wells, and a copy of the letter sent via certified mail to these offset operators.

If you need any further information please contact me at 713-296-2096 or through email [cekendrix@marathonoil.com](mailto:cekendrix@marathonoil.com).

Sincerely,

*Charles E. Kendrick*

Charles E. Kendrick  
Regulatory Compliance Representative  
Marathon Oil Company

*Commingle Blinebry production  
as of April 1987  
28 285 BO  
768 BW  
7126051 MCF*

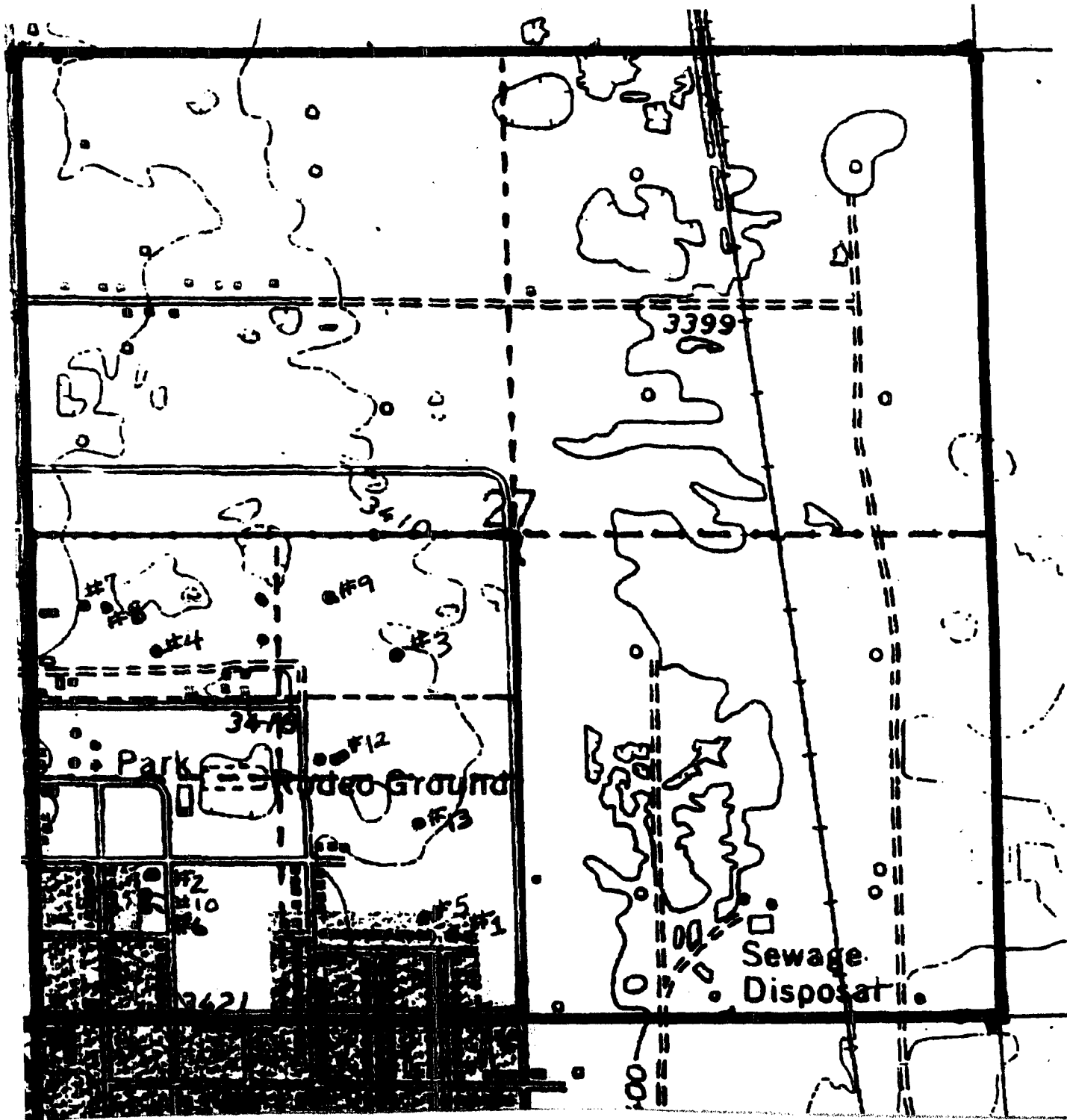

District I  
1625 N. French Dr., Hobbs, NM 88240  
District II  
1301 W. Grand Avenue, Artesia, NM 88210  
District III  
1000 Rio Brazos Rd., Aztec, NM 87410  
District IV  
1220 S. St. Francis Dr., Santa Fe, NM 87505

State of New Mexico  
Energy, Minerals & Natural Resources

Form C-102  
Revised June 10, 2003

OIL CONSERVATION DIVISION  
1220 South St. Francis Dr.  
Santa Fe, NM 87505

Submit to Appropriate District Office  
State Lease - 4 Copies  
Fee Lease - 3 Copies

☐ AMENDED REPORT

WELL LOCATION AND ACREAGE DEDICATION PLAT

<sup>1</sup> API Number 30-025-06821		<sup>2</sup> Pool Code 60240		<sup>3</sup> Pool Name Blinebry	
<sup>4</sup> Property Code 006428		<sup>5</sup> Property Name W.S. Marshall B			<sup>6</sup> Well Number 4
<sup>7</sup> OGRID No. 14021		<sup>8</sup> Operator Name Marathon Oil Company			<sup>9</sup> Elevation 3415'

<sup>10</sup> Surface Location

UL or lot no.	Section	Township	Range	Lot. Idn	Feet from the	North/South line	Feet from the	East/West line	County
L	27	21-S	37-E		1980	South	660	West	Lea

<sup>11</sup> Bottom Hole Location If Different From Surface

UL or lot no.	Section	Township	Range	Lot. Idn	Feet from the	North/South line	Feet from the	East/West line	County

<sup>12</sup> Dedicated Acres 40	<sup>13</sup> Joint or Infill N	<sup>14</sup> Consolidation Code	<sup>15</sup> Order No.
-------------------------------------	------------------------------------	----------------------------------	-------------------------

NO ALLOWABLE WILL BE ASSIGNED TO THIS COMPLETION UNTIL ALL INTERESTS HAVE BEEN CONSOLIDATED OR A NON-STANDARD UNIT HAS BEEN APPROVED BY THE DIVISION

<sup>16</sup> 	<sup>17</sup> OPERATOR CERTIFICATION I hereby certify that the information contained herein is true and complete to the best of my knowledge and belief.  Signature Charles E. Kendrix Printed Name Regulatory Compliance Rep cekendrix@marathonoil.com Title and E-mail Address 06/13/2006 Date			
	<sup>18</sup> SURVEYOR CERTIFICATION I hereby certify that the well location shown on this plat was plotted from field notes of actual surveys made by me or under my supervision, and that the same is true and correct to the best of my belief. Date of Survey Signature and Seal of Professional Surveyer: Certificate Number			

Standard 640-acre Section

District I  
1625 N. French Dr., Hobbs, NM 88240

District II  
1301 W. Grand Avenue, Artesia, NM 88210

District III  
1000 Rio Brazos Rd., Aztec, NM 87410

District IV  
1220 S. St. Francis Dr., Santa Fe, NM 87505

State of New Mexico  
Energy, Minerals & Natural Resources

OIL CONSERVATION DIVISION  
1220 South St. Francis Dr.  
Santa Fe, NM 87505

Form C-102  
Revised June 10, 2003

Submit to Appropriate District Office  
State Lease - 4 Copies  
Fee Lease - 3 Copies

☐ AMENDED REPORT

WELL LOCATION AND ACREAGE DEDICATION PLAT

<sup>1</sup> API Number 30-025-06821	<sup>2</sup> Pool Code 19190	<sup>3</sup> Pool Name Drinkard
<sup>4</sup> Property Code 006428	<sup>5</sup> Property Name W.S. Marshall B	<sup>6</sup> Well Number 4
<sup>7</sup> OGRID No. 14021	<sup>8</sup> Operator Name Marathon Oil Company	<sup>9</sup> Elevation 3415'

<sup>10</sup> Surface Location

UL or lot no. L	Section 27	Township 21-S	Range 37-E	Lot. Idn	Feet from the 1980	North/South line South	Feet from the 660	East/West line West	County Lea
--------------------	---------------	------------------	---------------	----------	-----------------------	---------------------------	----------------------	------------------------	---------------

<sup>11</sup> Bottom Hole Location If Different From Surface

UL or lot no.	Section	Township	Range	Lot. Idn	Feet from the	North/South line	Feet from the	East/West line	County
<sup>12</sup> Dedicated Acres 40	<sup>13</sup> Joint or Infill N	<sup>14</sup> Consolidation Code	<sup>15</sup> Order No.						

NO ALLOWABLE WILL BE ASSIGNED TO THIS COMPLETION UNTIL ALL INTERESTS HAVE BEEN CONSOLIDATED OR A  
NON-STANDARD UNIT HAS BEEN APPROVED BY THE DIVISION

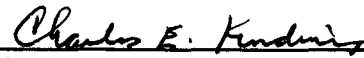
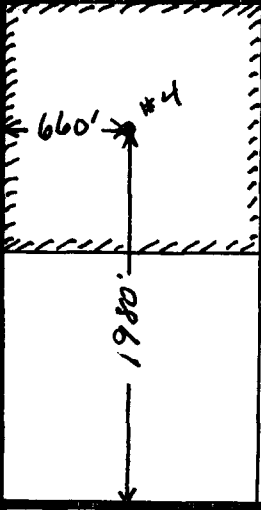
<sup>16</sup>				<sup>17</sup> OPERATOR CERTIFICATION <i>I hereby certify that the information contained herein is true and complete to the best of my knowledge and belief.</i>  Signature Charles E. Kendrix Printed Name Regulatory Compliance Rep cekendrix@marathonoil.com Title and E-mail Address 06/13/2006 Date
				<sup>18</sup> SURVEYOR CERTIFICATION <i>I hereby certify that the well location shown on this plat was plotted from field notes of actual surveys made by me or under my supervision, and that the same is true and correct to the best of my belief.</i>  Date of Survey Signature and Seal of Professional Surveyer:  Certificate Number

## OIL CONSERVATION DIVISION

STATE OF NEW MEXICO  
ENERGY AND MINERALS DEPARTMENTP. O. BOX 2088  
SANTA FE, NEW MEXICO 87501Form C-102  
Revised 10-1-

All distances must be from the outer boundaries of the Section.

Operator Marathon Oil Company		Lease W. S. Marshall "B"		Well No. 4
Unit Letter L	Section 27	Township 21-S	Range 37-E	County Lea
Actual Postage Location of Well:				
1980 feet from the South line and		660 feet from the West line		
Ground Level Elev. 3415'	Producing Formation Paddock	Pool Paddock	Dedicated Acreage 40 Acres	

1. Outline the acreage dedicated to the subject well by colored pencil or hatchure marks on the plat below.
2. If more than one lease is dedicated to the well, outline each and identify the ownership thereof (both as to working interest and royalty).
3. If more than one lease of different ownership is dedicated to the well, have the interests of all owners been consolidated by communitization, unitization, force-pooling, etc?

☐ Yes ☐ No If answer is "yes," type of consolidation \_\_\_\_\_

If answer is "no," list the owners and tract descriptions which have actually been consolidated. (Use reverse side of this form if necessary.) \_\_\_\_\_

No allowable will be assigned to the well until all interests have been consolidated (by communitization, unitization, forced-pooling, or otherwise) or until a non-standard unit, eliminating such interests, has been approved by the Division

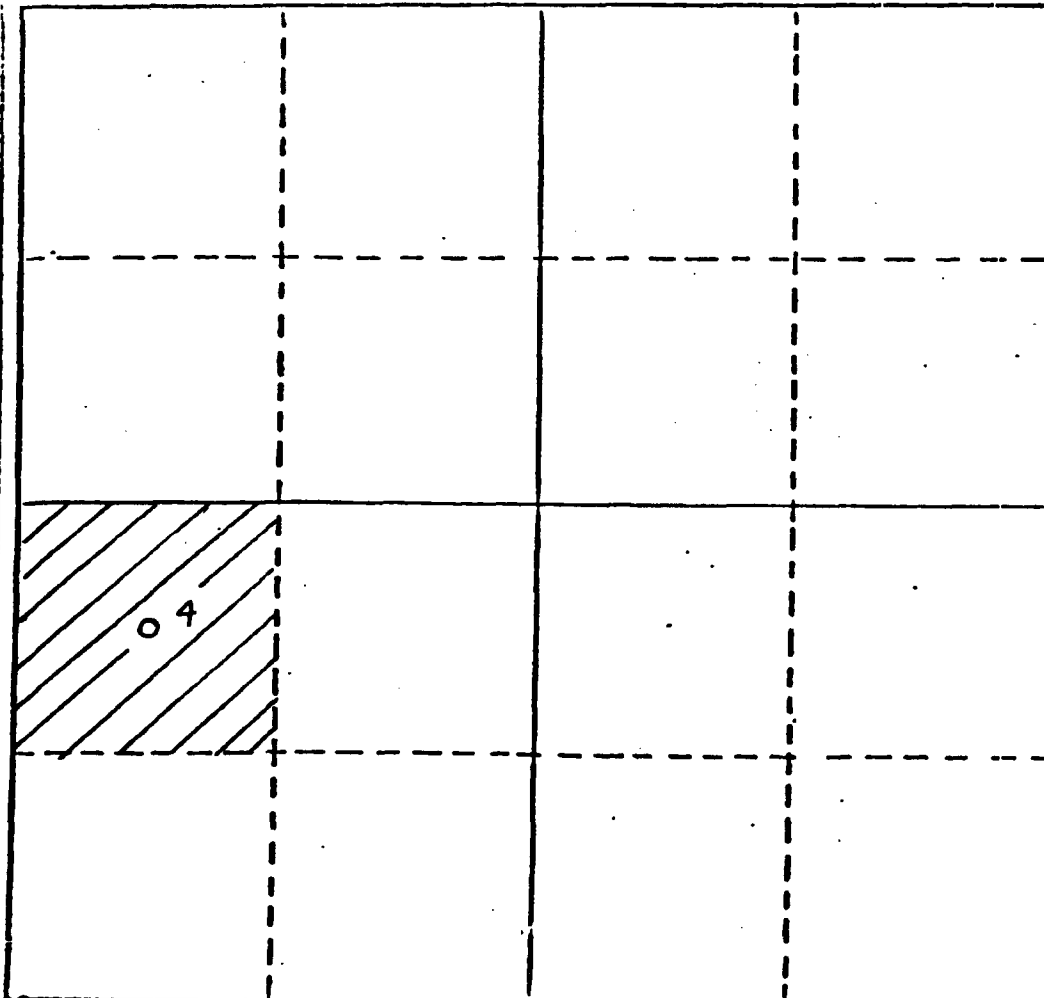

## CERTIFICATION

I hereby certify that the information contained herein is true and complete to the best of my knowledge and belief.

Name E. M. Pingle  
 Position Engineer  
 Company Marathon Oil Company  
 Date April 30, 1987

I hereby certify that the well location shown on this plat was plotted from field notes of actual surveys made by me or under my supervision, and that the same is true and correct to the best of my knowledge and belief.

Date Surveyed \_\_\_\_\_  
 Registered Professional Engineer  
 and/or Land Surveyor

Certificate No. \_\_\_\_\_

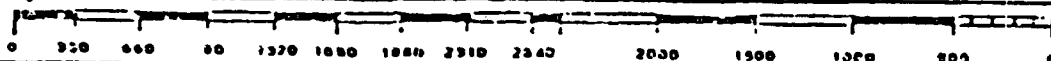

## **Offset Operator / Offset Well List for W.S. Marshall B Lease**

**Apache Corporation  
2000 Post Oak Blvd Suite 100  
Houston, Texas 77056-4400**

<b>Well/ Lease Name &amp; No.</b>	<b>API No.</b>	<b>Location</b>
Owen B No. 6	30-025-34321	"K", Sec 34, T-21-S, R-37-E
Owen B No. 10	30-025-35638	"L", Sec 34, T-21-S, R-37-E

**Chevron USA Inc  
15 Smith Road  
Midland, Texas 79705**

<b>Well/ Lease Name &amp; No.</b>	<b>API No.</b>	<b>Location</b>
Eunice King No. 10	30-025-06846	"B", Sec 28, T-21-S, R-37-E
Eunice King No. 13	30-025-06849	"A", Sec 28, T-21-S, R-37-E
Eunice King No. 15	30-025-06852	"F", Sec 28, T-21-S, R-37-E
Eunice King No. 25	30-025-06865	"D", Sec 28, T-21-S, R-37-E
J. N. Carson NCT A No. 9	30-025-06850	"K", Sec 28, T-21-S, R-37-E
J. N. Carson NCT A No. 10	30-025-06816	"J", Sec 28, T-21-S, R-37-E
J. N. Carson NCT C No. 9	30-025-06836	"I", Sec 28, T-21-S, R-37-E
Mark Owen No. 4	30-025-07003	"J", Sec 34, T-21-S, R-37-E

**ConocoPhillips  
4001 Penbrook Street  
Odessa, Texas 79762**

<b>Well/ Lease Name &amp; No.</b>	<b>API No.</b>	<b>Location</b>
Lockhart A 27 No. 5	30-025-06803	"A", Sec 27, T-21-S, R-37-E
Lockhart A 27 No. 15	30-025-34171	"F", Sec 27, T-21-S, R-37-E
Lockhart A 27 No. 16	30-025-34312	"B", Sec 27, T-21-S, R-37-E
M.E. Wantz No. 1	30-025-06706	"N", Sec 21, T-21-S, R-37-E
M.E. Wantz No. 8	30-025-06697	"O", Sec 21, T-21-S, R-37-E

**ExxonMobil Corporation**  
**P.O. Box 4358**  
**Houston, Texas 77210-4358**

<b>Well/ Lease Name &amp; No.</b>	<b>API No.</b>	<b>Location</b>
F. F. Hardison B No. 2	30-025-07009	"A", Sec 34, T-21-S, R-37-E
F. F. Hardison B No. 3	30-025-07010	"G", Sec 34, T-21-S, R-37-E
F. F. Hardison B No. 4	30-025-07011	"B", Sec 34, T-21-S, R-37-E
F. F. Hardison B No. 5	30-025-06808	"O", Sec 34, T-21-S, R-37-E
F. F. Hardison B No. 7	30-025-06810	"P", Sec 27, T-21-S, R-37-E
F. F. Hardison B No. 8	30-025-06811	"I", Sec 27, T-21-S, R-37-E

**John H. Hendrix Corporation**  
**P.O. Box 3040**  
**Midland, Texas 79702**

<b>Well/ Lease Name &amp; No.</b>	<b>API No.</b>	<b>Location</b>
H. Corrigan No 5	30-025-06992	"J", Sec 33, T-21-S, R-37-E

**Stephens & Johnson Operating Company**  
**P.O. Box 2249**  
**Wichita Falls, Texas 76307-2249**

<b>Well/ Lease Name &amp; No.</b>	<b>API No.</b>	<b>Location</b>
E.O. Carson No. 5	30-025-06977	"G", Sec 33, T-21-S, R-37-E
E.O. Carson No. 10	30-025-06982	"F", Sec 33, T-21-S, R-37-E
E.O. Carson No. 14	30-025-06985	"C", Sec 33, T-21-S, R-37-E
E.O. Carson No. 17	30-025-06871	"N", Sec 33, T-21-S, R-37-E
E.O. Carson No. 19	30-025-06873	"L", Sec 28, T-21-S, R-37-E
E.O. Carson No. 24	30-025-34353	"M", Sec 28, T-21-S, R-37-E
Carson Watson Com No. 2	30-025-06975	"H", Sec 33, T-21-S, R-37-E
Marshall Com No. 1	30-025-07013	"E", Sec 34, T-21-S, R-37-E
Marshall Com No. 3	30-025-07014	"D", Sec 34, T-21-S, R-37-E
Marshall Com No. 5	30-025-07016	"C", Sec 34, T-21-S, R-37-E



**Southern Business Unit**

P. O. Box 3487  
Houston, TX 77253-3487

5555 San Felipe Road  
Houston, TX 77056-2799

Telephone: (713) 296-2096

FAX: (713) 499-6750

June 15, 2006

RE: W.S. Marshall B No. 4 Blinbry Gas Non-Standard Proration Unit

TO: Whom it may concern

Marathon Oil Company is sending this notice to you as a designated operator for wells that offset Marathon's W.S. Marshall B No. 4 well located in Section 27, T21S, R37E. Marathon is proposing to put the No. 4 well back on production with the approval from the NMOCD for a non-standard gas proration unit in the Blinbry gas pool.

In the event that you should wish to protest this application you must contact the NMOCD in writing at 1220 South St. Francis Drive in Santa Fe, New Mexico within 21 days of this mailing. If you have any concerns or questions regarding this filing please feel free to contact me at phone number 713-296-2096 or through email at [cekendrix@marathonoil.com](mailto:cekendrix@marathonoil.com).

Thank You,

*Charles E. Kendrix*

Charles E. Kendrix  
Regulatory Compliance Representative  
Marathon Oil Company

Date: 6/14/2006

Time: 9:15 AM

**W.S. Marshall B Offset Active Blinebry Wells**

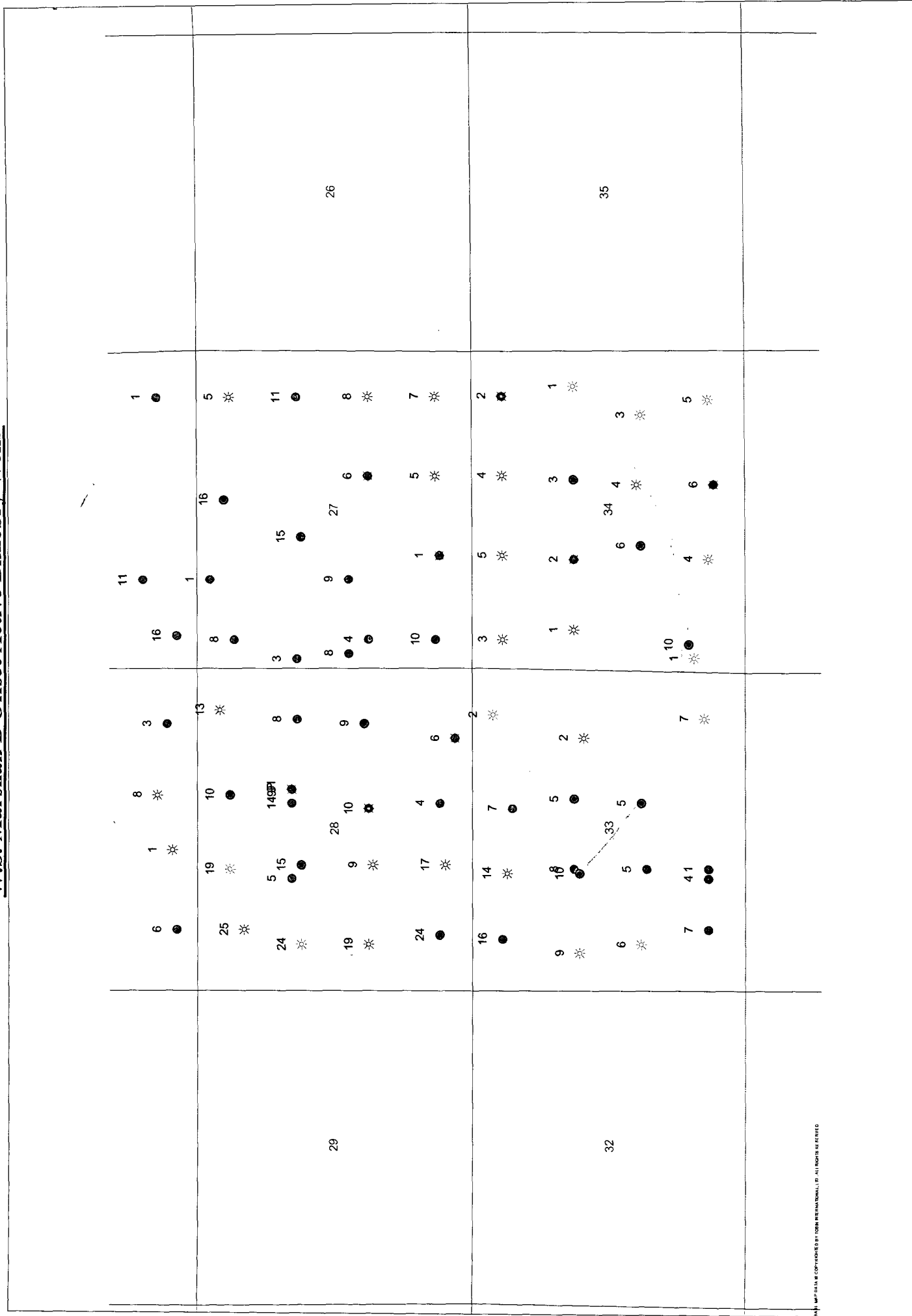

## SENDER: COMPLETE THIS SECTION

- Complete items 1, 2, and 3. Also complete item 4 if Restricted Delivery is desired.
- Print your name and address on the reverse so that we can return the card to you.
- Attach this card to the back of the mailpiece, or on the front if space permits.

1. Article Addressed to:

**Apache Corporation**  
**2000 Post Oak Blvd. Suite 100**  
**Houston, Texas 77056-4400**

2

91 7108 2133 3931 5873 6888

PS Form 3811, July 1999

Domestic Return Receipt

102595-00-M-0952

## COMPLETE THIS SECTION ON DELIVERY

A. Received by (Please Print Clearly)

B. Date of Delivery

C. Signature

X

☐ Agent☐ AddresseeD. Is delivery address different from item 1? ☐ YesIf YES, enter delivery address below: ☐ No

3. Service Type

☒ Certified Mail☐ Express Mail☐ Registered☐ Return Receipt for Merchandise☐ Insured Mail☐ C.O.D.

4. Restricted Delivery? (Extra Fee)

☐ Yes

## SENDER: COMPLETE THIS SECTION

- Complete items 1, 2, and 3. Also complete item 4 if Restricted Delivery is desired.
- Print your name and address on the reverse so that we can return the card to you.
- Attach this card to the back of the mailpiece, or on the front if space permits.

1. Article Addressed to:

**Chevron USA Inc**  
**15 Smith Road**  
**Midland, Texas 79705**

2

91 7108 2133 3931 5873 6871

PS Form 3811, July 1999

Domestic Return Receipt

102595-00-M-0952

## COMPLETE THIS SECTION ON DELIVERY

A. Received by (Please Print Clearly)

B. Date of Delivery

C. Signature

X

☐ Agent☐ AddresseeD. Is delivery address different from item 1? ☐ YesIf YES, enter delivery address below: ☐ No

3. Service Type

☒ Certified Mail☐ Express Mail☐ Registered☐ Return Receipt for Merchandise☐ Insured Mail☐ C.O.D.

4. Restricted Delivery? (Extra Fee)

☐ Yes

## SENDER: COMPLETE THIS SECTION

- Complete items 1, 2, and 3. Also complete item 4 if Restricted Delivery is desired.
- Print your name and address on the reverse so that we can return the card to you.
- Attach this card to the back of the mailpiece, or on the front if space permits.

1. Article Addressed to:

## COMPLETE THIS SECTION ON DELIVERY

A. Received by (Please Print Clearly) B. Date of Delivery

C. Signature

X

☐ Agent☐ AddresseeD. Is delivery address different from item 1? ☐ YesIf YES, enter delivery address below: ☐ No**Stephens & Johnson Op Co****P.O. Box 2249****Wichita Falls, Texas 76307-2249**

3. Service Type

☒ Certified Mail☐ Express Mail☐ Registered☐ Return Receipt for Merchandise☐ Insured Mail☐ C.O.D.

4. Restricted Delivery? (Extra Fee)

☐ Yes

2. Article Number (Copy from mailing label)

91 7108 2133 3931 5873 6727

PS Form 3811, July 1999

Domestic Return Receipt

102595-00-M-0952

## SENDER: COMPLETE THIS SECTION

- Complete items 1, 2, and 3. Also complete item 4 if Restricted Delivery is desired.
- Print your name and address on the reverse so that we can return the card to you.
- Attach this card to the back of the mailpiece, or on the front if space permits.

1. Article Addressed to:

**ConocoPhillips Company****4001 Penbrook Street****Odessa, Texas 79762**

## COMPLETE THIS SECTION ON DELIVERY

A. Received by (Please Print Clearly) B. Date of Delivery

C. Signature

X

☐ Agent☐ AddresseeD. Is delivery address different from item 1? ☐ YesIf YES, enter delivery address below: ☐ No

3. Service Type

☒ Certified Mail☐ Express Mail☐ Registered☐ Return Receipt for Merchandise☐ Insured Mail☐ C.O.D.

4. Restricted Delivery? (Extra Fee)

☐ Yes

91 7108 2133 3931 5873 6864

PS Form 3811, July 1999

Domestic Return Receipt

102595-00-M-0952

## SENDER: COMPLETE THIS SECTION

- Complete items 1, 2, and 3. Also complete item 4 if Restricted Delivery is desired.
- Print your name and address on the reverse so that we can return the card to you.
- Attach this card to the back of the mailpiece, or on the front if space permits.

1. Article Addressed to:

**ExxonMobil Corporation**  
**P.O. Box 4358**  
**Houston, Texas 77210-4358**

## COMPLETE THIS SECTION ON DELIVERY

A. Received by (Please Print Clearly) B. Date of Delivery

C. Signature

X

☐ Agent  
☐ Addressee

D. Is delivery address different from item 1? ☐ Yes  
If YES, enter delivery address below: ☐ No

3. Service Type

☒ Certified Mail ☐ Express Mail  
☐ Registered ☐ Return Receipt for Merchandise  
☐ Insured Mail ☐ C.O.D.
4. Restricted Delivery? (Extra Fee) ☐ Yes

91 7108 2133 3931 5873 6857

PS Form 3811, July 1999

Domestic Return Receipt

102595-00-M-0952

## SENDER: COMPLETE THIS SECTION

- Complete items 1, 2, and 3. Also complete item 4 if Restricted Delivery is desired.
- Print your name and address on the reverse so that we can return the card to you.
- Attach this card to the back of the mailpiece, or on the front if space permits.

1. Article Addressed to:

**John H. Hendrix Corporation**  
**P.O. Box 3040**  
**Midland, Texas 79702**

## COMPLETE THIS SECTION ON DELIVERY

A. Received by (Please Print Clearly) B. Date of Delivery

C. Signature

X

☐ Agent  
☐ Addressee

D. Is delivery address different from item 1? ☐ Yes  
If YES, enter delivery address below: ☐ No

3. Service Type

☒ Certified Mail ☐ Express Mail  
☐ Registered ☐ Return Receipt for Merchandise  
☐ Insured Mail ☐ C.O.D.
4. Restricted Delivery? (Extra Fee) ☐ Yes

91 7108 2133 3931 5873 6840

PS Form 3811, July 1999

Domestic Return Receipt

102595-00-M-0952