

DATE 7/29/02	SUSPENSE NA	ENGINEER WJ	LOGGED IN NV	TYPE DHC	APP NO. 221132969
--------------	-------------	-------------	--------------	----------	-------------------

ABOVE THIS LINE FOR DIVISION USE ONLY

NEW MEXICO OIL CONSERVATION DIVISION
 - Engineering Bureau -
 1220 South St. Francis Drive, Santa Fe, NM 87505



ADMINISTRATIVE APPLICATION CHECKLIST

THIS CHECKLIST IS MANDATORY FOR ALL ADMINISTRATIVE APPLICATIONS FOR EXCEPTIONS TO DIVISION RULES AND REGULATIONS WHICH REQUIRE PROCESSING AT THE DIVISION LEVEL IN SANTA FE

Application Acronyms:

[NSL-Non-Standard Location] [NSP-Non-Standard Proration Unit] [SD-Simultaneous Dedication]
 [DHC-Downhole Commingling] [CTB-Lease Commingling] [PLC-Pool/Lease Commingling]
 [PC-Pool Commingling] [OLS - Off-Lease Storage] [OLM-Off-Lease Measurement]
 [WFX-Waterflood Expansion] [PMX-Pressure Maintenance Expansion]
 [SWD-Salt Water Disposal] [IPI-Injection Pressure Increase]
 [EOR-Qualified Enhanced Oil Recovery Certification] [PPR-Positive Production Response]

[1] **TYPE OF APPLICATION** - Check Those Which Apply for [A]

[A] Location - Spacing Unit - Simultaneous Dedication
☐ NSL ☐ NSP ☐ SD

Check One Only for [B] or [C]

[B] Commingling - Storage - Measurement
☒ DHC ☐ CTB ☐ PLC ☐ PC ☐ OLS ☐ OLM

[C] Injection - Disposal - Pressure Increase - Enhanced Oil Recovery
☐ WFX ☐ PMX ☐ SWD ☐ IPI ☐ EOR ☐ PPR

[D] Other: Specify _____

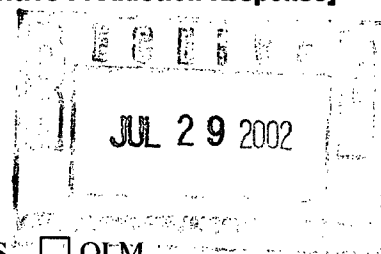

[2] **NOTIFICATION REQUIRED TO:** - Check Those Which Apply, or Does Not Apply

- [A] ☐ Working, Royalty or Overriding Royalty Interest Owners
- [B] ☒ Offset Operators, Leaseholders or Surface Owner
- [C] ☐ Application is One Which Requires Published Legal Notice
- [D] ☐ Notification and/or Concurrent Approval by BLM or SLO
U.S. Bureau of Land Management - Commissioner of Public Lands, State Land Office
- [E] ☐ For all of the above, Proof of Notification or Publication is Attached, and/or,
- [F] ☐ Waivers are Attached

[3] **SUBMIT ACCURATE AND COMPLETE INFORMATION REQUIRED TO PROCESS THE TYPE OF APPLICATION INDICATED ABOVE.**

[4] **CERTIFICATION:** I hereby certify that the information submitted with this application for administrative approval is **accurate** and **complete** to the best of my knowledge. I also understand that **no action** will be taken on this application until the required information and notifications are submitted to the Division.

Note: Statement must be completed by an individual with managerial and/or supervisory capacity.

CAROLYN L. HAYNIE
 Print or Type Name

Signature

Carolyn Haynie

PE TECHNICAL ASSISTANT
 Title

07-24-2002
 Date

CarolynHaynie@ChevronTexaco.com
 e-mail Address

Chevron U.S.A. Production Company
Carolyn J. Haynie
Technical Assistant
Eunice Waterflood
15 Smith Road
Midland, TX 79705

ChevronTexaco

July 24, 2002

Request for Exception to Rule 303-A
Downhole Commingling
Monument, Tubb; Monument, Drinkard;
& Monument, Abo
Baxter Culp 31 # 5
Section 31, T19S, R37E
Lea County, New Mexico

State of New Mexico
Energy, Minerals & Natural Resources Dept.
Oil Conservation Division
2040 S. Pacheco
Santa Fe, New Mexico 87505

Attention: Ms. Lori Wrotenbery, Director

Dear Ms. Wrotenbery:

ChevronTexaco, Exploration & Production Company, formerly Chevron U.S.A. Production Company, respectfully requests administrative approval for an exception to Rule 303-A to permit Downhole commingling of the Monument, Tubb; Monument, Drinkard; & Monument, Abo zones, in the Baxter Culp 31 # 5.

Currently, the Baxter Culp 31 # 5 is producing in the Monument, Tubb. The Drinkard zone is shut-in and is isolated with a CIBP. ChevronTexaco, is the operator of these wells with a 100% ownership. Commingling will not reduce the actual commercial value of gas or oil sold from the Baxter Culp 31 # 5. Permission to commingle the well would substantially lower operating costs to ChevronTexaco and will extend the economic life of the well.

If you have any questions or need additional information, please contact me at 915-687-7384.

Sincerely,

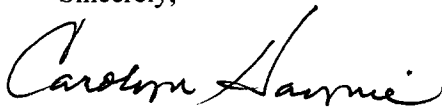

Carolyn Haynie
New Mexico Waterflood
Petroleum Engineering Technical Assistant

Attachments

Cc: NMOCD – Hobbs, NM
Central Files – Lease & Well Files

Nathan Mouser
Mike Howell
Kent Coggan
Reggie Holzer

Submit 3 Copies To Appropriate District
Office
District I
1625 N. French Dr., Hobbs, NM 88240
District II
1301 W. Grand Avenue, Artesia, NM 88210
District III
1000 Rio Brazos Rd., Aztec, NM 87410
District IV
1220 S. St. Francis Dr., Santa Fe, NM 87505

State of New Mexico
Energy, Minerals and Natural Resources

OIL CONSERVATION DIVISION
1220 South St. Francis Dr.
Santa Fe, NM 87505

Form C-103
Revised March 25, 1999

SUNDRY NOTICES AND REPORTS ON WELLS (DO NOT USE THIS FORM FOR PROPOSALS TO DRILL OR TO DEEPEN OR PLUG BACK TO A DIFFERENT RESERVOIR. USE "APPLICATION FOR PERMIT" (FORM C-101) FOR SUCH PROPOSALS.)		WELL API NO. 30-025-35692
1. Type of Well: Oil Well <input checked="" type="checkbox"/> Gas Well <input type="checkbox"/> Other (DHC, MONUMENT, TUBB, MONUMENT, DRINKARD, MONUMENT, ABO)		5. Indicate Type of Lease STATE <input type="checkbox"/> FEE <input checked="" type="checkbox"/>
2. Name of Operator CHEVRON U.S.A. INC.		6. State Oil & Gas Lease No. 28827
3. Address of Operator 15 SMITH ROAD, MIDLAND, TX 79705		7. Lease Name or Unit Agreement Name: BAXTER CULP 31
4. Well Location Unit Letter <u>P</u> : <u>330'</u> feet from the <u>SOUTH</u> line and <u>330'</u> feet from the <u>EAST</u> line Section <u>31</u> Township <u>19S</u> Range <u>37E</u> NMPM County <u>LEA</u>		8. Well No. 5
10. Elevation (Show whether DR, RKB, RT, GR, etc.) 3560' GR		9. Pool name or Wildcat MONUMENT, TUBB / MONUMENT, DRINKARD / MONUMENT, ABO

11. Check Appropriate Box to Indicate Nature of Notice, Report or Other Data

NOTICE OF INTENTION TO:

PERFORM REMEDIAL WORK ☐ PLUG AND ABANDON ☐
TEMPORARILY ABANDON ☐ CHANGE PLANS ☐
PULL OR ALTER CASING ☐ MULTIPLE COMPLETION ☐

OTHER: (DHC, MONUMENT, TUBB, MONUMENT, DRINKARD, MONUMENT, ABO) ☒

SUBSEQUENT REPORT OF:

REMEDIAL WORK ☐ ALTERING CASING ☐
COMMENCE DRILLING OPNS. ☐ PLUG AND ABANDONMENT ☐
CASING TEST AND CEMENT JOB ☐

OTHER: ☐

12. Describe proposed or completed operations. (Clearly state all pertinent details, and give pertinent dates, including estimated date of starting any proposed work). SEE RULE 1103. For Multiple Completions: Attach wellbore diagram of proposed completion or recompilation.

UNDER THE PROVISIONS OF RULE 303 C (5), IT IS PROPOSED TO DOWNHOLE COMMINGLE PRE-APPROVED POOLS, MONUMENT, TUBB (PERFS 6334' - 6584'); MONUMENT, DRINKARD, (PERFS 6802' - 6942'); AND MONUMENT, ABO (PERFS 7280' - 7379'), IN THE CAPTIONED WELL. CURRENTLY THE WELL IS PRODUCING MARGINAL RATES FROM THE TUBB. IT IS PROPOSED TO DHC WITH THE PREVIOUSLY TESTED DRINKARD INTERVALS, (PERFS 3802' - 6942'), AND ABO INTERVALS, (PERFS 7280' - 7379'), TO RECOVER THE REMAINING RESERVES FROM THOSE RESERVOIRS. WORK WILL INVOLVE REMOVING A PLUG CURRENTLY COVERING THOSE INTERVALS. PRODUCTION WILL BE ALLOCATED BACK TO THE THREE POOLS BASED ON THE PERCENTAGES SHOWN IN THE ATTACHED SUPPORT DATA.

I hereby certify that the information above is true and complete to the best of my knowledge and belief.

SIGNATURE Carolyn Haynie TITLE PE TECHNICAL ASSISTANT DATE 7/23/02

Type or print name CAROLYN HAYNIE Telephone No. (915) 687-7384

(This space for State use)

APPROVED BY _____ TITLE _____ DATE _____

Conditions of approval, if any:

REQUEST FOR EXCEPTION TO RULE 303-A
FOR WELLS LOCATED IN PRE-APPROVED POOLS OR AREAS

Operator

Chevron U.S.A., Inc.
15 Smith Road
Midland, TX 79705

Lease Name and Well Number

Baxter Culp 31 # 5
330' FSL & 330' FEL, Unit Letter P
Section 31, T19S, R37E
Lea County, New Mexico

Division Order

Pre-approved pools or area established by Division Order No. R-11363.

Pools To Be Commingled In Baxter Culp 31# 5

(47090) Monument; Tubb
(97060) Monument; Drinkard
(46970) Monument; Abo

Perforated Intervals

Monument; Tubb (6334' - 6584') (Wellbore diagrams attached)
Monument; Drinkard (6802' - 6942')
Monument; Abo (7284' - 7379')

Location Plat

Attached

Well Test Report & Production Plots

Attached.

Product Characteristics And Value

Previous commingling of these zones by Chevron and other operators in the area have shown that the produced fluids are compatible and commingling will not cause formation damage or producing problems. Also, the price received by Chevron for products from these zones is very similar, so value will not be adversely affected.

Production Allocation

<u>Pool</u>	<u>BOPD</u>	<u>BWPD</u>	<u>MCFPD</u>	<u>Estimation Method</u>
Monument; Tubb	14	38	13	Well Test Report 6/2002
Monument; DRK	7.2	28.8	15	Calculated from Swab Test, 2/20/2002
Monument; Abo	54	306	608	Calculated from Swab Test, 2/18/2002
Totals	75.2	372.8	636	

<u>Allocated %</u>	<u>Oil %</u>	<u>Water %</u>	<u>Gas %</u>	<u>Remarks</u>
Monument; Tubb	18.62	10.19	2.04	Calculated using above production volumes.
Monument; DRK	9.57	7.73	2.36	Calculated using above production volumes.
Monument; Abo	71.81	82.08	95.60	Calculated using above production volumes.
Totals	100.00	100.00	100.00	

Ownership

Ownership of all zones is identical so correlative rights will not be compromised.

State / Federal Land Notification

Well is on a fee lease.

Well: **Baxter Culp 31 #5**Field: **Monument**Reservoir: **Tubb****Location:**

330' FSL & 330' FEL
 Section: 31 (SE/4 SE/4)
 Township: 19S
 Range: 37E Lot: P
 County: Lea State: NM

Elevations:

GL: 3560'
 KB: 3575'
 DF: 3574'

Estimated Formation Tops

Rustler	1069'
Top Salt	1170'
Base Salt	2364'
Yates	2449'
Seven Rivers	2705'
Queen	3190'
Grayburg	3514'
San Andres	4043'
Glorietta	5167'
Blinbry	5621'
Tubb	6311'
Drinkard	6634'
Abo	6909'

TUBING DETAIL - 5/02/02

201 jts - 2-7/8" J-55 8rd tbg
 5-1/2" x 2-7/8" TAC
 11 2-7/8" J-55 8rd tbg
 1 2-7/8" SN
 Pump Intake @ 6594
 2-7/8" Perf Sub
 2-7/8" BPMA
 EOT landed @ 6630'

Rod Detail:

1-1/2" Polish Rod w/SHSM
 1" KD Pony Rods w/SHSM
 96 1" KD Rods w/SHSM
 95 7/8" KD Rods
 45 3/4" KD Rods
 24 1-1/2" Flexbars 'K' w/guide
 2-1/2" x 1-3/4" Insert pump

Pump: 25-175-RHBC 20-4-.5-.5 No.
 MGEN
 Barrel: BRNYAX w/+.001 FIT
 Plunger 51" AXMP w/-.0008 FIT

SN @ 6594'
 EOT @ 6630'

CIBP set @ 6754'

COTD: 6754'
 PBTD: 6754'
 TD: 7420'

OH interval from 7415-20'

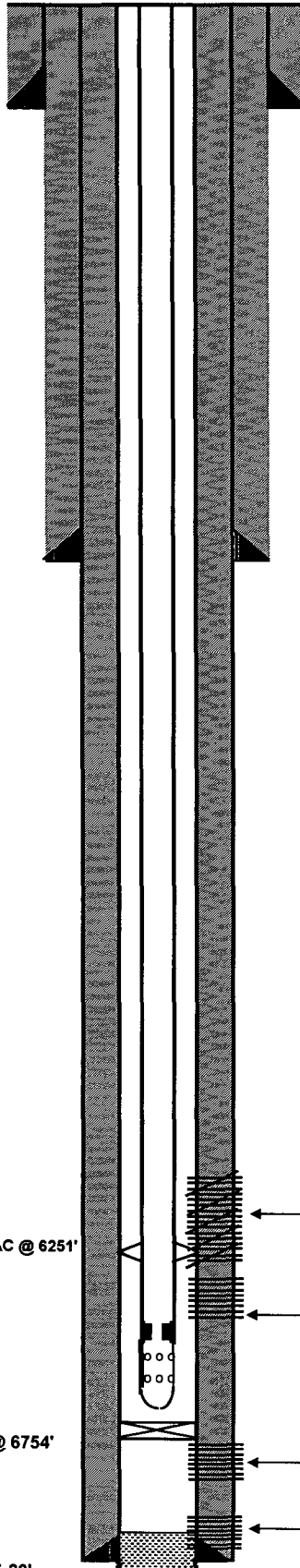
Current Wellbore Diagram**Well ID Info:**

Chevron: HE6550
 API No: 30-025-35692
 L5/L6:
 Spud Date: 11/24/01
 Rig Released: 12/11/01
 Compl. Date: 3/22/02

Surface Csg: 11 3/4", 42#, H-40 STC

Set: @ 430' w/ 350 sx cmt
 Hole Size: 14 3/4" to 430'
 Circ: Yes TOC: Surface
 TOC By: Circulation (115 sx cmt)

Initial Completion:

3/22/02: Perf f/ 6932-7379' (in 5 runs). Perf f/ 6802-6883'
 w/4 JHPF (in 3 runs). Acdz perms f/ 6802-7379' w/5,000
 gal anti-sludge 20% HCL. Set CIBP @ 6754'.
 Perf f/ 6492-6584' w/4 JHPF. Acdz perms f/ 6492-6584'
 w/2,200 gal anti-sludge 15% HCL. Frac @ 6259'
 w/68,500 gal 50-70 Q carbo foam/30, 8,000# 100 mesh
 white sd, & 185,500# 16/30 mesh/white sd.
 Set RBP @ 6400'. Perf f/ 6053-6316' w/4 JHPF
 (in 4 runs). Perf f/ 5660-6032' w/4 JHPF. Acdz perms
 f/ 5660-6316' w/7,000 gal anti-sludge 15% HCL.
 RIH w/P&R.

Subsequent Workovers/Reconditionings/Repairs:

4-25-02: In stages, Cmt Sqz Blinbry Perfs, 5660' - 6316',
 DO and Press. tst intervals w/500 PSI.
 5-1-02: DO CICR @ 6091' & cmt to 6320'. RIH tag sd @ 6385'.
 Rls RBP @ 6400'. RIH w/ 3 1/8" slick guns w/ 4 JSPF.
 120 Deg ph. Perf 5-1/2" csg @ 6334'-38, 6343-47', 6379'-84'
 6400'-04, 6454'-58' tto 21' & 84 holes, all shots fired.
 Run Tbg., set TAC @ 6251'. RIH w/ Rods. Press tst
 to 600 PSI. TOTP.

Intermediate Csg: 8 5/8", 24#, K-55 STC

Set: @ 2568' w/ 900 sx Class C cmt
 Hole Size: 11" to 2569'
 Circ: Yes TOC: surface
 TOC By: Circulation (185 sx cmt)

Prod. Csg: 5 1/2", 15.5#, K-55 LTC

Set: @ 7415' w/ 1350 sx cmt
 Hole Size: 7 7/8" to 7420'
 Circ: Yes TOC: surface
 TOC By: Circulation (87 sx cmt)

Perfs

5660-62', 5676-80', 5726-30',
 5843-51', 5860-63', 5876-81',
 5970-80', 6030-32', 6053-60',
 6065-70', 6198-6200',
 6230-34', 6298-6302',
 6312-16'

Perfs

6334-38', 6343-47' (5-3-02)
 3679-84', 6400-04' (5-3-02)
 6454-58' (5-3-02)
 6552-56', 6580-84'

Perfs

6802-07', 6814-17', 6832-36',
 6843-56', 6878-83', 6932-42'

7280-84', 7288-92', 7328-30',
 7342-45', 7360-63', 7376-79'

Status

Blinbry - Cmt Sqz'd
 Blinbry - Cmt Sqz'd
 Blinbry - Cmt Sqz'd
 Blinbry - Cmt Sqz'd
 Blinbry - Cmt Sqz'd
 Blinbry - Cmt Sqz'd
 Blinbry - Cmt Sqz'd
 Blinbry - Cmt Sqz'd
 Blinbry - Cmt Sqz'd
 Tubb - open
 Tubb - open
 Tubb - open
 Tubb - open

Status

Drinkard - Below CIBP
 Drinkard - Below CIBP

Abo - Below CIBP
 Abo - Below CIBP

Well: **Baxter Culp 31 #5**

Field: Monument

Reservoir: **Tubb, Drinkard, & Abo (DI**

Location:

330' FSL & 330' FEL
Section: 31 (SE/4 SE/4)
Township: 19S
Range: 37E Lot: P
County: Lea State: NM

Elevations:

GL: 3560'
KB: 3575'
DF: 3574'

Estimated Formation Tops

Rustler	1069'
Top Salt	1170'
Base Salt	2364'
Yates	2449'
Seven Rivers	2705'
Queen	3190'
Grayburg	3514'
San Andres	4043'
Glorietta	5167'
Blinberry	5621'
Tubb	6311'
Drinkard	6634'
Abo	6909'

TUBING DETAIL -Proposed

202 jts - 2-7/8" J-55 8rd tbq
5-1/2" x 2-7/8" TAC @ 6251'
35 2-7/8" J-55 8rd tbq
1 2-7/8" SN @ 7340'
Pump Intake @ 6594
2-7/8" Perf Sub
2-7/8" BPMA
EOT landed @ 7375'

Rod Detail:

1-1/2" Polish Rod w/SHSM
1" KD Pony Rods w/SHSM
96 1" KD Rods w/SHSM
95 7/8" KD Rods
45 3/4" KD Rods
24 1-1/2" Flexbars 'K' w/guide
2-1/2" x 1-3/4" Insert pump

Pump: 25-175-RHBC 20-4-.5-.5 No.
MGEN
Barrel: BRNYAX w/ +.001 FIT
Plunger 51" AXMP w/-.0008 FIT

SN @ 7340'
EOT @ 7375'

COTD: 7400'
PBTD: 7400'
TD: 7420'

Proposed Wellbore Diagram

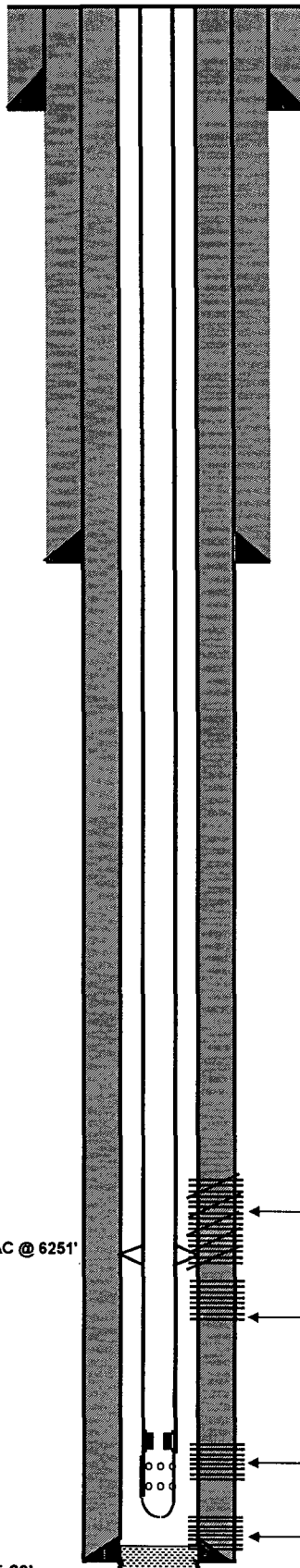
**Well ID Info:**

Chevno: HE6550
API No: 30-025-35692
L5/L6:
Spud Date: 11/24/01
Rig Released: 12/11/01
Compl. Date: 3/22/02

Surface Csg: 11 3/4", 42#, H-40 STC

Set: @ 430' w/ 350 sx cmt
Hole Size: 14 3/4" to 430'
Circ: Yes **TOC:** Surface
TOC By: Circulation (115 sx cmt)

Initial Completion:

3/22/02: Perf f/ 6932-7379' (in 5 runs). Perf f/ 6802-6883' w/4 JHPF (in 3 runs). Acdz perms f/ 6802-7379' w/5,000 gal anti-sludge 20% HCL. Set CIBP @ 6754'.

Perf f/ 6492-6584' w/4 JHPF. Acdz perms f/ 6492-6584' w/2,200 gal anti-sludge 15% HCL. Frac @ 6259' w/68,500 gal 50-70 Q carbo foam 30, 8,000# 100 mesh white sd, & 185,500# 16/30 mesh white sd.

Set RBP @ 6400'. Perf f/ 6053-6316' w/4 JHPF (in 4 runs). Perf f/ 5660-6032' w/4 JHPF. Acdz perms f/ 5660-6316' w/7,000 gal anti-sludge 15% HCL.

RIH w/P&R

Subsequent Workovers/Reconditionings/Repairs:

4-25-02: In stages, Cmt Sqz Blinebry Perfs, 5660' - 6316', DO and Press. tst intervals w/500 PSI.

5-1-02: DO C1CR @ 6091' & cmt/ to 6320'. RIH tag sd @ 6385'. Rls RBP @ 6400'. RIH w/ 3 1/8" slick guns w/ 4 JSFP, 120 Deg ph. Perf 5-1/2" csg @ 6334'-38, 6343-47', 6379'-84' 6400'-04, 6454'-58' to 21' & 84 holes, all shots fired.

Run Tbg., set TAC @ 6251. RIH w/ Rods. Press tst to 600 PSI. TOTP.

Intermediate Csq: 8 5/8", 24#, K-55 STC

Set: @ 2568' w/ 900 sx Class C cmt
Hole Size: 11" to 2569'
Circ: Yes **TOC:** surface
TOC By: Circulation (185 sx cmt)

Prod. Csg: 5 1/2", 15.5#, K-55 LTC

Set: @ 7415' w/ 1350 sx cmt
Hole Size: 7 7/8" to 7420'
Circ: Yes TOC: surface
TOC By: Circulation (87 sx cmt)

Perfs
5660-62', 5676-80', 5726-30',
5843-51', 5860-63', 5876-81',
5970-80', 6030-32', 6053-60',
6065-70', 6198-6200',
6230-34', 6298-6302',
6312-16'

[illegible]

Perfs
6334-38', 6343-47' (5-3-02)
3679-84', 6400-04' (5-3-02)
6454-58' (5-3-02)
6552-56', 6580-84'

Status
Tubb - open
Tubb - open
Tubb - open
Tubb - open

Perfs
6802-07', 6814-17', 6832-36',
6843-56', 6878-83', 6932-42'

Status
Drinkard - open
Drinkard - open

7280-84', 7288-92', 7328-30',
7342-45', 7360-63', 7376-79'

Abo - open⁴
Abo - open³

OH interval from 7415-20'

Updated: 6-10-02 by CHAY

District I
1625 N. French Dr., Hobbs, NM 88240

District II
811 South First, Artesia, NM 88210

District III
1000 Rio Brazos Rd., Aztec, NM 87410

District IV
2040 South Pacheco, Santa Fe, NM 87505

State of New Mexico
Energy, Minerals & Natural Resources Department

Form C-102
Revised March 17, 1999

OIL CONSERVATION DIVISION

2040 South Pacheco
Santa Fe, NM 87505

Submit to Appropriate District Office
State Lease - 4 Copies
Fee Lease - 3 Copies

☐ AMENDED REPORT

WELL LOCATION AND ACREAGE DEDICATION PLAT

¹ API Number 30-025-35692	² Pool Code 97060	³ Pool Name Monument, Drinkard
⁴ Property Code 28827	⁵ Property Name Baxter Culp 31	⁶ Well Number 5
⁷ OGRID No. 4323	⁸ Operator Name Chevron U.S.A. Production Company	⁹ Elevation 3560'

¹⁰ Surface Location

UL or Lot No.	Section	Township	Range	Lot Idn	Feet from the	North/South line	Feet from the	East/West line	County
P	31	19S	37E		330	South	330	East	Lea

¹¹ Bottom Hole Location If Different From Surface

UL or Lot No.	Section	Township	Range	Lot Idn	Feet from the	North/South line	Feet from the	East/West line	County
¹² Dedicated Acres 40	¹³ Joint or Infill	¹⁴ Consolidation Code	¹⁵ Order No.						

NO ALLOWABLE WILL BE ASSIGNED TO THIS COMPLETION UNTIL ALL INTERESTS HAVE BEEN CONSOLIDATED OR A
NON-STANDARD UNIT HAS BEEN APPROVED BY THE DIVISION

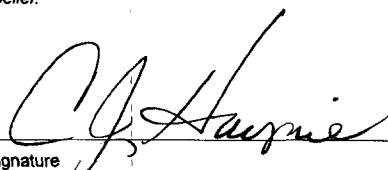
¹⁶				<div><p>¹ OPERATOR CERTIFICATION</p><p><i>I hereby certify that the information contained herein is true and complete to the best of my knowledge and belief.</i></p><p> Signature</p><p>C. J. Haynie Printed Name</p><p>New Mexico Technical Assistant Title</p><p>July 23, 2002 Title</p></div>
				<div><p>¹ SURVEYOR CERTIFICATION</p><p><i>I hereby certify that the well location shown on this plat was plotted from field notes of actual surveys made by me or under my supervision, and that the same is true and correct to the best of my belief.</i></p><p>Signature and Seal of Professional Surveyor:</p><p>40 acres</p><p>40-acre proration unit</p><p>330'</p><p>3 3 0</p></div>
				<p>Certificate Number</p>

District I
1625 N. French Dr., Hobbs, NM 88240

District II
811 South First, Artesia, NM 88210

District III
1000 Rio Brazos Rd., Aztec, NM 87410

District IV
2040 South Pacheco, Santa Fe, NM 87505

State of New Mexico
Energy, Minerals & Natural Resources Department

Form C-102
Revised March 17, 1999

OIL CONSERVATION DIVISION
2040 South Pacheco
Santa Fe, NM 87505

Submit to Appropriate District Office
State Lease - 4 Copies
Fee Lease - 3 Copies

☐ AMENDED REPORT

WELL LOCATION AND ACREAGE DEDICATION PLAT

¹ API Number 30-025-35692	² Pool Code 47090	³ Pool Name Monument, Tubb
⁴ Property Code 28827	⁵ Property Name Baxter Culp 31	⁶ Well Number 5
⁷ OGRID No. 4323	⁸ Operator Name Chevron U.S.A. Production Company	⁹ Elevation 3560'

¹⁰ Surface Location

UL or Lot No.	Section	Township	Range	Lot Idn	Feet from the	North/South line	Feet from the	East/West line	County
P	31	19S	37E		330	South	330	East	Lea

¹¹ Bottom Hole Location If Different From Surface

UL or Lot No.	Section	Township	Range	Lot Idn	Feet from the	North/South line	Feet from the	East/West line	County
¹² Dedicated Acres 80	¹³ Joint or Infill	¹⁴ Consolidation Code	¹⁵ Order No.						

NO ALLOWABLE WILL BE ASSIGNED TO THIS COMPLETION UNTIL ALL INTERESTS HAVE BEEN CONSOLIDATED OR A
NON-STANDARD UNIT HAS BEEN APPROVED BY THE DIVISION

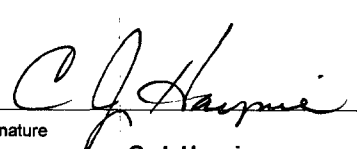
16						1 OPERATOR CERTIFICATION <i>I hereby certify that the information contained herein is true and complete to the best of my knowledge and belief.</i>  Signature C. J. Haynie Printed Name New Mexico Technical Assistant Title July 23, 2002	
							1 SURVEYOR CERTIFICATION <i>I hereby certify that the well location shown on this plat was plotted from field notes of actual surveys made by me or under my supervision, and that the same is true and correct to the best of my belief.</i> Signature and Seal of Professional Surveyor: Certificate Number

30

40 acres

80-acre proration unit

40 acres

330'

3
3
0

District I
1625 N. French Dr., Hobbs, NM 88240

District II
811 South First, Artesia, NM 88210

District III
1000 Rio Brazos Rd., Aztec, NM 87410

District IV
2040 South Pacheco, Santa Fe, NM 87505

State of New Mexico
Energy, Minerals & Natural Resources Department

Form C-102
Revised March 17, 1999

OIL CONSERVATION DIVISION

2040 South Pacheco
Santa Fe, NM 87505

Submit to Appropriate District Office
State Lease - 4 Copies
Fee Lease - 3 Copies

☐ **AMENDED REPORT**

WELL LOCATION AND ACREAGE DEDICATION PLAT

¹ API Number 30-025-35692	² Pool Code 46970	³ Pool Name Monument, Abo
⁴ Property Code 28827	⁵ Property Name Baxter Culp 31	⁶ Well Number 5
⁷ OGRID No. 4323	⁸ Operator Name Chevron U.S.A. Production Company	⁹ Elevation 3560'

¹⁰ Surface Location

UL or Lot No.	Section	Township	Range	Lot Idn	Feet from the	North/South line	Feet from the	East/West line	County
P	31	19S	37E		330	South	330	East	Lea

¹¹ Bottom Hole Location If Different From Surface

UL or Lot No.	Section	Township	Range	Lot Idn	Feet from the	North/South line	Feet from the	East/West line	County
¹² Dedicated Acres 40	¹³ Joint or Infill	¹⁴ Consolidation Code	¹⁵ Order No.						

NO ALLOWABLE WILL BE ASSIGNED TO THIS COMPLETION UNTIL ALL INTERESTS HAVE BEEN CONSOLIDATED OR A NON-STANDARD UNIT HAS BEEN APPROVED BY THE DIVISION

<div>16</div>				<div>1</div> <div>OPERATOR CERTIFICATION</div> <p><i>I hereby certify that the information contained herein is true and complete to the best of my knowledge and belief.</i></p> <div></div> <div>Signature</div> <div>C. J. Haynie</div> <div>Printed Name</div> <div>New Mexico Technical Assistant</div> <div>Title</div> <div>July 23, 2002</div>
				<div>1</div> <div>SURVEYOR CERTIFICATION</div> <p><i>I hereby certify that the well location shown on this plat was plotted from field notes of actual surveys made by me or under my supervision, and that the same is true and correct to the best of my belief.</i></p> <div>Signature and Seal of Professional Surveyor:</div> <div></div> <div>Certificate Number</div>

40-acre proration unit

330'

330'

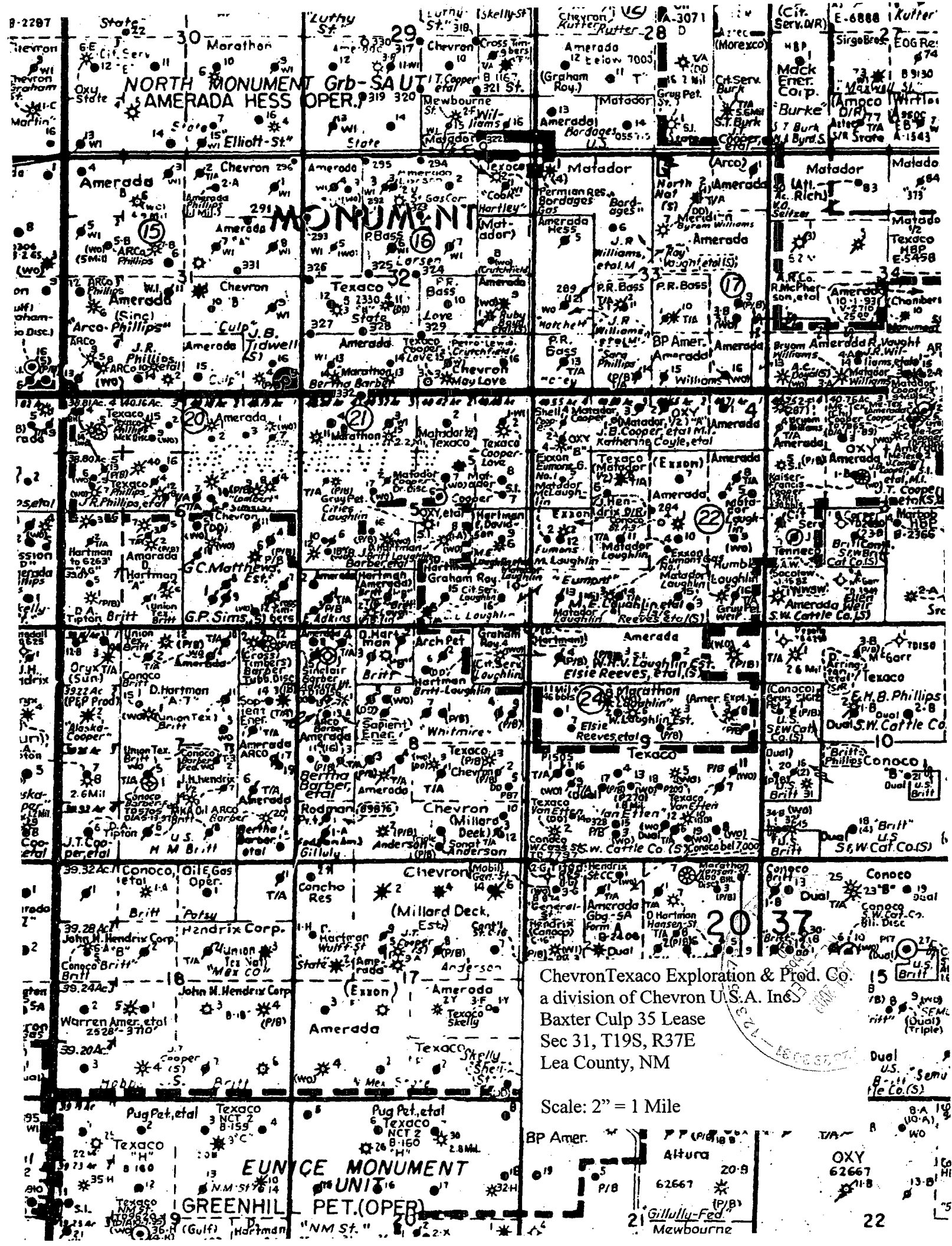

WELL TEST REPORT

Lease: **BAXTER CULP 31**

Field: **MONUMENT**

Reservoir: **Tubb**

Well: **5**

Field Code: **U93**
Unique Code: **PU936400**
Wellbore: **103348**

Resv Code: **BM**
Battery: **LOVE 32**
API No: **300253569200**

Test Date	BOPD	BWPD	MCFPD	Tbg PSI	GOR	% Oil	Comp No.	Status	Remarks	Fluid Level	Fld Lvl Date	BTFPD	% Runtime
6/11/02	14	38	13	200	910	26.9	01	PR	Tubb Pool	6532	6/4/02	52	38.0
6/10/02	14	40	14	200	981	25.9	01	PR	Tubb Pool	6532	6/4/02	54	38.0
6/9/02	13	38	16	200	1207	25.5	01	PR	Tubb Pool	6532	6/4/02	51	38.0
6/9/02	13	38	16	200	1207	25.5	01	PR	Tubb Pool	6532	6/4/02	51	38.0
6/8/02	13	41	16	200	1207	24.1	01	PR	Tubb Pool	6532	6/4/02	54	38.0
6/8/02	13	41	16	200	1207	24.1	01	PR	Tubb Pool	6532	6/4/02	54	38.0
6/7/02	16	39	13	200	796	29.1	01	PR	Tubb Pool	6532	6/4/02	55	38.0
6/7/02	16	39	13	200	796	29.1	01	PR	Tubb Pool	6532	6/4/02	55	38.0
6/6/02	13	37	13	200	980	26.0	01	PR	Tubb Pool	6532	6/4/02	50	38.0
6/5/02	12	30	13	200	1062	28.6	01	PR	Tubb Pool	6532	6/4/02	42	38.0
6/4/02	12	30	16	200	1308	28.6	01	PR	Tubb Pool	6532	6/4/02	42	38.0
6/3/02	23	40	20	200	853	36.5	01	PR	Tubb Pool	6526	2/22/02	63	38.0
5/30/02	26	30	15	200	566	46.4	01	PR	Tubb Pool	6526	2/22/02	56	38.0
5/28/02	16	26	29	200	1838	38.1	01	PR	Tubb Pool	6526	2/22/02	42	38.0
5/27/02	26	28	36	200	1395	48.1	01	PR	Tubb Pool	6526	2/22/02	54	38.0
5/26/02	31	65	37	200	1202	32.3	01	PR	Tubb Pool	6526	2/22/02	96	38.0
5/25/02	3	65	15	200	4903	4.4	01	PR	Tubb Pool	6526	2/22/02	68	38.0
5/24/02	0	0	14	200	#DIV/0!	#DIV/0!	01	PR	Tubb Pool	6526	2/22/02	0	0.0
5/23/02	18	32	31	200	1743	36.0	01	PR	Tubb Pool	6526	2/22/02	50	0.0
5/22/02	30	65	39	200	1307	31.6	01	PR	Tubb Pool	6526	2/22/02	95	70.0
5/21/02	12	45	20	200	1634	21.1	01	PR	Tubb Pool	5735	5/19/02	57	40.0
5/19/02	20	190	39	200	1961	9.5	01	PR	Tubb Pool	5735	5/19/02	210	100.0
4/16/02	0	260	0	200	#DIV/0!	0.0	01	PR	Blinebry Pool	2584	4/9/02	260	100.0
4/15/02	0	260	0	200	#DIV/0!	0.0	01	PR	Blinebry Pool	2584	4/9/02	260	100.0
4/14/02	0	247	0	200	#DIV/0!	0.0	01	PR	Blinebry Pool	2584	4/9/02	247	100.0
4/13/02	0	240	0	200	#DIV/0!	0.0	01	PR	Blinebry Pool	2584	4/9/02	240	100.0
4/12/02	0	244	0	200	#DIV/0!	0.0	01	PR	Blinebry Pool	2584	4/9/02	244	100.0
4/11/02	0	230	0	200	#DIV/0!	0.0	01	PR	Blinebry Pool	2584	4/9/02	230	100.0
4/10/02	0	260	0	200	#DIV/0!	0.0	01	PR	Blinebry Pool	2584	4/9/02	260	100.0
4/9/02	0	250	0	200	#DIV/0!	0.0	01	PR	Blinebry Pool	2584	4/9/02	250	100.0
4/8/02	0	258	0	200	#DIV/0!	0.0	01	PR	Blinebry Pool	2584	4/4/02	258	100.0
4/7/02	0	230	0	200	#DIV/0!	0.0	01	PR	Blinebry Pool	2584	4/4/02	230	100.0
4/6/02	0	235	0	200	#DIV/0!	0.0	01	PR	Blinebry Pool	2584	4/4/02	235	100.0
4/5/02	0	248	0	200	#DIV/0!	0.0	01	PR	Blinebry Pool	2584	4/4/02	248	100.0
4/4/02	0	235	0	200	#DIV/0!	0.0	01	PR	Blinebry Pool	2584	4/4/02	235	100.0
4/3/02	0	165	0	200	#DIV/0!	0.0	01	PR	Blinebry Pool	2584	4/3/02	165	100.0

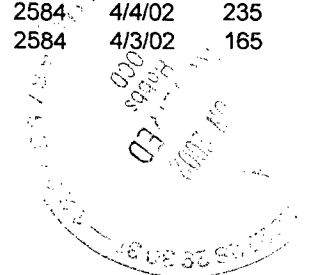

5

Version 3.0

[illegible]

Daily Completion / WO Report Version 3.0

Start Date:	2/5/2002	Actual Days:	9	Auth. Days:	8	TD:	7,420'	PBTD:	7,324'
Job Description:	COMP					KB Correction:	15'	Job Code:	COMP
Fluid Type:	KCL					Weight:			
Prod. Casing Size:	51/2	WT:	15.5	Grade:	K-55	Set @ MD:	7415'	Cmt. Top @	SURF.
Liner OD:		WT:		Grade:		Set@ MD:		Top @MD:	0'
Tubing OD	Wt.	Grade	Threads	Depth	Details				
27/8			8RD	7400'					
Packer @					Packer Make & Model	Perforations:	Details		
					RBP	6802-07', 6814-17', 6832-36',	NEW PERFS.		
					5-1/2 HD TRT. PKR	6843-56', 6878-83', 6932-42'			
						7280-84', 7288-92' 7328-30', 7342-45', 7360-63', 7376-79'.			
Fish Top:					Details:				
Hrs. From:	To:	Operations Covering 24 Hours - Ending at Midnight (24:00 hrs)							
06:30	07:30	CREW TRAVEL, & SAFETY MEETING							
07:30	08:30	SWB. SFL @1500' SWB & FLOW 41 BBLS. 2 RUNS 30% OIL							
08:30	09:30	SFL@ 3000' 14 BBLS 3 RUNS 10% OIL							
09:30	10:00	CLOSE IN FOR TRUCK TO LOAD							
10:00	11:00	SWB SFL @ 2000' EFL @ 3500' 20 BBLS. 4 RUNS 10% OIL							
11:00	12:00	SFL@ 3500' EFL @ 3500' 14 BBLS 4 RUNS 10% OIL							
12:00	13:00	SFL @ 3200' SCATTERED TO 4700' 16 BBLS 4 RUNS 12% OIL							
13:00	14:00	SFL @ 3500' EFL @5000' 10 BBLS 3 RUNS 15% OIL							
14:00	15:00	SFL @ 4500' EFL @ 5200' 15 BBLS 4 RUNS 15% OIL 5% BS							
15:00	16:00	SFL@ 4500' EFL @ 5200' 15 BBLS 4 RUNS 15% OIL 3% BS							
		CION							
		15 BPH * 24 = 360 BTFPD							
		360 * .15 = 54 BOPD							
		360 * .85 = 306 BWPD							
		AVG. GOR FOR MONUMENT ABO POOL = 11,253 .							
		(54 BOPD * 11,253 / 1000) = 608 MCFPD .							
SAFETY MEETINGS HELD: 1 OSHA MAN HRS: RIG: 40 OTHERS: 30 TOTAL: 70									
CUMULATIVE SAFETY HOURS: Mtg 10 RIG: 404 290 TOTAL: 694									
Fluid Lost To Formation		Daily:	Cumulative:						
Hours Charged To:		Contractor:	Chevron:	Other:		Total: 0			
Remarks:									
G&A: H2S: Accidents: NAR Chevron %:									
Daily Intangible Cost: \$2,850		Daily Tang. Cost: \$0		Daily Comp Cost: \$2,850		WBS Element No. (Capital) UWPWB-D1026-COM			
Cum Intangible Cost: \$57,408		Cum Tang Cost: \$22,500		Cum Comp Cost: \$79,908		WBS Element No. (Exp) UWPWB-D1026-COM			
Previous Comp Cst\$		Final Drilling Cost		Cum Well Cost:		Total Appr: \$			
Profit Cntr WEST		Rig: POOL-652		Rep Phone: 505-390-7143		WO Rep: B.E. CONE		API Well No: 30-025-35692	
Field: MONUMENT ABO		Lease: BAXTER CULP 31		Well #: 5		Date: 18-Feb-02			

Abo Production within 2 mile radius of Baxter Culp 31 #5

API	Lease Name	Well #	Operator Name	Location	Field Name	Prod Zone	Oil Cum	Gas Cum
30025041340000	J R PHILLIPS	5	AMERADA HESS CORPORATION	1 20S 36E	MONUMENT	ABO /SH/	8226	91577
30025041360001	J R PHILLIPS	7	AMERADA HESS CORPORATION	1 20S 36E	MONUMENT	ABO /SH/	60760	129590
30025041440000	STATE D DE	6	AMERADA DIV AMERADA HESS CORP.	1 20S 36E	MONUMENT	ABO /SH/	31760	
30025041500002	EUNICE MONUMENT EUMONT	1	RICE ENGINEERING & ASSOCIATES INC	1 20S 36E	MONUMENT	ABO /SH/	2925	
30025059280000	L M LAMBERT	4	AMERADA HESS CORPORATION	6 20S 37E C SE NE	MONUMENT	ABO /SH/	1216	4893
30025059460000	G C MATTHEWS	5	CHEVRON U S A INCORPORATED	6 20S 37E	MONUMENT	ABO /SH/	22337	206022
30025059580000	J R PHILLIPS	5	TEXACO EXPLORATION & PROD INC	6 20S 37E	MONUMENT	ABO /SH/	22868	1195776
30025124730000	STATE F	5	AMERADA HESS CORPORATION	36 19S 36E	MONUMENT	ABO /SH/	73099	170193
30025124780000	GRAHAM STATE NCT F	5	GULF OIL CORPORATION	36 19S 36E	MONUMENT	ABO /SH/	18551	
30025124820000	GRAHAM STATE NCT F	7	CHEVRON U S A INCORPORATED	36 19S 36E	MONUMENT	ABO /SH/	39201	152592
30025351190000	J R PHILLIPS	15	TEXACO EXPLORATION & PROD INC	6 20S 37E W2 NE NW	MONUMENT	ABO /SH/	12654	54782
30025355010000	J R PHILLIPS	16	TEXACO EXPLORATION & PROD INC	6 20S 37E NE SE NW	MONUMENT	ABO /SH/	2296	15104
30025059590000	J R PHILLIPS	6	TEXACO EXPLORATION & PROD INC	6 20S 37E	MONUMENT	ABO /SH/	84382	2301527
30025127220001	NEW MEXICO E STATE NCT 1	5	TEXACO EXPLORATION & PROD INC	1 20S 36E	MONUMENT	ABO /SH/	6848	1181744
30025302480000	SKELLY D STATE	4	MISSION RESOURCES INC	1 20S 36E NE SE	MONUMENT	ABO /SH/	15925	829809
						TOTAL CUM	403048	4535558

AVG. GOR = (4535558) x 1000

= 11,253

403048

Drinkard Production within 2 mile radius of Baxter Culp 31 #5									
API	Lease Name	Well #	Operator Name	Location	Field Name	POOL Name	Oil Cum	Gas Cum	
30025351510000	COOPER 5	6	MATADOR OPERATING CO	5 20S 37E SW SW NE	WILDCAT	DRINKARD NORTHEAST	6981	14664	
						TOTAL CUM	6981	14664	
AVG. GOR = (14664) x 1000				= 2,101					
6981									

District I
1625 N. French Drive, Hobbs, NM 88240
District II
1301 W. Grand Avenue, Artesia, NM 88210
District III
1000 Rio Brazos Road, Aztec, NM 87410
District IV
1220 S. St. Francis Dr., Santa Fe, NM 87505

State of New Mexico
Energy, Minerals and Natural Resources Department

Form C-107A
Revised May 15, 2000

Oil Conservation Division
1220 South St. Francis Dr.
Santa Fe, New Mexico 87505

APPLICATION TYPE
Single Well
Establish Pre-Approved Pools
EXISTING WELLBORE
Yes No

APPLICATION FOR DOWNHOLE COMMINGLING

Chevron U.S.A. Production Company 15 Smith Road Midland, TX 79705

Operator Address

Baxter Culp 31 5 P-31-19S-37E LEA
Lease Well No. Unit Letter-Section-Township-Range County

OGRID No. 004323 Property Code 28827 API No. 30-025-35692 Lease Type: Federal State X Fee

DATA ELEMENT	UPPER ZONE	INTERMEDIATE ZONE	LOWER ZONE
Pool Name	MONUMENT; TUBB	MONUMENT; DRINKARD	MONUMENT; ABO
Pool Code	47090	97060	46970
Top and Bottom of Pay Section (Perforated or Open-Hole Interval)	6334' – 6584'	6802' – 6932'	7280' – 7379'
Method of Production (Flowing or Artificial Lift)	Artificial Lift	Artificial Lift	Artificial Lift
Bottomhole Pressure (Note: Pressure data will not be required if the bottom perforation in the lower zone is within 150% of the depth of the top perforation in the upper zone)	(Calculated) 2056 PSI	(Calculated) 1921 PSI	(Calculated) 2537 PSI
Oil Gravity or Gas BTU (Degree API or Gas BTU)	34.8 degs. API	42.4 degs. API	39.1 degs. API
Producing, Shut-In or New Zone	Producing	New	New
Date and Oil/Gas/Water Rates of Last Production. (Note: For new zones with no production history, applicant shall be required to attach production estimates and supporting data.)	Date: 6-11-02 Rates: 14 BOPD / 13 MCFPD / 38 BWPD	Date: 2-20-02 Rates: 7.2 BOPD / 15 MCFPD / 28.8 BWPD	Date: 2-18-02 Rates: 54 BOPD / 608 MCFPD/ 306 BWPD
Fixed Allocation Percentage (Note: If allocation is based upon something other than current or past production, supporting data or explanation will be required.)	Oil 14 Gas 13 18.62% 2.04%	Oil 7.2 Gas 15 9.57 % 2.36 %	Oil 54 Gas 608 71.81% 95.60 %

ADDITIONAL DATA

Are all working, royalty and overriding royalty interests identical in all commingled zones? Yes X No
If not, have all working, royalty and overriding royalty interest owners been notified by certified mail? Yes NA No

Are all produced fluids from all commingled zones compatible with each other? Yes X No

Will commingling decrease the value of production? Yes No X

If this well is on, or communitized with, state or federal lands, has either the Commissioner of Public Lands or the United States Bureau of Land Management been notified in writing of this application? Yes No NA

NMOCD Reference Case No. applicable to this well:

Attachments:
C-102 for each zone to be commingled showing its spacing unit and acreage dedication.
Production curve for each zone for at least one year. (If not available, attach explanation.)
For zones with no production history, estimated production rates and supporting data.
Data to support allocation method or formula.
Notification list of working, royalty and overriding royalty interests for uncommon interest cases.
Any additional statements, data or documents required to support commingling.

PRE-APPROVED POOLS

If application is to establish Pre-Approved Pools, the following additional information will be required:

List of other orders approving downhole commingling within the proposed Pre-Approved Pools
List of all operators within the proposed Pre-Approved Pools
Proof that all operators within the proposed Pre-Approved Pools were provided notice of this application.
Bottomhole pressure data.

I hereby certify that the information above is true and complete to the best of my knowledge and belief.

SIGNATURE Carolyn J. Haynie TITLE PE TECHNICAL ASSISTANT DATE 7-24-02

TYPE OR PRINT NAME CAROLYN J. HAYNIE TELEPHONE NO. (915) 687-7384



NEW MEXICO ENERGY, MINERALS and NATURAL RESOURCES DEPARTMENT

GARY E. JOHNSON

Governor
Betty Rivera
Cabinet Secretary

8/8/02

Lori Wrotenbery
Director
Oil Conservation Division

Oil Conservation Division
1220 S. Francis Drive
Santa Fe, NM 87505

RE: Proposed:

MC _____
DHC X _____
NSL _____
NSP _____
SWD _____
WFX _____
PMX _____

Gentlemen:

I have examined the application for the:

Chevron Mexaco Baxter Culp 31 #5-P-31-19s-37e
Operator Lease & Well No. Unit S-T-R API # 30-025-35692

and my recommendations are as follows:

OK

Yours very truly,

Chris Williams
Chris Williams
Supervisor, District 1