

DATE IN 10/17/06	SUSPENSE	ENGINEER D. BROOKS	LOGGED IN 10/17/06	TYPE NSL	APP NO. PTD50629055215
------------------	----------	--------------------	--------------------	----------	------------------------

ABOVE THIS LINE FOR DIVISION USE ONLY

**NEW MEXICO OIL CONSERVATION DIVISION**  
 - Engineering Bureau -  
 1220 South St. Francis Drive, Santa Fe, NM 87505



*Burnet Oil  
 Disposal A #29  
 5518*

**ADMINISTRATIVE APPLICATION COVERSHEET**

THIS COVERSHEET IS MANDATORY FOR ALL ADMINISTRATIVE APPLICATIONS FOR EXCEPTIONS TO DIVISION RULES AND REGULATIONS WHICH REQUIRE PROCESSING AT THE DIVISION LEVEL IN SANTA FE

*2006 OCT 17 AM*

**Application Acronyms:**

[NSL-Non-Standard Location] [NSP-Non-Standard Proration Unit] [SD-Simultaneous Dedication]  
 [DHC-Downhole Commingling] [CTB-Lease Commingling] [PLC-Pool/Lease Commingling] ●  
 [PC-Pool Commingling] [OLS - Off-Lease Storage] [OLM-Off-Lease Measurement]  
 [WFX-Waterflood Expansion] [PMX-Pressure Maintenance Expansion]  
 [SWD-Salt Water Disposal] [IPI-Injection Pressure Increase]  
 [EOR-Qualified Enhanced Oil Recovery Certification] [PPR-Positive Production Response]

**[1] TYPE OF APPLICATION - Check Those Which Apply for [A]**

[A] Location - Spacing Unit - Simultaneous Dedication  
☒ NSL ☐ NSP ☐ SD

Check One Only for [B] or [C]

[B] Commingling - Storage - Measurement  
☐ DHC ☐ CTB ☐ PLC ☐ PC ☐ OLS ☐ OLM

[C] Injection - Disposal - Pressure Increase - Enhanced Oil Recovery  
☐ WFX ☐ PMX ☐ SWD ☐ IPI ☐ EOR ☐ PPR

**[2] NOTIFICATION REQUIRED TO: - Check Those Which Apply, or ☐ Does Not Apply**

- [A] ☐ Working, Royalty or Overriding Royalty Interest Owners
- [B] ☐ Offset Operators, Leaseholders or Surface Owner
- [C] ☐ Application is One Which Requires Published Legal Notice
- [D] ☐ Notification and/or Concurrent Approval by BLM or SLO  
U.S. Bureau of Land Management - Commissioner of Public Lands, State Land Office
- [E] ☐ For all of the above, Proof of Notification or Publication is Attached, and/or,
- [F] ☐ Waivers are Attached

**[3] INFORMATION / DATA SUBMITTED IS COMPLETE - Certification**

I hereby certify that I, or personnel under my supervision, have reviewed the applicable Rules and Regulations of the Oil Conservation Division. Further, I assert that the attached application for administrative approval is accurate and complete to the best of my knowledge and where applicable, verify that all interest (WI, RI, ORRI) is common.

*I understand that any omission of data (including API numbers, pool codes, etc.), pertinent information and any required notification is cause to have the application package returned with no action taken.*

**Note: Statement must be completed by an individual with managerial and/or supervisory capacity.**

Mark A. Jacoby  
 Print or Type Name

Mark A. Jacoby  
 Signature

PETROLEUM ENGINEER  
 Title

10/16/06  
 Date

e-mail Address

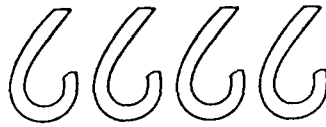

October 16, 2006

New Mexico Oil Conservation Division  
1220 South Saint Francis Drive  
Santa Fe, New Mexico 87504

Attn: Engineering Department

Re: Gissler A #29      30-015-3111  
Unit P, 1070' FSL, 860' FEL  
SEC.11, T17S, R30E- Eddy County, New Mexico

Gentlemen:

Burnett Oil Co., Inc. respectfully requests an exception without notice and hearing to NMOCD Rule 104 for the Gissler A #29 (Loco Hills Paddock) well. The original spot of this EOG dry hole is a non-standard location for our Federal lease LC- 029338A. The use of this old well bore allows us to conserve the amount of land that must be disturbed. The flow line will follow an existing road to our existing Gissler A tank battery on the lease. The attached plat shows we are the Operator of Record for all the wells on all sides of this well site. **All of the interest ownership for this entire lease is exactly the same.** A copy of our approved 3160-3 is enclosed for your records.

Please contact the undersigned if you should need any more information or have any question.

Yours truly,

James H. Arline  
Materials Coordinator

**OPERATOR'S COPY**

PRINT IN TRIPLICATE\*  
(Other instructions on  
reverse side)

Form approved.  
Budget Bureau No. 1004-0136  
Expires August 31, 1985

UNITED STATES  
DEPARTMENT OF THE INTERIOR  
BUREAU OF LAND MANAGEMENT

APPLICATION FOR PERMIT TO DRILL, DEEPEN, OR PLUG BACK

1a. TYPE OF WORK

DRILL ☒

DEEPEN ☐

PLUG BACK ☐

b. TYPE OF WELL

OIL  
WELL ☒

GAS  
WELL ☐

OTHER

Re Entry

SINGLE  
ZONE ☒

MULTIPLE  
ZONE ☐

2. NAME OF OPERATOR

BURNETT OIL CO., INC (817/332-5108)

3. ADDRESS OF OPERATOR

801 CHERRY STREET, SUITE 1500, FORT WORTH, TEXAS 76102

4. LOCATION OF WELL (Report location clearly and in accordance with any State requirements.)\*

At surface

UNIT P, 1070' FSL, 860' FEL

At proposed location SAME AS SURFACE

Non-Standard Location

14. DISTANCE IN MILES AND DIRECTION FROM NEAREST TOWN OR POST OFFICE\*

APPROXIMATELY 6 MILES EAST OF LOCO HILLS, NEW MEXICO

15. DISTANCE FROM PROPOSED\*

LOCATION TO NEAREST  
PROPERTY OR LEASE LINE, FT.  
(Also to nearest drilg. unit line, if any)

330'

16. NO. OF ACRES IN LEASE

120

17. NO. OF ACRES ASSIGNED  
TO THIS WELL

40

18. DISTANCE FROM PROPOSED LOCATION\*

TO NEAREST WELL, DRILLING, COMPLETED,  
OR APPLIED FOR, ON THIS LEASE, FT.

330'

19. PROPOSED DEPTH

5400'

20. ROTARY OR CABLE TOOLS

ROTARY

21. ELEVATIONS (Show whether DF, RT, GR, etc.)

3737' GR

3743' GR

22. APPROX. DATE WORK WILL START\*

SEPTEMBER 16, 2006

23.

PROPOSED CASING AND CEMENTING PROGRAM

Roswell Controlled Water Basin

SIZE OF HOLE	SIZE OF CASING	WEIGHT PER FOOT	SETTING DEPTH	QUANTITY OF CEMENT
14 3/4"	11 3/4"	42# IN PLACE	635'	430 Sks CL "C"
11"	8 5/8"	32# IN PLACE	3992'	1300 Sks CL "C"
7 7/8"	5 1/2"	15.5#	5400'	SEE SPEC pg 2 of 7

A 14 3/4" hole was drilled to 635' and 11 jts of 11 3/4" 42# H40 ST&C casing set and cemented to surface. An 11" hole was drilled to 3992' & 90 jts 8 5/8" 32# J55 ST&C was set and cemented to surface. A 7 7/8" hole was drilled to TD. This well bore was plugged and abandoned in July 2000. A copy of the EOG plugging filing is included in our request to re-enter this well bore. Per the attached letter from EOG Resources Inc. we propose to change the name to the Gissler A #29 and re-enter the Gissler A #29 well bore by drilling out cement plugs (#3,4 &5) and drill to 5800'. We will set a 300' cement plug and wait on cement. We will tag top of cement plug then set approx. 5400' new 5 1/2" J55 casing and cement to surface. We will perforate and complete as a Loco Hills Paddock well as recommended by our service company. The producing well will produce to our existing Burnet Gissler A Battery in Section 11, T17S, R30E.

APPROVAL SUBJECT TO  
GENERAL REQUIREMENTS AND  
SPECIAL STIPULATIONS  
ATTACHED

IN ABOVE SPACE DESCRIBE PROPOSED PROGRAM: If proposal is to deepen or plug back, give data on present productive zone and proposed new productive zone. If proposal is to drill or deepen directionally, give pertinent data on subsurface locations and measured and true vertical depths. Give blowout preventer program, if any.

24.

SIGNED

PETROLEUM ENGINEER

TITLE

DATE

8/16/2006

(This space for Federal or State office use)

PERMIT NO.

APPROVAL DATE

APPROVED BY

Acting

FIELD MANAGER

DATE

9/18/2006

CONDITIONS OF APPROVAL, IF ANY:

APPROVAL FOR 1 YEAR

\*See Instructions On Reverse Side

16

17 OPERATOR CERTIFICATION

I hereby certify that the information contained herein is true and complete to the best of my knowledge and belief.

Mike Francis  
Signature

Mike Francis  
Printed Name

Agent  
Title

3/22/00  
Date

18 SURVEYOR CERTIFICATION

I hereby certify that the well location shown on this plat was plotted from field notes of actual surveys made by me or under my supervision, and that the same is true and correct to best of my belief.

MARCH 2000  
Date of Survey

Signature and Seal of Registered Professional Surveyor

James E. Tompkins  
James E. Tompkins  
14729

Certificate Number 14729

## DRILLING PROGRAM

EOG RESOURCES, INC.  
OAK LAKE 11 FEDERAL COM NO. 1  
1,070' FSL & 860' FEL  
SEC. 11, T17S, R30E  
EDDY COUNTY, NM

### 1. GEOLOGIC NAME OF SURFACE FORMATION:

Permian

### 2. ESTIMATED TOPS OF IMPORTANT GEOLOGICAL MARKERS:

Queen	2500'
San Andres	3300'
Abo	6,500'
Wolfcamp	8000'
Lower Strawn	9875'
Atoka	10175'
Morrow Clastics	10600'
Chester	11000'

### 3. ESTIMATED DEPTHS OF ANTICIPATED FRESH WATER, OIL OR GAS:

Upper Permian Sands	Above 250'	Fresh Water
Grayburg/San Andres	3000'	Oil
Strawn	10200'	Oil
Atoka	10525'	Gas
Morrow	10925'	Gas

### 4. CASING PROGRAM

<u>Hole Size</u>	<u>Interval</u>	<u>OD Casing</u>	<u>Weight Grade Jt. Cond. Type</u>
<b>WITNESS</b> 11"	0-650'	11 3/4"	42# H-40 ST&C
11"	0-3500'	8 5/8"	32# J-55 LT&C
7 7/8"	0-11000'	5 1/2"	17# S95/P110 L&TC

**WITNESS** Cementing Program:

11 3/4" Surface Casing:	Cement to surface with 200 sx Prem Plus, 3% Econolite, 25 Calcium Chloride, 0.25#/sx Flocele, 150 sx Prem Plus, 2% Calcium Chloride
8 5/8" Intermediate:	Cement to surface with 800 sx Interfill C, .25#/sx flocele, 250 sx Premium Plus, 2% Calcium Chloride
5 1/2" Production:	Cement w/930 sx Premium, 3% Econolite, 5#/sx Salt (3%), 0.2% HR5, .25#/sk Flocele, 250 sx Prem 50/50 Poz mix 'A', 2% Halliburton-Gel First 2%, 0.5% Halad-322. This is designed to bring TOC to 4500'.



# LOCATION VERIFICATION MAP

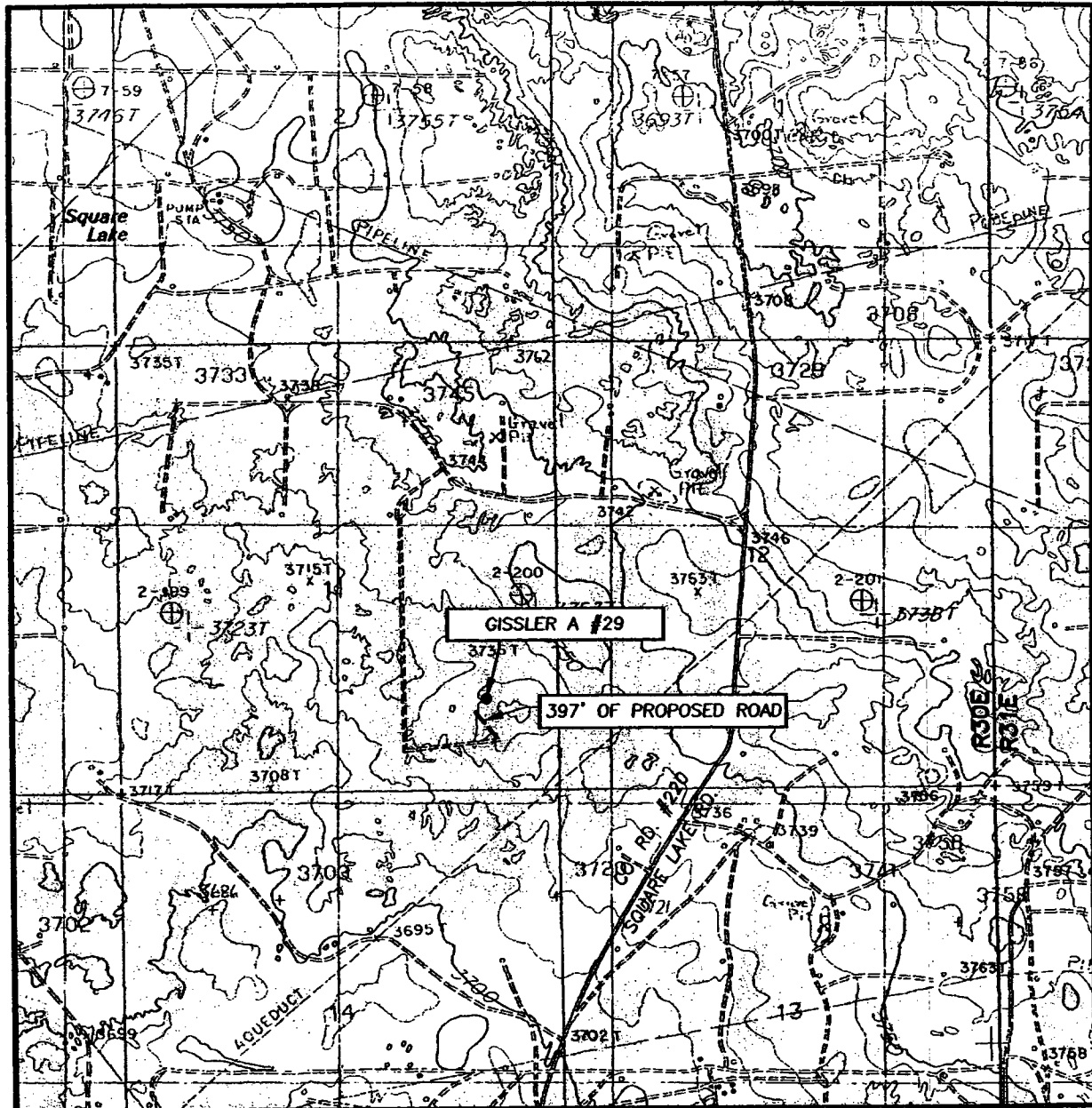

SCALE: 1" = 2000'

CONTOUR INTERVAL:  
LOCO HILLS, N.M. - 10'

SEC. 11 TWP. 17-S RGE. 30-E

SURVEY N.M.P.M.

COUNTY EDDY STATE NEW MEXICO

DESCRIPTION 1069' FSL & 860' FEL

ELEVATION 3743'

OPERATOR BURNETT OIL COMPANY

LEASE GISSLER A

U.S.G.S. TOPOGRAPHIC MAP  
LOCO HILLS, N.M.



PROVIDING SURVEYING SERVICES  
SINCE 1946  
**JOHN WEST SURVEYING COMPANY**  
412 N. DAL PASO  
HOBBS, N.M. 88240  
(505) 393-3117

GISSLER A #29  
EXHIBIT "B"

# VICINITY MAP

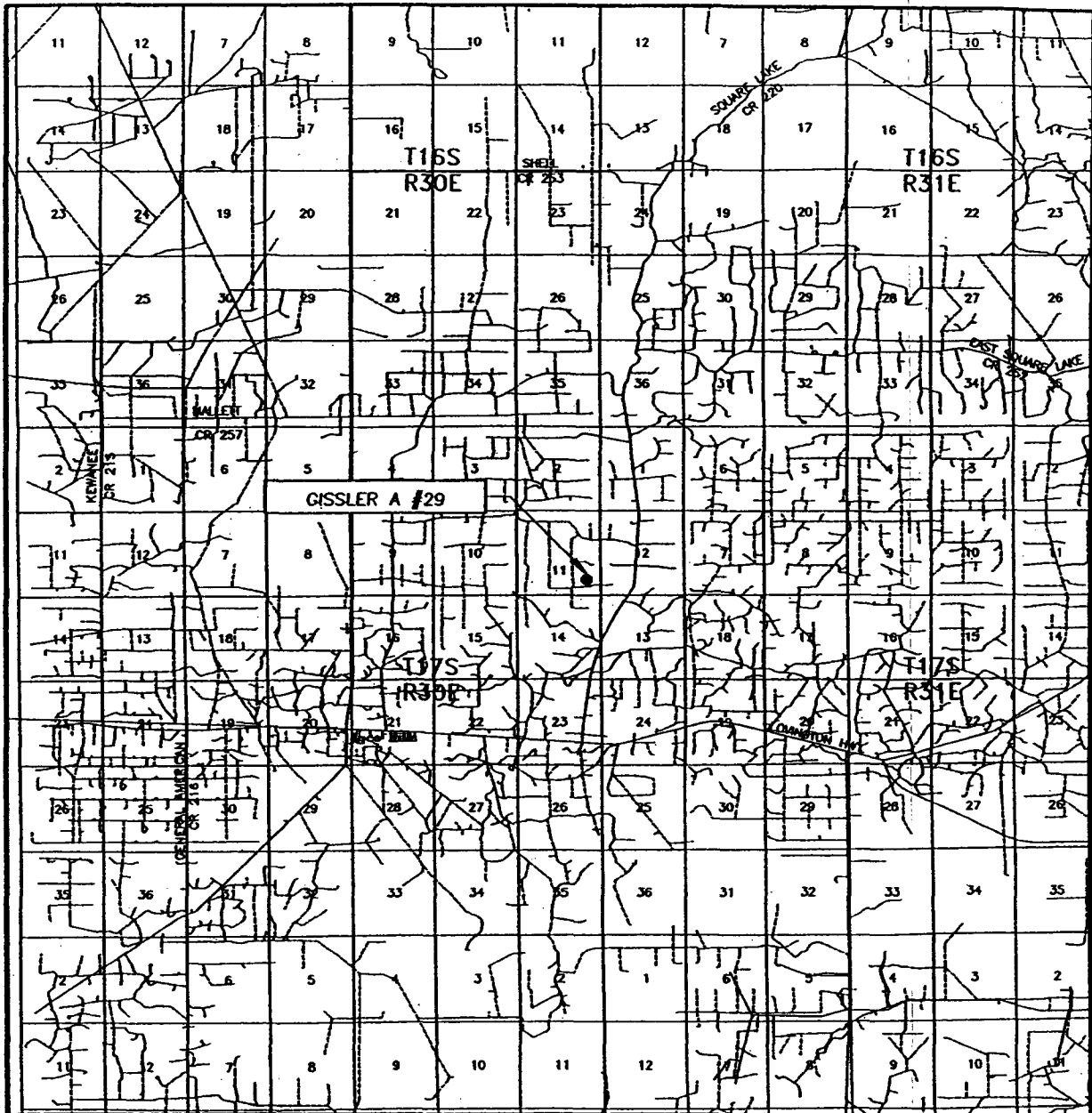

SCALE: 1" = 2 MILES

SEC. 11 TWP. 17-S RGE. 30-E

SURVEY N.M.P.M.

COUNTY EDDY STATE NEW MEXICO

DESCRIPTION 1669' FSL & 860' FEL

ELEVATION 3743'

OPERATOR BURNETT OIL COMPANY

LEASE GISSLER A

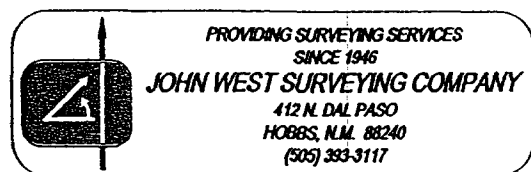

GISSLER A #29  
EXHIBIT "C"



UNITED STATES  
DEPARTMENT OF THE INTERIOR  
BUREAU OF LAND MANAGEMENT

FORM APPROVED  
OMB No. 1004-0136  
Expires November 30, 2000

APPLICATION FOR PERMIT TO DRILL OR REENTER

1a. Type of Work: <input checked="" type="checkbox"/> DRILL <input type="checkbox"/> REENTER		5. Lease Serial No. LC029338-A (drillsite)	
1b. Type of Well: <input type="checkbox"/> Oil Well <input checked="" type="checkbox"/> Gas Well <input type="checkbox"/> Other <input type="checkbox"/> Single Zone <input type="checkbox"/> Multiple Zone		6. If Indian, Allottee or Tribe Name	
2. Name of Operator EOG Resources, Inc. 7377		7. If Unit or CA Agreement, Name and No.	
3a. Address P.O. Box 2267, Midland, TX 79702		8. Lease Name and Well No. 25731 Oak Lake "11" Federal Com No. 1	
3b. Phone No. (include area code) (915)686-3714		9. API Well No. 30-003-3111	
4. Location of Well (Report location clearly and in accordance with any State requirements.) At surface 1,070' FSL & 860' FEL (Unit Letter P) At proposed prod. Zone Same as surface		10. Field and Pool, or Exploratory N. Cedar Lake Monnew	
14. Distance in miles and direction from nearest town or post office* Two miles northeast from Loco Hills		11. Sec., T., R., M., or Blk. And Survey or Area Sec. 11, T17S, R30E	
15. Distance from proposed* location to nearest property or lease line, ft. 860' (Also to nearest drlg. Unit line, if any) 860'		12. County or Parish Eddy	
16. No. of Acres in lease LC-029338-A - 40 ac NM2746 - 40 ac NM74939 - 240 ac		13. State NM	
17. Spacing Unit dedicated to this well S/2 320 ac			
18. Distance from proposed location* to nearest well, drilling, completed applied for, on this lease, ft.		20. BLM/BIA Bond No. on file MT-0748	
19. Proposed Depth 11,200'			
21. Elevations (Show whether DF, KDB, RT, GL, etc) GL-3737		22. Approximate date work will start* 5/2/2000	
		23. Estimated duration 30 days	

24. Attachments

The following completed in accordance with the requirements of Onshore Oil and Gas Order No. 1, shall be attached to this form:

- |  |  |
|--|--|
| 1. Well plat certified by a registered surveyor.   | 4. Bond to cover the operations unless covered by an existing bond on file (see Item 20 above)     |
| 2. A Drilling Plan.  | 5. Operator certification.   |
| 3. A Surface Use Plan (if the location is on National Forest System Lands, the SUPO shall be filed with the appropriate Forest Service Office) | 6. Such other site specific information and/or plans as may be required by the authorized officer. |

25. Signature <i>Mike Francis</i>	Name (Printed/Typed) Mike Francis	Date 3/22/2000
Title Agent		
Approved by (Signature) <i>[Signature]</i>	Name (Printed/Typed) <i>[Signature]</i>	Date APR 24 2000
Title Assistant Field Manager, Lands And Minerals		
Office FEDERAL FIELD OFFICE		

Application approval does not warrant or certify the applicant holds legal or equitable title to those rights in the subject lease which would entitle the applicant to conduct operations thereon.

Conditions of approval, if any, are attached

Title 18 U.S.C. Section 1001 and Title 43 U.S.C. Section 1212, make it a crime for any person knowingly and willfully to make to any department or agency of the United States any false, fictitious or fraudulent statements or representations as to any matter within its jurisdiction.

\*(Instructions on reverse)

APPROVAL SUBJECT TO  
GENERAL REQUIREMENTS AND  
SPECIAL STIPULATIONS



# NEW MEXICO ENERGY, MINERALS and NATURAL RESOURCES DEPARTMENT

**BILL RICHARDSON**

Governor

**Joanna Prukop**

Cabinet Secretary

**Mark E. Fesmire, P.E.**

Director

**Oil Conservation Division**

November 6, 2006

Mr. Mark A. Jacoby  
Petroleum Engineer  
Burnett Oil Co., Inc.  
Burnett Plaza - Suite 1500  
801 Cherry Street - Unit #9  
Fort Worth, TX 76102-6881

**Re: Administrative Application No. pDRC06-29055215  
Gissler A Well No. 29  
P-11-17S-30E  
Eddy County**

Dear Mr. Jacoby:

The referenced application does not contain sufficient information for us to determine if all necessary notices have been given.

The application letter from Mr. James H. Arline of your office states, "All of the interest ownership for this entire lease is exactly the same." However, the application does not disclose the boundaries of the lease.

Please specifically confirm, if such is the case, that the lease, the ownership of which is common, includes all of the NE/4 SE/4 of Section 11, Township 17S, Range 30E, as well as all of the SE/4 SE/4 of that section.

Should you have questions, please feel free to call the undersigned at (505)-476-3450.

Very truly yours,

David K. Brooks,  
david.brooks@state.nm.us  
Assistant General Counsel

CCCC

2006 NOV 17 PM 12 45

November 14, 2006

New Mexico Oil Conservation Division  
1220 South Saint Francis Drive  
Santa Fe, New Mexico 87505

Attn: Mr. David K. Brooks

Re: Gissler A #29 NSL  
Unit P, 1070' FSL, 860' FEL  
SEC.11, T17S, R30E- Eddy County, New Mexico

Dear Mr. Brooks:

With reference to your letter dated November 6, 2006 about the reference well, Burnett Oil Co., Inc. does operate the NE/4 SE/4 (NM- 2748) and the SE/4 SE/4 of Sec.11, T17S, R30E and the same ownership is common to all. We are the operator of record for all wells on all sides of this location.

Please contact the undersigned if you should need any more information or have any question.

Yours truly,

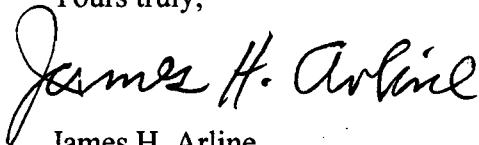

James H. Arline  
Materials Coordinator