

LEWIS B. BURLESON, INC.
OIL & GAS PROPERTIES

LEWIS B. BURLESON
PRESIDENT

STEVEN L. BURLESON
VICE-PRESIDENT

WAYNE JARVIS
SUPERINTENDENT

August 24, 1998

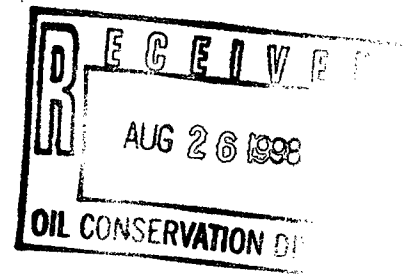

Mr. William LeMay, Director
State of New Mexico
Oil Conservation Division
2040 South Pacheco
Santa Fe, New Mexico 87505

Administrative Application for Non-Standard Proration Unit for Lewis B. Burleson, Inc.'s Marshall #2 well, located 1980' FSL & 660' FEL of Section 11, T-21-S, R-36-E, Lea County, New Mexico

Dear Mr. Lemay:

Enclosed you will find documentation showing notification of offset operators on the above referenced application.

Yours truly,

A handwritten signature in dark ink, appearing to be "L B Burleson", written over the typed name "Lewis B. Burleson".

Lewis B. Burleson

LBB/skb
Enclosures

F:\wp51\doc\marshall2notifications.doc

P. O. BOX 2479, MIDLAND, TEXAS 79702-AC 915/683-4747

P. O. BOX 2479, MIDLAND, TEXAS 79702-AC 915/683-4747

LEWIS B. BURLESON, INC.
OIL & GAS PROPERTIES

WELL
FILE

LEWIS B. BURLESON
PRESIDENT
STEVEN L. BURLESON
VICE-PRESIDENT
WAYNE JARVIS
SUPERINTENDENT

August 4, 1998

Mr. William LeMay, Director
State of New Mexico
Oil Conservation Division
P.O. Box 2088
Santa Fe, New Mexico 87501

Administrative Application for Non-Standard Proration Unit for Lewis B. Burleson, Inc.'s Marshall #2 well, located 1980' FSL & 660' FEL of Section 11, T-21-S, R-36-E, Lea County, New Mexico

Dear Mr. Lemay:

Lewis B. Burleson, Inc. requests administrative approval of a non-standard 160 acre proration unit for its Marshall #2 well which is proposed to be a re-entry to the Eumont Gas Pool. We have notified by Certified Letter, all offset operators as shown in Exhibit "B" so that they may object to this variance within the specified waiting period.

Non-Standard Unit:

A 160 acre Non-Standard Gas Proration Unit (E/2 of SE/4, Section 11, T-21-S, R-36-E and the W/2 of SW/4 of Section 12, T-21-S, R-36-E) was previously approved for the Marshall #1, as shown by the red circle on the enclosed map. This 160 acre unit in two sections was approved by your order R-5828. The Marshall No. 1 well will be plugged before this re-entry is completed.

Yours truly,



Lewis B. Burleson

LBB/skb
Enclosures

F:\wp51\doc\Marshall2.doc

MARSHALL #2
Offset Operators Mailing List

Conoco Inc.
Conservation/Proration Dept.
10 Desta Dr. #100W
Midland, Texas 79705-4500

John H. Hendrix Corp.
223 W. Wall, #525
Midland, Texas 79701

Texaco Exploration
Conservation/Proration Dept.
P.O. Box 3109
Midland, Texas 79702

David Arrington
P.O. Box 2071
Midland, Texas 79702

Chevron USA Production
Box 1150
Midland, Texas 79702

F:\wp51\doc\Marshall2.doc

<small>• Attach this form to the front of the mailpiece, or on the back, if space does not permit. • Write "Return Receipt Requested" on the mailpiece below the article number. • The Return Receipt will show to whom the article was delivered and the date delivered.</small>		1 <input checked="" type="checkbox"/> Addressee's Address	
3 Article Addressed to: Conoco, Inc. Conservation/Proration Dept. 10 Desta Drive #100W Midland, Texas 79705-4500		2 <input checked="" type="checkbox"/> Restricted Delivery Consult postmaster for fee.	
4a Article Number 7137 405 408		4b Service Type <input type="checkbox"/> Registered <input type="checkbox"/> Insured <input checked="" type="checkbox"/> Certified <input type="checkbox"/> COD <input type="checkbox"/> Express Mail <input type="checkbox"/> Return Receipt for Merchandise	
5 Signature (Addressee) <i>Arleta Gonzalez</i>		7 Date of Delivery 8/5	
6 Signature (Agent) <i>Arleta Gonzalez</i>		8 Addressee's Address (Only if requested and fee is paid)	
PS Form 3811, December 1991 U.S. GPO: 1993-382-714			
DOMESTIC RETURN RECEIPT			

is your RETURN ADDRESS completed on the rev

Thank you for using Return Receipt Ser



LEWIS B. BURLESON, INC.
OIL & GAS PROPERTIES

August 4, 1998

LEWIS B. BURLESON
PRESIDENT

STEVEN L. BURLESON
VICE-PRESIDENT

WAYNE JARVIS
SUPERINTENDENT

Conoco, Inc.
Conservation/Proration Dept.
10 Desta Dr, #100W
Midland, Texas 79705-4500

CERTIFIED MAIL # Z137 405 408
Return Receipt Requested

RE: Administrative Application for Non-Standard Proration Unit for Lewis B. Burleson, Inc.'s Marshall #2 well, located 1980' FSL & 660' FEL of Section 11, T-21-S, R-36-E, Lea County, New Mexico

Dear Offset Operator:

Enclosed is a copy of our administrative application for a non-standard proration unit on our Marshall #2 well.

This letter also starts your 21 day period to object to the above well.



Should you have any questions regarding this matter, feel free to call me.

Yours truly,

Lewis B Burleson

LBB/skb
Enclosures

PS Form 3811, December 1991 U.S. GPO: 1993-352-714

SENDER: Complete items 1 and/or 2 for additional services. Complete items 3 and 4. Print your name and address on the reverse of this form so that we can return this card to you. Attach this form to the front of the mailpiece, or on the back if space does not permit. Write "Return Receipt Requested" on the mailpiece below the article number. The Return Receipt will show to whom the article was delivered and the date delivered.		I also wish to receive the following services (for an extra fee): 1 <input checked="" type="checkbox"/> Addressee's Address 2 <input checked="" type="checkbox"/> Restricted Delivery Consult postmaster for fee.	
3 Article Addressed to: Conoco, Inc. Conservation/Proration Dept. 10 Desta Drive #100W Midland, Texas 79705-4500		4a Article Number: Z137 405 408	
5 Signature (Addressee): 		4b Service Type: <input checked="" type="checkbox"/> Registered <input type="checkbox"/> Insured <input checked="" type="checkbox"/> Certified <input type="checkbox"/> COD <input type="checkbox"/> Express Mail <input type="checkbox"/> Return Receipt for Merchandise	
6 Signature (Postmaster): 		7 Date of Delivery: 8/5/98	
8 Addressee's Address (Only if requested and fee is paid):		8/5/98	

DOMESTIC RETURN RECEIPT

LEWIS B. BURLESON, INC.
OIL & GAS PROPERTIES

20
August 4, 1998

LEWIS B. BURLESON
PRESIDENT

STEVEN L. BURLESON
VICE-PRESIDENT

WAYNE JARVIS
SUPERINTENDENT

David Arrington

P.O. Box 2071

Midland, Texas 79702

CERTIFIED MAIL # ^{7137 405 413}~~7137 405 411~~
Return Receipt Requested

RE: Administrative Application for Non-Standard Proration Unit for Lewis B. Burleson, Inc.'s Marshall #2 well, located 1980' FSL & 660' FEL of Section 11, T-21-S, R-36-E, Lea County, New Mexico

Dear Offset Operator:

Enclosed is a copy of our administrative application for a non-standard proration unit on our Marshall #2 well.

This letter also starts your 21 day period to object to the above well.

Should you have any questions regarding this matter, feel free to call me.

Yours truly,

LBB
Lewis B Burleson

LBB/skb
Enclosures

F:\wp51\doc\Marshall2.doc

SENDER: <ul style="list-style-type: none">• Complete items 1 and/or 2 for additional services.• Complete items 3 and 4a & b.• Print your name and address on the reverse of this form so that we can return this card to you.• Attach this form to the front of the mailpiece, or on the back if space does not permit.• Write "Return Receipt Requested" on the mailpiece below the article number.• The Return Receipt will show to whom the article was delivered and the date delivered.		I also wish to receive the following services (for an extra fee): <ul style="list-style-type: none">1. <input type="checkbox"/> Addressee's Address2. <input type="checkbox"/> Restricted Delivery Consult postmaster for fee.	
3. Article Addressed to: David Arrington P.O. Box 2071 Midland, Texas 79702		4a. Article Number: 7137 405 411	
4b. Service Type: <ul style="list-style-type: none"><input type="checkbox"/> Registered<input checked="" type="checkbox"/> Certified<input type="checkbox"/> Express Mail		<ul style="list-style-type: none"><input type="checkbox"/> Insured<input type="checkbox"/> COD<input type="checkbox"/> Return Receipt for Merchandise	
5. Signature (Addressee): <i>DA</i> 8-21-98		7. Date of Delivery:	
6. Signature (Agent):		8. Addressee's Address (Only if requested and fee is paid):	

Is your RETURN ADDRESS completed on the reverse side?

Thank you for using Return Receipt Service.

PS Form 3811, December 1991 U.S. GPO: 1994-352-714

DOMESTIC RETURN RECEIPT

LEWIS B. BURLESON, INC.
OIL & GAS PROPERTIES

LEWIS B. BURLESON
PRESIDENT

STEVEN L. BURLESON
VICE-PRESIDENT

WAYNE JARVIS
SUPERINTENDENT

August 4, 1998

Chevron USA Production
Box 1150
Midland, Texas 79702

CERTIFIED MAIL # Z 137 405 412
Return Receipt Requested

RE: Administrative Application for Non-Standard Proration Unit for Lewis B. Burleson, Inc.'s Marshall #2 well, located 1980' FSL & 660' FEL of Section 11, T-21-S, R-36-E, Lea County, New Mexico

Dear Offset Operator:

Enclosed is a copy of our administrative application for a non-standard proration unit on our Marshall #2 well.

This letter also starts your 21 day period to object to the above well.

Should you have any questions regarding this matter, feel free to call me.

Yours truly,

Lewis B Burleson

LBB/skb
Enclosures

F:\wp51\doc\Marshall2.doc

SENDER: • Complete items 1 and/or 2 for additional services. • Complete items 3 and 4a & b. • Print your name and address on the reverse of this form so that we can return this card to you. • Attach this form to the front of the mailpiece, or on the back if space does not permit. • Write "Return Receipt Requested" on the mailpiece below the article number. • The Return Receipt will show to whom the article was delivered and the date delivered.	3. Article Addressed to: Chevron USA Production Box 1150 Midland, Texas 79702		4a. Article Number Z137 405 412	
	4b. Service Type <input type="checkbox"/> Registered <input type="checkbox"/> Insured <input checked="" type="checkbox"/> Certified <input type="checkbox"/> COD <input type="checkbox"/> Express Mail <input type="checkbox"/> Return Receipt for Merchandise		7. Date of Delivery AUG 05 1998	
	5. Signature (Addressee) 		8. Addressee's Address (Only if requested and fee is paid)	
	Is your RETURN ADDRESS completed on the reverse side?			
	Thank you for using Return Receipt Service.			

RECEIPT

LEWIS B. BURLESON, INC.
OIL & GAS PROPERTIES

LEWIS B. BURLESON
PRESIDENT
STEVEN L. BURLESON
VICE-PRESIDENT
WAYNE JARVIS
SUPERINTENDENT

August 4, 1998

Texaco Exploration
Conservation/Proration Dept.
P.O. Box 3109
Midland, TX 79702

CERTIFIED MAIL # Z137 405 410
Return Receipt Requested

RE: Administrative Application for Non-Standard Proration Unit for Lewis B. Burleson, Inc.'s Marshall #2 well, located 1980' FSL & 660' FEL of Section 11, T-21-S, R-36-E, Lea County, New Mexico

Dear Offset Operator:

Enclosed is a copy of our administrative application for a non-standard proration unit on our Marshall #2 well.

This letter also starts your 21 day period to object to the above well.

Should you have any questions regarding this matter, feel free to call me.

Yours truly,

L B Burleson
Lewis B Burleson

LBB/skb
Enclosures

F:\wp51\doc\Marshall2.doc

SENDER: <ul style="list-style-type: none">• Complete items 1 and/or 2 for additional services.• Complete items 3 and 4a & b.• Print your name and address on the reverse of this form so that we can return this card to you.• Attach this form to the front of the mailpiece or on the back if space does not permit.• Write "Return Receipt Requested" on the mailpiece below the article number.• The Return Receipt will show to whom the article was delivered and the date delivered.		I also wish to receive the following services (for an extra fee): <ul style="list-style-type: none">1 <input type="checkbox"/> Addressee's Address2 <input type="checkbox"/> Restricted Delivery Consult postmaster for fee.	
3. Article Addressed to: Texaco Exploration Conservation/Proration Dept. P.O. Box 3109 Midland, TX 79702		4a. Article Number: Z137 405 410	
4b. Service Type: <ul style="list-style-type: none"><input type="checkbox"/> Registered<input checked="" type="checkbox"/> Certified<input type="checkbox"/> Express Mail		<ul style="list-style-type: none"><input type="checkbox"/> Insured<input type="checkbox"/> COD<input type="checkbox"/> Return Receipt for Merchandise	
5. Signature (Addressee): <i>[Signature]</i>		7. Date of Delivery: AUG 05 1998	
6. Signature (Agent): <i>[Signature]</i>		8. Addressee's Address (Only if requested and fee is paid):	

PS Form 3811, December 1991 *U.S. GPO: 1993-352-714

DOMESTIC RETURN RECEIPT

Is your RETURN ADDRESS completed on the reverse side?

Thank you for using Return Receipt Service

LEWIS B. BURLESON, INC.
OIL & GAS PROPERTIES

LEWIS B. BURLESON
PRESIDENT
STEVEN L. BURLESON
VICE-PRESIDENT
WAYNE JARVIS
SUPERINTENDENT

August 4, 1998

John H. Hendrix Corp.
P.O. Box 3040
Midland, Texas 79702

CERTIFIED MAIL # 7137 405 409
Return Receipt Requested

RE: Administrative Application for Non-Standard Proration Unit for Lewis B. Burleson, Inc.'s Marshall #2 well, located 1980' FSL & 660' FEL of Section 11, T-21-S, R-36-E, Lea County, New Mexico

Dear Offset Operator:

Enclosed is a copy of our administrative application for a non-standard proration unit on our Marshall #2 well.

This letter also starts your 21 day period to object to the above well.

Should you have any questions regarding this matter, feel free to call me.

Yours truly,

LBB
Lewis B Burleson

LBB/skb
Enclosures

F:\wp51\doc\Marshall2.doc

PS Form 3811, December 1991 (with amendments) 352-714

SENDER: <ul style="list-style-type: none">• Complete items 1 and/or 2 for additional services.• Complete items 3 and 4a & b.• Print your name and address on the reverse of this form so that we can return this card to you.• Attach this form to the front of the mailpiece, or on the back if space does not permit.• Write "Return Receipt Requested" on the mailpiece before the article number.• The Return Receipt will show to whom the article was delivered and the date delivered.		I also wish to receive the following services (for an extra fee): <ul style="list-style-type: none">1- <input type="checkbox"/> Addressee's Address2- <input type="checkbox"/> Restricted Delivery Consult postmaster for fee.	
3- Article Addressed to: John H. Hendrix Corp. P.O. Box 3040 Midland, TX 79702		4a- Article Number 7137 405 409	
4b- Service Type <ul style="list-style-type: none"><input type="checkbox"/> Registered<input checked="" type="checkbox"/> Certified<input type="checkbox"/> Express Mail		<input type="checkbox"/> Insured <input type="checkbox"/> COD <input type="checkbox"/> Return Receipt for Merchandise	
5- Signature (Addressee)		7- Date of Delivery	
6- Signature (Agent)		8- Addressee's Address (if requested and fee is paid)	

PS Form 3811, December 1991 (with amendments) 352-714

DOMESTIC RETURN RECEIPT

Thank you for using Return Receipt Service

R-674.

September 7, 1998

Rec: 8-18-98

Sug: 9-8-98

Released: 9-8-98

Lewis B. Burleson, Inc.
P. O. Box 2479
Midland, Texas 79702

Attention: Lewis B. Burleson

**ADMINISTRATIVE REINSTATEMENT OF
DIVISION ORDER NO. R-674
Addendum to Division Administrative Order NSL-12**

Dear Mr. Burleson:

Reference is made to the following: (a) your application dated August 4, 1998, which was received by the Division in Santa Fe on August 18, 1998, that included support data and notice to offset operators; (b) supplemental data submitted to the Division on August 26, 1998; and, (c) to the records of the Division in Santa Fe, including the files on: (i) Division Order No. R-5828, issued in Case 6336 and dated October 6, 1978; (ii) Division Order No. R-674, issued in Case 913 and dated August 17, 1955; and, (iii) Division Administrative Order NSL-12: all concerning your request to maintain the previously approved 160-acre non-standard gas spacing and proration unit consisting of the following acreage in the Eumont Gas Pool:

LEA COUNTY, NEW MEXICO
TOWNSHIP 21 SOUTH, RANGE 36 EAST, NMPM
Section 11: E/2 SE/4
Section 12: W/2 SW/4.

By Division Order No. R-674, the above-described 160-acre non-standard gas spacing and proration unit in the Eumont Gas Pool was initially established and dedicated to the Sunray Mid-Continent Oil Company C. W. Marshall Well No. 2 (API No. 30-025-04615), located at a location considered to be unorthodox at the time (approved by Division Administrative Order NSL-12, dated May 26, 1955) 1980 feet from the South line and 660 feet from the East line (Unit I) of said Section 11. This well was plugged and abandoned in 1977, whereby the subject 160-acre unit ceased to exist.

By Division Order No. R-5828 (dated October 6, 1978), this same acreage was established as a 160-acre non-standard gas spacing and proration unit and dedicated to the Burleson & Huff Marshall Well No. 1 (API No. 30-025-26055), located at a standard gas well location 660 feet from the South and East lines (Unit P) of said Section 11.

It is our understanding that the Marshall Well No. 1 is to be plugged and abandoned in the near future and, as a replacement well, Lewis B. Burleson, Inc. proposes to reenter and recomplete the original Marshall Well No. 2.

By the authority granted me under the provisions of **Rule 2(d)** of the "*General Rules for the Prorated Gas Pools of New Mexico/Special Rules and Regulations for the Eumont Gas Pool*," as promulgated by Division Order No. R-8170, as amended, the above-described 160-acre non-standard gas spacing and proration unit should be restored and that said Division Order R-674 shall be reinstated to its initial extent and is to remain in full force and affect until further notice. Said 160-acre unit shall be dedicated to the above-described Marshall Well No. 2, whereby Division Administrative Order NSL-12 shall also be reinstated at this time.

Further, said Division Order R-5828 is hereby placed in abeyance until further notice.

Jurisdiction of this matter shall be further retained for the entry of any such subsequent orders as the Division may deem necessary.

Sincerely,

Lori Wrotenbery
Director

LW/MES/kv

cc: New Mexico Oil Conservation Division - Hobbs
File: NSL-12

NSL 9/8/98

LEWIS B. BURLESON, INC.
OIL & GAS PROPERTIES

LEWIS B. BURLESON
PRESIDENT

STEVEN L. BURLESON
VICE-PRESIDENT

WAYNE JARVIS
SUPERINTENDENT

August 4, 1998

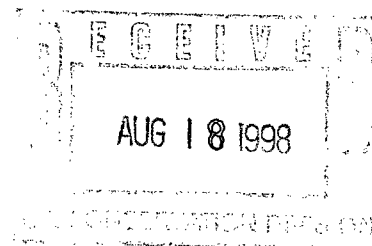

Mr. William LeMay, Director
State of New Mexico
Oil Conservation Division
P.O. Box 2088
Santa Fe, New Mexico 87501

Administrative Application for Non-Standard Proration Unit for Lewis B. Burleson, Inc.'s Marshall #2 well, located 1980' FSL & 660' FEL of Section 11, T-21-S, R-36-E, Lea County, New Mexico

Dear Mr. Lemay:

Lewis B. Burleson, Inc. requests administrative approval of a non-standard 160 acre proration unit for its Marshall #2 well which is proposed to be a re-entry to the Eumont Gas Pool. We have notified by Certified Letter, all offset operators as shown in Exhibit "B" so that they may object to this variance within the specified waiting period.

Non-Standard Unit:

A 160 acre Non-Standard Gas Proration Unit (E/2 of SE/4, Section 11, T-21-S, R-36-E and the W/2 of SW/4 of Section 12, T-21-S, R-36-E) was previously approved for the Marshall #1, as shown by the red circle on the enclosed map. This 160 acre unit in two sections was approved by your order R-5828. The Marshall No. 1 well will be plugged before this re-entry is completed.

Yours truly,

Lewis B. Burleson

LBB/skb
Enclosures

F:\wp51\doc\Marshall2.doc

MARSHALL #2
Offset Operators Mailing List

Conoco Inc.
Conservation/Proration Dept.
10 Desta Dr. #100W
Midland, Texas 79705-4500

John H. Hendrix Corp.
223 W. Wall, #525
Midland, Texas 79701

Texaco Exploration
Conservation/Proration Dept.
P.O. Box 3109
Midland, Texas 79702

David Arrington
P.O. Box 2071
Midland, Texas 79702

Chevron USA Production
Box 1150
Midland, Texas 79702

LEWIS B. BURLESON, INC.
OIL & GAS PROPERTIES

LEWIS B. BURLESON
PRESIDENT

STEVEN L. BURLESON
VICE-PRESIDENT

WAYNE JARVIS
SUPERINTENDENT

August 4, 1998

CERTIFIED MAIL #
Return Receipt Requested

RE: Administrative Application for Non-Standard Proration Unit for Lewis B. Burleson, Inc.'s Marshall #2 well, located 1980' FSL & 660' FEL of Section 11, T-21-S, R-36-E, Lea County, New Mexico

Dear Offset Operator:

Enclosed is a copy of our administrative application for a non-standard proration unit on our Marshall #2 well.

This letter also starts your 21 day period to object to the above well.

Should you have any questions regarding this matter, feel free to call me.

Yours truly,

Lewis B Burleson

LBB/skb
Enclosures

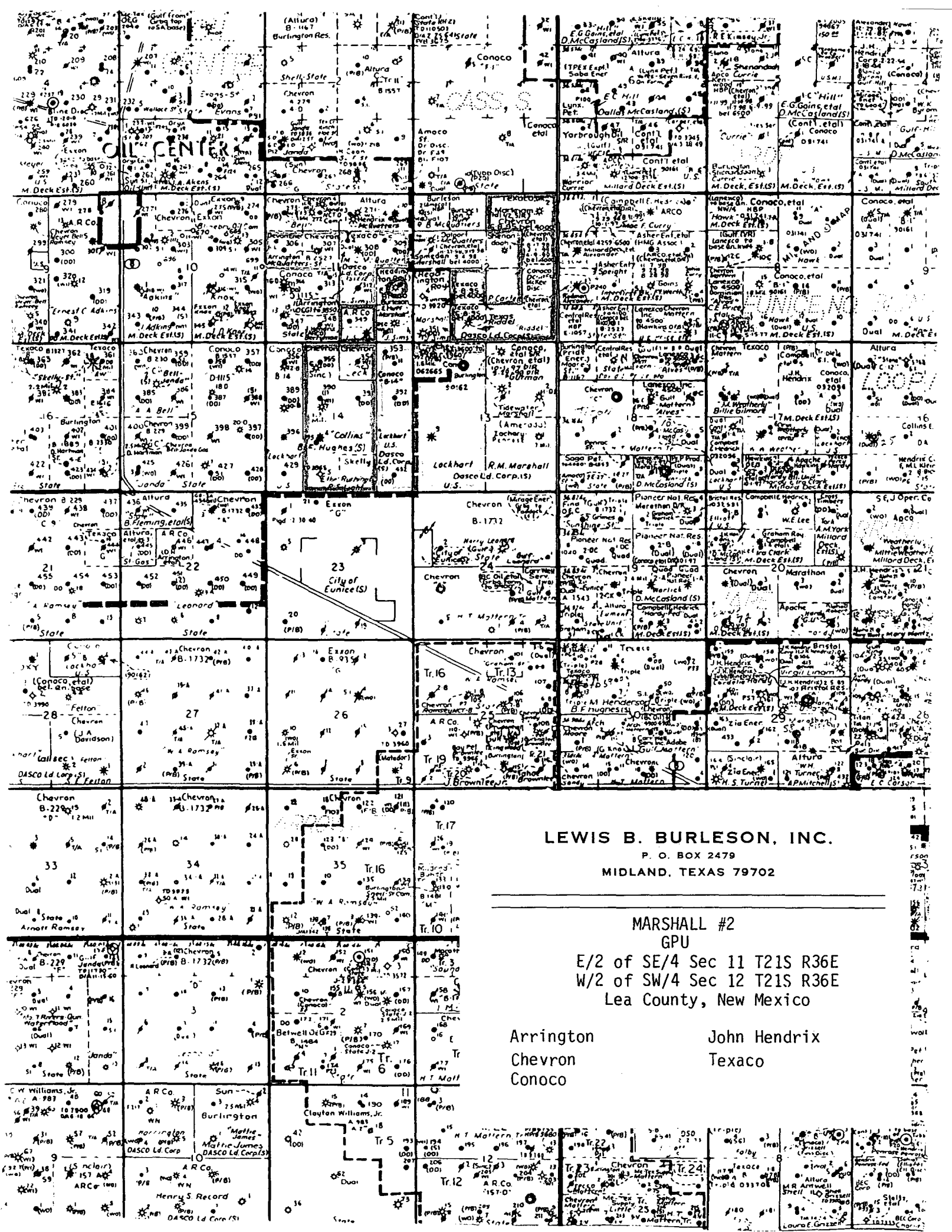

BEFORE THE OIL CONSERVATION COMMISSION
OF THE STATE OF NEW MEXICO

IN THE MATTER OF THE HEARING
CALLED BY THE OIL CONSERVATION
COMMISSION OF THE STATE OF NEW
MEXICO FOR THE PURPOSE OF
CONSIDERING:

CASE NO. 913
Order No. R-674

THE APPLICATION OF SUNRAY MID-
CONTINENT OIL COMPANY FOR AN
ORDER GRANTING APPROVAL OF AN
EXCEPTION PURSUANT TO RULE 5 (a)
OF THE SPECIAL RULES AND REGULATIONS
OF THE EUMONT GAS POOL OF ORDER NO.
R-520 IN ESTABLISHMENT OF A NON-STANDARD
GAS PRORATION UNIT OF 160 CONTIGUOUS ACRES
CONSISTING OF THE E/2 SW/4 OF SECTION 11
AND THE W/2 SW/4 OF SECTION 12, TOWNSHIP
21 SOUTH, RANGE 36 EAST, NMPM, LEA COUNTY,
NEW MEXICO.

ORDER OF THE COMMISSION

BY THE COMMISSION:

This cause came on for hearing at 9 o'clock a.m. on June 13, 1955 at Santa Fe, New Mexico, before the Oil Conservation Commission, hereinafter referred to as the "Commission".

NOW, on this 17th day of August, 1955, the Commission, a quorum being present, having considered the records and testimony adduced, and being fully advised in the premises,

FINDS:

(1) That due notice of the time and place of hearing and the purpose thereof having been given as required by law, the Commission has jurisdiction of this case and the subject matter thereof.

(2) That pursuant to provisions of Rule 5 (a) of the Special Rules and Regulations of the Eumont Gas Pool of Order No. R-520, the Commission has power and authority to permit the formation of a gas proration unit consisting of other than a legal section after notice and hearing by the Commission.

(3) That applicant, Sunray Mid-Continent Oil Company is the owner of an oil and gas lease in Lea County, New Mexico the land consisting of other than a legal section, and described as follows, to-wit:

TOWNSHIP 21 SOUTH, RANGE 36 EAST, NMPM
E/2 SE/4 of Section 11
and W/2 SW/4 of Section 12

containing 160 acres, more or less.

(4) That applicant, Sunray Mid-Continent Company has a producing well on the aforesaid lease known as the C. W. Marshall Well No. 2, located 1980 feet from the south line and 660 feet from the east line of Section 11, Township 21 South, Range 36 East, NMPM, Lea County, New Mexico.

(5) That the aforesaid well will be recompleted within the vertical and horizontal limits of the Eumont Gas Pool, as said pool is delineated and designated in Order No. R-520.

(6) That it is impractical to pool applicant's said lease with adjoining acreage in the Eumont Gas Pool, and that the owners of adjoining acreage in said area have not objected to the formation of the proposed proration unit of 160 acres.

(7) That unless a proration unit consisting of applicant's aforesaid acreage is permitted, applicant will be deprived of the opportunity to recover its just and equitable share of the natural gas in the Eumont Gas Pool.

(8) That creation of a proration unit consisting of the aforesaid acreage will not cause but will prevent waste, and will protect correlative rights.

IT IS THEREFORE ORDERED:

(1) That the application of Sunray Mid-Continent Oil Company for approval of a non-standard proration unit consisting of the following described acreage:

TOWNSHIP 21 SOUTH, RANGE 36 EAST, NMPM
E/2 SE/4 of Section 11
and W/2 SW/4 of Section 12

be and the same is hereby approved, and a proration unit consisting of aforesaid acreage is hereby created.

(2) That applicant's well, C. W. Marshall Well No. 2, located in the NE/4 SE/4 of Section 11, Township 21 South, Range 36 East, NMPM, Lea County, New Mexico, shall be granted an allowable in the proportion that the above described 160 acre unit bears to the standard or orthodox proration unit for said pool, all until further order of the Commission.

DONE at Santa Fe, New Mexico, the day and year hereinabove designated.

State of New Mexico

Oil Conservation Commission

Signed by: John F. Simms, Chairman; E. S. Walker, Member; W. B. Macey, Member and Secretary.

ir/

STATE OF NEW MEXICO
ENERGY AND MINERALS DEPARTMENT
OIL CONSERVATION DIVISION

IN THE MATTER OF THE HEARING
CALLED BY THE OIL CONSERVATION
DIVISION FOR THE PURPOSE OF
CONSIDERING:

CASE NO. 6336
Order No. R-5828

APPLICATION OF BURLESON & HUFF
FOR A NON-STANDARD PRORATION UNIT,
LEA COUNTY, NEW MEXICO.

ORDER OF THE DIVISION

BY THE DIVISION:

This cause came on for hearing at 9 a.m. on September 27, 1978, at Santa Fe, New Mexico, before Examiner Daniel S. Nutter.

NOW, on this 6th day of October, 1978, the Division Director, having considered the testimony, the record, and the recommendations of the Examiner, and being fully advised in the premises,

FINDS:

- (1) That due public notice having been given as required by law, the Division has jurisdiction of this cause and the subject matter thereof.
- (2) That the applicant, Burleson & Huff, seeks approval of a 160-acre non-standard gas proration unit comprising the E/2 SE/4 of Section 11 and the W/2 SW/4 of Section 12, Township 21 South, Range 36 East, NMPM, to be dedicated to a well at a standard location in Unit P of said Section 11.
- (3) That the entire non-standard proration unit may reasonably be presumed productive of gas from the Eumont Gas Pool and that the entire non-standard gas proration unit can be efficiently and economically drained and developed by the aforesaid well.
- (4) That approval of the subject application will afford the applicant the opportunity to produce his just and equitable share of the gas in the Eumont Gas Pool, will prevent the economic loss caused by the drilling of unnecessary wells, avoid the augmentation of risk arising from the drilling of an excessive number of wells, and will otherwise prevent waste and protect correlative rights.

IT IS THEREFORE ORDERED:

(1) That a 160-acre non-standard gas proration unit in the Eumont Gas Pool comprising the E/2 SE/4 of Section 11 and the W/2 SW/4 of Section 12, Township 21 South, Range 36 East, NMPM, Lea County, New Mexico, is hereby established and dedicated to a well at a standard location thereon in Unit P of said Section 11.

(2) That jurisdiction of this cause is retained for the entry of such further orders as the Division may deem necessary.

DONE at Santa Fe, New Mexico, on the day and year hereinabove designated.

STATE OF NEW MEXICO
OIL CONSERVATION DIVISION

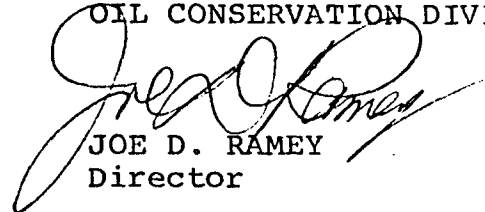
JOE D. RAMEY
Director

S E A L

fd/

ORIGINAL

NEW MEXICO OIL CONSERVATION COMMISSION
Santa Fe, New Mexico

(Form C-104)
(Revised 7/1/53)

REQUEST FOR (GAS) - (GAS) ALLOWABLE

This form shall be submitted by the operator before his initial allowable will be assigned to any completed Oil or Gas well. Form C-104 is to be submitted in QUADRUPPLICATE to the same District Office to which Form C-101 was sent. The allowable will be assigned effective 7:01 A.M. on date of completion or recompletion, provided this form is filed during calendar month of completion or recompletion. The completion date shall be that date in the case of an oil well when oil is delivered into the stock tanks. Gas must be reported on 15.025 psi at 60° Fahrenheit.

WE ARE HEREBY REQUESTING AN ALLOWABLE FOR A WELL KNOWN AS:
Sunny Mid-Continent Oil Co. (Company or Operator)
G. H. Marshall, Well No. 2, in NE 1/4, SE 1/4,
(Unit) T. 21S, R. 26E, NMPM. Eumont Gas Pool
Recompletion started 8-1-55, Date Completed 8-5-55

Please indicate location:

Elevation 3565 Gr. Total Depth 3845, P.B. 3662
Top oil/gas pay 3508 Name of Prod. Form Queen

Casing Perforations: 3508-50, 3566-95, 3608-12
Depth to Casing shoe of Prod. String -

Natural Prod. Test
Based on bbl. Oil in Hr. BOPD
Test after acid or shot Min.

Based on bbl. Oil in Hr. BOPD
Gas Well Potential 1830 MCF/D Min.

Size choke in inches. Absolute open flow

Date first oil run to tanks or gas to Transmission system: -

Transporter taking GRAS Gas: Permian Basin Pipe Line Co.

Remarks: Order No. R-57h, 8-17-55, approved non-standard 160 Ac proration unit.
Order HSL-12, 5-26-55, approved unorthodox location.
This well was recompleted as a GAS well in the Eumont Gas Pool.

I hereby certify that the information given above is true and complete to the best of my knowledge.
Approved FEB 3 1956 Sunny Mid-Continent Oil Co.
(Company or Operator)

By: [Signature]
Title: Engineer District

By: [Signature]
Title: District Engineer
Send Communications regarding well to:

Name: E. F. Patrick
Address: Midland Nat'l Bank, Midland, Texas

ORIGINAL

NEW MEXICO OIL CONSERVATION COMMISSION

Santa Fe, New Mexico

MAIN OFFICE OGD

FIELD OFFICE OGD

(Form O-104)
(Revised 9/1/52)

W

It is required that Form C-104 be approved before this form can be approved on an initial allowable or assigned to any completed (1) or (2) well. Submit this form in QUADRUPPLICATE.

1956 FEB 5 AM 10:10

CERTIFICATE OF COMPLIANCE AND AUTHORIZATION
TO TRANSPORT OIL AND NATURAL GAS

Company or Operator SUNRAY MID-CONTINENT OIL CO. Lease Co. W. Marshall
Address MIDLAND NATIONAL BANK BLDG., MIDLAND TEXAS, BOX 2039, TULSA, OKLAHOMA
(Local or Field Office) (Principal Place of Business)
Unit I, Well(s) No. 2, Sec. 11, T. 21-N, R. 36-E, Pool Eumont Gas
County Lea Kind of Lease: Patented
If Oil well Location of Tanks Gas Well
Authorized Transporter Permian Basin Pipeline Co. Address of Transporter
Hobbs, N.M. El Paso, Texas
(Local or Field Office) (Principal Place of Business)
Per cent of ~~Oil~~ Natural Gas to be Transported 100% Other Transporters authorized to transport Oil or Natural Gas
from this unit are None

REASON FOR FILING: (Please check proper box)

NEW WELL ☐ CHANGE IN OWNERSHIP ☐
CHANGE IN TRANSPORTER ☐ OTHER (Explain under Remarks) ☒

REMARKS: Recompletion from oil well to gas well in Eumont Gas Pool.
Order No. B-674, 8-17-55, approved non-standard and 160 Ac
proportion unit
Order NSL-12, 5-26-55, approved unorthodox location.

The undersigned certifies that the Rules and Regulations of the Oil Conservation Commission have been complied with.

Executed this the 2 day of February, 19 56.

Approved FEB 3 1956, 19

OIL CONSERVATION COMMISSION

By *[Signature]*
Title Engineer District 1

Sunray Mid-Continent Oil Co.

By *[Signature]*
Title District Engineer

BEFORE THE OIL CONSERVATION COMMISSION
OF THE STATE OF NEW MEXICO

IN THE MATTER OF THE HEARING
CALLED BY THE OIL CONSERVATION
COMMISSION OF THE STATE OF NEW
MEXICO FOR THE PURPOSE OF
CONSIDERING:

CASE NO. 913
Order No. R-674

THE APPLICATION OF SUNRAY MID-
CONTINENT OIL COMPANY FOR AN
ORDER GRANTING APPROVAL OF AN
EXCEPTION PURSUANT TO RULE 5 (a)
OF THE SPECIAL RULES AND REGULATIONS
OF THE EUMONT GAS POOL OF ORDER NO.
R-520 IN ESTABLISHMENT OF A NON-STANDARD
GAS PRORATION UNIT OF 160 CONTIGUOUS ACRES
CONSISTING OF THE E/2 SW/4 OF SECTION 11
AND THE W/2 SW/4 OF SECTION 12, TOWNSHIP
21 SOUTH, RANGE 36 EAST, NMPM, LEA COUNTY,
NEW MEXICO.

ORDER OF THE COMMISSION

BY THE COMMISSION:

This cause came on for hearing at 9 o'clock a.m. on June 13, 1955 at Santa Fe, New Mexico, before the Oil Conservation Commission, hereinafter referred to as the "Commission".

NOW, on this 17th day of August, 1955, the Commission, a quorum being present, having considered the records and testimony adduced, and being fully advised in the premises,

FINDS:

(1) That due notice of the time and place of hearing and the purpose thereof having been given as required by law, the Commission has jurisdiction of this case and the subject matter thereof.

(2) That pursuant to provisions of Rule 5 (a) of the Special Rules and Regulations of the Eumont Gas Pool of Order No. R-520, the Commission has power and authority to permit the formation of a gas proration unit consisting of other than a legal section after notice and hearing by the Commission.

(3) That applicant, Sunray Mid-Continent Oil Company is the owner of an oil and gas lease in Lea County, New Mexico the land consisting of other than a legal section, and described as follows, to-wit:

TOWNSHIP 21 SOUTH, RANGE 36 EAST, NMPM
E/2 SE/4 of Section 11
and W/2 SW/4 of Section 12

containing 160 acres, more or less.

(4) That applicant, Sunray Mid-Continent Company has a producing well on the aforesaid lease known as the C. W. Marshall Well No. 2, located 1980 feet from the south line and 660 feet from the east line of Section 11, Township 21 South, Range 36 East, NMPM, Lea County, New Mexico.

(5) That the aforesaid well will be recompleted within the vertical and horizontal limits of the Eumont Gas Pool, as said pool is delineated and designated in Order No. R-520.

(6) That it is impractical to pool applicant's said lease with adjoining acreage in the Eumont Gas Pool, and that the owners of adjoining acreage in said area have not objected to the formation of the proposed proration unit of 160 acres.

(7) That unless a proration unit consisting of applicant's aforesaid acreage is permitted, applicant will be deprived of the opportunity to recover its just and equitable share of the natural gas in the Eumont Gas Pool.

(8) That creation of a proration unit consisting of the aforesaid acreage will not cause but will prevent waste, and will protect correlative rights.

IT IS THEREFORE ORDERED:

(1) That the application of Sunray Mid-Continent Oil Company for approval of a non-standard proration unit consisting of the following described acreage:

TOWNSHIP 21 SOUTH, RANGE 36 EAST, NMPM
E/2 SE/4 of Section 11
and W/2 SW/4 of Section 12

be and the same is hereby approved, and a proration unit consisting of aforesaid acreage is hereby created.

(2) That applicant's well, C. W. Marshall Well No. 2, located in the NE/4 SE/4 of Section 11, Township 21 South, Range 36 East, NMPM, Lea County, New Mexico, shall be granted an allowable in the proportion that the above described 160 acre unit bears to the standard or orthodox proration unit for said pool, all until further order of the Commission.

DONE at Santa Fe, New Mexico, the day and year hereinabove designated.

State of New Mexico
Oil Conservation Commission

Signed by: John F. Simms, Chairman; E. S. Walker, Member; W. B. Macey,
Member and Secretary.
ir/