

cc-occ  
A2lec  
w/older  
MAIN OFFICE  
EST FEB 27 PM 1:20  
SOUTHERN UNION GAS COMPANY  
BURT BUILDING  
DALLAS 1, TEXAS

February 25, 1957

NSL-89

Due 3/14/57  
issue 3/6/57

New Mexico Oil Conservation Commission  
Santa Fe, New Mexico

Attention: Mr. A. L. Porter, Jr.,  
Secretary-Director

per Rule 104(F)

Gentlemen:

Southern Union Gas Company hereby requests approval of an unorthodox location for its No. 2-C Jicarilla Well in the SW $\frac{1}{4}$  of the SW $\frac{1}{4}$  of Section 11, Township 26 North, Range 4 West, N.M.P.M., Rio Arriba County, New Mexico, as an exception to Paragraph (5) of the Commission's Order No. R-794, dated April 18, 1956, establishing special rules for the Tapacito-Pictured Cliffs Gas Pool

As indicated by the attached plat, the well is proposed to be drilled at a point 570 feet from the west line and 540 feet from the south line of said section. Such location is necessary because of the presence of a deep arroyo, which, as indicated by the plat, cuts diagonally across the central portion of the section's SW $\frac{1}{4}$ , and because of additional rough terrain lying to the northeast of the arroyo itself.

Southern Union Gas Company is operator for the quarter sections lying immediately south and southwest of the proposed location, while Honolulu Oil Corporation is operator of the quarter section immediately to the west thereof. A copy of this letter is being mailed today to Honolulu Oil Corporation, with the request that they notify you promptly in the event they have no objection to the unorthodox well location herein proposed.

Since we are under some pressure of time in this matter, because of an impending lease expiration, your prompt attention to this application will be much appreciated.

Very truly yours,

SOUTHERN UNION GAS COMPANY

By

A. M. Wiederkehr  
A. M. Wiederkehr, Manager  
Exploration Department

SWORN TO AND SUBSCRIBED before me, the undersigned authority, this  
25th day of February, 1957.

DARLENE TANTON

My Commission Expires

June 1, 1957

Darlene Tanton  
Notary Public in and for  
Dallas County, Texas

NEW MEXICO  
OIL CONSERVATION COMMISSION

Form O-128

WELL LOCATION AND/OR GAS PRORATION PLAT

DATE February 25, 1957

OPERATOR SOUTHERN UNION GAS COMPANY LEASE JICARILLA  
WELL NO. 2-C SECTION 11 TOWNSHIP 26 NORTH RANGE 4 WEST, NMPM  
LOCATED 540 FEET FROM the SOUTH LINE 570 FEET FROM the WEST LINE  
RIO ARriba COUNTY, NEW MEXICO Oil Elevation To be determined  
NAME OF PRODUCING FORMATION Pictured Cliffs Tapacito DEDICATED ACREAGE 320

Note: All distances must be from outer boundaries of section.

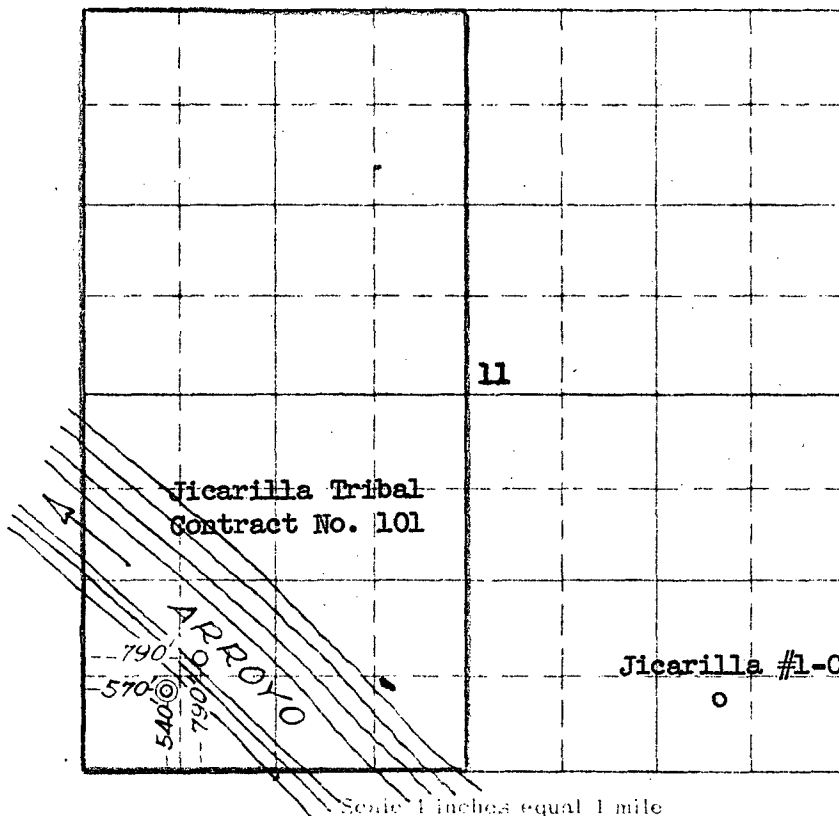

NOTE

This section of  
form is to be used  
for gas wells only

This is to certify that the above plat was prepared from  
field notes of actual surveys made by me or under my  
supervision and that the same are true and correct to the  
best of my knowledge and belief.

Date Surveyed 14 February 1957

James P. Leese  
Registered Professional Engineer and/or Land Surveyor  
**JAMES P. LEESE**  
N. MEX. REG. NO. 1463

1. Is this well a Dual Comp.  
Yes \_\_\_\_\_ No X

2. If the answer to Question 1  
is yes, are there any other dually  
completed wells within the  
dedicated acreage.

Yes \_\_\_\_\_ No \_\_\_\_\_  
Name A. M. Wiederkehr  
Position Mgr., Exploration Dept.

Representing Southern Union Gas Co.

Address 1001 Burt Bldg., Dallas, Tex.

MAIN OFFICE  
1957 MAR 6 AM 8:26  
**HONOLULU OIL CORPORATION**  
P. O. DRAWER 1391  
**MIDLAND, TEXAS**

March 4, 1957

NSL-89  
MAR 3/6/57

New Mexico Oil Conservation Commission  
Santa Fe, New Mexico

Attn: Mr. A. L. Porter, Jr.

Gentlemen:

We have received a copy of the application filed by Southern Union Gas Company for an unorthodox location to be drilled in the SW/4 of Section 11 - 26N - 4 W, Rio Arriba County, New Mexico.

As an offset operator, Honolulu Oil Corporation has no objection to this unorthodox location as shown in the application.

Yours very truly,

HONOLULU OIL CORPORATION

By

*George R. Hoy*

George R. Hoy  
Division Development Engineer

GRH:id

AIRMAIL