

cc-000-1214
EUSOB
OFFICE 000
March 25, 1957

BLACKWOOD & NICHOLS COMPANY

Box 1237

DURANGO, COLORADO

March 25, 1957

NSC-92

1000 4/1/57

Mr. A. L. Porter, Jr.
Secretary-Director
Oil Conservation Commission
P.O. Box 871
Santa Fe, New Mexico

Dear Mr. Porter:

As Operator of the Northeast Blanco Unit, we request permission to drill an unorthodox well, to be located 500' from the South line and 2065' from the West line of Section 29, T 31 N, R 7 W, San Juan County, New Mexico.

The normal location for this well is situated in the Pine River Canyon. It is, therefore, necessary to select a more suitable drilling site.

Section 29-31N-7W is a part of the Northeast Blanco Unit and the new location, as requested, will present no drainage problem to offset operations.

We enclose a location plat of the requested location.

Very truly yours,

BLACKWOOD & NICHOLS COMPANY

De Lasso Loos

DeLasso Loos
Field Superintendent

DL/cg
Encl.

NEW MEXICO
OIL CONSERVATION COMMISSION

Form C - 128

Well Location and/or Gas Proration Plat

Date March 16, 1957

Operator BLACKWOOD & NICHOLS COMPANY Lease NORTHEAST BLANCO UNIT

Well No. 51-29 Section 29 Township 31 N. Range 7 W. NMPM

Located 500 Feet From South Line, 2065 Feet From West Line,

San Juan County, New Mexico. G. L. Elevation 6375

Name of Producing Formation Mesa Verde Pool Blanco Mesa Dedicated Acreage Verde

(Note: All distances must be from outer boundaries of Section)

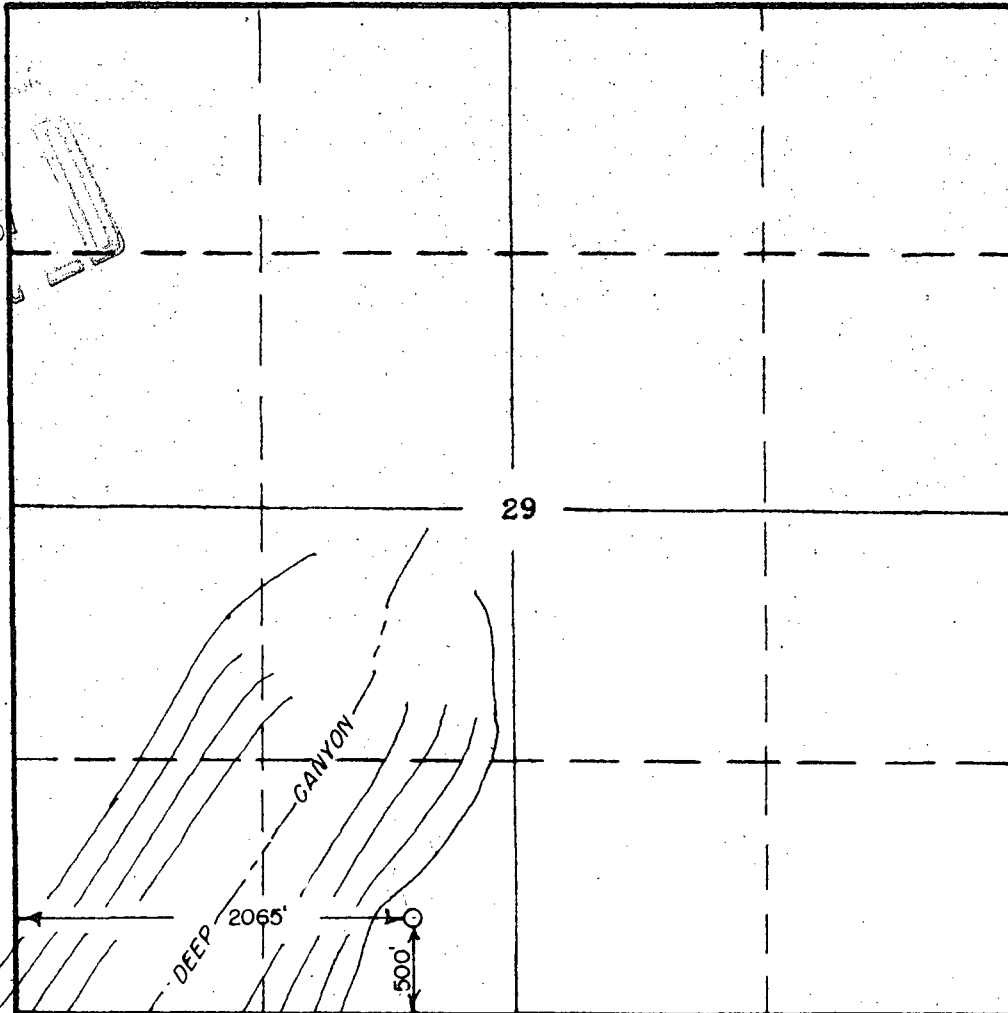

Scale: 1" = 1000'

NOTE

This section of form is to be used for gas wells only.

1. Is this well a Dual Comp.? Yes ☐ No ☐
2. If the answer to Question 1 is yes, are there any other dually completed wells within the dedicated acreage? Yes ☐ No ☐

Name

Position

Representing

Address

This is to certify that the above plat was prepared from field notes of actual surveys made by me or under my supervision and that the same are true and correct to the best of my knowledge and belief.

Date Surveyed March 14, 1957

John A. Kroeger
John A. Kroeger
Reg. Land Surveyor
N. Mex. Reg. No. 1941