

Log in, assign no. &
Write order

JP
El Paso Natural Gas Company
MAIN OFFICE

1958 NOV 3
El Paso, Texas
October 30, 1958

ADDRESS REPLY TO:
POST OFFICE BOX 997
FARMINGTON, NEW MEXICO

NSL-173

Mr. A. L. Porter
New Mexico Oil Conservation Commission
P. O. Box 871
Santa Fe, New Mexico

Dear Mr. Porter:

This is a request for administrative approval for an unorthodox gas well
location in the South Blanco Pictured Cliffs Pool.

The well, Rincon Unit No. 49, is a completed well, and was located by
the original survey 1090 feet from the North line, and 1650 feet from
the East line of Section 31, Township 27 North, Range 6 West, N.M.P.M.,
~~San Juan County, New Mexico.~~

Re: Amended
A recent United States Cadastral Survey shows the well to be located 719
feet from the North line, and 1652 feet from the East line of Section 31,
Township 27 North, Range 6 West.

Since El Paso Natural Gas Company holds all leases within a 790 foot radius
the consent to said location has not been sought from any other operators.

Yours very truly,

E. S. Oberly
E. S. Oberly,
Division Petroleum Engineer

ESO:DWN:dgb

cc: Sam Smith
O.C.C. (Emery Arnold)
U.S.G.S. (Phil McGrath)

Well Location and Acreage Dedication Plat

Section A.

Date AUGUST 5, 1958

Operator EL PASO NATURAL GAS COMPANY Lease RINCON UNIT SF 079364
 Well No. 49 Unit Letter B Section 31 Township 27-N Range 6-W NMPM
 Located 719 Feet From NORTH Line, 1652 Feet From EAST Line
 County RIO ARriba G. L. Elevation 6638 Dedicated Acreage 160 Acres
 Name of Producing Formation PICTURED CLIFF Pool SOUTH BLANCO PICTURED CLIFF

1. Is the Operator the only owner in the dedicated acreage outlined on the plat below?
 Yes X No _____
2. If the answer to question one is "no", have the interests of all the owners been consolidated by communitization agreement or otherwise? Yes _____ No _____. If answer is "yes", Type of Consolidation _____

3. If the answer to question two is "no", list all the owners and their respective interests below:

Owner

Land Description

Section B.

This is to certify that the information in Section A above is true and complete to the best of my knowledge and belief.

El Paso Natural Gas Company

(Operator)

D. W. Meehan

(Representative)

Box 997

(Address)

Farmington, New Mexico

Note: All distances must be

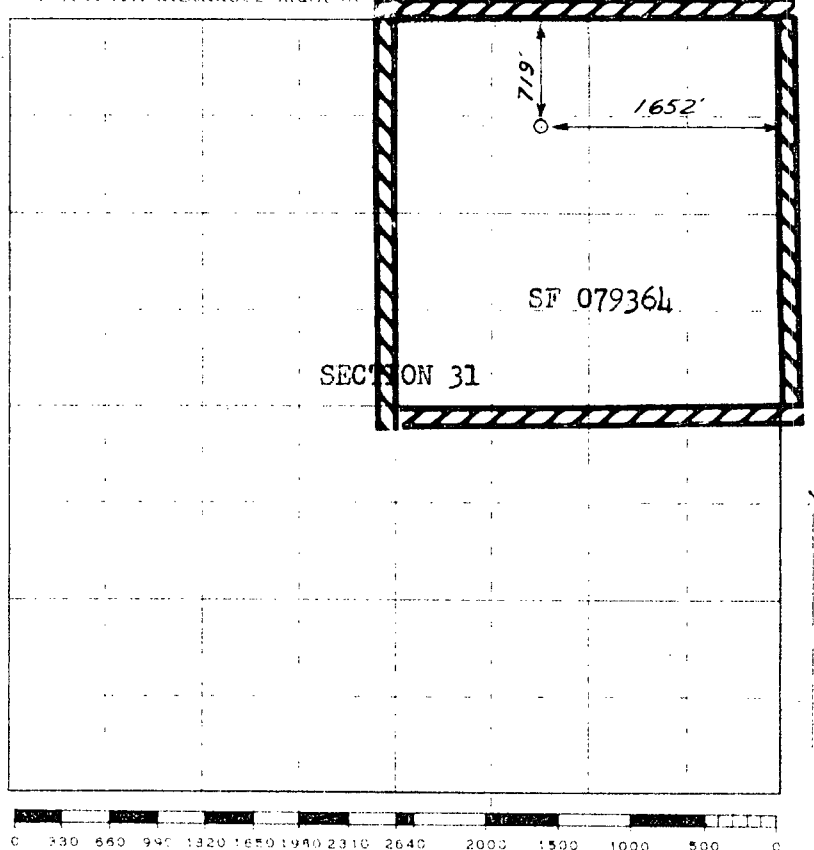

NOTE: THIS PLAT IS REISSUED TO SHOW
 CORRECT LOCATION FROM RECENT
 UNITED STATES CADASTRAL SURVEY.
 THIS IS A COMPLETED WELL. 8 5 58

This is to certify that the above plat was prepared from field notes of actual surveys made by me or under my supervision and that the same are true and correct to the best of my knowledge and belief.

(Seal)

Farmington, New Mexico

Date Surveyed APRIL 27, 1955

David O. Wilson
 Registered Professional Engineer and/or Land Surveyor

Well Location and Acreage Dedication Plat

Section A.

Date AUGUST 5, 1958

Operator EL PASO NATURAL GAS COMPANY Lease RINCON UNIT SF 079364
 Well No. 49 Unit Letter B Section 31 Township 27-N Range 6-W NMPM
 Located 719 Feet From NORTH Line, 1652 Feet From EAST Line
 County RIO ARriba G. L. Elevation 6638 Dedicated Acreage 160 Acres
 Name of Producing Formation PICTURED CLIFF Pool SOUTH BLANCO PICTURED CLIFF

1. Is the Operator the only owner in the dedicated acreage outlined on the plat below?
 Yes X No _____
2. If the answer to question one is "no", have the interests of all the owners been consolidated by communitization agreement or otherwise? Yes _____ No _____. If answer is "yes", Type of Consolidation _____
3. If the answer to question two is "no", list all the owners and their respective interests below:

Owner

Land Description

Section B.

This is to certify that the information in Section A above is true and complete to the best of my knowledge and belief.

El Paso Natural Gas Company
 (Operator)

(Representative)

Box 997

(Address)

Farmington, New Mexico

Note: All distances must be from corner boundaries of section.

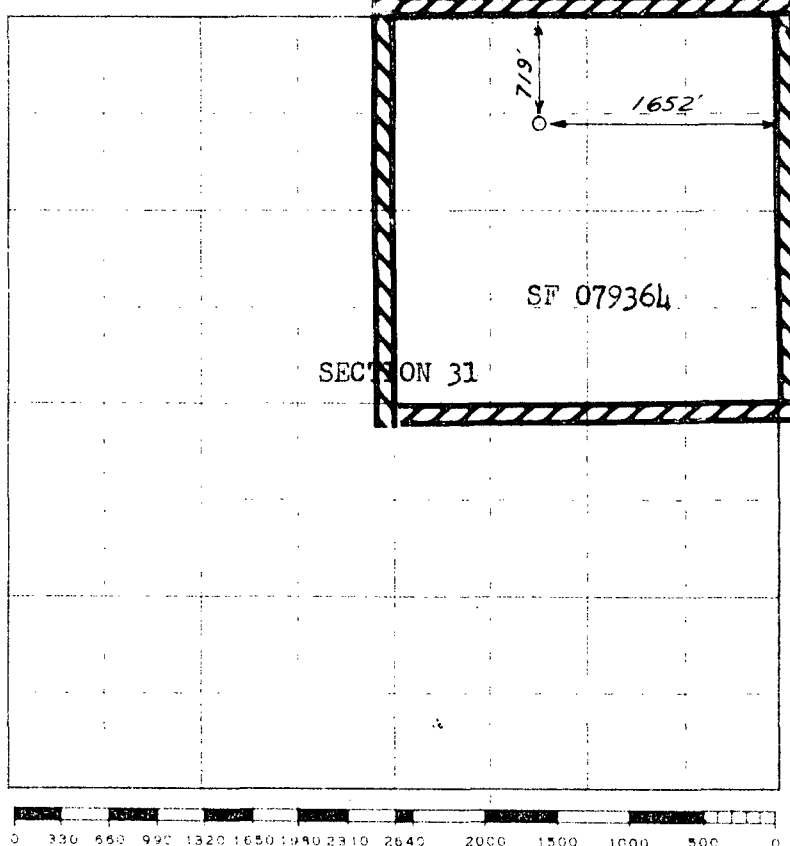

Scale 4 inches equal 1 mile

NOTE: THIS PLAT IS REISSUED TO SHOW CORRECT LOCATION FROM RECENT UNITED STATES CADASTRAL SURVEY. THIS IS A COMPLETED WELL. 8 5 58

This is to certify that the above plat was prepared from field notes of actual surveys made by me or under my supervision and that the same are true and correct to the best of my knowledge and belief.

(Seal)

Farmington, New Mexico

Date Surveyed APRIL 27, 1955

David O. Kilren
 Registered Professional Engineer and/or Land Surveyor