

VAL R. REESE & ASSOCIATES, Inc.

CONSULTING GEOLOGISTS
OIL - GAS - MINING

PHONE CHAPEL 3-3569

ALBUQUERQUE, NEW MEXICO

LOBBY OF SIMMS BUILDING

April 13, 1960

Mr. A. L. Porter
New Mexico Oil Conservation Commission
P. O. Box 871
Santa Fe, New Mexico

Dear Mr. Porter:

Val R. Reese & Associates, Inc. requests administrative approval to drill their #1-25 Mesa well on an unorthodox location. The #1-25 Mesa will be a Gallup-Dakota completion located 990' from the north line and 660' from the west line of Section 25, T-24N, R-7W, Rio Arriba County, New Mexico.

The unorthodox location is requested because of the extreme topography in the area as indicated on the attached plat. Standard Oil Company of Texas and Killarney Oil Company are offset operators and have been notified of this request by a copy of this letter and the attached plat.

Very truly yours,

Val R. Reese

VRR:sw

cc: Emery Arnold
Killarney Oil Company
Standard Oil Company of Texas

may 8
NSL - 213
(Waiting period)

NEW MEXICO OIL CONSERVATION COMMISSION

Well Location and Acreage Dedication Plat

Section A.

Date April 13, 1960

Operator VAL R. REESE & ASSOCIATES, INC. Lease Mesa
Well No. 1-25 Unit Letter D Section 25 Township 24 North Range 7 West NMPM
Located 990 Feet From North Line, 660 Feet From West Line
County Rio Arriba G. L. Elevation 6710 Dedicated Acreage 160 Acres
Name of Producing Formation Gallup Pool Undesignated

1. Is the Operator the only owner* in the dedicated acreage outlined on the plat below?
Yes X No
2. If the answer to question one is "no," have the interests of all the owners been consolidated by communitization agreement or otherwise? Yes No . If answer is "yes,"
Type of Consolidation
3. If the answer to question two is "no," list all the owners and their respective interests below:

Owner

Land Description

Section. B

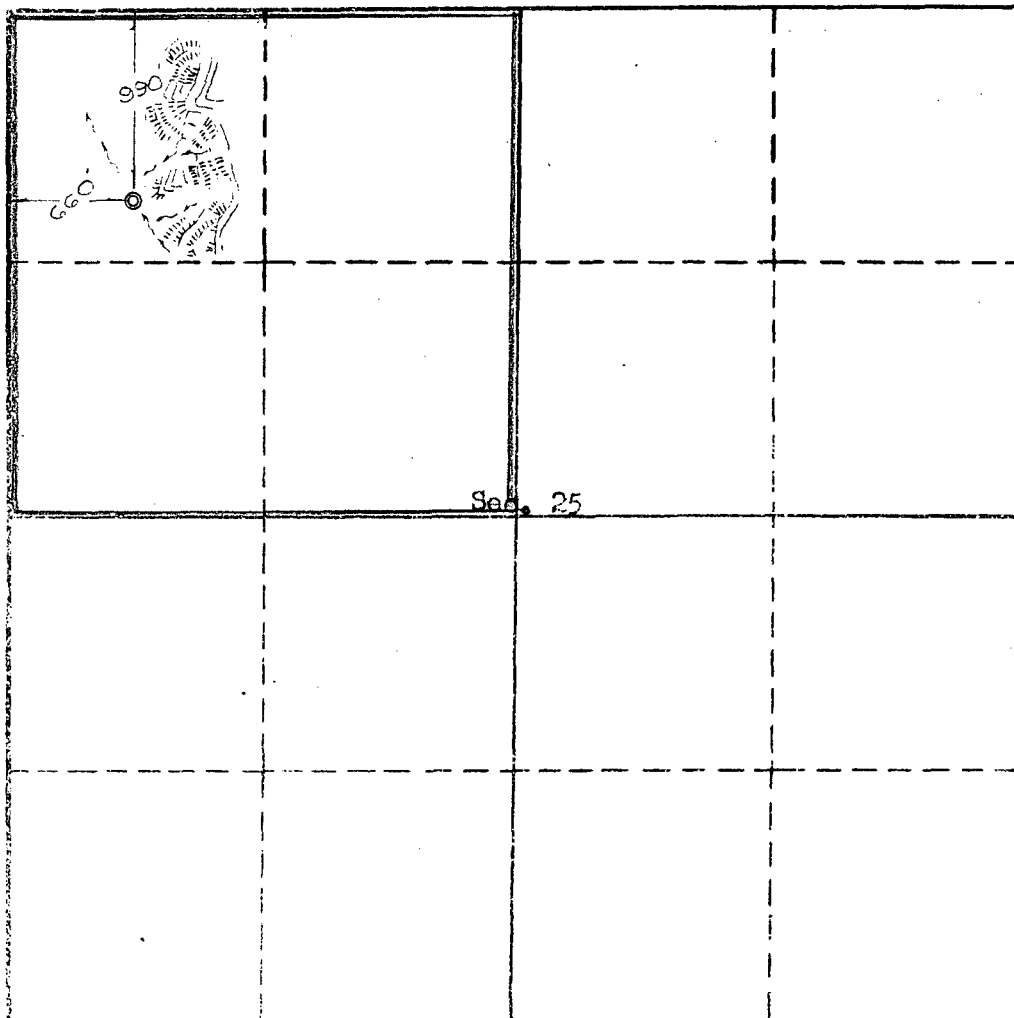

This is to certify that the information in Section A above is true and complete to the best of my knowledge and belief.

Val R. Reese & Assoc., Inc.
(Operator)

Lewis C. Johnson
(Representative)

Lobby of Simms Bldg.

Address

Albuquerque, New Mexico

This is to certify that the well location shown on the plat in Section A was plotted from field notes of actual surveys made by me or under my supervision and that the same is true and correct to the best of my knowledge and belief.

Date Surveyed April 9, 1960

Ernest V. Echolaw
Ernest V. Echolaw
Registered Land Surveyor.

Certificate No. 1545

213

STANDARD OIL COMPANY OF TEXAS

P. O. Box 1660
Midland, Texas

April 21, 1960

Winters

Mr. A. L. Porter
New Mexico Oil Conservation Commission
P. O. Box 871
Santa Fe, New Mexico

Dear Mr. Porter:

Standard Oil Company of Texas has no objection to the location of the Val R. Reese & Associates, Inc. #1-25 Mesa well on an unorthodox location 990' fnl, 660' fwl of Section 25, T-24N, R-7W, Rio Arriba County, New Mexico.

Very truly yours,



J. P. Jones
Division Production Superintendent

ALL LETTERS GO
1933 APR 20 PM 1:30

Warden

Mr. A. L. Porter
New Mexico Oil Conservation Commission
P. O. Box 871
Santa Fe, New Mexico

Dear Mr. Porter:

Killarney Oil Company has no objection to the location of the Val R. Reese & Associates, Inc. #1-25 Mesa well on an unorthodox location 990' fnl, 660' fwl of Section 25, T-24N, R-7W, Rio Arriba County, New Mexico.

Very truly yours,

Harold F. Cunningham
Gen Partner
Killarney oil co..