

El Paso Natural Gas Company

1962 SEP 24 AM 11 25
El Paso, Texas
September 24, 1962

ADDRESS REPLY TO
POST OFFICE BOX 990
FARMINGTON, NEW MEXICO

Mr. A. L. Porter, Secretary & Director
Oil Conservation Commission
Box 871
Santa Fe, New Mexico

Dear Mr. Porter:

This is a request for administrative approval for an unorthodox gas well location in the Basin Dakota Pool.

It is intended to locate the well, El Paso Natural Gas Co. San Juan 27-5 Unit No. 90, 2375 feet from the North line and 2200 feet from the East line of Section 16, Township 27 North, Range 5 West, N.M.P.M., Rio Arriba County, New Mexico. The E/2 of Section 16 is dedicated to this well.

As shown on the enclosed plat, the NE/4 consists of rock hills and steep bluffs. The only accessible land for a well in the NE/4 is that which makes the location unorthodox. It is, therefore planned to make the location unorthodox in order that the extremely high cost of constructing an orthodox location be avoided.

Since El Paso Natural Gas Co. holds all leases within the 790' radius, the consent to said location has not been asked from any other operators.

I am enclosing two copies of the certified well location plat, and two copies of the notice of intention to drill.

Yours very truly,



E. S. Oberly,
Area Petroleum Engineer

ESO:dgb

cc: Sam Smith
Emery Arnold

NEW MEXICO OIL CONSERVATION COMMISSION
Santa Fe, New Mexico

Form G-101
Revised (12/1/55)

MAIN OFFICE

NOTICE OF INTENTION TO DRILL

Notice must be given to the District Office of the Oil Conservation Commission and approval obtained before drilling or recompletion begins. If changes in the proposed plan are considered advisable, a copy of this notice showing such changes will be returned to the sender. Submit this notice in **QUINTUPLICATE**. One copy will be returned following approval. See additional instructions in Rules and Regulations of the Commission. If State Land submit 6 Copies Attach Form G-128 in triplicate to first 3 copies of form G-101

Farmington, New Mexico

September 24, 1962

OIL CONSERVATION COMMISSION
SANTA FE, NEW MEXICO

Gentlemen:

You are hereby notified that it is our intention to commence the Drilling of a well to be known as

El Paso Natural Gas Co.

(Company or Operator)

San Juan 27-5 Unit

(Lease)

Well No. **90**

in **G**

The well is

located **2375** feet from the **North** line and **2200** feet from the

East

line of Section **16**, T. **27N**, R. **5W**, NMPM.

(GIVE LOCATION FROM SECTION LINE) **Basin Dakota** Pool, **Rio Arriba** County

If State Land the Oil and Gas Lease is No. **E-290-30**

If patented land the owner is

Address

We propose to drill well with drilling equipment as follows: **Mud drill with rotary tools thru the Dakota formation**

The status of plugging bond is **Statewide**

Drilling Contractor **Aspen Drilling Company**

We intend to complete this well in the **Dakota**

formation at an approximate depth of **7862** feet.

CASING PROGRAM

We propose to use the following strings of Casing and to cement them as indicated:

Size of Hole	Size of Casing	Weight per Foot	New or Second Hand	Depth	Backs Cement
13 3/4"	9 5/8"	40#	New	300'	214
8 3/4"				5797'	
7 7/8"	4 1/2"	11.6, 10.5, 11.6#	New	7862	515 in 3 stages

If changes in the above plans become advisable we will notify you immediately.

ADDITIONAL INFORMATION (If recompletion give full details of proposed plan of work.)

Possible producing zones in the Dakota formation will be perforated and fractured.

The E/2 of Section 16 is dedicated to this well.

Approved _____, 19____
Except as follows:

Sincerely yours,

El Paso Natural Gas Company

(Company or Operator)

By **OR.G.NAL SIGNED E. S. OBERLY**

Position **Petroleum Engineer**

Send Communications regarding well to

Name **E. S. Oberly**

Address **Box 990, Farmington, New Mexico**

OIL CONSERVATION COMMISSION

By _____

NEW MEXICO OIL CONSERVATION COMMISSION

Well Location and Acreage Dedication Plat

Section A.

Date SEPTEMBER 19, 1962

Operator EL PASO NATURAL GAS COMPANY Lease SAN JUAN 27-5 UNIT E-290-30
 Well No. 90 Unit Letter G Section 16 Township 27-N Range 5-W NMPM
 Located 2375 Feet From NORTH Line, 2200 Feet From EAST Line
 County RIO ARriba G. L. Elevation 6564 Dedicated Acreage 320 Acres
 Name of Producing Formation DAKOTA Pool BASIN DAKOTA

1. Is the Operator the only owner in the dedicated acreage outlined on the plat below?
 Yes X No _____
2. If the answer to question one is "no", have the interests of all the owners been consolidated by communitization agreement or otherwise? Yes _____ No _____. If answer is "yes", Type of Consolidation.
3. If the answer to question two is "no", list all the owners and their respective interests below:

OwnerLand Description

Section B.

This is to certify that the information in Section A above is true and complete to the best of my knowledge and belief.

El Paso Natural Gas CompanyOR.G.NAL SIGNED E. S. OBERLY

(Representative)

Box 990

(Address)

Farmington, New Mexico

Note: All distances must be from outer boundaries of section

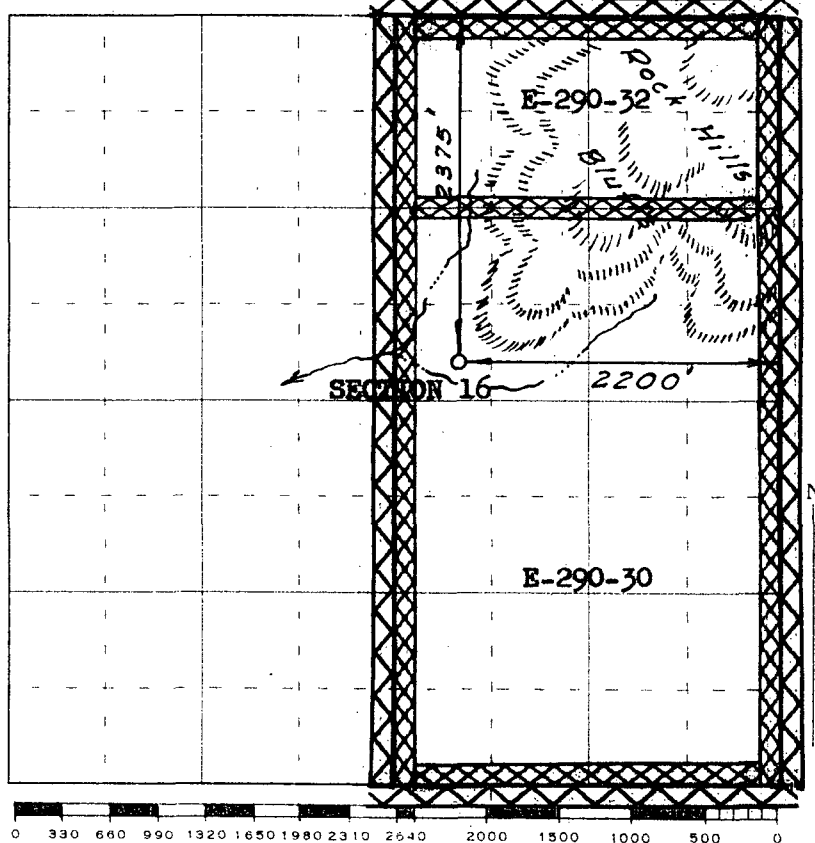

Scale 4 inches equal 1 mile

This is to certify that the above plat was prepared from field notes of actual surveys made by me or under my supervision and that the same are true and correct to the best of my knowledge and belief.

Date Surveyed SEPTEMBER 10, 1962

Registered Professional Engineer and/or Land Surveyor

(Seal)

Farmington, New Mexico

OIL CONSERVATION COMMISSION

P. O. BOX 871

SANTA FE, NEW MEXICO

September 28, 1962

**Mr. Emery Arnold
District Supervisor
Oil Conservation Commission
1000 Rio Brazos Road
Aztec, New Mexico**

**Re: El Paso Natural Gas Company
San Juan 27-5 Unit No. 90 Well**

Dear Emery:

We have received a request for administrative approval of an unorthodox gas well location for the above well. This application is based upon topographical conditions in the area.

I am enclosing herewith one copy of El Paso's Notice of Intention to Drill along with the Well Location and Acreage Dedication Plat. Will you please check this over and advise us as to whether or not you feel topographic conditions justify granting the application.

Very truly yours,

**JAMES M. DURRETT, Jr.,
Attorney**

**JMD/esr
Enclosures**

C
O
P
Y

GOVERNOR
EDWIN L. MECHEM
CHAIRMAN

NSK-304
now

State of New Mexico
Oil Conservation Commission

LAND COMMISSIONER
E. S. JOHNNY WALKER
MEMBER



STATE GEOLOGIST
A. L. PORTER, JR.
SECRETARY - DIRECTOR

1000 RIO BRAZOS ROAD
AZTEC, NEW MEXICO

October 5, 1962

Oil Conservation Commission
Box 871
Santa Fe, New Mexico

Attn: Mr. James M. Durrett
Attorney

Re: El Paso Nat. Gas #90
SJU 27-5, NE Section
16-27N-5W

Dear Jim:

I have received your request for approval of the above unorthodox location. I believe that the topography in this quarter-section justifies the granting of a non-standard location. As the well is in the approximate middle of El Paso's San Juan 27-5 Unit, no offset leaseholders could in any way be affected. I therefore recommend that the location be approved.

Yours very truly

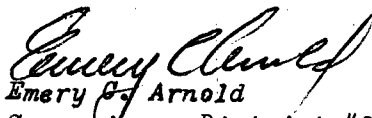
Emery G. Arnold
Supervisor, District #3

ECA:ks