

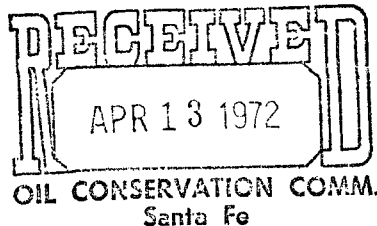

Handwritten: 4-13-72, NSL, issue
L. P. Thompson
Division Manager
Production Department
Hobbs Division

Western Hemisphere Petroleum Division
Continental Oil Company
P. O. 460
1001 North Turner
Hobbs, New Mexico 88240
(505) 393-4141



April 11, 1972

New Mexico Oil Conservation Commission (3)
P. O. Box 2088
Santa Fe, New Mexico 87501

Attention Mr. A. L. Porter, Jr., Secretary-Director

Gentlemen:

Application for Approval for Unorthodox Location for MCA Well No. 310

Continental Oil Company, as operator for the MCA Unit, hereby requests approval under the provisions of Order No. R-2403-A to drill MCA Unit Well No. 310 at a location 1295' from the north line and 1365' from the west line (Unit C) of Section 30, T-17S, R-32E, Lea County, New Mexico.

As shown on the attached plat this location is 25' from the nearest quarter-quarter section boundary line. The well is being drilled in conjunction with our current in-fill drilling evaluation program, and should result in the more efficient recovery of oil in this immediate area.

Since this well is located at lease 1/4 mile from the nearest outside boundary of the unit, it is respectfully requested that immediate approval of this location be given.

Yours very truly,

dw
CC + Enc:
New Mexico Oil Conservation Commission
P. O. Box 1980
Hobbs, New Mexico 88240

United States Geological Survey (2)
P. O. Box 1157
Hobbs, New Mexico

RLA JJB JWK

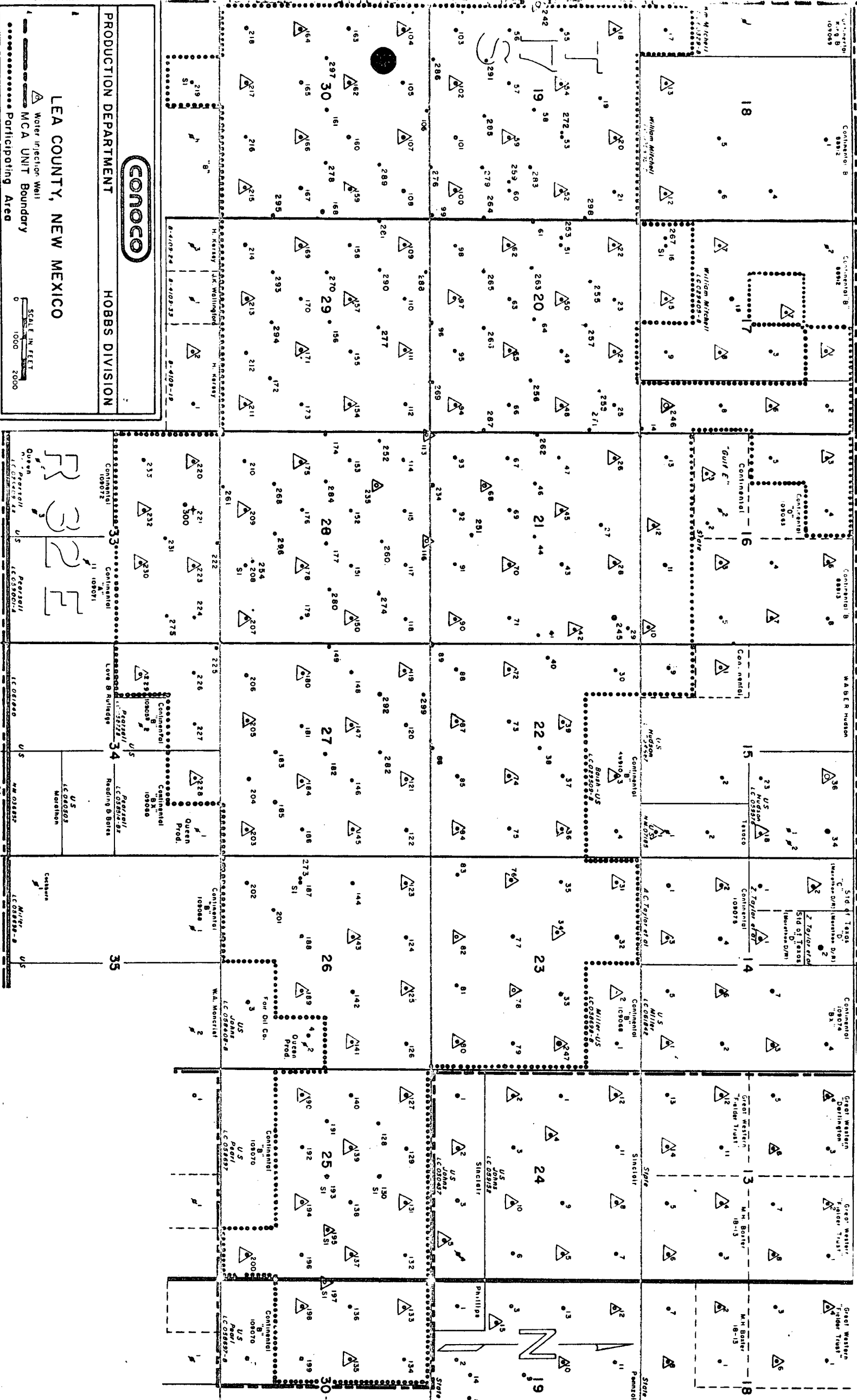

CONOCO

PRODUCTION DEPARTMENT
HOBBS DIVISION

LEA COUNTY, NEW MEXICO

Water Injection Well
MCA UNIT Boundary

SCALE IN FEET
0 1000 2000
Participating Area

R 32 E

