

El Paso Natural Gas Company

El Paso, Texas 79978

June 19, 1973

ADDRESS REPLY TO
POST OFFICE BOX 990
FARMINGTON, NEW MEXICO 87401

Mr. A. L. Porter, Secretary & Director
New Mexico Oil Conservation Commission
Post Office Box 2088
Santa Fe, New Mexico 87501

Dear Mr. Porter:

This is a request for administrative approval for an unorthodox gas well location in the Basin Dakota pool.

It is intended to locate the El Paso Natural Gas Company San Juan 28-4 Unit #37 1335' from the North line and 870' from the East line of Section 29 T-28-N, R-4-W, NMPM, Rio Arriba County, New Mexico. The East half of Section 29 is dedicated to this well.

The Northeast quarter of Section 29 is crossed by Munoz Canyon. The sides of this canyon are very steep, making an orthodox location extremely expensive to build.

All of the offsetting proration units are included in the San Juan 28-4 Unit of which El Paso Natural Gas Company is the operator.

Plats showing the proposed well location with terrain features and ownership of offset leases are attached.

Yours truly,

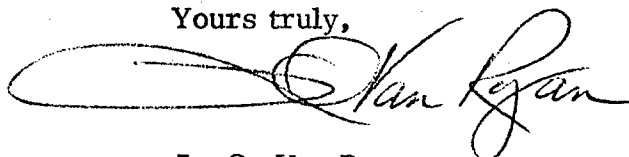

L. O. Van Ryan
Senior Petroleum Engineer

LOVR:pb

cc: Emery Arnold w/attachments
J. Permenter w/attachments
P. T. McGrath w/attachments

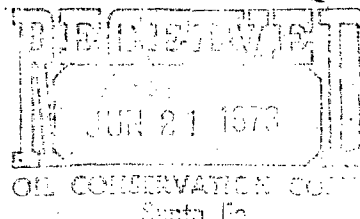

UNITED STATES
DEPARTMENT OF THE INTERIOR
GEOLOGICAL SURVEY

APPLICATION FOR PERMIT TO DRILL, DEEPEN, OR PLUG BACK

1a. TYPE OF WORK

DRILL ☒DEEPEN ☐PLUG BACK ☐

b. TYPE OF WELL

OIL
WELL ☐GAS
WELL ☒

OTHER

SINGLE
ZONE ☒MULTIPLE
ZONE ☐

2. NAME OF OPERATOR

El Paso Natural Gas Company

3. ADDRESS OF OPERATOR

PO Box 990, Farmington, NM 87401

4. LOCATION OF WELL (Report location clearly and in accordance with any State requirements.*)

At surface

1335'N, 870'E

At proposed prod. zone

14. DISTANCE IN MILES AND DIRECTION FROM NEAREST TOWN OR POST OFFICE*

15. DISTANCE FROM PROPOSED*

LOCATION TO NEAREST
PROPERTY OR LEASE LINE, FT.
(Also to nearest drlg. unit line, if any)

16. NO. OF ACRES IN LEASE

17. NO. OF ACRES ASSIGNED
TO THIS WELL

320.00

18. DISTANCE FROM PROPOSED LOCATION*
TO NEAREST WELL, DRILLING, COMPLETED,
OR APPLIED FOR, ON THIS LEASE, FT.

19. PROPOSED DEPTH

8784'

20. ROTARY OR CABLE TOOLS

Rotary

21. ELEVATIONS (Show whether DF, RT, GR, etc.)

7364'GL

22. APPROX. DATE WORK WILL START*

23.

PROPOSED CASING AND CEMENTING PROGRAM

SIZE OF HOLE	SIZE OF CASING	WEIGHT PER FOOT	SETTING DEPTH	QUANTITY OF CEMENT
13 3/4"	9 5/8"	32.3#	200'	220 cu. ft. to circulate
8 3/4"	7"	20.0#	4654'	210 cu. ft. to cover Ojo Alamo
6 1/4"	4 1/2"	10.5#&11.6#	8784'	635 cu. ft. to fill to intermediate casing

Selectively perforate and sandwater fracture the Dakota formation.

The E/2 of Section 29 is dedicated to this well.

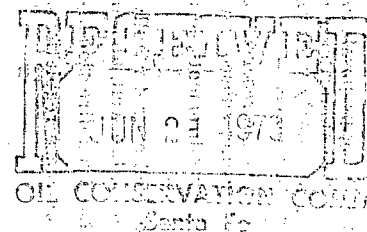

IN ABOVE SPACE DESCRIBE PROPOSED PROGRAM: If proposal is to deepen or plug back, give data on present productive zone and proposed new productive zone. If proposal is to drill or deepen directionally, give pertinent data on subsurface locations and measured and true vertical depths. Give blowout preventer program, if any.

24.

SIGNED

A. G. Lutes

TITLE

Drilling Clerk

DATE

June 20, 1973

(This space for Federal or State office use)

PERMIT NO.

APPROVAL DATE

APPROVED BY

TITLE

DATE

CONDITIONS OF APPROVAL, IF ANY:

NEW MEXICO OIL CONSERVATION COMMISSION
WELL LOCATION AND ACREAGE DEDICATION PLAT

Form C-192
Supersedes C-128
Effective 1-1-65

All distances must be from the outer boundaries of the Section.

Operator EL PASO NATURAL GAS COMPANY		Lease SAN JUAN 28-4 UNIT (NM-03863)		Well No. 37
Unit Letter H	Section 29	Township 28-N	Range 4-W	County RIO ARriba
Actual Footage Location of Well: 1335 feet from the NORTH line and 870 feet from the EAST line				
Ground Level Elev. 7364	Producing Formation DAKOTA	Pool BASIN DAKOTA	Dedicated Acreage 320.00 Acres	

1. Outline the acreage dedicated to the subject well by colored pencil or hatchure marks on the plat below.
2. If more than one lease is dedicated to the well, outline each and identify the ownership thereof (both as to working interest and royalty).
3. If more than one lease of different ownership is dedicated to the well, have the interests of all owners been consolidated by communitization, unitization, force-pooling, etc?

☒ Yes ☐ No If answer is "yes," type of consolidation Unitization

If answer is "no," list the owners and tract descriptions which have actually been consolidated. (Use reverse side of this form if necessary.)

No allowable will be assigned to the well until all interests have been consolidated (by communitization, unitization, forced-pooling, or otherwise) or until a non-standard unit, eliminating such interests, has been approved by the Commission.

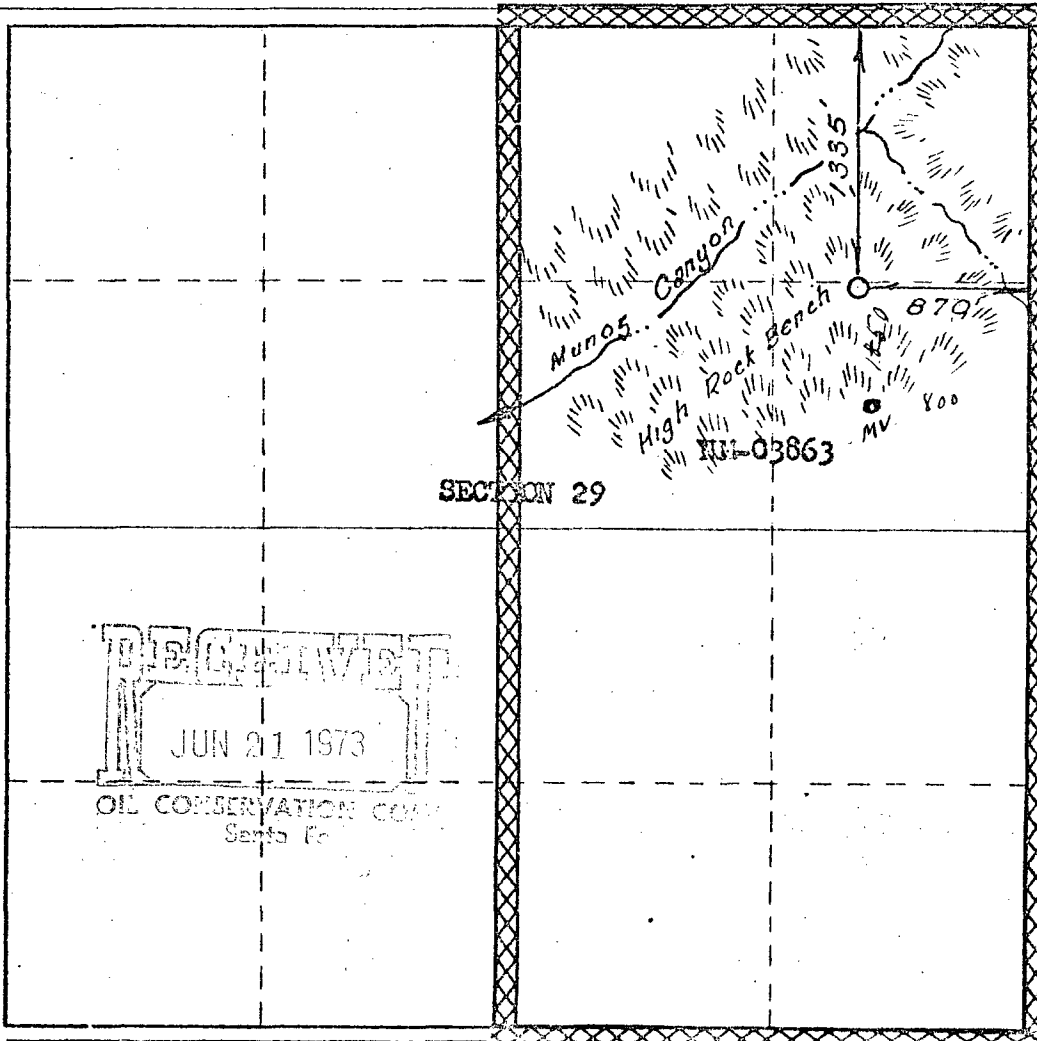

CERTIFICATION

I hereby certify that the information contained herein is true and complete to the best of my knowledge and belief.

Original Signed by
D. G. Brisco

Drilling Clerk

Position
El Paso Natural Gas Co.

Company
June 20, 1973

Date

I hereby certify that the well location shown on this plat was plotted from field notes of actual surveys made by me or under my supervision, and that the same is true and correct to the best of my knowledge and belief.

Date Surveyed
JUNE 4, 1973

Registered Professional Engineer
in Oil and Gas

[Signature]
Certificate No. **1760**

RECEIVED
JUN 21 1973
OIL CONSERVATION COM.
Santa Fe

R 4 W

El Paso Natural Gas

El Paso Natural Gas

El Paso Natural Gas

El Paso Natural Gas

El Paso Natural Gas

El Paso Natural Gas

37
(Kd)

1335'

870'

29

T
28
N

Amoco

Amoco

Amoco

* 30 (Kd)

* 32 (Kd)

RECEIVED
JUN 21 1973

OIL CONSERVATION COM.
Santa Fe

RECEIVED
JUN 21 1973
OIL CONSERVATION COM.
Santa Fe

DAKOTA OWNERSHIP

Offsetting E.P.N.G. San Juan 28-4 Unit No. 37 - 29 - 28N. - 4W.

Rio Arriba Co., New Mexico

SCALE: 3" = 1 Mile

DATE: 6/18/73

DRAWN BY: J.L.H.

OIL CONSERVATION COMMISSION
AZTEC DISTRICT

OIL CONSERVATION COMMISSION
BOX 2088
SANTA FE, NEW MEXICO

DATE June 25, 1973

Re: Proposed NSP _____

Proposed NWU _____

Proposed NSL XXXX

Proposed NFO _____

Proposed MC _____

Gentlemen:

I have examined the application dated June 19, 1973

for the El Paso Natural Gas Co. San Juan 28-4 Unit #37 H-29-28N-4W
Operator Lease and Well No. S-T-R

and my recommendations are as follows:

Approve

Yours very truly,

AR Kendrick

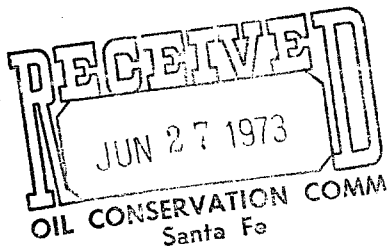

NEW MEXICO OIL CONSERVATION COMMISSION
WELL LOCATION AND ACREAGE DEDICATION PLAT

Form C-192
Supersedes C-128
Effective 1-1-65

All distances must be from the outer boundaries of the Section.

Operator EL PASO NATURAL GAS COMPANY			Lease SAN JUAN 28-4 UNIT (NM-03863)		Well No. 37
Unit Letter H	Section 29	Township 28-N	Range 4-W	County RIO ARriba	
Actual Portage Location of Well: 1335 feet from the NORTH line and 870 feet from the EAST line.					
Ground Level Elev. 7364	Producing Formation DAKOTA		Pool EAST DAKOTA	Dedicated Acreage 320.00 Acres	

1. Outline the acreage dedicated to the subject well by colored pencil or hatchure marks on the plat below.
2. If more than one lease is dedicated to the well, outline each and identify the ownership thereof (both as to working interest and royalty).
3. If more than one lease of different ownership is dedicated to the well, have the interests of all owners here dated by communitization, unitization, forced pooling, etc?

☒ Yes ☐ No If answer is "Yes" type via consolidation _____
OIL CONSERVATION COM. Santa Fe

Unitization _____

If answer is "no" list the owners and tract descriptions which have actually been consolidated. (Use reverse side of this form if necessary.) _____

No allowable will be assigned to the well until all interests have been consolidated (by communitization, unitization, forced-pooling, or otherwise) or until a non-standard unit, eliminating such interests, has been approved by the Commission.

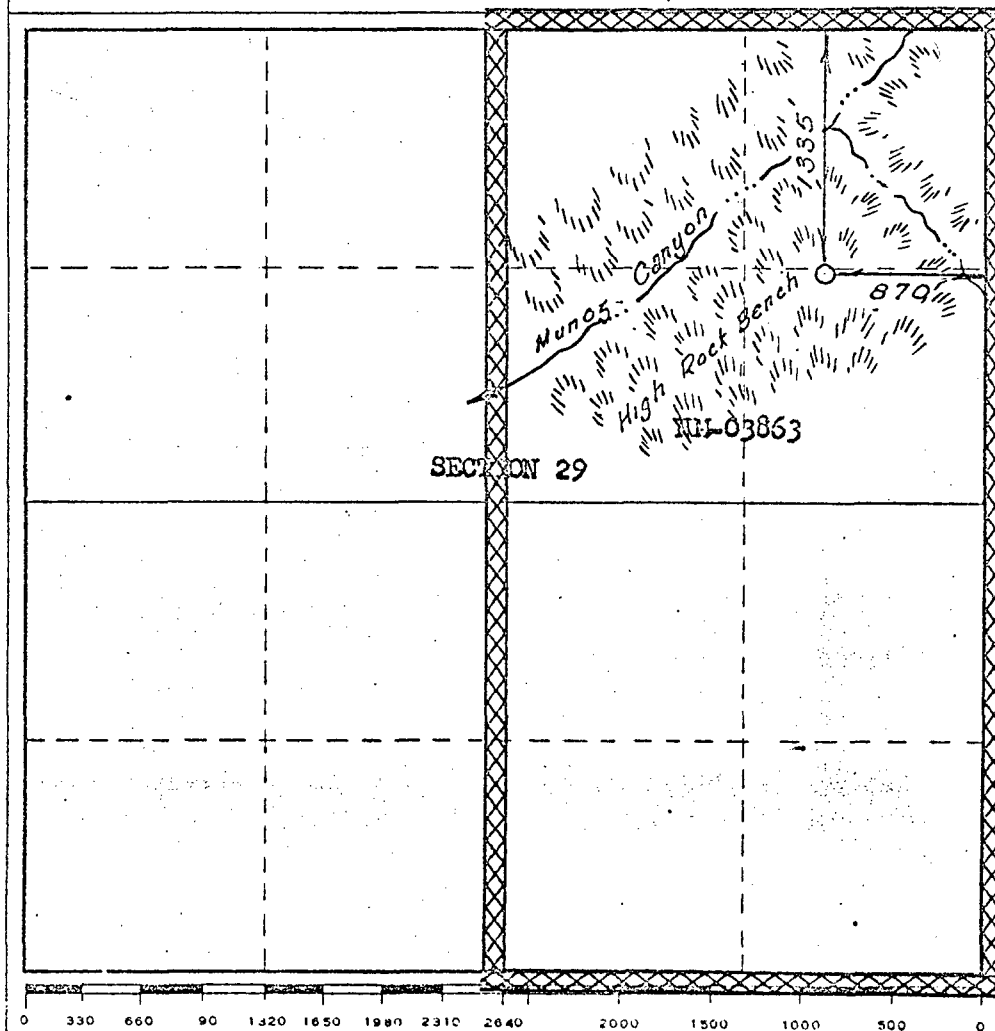

CERTIFICATION

I hereby certify that the information contained herein is true and complete to the best of my knowledge and belief.

Original Signed by

D. G. Brisco

Drilling Clerk

Position

El Paso Natural Gas Co.

Company

June 20, 1973

Date

I hereby certify that the well location shown on this plat was plotted from field notes of actual surveys made by me or under my supervision, and that the same is true and correct to the best of my knowledge and belief.

Date Surveyed

JUNE 4, 1973

Registered Professional Engineer and Land Surveyor

[Signature]
Certificate No. 1760