

LIVELY EXPLORATION COMPANY
960 Petroleum Club Building
Denver, Colorado 80202

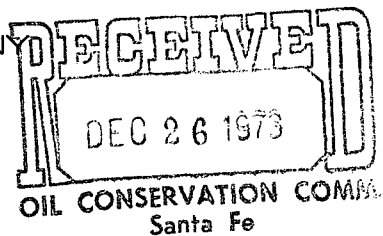

December 18, 1973

NSL - 638

Blue Jan 15

Mr. A. L. Porter, Secretary-Director
New Mexico Oil Conservation Commission
P.O. Box 2088
Santa Fe, New Mexico 87501

Re: Request for Administrative
Approval of Unorthodox Basin
Dakota Location For Lively
Well No. 20, E/2 Section 12,
26N - 8W, San Juan County,
New Mexico

Dear Mr. Porter:

Administrative approval for an unorthodox location, because of severe topographic conditions, is hereby requested for the Lively Well No. 20, a Basin Dakota test, located 560 feet West of the East section line and 890 feet North of the South section line.

The attached topographic map shows the rugged cliffs covering most of the E/2 of Section 12 leaving only a small portion of the proration unit with terrain where a practical location can be made.

Enclosed are:

1. Topographic plat showing the spacing unit, offset operators, and offset Basin Dakota wells,
2. Form C-102 showing surveyed location of Lively Well No. 20

Basin Dakota rights of offset leases are owned by El Paso Natural Gas Company, Southwest Production Company, Tenneco Oil Company, and Depco, Inc. Copies of this application have been mailed to each of these offset operators as of the date of this letter.

Yours very truly,

A handwritten signature in cursive script, appearing to read "V. E. Shryack".

Lively Exploration Company
V. E. Shryack, Agent

cc:





El Paso Natural Gas Company
P.O. Box 990
Petroleum Club Plaza Building
Farmington, New Mexico 87401

Southwest Production Company
3108 Southland Center
Dallas, Texas 75215

Tenneco Oil Company
Suite 1200
Lincoln Tower Building
Denver, Colorado 80203

Depco, Inc.
1025 Petroleum Club Building
Denver, Colorado 80202



-  El Paso Natural Gas Co.
-  Southwest Production Co.
-  Tenneco Oil Co.
-  Depco, Inc.

Lively Exploration Co.
Lively Well No. 20
Application for
Unorthodox Location

**NEW MEXICO OIL CONSERVATION COMMISSION
WELL LOCATION AND ACERAGE DEDICATION PLAT**

All distances must be from the outer boundaries of the Section

Operator Lively Exploration Company			Lease Lively		Well No. 20
Unit Letter P	Section 12	Township 26 North	Range 8 West	County San Juan	

Actual Footage Location of Well:
 890 feet from the **South** line and **560** feet from the **East** line

Ground Level Elev. 6229	Producing Formation	Pool	Dedicated Acreage: Acres
-----------------------------------	---------------------	------	---------------------------------

1. Outline the acreage dedicated to the subject well by colored pencil or hatchure marks on the plat below.
2. If more than one lease is dedicated to the well, outline each and identify the ownership thereof (both as to working interest and royalty),
3. If more than one lease of different ownership is dedicated to the well, have the interests of all owners been consolidated by communitization, unitization, force-pooling, etc?

() Yes () No If answer is "yes," type of consolidation

If answer is "no," list the owners and tract descriptions which have actually consolidated. (Use reverse side of this form if necessary.)

No allowable will be assigned to the well until all interests have been consolidated (by communitization, unitization, forced-pooling, or otherwise) or until a non standard unit, eliminating such interests, has been approved by the Commission.

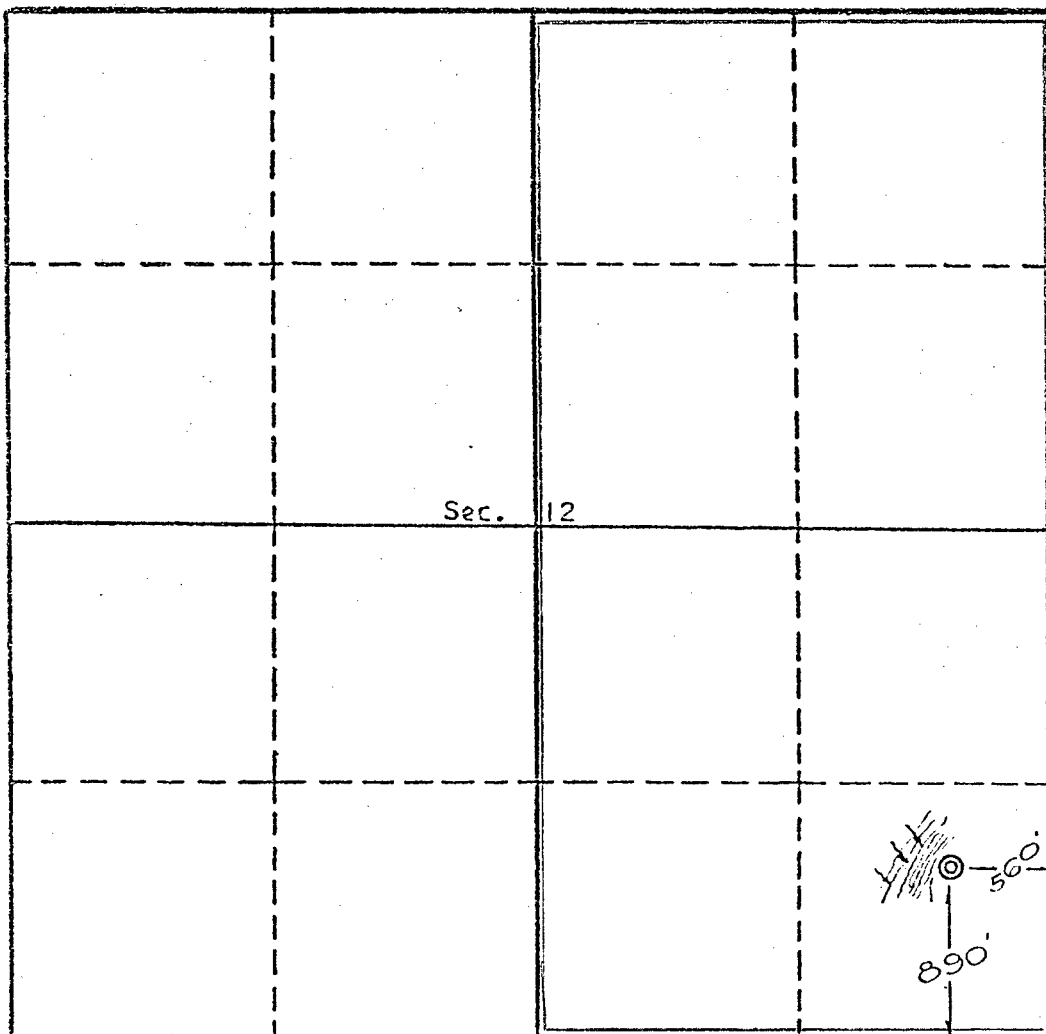

Scale, 1 inch = 1,000 feet

CERTIFICATION

I hereby certify that the information contained herein is true and complete to the best of my knowledge and belief.

Name _____

Position _____

Company _____

Date _____

I hereby certify that the well location shown on this plat was plotted from true notes of actual survey made by me or under my supervision, and that the same is true and correct to the best of my knowledge and belief.

Date Surveyed **V. ECHOHAWK**

December 13, 1973
Registered Professional Engineer
and/or Land Surveyor

E. V. Echohawk
Certificate No. **3602**
E. V. Echohawk LS

El Paso Natural Gas Company

El Paso, Texas 79978

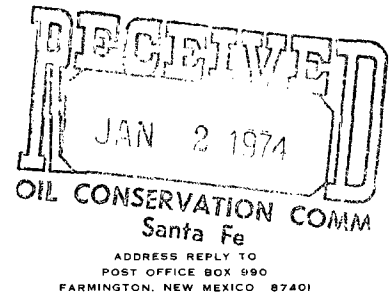

December 28, 1973

Mr. A. L. Porter, Secretary-Director
New Mexico Oil Conservation Commission
P. O. Box 2088
Santa Fe, New Mexico 87501

Dear Mr. Porter:

Re Request for Administrative Approval of Unorthodox Basin Dakota Location for Lively Well No. 20, E/2 Section 12, Township 26 North, Range 8 West, San Juan County, New Mexico, and for Lively Well No. 21, W/2 Section 31, Township 27 North, Range 7 West, Rio Arriba County, New Mexico

This is to advise you that El Paso Natural Gas Company, as an owner of offsetting acreage to the captioned wells, does hereby waive any objections to the above captioned unorthodox drilling locations.

Very truly yours,

John A. Ahlm
Regional Land Manager
Energy Resource Development

cc: Lively Exploration Company
Mr. Vince Shryack



W. C. Blackburn
Manager
Production Department
Casper Division
Western Hemisphere Petroleum Division

Continental Oil Company
152 North Durbin
Pacific Western Life Building
Casper, Wyoming 82601
(307) 234-7311

December 26, 1973

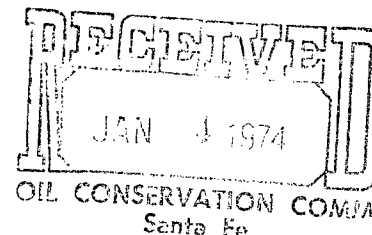

Mr. A. L. Porter
Secretary-Director
New Mexico Oil Conservation Commission
P. O. Box 2088
Santa Fe, New Mexico 87501

Dear Mr. Porter:

Request for Administrative Approval
of Unorthodox Basin Dakota Location
for Lively Well No. 21,
W $\frac{1}{2}$, Section 31, T27N, R7W,
Rio Arriba County, New Mexico
File: JO-986.511.N2-JO

Continental Oil Company, as an owner of leased lands offsetting the proposed unorthodox location for Lively Well No. 21, hereby waives all objections to the proposed location for the Dakota well by Lively Exploration Company.

Very truly yours,

er

cc: Lively Exploration Company
960 Petroleum Club Building
Denver, Colorado 80202

Tenneco Oil Company
Suite 1200
Lincoln Tower Building
Denver, Colorado 80203

Tenneco Oil
A Tenneco Company

Suite 1200
Lincoln Tower Building
Denver, Colorado 80203
(303) 292-9920

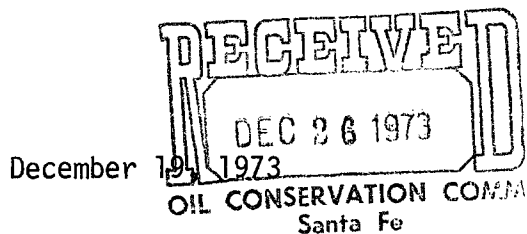

Mr. A. L. Porter
Secretary Director
New Mexico Oil Conservation Commission
P. O. Box 2088
Santa Fe, New Mexico 87501

Re: Lively Exploration Company
Request for Approval
Unorthodox Location
E/2, Section 12, T 25 N, R 8 W
San Juan County, New Mexico

Dear Mr. Porter:

Tenneco Oil Company has no objections to granting the request from Lively Exploration Company, by letter dated December 18, 1973, for administrative approval of an unorthodox Basin Dakota location.

Yours very truly,

TENNECO OIL COMPANY

A handwritten signature in cursive script, appearing to read "D. D. Myers".

D. D. Myers
Assistant Division
Production Manager

ADR/sy

cc: Lively Exploration Company
960 Petroleum Club Building
Denver, Colorado 80202